

R-36-E

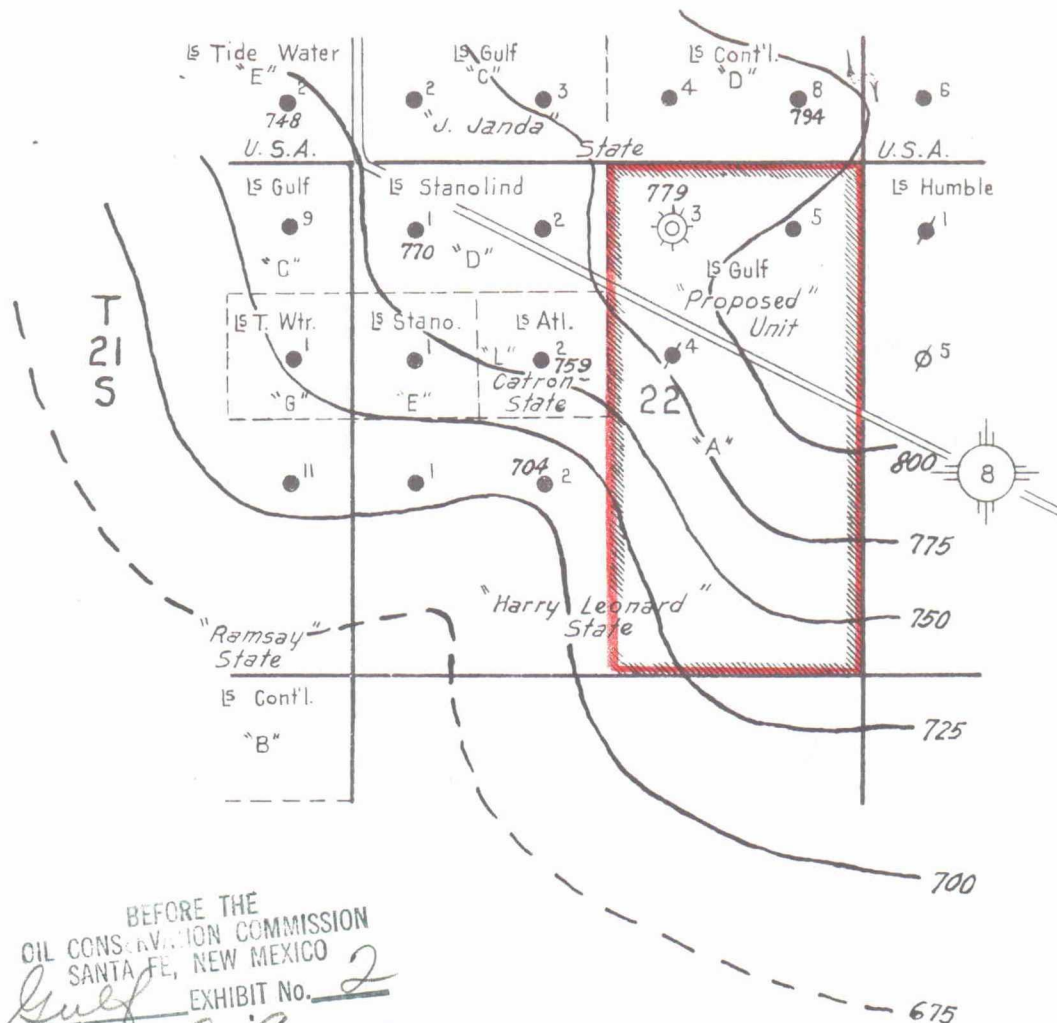

BEFORE THE
OIL CONSERVATION COMMISSION
SANTA FE, NEW MEXICO
Gulf EXHIBIT No. 2
CASE 919

GULF OIL CORPORATION
FORT WORTH PRODUCTION DIVISION
Scale 1" = 2,000'

Plat Accompanying Application for
320-Acre Non-Standard Gas Unit.

Gulf - Harry Leonard "A" Lease.

Structure Map Contoured on top
of Yates Horizon

Contour Interval - 25'