

# R-37-E

T  
20  
S

T  
21  
S

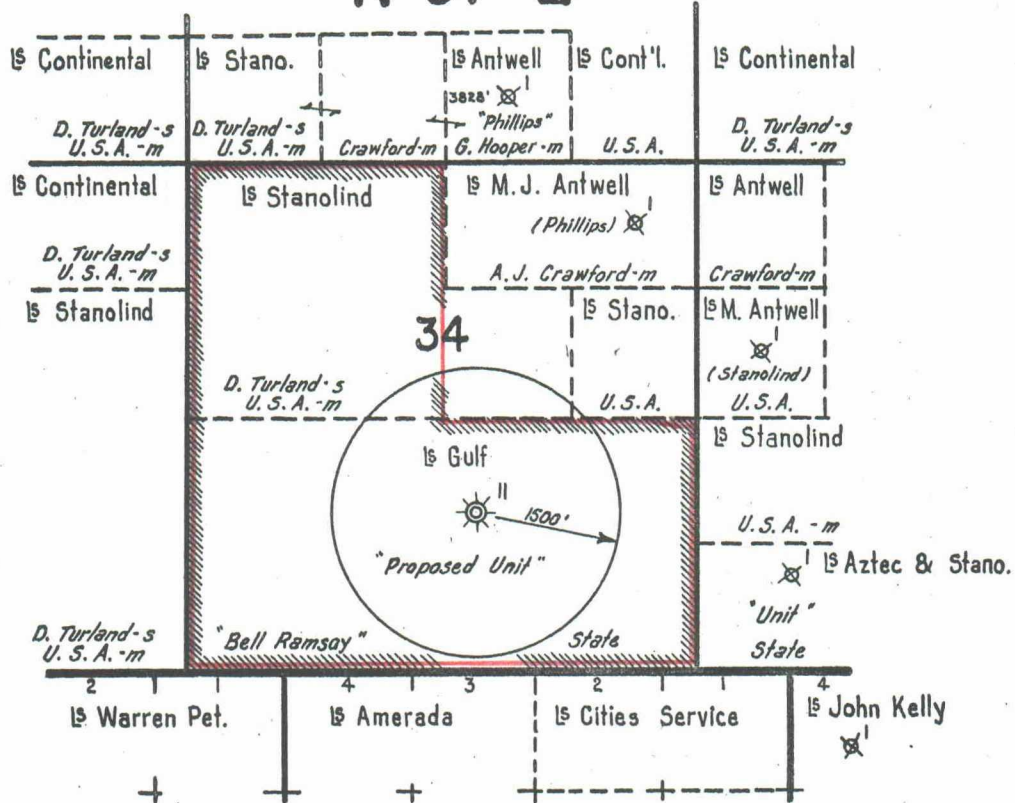

# R-36-E

BEFORE THE  
OIL CONSERVATION COMMISSION  
SANTA FE, NEW MEXICO  
EXHIBIT No. 1  
CASE 945

GULF OIL CORPORATION  
FORT WORTH PRODUCTION DIVISION  
Scale 1" = 2,000'

Plat Accompanying Application for  
Gulf-Stanolind 480 - Acre  
Non-Standard Gas Unit