



PETROLEUM AND ITS PRODUCTS

GULF OIL CORPORATION

P.O. DRAWER 1290 FORT WORTH 1, TEXAS

B. E. THOMPSON
DIVISION PRODUCTION MANAGER

FORT WORTH
PRODUCTION DIVISION

Oil Conservation Commission
State of New Mexico
Santa Fe, New Mexico

July 10, 1956

Re: Application for 160-Acre Non Standard Gas
Proration Unit, Blinebry Gas Pool, Com-
prising the E/2 and the SW/4 of the SW/4
and the SW/4 of the SE/4 of Section 23,
T-22-S, R-37-E, Lea County, New Mexico

Gentlemen:

As a result of our letter application dated September 6, 1955, Administrative Order NSP No. 193 authorized a 120-acre Non-Standard Gas Proration Unit in the Blinebry Gas Pool comprising the E/2 and the SW/4 of Section 23, T-22-S, R-37-E, with Gulf's O. I. Boyd Well No. 3 as the unit well.

It was originally planned to dedicate the other 40 acres of Gulf's Boyd Lease in this Section 23, being the SW/4 of the SE/4, to Anderson-Pritchard Oil Corporation's No. 1 Lee. However, due to the capacity of the Anderson-Pritchard well, it is now desired to combine the 40-acre SW/4 of the SE/4 with Gulf's O. I. Boyd approved 120-acre proration unit to form a 160-acre unit. It is respectfully requested that this matter be placed on the Docket for Examiner Hearing at an early date.

The following facts are offered in support of this application:

- (1) Gulf Oil Corporation is owner and operator of an oil and gas lease known as the O. I. Boyd Lease described above and shown on the attached plat.
- (2) Gulf Oil Corporation proposes that the above described acreage be established as a Non-Standard 160-Acre Gas Proration Unit in exception to NMOC Order No. R-610.
- (3) Gulf's O. I. Boyd Well No. 3, located 1980 feet from the south and west lines of Section 23, T-22-S, R-37-E, Lea County, New Mexico, was dually completed on May 12, 1955, as a gas-oil dual. This well produces oil from the Drinkard Oil Pool and gas from the Blinebry Gas Pool. The total depth of the well is 6420 feet with a packer set

July 10, 1956

at 6300 feet. The Blinebry Gas Zone is perforated between 5400 feet to 5550 feet. Applicant proposes to use this well as the unit well.

- (4) By copy of this letter of application, all operators owning interests in the section in which the proposed unit is located and all operators within 1500 feet of the proposed unit well are notified of the intent of Gulf Oil Corporation to form the proposed Non-Standard Gas Proration Unit.

Respectfully submitted

GULF OIL CORPORATION

By: B. E. Thompson
Division Production Manager

cc: Oil Conservation Commission
P. O. Box 2045
Hobbs, New Mexico

Anderson-Pritchard Oil Corporation
P. O. Box 196
Midland, Texas

R. Olsen Oil Company
Drawer Z
Jal, New Mexico

N. G. Penrose, Inc.
1815 Fair Building
Fort Worth, Texas

Samedan Oil Corporation
Route 2, Box 60-B
Big Spring, Texas

Sinclair Oil and Gas Company
P. O. Box 809
Roswell, New Mexico

R-37-E

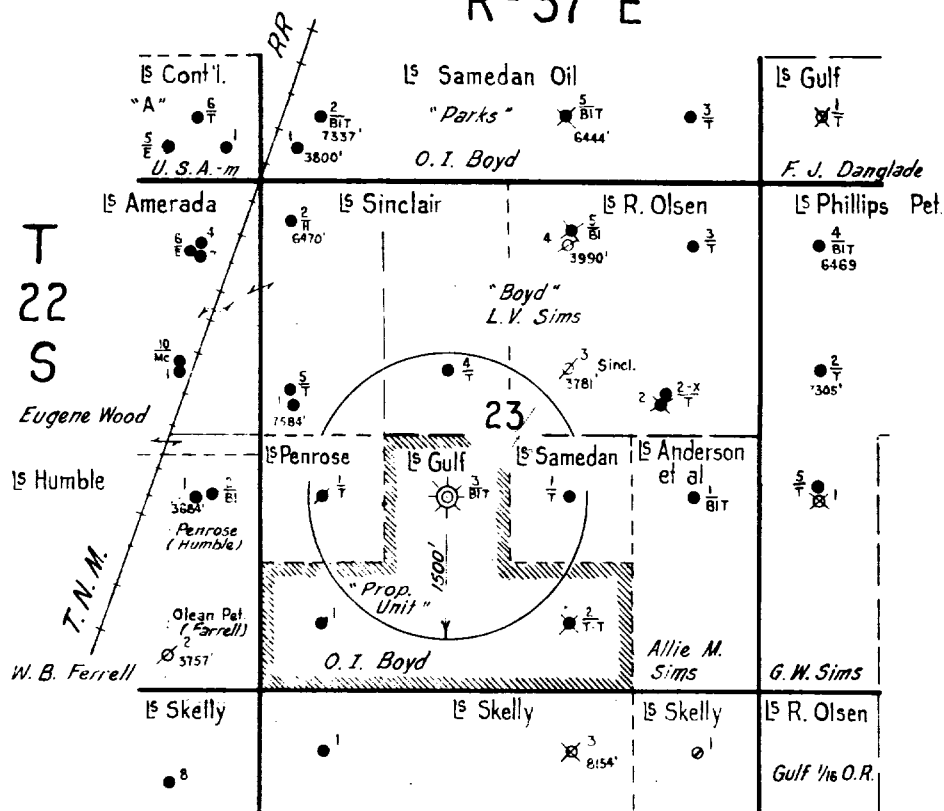

GULF OIL CORPORATION
FORT WORTH PRODUCTION DIVISION
Scale 1" = 2,000'

Plat Accompanying Application for
100-acre Non-Standard Gas Unit
(Blincy Gas Pool)

Gulf - O. I. Boyd Lease

R-37-E

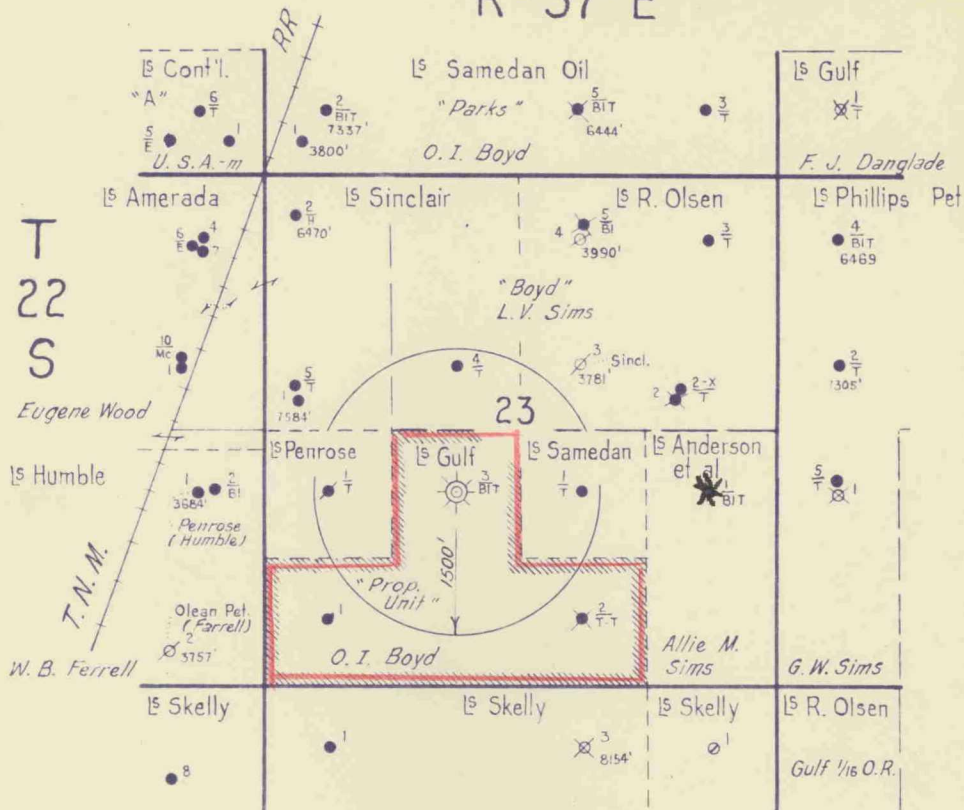

BEFORE THE
OIL CONSERVATION COMMISSION
SANTA FE, NEW MEXICO

EXHIBIT No. 1
CASE 1122

GULF OIL CORPORATION
FORT WORTH PRODUCTION DIVISION
Scale 1" = 2,000'

Plat Accompanying Application for
100-Acre Non-Standard Gas Unit
(Blinebry Gas Pool)

Gulf - O. I. Boyd Lease

Ex No. 1

CASE 1122

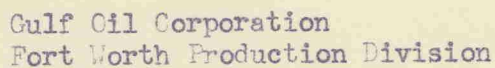

Proposed 160-Acre Non-Standard Blinbry Gas Unit
Assigned to Gulf's O. I. Boyd Well No. 3

Structure Contoured on Blinbry Marker
Contour Interval 50'

Scale 1" = 3000'

Case 1122

Ex 3

BEFORE THE
OIL CONSERVATION COMMISSION
SANTA FE, NEW MEXICO
EXHIBIT No. 3

OIL CONSERVATION
SANTA FE, NEW MEXICO
am EXHIBIT No. 3
CASE 1122

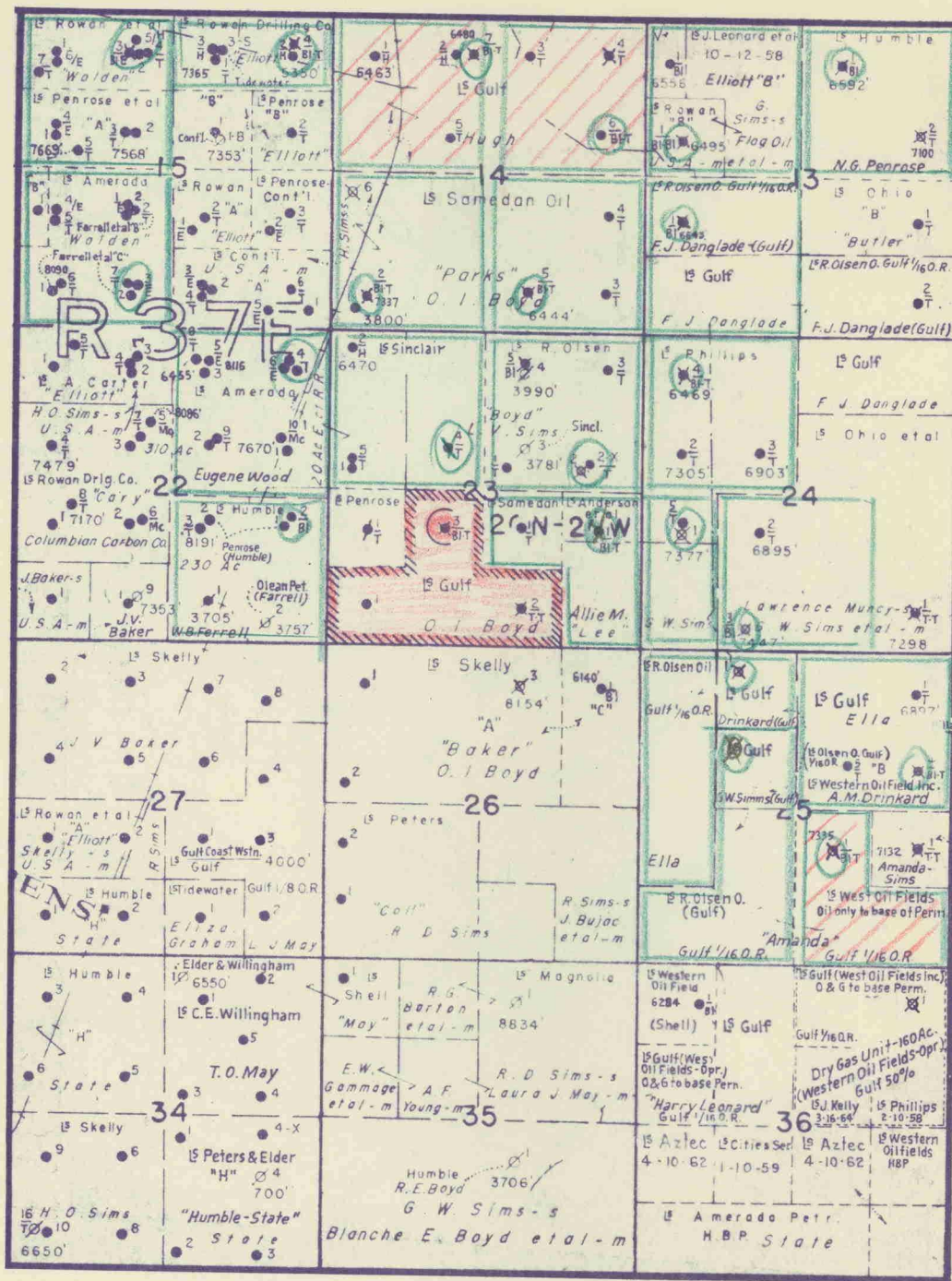

BEFORE THE
OIL CONSERVATION COMMISSION
SANTA FE, NEW MEXICO
EXHIBIT No. 4
CASE 112-2

Gulf Oil Corporation
Fort Worth Production Division

Proposed 160-Acre Non-Standard Blinbry Gas Unit
Assigned to Gulf's O. I. Boyd Well No. 3

Scale 1" = 3000'

Case No. 1122

Ex 4

Sec _____ Township No. _____ of Range No. _____

Case 1122

37E

Section 23

225

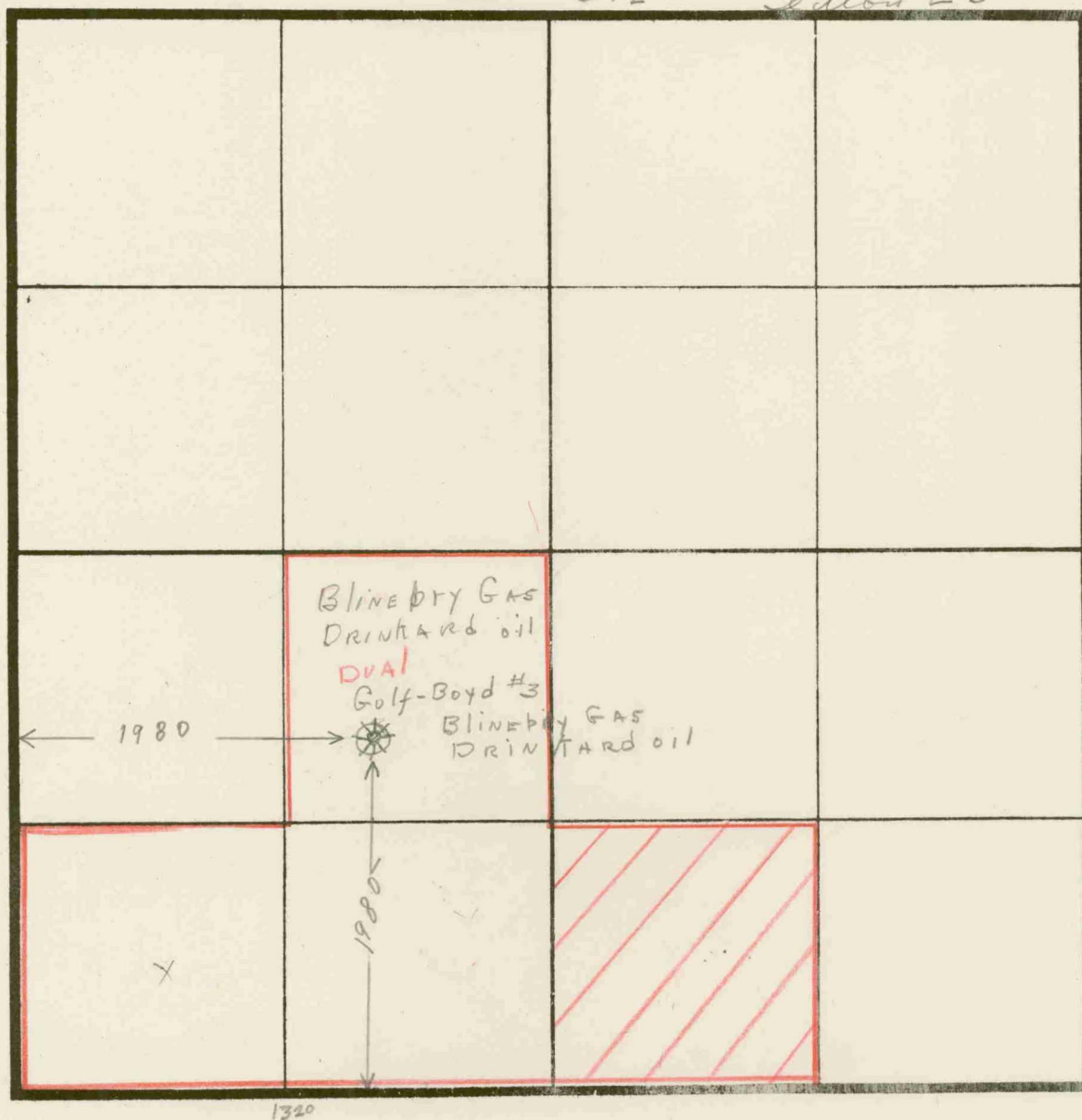

☑ To be added To NSR 193 AS AN EXCEPTION To
Rule 5 (A) R-610