

NEW MEXICO  
OIL CONSERVATION COMMISSION

Form C-128

Well Location and/or Gas Proration Plat

Date 3-12-57

Operator Hale Production Co. Lease Sanders State

Well No. 1 Section 22 Township 21 S Range 34 E NMPM

Located 2386 Feet From South Line, 670 Feet From West Line,

Lea County, New Mexico. G. L. Elevation \_\_\_\_\_

Name of Producing Formation \_\_\_\_\_ Pool \_\_\_\_\_ Dedicated Acreage \_\_\_\_\_

(Note: All distances must be from outer boundaries of Section)

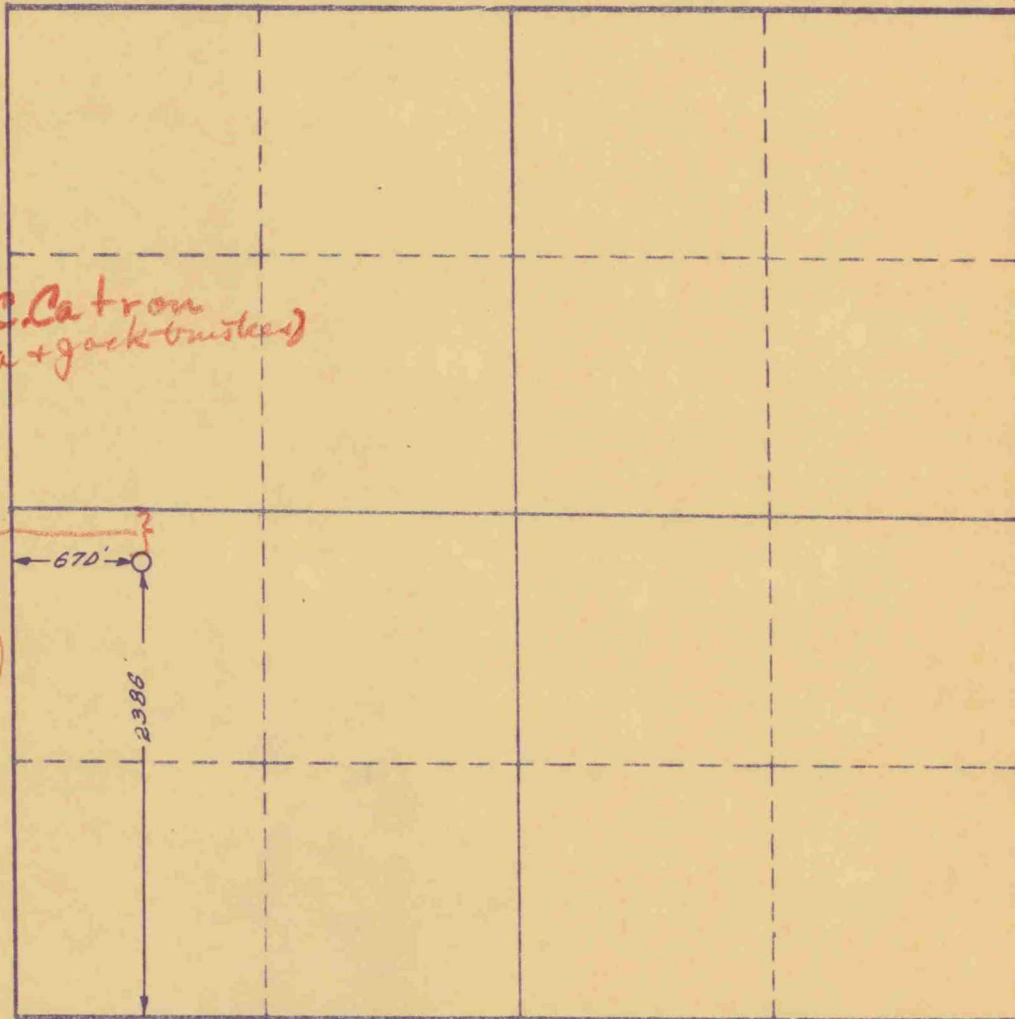

SCALE: 1" = 1000'

1. Is this Well a Dual Comp. ? Yes      No     .
2. If the answer to Question 1 is yes, are there any other dually completed wells within the dedicated acreage ? Yes      No     .

This is to certify that the above plat was prepared from field notes of actual surveys made by me or under my supervision and that the same are true and correct to the best of my knowledge and belief.

Name \_\_\_\_\_  
Position \_\_\_\_\_  
Representing \_\_\_\_\_  
Address \_\_\_\_\_

Date Surveyed 3-11-57  
John W. West  
Registered Professional Engineer and/or  
Land Surveyor