

Time Limit

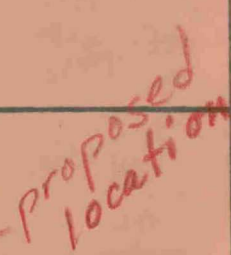

SANTA FE, NEW MEXICO  
maran EXHIBIT No. 1  
CASE 1248

CONTOURED ON TOP OF THE DRINKARD  
CONTOUR INTERVAL 20 FEET

Cyphlet "A"

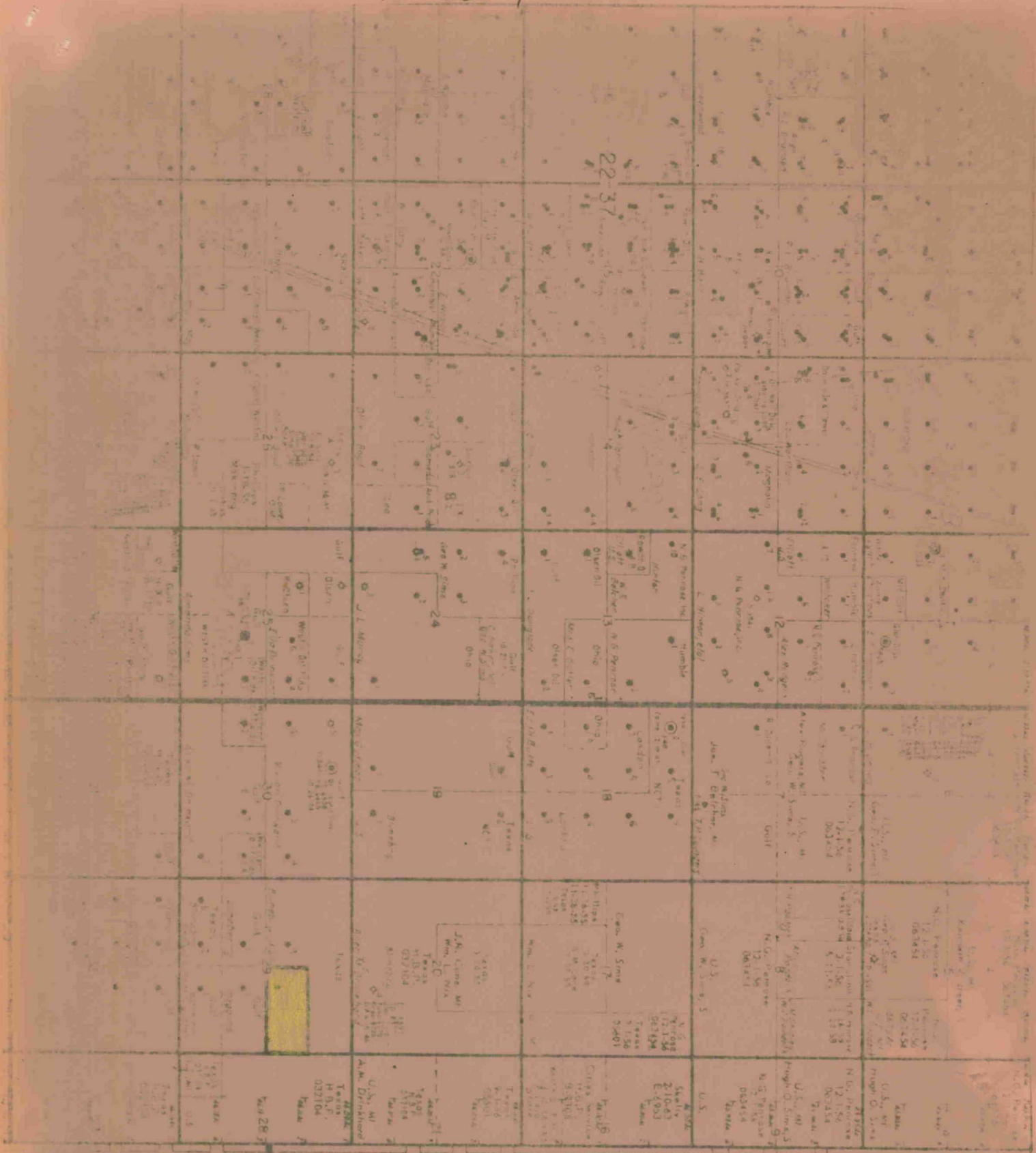

22-37

T 22 S

BLK. A-39

Cyphlet "A"

# Exhibit B

## DIAGRAMATIC SKETCH OF GAS-OIL DUAL COMPLETION

Tubb Gas

Drinkard Oil

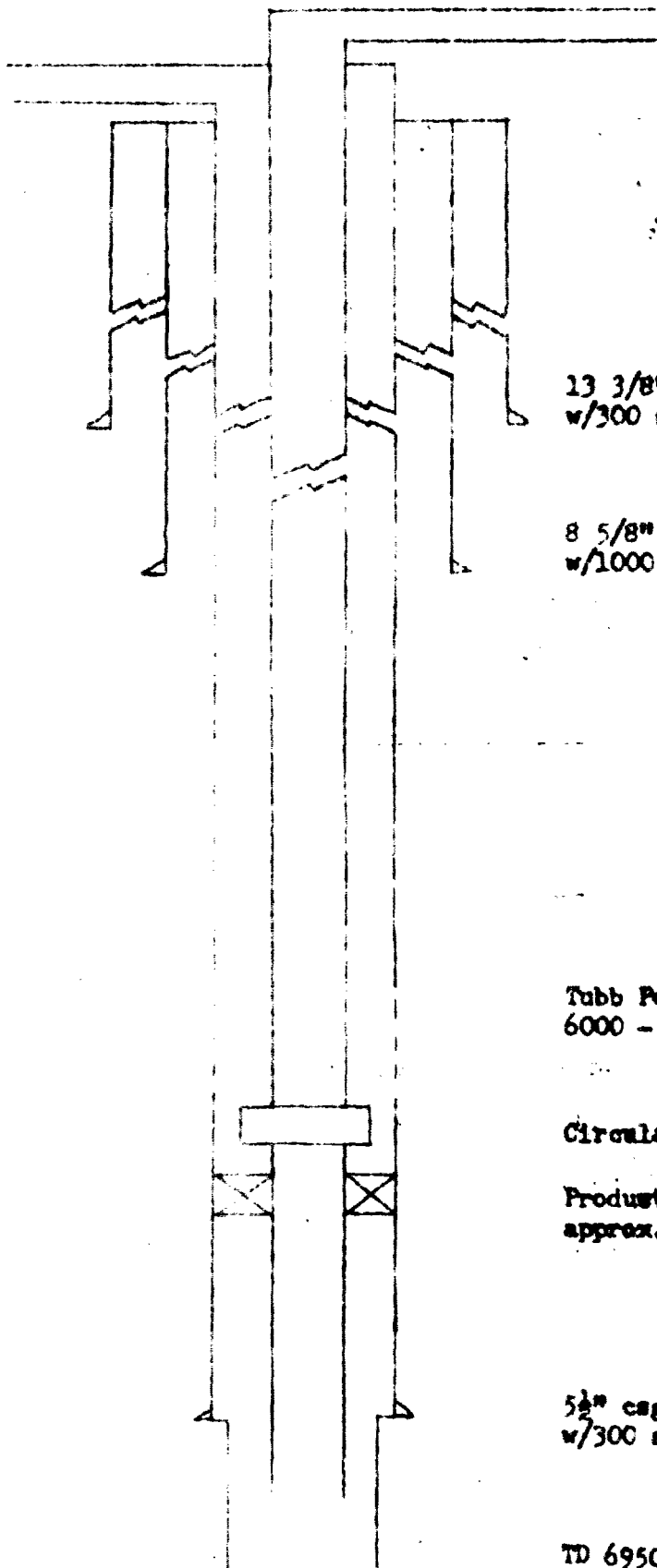

13 3/8" csg. @ 300'  
w/300 sx. cement circulated

8 5/8" csg @ 3000' approx.  
w/1000 sx cement

Tubb Perforations  
6000 - 6300' approx.

Circulating tool

Production Packer @ 6350'  
approx.

5 1/2" csg. @ 6900' approx.  
w/300 sx. cement

TD 6950' approx.

STATE OF NEW MEXICO

COUNTY OF LEA

Before me the undersigned authority on this day personally appeared R. M. Moran, known to me to be the duly authorized agent of this company who upon his oath says that the foregoing is true and correct to the best of his knowledge.

Subscribed and sworn to  
before me this 1<sup>st</sup>  
day of April 1957.

Jane Goddard  
Notary Public

My Commission Expires

February 10, 1960