

BEFORE THE
OIL CONSERVATION COMMISSION
SANTA FE, NEW MEXICO
EXHIBIT No. 3
CASE 1257

I HEREBY CERTIFY THAT THIS PLAT WAS MADE
FROM NOTES TAKEN IN THE FIELD IN A BONA FIDE
SURVEY MADE UNDER MY SUPERVISION, AND THAT
THE SAME IS TRUE AND CORRECT TO THE BEST OF
MY KNOWLEDGE AND BELIEF.

John W West
JOHN W WEST, PE & LS NO. 676

SOUTH CARTER
SAN ANDRES FIELD

LEA COUNTY, NEW MEXICO
& GAINES COUNTY, TEXAS

SCALE 1" = 2000' DATE 5-1-1957

R 39 E

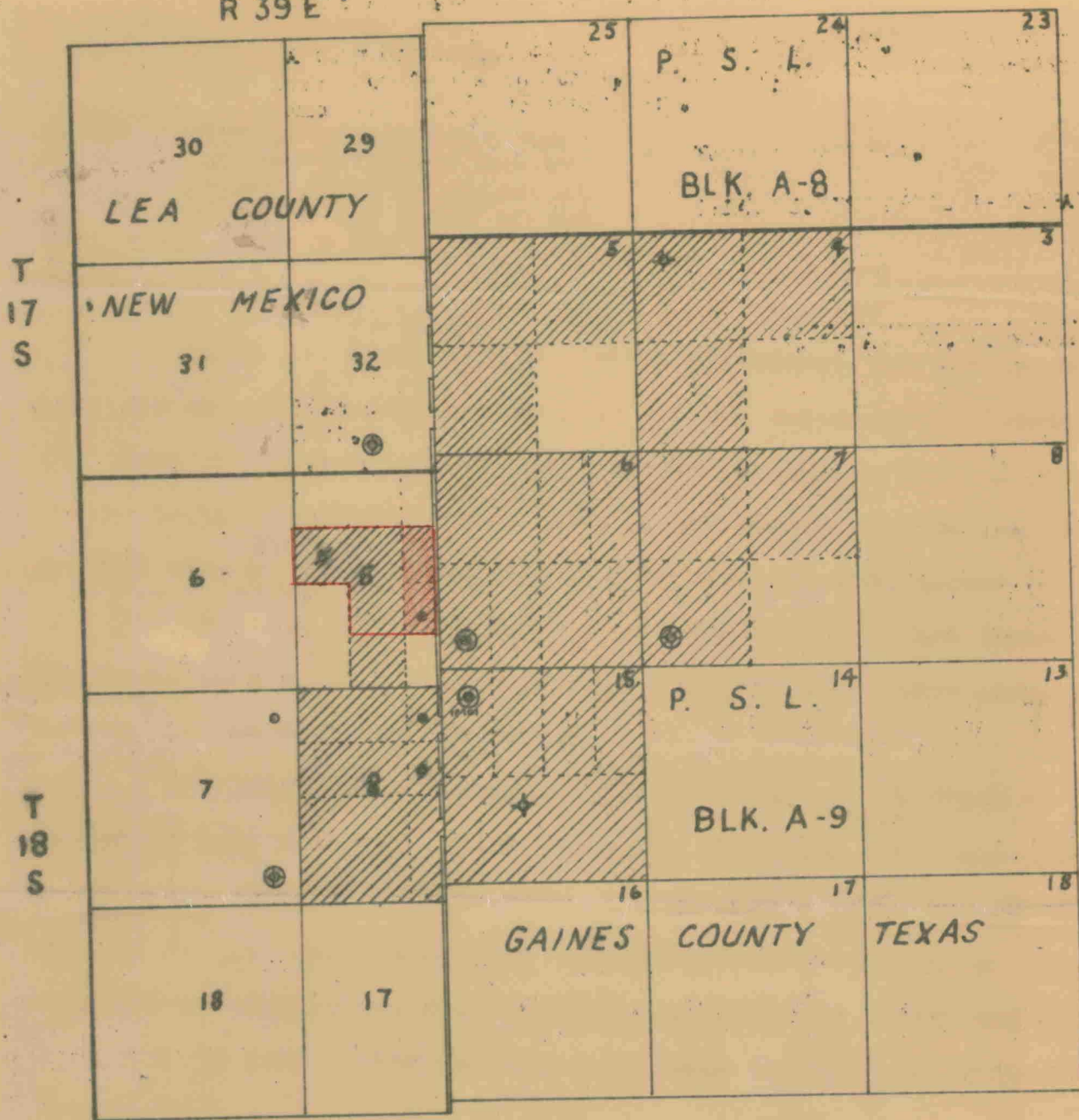

SCALE 1" : 4000'

EXHIBIT "A"

RAILROAD COMMISSION OF TEXAS

OIL AND GAS DIVISION

DISTRICT SUPERVISOR JUNE 1 1937		COUNTY SANTA FE	EXEMPT FIELD CRACKER - NEW MEXICO (SAN ANTONIO)	
DATE OF ISSUANCE 6/15/37	SUPPLEMENT NO. 2-100-2	EFFECTIVE DATE 6/24/37	THE ALLOWABLE FOR (NAME OF OPERATOR) CRACKER MINING & MILLING CO.	
LEASE NAME CRACKER			WELL NO. 1	
Has been set at Cch. Per Day 200	PLUS 200	MINUS	How or Retest	No. Hrs. Tested
			Size Cch.	Potential Cch.
			How Field	How Oper.
			How Lease	Remove Lease
			WELL COUNT PLUS MINUS	

REMARKS:

BEFORE THE
OIL CONSERV. COMMISSION
SANTA FE, NEW MEXICO

CASE 1257 ⁵

The allowable set forth above supersedes all previous allowables set for this well or wells irrespective of the manner in which such previous allowables were set, unless otherwise noted under "Remarks."

This letter constitutes authority for the purchaser or gatherer of oil produced from this well or wells, to take the allowable production accumulating or accumulated from the effective date above shown until the issuance of a new schedule in which the allowable for this well or wells will be included. The presentation of this letter, which you will deliver to the operator owning such well, in support of an SW-2, will be authority for the clearance of such accumulated production.

By order of the Railroad Commission of Texas

Darryl M. Bates

ILLEGIBLE

Chief Supervisor
Oil and Gas Division
Railroad Commission of Texas

RAILROAD COMMISSION OF TEXAS

OIL AND GAS DIVISION

DISTRICT SUPERVISOR JUNE 2 1937		COUNTY EL PASO	FIELD EL PASO - NEW MEXICO (SAL AMERICA)						
DATE OF ISSUANCE 2/13/37	SUPPLEMENT NO. 10-3094-3	EFFECTIVE DATE 2/14/37	THE ALLOWABLE FOR (NAME OF OPERATOR) QUINTA MEXICANA PETROLEUM CO.						
LEASE NAME 20076			WELL NO. 1						
Not Done Set At Bbls Per Day 200 BBL	PLUS 200 BBL	MINUS	<table border="1"> <tr> <th>Well Count</th> <th>PLUS</th> <th>MINUS</th> </tr> <tr> <td></td> <td></td> <td></td> </tr> </table>	Well Count	PLUS	MINUS			
Well Count	PLUS	MINUS							
Size Choke	Potential Bbls	New Field	New Oper.						
		New Lease	Removes Lease						

REMARKS:

BEFORE THE
OIL CONSERV. COMMISSION
SANTA FE, NEW MEXICO

CASE 1237

The allowable set forth above supersedes all previous allowables set for this well or wells irrespective of the manner in which such previous allowables were set, unless otherwise noted under "Remarks."

This letter constitutes authority for the purchaser or gatherer of oil produced from this well or wells, to take the allowable production accumulating or accumulated from the effective date above shown until the issuance of a new schedule in which the allowable for this well or wells will be included. The presentation of this letter, which you will deliver to the operator owning such well, in support of an SW-2, will be authority for the clearance of such accumulated production.

By order of the Railroad Commission of Texas

Darryl M. Bates

ILLEGIBLE

Chief Supervisor
Oil and Gas Division
Railroad Commission of Texas

RAILROAD COMMISSION OF TEXAS

OIL AND GAS DIVISION

DISTRICT SUPERVISOR JES. GUNTER		COUNTY GAINES	EXEMPT FID.	FIELD CARTER-NEW MEXICO (SAN ANDRES)
DATE OF ISSUANCE 1/4/57	SUPPLEMENT NO. 8-1091-1	EFFECTIVE DATE 12/24/56	THE ALLOWABLE FOR NAME OF OPERATOR GREAT WESTERN DRILLING CO.	
LEASE NAME C. A. TAYLOR		WELL NO. 1		
Has Been Set At Bbls Per Day 120 MFX	PLUS 120 MFX	MINUS	How or Retest H	No. Hrs. Tested 24
			Size Coke 161	Potential Bbls 161
			New Field X	New Oper X
			New Lease X	Remove Lease
			WELL COUNT PLUS MINUS	

REMARKS:

BEFORE THE
OIL CONSERVATION COMMISSION
SANTA FE, NEW MEXICO

IT NO. 11
CASE 1257

The allowable set forth above supersedes all previous allowables set for this well or wells irrespective of the manner in which such previous allowables were set, unless otherwise noted under "Remarks."

This letter constitutes authority for the purchaser or gatherer of oil produced from this well or wells, to take the allowable production accumulating or accumulated from the effective date above shown until the issuance of a new schedule in which the allowable for this well or wells will be included. The presentation of this letter, which you will deliver to the operator owning such well, in support of an SW-2, will be authority for the clearance of such accumulated production.

By order of the Railroad Commission of Texas

Darryl M. Bates

Chief Supervisor
Oil and Gas Division
Railroad Commission of Texas

ILLFGRIF