

(SUBMIT IN TRIPLICATE)

UNITED STATES
DEPARTMENT OF THE INTERIOR
GEOLOGICAL SURVEY

Land Office Las Cruces
Lease No. 065447
Unit 4

SUNDRY NOTICES AND REPORTS ON WELLS

| | | | |
|---|-------------------------------------|---|--|
| NOTICE OF INTENTION TO DRILL..... | <input checked="" type="checkbox"/> | SUBSEQUENT REPORT OF WATER SHUT-OFF..... | |
| NOTICE OF INTENTION TO CHANGE PLANS..... | | SUBSEQUENT REPORT OF SHOOTING OR ACIDIZING..... | |
| NOTICE OF INTENTION TO TEST WATER SHUT-OFF..... | | SUBSEQUENT REPORT OF ALTERING CASING..... | |
| NOTICE OF INTENTION TO RE-DRILL OR REPAIR WELL..... | | SUBSEQUENT REPORT OF RE-DRILLING OR REPAIR..... | |
| NOTICE OF INTENTION TO SHOOT OR ACIDIZE..... | | SUBSEQUENT REPORT OF ABANDONMENT..... | |
| NOTICE OF INTENTION TO PULL OR ALTER CASING..... | | SUPPLEMENTARY WELL HISTORY..... | |
| NOTICE OF INTENTION TO ABANDON WELL..... | | | |

(INDICATE ABOVE BY CHECK MARK NATURE OF REPORT, NOTICE, OR OTHER DATA)

Well No. 1 is located 1980 ft. from N line and 1980 ft. from E line of sec. 13
13 of sec. and 13 of 20S (Range) 3E (Section) N.M.P.M. (Meridian)
Texas (Field) Lee (County or Subdivision) New Mexico (State or Territory)

The elevation of the derrick floor above sea level is 3606 ft. Est.

DETAILS OF WORK

(State names of and expected depths to objective sands; show sizes, weights, and lengths of proposed casings; indicate mudding jobs, cementing points, and all other important proposed work)

Propose to drill a Yates zone oil well with cable tools with the following casing program: *

Surface Casing - 13-3/8" 48#, set at approx. 60'
Water Shut-off String - 8-5/8" 24# or 10-3/4" 32.75#, casing at approx. 1000'.
Production String - 5 1/2" 14# casing at approx. 3200'.

Propose to pull all casing except production string and cement to surface of ground.

*Hearing requested for exception to Csg. Requirements of 8-111-A.

I understand that this plan of work must receive approval in writing by the Geological Survey before operations may be commenced.

Company SOUTHERN CALIFORNIA PETROLEUM CORP.
 Address Box 1071
Midland, Texas

By Nile R. OwensTitle Petroleum Engineer

II LEGIBLE

NEW MEXICO OIL CONSERVATION COMMISSION

Santa Fe, New Mexico

(Form C-104)
Revised 7/1/57

REQUEST FOR (OIL) - (GAS) ALLOWABLE

New Well
Recompletion

This form shall be submitted by the operator before an initial allowable will be assigned to any completed Oil or Gas well. Form C-104 is to be submitted in QUADRUPPLICATE to the same District Office to which Form C-101 was sent. The allowable will be assigned effective 7:00 A.M. on date of completion or recompletion, provided this form is filed during calendar month of completion or recompletion. The completion date shall be that date in the case of an oil well when new oil is delivered into the stock tanks. Gas must be reported on 15.025 psia at 60° Fahrenheit.

Midland, Texas

Sept. 18, 1957

(Place)

(Date)

WE ARE HEREBY REQUESTING AN ALLOWABLE FOR A WELL KNOWN AS:

SOUTHERN CALIFORNIA PET. CORP. Federal-Bobb "C" Well No. 1, in SW 1/4 NE 1/4,

(Company or Operator)

(Lease)

G, Sec. 13, T. 20S, R. 33E, NMPM, Teas Pool

Unit Letter

Lea

Please indicate location:

| | | | |
|---|---|---|---|
| D | C | B | A |
| E | F | G | H |
| L | K | J | I |
| M | N | O | P |

County. Date Spudded 7-21-57 Date Drilling Completed 8-30-57

Elevation 3607 DF Total Depth 3389 PBD 3356

Top Oil/Gas Pay 3290 Name of Prod. Form. Yates

PRODUCING INTERVAL -

Perforations 3292-3328

Open Hole Depth Casing Shoe 3369 Depth Tubing 3274

OIL WELL TEST -

Natural Prod. Test: - bbls. oil, - bbls water in - hrs, - min. Size Choke

Test After Acid or Fracture Treatment (after recovery of volume of oil equal to volume of load oil used): 60 bbls. oil, 0 bbls water in 24 hrs, - min. Size Choke Pump

GAS WELL TEST -

Natural Prod. Test: - MCF/Day; Hours flowed - Choke Size -

Method of Testing (pitot, back pressure, etc.): -

Test After Acid or Fracture Treatment: - MCF/Day; Hours flowed -

Choke Size - Method of Testing: -

Acid or Fracture Treatment (Give amounts of materials used, such as acid, water, oil, and sand): 250 gals. MA, 10,000 gals. ref. oil & 15,000# sand
Casing Press. 1900 Tubing Press. 2900 Date first new oil run to tanks Sept. 14, 1957 & 200 B. oil

Oil Transporter Texas-New Mexico Pipe Line Co.

Gas Transporter none

Tubing, Casing and Cementing Record

| Size | Feet | Sax |
|--------|------|-----|
| 5 1/2" | 3369 | 995 |
| 2-3/8" | 3274 | |
| | | |
| | | |

Remarks:

I hereby certify that the information given above is true and complete to the best of my knowledge.

Approved: _____, 19____

SOUTHERN CALIFORNIA PETROLEUM CORP.

(Company or Operator)

OIL CONSERVATION COMMISSION

By: _____

Title: _____

By: _____

(Signature)

Title: Division Engineer

Send Communications regarding well to:

Name: SO. CAL. PET. CORP.

Address: Box 1071, Midland, Texas

NEW MEXICO
OIL CONSERVATION COMMISSION

Form C-128

Well Location and/or Gas Proration Plat

Date 5-18-57

Operator Southern California Pet. Corp. Lease ~~Bob - G~~ Federal-Bobb "C"

Well No. 1 Section 13 Township 20 S Range 33 E NMPM

Located 1980 Feet From North Line, 1980' Feet From East Line,

Lea County, New Mexico. G. L. Elevation 3606 Est.

Name of Producing Formation Yates Pool Teas Dedicated Acreage 40

(Note: All distances must be from outer boundaries of Section)

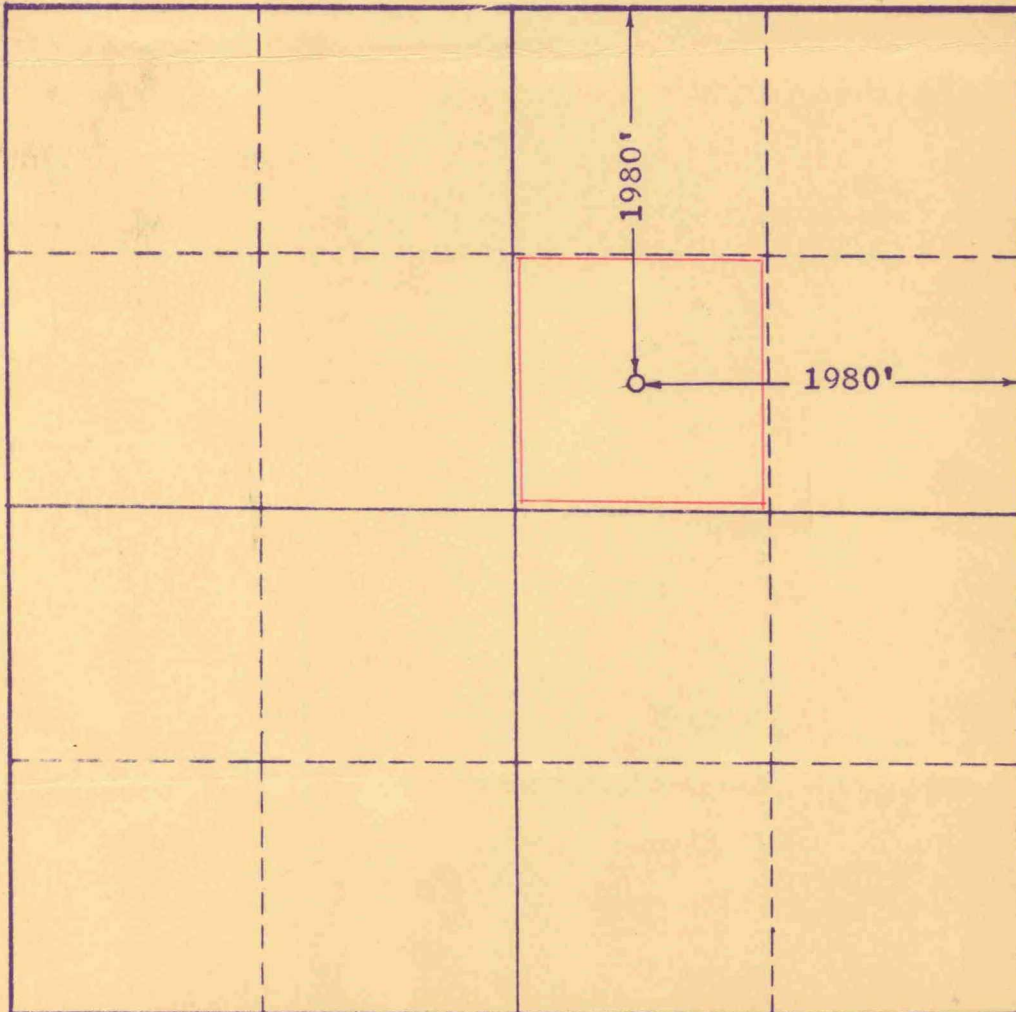

SCALE: 1"=1000'

1. Is this Well a Dual Comp. ? Yes No x
2. If the answer to Question 1 is yes, are there any other dually completed wells within the dedicated acreage? Yes No

This is to certify that the above plat was prepared from field notes of actual surveys made by me or under my supervision and that the same are true and correct to the best of my knowledge and belief.

Name Neil J. Owens
Position Petroleum Engineer
Representing SO. CAL. PET. CORP.
Address Box 1071, Midland, Texas

Date Surveyed 5-18-57
John W. West
Registered Professional Engineer and/or
Land Surveyor

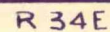

Exhibit A

EXAMINER HEARING July 2, 1957

Oil Conservation Commission 9:00 a.m., Mabry Hall, State Capitol,
Santa Fe

The following case will be heard before Daniel S. Nutter,
Examiner:

CASE 1274: Application of Southern California Petroleum Corporation
for an exception from the shallow-zone casing require-
ments in the Potash-Oil Area as established by Order
BOBB **R**-111-A. Applicant, in the above-styled cause, seeks an
"C" No. 1 order authorizing the following casing program in lieu of
the shallow-zone casing requirements established by Order
R-111-A for its proposed well to be drilled at a point
1980 feet from the North and East lines of Section 13,
Township 20 South, Range 33 East, in the Teas Pool, Lea
County, New Mexico.

13 3/8-inch casing in the top of the Red Beds at about
60 feet.

8- 5/8-inch or 10 3/4-inch casing at approximately 1,000
feet, but in any event below the water.

5 1/2-inch casing at approximately 3,200 feet in the
top of the Yates formation.

In the event production is encountered, applicant proposes
to pull all casing except the production string and to
cement the production casing to the surface.

Examiner Nutter, I am James A. Warren, Division Engineer for
Southern California Petroleum Corporation, Midland, Texas, and I
represent this company today in Case 1274. I have previously testi-
fied before the Commission as an engineering witness for this company.
If my qualifications are acceptable to the Examiner, I will proceed
with the testimony.

Southern California Petroleum Corporation filed an application
on ~~May~~ 20, 1957, for an examiner hearing regarding an exception to
the shallow-zone casing requirements in the Potash-Oil Area as estab-
lished by Order R-111-A dated October 13, 1955. Copies of this appli-
cation were mailed to the Potash Co. of America, Carlsbad, New Mexico,
and the U. S. G. S. offices in Carlsbad and Artesia, New Mexico.

Southern California Petroleum Corporation is the operator of
six of the fourteen wells in the Teas Pool and now proposes to drill
a new well in the SW $\frac{1}{4}$ of the NE $\frac{1}{4}$ of Section 13, T20S-R33E, (1980
feet from the north and east lines of said Section 13). This location
falls in the center of Unit G, being a part of Federal Government
Lease "Las Cruces No. 065447". This lease is within the horizontal

limits of the Teas Pool and the Potash-Oil Area as defined by Order R-111-A. A plat of the Teas Pool area was submitted with the abovementioned application, showing the location of our proposed well, and we wish to submit a copy of this plat as Exhibit "A".

In the interest of economy, we plan to drill this well with cable tools in order to set protective casing strings above the Salado formation without cementing them, and thus drill into the Yates oil zone and determine whether or not we have a productive well before cementing the "salt protection" or oil string. This procedure has been followed in drilling our other wells in the Teas Pool. Specifically, we propose to run the following casing strings:

Surface Casing: 13 3/8" at about 60 feet to shut off possible fresh water in surface sands.

Water Shut-off Casing: 10 3/4" at about 1000 feet to shut off caving section and Santa Rosa water. If it should be necessary to set the 10 3/4" casing at 600-700 feet to prevent caving, then 8-5/8" casing will be carried to about 1000 feet, and set below the water.

Production String: The Salado formation will be drilled dry, and hole reduced at the top of the Yates sands at about 3200 feet. The Yates sands will then be penetrated to determine if commercial oil and gas is present. If completion is to be attempted, 5 1/2" casing will be run to the top of the Yates, the upper casing strings will be pulled and the 5 1/2" casing cemented to the surface in accordance with Order R-111-A.

We feel that this casing program will adequately protect the salt section and possible potash deposits if well conditions are as they are expected to exist. If any unexpected conditions should occur, we will immediately take whatever action is necessary to prevent contamination of potash deposits which may be present.

In the event that completion is not attempted, the hole will be plugged with cement throughout the salt section, the upper strings of casing pulled, and all water zones cemented in accordance with Order R-111-A.

If this program be satisfactory, we respectfully request that the U. S. Geological Survey be so notified, in order that they may consider our Notice of Intention to Drill for approval.

Respectfully submitted this 2nd day of July, 1957.

SOUTHERN CALIFORNIA PETROLEUM CORP.

By James A. Warren
Division Engineer