



PETROLEUM AND ITS PRODUCTS

GULF OIL CORPORATION

P. O. DRAWER 1290 · FORT WORTH 1, TEXAS

E. HOSFORD
DIVISION PRODUCTION COORDINATOR

February 6, 1958

FORT WORTH
PRODUCTION DIVISION

Oil Conservation Commission
State of New Mexico
P. O. Box 871
Santa Fe, New Mexico

Re: Application to Dually Complete Gulf's Naomi Keenum Well No. 2 so as to Produce from the Terry-Blinebry Oil Pool and Tubb Gas Pool, Lea County

Gentlemen:

Gulf Oil Corporation respectfully submits application for permission to dually complete subject well, and requests that the Commission set this matter for examiner hearing at an early date.

The following facts are offered in support of this application:

- (1) Gulf Oil Corporation's Naomi Keenum Well No. 2 is located 660 feet from the south line and 1980 feet from the east line of Section 14, T-21-S, R-37-E, Lea County, New Mexico. This well was originally completed in the Drinkard Oil Pool in March 1953; however, this pay was abandoned in October 1957, and the well plugged back to the Tubb pay where it was completed as a gas well in the Tubb Gas Pool. Based on recent completion of our Naomi Keenum Well No. 1 in the Terry-Blinebry Oil Pool, we now plan to complete subject well as an oil over gas dual completion in the Terry-Blinebry Oil Pool and Tubb Gas Pool.
- (2) This well was drilled to a total depth of 7195 feet and 5½" casing set at 7193 feet and cemented with 695 sacks. A temperature survey indicated the top of the cement in the annulus to be 2970 feet. The plugged back total depth is 6700 feet. The Tubb zone is perforated from 6110 to 6284 feet and these perforations were treated with 12,000 gallons of acid and fractured with 30,000 gallons of sand-oil. After these treatments the well potentialled an estimated open flow of 8,000 MCF per day from the Tubb Gas Pool. If approval is obtained to dually complete this well, we anticipate treating the Blinebry oil zone perforations 5698 to 5800 feet with 1200 gallons of mud acid and 30,000 gallons of sand-oil frac.

February 6, 1958

- (3) In dually completing this well, applicant proposes to utilize two packers and two independent strings of tubing. Because of a previous casing leak located at approximately 1645 feet, this method of completion will enable the formation pressure to be kept off the repaired casing leak. As will be noted on the attached diagrammatic sketch of the proposed installation, we plan to install a Baker Model "D" Packer at approximately 5879 feet which will separate the Tubb pay from the Blinebry pay and install a Baker Model "D" Packer No. 45-26 at 5668 feet to serve as the upper packer for the installation. A Baker Model "A" Parallel Anchor Flow Tube on 2" Hydrill "A" Tubing will be latched into the upper packer and will permit separation of production from each pay into individual tubing strings. The Blinebry oil production will be carried from the Parallel Anchor Flow Tube to the surface through 2" Hydrill "A" J-55 Tubing. The Tubb gas will flow from this point to the surface through 1½" NUJ-55 tubing to the surface. Pressure from the Tubb gas zone will be isolated below the lower packer and formation pressure from the Blinebry oil zone will be isolated between the two packers. There will be no pressure on the casing above the upper packer.

The manner and method of the proposed installation is mechanically feasible and practical and the granting of this oil over gas dual completion application is in the interest of conservation and the protection of correlative rights. Applicant will comply with all rules and regulations of the New Mexico Oil Conservation Commission to maintain separation of production from the two pays.

By copy of this letter of application, all offset operators are notified of the proposed dual completion.

Respectfully submitted,

GULF OIL CORPORATION

By E. Hasford
Division Production Coordinator

cc: Oil Conservation Commission
P. O. Box 2045
Hobbs, New Mexico

Oil Conservation Commission

- 3 -

February 6, 1958

cc: Continental Oil Company
P. O. Box 427
Hobbs, New Mexico

Magnolia Petroleum Company
P. O. Box 633
Midland, Texas

Markham, Cone and Radfern
209 Turner Drive
Hobbs, New Mexico

Shell Oil Company
P. O. Box 1957
Hobbs, New Mexico

Sinclair Oil and Gas Company
P. O. Box 1470
Hobbs, New Mexico

Tidewater Oil Company
P. O. Box 1404
Houston, Texas

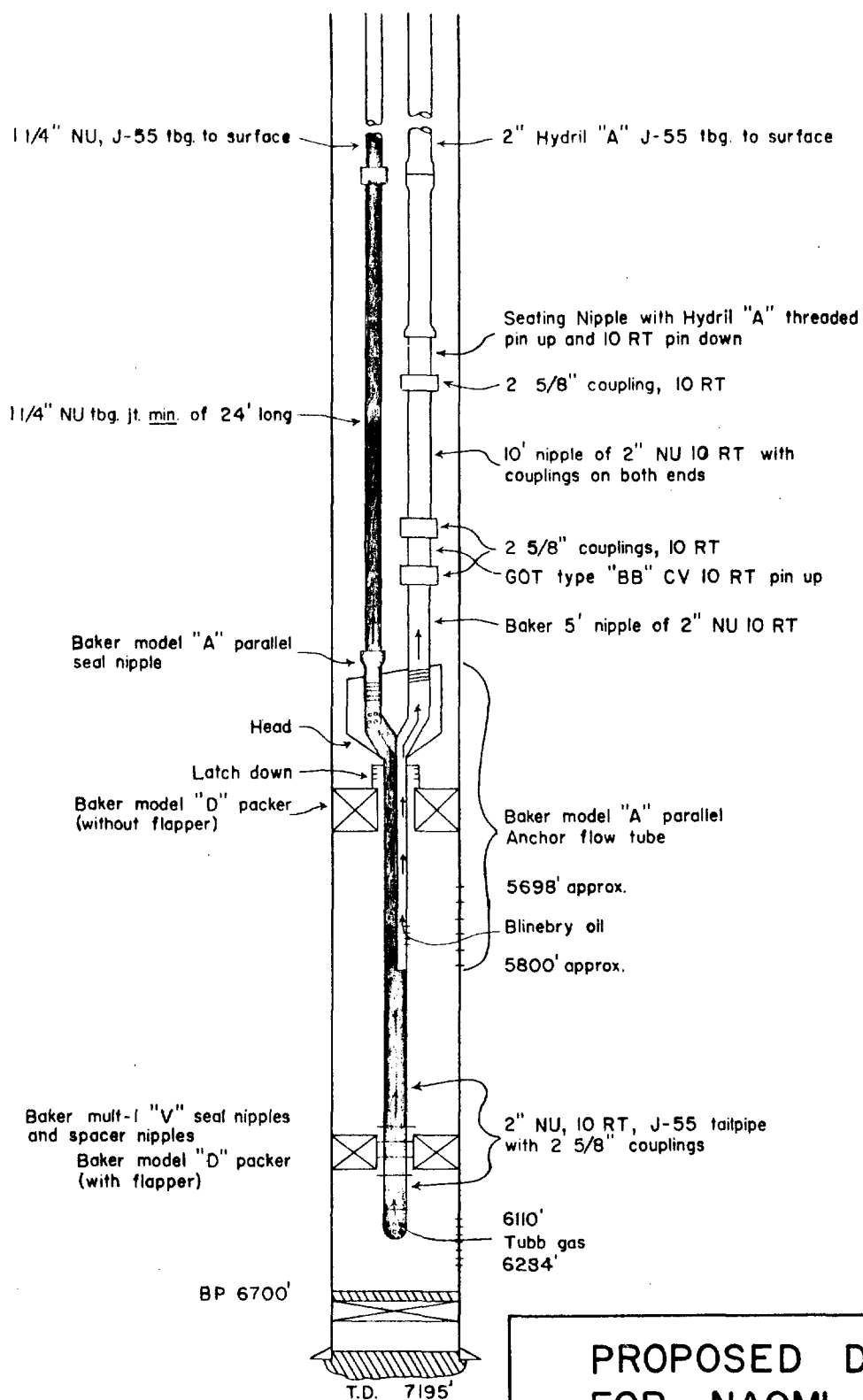

CASE NO. _____
EXHIBIT NO. _____

PROPOSED DUAL EQUIPMENT FOR NAOMI KEENUM NO. 2

TERRY-BLINEBRY OIL AND TUBB-GAS POOLS
LEA COUNTY, NEW MEXICO

GULF OIL CORPORATION

JANUARY 29, 1958

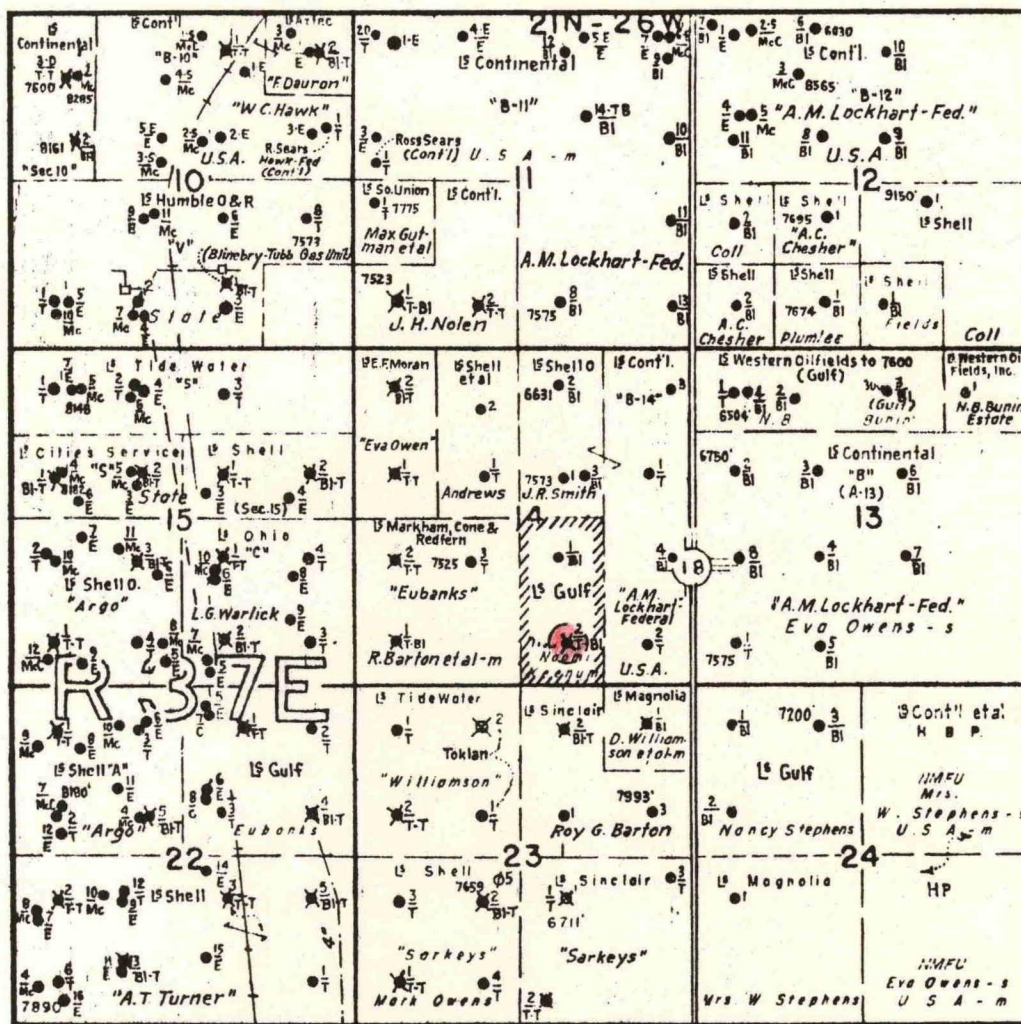

GULF'S NAOMI KEENUM LEASE LEA COUNTY, NEW MEXICO

Legend

Terry-Blinebry Oil Unit 40 Ac.

Tubb Gas Unit 80 Ac.

Proposed Oil Over Gas Dual

GULF OIL CORPORATION

SCALE 1" = 3000'