

PHILLIPS PETROLEUM COMPANY

P. O. Box 2105
Hobbs, New Mexico

April 18, 1958

*Oil & Gas
Comm. has been
communicating
from the pool*

In re: Application to Oil-Oil Dually Complete and Produce Crudes into
Common Storage - Phillips Petroleum Company, New Mex "A" Well No. 1 -
Kemnitz Wolfcamp Pool and Undesignated Pennsylvania Pool,
Lea County, New Mexico.

New Mexico Oil Conservation Commission
P. O. Box 871
Santa Fe, New Mexico

Gentlemen:

By this letter of application Phillips Petroleum Company wishes to state
the following:

(a) That Phillips Petroleum Company's New Mex "A" Well No. 1, located
1983' from south and 2313' from west line of Section 25-16S-33E, is now drilling
to a projected total depth of approximately 11,580'. The attached Exhibit "A"
shows the location of this well on the Phillips New Mex "A" Lease together with
the location of all offset wells. The attached Exhibit "B" shows a diagrammatic
sketch of the proposed dual completion.

(b) That the well will have 7" production casing set at approximately
11,580' and cemented with sufficient volume to connect with 9-5/8" casing set at
4547'. The subject well is offset by two wells producing oil from the Kemnitz
Wolfcamp Pool. Also 3/4 mile northwest of the subject well an undesignated Penn-
sylvania Pool well located in the NE/4 of Section 26-13S-33E potential for 190
BOPD.

(c) That the applicant proposes to dually complete the well in the
following manner:

- (1) Perforate the 7" casing within the approximate interval
of 11,450' to 11,530' opposite the Pennsylvania formation.
Perforate the 7" casing opposite the Wolfcamp formation at an
approximate interval of 10,780' to 10,830'.
- (2) Set production type packer between the two sets of
perforations at approximately 11,400' to separate the two
pay zones and dually complete through the use of two strings
of 2" tubing in the manner set out in the attached Exhibit "B".

(c) Continued

(3) Produce oil from the Pennsylvanian formation through 2" tubing extending through the production packer and oil from the Wolfcamp formation through a second parallel 2" tubing string.

(d) That the dual completion of the well in the above described manner is mechanically feasible and practical and is in the interest of conservation and the protection of correlative rights.

(e) That the applicant will comply with all rules and regulations of the New Mexico Oil Conservation Commission to maintain separation of production from the two pay zones.

(f) That applicant has mailed a copy of this application to the following offset operators:

Tennessee Gas Transmission Company
Box 307
Hobbs, New Mexico

Forest Oil Corporation
P. O. Box 4486
Midland, Texas

Application is also made to produce Wolfcamp and Pennsylvanian crudes into common storage. Pennsylvanian oil will be produced and measured through a metering separator that incorporates a cyclic type dump meter. [Wolfcamp oil production will be determined by deducting the metered Pennsylvanian oil from the total gauged production.]

Therefore, Phillips Petroleum Company requests that the Oil Conservation Commission grant a hearing on this application to dually complete the subject well and produce Wolfcamp and Pennsylvanian crudes into common storage.

I hereby certify that the information given above is true and complete to the best of my knowledge.

Respectfully submitted,

PHILLIPS PETROLEUM COMPANY

W. C. Rodgers

W. C. Rodgers
District Superintendent
Production Department

WWF:js
Attach (2)

Sworn to and subscribed before me this the _____ day of April, 1958.

My Commission expires _____

Notary Public

EXHIBIT "A"

SEC. 25

1

• 3

1 •

4 •

2 ✓

Tenn. Gas Trans.
"A.A. Kemnitz "B"

Forest
"State"

80 Ac.

1 •

1 •

Phillips Pet. Co.
New Mex "A"

Phillips Pet.
"State"

Tenn. Gas.
"State Phillips"

Forest

Phillips Petroleum
"State"

BARTLESVILLE, OKLAHOMA

PHILLIPS PETROLEUM COMPANY
NEW MEX "A"
Sec 25, T-16-S, R-33-E
Lea County, New Mexico

DRAWN	<i>B</i>	REVISION	BY	DATE	AFE. NO.	DWG. NO.
CHECKED	4-16-58 <i>7017</i>				SCALE	SHEET NO.
APPROVED						

EXHIBIT "B"

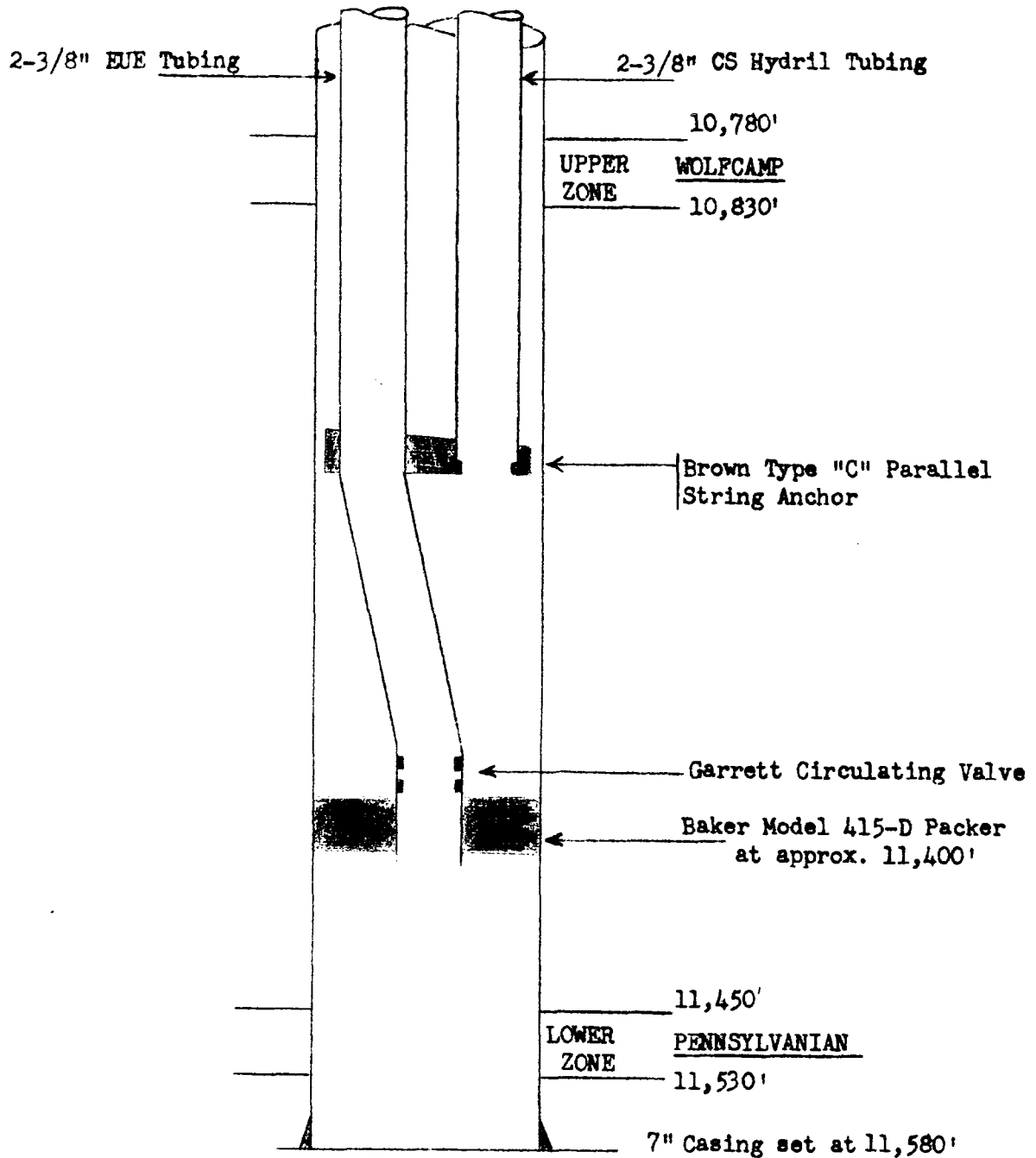

BARTLESVILLE, OKLAHOMA

PROPOSED DUAL COMPLETION
 NEW MEX "A" No. 1
 LEA COUNTY - NEW MEXICO

DRAWN	<i>B</i>	REVISION	BY	DATE	AFE. NO.	DWG. NO.
CHECKED 4-11-57	<i>W. H. H.</i>				SCALE	SHEET NO.
APPROVED						

PHILLIPS PETROLEUM COMPANY

P. O. Box 2105
Hobbs, New Mexico

April 28, 1958

In re: Application to Oil-Oil Dually Complete and Produce Crudes
into Common Storage - Phillips Petroleum Company, New Mex "A"
Well No. 1, Keanitz Wolfcamp Pool and Undesignated Pennsylvania
Pool, Lea County, New Mexico

New Mexico Oil Conservation Commission
P. O. Box 871
Santa Fe, New Mexico

Gentlemen:

Our application of April 18, 1958, to dual complete
New Mex "A" Well No. 1 and produce crudes into common storage was
submitted without an offset acreage plat and sketch of the proposed
dual completion. Please include the attached Exhibit "A" (acreage
plat) and Exhibit "B" (dual completion sketch) with our original
application.

We would appreciate the subject application being included
in the May 7, 1958, Examiner Hearing if possible.

Sincerely yours,

PHILLIPS PETROLEUM COMPANY

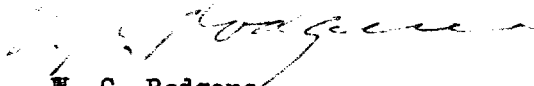
W. C. Rodgers
District Superintendent
Production Department

WWP:js
Attach (2)
cc: Tennessee Gas Transmission - Hobbs
Forest Oil Company - Midland
Attach (2)

EXHIBIT "B"

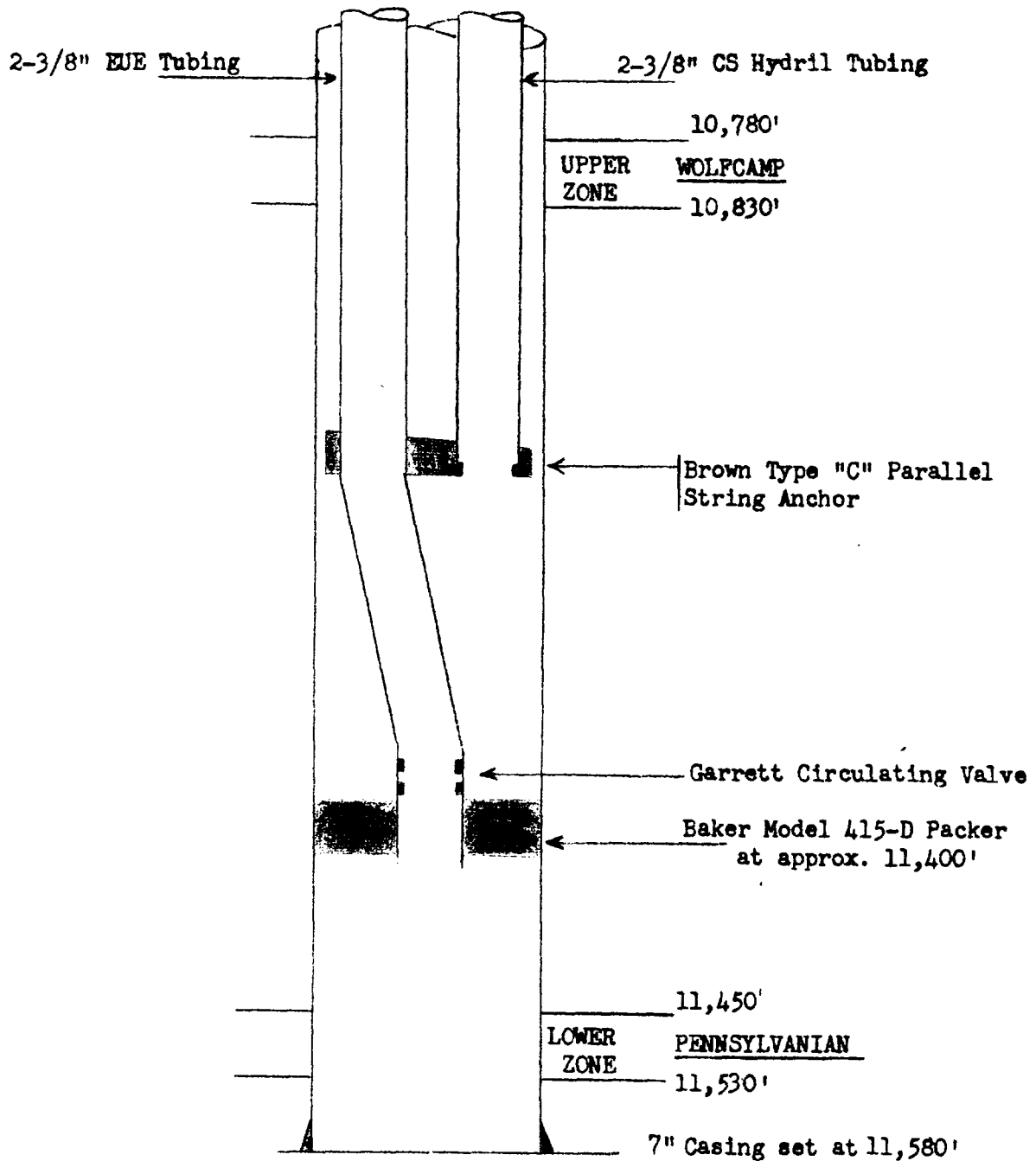

BARTLESVILLE, OKLAHOMA

PROPOSED DUAL COMPLETION
 NEW MEX "A" No. 1
 LEA COUNTY - NEW MEXICO

DRAWN	<i>B</i>	REVISION	BY	DATE	AFE. NO.	DWG. NO.
CHECKED	<i>4/11/58</i>				SCALE	SHEET NO.
APPROVED						

EXHIBIT "A"

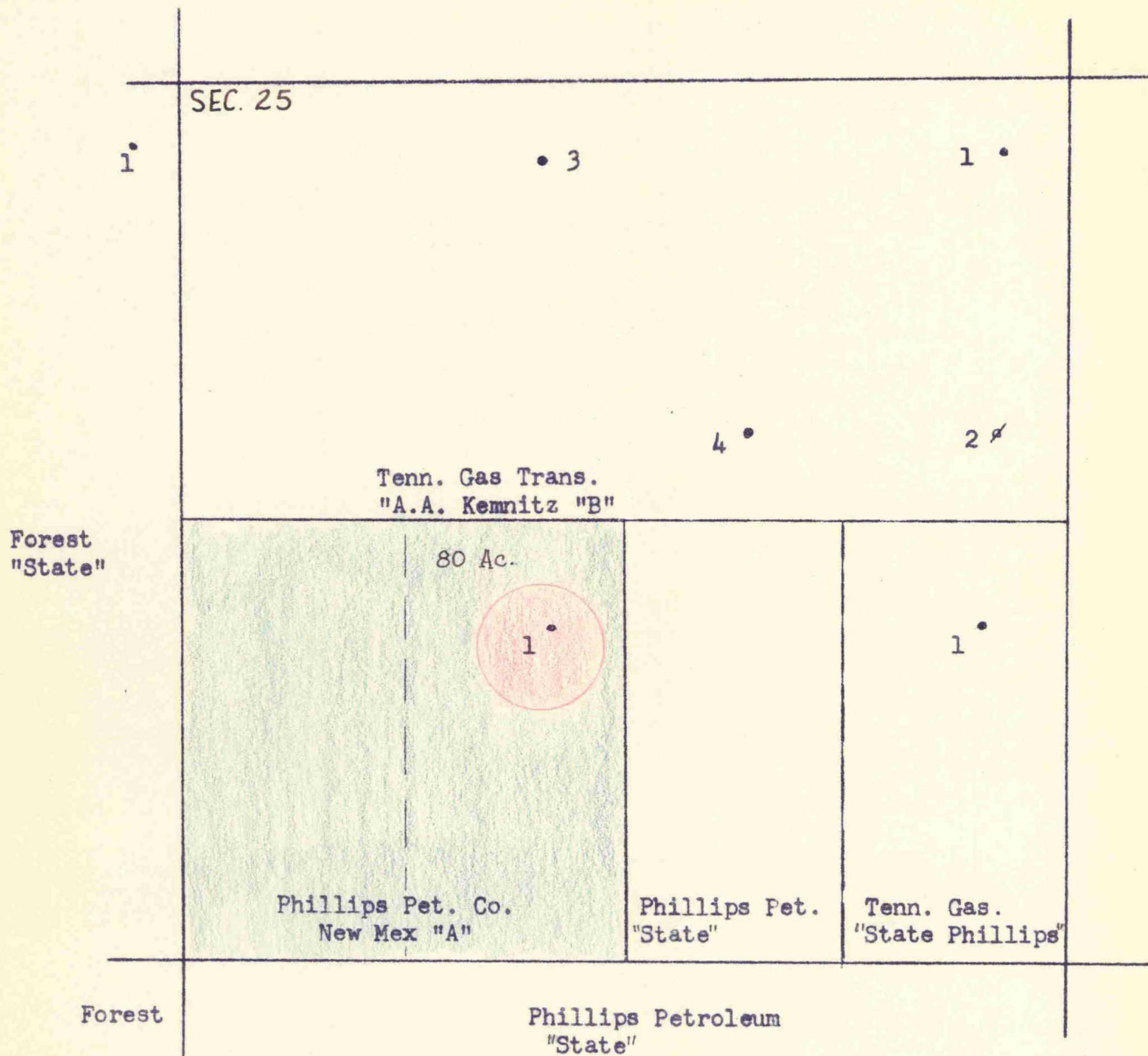

BARTLESVILLE, OKLAHOMA

PHILLIPS PETROLEUM COMPANY
NEW MEX "A"
Sec 25, T-16-S, R-33-E
Lea County, New Mexico

DRAWN	<i>B</i>	REVISION	BY	DATE	AFE. NO.	DWG. NO.
CHECKED	1-16-58 <i>7617</i>				SCALE	SHEET NO.
APPROVED						

- CASE 1456: Application of Gulf Oil Corporation for an oil-oil dual completion. Applicant, in the above-styled cause, seeks an order authorizing the dual completion of its Learcy McBuffington Well No. 6, located 330 feet from the South line and 1980 feet from the East line of Section 13, Township 25 South, Range 37 East, Lea County, New Mexico, in such a manner as to permit the production of oil from an undesignated Blinebry oil pool and oil from the McKee formation, adjacent to the Justis-McKee Pool, through parallel strings of tubing.
- CASE 1457: Application of Sinclair Oil & Gas Company for an oil-oil dual completion. Applicant, in the above-styled cause, seeks an order authorizing the dual completion of its State Lea Well No. 1, located 660 feet from the South and West lines of Section 24, Township 16 South, Range 33 East, Lea County, New Mexico, in such a manner as to permit the production of oil from the Kemnitz-Wolfcamp Pool and from the Pennsylvanian formation adjacent to the Kemnitz-Pennsylvanian Pool through parallel strings of tubing.
- CASE 1458: Application of Albert Gackle for a non-standard gas proration unit. Applicant, in the above-styled cause, seeks an order establishing a 320-acre non-standard gas proration unit in the Jalmat Gas Pool consisting of the S/2 of Section 23, Township 23 South, Range 36 East, Lea County, New Mexico, said unit to be dedicated to the applicant's Sinclair State No. 1 Well, located 1650 feet from the South line and 990 feet from the East line of said Section 23.
- CASE 1459: Application of Continental Oil Company for a dual completion and non-standard gas proration unit. Applicant, in the above-styled cause, seeks an order authorizing the dual completion of its Farney A-17 Well No 3, located in Section 17, Township 23 South, Range 36 East, Lea County, New Mexico, in such a manner as to permit the production of oil from the Lower Yates formation of the Jalmat Gas Pool and gas from the Upper Yates formation of the Jalmat Gas Pool through the tubing and casing-tubing annulus respectively. The applicant further seeks the establishment of a 160-acre non-standard gas proration unit in the Jalmat Gas Pool comprising the NW/4 of said Section 17, to be dedicated to the said Farney A-17 Well No. 3.
- CASE 1460: Application of Phillips Petroleum Company for an oil-oil dual completion and for permission to commingle production from two separate pools. Applicant, in the above-styled cause, seeks an order authorizing the dual completion of its New Mex "A" Well No. 1 located 1983 feet from the South line and 2313 feet from the West line of Section 25, Township 16 South, Range 33 East, Lea County, New Mexico, in such a manner as to permit the production of oil from the Kemnitz-Wolfcamp Pool and oil from an undesignated Pennsylvanian pool through parallel strings of tubing. The applicant also proposes to produce the Wolfcamp and Pennsylvanian production from said well into common storage.

- CASE 1461: Application of A. A. Greer, et al., for an exception to the acreage factors established by Order No. R-565-C for certain wells in San Juan County, New Mexico. Applicant, in the above-styled cause, seek an order granting an exception to the acreage factors provided in the Special Rules and Regulations for the Aztec-Pictured Cliffs Gas Pool and Fulcher Kutz-Pictured Cliffs Gas Pool, as set forth in Order No. R-565-C, for one well in the Aztec-Pictured Cliffs Gas Pool and eight wells in the Fulcher Kutz-Pictured Cliffs Gas Pool which were drilled on 40-acre spacing prior to the establishment of 160-acre spacing in the aforementioned pools.
- CASE 1462: Application of El Paso Natural Gas Company for a non-standard gas proration unit. Applicant, in the above-styled cause, seeks an order establishing a 335-acre, more or less, non-standard gas proration unit in the Blanco Mesaverde Gas Pool consisting of the SW/4 of Section 7 and the W/2 of Section 18, all in Township 30 North, Range 8 West, San Juan County, New Mexico, said unit to be dedicated to the applicant's Howell No. 4-C Well, located 933 feet from the South line and 931 feet from the West line of said Section 18.
- CASE 1463: Application of Pan American Petroleum Corporation for an oil-gas dual completion. Applicant, in the above-styled cause, seeks an order authorizing the dual completion of its O. H. Randel "A" No. 1 Well, located 1650 feet from the South line and 990 feet from the West line of Section 9, Township 26 North, Range 11 West, San Juan County, New Mexico, in such a manner as to permit the production of oil from an undesignated Gallup oil pool and gas from an undesignated Dakota gas pool through parallel strings of tubing.

EXHIBIT "A"

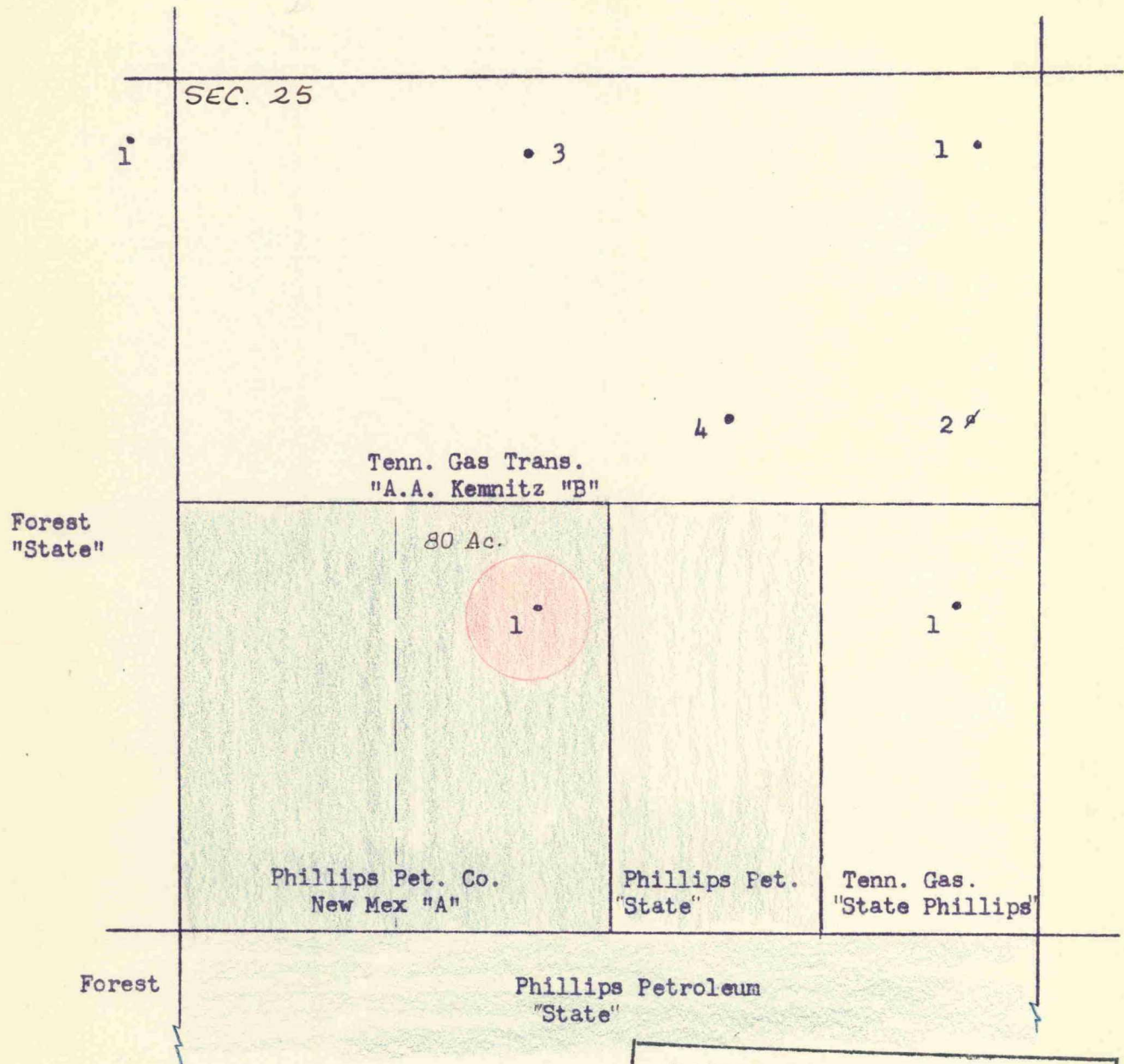

BEFORE EXAMINER UTZ

CIL CONSERVATION COMMISSION

Phillips EXHIBIT NO. A

CASE NO. 1460

BARTLESVILLE, OKLAHOMA

PHILLIPS PETROLEUM COMPANY

NEW MEX "A"

Sec 25, T-16-S, R-33-E

Lea County, New Mexico

DRAWN	<i>B</i>	REVISION	BY	DATE	AFE. NO.	DWG. NO.
CHECKED	<i>16 SB 10/17</i>				SCALE	SHEET NO.
APPROVED						

EXHIBIT "B"

2-3/8" EUE Tubing

2-3/8" CS Hydril Tubing

By deduction

10,780'

UPPER WOLFCAMP
ZONE 10,830'

*41°
1300 ft
Brown oil*

Brown Type "C" Parallel
String Anchor

BEFORE EXAMINER UTZ

OIL CONSERVATION COMMISSION

Phillips EXHIBIT NO. B

CASE NO. 1460

Garrett Circulating Valve

Baker Model 415-D Packer
at approx. 11,400'

19,000' savings.

11,450'

LOWER PENNSYLVANIAN
ZONE 11,530'

*Green oil.
39°
1300 ft*

Metamorphic

7" Casing set at 11,580'

BARTLESVILLE, OKLAHOMA

PROPOSED DUAL COMPLETION
NEW MEX "A" No. 1
LEA COUNTY - NEW MEXICO

DRAWN	<i>B</i>	REVISION	BY	DATE	AFE. NO.	DWG. NO.
CHECKED	<i>4-11-55</i>				SCALE	SHEET NO.
APPROVED						

EXHIBIT "C"

CASE NO. 1460

Revised Request to Produce Wolfcamp and
Pennsylvanian Crudes Into Common Storage

It is requested that the paragraph of the application which
read:

"Application is also made to produce Wolfcamp and Pennsylvanian
crudes into common storage. Pennsylvanian oil will be produced and
measured through a metering separator that incorporates a cyclic type
dump meter. Wolfcamp oil production will be determined by deducting the
metered Pennsylvanian oil from the total gauged production".

be modified to read as follows:

"Application is also made to produce Wolfcamp and Pennsylvanian
crudes into common storage. Production from both formations will be
separately measured with positive displacement meters prior to being
commingled. The meters will be checked for accuracy at intervals satis-
factory to the Commission."

Handwritten: 1300.00
Handwritten: 1300.00

BEFORE EXAMINER UTZ	
OIL CONSERVATION COMMISSION	
<i>Phillips</i>	EXHIBIT NO. <u>C</u>
CASE NO.	<u>1460</u>