

R-37-E

Section 18

Gulf Texas Pacific
Crosby

17

+850

Notes contour

04 02 03 07

Amerada Christmas "C"

05 01 01 01 01 01 01 01

Christ State mas "C" State "M"

Humble 04 04 04 04 04 04 04 04

05 04 04 04 04 04 04 04

06 04 04 04 04 04 04 04

07 04 04 04 04 04 04 04

08 04 04 04 04 04 04 04

09 04 04 04 04 04 04 04

10 04 04 04 04 04 04 04

11 04 04 04 04 04 04 04

12 04 04 04 04 04 04 04

13 04 04 04 04 04 04 04

T 22 S

EUMONT POOL
Lea County, N.M.
GAS UNITS OFFSETTING
PROPOSED UNIT FOR
HUMBLE - N.M. STATE "M"
WELL NO. 1

+750

State "M"

State "M"

Continental
Elliott "B-20"

HUMBLE

HUMBLE
EUMONT GAS
WELL

STATE "M"

BEFORE EXAMINER FISCHER
OIL CONSERVATION COMMISSION
Case No. 1629
Exhibit No. 1

LARGE FORMAT
EXHIBIT HAS
BEEN REMOVED
AND IS LOCATED
IN THE NEXT FILE

NEW MEXICO OIL CONSERVATION COMMISSION

Well Location and Acreage Dedication Plat

Section A.

Date March 6, 1959

Operator HUMBLE OIL & REFG. CO Lease New Mexico State "M"
Well No. 1 Unit Letter "J" Section 18 Township 22 S Range 37 E NMPM
Located 1980 Feet From South Line, 1980 Feet From East Line
County Lea G. L. Elevation _____ Dedicated Acreage 320 Acres
Name of Producing Formation Queens Pool Eumont

1. Is the Operator the only owner* in the dedicated acreage outlined on the plat below?
Yes ☒ No ☐.
2. If the answer to question one is "no," have the interests of all the owners been consolidated by communitization agreement or otherwise? Yes ☐ No ☐. If answer is "yes," Type of Consolidation _____
3. If the answer to question two is "no," list all the owners and their respective interests below:

Owner

Land Description

<u>Owner</u>	<u>Land Description</u>

Section B

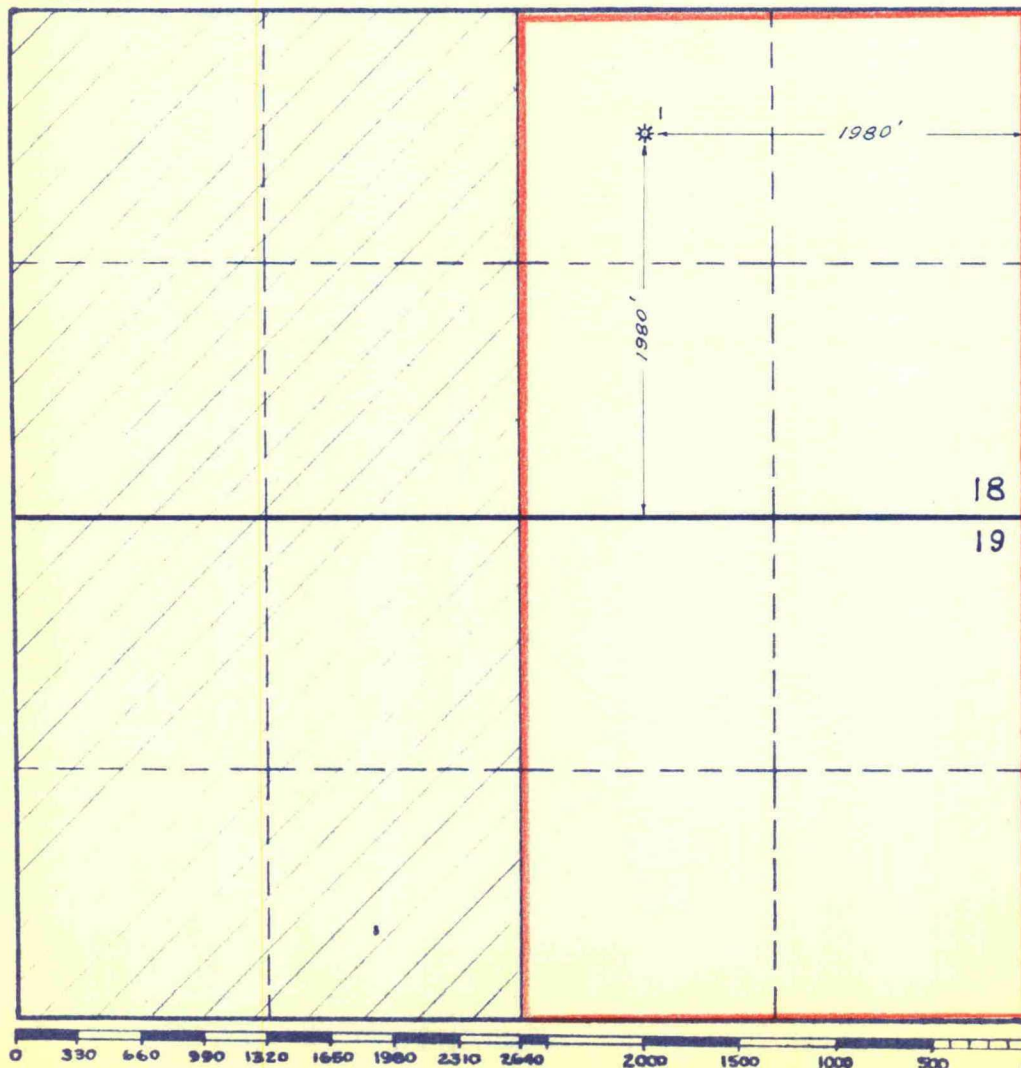

This is to certify that the information in Section A above is true and complete to the best of my knowledge and belief.

HUMBLE OIL & REFG. CO
(Operator)

H. L. Hensley
(Representative)
Assistant Division Supt.
Box 1600 Midland, Texas
Address

This is to certify that the well location shown on the plat in Section B was plotted from field notes of actual surveys made by me or under my supervision and that the same is true and correct to the best of my knowledge and belief.

Date Surveyed 3-25-40

H. S. Westerfield
Registered Professional
Engineer and/or Land Surveyor.

Certificate No. 1382

LEASE NO. 37721

W-A - 2433

HUMBLE OIL & REFINING COMPANY

MIDLAND, TEXAS

March 6, 1959

Amerada Petroleum Corporation
P. O. Box 2040
Tulsa, Oklahoma

Gulf Oil Corporation
P. O. Box 962
Roswell, New Mexico

Gentlemen:

Please find attached a copy of our application to the New Mexico Oil Conservation Commission for approval of a non-standard gas proration unit in the Eumont Gas Pool for our New Mexico State "M" Well No. 1, located 1980 feet from the South and East lines of Section 18, T-22-E, R-37-E, Lea County, New Mexico.

This notice is given you in accordance with the Eumont Field Rules.

Yours very truly,

Humble Oil & Refining Company

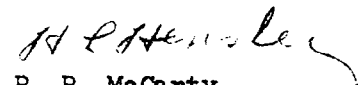
R. R. McCarty

WHN:ar
Attachment

R-37-E

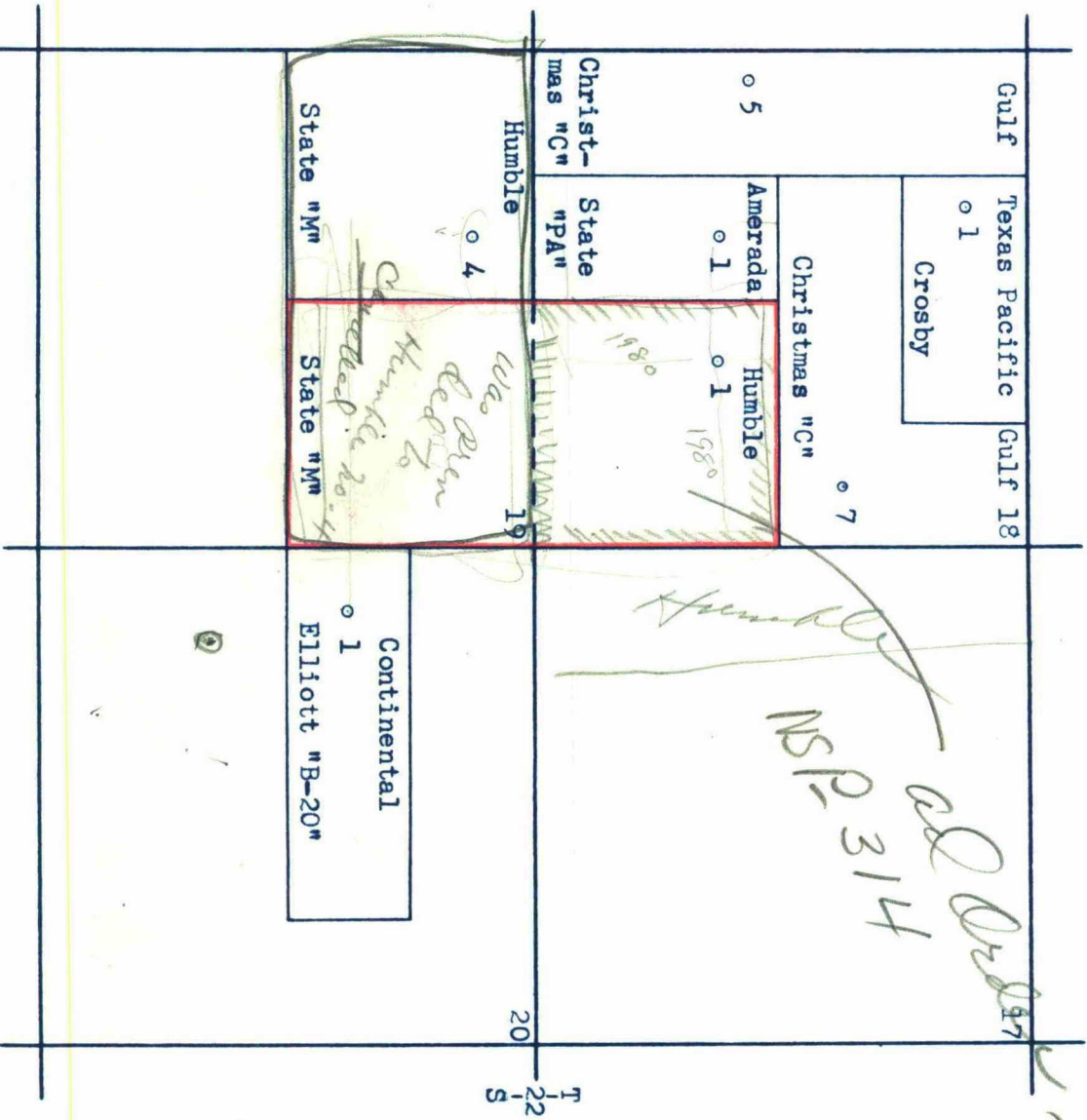

EUMONT POOL
 Lea County, N.M.
 GAS UNITS OFFSETTING
 PROPOSED UNIT FOR
 HUMBLE - N.M. STATE "M"
 WELL NO. 1