

NEW MEXICO OIL CONSERVATION COMMISSION
Santa Fe, New Mexico

Form C-101
Revised (12/1/55)

NOTICE OF INTENTION TO DRILL

Notice must be given to the District Office of the Oil Conservation Commission and approval obtained before drilling or recompletion begins. If changes in the proposed plan are considered advisable, a copy of this notice showing such changes will be returned to the sender. Submit this notice in QUINTUPLICATE. One copy will be returned following approval. See additional instructions in Rules and Regulations of the Commission. If State Land submit 6 Copies Attach Form C-128 in triplicate to first 3 copies of form C-101

Midland, Texas
(Place)

February 6, 1959
(Date)

OIL CONSERVATION COMMISSION
SANTA FE, NEW MEXICO

Gentlemen:

You are hereby notified that it is our intention to commence the Drilling of a well to be known as

Humble Oil & Refining Company

Co. Lease No. 37722

(Company or Operator)

New Mexico State "G"

Well No. 19

in "0"

(Unit)

The well is

located 580 feet from the South line and 1980 feet from the East line of Section 23, T. -21-S, R. -36-E, NMPM.

(GIVE LOCATION FROM SECTION LINE)

Eumont

Pool,

Lea

County

If State Land the Oil and Gas Lease is No. B-935

If patented land the owner is -

Address -

We propose to drill well with drilling equipment as follows: Rotary

The status of plugging bond is on file in Commission Office.

Drilling Contractor Unknown

We intend to complete this well in the Queen Sand

formation at an approximate depth of 4100 feet.

See attached plat.

CASING PROGRAM

We propose to use the following strings of Casing and to cement them as indicated:

Size of Hole	Size of Casing	Weight per Foot	New or Second Hand	Depth	Seals Cement
11"	7-5/8"	24#	New	300	150 sks*
6-3/4"	2-7/8"	6.50#	New	4100	200 sks**

If changes in the above plans become advisable we will notify you immediately.

ADDITIONAL INFORMATION (If recompletion give full details of proposed plan of work.)

*Circulate to surface.

**Circulate to at least 2700' from surface.

Minimum mud for samples.

Halliburton OWCO method of cementing to be used.

Approved _____, 19_____
Except as follows:

Sincerely yours,

Humble Oil & Refining Company
(Company or Operator)

By _____

Position Asst. Div. Chief Clerk

Send Communications regarding well to

Name R. R. McCarty

Address Box 1600, Midland, Texas

OIL CONSERVATION COMMISSION

By _____

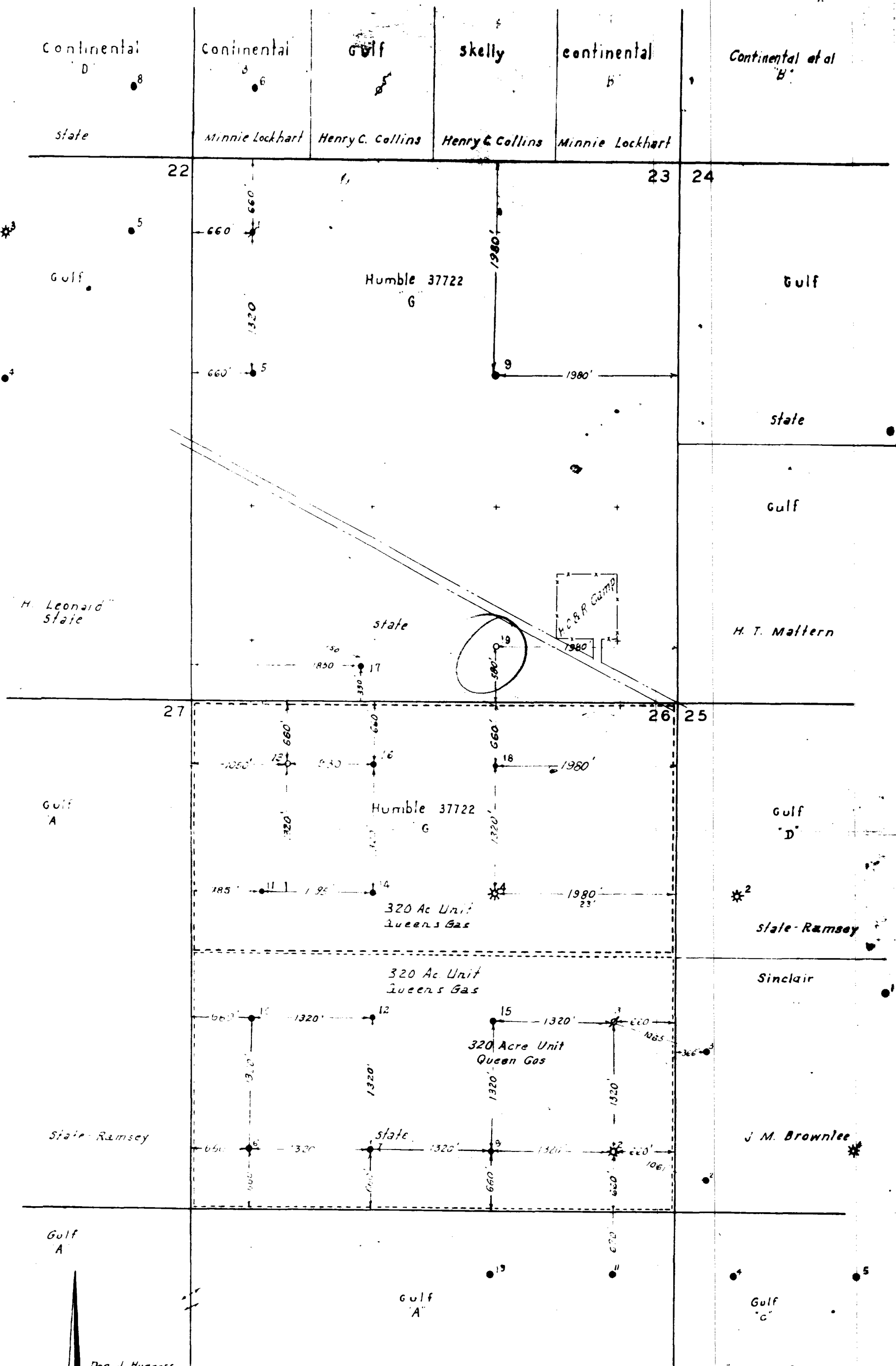

NEW MEXICO OIL CONSERVATION COMMISSION

Well Location and Acreage Dedication Plat

Section A.

Date 1-12-58

Operator HUMBLE OIL & REFG CO Lease NEW MEXICO STATE "G"
Well No. 19 Tract Letter "O" Section 23 Township -21-S Range -36-E N.M.M.
Location 580' Feet From SOUTH Line, 1980 Feet From EAST Line
County LEA G. L. Elevation _____ Dedicated Acreage 40 Acres
Name of Producing Formation QUEEN Pool EUMOUNT

1. Is the operator the only owner* in the dedicated acreage outlined on the plat below?
Yes ✓ No _____.
2. If the answer to question one is "no," have the interests of all the owners been consolidated by communitization agreement or otherwise? Yes _____ No _____. If answer is "yes," Date of Consolidation _____
3. If the answer to question two is "no," list all the owners and their respective interests below:

Owner

Land Description

Section B

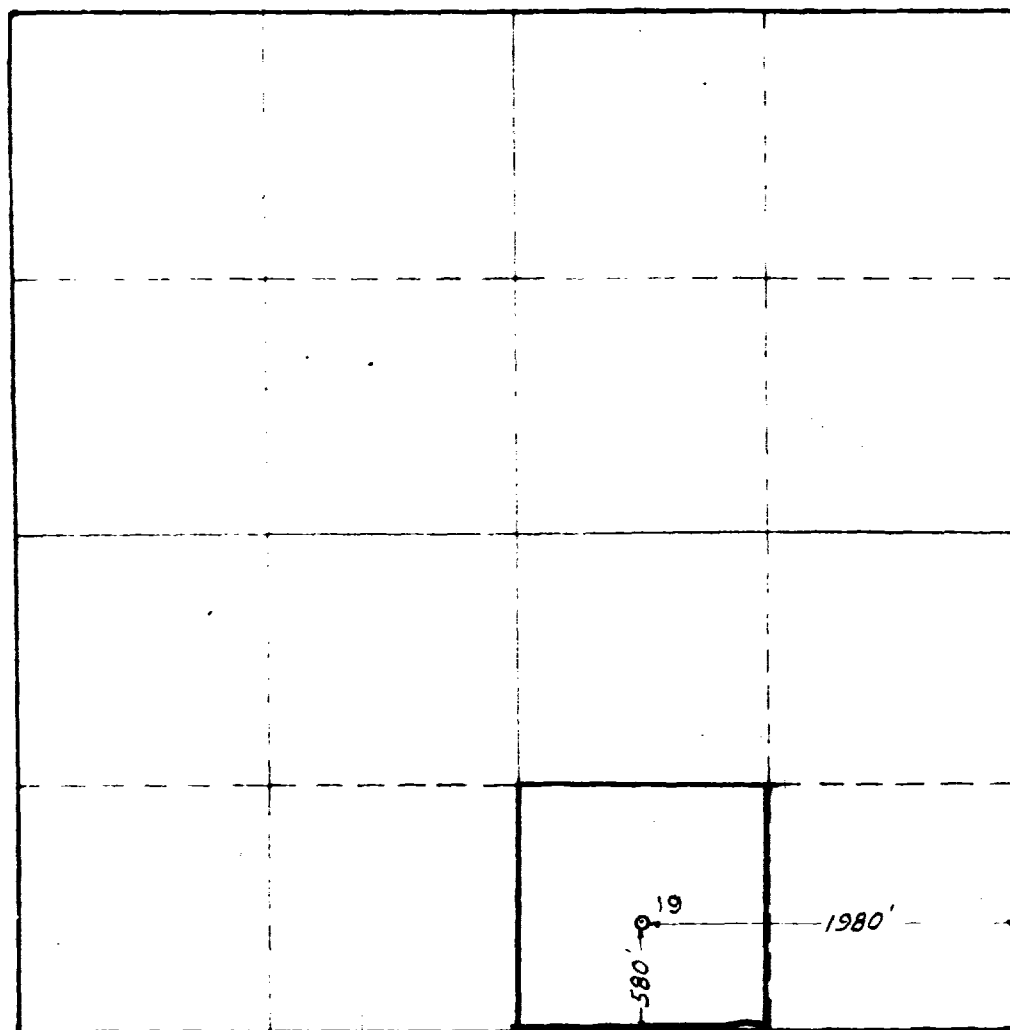

This is to certify that the information in Section A above is true and complete to the best of my knowledge and belief.

HUMBLE OIL & REFG CO
(Operator)

H. P. Hensley
(Representative)
Assistant Division Supt
Box 1602 Midland, Texas
Address

This is to certify that the well location shown on the plat in Section B was plotted from field notes of actual surveys made by me or under my supervision and that the same is true and correct to the best of my knowledge and belief.

Date Surveyed 1-10-59

H. S. Hesterfield
Registered Professional
Engineer and/or Land Surveyor.

Certificate No. 1382

LEASE NO 37722

W-A - 2449