

R-37-E

T  
20  
S

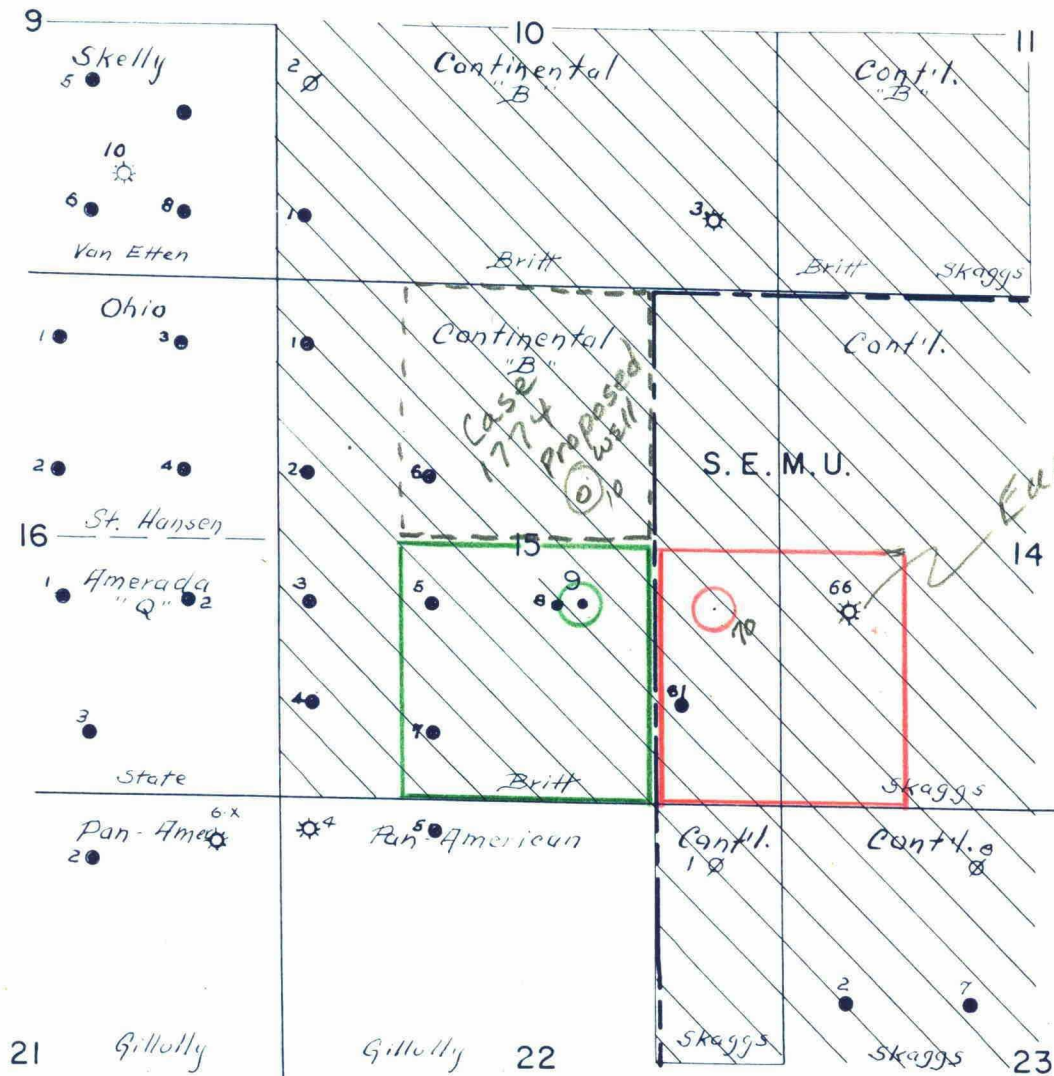

OWNERSHIP PLAT

CONTINENTAL OIL COMPANY

Britt B-15 No.9

Scale: 1"=2,000'

- Proposed Dual Completion
- Offset Dual Completion
- Proposed Tubb Gas Unit
- Offset Tubb Gas Unit
- Continental Acreage Cross-hatched

August, 1959

CASE  
EXHIBIT

# CONTINENTAL OIL COMPANY

SEMU-DT NO.70

PROPOSED INSTALLATION  
(Showing Approx. Depths)

## CASING RECORD

## DUAL COMPLETION EQUIPMENT

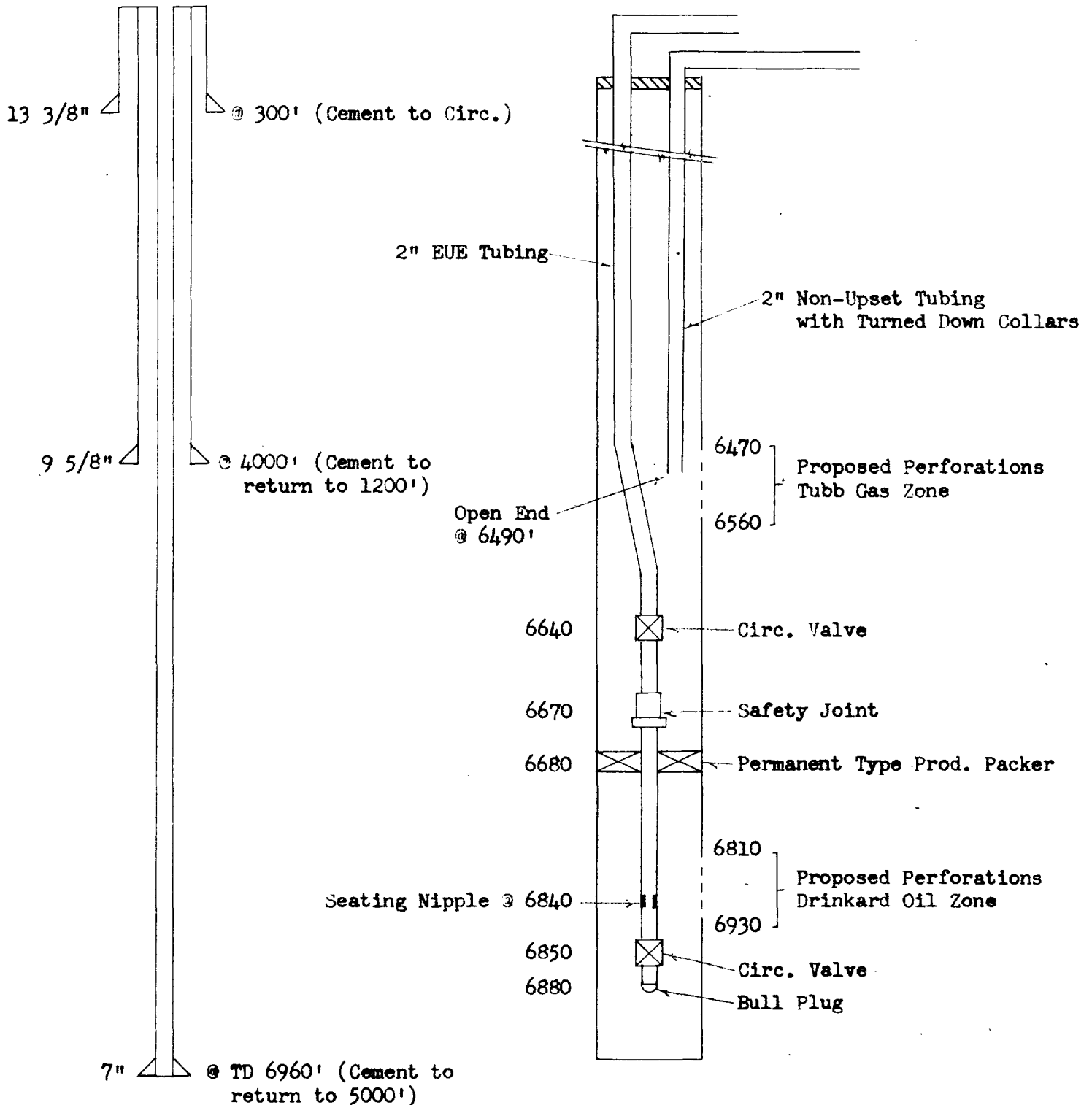

R-37-E

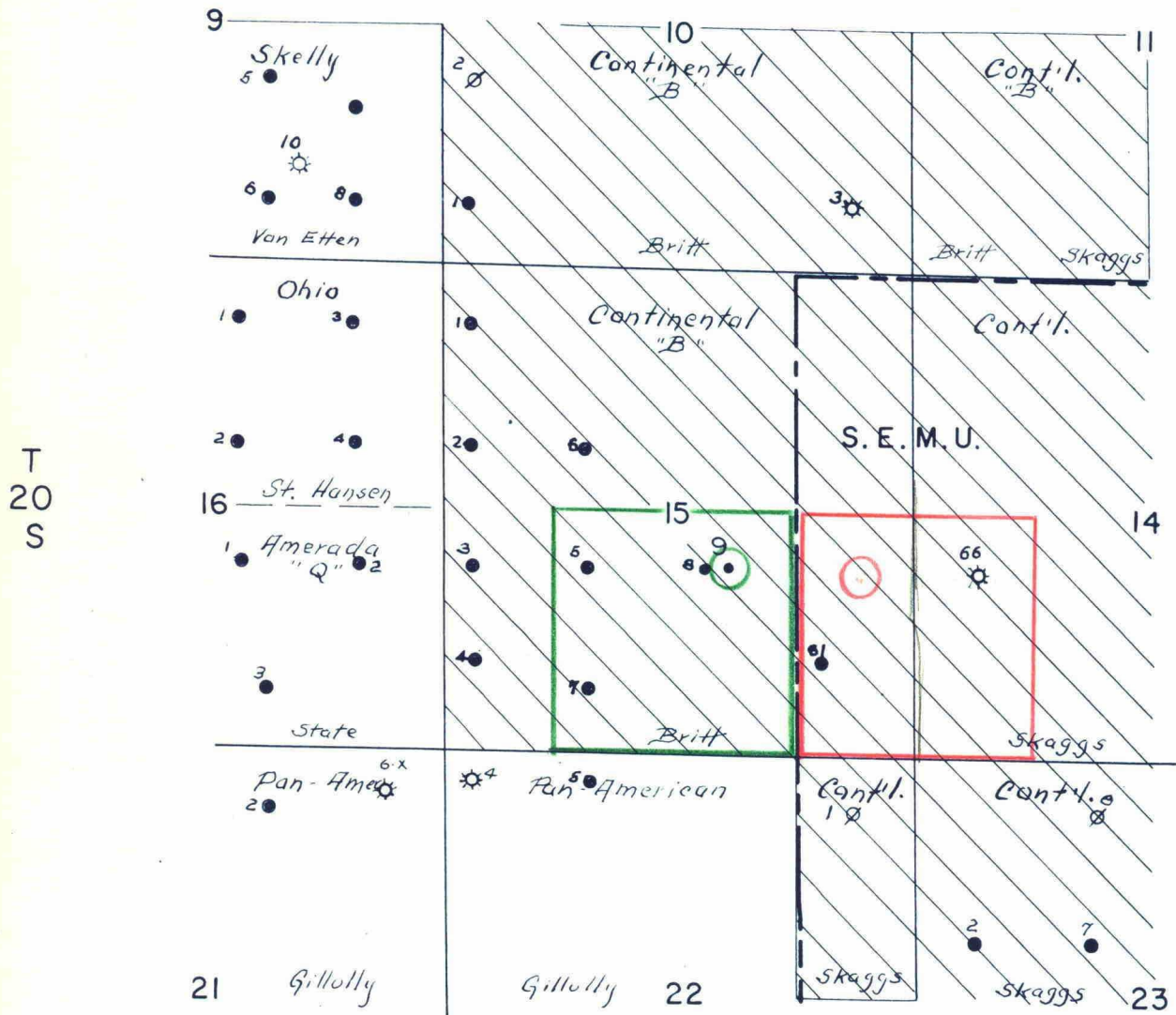

OWNERSHIP PLAT

CONTINENTAL OIL COMPANY

Britt B-15 No.9

Scale: 1"=2,000'

- Proposed Dual Completion
- Offset Dual Completion
- Proposed Tubb Gas Unit
- Offset Tubb Gas Unit
- Continental Acreage Cross-hatched

August, 1959

CASE  
EXHIBIT