

R-30E

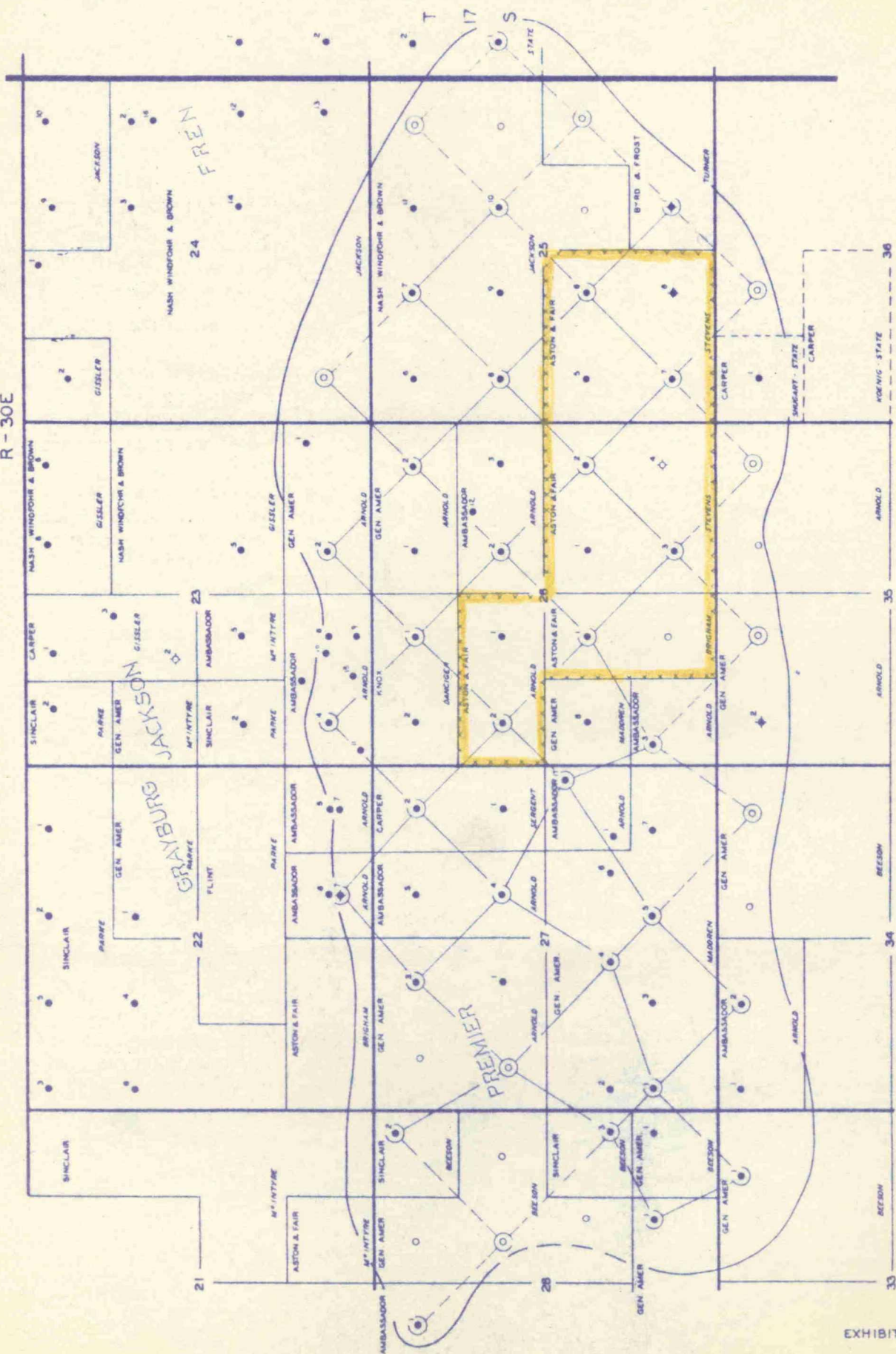

PREMIER FIELD  
EDDY COUNTY, NEW MEXICO

PROPOSED WATER-FLOOD DEVELOPMENT PROGRAM

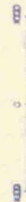
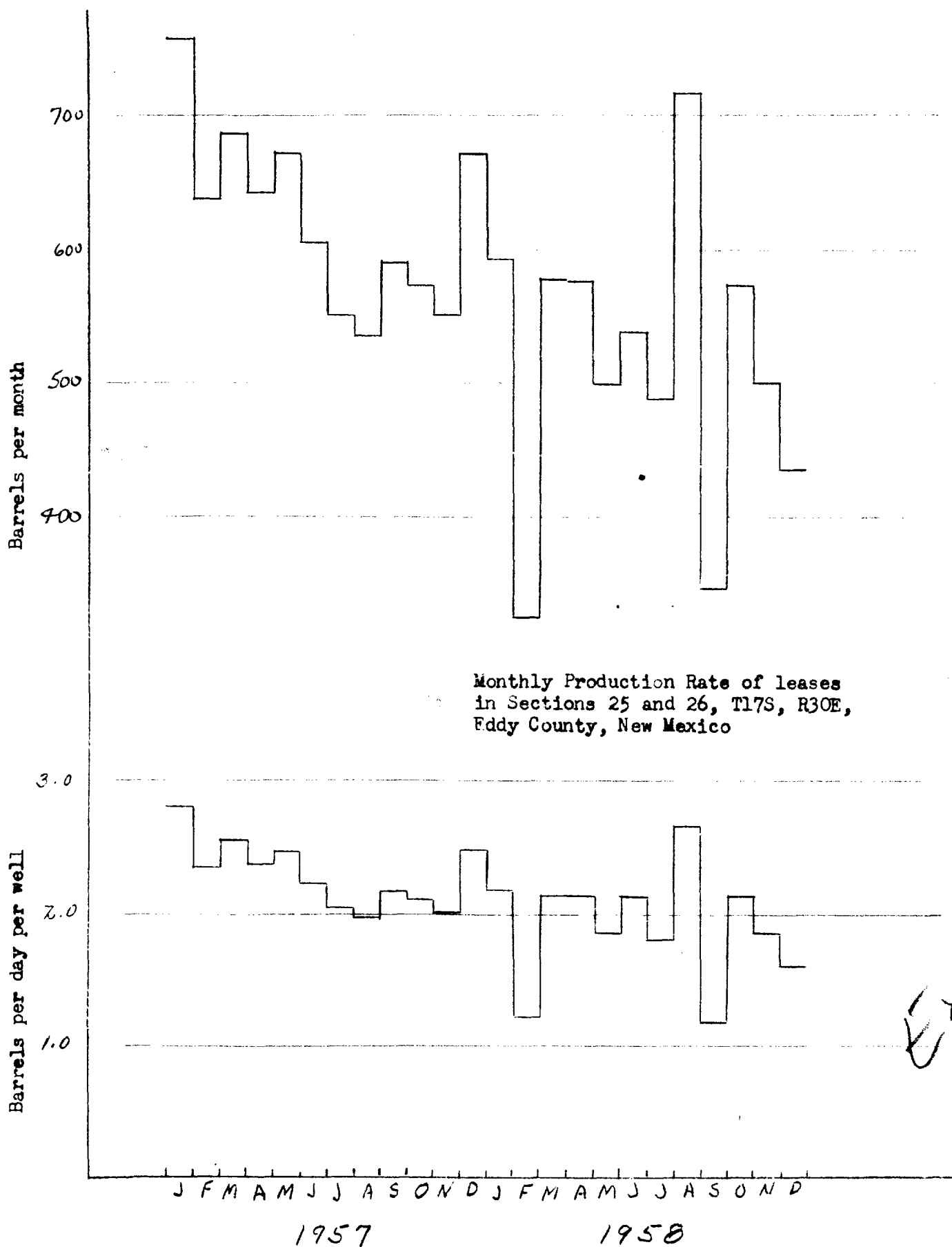

EXHIBIT N° 16

OIL PRODUCTION RATE



EX-2

FRANKLIN, ASTON AND FAIR, INC.

data from NM&GEC reports

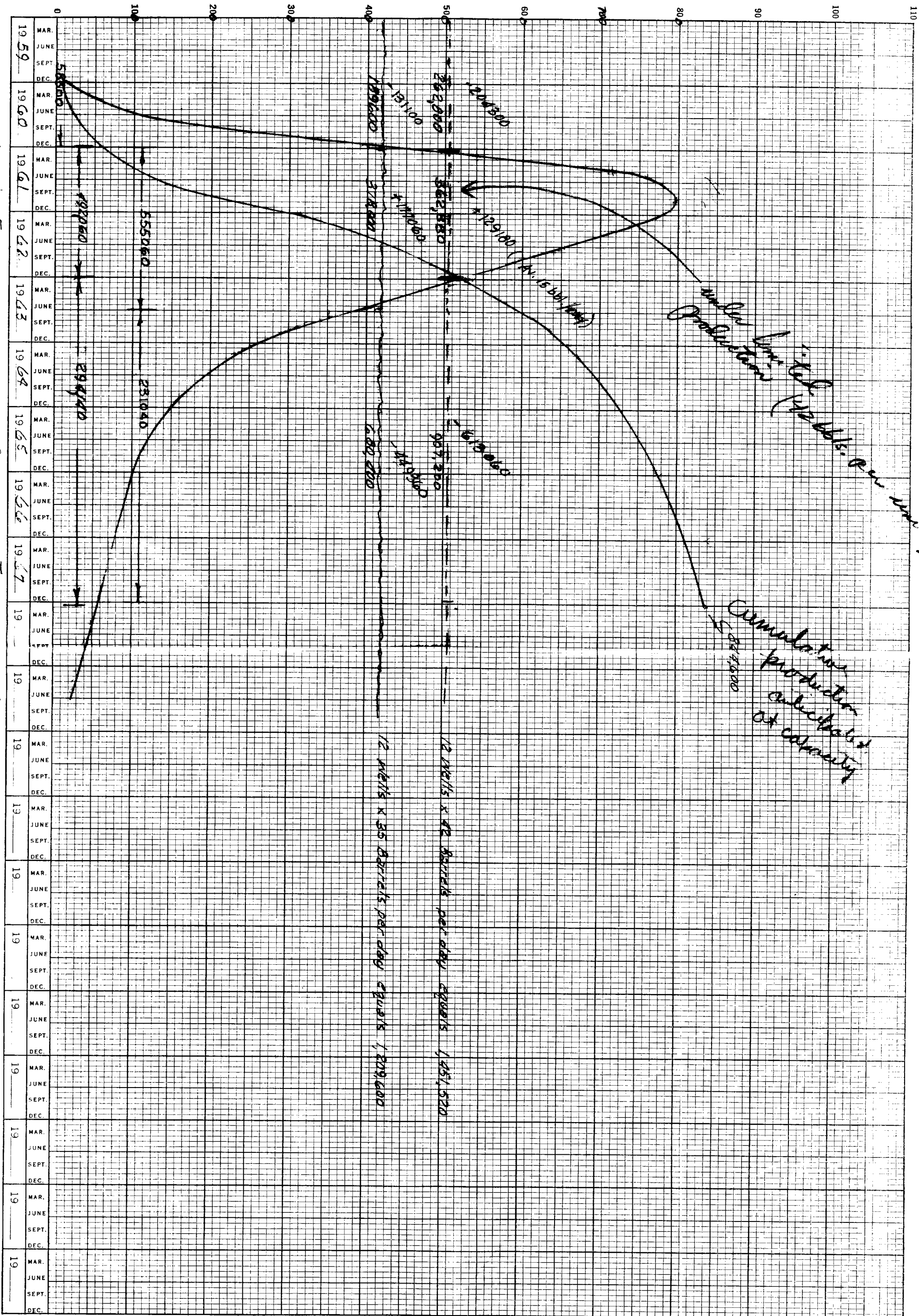

Aston-Fair Waterflood - Grayburg - Field - Early County - W. Va.

See page 10

LARGE FORMAT  
EXHIBIT HAS  
BEEN REMOVED  
AND IS LOCATED  
IN THE NEXT FILE

LARGE FORMAT  
EXHIBIT HAS  
BEEN REMOVED  
AND IS LOCATED  
IN THE NEXT FILE

LARGE FORMAT  
EXHIBIT HAS  
BEEN REMOVED  
AND IS LOCATED  
IN THE NEXT FILE

LARGE FORMAT  
EXHIBIT HAS  
BEEN REMOVED  
AND IS LOCATED  
IN THE NEXT FILE

LARGE FORMAT  
EXHIBIT HAS  
BEEN REMOVED  
AND IS LOCATED  
IN THE NEXT FILE



LARGE FORMAT  
EXHIBIT HAS  
BEEN REMOVED  
AND IS LOCATED  
IN THE NEXT FILE