

Case 2226

PAN AMERICAN PETROLEUM CORPORATION

P. O. Box 480, Farmington, New Mexico
February 14, 1961

File: E-151-986.510.1

Subject: Application for Hearing to
Consider Unorthodox Well Location
And Nonstandard Unit
Cha Cha Gallup Pool
San Juan County, New Mexico

Mr. A. L. Porter, Jr. (3)
New Mexico Oil Conservation Commission
P. O. Box 871
Santa Fe, New Mexico

Dear Sir:

Pan American Petroleum Corporation hereby makes application for a hearing to consider an unorthodox well location for its Navajo Tribal "G" No. 6 which has been staked 310 feet from the south line and 2030 feet from the east line of Section 17, T-29-N, R-14-W, Cha Cha Gallup Pool, San Juan County, New Mexico. The standard location in Lot 10 of Section 17 falls in the San Juan River channel and the maximum orthodox alternate location is on the edge of the river at the bottom of the river bank. These conditions necessitated moving the drill site to an unorthodox location on higher ground adjacent to the river bottom land. The terrain conditions resulting in this request are illustrated on the attached copy of Form C-128, Well Location Plat, for the Navajo Tribal "G" No. 6.

Pan American also makes application for a hearing to consider a nonstandard proration unit for its Navajo Tribal "G" No. 6 consisting of Lots 9 and 10 plus the remaining acreage in the Navajo Tribal "G" Lease in the SE/4 of Section 17, being the S/2 of the San Juan River channel. Lot 9 of Section 17 contains 18.31 acres, Lot 10 contains 25.30 acres and the S/2 of the river channel contains 8.25 acres making a total of 51.86 acres in the nonstandard unit. The acreage to be dedicated to the Navajo Tribal "G" No. 6, as described above, is also shown on the attached copy of Form C-128, Well Location Plat.

It is respectfully requested that application for the nonstandard unit and the unorthodox location be set for hearing at the earliest possible date.

Yours very truly,

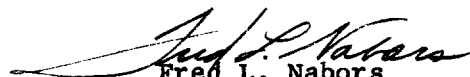
Fred L. Nabors
District Engineer

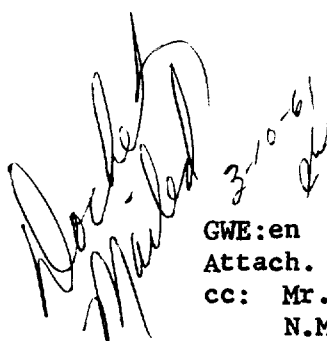
GWE:en
Attach.

cc: Mr. Emery C. Arnold
N.M.O.C.C.
Aztec, New Mexico

NEW MEXICO OIL CONSERVATION COMMISSION
Well Location and Acreage Dedication Plat

Case 2226

SECTION A.

Date February 14, 1961

Operator PAN AMERICAN PETROLEUM CORPORATION Lease Navajo Tribal "G"
Well No. 6 Unit Letter 0 Section 17 Township 29N Range 14W NMPM
Located 310 Feet From South Line, 2030 Feet From East Line
County San Juan G. L. Elevation To be reported later Dedicated Acreage 51.86 Acres
Name of Producing Formation Gallup Pool Cha Cha Gallup

1. Is the Operator the only owner* in the dedicated acreage outlined on the plat below? Yes X No _____
2. If the answer to question One is "No," have the interests of all the owners been consolidated by communitization agreement or otherwise? Yes _____ No _____. If answer is "Yes," Type of Consolidation _____
3. If the answer to question Two is "No," list all the owners and their respective interests below:

OWNER

LAND DESCRIPTION

SECTION B.

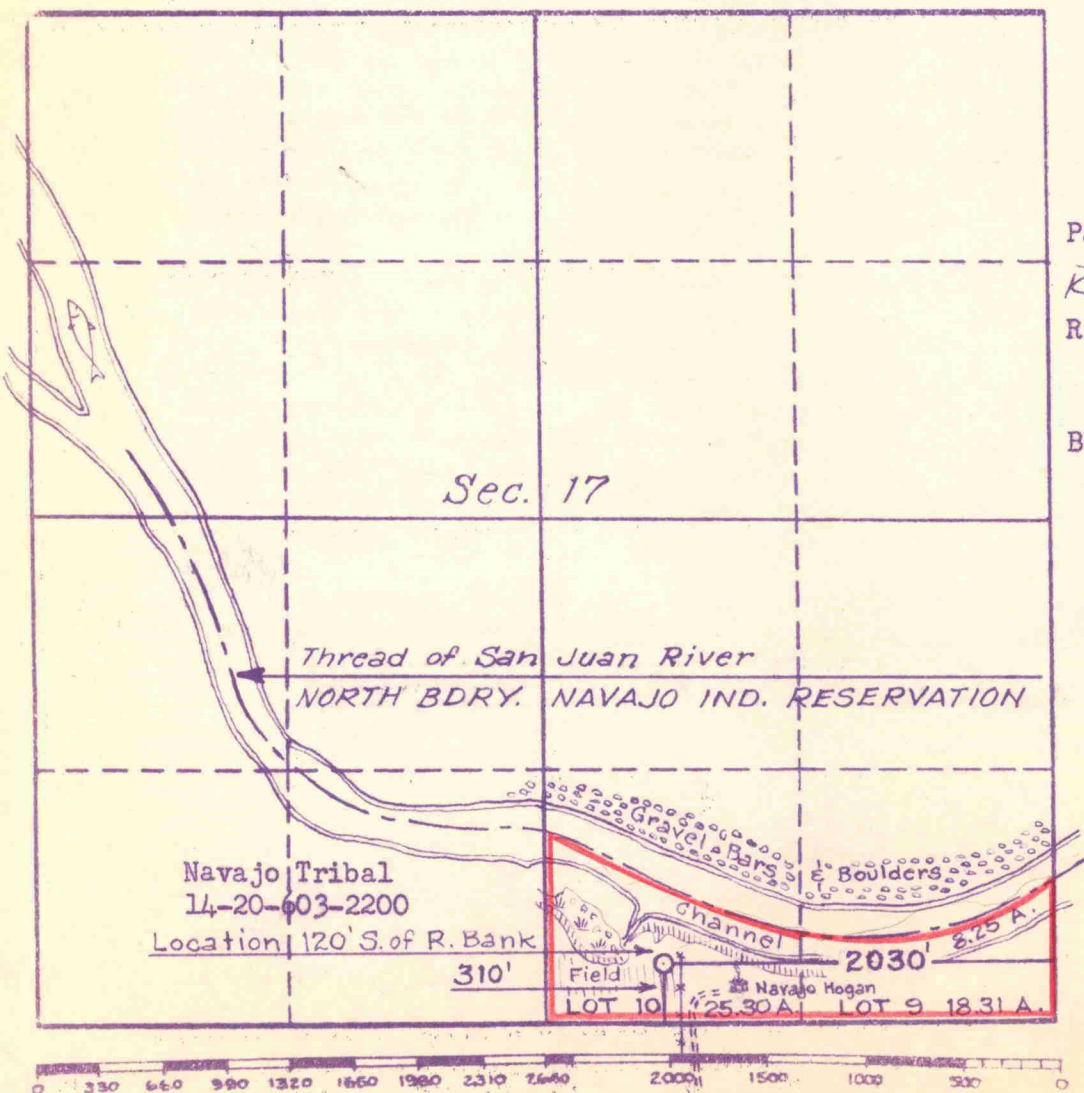

This is to certify that the information in Section A above is true and complete to the best of my knowledge and belief.

Pan American Petroleum Corp.

R. M. Bauer, Jr. (OPERATOR)

R. M. Bauer, Jr.

(REPRESENTATIVE)

Box 480, Farmington, New Mexico

(ADDRESS)

This is to certify that the well location shown on the plat in Section B was plotted from field notes of actual surveys made by me or under my supervision and that the same is true and correct to the best of my knowledge and belief.

Date Surveyed 2-10-61

Four States Engineering Co.
FARMINGTON, NEW MEXICOE. J. C. W. Shuck
REGISTERED ENGINEER OR
LAND SURVEYOR

Certificate No. 1545