

T. P. C. & O. Co.

Lane-Mill Unit

State

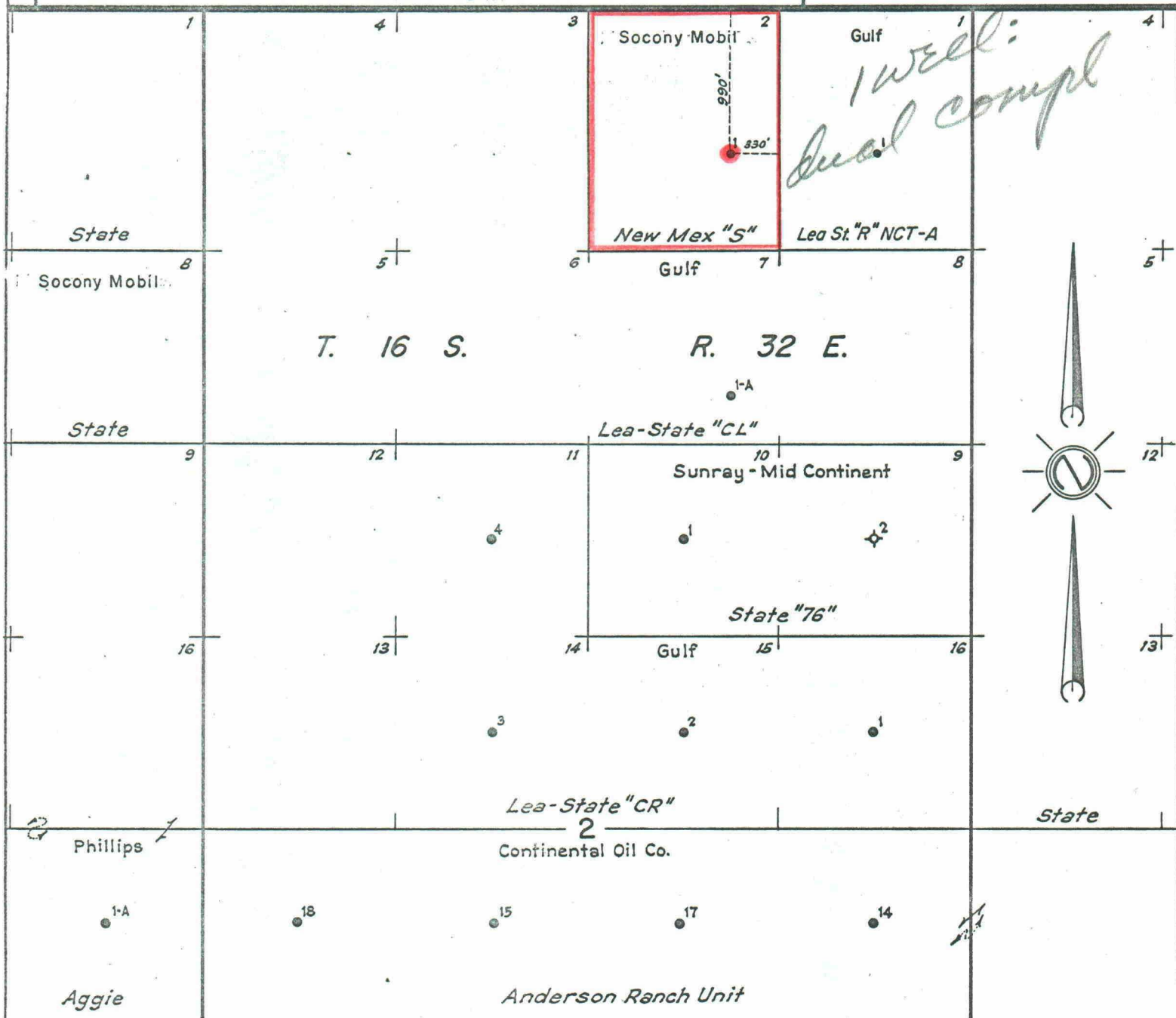

Reserve None

Permit depth

Special instructions

Date work is commenced _____, 19____ Supt.

Location approved by _____ Location made by _____

THE STATE OF TEXAS
COUNTY OF MIDLAND

I hereby certify that this plat truly represents conditions as they actually exist on this lease; that said plat which is drawn to the scale indicated hereon, is to the best of my knowledge true and correct; that it accurately shows said lease with all wells on same; that number and locations of said wells are as indicated hereon; and that this plat correctly reflects all pertinent and required data.

BEFORE EXAMINER NUTTER
OIL CONSERVATION COMMISSION
EXHIBIT NO. 1
CASE NO. 2411

SOCONY MOBIL OIL COMPANY, INC.
EXPLORATION & PRODUCING DEPARTMENT
MIDLAND DIVISION — MIDLAND, TEXAS

LEASE New Mex. "S"
DISTRICT Hobbs LEASE NO. NM-2979
LOCATION MADE19..... WELL NO.
TOTAL ACRES IN LEASE 50.34 ACRES COVERED BY PLAT 50.34
DESCRIPTION Lot 2, Sec. 2, T. 16 S. - R. 32 E.

Lea COUNTY New Mexico

DRAWN Wm. H. Winckler

DATE 4-1-57

FIELD Anderson Ranch

SCALE 1" = 1000'

FILE NO. 39

GOVERNOR
EDWIN L. MECHEM
CHAIRMAN

State of New Mexico
Oil Conservation Commission



P. O. BOX 871
SANTA FE

STATE GEOLOGIST
A. L. PORTER, JR.
SECRETARY - DIRECTOR

LAND COMMISSIONER
E. S. JOHNNY WALKER
MEMBER

December 7, 1961

Mr. Burns Errebo
Box 466
Simms Building
Albuquerque, New Mexico

Re: Case No. 2411
Order No. R-2129
Applicant:
Socony Mobil Oil Company

Dear Sir:

Enclosed herewith are two copies of the above-referenced Commission order recently entered in the subject case.

Very truly yours,

A handwritten signature in cursive script, appearing to read "A. L. Porter, Jr.", written over the typed name.

A. L. PORTER, Jr.
Secretary-Director

ir/

Carbon copy of order also sent to:

Hobbs OCC x
Artesia OCC
Aztec OCC

OTHER

File 2411

LAW OFFICES OF
MODRALL, SEYMOUR, SPERLING, ROEHL & HARRIS

SIMMS BUILDING

P. O. BOX 466

ALBUQUERQUE, NEW MEXICO

TELEPHONE CHAPEL 3-4511

JOHN F. SIMMS (1885-1954)

J. R. MODRALL
AUGUSTUS T. SEYMOUR
JAMES E. SPERLING
JOSEPH E. ROEHL
GEORGE T. HARRIS
DANIEL A. SISK

LELAND S. SEDBERRY
BURNS H. ERREBO
ALLEN C. DEWEY
FRANK H. ALLEN
JAMES A. BORLAND

October 2, 1961

New Mexico Oil Conservation Commission
Post Office Box 871
Santa Fe, New Mexico

Re: Application of Socony Mobil Oil Company, Inc.
for Exception to Rule 303(a) to Permit Commingling
on its New Mexico "S" Lease.

Gentlemen:

Enclosed herewith is Application of Socony Mobil Oil Company,
Inc., covering the above matter, which we would appreciate
your setting for hearing at your early convenience.

Very truly yours,

MODRALL SEYMOUR SPERLING ROEHL & HARRIS

By Burns H. Errebo
BURNS H. ERREBO

BHE:get
Encl.

cc: Socony Mobil Oil Company, Inc.
Attention: Mr. C. H. Samples
Post Office Box 2046
Hobbs, New Mexico
(Encl. - copy of application)

Mobil Oil Company
Attention: Mr. J. H. Vickrey
Box 633 - Mobil Building
Midland, Texas
(Encl. - copy of application)

10/11/61

CASE 2410: (Cont.)

New Mexico, the surface location to be 2310 feet from the North line and 1980 feet from the East line of said Section 26 and the bottom hole location to be in the Empire-Abo Pool at a situs 2540 feet from the North line and 1980 feet from the East line of said Section 26.

CASE 2411:

Application of Socony Mobil Oil Company, Inc., for an exception to Rule 303 (a), Lea County, New Mexico. Applicant, in the above-styled cause, seeks an exception to Rule 303 (a) to permit the commingling of the production from the Anderson Ranch-Devonian and the Anderson Ranch-Wolfcamp Pools on its New Mexico "S" lease, which includes Lot 2 of Section 2, Township 16 South, Range 32 East, Lea County, New Mexico. Applicant proposes to meter the production from one pool only, and to allocate production to the other pool according to the subtraction method; the API gravity of the Anderson Ranch-Devonian crude is greater than 45⁰.

CASE 2412:

Application of Val R. Reese & Associates, Inc., for an unorthodox gas well location and a non-standard gas unit, Rio Arriba County, New Mexico. Applicant, in the above-styled cause, seeks permission to locate its Benn Well No. 1-9 at an unorthodox gas well location in an undesignated Gallup pool, 2210 feet from the North line and 330 feet from the East line of Section 9, Township 23 North, Range 7 West, Rio Arriba County, New Mexico, said well to be dedicated to a 152.02-acre non-standard gas unit comprising the NE/4 of said Section 9.

The following cases will not be heard before 1:00 P.M.

CASE 2413:

Application of Aspen Crude Purchasing Company for an unorthodox oil well location, San Juan County, New Mexico. Applicant, in the above-styled cause, seeks approval of an unorthodox oil well location in the Totah-Gallup Oil Pool for a well to be drilled 1190 feet from the South line and 2210 feet from the East line of Section 11, Township 28 North, Range 13 West, San Juan County, New Mexico.

CASE 2414:

Application of Southwest Production Company for an unorthodox gas well location, San Juan County, New Mexico. Applicant, in the above-styled cause, seeks approval of an unorthodox

Docket No. 29-61

CASE 2414: (Cont.)

gas well location in an undesignated Mesaverde pool for a well located 2360 feet from the South line and 830 feet from the West line of Section 26, Township 30 North, Range 12 West, San Juan County, New Mexico. Said well is to serve as the unit well for a 160-acre gas proration unit comprising the SW/4 of said Section 26.

CASE 2415:

Application of Southwest Production Company for an order pooling all mineral interests in the Basin-Dakota Gas Pool in the E/2 of Section 14, Township 30 North, Range 12 West, San Juan County, New Mexico. Interested parties include the unknown heirs of Abas Hassan, deceased, the unknown heirs of D. M. Longstreet, deceased, and Robert E., Alice L., and Samuel Glenn Goodwin, and/or their unknown heirs.

CASE 2416:

Application of Southwest Production Company for an order pooling all mineral interests in an undesignated Mesaverde gas pool in the E/2 of Section 22, Township 30 North, Range 12 West, San Juan County, New Mexico.

CASE 2417:

Application of Scanlon Engineering Company for an order fixing the spacing of wells, McKinley County, New Mexico. Applicant, in the above-styled cause, seeks an order fixing the spacing of wells producing from the Mesaverde formation in Sections 21, 22 and 27, all in Township 20 North, Range 9 West, McKinley County, New Mexico. Applicant recommends the establishment of two and one-half acre well spacing.

CASE 2418:

Application of Humble Oil & Refining Company for a dual completion, Lea County, New Mexico. Applicant, in the above-styled cause, seeks permission to complete its State BM Well No. 1, located in Unit I, Section 2, Township 25 South, Range 37 East, Lea County, New Mexico, as a dual completion (Tubingless) in undesignated Fusselman and Ellenburger pools, with the production of oil from the Fusselman zone through 2 7/8-inch casing and the production of oil from the Ellenburger zone through 2 3/8-inch casing cemented in a common well bore.

CASE 2419:

Application of Leonard Oil Company for a triple completion, Lea County, New Mexico. Applicant, in the above-styled cause, seeks permission to complete its Federal Ginsberg Well No. 11, located in Unit E, of Section 31, Township 25 South, Range 38 East, Lea County, New Mexico, as a triple completion (conventional) in the Justis Blinbry Pool, in an undesignated

EXHIBIT III

Commingle Fluid Production
Socony Mobil Oil Company, Inc.
New Mexico "S" Lease

Lot 2, Section 2, T16S, R12E

Pool	API Gravity	Monthly Production	Unit Value	Total Value
Anderson Ranch Devonian	50.6°	4514	\$ 2.93	\$13,045.40
Anderson Ranch Wolfcamp	41.5°	4522	3.01	13,612.22
Lease Total		9136		\$26,657.68
Anderson Ranch Commingled	46°	9136	\$ 2.37	\$21,133.92

The actual commercial value of the commingled crude oil will be \$106.24 more than the two separate zones.

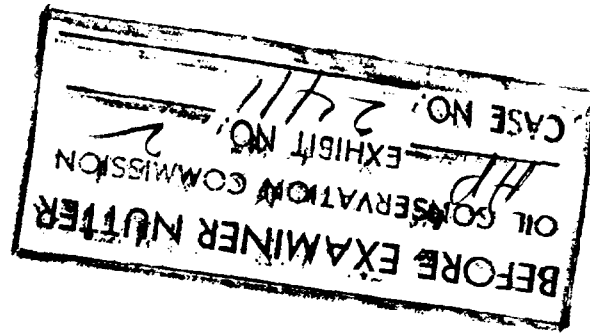

*Order no.
PC-36
authorizes comm
w/ two meters*

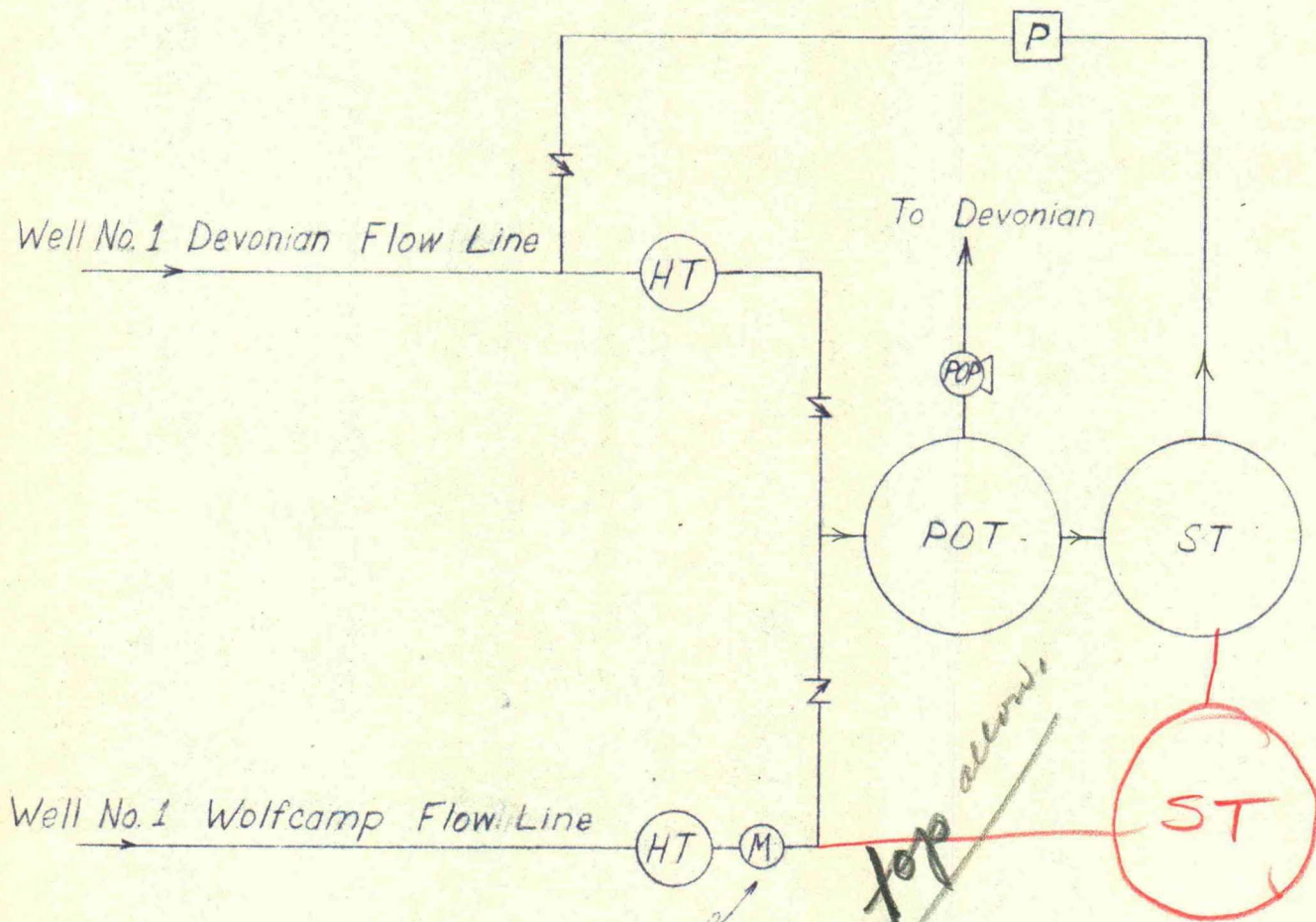

*will hold oil
for 24 hrs.
1000 bbl
tanks*

BEFORE EXAMINER NUTTER
OIL CONSERVATION COMMISSION
AP EXHIBIT NO. 3
CASE NO. 2411

proved in stock tank

Exhibit II

- LEGEND
- HT Heater Treater
 - M Meter
 - P Recirculating Pump
 - POT Power Oil Tank
 - ST Stock Tank
 - POP Power Oil Pump

NO.	DATE	BY	ALTERATION
PROPOSED COMMINGLING INSTALLATION			
NEW MEXICO "S" LEASE			
LOT 2, SEC 2, T16S, R32E			
LEA COUNTY, NEW MEXICO			
SOCONY MOBIL OIL COMPANY, INC.			
Hobbs, New Mexico			
DRAWN <i>J.E.B.</i>		DWG. NO.	
CHECKED <i>J.G.S.</i>		A	
SCALE		DATE 10-17-61	

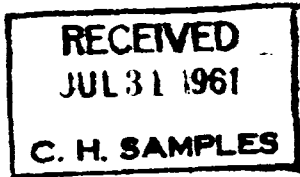

State of New Mexico



Commissioner of Public Lands

E. S. JOHNNY WALKER
COMMISSIONER



P. O. BOX 901
SANTA FE, NEW MEXICO

July 28, 1961

MC

File
Ref.

7.01

Socony Mobil Oil Company
P. O. Box 2406
Hobbs, New Mexico

Attention: Mr. C. H. Samples:

Dear Mr. Samples:

We find no reason to object to your request to commingle the Devonian - Wolf Camp crude oils produced from your New Mexico S Lease in the Anderson Ranch Field, if the commingling does not lessen the amount of royalty to be received by the State.

Exhibit 3 definitely shows that the royalty should be increased, therefore, we are glad to give you this permission.

Yours very truly,

E. S. JOHNNY WALKER
Commissioner of Public Lands

By: *Ted Bilberry*
Ted Bilberry, Supervisor
Oil and Gas Division

ESW:TB:eq