

## Gas Well Plat

Well No.

(over)

STANDARD OIL AND GAS WELL LOCATIONS IN NEW MEXICO ACCORDING TO RULE 104  
OF THE GENERAL RULES AND REGULATIONS

Sec. \_\_\_\_\_ Township No. \_\_\_\_\_ of Range No. \_\_\_\_\_

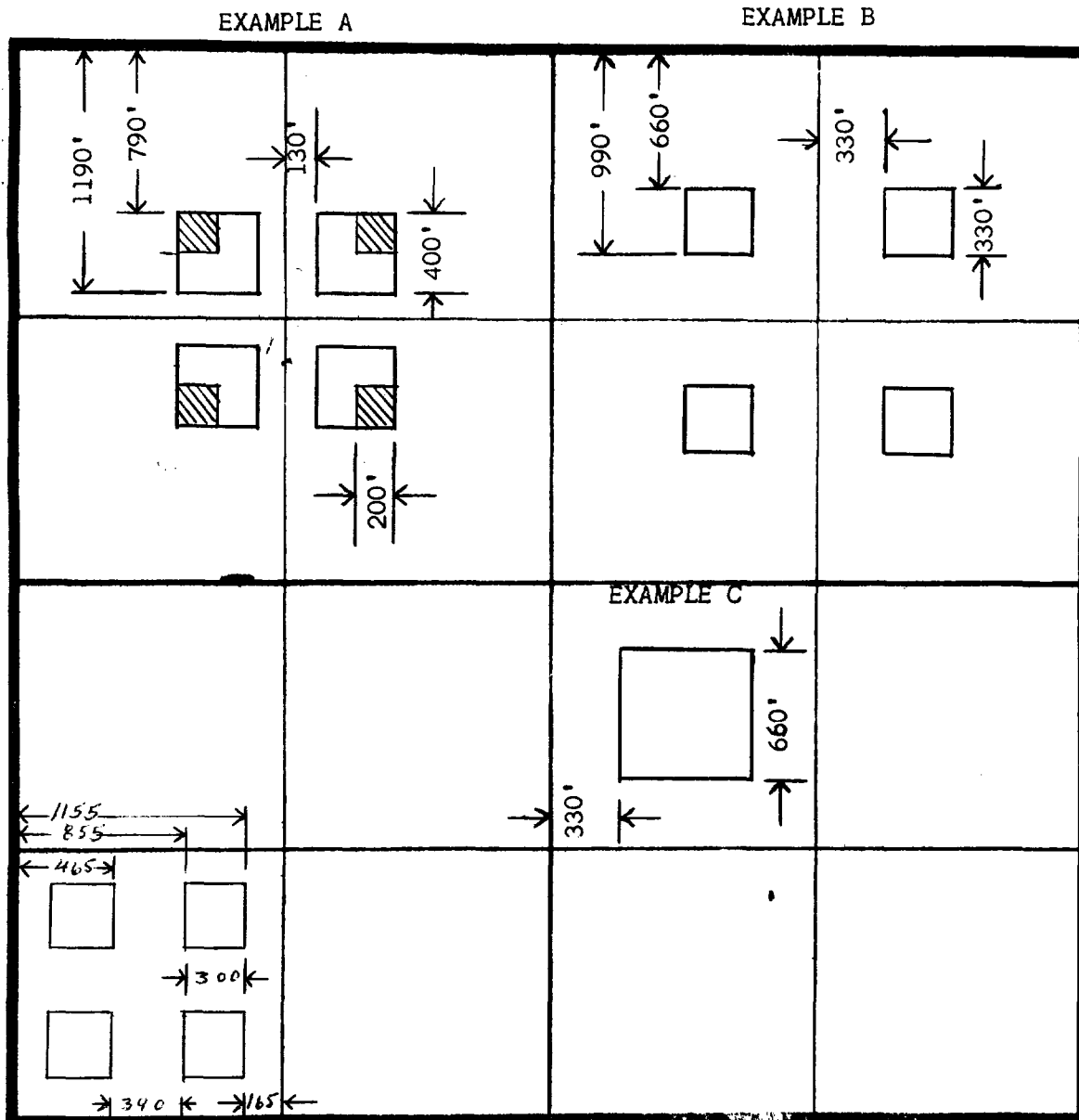

EXAMPLE A - Shows Standard Gas Well location in San Juan, Rio Arriba and Sandoval Counties. 200' crosshatched square shows portion of 400' square which is a standard location for oil or gas wells. These locations may be used in any quarter section.

EXAMPLE B - Shows standard gas well location for the State, except San Juan, Rio Arriba and Sandoval Counties. These locations may be used in any quarter section.

EXAMPLE C - Shows Standard Oil Well location for the State. This location may be used for a wildcat oil or gas well except in San Juan, Rio Arriba and Sandoval Counties. This location may be used in any quarter quarter section.

LARGE FORMAT  
EXHIBIT HAS  
BEEN REMOVED  
AND IS LOCATED  
IN THE NEXT FILE