

22-105-30E

STANDARD OIL AND GAS WELL LOCATIONS IN NEW MEXICO ACCORDING TO RULE 104
OF THE GENERAL RULES AND REGULATIONS

Sec. _____ Township No. _____ of Range No. _____

Sec. 22

EXAMPLE A

EXAMPLE B

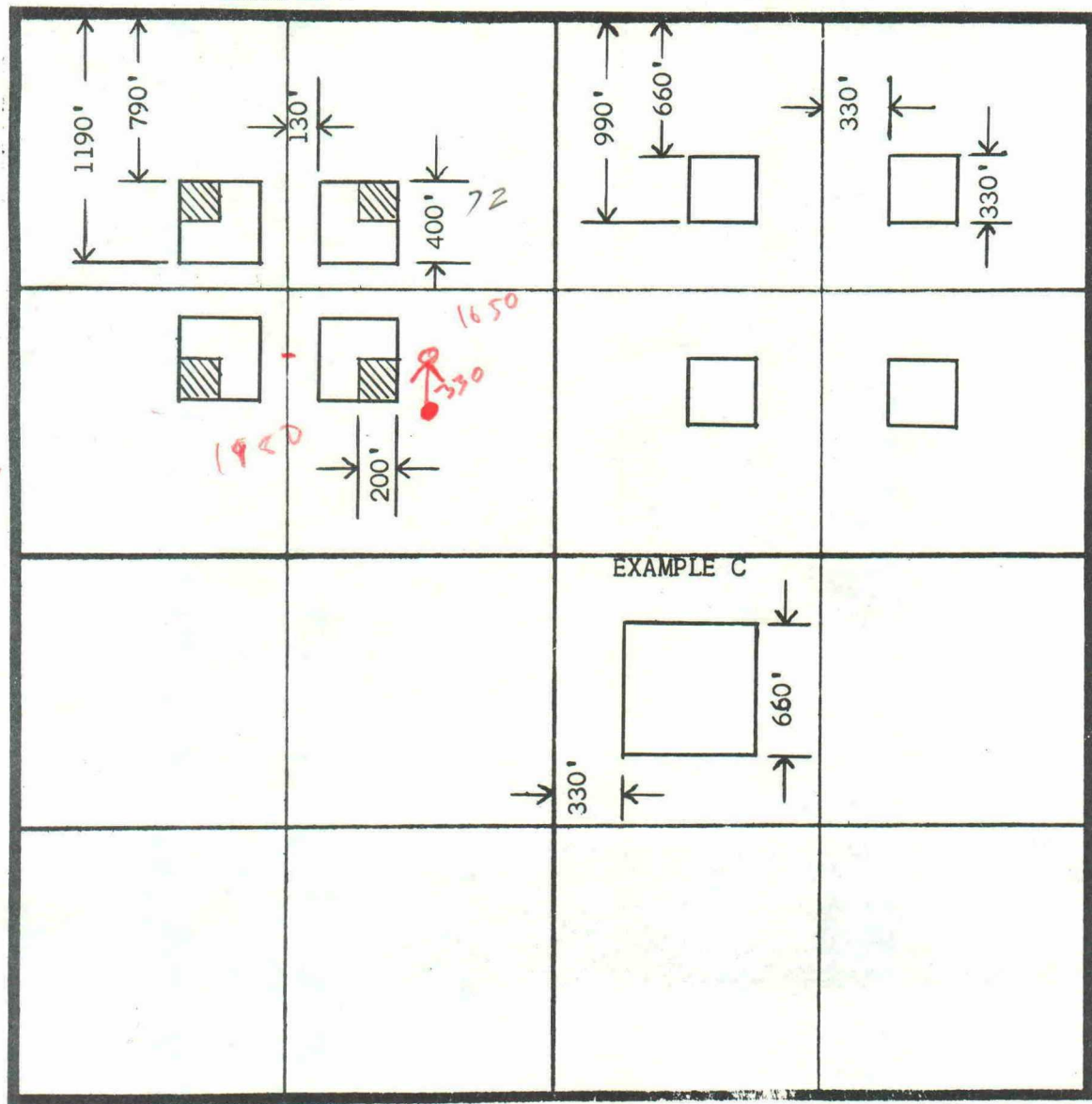

1980
1320
1650
1320
330

330
150
180 out.
of other

- EXAMPLE A - Shows Standard Gas Well location in San Juan, Rio Arriba and Sandoval Counties. 200' crosshatched square shows portion of 400' square which is a standard location for oil or gas wells. These locations may be used in any quarter section.
- EXAMPLE B - Shows standard gas well location for the State, except San Juan, Rio Arriba and Sandoval Counties. These locations may be used in any quarter section.
- EXAMPLE C - Shows Standard Oil Well location for the State. This location may be used for a wildcat oil or gas well except in San Juan, Rio Arriba and Sandoval Counties. This location may be used in any quarter quarter section.

11/19/56