

HP

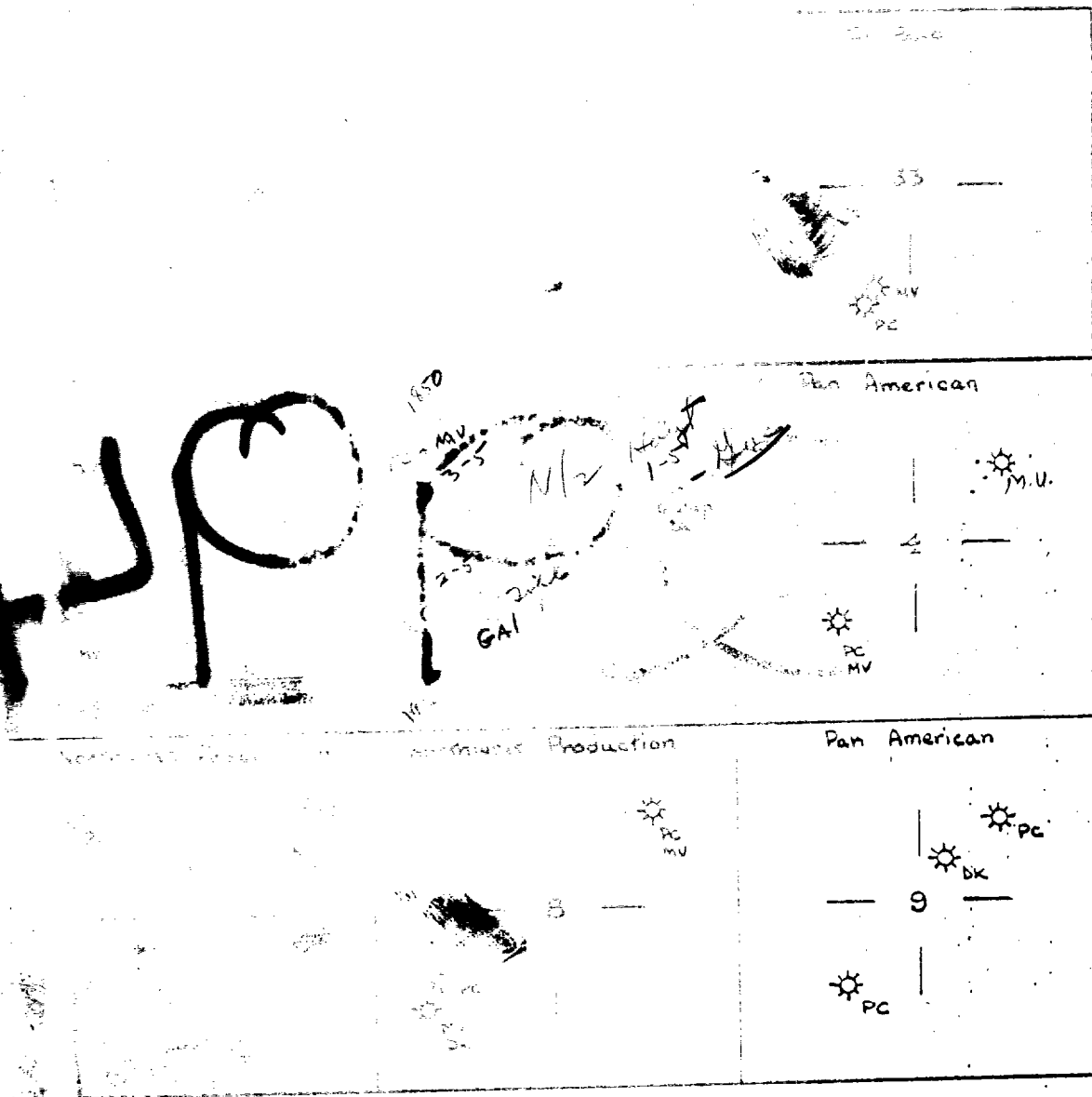

LOCATION FOR UNORTHODOX LOCATION
 BLANCO MESA VERDE
 CONSOLIDATED OIL & GAS CO.
 HOYT NO. 3-5
 NW/4, - Section 5, Township 26 North, Range 4 West
 Rio Arriba County, New Mexico

ILLEGIBLE

Well Location and Acreage Dedication Plat

Section A.

Date January 24, 1964

Operator CONSOLIDATED OIL AND GAS, INC. Lease Hoyt
 Well No. 3-5 Unit Letter E Section 5 Township 26 NORTH Range 4 WEST, NMPM
 Located 1850 Feet From the NORTH Line, 1130 Feet From the WEST Line
 County RIO ARriba G. L. Elevation 7299.0 Dedicated Acreage 160 Acres
 Name of Producing Formation Pictured Cliffs Pool Tapacito

1. Is the Operator the only owner in the dedicated acreage outlined on the plat below?
 Yes X No _____
2. If the answer to question one is "no", have the interests of all the owners been consolidated by communitization agreement or otherwise? Yes _____ No _____. If answer is "yes", Type of Consolidation.
3. If the answer to question two is "no", list all the owners and their respective interests below:

OwnerLand Description

Section B.

Note: All distances must be from outer boundaries of section.

This is to certify that the information in Section A above is true and complete to the best of my knowledge and belief.

Consolidated Oil & Gas, Inc.
 (Operator)

(Representative)

Chief Engineer

(Address)

4150 East Mexico AvenueDenver 22, Colorado

Ref: GLO plat dated 4 November 1882

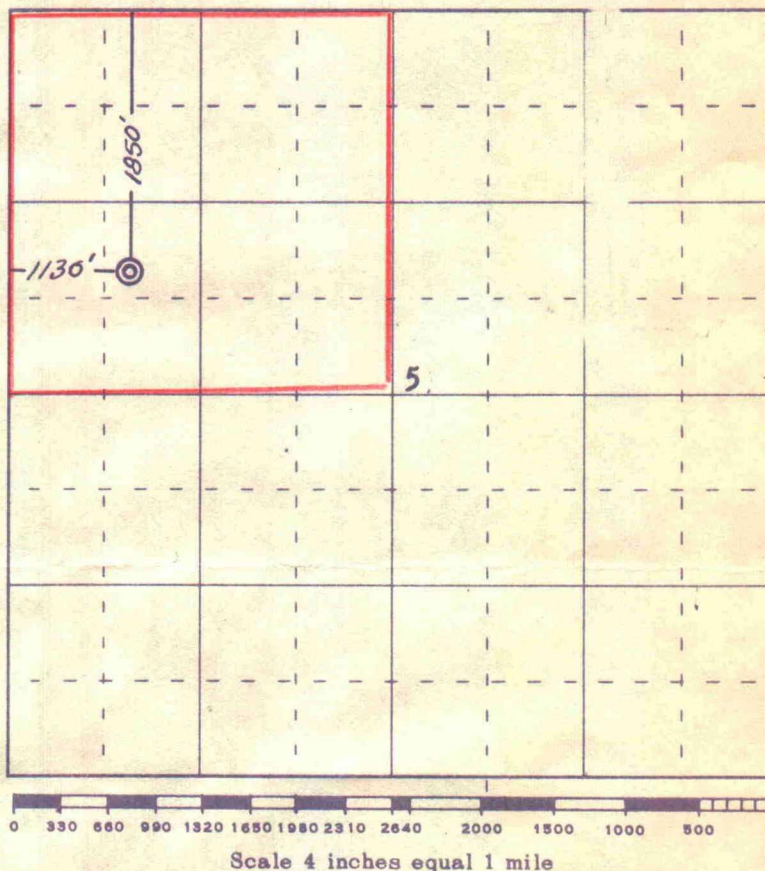

This is to certify that the above plat was prepared from field notes of actual surveys made by me or under my supervision and that the same are true and correct to the best of my knowledge and belief.

Date Surveyed 15 January 1964

James P. Leese
 Registered Professional Engineer and/or Land Surveyor
 James P. Leese N. Mex. Reg. No. 1463
 San Juan Engineering Company



Case 2992