



1969 JUN 18 AM 8 54

# OIL CONSERVATION COMMISSION

STATE OF NEW MEXICO

DRAWER DD - ARTESIA

88210

June 17, 1969

GOVERNOR  
DAVID F. CARGO  
CHAIRMAN

LAND COMMISSIONER  
ALEX ARMIJO  
MEMBER

STATE GEOLOGIST  
A. L. PORTER, JR.  
SECRETARY - DIRECTOR

N. M. Oil Conservation Commission  
P. O. Box 2088  
Santa Fe, New Mexico

Attention: Mr. A. L. Porter, Jr.

Re: Request for exception to  
Order No. R-3221, Perry R.  
Bass, Continental Federal  
No. 1-D, 20-25-30, Corral  
Canyon-Delaware Pool, Eddy  
County, New Mexico

Dear Mr. Porter:

It is my understanding that Perry R. Bass has requested that the Commission consider calling a hearing upon its own motion for the exemption of the subject well or lease from the no pit provisions of Order No. R-3221. I am in favor of this request for the following reasons.

1. An inspection of the area January 8, 1969, showed no windmills in evidence between the Pecos River and the well.
2. Said inspection showed surface drainage to be toward the Pecos River seven miles to the southwest. There is no evidence that the subsurface drainage flows in any other direction.
3. Based on testimony in Case No. 4025 and 4026 and my own observations, the only windmills in use in the area are around 300 or more feet deep and lie nearly two miles north and northeast of the well in question. This is upstream to the drainage.
4. The subject well produces only about 5 BWPD and Commission Orders No. R-3684 and R-3685 have previously authorized the disposal of about 270 BWPD in unlined pits in the pool.

-2-

Mr. A. L. Porter, Jr.

Enclosed you will find an area map showing the pool, well and other information. The area map is a portion of Plate 4, Ground Water Report No. 3. No water wells were observed which are not shown on this map. Also enclosed is a sketch map of the pool showing the location of all oil wells, tanks, pits and windmills in the pool.

At this time, there are other pools in the district lying near or between areas or leases that have been exempted from the no pit provisions of Order No. R-3221 which might also be considered for exemption. I am thinking primarily of the territory around the Shugart Pool and the Potash Area.

If you wish me to work up any additional recommendations or need any more information on Mr. Bass's request, please advise.

Very truly yours,

OIL CONSERVATION COMMISSION

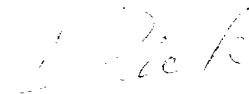

R. L. Stamets

RLS:jw  
Enclosures

## CORRAL CANYON DELAWARE POOL

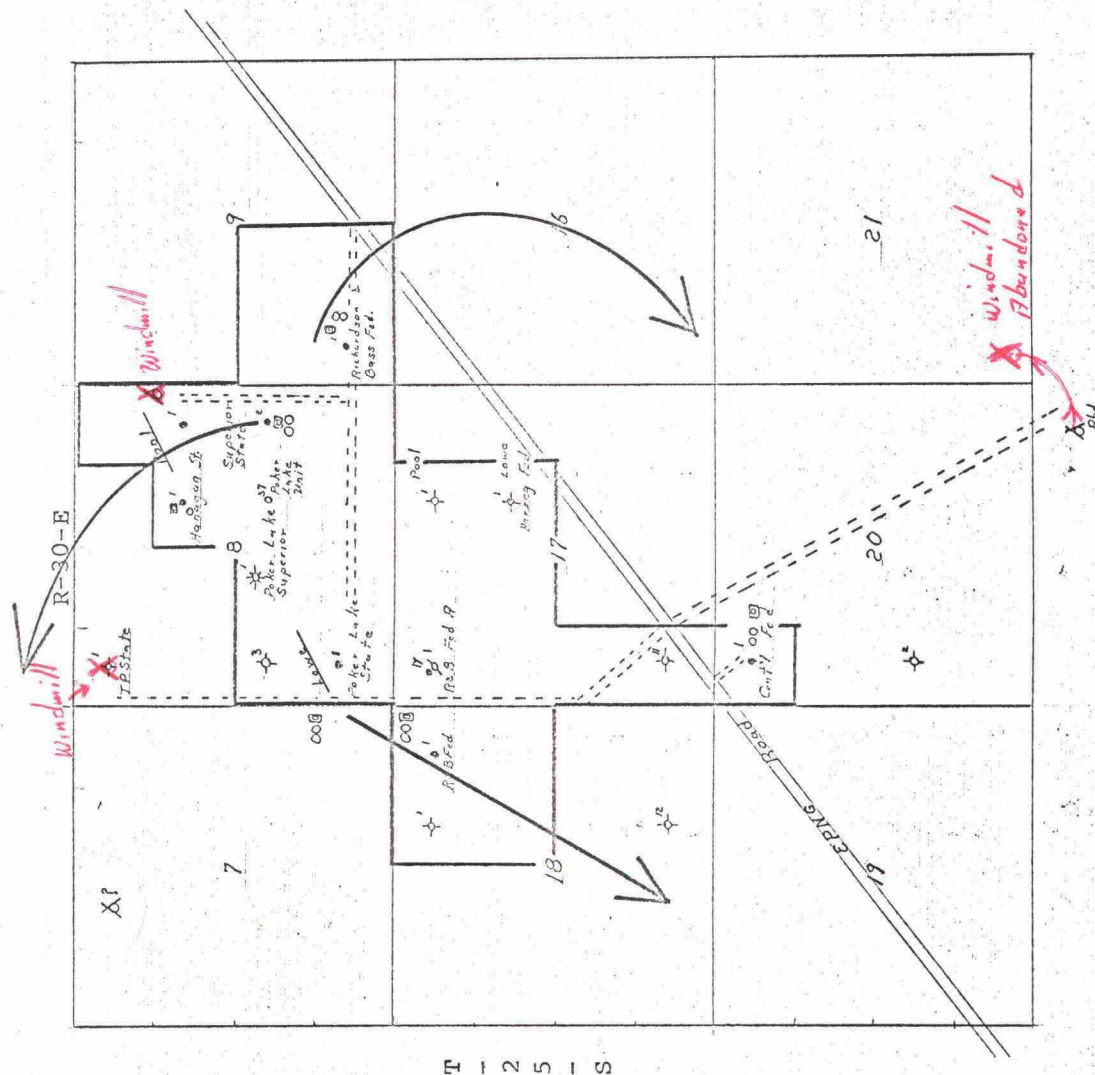

Estimated direction of drainage.

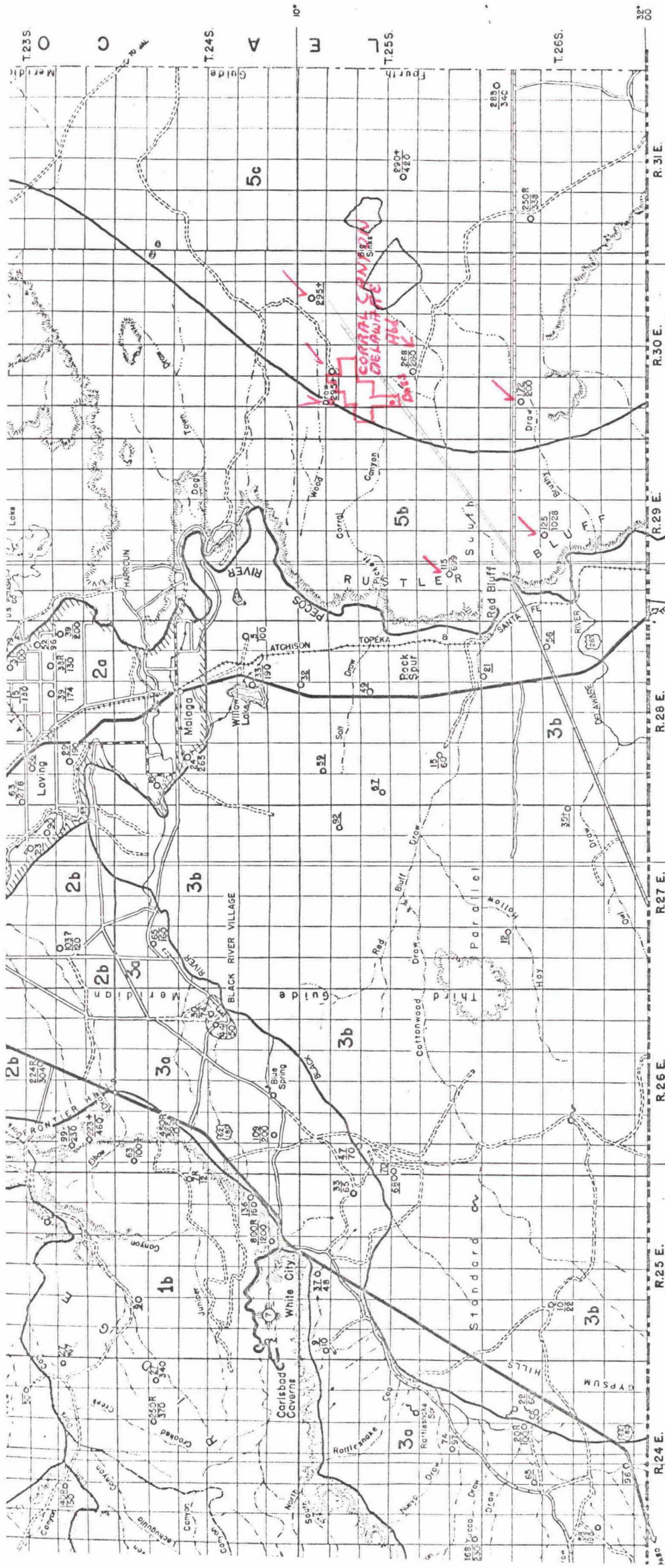

R S O N C O U N T Y A S R E E V E S C O . L O V I N G C O U N T Y

# SPRINGS AND AVAILABILITY OF GROUND WATER IN EDDY COUNTY, NEW MEXICO

Note: Most well depths are reported. Depths to water are measured except those followed by the letter R which are reported. Measurements made 1947 to 1950.

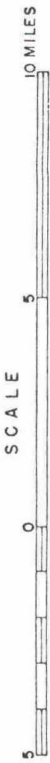

Well 250 - Depth to water  
On Spring 370 - Depth to well