

NEW MEXICO OIL CONSERVATION COMMISSION
WELL LOCATION AND ACREAGE DEDICATION PLAT

Form C-102
Supersedes C-128
Effective 1-1-65

All distances must be from the outer boundaries of the Section.

Operator Western Oil Producers, Inc.			Lease State M		Well No. 1
Unit Letter E	Section 32	Township 20S	Range 36E	County Lea	
Actual Footage Location of Well: 1980 feet from the north line and 660 feet from the west line					
Ground Level Elev: 3661	Producing Formation Devonian		Pool Wild cat	Dedicated Acreage: Subject hearing 320 Acres	

1. Outline the acreage dedicated to the subject well by colored pencil or hachure marks on the plat below.
2. If more than one lease is dedicated to the well, outline each and identify the ownership thereof (both as to working interest and royalty).
3. If more than one lease of different ownership is dedicated to the well, have the interests of all owners been consolidated by communitization, unitization, force-pooling, etc?

☐ Yes ☒ No If answer is "yes," type of consolidation _____

If answer is "no," list the owners and tract descriptions which have actually been consolidated. (Use reverse side of this form if necessary.) _____

No allowable will be assigned to the well until all interests have been consolidated (by communitization, unitization, forced-pooling, or otherwise) or until a non-standard unit, eliminating such interests, has been approved by the Commission.

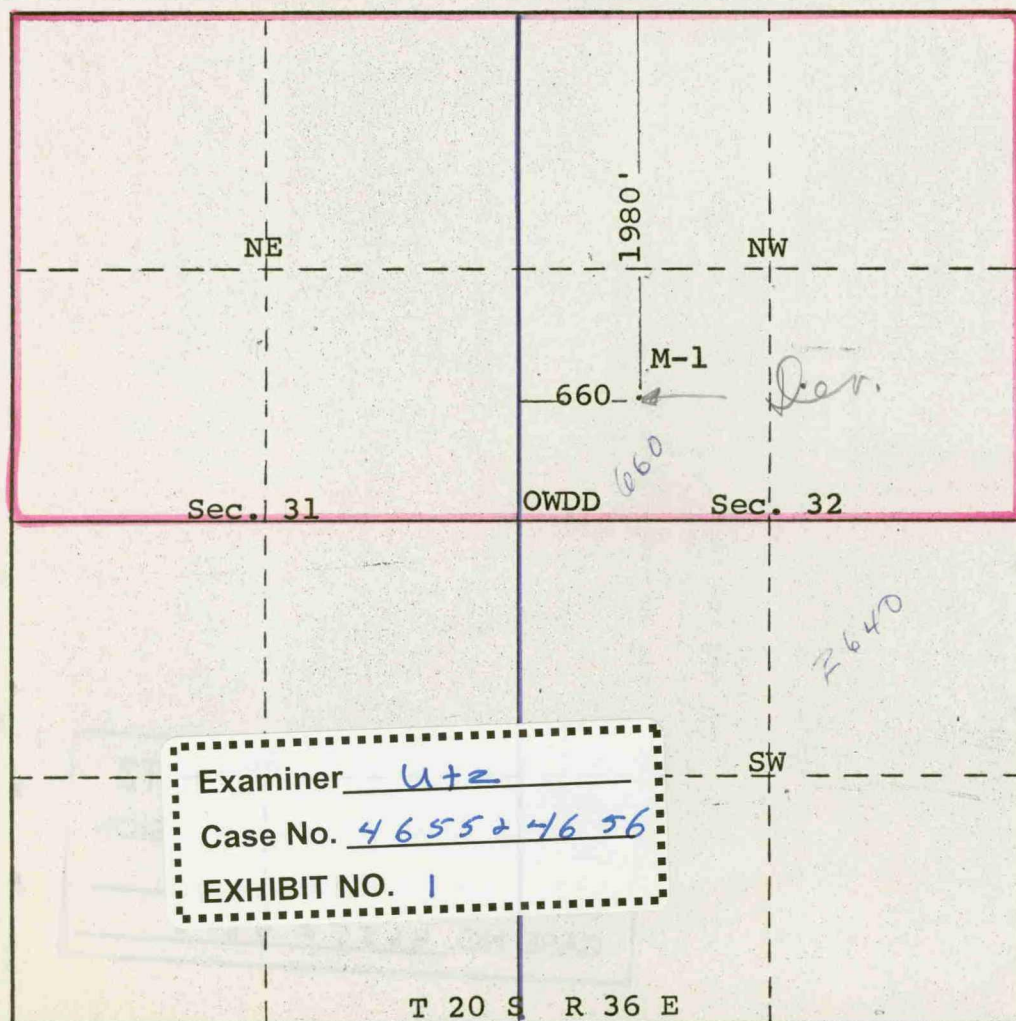

CERTIFICATION

I hereby certify that the information contained herein is true and complete to the best of my knowledge and belief.

Name _____

Position _____

Company _____

Western Oil Producers, Inc.

Date _____

1-20-72

I hereby certify that the well location shown on this plat was plotted from field notes of actual surveys made by me or, under my supervision, and that the same is true and correct to the best of my knowledge and belief.

Resurveyed OWDD

Date Surveyed _____

1-20-72

Registered Professional Engineer and/or Land Surveyor

N. Raymond Lamb

Certificate No. _____

929

0 330 660 990 1320 1650 1980 2310 2640 2000 1500 1000 500 0

Subject: Western Oil Properties

1. The above described property is situated in the State of Texas, County of [blank], and is more or less bounded by the following:

2. It contains more or less than one acre, and is more or less bounded by the following:

3. It contains more or less than one acre, and is more or less bounded by the following:

4. It contains more or less than one acre, and is more or less bounded by the following:

5. It contains more or less than one acre, and is more or less bounded by the following:

6. It contains more or less than one acre, and is more or less bounded by the following:

7. It contains more or less than one acre, and is more or less bounded by the following:

8. It contains more or less than one acre, and is more or less bounded by the following:

9. It contains more or less than one acre, and is more or less bounded by the following:

10. It contains more or less than one acre, and is more or less bounded by the following:



CERTIFICATION

I hereby certify that the information contained herein is true and correct to the best of my knowledge and belief.

Signature: [blank]

Notary Public for Texas

Western Oil Properties

1-20-72

1-20-72

1-20-72

1-20-72

1-20-72

BEFORE EXAMINER UTZ
OIL CONSERVATION COMMISSION
Western Oil EXHIBIT NO. 1
CASE NO. 4655 & 4656