

Case No.

5341

Large Exhibits

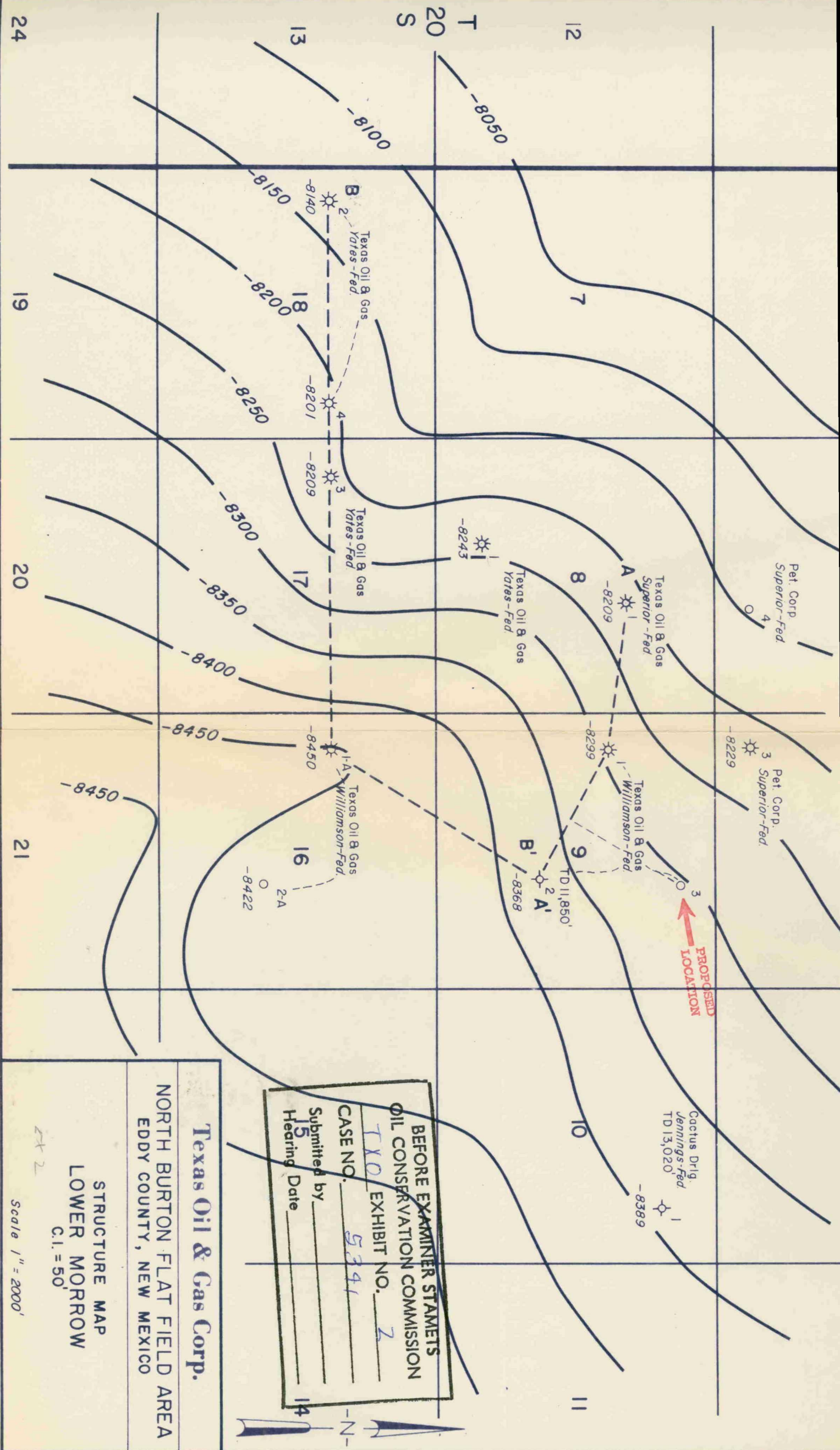

BEFORE EXAMINER STATEMENTS
OIL CONSERVATION COMMISSION

TXO EXHIBIT NO. 2

CASE NO. 5341

Submitted by _____

Hearing Date _____

Texas Oil & Gas Corp.

NORTH BURTON FLAT FIELD AREA
EDDY COUNTY, NEW MEXICO

STRUCTURE MAP
LOWER MORROW
C.I. = 50'

Scale 1" = 2000'

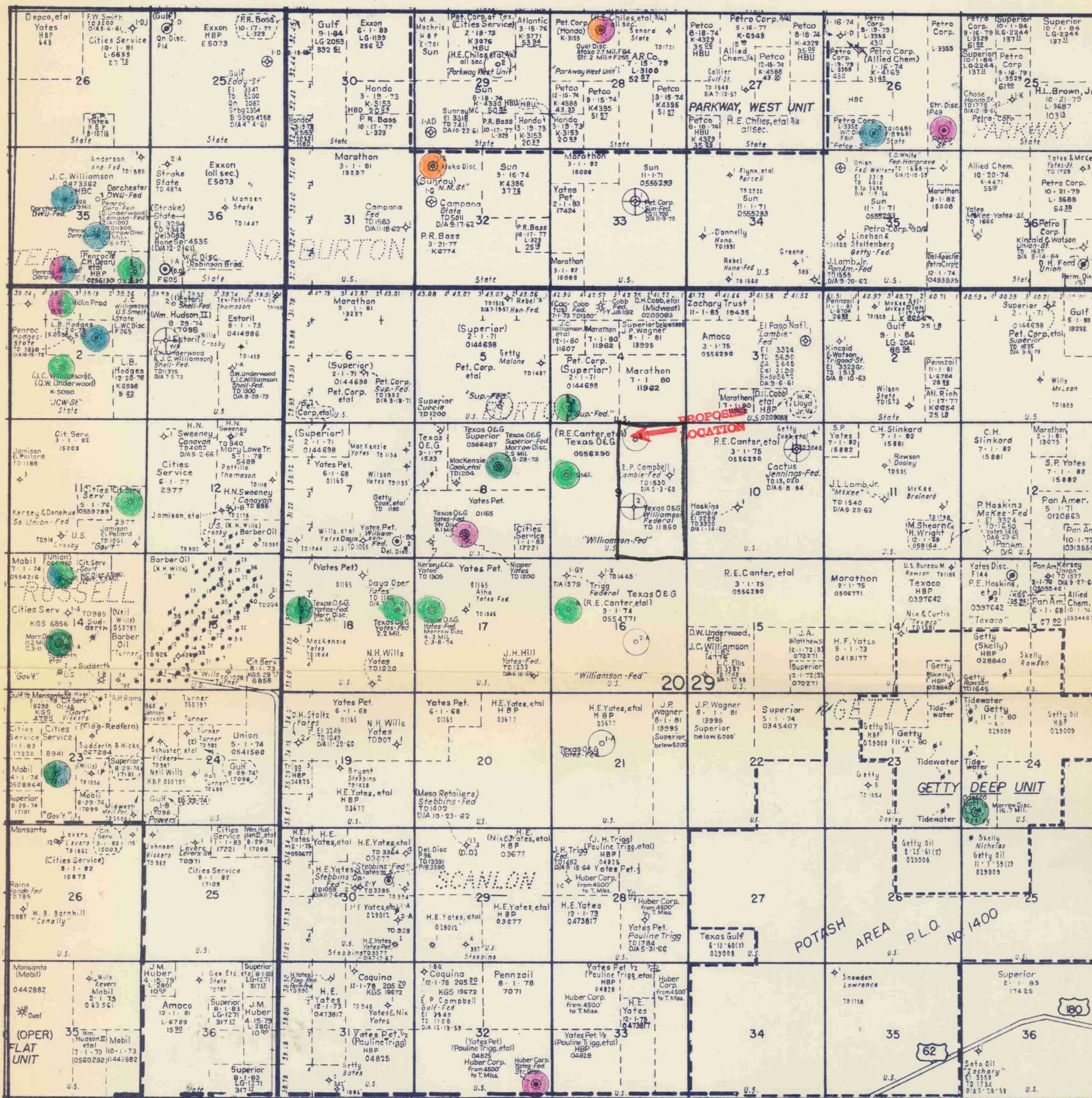

BEFORE EXAMINER STAMETS
OIL CONSERVATION COMMISSION
TXO EXHIBIT NO. 1
CASE NO. 5341
Submitted by
Hearing Date

Texas Oil & Gas Corp.

NORTH BURTON FLAT FIELD AREA
EDDY COUNTY, NEW MEXICO

PRODUCTION & LAND
MAP

D.G.M.

Scale: 1" = 4000'