

STATE OF NEW MEXICO
DEPARTMENT OF ENERGY AND MINERALS
OIL CONSERVATION DIVISION

MARCH 26, 1980

EXHIBITS

TENNECO OIL COMPANY
1980 BLOOMFIELD AREA DRILLING PROGRAM
WELL SUMMARY

CHACRA-MESA VERDE-DAKOTA WELLS

<u>WELL</u>	<u>LOCATION</u>
1. Marquis G. Eaton A1E	NE-25-29-11
2. Elvin J. Payne A1E	SW-19-29-10
3. Sullivan Frame Gas A1E	NE-30-29-10
4. Sullivan Gas A1E	SW-25-29-11
5. Valdez Gas A1E	NE-24-29-11

CHACRA-MESA VERDE WELLS

<u>WELL</u>	<u>LOCATION</u>
1. Bunce Com 1	NW-29-29-10
2. Eaton Com B-1	SW-25-29-11
3. Bruce Sullivan Com B-1	NW-25-29-11
4. Sullivan Frame Com B-1	NW-30-29-10
5. Valdez Com B-1	SE-24-29-11

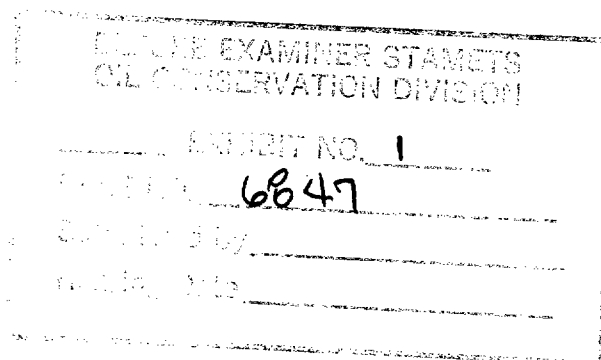

TYPE LOG
CHACRA FM.

GETTY OIL COMPANY
HANLEY B# 1
SW/4 SEC. 18, T29N-R10W
SAN JUAN COUNTY, NEW MEXICO

IPF: 791 MCFD
48/64 CK
PERF: 2932-38
SWFR 21,000 GALS.
30,000 LBS. SAND
TP 46, CP 290, GTY 60

DATUM ——— TOP

CHACRA

2924
(2634)

BEFORE EXAMINED GETTY OIL OIL CONSERVATION DIVISION	
EXHIBIT NO.	4
CASE NO.	6847
DATE FILED BY	
INDEXING DATE	

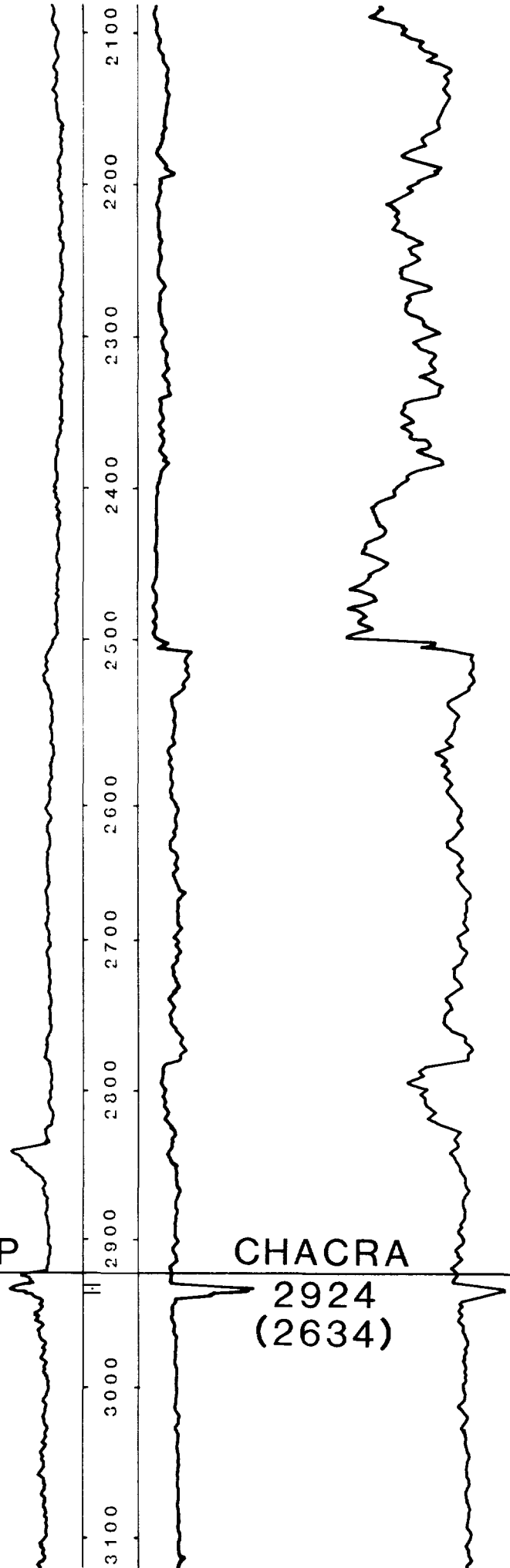

RP1-ASL

356

EL PASO NATURAL GAS COMPANY
CHICAGO, ILLINOIS 60601

RP1 DATE 09 15 79
ANAL DATE 09 17 79

Setty Ch.

MILK LACTATION
FELLY LACTATION

ANALYST 40017
SPEC 4000

TYPE CODE 00 SAMPLE DATE 09 15 79 APP. DATE 09 19 79 1 0000

C 3 2

00.01

0.000

H 2 5

00.00

0.000

N2

00.27

0.000

METHANE

00.07

0.000

ETHANE

07.10

1.900

PROPANE

01.01

0.900

ISO-BUTANE

00.47

0.104

NORM-BUTANE

00.02

0.208

ISO-PENTANE

00.23

0.064

NORM-PENTANE

00.10

0.065

HEXANE PLUS

00.41

0.179

TOTALS

100.00

3.534

SPECIFIC GRAVITY

1.04

MIXTURE HEATING VALUE

(BTU/CF @ 14.73 PSIA, 60 DEGREE F, HV) 1173

RATIO OF SPECIFIC HEATS

1.14

* NO TEST SECURED FOR DETERMINATION H2S CONCENT.

EXAMINER'S SIGNATURE
LABORATORY

LABORATORY NO. 9
DATE 6847

Submitted by
Receiving Date

ILLEGIBLE

... ..

Getty M.V.

[illegible]

100

— — — — —

•

72.4.4.

♂ ♀

U. S. A.

1111

01.23

00-42

۱۳۸۰

۱۳۳۳

100.00

0.754

174

1.27c

1. Control.

the 1990s, the number of people in the world who are under 15 years of age is expected to increase from 1.1 billion to 1.5 billion. The number of people aged 65 and over is expected to increase from 200 million to 400 million. The number of people aged 15 and over is expected to increase from 3.5 billion to 4.5 billion. The number of people aged 15 and over is expected to increase from 3.5 billion to 4.5 billion. The number of people aged 15 and over is expected to increase from 3.5 billion to 4.5 billion.

443.10.10

01/02/13 6847

Hearing Date

ILLEGIBLE

TENNECO OIL COMPANY
1980 BLOOMFIELD AREA DRILLING PROGRAM
DRILLING AND COMPLETION PROCEDURE
COMMINGLED MESA VERDE-CHACRA WELLS

DRILLING

1. Drill 12-1/4" hole to 250'.
2. Set 9-5/8" casing and cement to surface.
3. Drill 8-3/4" hole thru Chacra to \approx 3100'.
4. Set 7" csg and cement to surface.
5. Drill 6-1/4" hole thru Mesa Verde to \approx 4500'.
6. Run open hole logs over Mesa Verde and cased hole logs over Chacra.
7. Set 4-1/2" liner from 4500' to 2900'.
8. Cement liner in place.

;

COMPLETION

1. Drill out to plug back total depth.
2. Perforate Mesa Verde (\approx 50') with 2 shots per foot.
3. Acidize Mesa Verde with 1000 gals 15% HCL and ball sealers.
4. Frac Mesa Verde with 175,000# 20/40 sand in 1% KCl water.
5. Set retrievable bridge plug between Chacra and Mesa Verde.
6. Perforate Chacra (\approx 10') with 2 shots per foot.
7. Acidize Chacra with 500 gals 15% HCL and ball sealers.
8. Frac Chacra with 30,000# 10/20 sand in 70% quality foam.
9. Retrieve bridge plug.
10. Land tubing above Mesa Verde perforations.
11. Flow well to cleanup frac fluid.
12. Shut-in well for AOF test.

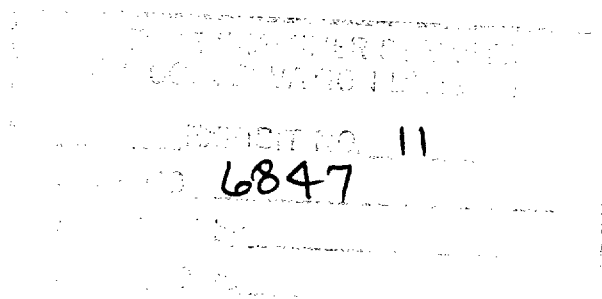

TENNECO OIL COMPANY
BLOOMFIELD AREA
T 29 N - R 10 & 11 W
SAN JUAN COUNTY, NEW MEXICO

MESAVERDE - CHACRA COMINGLED
WELLBORE SCHEMATIC

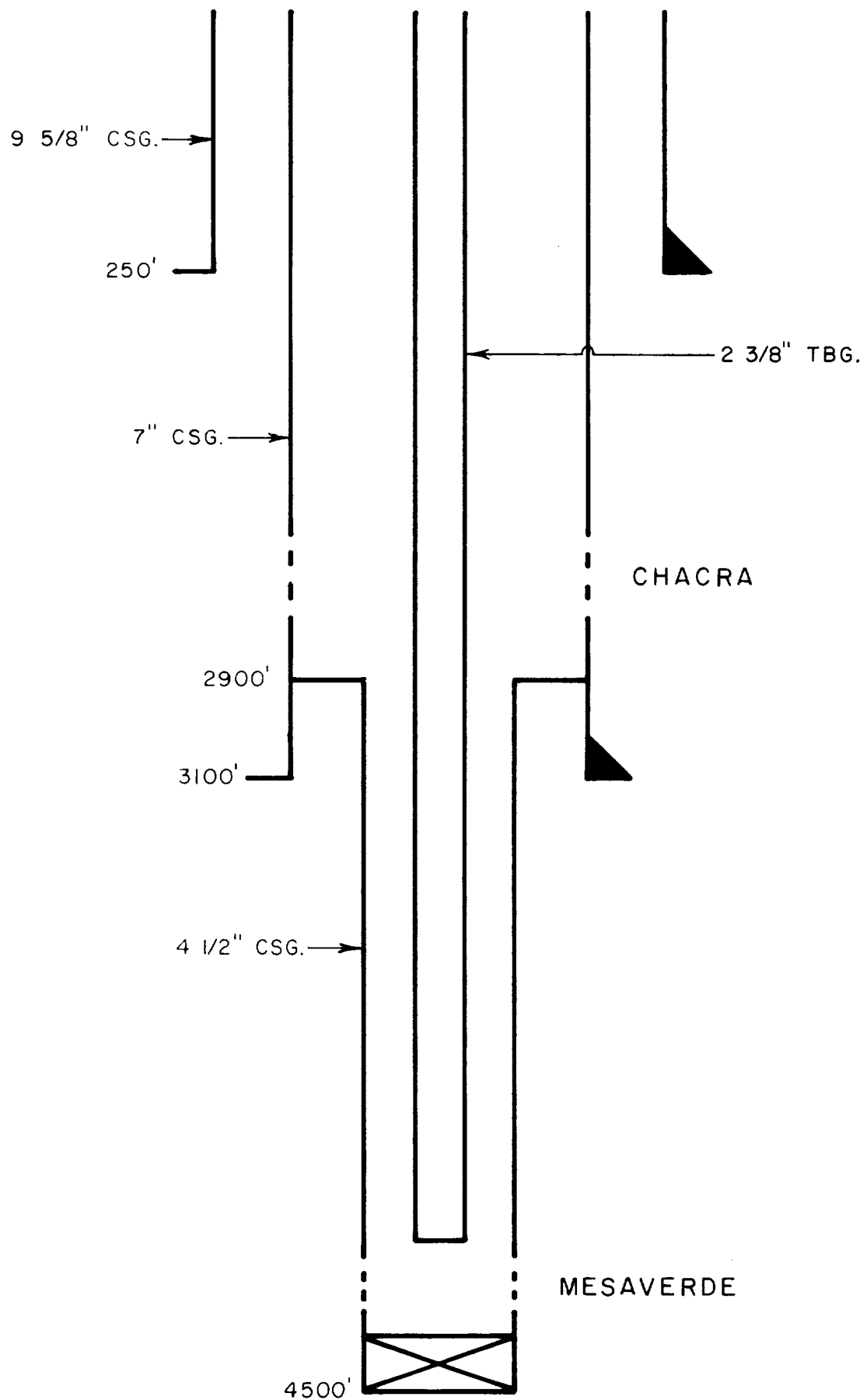

12
6847

TENNECO OIL COMPANY
1980 BLOOMFIELD AREA DRILLING PROGRAM
DRILLING AND COMPLETION PROCEDURE
DAKOTA DUALED WITH COMMINGLED CHACRA-MESA VERDE

DRILLING

1. Drill 12-1/4" hole to 250'.
2. Set 9-5/8" csg and cement to surface.
3. Drill 8-3/4" hole thru Mesa Verde to \approx 4500'.
4. Set 7" csg and cement to surface using 2 stage cement job with DV tool at 2950'
5. Drill 6-1/4" hole thru Dakota to \approx 6400'.
6. Run open hole logs over Dakota and cased hole log in 4-1/2" casing.
7. Set 4-1/2" liner from 6400' to 4300'.
8. Cement liner in place.

:

COMPLETION

1. Drill out to plug back total depth.
2. Perforate Dakota (\approx 50') with 2 shots per foot.
3. Acidize Dakota with 1500 gals 15% HCL and ball sealers.
4. Frac Dakota with 105,000# sand in 30# cross-linked gelled water.
5. Set Model "F" packer with expendable plug above Dakota.
6. Perforate Mesa Verde (\approx 50') with 2 shots per foot.
7. Acidize Mesa Verde with 1000 gals 15% HCL and ball sealers.
8. Frac Mesa Verde with 175,000# 20/40 sand in 1% KCl water.
9. Set retrievable bridge plug between Chacra and Mesa Verde.
10. Perforate Chacra (\approx 10') with 2 shots per foot.
11. Acidize Chacra with 500 gal 15% HCL and ball sealers.
12. Frac Chacra with 30,000# 10/20 sand in 70% quality foam.
13. Retrieve bridge plug.
14. Run in hole and land Dakota tubing string in Model "F" packer.
15. Run in hole and land Mesa Verde-Chacra tubing string above Mesa Verde.
16. Flow well to cleanup frac fluid.
17. Shut-in well for AOF test.

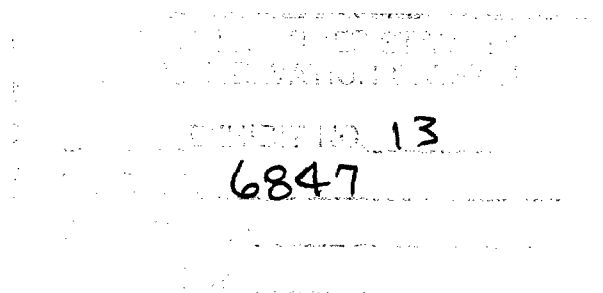

TENNECO OIL COMPANY
BLOOMFIELD AREA
T 29 N - R 10 & 11 W
SAN JUAN COUNTY, NEW MEXICO
DAKOTA DUAL WITH
MESAVERDE - CHACRA COMINGLED
WELLBORE SCHEMATIC

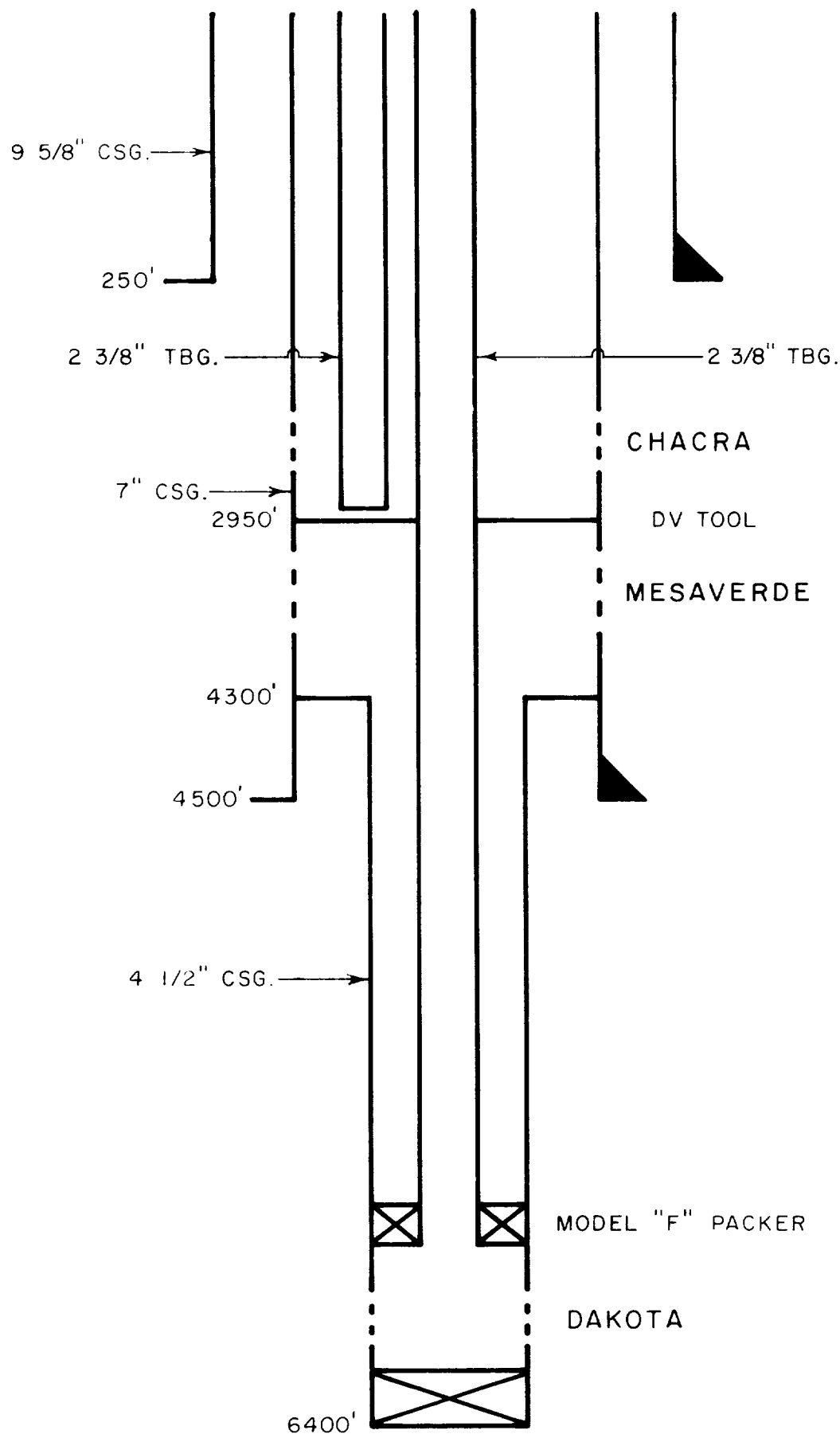

RECEIVED
JAN 14 1968
FBI - NEW YORK
6847

TENNECO OIL COMPANY
1980 BLOOMFIELD AREA DRILLING PROGRAM
ESTIMATED GROSS RESERVES

<u>ZONE</u>	<u>RESERVES (MMCF)</u>
Chacra	170
Mesa Verde	160
Dakota	1350

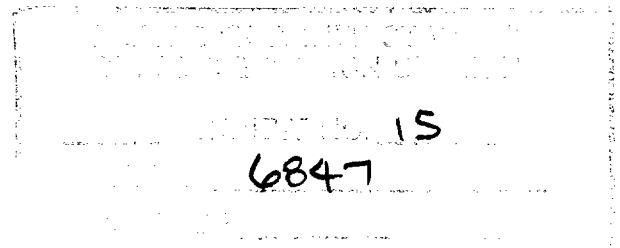

TENNECO OIL COMPANY
1980 BLOOMFIELD AREA DRILLING PROGRAM
ALTERNATIVE COST SUMMARY

<u>TYPE WELL</u>	<u>TOTAL COST</u> (\$M)
------------------	----------------------------

Single Completion

Mesa Verde	263
Dakota	347
Chacra	140

:

Duals Without Commingling

• Dakota-Mesa Verde	449
Mesa Verde-Chacra	349
Dakota-Chacra	401

Commingled Charca-Mesa Verde

Mesa Verde-Chacra	327
-------------------	-----

Three Zones With Two Commingled

Dakota Dualled with Chacra & Mesa Verde Commingled	461
---	-----

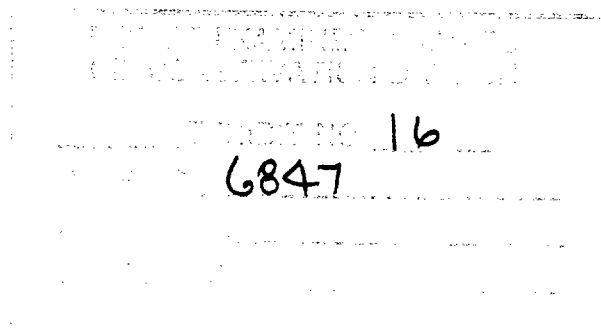

TENNECO OIL COMPANY
1980 BLOOMFIELD AREA DRILLING PROGRAM
WELLS WITH MESA VERDE AND CHACRA POTENTIAL
COST COMPARISON

I. Proposed Completion-Commingle Zones

Cost: \$327,000

:

II. Alternative Without Commingling

<u>Alternative</u>	<u>Cost</u>	<u>Cost Over Commingled Alternative (\$M)</u>
1. Dually Complete Chacra & Mesa Verde	349	22

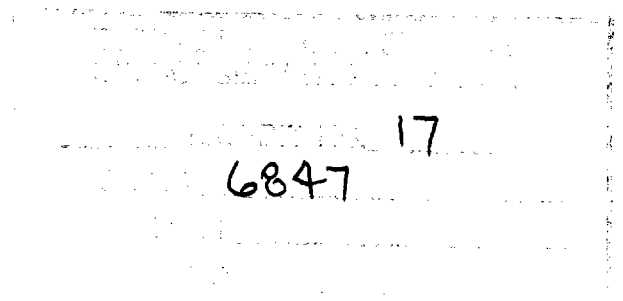

TENNECO OIL COMPANY
1980 BLOOMFIELD AREA DRILLING PROGRAM
ECONOMIC SUMMARY
MESA VERDE-CHACRA WELL

<u>TYPE WELL</u>	<u>AFTER TAX RATE OF RETURN (%)</u>	<u>DISCOUNTED PROFIT @10% (M\$)</u>	<u>RESERVES (MMCF)</u>	<u>PAYOUT (YEARS)</u>
<u>COMMINGLED</u>				
Mesa Verde-Chacra	22.6	80.9	360	3.2
<u>DUAL</u>				
Mesa Verde-Chacra	14.0	28.6	330	3.9

18
6847

TENNECO OIL COMPANY
1980 BLOOMFIELD AREA DRILLING PROGRAM
WELLS WITH CHACRA, MESA VERDE, AND DAKOTA POTENTIAL
COST COMPARISON

I. Proposed Completion-Dakota Dual With Mesa Verde & Charca Commingled

Cost: \$461,000

II. Alternatives Without Commingling

<u>Alternative</u>	<u>Cost</u>	<u>Cost Over Commingled Alternative (\$M)</u>
1. Drill 3 Single Completions	750	289
2. Drill 1 Dual MV-Dakota	449	-
Drill 1 Single Chacra	<u>140</u>	-
Total 2 Wells	589	128
3. Drill 1 Dual MV-Chacra	349	-
Drill 1 Single Dakota	<u>347</u>	-
Total 2 Wells	696	235
4. Drill 1 Dual Dakota-Chacra	401	-
Drill 1 Single Mesa Verde	<u>263</u>	-
Total 2 Wells	664	203

19
6847

STATE OF NEW MEXICO
DEPARTMENT OF ENERGY AND MINERALS
OIL CONSERVATION DIVISION

MARCH 26, 1980

EXHIBITS

TENNECO OIL COMPANY
1980 BLOOMFIELD AREA DRILLING PROGRAM
WELL SUMMARY

CHACRA-MESA VERDE-DAKOTA WELLS

<u>WELL</u>	<u>LOCATION</u>
1. Marquis G. Eaton A1E	NE-25-29-11
2. Elvin J. Payne A1E	SW-19-29-10
3. Sullivan Frame Gas A1E	NE-30-29-10
4. Sullivan Gas A1E	SW-25-29-11
5. Valdez Gas A1E	NE-24-29-11

CHACRA-MESA VERDE WELLS

<u>WELL</u>	<u>LOCATION</u>
1. Bunce Com 1	NW-29-29-10
2. Eaton Com B-1	SW-25-29-11
3. Bruce Sullivan Com B-1	NW-25-29-11
4. Sullivan Frame Com B-1	NW-30-29-10
5. Valdez Com B-1	SE-24-29-11

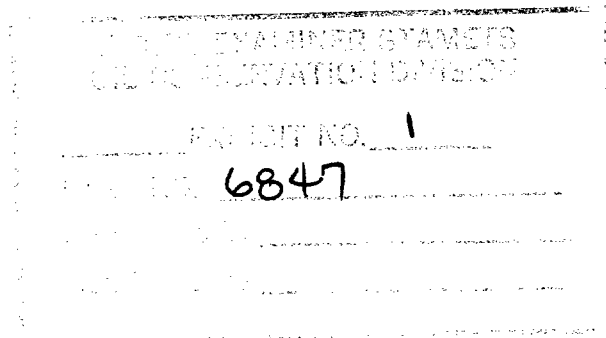

TYPE LOG
CHACRA FM.

GETTY OIL COMPANY
HANLEY B#1
SW/4 SEC. 18, T29N-R10W
SAN JUAN COUNTY, NEW MEXICO

IPF: 791 MCFD
48/64 CK
PERF: 2932-38
SWFR 21,000 GALS.
30,000 LBS. SAND
TP 46, CP 290, GTY 60

*51CP
1012*

DATUM

TOP

CHACRA

2924
(2634)

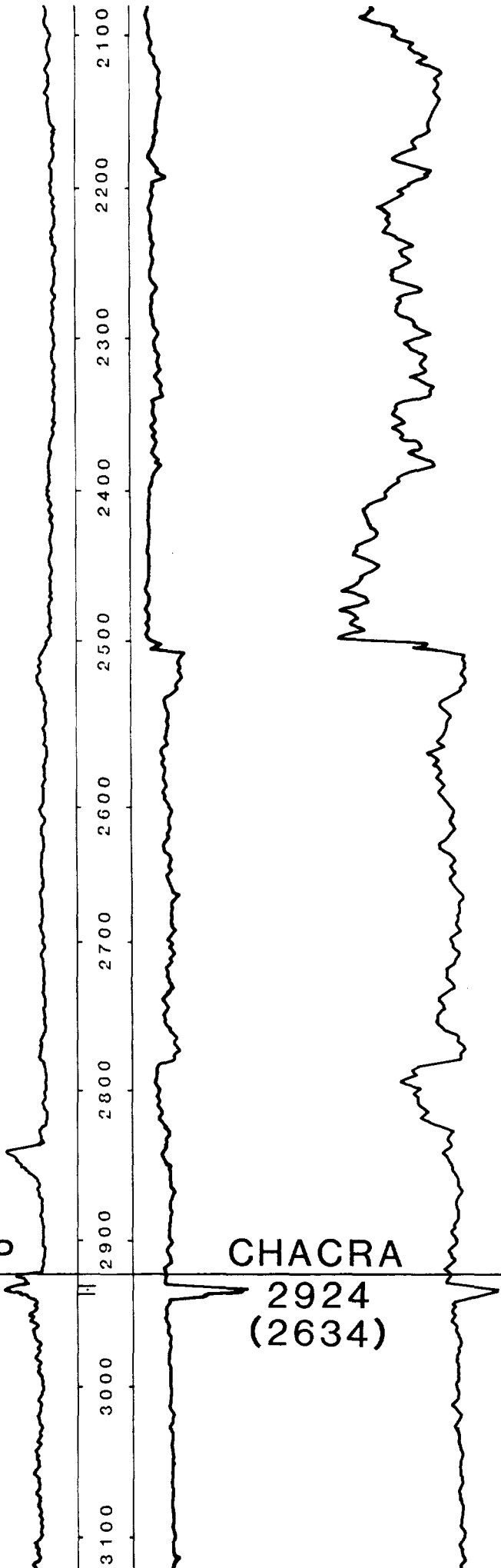
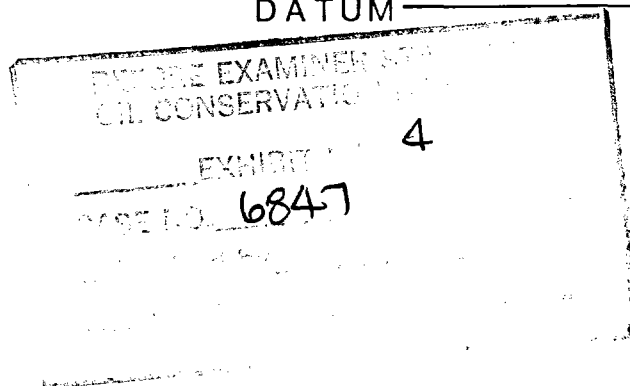

TYPE LOG
MESAVERDE FM.

GETTY OIL COMPANY
HANLEY B#1
SW/4 SEC. 18, T29N-R10W
SAN JUAN CO., NEW MEXICO

BEFORE EXAMINER STATES
OIL CONSERVATION DIVISION

EXHIBIT NO. 6

CASE NO. 6847

SUBMITTED BY

RECORDING DATE

IPF: 2 BCPD 2117 MCFD
PERF: 3764-69, 3787-97,
3804-10, 3818-22,
3842-52, 3861-76,
3924-28, 4017-29,
4126-32, 4202-17,
4243-44, 4344-49

SWFR 3764 3876
73,000 GALS.
75,000 LBS. SAND

SWFR 3924-4349
48,310 GALS.
55,000 LBS. SAND

TP 148 CPO, GTY 60

DATUM

TOP

TOP

TOP

CLIFF HOUSE

3396 (2162)

MENEFEE

3526 (2032)

POINT
LOOKOUT

4124 (1434)

3400
3500
3600
3700
3800
3900
4000
4100
4200
4300

TENNECO OIL COMPANY
BLOOMFIELD AREA
MESAVERDE PRODUCTION HISTORY

— — —	Houck	B #1	NE/4 Sec. 13, T29N—R11W
- - - -	Hanley	A #1	NW/4 Sec. 18, T29N—R10W
— — —	Hanley	B #1	SW/4 Sec. 18, T29N—R10W
- - - -	Bunce	A #1	NE/4 Sec. 19, T29N—R10W

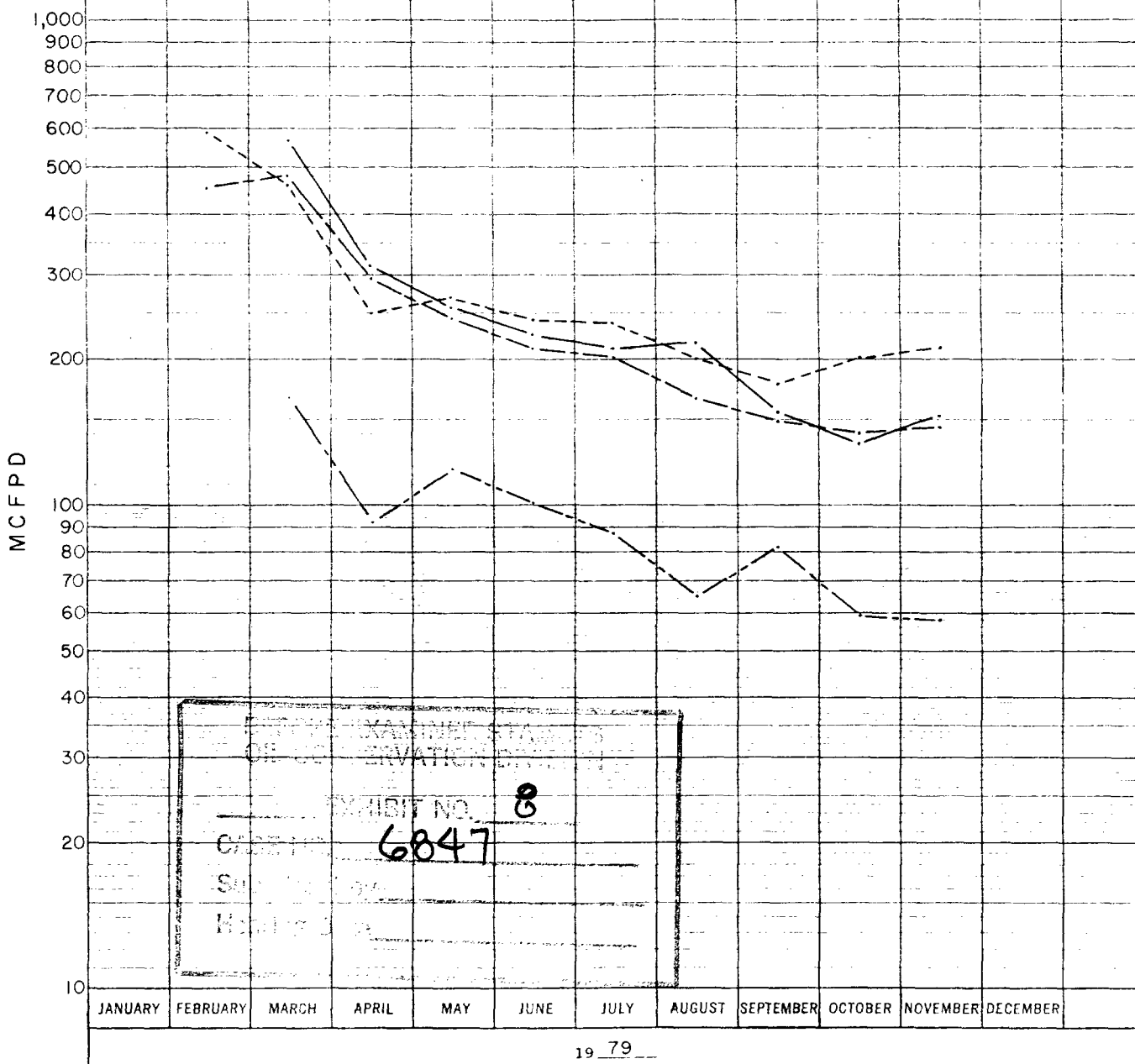

RPT-ASL

376

EL PASO NATURAL GAS COMPANY
CHROMATOGRAPHIC ANALYSIS REPORT

RPT DATE 09 15 79

ANAL DATE 09 17 79

METER CALIBRATION

FULLY CALIB

ANALYST J. J. JONES

SPEC. NO. 4000

TYPE CODE	SAMPLE DATE	REF. DATE	QTY. (LBS)	SCALE	NES GRAVITY	LOCATION
00	09 15 79	09 19 79	1	0000*	4 1 79	

C 3 2

00.21

0.000

H 2 S

00.00*

0.000

N2

00.27

0.000

METHANE

00.37

0.000

ETHANE

07.10

1.905

PROPANE

00.61

0.935

ISOBUTANE

00.47

0.154

NORM-BUTANE

00.62

0.258

ISOPENTANE

00.23

0.064

NORM-PENTANE

00.18

0.065

HEXANE PLUS

00.41

0.177

TOTALS

100.00

3.584

SPECIFIC GRAVITY

1.264

MIXTURE HEATING VALUE

(BTU/CF @ 14.73 PSIA, 60 DEGREES F) 1173

RATIO OF SPECIFIC HEATS

1.19

* NO TEST SECURED FOR DETERMINATION NES CORRECT.

CHROME EXAMINER STAMPS
OIL CONSERVATION DIVISION

EXHIBIT NO. 9

CASE NO. 6847

Submitted by

Hearing Date

ILLEGIBLE

KPT-143L

Setty M.V.

APR DATE 05 24 75
ANAL DATE 05 11 75

TYPE CODE SAMPLE DATE ANAL DATE ANAL DATE ANAL DATE ANAL DATE ANAL DATE ANAL DATE

	100.00	1.731
C O 2	0.00	0.000
H 2 O	00.00	0.000
N 2	00.00	0.000
METHANE	79.80	0.000
ETHANE	10.00	0.000
PROPANE	00.00	1.010
ISO-BUTANE	11.11	0.260
NORM-BUTANE	01.00	0.300
ISO-PENTANE	00.00	0.180
NORM-PENTANE	00.00	0.100
HEXANE PLUS	00.00	0.227
TOTALS	100.00	1.708

SPECIFIC GRAVITY 1.731

MIXTURE HEATING VALUE
(BTU/GF @ 24.73 PSIA, 60 DEGREES, DRY) 1.74

RATIO OF SPECIFIC HEATS
• NO TEST SECURED FOR DETERMINATION

EXAMINER SP...
INVESTIGATION DIVISION

EXHIBIT NO. 10
CASE NO. 6847
SUBMITTED BY
ANALYST DATE

ILLEGIBLE

TENNECO OIL COMPANY
1980 BLOOMFIELD AREA DRILLING PROGRAM
DRILLING AND COMPLETION PROCEDURE
COMMINGLED MESA VERDE-CHACRA WELLS

DRILLING

1. Drill 12-1/4" hole to 250'.
2. Set 9-5/8" casing and cement to surface.
3. Drill 8-3/4" hole thru Chacra to \approx 3100'.
4. Set 7" csg and cement to surface.
5. Drill 6-1/4" hole thru Mesa Verde to \approx 4500'.
6. Run open hole logs over Mesa Verde and cased hole logs over Chacra.
7. Set 4-1/2" liner from 4500' to 2900'.
8. Cement liner in place.

;

COMPLETION

1. Drill out to plug back total depth.
2. Perforate Mesa Verde (\approx 50') with 2 shots per foot.
3. Acidize Mesa Verde with 1000 gals 15% HCL and ball sealers.
4. Frac Mesa Verde with 175,000# 20/40 sand in 1% KCl water.
5. Set retrievable bridge plug between Chacra and Mesa Verde.
6. Perforate Chacra (\approx 10') with 2 shots per foot.
7. Acidize Chacra with 500 gals 15% HCL and ball sealers.
8. Frac Chacra with 30,000# 10/20 sand in 70% quality foam.
9. Retrieve bridge plug.
10. Land tubing above Mesa Verde perforations.
11. Flow well to cleanup frac fluid.
12. Shut-in well for AOF test.

EXAMINER'S SIGNATURE
OIL CONSERVATION DIVISION
EXHIBIT NO. 11
6847

TENNECO OIL COMPANY
BLOOMFIELD AREA
T 29 N - R 10 & 11 W
SAN JUAN COUNTY, NEW MEXICO

MESAVERDE - CHACRA COMINGLED
WELLBORE SCHEMATIC

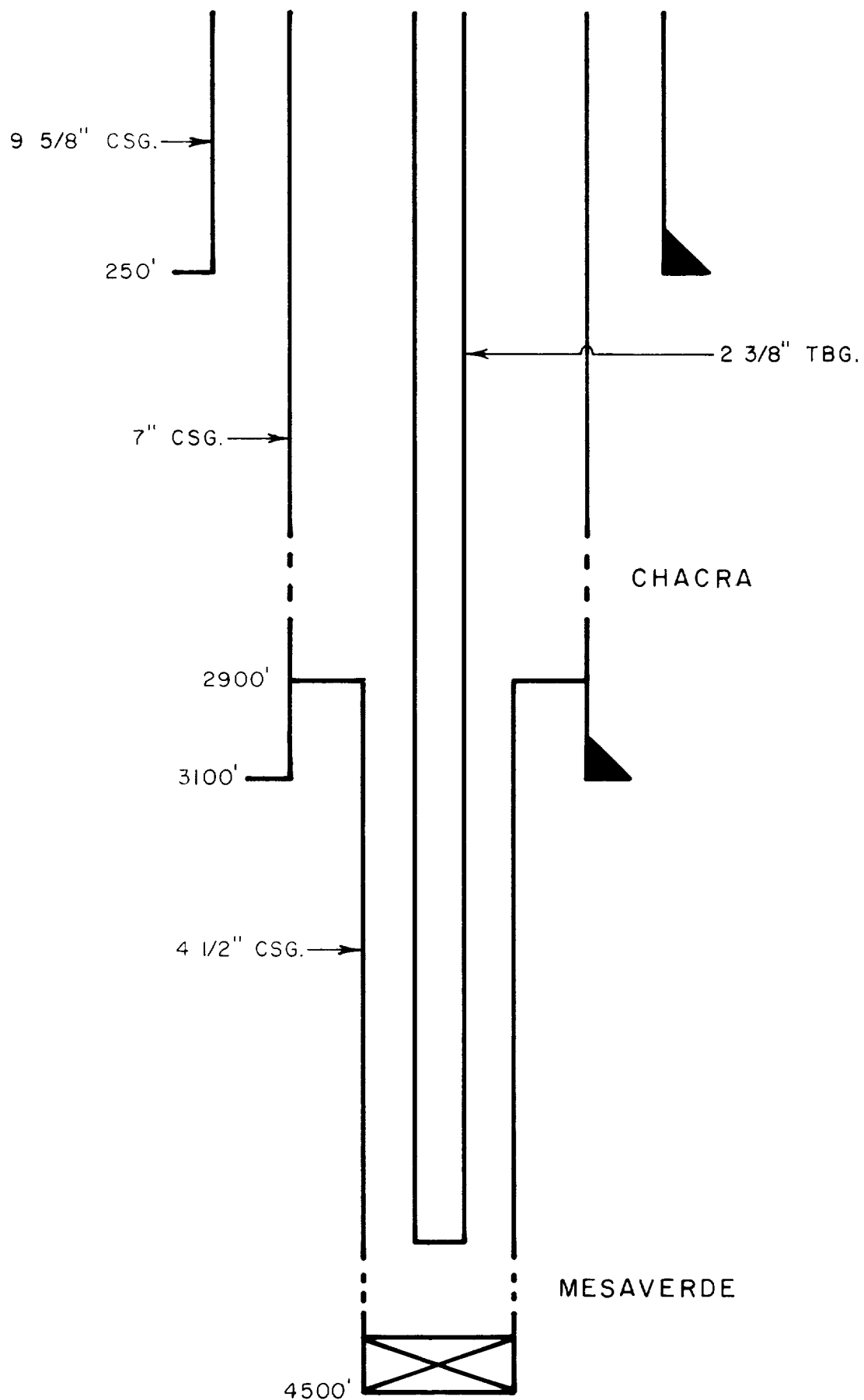

ON THE LARVAE OF THE
ON THE LARVAE OF THE

RIGHT NO. 12

6847

TENNECO OIL COMPANY
1980 BLOOMFIELD AREA DRILLING PROGRAM
DRILLING AND COMPLETION PROCEDURE
DAKOTA DUALED WITH COMMINGLED CHACRA-MESA VERDE

DRILLING

1. Drill 12-1/4" hole to 250'.
2. Set 9-5/8" csg and cement to surface.
3. Drill 8-3/4" hole thru Mesa Verde to \approx 4500'.
4. Set 7" csg and cement to surface using 2 stage cement job with DV tool at 2950'
5. Drill 6-1/4" hole thru Dakota to \approx 6400'.
6. Run open hole logs over Dakota and cased hole log in 4-1/2" casing.
7. Set 4-1/2" liner from 6400' to 4300'.
8. Cement liner in place.

:

COMPLETION

1. Drill out to plug back total depth.
2. Perforate Dakota (\approx 50') with 2 shots per foot.
3. Acidize Dakota with 1500 gals 15% HCL and ball sealers.
4. Frac Dakota with 105,000# sand in 30# cross-linked gelled water.
5. Set Model "F" packer with expendable plug above Dakota.
6. Perforate Mesa Verde (\approx 50') with 2 shots per foot.
7. Acidize Mesa Verde with 1000 gals 15% HCL and ball sealers.
8. Frac Mesa Verde with 175,000# 20/40 sand in 1% KCl water.
9. Set retrievable bridge plug between Chacra and Mesa Verde.
10. Perforate Chacra (\approx 10') with 2 shots per foot.
11. Acidize Chacra with 500 gal 15% HCL and ball sealers.
12. Frac Chacra with 30,000# 10/20 sand in 70% quality foam.
13. Retrieve bridge plug.
14. Run in hole and land Dakota tubing string in Model "F" packer.
15. Run in hole and land Mesa Verde-Chacra tubing string above Mesa Verde.
16. Flow well to cleanup frac fluid.
17. Shut-in well for AOF test.

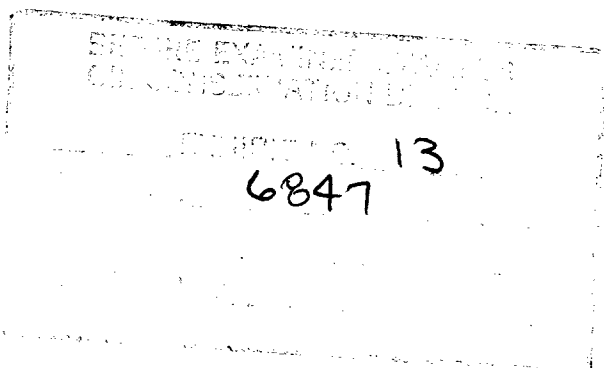

TENNECO OIL COMPANY
BLOOMFIELD AREA
T 29 N - R 10 & 11 W
SAN JUAN COUNTY, NEW MEXICO

**DAKOTA DUAL WITH
MESAVERDE - CHACRA COMINGLED
WELLBORE SCHEMATIC**

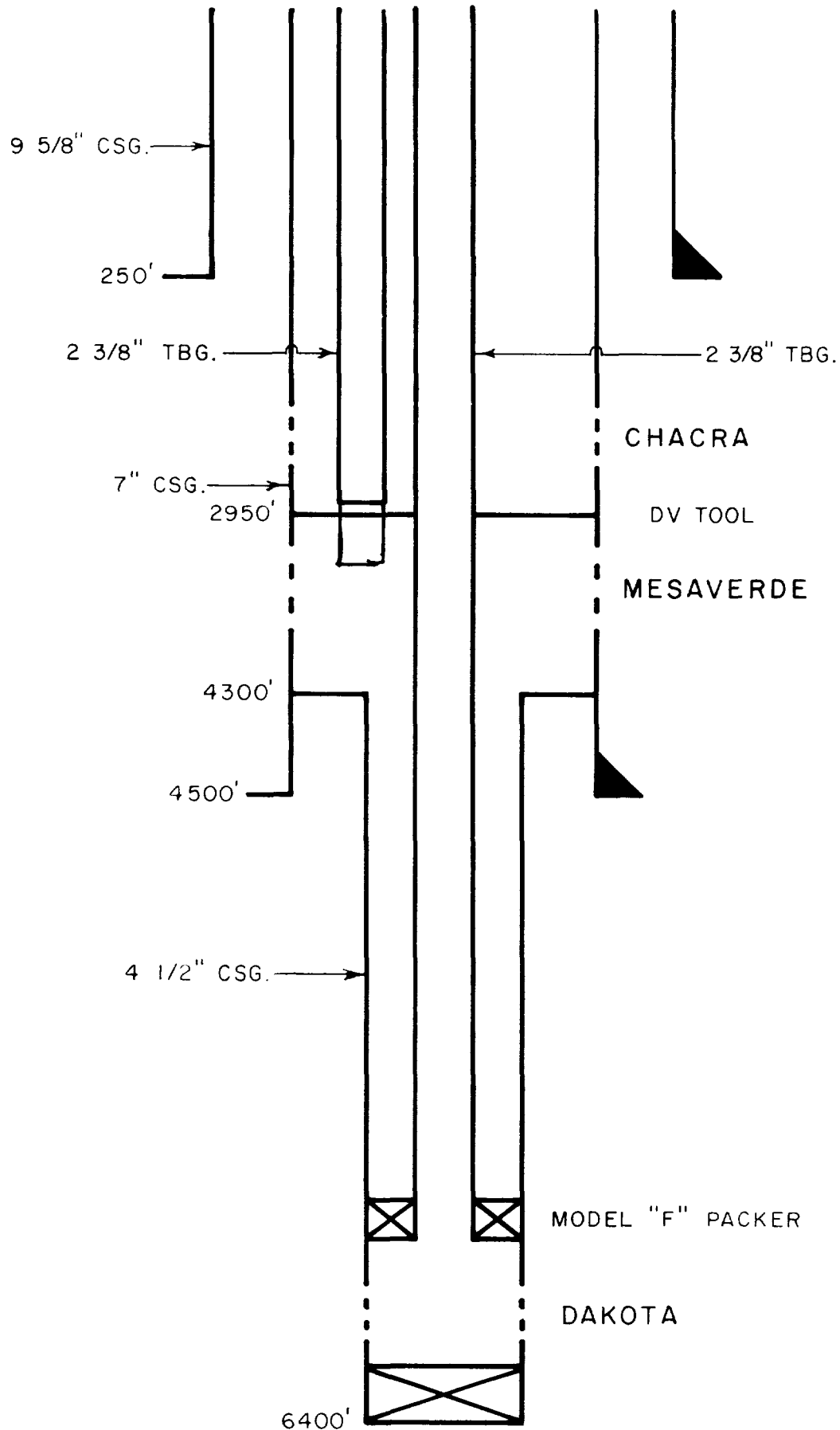

6847

14

TENNECO OIL COMPANY
1980 BLOOMFIELD AREA DRILLING PROGRAM
ESTIMATED GROSS RESERVES

<u>ZONE</u>	<u>RESERVES (MMCF)</u>
Chacra	170
Mesa Verde	160
Dakota	1350

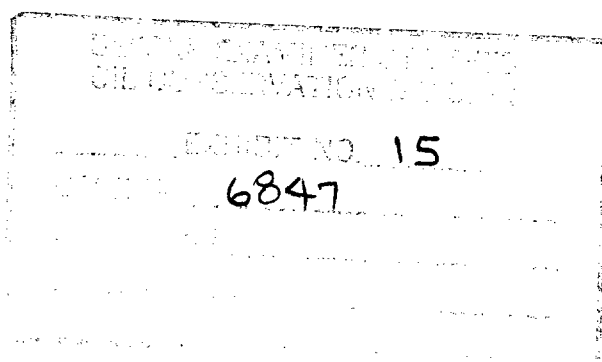

TENNECO OIL COMPANY
1980 BLOOMFIELD AREA DRILLING PROGRAM
ALTERNATIVE COST SUMMARY

<u>TYPE WELL</u>	<u>TOTAL COST</u> (\$M)
<u>Single Completion</u>	
Mesa Verde	263
Dakota	347
Chacra	140
	<u>750</u>
<u>Duals Without Commingling</u>	
Dakota-Mesa Verde	449
Mesa Verde-Chacra	349
Dakota-Chacra	401
<u>Commingled Charca-Mesa Verde</u>	
Mesa Verde-Chacra	327
<u>Three Zones With Two Commingled</u>	
Dakota Dualled with Chacra & Mesa Verde Commingled	461

6847

16

TENNECO OIL COMPANY
1980 FLOOMFIELD AREA DRILLING PROGRAM
WELLS WITH MESA VERDE AND CHACRA POTENTIAL
COST COMPARISON

I. Proposed Completion-Commingle Zones

Cost: \$327,000

II. Alternative Without Commingling

<u>Alternative</u>	<u>Cost</u>	<u>Cost Over Commingled Alternative (\$M)</u>
1. Dually Complete Chacra & Mesa Verde	349	22

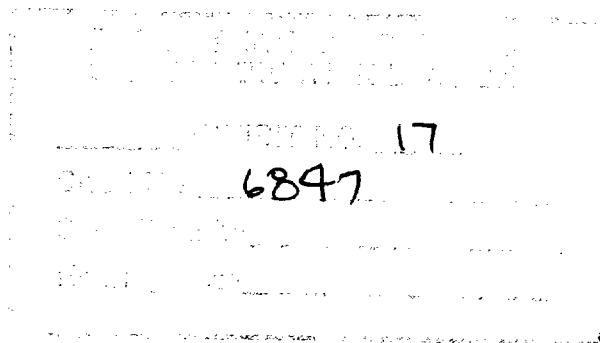

TENNECO OIL COMPANY
1980 BLOOMFIELD AREA DRILLING PROGRAM
ECONOMIC SUMMARY
MESA VERDE-CHACRA WELL

18

6847

TYPE WELL

AFTER TAX RATE OF RETURN (%)	DISCOUNTED PROFIT @10% (M\$)	RESERVES (MMCF)	PAYOUT (YEARS)
------------------------------------	------------------------------------	--------------------	-------------------

COMMINGLED

Mesa Verde-Chacra	22.6	80.9	360	3.2
-------------------	------	------	-----	-----

DUAL

Mesa Verde-Chacra	14.0	28.6	330	3.9
-------------------	------	------	-----	-----

TENNECO OIL COMPANY
1980 BLOOMFIELD AREA DRILLING PROGRAM
WELLS WITH CHACRA, MESA VERDE, AND DAKOTA POTENTIAL
COST COMPARISON

I. Proposed Completion-Dakota Dual With Mesa Verde & Charca Commingled

Cost: \$461,000

II. Alternatives Without Commingling

<u>Alternative</u>	<u>Cost</u>	<u>Cost Over Commingled Alternative (\$M)</u>
1. Drill 3 Single Completions	750	289
2. Drill 1 Dual MV-Dakota	449	-
Drill 1 Single Chacra	<u>140</u>	-
Total 2 Wells	589	128
3. Drill 1 Dual MV-Chacra	349	-
Drill 1 Single Dakota	<u>347</u>	-
Total 2 Wells	696	235
4. Drill 1 Dual Dakota-Chacra	401	-
Drill 1 Single Mesa Verde	<u>263</u>	-
Total 2 Wells	664	203

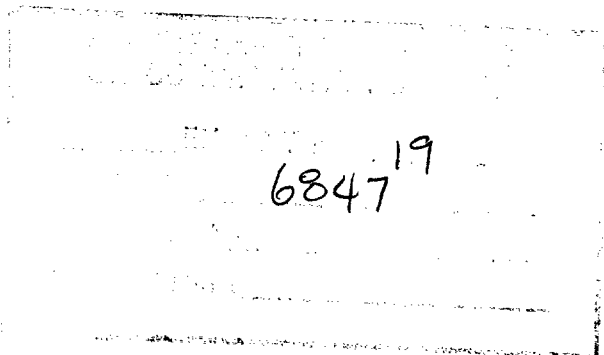

Dockets Nos. 9-80 and 10-80 are tentatively set for April 9 and 23, 1980. Applications for hearing must be filed at least 22 days in advance of hearing date.

DOCKET: EXAMINER HEARING - WEDNESDAY - MARCH 26, 1980

9 A.M. - OIL CONSERVATION DIVISION CONFERENCE ROOM,
STATE LAND OFFICE BUILDING, SANTA FE, NEW MEXICO

The following cases will be heard before Richard L. Stamets, Examiner, or Daniel S. Nutter, Alternate Examiner:

- CASE 6838: Application of Amax Chemical Corporation for the amendment of Order No. R-111-A, Eddy County, New Mexico. Applicant, in the above-styled cause, seeks the amendment of Order No. R-111-A to extend the boundaries of the Potash-Oil Area by the inclusion of certain lands in Sections 11, 12, and 13, Township 19 South, Range 30 East, and Sections 7 and 18, Township 19 South, Range 31 East.
- CASE 6839: Application of Kimbell Oil Company for downhole commingling, Rio Arriba County, New Mexico. Applicant, in the above-styled cause, seeks approval for the downhole commingling of Otero-Chacra and South Blanco-Pictured Cliffs production in the wellbore of its Salazar Well No. 4-26 to be located in Unit D of Section 26, Township 25 North, Range 6 West.
- CASE 6840: Application of Union Texas Petroleum for downhole commingling, San Juan County, New Mexico. Applicant, in the above-styled cause, seeks approval for the downhole commingling of Fruitland and Pictured Cliffs production in the wellbore of its Johnston Federal Well No. 11Y located in Unit N of Section 7, Township 31 North, Range 9 West.
- CASE 6841: Application of CIG Exploration, Inc. for two non-standard gas proration units, Eddy County, New Mexico. Applicant, in the above-styled cause, seeks approval of two non-standard gas proration units in Township 16 South, Range 28 East, the first being 219.6 acres comprising Lots 1 thru 8 of Section 1 and the second being 219.92 acres comprising Lots 1 thru 8 of Section 2, for the Wolfcamp, Pennsylvanian, and Mississippian formations, each unit to be dedicated to a well to be drilled at a standard location thereon.
- CASE 6842: Application of ARCO Oil and Gas Company for an unorthodox gas well location, simultaneous dedication, and approval of infill drilling, Lea County, New Mexico. Applicant, in the above-styled cause, seeks approval for the unorthodox location of its W. C. Roach Well No. 6, 660 feet from the North line and 1980 feet from the West line of Section 21, Township 20 South, Range 37 East, Eumont Gas Pool, to be simultaneously dedicated with its W. C. Roach Well No. 1 in Unit D to the W/2 of said Section 21. Also sought are findings that the proposed well is necessary to effectively and efficiently drain that portion of the proration unit which cannot be so drained by the existing unit well.
- CASE 6843: Application of Yates Petroleum Corporation for two compulsory poolings, Eddy County, New Mexico. Applicant, in the above-styled cause, seeks an order pooling all mineral interests in the Yaso formation underlying two 40-acre proration units, the first being the SE/4 SE/4 and the second being the SW/4 SE/4 of Section 6, Township 19 South, Range 25 East, Penasco Draw Field, each unit to be dedicated to a well to be drilled at a standard location thereon. Also to be considered will be the cost of drilling and completing said wells and the allocation of the cost thereof as well as actual operating costs and charges for supervision. Also to be considered will be the designation of applicant as operator of the wells and a charge for risk involved in drilling said wells.
- CASE 6844: Application of Arrowhead Oil Corporation for two exceptions to Order No. R-111-A and an unorthodox well location, Eddy County, New Mexico. Applicant, in the above-styled cause, seeks an exception to the casing-cementing rules of Order No. R-111-A to complete its Creek Federal Well No. 3 at an unorthodox location 250 feet from the North line and 2350 feet from the East line and its Creek Federal Well No. 4 to be drilled in Unit G, both in Section 23, Township 18 South, Range 30 East, by setting surface casing at a depth of approximately 600 feet and production casing at total depth. The production casing would have cement circulated back to the potash zone in the salt section.
- CASE 6845: Application of Marathon Oil Company for an unorthodox gas well location, Eddy County, New Mexico. Applicant, in the above-styled cause, seeks approval for the unorthodox location of a well to be drilled 800 feet from the North line and 200 feet from the East line of Section 30, Township 21 South, Range 23 East, Indian Basin-Upper Pennsylvanian Gas Pool, all of Section 30 or that portion thereof which may be reasonably presumed productive of gas from said pool to be dedicated to the well.

CASE 6846: Application of Doyle Hartman for two compulsory poolings, two non-standard gas proration units, and two unorthodox well locations, Lea County, New Mexico. Applicant, in the above-styled cause, seeks an order pooling all mineral interests in the Eumont Gas Pool underlying two 80-acre non-standard gas proration units, the first being the S/2 NE/4 of Section 13, Township 21 South, Range 36 East, to be dedicated to a well to be drilled at an unorthodox location 1650 feet from the North line and 2310 feet from the East line of said Section 13, and the second being the N/2 NE/4 of said Section 13 to be dedicated to a well to be drilled at an unorthodox location 1330 feet from the North line and 2310 feet from the East line of said Section 13. Also to be considered will be the cost of drilling and completing said wells and the allocation of the cost thereof as well as actual operating costs and charges for supervision. Also to be considered will be the designation of applicant as operator of the wells and a charge for risk involved in drilling said wells.

CASE 6834: (Continued and Readvertised)

Application of Conoco Inc. for a dual completion and unorthodox well location, Lea County, New Mexico. Applicant, in the above-styled cause, seeks approval for the dual completion (conventional) of its SEMU Burger Well No. 107 at an unorthodox location 2615 feet from the South and East lines of Section 19, Township 20 South, Range 38 East, to produce oil from the Blinebry Oil and Gas and Drinkard Pools.

CASE 6837: (Continued from March 12, 1980, Examiner Hearing)

Application of Curtis Little for compulsory pooling, Rio Arriba County, New Mexico. Applicant, in the above-styled cause, seeks an order pooling all mineral interests in the Dakota formation underlying the W/2 of Section 7, Township 25 North, Range 3 West, to be dedicated to a well to be drilled at a standard location thereon. Also to be considered will be the cost of drilling and completing said well and the allocation of the cost thereof as well as actual operating costs and charges for supervision. Also to be considered will be the designation of applicant as operator of the well and a charge for risk involved in drilling said well.

CASE 6847: Application of Tenneco Oil Company for dual completions and downhole commingling, San Juan County, New Mexico. Applicant, in the above-styled cause, seeks authority to dually complete, in such a manner as to produce gas from the Dakota formation and commingled Chacra and Mesaverde production through parallel strings of tubing, ten proposed wells to be located as follows: in Township 29 North, Range 10 West: Unit C, Section 19; Unit N, Section 19; Unit A, Section 30; and Unit D, Section 30; in Township 29 North, Range 11 West: Unit G, Section 24; Unit O, Section 24; Unit A, Section 25; Unit D, Section 25; Unit M, Section 25; and Unit P, Section 25.

CASE 6818: (Continued from March 12, 1980, Examiner Hearing)

Application of Tenneco Oil Company for an NGPA determination, Eddy County, New Mexico. Applicant, in the above-styled cause, seeks a new onshore reservoir determination for its State HL 11 Well No. 1 located in Unit N of Section 11, Township 19 South, Range 29 East.

CASE 6849: (This is the same matter as was previously designated Case No. 6813.)

Application of Petroleum Development Corporation to amend Order No. R-6196, Eddy County, New Mexico. Applicant, in the above-styled cause, seeks to amend Order No. R-6196 which authorized re-entry of a well at an unorthodox location in the Lusk-Morrow Gas Pool to be dedicated to the N/2 of Section 13, Township 19 South, Range 31 East. Applicant now seeks approval for a new revised location 750 feet from the North line and 660 feet from the West line of said Section 13.

CASE 6848: Application of Petroleum Development Corporation for pool contraction and creation, Lea County, New Mexico. Applicant, in the above-styled cause, seeks the contraction of the Querecho Plains-Bone Spring Pool to comprise the Upper Bone Spring formation only, from 8390 feet to 8680 feet on the log of its McKay West Federal Well No. 1 located in Unit F of Section 34, Township 18 South, Range 32 East, and the creation of the Querecho Plains-Lower Bone Spring Pool to comprise said formation from 8680 feet to the base of the Bone Spring underlying the NW/4 of said Section 34.

CASE 6826: (Continued from March 12, 1980, Examiner Hearing)

Application of Tahoe Oil and Cattle Company for compulsory pooling, Lea County, New Mexico. Applicant, in the above-styled cause, seeks an order pooling all mineral interests in the Penrose Skelly Pool underlying the SE/4 SE/4 of Section 25, Township 21 South, Range 36 East, to be dedicated to its Bromlee Well No. 1 located thereon. Also to be considered will be the cost of recompleting said well and the allocation of the cost thereof as well as actual operating costs and charges for supervision. Also to be considered will be the designation of applicant as operator of the well and a charge for risk involved in recompleting said well.

KELLAHIN and KELLAHIN

Attorneys at Law

500 Don Gaspar Avenue

Post Office Box 1769

Santa Fe, New Mexico 87501

Jason Kellahin
W. Thomas Kellahin
Karen Aubrey

Telephone 982-4285
Area Code 505

March 3, 1980

Mr. Joe Ramey
Oil Conservation Division
P. O. Box 2088
Santa Fe, New Mexico

re: Tenneco Oil Company
Application for Dual Completion
and Downhole Commingling,
San Juan County, New Mexico

Dear Joe:

Please set the enclosed application for hearing on
March 26, 1980.

Very truly yours,

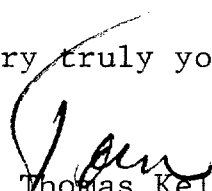

W. Thomas Kellahin

encl.

cc: Mr. Millard Carr (Tenneco - Denver)

WTK:msf

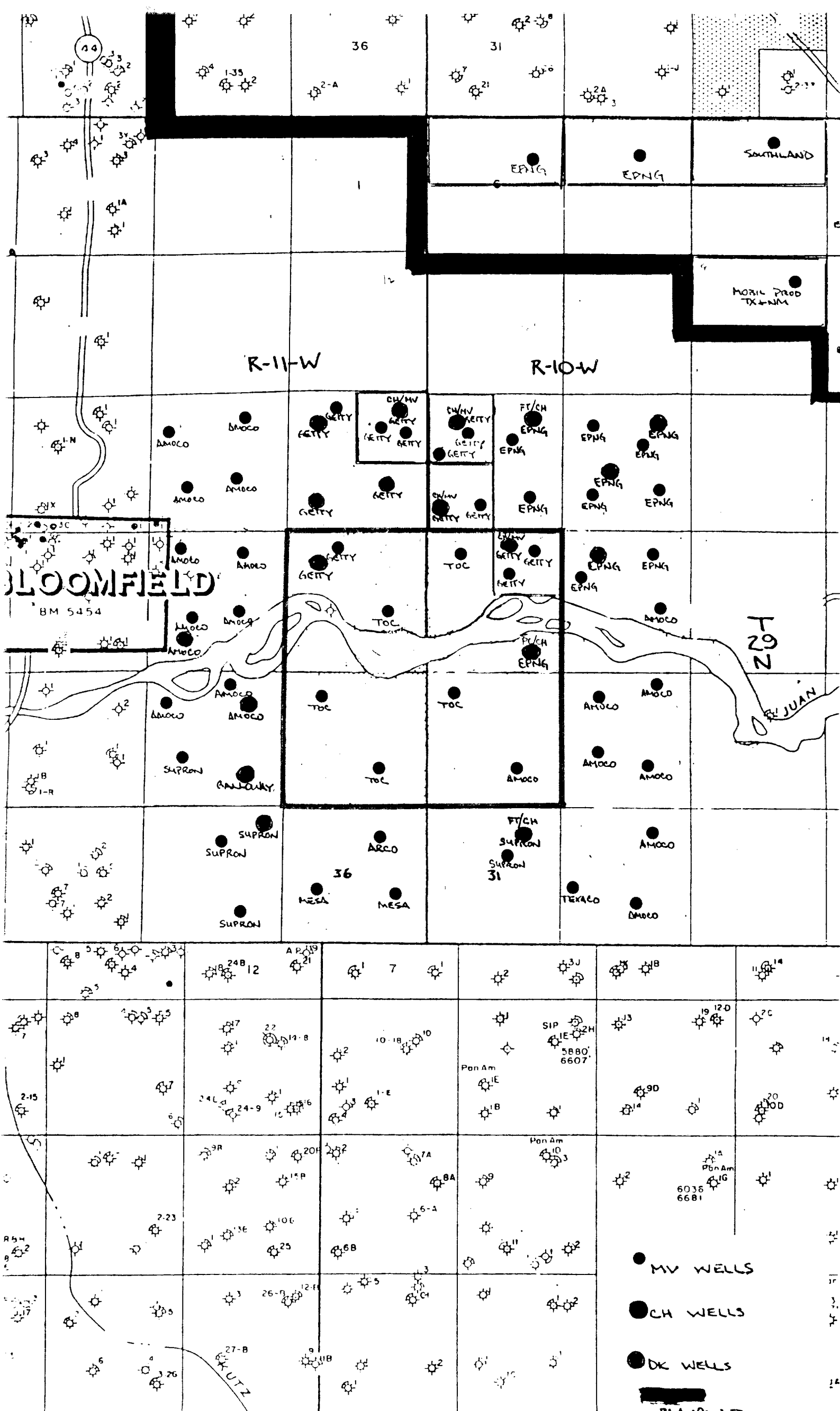
Case 6847



All distances must be from the outer boundaries of the Section.

Operator TENNECO OIL COMPANY			Lease BUNCE COM			Well No. 1		
Unit Letter C	Section 19	Township 29N	Range 10W	County San Juan				
Actual Footage Location of Well: 990 feet from the North line and 1650 feet from the West line								
Ground Level Elev. 5521	Producing Formation		Pool			Dedicated Acreage: Acres		

1. Outline the acreage dedicated to the subject well by colored pencil or hatchure marks on the plat below.
2. If more than one lease is dedicated to the well, outline each and identify the ownership thereof (both as to working interest and royalty).
3. If more than one lease of different ownership is dedicated to the well, have the interests of all owners been consolidated by communitization, unitization, force-pooling, etc?

☐ Yes ☐ No If answer is "yes," type of consolidation _____

If answer is "no," list the owners and tract descriptions which have actually been consolidated. (Use reverse side of this form if necessary.) _____

No allowable will be assigned to the well until all interests have been consolidated (by communitization, unitization, forced-pooling, or otherwise) or until a non-standard unit, eliminating such interests, has been approved by the Commission.

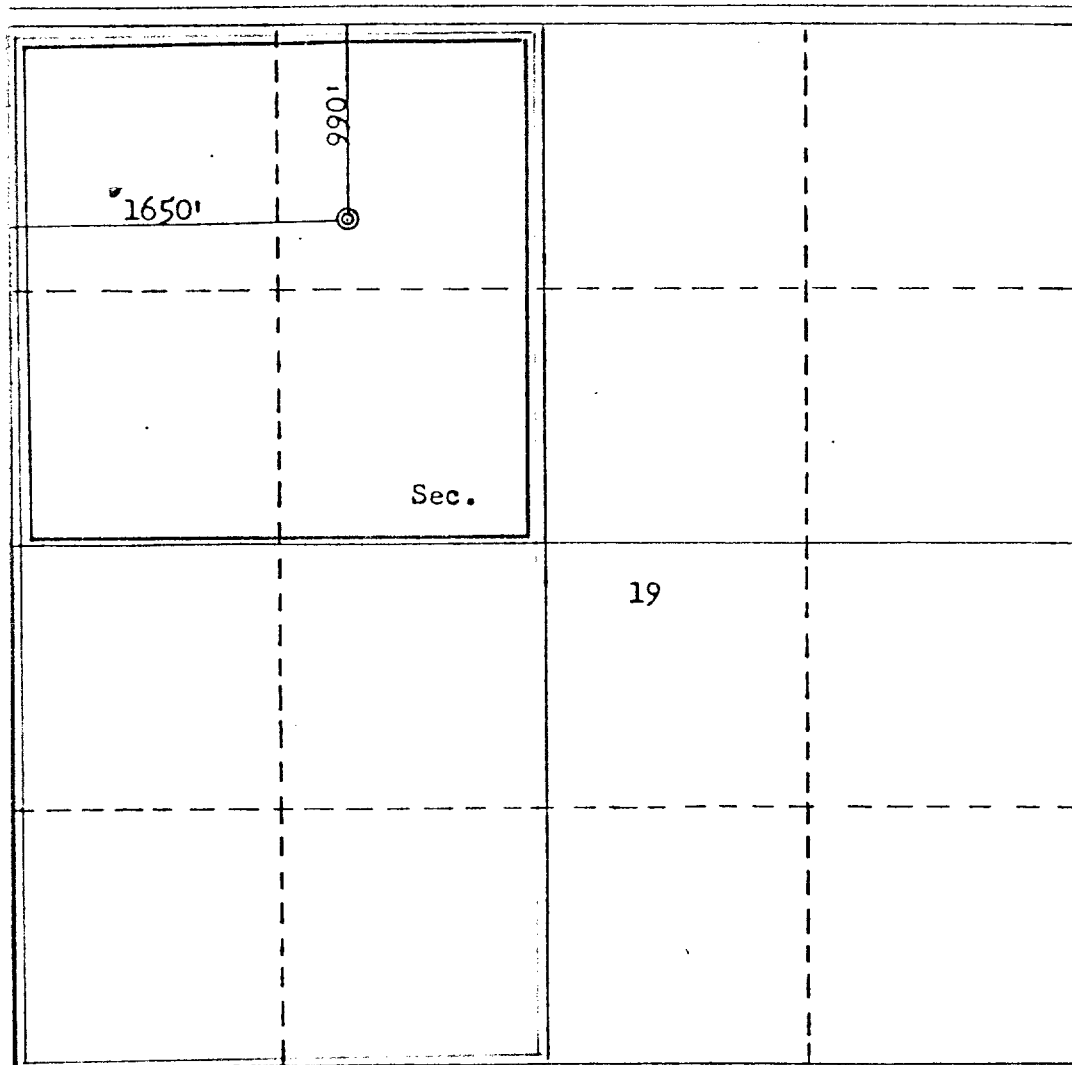

CERTIFICATION

I hereby certify that the information contained herein is true and complete to the best of my knowledge and belief.

Name

Position

Company

Date

I hereby certify that the well location shown on this plat was plotted from field notes of actual surveys made by me or under my supervision, and that the same is true and correct to the best of my knowledge and belief.

Date Surveyed

November 26, 1979

Registered Professional Engineer
and/or Land Surveyor

Fred B. Kerr, Jr.

Certificate No.

3950

0 330 660 990 1320 1650 1980 2310 2640 2000 1600 1000 500 0

All distances must be from the outer boundaries of the Section.

Operator TENNECO OIL COMPANY			Lease ELVIN J. PAYNE GAS UNIT "A"		Well No. 1-E
Unit Letter N	Section 19	Township 29N	Range 10W	County San Juan	
Actual Footage Location of Well: 530 feet from the South line and 2080 feet from the West line					
Ground Level Elev. 5476	Producing Formation		Pool	Dedicated Acreage: Acres	

1. Outline the acreage dedicated to the subject well by colored pencil or hachure marks on the plat below.
2. If more than one lease is dedicated to the well, outline each and identify the ownership thereof (both as to working interest and royalty).
3. If more than one lease of different ownership is dedicated to the well, have the interests of all owners been consolidated by communitization, unitization, force-pooling, etc?

☐ Yes ☐ No If answer is "yes," type of consolidation _____

If answer is "no," list the owners and tract descriptions which have actually been consolidated. (Use reverse side of this form if necessary.) _____

No allowable will be assigned to the well until all interests have been consolidated (by communitization, unitization, forced-pooling, or otherwise) or until a non-standard unit, eliminating such interests, has been approved by the Commission.



CERTIFICATION

I hereby certify that the information contained herein is true and complete to the best of my knowledge and belief.

Name

Position

Company

Date

I hereby certify that the well location shown on this plat was plotted from field notes of actual surveys made by me or under my supervision, and that the same is true and correct to the best of my knowledge and belief.

Date Surveyed

September 1979

Registered Professional Engineer and/or Land Surveyor

Fred B. Kerr

Certificate No.

3950

OIL CONSERVATION DIVISION

STATE OF NEW MEXICO
ENERGY AND MINERALS DEPARTMENTP. O. BOX 2088
SANTA FE, NEW MEXICO 87501Form C-102
Revised 10-1-78

All distances must be from the outer boundaries of the Section.

Operator TENNECO OIL COMPANY			Lease SULLIVAN FRAME GAS UNIT "A"		Well No. 1-E
Unit Letter A	Section 30	Township 29N	Range 10W	County San Juan	
Actual Footage Location of Well:					
990 feet from the North		line and 790 feet from the East		line	
Ground Level Elev. 5502	Producing Formation Dakota		Pool Basin Dakota		Dedicated Acreage: Acres

1. Outline the acreage dedicated to the subject well by colored pencil or hatchure marks on the plat below.
2. If more than one lease is dedicated to the well, outline each and identify the ownership thereof (both as to working interest and royalty).
3. If more than one lease of different ownership is dedicated to the well, have the interests of all owners been consolidated by communitization, unitization, force-pooling, etc?

☐ Yes ☐ No If answer is "yes," type of consolidation _____

If answer is "no," list the owners and tract descriptions which have actually been consolidated. (Use reverse side of this form if necessary.) _____

No allowable will be assigned to the well until all interests have been consolidated (by communitization, unitization, forced-pooling, or otherwise) or until a non-standard unit, eliminating such interests, has been approved by the Commission.

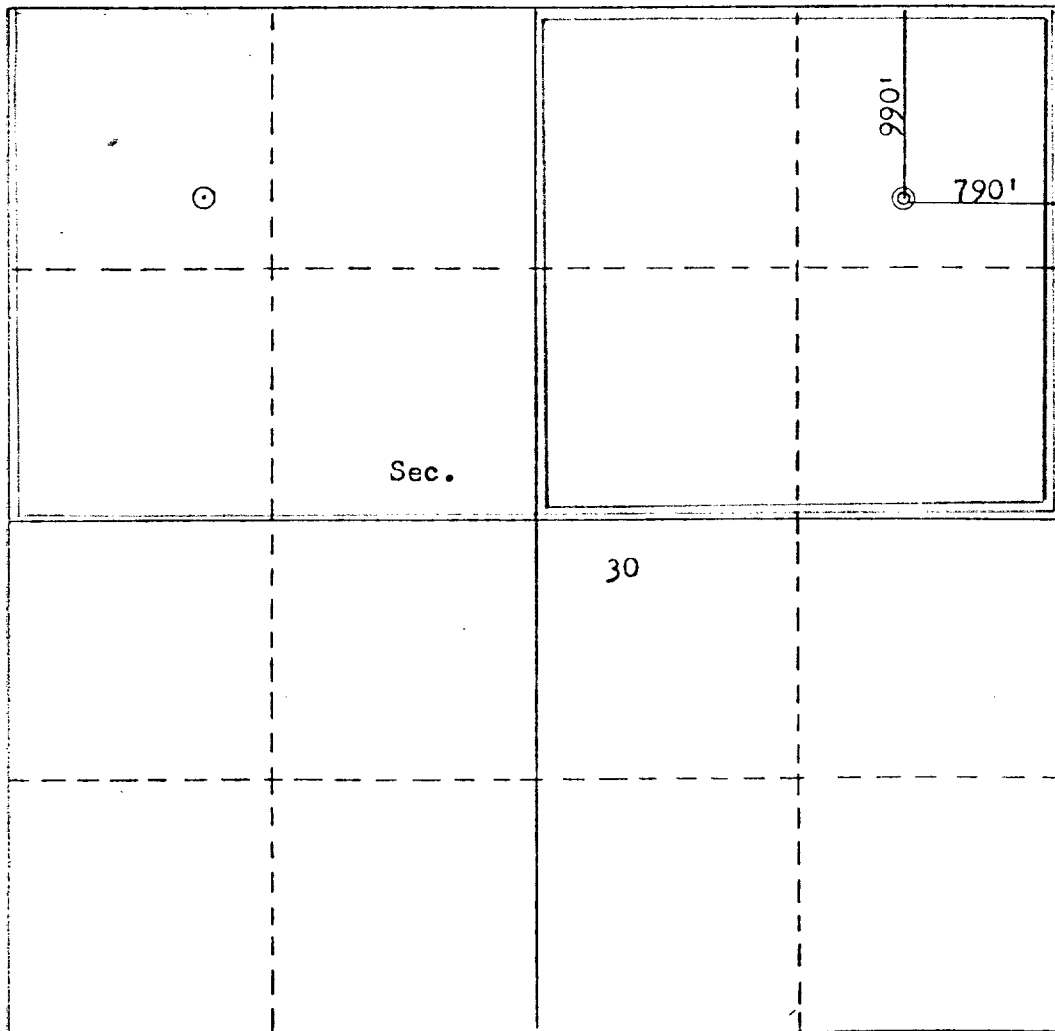

CERTIFICATION

I hereby certify that the information contained herein is true and complete to the best of my knowledge and belief.

Name

Position

Company

Date

I hereby certify that the well location shown on this plat was plotted from field notes of actual surveys made by me or under my supervision, and that the same is true and correct to the best of my knowledge and belief.

Date Surveyed

September 3, 1979

Registered Professional Engineer
and/or Land Surveyor

Fred B. Kerr Jr.
Fred B. Kerr Jr.
Certificate No. 3950

3950
Kerr, Jr.

OIL CONSERVATION DIVISION

STATE OF NEW MEXICO
ENERGY AND MINERALS DEPARTMENTP. O. BOX 2088
SANTA FE, NEW MEXICO 87501Form C-107
Revised 10-1-78

All distances must be from the outer boundaries of the Section.

Operator TENNECO OIL COMPANY		Lease SULLIVAN FRAME COM "B"		Well No. 1
Init Letter D	Section 30	Township 29N	Range 10W	County San Juan
Actual Footage Location of Well: 1100 feet from the North line and 800 feet from the West line				
Ground Level Elev. 5466	Producing Formation		Pool	Dedicated Acreage: Acres

1. Outline the acreage dedicated to the subject well by colored pencil or hatchure marks on the plat below.
2. If more than one lease is dedicated to the well, outline each and identify the ownership thereof (both as to working interest and royalty).
3. If more than one lease of different ownership is dedicated to the well, have the interests of all owners been consolidated by communitization, unitization, force-pooling, etc?

☐ Yes ☐ No If answer is "yes," type of consolidation _____

If answer is "no," list the owners and tract descriptions which have actually been consolidated. (Use reverse side of this form if necessary.) _____

No allowable will be assigned to the well until all interests have been consolidated (by communitization, unitization, forced-pooling, or otherwise) or until a non-standard unit, eliminating such interests, has been approved by the Commission.

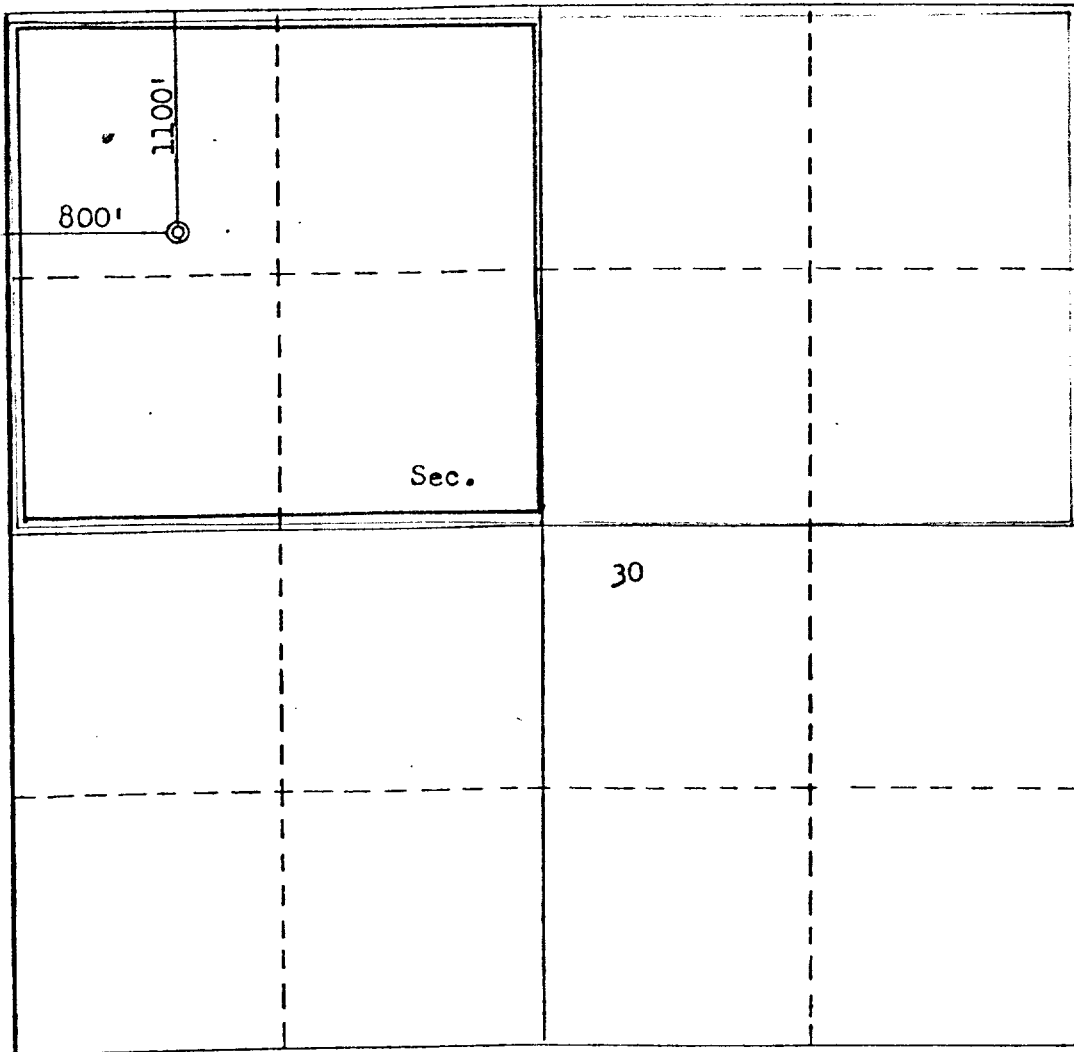

CERTIFICATION

I hereby certify that the information contained herein is true and complete to the best of my knowledge and belief.

Name

Position

Company

Date

I hereby certify that the well location shown on this plat was plotted from field notes of actual surveys made by me or under my supervision, and that the same is true and correct to the best of my knowledge and belief.

Date Surveyed

November 27, 1978

Registered Professional Engineer
and/or Land Surveyor

Fred B. Kerr, Jr.

Certificate No.

3950

OIL CONSERVATION DIVISION

STATE OF NEW MEXICO

P. O. BOX 2088

Form C-102
Revised 10-1-78

SANTA FE, NEW MEXICO 87501

All distances must be from the outer boundaries of the Section

Operator TENNECO OIL COMPANY			Lease VALDEZ GAS UNIT "A"		Well No. 1-E
Plat Letter G	Section 24	Township 29N	Range 11W	County San Juan	
Actual Footage Location of Well:					
1650		feet from the North	line and	1650	feet from the East
Ground Level Elev. 5486	Producing Formation Dakota		Pool Basin Dakota		Dedicated Acreage: Acres

1. Outline the acreage dedicated to the subject well by colored pencil or hachure marks on the plat below.
2. If more than one lease is dedicated to the well, outline each and identify the ownership thereof (both as to working interest and royalty).
3. If more than one lease of different ownership is dedicated to the well, have the interests of all owners been consolidated by communitization, unitization, force-pooling, etc?

☐ Yes ☐ No If answer is "yes," type of consolidation _____

If answer is "no," list the owners and tract descriptions which have actually been consolidated. (Use reverse side of this form if necessary.) _____

No allowable will be assigned to the well until all interests have been consolidated (by communitization, unitization, forced-pooling, or otherwise) or until a non-standard unit, eliminating such interests, has been approved by the Commission.

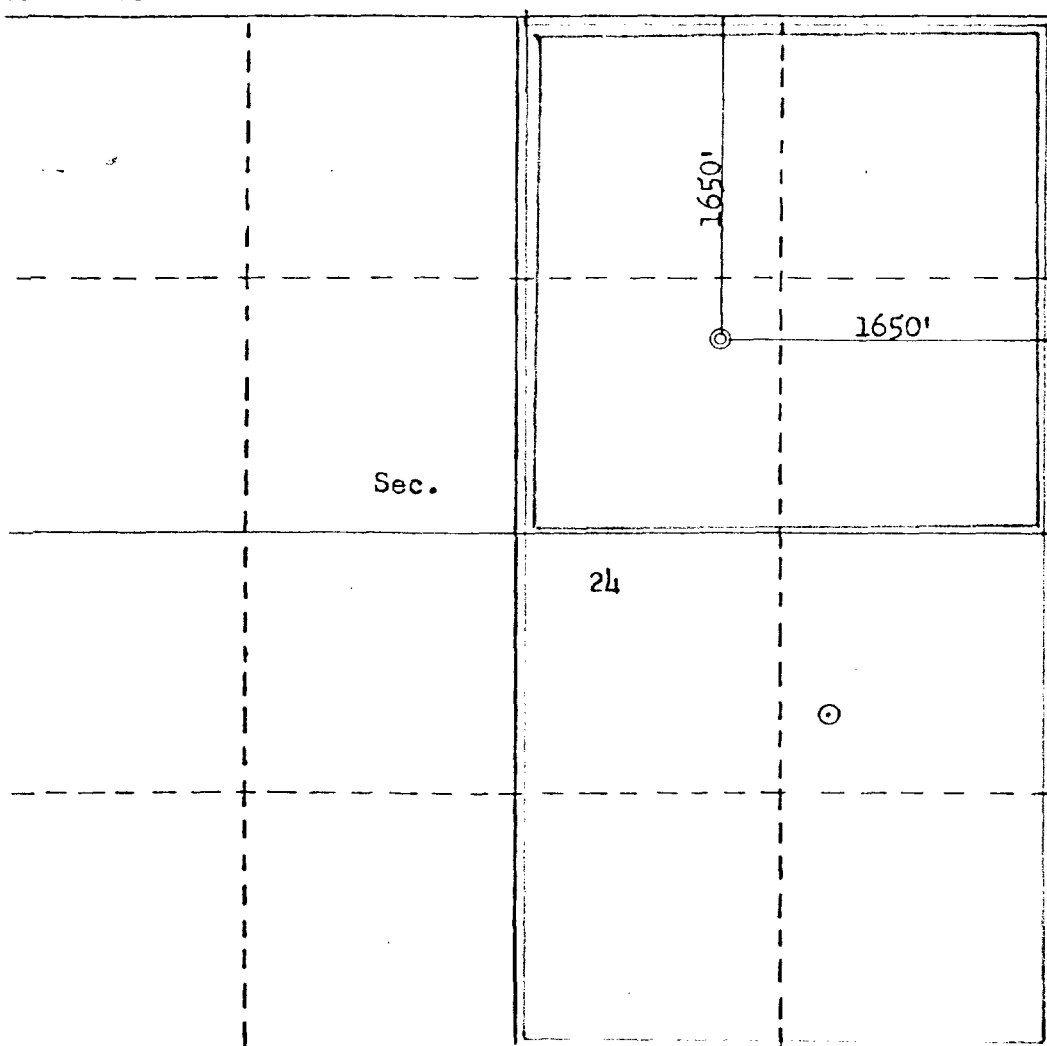

CERTIFICATION

I hereby certify that the information contained herein is true and complete to the best of my knowledge and belief.

Name

Position

Company

Date

I hereby certify that the well location shown on this plat was plotted from field notes of actual surveys made by me or under my supervision, and that the same is true and correct to the best of my knowledge and belief.

Date Surveyed

February 1, 1980

Registered Professional Engineer and/or Land Surveyor

Fred B. Kerr, Jr.

Certificate No. B. KERR, JR.

3950

330 660 990 1320 1650 1980 2310 2640 2000 1500 1000 500 0

OIL CONSERVATION DIVISION

STATE OF NEW MEXICO
ENERGY AND MINERALS DEPARTMENTP. O. BOX 2088
SANTA FE, NEW MEXICO 87501Form C-102
Revised 10-1-79

All distances must be from the outer boundaries of the Section.

Operator TENNECO OIL COMPANY			Lease MARQUIS G. EATON GAS UNIT "A"		Well No. 1-E
Unit Letter A	Section 25	Township 29N	Range 11W	County San Juan	
Actual Footage Location of Well: 990 feet from the North line and 990 feet from the East line					
Ground Level Elev. 5457	Producing Formation Dakota		Pool Basin Dakota		Dedicated Acreage: Acres

1. Outline the acreage dedicated to the subject well by colored pencil or hachure marks on the plat below.
2. If more than one lease is dedicated to the well, outline each and identify the ownership thereof (both as to working interest and royalty).
3. If more than one lease of different ownership is dedicated to the well, have the interests of all owners been consolidated by communitization, unitization, force-pooling, etc?

☐ Yes ☐ No If answer is "yes," type of consolidation _____

If answer is "no," list the owners and tract descriptions which have actually been consolidated. (Use reverse side of this form if necessary.) _____

No allowable will be assigned to the well until all interests have been consolidated (by communitization, unitization, forced-pooling, or otherwise) or until a non-standard unit, eliminating such interests, has been approved by the Commission.

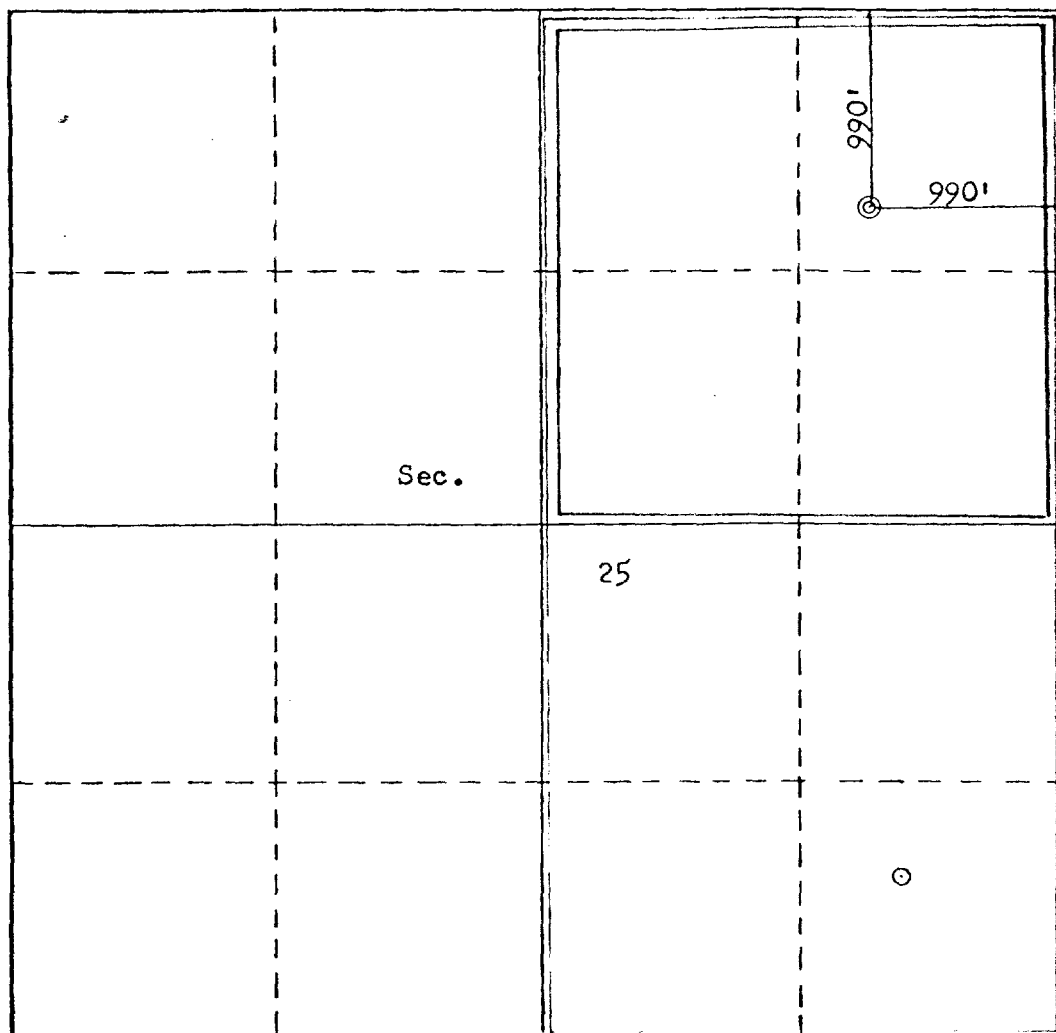

CERTIFICATION

I hereby certify that the information contained herein is true and complete to the best of my knowledge and belief.

Name _____

Position _____

Company _____

Date _____

I hereby certify that the well location shown on this plat was plotted from field notes of actual surveys made by me or under my supervision, and that the same is true and correct to the best of my knowledge and belief.

Date Surveyed _____

September 14, 1979

Registered Professional Engineer
and/or Land Surveyor
Fred B. Kerr Jr.

Certificate No.

3950

0 330 660 990 1320 1650 1980 2310 2640 2000 1500 1000 500 0

TENNECO OIL
Penthouse
720 South Colorado Boulevard
Denver, Colorado 80222

WELL LOCATION PLAT AND DESCRIPTION

Well Name VALDEZ COM B-1
Location: 825 1670
1850 FSL 1850 FEL Section 24, T 29N, R 11W
1/4-1/4-1/4 Section SE NW SE County San Juan State New Mexico
Lease No.: Federal State NM 481 482 483 484 530 Fee
MV 320
Spacing Unit Chacra 160 Acres: Description Mesaverde: E/2 Chacra: SE/4
Location meets State rules Yes Field Rules Yes
Deepest Objective Mesaverde Est. TD 4500 Est. G.L. Elev 5450
Plat Scale: 1" = 1000 ft.

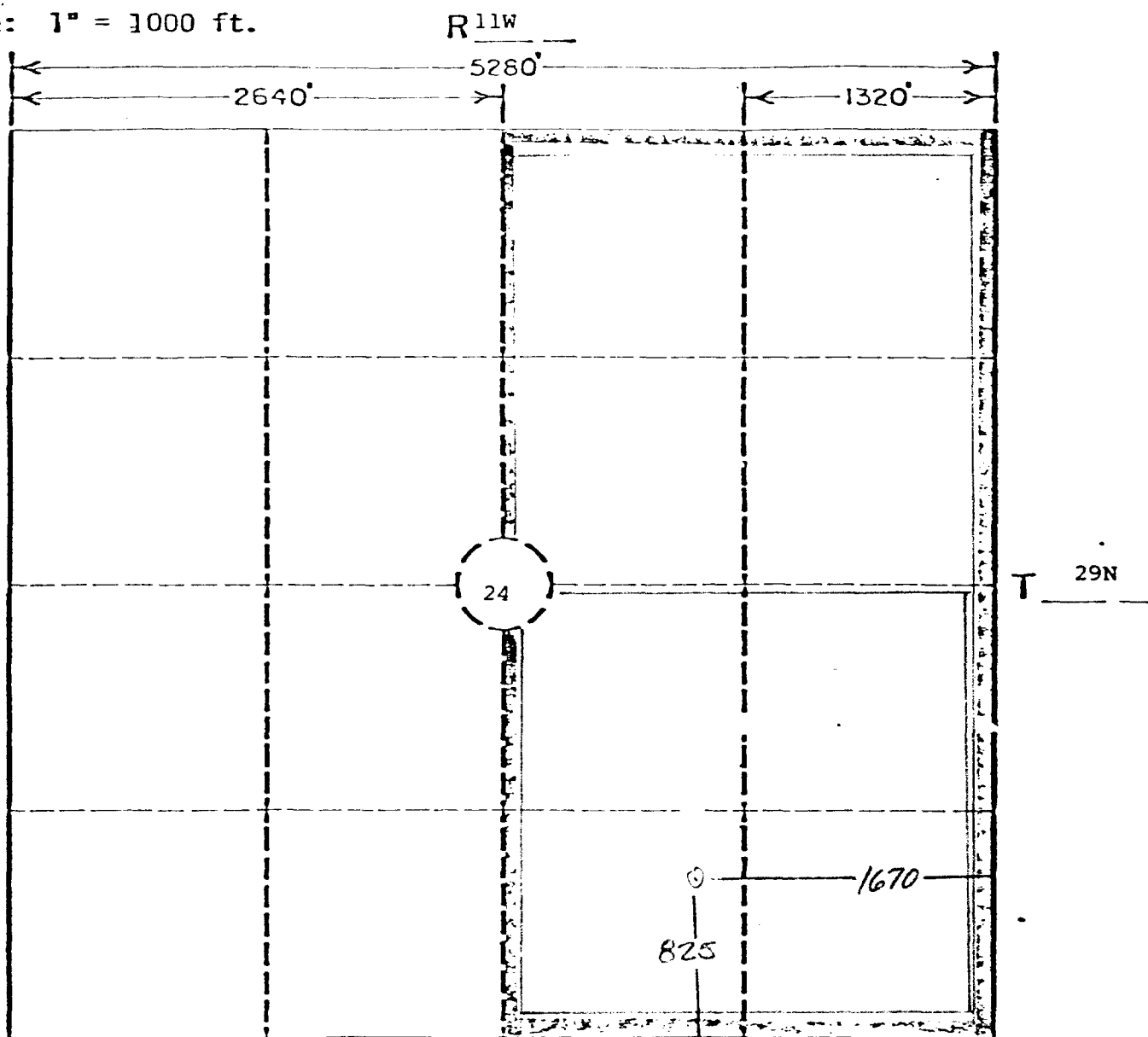

Preferred direction for relocation within legal boundaries shown SE
If relocation of more than 0 feet is necessary, please contact Carol Peavey
 in the G.E. Section.

Prepared by Doug Brandon Approved by Original Signed By: R H CASTLE Date October 24, 1979

cc: Well File
Land
Properties
Administrative
Drilling

All distances must be from the outer boundaries of the Section.

Operator TENNECO OIL COMPANY			Lease BRUCE SULLIVAN COM B			Well No. 1		
Unit Letter D	Section 25	Township 29N	Range 11W	County San Juan				
Actual Footage Location of Well:								
790 feet from the North line and			790 feet from the West line					
Ground Level Elev. 5457		Producing Formation		Pool		Dedicated Acreage: Acres		

1. Outline the acreage dedicated to the subject well by colored pencil or hachure marks on the plat below.
2. If more than one lease is dedicated to the well, outline each and identify the ownership thereof (both as to working interest and royalty).
3. If more than one lease of different ownership is dedicated to the well, have the interests of all owners been consolidated by communitization, unitization, force-pooling, etc?

☐ Yes ☐ No If answer is "yes," type of consolidation _____

If answer is "no," list the owners and tract descriptions which have actually been consolidated. (Use reverse side of this form if necessary.) _____

No allowable will be assigned to the well until all interests have been consolidated (by communitization, unitization, forced-pooling, or otherwise) or until a non-standard unit, eliminating such interests, has been approved by the Commission.

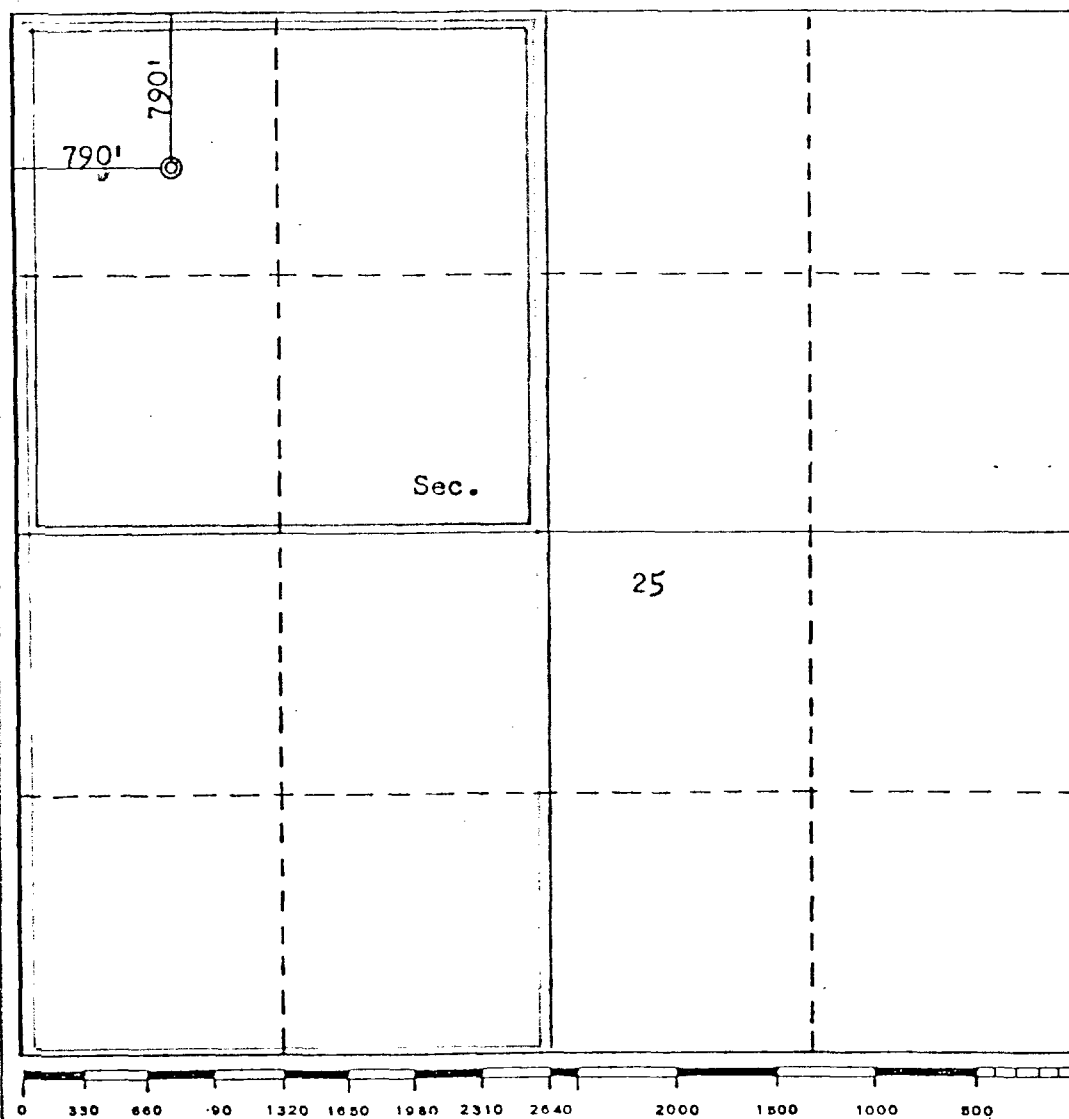

CERTIFICATION

I hereby certify that the information contained herein is true and complete to the best of my knowledge and belief.

Name

Position

Company

Date

I hereby certify that the well location shown on this plat was plotted from field notes of actual surveys made by me or under my supervision, and that the same is true and correct to the best of my knowledge and belief.

Date Surveyed

November 26, 1979

Registered Professional Engineer
and/or Land Surveyor

Fred B. Kerr, Jr.

Certification No. B. KERR, JR.

3950

OIL CONSERVATION DIVISION

STATE OF NEW MEXICO

P. O. BOX 2088

Form C-102
Revised 10-1-78

ENERGY AND MINERALS DEPARTMENT

SANTA FE, NEW MEXICO 87501

All distances must be from the outer boundaries of the Section.

Operator TENNECO OIL COMPANY			Lease SULLIVAN GAS UNIT "A"		Well No. 1-E
Unit Letter M	Section 25	Township 29N	Range 11W	County San Juan	
Actual Footage Location of Well:					
990 feet from the South line and		990 feet from the West line			
Ground Level Elev. 5583	Producing Formation		Pool	Dedicated Acreage: Acres	

1. Outline the acreage dedicated to the subject well by colored pencil or hachure marks on the plat below.
2. If more than one lease is dedicated to the well, outline each and identify the ownership thereof (both as to working interest and royalty).
3. If more than one lease of different ownership is dedicated to the well, have the interests of all owners been consolidated by communitization, unitization, force-pooling, etc?

☐ Yes ☐ No If answer is "yes," type of consolidation _____

If answer is "no," list the owners and tract descriptions which have actually been consolidated. (Use reverse side of this form if necessary.) _____

No allowable will be assigned to the well until all interests have been consolidated (by communitization, unitization, forced-pooling, or otherwise) or until a non-standard unit, eliminating such interests, has been approved by the Commission.

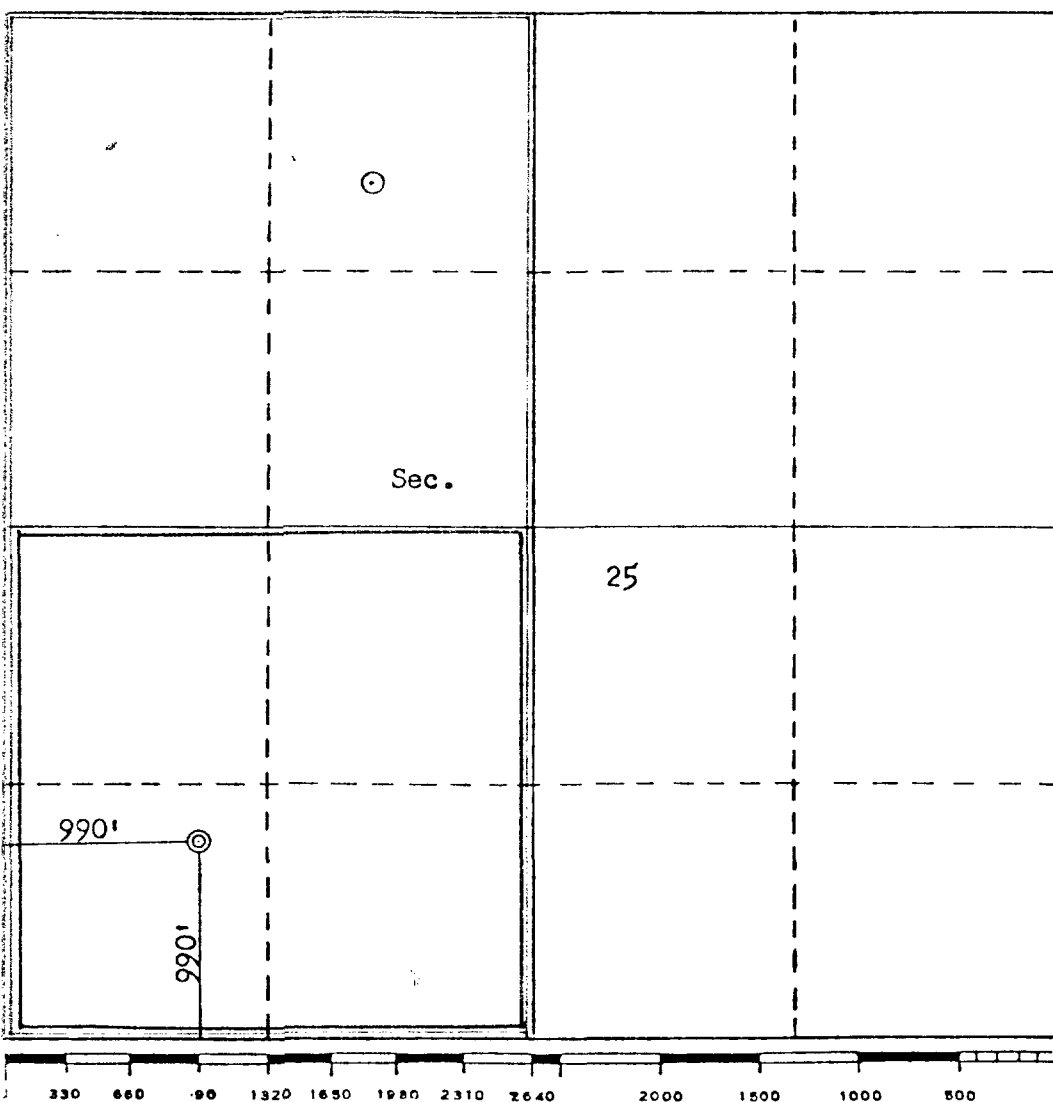

CERTIFICATION

I hereby certify that the information contained herein is true and complete to the best of my knowledge and belief.

Name

Position

Company

Date

I hereby certify that the well location shown on this plat was plotted from field notes of actual surveys made by me or under my supervision, and that the same is true and correct to the best of my knowledge and belief.

Date Surveyed

September 11, 1979

Registered Professional Engineer
and/or Land Surveyor

Fred B. Kerr, Jr.

Certificate No. 3950
F. B. KERR, JR.

All distances must be from the outer boundaries of the Section.

Operator TENNECO OIL COMPANY			Lease EATON COM "B"		Well No. 1
Section P	Section 25	Township 29N	Range 11W	County San Juan	
Actual Footage Location of Well:					
1040		feet from the South	line and 790	feet from the East	line
Ground Level Elev. 5562	Producing Formation		Pool	Dedicated Acreage: Acres	

1. Outline the acreage dedicated to the subject well by colored pencil or hachure marks on the plat below.
2. If more than one lease is dedicated to the well, outline each and identify the ownership thereof (both as to working interest and royalty).
3. If more than one lease of different ownership is dedicated to the well, have the interests of all owners been consolidated by communitization, unitization, force-pooling, etc?

☐ Yes ☐ No If answer is "yes," type of consolidation _____

If answer is "no," list the owners and tract descriptions which have actually been consolidated. (Use reverse side of this form if necessary.) _____

No allowable will be assigned to the well until all interests have been consolidated (by communitization, unitization, forced-pooling, or otherwise) or until a non-standard unit, eliminating such interests, has been approved by the Commission.

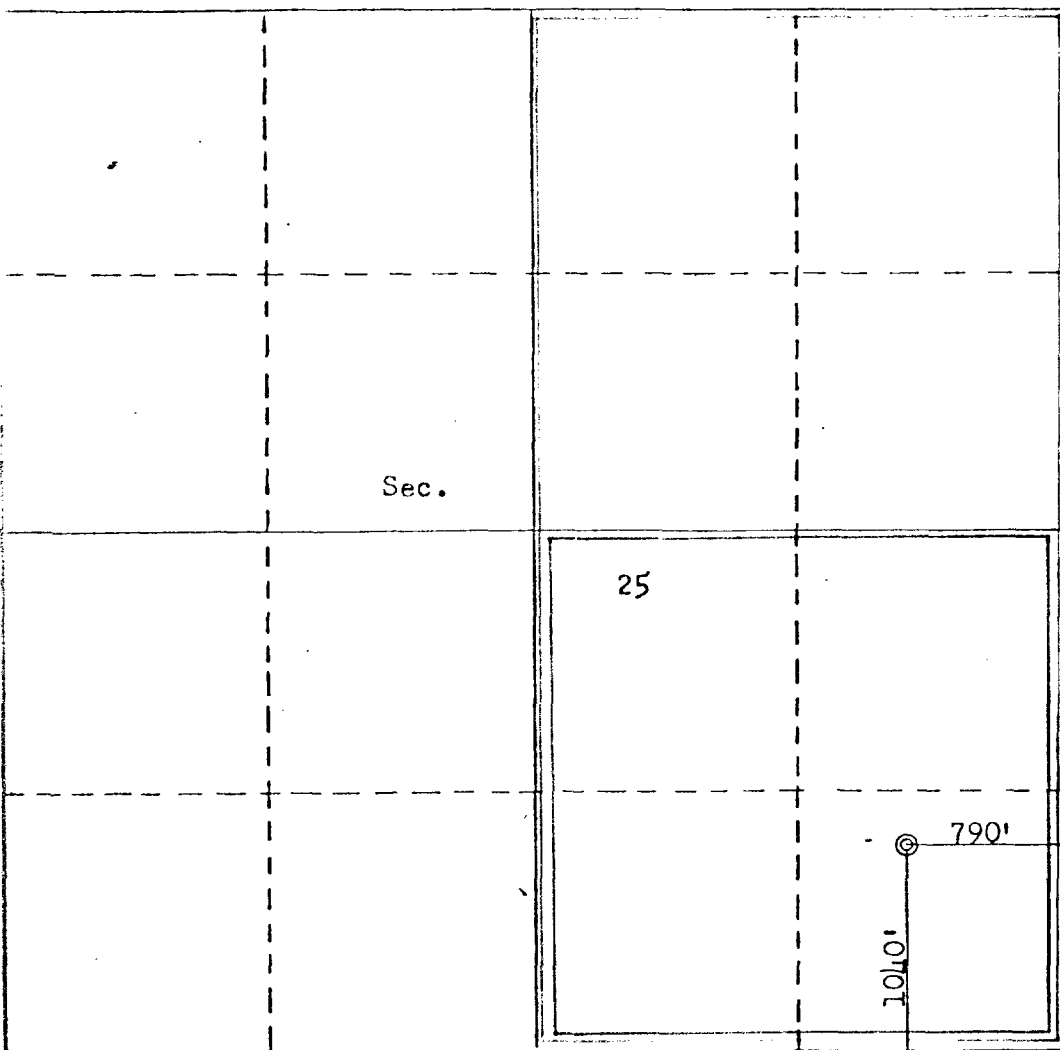

CERTIFICATION

I hereby certify that the information contained herein is true and complete to the best of my knowledge and belief.

Name

Position

Company

Date

I hereby certify that the well location shown on this plat was plotted from field notes of actual surveys made by me or under my supervision, and that the same is true and correct to the best of my knowledge and belief.

Date Surveyed

November 14, 1979

Registered Professional Engineer and/or Land Surveyor

Fred B. Kerr, Jr.

Certificate No.

3950

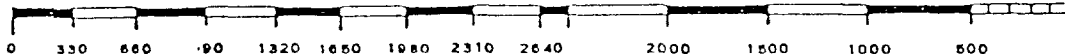

TENNECO OIL COMPANY
BLOOMFIELD AREA
R10+11 W, T29 N
SAN JUAN COUNTY, NEW MEXICO
DAKOTA DUAL WITH MESA VERDE-CHACRA COMINGLE

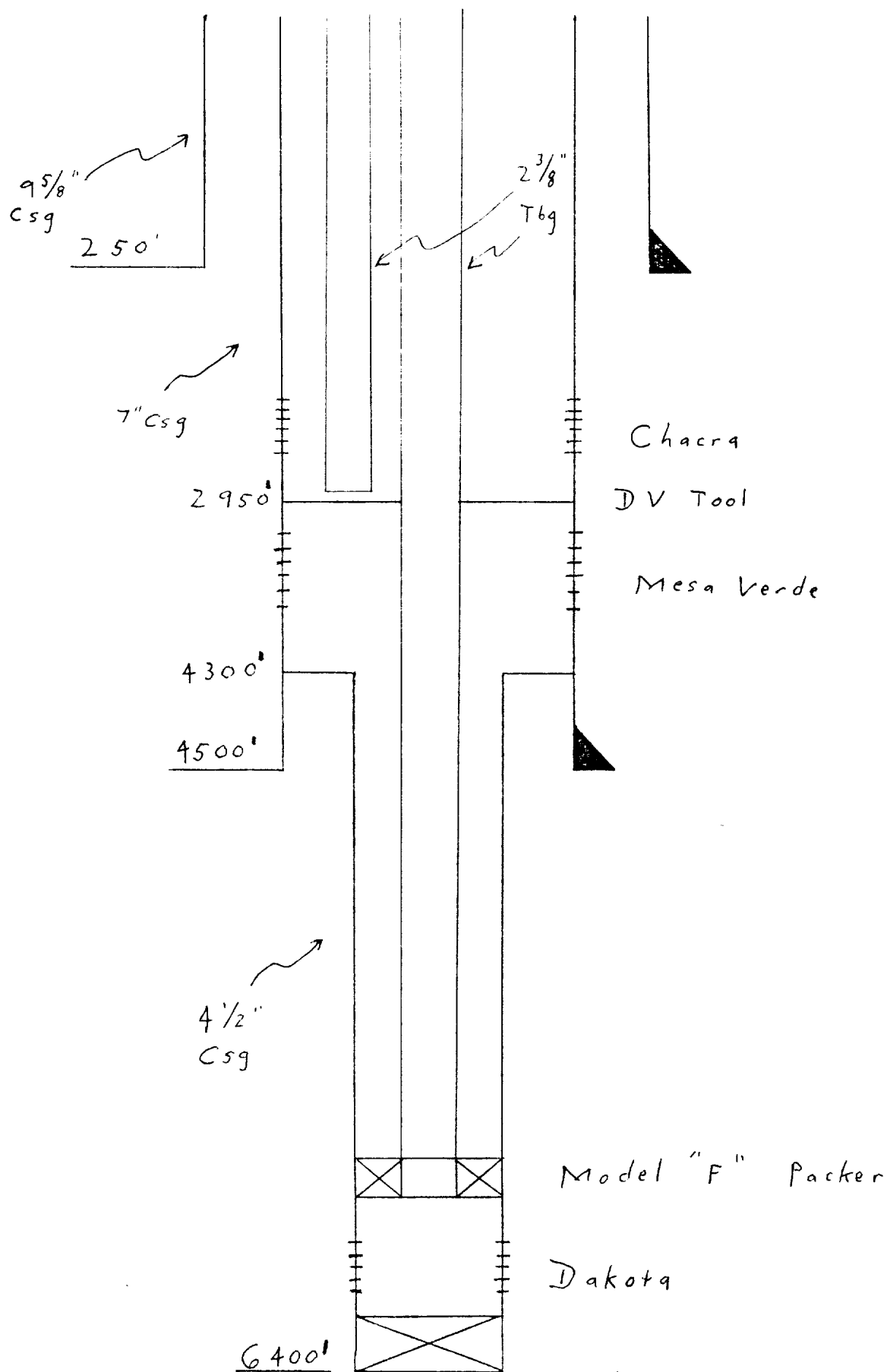

TENNECO OIL COMPANY
BLOOMFIELD AREA
R10&11 W, T29N
SAN JUAN COUNTY, NEW MEXICO
DAKOTA DUAL WITH MESA VERDE-CHACRA COMINGLED

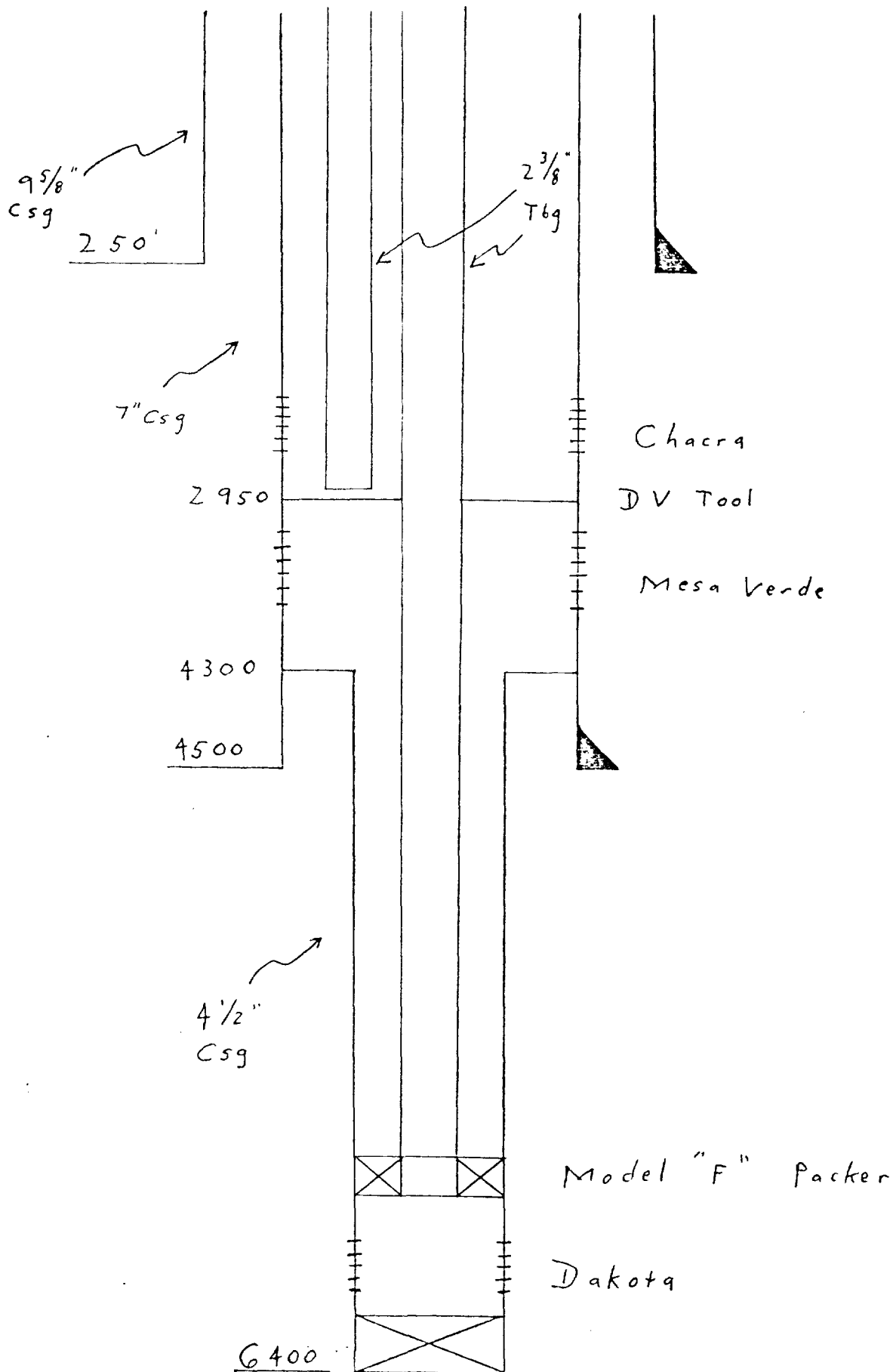

STATE OF NEW MEXICO
DEPARTMENT OF ENERGY AND MINERALS
OIL CONSERVATION DIVISION

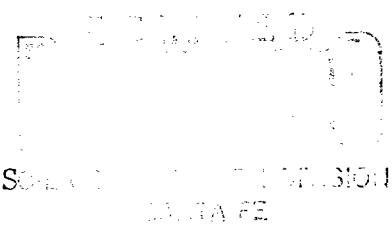

IN THE MATTER OF THE APPLICATION
OF TENNECO OIL COMPANY FOR DUAL
COMPLETION AND DOWNHOLE COMMINGLING,
SAN JUAN COUNTY, NEW MEXICO.

APPLICATION

Case 6847

COMES NOW TENNECO OIL COMPANY, by and through its attorneys,
KELLAHIN & KELLAHIN, and applies to the New Mexico Oil Conservation
Division for approval to drill ten wells in which the Chacra and
Mesa Verde production will be commingled and then produced as
a dual completion with the Dakota formation, all in San Juan
County, New Mexico, and in support thereof would show:

1. Applicant is the operator of each of the units and for-
mations involved in this application as shown on the attached sur-
face plat.

2. Applicant requests approval to commingle production from
the Chacra and Mesaverde formations and to dually complete those
commingled zones with the Dakota formation for the following
wells:

1. Bunce Com Well No. 1, Unit C, Sec. 19,
729N, R10W, NMPM;
2. Elvin J. Paynes Gas Unit "A" Well No. 1-E,
Unit N, Sec. 19, T29N, R10W, NMPM;
3. Sullivan Frame Gas Unit "A" Well No. 1-E,
Unit A, Sec. 30, T29N, R10W, NMPM;
4. Sullivan Frame Com "B" Well No. 1, Unit D,
Sec. 30, T29N, R10W, NMPM;
5. Valdez Gas Unit "A" Well No. 1-E, Unit G,
Sec. 24, T29N, R11W, NMPM;
6. Marquis G. Eaton Gas Unit "A" Well No. 1-E,
Unit A, Sec. 25, T29N, R11W, NMPM;
7. Valdez Com B-1 Well No. 1, Unit O, Sec. 24,
T29N, R11W, NMPM;

8. Bruce Sullivan Com B Well No. 1, Unit D,
Sec. 25, T29N, R11W, NMPM;
9. Sullivan Gas Unit "A" Well No. 1-E,
Unit M, Sec 25, T29N, R11W, NMPM;
10. Eaton Com "B" Well No. 1, Unit P,
Sec. 25, T29N, R11W, NMPM.

Attached hereto and incorporated by reference are Division Forms C-102 for each well.

3. Applicant proposes to dedicate a 320-acre Dakota unit to each well and a 160-acre Chacra-Mesaverde unit to each well as shown on the Form C-102 attached hereto and incorporated by reference.

4. Applicant proposes to complete each well as shown on the wellbore schematic attached hereto and incorporated by reference.

5. That approval of the application will be in the best interest of conservation, the prevention of waste and the protection of correlative rights.

WHEREFORE, Applicant requests that this matter be set for hearing and that after notice and hearing, the Division approve the application as requested.

TENNECO OIL COMPANY

By 

W. Thomas Kellahin

KELLAHIN & KELLAHIN

P. O. Box 1769

Santa Fe, New Mexico 87501

ATTORNEYS FOR APPLICANT

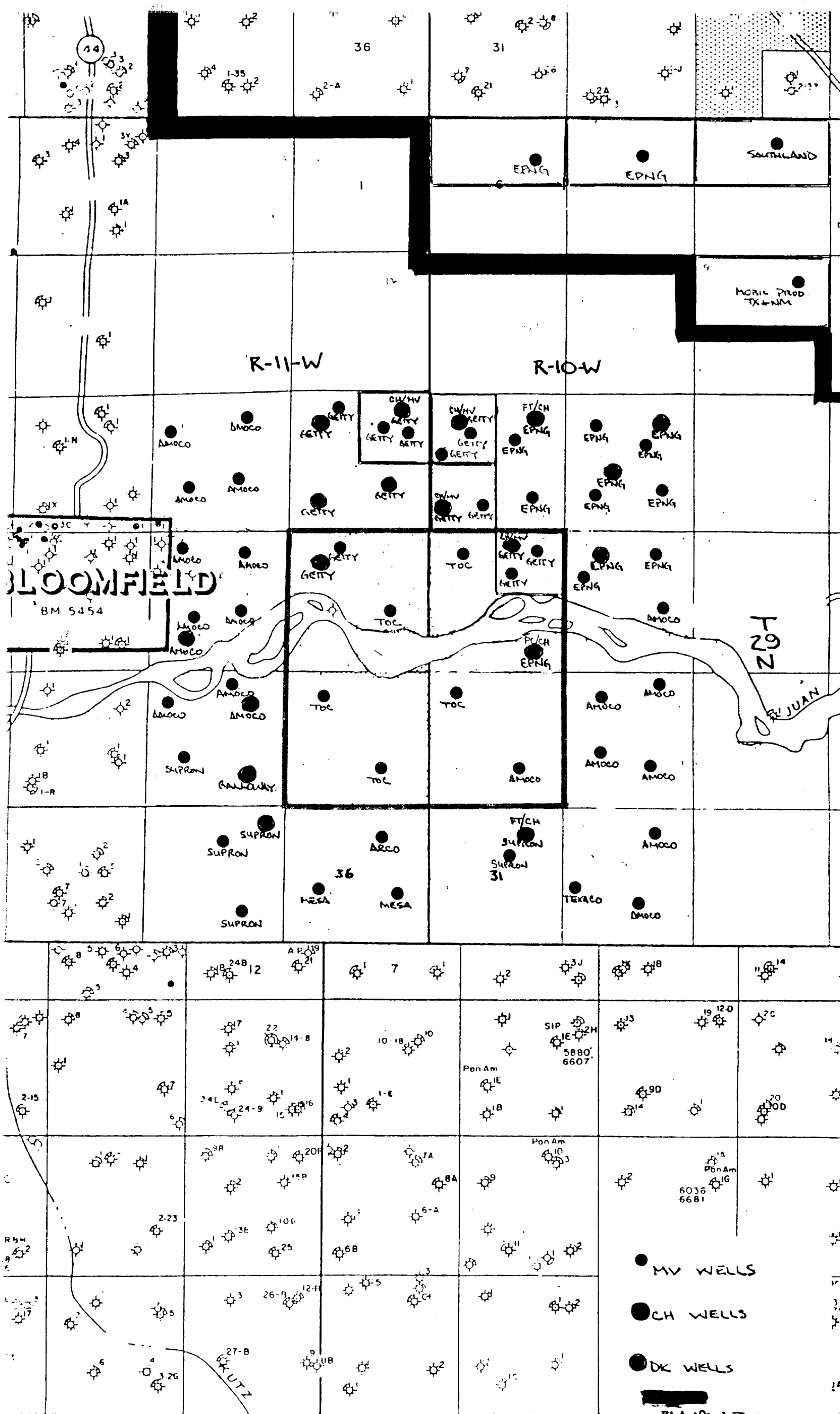

All distances must be from the outer boundaries of the Section.

Operator TENNECO OIL COMPANY		Lease BUNCE COM		Well No. 1
Well Letter C	Section 19	Township 29N	Range 10W	County San Juan
Actual Footage Location of Well: 990 feet from the North line and 1650 feet from the West line				
Ground Level Elev. 5521	Producing Formation		Pool	Dedicated Acreage: Acres

1. Outline the acreage dedicated to the subject well by colored pencil or hatchure marks on the plat below.
2. If more than one lease is dedicated to the well, outline each and identify the ownership thereof (both as to working interest and royalty).
3. If more than one lease of different ownership is dedicated to the well, have the interests of all owners been consolidated by communitization, unitization, force-pooling, etc?

☐ Yes ☐ No If answer is "yes," type of consolidation _____

If answer is "no," list the owners and tract descriptions which have actually been consolidated. (Use reverse side of this form if necessary.) _____

No allowable will be assigned to the well until all interests have been consolidated (by communitization, unitization, forced-pooling, or otherwise) or until a non-standard unit, eliminating such interests, has been approved by the Commission.

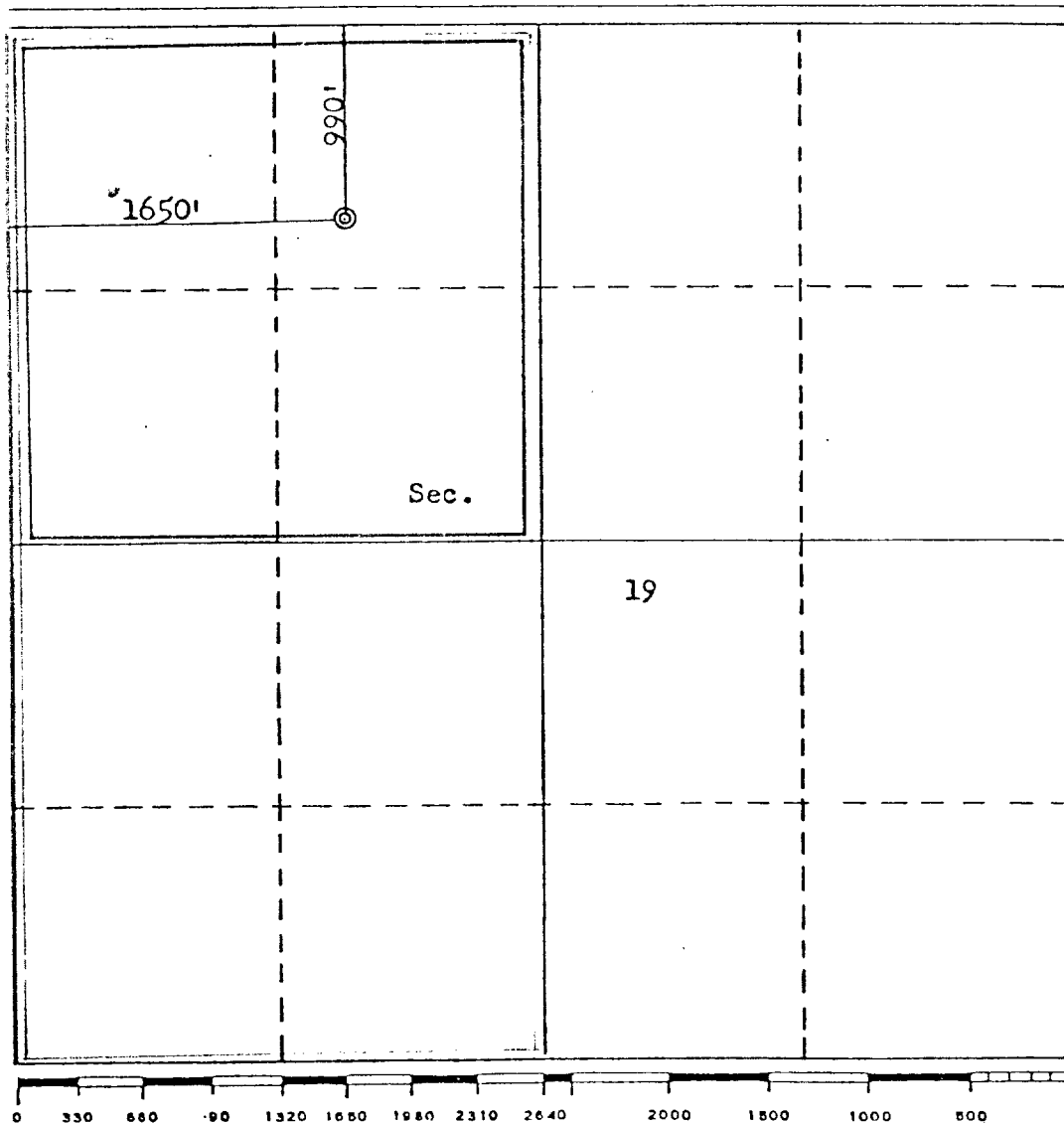

CERTIFICATION

I hereby certify that the information contained herein is true and complete to the best of my knowledge and belief.

Name

Position

Company

Date

I hereby certify that the well location shown on this plat was plotted from field notes of actual surveys made by me or under my supervision, and that the same is true and correct to the best of my knowledge and belief.

Date Surveyed

November 26, 1979

Registered Professional Engineer
and/or Land Surveyor

Fred B. Kerr, Jr.

Certificate No. B. KERR, JR.
3950

All distances must be from the outer boundaries of the Section

Operator TENNECO OIL COMPANY			Lease ELVIN J. PAYNE GAS UNIT "A"		Well No. 1-E
Unit Letter N	Section 19	Township 29N	Range 10W	County San Juan	
Actual Footage Location of Well: 530 feet from the South line and 2080 feet from the West line					
Ground Level Elev. 5476	Producing Formation		Pool	Dedicated Acreage: Acres	

1. Outline the acreage dedicated to the subject well by colored pencil or hachure marks on the plat below.
2. If more than one lease is dedicated to the well, outline each and identify the ownership thereof (both as to working interest and royalty).
3. If more than one lease of different ownership is dedicated to the well, have the interests of all owners been consolidated by communitization, unitization, force-pooling, etc?

☐ Yes ☐ No If answer is "yes," type of consolidation _____

If answer is "no," list the owners and tract descriptions which have actually been consolidated. (Use reverse side of this form if necessary.) _____

No allowable will be assigned to the well until all interests have been consolidated (by communitization, unitization, forced-pooling, or otherwise) or until a non-standard unit, eliminating such interests, has been approved by the Commission.

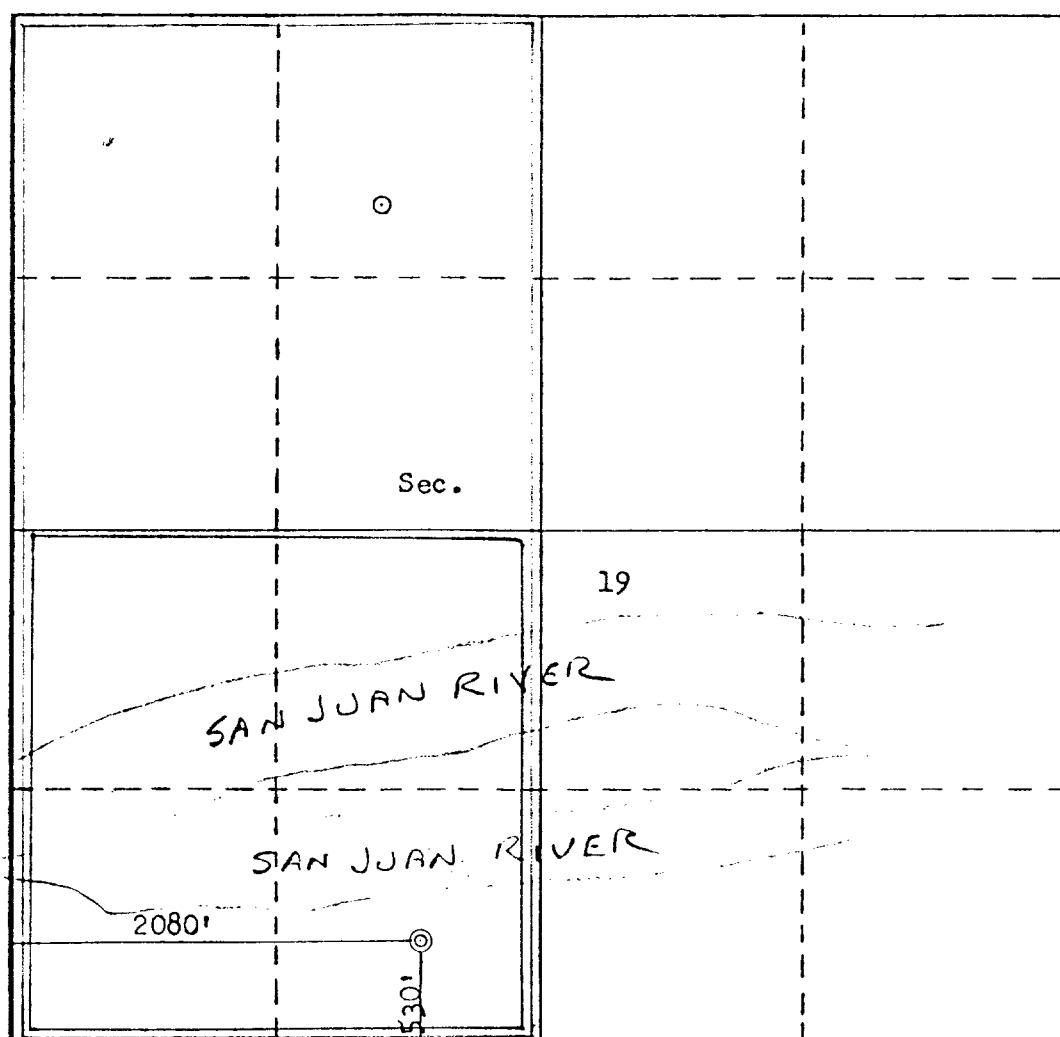

CERTIFICATION

I hereby certify that the information contained herein is true and complete to the best of my knowledge and belief.

Name

Position

Company

Date

I hereby certify that the well location shown on this plat was plotted from field notes of actual surveys made by me or under my supervision, and that the same is true and correct to the best of my knowledge and belief.

Date Surveyed

September 7, 1979

Registered Professional Engineer and/or Land Surveyor

Fred B. Kerr
Fred B. Kerr

Certificate No. 3950

OIL CONSERVATION DIVISION

STATE OF NEW MEXICO
ENERGY AND MINERALS DEPARTMENTP. O. BOX 2088
SANTA FE, NEW MEXICO 87501Form C-102
Revised 10-1-78

All distances must be from the outer boundaries of the Section.

Operator TENNECO OIL COMPANY			Lease SULLIVAN FRAME GAS UNIT "A"			Well No. 1-E		
Unit Letter A	Section 30	Township 29N	Range 10W	County San Juan				
Actual Footage Location of Well: 990 feet from the North line and 790 feet from the East line								
Ground Level Elev. 5502		Producing Formation Dakota		Pool Basin Dakota			Dedicated Acreage: Acres	

1. Outline the acreage dedicated to the subject well by colored pencil or hachure marks on the plat below.
2. If more than one lease is dedicated to the well, outline each and identify the ownership thereof (both as to working interest and royalty).
3. If more than one lease of different ownership is dedicated to the well, have the interests of all owners been consolidated by communitization, unitization, force-pooling, etc?

☐ Yes ☐ No If answer is "yes," type of consolidation _____

If answer is "no," list the owners and tract descriptions which have actually been consolidated. (Use reverse side of this form if necessary.) _____

No allowable will be assigned to the well until all interests have been consolidated (by communitization, unitization, forced-pooling, or otherwise) or until a non-standard unit, eliminating such interests, has been approved by the Commission.

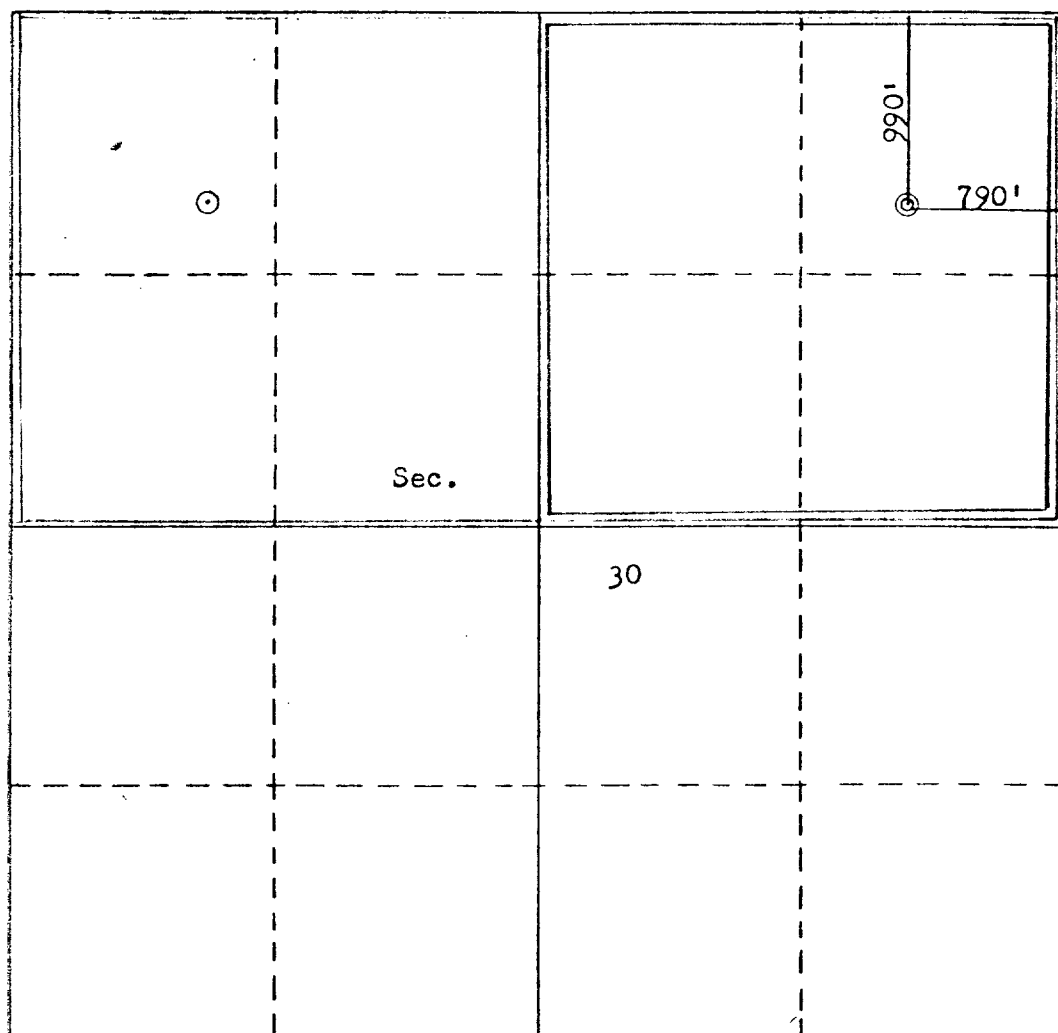

CERTIFICATION

I hereby certify that the information contained herein is true and complete to the best of my knowledge and belief.

Name

Position

Company

Date

I hereby certify that the well location shown on this plat was plotted from field notes of actual surveys made by me or under my supervision, and that the same is true and correct to the best of my knowledge and belief.

Date Surveyed

September 3, 1979

Registered Professional Engineer
and/or Land SurveyorFred B. Kerr Jr.
No. 3950

Certificate No. 3950

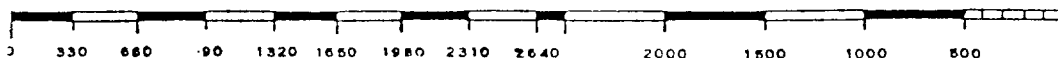

OIL CONSERVATION DIVISION

STATE OF NEW MEXICO
ENERGY AND MINERALS DEPARTMENT

P. O. BOX 2088

SANTA FE, NEW MEXICO 87501

Form C-107
Revised 10-1-78

All distances must be from the outer boundaries of the Section.

Operator TENNECO OIL COMPANY		Lease SULLIVAN FRAME COM "B"		Well No. 1
Unit Letter D	Section 30	Township 29N	Range 10W	County San Juan
Actual Footage Location of Well:				
1100	feet from the North	line and	800	feet from the West
Ground Level Elev. 5466	Producing Formation	Pool	Dedicated Acreage: Acres	

1. Outline the acreage dedicated to the subject well by colored pencil or hachure marks on the plat below.
2. If more than one lease is dedicated to the well, outline each and identify the ownership thereof (both as to working interest and royalty).
3. If more than one lease of different ownership is dedicated to the well, have the interests of all owners been consolidated by communitization, unitization, force-pooling, etc?

☐ Yes ☐ No If answer is "yes," type of consolidation _____

If answer is "no," list the owners and tract descriptions which have actually been consolidated. (Use reverse side of this form if necessary.) _____

No allowable will be assigned to the well until all interests have been consolidated (by communitization, unitization, forced-pooling, or otherwise) or until a non-standard unit, eliminating such interests, has been approved by the Commission.

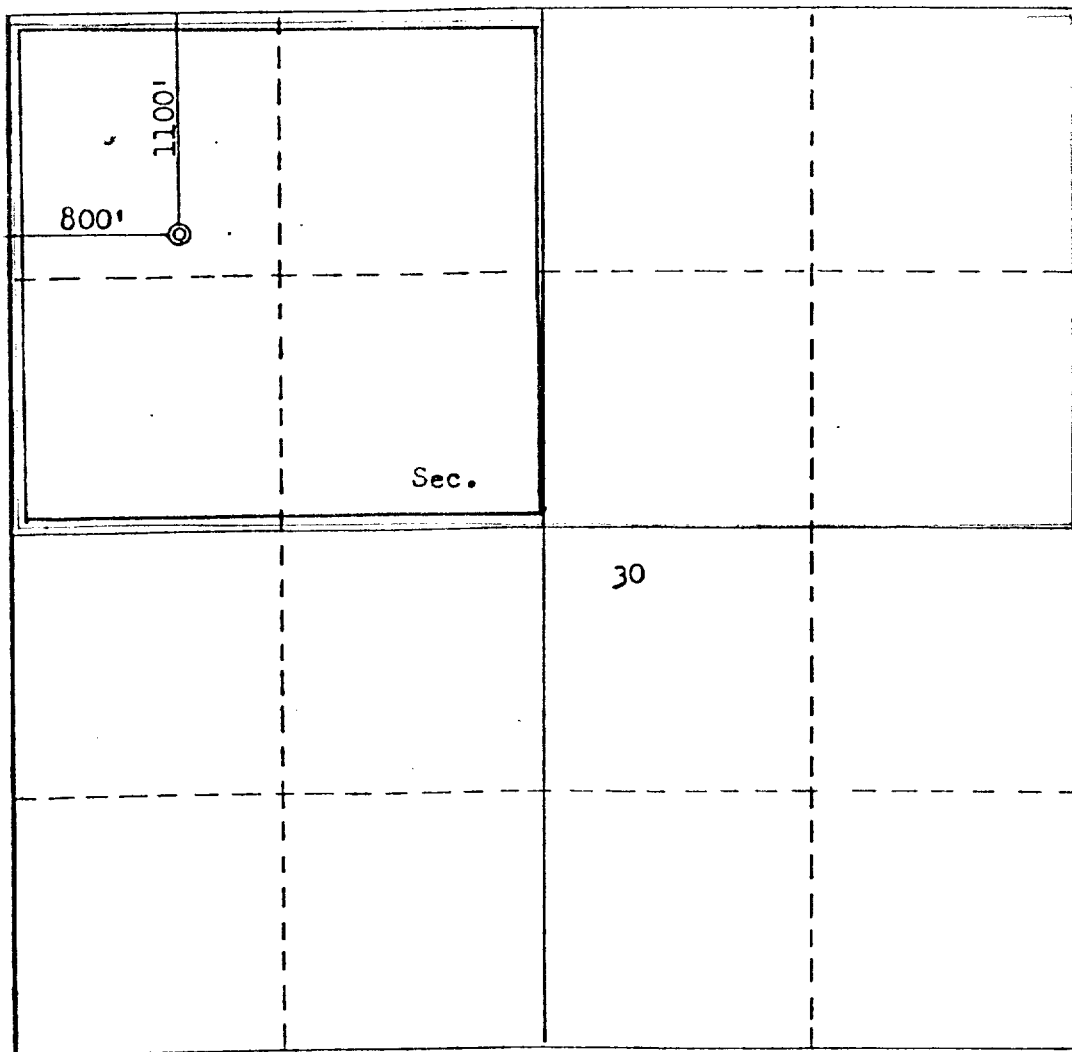

CERTIFICATION

I hereby certify that the information contained herein is true and complete to the best of my knowledge and belief.

Name

Position

Company

Date

I hereby certify that the well location shown on this plat was plotted from field notes of actual surveys made by me or under my supervision, and that the same is true and correct to the best of my knowledge and belief.

Date Surveyed

November 27, 1978

Registered Professional Engineer
and/or Land Surveyor No.

Fred B. Kerr, Jr.

Certificate No. 3950

3950

OIL CONSERVATION DIVISION

STATE OF NEW MEXICO

P. O. BOX 2088

Form C-102

Revised 10-1-78

ENERGY AND MINERALS DEPARTMENT

SANTA FE, NEW MEXICO 87501

All distances must be from the outer boundaries of the Section

Operator TENNECO OIL COMPANY			Lease VALDEZ GAS UNIT "A"		Well No. 1-E
Well Letter G	Section 24	Township 29N	Range 11W	County San Juan	
Actual Footage Location of Well: 1650 feet from the North line and 1650 feet from the East line					
Ground Level Elev. 5486	Producing Formation Dakota		Pool Basin Dakota		Dedicated Acreage: Acres

1. Outline the acreage dedicated to the subject well by colored pencil or hachure marks on the plat below.
2. If more than one lease is dedicated to the well, outline each and identify the ownership thereof (both as to working interest and royalty).
3. If more than one lease of different ownership is dedicated to the well, have the interests of all owners been consolidated by communitization, unitization, force-pooling, etc?

☐ Yes ☐ No If answer is "yes," type of consolidation _____

If answer is "no," list the owners and tract descriptions which have actually been consolidated. (Use reverse side of this form if necessary.) _____

No allowable will be assigned to the well until all interests have been consolidated (by communitization, unitization, forced-pooling, or otherwise) or until a non-standard unit, eliminating such interests, has been approved by the Commission.

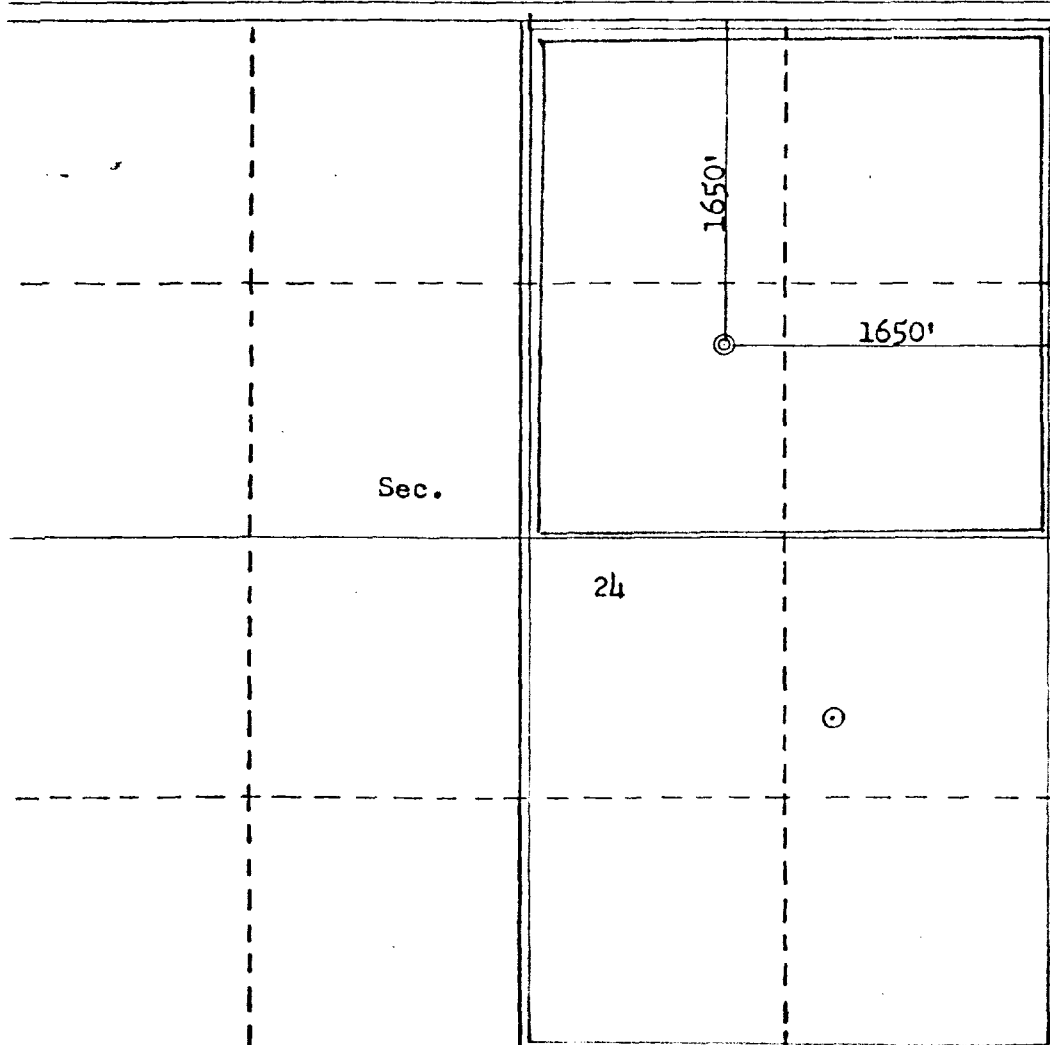

CERTIFICATION

I hereby certify that the information contained herein is true and complete to the best of my knowledge and belief.

Name

Position

Company

Date

I hereby certify that the well location shown on this plat was plotted from field notes of actual surveys made by me or under my supervision, and that the same is true and correct to the best of my knowledge and belief.

Date Surveyed

February 1, 1980

Registered Professional Engineer and/or Land Surveyor

Fred B. Kerr, Jr.

Certificate No. B. KERR, JR.

3950

330 440 550 660 770 880 990 1100 1210 1320 1430 1540 1650 1760 1870 1980 2090 2200 2310 2420 2530 2640 2750 2860 2970 3080 3190 3300 3410 3520 3630 3740 3850 3960 4070 4180 4290 4400 4510 4620 4730 4840 4950 5060 5170 5280 5390 5500 5610 5720 5830 5940 6050 6160 6270 6380 6490 6600 6710 6820 6930 7040 7150 7260 7370 7480 7590 7700 7810 7920 8030 8140 8250 8360 8470 8580 8690 8800 8910 9020 9130 9240 9350 9460 9570 9680 9790 9900 10000

OIL CONSERVATION DIVISION

STATE OF NEW MEXICO
ENERGY AND MINERALS DEPARTMENTP. O. BOX 2088
SANTA FE, NEW MEXICO 87501Form C-107
Revised 10-1

All distances must be from the outer boundaries of the Section.

Operator TENNECO OIL COMPANY			Lease MARQUIS G. EATON GAS UNIT "A"		Well No. 1-E
Unit Letter A	Section 25	Township 29N	Range 11W	County San Juan	
Actual Footage Location of Well: 990 feet from the North line and 990 feet from the East line					
Ground Level Elev. 5457	Producing Formation Dakota		Pool Basin Dakota		Dedicated Acreage: Acre:

1. Outline the acreage dedicated to the subject well by colored pencil or hatchure marks on the plat below.
2. If more than one lease is dedicated to the well, outline each and identify the ownership thereof (both as to working interest and royalty).
3. If more than one lease of different ownership is dedicated to the well, have the interests of all owners been consolidated by communitization, unitization, force-pooling, etc?

☐ Yes ☐ No If answer is "yes," type of consolidation _____

If answer is "no," list the owners and tract descriptions which have actually been consolidated. (Use reverse side of this form if necessary.) _____

No allowable will be assigned to the well until all interests have been consolidated (by communitization, unitization, forced-pooling, or otherwise) or until a non-standard unit, eliminating such interests, has been approved by the Commission.

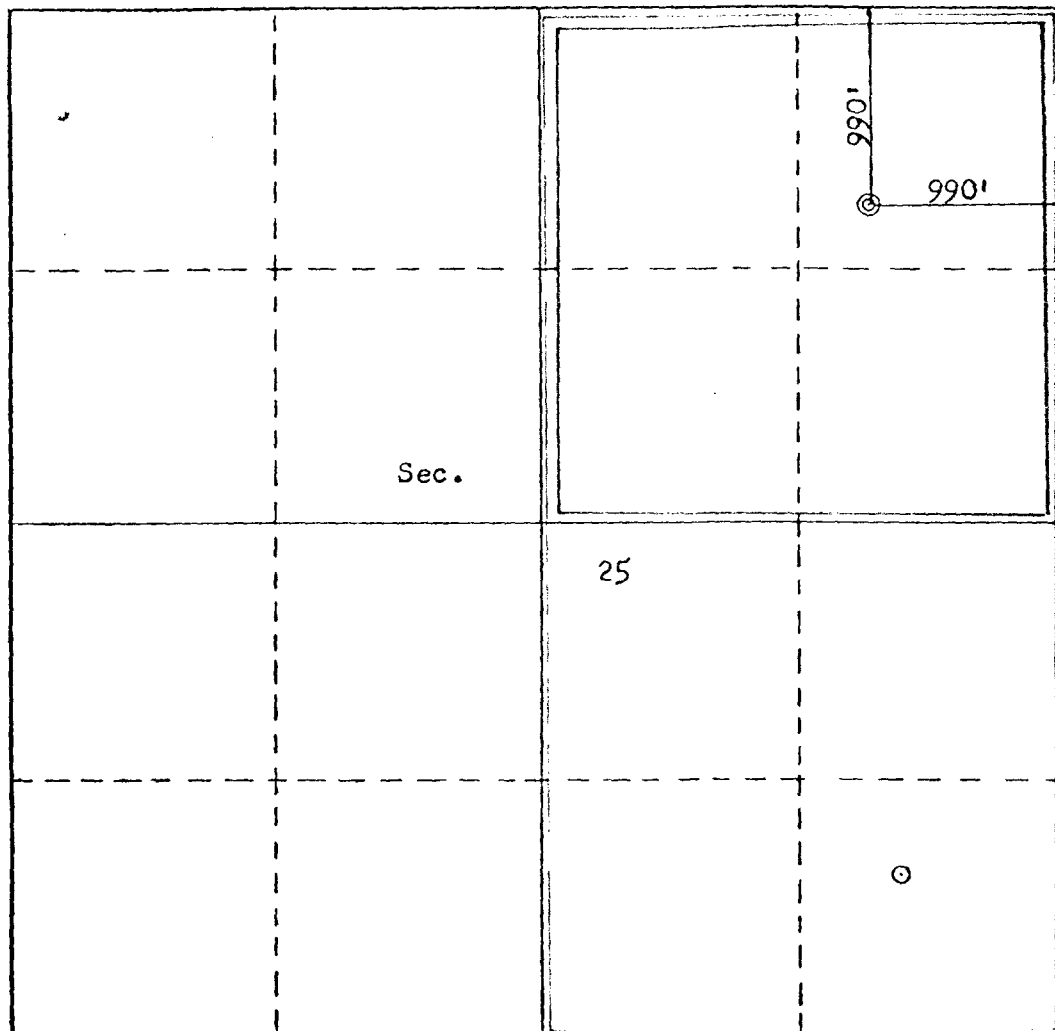

CERTIFICATION

I hereby certify that the information contained herein is true and complete to the best of my knowledge and belief.

Name _____

Position _____

Company _____

Date _____

I hereby certify that the well location shown on this plat was plotted from notes of actual surveys made by me under my supervision, and that the same is true and correct to the best of my knowledge and belief.

Date Surveyed _____

September 14, 1979

Registered Professional Engineer and/or Land Surveyor

Fred B. Kerr Jr.

Certificate No.

3950

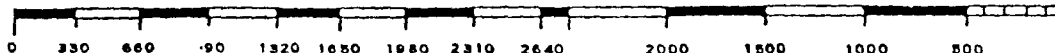

TEKNECO OIL
Penthouse
720 South Colorado Boulevard
Denver, Colorado 80222

WELL LOCATION PLAT AND DESCRIPTION

Well Name VALDEZ COM B-1
Location: 825 1670
1850 FSL 1850 FEL Section 24, T 29N, R 11W
1/4-1/4-1/4 Section SE NW SE County San Juan State New Mexico
Lease No.: Federal State NM 481 482 483 484 530 Fee
MV 320
Spacing Unit Chacra 160 Acres: Description Mesaverde: E/2 Chacra: SE/4
Location meets State rules Yes Field Rules Yes
Deepest Objective Mesaverde Est. TD 4500 Est. G.L. Elev 5450

Plat Scale: 1" = 1000 ft.

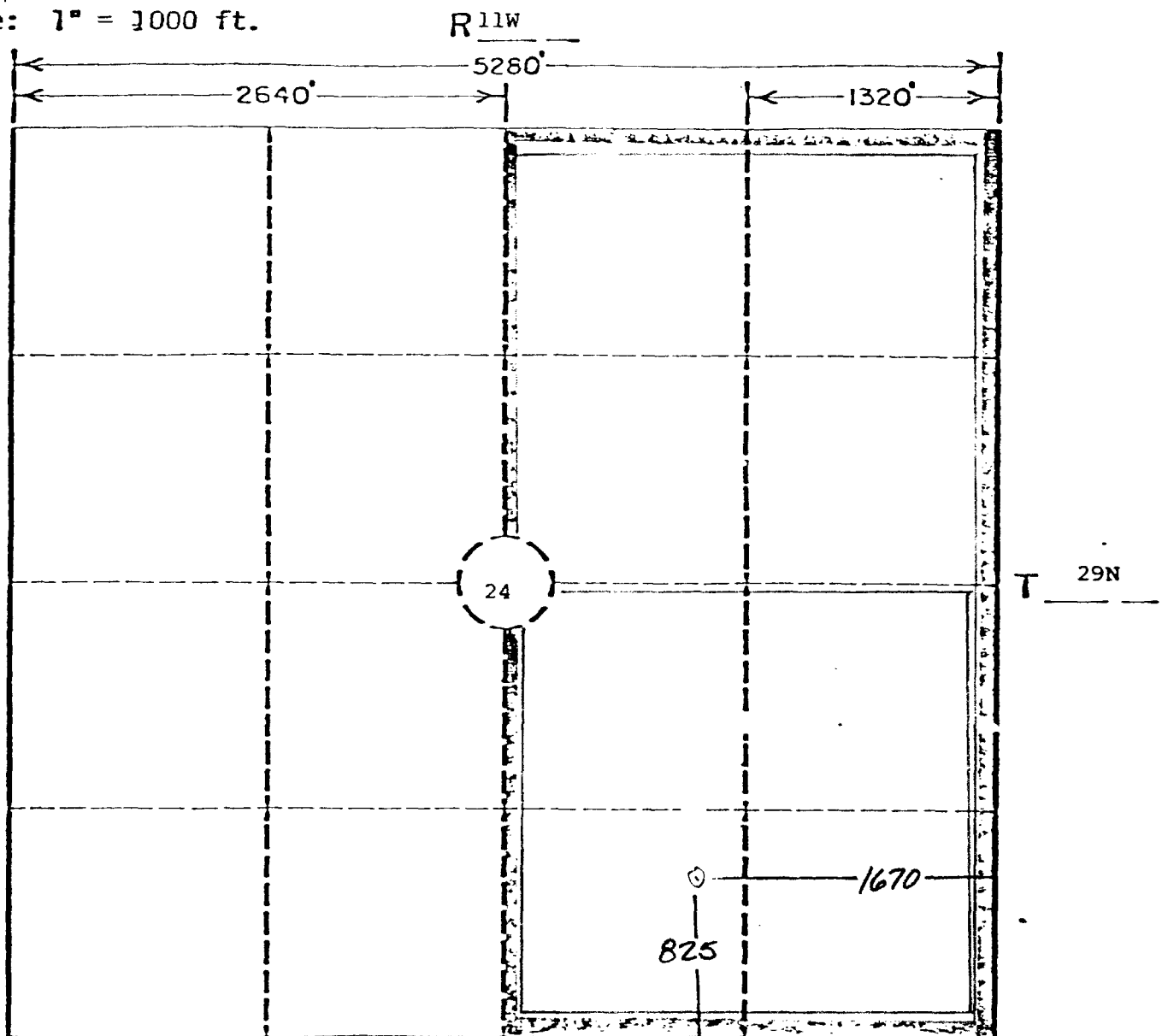

Preferred direction for relocation within legal boundaries shown SE
If relocation of more than 0 feet is necessary, please contact Carol Peavey
 in the G.E. Section.

Prepared by Doug Brandon Approved by Original Signed By: R. H. CASTLE Date October 24, 1979

cc: Well File
Land
Properties
Administrative
Drilling

All distances must be from the outer boundaries of the Section.

Operator TENNECO OIL COMPANY			Lease BRUCE SULLIVAN COM B		Well No. 1
Unit Letter D	Section 25	Township 29N	Range 11W	County San Juan	
Actual Footage Location of Well:					
790 feet from the North line and		790 feet from the West line			
Ground Level Elev. 5457	Producing Formation		Pool	Dedicated Acreage: Acres	

1. Outline the acreage dedicated to the subject well by colored pencil or hatchure marks on the plat below.
2. If more than one lease is dedicated to the well, outline each and identify the ownership thereof (both as to working interest and royalty).
3. If more than one lease of different ownership is dedicated to the well, have the interests of all owners been consolidated by communitization, unitization, force-pooling, etc?

☐ Yes ☐ No If answer is "yes," type of consolidation _____

If answer is "no," list the owners and tract descriptions which have actually been consolidated. (Use reverse side of this form if necessary.) _____

No allowable will be assigned to the well until all interests have been consolidated (by communitization, unitization, forced-pooling, or otherwise) or until a non-standard unit, eliminating such interests, has been approved by the Commission.

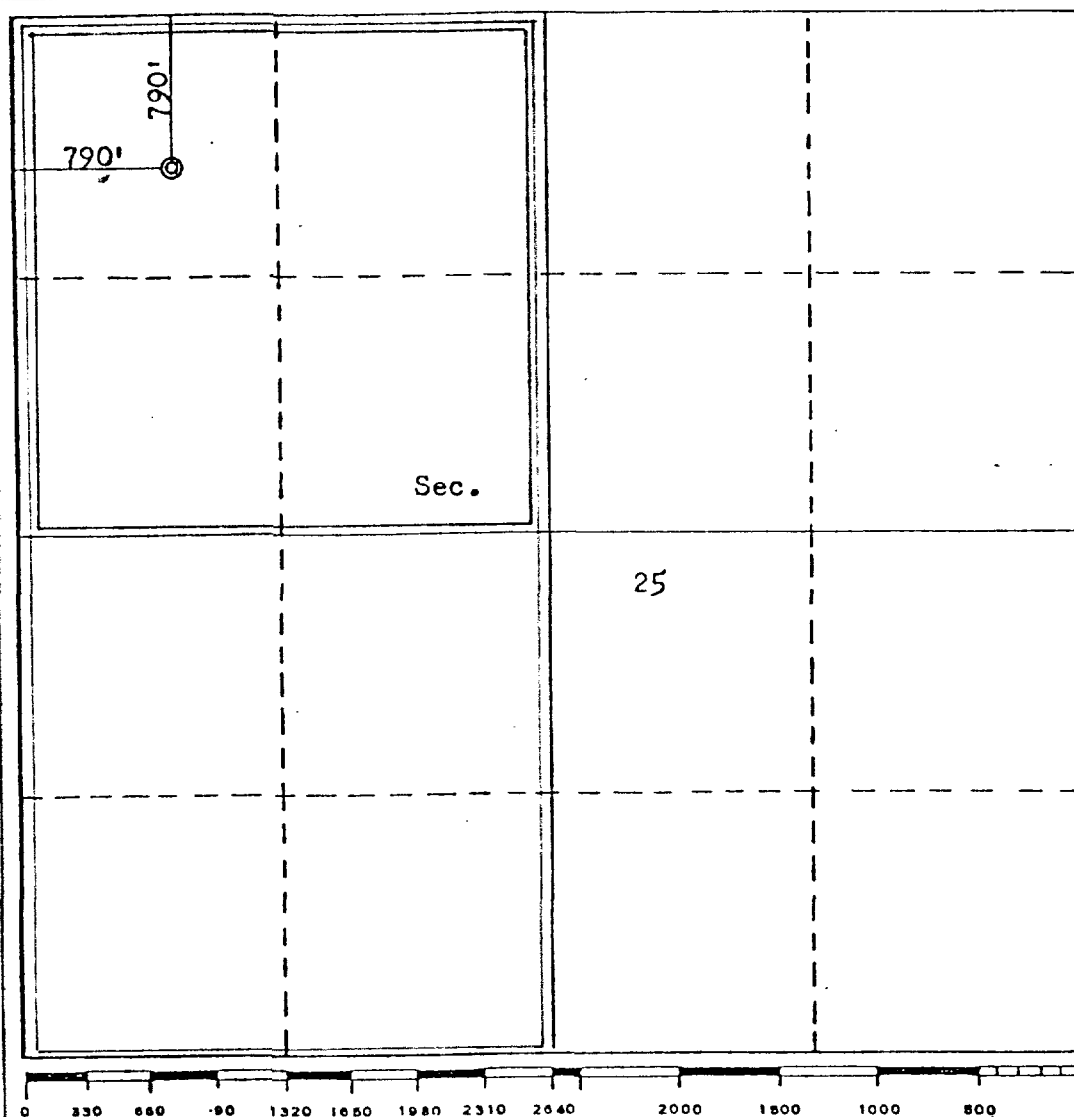

CERTIFICATION

I hereby certify that the information contained herein is true and complete to the best of my knowledge and belief.

Name

Position

Company

Date

I hereby certify that the well location shown on this plat was plotted from field notes of actual surveys made by me or under my supervision, and that the same is true and correct to the best of my knowledge and belief.

Date Surveyed

November 26, 1979

Registered Professional Engineer and/or Land Surveyor

Fred B. Kerr, Jr.

Certification No. B. KERR, JR.

3950

OIL CONSERVATION DIVISION

STATE OF NEW MEXICO
ENERGY AND MINERALS DEPARTMENTP. O. BOX 2088
SANTA FE, NEW MEXICO 87501Form C-102
Revised 10-1-78

All distances must be from the outer boundaries of the Section.

Operator TENNECO OIL COMPANY			Lease SULLIVAN GAS UNIT "A"		Well No. 1-E
Unit Letter M	Section 25	Township 29N	Range 11W	County San Juan	
Actual Footage Location of Well: 990 feet from the South line and 990 feet from the West line					
Ground Level Elev. 5583	Producing Formation		Pool	Dedicated Acreage: Acres	

1. Outline the acreage dedicated to the subject well by colored pencil or hachure marks on the plat below.
2. If more than one lease is dedicated to the well, outline each and identify the ownership thereof (both as to working interest and royalty).
3. If more than one lease of different ownership is dedicated to the well, have the interests of all owners been consolidated by communitization, unitization, force-pooling, etc?

☐ Yes ☐ No If answer is "yes," type of consolidation _____

If answer is "no," list the owners and tract descriptions which have actually been consolidated. (Use reverse side of this form if necessary.) _____

No allowable will be assigned to the well until all interests have been consolidated (by communitization, unitization, forced-pooling, or otherwise) or until a non-standard unit, eliminating such interests, has been approved by the Commission.

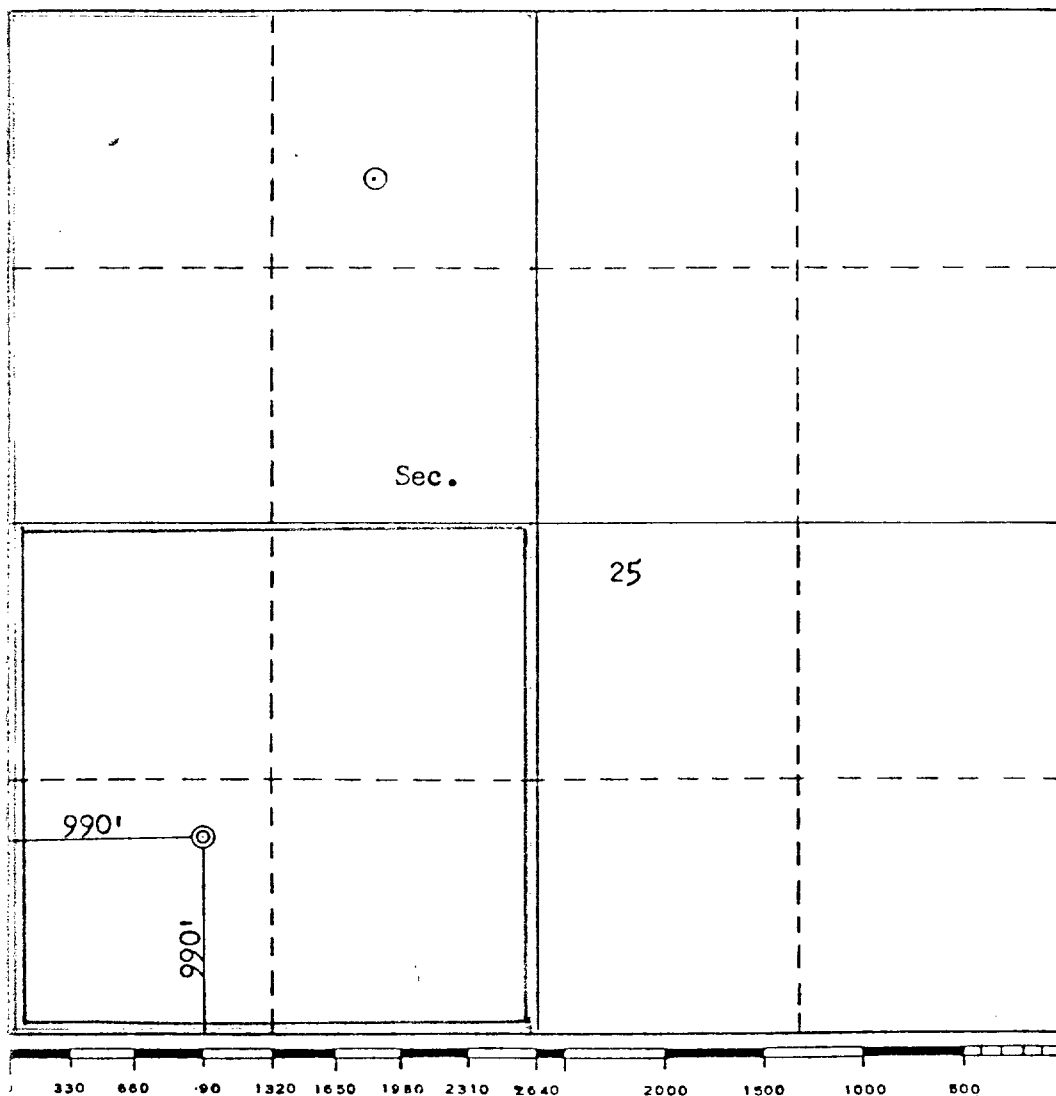

CERTIFICATION

I hereby certify that the information contained herein is true and complete to the best of my knowledge and belief.

Name

Position

Company

Date

I hereby certify that the well location shown on this plat was plotted from field notes of actual surveys made by me or under my supervision, and that the same is true and correct to the best of my knowledge and belief.

Date Surveyed

September 11, 1979

Registered Professional Engineer
and/or Land SurveyorFred B. Kerr, Jr.
Certificate No. 3950

B. KERR, JR.

All distances must be from the outer boundaries of the Section.

Operator TENNECO OIL COMPANY			Lease EATON COM "B"		Well No. 1
Section Letter P	Section 25	Township 29N	Range 11W	County San Juan	
Actual Footage Location of Well: 1040 feet from the South line and 790 feet from the East line					
Ground Level Elev. 5562	Producing Formation		Pool		Dedicated Acreage: Acres

1. Outline the acreage dedicated to the subject well by colored pencil or hachure marks on the plat below.
2. If more than one lease is dedicated to the well, outline each and identify the ownership thereof (both as to working interest and royalty).
3. If more than one lease of different ownership is dedicated to the well, have the interests of all owners been consolidated by communitization, unitization, force-pooling, etc?

☐ Yes ☐ No If answer is "yes," type of consolidation _____

If answer is "no," list the owners and tract descriptions which have actually been consolidated. (Use reverse side of this form if necessary.) _____

No allowable will be assigned to the well until all interests have been consolidated (by communitization, unitization, forced-pooling, or otherwise) or until a non-standard unit, eliminating such interests, has been approved by the Commission.

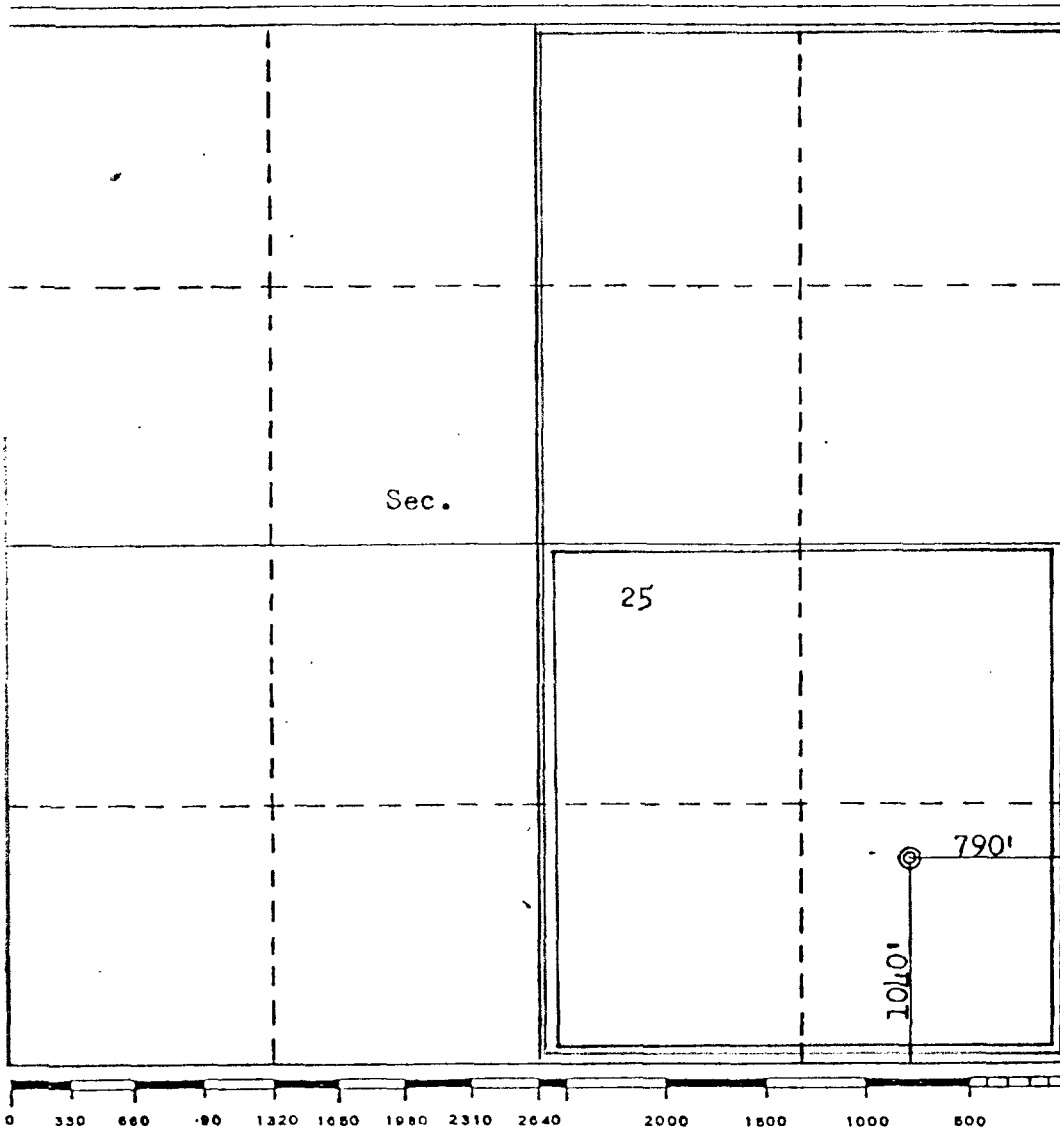

CERTIFICATION

I hereby certify that the information contained herein is true and complete to the best of my knowledge and belief.

Name _____

Position _____

Company _____

Date _____

I hereby certify that the well location shown on this plat was plotted from field notes of actual surveys made by me or under my supervision, and that the same is true and correct to the best of my knowledge and belief.

Date Surveyed _____

November 14, 1979
Registered Professional Engineer
and/or Land Surveyor

Fred B. Kerr, Jr.
Certification No. **3950**
B. KERR, JR.

TENNECO OIL COMPANY
 BLOOMFIELD AREA
 R10+11 W, T29 N
 SAN JUAN COUNTY, NEW MEXICO
 DAKOTA DUAL WITH MESA VERDE-CHACRA COMINGLE

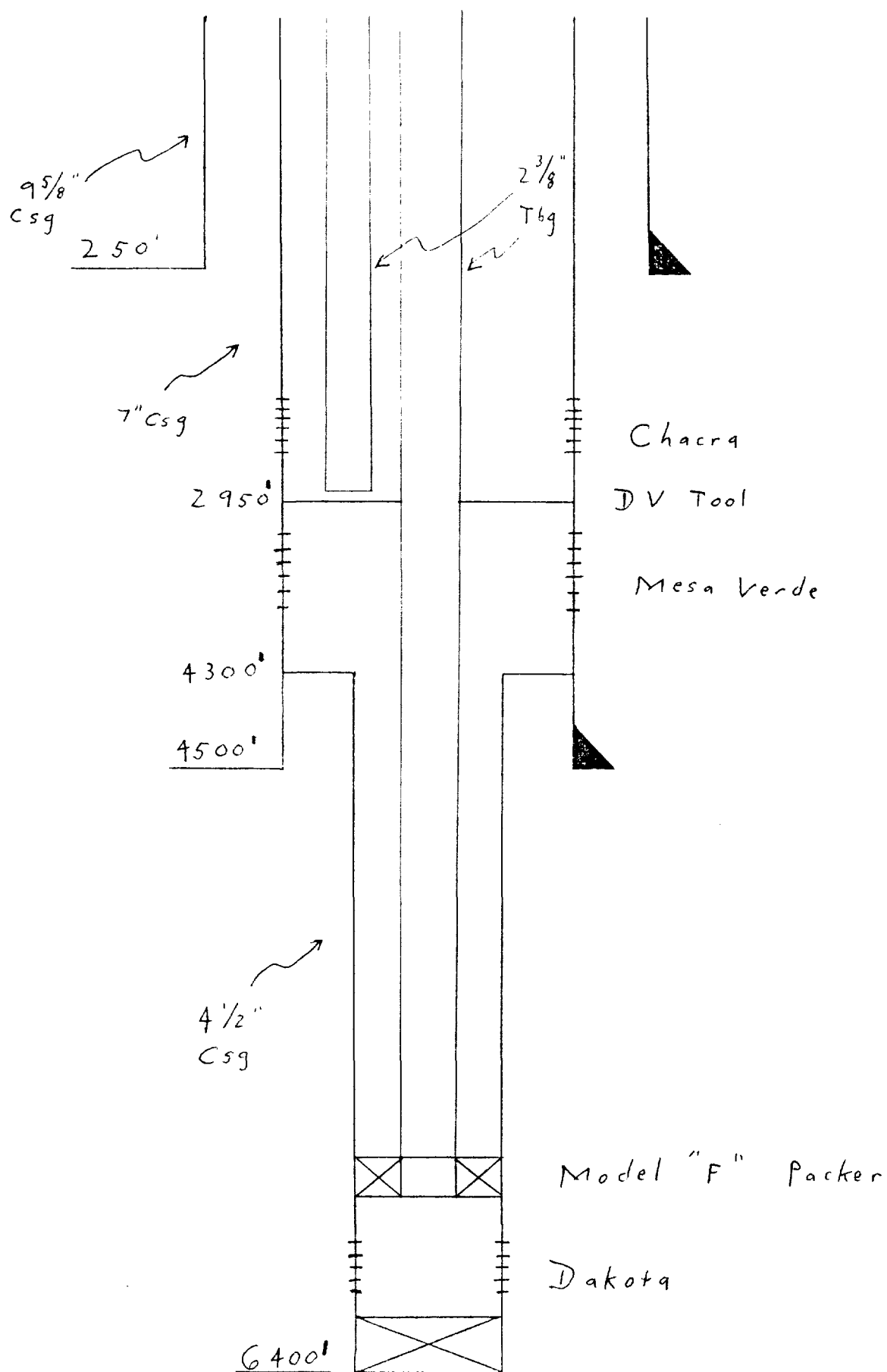

TENNECO OIL COMPANY
BLOOMFIELD AREA
R10&11 W, T29N
SAN JUAN COUNTY, NEW MEXICO
DAKOTA DUAL WITH MESA VERDE-CHACRA COMINGLED

