

**SG INTERESTS I, LTD.**

11-19-92

**ARCHUNDE 29-10-24 #1 WELL**  
**FRUITLAND COAL FORMATION**  
**DRILLING AND SPACING UNIT**  
**SECTION 24: N/2 TOWNSHIP 29 NORTH-RANGE 10 WEST**  
**320.00 ACRES**  
**SAN JUAN COUNTY, NEW MEXICO**

**LOCATION: 1030' FNL AND 640' FEL**

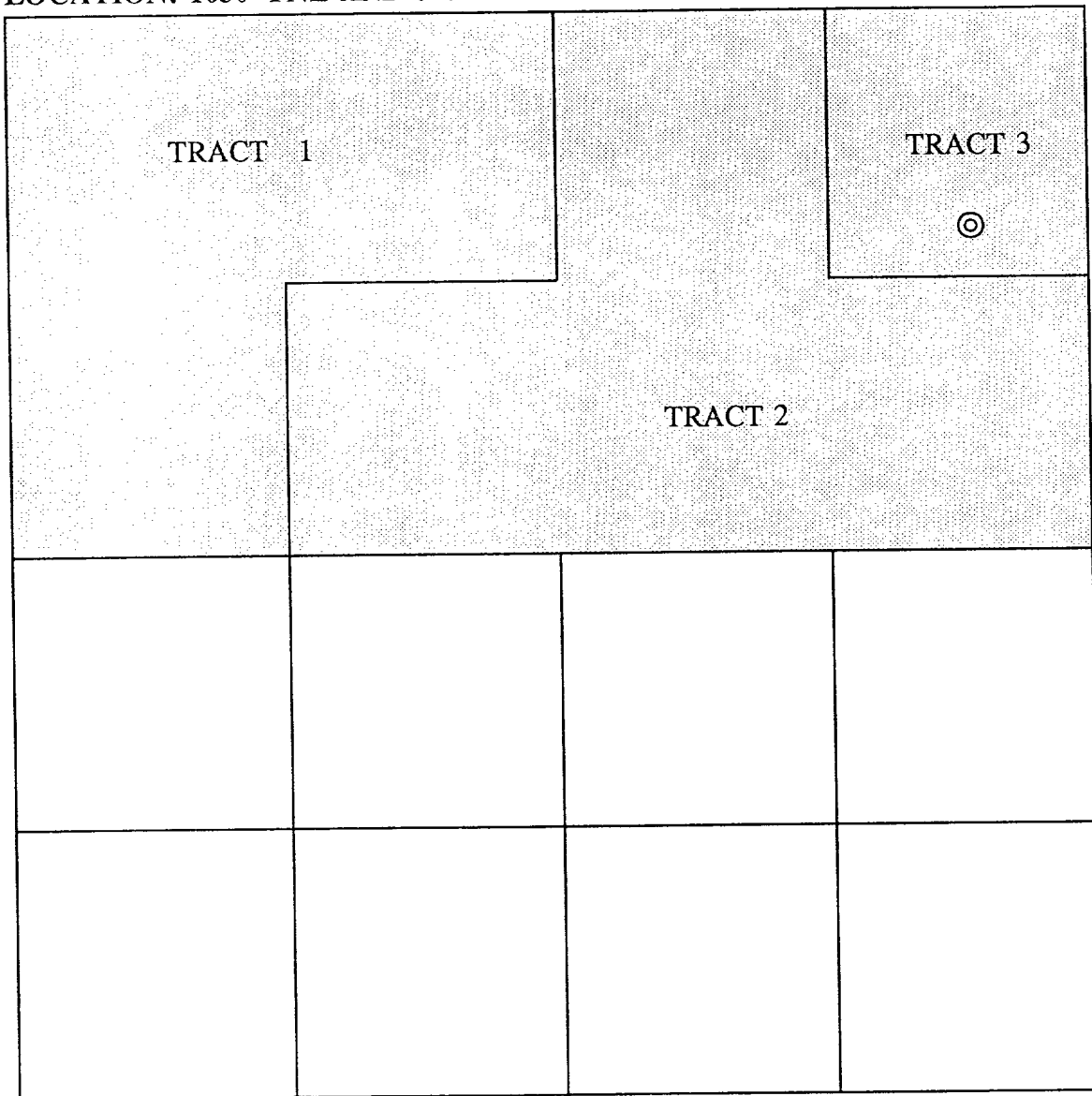

Scale 6" = 1 Mile

III0702.EX

Application of SG Interests I, Ltd. for  
Compulsory Pooling

Case No. 10609 & 10610

Examiner Hearing Docket Dated 11/19/92

Exhibit No. 1