

CASE

201-5

APPLICATION OF EXXON CORPORATION FOR  
AN UNORTHODOX GAS WELL LOCATION AND  
SIMULTANEOUS DEDICATION, REA COUNTY, NEW  
MEXICO.

Applicant, in the above-stated case, seeks approval of  
an unorthodox gas well location for its existing John D.  
Knox Well No. 11 located 2310 feet from the South line and  
336 feet from the E. + line (Unit I) of Section 10, Township  
21 South, Range 36 East, Eureka Gas Pool. Said well to  
be simultaneously dedicated with the John D. Knox Well Nos.  
1 and 13 located in Unit J and H, respectively, of said Section  
10 to ~~the~~ existing 320-acre Eureka Gas spacing and  
production unit comprising the E<sub>1/2</sub> of said Section 10. Said unit  
is located approximately one mile southeast of Cit  
Center, New Mexico.

and approved the simultaneous dedication of said acreage to the El Paso Tom Federal Well Nos. 5, 6, 7 and 8, is hereby rescinded on a permanent basis.

Sincerely,

WILLIAM J. LEMAY  
Director

cc: Oil Conservation Division - Hobbs  
U.S. Bureau of Land Management - Carlsbad  
File: NSL-3172(SD)



STATE OF NEW MEXICO  
ENERGY, MINERALS AND NATURAL RESOURCES DEPARTMENT  
OIL CONSERVATION DIVISION



BRUCE KING  
GOVERNOR

ANITA LOCKWOOD  
CABINET SECRETARY

February 1, 1993

POST OFFICE BOX 2088  
STATE LAND OFFICE BUILDING  
SANTA FE, NEW MEXICO 87504  
(505) 827-5800

Exxon Company U.S.A.  
P.O. Box 1600  
Midland, Texas 79702-1600

Attn: Alex M. Correa

*RE: Administrative Application for an Unorthodox Gas  
Well Location, John D. Knox Well No. 11  
2310' FSL - 330' FEL (Unit I) Section 10,  
Township 21 South, Range 36 East, NMPM,  
Eumont Gas Pool, Lea County, New Mexico.*

Dear Mr. Correa:

10674

The Division has received an objection to the subject application, filed with the Division on January 25, 1993, from Conoco, Inc. (see copy of letter attached).

This matter will be set for hearing before a Division Examiner on the next available docket scheduled for February 18, 1993. Please provide the required notice in this matter pursuant to Division General Rule 1207.A(5).

Should you have any questions or comments concerning this matter, please contact me at (505) 827-5811 or FAX (505) 827-5741.

Sincerely,

MICHAEL E. STOGNER  
Chief Hearing Officer/Engineer

MES/jc

cc: OCD - Hobbs  
W. Thomas Kellahin - Santa Fe

KELLAHIN AND KELLAHIN

ATTORNEYS AT LAW

EL PATIO BUILDING

117 NORTH GUADALUPE

POST OFFICE BOX 2265

SANTA FE, NEW MEXICO 87504-2265

TELEPHONE (505) 982-4285  
TELEFAX (505) 982-2047

W. THOMAS KELLAHIN\*

\*NEW MEXICO BOARD OF LEGAL SPECIALIZATION  
RECOGNIZED SPECIALIST IN THE AREA OF  
NATURAL RESOURCES-OIL AND GAS LAW

JASON KELLAHIN (RETIRED 1991)

January 29, 1993

Oil Conservation Division  
310 Old Santa Fe Trail  
Santa Fe, New Mexico 87504

VIA FACSIMILE  
(505) 827-5741

Attn: Mr. Michael E. Stogner

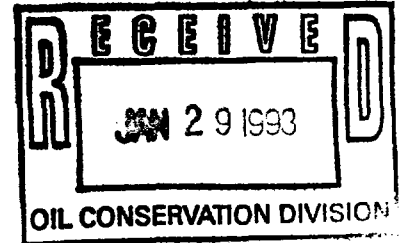

Re: NOTICE OF OBJECTION:

Exxon Corp.'s John D. Knox Well #11  
E/2 Section 10, T21SR36E, NMPM,  
Administrative Application to NMOCD  
for Approval of Unorthodox Gas Well  
Location, Non-Standard Proration Unit and  
Simultaneous Dedication, Eumont Yates Seven  
Rivers Queen Pool, Lea County, New Mexico

Dear Mr. Stogner:

By letter dated January 11, 1993 and received by  
Conoco on January 18, 1993, Exxon Corp. sent notification  
to the offsetting operators of the referenced request.

On behalf of Conoco Inc., as an offsetting operator,  
we hereby object to the application by Exxon Corp. for an  
unorthodox gas well location, non-standard proration unit  
and simultaneous dedication for its John D. Knox Well #11  
as described in its administrative application to the  
Division which we believe was received by the Division on  
January 25, 1993.

We request that this matter be set for hearing and  
that Conoco Inc. be provided notification of the hearing  
in accordance with Division notice rules.

Very truly yours,

  
W. Thomas Kellahin

cc: Jerry Hoover (Conoco-Midland)  
cc: Exxon Corp. (Midland)  
Attn: Alex M. Correa

**KELLAHIN AND KELLAHIN**

ATTORNEYS AT LAW

EL PATIO BUILDING

117 NORTH GUADALUPE

POST OFFICE BOX 2265

SANTA FE, NEW MEXICO 87504-2265

W. THOMAS KELLAHIN\*

\*NEW MEXICO BOARD OF LEGAL SPECIALIZATION  
RECOGNIZED SPECIALIST IN THE AREA OF  
NATURAL RESOURCES-OIL AND GAS LAW

JASON KELLAHIN (RETIRED 1991)

TELEPHONE (505) 982-4285  
TELEFAX (505) 982-2047

January 29, 1993

Oil Conservation Division  
310 Old Santa Fe Trail  
Santa Fe, New Mexico 87504

**VIA FACSIMILE**  
(505) 827-5741

Attn: Mr. Michael E. Stogner

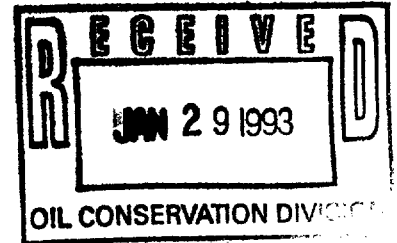

Re: **NOTICE OF OBJECTION:**

Exxon Corp.'s John D. Knox Well #11  
E/2 Section 10, T21SR36E, NMPM,  
Administrative Application to NMOCD  
for Approval of Unorthodox Gas Well  
Location, Non-Standard Proration Unit and  
Simultaneous Dedication, Eumont Yates Seven  
Rivers Queen Pool, Lea County, New Mexico

Dear Mr. Stogner:

By letter dated January 11, 1993 and received by  
Conoco on January 18, 1993, Exxon Corp. sent notification  
to the offsetting operators of the referenced request.

On behalf of Conoco Inc., as an offsetting operator,  
we hereby object to the application by Exxon Corp. for an  
unorthodox gas well location, non-standard proration unit  
and simultaneous dedication for its John D. Knox Well #11  
as described in its administrative application to the  
Division which we believe was received by the Division on  
January 25, 1993.

We request that this matter be set for hearing and  
that Conoco Inc. be provided notification of the hearing  
in accordance with Division notice rules.

Very truly yours,

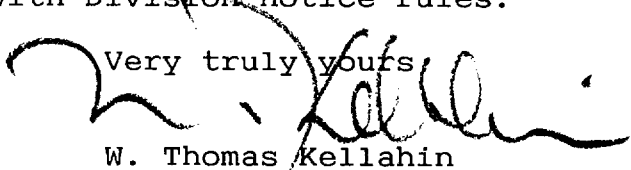
  
W. Thomas Kellahin

cc: Jerry Hoover (Conoco-Midland)  
cc: Exxon Corp. (Midland)  
Attn: Alex M. Correa

## KELLAHIN AND KELLAHIN

ATTORNEYS AT LAW

EL PATIO BUILDING

117 NORTH GUADALUPE

POST OFFICE BOX 2265

SANTA FE, NEW MEXICO 87504-2265

TELEPHONE (505) 982-4285

TELEFAX (505) 982-2047

W. THOMAS KELLAHIN\*

\*NEW MEXICO BOARD OF LEGAL SPECIALIZATION  
RECOGNIZED SPECIALIST IN THE AREA OF  
NATURAL RESOURCES-OIL AND GAS LAW

JASON KELLAHIN (RETIRED 1991)

January 29, 1993

Oil Conservation Division  
310 Old Santa Fe Trail  
Santa Fe, New Mexico 87504

VIA FACSIMILE  
(505) 827-5741

Attn: Mr. Michael E. Stogner

Re: NOTICE OF OBJECTION:

Exxon Corp.'s ~~John D. Knox Well #11~~  
E/2 Section 10, T21SR36E, NMPM,  
Administrative Application to NMOCB  
for Approval of Unorthodox Gas Well  
Location, Non-Standard Proration Unit and  
Simultaneous Dedication, Eumont Yates Seven  
Rivers Queen Pool, Lea County, New Mexico

Dear Mr. Stogner:

By letter dated January 11, 1993 and received by  
Conoco on January 18, 1993, Exxon Corp. sent notification  
to the offsetting operators of the referenced request.

~~On behalf of Conoco Inc., as an offsetting operator,~~  
~~we hereby object to the application by Exxon Corp. for an~~  
~~unorthodox gas well location, non-standard proration unit~~  
~~and simultaneous dedication for its John D. Knox Well #11~~  
as described in its administrative application to the  
Division which we believe was received by the Division on  
January 25, 1993.

We request that this matter be set for hearing and  
that Conoco Inc. be provided notification of the hearing  
in accordance with Division notice rules.

Very truly yours,

  
W. Thomas Kellahin

cc: Jerry Hoover (Conoco-Midland)  
cc: Exxon Corp. (Midland)  
Attn: Alex M. Correa

## KELLAHIN AND KELLAHIN

ATTORNEYS AT LAW

EL PATIO BUILDING

117 NORTH GUADALUPE

Post Office Box 2265

SANTA FE, NEW MEXICO 87504-2265

W. THOMAS KELLAHIN\*

\*NEW MEXICO BOARD OF LEGAL SPECIALIZATION  
RECOGNIZED SPECIALIST IN THE AREA OF  
NATURAL RESOURCES-OIL AND GAS LAWTELEPHONE (505) 982-4265  
TELEFAX (505) 982-2047

JASON KELLAHIN (RETIRED 1991)

FACSIMILE COVER SHEET

DATE: January 29, 1993

NUMBER OF PAGES: 2  
(including cover sheet)

TIME: 3:35-

TO: Michael E. Stogner

FROM: W. Thomas Kellahin

OF: Oil Conservation Division

## SPECIAL INSTRUCTIONS:

FAX NO.: 827-5741

☐ URGENT

RE: Exxon Corp.'s John D. Knox

☐ FOR YOUR INFORMATION

Well #11/Administrative

☒ FOR YOUR REVIEW

Application for Unorthodox

☐ PLEASE REPLY

Location

☐ FOR YOUR APPROVAL☐ PER YOUR REQUESTMESSAGE: A letter dated today to you regarding the above  
application follows. A hard copy will be delivered by hand.A HARD COPY ☒ WILL ☐ WILL NOT FOLLOW BY U.S. MAIL.

**EXXON** COMPANY, U.S.A.

POST OFFICE BOX 1600 • MIDLAND, TEXAS 79702-1600

PRODUCTION DEPARTMENT  
SOUTHWESTERN DIVISION

ENVIRONMENTAL AND REGULATORY AFFAIRS

669437 6 10 10 21  
10 10 21  
10 10 21

**January 21, 1993**

Unorthodox Location  
Non-Standard Proration Unit  
Simultaneous Dedication  
John D. Knox Well #11  
Units: 1  
Section 10, T21S-R36E  
Lea County, NM  
Eumont Yates Seven Rivers Queens (Pro Gas)

Mr. Michael E. Stogner  
New Mexico Oil Conservation Division  
P. O. Box 2088  
Santa Fe, New Mexico 87504-2088

Dear Mr. Stogner:

Exxon Corporation requests administrative approval for an Unorthodox Locations for the John D. Knox #11. Form C-101 and C-102 are attached. This well is located in Section 10, T21S-R36E, Lea County and will be recompleted in the Eumont Yates Seven Rivers Queen (Pro Gas) Pool. The request for administrative approval is based on Rule 104-F(1) since the recompletion is from a deeper horizon and the well was at an orthodox location for the Oil Center Blinbry.

Administrative approval is also requested for Non-Standard Proration Unit and Simultaneous Dedication. The C-102 shows 320 acres instead of the standard 640 acres and this same acreage will be simultaneously dedicated with the John D. Knox well numbers 1 and 13. Both are on the proration schedule with an acreage factor of 2.00 (copy attached).

The following offset operators have been notified: Chevron, Conoco, Devon Energy Corp., Oryx Energy Co., and Oxy USA. A copy of the returned receipts are enclosed. If they have no objections, I have requested that they execute a waiver and send one copy to the N.M.O.C.D. and one to me.

If there are any questions, please call me at 915/688-6782.

Sincerely,



Alex M. Correa

AMC/mcn  
Enclosure  
B:16.AMC



**EXXON** COMPANY, U.S.A.

POST OFFICE BOX 1600 • MIDLAND, TEXAS 79702-1600

PRODUCTION DEPARTMENT  
SOUTHWESTERN DIVISION

ENVIRONMENTAL AND REGULATORY AFFAIRS

January 21, 1993

Unorthodox Location  
Non-Standard Proration Unit  
Simultaneous Dedication  
John D. Knox Well #11  
Unit: I  
Section 10, T21S-R36E  
Lea County, New Mexico  
Eumont Yates Seven Rivers Queen (Pro Gas)

Mr. Jerry Sexton  
New Mexico Oil Conservation Division  
P. O. Box 1980  
Hobbs, New Mexico 88240

Dear Mr. Sexton:

Exxon Corp. has requested administrative approval of an Unorthodox Location, Non-Standard Proration Unit and Simultaneous Dedication for the John D. Knox well #11. This well is located in Unit: I, Section 10, T21S-R36E, Lea County, New Mexico. The following information is enclosed: copy of the letter to the N.M.O.C.D., Santa Fe, Attn: M. Stogner; form C-101; form C-102; list of offset operators; and a plat showing offset operators.

The offset operators have been notified by certified mail (return receipt requested) and waivers have been requested. If there are any questions, please call me at 915/688-6782.

Sincerely,



Alex M. Correa

AMC/mcn  
Enclosure  
B:21.AMC

**EXXON** COMPANY, U.S.A.

POST OFFICE BOX 1600 • MIDLAND TEXAS 79702-1600

PRODUCTION DEPARTMENT  
SOUTHWESTERN DIVISION

ENVIRONMENTAL AND REGULATORY AFFAIRS

*sent certified mail to  
offset operators 1/12/93*

January 11, 1993

Unorthodox Location  
Non-Standard Proration Unit  
Simultaneous Dedication  
John D. Knox Well #11  
Unit: I  
Section 10, T21S-R36E  
Lea County, NM  
Eumont Yates Seven Rivers Queens (Pro Gas)

Offset Operators

Gentlemen:

Exxon Corp. has requested administrative approval for an Unorthodox Location, Non-Standard Proration Unit, and Simultaneous Dedication for the John D. Knox well #11. This well is to be plugged back to the Eumont Yates Seven Rivers Queen (Pro Gas) Pool. A copy of the application and plats are attached.

If you have no objection to the above referenced Unorthodox Location, Non-Standard Proration Unit, and Simultaneous Dedication, please sign and return one copy of the waiver to the N.M.O.C.D. Office in Santa Fe and one copy to me. Return envelopes are enclosed. If you have any questions, please call me at 915/688-6782.

Sincerely,

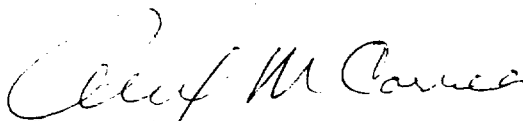
  
Alex M. Correa

AMC/mcn  
Enclosure  
B:15.AMC

Submit to Appropriate  
District Office  
State Lease -- 6 copies  
Fee Lease -- 5 copies

Energy, Minerals and Natural Resources Department

Form C 101  
Revised 1-1-89

OIL CONSERVATION DIVISION

DISTRICT I  
P.O. Box 1980, Hobbs, NM 88240

P.O. Box 2088  
Santa Fe, New Mexico 87504-2088

DISTRICT II  
P.O. Drawer DD, Artesia, NM 88210

DISTRICT III  
1000 Rio Brazos Rd., Aztec, NM 87410

API NO. (assigned by OCD on New Wells)  
**3002520306**

5. Indicate Type of Lease  
STATE ☐ FEE ☒

6. State Oil & Gas Lease No.  
**FEE**

APPLICATION FOR PERMIT TO DRILL, DEEPEN, OR PLUG BACK

1a. Type of Work:

DRILL ☐ RE-ENTER ☐ DEEPEN ☐ PLUG BACK ☒

1b. Type of Well:

OIL WELL ☐ GAS WELL ☒ OTHER ☐ SINGLE ZONE ☒ MULTIPLE ZONE ☐

2. Name of Operator

**EXXON CORPORATION**

8. Well No.

**11**

3. Address of Operator

**ATTN: REGULATORY AFFAIRS  
P. O. BOX 1600  
MIDLAND, TX 79702**

9. Pool name or Wildcat

**EUMONT YATES 7 RIVERS QUEEN**

4. Well Location

Unit Letter **I** : **2310** Feet From The **SOUTH** Line and **330** Feet From The **EAST** Line

Section **10** Township **21S** Range **36E** NMPM **LEA** County

10. Proposed Depth  
**6225**

11. Formation  
**QUEEN**

12. Rotary or C.T.  
**CT**

13. Elevations (Show whether DF, RT, GR, etc.)  
**3597 DF**

14. Kind & Status Plug. Bond  
**BLANKET**

15. Drilling Contractor  
**UNKNOWN**

16. Approx. Date Work will start  
**ASAP**

17. PROPOSED CASING AND CEMENT PROGRAM

SIZE OF HOLE	SIZE OF CASING	WEIGHT PER FOOT	SETTING DEPTH	SACKS OF CEMENT	EST. TOP
<b>11</b>	<b>7 5/8</b>	<b>24</b>	<b>1329</b>	<b>575</b>	<b>SURF.</b>
<b>6 3/4</b>	<b>4 1/2</b>	<b>9.5, 11.6</b>	<b>6225</b>	<b>500</b>	<b>2400</b>

1. ABANDON BLINEBRY PERFS. 5812-5945' BY SETTING CIBP @ +/- 5762' WITH A MIN. OF 35' CMT.
2. PERF. QUEEN 3396'-3580', AC. APPROX. 2500 GAL., FRAC. APPROX. 149000 # + 40300 GAL.

IN ABOVE SPACE DESCRIBE PROPOSED PROGRAM: IF PROPOSAL IS TO DEEPEN OR PLUG BACK, GIVE DATA ON PRESENT PRODUCTIVE ZONE AND PROPOSED NEW PRODUCTIVE ZONE. GIVE BLOWOUT PREVENTER PROGRAM, IF ANY.

I hereby certify that the information above is true and complete to the best of my knowledge and belief.

SIGNATURE

*Alex M. Correa*

TITLE **Administrative Specialist**

DATE **01/08/93**

TYPE OR PRINT NAME **Alex M. Correa**

**(915) 688-6782** TELEPHONE NO.

(This space for State Use)

APPROVED BY \_\_\_\_\_ TITLE \_\_\_\_\_ DATE \_\_\_\_\_

CONDITIONS OF APPROVAL, IF ANY:

Submit to Appropriate  
District Office  
State Lease-4 copies  
Fee Lease-3 copies

State of New Mexico  
Energy, Minerals and Natural Resources Department

Form C-102  
Revised 1-1-89

OIL CONSERVATION DIVISION

P.O. Box 2088  
Santa Fe, New Mexico 87504-2088

DISTRICT I  
P.O. Box 1980, Hobbs, NM 88240

DISTRICT II  
P.O. Drawer DD, Artesia, NM 88210

DISTRICT III  
1000 Rio Brazos Rd., Aztec, NM 87410

WELL LOCATION AND ACREAGE DEDICATION PLAT

All distances must be from the outer boundaries of the Section.

Operator Exxon Corporation			Lease JOHN D. KNOX		Well No. 11
Unit Letter I	Section 10	Township 21S	Range 36E	NMPM	County LEA
Actual Footage Location of Well: 2310 feet from the SOUTH line and 330 feet from the EAST line.					
Ground level Elev. ?	Producing Formation QUEEN (GAS)		Pool EUMONT YATES 7 RVRS. QN.(PRO. GAS)		Dedicated Acreage: 320 Acres

- Outline the acreage dedicated to the subject well by colored pencil or hachure marks on the plat below.
- If more than one lease is dedicated to the well, outline each and identify the ownership thereof (both as to working interest and royalty).
- If more than one lease of different ownership is dedicated to the well, have the interest of all owners been consolidated by communitization, unitization, force-pooling, etc?  
☐ Yes ☐ No If answer is "yes", type of consolidation \_\_\_\_\_  
If answer is "no", list the owners and tract descriptions which have actually been consolidated. (Use reverse side of this form if necessary.) \_\_\_\_\_  
No allowable will be assigned to the well until all interests have been consolidated (by communitization, unitization, forced-pooling, or otherwise) or until a non-standard unit, eliminating such interest, has been approved by the Division.

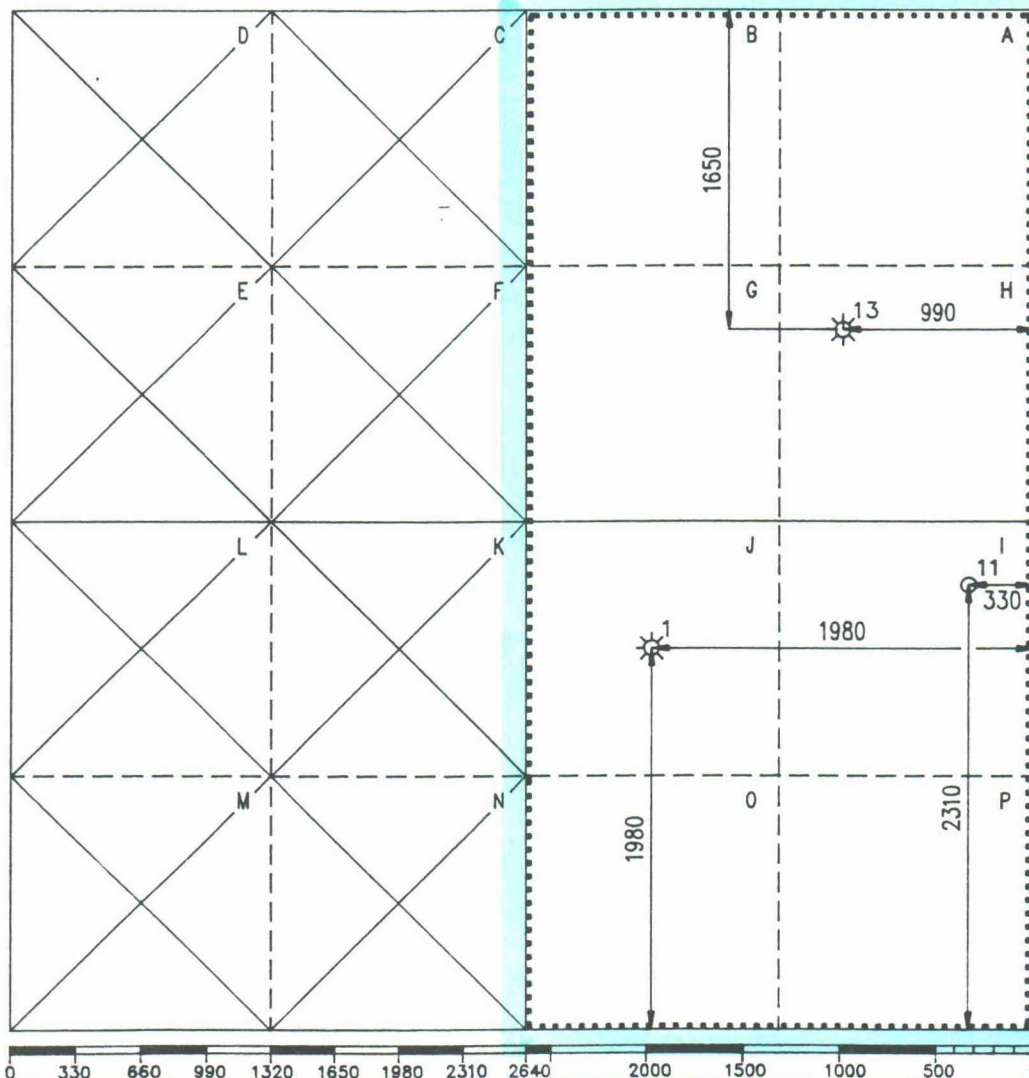

OPERATOR CERTIFICATION

I hereby certify that the information  
contained herein is true and complete to the  
best of my knowledge and belief.

Signature C. H. Harper  
Printed Name  
C. H. HARPER  
Position PERMITS SUPERVISOR  
Company Exxon Corporation  
P.O. Box 1600-Midland, Tx.-79702  
Date 1-18-93

SURVEYOR CERTIFICATION

I hereby certify that the well location  
shown on this plat was plotted from field  
notes of actual surveys made by me or  
under my supervision, and that the same  
is true and correct to the best of my  
knowledge and belief.

Date Surveyed 11/14/63  
Signature & Seal of  
Professional Surveyor

Certificate No.

6.6 Miles NW of EUNICE, New Mexico.

C.E. File No. A07185c

OWPB PLAT DATE:  
01/08/93 DAC

Offset Operators to the  
John D. Knox #11  
Section 10, T21S-R36E  
Lea County, NM

Eumont Yates Seven Rivers Queen (Pro Gas)

Chevron USA Inc.  
P. O. Box 1150  
Midland, TX 79702  
Attn: Land Department

Conoco Inc.  
P. O. Box 1959  
Midland, TX 79702  
Attn: Land Department

Devon Energy Corporation  
20 North Broadway, Suite 1500  
Oklahoma City, OK 73102-8260  
Attn: Land Department

Oryx Energy Co.  
P. O. Box 2880  
Dallas, TX 75221-2800  
Attn: Land Department

Oxy U.S.A. Inc.  
P. O. Box 50250  
Midland, TX 79710  
Attn: Land Department

AMC/mcn  
B:15.AMC

4

3

2

Oryx Energy Co.

Oryx  
Energy Co.

Oryx Energy Co.

Oxy USA

Chevron

Devon  
Energy Corp.

11

9

Conoco

Chevron

Conoco

Conoco

16

15

14

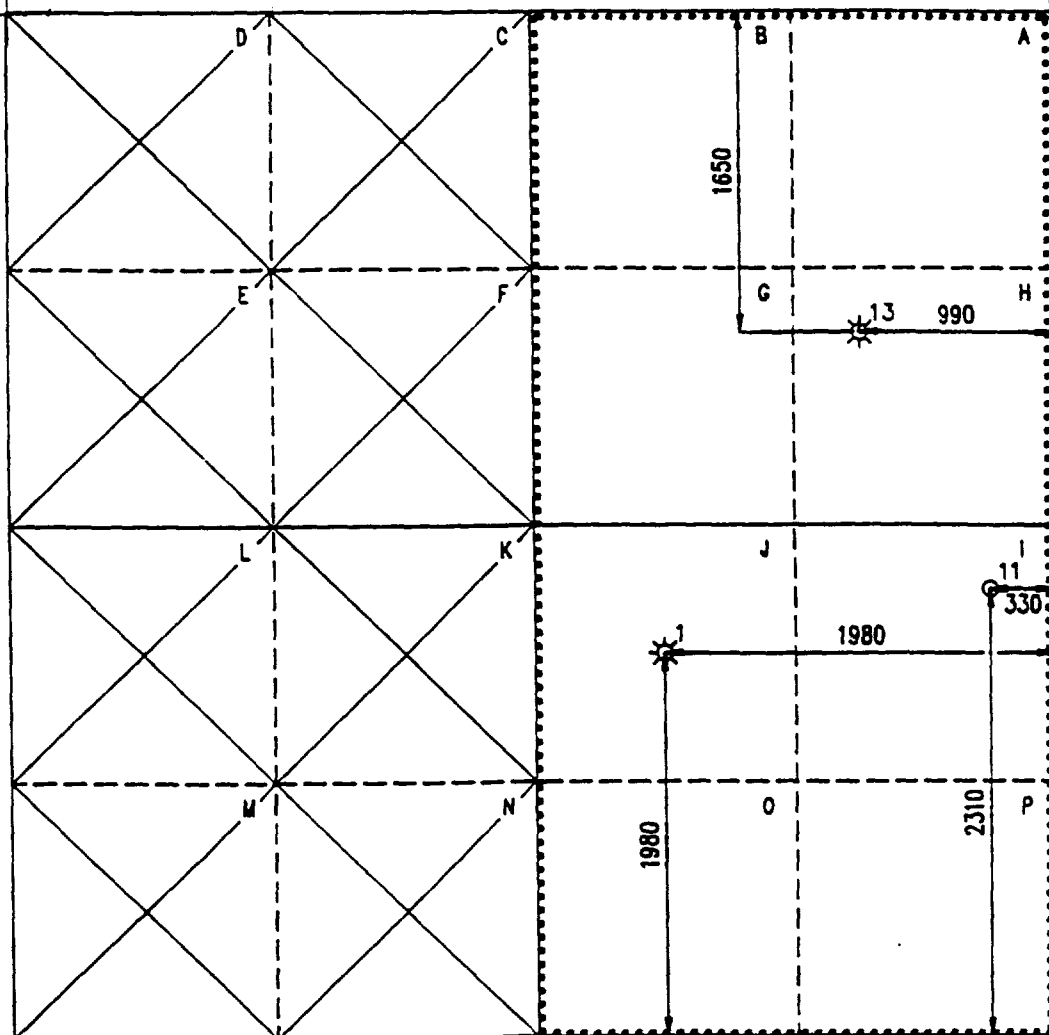

**SENDER: Complete items 1 and 2 when additional services are desired, and complete items 3 and 4.**  
Put your address in the "RETURN TO" Space on the reverse side. Failure to do this will prevent this card from being returned to you. The return receipt fee will provide you the name of the person delivered to and the date of delivery. For additional fees the following services are available. Consult postmaster for fees and check box(es) for additional service(s) requested.

1. ☐ Show to whom delivered, date, and addressee's address. (Extra charge)  
2. ☐ Restricted Delivery (Extra charge)

3. Article Addressed to:  CHEVRON USA INC. LAND DEPARTMENT P. O. BOX 1150 MIDLAND, TX 79702	4. Article Number P 046 797 481 Type of Service: <input checked="" type="checkbox"/> Registered <input type="checkbox"/> Insured <input type="checkbox"/> Certified <input type="checkbox"/> COD <input type="checkbox"/> Express Mail <input checked="" type="checkbox"/> Return Receipt for Merchandise Always obtain signature of addressee or agent and DATE DELIVERED.
5. Signature — Addressee X	8. Addressee's Address (ONLY if requested and fee paid)
6. Signature — Agent X P. Miller	
7. Date of Delivery	

PS Form 3811, Mar. 1988 \* U.S.G.P.O. 1988-212-865 DOMESTIC RETURN RECEIPT

**SENDER: Complete items 1 and 2 when additional services are desired, and complete items 3 and 4.**  
Put your address in the "RETURN TO" Space on the reverse side. Failure to do this will prevent this card from being returned to you. The return receipt fee will provide you the name of the person delivered to and the date of delivery. For additional fees the following services are available. Consult postmaster for fees and check box(es) for additional service(s) requested.

1. ☐ Show to whom delivered, date, and addressee's address. (Extra charge)  
2. ☐ Restricted Delivery (Extra charge)

3. Article Addressed to:  CONOCO INC. LAND DEPARTMENT P. O. BOX 1959 MIDLAND, TX 79702	4. Article Number P-046 797 480 Type of Service: <input checked="" type="checkbox"/> Registered <input type="checkbox"/> Insured <input type="checkbox"/> Certified <input type="checkbox"/> COD <input checked="" type="checkbox"/> Express Mail <input type="checkbox"/> Return Receipt for Merchandise Always obtain signature of addressee or agent and DATE DELIVERED.
5. Signature — Addressee X	8. Addressee's Address (ONLY if requested and fee paid)
6. Signature — Agent X A. Gonzales	
7. Date of Delivery 7-16-93	

PS Form 3811, Apr. 1989 \* U.S.G.P.O. 1989-238-815 DOMESTIC RETURN RECEIPT

● **SENDER:** Complete items 1 and 2 when additional services are desired, and complete items 3 and 4.  
Put your address in the "RETURN TO" Space on the reverse side. Failure to do this will prevent this card from being returned to you. The return receipt fee will provide you the name of the person delivered to and the date of delivery. For additional fees the following services are available. Consult postmaster for fees and check box(es) for additional service(s) requested.

1. ☐ Show to whom delivered, date, and addressee's address. (Extra charge) 2. ☐ Restricted Delivery (Extra charge)

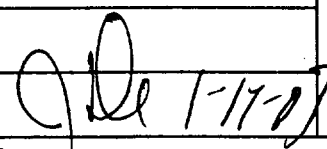
<b>3. Article Addressed to:</b>  <b>DEVON ENERGY CORPORATION</b> <b>LAND DEPARTMENT</b> <b>20 NORTH BROADWAY, SUITE 1500</b> <b>OKLAHOMA CITY, OK 73102-8260</b>	<b>4. Article Number</b> <b>P-046-797-479</b> <b>Type of Service:</b> <input checked="" type="checkbox"/> Registered <input type="checkbox"/> Insured <input type="checkbox"/> Certified <input type="checkbox"/> COD <input type="checkbox"/> Express Mail <input checked="" type="checkbox"/> Return Receipt for Merchandise <b>Always obtain signature of addressee or agent and DATE DELIVERED.</b>
<b>5. Signature — Addressee</b> <b>X</b>	<b>8. Addressee's Address (ONLY if requested and fee paid)</b>
<b>6. Signature — Agent</b> <b>X</b>	
<b>7. Date of Delivery</b> 	

PS Form 3811, Apr. 1989

★ U.S.G.P.O. 1989-238-815

DOMESTIC RETURN RECEIPT

● **SENDER:** Complete items 1 and 2 when additional services are desired, and complete items 3 and 4.  
Put your address in the "RETURN TO" Space on the reverse side. Failure to do this will prevent this card from being returned to you. The return receipt fee will provide you the name of the person delivered to and the date of delivery. For additional fees the following services are available. Consult postmaster for fees and check box(es) for additional service(s) requested.

1. ☐ Show to whom delivered, date, and addressee's address. (Extra charge) 2. ☐ Restricted Delivery (Extra charge)

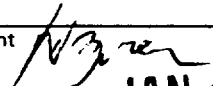
<b>3. Article Addressed to:</b>  <b>ORYX ENERGY CO.</b> <b>LAND DEPARTMENT</b> <b>P. O. BOX 2880</b> <b>DALLAS, TX 75221-2800</b>	<b>4. Article Number</b> <b>P 046 797 478</b> <b>Type of Service:</b> <input checked="" type="checkbox"/> Registered <input type="checkbox"/> Insured <input type="checkbox"/> Certified <input type="checkbox"/> COD <input type="checkbox"/> Express Mail <input checked="" type="checkbox"/> Return Receipt for Merchandise <b>Always obtain signature of addressee or agent and DATE DELIVERED.</b>
<b>5. Signature — Addressee</b> <b>X</b>	<b>8. Addressee's Address (ONLY if requested and fee paid)</b>
<b>6. Signature — Agent</b> 	
<b>7. Date of Delivery</b> <b>JAN 14 1993</b>	

PS Form 3811, Apr. 1989

★ U.S.G.P.O. 1989-238-815

DOMESTIC RETURN RECEIPT



<p>● <b>SENDER:</b> Complete items 1 and 2 when additional services are desired, and complete items 3 and 4.</p> <p>Put your address in the "RETURN TO" Space on the reverse side. Failure to do this will prevent this card from being returned to you. The return receipt fee will provide you the name of the person delivered to and the date of delivery. For additional fees the following services are available. Consult postmaster for fees and check box(es) for additional service(s) requested.</p> <p>1. <input type="checkbox"/> Show to whom delivered, date, and addressee's address. (Extra charge)      2. <input type="checkbox"/> Restricted Delivery (Extra charge)</p>	
<p>3. Article Addressed to:</p> <p><b>OXY U.S.A. INC. LAND DEPARTMENT P. O. BOX 50250 MIDLAND, TX 79710</b></p>	<p>4. Article Number <b>P046 797 472</b></p> <p>Type of Service:</p> <p><input checked="" type="checkbox"/> Registered      <input type="checkbox"/> Insured  <input type="checkbox"/> Certified      <input type="checkbox"/> COD  <input type="checkbox"/> Express Mail      <input checked="" type="checkbox"/> Return Receipt for Merchandise</p> <p>Always obtain signature of addressee or agent and <b>DATE DELIVERED</b>.</p>
<p>5. Signature — Addressee <b>X</b></p>	<p>8. Addressee's Address (ONLY if requested and fee paid)</p>
<p>6. Signature — Agent <b>X</b></p> <p>7. Date of Delivery <b>1/13/93</b></p>	

PS Form 3811, Apr. 1989

U.S.G.P.O. 1989-238-615

DOMESTIC RETURN RECEIPT

ENG706T--ENG706-01  
RUN-TIME: 15:20:39

GAS PRORATION SCHEDULE  
SOUTHEAST, NEW MEXICO

OCT-MAR, 1992

RUN-DATE 10/04/91  
PAGE: 34

POOL/OPERATOR/LEASE/WELL

NUM U SE TWN RAN STA TRANS  
BER L CT SHP GE TUS

ACREAGE

AF

DELIVER APR-JUN 91  
TEST AVG MO SALES

O/P  
LTM

MAR 91  
O/U

MAR 91  
OLD O/P

MONTHLY  
ALLOWABLE

EUMONT YATES, 7 RURS QN (PRO GAS)  
CONOCO, INC.  
STATE KP 13

1 F 13 195 36E MMU NNG  
3 C 13 195 36E MMU NNG  
M

160.00 1.00

2,183  
6,251  
8,434

8,434

\*\*\*OPERATOR TOTALS\*\*\*  
ESTORIL PRODUCING CORP.  
PHILLIPS CRAWFORD

1 A 34 205 37E M EPG  
STANOLIND FEDERAL 160.00 1.00 3,124  
1 E 35 205 37E M NNG 210  
TURLAND FEDERAL 160.00 1.00 3,812  
1 K 27 205 37E M NNG

160.00 1.00

3,124  
210  
3,812

3,124  
210  
3,812

\*\*\*OPERATOR TOTALS\*\*\*  
JAMES L. EVANS  
GULF STATE

1 V 1 215 35E M NNG  
SUPERIOR STATE 160.00 1.00 1,101  
1 K 12 215 35E M EPG 80.00 .50 1,653  
WILSON STATE 160.00 1.00 127  
1 A 11 215 35E M EPG

160.00 1.00

1,101  
1,653  
127

1,101  
1,653  
127

\*\*\*OPERATOR TOTALS\*\*\*  
EXXON CORPORATION  
A J ADKINS COM

1 L 10 215 36E MMU EPG  
2 F 10 215 36E MMU EPG  
M

320.00 2.00

1,660  
10,064  
11,724

11,724

EUMONT GAS COM NO 1  
1 J 4 205 37E MMU EPG  
2 L 4 205 37E MMU EPG  
M

640.00 4.00

3,280  
6,792  
10,072

10,072

EUMONT GAS COM NO 2  
1 I 29 215 36E M EPG  
EUMONT GAS COM NO 3  
1 A 35 205 36E MMU EPG  
M

320.00 2.00

16,216

16,216

EUMONT GAS COM NO 4  
1 M 25 205 36E M EPG  
EXXON AGGIES STATE  
7 B 31 205 37E M EPG  
4 F 31 205 37E MMU EPG  
13 N 31 205 37E MMU EPG  
M

160.00 1.00

59  
3,452

59

EUMONT GAS COM NO 4  
1 M 25 205 36E M EPG  
EXXON AGGIES STATE  
7 B 31 205 37E M EPG  
4 F 31 205 37E MMU EPG  
13 N 31 205 37E MMU EPG  
M

240.00 1.50

7,812  
2,497  
5,192

7,812

JOHN D KNOX  
1 J 10 215 36E MMU EPG  
13 H 10 215 36E MMU EPG  
M

320.00 2.00

6,469  
14,639  
21,108

21,108

**EXXON COMPANY, U.S.A.**

POST OFFICE BOX 1600 • MIDLAND, TEXAS 79702-1600

PRODUCTION DEPARTMENT  
SOUTHWESTERN DIVISION

ENVIRONMENTAL AND REGULATORY AFFAIRS

NEW MEXICO OIL CONSERVATION DIVISION  
JAN 22 1993

JAN 22 1993 10 25

**January 21, 1993**

Unorthodox Location  
Non-Standard Proration Unit  
Simultaneous Dedication  
John D. Knox Well #11  
Units: I  
Section 10, T21S-R36E  
Lea County, NM  
Eumont Yates Seven Rivers Queens (Pro Gas)

Mr. Michael E. Stogner  
New Mexico Oil Conservation Division  
P. O. Box 2088  
Santa Fe, New Mexico 87504-2088

Dear Mr. Stogner:

Exxon Corporation requests administrative approval for an Unorthodox Locations for the John D. Knox #11. Form C-101 and C-102 are attached. This well is located in Section 10, T21S-R36E, Lea County and will be recompleted in the Eumont Yates Seven Rivers Queen (Pro Gas) Pool. The request for administrative approval is based on Rule 104-F(1) since the recompletion is from a deeper horizon and the well was at an orthodox location for the Oil Center Blinbry.

Administrative approval is also requested for Non-Standard Proration Unit and Simultaneous Dedication. The C-102 shows 320 acres instead of the standard 640 acres and this same acreage will be simultaneously dedicated with the John D. Knox well numbers 1 and 13. Both are on the proration schedule with an acreage factor of 2.00 (copy attached).

The following offset operators have been notified: Chevron, Conoco, Devon Energy Corp., Oryx Energy Co., and Oxy USA. A copy of the returned receipts are enclosed. If they have no objections, I have requested that they execute a waiver and send one copy to the N.M.O.C.D. and one to me.

If there are any questions, please call me at 915/688-6782.

Sincerely,



Alex M. Correa

AMC/mcn  
Enclosure  
B:16.AMC



POST OFFICE BOX 1600 • MIDLAND, TEXAS 79702-1600

PRODUCTION DEPARTMENT  
SOUTHWESTERN DIVISION

ENVIRONMENTAL AND REGULATORY AFFAIRS

January 21, 1993

Unorthodox Location  
Non-Standard Proration Unit  
Simultaneous Dedication  
John D. Knox Well #11  
Unit: I  
Section 10, T21S-R36E  
Lea County, New Mexico  
Eumont Yates Seven Rivers Queen (Pro Gas)

Mr. Jerry Sexton  
New Mexico Oil Conservation Division  
P. O. Box 1980  
Hobbs, New Mexico 88240

Dear Mr. Sexton:

Exxon Corp. has requested administrative approval of an Unorthodox Location, Non-Standard Proration Unit and Simultaneous Dedication for the John D. Knox well #11. This well is located in Unit: I, Section 10, T21S-R36E, Lea County, New Mexico. The following information is enclosed: copy of the letter to the N.M.O.C.D., Santa Fe, Attn: M. Stogner; form C-101; form C-102; list of offset operators; and a plat showing offset operators.

The offset operators have been notified by certified mail (return receipt requested) and waivers have been requested. If there are any questions, please call me at 915/688-6782.

Sincerely,

Alex M. Correa

AMC/mcn  
Enclosure  
B:21.AMC

**EXXON** COMPANY, U.S.A.

POST OFFICE BOX 1600 • MIDLAND, TEXAS 79702-1600

PRODUCTION DEPARTMENT  
SOUTHWESTERN DIVISION

ENVIRONMENTAL AND REGULATORY AFFAIRS

*Sent certified mail to  
offset operators 1/12/93*

January 11, 1993

Unorthodox Location  
Non-Standard Proration Unit  
Simultaneous Dedication  
John D. Knox Well #11  
Unit: I  
Section 10, T21S-R36E  
Lea County, NM  
Eumont Yates Seven Rivers Queens (Pro Gas)

Offset Operators

Gentlemen:

Exxon Corp. has requested administrative approval for an Unorthodox Location, Non-Standard Proration Unit, and Simultaneous Dedication for the John D. Knox well #11. This well is to be plugged back to the Eumont Yates Seven Rivers Queen (Pro Gas) Pool. A copy of the application and plats are attached.

If you have no objection to the above referenced Unorthodox Location, Non-Standard Proration Unit, and Simultaneous Dedication, please sign and return one copy of the waiver to the N.M.O.C.D. Office in Santa Fe and one copy to me. Return envelopes are enclosed. If you have any questions, please call me at 915/688-6782.

Sincerely,

  
Alex M. Correa

AMC/mcn  
Enclosure  
B:15.AMC

Submit to Appropriate  
District Office  
State Lease -- 6 copies  
Fee Lease -- 5 copies

State of New Mexico  
Energy, Minerals and Natural Resources Department

Form C 101  
Revised 1-1-89

OIL CONSERVATION DIVISION

DISTRICT I  
P.O. Box 1980, Hobbs, NM 88240

DISTRICT II  
P.O. Drawer DD, Artesia, NM 88210

DISTRICT III  
1000 Rio Brazos Rd., Aztec, NM 87410

P.O. Box 2088  
Santa Fe, New Mexico 87504-2088

API NO. (assigned by OCD on New Wells)  
**3002520306**

5. Indicate Type of Lease  
STATE ☐ FEE ☒

6. State Oil & Gas Lease No.  
**FEE**

APPLICATION FOR PERMIT TO DRILL, DEEPEN, OR PLUG BACK

1a. Type of Work:

DRILL ☐ RE-ENTER ☐ DEEPEN ☐ PLUG BACK ☒

1b. Type of Well:

OIL WELL ☐ GAS WELL ☒ OTHER ☐ SINGLE ZONE ☒ MULTIPLE ZONE ☐

2. Name of Operator

**EXXON CORPORATION**

3. Address of Operator

**ATTN: REGULATORY AFFAIRS  
P. O. BOX 1600  
MIDLAND, TX 79702**

7. Lease Name or Unit Agreement Name

**JOHN D KNOX**

8. Well No.

**11**

9. Pool name or Wildcat

**EUMONT YATES 7 RIVERS QUEEN**

4. Well Location

Unit Letter **I** : **2310** Feet From The **SOUTH** Line and **330** Feet From The **EAST** Line

Section **10** Township **21S** Range **36E** NMPM **LEA** County

10. Proposed Depth  
**6225**

11. Formation  
**QUEEN**

12. Rotary or C.T.  
**CT**

13. Elevations (Show whether DF, RT, GR, etc.)  
**3597 DF**

14. Kind & Status Plug. Bond  
**BLANKET**

15. Drilling Contractor  
**UNKNOWN**

16. Approx. Date Work will start  
**ASAP**

17. PROPOSED CASING AND CEMENT PROGRAM

SIZE OF HOLE	SIZE OF CASING	WEIGHT PER FOOT	SETTING DEPTH	SACKS OF CEMENT	EST. TOP
<b>11</b>	<b>7 5/8</b>	<b>24</b>	<b>1329</b>	<b>575</b>	<b>SURF.</b>
<b>6 3/4</b>	<b>4 1/2</b>	<b>9.5, 11.6</b>	<b>6225</b>	<b>500</b>	<b>2400</b>

1. ABANDON BLINEBRY PERFS. 5812-5945' BY SETTING CIBP @ +/- 5762' WITH A MIN. OF 35' CMT.
2. PERF. QUEEN 3396'-3580', AC. APPROX. 2500 GAL., FRAC. APPROX. 149000 # + 40300 GAL.

IN ABOVE SPACE DESCRIBE PROPOSED PROGRAM: IF PROPOSAL IS TO DEEPEN OR PLUG BACK, GIVE DATA ON PRESENT PRODUCTIVE ZONE AND PROPOSED NEW PRODUCTIVE ZONE. GIVE FLOWOUT PREVENTER PROGRAM, IF ANY.

I hereby certify that the information above is true and complete to the best of my knowledge and belief.

SIGNATURE *Alex M. Correa* TITLE Administrative Specialist DATE 01/08/93

TYPE OR PRINT NAME Alex M. Correa (915) 688-6782 TELEPHONE NO.

(This space for State Use)

APPROVED BY \_\_\_\_\_ TITLE \_\_\_\_\_ DATE \_\_\_\_\_

CONDITIONS OF APPROVAL, IF ANY:

Submit to Appropriate  
District Office  
State Lease-4 copies  
Fee Lease-3 copies

State of New Mexico  
Energy, Minerals and Natural Resources Department

Form C-102  
Revised 1-1-89

OIL CONSERVATION DIVISION

P.O. Box 2088  
Santa Fe, New Mexico 87504-2088

DISTRICT I  
P.O. Box 1980, Hobbs, NM 88240

DISTRICT II  
P.O. Drawer DD, Artesia, NM 88210

DISTRICT III  
1000 Rio Brazos Rd., Aztec, NM 87410

WELL LOCATION AND ACREAGE DEDICATION PLAT

All distances must be from the outer boundaries of the Section.

Operator Exxon Corporation			Lease JOHN D. KNOX		Well No. 11
Unit Letter I	Section 10	Township 21S	Range 36E	County NMPM	LEA
Actual Footage Location of Well: 2310 feet from the SOUTH line and 330 feet from the EAST line.					
Ground level Elev. ?	Producing Formation QUEEN (GAS)	Pool EUMONT YATES 7 RVRS. QN.(PRO. GAS)		Dedicated Acreage: 320 Acres	

- Outline the acreage dedicated to the subject well by colored pencil or hachure marks on the plat below.
- If more than one lease is dedicated to the well, outline each and identify the ownership thereof (both as to working interest and royalty).
- If more than one lease of different ownership is dedicated to the well, have the interest of all owners been consolidated by communitization, unitization, force-pooling, etc.?  
☐ Yes ☐ No If answer is "yes", type of consolidation \_\_\_\_\_  
If answer is "no", list the owners and tract descriptions which have actually been consolidated. (Use reverse side of this form if necessary.) \_\_\_\_\_  
No allowable will be assigned to the well until all interests have been consolidated (by communitization, unitization, forced-pooling, or otherwise) or until a non-standard unit, eliminating such interest, has been approved by the Division.

	<b>OPERATOR CERTIFICATION</b> <i>I hereby certify that the information contained herein is true and complete to the best of my knowledge and belief.</i>
	Signature <i>C. H. Harper</i>
	Printed Name C. H. HARPER
	Position PERMITS SUPERVISOR
	Company Exxon Corporation P.O. Box 1600-Midland, Tx.-79702
	Date 1-18-93
	<b>SURVEYOR CERTIFICATION</b> <i>I hereby certify that the well location shown on this plat was plotted from field notes of actual surveys made by me or under my supervision, and that the same is true and correct to the best of my knowledge and belief.</i>
	Date Surveyed 11/14/63
	Signature & Seal of Professional Surveyor
	Certificate No.

6.6 Miles NW of EUNICE, New Mexico.

C.E. File No. A07185c

OWPB PLAT DATE: 01/06/93 DAC

Offset Operators to the  
John D. Knox #11  
Section 10, T21S-R36E  
Lea County, NM

Eumont Yates Seven Rivers Queen (Pro Gas)

Chevron USA Inc.  
P. O. Box 1150  
Midland, TX 79702  
Attn: Land Department

Conoco Inc.  
P. O. Box 1959  
Midland, TX 79702  
Attn: Land Department

Devon Energy Corporation  
20 North Broadway, Suite 1500  
Oklahoma City, OK 73102-8260  
Attn: Land Department

Oryx Energy Co.  
P. O. Box 2880  
Dallas, TX 75221-2800  
Attn: Land Department

Oxy U.S.A. Inc.  
P. O. Box 50250  
Midland, TX 79710  
Attn: Land Department

AMC/mcn  
B:15.AMC



4

3

2

Oryx Energy Co.

Oryx Energy Co.

Oryx Energy Co.

Oxy USA

Chevron

Devon Energy Corp.

Conoco

Chevron

Conoco

Conoco

9

11

1

1980

11

330

1980

0

2310

13

990

1650

16

15

14

<p><b>SENDER: Complete items 1 and 2 when additional services are desired, and complete items 3 and 4.</b></p> <p>Put your address in the "RETURN TO" Space on the reverse side. Failure to do this will prevent this card from being returned to you. The return receipt fee will provide you the name of the person delivered to and the date of delivery. For additional fees the following services are available. Consult postmaster for fees and check box(es) for additional service(s) requested.</p> <p>1. <input type="checkbox"/> Show to whom delivered, date, and addressee's address. (Extra charge) 2. <input type="checkbox"/> Restricted Delivery (Extra charge)</p>	
<p>3. Article Addressed to:</p> <p>CHEVRON USA INC. LAND DEPARTMENT P. O. BOX 1150 MIDLAND, TX 79702</p>	<p>4. Article Number</p> <p>P 046 797 481</p> <p>Type of Service:</p> <p><input checked="" type="checkbox"/> Registered <input type="checkbox"/> Insured  <input type="checkbox"/> Certified <input type="checkbox"/> COD  <input type="checkbox"/> Express Mail <input checked="" type="checkbox"/> Return Receipt for Merchandise</p> <p>Always obtain signature of addressee or agent and DATE DELIVERED.</p>
<p>5. Signature — Address</p> <p>X</p>	<p>8. Addressee's Address (ONLY if requested and fee paid)</p>
<p>6. Signature — Agent</p> <p>X <i>P. Miller</i></p>	
<p>7. Date of Delivery</p>	
<p>PS Form 3811, Mar. 1988 * U.S.G.P.O. 1988-212-865 DOMESTIC RETURN RECEIPT</p>	

<p><b>SENDER: Complete items 1 and 2 when additional services are desired, and complete items 3 and 4.</b></p> <p>Put your address in the "RETURN TO" Space on the reverse side. Failure to do this will prevent this card from being returned to you. The return receipt fee will provide you the name of the person delivered to and the date of delivery. For additional fees the following services are available. Consult postmaster for fees and check box(es) for additional service(s) requested.</p> <p>1. <input type="checkbox"/> Show to whom delivered, date, and addressee's address. (Extra charge) 2. <input type="checkbox"/> Restricted Delivery (Extra charge)</p>	
<p>3. Article Addressed to:</p> <p>CONOCO INC. LAND DEPARTMENT P. O. BOX 1959 MIDLAND, TX 79702</p>	<p>4. Article Number</p> <p>P-046 797 480</p> <p>Type of Service:</p> <p><input checked="" type="checkbox"/> Registered <input type="checkbox"/> Insured  <input type="checkbox"/> Certified <input type="checkbox"/> COD  <input checked="" type="checkbox"/> Express Mail <input type="checkbox"/> Return Receipt for Merchandise</p> <p>Always obtain signature of addressee or agent and DATE DELIVERED.</p>
<p>5. Signature — Addressee</p> <p>X</p>	<p>8. Addressee's Address (ONLY if requested and fee paid)</p>
<p>6. Signature — Agent</p> <p>X <i>A. Gonzalez</i></p>	
<p>7. Date of Delivery</p> <p>7-16-93</p>	
<p>PS Form 3811, Apr. 1989 * U.S.G.P.O. 1989-238-815 DOMESTIC RETURN RECEIPT</p>	

**SENDER:** Complete items 1 and 2 when additional services are desired, and complete items 3 and 4.  
Put your address in the "RETURN TO" Space on the reverse side. Failure to do this will prevent this card from being returned to you. The return receipt fee will provide you the name of the person delivered to and the date of delivery. For additional fees the following services are available. Consult postmaster for fees and check box(es) for additional service(s) requested.

1. ☐ Show to whom delivered, date, and addressee's address. (Extra charge) 2. ☐ Restricted Delivery (Extra charge)

3. Article Addressed to:  <b>DEVON ENERGY CORPORATION LAND DEPARTMENT 20 NORTH BROADWAY, SUITE 1500 OKLAHOMA CITY, OK 73102-8260</b>	4. Article Number <b>P-046-797-479</b> Type of Service: <input checked="" type="checkbox"/> Registered <input type="checkbox"/> Insured <input type="checkbox"/> Certified <input type="checkbox"/> COD <input type="checkbox"/> Express Mail <input checked="" type="checkbox"/> Return Receipt for Merchandise Always obtain signature of addressee or agent and <b>DATE DELIVERED.</b>
5. Signature — Addressee <b>X</b>	8. Addressee's Address (ONLY if requested and fee paid)
6. Signature — Agent <b>X</b>	
7. Date of Delivery <b>1-17-89</b>	

PS Form 3811, Apr. 1989 ★ U.S.G.P.O. 1989-238-815 DOMESTIC RETURN RECEIPT

**SENDER:** Complete items 1 and 2 when additional services are desired, and complete items 3 and 4.  
Put your address in the "RETURN TO" Space on the reverse side. Failure to do this will prevent this card from being returned to you. The return receipt fee will provide you the name of the person delivered to and the date of delivery. For additional fees the following services are available. Consult postmaster for fees and check box(es) for additional service(s) requested.

1. ☐ Show to whom delivered, date, and addressee's address. (Extra charge) 2. ☐ Restricted Delivery (Extra charge)

3. Article Addressed to:  <b>ORYX ENERGY CO. LAND DEPARTMENT P. O. BOX 2880 DALLAS, TX 75221-2800</b>	4. Article Number <b>P 046 797 478</b> Type of Service: <input checked="" type="checkbox"/> Registered <input type="checkbox"/> Insured <input type="checkbox"/> Certified <input type="checkbox"/> COD <input type="checkbox"/> Express Mail <input checked="" type="checkbox"/> Return Receipt for Merchandise Always obtain signature of addressee or agent and <b>DATE DELIVERED.</b>
5. Signature — Addressee <b>X</b>	8. Addressee's Address (ONLY if requested and fee paid)
6. Signature — Agent <b>X</b>	
7. Date of Delivery <b>JAN 14 1993</b>	

PS Form 3811, Apr. 1989 ★ U.S.G.P.O. 1989-238-815 DOMESTIC RETURN RECEIPT

<p>● <b>SENDER:</b> Complete items 1 and 2 when additional services are desired, and complete items 3 and 4.</p> <p>Put your address in the "RETURN TO" Space on the reverse side. Failure to do this will prevent this card from being returned to you. The return receipt fee will provide you the name of the person delivered to and the date of delivery. For additional fees the following services are available. Consult postmaster for fees and check box(es) for additional service(s) requested.</p> <p>1. <input type="checkbox"/> Show to whom delivered, date, and addressee's address. (Extra charge)      2. <input type="checkbox"/> Restricted Delivery (Extra charge)</p>	
<p>3. Article Addressed to:</p> <p><b>OXY U.S.A. INC. LAND DEPARTMENT P. O. BOX 50250 MIDLAND, TX 79710</b></p>	<p>4. Article Number <b>P046 797 477</b></p> <p>Type of Service:</p> <p><input checked="" type="checkbox"/> Registered      <input type="checkbox"/> Insured  <input type="checkbox"/> Certified      <input type="checkbox"/> COD  <input type="checkbox"/> Express Mail      <input checked="" type="checkbox"/> Return Receipt for Merchandise</p> <p>Always obtain signature of addressee or agent and <b>DATE DELIVERED</b>.</p>
<p>5. Signature — Addressee <b>X</b></p>	<p>8. Addressee's Address (ONLY if requested and fee paid)</p>
<p>6. Signature — Agent <b>X</b></p>	
<p>7. Date of Delivery <b>1/13/93</b></p>	

PS Form 3811, Apr. 1989

U.S.G.P.O. 1989-238-815

DOMESTIC RETURN RECEIPT

RUN-DATE 10/04/91  
PAGE: 34

MONTHLY  
ALLOWABLE

**8,434**

3-126

• • • • •

10.072

7.812

5.192



POST OFFICE BOX 1600 • MIDLAND, TEXAS 79702-1600

PRODUCTION DEPARTMENT  
SOUTHWESTERN DIVISION

ENVIRONMENTAL AND REGULATORY AFFAIRS

January 21, 1993

Unorthodox Location  
Non-Standard Proration Unit  
Simultaneous Dedication  
John D. Knox Well #11  
Unit: I  
Section 10, T21S-R36E  
Lea County, New Mexico  
Eumont Yates Seven Rivers Queen (Pro Gas)

Mr. Jerry Sexton  
New Mexico Oil Conservation Division  
P. O. Box 1980  
Hobbs, New Mexico 88240

Dear Mr. Sexton:

Exxon Corp. has requested administrative approval of an Unorthodox Location, Non-Standard Proration Unit and Simultaneous Dedication for the John D. Knox well #11. This well is located in Unit: I, Section 10, T21S-R36E, Lea County, New Mexico. The following information is enclosed: copy of the letter to the N.M.O.C.D., Santa Fe, Attn: M. Stogner; form C-101; form C-102; list of offset operators; and a plat showing offset operators.

The offset operators have been notified by certified mail (return receipt requested) and waivers have been requested. If there are any questions, please call me at 915/688-6782.

Sincerely,

Alex M. Correa

AMC/mcn  
Enclosure  
B:21.AMC

**EXXON** COMPANY U.S.A.

POST OFFICE BOX 1600 • MIDLAND, TEXAS 79702-1600

PRODUCTION DEPARTMENT  
NORTHWESTERN DIVISION

ENVIRONMENTAL AND REGULATORY AFFAIRS

January 21, 1993

Unorthodox Location  
Non-Standard Proration Unit  
Simultaneous Dedication  
John D. Knox Well #11  
Units: 1  
Section 10, T21S-R36E  
Lea County, NM  
Eumont Yates Seven Rivers Queens (Pro Gas)

Mr. Michael E. Stogner  
New Mexico Oil Conservation Division  
P. O. Box 2088  
Santa Fe, New Mexico 87504-2088

Dear Mr. Stogner:

Exxon Corporation requests administrative approval for an Unorthodox Locations for the John D. Knox #11. Form C-101 and C-102 are attached. This well is located in Section 10, T21S-R36E, Lea County and will be recompleted in the Eumont Yates Seven Rivers Queen (Pro Gas) Pool. The request for administrative approval is based on Rule 104-F(1) since the recompletion is from a deeper horizon and the well was at an orthodox location for the Oil Center Blinbry.

Administrative approval is also requested for Non-Standard Proration Unit and Simultaneous Dedication. The C-102 shows 320 acres instead of the standard 640 acres and this same acreage will be simultaneously dedicated with the John D. Knox well numbers 1 and 13. Both are on the proration schedule with an acreage factor of 2.00 (copy attached).

The following offset operators have been notified: Chevron, Conoco, Devon Energy Corp., Oryx Energy Co., and Oxy USA. A copy of the returned receipts are enclosed. If they have no objections, I have requested that they execute a waiver and send one copy to the N.M.O.C.D. and one to me.

If there are any questions, please call me at 915/688-6782.

Sincerely,



Alex M. Correa

AMC/mcn  
Enclosure  
B:16.AMC

**EXXON** COMPANY, U.S.A.

POST OFFICE BOX 1600 • MIDLAND TEXAS 79702-1600

PRODUCTION DEPARTMENT  
SOUTHWESTERN DIVISION

ENVIRONMENTAL AND REGULATORY AFFAIRS

*sent certified mail to  
offset operators 1/12/93*

January 11, 1993

Unorthodox Location  
Non-Standard Proration Unit  
Simultaneous Dedication  
John D. Knox Well #11  
Unit: I  
Section 10, T21S-R36E  
Lea County, NM  
Eumont Yates Seven Rivers Queens (Pro Gas)

Offset Operators

Gentlemen:

Exxon Corp. has requested administrative approval for an Unorthodox Location, Non-Standard Proration Unit, and Simultaneous Dedication for the John D. Knox well #11. This well is to be plugged back to the Eumont Yates Seven Rivers Queen (Pro Gas) Pool. A copy of the application and plats are attached.

If you have no objection to the above referenced Unorthodox Location, Non-Standard Proration Unit, and Simultaneous Dedication, please sign and return one copy of the waiver to the N.M.O.C.D. Office in Santa Fe and one copy to me. Return envelopes are enclosed. If you have any questions, please call me at 915/688-6782.

Sincerely,

  
Alex M. Correa

AMC/mcn  
Enclosure  
B:15.AMC



Submit to Appropriate  
District Office  
State Lease -- 6 copies  
Fee Lease -- 5 copies

State of New Mexico  
Energy, Minerals and Natural Resources Department

Form C 101  
Revised 1-1-89

## OIL CONSERVATION DIVISION

P.O. Box 2088

Santa Fe, New Mexico 87504-2088

**DISTRICT I**

P.O. Box 1980, Hobbs, NM 88240

**DISTRICT II**

P.O. Drawer DD, Artesia, NM 88210

**DISTRICT III**

1000 Rio Brazos Rd., Aztec, NM 87410

API NO. (assigned by OCD on New Wells)

**3002520306**

5. Indicate Type of Lease

STATE ☐

FEE ☒

6. State Oil & Gas Lease No.

**FEE**

### APPLICATION FOR PERMIT TO DRILL, DEEPEN, OR PLUG BACK

1a. Type of Work:

DRILL ☐

RE-ENTER ☐

DEEPEN ☐

PLUG BACK ☒

1b. Type of Well:

OIL  
WELL ☐

GAS  
WELL ☒

OTHER ☐

SINGLE  
ZONE ☒

MULTIPLE  
ZONE ☐

2. Name of Operator

**EXXON CORPORATION**

3. Address of Operator

**ATTN: REGULATORY AFFAIRS  
P. O. BOX 1600  
MIDLAND, TX 79702**

7. Lease Name or Unit Agreement Name

**JOHN D KNOX**

8. Well No.

**11**

9. Pool name or Wildcat

**EUMONT YATES 7 RIVERS QUEEN**

4. Well Location

Unit Letter **I** : **2310** Feet From The **SOUTH** Line and **330** Feet From The **EAST** Line

Section **10**

Township **21S**

Range **36E**

NMPM

LEA

County

10. Proposed Depth

**6225**

11. Formation

**QUEEN**

12. Rotary or C.T.

**CT**

13. Elevations/ Show whether DF, RT, GR, etc.)

**3597 DF**

14. Kind & Status Plug. Bond

**BLANKET**

15. Drilling Contractor

**UNKNOWN**

16. Approx. Date Work will start

**ASAP**

### 17. PROPOSED CASING AND CEMENT PROGRAM

SIZE OF HOLE	SIZE OF CASING	WEIGHT PER FOOT	SETTING DEPTH	SACKS OF CEMENT	EST. TOP
<b>11</b>	<b>7 5/8</b>	<b>24</b>	<b>1329</b>	<b>575</b>	<b>SURF.</b>
<b>6 3/4</b>	<b>4 1/2</b>	<b>9.5, 11.6</b>	<b>6225</b>	<b>500</b>	<b>2400</b>

1. ABANDON BLINEBRY PERFS. 5812-5945' BY SETTING CIBP @ +/- 5762' WITH A MIN. OF 35' CMT.
2. PERF. QUEEN 3396'-3580', AC. APPROX. 2500 GAL., FRAC. APPROX. 149000 # + 40300 GAL.

IN ABOVE SPACE DESCRIBE PROPOSED PROGRAM: IF PROPOSAL IS TO DEEPEN OR PLUG BACK, GIVE DATA ON PRESENT PRODUCTIVE ZONE AND PROPOSED NEW PRODUCTIVE ZONE. GIVE BLOWOUT PREVENTER PROGRAM, IF ANY.

I hereby certify that the information above is true and complete to the best of my knowledge and belief.

SIGNATURE

*Alex M. Correa*

TITLE **Administrative Specialist**

DATE **01/08/93**

TYPE OR PRINT NAME

**Alex M. Correa**

**(915) 688-6782** TELEPHONE NO.

(This space for State Use)

APPROVED BY

TITLE

DATE

CONDITIONS OF APPROVAL, IF ANY:

# OIL CONSERVATION DIVISION

P.O. Box 2088  
Santa Fe, New Mexico 87504-2088

## WELL LOCATION AND ACREAGE DEDICATION PLAT

All distances must be from the outer boundaries of the Section.

Submit to Appropriate  
District Office  
State Lease-4 copies  
Fee Lease-3 copies

DISTRICT I  
P.O. Box 1980, Hobbs, NM 88240

DISTRICT II  
P.O. Drawer DD, Artesia, NM 88210

DISTRICT III  
1000 Rio Brazos Rd., Aztec, NM 87410

Operator <b>Exxon Corporation</b>			Lease <b>JOHN D. KNOX</b>		Well No. <b>11</b>
Unit Letter <b>I</b>	Section <b>10</b>	Township <b>21S</b>	Range <b>36E</b>	County <b>NMPM LEA</b>	
Actual Footage Location of Well: <b>2310</b> feet from the <b>SOUTH</b> line and <b>330</b> feet from the <b>EAST</b> line.					
Ground level Elev. <b>?</b>	Producing Formation <b>QUEEN (GAS)</b>	Pool <b>EUMONT YATES 7 RVRS. QN.(PRO. GAS)</b>		Dedicated Acreage: <b>320</b> Acres	

- Outline the acreage dedicated to the subject well by colored pencil or hatchure marks on the plat below.
- If more than one lease is dedicated to the well, outline each and identify the ownership thereof (both as to working interest and royalty).
- If more than one lease of different ownership is dedicated to the well, have the interest of all owners been consolidated by communitization, unitization, force-pooling, etc?  
☐ Yes ☐ No If answer is "yes", type of consolidation \_\_\_\_\_  
 If answer is "no", list the owners and tract descriptions which have actually been consolidated. (Use reverse side of this form if necessary.) \_\_\_\_\_  
 No allowable will be assigned to the well until all interests have been consolidated (by communitization, unitization, forced-pooling, or otherwise) or until a non-standard unit, eliminating such interest, has been approved by the Division.

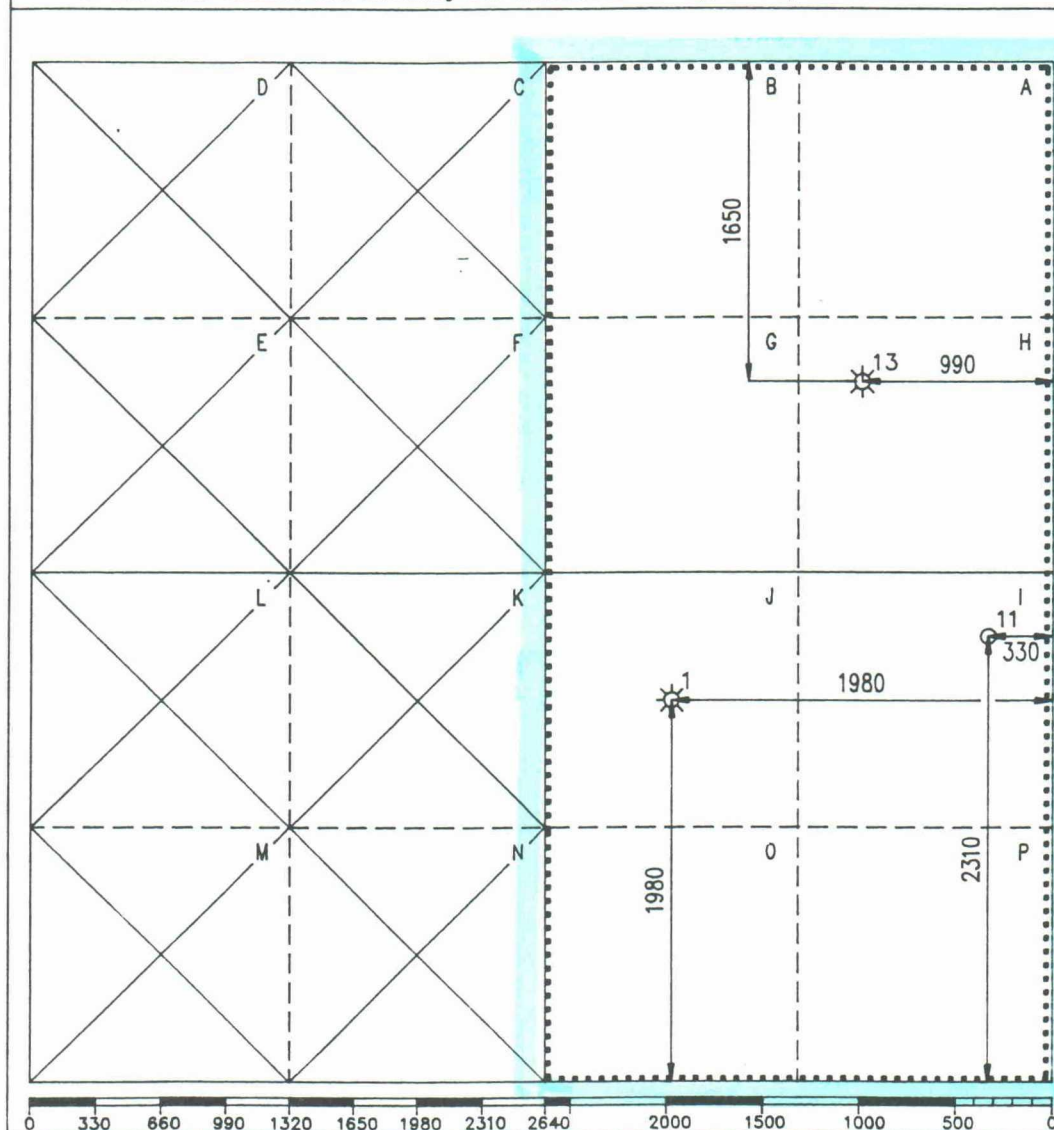

### OPERATOR CERTIFICATION

I hereby certify that the information contained herein is true and complete to the best of my knowledge and belief.

Signature C. H. Harper  
 Printed Name **C. H. HARPER**  
 Position **PERMITS SUPERVISOR**  
 Company **Exxon Corporation**  
 P.O. Box 1600-Midland, Tx.-79702  
 Date **1-18-93**

### SURVEYOR CERTIFICATION

I hereby certify that the well location shown on this plat was plotted from field notes of actual surveys made by me or under my supervision, and that the same is true and correct to the best of my knowledge and belief.

Date Surveyed **11/14/63**  
 Signature & Seal of Professional Surveyor \_\_\_\_\_  
 Certificate No. \_\_\_\_\_

6.6 Miles NW of Eunice, New Mexico.

C.E. File No. A07185c

Offset Operators to the  
John D. Knox #11  
Section 10, T21S-R36E  
Lea County, NM

Eumont Yates Seven Rivers Queen (Pro Gas)

Chevron USA Inc.  
P. O. Box 1150  
Midland, TX 79702  
Attn: Land Department

Conoco Inc.  
P. O. Box 1959  
Midland, TX 79702  
Attn: Land Department

Devon Energy Corporation  
20 North Broadway, Suite 1500  
Oklahoma City, OK 73102-8260  
Attn: Land Department

Oryx Energy Co.  
P. O. Box 2880  
Dallas, TX 75221-2800  
Attn: Land Department

Oxy U.S.A. Inc.  
P. O. Box 50250  
Midland, TX 79710  
Attn: Land Department

AMC/mcn  
B:15.AMC

4

3

2

Oryx Energy Co.

Oryx  
Energy Co.

Oryx Energy Co.

Oxy USA

Chevron

Devon  
Energy Corp.

11

Conoco

Chevron

Conoco

Conoco

16

15

14

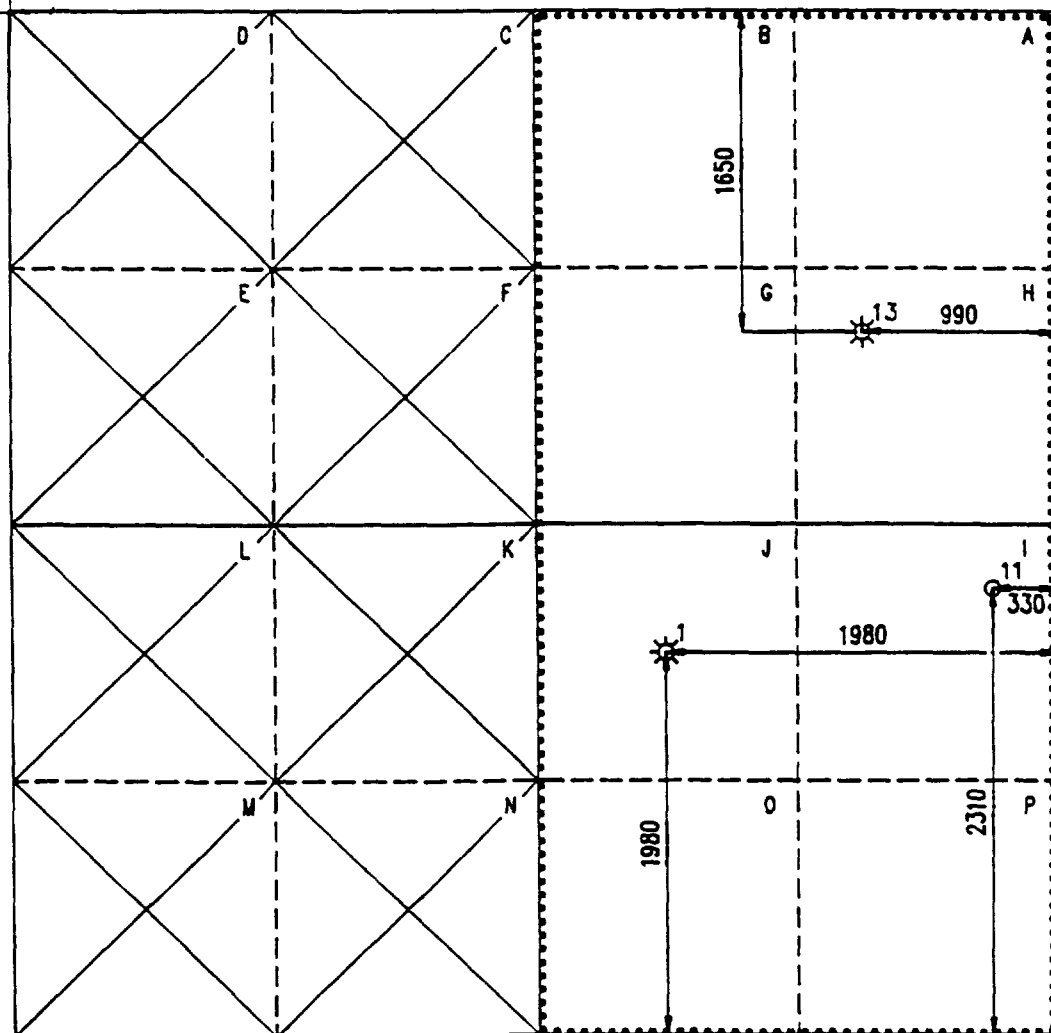

**SENDER: Complete items 1 and 2 when additional services are desired, and complete items 3 and 4.**  
Put your address in the "RETURN TO" Space on the reverse side. Failure to do this will prevent this card from being returned to you. The return receipt fee will provide you the name of the person delivered to and the date of delivery. For additional fees the following services are available. Consult postmaster for fees and check box(es) for additional service(s) requested.

1. ☐ Show to whom delivered, date, and addressee's address. (Extra charge)  
2. ☐ Restricted Delivery (Extra charge)

3. Article Addressed to:  CHEVRON USA INC. LAND DEPARTMENT P. O. BOX 1150 MIDLAND, TX 79702	4. Article Number P 046 797 481 Type of Service: <input checked="" type="checkbox"/> Registered <input type="checkbox"/> Insured <input type="checkbox"/> Certified <input type="checkbox"/> COD <input type="checkbox"/> Express Mail <input checked="" type="checkbox"/> Return Receipt for Merchandise Always obtain signature of addressee or agent and DATE DELIVERED.
5. Signature — Addressee X	8. Addressee's Address (ONLY if requested and fee paid)
6. Signature — Agent X P. Miller	
7. Date of Delivery	

PS Form 3811, Mar. 1988 \* U.S.G.P.O. 1988-212-885 DOMESTIC RETURN RECEIPT

**SENDER: Complete items 1 and 2 when additional services are desired, and complete items 3 and 4.**  
Put your address in the "RETURN TO" Space on the reverse side. Failure to do this will prevent this card from being returned to you. The return receipt fee will provide you the name of the person delivered to and the date of delivery. For additional fees the following services are available. Consult postmaster for fees and check box(es) for additional service(s) requested.

1. ☐ Show to whom delivered, date, and addressee's address. (Extra charge)  
2. ☐ Restricted Delivery (Extra charge)

3. Article Addressed to:  CONOCO INC. LAND DEPARTMENT P. O. BOX 1959 MIDLAND, TX 79702	4. Article Number P-046 797 480 Type of Service: <input checked="" type="checkbox"/> Registered <input type="checkbox"/> Insured <input type="checkbox"/> Certified <input type="checkbox"/> COD <input checked="" type="checkbox"/> Express Mail <input type="checkbox"/> Return Receipt for Merchandise Always obtain signature of addressee or agent and DATE DELIVERED.
5. Signature — Addressee X	8. Addressee's Address (ONLY if requested and fee paid)
6. Signature — Agent X A. Gonzalez	
7. Date of Delivery 7-16-93	

PS Form 3811, Apr. 1989 \* U.S.G.P.O. 1989-238-815 DOMESTIC RETURN RECEIPT

● **SENDER:** Complete items 1 and 2 when additional services are desired, and complete items 3 and 4.  
Put your address in the "RETURN TO" Space on the reverse side. Failure to do this will prevent this card from being returned to you. The return receipt fee will provide you the name of the person delivered to and the date of delivery. For additional fees the following services are available. Consult postmaster for fees and check box(es) for additional service(s) requested.

1. ☐ Show to whom delivered, date, and addressee's address. (Extra charge) 2. ☐ Restricted Delivery (Extra charge)

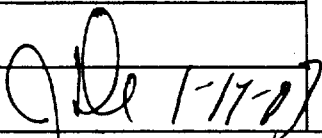
<b>3. Article Addressed to:</b>  <b>DEVON ENERGY CORPORATION</b> <b>LAND DEPARTMENT</b> <b>20 NORTH BROADWAY, SUITE 1500</b> <b>OKLAHOMA CITY, OK 73102-8260</b>	<b>4. Article Number</b> <b>P-046-797-479</b> <b>Type of Service:</b> <input checked="" type="checkbox"/> Registered <input type="checkbox"/> Insured <input type="checkbox"/> Certified <input type="checkbox"/> COD <input type="checkbox"/> Express Mail <input checked="" type="checkbox"/> Return Receipt for Merchandise Always obtain signature of addressee or agent and <b>DATE DELIVERED.</b>
<b>5. Signature — Addressee</b> <b>X</b>	<b>8. Addressee's Address (ONLY if requested and fee paid)</b>
<b>6. Signature — Agent</b> <b>X</b>	
<b>7. Date of Delivery</b> 	

PS Form 3811, Apr. 1989 \*U.S.G.P.O. 1989-238-815 **DOMESTIC RETURN RECEIPT**

● **SENDER:** Complete items 1 and 2 when additional services are desired, and complete items 3 and 4.  
Put your address in the "RETURN TO" Space on the reverse side. Failure to do this will prevent this card from being returned to you. The return receipt fee will provide you the name of the person delivered to and the date of delivery. For additional fees the following services are available. Consult postmaster for fees and check box(es) for additional service(s) requested.

1. ☐ Show to whom delivered, date, and addressee's address. (Extra charge) 2. ☐ Restricted Delivery (Extra charge)

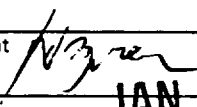
<b>3. Article Addressed to:</b>  <b>ORYX ENERGY CO.</b> <b>LAND DEPARTMENT</b> <b>P. O. BOX 2880</b> <b>DALLAS, TX 75221-2800</b>	<b>4. Article Number</b> <b>P 046 797 478</b> <b>Type of Service:</b> <input checked="" type="checkbox"/> Registered <input type="checkbox"/> Insured <input type="checkbox"/> Certified <input type="checkbox"/> COD <input type="checkbox"/> Express Mail <input checked="" type="checkbox"/> Return Receipt for Merchandise Always obtain signature of addressee or agent and <b>DATE DELIVERED.</b>
<b>5. Signature — Addressee</b> <b>X</b>	<b>8. Addressee's Address (ONLY if requested and fee paid)</b>
<b>6. Signature — Agent</b> 	
<b>7. Date of Delivery</b> <b>JAN 14 1993</b>	

PS Form 3811, Apr. 1989 \*U.S.G.P.O. 1989-238-815 **DOMESTIC RETURN RECEIPT**

<p><b>SENDER:</b> Complete items 1 and 2 when additional services are desired, and complete items 3 and 4.</p> <p>Put your address in the "RETURN TO" Space on the reverse side. Failure to do this will prevent this card from being returned to you. The return receipt fee will provide you the name of the person delivered to and the date of delivery. For additional fees the following services are available. Consult postmaster for fees and check box(es) for additional service(s) requested.</p> <p>1. <input type="checkbox"/> Show to whom delivered, date, and addressee's address. (Extra charge)      2. <input type="checkbox"/> Restricted Delivery (Extra charge)</p>	
<p>3. Article Addressed to:</p> <p><b>OXY U.S.A. INC. LAND DEPARTMENT P. O. BOX 50250 MIDLAND, TX 79710</b></p>	<p>4. Article Number <b>P 046 797 472</b></p> <p>Type of Service:</p> <p><input checked="" type="checkbox"/> Registered      <input type="checkbox"/> Insured  <input type="checkbox"/> Certified      <input type="checkbox"/> COD  <input type="checkbox"/> Express Mail      <input checked="" type="checkbox"/> Return Receipt for Merchandise</p> <p>Always obtain signature of addressee or agent and <u>DATE DELIVERED</u>.</p>
<p>5. Signature — Addressee <b>X</b></p> <p>6. Signature — Agent <b>X</b></p> <p>7. Date of Delivery <b>1/13/93</b></p>	<p>8. Addressee's Address (ONLY if requested and fee paid)</p>

PS Form 3811, Apr. 1989

U.S.G.P.O. 1989-238-815

DOMESTIC RETURN RECEIPT

ENG706T--ENG706-01  
RUN-TIME: 15:20:39

GAS PRODUCTION SCHEDULE  
SOUTHEAST, NEW MEXICO

OCT-MAR, 1992

RUN-DATE 10/04/91  
PAGE: 34

POOL/OPERATOR/LEASE/WELL

NUM U SE TWN RAN STA TRANS  
BER L CT SHP GE TUS

ACREAGE

AF

DELIVER APR-JUN 91  
TEST AVG MO SALES

O/P  
LIM

MAR 91  
O/U

MAR 91  
OLD O/P

MONTHLY  
ALLOWABLE

\*EUMONT YATES, 7 RVR8 QN (PRO GAS)  
CONOCO, INC.  
STATE KP 13

1 F 13 195 36E MMU NNG  
3 C 13 195 36E MMU NNG  
M

160.00 1.00

2,183  
6,251  
8,434

8,434

\*\*\*OPERATOR TOTALS\*\*\*  
ESTORIL PRODUCING CORP.  
PHILLIPS CRAWFORD

1 A 34 205 37E M EPG  
STANOLIND FEDERAL  
1 E 35 205 37E M NNG  
TURLAND FEDERAL  
1 K 27 205 37E M NNG

160.00 1.00  
160.00 1.00  
160.00 1.00

3,124  
210  
3,812

3,124  
210  
3,812

\*\*\*OPERATOR TOTALS\*\*\*  
JAMES L. EVANS  
GULF STATE

1 V 1 215 35E M NNG  
SUPERIOR STATE  
1 K 12 215 35E M EPG  
WILSON STATE  
1 A 11 215 35E M EPG

160.00 1.00  
80.00 .50  
160.00 1.00

1,101  
1,653  
127

1,101  
1,653  
127

\*\*\*OPERATOR TOTALS\*\*\*  
EXXON CORPORATION  
A J ADKINS COM

1 L 10 215 36E MMU EPG  
2 F 10 215 36E MMU EPG  
M

320.00 2.00

1,660  
10,064  
11,724

11,724

EUMONT GAS COM NO 1  
1 J 4 205 37E MMU EPG  
2 L 4 205 37E MMU EPG  
M

640.00 4.00

3,280  
6,792  
10,072

10,072

EUMONT GAS COM NO 2  
1 I 29 215 36E M EPG  
EUMONT GAS COM NO 3  
1 A 35 205 36E MMU EPG  
M

320.00 2.00

16,216

16,216

EUMONT GAS COM NO 4  
1 N 25 205 36E M EPG  
EXXON AGGIES STATE  
7 B 31 205 37E M EPG  
4 F 31 205 37E MMU EPG  
13 N 31 205 37E MMU EPG  
M

160.00 1.00  
240.00 1.50  
160.00 1.00

59  
3,452  
7,812  
2,497  
2,695  
5,192

59  
3,452  
7,812

JOHN D KNOX  
1 J 10 215 36E MMU EPG  
13 H 10 215 36E MMU EPG  
M

320.00 2.00

6,469  
14,639  
21,108

21,108



OIL CONSERVATION DIVISION  
RECEIVED

1993 JAN 21 AM 8 53

WAIVER

New Mexico Oil Conservation Division  
P.O. Box 2088  
Santa Fe, New Mexico 87504-2088

This is to advise that the undersigned has been given due notice that Exxon Corp. has made application for an unorthodox location, non-standard proration unit and simultaneous dedication for the J. D. Knox well #11.

We, the undersigned, hereby waive any objection to the granting of this application for the permit to plug back the J. D. Knox well #11 to the Eumomt Yates 7 Rivers Queen pool. The location of this well is 2310' FSL & 330' FEL of Section 10, T21S-R36E.

Executed this 18<sup>th</sup> day of January, 1992.

Company Oxy USA Inc.

By Richard E. Lippman



STATE OF NEW MEXICO

ENERGY, MINERALS AND NATURAL RESOURCES DEPARTMENT

OIL CONSERVATION DIVISION  
HOBBS DISTRICT OFFICE

93 JAN 28 AM 9 26

1 2 3 73

BRUCE KING  
GOVERNOR

POST OFFICE BOX 1980  
HOBBS, NEW MEXICO 88241-1980  
(505) 393-6161

OIL CONSERVATION DIVISION  
P. O. BOX 2088  
SANTA FE, NEW MEXICO 87501

RE: Proposed:

MC \_\_\_\_\_  
DHC \_\_\_\_\_  
NSL X 458 \_\_\_\_\_  
NSP \_\_\_\_\_  
SWD \_\_\_\_\_  
WFX \_\_\_\_\_  
PMX \_\_\_\_\_

Gentlemen:

I have examined the application for the:

Edward Cooper John D. Knox #11-I 10-21-36  
Operator Lease & Well No. Unit S-T-R

and my recommendations are as follows:

OK

Yours very truly,

Jerry Sexton  
Jerry Sexton  
Supervisor, District 1

/ed

STATE OF NEW MEXICO  
ENERGY AND MINERALS DEPARTMENT  
OIL CONSERVATION DIVISION

IN THE MATTER OF THE HEARING  
CALLED BY THE OIL CONSERVATION  
DIVISION FOR THE PURPOSE OF  
CONSIDERING:

CASE NO. 6637  
Order No. R-6119

APPLICATION OF EXXON CORPORATION  
FOR AN UNORTHODOX WELL LOCATION AND  
SIMULTANEOUS DEDICATION, LEA COUNTY,  
NEW MEXICO.

ORDER OF THE DIVISION

BY THE DIVISION:

This cause came on for hearing at 9 a.m. on September 5, 1979, at Santa Fe, New Mexico, before Examiner Richard L. Stamets.

NOW, on this 24th day of September, 1979, the Division Director, having considered the testimony, the record, and the recommendations of the Examiner, and being fully advised in the premises,

FINDS:

- (1) That due public notice having been given as required by law, the Division has jurisdiction of this cause and the subject matter thereof.
- (2) That the applicant, Exxon Corporation, seeks approval of an unorthodox gas well location for its Knox Well No. 13 located 1650 feet from the North line and 990 feet from the East line of Section 10, Township 21 South, Range 36 East, NMPM, Eumont Gas Pool, Lea County, New Mexico.
- (3) That the applicant further seeks to simultaneously dedicate the E/2 of said Section 10 to the above described well and to its Knox Well No. 1 located in Unit J of said Section 10.
- (4) That a well at said unorthodox location will better enable applicant to produce the gas underlying the proration unit.
- (5) That no offset operator objected to the proposed unorthodox location and simultaneous dedication.

(6) That approval of the subject application will afford the applicant the opportunity to produce its just and equitable share of the gas in the subject pool, will prevent the economic loss caused by the drilling of unnecessary wells, avoid the augmentation of risk arising from the drilling of an excessive number of wells, and will otherwise prevent waste and protect correlative rights.

IT IS THEREFORE ORDERED:

(1) That Exxon Corporation is hereby authorized to drill its Knox Well No. 13 at an unorthodox location 1650 feet from the North line and 990 feet from the East line of Section 10, Township 21 South, Range 36 East, NMPM, Eumont Gas Pool, Lea County, New Mexico.

(2) That the E/2 of said Section 10 shall be simultaneously dedicated to the above-described well and to applicant's Knox Well No. 1 located in Unit J of said Section 10.

(3) That jurisdiction of this cause is retained for the entry of such further orders as the Division may deem necessary.

DONE at Santa Fe, New Mexico, on the day and year herein-above designated.

STATE OF NEW MEXICO  
OIL CONSERVATION DIVISION

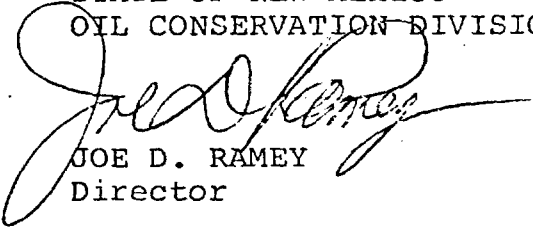
  
JOE D. RAMEY  
Director

S E A L

fd/

Exxon Company U.S.A.  
P.O. Box 1600  
Midland, Tx 79702-1600  
Attn: Alex M. Correa

January 3, 1991

Administrative Order NSL-\*(SD)

Dear \*: Mr. Correa

Reference is made to your application dated \*, for an unorthodox ~~Jalmat~~<sup>320</sup> ~~Eumont~~<sup>E/2</sup> gas well location in an existing non-standard-acre gas spacing and proration unit (GPU) for said ~~Jalmat~~<sup>21 Sec. 10</sup> ~~Eumont~~<sup>36 East</sup> Gas Pool comprising the \* of Section <sup>10</sup>, Township \*, Range \*, NMPM, <sup>1/24/55</sup> County, New Mexico. Said GPU was authorized by Division \*, dated \* and presently has dedicated thereon the \* located in ~~Unit~~<sup>Administrative Order NSP-77A</sup> of said Section \*. <sup>John D. Knox Well No. 1 at an unorthodox gas well location 1850' FSL - 990' FEL (Unit H)</sup>

By Division Order No. R-6119, dated September 24, 1979, an additional well to be drilled ~~at~~ on the subject GPU was approved for the John D. Knox Well No. 13, located at a standard gas well location 1850' FSL - 990' FEL (Unit H) of said Section 10.

It is our understanding that the subject well to be considered at this time is completed in the Owl Center Blinley Pool; however, upon review of this order will be physical such and completed on the ~~subject~~ Eumont Gas Pool.

By authority granted me under the provisions of Rule 2(c) of the Special Rules and Regulations for the ~~Jalmat~~ ~~Eumont~~ Gas Pool, as promulgated by Division Order No. R-8170, as amended, the following described well located at an unorthodox gas well location is hereby approved:

John D. Knox Well No. 11  
2310' FSL - 330' FEL (Unit I)

<sup>John D. Knox Well No. 11</sup> Also, you are hereby authorized to simultaneously dedicate ~~Jalmat~~ ~~Eumont~~ Gas production from the \* with the \*. Furthermore, you are hereby permitted to produce the allowable assigned the subject GPU from ~~all~~ both of said wells in any proportion. <sup>John D. Knox Well No. 10 and 13</sup>

Sincerely,

William J. LeMay  
Director

WJL/MES/ag

cc: Oil Conservation Division - Hobbs  
~~US Bureau of Land Management - Carlsbad~~  
~~NM State Land Office - Santa Fe~~

ILLEGIBLE

OIL CONSERVATION COMMISSION

P. O. BOX 871

SANTA FE, NEW MEXICO

January 24, 1955

Humble Oil & Refining Co.  
P. O. Box 1600  
Midland, Texas

Attention: Mr. J. W. House

Administrative Order NSP-77-A

Gentlemen:

Reference is made to your application for approval of a 320-acre non-standard gas proration unit in the Eument Gas Pool consisting of the following acreage:

Twp. 21 South, Rge. 36 East, NMPM  
E/2 of Section 10

It is understood that this unit is to be ascribed to your J. D. Knox Well No. 1, located 1980' from the East and South lines of Section 10, Township 21 South, Range 36 East, NMPM, Lea County, New Mexico.

Inasmuch as you enclosed waivers from the offset operators agreeing to the formation of the proposed unit, it is possible for immediate approval to be granted. Therefore, by authority granted me under provisions of Rule 5, Section (b)-5 of the Special Rules and Regulations of the Eument Gas Pool, as set forth in Order R-520, you are hereby authorized to operate the above described acreage as a non-standard gas proration unit, with allowable to be assigned thereto in accordance with pool rules, based upon the unit size of 320 acres.

Very truly yours,

W. B. Macey  
Secretary - Director

WBM:jh

cc: Oil Conservation Commission, Hobbs

Oil & Gas Engineering Committee, Hobbs

ILLEGIBLE

NO. OF COPIES RECEIVED	
DISTRIBUTION	
SANTA FE	
FILE	
U.S.O.S.	
LAND OFFICE	
OPERATOR	

# OIL CONSERVATION DIVISION

P. O. BOX 2088  
SANTA FE, NEW MEXICO 87501

Form C-103  
Revised 10-1-7

5a. Indicate Type of Lease  
State ☐ Fee ☒  
5. State Oil & Gas Lease No.

## SUNDRY NOTICES AND REPORTS ON WELLS

(DO NOT USE THIS FORM FOR PROPOSALS TO DRILL OR TO DEEPEN OR PLUG BACK TO A DIFFERENT RESERVOIR. USE "APPLICATION FOR PERMIT -" (FORM C-101) FOR SUCH PROPOSALS.)

1. OIL WELL <input checked="" type="checkbox"/> GAS WELL <input type="checkbox"/> OTHER-	7. Unit Agreement Name
2. Name of Operator EXXON CORPORATION	8. Farm or Lease Name JOHN D. KNOX
3. Address of Operator Box 1600, MIDLAND, TEXAS 79702	9. Well No. 11
4. Location of Well UNIT LETTER <u>I</u> <u>2310</u> FEET FROM THE <u>SOUTH</u> LINE AND <u>330</u> FEET FROM THE <u>EAST</u> LINE, SECTION <u>10</u> TOWNSHIP <u>21-S</u> RANGE <u>36-E</u> NMPM.	10. Field and Pool, or Wildcat DIL CENTER BLINEBRY
15. Elevation (Show whether DF, RT, GR, etc.) 3597 D.F.	12. County LEN

16. Check Appropriate Box To Indicate Nature of Notice, Report or Other Data  
NOTICE OF INTENTION TO: SUBSEQUENT REPORT OF:

PERFORM REMEDIAL WORK <input type="checkbox"/>	PLUG AND ABANDON <input type="checkbox"/>	REMEDIAL WORK <input checked="" type="checkbox"/>	ALTERING CASING <input type="checkbox"/>
TEMPORARILY ABANDON <input type="checkbox"/>	CHANGE PLANS <input type="checkbox"/>	COMMENCE DRILLING OPNS. <input type="checkbox"/>	PLUG AND ABANDONMENT <input type="checkbox"/>
PULL OR ALTER CASING <input type="checkbox"/>	OTHER <input type="checkbox"/>	CASING TEST AND CEMENT JOBS <input type="checkbox"/>	

17. Describe Proposed or Completed Operations (Clearly state all pertinent details, and give pertinent dates, including estimated date of starting any proposed work) SEE RULE 1103.

1. PULLED PRODUCTION EQUIPMENT.
2. TEST FOR CSG LEAK - OK.
3. SET PKR AT 5686'
4. ACIDIZE W/4000 GAL 15% 5812-5945'
5. PLACED ON PUMP. TESTED 6-DAYS-FINAL TEST 1080 PLUS 37BL

18. I hereby certify that the information above is true and complete to the best of my knowledge and belief.

SIGNED D. P. Lowe TITLE S.R. ADMIN. DATE 9-28-84  
APPROVED BY [Signature] TITLE DISTRICT 1 SUPERVISOR DATE OCT - 3 1984  
CONDITIONS OF APPROVAL, IF ANY:

NO. OF COPIES RECEIVED	
DISTRIBUTION	
SANTA FE	
FILE	
U.S.O.S.	
LAND OFFICE	
OPERATOR	

**OIL CONSERVATION DIVISION**  
P. O. BOX 2088  
SANTA FE, NEW MEXICO 87501

Form C-103  
Revised 10-1-

5a. Indicate Type of Lease  
State ☐ Fee ☒  
5. State Oil & Gas Lease No.

**SUNDRY NOTICES AND REPORTS ON WELLS**

(DO NOT USE THIS FORM FOR PROPOSALS TO DRILL OR TO DEEPEN OR PLUG BACK TO A DIFFERENT RESERVOIR.  
USE "APPLICATION FOR PERMIT -" (FORM C-101) FOR SUCH PROPOSALS.)

1. OIL WELL <input checked="" type="checkbox"/> GAS WELL <input type="checkbox"/> OTHER-	7. Unit Agreement Name
2. Name of Operator <u>EXXON CORPORATION</u>	8. Farm or Lease Name <u>JOHN D. KNOX</u>
3. Address of Operator <u>Box 1600, MIDLAND, TEXAS 79702</u>	9. Well No. <u>11</u>
4. Location of Well UNIT LETTER <u>I</u> , <u>2310</u> FEET FROM THE <u>SOUTH</u> LINE AND <u>330</u> FEET FROM THE <u>EAST</u> LINE, SECTION <u>10</u> TOWNSHIP <u>21-S</u> RANGE <u>36-E</u> NMPM.	10. Field and Pool, or Wildcat <u>OIL CENTER BUNEBSY</u>
15. Elevation (Show whether DF, RT, GR, etc.) <u>3597 D.F.</u>	12. County <u>LEA</u>

Check Appropriate Box To Indicate Nature of Notice, Report or Other Data  
NOTICE OF INTENTION TO: SUBSEQUENT REPORT OF:

PERFORM REMEDIAL WORK <input checked="" type="checkbox"/>	PLUG AND ABANDON <input type="checkbox"/>	REMEDIAL WORK <input type="checkbox"/>	ALTERING CASING <input type="checkbox"/>
TEMPORARILY ABANDON <input type="checkbox"/>	CHANGE PLANS <input type="checkbox"/>	COMMENCE DRILLING OPS. <input type="checkbox"/>	PLUG AND ABANDONMENT <input type="checkbox"/>
PULL OR ALTER CASING <input type="checkbox"/>	OTHER <input type="checkbox"/>	CASING TEST AND CEMENT JOBS <input type="checkbox"/>	

17. Describe Proposed or Completed Operations (Clearly state all pertinent details, and give pertinent dates, including estimated date of starting any proposed work) SEE RULE 1103.

1. FULL PRODUCTION EQUIPMENT.
2. SET TREATING PKR AT 5700'.
3. SWAB 1-2 DAYS TO DETERMINE PRODUCTION.
4. ACIDIZE W/4000 GAL OF INHIBITED 15% NEHCL.
5. SWAB TEST WELL.
6. PLACE WELL ON PUMP.

18. I hereby certify that the information above is true and complete to the best of my knowledge and belief.

SIGNED A. H. Lowe TITLE SR. ADMIN DATE 6-4-84  
APPROVED BY [Signature] TITLE DISTRICT 1 SUPERVISOR DATE JUN 6 1984  
CONDITIONS OF APPROVAL, IF ANY:



DISTRIBUTION		
SANTA FE		
FILE		
U.S.G.S.		
LAND OFFICE		
TRANSPORTER	OIL	
	GAS	
PRODUCTION OFFICE		
OPERATOR		

NEW MEXICO OIL CONSERVATION COMMISSION  
SANTA FE, NEW MEXICO

FORM C-110  
(Rev. 7-60)

**CERTIFICATE OF COMPLIANCE AND AUTHORIZATION  
TO TRANSPORT OIL AND NATURAL GAS**

FILE THE ORIGINAL AND 4 COPIES WITH THE APPROPRIATE OFFICE

Company or Operator <b>HUMBLE OIL &amp; REFINING COMPANY</b>				Lease <b>John D. Knox</b>		Well No. <b>11</b>
Unit Letter <b>"I"</b>	Section <b>10</b>	Township <b>T-21-S</b>	Range <b>R-36-E</b>	County <b>Lea</b>		
Pool <b>Oil Center Blinebry</b>				Kind of Lease (State, Fed, Fee) <b>Fee</b>		
If well produces oil or condensate give location of tanks		Unit Letter <b>"A"</b>	Section <b>10</b>	Township <b>T-21-S</b>	Range <b>R-36-E</b>	
Authorized transporter of oil <input checked="" type="checkbox"/> or condensate <input type="checkbox"/> <b>Shell Pipe Line Company</b>				Address (give address to which approved copy of this form is to be sent) <b>Box 1910, Midland, Texas</b>		
Is Gas Actually Connected? Yes <input checked="" type="checkbox"/> No <input type="checkbox"/>						
Authorized transporter of casing head gas <input checked="" type="checkbox"/> or dry gas <input type="checkbox"/> <b>Phillips Petroleum Company</b>		Date Connected	Address (give address to which approved copy of this form is to be sent) <b>4th &amp; Washington, Odessa, Texas</b>			

If gas is not being sold, give reasons and also explain its present disposition:

**REASON(S) FOR FILING (please check proper box)**

New Well ..... ☐ Change in Ownership ..... ☒  
Change in Transporter (check one) Other (explain below)  
Oil ..... ☐ Dry Gas ..... ☐  
Casing head gas ..... ☐ Condensate ..... ☐ Change in pool designation

RECEIVED IN CHARGE OF  
HUMBLE OIL & REFINING COMPANY  
TO OIL CONSERVATION  
COMMISSION  
JANUARY 1, 1964

**Remarks**

Change in pool designation effective June 1, 1964.

The undersigned certifies that the Rules and Regulations of the Oil Conservation Commission have been complied with.

Executed this the 13th day of May, 19 64.

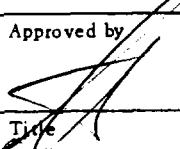
OIL CONSERVATION COMMISSION		By 
Approved by 		Title <b>Agent</b>
Title <b>Engineer District 3</b>		Company <b>HUMBLE OIL &amp; REFINING COMPANY</b>
Date <b>MAY 15 1964</b>		Address <b>Box 2100, Hobbs, New Mexico 88240</b>

DISTRIBUTION	
SA 7-PT	
FILE	
U.S. S.	
LAND OFFICE	
TRANSPORTER	OIL
	GAS
PRORATION OFFICE	
OPERATOR	

# NEW MEXICO OIL CONSERVATION COMMISSION

SANTA FE, NEW MEXICO

FORM C-110

(Rev. 7-60)

## CERTIFICATE OF COMPLIANCE AND AUTHORIZATION C. TO TRANSPORT OIL AND NATURAL GAS

FILE THE ORIGINAL AND 4 COPIES WITH THE APPROPRIATE OFFICE

Company or Operator <b>Humble Oil &amp; Refining Company</b>				Lease <b>J. D. Knox</b>		Well No. <b>11</b>	
Unit Letter <b>I</b>	Section <b>10</b>	Township <b>21-S</b>	Range <b>36-E</b>	County <b>Lea</b>			
Pool <b>Oil Center Blinebry</b>				Kind of Lease (State, Fed, Fee) <b>Fee</b>			
If well produces oil or condensate give location of tanks		Unit Letter <b>A</b>	Section <b>10</b>	Township <b>21-S</b>	Range <b>36-E</b>		
Authorized transporter of oil <input checked="" type="checkbox"/> or condensate <input type="checkbox"/> <b>Shell Pipe Line Company</b>				Address (give address to which approved copy of this form is to be sent) <b>Box 1910, Midland, Texas</b>			

Is Gas Actually Connected? Yes ☐ No ☒

Authorized transporter of casing head gas <input type="checkbox"/> or dry gas <input type="checkbox"/>	Date Connected	Address (give address to which approved copy of this form is to be sent)
--	----------------	--

If gas is not being sold, give reasons and also explain its present disposition:

Vented at present



### REASON(S) FOR FILING (please check proper box)

New Well ☒ Change in Ownership ☐  
 Change in Transporter (check one) Other (explain below)  
 Oil ☐ Dry Gas ☐  
 Casing head gas ☐ Condensate ☐

Remarks
---------

The undersigned certifies that the Rules and Regulations of the Oil Conservation Commission have been complied with.

Executed this the 31st day of January, 19 64

OIL CONSERVATION COMMISSION		By 
Approved by 		Title <b>Agent</b>
Title <b>Engineer District #1</b>		Company <b>Humble Oil &amp; Refining Company</b>
Date <b>FEB 3 1964</b>		Address <b>Box 2100, Hobbs, New Mexico</b>

**NEW MEXICO OIL CONSERVATION COMMISSION**  
Santa Fe, New Mexico

(Form C-104)  
Revised 7/1/57

## REQUEST FOR (OIL) - (GAS) ALLOWABLE

This form shall be submitted by the operator before an initial allowable will be assigned to any completed Oil or Gas well. Form C-104 is to be submitted in QUADRUPPLICATE to the same District Office to which Form C-101 was sent. The allowable will be assigned effective 7:00 A.M. on date of completion or recompletion, provided this form is filed during calendar month of completion or recompletion. The completion date shall be that date in the case of an oil well when new oil is delivered into the stock tanks. Gas must be reported on 15.025 psia at 60° Fahrenheit.

Hobbs, New Mexico      January 31, 1964  
(Place)      (Date)

**WE ARE HEREBY REQUESTING AN ALLOWABLE FOR A WELL KNOWN AS:**

Humble Oil & Refining Co.      John D. Knox      Well No. 11      in NE 1/4 SE 1/4,  
(Company or Operator)      (Lease)  
I, Sec. 10, T-21-S, R-36-E, NMPM, Oil Center Blinebry Pool  
Unit Letter

Lea      County. Date Spudded 11-23-63      Date Drilling Completed 12-6-63  
Please indicate location:      Elevation 3597 D.F.      Total Depth 6225      PBTD 5872

D	C	B	A
E	F	G	H
L	K	J	I X
M	N	O	P

330' FEL, 2310' FSL

**Tubing, Casing and Cementing Record**

Size	Feet	Sax
7-5/8	1318	575
4-1/2	6214	500
2	5808	-

Top Oil/Gas Pay 5885      Name of Prod. Form. Blinebry

PRODUCING INTERVAL -

Perforations 5812, 5816, 5825, 5835, 5838, 5842, 5847, 5859

Open Hole -      Depth Casing Shoe 6225      Depth Tubing 5815

OIL WELL TEST -

Natural Prod. Test: - bbls. oil, - bbls water in - hrs, - min. Size - Choke -

Test After Acid or Fracture Treatment (after recovery of volume of oil equal to volume of load oil used): 58 bbls. oil, 29 bbls water in 10 hrs, - min. Size Swab Choke

GAS WELL TEST -

Natural Prod. Test: - MCF/Day; Hours flowed - Choke Size -

Method of Testing (pitot, back pressure, etc.): -

Test After Acid or Fracture Treatment: - MCF/Day; Hours flowed -

Choke Size - Method of Testing: -

Acid or Fracture Treatment (Give amounts of materials used, such as acid, water, oil, and sand): Acidized with 5000 gals N.E. acid

Casing      Tubing      Date first new  
Press. -      Press. -      oil run to tanks 1-6-64

Oil Transporter Shell Pipe Line Company

Gas Transporter Vented at present

Remarks:

I hereby certify that the information given above is true and complete to the best of my knowledge.

Approved FEB 3 1964, 19

Humble Oil & Refining Company  
(Company or Operator)

**OIL CONSERVATION COMMISSION**

By: *[Signature]*  
(Signature)

By: *[Signature]*  
Title Engineer District 1

Title Agent  
Send Communications regarding well to:

Name Humble Oil & Refining Company

Address Box 2100, Hobbs, New Mexico

Deviation listings on Humble Oil & Refining Company's John D. Knox No. 11

<u>Depth</u>	<u>Deviation</u>
304	1/2
630	1/2
1027	1/2
1309	1/2
1420	1/4
1760	3/4
2072	1
2291	1-1/4
2500	1-1/4
2600	1-3/4
2940	1-1/4
3220	1
3490	1-1/2
3667	1-1/2
3958	1-3/4
4250	2
4550	1-3/4
4900	2
5190	2
5478	2
5740	1-3/4
5976	1-3/4

HUMBLE OIL & REFINING COMPANY

BY

E. S. Davis  
Agent

Subscribed and sworn to before this 31st day of January 1964

NOTARY PUBLIC

Charles Ray Younger (Chandler)  
Notary Public

Lea County, New Mexico

MY COMMISSION EXPIRES JANUARY 1, 1965

NEW MEXICO OIL CONSERVATION COMMISSION

SANTA FE, NEW MEXICO

HOBBS FIELD O.C.C.

WELL RECORD  
FEB 20 1964

AREA 640 ACRES  
LOCATE WELL CORRECTLY

MAIL TO DISTRICT OFFICE, OIL CONSERVATION COMMISSION, TO WHICH FORM C-101 WAS SENT NOT LATER THAN TWENTY DAYS AFTER COMPLETION OF WELL. FOLLOW INSTRUCTIONS IN RULES AND REGULATIONS OF THE COMMISSION. SUBMIT IN QUINTUPPLICATE.

HUMBLE OIL & REFINING COMPANY John D. Knox

(COMPANY OR OPERATOR)

(LEASE)

WELL NO. 11, IN NE 1/4 OF SE 1/4, OF SEC. 10, T. -21-S, R. -36-E, NMPM.

Oil Center Blinebry POOL, Lea COUNTY.

WELL IS 330 FEET FROM East LINE AND 2310 FEET FROM South LINE

OF SECTION 10. IF STATE LAND THE OIL AND GAS LEASE NO. IS -

DRILLING COMMENCED November 23, 1963 DRILLING WAS COMPLETED December 6, 1963

NAME OF DRILLING CONTRACTOR Moran Drilling Company

ADDRESS Hobbs, New Mexico

ELEVATION ABOVE SEA LEVEL AT TOP OF TUBING HEAD 3597 D.F. THE INFORMATION GIVEN IS TO BE

KEPT CONFIDENTIAL UNTIL -, 19- DATE WELL COMPLETED 12-31-63

DISTANCE FROM RDB TO CSG. HEAD FLANGE 10.70 TOP OF RDB 1.0

OIL SANDS OR ZONES

NO. 1, FROM 5913, 5919, 5922, 5932, 5936, 5945 NO. 4, FROM TO

NO. 2, FROM 5812, 5816, 5825, 5835, 5838, 5842, NO. 5, FROM TO

NO. 3, FROM 5847, 5859 NO. 6, FROM TO

IMPORTANT WATER SANDS

INCLUDE DATA ON RATE OF WATER INFLOW AND ELEVATION TO WHICH WATER ROSE IN HOLE.

NO. 1, FROM TO FEET.

NO. 2, FROM TO FEET.

NO. 3, FROM TO FEET.

NO. 4, FROM TO FEET.

CASING RECORD

SIZE	WEIGHT PER FOOT	NEW OR USED	AMOUNT	KIND OF SHOE	CUT AND PULLED FROM	PERFORATIONS	PURPOSE
7-5/8"	24	New	1318	Larkin	-	-	Surface
4-1/2"	9.5 & 11.6	New	6214	Larkin	-	See Above under	Oil String
						"Oil Sands or Zones"	
*2	4.70	New	5777	-	-	-	-

\* tubing with packer set at 5787.

MUDDING AND CEMENTING RECORD

SIZE OF HOLE	SIZE OF CASING	WHERE SET	NO. SACKS OF CEMENT	METHOD USED	MUD GRAVITY	TOP OF CEMENT
11	7-5/8	1329	575	Pumped	-	Cement circulated
6-3/4	4-1/2	6225	500	Pumped	-	2400 by temp survey

RECORD OF PRODUCTION AND STIMULATION

(RECORD THE PROCESS USED, NO. OF QTS. OR GALS. USED, INTERVAL TREATED OR SHOT.)

Acidized perf 5913-45 with 2000 gals with an average injection rate of 3 BPM. Max press

3450#. Min press 2600#, flushed with 24 bbls & overflushed with 4 bbls lse crude. Job

by Dowell. Acidized perf 5913-45 with 6000 gals acid with an average injection rate of

4 BPM. Max press 3650#. Min press 2900#. Flushed with 24 bbls & overflushed (con't pg. 3)

RESULT OF PRODUCTION STIMULATION Well completed as a flowing oil well.

TOTAL DEPTH 6225 Driller's T.D. PBD 6203



# SUPPLEMENTAL WELL INFORMATION

NAME OF WELL AND NUMBER John D. Knox Well No. 11.

POOL COMPLETED IN Oil Center Blinebry.

PERFORATED INTERVAL 5913,5919,5922,5932,5936,5945,5812,5816,5825,5835,5838,5842,5847 & 5859.

STIMULATIONS: with 5 bbls lse crude. Job by Dowell. Treated perf 5913-45 with 20,000 gals jelled lse crude and 30,000 20-40 sand with an average injection rate of 15.5 BPM. Max press 3600#. Min press 3400#. Flushed with 96 bbls and overflushed with 20 bbls lease crude. Job by Dowell. Spotted acid over perf 5812-59 and let soak. Followed with a 5000 gal acid job with an average injection rate of 3.3 BPM. Average treating press 3000#. Job by BJ Service. Frac perf 5812-59 with 10,000 gals Humble Frac Oil with 0.025# Mark II adomite per gal and 7500# (continued below)

## POTENTIAL TEST

DATE	CHOKE SIZE	HOURS TESTED	BBLS/DAY		% OF BS&W	GAS MCF /DAY	GOR	TBG PR OR S P M	CSG PR OR L. STROKE	CORRECTED GRAVITY
			FLUID	OIL						
* 1-17-64	Swab	10	87	58		-	-	-	-	-
** 2-10-64	3/8	24	71	71	-	49	690	50	-	40.1

\*\* Potential test

## DRILL STEM TESTS

NO.	RESERVOIR	INTERVAL TESTED		PRESSURES			RECOVERY - FEET	RUN BY
		FROM	TO	I. SI.	F. FLOW.	F. SI.		
	NONE							

CORES: NONE

LOGS: Acoustic scope - PGAC from 6225 to surface on 12-6-63  
 Gamma Ray-Sonic - PGAC from 6225 to surface on 12-6-63  
 Microlaterolog - PGAC from 6225 to 2500 on 12-6-63  
 Laterolog - PGAC from 6225 to 2500 on 12-6-63  
 Microlog - PGAC from 6120 to 5700 on 1-14-64  
 Acoustic Scope - PGAC from 6120 to 5700 on 1-14-64  
 Radio active Tracer Survey - Western Company from 6050 to 5870 on 12-16-63.

UNSUCCESSFUL COMPLETION ATTEMPTS: FROM NONE TO NONE  
 (SEE DAILY DRILLERS REPORTS FOR SQUEEZES OR BRIDGES.)

\* allowable received effective January 6, 1964 (date of first new oil) based on swab test taken on January 17, 1964 from perf 5812-59.

STIMULATIONS: (con't from above) 20-40 sand with an average injection rate of 13 BPM. Average treating press 3700#. Flushed with 96 bbls and overflushed with 13 bbls lease crude. Job by Halliburton.

NUMBER OF COPIES RECEIVED	
DISTRIBUTION	
SANT - FF	
FILE	
U.S.G.S.	
LAND OFFICE	
TRANSPORTER	
PRORATION OFFICE	
OPERATOR	

# NEW MEXICO OIL CONSERVATION COMMISSION

FORM C-103  
(Rev 3-55)

## MISCELLANEOUS REPORTS ON WELLS

(Submit to appropriate District Office as per Commission Rule 310a) '64

Name of Company Humble Oil & Refining Company		Address Box 2100, Hobbs, New Mexico 88240	
Lease John D. Knox	Well No. 11	Unit Letter I	Section 10
Date Work Performed 11-23, 25-63		Pool Oil Center Blinbry	County Lea

THIS IS A REPORT OF: (Check appropriate block)

- ☒ Beginning Drilling Operations
 ☒ Casing Test and Cement Job
 ☐ Other (Explain):
- ☐ Plugging
 ☐ Remedial Work

Detailed account of work done, nature and quantity of materials used, and results obtained.

Spudded 11" hole at 1:00PM on 11-23-63. Ran 1318' (41 jts) 7-5/8" csg 24#, H-40 set at 1329'. Cemented with 375 sxs reg. 4% Gel and 200 sxs reg. neat with 2% Cal. Chlo. POB 11:30AM on 11-24-63. Circulated cement. WOC 18 hours. Tested csg with 800# for 30 minutes, no drop in pressure. Drilled plug out at 5:00AM on 11-25-63.

Witnessed by C. L. Sparkman	Position Field Supt.	Company Humble Oil & Refining Company
--------------------------------	-------------------------	--

FILL IN BELOW FOR REMEDIAL WORK REPORTS ONLY

### ORIGINAL WELL DATA

D F Elev.	T D	P B T D	Producing Interval	Completion Date
Tubing Diameter	Tubing Depth	Oil String Diameter	Oil String Depth	
Perforated Interval(s)				
Open Hole Interval		Producing Formation(s)		

### RESULTS OF WORKOVER

Test	Date of Test	Oil Production BPD	Gas Production MCFPD	Water Production BPD	GOR Cubic feet/Bbl	Gas Well Potential MCFPD
Before Workover						
After Workover						

OIL CONSERVATION COMMISSION

I hereby certify that the information given above is true and complete to the best of my knowledge.

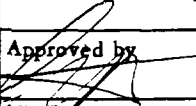
Approved by 	Name E. L. Sparkman
Title	Position Agent
Date JAN 1 1964	Company Humble Oil & Refining Company



**HUMBLE OIL & REFINING COMPANY** PLANS OFFICE O. C. C.

MIDLAND AREA  
MIDLAND, TEXAS

DEC 16 8 40 AM '63

12-11-63

New Mexico Oil Conservation Commission  
Box 1545  
Hobbs, N. M.

Re: ELEVATION

~~TEXAS R.R.C. COMM. FILE~~  
~~ON XERO COPY~~

Attn:

Gentlemen:

The ELEVATION of the following well is: 3597 DF as  
reported by Laughlin-Simmons & Company.  
COUNTY: Lea, N. M. Field: Oil Center Blinebry

**Humble Oil & Refining Company**

No. 11 Knox, J. D.

Sec 10, T-21-S, R-36-E

2310' FSL & 330' FEL of Sec.

The above is given you to complete your records for the Form 1,  
"Notice of Intention to Drill," filed with you on this well under date of:

11-21-63

**HUMBLE OIL & REFINING COMPANY**

BILL R. PAYNE, AREA EXPL. MANAGER

By: F. H. McMahon by George A. Ross  
F. H. McMahon

FHM/ 1st

Orig: 1 cc: ~~Texas RRC~~  
cc:  
Mr. R. R. McCarty  
Mr. H. L. Beckman  
Dist. Supt.  
File

NUMBER OF COPIES RECEIVED	
DISTRIBUTION	
SANTA FE	
FILE	
U.S.G.S.	
LAND OFFICE	
TRANSPORTER	OIL
PRODUCTION OFFICE	GAS
OPERATOR	

# NEW MEXICO OIL CONSERVATION COMMISSION

FORM C-103  
(Rev 3-55)

## MISCELLANEOUS REPORTS ON WELLS

(Submit to appropriate District Office for Commission Rule 1106)

Name of Company Humble Oil & Refining Company		Address Box 2100, Hobbs, New Mexico			
Lease John D. Knox	Well No. 11	Unit Letter I	Section 10	Township 21-S	Range 36-E
Date Work Performed 12-7-63	Pool Oil Center Blinbry	County Lea			

THIS IS A REPORT OF: (Check appropriate block)

- ☐ Beginning Drilling Operations
 ☒ Casing Test and Cement Job
 ☐ Other (Explain):  
☐ Plugging
 ☐ Remedial Work

Detailed account of work done, nature and quantity of materials used, and results obtained.

Drilled to a total depth of 6225. Ran 6214' (196 jts) 4-1/2" J-55, 9.5# and 11.6#casing. Set at 6225. Cemented with 300 sxs regular 12% Gel plus 1/4# HR7 per sx 1/4# Flocele per sx., followed by 200 sxs Incor neat. POB at 6:45 PM, 12-7-63. Cement did not circulate. WOC 24 hours. Top of cement at 2400 by temp survey. Preparing to perforate.

Witnessed by C. L. Sparkman	Position Field Supt.	Company Humble Oil & Refining Co.
--------------------------------	-------------------------	--------------------------------------

FILL IN BELOW FOR REMEDIAL WORK REPORTS ONLY

### ORIGINAL WELL DATA

D F Elev.	T D	P BTD	Producing Interval	Completion Date
Tubing Diameter	Tubing Depth	Oil String Diameter	Oil String Depth	
Perforated Interval(s)				
Open Hole Interval		Producing Formation(s)		

### RESULTS OF WORKOVER

Test	Date of Test	Oil Production BPD	Gas Production MCFPD	Water Production BPD	GOR Cubic feet/Bbl	Gas Well Potential MCFPD
Before Workover						
After Workover						

### OIL CONSERVATION COMMISSION

I hereby certify that the information given above is true and complete to the best of my knowledge.

Approved by <i>[Signature]</i> Title District	Name <i>[Signature]</i>
Date DEC 19 1963	Position Agent
	Company Humble Oil & Refining Company

CORRECTION

## NOTICE OF INTENTION TO DRILL

HOBBS OFFICE O. C. C.

Notice must be given to the District Office of the Oil Conservation Commission and approval obtained before drilling or recompletion begins. If changes in the proposed plan are considered advisable, a copy of this notice showing such changes will be returned to the sender. Submit this notice in **QUINTUPLICATE**. One copy will be returned following approval. See additional instructions in Rules and Regulations of the Commission. If State Land submit 6 Copies Attach Form O-128 in triplicate to first 3 copies of form O-101

Midland, Texas  
(Place)

11-21-63  
(Date)

**OIL CONSERVATION COMMISSION  
SANTA FE, NEW MEXICO**

Gentlemen:

You are hereby notified that it is our intention to commence the Drilling of a well to be known as

Humble Oil & Refining Co.  
(Company or Operator)

J. D. Knox  
(Land)

Well No. 11

I

located 330 feet from the East line and 2310 feet from the South line of Section 10, T. 21-S., R. 36-E., NMPM.

(GIVE LOCATION FROM SECTION LINE) Oil Center Blinbry Pool, Lea County

If State Land the Oil and Gas Lease is No. Fee Land, J. D. Knox, Mineral Owner.

If patented land the owner is Rt. 2, Box 1986, Turlock, Calif.

Address

We propose to drill well with drilling equipment as follows: rotary

The status of plugging bond is on file

Drilling Contractor Unknown

We intend to complete this well in the Blinbry formation at an approximate depth of 6400 feet.

## CASING PROGRAM

We propose to use the following strings of Casing and to cement them as indicated:

Size of Hole	Size of Casing	Weight per Foot	New or Second Hand	Depth	Shots Cement
10-5/8	7-5/8 or 8-5/8	24#	New	1300	300*
6-3/4	4-1/2	9.5 & 11.6	New	6400	400**

If changes in the above plans become advisable we will notify you immediately.

**ADDITIONAL INFORMATION** (If recompletion give full details of proposed plan of work.)

\*Circl. to surf.

\*\*Circl. to 2400' or into the salt section.

Min. mud for samples.

HOWCO method of cntg. to be used.

CORES

3-Blinbry 5830-6200

Sincerely yours,

HUMBLE OIL & REFINING COMPANY

(Company or Operator)

By

Position Adm. Specialist

Send Communications regarding well to

Name R. R. McCarty

Address Box 1600, Midland, Texas

OIL CONSERVATION COMMISSION

Approved NOV 27 1963, 19

Exempt as follows:

HUMBLE LEASE NO. 16156 NEW MEXICO OIL CONSERVATION COMMISSION

STATE LEASE NO.  
FEDERAL LEASE NO.

Well Location and Acreage Dedication Plat

'Corrected Plat'

HOBBS OFFICE Form C-128  
Revised 5/1/57

Date November 20, 1963

Section A.

Operator Humble Oil & Refining Co. Lease John D. Knox  
Well No. 11 Unit Letter "I" Section 10 Township 21 South Range 36 East NMPM  
Located 2310 Feet From South Line 330 Feet From East Line  
County Lea G. L. Elevation Later Dedicated Acreage 80 Acres  
Name of Producing Formation Blinberry Pool Oil Center - Blinberry

1. Is the Operator the only owner\* in the dedicated acreage outlined on the plat below?  
Yes ☒ No ☐
2. If the answer to question one is "no", have the interests of all the owners been consolidated by communitization agreement or otherwise? Yes ☐ No ☐ If answer is "yes," Type of Consolidation \_\_\_\_\_
3. If the answer to question two is "no," list all the owners and thier respective interests below:

Owner

Land Description

Section B

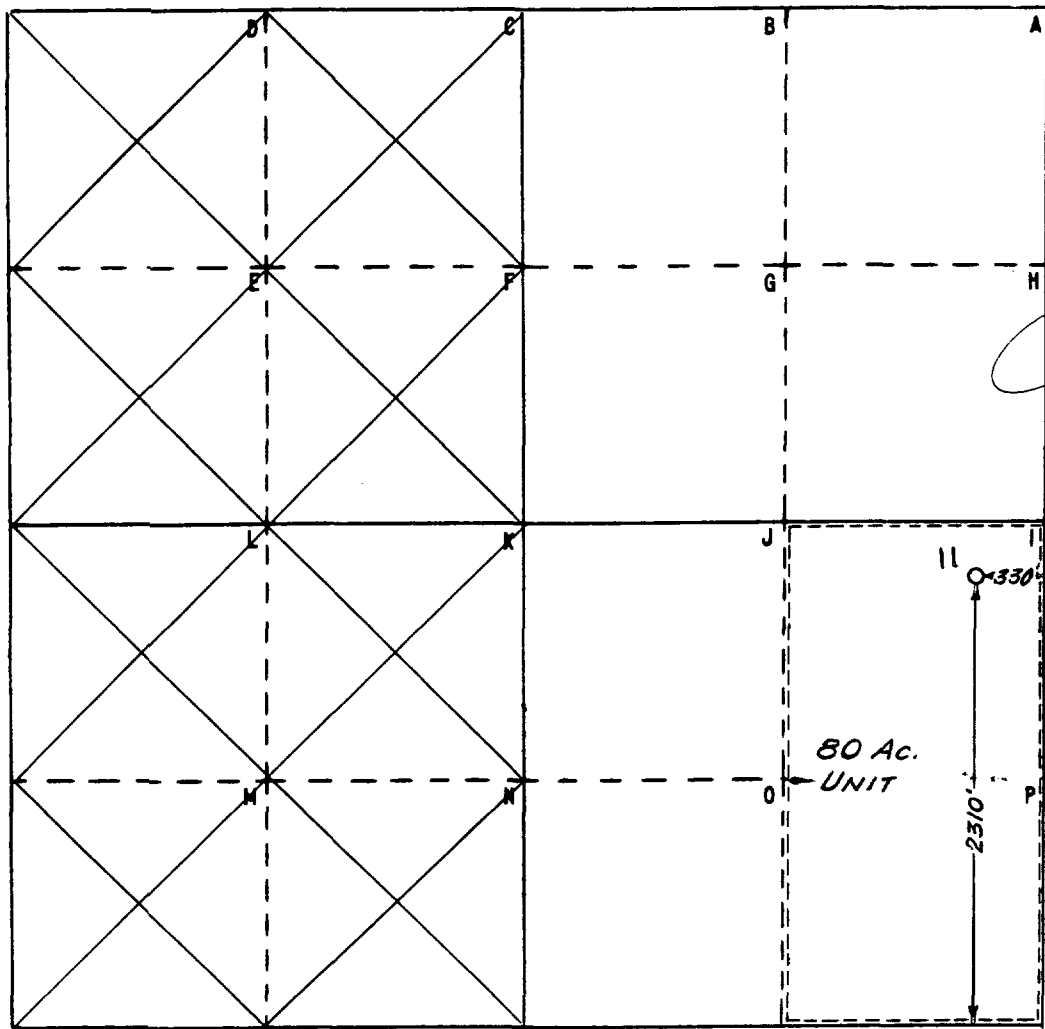

This is to certify that the information in Section A above is true and complete to the best of my knowledge and belief

HUMBLE OIL & REFG. CO.

(Operator)

(Representative)

Box 1600 Midland, Texas

Address

This is to certify that the well location shown on the plat in Section B was plotted from field notes of actual surveys made by me or under my supervision and that the same is true and correct to the best of my knowledge and belief.

Date Surveyed 11-14-63

Registered Professional Engineer and/or Land Surveyor

Certificate No. 554

0 330 660 990 1320 1650 1980 2310 2640 2000 1500 1000 500 0

FILE NO. W-A-

## NEW MEXICO OIL CONSERVATION COMMISSION

Santa Fe, New Mexico

Form O-101  
Revised (12/1/55)

HOBBS OFFICE O. C. C.

## NOTICE OF INTENTION TO DRILL

Notice must be given to the District Office of the Oil Conservation Commission and approval obtained before drilling or completion begins. If changes in the proposed plan are considered advisable, a copy of this notice showing such changes will be returned to the sender. Submit this notice in QUINTUPLICATE. One copy will be returned following approval. See additional instructions in Rules and Regulations of the Commission.

If State Land submit 6 Copies Attach Form O- 128 in triplicate to first 3 copies of form O-101

Midland, Texas

(Place)

11-15-63

(Date)

OIL CONSERVATION COMMISSION  
SANTA FE, NEW MEXICO

Gentlemen:

You are hereby notified that it is our intention to commence the Drilling of a well to be known as  
Humble Oil & Refining Co.

(Company or Operator)

J. D. Knox

(Lease)

Well No. 11

in I

(Unit)

The well is

located 330 feet from the East line and 1980 feet from the

South

line of Section 10

T. 21-S

R. 36-E

, NMPM.

(GIVE LOCATION FROM SECTION LINE) Oil Center Blinebry Pool, Lea County

If State Land the Oil and Gas Lease is No. Fee Land, J. D. Knox, Mineral Owner,

If patented land the owner is Rt. 2, Box 1986, Turlock, Calif.

Address

We propose to drill well with drilling equipment as follows: rotary

The status of plugging bond is on file

Drilling Contractor unknown

We intend to complete this well in the Blinebry

formation at an approximate depth of 6400 feet.

## CASING PROGRAM

We propose to use the following strings of Casing and to cement them as indicated:

Size of Hole	Size of Casing	Weight per Foot	New or Second Hand	Depth	Sacks Cement
10-5/8	7-5/8 or 8-5/8	24#	New	1300	300*
6-3/4	4-1/2	9.5 & 11.6	New	6400	400**

If changes in the above plans become advisable we will notify you immediately.

ADDITIONAL INFORMATION (If recompletion give full details of proposed plan of work.)

\*Circl. to surf.

\*\*Circl. to 2400' or into the salt section.

Min. mud for samples.

HOWCO method of cmtg. to be used.

NOV 19 1963

Approved....., 19.....  
Except as follows:

Sincerely yours,

HUMBLE OIL &amp; REFINING COMPANY

(Company or Operator)

By

Position Adm. Specialist

Send Communications regarding well to

Name R. R. McCarty

Address Box 1600, Midland, Texas

OIL CONSERVATION COMMISSION

By

HUMBLE LEASE NO. 16156

## NEW MEXICO OIL CONSERVATION COMMISSION

Form C-128

STATE LEASE NO.

FEDERAL LEASE NO.

Well Location and Acreage Dedication Plat HOBBS OFFICE NOV 11/57

Section A.

1963 NOV 22 AM 8:37 Date NOV 19 10 1/2 AM '63  
 Operator Humble Oil & Refining Co. Lease John D. Knox  
 Well No. 11 Unit Letter "I" Section 10 Township 21 South Range 36 East NMPM  
 Located 2310 Feet From South Line, 330 Feet From East Line  
 County Lea G. L. Elevation Later Dedicated Acreage 80 Acres  
 Name of Producing Formation Blinbry Pool Oil Center - Blinbry

1. Is the Operator the only owner\* in the dedicated acreage outlined on the plat below?  
 Yes ☒ No ☐  
 2. If the answer to question one is "no", have the interests of all the owners been consolidated by communitization agreement or otherwise? Yes ☐ No ☐ If answer is "yes," Type of Consolidation \_\_\_\_\_  
 3. If the answer to question two is "no," list all the owners and thier respective interests below:

OwnerLand Description

Section B

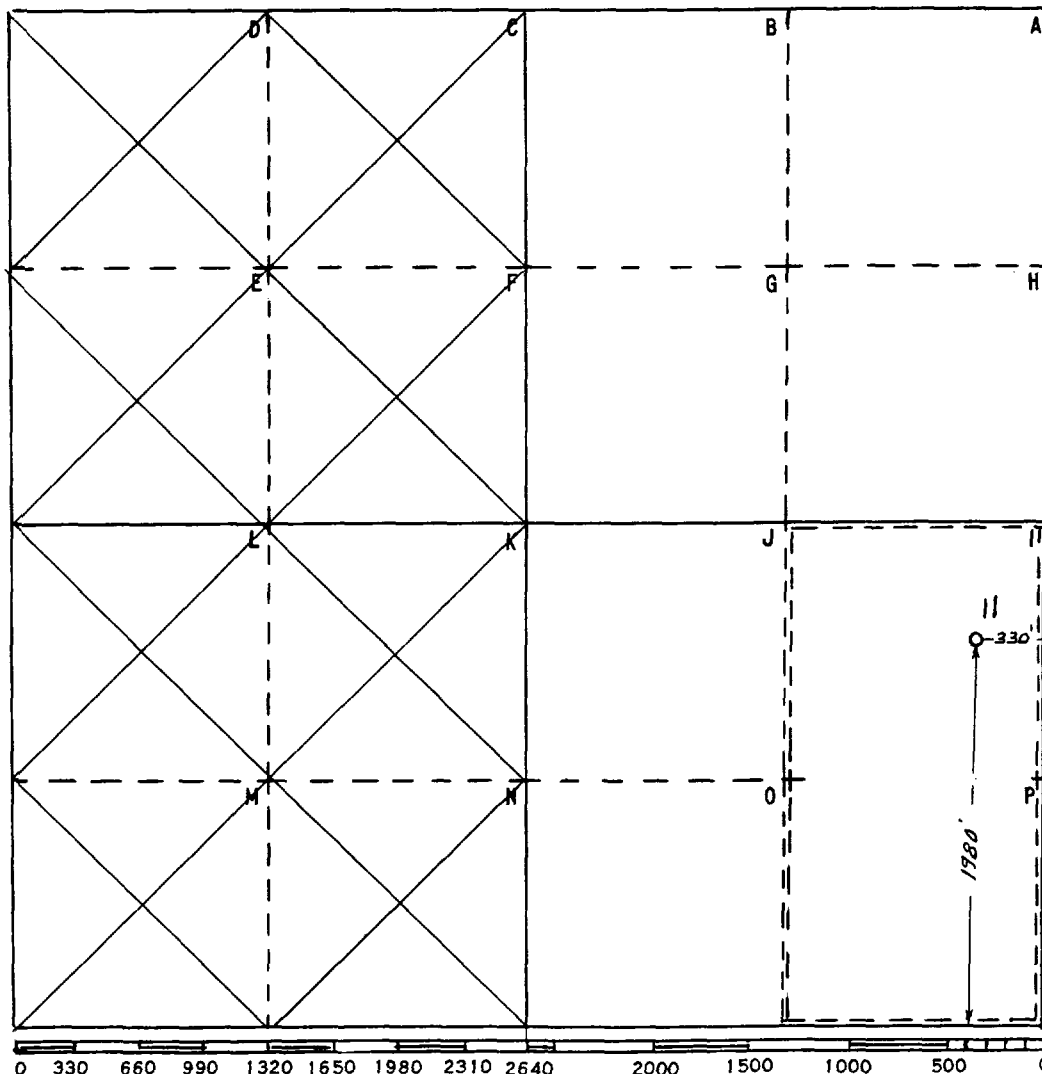

This is to certify that the information in Section A above is true and complete to the best of my knowledge and belief

HUMBLE OIL &amp; REFG. CO.

(Operator)

H. P. Hensley  
 (Representative)

Box 1600 Midland, Texas  
 Address

This is to certify that the well location shown on the plat in Section B was plotted from field notes of actual surveys made by me or under my supervision and that the same is true and correct to the best of my knowledge and belief.

Date Surveyed 11-14-63

R. A. Estes  
 Registered Professional  
 Engineer and/or Land Surveyor

Certificate No. 554

FILE NO. W-A-2206

COUNTY	LEA	FIELD Oil Center-Blinebry STATE N.M.		
OPR	HUMBLE OIL & REFG. COMPANY			MAP
11 Knox, J. D.				
Sec. 10, T-21-S, R-36-E				CO-ORD
2310' fr S Line & 330' fr E Line of Sec.				
Spudded 11-23-63				
Completed 2-10-64		CLASS	EL	
		FORMATION	DATUM	FORMATION
		DATUM		
CSG & SX - TUBING		LOG:		
		B/Salt 2562		
7 5/8" 1329' 575		Queen 3390		
4 1/2" 6225' 500		Grb 3666		
		SA 3943		
		Glor 5292		
LOGS EL GR RA IND HC A		Bli 5885		
TD 6225', PB 6204'				

IP Blinebry Perfs 5812-5945' Flwd 71 BOPD. Pot. Based on 24 hr test thru 3/8" chk., TP 50#, GOR 690, gravity 37.8.

Distribution limited and publication prohibited by subscribers' agreement.  
Reproduction rights reserved by Williams & Lee Scouting Service, Inc.

CONT.	PROP DEPTH	6400'	TYPE
DATE			

F.R. 11-21-63  
PD 6400' - Blinebry

11-26-63 Drlg. 2607'.  
12-2-63 Drlg. 4919'.  
12-9-63 TD 6225', prep to perf.  
12-16-63 TD 6225', swbg.  
Perf @ 5913', 5919', 5922', 5932', 5936' & 5945' W/1 SPI  
Ac. 2000 gals.  
Swbd 18 BLO + 10 BAW/8 hrs.  
Re-Ac. 6000 gals.  
Swbd & flwd 27 BLO + 50 BNO in 72 hrs.

12-30-63 TD 6225', PB 6204', tstg.  
Frac 20,000 gals oil + 30,000# sd. (5913-45')  
Flwd 25 BLO/6 hrs thru 3/8" chk., TP 50#. (-353 BLO).

1-6-64 TD 6225', PB 6204', WO Potential.  
1-13-64 TD 6225', PB 6204', WO Potential.  
1-20-64 TD 6225', PB 6204', tstg.  
Perf @ 5812', 5816', 5825', 5835', 5838', 5842', 5847' & 5859' W/1 SPI

1-20-64 -cont'd-  
Set ret. BP @ 5885'  
Ac. 5000 gals  
Swbd 34 BNO + 12 BAW/9 hrs.  
1-27-64 TD 6225', PB 6204', prep to pull BP.  
Frac 10,000 gals oil + 7451# sd. (5812-59')  
Rec load & swbd 20 BO/2 hrs.  
2-3-64 TD 6225', PB 6204', tstg.  
Pulled BP @ 5885'.  
Swbd & flwd 101 BNO/24 hrs thru 3/8" chk.,  
TP 150#.  
2-10-64 TD 6225', PB 6204', tstg.  
Flwd 146 BO/67 hrs.  
2-17-64 TD 6225', PB 6204', COMPLETED.



STATE OF NEW MEXICO  
ENERGY, MINERALS, AND NATURAL RESOURCES DEPARTMENT  
OIL CONSERVATION DIVISION

IN THE MATTER OF THE HEARING  
CALLED BY THE OIL CONSERVATION  
DIVISION FOR THE PURPOSE OF  
CONSIDERING:

DO 3/5/93  
25 3/5/93  
CASE NO. 10674  
Order No. R-9854

APPLICATION OF EXXON CORPORATION  
FOR AN UNORTHODOX GAS WELL LOCATION  
AND SIMULTANEOUS DEDICATION, LEA  
COUNTY, NEW MEXICO.

ORDER OF THE DIVISION

BY THE DIVISION:

This cause came on for hearing at 8:15 a.m. on March 4, 1993,  
at Santa Fe, New Mexico, before Examiner David R. Catanach.

NOW, on this \_\_\_\_\_ day of March, 1993, the Division Director,  
having considered the record and the recommendations of the  
Examiner, and being fully advised in the premises,

FINDS THAT:

The applicant's request for dismissal should be granted.

IT IS THEREFORE ORDERED THAT:

Case No. 10674 is hereby dismissed.

DONE at Santa Fe, New Mexico, on the day and year hereinabove  
designated.

STATE OF NEW MEXICO  
OIL CONSERVATION DIVISION

WILLIAM J. LEMAY  
Director

S E A L

MS 10/22/93

STATE OF NEW MEXICO  
ENERGY, MINERALS, AND NATURAL RESOURCES DEPARTMENT  
OIL CONSERVATION DIVISION

IN THE MATTER OF THE HEARING  
CALLED BY THE OIL CONSERVATION  
DIVISION FOR THE PURPOSE OF  
CONSIDERING:

WTP  
10/20/93

RECEIVED  
CASE NO. 10674  
Order No. R-9854 -A

APPLICATION OF EXXON CORPORATION  
FOR AN UNORTHODOX GAS WELL LOCATION  
AND SIMULTANEOUS DEDICATION, LEA  
COUNTY, NEW MEXICO.

ORDER OF THE DIVISION

BY THE DIVISION:

September 23

This cause came on for hearing at 8:15 a.m. on ~~March 4~~, 1993, at Santa Fe, New Mexico, before Examiner ~~David R. Catanzani~~ *Michael E. Stegner*.

*October*

NOW, on this ~~10th~~ day of ~~March~~, 1993, the Division Director, having considered the record and the recommendations of the Examiner, and being fully advised in the premises,

FINDS THAT:

(1) Due public notice having been given as required by law, the Division has jurisdiction of this cause and the subject matter thereof.

(2) *Exxon Corporation*  
The Applicant seeks approval of an unorthodox gas well location for its existing John D. Knox Well No. 11 located 2310 feet from the South line and 330 feet from the East line (Unit I) of Section 10, Township 21 South, Range 36 East, *N.M.P.M.* Eumont Gas Pool, *Lea County, New Mexico*, + Said well is to be simultaneously dedicated with the John D. Knox Well Nos. 1 and 13 located in Units J and H, respectively, of said Section 10 to ~~the~~ *a previously approved* 320-acre Eumont Gas spacing and proration unit comprising the E/2 of said Section 10. *Uncon-standard* Said unit is located approximately one mile southeast of ~~Oil Center, New Mexico.~~ *(Division Administrative Order NSP-77A, dated January 24, 1955).*

(3) This case was originally docketed for hearing on March 4, 1993; however at the applicant's request this matter was dismissed from those proceedings.

(4) By application dated September 1, 1993 Exxon Corporation again requested this matter be placed on the docket for hearing before a Division Examiner.

(5) Prior to the September 23, 1993 hearing the applicant requested this case be dismissed.

(4) The applicant's request for dismissal should be granted.

IT IS THEREFORE ORDERED THAT:

*Reopened*  
Case No. ~~10624~~ is hereby dismissed.  
*10674*

DONE at Santa Fe, New Mexico, on the day and year hereinabove designated.

STATE OF NEW MEXICO  
OIL CONSERVATION DIVISION

*William J. Lema*  
WILLIAM J. LEMAY  
Director