

KELLAHIN AND KELLAHIN

ATTORNEYS AT LAW

EL PATIO BUILDING

117 NORTH GUADALUPE

POST OFFICE BOX 2265

SANTA FE, NEW MEXICO 87504-2265

W. THOMAS KELLAHIN*

*NEW MEXICO BOARD OF LEGAL SPECIALIZATION
RECOGNIZED SPECIALIST IN THE AREA OF
NATURAL RESOURCES-OIL AND GAS LAW

TELEPHONE (505) 982-4285

TELEFAX (505) 982-2047

JASON KELLAHIN (RETIRED 1991)

March 29, 1993

Mr. William J. LeMay
Oil Conservation Division
State Land Office Building
310 Old Santa Fe Trail, 2nd Floor
Santa Fe, New Mexico 87501

HAND DELIVERED

10720

RE: Black Diamond Com. 20 No. 1 Well
Application of Meridian Oil Inc.
To Reopen NMOCD Case 10486 and to
Amend Division Order R-9702 for a
Previously Approved High Angle/Horizontal
Direction Drilling Pilot Project and
Special Operating Rules Therefor,
San Juan County, New Mexico

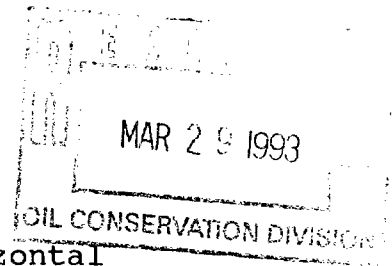

Dear Mr. LeMay:

On behalf of Meridian Oil Inc., please find enclosed our Application to Reopen NMOCD Case 10486 and to Amend Division Order R-9702 in order to change the commencement point and correspondingly the azimuth of the previously approved Black Diamond Com 20 No 1 Well for the High Angle/Horizontal Direction Drilling Pilot Project as referenced above.

We request that this application be set for hearing on the next available Examiner's docket now scheduled for April 22, 1993.

By copy of this letter and application, sent certified mail, we are notifying all interested parties within a 1/2 mile radius of the subject well of their right to appear at the hearing and participate in this case, including the right to present evidence either in support of or in opposition to the application.

Mr. William J. LeMay
March 29, 1993
Page Two

Also, all parties entitled to notice are hereby informed that pursuant to Division Memorandum 2-90 all parties appearing in this case are requested to file a Pre-Hearing Statement with the Division, with copies to the undersigned, no later than 4:00 PM on Friday, April 16, 1993.

Very truly yours,

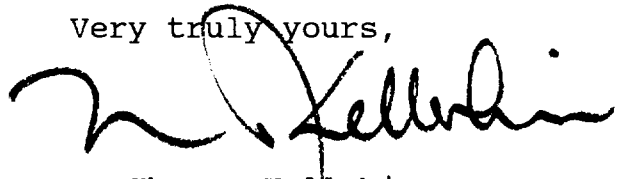

W. Thomas Kellahin

WTK/lam
Enclosure

cc: Mr. John Zent
Meridian Oil Inc.
Post Office Box 4289
Farmington, New Mexico 87499-4289

By Certified Mail - Return Receipt

All Parties Listed on Exhibit "D" of Application

SUGGESTED ADVERTISEMENT:

16720

CASE 10486 (REOPENED): Application of Meridian Oil Inc. to reopen Case 10486 and to amend Division Order R-9702, San Juan County, New Mexico. Applicant seeks to reopen Case 10486 and to amend Division Order R-9702 in order to change the commencement point of its previously approved Black Diamond Com "20" Well No. 1 to commence at an unorthodox surface location 120 feet FNL and 120 feet FWL of Section 20, Township 30 North, Range 15 West, being a previously approved High Angle/Horizontal Direction Drilling Pilot Project located in the W/2 of said Section 20, Undesignated Horseshoe-Gallup Oil Pool. Said pilot project area is located approximately 4.75 miles northwest by north of Fruitland, New Mexico.

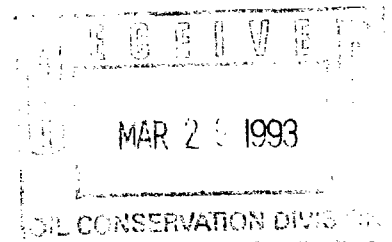

STATE OF NEW MEXICO
ENERGY, MINERALS AND NATURAL RESOURCES DEPARTMENT
OIL CONSERVATION DIVISION

IN THE MATTER OF THE HEARING
CALLED BY THE OIL CONSERVATION
DIVISION FOR THE PURPOSE OF
CONSIDERING:

CASE:

APPLICATION OF MERIDIAN OIL INC.
TO REOPEN NMOCD CASE 10486 AND
TO AMENDED DIVISION ORDER R-9702
FOR A PREVIOUSLY APPROVED HIGH
ANGLE/HORIZONTAL DIRECTION
DRILLING PILOT PROJECT AND
SPECIAL OPERATING RULES,
SAN JUAN COUNTY, NEW MEXICO

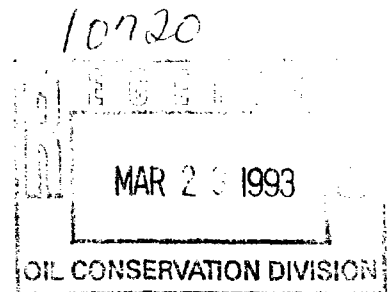

A P P L I C A T I O N

Comes now Meridian Oil Inc., by and through its attorneys, Kellahin, Kellahin & Aubrey, and applies to the New Mexico Oil Conservation Division to **reopen** Case 10486 and to amend Division Order R-9702 in order to change the commencement point of its previously approved Black Diamond Com "20" Well No. 1 to commence at an unorthodox surface location 120 feet FNL and 120 feet FWL of Section 20, Township 30 North, Range 15 West, being a previously approved High Angle/Horizontal Direction Drilling Pilot Project located in the W/2 of

said Section 20, Undesignated Horseshoe-Gallup Oil Pool. Said pilot project area is located approximately 4.75 miles northwest by north of Fruitland, New Mexico.

In support thereof Meridian Oil Inc. states:

(1) Applicant is an operator in Section 20, T30N, R15W, N.M.P.M., San Juan County, New Mexico.

(2) On August 6, 1992, The Division entered Order R-9702 which, among other things, approved applicant's High Angle/ Horizontal Directional Drilling Pilot Project for Section 20, T30N, R15W and authorized applicant to commence its proposed Black Diamond "20" Well No. 1 at an unorthodox surface location in the SE/4SW/4 of Section 20 estimated to be 195 feet FSL and 2510 feet FWL of said Section 20.

(3) Applicant has re-evaluated its well prognosis and now seeks to place the surface location for the Black Diamond "20" Well No 1 in the NW/4NW/4 commencing at a point 120 feet FNL and 120 feet FWL of said Section 20, with a projected bottom hole location no

closer than 330 feet from the outer boundary of a spacing unit consisting of the W/2 of said Section 20.

(4) The proposed amendments to Order R-9702 will allow the applicant to drill the subject well vertically to a depth of approximately 4250 feet and then come up hole to a point at approximately 3579 feet where applicant will kick off the well in an southeasterly direction (approximately azimuth of 155 degrees) and commence to build an angle of 12^{degrees} per 100 feet to approximately 80^{degrees} and penetrate the top of the "Waterflow" zone of the Niobrara member of the Horseshoe Gallup Oil Pool at an estimated total vertical depth of 4085 feet, and then to continue to build angle to 90 degrees and thence drilling horizontally in a lateral distance not in excess of 4689 feet and no closer than 330 feet to the outer boundaries of the 320-acre spacing and proration unit. See Exhibits "A," "B," and "C."

(5) Applicant proposes that Decretory Paragraphs (1) and (2) of Division Order R-9702 be deleted and new Decretory Paragraphs (1) and (2) be adopted as follows"

"(1) The applicant, Meridian Oil Inc. is hereby authorized to initiate a high angle/horizontal directional drilling pilot project in the W/2 of Section 20, T30N, R15W, NMPM, Undesignated Horseshoe-Gallup Oil Pool, San Juan County, New Mexico, by drilling its Black Diamond "20" Well No.1 from an unorthodox surface location 120 feet from the North and West lines (Unit D) of Section 20, in the following unconventional manner:

Drill vertically to a depth of approximately 4250 feet and then come up hole to a point at approximately 3579 feet and kick off the well in an southeasterly direction (approximately azimuth of 155 degrees) and commence to build an angle of 12^{degrees} per 100 feet to approximately 80^{degrees} and penetrate the top of the Waterflow" zone of the Niobrara member of Horseshoe Gallup Oil Pool at an estimated total vertical depth of 4085 feet, and then to continue to build angle to 90 degrees and thence drilling horizontally in a lateral

distance not in excess of 4689 feet and no closer than 330 feet to the outer boundary of the designated project area.

PROVIDED HOWEVER THAT, no portion of the horizontal portion of the wellbore shall be located closer than 330 feet from the outer boundary of the project area."

(2) The applicant shall dedicate the W/2 of Section 20 to the above described well forming a non-standard 320 acre oil spacing and proration unit which is also hereby approved."

(6) The Waterflow interval of the Gallup is believed to be the potential productive zone at this location in the Horseshoe Gallup Oil Pool. This interval produces through intergranular permeability.

(7) Past experience in said pool has shown that unless a conventionally drilled (vertical) well intersects natural fractures, the chance of obtaining commercial production is severely curtailed.

(8) By amending its surface location, applicant is attempting to increase the probability of encountering several of these fractures, which may ultimately result in the recovery of a greater amount of gas and oil, thereby preventing waste.

(9) In as much as the exact distance and direction of the lateral portion of the wellbore is not known at this time, the Applicant seeks approval to be allowed to drill and produce said lateral portion anywhere within an area designated a target window as follows: commencing at a distance not closer than 330 feet from any of the side boundaries of the proposed spacing unit so that within the drilling window no portion of the wellbore open for production shall be closer than 330 feet to the outer boundary of the spacing unit.

(10) As required, notice is provided to those offsetting operators as listed on Exhibit "D."

(11) The granting of this Application will be in the best interest of conservation, the prevention of waste and the protection of correlative rights.

Application of Meridian Oil Inc.
Page 7

WHEREFORE, Applicant requests that this matter be set for hearing on April 22, 1993 before a duly appointed Examiner of the Oil Conservation Division and, after notice and hearing as required by law, the Division enter its Order granting this application.

Respectfully submitted,

KELLAHIN and KELLAHIN

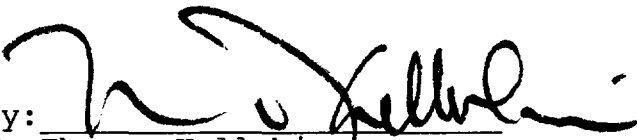
By: 

W. Thomas Kellahin
Post Office Box 2265
Santa Fe, New Mexico 87504
(505) 982-4285
Attorneys for Applicant

BLACK DIAMOND COM 20-1
SEC 20, T30N-R15W

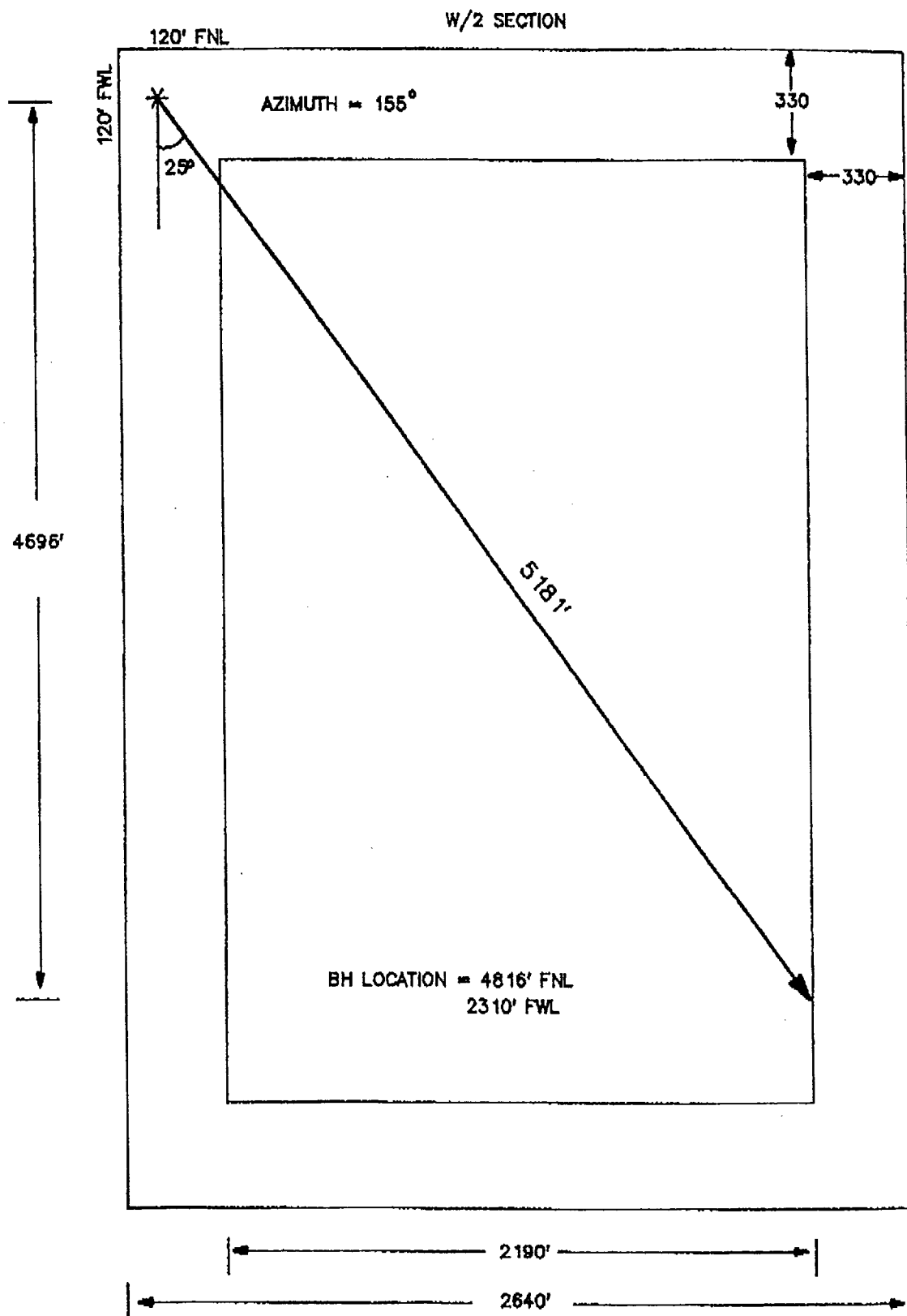

AMM 03/25/03

BLACK DIAMOND COM 20 #1 NW/NW 20-T30N-R15W

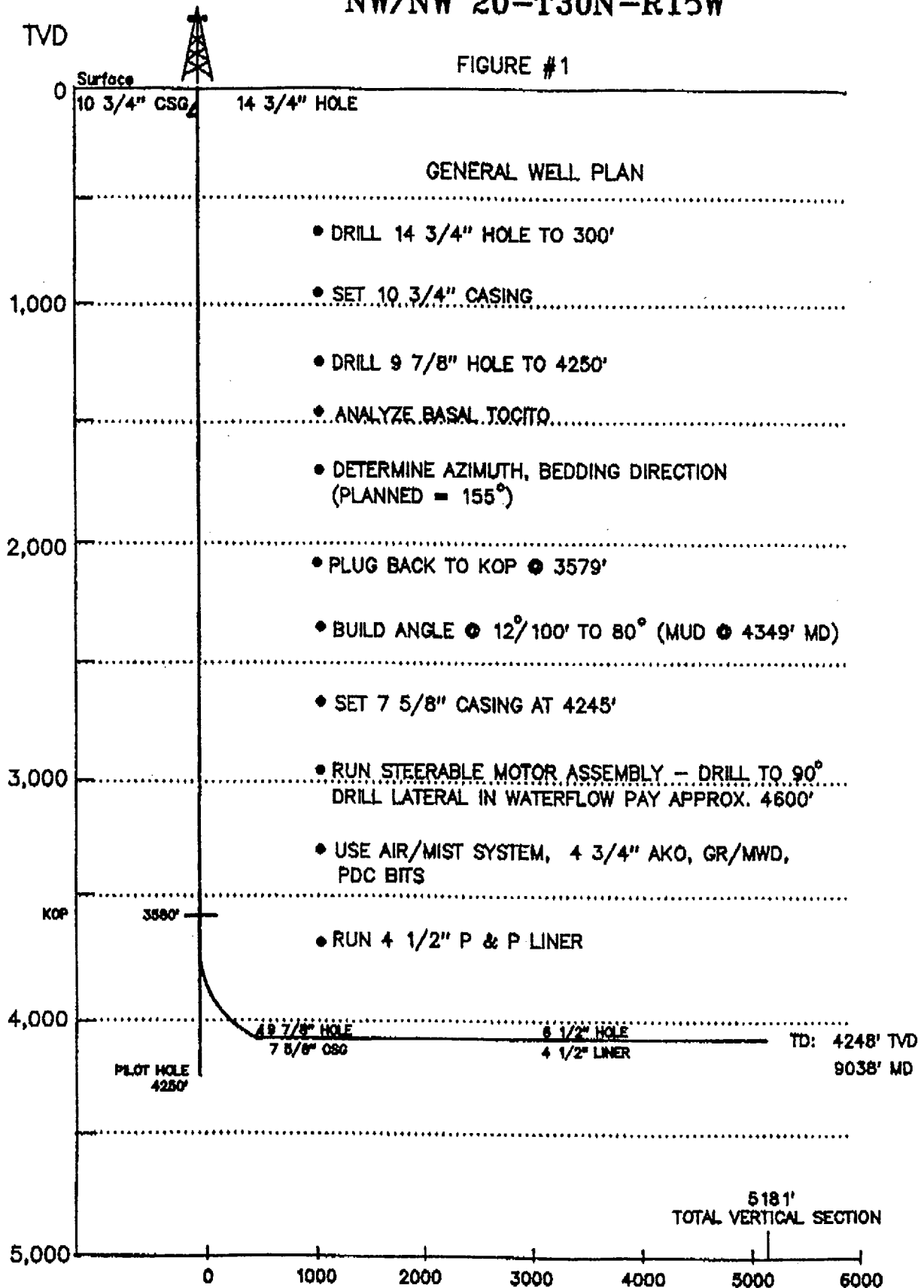

MM 03/25/93

BLACK DIAMOND COM #20-1 PROPOSED DIRECTIONAL WELL PLAN

ASSUMED 2° DIP (NOT SHOWN) LATERAL INCL. = 88°
 TARGET TVD = 4093' @ 88° TO 4247' @ 88°
 TOP POSSIBLE PRODUCTION TVD = 4067 TVD (2° DIP)
 TOTAL LATERAL ZONE = 4689'

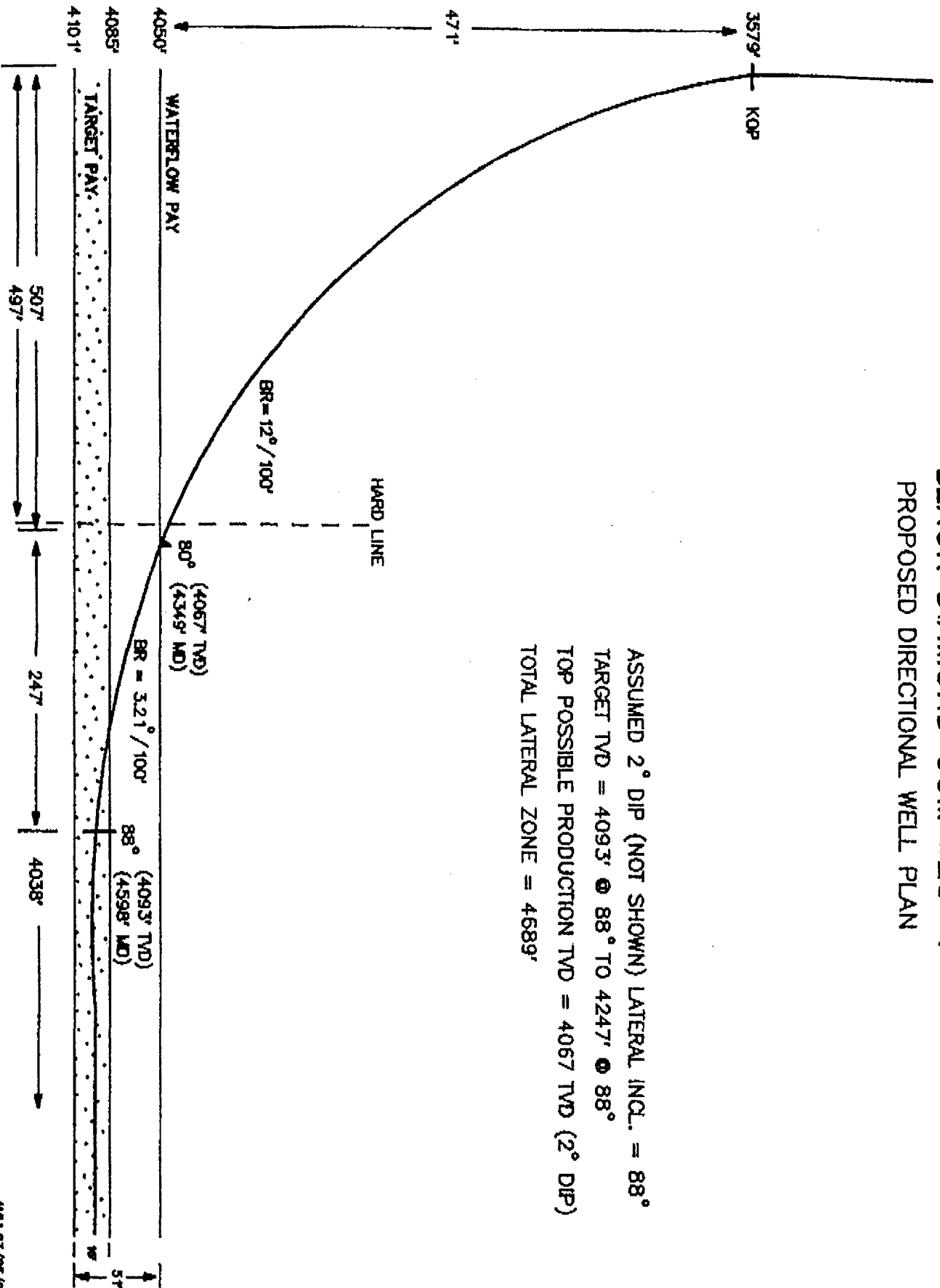

MM 03/25/93

**BLACK DIAMOND 20 #1
W/2 SECTION 20 T30N, R15W
SAN JUAN COUNTY, NEW MEXICO**

OFFSET OWNERSHIP

1. ● MOI
2. ● EP Operating Company
 4849 Greenville Ave, Ste 1200
 Dallas, TX 75206-4186
3. ● MOI

 ● Oxford Exploration Co.
 4582 S. Ulster St, Ste 1500
 Stenford Place III
 Denver, CO 80237
4. ● Yates Petroleum Corporation
 105 S. Fourth Street
 Artesia, NM 88201
5. ● MOI

 ● Richardson Operating Company
 P.O. Box 9808
 Denver, CO 80209
6. ● MOI

 ● SRC

 ● Read & Stevens
 P.O. Box 1518
 Roswell, NM 88201

 ● Westway Petroleum
 500 N. Akard St.
 Dallas, TX 75201-3394
7. ● BLM-Santa Fe

 ● Unleased

8. ● Amoco Production Company
P.O. Box 800
Denver, CO 80202
9. ● Evko Development
4710 Cabrillo St.
San Francisco, CA 94121
10. ● L.T Barringer/W.H. Atkins
11 W. Nettleton Ave.
Memphis, TN 38103
11. ● MOI
 - Unleased
 - Mary Lettman
James Lettman
Pat Buckway
Route 3, Box 158 F
Poteau, OK 74954
 - Clifford C Coppinger
19850 N. 27th Place
Phoenix, AZ 85024
 - LeRoy A Brimhall
205 Manana Place
Farmington, NM 87401
 - Ronald M. Brimhall
P.O. Box 11
Wellborn, TX 77881
 - Ethel Brimhall Foutz, Estate
P.O. Box 262
Farmington, NM 87499

KELLAHIN AND KELLAHIN

ATTORNEYS AT LAW

EL PATIO BUILDING

117 NORTH GUADALUPE

POST OFFICE BOX 2265

SANTA FE, NEW MEXICO 87504-2265

W. THOMAS KELLAHIN*

*NEW MEXICO BOARD OF LEGAL SPECIALIZATION
RECOGNIZED SPECIALIST IN THE AREA OF
NATURAL RESOURCES-OIL AND GAS LAW

TELEPHONE (505) 982-4285
TELEFAX (505) 982-2047

JASON KELLAHIN (RETIRED 1991)

March 29, 1993

Mr. William J. LeMay
Oil Conservation Division
State Land Office Building
310 Old Santa Fe Trail, 2nd Floor
Santa Fe, New Mexico 87501

HAND DELIVERED

10720

RE: Black Diamond Com. 20 No. 1 Well
Application of Meridian Oil Inc.
To Reopen NMOCD Case 10486 and to
Amend Division Order R-9702 for a
Previously Approved High Angle/Horizontal
Direction Drilling Pilot Project and
Special Operating Rules Therefor,
San Juan County, New Mexico

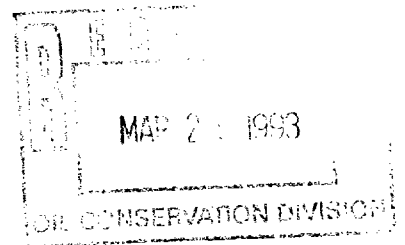

Dear Mr. LeMay:

On behalf of Meridian Oil Inc., please find enclosed our Application to Reopen NMOCD Case 10486 and to Amend Division Order R-9702 in order to change the commencement point and correspondingly the azimuth of the previously approved Black Diamond Com 20 No 1 Well for the High Angle/Horizontal Direction Drilling Pilot Project as referenced above.

We request that this application be set for hearing on the next available Examiner's docket now scheduled for April 22, 1993.

By copy of this letter and application, sent certified mail, we are notifying all interested parties within a 1/2 mile radius of the subject well of their right to appear at the hearing and participate in this case, including the right to present evidence either in support of or in opposition to the application.

Mr. William J. LeMay
March 29, 1993
Page Two

Also, all parties entitled to notice are hereby informed that pursuant to Division Memorandum 2-90 all parties appearing in this case are requested to file a Pre-Hearing Statement with the Division, with copies to the undersigned, no later than 4:00 PM on Friday, April 16, 1993.

Very truly yours,

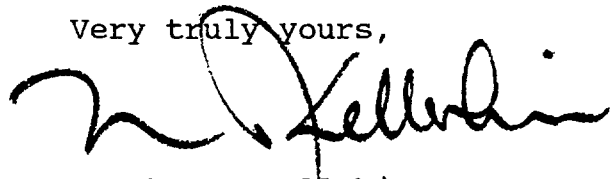
A handwritten signature in black ink, appearing to read 'W. Thomas Kellahin', written over the closing 'yours,'.

W. Thomas Kellahin

WTK/lam
Enclosure

cc: Mr. John Zent
Meridian Oil Inc.
Post Office Box 4289
Farmington, New Mexico 87499-4289

By Certified Mail - Return Receipt

All Parties Listed on Exhibit "D" of Application

SUGGESTED ADVERTISEMENT:

10720

CASE 10486(REOPENED): Application of Meridian Oil Inc. to reopen Case 10486 and to amend Division Order R-9702, San Juan County, New Mexico. Applicant seeks to reopen Case 10486 and to amend Division Order R-9702 in order to change the commencement point of its previously approved Black Diamond Com "20" Well No. 1 to commence at an unorthodox surface location 120 feet FNL and 120 feet FWL of Section 20, Township 30 North, Range 15 West, being a previously approved High Angle/Horizontal Direction Drilling Pilot Project located in the W/2 of said Section 20, Undesignated Horseshoe-Gallup Oil Pool. Said pilot project area is located approximately 4.75 miles northwest by north of Fruitland, New Mexico.

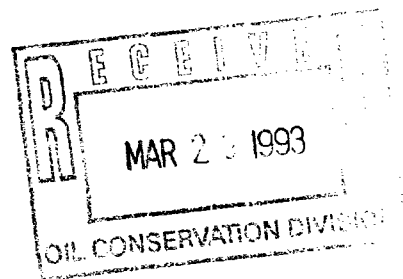

STATE OF NEW MEXICO
ENERGY, MINERALS AND NATURAL RESOURCES DEPARTMENT
OIL CONSERVATION DIVISION

IN THE MATTER OF THE HEARING
CALLED BY THE OIL CONSERVATION
DIVISION FOR THE PURPOSE OF
CONSIDERING:

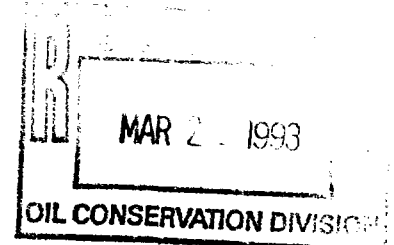

CASE: 10720

APPLICATION OF MERIDIAN OIL INC.
TO REOPEN NMOC CASE 10486 AND
TO AMENDED DIVISION ORDER R-9702
FOR A PREVIOUSLY APPROVED HIGH
ANGLE/HORIZONTAL DIRECTION
DRILLING PILOT PROJECT AND
SPECIAL OPERATING RULES,
SAN JUAN COUNTY, NEW MEXICO

A P P L I C A T I O N

Comes now Meridian Oil Inc., by and through its
attorneys, Kellahin, Kellahin & Aubrey, and applies to
the New Mexico Oil Conservation Division to **reopen** Case
10486 and to amend Division Order R-9702 in order to
change the commencement point of its previously
approved Black Diamond Com "20" Well No. 1 to commence
at an unorthodox surface location 120 feet FNL and 120
feet FWL of Section 20, Township 30 North, Range 15
West, being a previously approved High Angle/Horizontal
Direction Drilling Pilot Project located in the W/2 of

said Section 20, Undesignated Horseshoe-Gallup Oil Pool. Said pilot project area is located approximately 4.75 miles northwest by north of Fruitland, New Mexico.

In support thereof Meridian Oil Inc. states:

(1) Applicant is an operator in Section 20, T30N, R15W, N.M.P.M., San Juan County, New Mexico.

(2) On August 6, 1992, The Division entered Order R-9702 which, among other things, approved applicant's High Angle/ Horizontal Directional Drilling Pilot Project for Section 20, T30N, R15W and authorized applicant to commence its proposed Black Diamond "20" Well No. 1 at an unorthodox surface location in the SE/4SW/4 of Section 20 estimated to be 195 feet FSL and 2510 feet FWL of said Section 20.

(3) Applicant has re-evaluated its well prognosis and now seeks to place the surface location for the Black Diamond "20" Well No 1 in the NW/4NW/4 commencing at a point 120 feet FNL and 120 feet FWL of said Section 20, with a projected bottom hole location no

closer than 330 feet from the outer boundary of a spacing unit consisting of the W/2 of said Section 20.

(4) The proposed amendments to Order R-9702 will allow the applicant to drill the subject well vertically to a depth of approximately 4250 feet and then come up hole to a point at approximately 3579 feet where applicant will kick off the well in an southeasterly direction (approximately azimuth of 155 degrees) and commence to build an angle of 12^{degrees} per 100 feet to approximately 80^{degrees} and penetrate the top of the "Waterflow" zone of the Niobrara member of the Horseshoe Gallup Oil Pool at an estimated total vertical depth of 4085 feet, and then to continue to build angle to 90 degrees and thence drilling horizontally in a lateral distance not in excess of 4689 feet and no closer than 330 feet to the outer boundaries of the 320-acre spacing and proration unit. See Exhibits "A," "B," and "C."

(5) Applicant proposes that Decretory Paragraphs (1) and (2) of Division Order R-9702 be deleted and new Decretory Paragraphs (1) and (2) be adopted as follows"

"(1) The applicant, Meridian Oil Inc. is hereby authorized to initiate a high angle/horizontal directional drilling pilot project in the W/2 of Section 20, T30N, R15W, NMPM, Undesignated Horseshoe-Gallup Oil Pool, San Juan County, New Mexico, by drilling its Black Diamond "20" Well No.1 from an unorthodox surface location 120 feet from the North and West lines (Unit D) of Section 20, in the following unconventional manner:

Drill vertically to a depth of approximately 4250 feet and then come up hole to a point at approximately 3579 feet and kick off the well in an southeasterly direction (approximately azimuth of 155 degrees) and commence to build an angle of 12^{degrees} per 100 feet to approximately 80^{degrees} and penetrate the top of the Waterflow" zone of the Niobrara member of Horseshoe Gallup Oil Pool at an estimated total vertical depth of 4085 feet, and then to continue to build angle to 90 degrees and thence drilling horizontally in a lateral

distance not in excess of 4689 feet and no closer than 330 feet to the outer boundary of the designated project area.

PROVIDED HOWEVER THAT, no portion of the horizontal portion of the wellbore shall be located closer than 330 feet from the outer boundary of the project area."

(2) The applicant shall dedicate the W/2 of Section 20 to the above described well forming a non-standard 320 acre oil spacing and proration unit which is also hereby approved."

(6) The Waterflow interval of the Gallup is believed to be the potential productive zone at this location in the Horseshoe Gallup Oil Pool. This interval produces through intergranular permeability.

(7) Past experience in said pool has shown that unless a conventionally drilled (vertical) well intersects natural fractures, the chance of obtaining commercial production is severely curtailed.

(8) By amending its surface location, applicant is attempting to increase the probability of encountering several of these fractures, which may ultimately result in the recovery of a greater amount of gas and oil, thereby preventing waste.

(9) In as much as the exact distance and direction of the lateral portion of the wellbore is not known at this time, the Applicant seeks approval to be allowed to drill and produce said lateral portion anywhere within an area designated a target window as follows: commencing at a distance not closer than 330 feet from any of the side boundaries of the proposed spacing unit so that within the drilling window no portion of the wellbore open for production shall be closer than 330 feet to the outer boundary of the spacing unit.

(10) As required, notice is provided to those offsetting operators as listed on Exhibit "D."

(11) The granting of this Application will be in the best interest of conservation, the prevention of waste and the protection of correlative rights.

Application of Meridian Oil Inc.
Page 7

WHEREFORE, Applicant requests that this matter be set for hearing on April 22, 1993 before a duly appointed Examiner of the Oil Conservation Division and, after notice and hearing as required by law, the Division enter its Order granting this application.

Respectfully submitted,

KELLAHIN and KELLAHIN

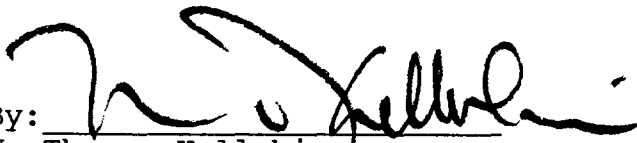
By: 

W. Thomas Kellahin
Post Office Box 2265
Santa Fe, New Mexico 87504
(505) 982-4285
Attorneys for Applicant

BLACK DIAMOND COM 20-1
SEC 20, T30N-R15W

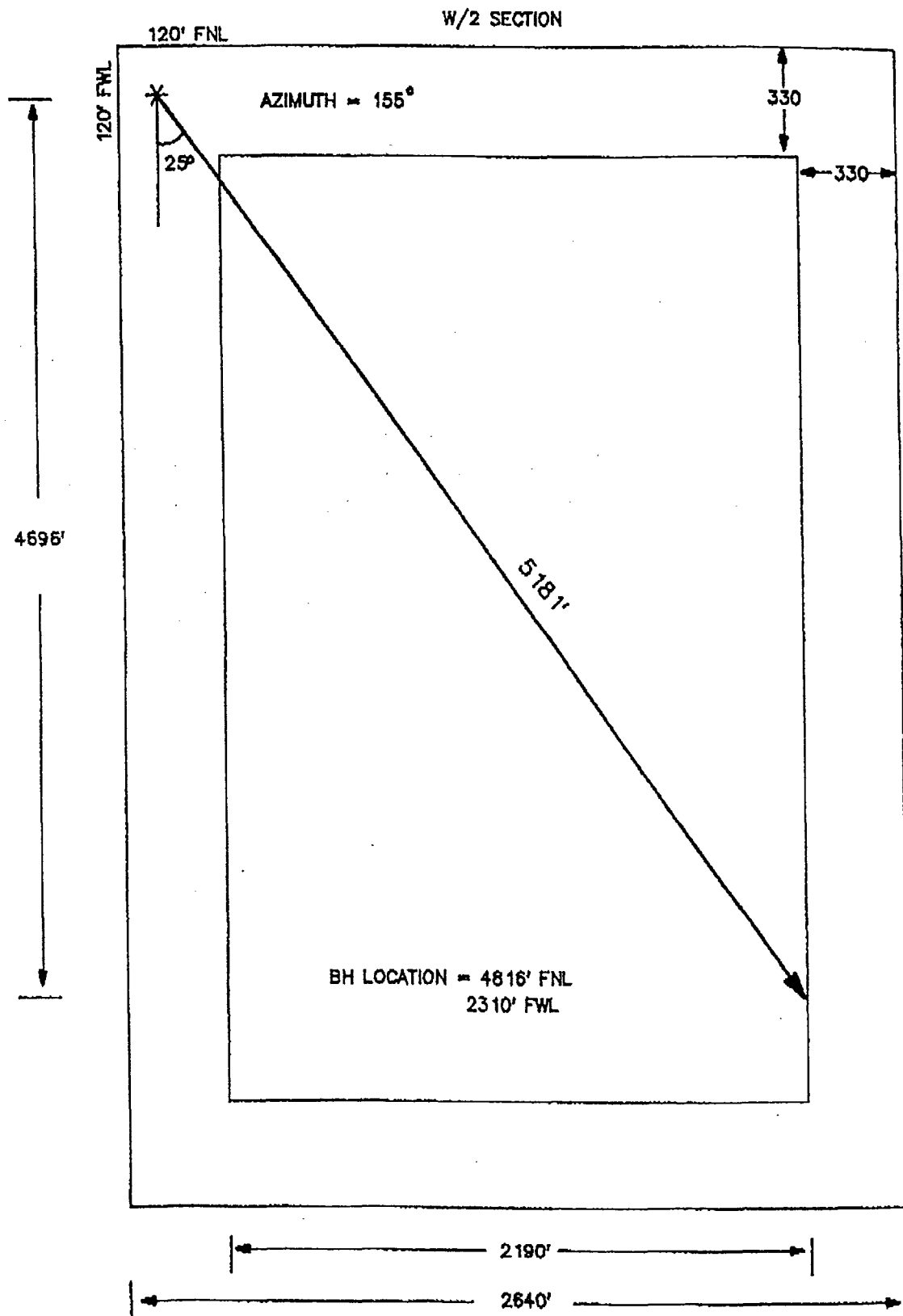

AMM 03/25/83

BLACK DIAMOND COM 20 #1 NW/NW 20-T30N-R15W

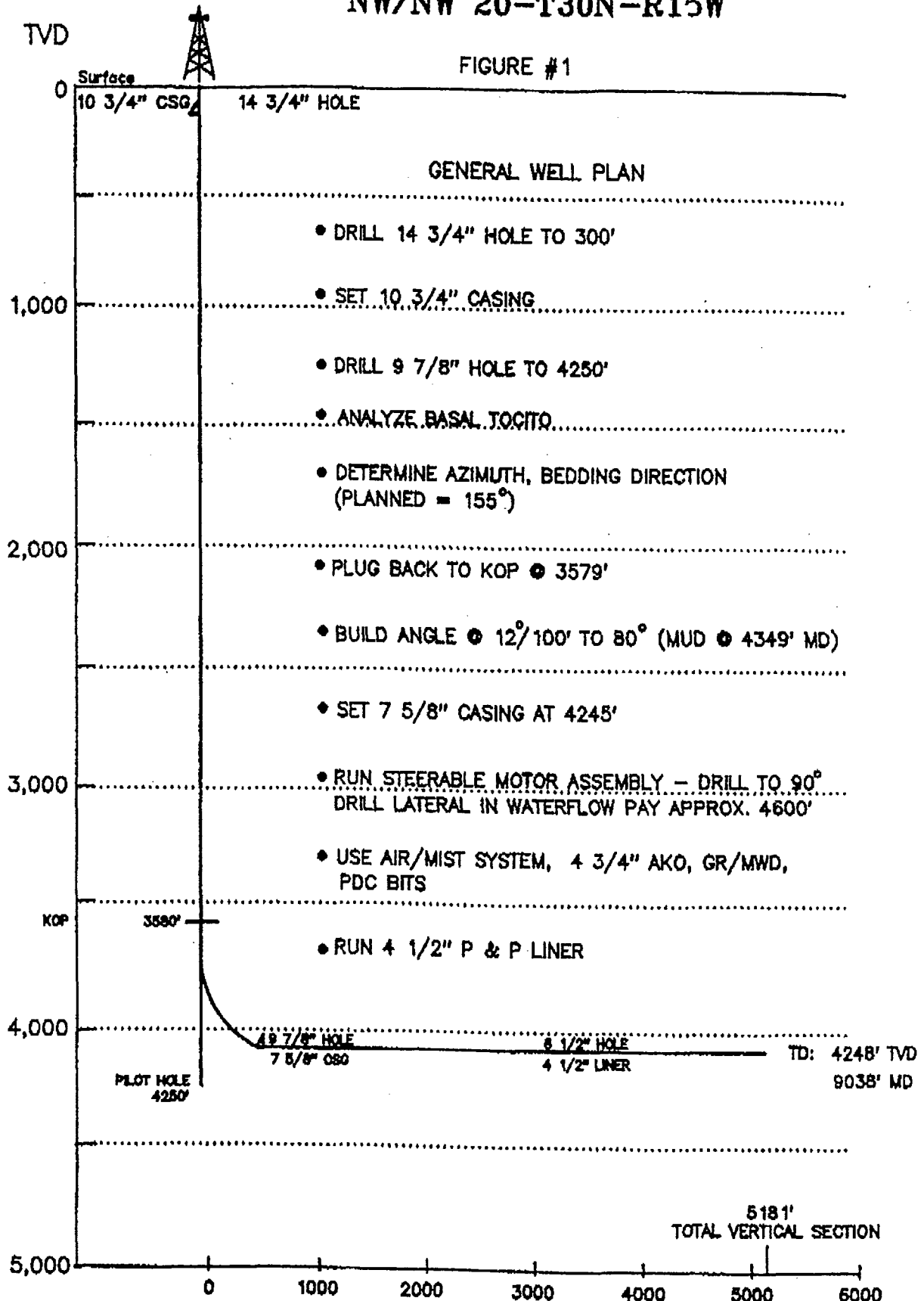

AMM 03/25/93

BLACK DIAMOND COM #20-1 PROPOSED DIRECTIONAL WELL PLAN

ASSUMED 2° DIP (NOT SHOWN) LATERAL INCL. = 88°
 TARGET TVD = 4093' @ 88° TO 4247' @ 88°
 TOP POSSIBLE PRODUCTION TVD = 4067 TVD (2° DIP)
 TOTAL LATERAL ZONE = 4689'

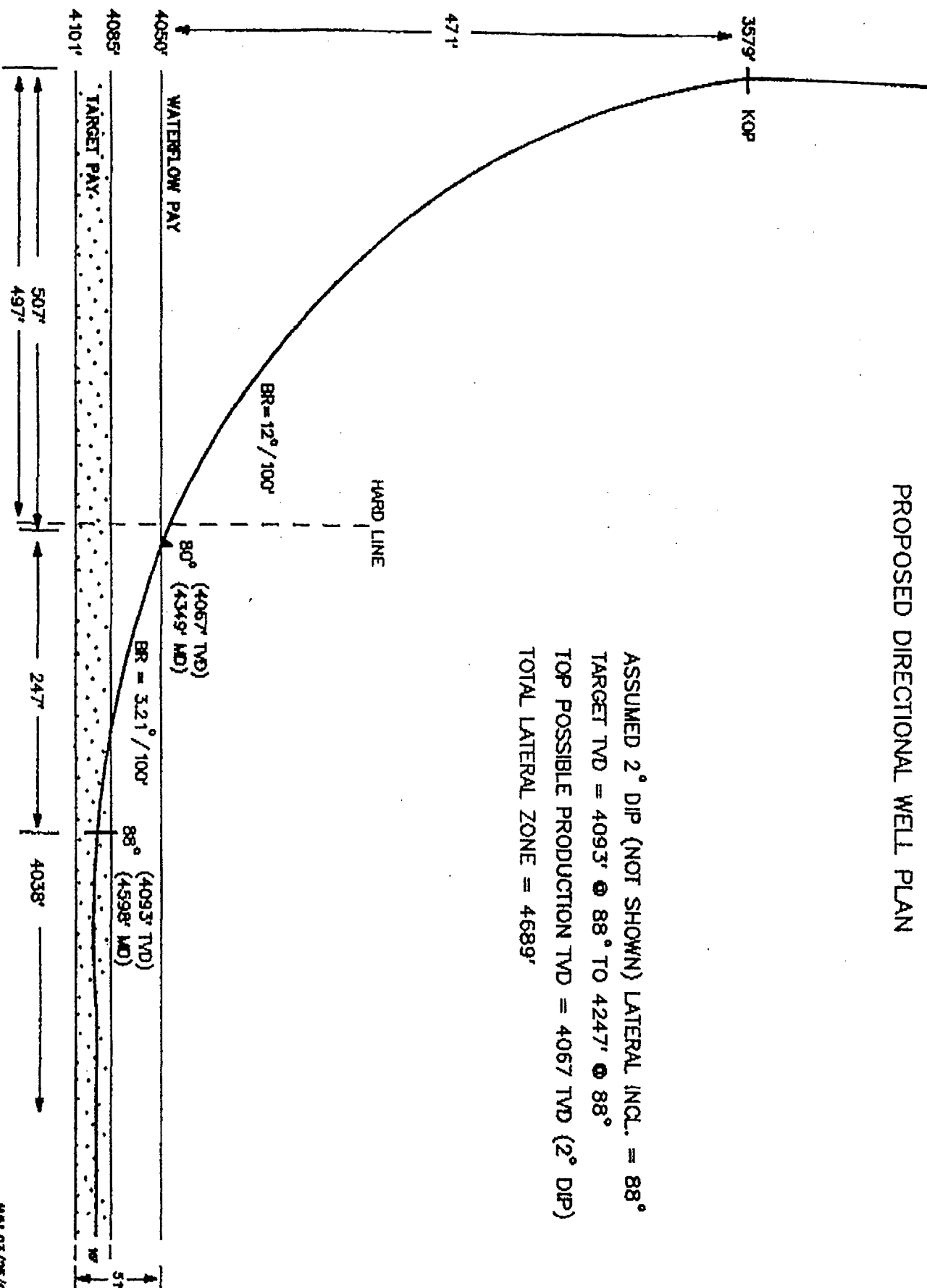

**BLACK DIAMOND 20 #1
W/2 SECTION 20 T30N, R15W
SAN JUAN COUNTY, NEW MEXICO**

OFFSET OWNERSHIP

1. ● MOI
2. ● EP Operating Company
 4849 Greenville Ave, Ste 1200
 Dallas, TX 75206-4186
3. ● MOI

 ● Oxford Exploration Co.
 4582 S. Ulster St, Ste 1500
 Stenford Place III
 Denver, CO 80237
4. ● Yates Petroleum Corporation
 105 S. Fourth Street
 Artesia, NM 88201
5. ● MOI

 ● Richardson Operating Company
 P.O. Box 9808
 Denver, CO 80209
6. ● MOI

 ● SRC

 ● Read & Stevens
 P.O. Box 1518
 Roswell, NM 88201

 ● Westway Petroleum
 500 N. Akard St.
 Dallas, TX 75201-3394
7. ● BLM-Santa Fe

 ● Unleased

8. ● Amoco Production Company
P.O. Box 800
Denver, CO 80202
9. ● Evko Development
4710 Cabrillo St.
San Francisco, CA 94121
10. ● L.T Barringer/W.H. Atkins
11 W. Nettleton Ave.
Memphis, TN 38103
11. ● MOI
 - Unleased
 - Mary Lettman
James Lettman
Pat Buckway
Route 3, Box 158 F
Poteau, OK 74954
 - Clifford C Coppinger
19850 N. 27th Place
Phoenix, AZ 85024
 - LeRoy A Brimhall
205 Manana Place
Farmington, NM 87401
 - Ronald M. Brimhall
P.O. Box 11
Wellborn, TX 77881
 - Ethel Brimhall Foutz, Estate
P.O. Box 262
Farmington, NM 87499

KELLAHIN AND KELLAHIN

ATTORNEYS AT LAW

EL PATIO BUILDING

117 NORTH GUADALUPE

POST OFFICE BOX 2265

SANTA FE, NEW MEXICO 87504-2265

W. THOMAS KELLAHIN*

*NEW MEXICO BOARD OF LEGAL SPECIALIZATION
RECOGNIZED SPECIALIST IN THE AREA OF
NATURAL RESOURCES-OIL AND GAS LAW

TELEPHONE (505) 982-4285
TELEFAX (505) 982-2047

JASON KELLAHIN (RETIRED 1991)

March 29, 1993

Mr. William J. LeMay
Oil Conservation Division
State Land Office Building
310 Old Santa Fe Trail, 2nd Floor
Santa Fe, New Mexico 87501

10720
HAND DELIVERED

RE: Black Diamond Com. 20 No. 1 Well
Application of Meridian Oil Inc.
To Reopen NMOCD Case 10486 and to
Amend Division Order R-9702 for a
Previously Approved High Angle/Horizontal
Direction Drilling Pilot Project and
Special Operating Rules Therefor,
San Juan County, New Mexico

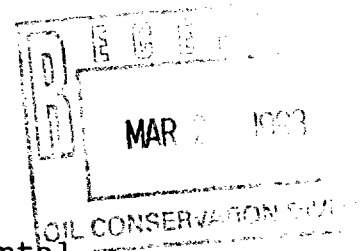

Dear Mr. LeMay:

On behalf of Meridian Oil Inc., please find enclosed our Application to Reopen NMOCD Case 10486 and to Amend Division Order R-9702 in order to change the commencement point and correspondingly the azimuth of the previously approved Black Diamond Com 20 No 1 Well for the High Angle/Horizontal Direction Drilling Pilot Project as referenced above.

We request that this application be set for hearing on the next available Examiner's docket now scheduled for April 22, 1993.

By copy of this letter and application, sent certified mail, we are notifying all interested parties within a 1/2 mile radius of the subject well of their right to appear at the hearing and participate in this case, including the right to present evidence either in support of or in opposition to the application.

Mr. William J. LeMay
March 29, 1993
Page Two

Also, all parties entitled to notice are hereby informed that pursuant to Division Memorandum 2-90 all parties appearing in this case are requested to file a Pre-Hearing Statement with the Division, with copies to the undersigned, no later than 4:00 PM on Friday, April 16, 1993.

Very truly yours,

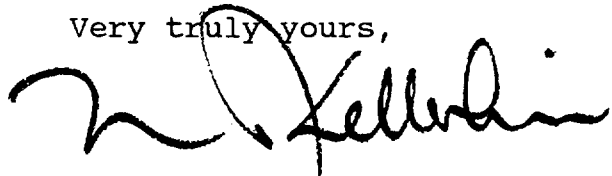
A handwritten signature in black ink, appearing to read 'W. Thomas Kellahin', with a large, stylized loop at the end.

W. Thomas Kellahin

WTK/lam
Enclosure

cc: Mr. John Zent
Meridian Oil Inc.
Post Office Box 4289
Farmington, New Mexico 87499-4289

By Certified Mail - Return Receipt

All Parties Listed on Exhibit "D" of Application

SUGGESTED ADVERTISEMENT:

10720

CASE 10486 (REOPENED): Application of Meridian Oil Inc. to reopen Case 10486 and to amend Division Order R-9702, San Juan County, New Mexico. Applicant seeks to reopen Case 10486 and to amend Division Order R-9702 in order to change the commencement point of its previously approved Black Diamond Com "20" Well No. 1 to commence at an unorthodox surface location 120 feet FNL and 120 feet FWL of Section 20, Township 30 North, Range 15 West, being a previously approved High Angle/Horizontal Direction Drilling Pilot Project located in the W/2 of said Section 20, Undesignated Horseshoe-Gallup Oil Pool. Said pilot project area is located approximately 4.75 miles northwest by north of Fruitland, New Mexico.

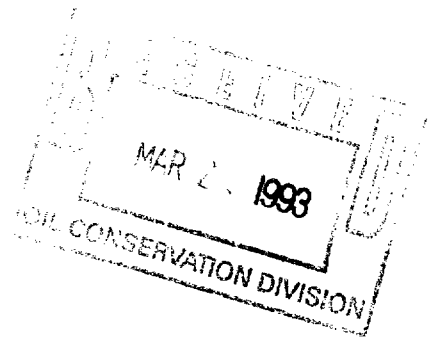

STATE OF NEW MEXICO
ENERGY, MINERALS AND NATURAL RESOURCES DEPARTMENT
OIL CONSERVATION DIVISION

IN THE MATTER OF THE HEARING
CALLED BY THE OIL CONSERVATION
DIVISION FOR THE PURPOSE OF
CONSIDERING:

CASE: 10720

APPLICATION OF MERIDIAN OIL INC.
TO REOPEN NMOC CASE 10486 AND
TO AMENDED DIVISION ORDER R-9702
FOR A PREVIOUSLY APPROVED HIGH
ANGLE/HORIZONTAL DIRECTION
DRILLING PILOT PROJECT AND
SPECIAL OPERATING RULES,
SAN JUAN COUNTY, NEW MEXICO

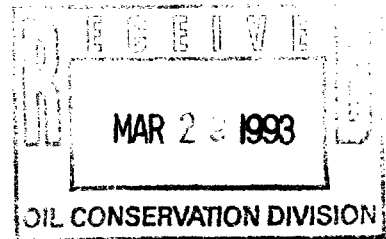

A P P L I C A T I O N

Comes now Meridian Oil Inc., by and through its attorneys, Kellahin, Kellahin & Aubrey, and applies to the New Mexico Oil Conservation Division to **reopen** Case 10486 and to amend Division Order R-9702 in order to change the commencement point of its previously approved Black Diamond Com "20" Well No. 1 to commence at an unorthodox surface location 120 feet FNL and 120 feet FWL of Section 20, Township 30 North, Range 15 West, being a previously approved High Angle/Horizontal Direction Drilling Pilot Project located in the W/2 of

Application of Meridian Oil Inc.

Page 2

said Section 20, Undesignated Horseshoe-Gallup Oil Pool. Said pilot project area is located approximately 4.75 miles northwest by north of Fruitland, New Mexico.

In support thereof Meridian Oil Inc. states:

(1) Applicant is an operator in Section 20, T30N, R15W, N.M.P.M., San Juan County, New Mexico.

(2) On August 6, 1992, The Division entered Order R-9702 which, among other things, approved applicant's High Angle/ Horizontal Directional Drilling Pilot Project for Section 20, T30N, R15W and authorized applicant to commence its proposed Black Diamond "20" Well No. 1 at an unorthodox surface location in the SE/4SW/4 of Section 20 estimated to be 195 feet FSL and 2510 feet FWL of said Section 20.

(3) Applicant has re-evaluated its well prognosis and now seeks to place the surface location for the Black Diamond "20" Well No 1 in the NW/4NW/4 commencing at a point 120 feet FNL and 120 feet FWL of said Section 20, with a projected bottom hole location no

closer than 330 feet from the outer boundary of a spacing unit consisting of the W/2 of said Section 20.

(4) The proposed amendments to Order R-9702 will allow the applicant to drill the subject well vertically to a depth of approximately 4250 feet and then come up hole to a point at approximately 3579 feet where applicant will kick off the well in an southeasterly direction (approximately azimuth of 155 degrees) and commence to build an angle of 12^{degrees} per 100 feet to approximately 80^{degrees} and penetrate the top of the "Waterflow" zone of the Niobrara member of the Horseshoe Gallup Oil Pool at an estimated total vertical depth of 4085 feet, and then to continue to build angle to 90 degrees and thence drilling horizontally in a lateral distance not in excess of 4689 feet and no closer than 330 feet to the outer boundaries of the 320-acre spacing and proration unit. See Exhibits "A," "B," and "C."

(5) Applicant proposes that Decretory Paragraphs (1) and (2) of Division Order R-9702 be deleted and new Decretory Paragraphs (1) and (2) be adopted as follows"

"(1) The applicant, Meridian Oil Inc. is hereby authorized to initiate a high angle/horizontal directional drilling pilot project in the W/2 of Section 20, T30N, R15W, NMPM, Undesignated Horseshoe-Gallup Oil Pool, San Juan County, New Mexico, by drilling its Black Diamond "20" Well No.1 from an unorthodox surface location 120 feet from the North and West lines (Unit D) of Section 20, in the following unconventional manner:

Drill vertically to a depth of approximately 4250 feet and then come up hole to a point at approximately 3579 feet and kick off the well in an southeasterly direction (approximately azimuth of 155 degrees) and commence to build an angle of 12^{degrees} per 100 feet to approximately 80^{degrees} and penetrate the top of the Waterflow" zone of the Niobrara member of Horseshoe Gallup Oil Pool at an estimated total vertical depth of 4085 feet, and then to continue to build angle to 90 degrees and thence drilling horizontally in a lateral

distance not in excess of 4689 feet and no closer than 330 feet to the outer boundary of the designated project area.

PROVIDED HOWEVER THAT, no portion of the horizontal portion of the wellbore shall be located closer than 330 feet from the outer boundary of the project area."

(2) The applicant shall dedicate the W/2 of Section 20 to the above described well forming a non-standard 320 acre oil spacing and proration unit which is also hereby approved."

(6) The Waterflow interval of the Gallup is believed to be the potential productive zone at this location in the Horseshoe Gallup Oil Pool. This interval produces through intergranular permeability.

(7) Past experience in said pool has shown that unless a conventionally drilled (vertical) well intersects natural fractures, the chance of obtaining commercial production is severely curtailed.

(8) By amending its surface location, applicant is attempting to increase the probability of encountering several of these fractures, which may ultimately result in the recovery of a greater amount of gas and oil, thereby preventing waste.

(9) In as much as the exact distance and direction of the lateral portion of the wellbore is not known at this time, the Applicant seeks approval to be allowed to drill and produce said lateral portion anywhere within an area designated a target window as follows: commencing at a distance not closer than 330 feet from any of the side boundaries of the proposed spacing unit so that within the drilling window no portion of the wellbore open for production shall be closer than 330 feet to the outer boundary of the spacing unit.

(10) As required, notice is provided to those offsetting operators as listed on Exhibit "D."

(11) The granting of this Application will be in the best interest of conservation, the prevention of waste and the protection of correlative rights.

Application of Meridian Oil Inc.
Page 7

WHEREFORE, Applicant requests that this matter be set for hearing on April 22, 1993 before a duly appointed Examiner of the Oil Conservation Division and, after notice and hearing as required by law, the Division enter its Order granting this application.

Respectfully submitted,

KELLAHIN and KELLAHIN

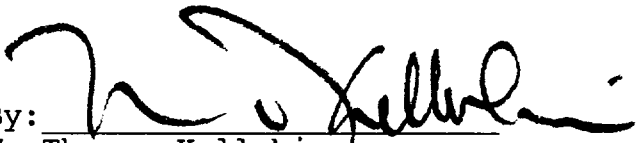
By: 

W. Thomas Kellahin
Post Office Box 2265
Santa Fe, New Mexico 87504
(505) 982-4285
Attorneys for Applicant

BLACK DIAMOND COM 20-1
SEC 20, T30N-R15W

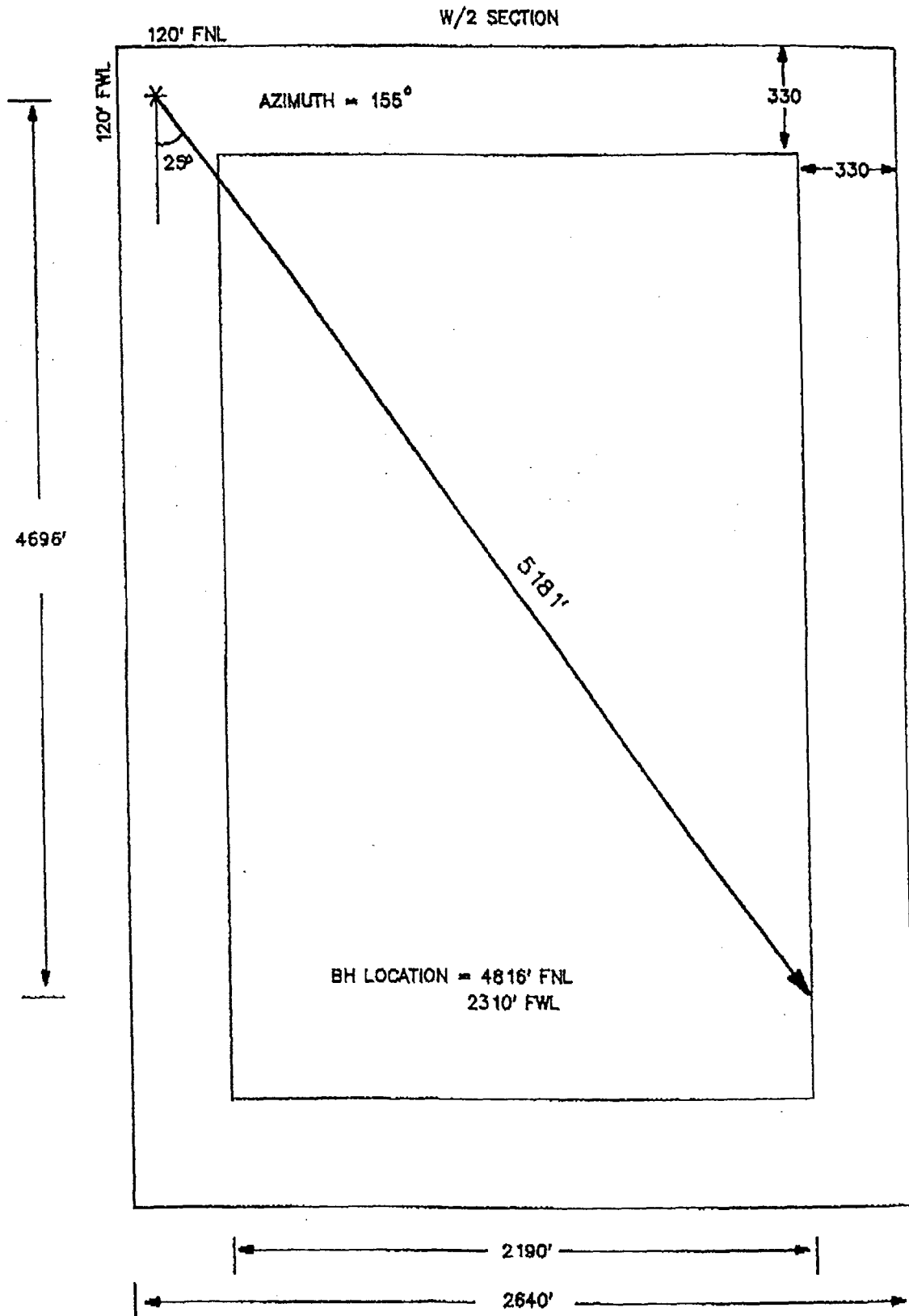

AMM 03/25/93

BLACK DIAMOND COM 20 #1 NW/NW 20-T30N-R15W

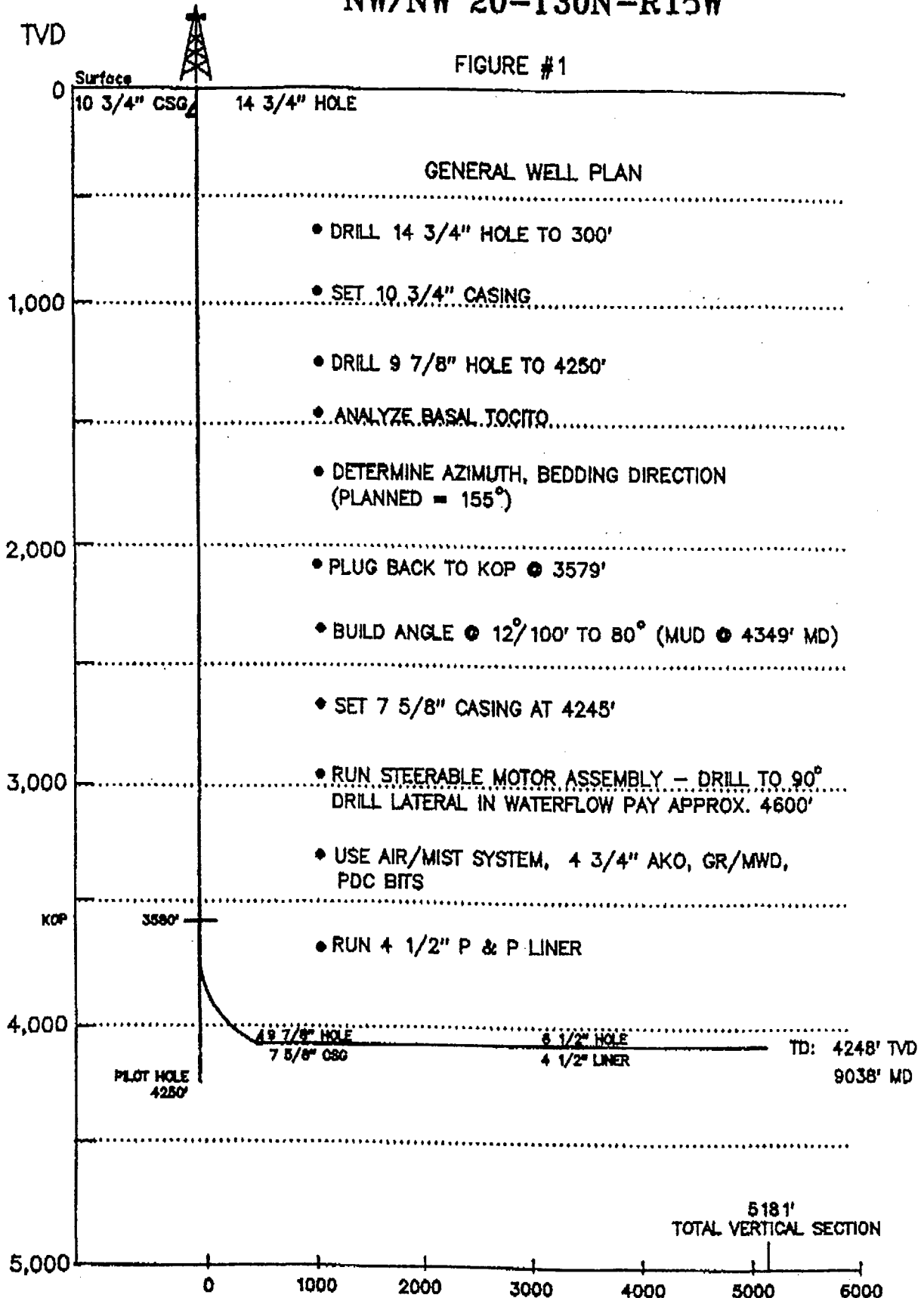

AMM 03/25/93

BLACK DIAMOND COM #20-1 PROPOSED DIRECTIONAL WELL PLAN

ASSUMED 2° DIP (NOT SHOWN) LATERAL INCL. = 88°
 TARGET TVD = 4093' @ 88° TO 4247' @ 88°
 TOP POSSIBLE PRODUCTION TVD = 4067 TVD (2° DIP)
 TOTAL LATERAL ZONE = 4689'

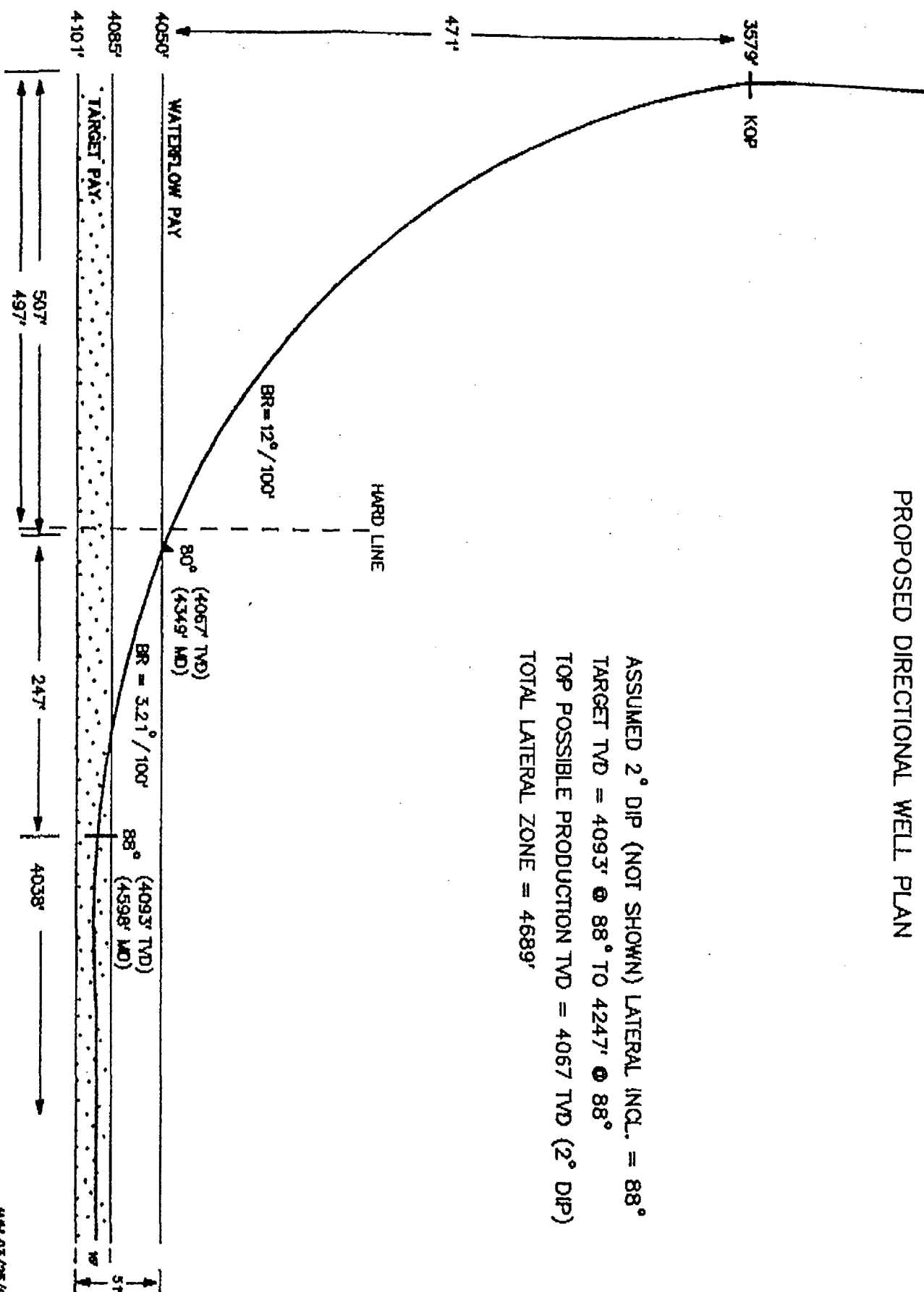

MM 03/25/93

**BLACK DIAMOND 20 #1
W/2 SECTION 20 T30N, R15W
SAN JUAN COUNTY, NEW MEXICO**

OFFSET OWNERSHIP

1. ● MOI
2. ● EP Operating Company
 4849 Greenville Ave, Ste 1200
 Dallas, TX 75206-4186
3. ● MOI

 ● Oxford Exploration Co.
 4582 S. Ulster St, Ste 1500
 Stenford Place III
 Denver, CO 80237
4. ● Yates Petroleum Corporation
 105 S. Fourth Street
 Artesia, NM 88201
5. ● MOI

 ● Richardson Operating Company
 P.O. Box 9808
 Denver, CO 80209
6. ● MOI

 ● SRC

 ● Read & Stevens
 P.O. Box 1518
 Roswell, NM 88201

 ● Westway Petroleum
 500 N. Akard St.
 Dallas, TX 75201-3394
7. ● BLM-Santa Fe

 ● Unleased

8. ● Amoco Production Company
P.O. Box 800
Denver, CO 80202
9. ● Evko Development
4710 Cabrillo St.
San Francisco, CA 94121
10. ● L.T Barringer/W.H. Atkins
11 W. Nettleton Ave.
Memphis, TN 38103
11. ● MOI
 - Unleased
 - Mary Lettman
James Lettman
Pat Buckway
Route 3, Box 158 F
Poteau, OK 74954
 - Clifford C Coppinger
19850 N. 27th Place
Phoenix, AZ 85024
 - LeRoy A Brimhall
205 Manana Place
Farmington, NM 87401
 - Ronald M. Brimhall
P.O. Box 11
Wellborn, TX 77881
 - Ethel Brimhall Foutz, Estate
P.O. Box 262
Farmington, NM 87499

STATE OF NEW MEXICO
ENERGY, MINERALS AND NATURAL RESOURCES DEPARTMENT
OIL CONSERVATION DIVISION

IN THE MATTER OF THE HEARING CALLED
BY THE OIL CONSERVATION DIVISION
FOR THE PURPOSE OF CONSIDERING:

CASE NO. 10720

APPLICATION OF MERIDIAN OIL INC.
TO AMEND DIVISION ORDER R-9702,
SAN JUAN COUNTY, NEW MEXICO.

CERTIFICATE OF MAILING

AND

COMPLIANCE WITH ORDER R-8054

W. THOMAS KELLAHIN, attorney in fact and authorized representative of Meridian Oil Inc., states that the notice provisions of Division Rule 1207 (Order R-8054) have been complied with, that Applicant has caused to be conducted a good faith diligent effort to find the correct addresses of all interested parties entitled to receive notice, that on March 30, 1993, I caused to be mailed by certified mail return-receipt requested notice of this hearing and a copy of the application for the above referenced case along with the cover letter, at least twenty days prior to the hearing set for April 22, 1993, to the parties shown in the application as evidenced by the attached copies of return receipt cards, and that pursuant to Division Rule 1207, notice has been given at the correct addresses provided by such rule.



W. Thomas Kellahin

SUBSCRIBED AND SWORN to before me this 21st day of
APRIL, 1993.

Notary Public

My Commission Expires:

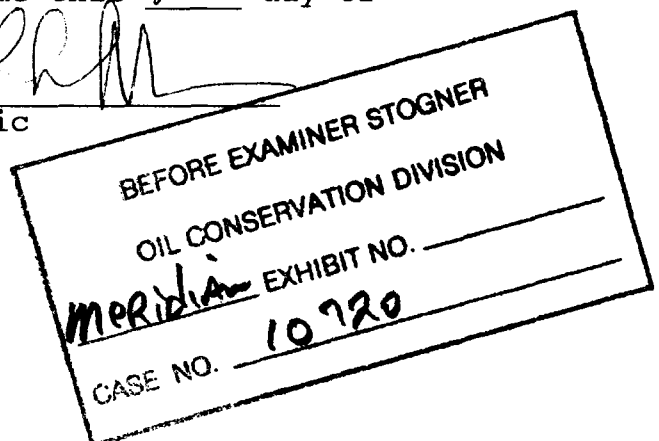
10/7/95



Is your RETURN ADDRESS completed on the reverse side?

SENDER:

- Complete items 1 and/or 2 for additional services.
- Complete items 3, and 4a & b.
- Print your name and address on the reverse of this form so that we can return this card to you.
- Attach this form to the front of the mailpiece, or on the back if space does not permit.
- Write "Return Receipt Requested" on the mailpiece below the article number.
- The Return Receipt will show to whom the article was delivered and the date delivered.

I also wish to receive the following services (for an extra fee):

- ☐ Addressee's Address
- ☐ Restricted Delivery

Consult postmaster for fee.

3. Article Addressed to:

EP Operating Company
4849 Greenville Avenue
Suite 1200
Dallas, Texas 75206-4186

4a. Article Number
P 676 666 389

4b. Service Type

☐ Registered ☐ Insured
☒ Certified ☐ COD
☐ Express Mail ☐ Return Receipt for Merchandise

7. Date of Delivery
4/1/93

5. Signature (Addressee)
Maiden Black Diamond Corp #10486

6. Signature (Agent)

8. Addressee's Address (Only if requested and fee is paid)

PS Form 3811, December 1991 ☆ U.S.G.P.O. : 1992-307-530

DOMESTIC RETURN RECEIPT

Thank you for using Return Receipt Service.

Is your RETURN ADDRESS completed on the reverse side?

SENDER:

- Complete items 1 and/or 2 for additional services.
- Complete items 3, and 4a & b.
- Print your name and address on the reverse of this form so that we can return this card to you.
- Attach this form to the front of the mailpiece, or on the back if space does not permit.
- Write "Return Receipt Requested" on the mailpiece below the article number.
- The Return Receipt will show to whom the article was delivered and the date delivered.

I also wish to receive the following services (for an extra fee):

- ☐ Addressee's Address
- ☐ Restricted Delivery

Consult postmaster for fee.

3. Article Addressed to:

Oxford Exploration Co.
4582 S. Ulster Street
Suite 1500
Stenford Place III
Denver, Colorado 80237

4a. Article Number
P 676 666 390

4b. Service Type

☐ Registered ☐ Insured
☒ Certified ☐ COD
☐ Express Mail ☐ Return Receipt for Merchandise

7. Date of Delivery

5. Signature (Addressee)
Maiden Black Diamond Corp #10486

6. Signature (Agent)

8. Addressee's Address (Only if requested and fee is paid)

PS Form 3811, December 1991 ☆ U.S.G.P.O. : 1992-307-530

DOMESTIC RETURN RECEIPT

Thank you for using Return Receipt Service.

Is your RETURN ADDRESS completed on the reverse side?

SENDER:

- Complete items 1 and/or 2 for additional services.
- Complete items 3, and 4a & b.
- Print your name and address on the reverse of this form so that we can return this card to you.
- Attach this form to the front of the mailpiece, or on the back if space does not permit.
- Write "Return Receipt Requested" on the mailpiece below the article number.
- The Return Receipt will show to whom the article was delivered and the date delivered.

I also wish to receive the following services (for an extra fee):

- ☐ Addressee's Address
- ☐ Restricted Delivery

Consult postmaster for fee.

3. Article Addressed to:

Yates Petroleum Corp.
105 S. Fourth Street
Artesia, New Mexico 88201

4a. Article Number
P 676 666 391

4b. Service Type

☐ Registered ☐ Insured
☒ Certified ☐ COD
☐ Express Mail ☐ Return Receipt for Merchandise

7. Date of Delivery
APR 1 1993

5. Signature (Addressee)
Maiden Black Diamond Corp #10486

6. Signature (Agent)
Steve Robinson

8. Addressee's Address (Only if requested and fee is paid)

PS Form 3811, December 1991 ☆ U.S.G.P.O. : 1992-307-530

DOMESTIC RETURN RECEIPT

Thank you for using Return Receipt Service.

Is your RETURN ADDRESS completed on the reverse side?

SENDER:

- Complete items 1 and/or 2 for additional services.
- Complete items 3, and 4a & b.
- Print your name and address on the reverse of this form so that we can return this card to you.
- Attach this form to the front of the mailpiece, or on the back if space does not permit.
- Write "Return Receipt Requested" on the mailpiece below the article number.
- The Return Receipt will show to whom the article was delivered and the date delivered.

I also wish to receive the following services (for an extra fee):

- ☐ Addressee's Address
- ☒ Restricted Delivery

Consult postmaster for fee.

3. Article Addressed to:

Richardson Operating Co.
P.O. Box 9808
Denver, Colorado 80209

4a. Article Number
P 676 666 392

4b. Service Type

☐ Registered ☐ Insured
☒ Certified ☐ COD
☐ Express Mail ☐ Return Receipt for Merchandise

7. Date of Delivery
4-2-93

5. Signature (Addressee)
Meridian Black Diamond #10486

6. Signature (Agent)
[Signature]

8. Addressee's Address (Only if requested and fee is paid)

PS Form 3811, December 1991 * U.S.G.P.O. : 1992-307-530

DOMESTIC RETURN RECEIPT

Thank you for using Return Receipt Service.

Is your RETURN ADDRESS completed on the reverse side?

SENDER:

- Complete items 1 and/or 2 for additional services.
- Complete items 3, and 4a & b.
- Print your name and address on the reverse of this form so that we can return this card to you.
- Attach this form to the front of the mailpiece, or on the back if space does not permit.
- Write "Return Receipt Requested" on the mailpiece below the article number.
- The Return Receipt will show to whom the article was delivered and the date delivered.

I also wish to receive the following services (for an extra fee):

- ☐ Addressee's Address
- ☐ Restricted Delivery

Consult postmaster for fee.

3. Article Addressed to:

Read & Stevens
P.O. Box 1518
Roswell, New Mexico 88201

4a. Article Number
P 676 666 393

4b. Service Type

☐ Registered ☐ Insured
☒ Certified ☐ COD
☐ Express Mail ☐ Return Receipt for Merchandise

7. Date of Delivery
3-7-93

5. Signature (Addressee)
Meridian Black Diamond #10486

6. Signature (Agent)
[Signature]

8. Addressee's Address (Only if requested and fee is paid)

PS Form 3811, December 1991 * U.S.G.P.O. : 1992-307-530

DOMESTIC RETURN RECEIPT

Thank you for using Return Receipt Service.

Is your RETURN ADDRESS completed on the reverse side?

SENDER:

- Complete items 1 and/or 2 for additional services.
- Complete items 3, and 4a & b.
- Print your name and address on the reverse of this form so that we can return this card to you.
- Attach this form to the front of the mailpiece, or on the back if space does not permit.
- Write "Return Receipt Requested" on the mailpiece below the article number.
- The Return Receipt will show to whom the article was delivered and the date delivered.

I also wish to receive the following services (for an extra fee):

- ☐ Addressee's Address
- ☐ Restricted Delivery

Consult postmaster for fee.

3. Article Addressed to:

Westway Petroleum
500 N. Akard Street
Dallas, Texas 75201-3394

4a. Article Number
P 676 666 394

4b. Service Type

☐ Registered ☐ Insured
☒ Certified ☐ COD
☐ Express Mail ☐ Return Receipt for Merchandise

7. Date of Delivery
APR 01 1993

5. Signature (Addressee)
Meridian Black Diamond #10486

6. Signature (Agent)
[Signature]

8. Addressee's Address (Only if requested and fee is paid)

PS Form 3811, December 1991 * U.S.G.P.O. : 1992-307-530

DOMESTIC RETURN RECEIPT

Thank you for using Return Receipt Service.

Is your RETURN ADDRESS completed on the reverse side?

SENDER:

- Complete items 1 and/or 2 for additional services.
- Complete items 3, and 4a & b.
- Print your name and address on the reverse of this form so that we can return this card to you.
- Attach this form to the front of the mailpiece, or on the back if space does not permit.
- Write "Return Receipt Requested" on the mailpiece below the article number.
- The Return Receipt will show to whom the article was delivered and the date delivered.

I also wish to receive the following services (for an extra fee):

1. ☐ Addressee's Address

2. ☐ Restricted Delivery

Consult postmaster for fee.

3. Article Addressed to:

Bureau of Land Management
Farmington Resource Area
1235 Laplata Highway
Farmington, New Mexico
87401

4a. Article Number

P 676 666 395

4b. Service Type

☐ Registered ☐ Insured

☒ Certified ☐ COD

☐ Express Mail ☐ Return Receipt for Merchandise

7. Date of Delivery

3-31-93

5. Signature (Addressee)

Paul Bougeant

6. Signature (Agent)

Meridian Black Diamond Co. # 10486

8. Addressee's Address (Only if requested and fee is paid)

PS Form 3811, December 1991 ☆ U.S.G.P.O. : 1992-307-530 **DOMESTIC RETURN RECEIPT**

Thank you for using Return Receipt Service.

Is your RETURN ADDRESS completed on the reverse side?

SENDER:

- Complete items 1 and/or 2 for additional services.
- Complete items 3, and 4a & b.
- Print your name and address on the reverse of this form so that we can return this card to you.
- Attach this form to the front of the mailpiece, or on the back if space does not permit.
- Write "Return Receipt Requested" on the mailpiece below the article number.
- The Return Receipt will show to whom the article was delivered and the date delivered.

I also wish to receive the following services (for an extra fee):

1. ☐ Addressee's Address

2. ☐ Restricted Delivery

Consult postmaster for fee.

3. Article Addressed to:

Amoco Production Company
P.O. Box 800
Denver, Colorado 80202

4a. Article Number

P 676 666 396

4b. Service Type

☐ Registered ☐ Insured

☒ Certified ☐ COD

☐ Express Mail ☐ Return Receipt for Merchandise

7. Date of Delivery

4/1/93

5. Signature (Addressee)

Meridian Black Diamond Co. # 10486

6. Signature (Agent)

PS Form 3811, December 1991 ☆ U.S.G.P.O. : 1992-307-530 **DOMESTIC RETURN RECEIPT**

Thank you for using Return Receipt Service.

Is your RETURN ADDRESS completed on the reverse side?

SENDER:

- Complete items 1 and/or 2 for additional services.
- Complete items 3, and 4a & b.
- Print your name and address on the reverse of this form so that we can return this card to you.
- Attach this form to the front of the mailpiece, or on the back if space does not permit.
- Write "Return Receipt Requested" on the mailpiece below the article number.
- The Return Receipt will show to whom the article was delivered and the date delivered.

I also wish to receive the following services (for an extra fee):

1. ☐ Addressee's Address

2. ☐ Restricted Delivery

Consult postmaster for fee.

3. Article Addressed to:

Evko Development
4710 Cabrillo Street
San Francisco, California
94121

4a. Article Number

P 676 666 397

4b. Service Type

☐ Registered ☐ Insured

☒ Certified ☐ COD

☐ Express Mail ☐ Return Receipt for Merchandise

7. Date of Delivery

APR 02 1993

5. Signature (Addressee)

Meridian Black Diamond Co. # 10486

6. Signature (Agent)

PS Form 3811, December 1991 ☆ U.S.G.P.O. : 1992-307-530 **DOMESTIC RETURN RECEIPT**

Thank you for using Return Receipt Service.

Is your RETURN ADDRESS completed on the reverse side?

SENDER:

- Complete items 1 and/or 2 for additional services.
- Complete items 3, and 4a & b.
- Print your name and address on the reverse of this form so that we can return this card to you.
- Attach this form to the front of the mailpiece, or on the back if space does not permit.
- Write "Return Receipt Requested" on the mailpiece below the article number.
- The Return Receipt will show to whom the article was delivered and the date delivered.

I also wish to receive the following services (for an extra fee):

- ☐ Addressee's Address
- ☐ Restricted Delivery

Consult postmaster for fee.

3. Article Addressed to:

Mary Lettman
Route 3, Box 158F
Poteau, Oklahoma 74954

4a. Article Number
P 676 666 399

4b. Service Type

☐ Registered ☐ Insured
☒ Certified ☐ COD
☐ Express Mail ☐ Return Receipt for Merchandise

7. Date of Delivery
4-5

5. Signature (Addressee)
Mary Lettman

6. Signature (Agent)

8. Addressee's Address (Only if requested and fee is paid)

PS Form 3811, December 1991 U.S.G.P.O. : 1992-307-530 **DOMESTIC RETURN RECEIPT**

Thank you for using Return Receipt Service.

Is your RETURN ADDRESS completed on the reverse side?

SENDER:

- Complete items 1 and/or 2 for additional services.
- Complete items 3, and 4a & b.
- Print your name and address on the reverse of this form so that we can return this card to you.
- Attach this form to the front of the mailpiece, or on the back if space does not permit.
- Write "Return Receipt Requested" on the mailpiece below the article number.
- The Return Receipt will show to whom the article was delivered and the date delivered.

I also wish to receive the following services (for an extra fee):

- ☐ Addressee's Address
- ☐ Restricted Delivery

Consult postmaster for fee.

3. Article Addressed to:

James Lettman
Route 3, Box 158F
Poteau, Oklahoma 74954

4a. Article Number
P 676 666 400

4b. Service Type

☐ Registered ☐ Insured
☒ Certified ☐ COD
☐ Express Mail ☐ Return Receipt for Merchandise

7. Date of Delivery

5. Signature (Addressee)
James Lettman

6. Signature (Agent)

8. Addressee's Address (Only if requested and fee is paid)

PS Form 3811, December 1991 U.S.G.P.O. : 1992-307-530 **DOMESTIC RETURN RECEIPT**

Thank you for using Return Receipt Service.

Is your RETURN ADDRESS completed on the reverse side?

SENDER:

- Complete items 1 and/or 2 for additional services.
- Complete items 3, and 4a & b.
- Print your name and address on the reverse of this form so that we can return this card to you.
- Attach this form to the front of the mailpiece, or on the back if space does not permit.
- Write "Return Receipt Requested" on the mailpiece below the article number.
- The Return Receipt will show to whom the article was delivered and the date delivered.

I also wish to receive the following services (for an extra fee):

- ☐ Addressee's Address
- ☐ Restricted Delivery

Consult postmaster for fee.

3. Article Addressed to:

Pat Buckway
Route 3, Box 158F
Poteau, Oklahoma 74954

4a. Article Number
P 676 666 401

4b. Service Type

☐ Registered ☐ Insured
☒ Certified ☐ COD
☐ Express Mail ☐ Return Receipt for Merchandise

7. Date of Delivery
4/9/93

5. Signature (Addressee)
Pat Buckway

6. Signature (Agent)

8. Addressee's Address (Only if requested and fee is paid)

PS Form 3811, December 1991 U.S.G.P.O. : 1992-307-530 **DOMESTIC RETURN RECEIPT**

Thank you for using Return Receipt Service.

Is your RETURN ADDRESS completed on the reverse side?

SENDER:

- Complete items 1 and/or 2 for additional services.
- Complete items 3, and 4a & b.
- Print your name and address on the reverse of this form so that we can return this card to you.
- Attach this form to the front of the mailpiece, or on the back if space does not permit.
- Write "Return Receipt Requested" on the mailpiece below the article number.
- The Return Receipt will show to whom the article was delivered and the date delivered.

I also wish to receive the following services (for an extra fee):

- ☒ Addressee's Address
- ☐ Restricted Delivery

Consult postmaster for fee.

3. Article Addressed to:

Clifford C. Coppinger
19850 N. 27th Place
Phoenix, Arizona 85024

4a. Article Number

P 676 666 402

4b. Service Type

- ☐ Registered ☐ Insured
☒ Certified ☐ COD
☐ Express Mail ☐ Return Receipt for Merchandise

7. Date of Delivery

4-1-93

Meridian Black Diamond Com # 10486

5. Signature (Addressee)

Mrs C Coppinger

6. Signature (Agent)

8. Addressee's Address (Only if requested and fee is paid)

PS Form 3811, December 1991 ☆ U.S.G.P.O. : 1992-307-530

DOMESTIC RETURN RECEIPT

Thank you for using Return Receipt Service

Is your RETURN ADDRESS completed on the reverse side?

SENDER:

- Complete items 1 and/or 2 for additional services.
- Complete items 3, and 4a & b.
- Print your name and address on the reverse of this form so that we can return this card to you.
- Attach this form to the front of the mailpiece, or on the back if space does not permit.
- Write "Return Receipt Requested" on the mailpiece below the article number.
- The Return Receipt will show to whom the article was delivered and the date delivered.

I also wish to receive the following services (for an extra fee):

- ☐ Addressee's Address
- ☐ Restricted Delivery

Consult postmaster for fee.

3. Article Addressed to:

Ethel Brimhall Foutz, Estate
P.O. Box 262
Farmington, New Mexico 87499

4a. Article Number

P 676 666 405

4b. Service Type

- ☐ Registered ☐ Insured
☒ Certified ☐ COD
☐ Express Mail ☐ Return Receipt for Merchandise

7. Date of Delivery

4-1-93

Meridian - Black Diamond Com # 10486

5. Signature (Addressee)

E. Foutz

6. Signature (Agent)

8. Addressee's Address (Only if requested and fee is paid)

PS Form 3811, December 1991 ☆ U.S.G.P.O. : 1992-307-530

DOMESTIC RETURN RECEIPT

Thank you for using Return Receipt Service

Is your RETURN ADDRESS completed on the reverse side?

SENDER:

- Complete items 1 and/or 2 for additional services.
- Complete items 3, and 4a & b.
- Print your name and address on the reverse of this form so that we can return this card to you.
- Attach this form to the front of the mailpiece, or on the back if space does not permit.
- Write "Return Receipt Requested" on the mailpiece below the article number.
- The Return Receipt will show to whom the article was delivered and the date delivered.

I also wish to receive the following services (for an extra fee):

- ☐ Addressee's Address
- ☐ Restricted Delivery

Consult postmaster for fee.

3. Article Addressed to:

Ronald M. Brimhall
P.O. Box 11
Wellborn, Texas 77881

4a. Article Number

P 676 666 404

4b. Service Type

- ☐ Registered ☐ Insured
☒ Certified ☐ COD
☐ Express Mail ☐ Return Receipt for Merchandise

7. Date of Delivery

4-8-93

Meridian - Black Diamond Com # 10486

5. Signature (Addressee)

R. M. Brimhall

6. Signature (Agent)

8. Addressee's Address (Only if requested and fee is paid)

PS Form 3811, December 1991 ☆ U.S.G.P.O. : 1992-307-530

DOMESTIC RETURN RECEIPT

Thank you for using Return Receipt Service

STATE OF NEW MEXICO
ENERGY, MINERALS AND NATURAL RESOURCES DEPARTMENT
OIL CONSERVATION DIVISION

IN THE MATTER OF THE HEARING CALLED
BY THE OIL CONSERVATION DIVISION
FOR THE PURPOSE OF CONSIDERING:

CASE NO. 10720

APPLICATION OF MERIDIAN OIL INC.
TO AMEND DIVISION ORDER R-9702,
SAN JUAN COUNTY, NEW MEXICO.

CERTIFICATE OF MAILING

AND

COMPLIANCE WITH ORDER R-8054

W. THOMAS KELLAHIN, attorney in fact and authorized representative of Meridian Oil Inc., states that the notice provisions of Division Rule 1207 (Order R-8054) have been complied with, that Applicant has caused to be conducted a good faith diligent effort to find the correct addresses of all interested parties entitled to receive notice, that on March 30, 1993, I caused to be mailed by certified mail return-receipt requested notice of this hearing and a copy of the application for the above referenced case along with the cover letter, at least twenty days prior to the hearing set for April 22, 1993, to the parties shown in the application as evidenced by the attached copies of return receipt cards, and that pursuant to Division Rule 1207, notice has been given at the correct addresses provided by such rule.

W. Thomas Kellahin

SUBSCRIBED AND SWORN to before me this 21ST day of
APRIL, 1993.

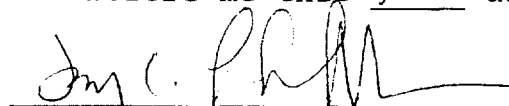
Notary Public

My Commission Expires:

10/7/95

Is your RETURN ADDRESS completed on the reverse side?

SENDER:

- Complete items 1 and/or 2 for additional services.
- Complete items 3, and 4a & b.
- Print your name and address on the reverse of this form so that we can return this card to you.
- Attach this form to the front of the mailpiece, or on the back if space does not permit.
- Write "Return Receipt Requested" on the mailpiece below the article number.
- The Return Receipt will show to whom the article was delivered and the date delivered.

I also wish to receive the following services (for an extra fee):

- ☐ Addressee's Address
- ☐ Restricted Delivery

Consult postmaster for fee.

3. Article Addressed to:

EP Operating Company
4849 Greenville Avenue
Suite 1200
Dallas, Texas 75206-4186

4a. Article Number
P 676 666 389

4b. Service Type

☐ Registered ☐ Insured
☒ Certified ☐ COD
☐ Express Mail ☐ Return Receipt for Merchandise

7. Date of Delivery
4/1/93

8. Addressee's Address (Only if requested and fee is paid)

5. Signature (Addressee)
Maiden Black Diagram Corp #10486

6. Signature (Agent)

PS Form 3811, December 1991 * U.S.G.P.O. : 1992-307-530

DOMESTIC RETURN RECEIPT

Thank you for using Return Receipt Service.

Is your RETURN ADDRESS completed on the reverse side?

SENDER:

- Complete items 1 and/or 2 for additional services.
- Complete items 3, and 4a & b.
- Print your name and address on the reverse of this form so that we can return this card to you.
- Attach this form to the front of the mailpiece, or on the back if space does not permit.
- Write "Return Receipt Requested" on the mailpiece below the article number.
- The Return Receipt will show to whom the article was delivered and the date delivered.

I also wish to receive the following services (for an extra fee):

- ☐ Addressee's Address
- ☐ Restricted Delivery

Consult postmaster for fee.

3. Article Addressed to:

Oxford Exploration Co.
4582 S. Ulster Street
Suite 1500
Stenford Place III
Denver, Colorado 80237

4a. Article Number
P 676 666 390

4b. Service Type

☐ Registered ☐ Insured
☒ Certified ☐ COD
☐ Express Mail ☐ Return Receipt for Merchandise

7. Date of Delivery

8. Addressee's Address (Only if requested and fee is paid)

5. Signature (Addressee)
Maiden Black Diagram Corp #10486

6. Signature (Agent)

PS Form 3811, December 1991 * U.S.G.P.O. : 1992-307-530

DOMESTIC RETURN RECEIPT

Thank you for using Return Receipt Service.

Is your RETURN ADDRESS completed on the reverse side?

SENDER:

- Complete items 1 and/or 2 for additional services.
- Complete items 3, and 4a & b.
- Print your name and address on the reverse of this form so that we can return this card to you.
- Attach this form to the front of the mailpiece, or on the back if space does not permit.
- Write "Return Receipt Requested" on the mailpiece below the article number.
- The Return Receipt will show to whom the article was delivered and the date delivered.

I also wish to receive the following services (for an extra fee):

- ☐ Addressee's Address
- ☐ Restricted Delivery

Consult postmaster for fee.

3. Article Addressed to:

Yates Petroleum Corp.
105 S. Fourth Street
Artesia, New Mexico 88201

4a. Article Number
P 676 666 391

4b. Service Type

☐ Registered ☐ Insured
☒ Certified ☐ COD
☐ Express Mail ☐ Return Receipt for Merchandise

7. Date of Delivery
APR 1 1993

8. Addressee's Address (Only if requested and fee is paid)

5. Signature (Addressee)
Maiden Black Diagram Corp #10486

6. Signature (Agent)
Jura Robinson

PS Form 3811, December 1991 * U.S.G.P.O. : 1992-307-530

DOMESTIC RETURN RECEIPT

Thank you for using Return Receipt Service.

Is your RETURN ADDRESS completed on the reverse side?

SENDER:

- Complete items 1 and/or 2 for additional services.
- Complete items 3, and 4a & b.
- Print your name and address on the reverse of this form so that we can return this card to you.
- Attach this form to the front of the mailpiece, or on the back if space does not permit.
- Write "Return Receipt Requested" on the mailpiece below the article number.
- The Return Receipt will show to whom the article was delivered and the date delivered.

I also wish to receive the following services (for an extra fee):

- ☒ Addressee's Address
- ☒ Restricted Delivery

Consult postmaster for fee.

3. Article Addressed to:

Richardson Operating Co.
P.O. Box 9808
Denver, Colorado 80209

4a. Article Number

P 676 666 392

4b. Service Type

☐ Registered ☐ Insured
☒ Certified ☐ COD
☐ Express Mail ☐ Return Receipt for Merchandise

7. Date of Delivery

4-2-93

5. Signature (Addressee)

6. Signature (Agent)

8. Addressee's Address (Only if requested and fee is paid)

PS Form 3811, December 1991 * U.S.G.P.O. : 1992-307-530

DOMESTIC RETURN RECEIPT

Thank you for using Return Receipt Service.

Is your RETURN ADDRESS completed on the reverse side?

SENDER:

- Complete items 1 and/or 2 for additional services.
- Complete items 3, and 4a & b.
- Print your name and address on the reverse of this form so that we can return this card to you.
- Attach this form to the front of the mailpiece, or on the back if space does not permit.
- Write "Return Receipt Requested" on the mailpiece below the article number.
- The Return Receipt will show to whom the article was delivered and the date delivered.

I also wish to receive the following services (for an extra fee):

- ☐ Addressee's Address
- ☐ Restricted Delivery

Consult postmaster for fee.

3. Article Addressed to:

Read & Stevens
P.O. Box 1518
Roswell, New Mexico 88201

4a. Article Number

P 676 666 393

4b. Service Type

☐ Registered ☐ Insured
☒ Certified ☐ COD
☐ Express Mail ☐ Return Receipt for Merchandise

7. Date of Delivery

3-7-93

5. Signature (Addressee)

6. Signature (Agent)

8. Addressee's Address (Only if requested and fee is paid)

PS Form 3811, December 1991 * U.S.G.P.O. : 1992-307-530

DOMESTIC RETURN RECEIPT

Thank you for using Return Receipt Service.

Is your RETURN ADDRESS completed on the reverse side?

SENDER:

- Complete items 1 and/or 2 for additional services.
- Complete items 3, and 4a & b.
- Print your name and address on the reverse of this form so that we can return this card to you.
- Attach this form to the front of the mailpiece, or on the back if space does not permit.
- Write "Return Receipt Requested" on the mailpiece below the article number.
- The Return Receipt will show to whom the article was delivered and the date delivered.

I also wish to receive the following services (for an extra fee):

- ☐ Addressee's Address
- ☐ Restricted Delivery

Consult postmaster for fee.

3. Article Addressed to:

Westway Petroleum
500 N. Akard Street
Dallas, Texas 75201-3394

4a. Article Number

P 676 666 394

4b. Service Type

☐ Registered ☐ Insured
☒ Certified ☐ COD
☐ Express Mail ☐ Return Receipt for Merchandise

7. Date of Delivery

APR 01 1993

5. Signature (Addressee)

6. Signature (Agent)

8. Addressee's Address (Only if requested and fee is paid)

PS Form 3811, December 1991 * U.S.G.P.O. : 1992-307-530

DOMESTIC RETURN RECEIPT

Thank you for using Return Receipt Service.

Is your RETURN ADDRESS completed on the reverse side?

SENDER:

- Complete items 1 and/or 2 for additional services.
- Complete items 3, and 4a & b.
- Print your name and address on the reverse of this form so that we can return this card to you.
- Attach this form to the front of the mailpiece, or on the back if space does not permit.
- Write "Return Receipt Requested" on the mailpiece below the article number.
- The Return Receipt will show to whom the article was delivered and the date delivered.

I also wish to receive the following services (for an extra fee):

- ☒ Addressee's Address
- ☒ Restricted Delivery

Consult postmaster for fee.

3. Article Addressed to:

Bureau of Land Management
Farmington Resource Area
1235 Laplata Highway
Farmington, New Mexico
87401

4a. Article Number
P 676 666 395

4b. Service Type

☐ Registered ☐ Insured
☒ Certified ☐ COD
☐ Express Mail ☐ Return Receipt for Merchandise

7. Date of Delivery
3-31-93

5. Signature (Addressee)
Paul Bougeant

6. Signature (Agent)

8. Addressee's Address (Only if requested and fee is paid)

PS Form 3811, December 1991 ☆ U.S.G.P.O. : 1992-307-530 **DOMESTIC RETURN RECEIPT**

Thank you for using Return Receipt Service.

Is your RETURN ADDRESS completed on the reverse side?

SENDER:

- Complete items 1 and/or 2 for additional services.
- Complete items 3, and 4a & b.
- Print your name and address on the reverse of this form so that we can return this card to you.
- Attach this form to the front of the mailpiece, or on the back if space does not permit.
- Write "Return Receipt Requested" on the mailpiece below the article number.
- The Return Receipt will show to whom the article was delivered and the date delivered.

I also wish to receive the following services (for an extra fee):

- ☐ Addressee's Address
- ☐ Restricted Delivery

Consult postmaster for fee.

3. Article Addressed to:

Amoco Production Company
P.O. Box 800
Denver, Colorado 80202

4a. Article Number
P 676 666 396

4b. Service Type

☐ Registered ☐ Insured
☒ Certified ☐ COD
☐ Express Mail ☐ Return Receipt for Merchandise

7. Date of Delivery

5. Signature (Addressee)
meridian Black Diam Comd # 10486

6. Signature (Agent)

8. Addressee's Address (Only if requested and fee is paid)

PS Form 3811, December 1991 ☆ U.S.G.P.O. : 1992-307-530 **DOMESTIC RETURN RECEIPT**

Thank you for using Return Receipt Service.

Is your RETURN ADDRESS completed on the reverse side?

SENDER:

- Complete items 1 and/or 2 for additional services.
- Complete items 3, and 4a & b.
- Print your name and address on the reverse of this form so that we can return this card to you.
- Attach this form to the front of the mailpiece, or on the back if space does not permit.
- Write "Return Receipt Requested" on the mailpiece below the article number.
- The Return Receipt will show to whom the article was delivered and the date delivered.

I also wish to receive the following services (for an extra fee):

- ☐ Addressee's Address
- ☐ Restricted Delivery

Consult postmaster for fee.

3. Article Addressed to:

Evko Development
4710 Cabrillo Street
San Francisco, California
94121

4a. Article Number
P 676 666 397

4b. Service Type

☐ Registered ☐ Insured
☒ Certified ☐ COD
☐ Express Mail ☐ Return Receipt for Merchandise

7. Date of Delivery
APR 02 1993

5. Signature (Addressee)
meridian Black Diam Comd # 10486

6. Signature (Agent)

8. Addressee's Address (Only if requested and fee is paid)

PS Form 3811, December 1991 ☆ U.S.G.P.O. : 1992-307-530 **DOMESTIC RETURN RECEIPT**

Thank you for using Return Receipt Service.

Is your RETURN ADDRESS completed on the reverse side?

SENDER:

- Complete items 1 and/or 2 for additional services.
- Complete items 3, and 4a & b.
- Print your name and address on the reverse of this form so that we can return this card to you.
- Attach this form to the front of the mailpiece, or on the back if space does not permit.
- Write "Return Receipt Requested" on the mailpiece below the article number.
- The Return Receipt will show to whom the article was delivered and the date delivered.

I also wish to receive the following services (for an extra fee):

- ☐ Addressee's Address
- ☐ Restricted Delivery

Consult postmaster for fee.

3. Article Addressed to:

Mary Lettman
Route 3, Box 158F
Poteau, Oklahoma 74954

4a. Article Number

P 676 666 399

4b. Service Type

☐ Registered ☐ Insured
☒ Certified ☐ COD
☐ Express Mail ☐ Return Receipt for Merchandise

7. Date of Delivery

4-5

5. Signature (Addressee)

Mary Lettman

6. Signature (Agent)

PS Form 3811, December 1991 U.S.G.P.O. : 1992-307-530

DOMESTIC RETURN RECEIPT

Thank you for using Return Receipt Service.

Is your RETURN ADDRESS completed on the reverse side?

SENDER:

- Complete items 1 and/or 2 for additional services.
- Complete items 3, and 4a & b.
- Print your name and address on the reverse of this form so that we can return this card to you.
- Attach this form to the front of the mailpiece, or on the back if space does not permit.
- Write "Return Receipt Requested" on the mailpiece below the article number.
- The Return Receipt will show to whom the article was delivered and the date delivered.

I also wish to receive the following services (for an extra fee):

- ☐ Addressee's Address
- ☐ Restricted Delivery

Consult postmaster for fee.

3. Article Addressed to:

James Lettman
Route 3, Box 158F
Poteau, Oklahoma 74954

4a. Article Number

P 676 666 400

4b. Service Type

☐ Registered ☐ Insured
☒ Certified ☐ COD
☐ Express Mail ☐ Return Receipt for Merchandise

7. Date of Delivery

10/10/93

5. Signature (Addressee)

James Lettman

6. Signature (Agent)

PS Form 3811, December 1991 U.S.G.P.O. : 1992-307-530

DOMESTIC RETURN RECEIPT

Thank you for using Return Receipt Service.

Is your RETURN ADDRESS completed on the reverse side?

SENDER:

- Complete items 1 and/or 2 for additional services.
- Complete items 3, and 4a & b.
- Print your name and address on the reverse of this form so that we can return this card to you.
- Attach this form to the front of the mailpiece, or on the back if space does not permit.
- Write "Return Receipt Requested" on the mailpiece below the article number.
- The Return Receipt will show to whom the article was delivered and the date delivered.

I also wish to receive the following services (for an extra fee):

- ☐ Addressee's Address
- ☐ Restricted Delivery

Consult postmaster for fee.

3. Article Addressed to:

Pat Buckway
Route 3, Box 158F
Poteau, Oklahoma 74954

4a. Article Number

P 676 666 401

4b. Service Type

☐ Registered ☐ Insured
☒ Certified ☐ COD
☐ Express Mail ☐ Return Receipt for Merchandise

7. Date of Delivery

4/9/93

5. Signature (Addressee)

Pat Buckway

6. Signature (Agent)

PS Form 3811, December 1991 U.S.G.P.O. : 1992-307-530

DOMESTIC RETURN RECEIPT

Thank you for using Return Receipt Service.

Is your RETURN ADDRESS completed on the reverse side?

SENDER:

- Complete items 1 and/or 2 for additional services.
- Complete items 3 and 4a & b.
- Print your name and address on the reverse of this form so that we can return this card to you.
- Attach this form to the front of the mailpiece, or on the back if space does not permit.
- Write "Return Receipt Requested" on the mailpiece below the article number.
- The Return Receipt will show to whom the article was delivered and the date delivered.

I also wish to receive the following services (for an extra fee):

- ☐ Addressee's Address
 - ☐ Restricted Delivery
- Consult postmaster for fee.

3. Article Addressed to:

Clifford C. Coppinger
19850 N. 27th Place
Phoenix, Arizona 85024

4a. Article Number

P 676 666 402

4b. Service Type

- ☐ Registered ☐ Insured
☒ Certified ☐ COD
☐ Express Mail ☐ Return Receipt for Merchandise

7. Date of Delivery

4-1-93

5. Signature (Addressee)

Clifford C. Coppinger

6. Signature (Agent)

8. Addressee's Address (Only if requested and fee is paid)

PS Form 3811, December 1991 ☆ U.S.G.P.O. : 1992-307-530

DOMESTIC RETURN RECEIPT

Thank you for using Return Receipt Service.

Is your RETURN ADDRESS completed on the reverse side?

SENDER:

- Complete items 1 and/or 2 for additional services.
- Complete items 3 and 4a & b.
- Print your name and address on the reverse of this form so that we can return this card to you.
- Attach this form to the front of the mailpiece, or on the back if space does not permit.
- Write "Return Receipt Requested" on the mailpiece below the article number.
- The Return Receipt will show to whom the article was delivered and the date delivered.

I also wish to receive the following services (for an extra fee):

- ☐ Addressee's Address
 - ☐ Restricted Delivery
- Consult postmaster for fee.

3. Article Addressed to:

Ethel Brimhall Foutz, Estate
P.O. Box 262
Farmington, New Mexico
87499

4a. Article Number

P 676 666 405

4b. Service Type

- ☐ Registered ☐ Insured
☒ Certified ☐ COD
☐ Express Mail ☐ Return Receipt for Merchandise

7. Date of Delivery

4-1-93

5. Signature (Addressee)

Ethel Brimhall Foutz

6. Signature (Agent)

8. Addressee's Address (Only if requested and fee is paid)

PS Form 3811, December 1991 ☆ U.S.G.P.O. : 1992-307-530

DOMESTIC RETURN RECEIPT

Thank you for using Return Receipt Service.

Is your RETURN ADDRESS completed on the reverse side?

SENDER:

- Complete items 1 and/or 2 for additional services.
- Complete items 3 and 4a & b.
- Print your name and address on the reverse of this form so that we can return this card to you.
- Attach this form to the front of the mailpiece, or on the back if space does not permit.
- Write "Return Receipt Requested" on the mailpiece below the article number.
- The Return Receipt will show to whom the article was delivered and the date delivered.

I also wish to receive the following services (for an extra fee):

- ☐ Addressee's Address
 - ☒ Restricted Delivery
- Consult postmaster for fee.

3. Article Addressed to:

Ronald M. Brimhall
P.O. Box 11
Wellborn, Texas 77881

4a. Article Number

P 676 666 404

4b. Service Type

- ☐ Registered ☐ Insured
☒ Certified ☐ COD
☐ Express Mail ☐ Return Receipt for Merchandise

7. Date of Delivery

4-8-93

5. Signature (Addressee)

Ronald M. Brimhall

6. Signature (Agent)

8. Addressee's Address (Only if requested and fee is paid)

PS Form 3811, December 1991 ☆ U.S.G.P.O. : 1992-307-530

DOMESTIC RETURN RECEIPT

Thank you for using Return Receipt Service.

STATE OF NEW MEXICO
ENERGY, MINERALS AND NATURAL RESOURCES DEPARTMENT
OIL CONSERVATION DIVISION

IN THE MATTER OF THE HEARING CALLED
BY THE OIL CONSERVATION DIVISION
FOR THE PURPOSE OF CONSIDERING:

CASE NO. 10720

APPLICATION OF MERIDIAN OIL INC.
TO AMEND DIVISION ORDER R-9702,
SAN JUAN COUNTY, NEW MEXICO.

CERTIFICATE OF MAILING

AND

COMPLIANCE WITH ORDER R-8054

W. THOMAS KELLAHIN, attorney in fact and authorized representative of Meridian Oil Inc., states that the notice provisions of Division Rule 1207 (Order R-8054) have been complied with, that Applicant has caused to be conducted a good faith diligent effort to find the correct addresses of all interested parties entitled to receive notice, that on March 30, 1993, I caused to be mailed by certified mail return-receipt requested notice of this hearing and a copy of the application for the above referenced case along with the cover letter, at least twenty days prior to the hearing set for April 22, 1993, to the parties shown in the application as evidenced by the attached copies of return receipt cards, and that pursuant to Division Rule 1207, notice has been given at the correct addresses provided by such rule.

W. Thomas Kellahin

SUBSCRIBED AND SWORN to before me this 21st day of
APRIL, 1993.

Notary Public

My Commission Expires:

10/7/95

Is your RETURN ADDRESS completed on the reverse side?

SENDER:

- Complete items 1 and/or 2 for additional services.
- Complete items 3, and 4a & b.
- Print your name and address on the reverse of this form so that we can return this card to you.
- Attach this form to the front of the mailpiece, or on the back if space does not permit.
- Write "Return Receipt Requested" on the mailpiece below the article number.
- The Return Receipt will show to whom the article was delivered and the date delivered.

3. Article Addressed to:

EP Operating Company
4849 Greenville Avenue
Suite 1200
Dallas, Texas 75206-4186

5. Signature (Addressee)

6. Signature (Agent)

4a. Article Number

P 676 666 389

4b. Service Type

☐ Registered ☐ Insured

☒ Certified ☐ COD

☐ Express Mail ☐ Return Receipt for Merchandise

7. Date of Delivery

4/1/93

8. Addressee's Address (Only if requested and fee is paid)

DOMESTIC RETURN RECEIPT

Is your RETURN ADDRESS completed on the reverse side?

SENDER:

- Complete items 1 and/or 2 for additional services.
- Complete items 3, and 4a & b.
- Print your name and address on the reverse of this form so that we can return this card to you.
- Attach this form to the front of the mailpiece, or on the back if space does not permit.
- Write "Return Receipt Requested" on the mailpiece below the article number.
- The Return Receipt will show to whom the article was delivered and the date delivered.

3. Article Addressed to:

Oxford Exploration Co.
4582 S. Ulster Street
Suite 1500
Stenford Place III
Denver, Colorado 80237

5. Signature (Addressee)

6. Signature (Agent)

4a. Article Number

P 676 666 390

4b. Service Type

☐ Registered ☐ Insured

☒ Certified ☐ COD

☐ Express Mail ☐ Return Receipt for Merchandise

7. Date of Delivery

8. Addressee's Address (Only if requested and fee is paid)

DOMESTIC RETURN RECEIPT

Is your RETURN ADDRESS completed on the reverse side?

SENDER:

- Complete items 1 and/or 2 for additional services.
- Complete items 3, and 4a & b.
- Print your name and address on the reverse of this form so that we can return this card to you.
- Attach this form to the front of the mailpiece, or on the back if space does not permit.
- Write "Return Receipt Requested" on the mailpiece below the article number.
- The Return Receipt will show to whom the article was delivered and the date delivered.

3. Article Addressed to:

Yates Petroleum Corp.
105 S. Fourth Street
Artesia, New Mexico 88201

5. Signature (Addressee)

6. Signature (Agent)

4a. Article Number

P 676 666 391

4b. Service Type

☐ Registered ☐ Insured

☒ Certified ☐ COD

☐ Express Mail ☐ Return Receipt for Merchandise

7. Date of Delivery

APR 1 1993

8. Addressee's Address (Only if requested and fee is paid)

DOMESTIC RETURN RECEIPT

Is your RETURN ADDRESS completed on the reverse side?

SENDER:

- Complete items 1 and/or 2 for additional services.
- Complete items 3, and 4a & b.
- Print your name and address on the reverse of this form so that we can return this card to you.
- Attach this form to the front of the mailpiece, or on the back if space does not permit.
- Write "Return Receipt Requested" on the mailpiece below the article number.
- The Return Receipt will show to whom the article was delivered and the date delivered.

I also wish to receive the following services (for an extra fee):

- ☐ Addressee's Address
- ☒ Restricted Delivery

Consult postmaster for fee.

3. Article Addressed to:

Richardson Operating Co.
P.O. Box 9808
Denver, Colorado 80209

4a. Article Number
P 676 666 392

4b. Service Type

☐ Registered ☐ Insured
☒ Certified ☐ COD
☐ Express Mail ☐ Return Receipt for Merchandise

7. Date of Delivery
4-2-93

5. Signature (Addressee)
Meridian Block Diagram #10486

6. Signature (Agent)
Richardson Operating Co.

8. Addressee's Address (Only if requested and fee is paid)

PS Form 3811, December 1991, U.S.G.P.O. : 1992-307-530

DOMESTIC RETURN RECEIPT

Thank you for using Return Receipt Service.

Is your RETURN ADDRESS completed on the reverse side?

SENDER:

- Complete items 1 and/or 2 for additional services.
- Complete items 3, and 4a & b.
- Print your name and address on the reverse of this form so that we can return this card to you.
- Attach this form to the front of the mailpiece, or on the back if space does not permit.
- Write "Return Receipt Requested" on the mailpiece below the article number.
- The Return Receipt will show to whom the article was delivered and the date delivered.

I also wish to receive the following services (for an extra fee):

- ☐ Addressee's Address
- ☐ Restricted Delivery

Consult postmaster for fee.

3. Article Addressed to:

Read & Stevens
P.O. Box 1518
Roswell, New Mexico 88201

4a. Article Number
P 676 666 393

4b. Service Type

☐ Registered ☐ Insured
☒ Certified ☐ COD
☐ Express Mail ☐ Return Receipt for Merchandise

7. Date of Delivery
3-7-93

5. Signature (Addressee)
Meridian Block Diagram #10486

6. Signature (Agent)
Read & Stevens

8. Addressee's Address (Only if requested and fee is paid)

PS Form 3811, December 1991, U.S.G.P.O. : 1992-307-530

DOMESTIC RETURN RECEIPT

Thank you for using Return Receipt Service.

Is your RETURN ADDRESS completed on the reverse side?

SENDER:

- Complete items 1 and/or 2 for additional services.
- Complete items 3, and 4a & b.
- Print your name and address on the reverse of this form so that we can return this card to you.
- Attach this form to the front of the mailpiece, or on the back if space does not permit.
- Write "Return Receipt Requested" on the mailpiece below the article number.
- The Return Receipt will show to whom the article was delivered and the date delivered.

I also wish to receive the following services (for an extra fee):

- ☐ Addressee's Address
- ☐ Restricted Delivery

Consult postmaster for fee.

3. Article Addressed to:

Westway Petroleum
500 N. Akard Street
Dallas, Texas 75201-3394

4a. Article Number
P 676 666 394

4b. Service Type

☐ Registered ☐ Insured
☒ Certified ☐ COD
☐ Express Mail ☐ Return Receipt for Merchandise

7. Date of Delivery
APR 01 1993

5. Signature (Addressee)
Meridian Block Diagram #10486

6. Signature (Agent)
Westway Petroleum

8. Addressee's Address (Only if requested and fee is paid)

PS Form 3811, December 1991, U.S.G.P.O. : 1992-307-530

DOMESTIC RETURN RECEIPT

Thank you for using Return Receipt Service.

Is your RETURN ADDRESS completed on the reverse side?

SENDER:

- Complete items 1 and/or 2 for additional services.
- Complete items 3, and 4a & b.
- Print your name and address on the reverse of this form so that we can return this card to you.
- Attach this form to the front of the mailpiece, or on the back if space does not permit.
- Write "Return Receipt Requested" on the mailpiece below the article number.
- The Return Receipt will show to whom the article was delivered and the date delivered.

I also wish to receive the following services (for an extra fee):

1. ☐ Addressee's Address

2. ☐ Restricted Delivery

Consult postmaster for fee.

3. Article Addressed to:

Bureau of Land Management
Farmington Resource Area
1235 Laplata Highway
Farmington, New Mexico
87401

4a. Article Number
P 676 666 395

4b. Service Type

☐ Registered ☐ Insured

☒ Certified ☐ COD

☐ Express Mail ☐ Return Receipt for Merchandise

7. Date of Delivery
3-31-93

5. Signature (Addressee)
Paul Bougeant

6. Signature (Agent)

8. Addressee's Address (Only if requested and fee is paid)

PS Form 3811, December 1991 ☆ U.S.G.P.O. : 1992-307-530 **DOMESTIC RETURN RECEIPT**

Thank you for using Return Receipt Service.

Is your RETURN ADDRESS completed on the reverse side?

SENDER:

- Complete items 1 and/or 2 for additional services.
- Complete items 3, and 4a & b.
- Print your name and address on the reverse of this form so that we can return this card to you.
- Attach this form to the front of the mailpiece, or on the back if space does not permit.
- Write "Return Receipt Requested" on the mailpiece below the article number.
- The Return Receipt will show to whom the article was delivered and the date delivered.

I also wish to receive the following services (for an extra fee):

1. ☐ Addressee's Address

2. ☐ Restricted Delivery

Consult postmaster for fee.

3. Article Addressed to:

Amoco Production Company
P.O. Box 800
Denver, Colorado 80202

4a. Article Number
P 676 666 396

4b. Service Type

☐ Registered ☐ Insured

☒ Certified ☐ COD

☐ Express Mail ☐ Return Receipt for Merchandise

7. Date of Delivery

5. Signature (Addressee)
Meridian Black Diam Comd # 10486

6. Signature (Agent)

8. Addressee's Address (Only if requested and fee is paid)

PS Form 3811, December 1991 ☆ U.S.G.P.O. : 1992-307-530 **DOMESTIC RETURN RECEIPT**

Thank you for using Return Receipt Service.

Is your RETURN ADDRESS completed on the reverse side?

SENDER:

- Complete items 1 and/or 2 for additional services.
- Complete items 3, and 4a & b.
- Print your name and address on the reverse of this form so that we can return this card to you.
- Attach this form to the front of the mailpiece, or on the back if space does not permit.
- Write "Return Receipt Requested" on the mailpiece below the article number.
- The Return Receipt will show to whom the article was delivered and the date delivered.

I also wish to receive the following services (for an extra fee):

1. ☐ Addressee's Address

2. ☐ Restricted Delivery

Consult postmaster for fee.

3. Article Addressed to:

Evko Development
4710 Cabrillo Street
San Francisco, California
94121

4a. Article Number
P 676 666 397

4b. Service Type

☐ Registered ☐ Insured

☒ Certified ☐ COD

☐ Express Mail ☐ Return Receipt for Merchandise

7. Date of Delivery
APR 02 1993

5. Signature (Addressee)
Meridian Black Diam Comd # 10486

6. Signature (Agent)

8. Addressee's Address (Only if requested and fee is paid)

PS Form 3811, December 1991 ☆ U.S.G.P.O. : 1992-307-530 **DOMESTIC RETURN RECEIPT**

Thank you for using Return Receipt Service.

Is your RETURN ADDRESS completed on the reverse side?

SENDER:

- Complete items 1 and/or 2 for additional services.
- Complete items 3 and 4a & b.
- Print your name and address on the reverse of this form so that we can return this card to you.
- Attach this form to the front of the mailpiece, or on the back if space does not permit.
- Write "Return Receipt Requested" on the mailpiece below the article number.
- The Return Receipt will show to whom the article was delivered and the date delivered.

I also wish to receive the following services (for an extra fee):

- ☐ Addressee's Address
- ☐ Restricted Delivery

Consult postmaster for fee.

3. Article Addressed to:

Mary Lettman
Route 3, Box 158F
Poteau, Oklahoma 74954

4a. Article Number

P 676 666 399

4b. Service Type

- ☐ Registered ☐ Insured
☒ Certified ☐ COD
☐ Express Mail ☐ Return Receipt for Merchandise

7. Date of Delivery

4-5

5. Signature (Addressee)

Mary Lettman
Meridian Black Diam Com # 10486

6. Signature (Agent)

8. Addressee's Address (Only if requested and fee is paid)

PS Form 3811, December 1991 • U.S.G.P.O. : 1992-307-530

DOMESTIC RETURN RECEIPT

Thank you for using Return Receipt Service.

Is your RETURN ADDRESS completed on the reverse side?

SENDER:

- Complete items 1 and/or 2 for additional services.
- Complete items 3 and 4a & b.
- Print your name and address on the reverse of this form so that we can return this card to you.
- Attach this form to the front of the mailpiece, or on the back if space does not permit.
- Write "Return Receipt Requested" on the mailpiece below the article number.
- The Return Receipt will show to whom the article was delivered and the date delivered.

I also wish to receive the following services (for an extra fee):

- ☐ Addressee's Address
- ☐ Restricted Delivery

Consult postmaster for fee.

3. Article Addressed to:

James Lettman
Route 3, Box 158F
Poteau, Oklahoma 74954

4a. Article Number

P 676 666 400

4b. Service Type

- ☐ Registered ☐ Insured
☒ Certified ☐ COD
☐ Express Mail ☐ Return Receipt for Merchandise

7. Date of Delivery

5. Signature (Addressee)

James Lettman
Meridian Black Diam Com # 10486

6. Signature (Agent)

8. Addressee's Address (Only if requested and fee is paid)

PS Form 3811, December 1991 • U.S.G.P.O. : 1992-307-530

DOMESTIC RETURN RECEIPT

Thank you for using Return Receipt Service.

Is your RETURN ADDRESS completed on the reverse side?

SENDER:

- Complete items 1 and/or 2 for additional services.
- Complete items 3 and 4a & b.
- Print your name and address on the reverse of this form so that we can return this card to you.
- Attach this form to the front of the mailpiece, or on the back if space does not permit.
- Write "Return Receipt Requested" on the mailpiece below the article number.
- The Return Receipt will show to whom the article was delivered and the date delivered.

I also wish to receive the following services (for an extra fee):

- ☐ Addressee's Address
- ☐ Restricted Delivery

Consult postmaster for fee.

3. Article Addressed to:

Pat Buckway
Route 3, Box 158F
Poteau, Oklahoma 74954

4a. Article Number

P 676 666 401

4b. Service Type

- ☐ Registered ☐ Insured
☒ Certified ☐ COD
☐ Express Mail ☐ Return Receipt for Merchandise

7. Date of Delivery

4/9/93

5. Signature (Addressee)

Pat Buckway
Meridian Black Diam Com # 10486

6. Signature (Agent)

8. Addressee's Address (Only if requested and fee is paid)

PS Form 3811, December 1991 • U.S.G.P.O. : 1992-307-530

DOMESTIC RETURN RECEIPT

Thank you for using Return Receipt Service.

Is your RETURN ADDRESS completed on the reverse side?

SENDER:

- Complete items 1 and/or 2 for additional services.
- Complete items 3, and 4a & b.
- Print your name and address on the reverse of this form so that we can return this card to you.
- Attach this form to the front of the mailpiece, or on the back if space does not permit.
- Write "Return Receipt Requested" on the mailpiece below the article number.
- The Return Receipt will show to whom the article was delivered and the date delivered.

I also wish to receive the following services (for an extra fee):

1. ☐ Addressee's Address
2. ☐ Restricted Delivery

Consult postmaster for fee.

3. Article Addressed to:

Clifford C. Coppinger
19850 N. 27th Place
Phoenix, Arizona 85024

4a. Article Number

P 676 666 402

4b. Service Type

- ☐ Registered ☐ Insured
☒ Certified ☐ COD
☐ Express Mail ☐ Return Receipt for Merchandise

7. Date of Delivery

4-1-83

5. Signature (Addressee)

Miss C. Coppinger

6. Signature (Agent)

8. Addressee's Address (Only if requested and fee is paid)

PS Form 3811, December 1991 ☆ U.S.G.P.O. : 1992-307-530

DOMESTIC RETURN RECEIPT

Thank you for using Return Receipt Service.

Is your RETURN ADDRESS completed on the reverse side?

SENDER:

- Complete items 1 and/or 2 for additional services.
- Complete items 3, and 4a & b.
- Print your name and address on the reverse of this form so that we can return this card to you.
- Attach this form to the front of the mailpiece, or on the back if space does not permit.
- Write "Return Receipt Requested" on the mailpiece below the article number.
- The Return Receipt will show to whom the article was delivered and the date delivered.

I also wish to receive the following services (for an extra fee):

1. ☐ Addressee's Address
2. ☐ Restricted Delivery

Consult postmaster for fee.

3. Article Addressed to:

Ethel Brimhall Foutz, Estate
P.O. Box 262
Farmington, New Mexico
87499

4a. Article Number

P 676 666 405

4b. Service Type

- ☐ Registered ☐ Insured
☒ Certified ☐ COD
☐ Express Mail ☐ Return Receipt for Merchandise

7. Date of Delivery

4-1-93

5. Signature (Addressee)

Ethel Foutz

6. Signature (Agent)

8. Addressee's Address (Only if requested and fee is paid)

PS Form 3811, December 1991 ☆ U.S.G.P.O. : 1992-307-530

DOMESTIC RETURN RECEIPT

Thank you for using Return Receipt Service.

Is your RETURN ADDRESS completed on the reverse side?

SENDER:

- Complete items 1 and/or 2 for additional services.
- Complete items 3, and 4a & b.
- Print your name and address on the reverse of this form so that we can return this card to you.
- Attach this form to the front of the mailpiece, or on the back if space does not permit.
- Write "Return Receipt Requested" on the mailpiece below the article number.
- The Return Receipt will show to whom the article was delivered and the date delivered.

I also wish to receive the following services (for an extra fee):

1. ☐ Addressee's Address
2. ☐ Restricted Delivery

Consult postmaster for fee.

3. Article Addressed to:

Ronald M. Brimhall
P.O. Box 11
Wellborn, Texas 77881

4a. Article Number

P 676 666 404

4b. Service Type

- ☐ Registered ☐ Insured
☒ Certified ☐ COD
☐ Express Mail ☐ Return Receipt for Merchandise

7. Date of Delivery

4-8-83

5. Signature (Addressee)

Ronald M. Brimhall

6. Signature (Agent)

8. Addressee's Address (Only if requested and fee is paid)

PS Form 3811, December 1991 ☆ U.S.G.P.O. : 1992-307-530

DOMESTIC RETURN RECEIPT

Thank you for using Return Receipt Service.