

County, \_\_\_\_\_

Township \_\_\_\_\_ Range \_\_\_\_\_

Township \_\_\_\_\_ Range \_\_\_\_\_

Township \_\_\_\_\_ Range \_\_\_\_\_

Township \_\_\_\_\_ Range \_\_\_\_\_

Form 104—(Four on Township)

6	5	4	3	2	1	6	5	4	3	2	1
7	8	9	10	11	12	7	8	9	10	11	12
18	17	16	15	14	13	18	17	16	15	14	13
19	20	21	22	23	24	19	20	21	22	23	24
30	29	28	27	26	25	30	29	28	27	26	25
31	32	33	34	35	36	31	32	33	34	35	36
6	5	4	3	2	1	6	5	4	3	2	1
7	8	9	10	11	12	7	8	9	10	11	12
18	17	16	15	14	13	18	17	16	15	14	13
19	20	21	22	23	24	19	20	21	22	23	24
30	29	28	27	26	25	30	29	28	27	26	25
31	32	33	34	35	36	31	32	33	34	35	36

North West-Morrow Gas Pool

— Quicks Plans Pennsylvania

R-992, L-3056

# West Texas and Eastern New Mexico

5

## Oil Wells

Responses		Depth in Feet		Monthly Drilling Well Rates				Monthly Producing Well Rates			
				1993		1992		1993		1992	
				Mean	Median	Mean	Median	Mean	Median	Mean	Median
1993	1992										
141	173	0 - 5,000		\$3,093	\$3,000	\$3,271	\$3,000	\$323	\$300	\$326	\$300
114	142	5,001 - 10,000		4,136	4,000	4,311	4,000	450	425	550	400
42	35	10,001 - 15,000		5,146	5,000	5,185	5,000	502	500	501	500
5	6	15,001 - 20,000		5,590	5,000	6,529	7,618	538	450	623	668
1	1	20,001 -		4,500	4,500	8,500	8,500	400	400	850	850
8	7	No Depth Limit		4,018	4,000	3,405	3,650	476	476	372	330

# West Texas and Eastern New Mexico

5

## Gas Wells

Responses		Depth in Feet		Monthly Drilling Well Rates				Monthly Producing Well Rates			
				1993		1992		1993		1992	
				Mean	Median	Mean	Median	Mean	Median	Mean	Median
1993	1992										
72	90	0 - 5,000		\$3,138	\$3,000	\$3,138	\$3,000	\$330	\$310	\$351	\$300
60	73	5,001 - 10,000		4,270	4,000	4,325	4,141	431	425	447	400
32	26	10,001 - 15,000		5,462	5,000	5,388	5,000	548	500	514	500
4	10	15,001 - 20,000		6,259	5,500	5,209	5,000	544	537	544	575
2	2	20,001 -		6,000	6,000	8,500	8,500	425	425	600	600
8	5	No Depth Limit		4,199	4,000	4,408	3,816	486	475	430	389

Leo

## FOOD

*Quaracho hillensis*

## Argument

## TOWNSHIP

10-South

# RANGE

32 East

A 36x36 grid with numbers 1-36 in the top row and 1-36 in the left column. The grid is composed of small squares, each containing a number. The numbers are arranged in a regular pattern, with the top row containing numbers 1 through 36 and the left column containing numbers 1 through 36. The grid is used for a statistical analysis of the numbers.

Description: 5 1/4 Sec. 22, (R-9524-ES-57).

Ext.  $\frac{SW}{4}$  Sec. 15;  $\frac{NW}{4}$  Sec. 22 (R. 3056, 5-1-66)

ILLEGIBLE

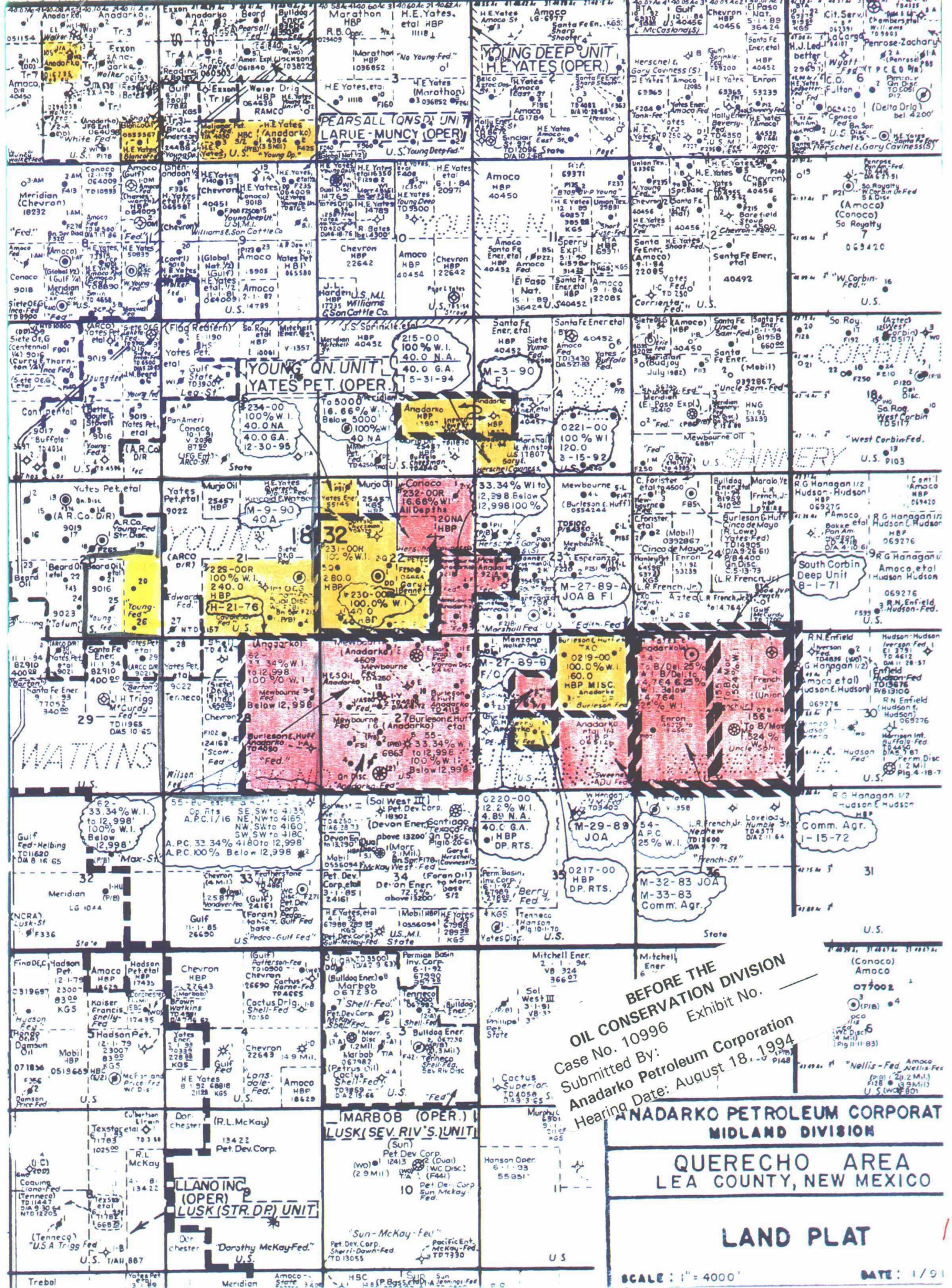

3-47-30-015-0229

SACROW 21 T783 R 300

F/2 SW/4, SW/4

## WELL HISTORY

**ANADARKO PETROLEUM CORPORATION  
QUERCHO PLAINS UNIT No 1  
UNIT LETTER "K"  
1980' FSL & 1980' FWL  
SEC 22, T 18 S, R 32 E  
LEA COUNTY, NEW MEXICO**

**OPERATOR:** Shell Oil Company

**SPUD DATE:** July 10, 1956

**TOTAL DEPTH:** 14,217'

**CASING PROGRAM:** 13-3/8", 48# @ 734' w/ 750 sxs (cmt circ - 35 sxs)  
9-5/8", 40# @ 4539' w/ 1150 sxs (cmt circ - 120 sxs)  
Sqzd bad casing @ 3430' w/ 150 sxs  
7", 26# & 29# @ 13,755' w/ 900 sxs (TSITC @ 9900')

**OPEN HOLE:** 13,755' to 14,217'

**PLUG BACK:** January 8, 1957 w/ CIBP @ 13,730', CIBP @ 11,750' w/ 1 sx *Strawn*

**PERFORATE:** January 10, 1957 Des Moines (Penn) 4 SPF 11,595'-625' & 640'-660'  
IPF January 11, 1957 221 BOPD  
Additional perfs shot March 23, 1959 w/ 4 SPF 11,578'-586'

**CHANGE IN OWNERSHIP TO:** Petroleum Corporation of Texas on November 20, 1967  
Breck Operating Corporation on October 12, 1983  
Gary L. Bennett on June 27, 1989

**UNREPORTED RECOMPLETION:** Gary L. Bennett filed a notice to deepen within the casing and perforate Morrow from 12,530' to 12,644'. The notice included a proposed proration unit of 320 acres consisting of the S/2 NW/4, SW/4, and W/2 SE/4 all in Sec 22. The proration unit was not legal and was not approved. The recompletion was performed either before or after the notice was rejected. The subsequent gas production was reported as Penn production. Please refer to decline curve and Anadarko's workover report.

**CHANGE IN OWNERSHIP TO:** Anadarko Petroleum Corporation on September 26, 1990

**WORKOVER:** October 4, 1990 the Morrow was TA'ed with BP set @ 11,909' and the Penn was put back on pump October 18, 1990.

**CURRENT STATUS:** Well is pumping 13 BOPD from Penn perfs 11,578 to 11,660' O.A.

**CURRENT PRORATION UNIT:** NE/4 SW/4 Sec 22 - 40 acres

BEFORE THE  
OIL CONSERVATION DIVISION  
Case No. 10996 Exhibit No. \_\_\_\_\_  
Submitted By:  
Anadarko Petroleum Corporation  
Hearing Date: August 18, 1994

# QUERCHO FLAINS UNIT "

1980' FSL & 1980' FWL  
SEC 22, T.18S, R.32E  
LEA COUNTY, NEW MEXICO

Spud Date: 7/10/56

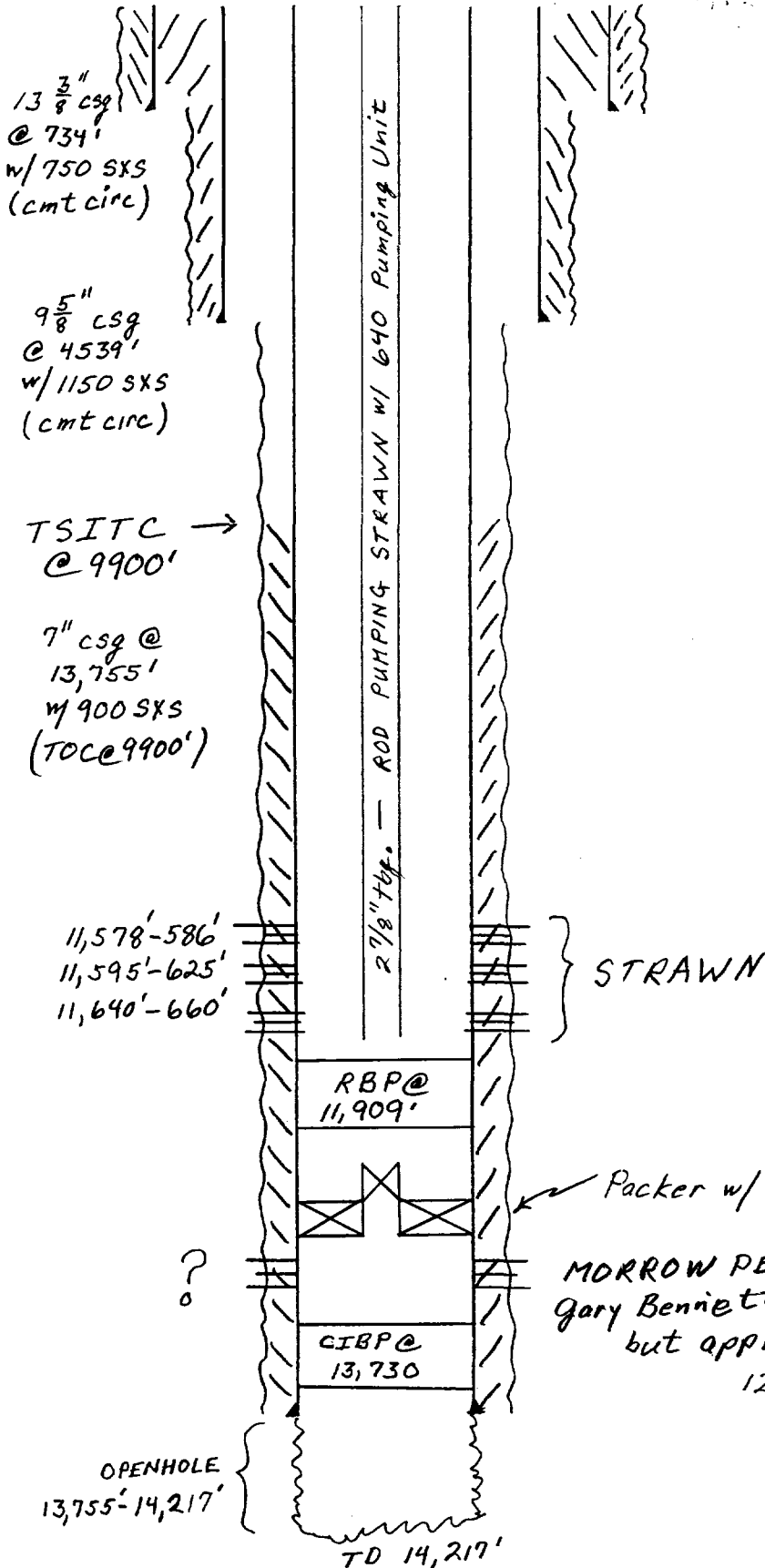

BEFORE THE  
OIL CONSERVATION DIVISION  
Case No. 10996 Exhibit No. \_\_\_\_\_  
Submitted By:  
Anadarko Petroleum Corporation  
Hearing Date: August 18, 1994

GRSB  
11-15-93

NO. OF COPIES RECEIVED	
DISTRIBUTION	
SANTA FE	
FILE	
U.S.G.S.	
LAND OFFICE	
TRANSPORTER	OIL GAS
OPERATOR	
PRORATION OFFICE	

NEW MEXICO OIL CONSERVATION COMMISSION  
REQUEST FOR ALLOWABLE  
AND  
AUTHORIZATION TO TRANSPORT OIL AND NATURAL GAS

Form C-104  
Supersedes Old C-104 and C-110  
Effective 1-1-65

BEFORE THE  
OIL CONSERVATION DIVISION  
Case No. 10996 Exhibit No. \_\_\_\_\_  
Submitted By:  
Anadarko Petroleum Corporation  
Hearing Date: August 18, 1994

Operator  
Petroleum Corporation of Texas  
Address  
Box 911, Breckenridge, Texas 75024  
Reason(s) for filing (Check proper box)  
New Well ☐ Change in Transporter of:  
Recompletion ☐ Oil ☐ Dry Gas ☐  
Change in Ownership ☒ Casinghead Gas ☐ Condensate ☐  
Other (Please explain)  
If change of ownership give name and address of previous owner  
Shell Oil Company, Box 1509, Midland, Texas 79701

II. DESCRIPTION OF WELL AND LEASE  
Lease Name  
Querecho Plains Unit  
Well No.  
1  
Pool Name, Including Formation  
Querecho Plains (Penn.)  
Kind of Lease  
State, Federal or Fee Federal  
Location  
Unit Letter K ; 1980 Feet From The South Line and 1980 Feet From The West  
Line of Section 22 Township 18S Range 32E , NMPM, Lea County

III. DESIGNATION OF TRANSPORTER OF OIL AND NATURAL GAS  
Name of Authorized Transporter of Oil ☒ or Condensate ☐  
Texas-New Mexico Pipe Line Company  
Address (Give address to which approved copy of this form is to be sent)  
Box 151C, Midland, Texas 79701  
Name of Authorized Transporter of Casinghead Gas ☒ or Dry Gas ☐  
Phillips Petroleum Company  
Address (Give address to which approved copy of this form is to be sent)  
Bartlesville, Oklahoma 74004  
If well produces oil or liquids, give location of tanks.  
Unit K Sec. 22 Twp. 18S Rge. 32E  
Is gas actually connected? Yes When November 2, 1959

If this production is commingled with that from any other lease or pool, give commingling order number:

IV. COMPLETION DATA  
Designate Type of Completion - (X)  
Oil Well Gas Well New Well Workover Deepen Plug Back Same Res'v. Diff. Res'v.  
Date Spudded Date Compl. Ready to Prod. Total Depth P.B.T.D.  
Pool Name of Producing Formation Top Oil/Gas Pay Tubing Depth  
Perforations Depth Casing Shoe  
TUBING, CASING, AND CEMENTING RECORD  
HOLE SIZE CASING & TUBING SIZE DEPTH SET SACKS CEMENT

V. TEST DATA AND REQUEST FOR ALLOWABLE OIL WELL  
(Test must be after recovery of production of load oil and must be equal to or exceed top allowable for this depth or be for full 24 hours)  
Date First New Oil Run To Tanks Date of Test Producing Method (Flow, pump, gas lift, etc.)  
Length of Test Tubing Pressure Casing Pressure  
Actual Prod. During Test Oil-Bbls. Water-Bbls.  
GAS WELL  
Actual Prod. Test-MCF/D Length of Test Bbls. Condensate  
Testing Method (pitot, back pr.) Tubing Pressure Casing Pressure

VI. CERTIFICATE OF COMPLIANCE  
I hereby certify that the rules and regulations of the Oil Conservation Commission have been complied with and that the information given above is true and complete to the best of my knowledge and belief.

Mary B. Taylor  
(Signature) Mary B. Taylor  
Production Clerk  
(Title)  
November 20, 1967  
(Date)

APPROVED BY  
TITLE

This form is to be filed in compliance with RULE 1104.  
If this is a request for allowable for a newly drilled or deepened well, this form must be accompanied by a tabulation of the deviation tests taken on the well in accordance with RULE 111.  
All sections of this form must be filled out completely for allowable on new and recompleted wells.  
Fill out Sections I, II, III, and VI only for changes of owner, well name or number, or transporter, or other such change of condition.  
Separate Forms C-104 must be filed for each pool in multiply completed wells.

DISTRIBUTION			
SANTA FE			
FILE			
U.S.G.S.			
LAND OFFICE			
TRANSPORTER	OIL		
	GAS		
OPERATOR			
PRORATION OFFICE			

NEW MEXICO OIL CONSERVATION COMMISSION  
REQUEST FOR ALLOWABLE  
AND  
AUTHORIZATION TO TRANSPORT OIL AND NATURAL GAS

Form C-104  
Supersedes Old C-104 and C  
Effective 1-1-65

I. Operator  
Breck Operating Corp.  
Address  
P. O. Box 911, Breckenridge, Texas 76024  
Reason(s) for filing (Check proper box)  
New Well ☐ Change in Transporter of:  
Recompletion ☐ Oil ☐ Dry Gas ☐  
Change in Ownership ☒ Casinghead Gas ☐ Condensate ☐  
Other (Please explain)  
If change of ownership give name and address of previous owner  
Petroleum Corporation of Texas, Box 911, Breckenridge, TX 76024

II. DESCRIPTION OF WELL AND LEASE  
Lease Name  
Querecho Plains Unit  
Well No.  
1  
Pool Name, Including Formation  
Querecho Plains, Penn.  
Kind of Lease  
State, Federal or Fee  
Federal NM-04371A  
Location  
Unit Letter  
K  
1980  
Feet From The  
south  
Line and  
1980  
Feet From The  
west  
Line of Section  
22  
Township  
18S  
Range  
32E  
NMPM,  
Lea  
County

III. DESIGNATION OF TRANSPORTER OF OIL AND NATURAL GAS  
Name of Authorized Transporter of Oil ☒ or Condensate ☐  
Texas New Mexico Pipe Line Company  
Address (Give address to which approved copy of this form is to be sent)  
Box 1510, Midland, Texas 79702  
Name of Authorized Transporter of Casinghead Gas ☐ or Dry Gas ☐  
Phillips Petroleum Company  
Address (Give address to which approved copy of this form is to be sent)  
4001 penbrook, Odessa, TX 79762  
If well produces oil or liquids, give location of tanks.  
Unit  
K  
Sec.  
22  
Twp.  
18S  
Rge.  
32E  
Is gas actually connected?  
Yes  
When  
11-2-59

If this production is commingled with that from any other lease or pool, give commingling order number:

IV. COMPLETION DATA  
Designate Type of Completion - (X)  
Oil Well ☐ Gas Well ☐ New Well ☐ Workover ☐ Deepen ☐ Plug Back ☐ Same Rest'v. ☐ Diff. Rest'v. ☐  
Date Spudded  
Date Compl. Ready to Prod.  
Total Depth  
P.B.T.D.  
Elevations (DF, RKB, RT, GR, etc.)  
Name of Producing Formation  
Top Oil/Gas Pay  
Tubing Depth  
Perforations  
Depth Casing Shoe  
TUBING, CASING, AND CEMENTING RECORD  
HOLE SIZE  
CASING & TUBING SIZE  
DEPTH SET  
SACKS CEMENT

V. TEST DATA AND REQUEST FOR ALLOWABLE OIL WELL (Test must be after recovery of total volume of load oil and must be equal to or exceed top allowable for this depth or be for full 24 hours)  
Date First New Oil Run To Tanks  
Date of Test  
Producing Method (Flow, pump, gas lift, etc.)  
Length of Test  
Tubing Pressure  
Casing Pressure  
Choke Size  
Actual Prod. During Test  
Oil-Bbls.  
Water-Bbls.  
Gas-MCF

GAS WELL  
Actual Prod. Test-MCF/D  
Length of Test  
Bbls. Condensate/MMCF  
Gravity of Condensate  
Testing Method (pilot, back pr.)  
Tubing Pressure (Shut-in)  
Casing Pressure (Shut-in)  
Choke Size

VI. CERTIFICATE OF COMPLIANCE  
I hereby certify that the rules and regulations of the Oil Conservation Commission have been complied with and that the information given above is true and complete to the best of my knowledge and belief.  
Gadear Ragland  
(Signature)  
Production Clerk  
(Title)  
10-12-83  
(Date)  
OIL CONSERVATION COMMISSION  
JAN 20 1984  
APPROVED  
BY ORIGINAL SIGNED BY JERRY SEXTON  
DISTRICT I SUPERVISOR  
TITLE  
This form is to be filed in compliance with RULE 1104.  
If this is a request for allowable for a newly drilled or deepened well, this form must be accompanied by a tabulation of the deviated tests taken on the well in accordance with RULE 111.  
All sections of this form must be filled out completely for allowable on new and recompleted wells.  
Fill out only Sections I, II, III, and VI for changes of owner name or number, or transporter, or other such change of condition.  
Separate Forms C-104 must be filed for each pool in multiphase wells.

DISTRICT II  
P.O. Drawer DD, Artesia, NM 88210

## OIL CONSERVATION DIVISION

P.O. Box 2088  
Santa Fe, New Mexico 87504-2088

DISTRICT III  
1000 Rio Brazos Rd., Aztec, NM 87410

### REQUEST FOR ALLOWABLE AND AUTHORIZATION TO TRANSPORT OIL AND NATURAL GAS

I.

Operator <u>Gary L. Bennett</u>	Well API No. 300250302100S1
Address P.O. Box 16844 Lubbock Texas 79490	
Reason(s) for Filing (Check proper box) <input type="checkbox"/> Other (Please explain)	
New Well <input type="checkbox"/>	Change in Transporter of:
Recompletion <input type="checkbox"/>	Oil <input type="checkbox"/> Dry Gas <input type="checkbox"/>
Change in Operator <input checked="" type="checkbox"/>	Casinghead Gas <input type="checkbox"/> Condensate <input type="checkbox"/>

If change of operator give name and address of previous operator Breck Operating Corp., P.O. Box 911, Breckenridge, Texas 76024

### II. DESCRIPTION OF WELL AND LEASE

Lease Name <u>Querecho Plains Unit</u>	Well No. 1	Pool Name, Including Formation <u>Querecho Plains (PENN)</u>	Kind of Lease <u>State, Federal or Fee</u>	Lease No. NM 04317
Location Unit Letter <u>K</u> : <u>1980</u> Feet From The <u>south</u> Line and <u>1980</u> Feet From The <u>west</u> Line Section <u>22</u> Township <u>18S</u> Range <u>32E</u> , <u>NMPM</u> , <u>Lea</u> County				

### III. DESIGNATION OF TRANSPORTER OF OIL AND NATURAL GAS

Name of Authorized Transporter of Oil <input checked="" type="checkbox"/> or Condensate <input type="checkbox"/> <u>Enron Oil Trading &amp; Transp. Company</u>	Address (Give address to which approved copy of this form is to be sent) <u>P.O. Box 1188, Houston, Tx., 77251-1188</u>					
Name of Authorized Transporter of Casinghead Gas <input checked="" type="checkbox"/> or Dry Gas <input type="checkbox"/> <u>Phillips Petroleum Company</u>	Address (Give address to which approved copy of this form is to be sent) <u>Bartlesville, Oklahoma 74004</u>					
If well produces oil or liquids, give location of tanks.	Unit <u>K</u>	Sec. <u>22</u>	Twp. <u>18S</u>	Rge. <u>32E</u>	Is gas actually connected? <u>Yes</u>	When? <u>November 2, 1959</u>

If this production is commingled with that from any other lease or pool, give commingling order number:

### IV. COMPLETION DATA

Designate Type of Completion - (X)	Oil Well	Gas Well	New Well	Workover	Deepen	Plug Back	Same Res'v	Diff Res'v
Date Spudded	Date Compl. Ready to Prod.		Total Depth			P.B.T.D.		
Elevations (DF, RKB, RT, GR, etc.)	Name of Producing Formation		Top Oil/Gas Pay			Tubing Depth		
Perforations						Depth Casing Shoe		
TUBING, CASING AND CEMENTING RECORD								
HOLE SIZE	CASING & TUBING SIZE		DEPTH SET			SACKS CEMENT		

### V. TEST DATA AND REQUEST FOR ALLOWABLE

OIL WELL (Test must be after recovery of total volume of load oil and must be equal to or exceed top allowable for this depth or be for full 24 hours.)

Date First New Oil Run To Tank	Date of Test	Producing Method (Flow, pump, gas lift, etc.)	
Length of Test	Tubing Pressure	Casing Pressure	Choke Size
Actual Prod. During Test	Oil - Bbls.	Water - Bbls.	Gas- MCF

### GAS WELL

Actual Prod. Test - MCF/D	Length of Test	Bbls. Condensate/MMCF	Gravity of Condensate
Testing Method (pilot, back pr.)	Tubing Pressure (Shut-in)	Casing Pressure (Shut-in)	Choke Size

### VI. OPERATOR CERTIFICATE OF COMPLIANCE

I hereby certify that the rules and regulations of the Oil Conservation Division have been complied with and that the information given above is true and complete to the best of my knowledge and belief.

Gary L. Bennett  
Signature  
Gary L. Bennett Operator  
Printed Name  
6-27-89 806-794-3368  
Date Telephone No.

OIL CONSERVATION DIVISION  
JUN 29 1989

Date Approved  
By ORIGINAL SIGNED BY JERRY SEXTON  
DISTRICT I SUPERVISOR  
Title

INSTRUCTIONS: This form is to be filed in compliance with Rule 1104

- 1) Request for allowable for newly drilled or deepened well must be accompanied by tabulation of deviation tests taken in accordance with Rule 111.
- 2) All sections of this form must be filled out for allowable on new and recompleted wells.
- 3) Fill out only Sections I, II, III, and VI for changes of operator, well name or number, transporter, or other such changes.
- 4) Separate Form C-104 must be filed for each pool in multiply completed wells.

Submit 5 Copies  
Appropriate District Office  
DISTRICT I  
P.O. Box 1980, Hobbs, NM 88240

DISTRICT II  
P.O. Drawer DD, Artesia, NM 88210

DISTRICT III  
1000 Rio Brazos Rd., Aztec, NM 87410

State of New Mexico  
Energy, Minerals and Natural Resources Department

OIL CONSERVATION DIVISION

P.O. Box 2088  
Santa Fe, New Mexico 87504-2088

Form C-104  
Revised 1-1-89  
See Instructions  
at Bottom of Page

REQUEST FOR ALLOWABLE AND AUTHORIZATION  
TO TRANSPORT OIL AND NATURAL GAS

Operator Anadarko Petroleum Corporation	Well API No. 30-025-03021
Address P.O. Drawer 130, Artesia, New Mexico 88211-0130	
Reason(s) for Filing (Check proper box) <input checked="" type="checkbox"/> Other (Please explain)	
New Well <input type="checkbox"/>	Change in Transporter of: Also, change of transporter of oil.
Recompletion <input type="checkbox"/>	Oil <input type="checkbox"/> Dry Gas <input type="checkbox"/>
Change in Operator <input checked="" type="checkbox"/>	Casinghead Gas <input type="checkbox"/> Condensate <input type="checkbox"/>
If change of operator give name and address of previous operator Gary L. Bennett, P.O. Box 16844, Lubbock, Texas 79490	

II. DESCRIPTION OF WELL AND LEASE

Lease Name Querecho Plains Unit	Well No. 1	Pool Name, Including Formation Querecho Plains (Penn)	Kind of Lease <del>State</del> , Federal <del>Lease</del>	Lease No. NM-04317
Location Unit Letter <u>K</u> : <u>1980</u> Feet From The <u>South</u> Line and <u>1980</u> Feet From The <u>West</u> Line Section <u>22</u> Township <u>18S</u> Range <u>32E</u> , <u>NMPM</u> , <u>Lea</u> County				

III. DESIGNATION OF TRANSPORTER OF OIL AND NATURAL GAS

Name of Authorized Transporter of Oil <input checked="" type="checkbox"/> or Condensate <input type="checkbox"/> Navajo Refining Company, Trucking Div.	Address (Give address to which approved copy of this form is to be sent) P.O. Drawer 159, Artesia, NM 88210	
Name of Authorized Transporter of Casinghead Gas <input checked="" type="checkbox"/> or Dry Gas <input type="checkbox"/> Phillips 66 Natural Gas	Address (Give address to which approved copy of this form is to be sent) 4001 Penbrook, Odessa, Texas 79762	
If well produces oil or liquids, give location of tanks.	Unit K	Sec. 22
	Twp. 18S	Rge. 32E
	Is gas actually connected? Yes	When? 11-02-59

If this production is commingled with that from any other lease or pool, give commingling order number:

IV. COMPLETION DATA

Designate Type of Completion - (X)	Oil Well	Gas Well	New Well	Workover	Deepen	Plug Back	Same Res'v	Diff Res'v
Date Spudded	Date Compl. Ready to Prod.		Total Depth			P.B.T.D.		
Elevations (DF, RKB, RT, GR, etc.)	Name of Producing Formation		Top Oil/Gas Pay			Tubing Depth		
Perforations						Depth Casing Shoe		
TUBING, CASING AND CEMENTING RECORD								
HOLE SIZE	CASING & TUBING SIZE		DEPTH SET			SACKS CEMENT		

V. TEST DATA AND REQUEST FOR ALLOWABLE

OIL WELL (Test must be after recovery of total volume of load oil and must be equal to or exceed top allowable for this depth or be for full 24 hours.)

Date First New Oil Run To Tank	Date of Test	Producing Method (Flow, pump, gas lift, etc.)	
Length of Test	Tubing Pressure	Casing Pressure	Choke Size
Actual Prod. During Test	Oil - Bbls.	Water - Bbls.	Gas- MCF

GAS WELL

Actual Prod. Test - MCF/D	Length of Test	Bbls. Condensate/MMCF	Gravity of Condensate
Testing Method (pilot, back pr.)	Tubing Pressure (Shut-in)	Casing Pressure (Shut-in)	Choke Size

VI. OPERATOR CERTIFICATE OF COMPLIANCE

I hereby certify that the rules and regulations of the Oil Conservation Division have been complied with and that the information given above is true and complete to the best of my knowledge and belief.

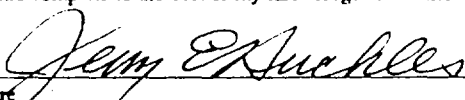
  
Signature  
Jerry E. Buckles Area Supervisor  
Printed Name  
September 26, 1990 (505) 748-3368  
Date Telephone No.

OIL CONSERVATION DIVISION

Date Approved SEP 27 1990

By ORIGINAL SIGNATURE OF JERRY E. BUCKLES  
DISTRICT I SUPERVISOR

Title

INSTRUCTIONS: This form is to be filed in compliance with Rule 1104

- 1) Request for allowable for newly drilled or deepened well must be accompanied by tabulation of deviation tests taken in accordance with Rule 111.
- 2) All sections of this form must be filled out for allowable on new and recompleted wells.
- 3) Fill out only Sections I, II, III, and VI for changes of operator, well name or number, transporter, or other such changes.
- 4) Separate Form C-104 must be filed for each pool in multiply completed wells.

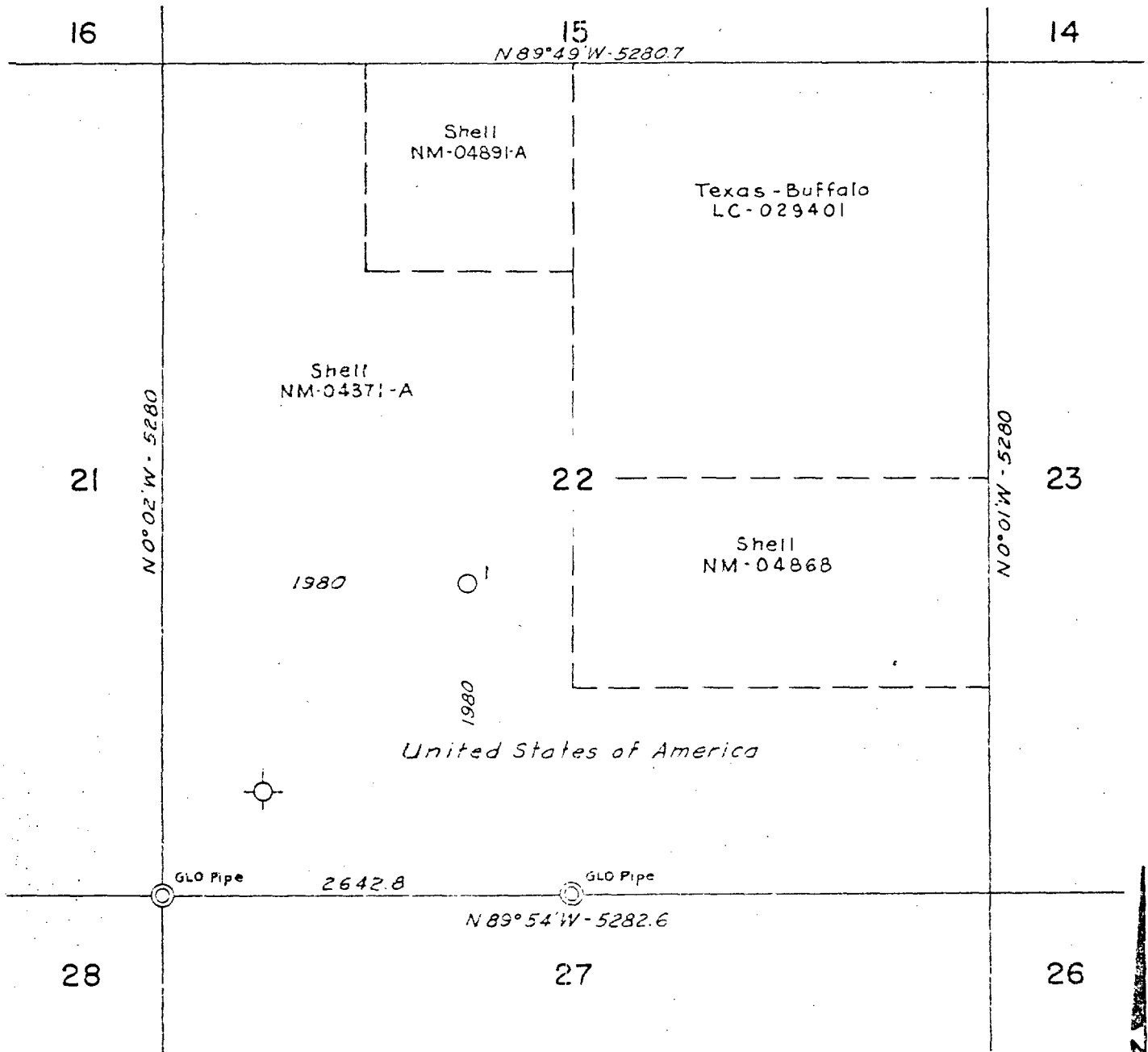

I, L.H. Moncrief, certify that this survey was made by me on the ground and that this plat is true and correct. May 23, 1956

*L.H. Moncrief*  
 Registered Public Surveyor  
 (Texas)

**SHELL OIL COMPANY**  
 LOCATION PLAT  
 SHELL QUERECHO PLAINS UNIT NO. 1  
 U.S.A. LEASE NO. NM-04371-A  
 SEC. 22, T-18-S, R-32-E  
 LEA COUNTY, NEW MEXICO  
 SCALE 1" = 1000 FT.

**BEFORE THE**  
**OIL CONSERVATION DIVISION**  
 Case No. 10996 Exhibit No. \_\_\_\_\_  
 Submitted By:  
**Anadarko Petroleum Corporation**  
 Hearing Date: August 18, 1994

1000-100-1  
(November 1983)  
Form 1000-100-1

SUBMIT IN TRIPLICATE\*  
(Other instructions on  
reverse side)

Form approved,  
Budget Bureau No. 1004-0136  
Effective August 31, 1985

UNITED STATES  
DEPARTMENT OF THE INTERIOR  
BUREAU OF LAND MANAGEMENT

1000-100-1

APPLICATION FOR PERMIT TO DRILL, DEEPEN, OR PLUG BACK

1. TYPE OF WORK

DRILL ☐

DEEPEN ☒

PLUG BACK ☐

2. TYPE OF WELL

OIL  
WELL ☐

GAS  
WELL ☒

OTHER

SINGLE  
ZONE ☒

MULTIPLE  
ZONE ☐

3. NAME OF OPERATOR

Grey L. Bennett

4. ADDRESS OF OPERATOR

Box 16844 Lubbock, Texas 79490

5. LOCATION OF WELL (Report location clearly and in accordance with any State requirements.)\*

1980' FWL & 1980' FSL

Location and name

Same

6. DISTANCE IN MILES AND DIRECTION FROM NEAREST TOWN OR POST OFFICE\*

1/2 mi Southeast of Maljamar, New Mexico

7. LEASE DESIGNATION AND SERIAL NO.

NM-04371A, NM-04868

APPROPRIATE, ALLOTMENT OR OTHER NAME

8. UNIT AGREEMENT NAME

Querecho Plains Unit

9. FARM OR LEASE NAME

10. WELL NO.

1

11. FIELD AND POOL, OR WILDCAT

Und. No. Yank Morrow

12. SEC., T., R., M., OR BLM, AND SURVEY OF AREA

Sec. 22-T10N-R32E

13. COUNTY OR PARISH

Lea

14. STATE

NM

15. NO. OF ACRES IN LEASE

320

16. NO. OF ACRES ASSIGNED TO THIS WELL

320

17. PROPOSED DEPTH

13,730'

18. ROTARY OR CABLE TOOLS

Reverse Unit/Blower

19. APPROX. DATE OF WELL STOP

8-15-89

20. PROPOSED CASING AND CEMENTING PROGRAM

TYPE OF HOLE	TYPE OF CASING	WEIGHT PER FOOT	SETTING DEPTH	QUANTITY OF CEMENT
		26 & 29#	13,755'	900.0

NOVE CASING IN HOLE NOW.

operator plan to drill out the CIBP at 11,750' and clean out the existing 7" casing to a total depth of 13,730 to test the morrow formation. The Morrow will be perforated from 12,530'--12,644' with a tubing conveyed system. Well will be tested and stimulated as necessary for production in commercial quantities. If now proves unproductive, the well will be plugged back and re-establish from the Strawn interval from 11578'-11,660.

WP: A Hydraulic double ram preventer will be used with a 5000# wp rating & tested.

For additional information refer to Original permit --Shell Oil Company  
Querecho PLains Unit #1.

IN ABOVE SPACE DESCRIBE PROPOSED PROGRAM: If proposal is to drill or plug back, give data on present productive zone and proposed new productive zone. If proposal is to drill or deepen directionally, give pertinent data on subsurface locations and measured and true vertical depths. Give blowout preventer program, if any.

SIGNED [Signature] TITLE Agent DATE 8-1-89  
(This space for Federal or State office use)

PERMIT NO.

APPROVAL DATE

APPROVED BY

FOR:

DATE

CONDITIONS OF APPROVAL, IF ANY

Instructions On Reverse Side

1. TOTAL PAGE 02 \*\*

PAGE 005

BEFORE THE  
OIL CONSERVATION DIVISION  
Case No. 10996 Exhibit No. \_\_\_\_\_  
Submitted By:  
Anadarko Petroleum Corporation  
Hearing Date: August 18, 1994

ILLEGIBLE

BEFORE THE  
 OIL CONSERVATION DIVISION  
 Case No. 10996 Exhibit No. \_\_\_\_\_  
 Submitted By:  
 Anadarko Petroleum Corporation  
 Hearing Date: August 18, 1994

Date: 08/15/94  
 Time: 10:43:42

File: NMWELLS.DSF  
 Get#: 285

# PRODUCTION

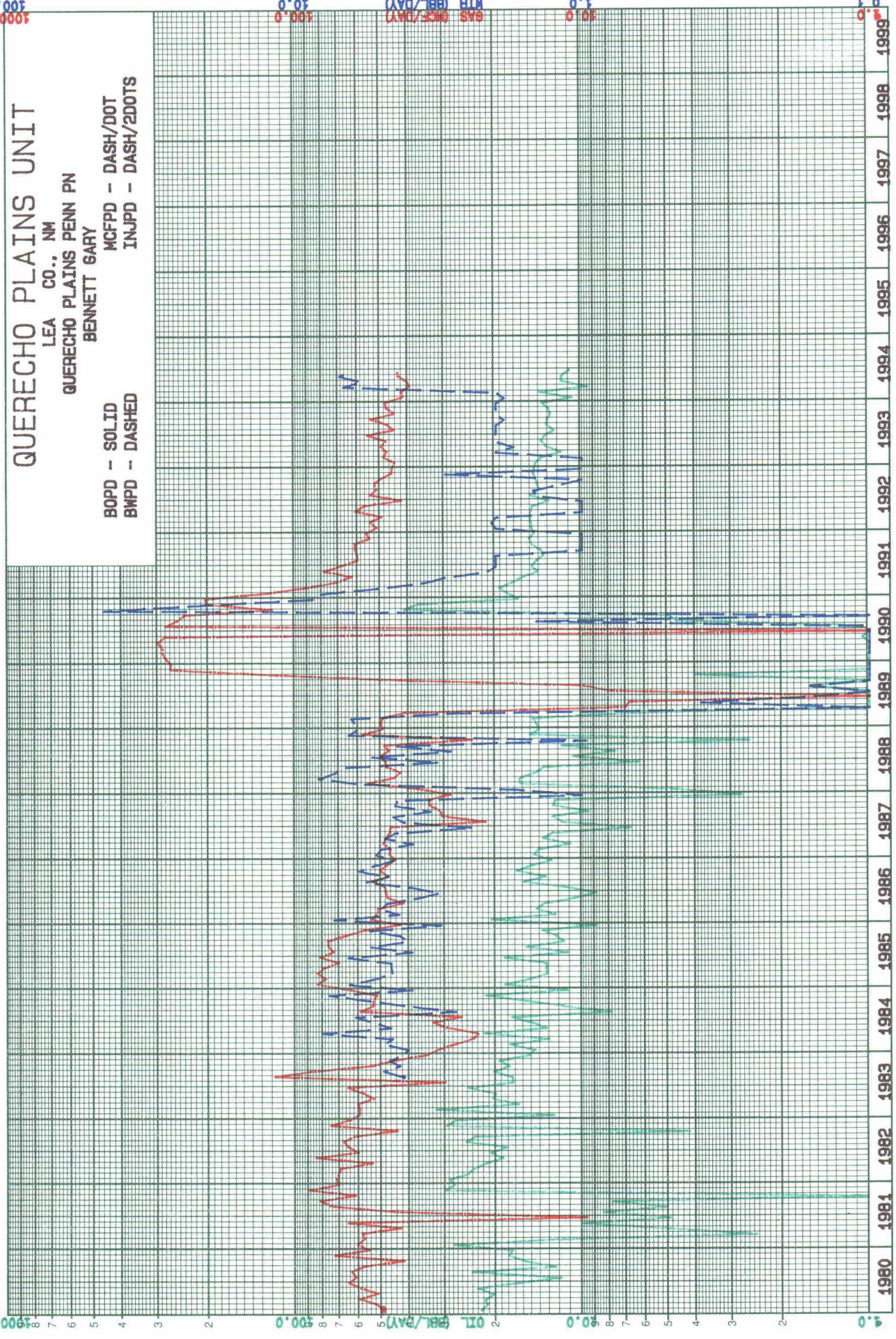

QUERRECHO PLAINS UNIT  
LEA CO., NM  
QUERRECHO PLAINS PENN PN  
BENNETT GARY

DATE: 08/15/94  
TIME: 11:21:02  
FILE: NMWELLS  
GET : 285

PRODUCTION DATA  
-----  
THROUGH 6/30/1994

PERIOD ENDING	DAYS PROD	OIL MB-----	OIL RATE B/D----	GAS MMF-----	GAS RATE MCF/D--	GCR (MCF/B)	WATER MB-----	WATER (PCT)	CUM. OIL MB-----	CUM. GAS MMF-----	CUM. WATER MB-----	FTP PSI----
PRIOR 1/80		472.227		757.666		1.604	0.000	0.0	472.227	757.666	0.000	
1/80	31	0.688	22.2	1.521	49.1	2.211	0.000	0.0	472.915	759.187	0.000	0
2/80	28	0.597	21.3	1.443	51.5	2.417	0.000	0.0	473.512	760.630	0.000	0
3/80	31	0.669	21.6	1.834	59.2	2.741	0.000	0.0	474.181	762.464	0.000	0
4/80	30	0.601	20.0	1.526	50.9	2.539	0.000	0.0	474.782	763.990	0.000	0
5/80	31	0.715	23.1	1.813	58.5	2.536	0.000	0.0	475.497	765.803	0.000	0
6/80	30	0.502	16.7	1.936	64.5	3.857	0.000	0.0	475.999	767.739	0.000	0
7/80	31	0.364	11.7	1.884	60.8	5.176	0.000	0.0	476.363	769.623	0.000	0
8/80	31	0.748	24.1	1.952	63.0	2.610	0.000	0.0	477.111	771.575	0.000	0
9/80	30	0.367	12.2	1.712	57.1	4.665	0.000	0.0	477.478	773.287	0.000	0
10/80	31	0.484	15.6	1.283	41.4	2.651	0.000	0.0	477.962	774.570	0.000	0
11/80	30	0.538	17.9	2.170	72.3	4.033	0.000	0.0	478.500	776.740	0.000	0
12/80	31	0.539	17.4	1.685	54.4	3.126	0.000	0.0	479.039	778.425	0.000	0
YR 80	365	6.812	18.7	20.759	56.9	3.047	0.000	0.0	479.039	778.425	0.000	
1/81	31	0.863	27.8	1.877	60.5	2.175	0.000	0.0	479.902	780.302	0.000	0
2/81	28	0.335	12.0	1.590	56.8	4.746	0.000	0.0	480.237	781.892	0.000	0
3/81	31	0.076	2.5	1.797	58.0	23.645	0.000	0.0	480.313	783.689	0.000	0
4/81	30	0.147	4.9	1.272	42.4	8.653	0.000	0.0	480.460	784.961	0.000	0
5/81	31	0.307	9.9	2.007	64.7	6.537	0.000	0.0	480.767	786.968	0.000	0
6/81	30	0.146	4.9	0.287	9.6	1.966	0.000	0.0	480.913	787.255	0.000	0
7/81	31	0.259	8.4	1.357	43.8	5.239	0.000	0.0	481.172	788.612	0.000	0
8/81	31	0.157	5.1	2.277	73.5	14.503	0.000	0.0	481.329	790.889	0.000	0
9/81	30	0.235	7.8	2.437	81.2	10.370	0.000	0.0	481.564	793.326	0.000	0
10/81	31	0.005	0.2	1.895	61.1	379.000	0.000	0.0	481.569	795.221	0.000	0
11/81	30	0.897	29.9	2.662	88.7	2.968	0.000	0.0	482.466	797.883	0.000	0
12/81	31	0.855	27.6	2.165	69.8	2.532	0.000	0.0	483.321	800.048	0.000	0
YR 81	365	4.282	11.7	21.623	59.2	5.050	0.000	0.0	483.321	800.048	0.000	
1/82	31	0.893	28.8	2.207	71.2	2.471	0.000	0.0	484.214	802.255	0.000	0
2/82	28	0.698	24.9	1.954	69.8	2.799	0.000	0.0	484.912	804.209	0.000	0
3/82	31	0.738	23.8	2.133	68.8	2.890	0.000	0.0	485.650	806.342	0.000	0
4/82	30	0.646	21.5	1.604	53.5	2.483	0.000	0.0	486.296	807.946	0.000	0
5/82	31	0.579	18.7	2.607	84.1	4.503	0.000	0.0	486.875	810.553	0.000	0
6/82	30	0.620	20.7	1.791	59.7	2.889	0.000	0.0	487.495	812.344	0.000	0
7/82	31	0.560	18.1	2.009	64.8	3.588	0.000	0.0	488.055	814.353	0.000	0
8/82	31	0.784	25.3	2.081	67.1	2.654	0.000	0.0	488.839	816.434	0.000	0

BEFORE THE  
OIL CONSERVATION DIVISION

Case No. 10996 Exhibit No. \_\_\_\_\_  
Submitted By:  
Anadarko Petroleum Corporation  
Hearing Date: August 18, 1994

QUERRECHO PLAINS UNIT  
LEA CO., NM  
QUERRECHO PLAINS PENN PN  
BENNETT GARY

DATE: 08/15/94  
TIME: 11:21:02  
FILE: NMWELLS  
GET : 285

PRODUCTION DATA

THROUGH 6/30/1994

PERIOD ENDING	DAYS PROD	OIL MB-----	OIL RATE B/D-----	GAS MMF-----	GAS RATE MCF/D--	GOR (MCF/B)	WATER MB-----	WATER (PCT)	CUM. OIL MB-----	CUM. GAS MMF-----	CUM. WATER MB-----	FTP PSI----
9/82	30	0.704	23.5	1.842	61.4	2.616	0.000	0.0	489.543	818.276	0.000	0
10/82	31	0.130	4.2	1.361	43.9	10.469	0.000	0.0	489.673	819.637	0.000	0
11/82	30	0.888	29.6	2.243	74.8	2.526	0.000	0.0	490.561	821.880	0.000	0
12/82	31	0.848	27.4	1.986	64.1	2.342	0.000	0.0	491.409	823.866	0.000	0
YR 82	365	8.088	22.2	23.818	65.3	2.945	0.000	0.0	491.409	823.866	0.000	
1/83	31	0.383	12.4	1.839	59.3	4.802	0.000	0.0	491.792	825.705	0.000	0
2/83	28	0.901	32.2	1.658	59.2	1.840	0.000	0.0	492.693	827.363	0.000	0
3/83	31	0.510	16.5	1.860	60.0	3.647	0.000	0.0	493.203	829.223	0.000	0
4/83	30	0.611	20.4	1.589	53.0	2.601	0.000	0.0	493.814	830.812	0.000	0
5/83	31	0.616	19.9	1.789	57.7	2.904	0.000	0.0	494.430	832.601	0.000	0
6/83	30	0.748	24.9	1.954	65.1	2.612	0.000	0.0	495.178	834.555	0.000	0
7/83	31	0.537	17.3	0.926	29.9	1.724	0.000	0.0	495.715	835.481	0.000	0
8/83	31	0.538	17.4	3.632	117.2	6.751	0.130	19.5	496.253	839.113	0.130	0
9/83	30	0.609	20.3	2.574	85.8	4.227	0.147	19.4	496.862	841.687	0.277	0
10/83	31	0.552	17.8	1.659	53.5	3.005	0.133	19.4	497.414	843.346	0.410	0
11/83	30	0.583	19.4	1.348	44.9	2.312	0.140	19.4	497.997	844.694	0.550	0
12/83	31	0.471	15.2	1.083	34.9	2.299	0.130	21.6	498.468	845.777	0.680	0
YR 83	365	7.059	19.3	21.911	60.0	3.104	0.680	8.8	498.468	845.777	0.680	
1/84	31	0.449	14.5	0.981	31.6	2.185	0.124	21.6	498.917	846.758	0.804	0
2/84	28	0.497	17.8	0.773	27.6	1.555	0.137	21.6	499.414	847.531	0.941	0
3/84	31	0.400	12.9	0.741	23.9	1.853	0.141	26.1	499.814	848.272	1.082	0
4/84	30	0.657	21.9	0.688	22.9	1.047	0.240	26.8	500.471	848.960	1.322	0
5/84	31	0.407	13.1	0.914	29.5	2.246	0.143	26.0	500.878	849.874	1.465	0
6/84	30	0.447	14.9	0.997	33.2	2.230	0.157	26.0	501.325	850.871	1.622	0
7/84	31	0.541	17.5	0.815	26.3	1.506	0.190	26.0	501.866	851.686	1.812	0
8/84	31	0.243	7.8	1.832	59.1	7.539	0.085	25.9	502.109	853.518	1.897	0
9/84	30	0.341	11.4	1.597	53.2	4.683	0.119	25.9	502.450	855.115	2.016	0
10/84	31	0.483	15.6	1.647	53.1	3.410	0.169	25.9	502.933	856.762	2.185	0
11/84	30	0.649	21.6	1.550	51.7	2.388	0.227	25.9	503.582	858.312	2.412	0
12/84	31	0.344	11.1	2.012	64.9	5.849	0.120	25.9	503.926	860.324	2.532	0
YR 84	365	5.458	15.0	14.547	39.9	2.665	1.852	25.3	503.926	860.324	2.532	
1/85	31	0.573	18.5	2.577	83.1	4.497	0.200	25.9	504.499	862.901	2.732	0
2/85	28	0.425	15.2	2.177	77.8	5.122	0.148	25.8	504.924	865.078	2.880	0
3/85	31	0.405	13.1	2.580	83.2	6.370	0.141	25.8	505.329	867.658	3.021	0
4/85	30	0.396	13.2	2.372	79.1	5.990	0.138	25.8	505.725	870.030	3.159	0

QUERRECHO PLAINS UNIT  
LEA CO., NM  
QUERRECHO PLAINS PENN PN  
BENNETT GARY

DATE: 08/15/94  
TIME: 11:21:02  
FILE: NMWELLS  
GET : 285

PRODUCTION DATA  
-----  
THROUGH 6/30/1994

PERIOD ENDING	DAYS PROD	OIL MB-----	OIL RATE B/D-----	GAS MMF-----	GAS RATE MCF/D--	GOR (MCF/B)	WATER MB-----	WATER (PCT)	CUM. OIL MB-----	CUM. GAS MMF-----	CUM. WATER MB-----	FTP PSI----
5/85	31	0.409	13.2	2.168	69.9	5.301	0.143	25.9	506.134	872.198	3.302	0
6/85	30	0.557	18.6	2.448	81.6	4.395	0.195	25.9	506.691	874.646	3.497	0
7/85	31	0.345	11.1	2.270	73.2	6.580	0.121	26.0	507.036	876.916	3.618	0
8/85	31	0.483	15.6	2.362	76.2	4.890	0.169	25.9	507.519	879.278	3.787	0
9/85	30	0.346	11.5	2.300	76.7	6.647	0.121	25.9	507.865	881.578	3.908	0
10/85	31	0.379	12.2	2.045	66.0	5.396	0.133	26.0	508.244	883.623	4.041	0
11/85	30	0.411	13.7	1.716	57.2	4.175	0.164	28.5	508.655	885.339	4.205	0
12/85	31	0.274	8.8	1.334	43.0	4.869	0.096	25.9	508.929	886.673	4.301	0
YR 85	365	5.003	13.7	26.349	72.2	5.267	1.769	26.1	508.929	886.673	4.301	
1/86	31	0.643	20.7	1.682	54.3	2.616	0.226	26.0	509.572	888.355	4.527	0
2/86	28	0.344	12.3	1.442	51.5	4.192	0.121	26.0	509.916	889.797	4.648	0
3/86	31	0.446	14.4	1.590	51.3	3.565	0.157	26.0	510.362	891.387	4.805	0
4/86	30	0.406	13.5	1.253	41.8	3.086	0.143	26.0	510.768	892.640	4.948	0
5/86	31	0.330	10.6	1.478	47.7	4.479	0.116	26.0	511.098	894.118	5.064	0
6/86	30	0.266	8.9	1.445	48.2	5.432	0.094	26.1	511.364	895.563	5.158	0
7/86	31	0.346	11.2	1.507	48.6	4.355	0.122	26.1	511.710	897.070	5.280	0
8/86	31	0.496	16.0	1.665	53.7	3.357	0.175	26.1	512.206	898.735	5.455	0
9/86	30	0.400	13.3	1.421	47.4	3.553	0.141	26.1	512.606	900.156	5.596	0
10/86	31	0.524	16.9	1.570	50.6	2.996	0.185	26.1	513.130	901.726	5.781	0
11/86	30	0.449	15.0	1.440	48.0	3.207	0.159	26.2	513.579	903.166	5.940	0
12/86	31	0.395	12.7	1.387	44.7	3.511	0.140	26.2	513.974	904.553	6.080	0
YR 86	365	5.045	13.8	17.880	49.0	3.544	1.779	26.1	513.974	904.553	6.080	
1/87	31	0.457	14.7	1.454	46.9	3.182	0.162	26.2	514.431	906.007	6.242	0
2/87	28	0.394	14.1	1.302	46.5	3.305	0.140	26.2	514.825	907.309	6.382	0
3/87	31	0.338	10.9	1.526	49.2	4.515	0.120	26.2	515.163	908.835	6.502	0
4/87	30	0.411	13.7	1.450	48.3	3.528	0.146	26.2	515.574	910.285	6.648	0
5/87	31	0.390	12.6	1.448	46.7	3.713	0.139	26.3	515.964	911.733	6.787	0
6/87	30	0.202	6.7	1.394	46.5	6.901	0.072	26.3	516.166	913.127	6.859	0
7/87	31	0.364	11.7	0.674	21.7	1.852	0.130	26.3	516.530	913.801	6.989	0
8/87	31	0.395	12.7	0.955	30.8	2.418	0.141	26.3	516.925	914.756	7.130	0
9/87	30	0.284	9.5	0.936	31.2	3.296	0.101	26.2	517.209	915.692	7.231	0
10/87	31	0.390	12.6	1.059	34.2	2.715	0.139	26.3	517.599	916.751	7.370	0
11/87	30	0.371	12.4	1.028	34.3	2.771	0.132	26.2	517.970	917.779	7.502	0
12/87	31	0.086	2.8	0.892	28.8	10.372	0.031	26.5	518.056	918.671	7.533	0
YR 87	365	4.082	11.2	14.118	38.7	3.459	1.453	26.3	518.056	918.671	7.533	

QUERRECHO PLAINS UNIT  
LEA CO., NM  
QUERRECHO PLAINS PENN PN  
BENNETT GARY

DATE: 08/15/94  
TIME: 11:21:02  
FILE: NMWELLS  
GET : 285

PRODUCTION DATA

THROUGH 6/30/1994

PERIOD ENDING	DAYS PROD	OIL MB-----	OIL RATE B/D-----	GAS MMF-----	GAS RATE MCF/D--	GOR (MCF/B)	WATER MB-----	WATER (PCT)	CUM. OIL MB-----	CUM. GAS MMF-----	CUM. WATER MB-----	FTP PSI----
1/88	31	0.147	4.7	1.158	37.4	7.878	0.053	26.5	518.203	919.829	7.586	0
2/88	28	0.459	16.4	1.564	55.9	3.407	0.165	26.4	518.662	921.393	7.751	0
3/88	31	0.511	16.5	1.401	45.2	2.742	0.256	33.4	519.173	922.794	8.007	0
4/88	30	0.434	14.5	1.287	42.9	2.965	0.217	33.3	519.607	924.081	8.224	0
5/88	31	0.421	13.6	1.484	47.9	3.525	0.211	33.4	520.028	925.565	8.435	0
6/88	30	0.189	6.3	1.454	48.5	7.693	0.095	33.5	520.217	927.019	8.530	0
7/88	31	0.335	10.8	1.568	50.6	4.681	0.168	33.4	520.552	928.587	8.698	0
8/88	31	0.237	7.6	1.459	47.1	6.156	0.089	27.3	520.789	930.046	8.787	0
9/88	30	0.354	11.8	1.470	49.0	4.153	0.133	27.3	521.143	931.516	8.920	0
10/88	31	0.081	2.6	0.750	24.2	9.259	0.030	27.0	521.224	932.266	8.950	0
11/88	30	0.457	15.2	1.745	58.2	3.818	0.195	29.9	521.681	934.011	9.145	0
12/88	31	0.438	14.1	1.532	49.4	3.498	0.187	29.9	522.119	935.543	9.332	0
YR 88	365	4.063	11.1	16.872	46.2	4.153	1.799	30.7	522.119	935.543	9.332	
1/89	31	0.445	14.4	1.557	50.2	3.499	0.190	29.9	522.564	937.100	9.522	0
2/89	28	0.416	14.9	1.385	49.5	3.329	0.178	30.0	522.980	938.485	9.700	0
3/89	31	0.206	6.6	1.292	41.7	6.272	0.088	29.9	523.186	939.777	9.788	0
4/89	30	0.000	0.0	0.213	7.1	0.000	0.000	0.0	523.186	939.990	9.788	0
5/89	31	0.027	0.9	0.213	6.9	7.889	0.012	30.8	523.213	940.203	9.800	0
6/89	30	0.012	0.4	0.000	0.0	0.000	0.005	29.4	523.225	940.203	9.805	0
7/89	31	0.000	0.0	0.246	7.9	0.000	0.000	0.0	523.225	940.449	9.805	0
8/89	31	0.050	1.6	0.306	9.9	6.120	0.005	9.1	523.275	940.755	9.810	0
9/89	30	0.000	0.0	1.283	42.8	0.000	0.000	0.0	523.275	942.038	9.810	0
10/89	31	0.125	4.0	3.755	121.1	30.040	0.000	0.0	523.400	945.793	9.810	0
11/89	30	0.000	0.0	8.164	272.1	0.000	0.000	0.0	523.400	953.957	9.810	0
12/89	31	0.000	0.0	8.401	271.0	0.000	0.000	0.0	523.400	962.358	9.810	0
YR 89	365	1.281	3.5	26.815	73.5	20.933	0.478	27.2	523.400	962.358	9.810	
1/90	31	0.000	0.0	8.735	281.8	0.000	0.000	0.0	523.400	971.093	9.810	0
2/90	28	0.000	0.0	8.080	288.6	0.000	0.000	0.0	523.400	979.173	9.810	0
3/90	31	0.000	0.0	8.945	288.5	0.000	0.000	0.0	523.400	988.118	9.810	0
4/90	30	0.030	1.0	9.072	302.4	302.400	0.000	0.0	523.430	997.190	9.810	0
5/90	31	0.033	1.1	8.770	282.9	265.758	0.000	0.0	523.463	1005.960	9.810	0
6/90	30	0.000	0.0	0.000	0.0	0.000	0.000	0.0	523.463	1005.960	9.810	0
7/90	31	0.033	1.1	8.777	283.1	265.970	0.000	0.0	523.496	1014.737	9.810	0
8/90	31	0.145	4.7	7.967	257.0	54.945	0.045	23.7	523.641	1022.704	9.855	0
9/90	30	0.153	5.1	7.271	242.4	47.523	0.000	0.0	523.794	1029.975	9.855	0
10/90	31	1.297	41.8	3.730	120.3	2.876	1.439	52.6	525.091	1033.705	11.294	0
11/90	30	1.121	37.4	6.112	203.7	5.452	0.640	36.3	526.212	1039.817	11.934	0

Anadarko take over  
abandons Marmon Reforale Marmon?

QUERRECHO PLAINS UNIT  
LEA CO., NM  
QUERRECHO PLAINS PENN PN  
BENNETT GARY

DATE: 08/15/94  
TIME: 11:21:02  
FILE: NMWELLS  
GET : 285

P R O D U C T I O N   D A T A

-----  
THROUGH 6/30/1994

PERIOD ENDING	DAYS PROD	OIL MB-----	OIL RATE B/D-----	GAS MMF-----	GAS RATE MCF/D--	GOR (MCF/B)	WATER MB-----	WATER (PCT)	CUM. OIL MB-----	CUM. GAS MMF-----	CUM. WATER MB-----	FTP PSI----
12/90	31	0.516	16.6	6.387	206.0	12.378	0.270	34.4	526.728	1046.204	12.204	0
YR 90	365	3.328	9.1	83.846	229.7	25.194	2.394	41.8	526.728	1046.204	12.204	
1/91	31	0.565	18.2	3.878	125.1	6.864	0.252	30.8	527.293	1050.082	12.456	0
2/91	28	0.547	19.5	2.567	91.7	4.693	0.146	21.1	527.840	1052.649	12.602	0
3/91	31	0.541	17.5	2.212	71.4	4.089	0.111	17.0	528.381	1054.861	12.713	0
4/91	30	0.482	16.1	1.900	63.3	3.942	0.090	15.7	528.863	1056.761	12.803	0
5/91	31	0.440	14.2	2.465	79.5	5.602	0.067	13.2	529.303	1059.226	12.870	0
6/91	30	0.451	15.0	2.070	69.0	4.590	0.060	11.7	529.754	1061.296	12.930	0
7/91	31	0.446	14.4	1.874	60.5	4.202	0.062	12.2	530.200	1063.170	12.992	0
8/91	31	0.423	13.6	1.883	60.7	4.452	0.062	12.8	530.623	1065.053	13.054	0
9/91	30	0.420	14.0	1.849	61.6	4.402	0.030	6.7	531.043	1066.902	13.084	0
10/91	31	0.465	15.0	1.921	62.0	4.131	0.031	6.3	531.508	1068.823	13.115	0
11/91	30	0.460	15.3	1.651	55.0	3.589	0.030	6.1	531.968	1070.474	13.145	0
12/91	31	0.456	14.7	1.754	56.6	3.846	0.031	6.4	532.424	1072.228	13.176	0
YR 91	365	5.696	15.6	26.024	71.3	4.569	0.972	14.6	532.424	1072.228	13.176	
1/92	31	0.466	15.0	1.610	51.9	3.455	0.062	11.7	532.890	1073.838	13.238	0
2/92	28	0.423	15.1	1.542	55.1	3.645	0.058	12.1	533.313	1075.380	13.296	0
3/92	31	0.472	15.2	1.543	49.8	3.269	0.062	11.6	533.785	1076.923	13.358	0
4/92	30	0.453	15.1	1.852	61.7	4.088	0.030	6.2	534.238	1078.775	13.388	0
5/92	31	0.463	14.9	1.783	57.5	3.851	0.031	6.3	534.701	1080.558	13.419	0
6/92	30	0.389	13.0	1.278	42.6	3.285	0.030	7.2	535.090	1081.836	13.449	0
7/92	31	0.475	15.3	1.703	54.9	3.585	0.045	8.7	535.565	1083.539	13.494	0
8/92	31	0.437	14.1	1.616	52.1	3.698	0.046	9.5	536.002	1085.155	13.540	0
9/92	30	0.428	14.3	1.600	53.3	3.738	0.036	7.8	536.430	1086.755	13.576	0
10/92	31	0.448	14.5	1.561	50.4	3.484	0.031	6.5	536.878	1088.316	13.607	0
11/92	30	0.443	14.8	1.385	46.2	3.126	0.090	16.9	537.321	1089.701	13.697	0
12/92	31	0.456	14.7	1.423	45.9	3.121	0.031	6.4	537.777	1091.124	13.728	0
YR 92	365	5.353	14.7	18.896	51.8	3.530	0.552	9.3	537.777	1091.124	13.728	
1/93	31	0.449	14.5	1.398	45.1	3.114	0.031	6.5	538.226	1092.522	13.759	0
2/93	28	0.389	13.9	1.381	49.3	3.550	0.028	6.7	538.615	1093.903	13.787	0
3/93	31	0.366	11.8	1.489	48.0	4.068	0.062	14.5	538.981	1095.392	13.849	0
4/93	30	0.400	13.3	1.507	50.2	3.768	0.052	11.5	539.381	1096.899	13.901	0
5/93	31	0.430	13.9	1.493	48.2	3.472	0.062	12.6	539.811	1098.392	13.963	0
6/93	30	0.404	13.5	1.682	56.1	4.163	0.060	12.9	540.215	1100.074	14.023	0
7/93	31	0.388	12.5	1.405	45.3	3.621	0.062	13.8	540.603	1101.479	14.085	0

QUERECHO PLAINS UNIT  
LEA CO., NM  
QUERECHO PLAINS PENN PN  
BENNETT GARY

DATE: 08/15/94  
TIME: 11:21:02  
FILE: NMWELLS  
GET : 285

P R O D U C T I O N   D A T A

-----  
THROUGH 6/30/1994

PERIOD ENDING	DAYS PROD	OIL MB-----	OIL RATE B/D-----	GAS MMF-----	GAS RATE MCF/D--	GOR (MCF/B)	WATER MB-----	WATER (PCT)	CUM. OIL MB-----	CUM. GAS MMF-----	CUM. WATER MB-----	FTP PSI---
8/93	31	0.412	13.3	1.483	47.8	3.600	0.062	13.1	541.015	1102.962	14.147	0
9/93	30	0.395	13.2	1.641	54.7	4.154	0.056	12.4	541.410	1104.603	14.203	0
10/93	31	0.399	12.9	1.394	45.0	3.494	0.062	13.4	541.809	1105.997	14.265	0
11/93	30	0.394	13.1	1.440	48.0	3.655	0.060	13.2	542.203	1107.437	14.325	0
12/93	31	0.428	13.8	1.512	48.8	3.533	0.062	12.7	542.631	1108.949	14.387	0
YR 93	365	4.854	13.3	17.825	48.8	3.672	0.659	12.0	542.631	1108.949	14.387	
1/94	31	0.334	10.8	1.301	42.0	3.895	0.058	14.8	542.965	1110.250	14.445	0
2/94	28	0.395	14.1	1.199	42.8	3.035	0.056	12.4	543.360	1111.449	14.501	0
3/94	31	0.296	9.5	1.240	40.0	4.189	0.210	41.5	543.656	1112.689	14.711	0
4/94	30	0.355	11.8	1.229	41.0	3.462	0.175	33.0	544.011	1113.918	14.886	0
5/94	31	0.365	11.8	1.369	44.2	3.751	0.217	37.3	544.376	1115.287	15.103	0
6/94	30	0.334	11.1	1.316	43.9	3.940	0.189	36.1	544.710	1116.603	15.292	0
YR 94	181	2.079	11.5	7.654	42.3	3.682	0.905	30.3	544.710	1116.603	15.292	
SUB TOTAL	5291	72.483	13.7	358.937	67.8	4.952	15.292	17.4	544.710	1116.603	15.292	
TOTAL		544.710		1116.603		2.050	15.292	2.7	544.710	1116.603	15.292	

ANADARKO PETROLEUM CORPORATION  
Daily Well Work Report Form

BEFORE THE  
OIL CONSERVATION DIVISION

Case No. 10996 Exhibit No. \_\_\_\_\_

Submitted By:

Anadarko Petroleum Corporation

Hearing Date: August 18, 1994

New Well ☐Conversion ☐Workover ☐

Flood No. Lease: Querecho Plains Unit Well No. 1  
1980' FWL & 1980' FSL, Sec. 22-T18S-R32E, Lea County, NM; No AFE  
Location: to plug back Morrow and put Strawn on pump.

## REPORT:

10/04/90 Rigged up Bennett Cathey and ran 2.31 gauge ring. Gauge ring stopped at 12,284' (on/off tool at 12,419'). Could not run blanking plug. Rigged down Bennett Cathey. Well quit selling gas when bomb ran.  
DC = \$1200 CC = \$1200

10/05/90 Well started selling gas again.

10/08/90 Flowing gas rate at 205 MCFPD up casing. Tbg pressure = 775#. Do not know when tbg valve got SI. Ran bottom hole bombs. Rigged up pulling unit. Prepare to pull. SD. DC = \$1100 CC = \$2300

10/09/90 Flowing gas rate up tbg at 197 MCFPD. Tbg pressure = 905#. Pulled bombs. Blew well down. Dumped 20 bbls 2% KCL down tbg & 40 bbls down casing. Removed tree and installed BOP. Attempted to unset pkr and could not. Off on/off tool to equalize fluid. Had to kill well again. Latched onto pkr and still could not unset. (Pulled 120,000# on tbg). Got off on/off tool and TOH. Had to kill well four more times while pulling tbg. SI BOP. SD. TOH with 395 jts 2½ tbg, 1 - 10' sub, and on/off tool retrieving head. Tbg tally shows on/off tool to be at 12,419'KB. (Strawn probably drinking fluid and letting Morrow flow in). BLWTR = 220. Have lots of bent tbg. (about 25 jts.)  
DC = \$5300 CC = \$7600

10/10/90 Well selling gas up casing at 162 MCFPD. Blew well down and killed. Hydro-tested to 6500# with 395 jts - 2-7/8" N-80 tbg with on/off tool retrieving head on bottom. Found 1 bad collar leak at 11,917' KB. Latched onto pkr and SD. Had to pump KCL water at ½ bbl/min to keep well dead while testing in hole. Pump 295 bbls. BLWTR = 515.  
DC = \$5600 CC = \$13200

10/11/90 Well selling gas up casing at 162 MCFPD. Tbg pressure = 450#. Set 2.25 FWG blanking plug in on/off tool at 12,419'KB (Wireline measurement = 12,426'KB). Blew tbg down and it quit flowing. Still selling gas up casing. Blew casing to air. It died down to approx. 170 MCFPD and held for one hour. Pkr leaking. Killed well and TOH with on/off tool head. SIH with 7" Baker Lock set pkr with K-valve (by-pass) and mechanical hold down SN on 2-7/8", N-80 tbg. SD for darkness. Pumped 280 bbls 2% KCL to keep well dead. BLWTR = 795.  
(NOTE: Ran in head; will not pull all the way in. Pkr drag blocks will catch. Pkr has to be turned just right to go in or out).  
DC = \$10900 CC = \$24100

10/12/90 Well selling gas at 174 MCFPD. Killed well. Set 7", 29# Baker Lock-set pkr with K-valve (by-pass) at 11,909'KB to be used as RBP. Got off pkr and TOH. Found out SN had been ran upside down. SIH with RBP retrieving tool, mechanical holddown SN and 7" tbg anchor on 2-7/8" tbg. SD for darkness. Used 370 bbls 2% KCL water to keep well dead. BLWTR = 1165.  
DC = \$3900 CC = \$28000

10/13/90 Well dead. Finish in hole. Removed BOP. Set SNOE at 11,704'KB on 372 jts, 2-7/8", N-80 tbg and 10' sub with tbg anchor set @ 11,453' with 15 points tension pulled into it (tbg anchor has 40,000# shear). Built up well head hookup. Start in hole with pump. SD for darkness.  
DC = \$37100 CC = \$65100

## PLUG BACK MORROW

## ANADARKO PETROLEUM CORPORATION

## Daily Well Work Report Form

New Well ☐ Conversion ☐ Workover ☐ Plugging ☐

Flood No. Lease: Querecho Plains Unit Well No. 1  
 1980' FWL & 1980' FSL, Sec. 22-T18S-R32E, Lea County, NM; No AFE  
 Location: to plug back Morrow and put Strawn on pump.

## REPORT:

10/14/90 Well dead. FIH with 2½"x1½"x34' RHBM pump, 2-7/8" sub, 26 K shear tool, 2-7/8" sub, 96 - 7/8" rods, 127 - 1" rods, 160 - 1½" fiberglass rods and 31' fiberglass rod subs on 1½" polish rod. Loaded tbg and pressured up to 400#. Held. Long stroked pump. Pumping good. Clamped off with pump 96" off bottom. Prepare for pumping unit (all steel rods are Type 90, & put rod guides on bottom-250' rods). Took 45 bbls to load tbg. DC = \$1000 CC = \$66100

10/15/90 RDP. Set American 640 unit (from Burleson). Put 8" sheave on motor and had 168" stroke. Started unit, but not enough unit weights to run. Very rod heavy. SD. DC = \$44800 CC = \$110900

10/16/90 Locating unit weights.

10/17/90 " " "

10/18/90 Put in pocket weights and shortened stroke to 144" with unit running 7.5 SPM with 1½" pump. Started unit at 2:30 pm (10/18/90). DC = \$2900 CC = \$113800

10/19/90 Pumped 17 BO & 112 BW for 19 hrs.

10/20/90 " 32 BO & 135 BW for 24 hrs.

10/21/90 " 50 BO & 143 BW for 24 hrs.

10/22/90 " 54 BO & 152 BW for 24 hrs.

10/23/90 " 70 BO & 118 BW for 24 hrs.

10/24/90 " 119 BO & 87 BW for 24 hrs.

10/25/90 " 124 BO & 85 BW for 24 hrs.

10/26/90 " 130 BO & 99 BW for 24 hrs.

10/27/90 " 103 BO & 98 BW for 24 hrs.

10/28/90 " 109 BO & 83 BW for 24 hrs.

10/29/90 " 102 BO & 88 BW for 24 hrs.

10/30/90 " 114 BO & 83 BW for 24 hrs.

10/31/90 " 124 BO & 82 BW for 24 hrs.

11/01/90 " 135 BO & 74 BW for 24 hrs.

11/02/90 " 134 BO & 69 BW for 24 hrs.

11/03/90 " 103 BO & 63 BW for 24 hrs.

11/04/90 " 103 BO & 60 BW for 24 hrs.

11/05/90 " 75 BO & 47 BW for 24 hrs.

11/06/90 " 61 BO & 36 BW for 24 hrs.

11/07/90 " 56 BO & 33 BW for 24 hrs.

11/08/90 " 49 BO & 24 BW for 18 hrs.

11/09/90 " 43 BO & 25 BW for 18 hrs.

FINAL REPORT

CO(2) DIV(2) AFE NO(4)/(4) LOCATION NO(7) DATE-MO/DAY/YR(6)  
03 90 / 11-15-93  
WORK DES(12) WELL LOCATION NAME(20) WELL NO(5) FIELD/PROSPECT(25) ST(5) ST CD(2)  
RECOMPLETION QUERCHO PLAINS UNIT 1 UNDESIGNATED MORROW NM 30  
EXPLAIN PROJECT FISH PACKER & REDRESS, PURCHASE & INSTALL 2-3/8 TUBING STRING  
O/S OPERATOR AFE# SECTION-TOWNSHIP-RANGE-DES OF LOC (23) COUNTY(13) CO CD(3)  
22 - 18S - 32E 1980 FS & WL LEA 025  
FIELD CD (3) PROJ CD (4) PROSP CD (3) BUDGET (3) AMOUNT AUTHORIZED (9)/(9)  
0000 000 313 \$ 55,500 /

OWNER NAME (24) WORKING INT(1.6) OWNER NAME (24) WORKING INT(1.6)  
OPER ANADARKO PETROLEUM CORP. .875000  
OTHER WORKING INTEREST OWNERS .125000  
COMPANY REVENUE INTEREST .701875

TYPE: PROJECT SUBJECT TO: ORIGINATING OFFICE MIDLAND  
DRILLING CONSTRUCTION CARRIED INTEREST PREPARED BY G. BUEHLER/ S. HATLEY  
EXPLORATION LHP NET PROFITS INTEREST  
DEVELOPMENT GEOPHYSICAL RIGHT TO CONVERT TO WI  
X RECOMPLETION FARMIN  
PLUG & ABANDON DHC or BHC  
SALE  
EXPLAIN: FOR DRILLING WELLS  
EST SPUD  
DATE EST TD  
TYPE WELL(OIL,GAS,ETC)  
DRILLING OBLG DATE  
EST DAYS TO DRILL  
EST DAYS TO COMPLETE  
ACRES (Spacing Unit) LSE EXP DATE  
LSE NOS IN UNIT

DRY HOLE COST-AFE			RETIREMENT COST		
TOTAL	JT OWNERS	CO NET	TOTAL	JT OWNERS	CO NET
IDC \$	\$	\$	REMOVALS \$	\$	\$
TDC			SALVAGE		
TOTALS \$	\$	\$	COST/		
			(RECOVER) \$	\$	\$
DHC/					
BHC (\$ ) (\$ ) (\$ )					
TOTALS \$	\$	\$	EXPLORATION AND OTHER PROJECTS COST		
			IDC \$ 24,700	\$ 3,100	\$ 21,600
			OTHER 38,700	4,800	33,900
			TOTAL \$ 63,400	\$ 7,900	\$ 55,500
COMPLETION COST - AFE			REMARKS: MORROW ZONE IS PERFORATED BUT TA'ED		
ICC \$	\$	\$	WITH BOTH A PACKER AND RBP PENDING THE		
TCC			FORMATION OF A 320 ACRE PRORATION UNIT.		
TOTALS \$	\$	\$			
CWC \$	\$	\$			

NEED TO ESTABLISH FIELD CODE, AND NEW LOCATION NUMBER.

APPROVAL LEVEL  
X MGR VP CHAIRMAN/CEO  
RECOMMENDED: DATE

MANAGEMENT ACTION  
AUTHORIZED REJECTED DATE:  
APPROVED: DATE

NON-OPERATOR APPROVAL

COMPANY Anadarko Petroleum Corporation  
TITLE  
Hearing Date: August 18, 1994

PROJECT ECONOMIC ASSUMPTIONS

RISKED ECONOMIC YARDSTICKS (AFIT)

CHANCE OF SUCCESS: EXPL % DEVEL %  
PRICES: \$/BBL; \$/MCF

THIS WELL		TOTAL PROSPECT	
Gross	Ri	Gross	Ri
RESERVES - OIL, MBbl			
GAS, MMCF			
EEB, MBbl			
BUDGET STATUS: ON BUDGET NEW PROJECT			
APC INVESTMENT-UNRISKED \$		RISKED \$	
ACREAGE COST (INCLUDING G & G)			

DCF RATE OF RETURN %  
PROFIT-TO-INVESTMENT RATIO  
UNDISCOUNTED  
DISCOUNTED  
PAYOUT YRS  
COST OF FINDING \$/NEEB

BY  
REMARKS:

AUTHORITY FOR EXPENDITURE

[illegible]

AFE CONSTRUCTION ESTIMATE 20

**BEFORE THE  
OIL CONSERVATION DIVISION**

Case No. 10996 Exhibit No. \_\_\_\_\_

Submitted By:

**Anadarko Petroleum Corporation**

Hearing Date: August 18, 1994

PAS:ing(queerecho2.wk3)

09-Dec-93

<b>ANADARKO PETROLEUM CORPORATION PARTICIPATING INTERESTS QUERECHO PLAINS UNIT #1 LEA COUNTY, NEW MEXICO W/2 SECTION 22, T18S, R32E</b>			
<b>WORKING INTEREST OWNERS</b>	<b>Tract Participation NENW</b>	<b>Tract WI</b>	<b>Participating WI</b>
Murjo Oil & Royalty - <i>Anadarko</i>	40/320	0.443750	0.055469
Debra J. Head	40/320	0.147917	0.018490
Demar J. Hopson	40/320	0.147917	0.018490
F. Kirk Johnson III	40/320	0.081354	0.010169
Ann H.J. McReynolds	40/320	0.066562	0.008320
C. Daniel Walker	40/320	0.062500	0.007813
C.W. Stumhoffer	40/320	0.050000	0.006250
		1.000000	0.125000
	<u>All except NENW</u>		
	280/320	1.000000	0.875000
Anadarko			
<b>TOTAL:</b>			1.000000

CERTIFIED - RETURN RECEIPT



January 5, 1994

Murjo Oil & Royalty  
Box 12666  
Fort Worth, TX 76116

BEFORE THE  
OIL CONSERVATION DIVISION  
Case No. 10996 Exhibit No. \_\_\_\_\_  
Submitted By:  
Anadarko Petroleum Corporation  
Hearing Date: August 18, 1994

RE: Recompletion Proposal  
Querecho Plains Unit #1  
1,980' FSL & 1,980' FWL  
Section 22, T18S, R32E  
Lea County, New Mexico

Ladies and Gentlemen:

Anadarko hereby proposes the recompletion of the above-referenced well in the Morrow formation from 12,530 to 12,644 feet. The well was originally drilled to a depth of 14,217 feet and was to be produced from the Morrow formation at the aforementioned depths. The flow test data reviewed by Anadarko indicated that the well was apparently capable of commercial production. However, the original operator, Gary L. Bennett, was denied approval of an irregular 360 acre proration unit by the NMOCD.

Subsequently, the Morrow formation was isolated by setting a packer at a depth of 12,400 feet and the well was placed on production from the Strawn formation which is now in decline. A schematic of the well bore is included for your reference.

It is Anadarko's intention to seek NMOCD approval for a 320 acre proration unit being the W/2 of Section 22 in which you own operating rights in the NE/4 NW/4. Therefore, Anadarko respectfully requests your support for the purchase of the well bore and participation in the recompletion. A Joint Operating Agreement and an AFE are enclosed for your review and approval.

In the event you do not wish to participate in the recompletion, Anadarko proposes the following alternative:

1. If the recompletion attempt is capable of commercial production, farmout all of your interest in the NE/4 NW/4 of Section 22, T18S, R32E from a depth of 11,746 to 14,317 feet below the earth's surface.

January 5, 1994  
Page Two

2. You will retain an overriding royalty interest equal to the difference, if any, between 17 1/2% and all existing lease burdens, delivering to Anadarko an 82 1/2% net revenue interest. Such overriding royalty interest shall be subject to proportionate reduction.
3. Upon acceptance of Anadarko's proposal, you agree to furnish at no cost to Anadarko copies of the lease and any appropriate title information, as well as a formal Farmout Agreement for our review and joint execution.

As Anadarko wishes to attempt the recompletion in the near future, your earliest response to this proposal would be appreciated. Should you require any further information, please contact me at (713) 876-8374.

Sincerely,

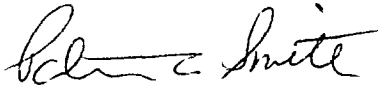

Patrick A. Smith  
Project Landman

PAS:jw  
RecmpQur

Encl.

cc: M. Dollarhide  
D. Kernaghan  
Querecho Plains North

CERTIFIED - RETURN RECEIPT



January 5, 1994

Debra Johnson Head  
1400 Ranking Highway, Ste. 28  
Midland, TX 79701

RE: Recompletion Proposal  
Querecho Plains Unit #1  
1,980' FSL & 1,980' FWL  
Section 22, T18S, R32E  
Lea County, New Mexico

Ladies and Gentlemen:

Anadarko hereby proposes the recompletion of the above-referenced well in the Morrow formation from 12,530 to 12,644 feet. The well was originally drilled to a depth of 14,217 feet and was to be produced from the Morrow formation at the aforementioned depths. The flow test data reviewed by Anadarko indicated that the well was apparently capable of commercial production. However, the original operator, Gary L. Bennett, was denied approval of an irregular 360 acre proration unit by the NMOCD.

Subsequently, the Morrow formation was isolated by setting a packer at a depth of 12,400 feet and the well was placed on production from the Strawn formation which is now in decline. A schematic of the well bore is included for your reference.

It is Anadarko's intention to seek NMOCD approval for a 320 acre proration unit being the W/2 of Section 22 in which you own operating rights in the NE/4 NW/4. Therefore, Anadarko respectfully requests your support for the purchase of the well bore and participation in the recompletion. A Joint Operating Agreement and an AFE are enclosed for your review and approval.

In the event you do not wish to participate in the recompletion, Anadarko proposes the following alternative:

1. If the recompletion attempt is capable of commercial production, farmout all of your interest in the NE/4 NW/4 of Section 22, T18S, R32E from a depth of 11,746 to 14,317 feet below the earth's surface.

January 5, 1994

Page Two

2. You will retain an overriding royalty interest equal to the difference, if any, between 17 1/2% and all existing lease burdens, delivering to Anadarko an 82 1/2% net revenue interest. Such overriding royalty interest shall be subject to proportionate reduction.
3. Upon acceptance of Anadarko's proposal, you agree to furnish at no cost to Anadarko copies of the lease and any appropriate title information, as well as a formal Farmout Agreement for our review and joint execution.

As Anadarko wishes to attempt the recompletion in the near future, your earliest response to this proposal would be appreciated. Should you require any further information, please contact me at (713) 876-8374.

Sincerely,

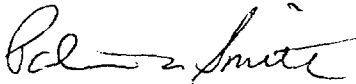

Patrick A. Smith  
Project Landman

PAS:jw  
RecmpQur

Encl.

cc: M. Dollarhide  
D. Kernaghan  
Querecho Plains North

CERTIFIED - RETURN RECEIPT



January 5, 1994

DeMar Johnson Hopson  
1400 Rankin Highway, Ste. 28  
Midland, TX 79701

RE: Recompletion Proposal  
Querecho Plains Unit #1  
1,980' FSL & 1,980' FWL  
Section 22, T18S, R32E  
Lea County, New Mexico

Ladies and Gentlemen:

Anadarko hereby proposes the recompletion of the above-referenced well in the Morrow formation from 12,530 to 12,644 feet. The well was originally drilled to a depth of 14,217 feet and was to be produced from the Morrow formation at the aforementioned depths. The flow test data reviewed by Anadarko indicated that the well was apparently capable of commercial production. However, the original operator, Gary L. Bennett, was denied approval of an irregular 360 acre proration unit by the NMOCD.

Subsequently, the Morrow formation was isolated by setting a packer at a depth of 12,400 feet and the well was placed on production from the Strawn formation which is now in decline. A schematic of the well bore is included for your reference.

It is Anadarko's intention to seek NMOCD approval for a 320 acre proration unit being the W/2 of Section 22 in which you own operating rights in the NE/4 NW/4. Therefore, Anadarko respectfully requests your support for the purchase of the well bore and participation in the recompletion. A Joint Operating Agreement and an AFE are enclosed for your review and approval.

In the event you do not wish to participate in the recompletion, Anadarko proposes the following alternative:

1. If the recompletion attempt is capable of commercial production, farmout all of your interest in the NE/4 NW/4 of Section 22, T18S, R32E from a depth of 11,746 to 14,317 feet below the earth's surface.

January 5, 1994

Page Two

2. You will retain an overriding royalty interest equal to the difference, if any, between 17 1/2% and all existing lease burdens, delivering to Anadarko an 82 1/2% net revenue interest. Such overriding royalty interest shall be subject to proportionate reduction.
3. Upon acceptance of Anadarko's proposal, you agree to furnish at no cost to Anadarko copies of the lease and any appropriate title information, as well as a formal Farmout Agreement for our review and joint execution.

As Anadarko wishes to attempt the recompletion in the near future, your earliest response to this proposal would be appreciated. Should you require any further information, please contact me at (713) 876-8374.

Sincerely,

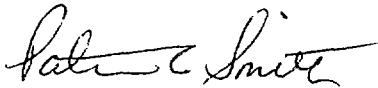

Patrick A. Smith  
Project Landman

PAS:jw  
RecmpQur

Encl.

cc: M. Dollarhide  
D. Kernaghan  
Querecho Plains North

CERTIFIED - RETURN RECEIPT



January 5, 1994

F. Kirk Johnson, III  
1832 Hilcrest  
Fort Worth, TX 76107

RE: Recompletion Proposal  
Querecho Plains Unit #1  
1,980' FSL & 1,980' FWL  
Section 22, T18S, R32E  
Lea County, New Mexico

Ladies and Gentlemen:

Anadarko hereby proposes the recompletion of the above-referenced well in the Morrow formation from 12,530 to 12,644 feet. The well was originally drilled to a depth of 14,217 feet and was to be produced from the Morrow formation at the aforementioned depths. The flow test data reviewed by Anadarko indicated that the well was apparently capable of commercial production. However, the original operator, Gary L. Bennett, was denied approval of an irregular 360 acre proration unit by the NMOCD.

Subsequently, the Morrow formation was isolated by setting a packer at a depth of 12,400 feet and the well was placed on production from the Strawn formation which is now in decline. A schematic of the well bore is included for your reference.

It is Anadarko's intention to seek NMOCD approval for a 320 acre proration unit being the W/2 of Section 22 in which you own operating rights in the NE/4 NW/4. Therefore, Anadarko respectfully requests your support for the purchase of the well bore and participation in the recompletion. A Joint Operating Agreement and an AFE are enclosed for your review and approval.

In the event you do not wish to participate in the recompletion, Anadarko proposes the following alternative:

1. If the recompletion attempt is capable of commercial production, farmout all of your interest in the NE/4 NW/4 of Section 22, T18S, R32E from a depth of 11,746 to 14,317 feet below the earth's surface.

January 5, 1994

Page Two

2. You will retain an overriding royalty interest equal to the difference, if any, between 17 1/2% and all existing lease burdens, delivering to Anadarko an 82 1/2% net revenue interest. Such overriding royalty interest shall be subject to proportionate reduction.
3. Upon acceptance of Anadarko's proposal, you agree to furnish at no cost to Anadarko copies of the lease and any appropriate title information, as well as a formal Farmout Agreement for our review and joint execution.

As Anadarko wishes to attempt the recompletion in the near future, your earliest response to this proposal would be appreciated. Should you require any further information, please contact me at (713) 876-8374.

Sincerely,



Patrick A. Smith  
Project Landman

PAS:jw  
RecmpQur

Encl.

cc: M. Dollarhide  
D. Kernaghan  
Querecho Plains North

CERTIFIED - RETURN RECEIPT



January 5, 1994

Ann H. Johnson McReynolds  
Managing Conservator for F. Kirk  
Johnson, IV and Marsland Holt Johnson  
c/o John W. McReynolds  
Thirty-Two Hundred, 2001 Bryan Tr.  
Dallas, TX 75201

RE: Recompletion Proposal  
Querecho Plains Unit #1  
1,980' FSL & 1,980' FWL  
Section 22, T18S, R32E  
Lea County, New Mexico

Ladies and Gentlemen:

Anadarko hereby proposes the recompletion of the above-referenced well in the Morrow formation from 12,530 to 12,644 feet. The well was originally drilled to a depth of 14,217 feet and was to be produced from the Morrow formation at the aforementioned depths. The flow test data reviewed by Anadarko indicated that the well was apparently capable of commercial production. However, the original operator, Gary L. Bennett, was denied approval of an irregular 360 acre proration unit by the NMOCD.

Subsequently, the Morrow formation was isolated by setting a packer at a depth of 12,400 feet and the well was placed on production from the Strawn formation which is now in decline. A schematic of the well bore is included for your reference.

It is Anadarko's intention to seek NMOCD approval for a 320 acre proration unit being the W/2 of Section 22 in which you own operating rights in the NE/4 NW/4. Therefore, Anadarko respectfully requests your support for the purchase of the well bore and participation in the recompletion. A Joint Operating Agreement and an AFE are enclosed for your review and approval.

In the event you do not wish to participate in the recompletion, Anadarko proposes the following alternative:

1. If the recompletion attempt is capable of commercial production, farmout all of your interest in the NE/4 NW/4 of Section 22, T18S, R32E from a depth of 11,746 to 14,317 feet below the earth's surface.

January 5, 1994

Page Two

2. You will retain an overriding royalty interest equal to the difference, if any, between 17 1/2% and all existing lease burdens, delivering to Anadarko an 82 1/2% net revenue interest. Such overriding royalty interest shall be subject to proportionate reduction.
3. Upon acceptance of Anadarko's proposal, you agree to furnish at no cost to Anadarko copies of the lease and any appropriate title information, as well as a formal Farmout Agreement for our review and joint execution.

As Anadarko wishes to attempt the recompletion in the near future, your earliest response to this proposal would be appreciated. Should you require any further information, please contact me at (713) 876-8374.

Sincerely,

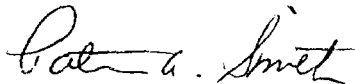

Patrick A. Smith  
Project Landman

PAS:jw  
RecmpQur

Encl.

cc: M. Dollarhide  
D. Kernaghan  
Querecho Plains North

CERTIFIED - RETURN RECEIPT



January 5, 1994

C. Daniel Walker  
6729 Grants Lane  
Fort Worth, TX 76116

RE: Recompletion Proposal  
Querecho Plains Unit #1  
1,980' FSL & 1,980' FWL  
Section 22, T18S, R32E  
Lea County, New Mexico

Ladies and Gentlemen:

Anadarko hereby proposes the recompletion of the above-referenced well in the Morrow formation from 12,530 to 12,644 feet. The well was originally drilled to a depth of 14,217 feet and was to be produced from the Morrow formation at the aforementioned depths. The flow test data reviewed by Anadarko indicated that the well was apparently capable of commercial production. However, the original operator, Gary L. Bennett, was denied approval of an irregular 360 acre proration unit by the NMOCD.

Subsequently, the Morrow formation was isolated by setting a packer at a depth of 12,400 feet and the well was placed on production from the Strawn formation which is now in decline. A schematic of the well bore is included for your reference.

It is Anadarko's intention to seek NMOCD approval for a 320 acre proration unit being the W/2 of Section 22 in which you own operating rights in the NE/4 NW/4. Therefore, Anadarko respectfully requests your support for the purchase of the well bore and participation in the recompletion. A Joint Operating Agreement and an AFE are enclosed for your review and approval.

In the event you do not wish to participate in the recompletion, Anadarko proposes the following alternative:

1. If the recompletion attempt is capable of commercial production, farmout all of your interest in the NE/4 NW/4 of Section 22, T18S, R32E from a depth of 11,746 to 14,317 feet below the earth's surface.

January 5, 1994  
Page Two

2. You will retain an overriding royalty interest equal to the difference, if any, between 17 1/2% and all existing lease burdens, delivering to Anadarko an 82 1/2% net revenue interest. Such overriding royalty interest shall be subject to proportionate reduction.
3. Upon acceptance of Anadarko's proposal, you agree to furnish at no cost to Anadarko copies of the lease and any appropriate title information, as well as a formal Farmout Agreement for our review and joint execution.

As Anadarko wishes to attempt the recompletion in the near future, your earliest response to this proposal would be appreciated. Should you require any further information, please contact me at (713) 876-8374.

Sincerely,

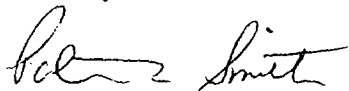

Patrick A. Smith  
Project Landman

PAS:jw  
RecmpQur

Encl.

cc: M. Dollarhide  
D. Kernaghan  
Querecho Plains North

CERTIFIED - RETURN RECEIPT



January 5, 1994

C. W. Stumhoffer  
1007 Ridglea Bank Bldg.  
Fort Worth, TX 76116

RE: Recompletion Proposal  
Querecho Plains Unit #1  
1,980' FSL & 1,980' FWL  
Section 22, T18S, R32E  
Lea County, New Mexico

Ladies and Gentlemen:

Anadarko hereby proposes the recompletion of the above-referenced well in the Morrow formation from 12,530 to 12,644 feet. The well was originally drilled to a depth of 14,217 feet and was to be produced from the Morrow formation at the aforementioned depths. The flow test data reviewed by Anadarko indicated that the well was apparently capable of commercial production. However, the original operator, Gary L. Bennett, was denied approval of an irregular 360 acre proration unit by the NMOCD.

Subsequently, the Morrow formation was isolated by setting a packer at a depth of 12,400 feet and the well was placed on production from the Strawn formation which is now in decline. A schematic of the well bore is included for your reference.

It is Anadarko's intention to seek NMOCD approval for a 320 acre proration unit being the W/2 of Section 22 in which you own operating rights in the NE/4 NW/4. Therefore, Anadarko respectfully requests your support for the purchase of the well bore and participation in the recompletion. A Joint Operating Agreement and an AFE are enclosed for your review and approval.

In the event you do not wish to participate in the recompletion, Anadarko proposes the following alternative:

1. If the recompletion attempt is capable of commercial production, farmout all of your interest in the NE/4 NW/4 of Section 22, T18S, R32E from a depth of 11,746 to 14,317 feet below the earth's surface.

January 5, 1994

Page Two

2. You will retain an overriding royalty interest equal to the difference, if any, between 17 1/2% and all existing lease burdens, delivering to Anadarko an 82 1/2% net revenue interest. Such overriding royalty interest shall be subject to proportionate reduction.
3. Upon acceptance of Anadarko's proposal, you agree to furnish at no cost to Anadarko copies of the lease and any appropriate title information, as well as a formal Farmout Agreement for our review and joint execution.

As Anadarko wishes to attempt the recompletion in the near future, your earliest response to this proposal would be appreciated. Should you require any further information, please contact me at (713) 876-8374.

Sincerely,

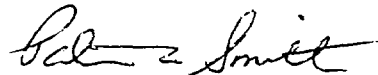

Patrick A. Smith  
Project Landman

PAS:jw  
ReempQur

Encl.

cc: M. Dollarhide  
D. Kernaghan  
Querecho Plains North

**NAME AND ADDRESS OF SENDER**

ANADARKO PETROLEUM CORPORATION  
P.O. BOX 1330 ATTN: JANICE WOODERSON  
HOUSTON, TX 77251

Indicate type of mail:  
☐ Registered Mail  
☐ Insured  
☐ COD  
☒ Certified ☐ Express Mail

Check appropriate block for Registered Mail:  
☐ With Postal Insurance  
☐ Without Postal Insurance

Affix stamp here if issued as certificate of mailing or for additional copies of this bill.

POSTMARK AND DATE OF RECEIPT

Line	Number of Article	Name of Addressee, Street, and Post-Office Address	Postage	Fee	Handling Charge	Act. Value (if Regis.)	Insured Value	Due Sender If C.O.D.	R. R. Fee	S. D. Fee	S. H. Fee	Rest. Del. Fee	Remarks
1	P 909 403 284	F. KIRK JOHNSON, III 1832 HILCREST	1.00					1.00					
2	P 909 403 283	FORT WORTH, TX 76107 DEMAR JOHNSON HOPSON											
3		1400 RANKIN HIGHWAY, STE. 28 MIDLAND, TX 79701											
4	P 909 403 282	DEBRA JOHNSON HEAD 1400 RANKIN HIGHWAY, STE. 28 MIDLAND, TX 79701											
5	P 909 403 281	MURJO OIL & ROYALTY BOX 12666 FORT WORTH, TX 76116											
6		C. W. STUMHOFFER 1007 RIDGLEA BANK BLDG. FORT WORTH, TX 76116											
7	P 909 403 280	C. DANIEL WALKER 6729 GRANTS LANE FORT WORTH, TX 76116											
8	P 909 403 279	JOHN W. MC REYNOLDS THIRTY-TWO HUNDRED, 2001 BRYAN DALLAS, TX 75201											
9	P 909 403 278												
10													
11													
12													
13													
14													
15													

BEFORE THE  
OIL CONSERVATION DIVISION  
Exhibit No. \_\_\_\_\_

Submitted By: \_\_\_\_\_  
Case No. 10996  
Anadarko Petroleum Corporation  
Hearing Date: August 18, 1994

POSTMASTER, PER (Name of receiving employee)

Total Number of Pieces Received at Post Office

Total number of Pieces Listed by Sender

The full declaration of value is required on all domestic and international registered mail. The maximum indemnity payable for nonnegotiable documents under Express Mail document reconstruction insurance is \$50,000 per piece subject to a limit of \$500,000 per occurrence. The maximum indemnity payable on Express Mail merchandise insurance is \$500. The maximum indemnity payable is \$25,000 for Registered Mail, \$500 for COD and \$500 for Insured Mail. Special handling charges apply only to Third- and Fourth-Class parcels.

FORM MUST BE COMPLETED BY TYPEWRITER, INK OR BALL POINT PEN

Is your RETURN ADDRESS completed on the reverse side?

**SENDER:**

- Complete items 1 and/or 2 for additional services.
- Complete items 3, and 4a & b.
- Print your name and address on the reverse of this form so that we can return this card to you.
- Attach this form to the front of the mailpiece, or on the back if space does not permit.
- Write "Return Receipt Requested" on the mailpiece below the article number.
- The Return Receipt will show to whom the article was delivered and the date delivered. PS QRCHO

I also wish to receive the following services (for an extra fee):

- ☐ Addressee's Address
  - ☐ Restricted Delivery
- Consult postmaster for fee.

3. Article Addressed to:

F. KIRK JOHNSON, III  
1832 HILCREST  
FORT WORTH, TX 76107

4a. Article Number

P 909 403 284

4b. Service Type

- ☐ Registered ☐ Insured  
☒ Certified ☐ COD  
☐ Express Mail ☒ Return Receipt for Merchandise

7. Date of Delivery

FEB 4 1994

5. Signature (Addressee)

6. Signature (Agent)

8. Addressee's Address (Only if requested and fee is paid)

PS Form 3811, December 1991 ☆ U.S.G.P.O.: 1992-307-530

**DOMESTIC RETURN RECEIPT**

Thank you for using Return Receipt Service.

Is your RETURN ADDRESS completed on the reverse side?

**SENDER:**

- Complete items 1 and/or 2 for additional services.
- Complete items 3, and 4a & b.
- Print your name and address on the reverse of this form so that we can return this card to you.
- Attach this form to the front of the mailpiece, or on the back if space does not permit.
- Write "Return Receipt Requested" on the mailpiece below the article number.
- The Return Receipt will show to whom the article was delivered and the date delivered. PS QRCHO

I also wish to receive the following services (for an extra fee):

- ☐ Addressee's Address
  - ☐ Restricted Delivery
- Consult postmaster for fee.

3. Article Addressed to:

C. DANIEL WALKER  
6729 GRANTS LANE  
FORT WORTH, TX 76116

4a. Article Number

P 909 403 279

4b. Service Type

- ☐ Registered ☐ Insured  
☒ Certified ☐ COD  
☐ Express Mail ☒ Return Receipt for Merchandise

7. Date of Delivery

1-27-94

5. Signature (Addressee)

6. Signature (Agent)

8. Addressee's Address (Only if requested and fee is paid)

PS Form 3811, December 1991 ☆ U.S.G.P.O.: 1992-307-530

**DOMESTIC RETURN RECEIPT**

Thank you for using Return Receipt Service.

Is your RETURN ADDRESS completed on the reverse side?

**SENDER:**

- Complete items 1 and/or 2 for additional services.
- Complete items 3, and 4a & b.
- Print your name and address on the reverse of this form so that we can return this card to you.
- Attach this form to the front of the mailpiece, or on the back if space does not permit.
- Write "Return Receipt Requested" on the mailpiece below the article number.
- The Return Receipt will show to whom the article was delivered and the date delivered. PS QRCHO

I also wish to receive the following services (for an extra fee):

- ☐ Addressee's Address
  - ☐ Restricted Delivery
- Consult postmaster for fee.

3. Article Addressed to:

MURJO OIL & ROYALTY  
BOX 12666 121818  
FORT WORTH, TX 76116  
76121

4a. Article Number

P 909 403 281

4b. Service Type

- ☐ Registered ☐ Insured  
☒ Certified ☐ COD  
☐ Express Mail ☒ Return Receipt for Merchandise

7. Date of Delivery

1-25-94

5. Signature (Addressee)

6. Signature (Agent)

8. Addressee's Address (Only if requested and fee is paid)

ILLEGIBLE

PS Form 3811, December 1991 ☆ U.S.G.P.O.: 1992-307-530

**DOMESTIC RETURN RECEIPT**

Thank you for using Return Receipt Service.

37

Is your RETURN ADDRESS completed on the reverse side?

**SENDER:**

- Complete items 1 and/or 2 for additional services.
- Complete items 3, and 4a & b.
- Print your name and address on the reverse of this form so that we can return this card to you.
- Attach this form to the front of the mailpiece, or on the back if space does not permit.
- Write "Return Receipt Requested" on the mailpiece below the article number.
- The Return Receipt will show to whom the article was delivered and the date delivered.

PS QRCHO

3. Article Addressed to:

JOHN W. MCREYNOLDS  
THIRTY-TWO HUNDRED, 2001 BRYAN T  
DALLAS, TX 75201

4a. Article Number  
P 909 403 278

4b. Service Type  
☒ Registered ☐ Insured  
☒ Certified ☐ COD  
☐ Express Mail ☒ Return Receipt for Merchandise

7. Date of Delivery  
1-24-94

5. Signature (Addressee)  
*[Signature]*

6. Signature (Agent)  
*[Signature]*

8. Addressee's Address (Only if requested and fee is paid)

I also wish to receive the following services (for an extra fee):

1. ☐ Addressee's Address

2. ☐ Restricted Delivery

Consult postmaster for fee.

PS Form 3811, December 1991 ☆ U.S.G.P.O.: 1992-307-530 **DOMESTIC RETURN RECEIPT**

Thank you for using Return Receipt Service.

Is your RETURN ADDRESS completed on the reverse side?

**SENDER:**

- Complete items 1 and/or 2 for additional services.
- Complete items 3, and 4a & b.
- Print your name and address on the reverse of this form so that we can return this card to you.
- Attach this form to the front of the mailpiece, or on the back if space does not permit.
- Write "Return Receipt Requested" on the mailpiece below the article number.
- The Return Receipt will show to whom the article was delivered and the date delivered.

PS QRCHO

3. Article Addressed to:

C. W. STUMHOFFER  
1007 RIDGLEA BANK BLDG.  
FORT WORTH, TX 76116

4a. Article Number  
P 909 403 280

4b. Service Type  
☐ Registered ☐ Insured  
☒ Certified ☐ COD  
☐ Express Mail ☒ Return Receipt for Merchandise

7. Date of Delivery  
12-31-94

5. Signature (Addressee)

6. Signature (Agent)  
*C. W. Stumhoffer*

8. Addressee's Address (Only if requested and fee is paid)

I also wish to receive the following services (for an extra fee):

1. ☐ Addressee's Address

2. ☐ Restricted Delivery

Consult postmaster for fee.

PS Form 3811, December 1991 ☆ U.S.G.P.O.: 1992-307-530 **DOMESTIC RETURN RECEIPT**

Thank you for using Return Receipt Service.

ILLEGIBLE

Is your RETURN ADDRESS completed on the reverse side?

**SENDER:**

- Complete items 1 and/or 2 for additional services.
- Complete items 3, and 4a & b.
- Print your name and address on the reverse of this form so that we can return this card to you.
- Attach this form to the front of the mailpiece, or on the back if space does not permit.
- Write "Return Receipt Requested" on the mailpiece below the article number.
- The Return Receipt will show to whom the article was delivered and the date delivered. PS QRCHO

I also wish to receive the following services (for an extra fee):

1. ☐ Addressee's Address
2. ☐ Restricted Delivery

Consult postmaster for fee.

3. Article Addressed to:

DEMAR JOHNSON HOPSON  
1400 RANKIN HIGHWAY, STE. 28  
MIDLAND, TX 79701

4a. Article Number

P 909 403 283

4b. Service Type

- ☐ Registered ☐ Insured  
☒ Certified ☐ COD  
☐ Express Mail ☒ Return Receipt for Merchandise

7. Date of Delivery

11 24

5. Signature (Addressee)

*B. Wallace*

6. Signature (Agent)

8. Addressee's Address (Only if requested and fee is paid)

PS Form 3811, December 1991 ☆ U.S.G.P.O.: 1992-307-530

**DOMESTIC RETURN RECEIPT**

Thank you for using Return Receipt Service.

Is your RETURN ADDRESS completed on the reverse side?

**SENDER:**

- Complete items 1 and/or 2 for additional services.
- Complete items 3, and 4a & b.
- Print your name and address on the reverse of this form so that we can return this card to you.
- Attach this form to the front of the mailpiece, or on the back if space does not permit.
- Write "Return Receipt Requested" on the mailpiece below the article number.
- The Return Receipt will show to whom the article was delivered and the date delivered. PS QRCHO

I also wish to receive the following services (for an extra fee):

1. ☐ Addressee's Address
2. ☐ Restricted Delivery

Consult postmaster for fee.

3. Article Addressed to:

DEBRA JOHNSON HEAD  
1400 RANKIN HIGHWAY, STE. 28  
MIDLAND, TX 79701

4a. Article Number

P 909, 403 282

4b. Service Type

- ☐ Registered ☐ Insured  
☒ Certified ☐ COD  
☐ Express Mail ☒ Return Receipt for Merchandise

7. Date of Delivery

11 24

5. Signature (Addressee)

*B. Wallace*

6. Signature (Agent)

8. Addressee's Address (Only if requested and fee is paid)

PS Form 3811, December 1991 ☆ U.S.G.P.O.: 1992-307-530

**DOMESTIC RETURN RECEIPT**

Thank you for using Return Receipt Service.

ILLEGIBLE

STATE OF NEW MEXICO  
ENERGY, MINERALS AND NATURAL RESOURCES DEPARTMENT  
OIL CONSERVATION DIVISION

EX #2

IN THE MATTER OF THE HEARING CALLED  
BY THE OIL CONSERVATION DIVISION  
FOR THE PURPOSE OF CONSIDERING:

CASE NO. 10996

Application of Anadarko Petroleum  
Corporation for Compulsory Pooling;  
Querecho Plains Unit Well No.1, W/2  
Section 22, T18S, R32E, NMPM, Lea  
County, New Mexico.

CERTIFICATE OF MAILING  
AND  
COMPLIANCE WITH ORDER R-8054

W. THOMAS KELLAHIN, attorney in fact and authorized representative of Anadarko Petroleum Corporation, states that the notice provisions of Division Rule 1207 (Order R-8054) have been complied with, that Applicant has caused to be conducted a good faith diligent effort to find the correct addresses of all interested parties entitled to receive notice, that on the 17th day of May 1994 and the 6th of June, 1994 I caused to be sent, by certified mail return receipt requested, notice of this hearing and a copy of the application for the referenced case along with the cover letter, at least twenty days prior to the hearing set for August 18th, 1994, to the parties shown in the application as evidenced by the attached copies of receipt cards, and that pursuant to Division Rule 1207, notice has been given at the correct addresses provided by such rule.

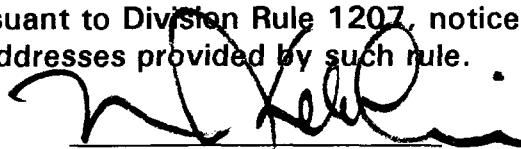

W. Thomas Kellahin

SUBSCRIBED AND SWORN to before me on this 17th day of August 1994.

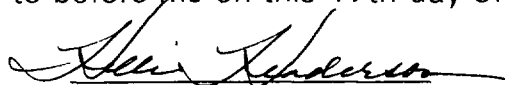

Notary Public

My Commission Expires: June 15th, 1998

EXHIBIT "A"  
ANADARKO COMPULSORY POOLING  
APPLICATION

Murjo Oil and Royalty Box 12666 Fort Worth, Texas 76116	0.055469
Debra Johnson Head 1400 Rankin Highway, Suite 28 Midland, Texas 79701	0.018490
Demar Johnson Hopson 1400 Rankin Highway, Suite 28 Midland, Texas 79701	0.018490
F. Kirk Johnson III 1832 Hilcrest Fort Worth, Texas 76107	0.010169
Ann H. Johnson McReynolds Managing Conservator for F. Kirk Johnson IV and Marsland Holt Johnson c/o John W. McReynolds 2001 Byran Tower Dallas, Texas 75201	0.008320
C. Daniel Walker 6729 Grants Lane Fort Worth, Texas 76116	0.007813
C.W. Stumhoffer 1007 Ridglea Bank Bldg. Fort Worth, Texas 76116	0.006250

---

Is your RETURN ADDRESS completed on the reverse side?

**SENDER:**

- Complete items 1 and/or 2 for additional services.
- Complete items 3, and 4a & b.
- Print return to June 6, 1994
- Attach this form to the front of the mailpiece, or on the back if space does not permit.
- Write "Return Receipt Requested" on the mailpiece below the article number.
- The Return Receipt will show to whom the article was delivered and the date delivered.

3. Article Addressed to:

C.W. STUMHOFFER  
P.O. BOX 100416  
FORT WORTH, TEXAS  
76185-0416

5. Signature (Addressee)

6. Signature (Agent)

4a. Article Number

P 206 001 981

4b. Service Type

- ☒ Registered ☐ Insured  
☐ Certified ☐ COD  
☐ Express Mail ☒ Return Receipt for Merchandise

7. Date of Delivery

6/6/94

8. Addressee's Address (Only if requested and fee is paid)

I also wish to receive the following services (for an extra fee):

1. ☐ Addressee's Address  
 2. ☐ Restricted Delivery

Consult postmaster for fee.

PS Form 3811, December 1991

\*U.S. GPO: 1993-352-714

**DOMESTIC RETURN RECEIPT**

Thank you for using Return Receipt Service.

Is your RETURN ADDRESS completed on the reverse side?

**SENDER:**

- Complete items 1 and/or 2 for additional services.
- Complete items 3, and 4a & b.
- The Return Receipt will show to whom the article was delivered and the date delivered.

3. Article Addressed to:

C. DANIEL WALKER  
6729 GRANTS LANE  
FORT WORTH, TEXAS 76116

5. Signature (Addressee)

6. Signature (Agent)

4a. Article Number

206 002 262

4b. Service Type

- ☒ Registered ☐ Insured  
☐ Certified ☐ COD  
☐ Express Mail ☒ Return Receipt for Merchandise

7. Date of Delivery

5 23 94

8. Addressee's Address (Only if requested and fee is paid)

I also wish to receive the following services (for an extra fee):

1. ☐ Addressee's Address  
 2. ☐ Restricted Delivery

Consult postmaster for fee.

PS Form 3811, December 1991

\*U.S. GPO: 1993-352-714

**DOMESTIC RETURN RECEIPT**

Thank you for using Return Receipt Service.

Is your RETURN ADDRESS completed on the reverse side?

**SENDER:**

ANADARKO QUERECHO  
05/17/94

- The Return Receipt will show to whom the article was delivered and the date delivered.

3. Article Addressed to:

F. KIRK JOHNSON III  
1832 HILCREST  
FORT WORTH, TEXAS 76107

5. Signature (Addressee)

6. Signature (Agent)

4a. Article Number

4b. Service Type

- ☐ Registered ☐ Insured  
☒ Certified ☐ COD  
☐ Express Mail ☒ Return Receipt for Merchandise

7. Date of Delivery

JUN - 8 1994

8. Addressee's Address (Only if requested and fee is paid)

I also wish to receive the following services (for an extra fee):

1. ☐ Addressee's Address  
 2. ☐ Restricted Delivery

Consult postmaster for fee.

PS Form 3811, December 1991

\*U.S. GPO: 1993-352-714

**DOMESTIC RETURN RECEIPT**

Thank you for using Return Receipt Service.



P 206 002 260

**Receipt for Certified Mail**

No Insurance Coverage Provided  
 Do not use for International Mail  
 (See Reverse)

F. KIRK JOHNSON III  
1832 HILCREST  
FORT WORTH, TEXAS 76107

F. KIRK JOHNSON III

Certified Fee

Special Delivery Fee

Restricted Delivery Fee

P 206 002 262

**Receipt for Certified Mail**

No Insurance Coverage Provided  
 Do not use for International Mail  
 (See Reverse)

C. DANIEL WALKER  
6729 GRANTS LANE  
FORT WORTH, TEXAS 76116

June 1991

Certified Fee

Special Delivery Fee

Restricted Delivery Fee

Return Receipt following to Whom Date Delivered

Return Receipt following to Whom Date and Addressee's Address

TOTAL Postage &amp; Fees

P 206 001 981

**Receipt for Certified Mail**

No Insurance Coverage Provided  
 Do not use for International Mail  
 (See Reverse)

C.W. STUMHOFFER  
P.O. BOX 100416  
FORT WORTH, TEXAS  
76185-0416

300, June 1991

Certified Fee

Special Delivery Fee

Restricted Delivery Fee

Return Receipt following to Whom Date Delivered

Return Receipt following to Whom Date and Addressee's Address

TOTAL Postage &amp; Fees

Postmark or Date

Anadarko/Querecho  
June 6, 1994

Is your RETURN ADDRESS completed on the reverse side?

**SENDER:**  
ANADARKO QUERECHO  
05/17/94

so that we can  
back if space

I also wish to receive the following services (for an extra fee):

1. ☐ Addressee's Address  
2. ☐ Restricted Delivery  
Consult postmaster for fee.

3. Article Addressed to:  
ANN H. JOHNSON MCREYNOLDS  
MANAGING COSERVATOR FOR F. KIRK JOHNSON  
IV AND MARSLAND HOLT JOHNSON C/O JOHN W.  
MCREYNOLDS  
2001 BRYAN TOWER  
DALLAS, TEXAS 75201

4a. Article Number  
206 002 264

4b. Service Type  
☐ Registered ☐ Insured  
☒ Certified ☐ COD  
☐ Express Mail ☐ Return Receipt for Merchandise

7. Date of Delivery  
5-20-94

5. Signature (Addressee)  
Joe Wallace

6. Signature (Agent)

PS Form 3811, December 1991 ☆U.S. GPO: 1993-352-714 DOMESTIC RETURN RECEIPT

Thank you for using Return Receipt Service.

Is your RETURN ADDRESS completed on the reverse side?

**SENDER:**  
ANADARKO QUERECHO  
05/17/94

so that we can  
back if space

I also wish to receive the following services (for an extra fee):

1. ☐ Addressee's Address  
2. ☐ Restricted Delivery  
Consult postmaster for fee.

3. Article Addressed to:  
DEMAR JOHNSON HOPSON  
1400 RANKIN HIGHWAY  
SUITE 28  
MIDLAND, TEXAS 79701

4a. Article Number  
206 002 259

4b. Service Type  
☐ Registered ☐ Insured  
☒ Certified ☐ COD  
☐ Express Mail ☐ Return Receipt for Merchandise

7. Date of Delivery  
5-19-94

5. Signature (Addressee)  
Joe Wallace

6. Signature (Agent)

PS Form 3811, December 1991 ☆U.S. GPO: 1993-352-714 DOMESTIC RETURN RECEIPT

Thank you for using Return Receipt Service.

Is your RETURN ADDRESS completed on the reverse side?

**SENDER:**  
ANADARKO QUERECHO  
05/17/94

so that we can  
back if space

I also wish to receive the following services (for an extra fee):

1. ☐ Addressee's Address  
2. ☐ Restricted Delivery  
Consult postmaster for fee.

3. Article Addressed to:  
DEBRA JOHNSON HEAD  
1400 RANKIN HIGHWAY  
SUITE 28  
MIDLAND, TEXAS 79701

4a. Article Number

4b. Service Type  
☐ Registered ☐ Insured  
☒ Certified ☐ COD  
☐ Express Mail ☒ Return Receipt for Merchandise

7. Date of Delivery  
5-19-94

5. Signature (Addressee)  
Joe Wallace

6. Signature (Agent)

PS Form 3811, December 1991 ☆U.S. GPO: 1993-352-714 DOMESTIC RETURN RECEIPT

Thank you for using Return Receipt Service.

P 206 002 261  
**Receipt for Certified Mail**  
No Insurance Coverage Provided  
Do not use for International Mail

ANN H. JOHNSON MCREYNOLDS  
MANAGING COSERVATOR FOR F. KIRK JOHNSON  
IV AND MARSLAND HOLT JOHNSON C/O JOHN W.  
MCREYNOLDS  
2001 BRYAN TOWER  
DALLAS, TEXAS 75201

Certified Fee	
Special Delivery Fee	
Restricted Delivery Fee	
Return Receipt Showing to Whom Date Delivered	

P 206 002 259  
**Receipt for Certified Mail**  
No Insurance Coverage Provided  
Do not use for International Mail  
(See Reverse)

DEMAR JOHNSON HOPSON  
1400 RANKIN HIGHWAY  
SUITE 28  
MIDLAND, TEXAS 79701

Certified Fee	
Special Delivery Fee	
Restricted Delivery Fee	
Return Receipt Showing to Whom Date Delivered	

P 206 002 258  
**Receipt for Certified Mail**  
No Insurance Coverage Provided  
Do not use for International Mail  
(See Reverse)

DEBRA JOHNSON HEAD  
1400 RANKIN HIGHWAY  
SUITE 28  
MIDLAND, TEXAS 79701

Certified Fee	
Special Delivery Fee	
Restricted Delivery Fee	
Return Receipt Showing to Whom Date Delivered	
Return Receipt Showing to Whom Date Delivered	
TOTAL Postage & Fees	\$
Postmark or Date	

800, June 1991  
ANADARKO QUERECHO  
05/17/94

ILLEGIBLE

P 206 002 257



Receipt for  
Certified Mail

No Insurance Coverage Provided  
Do not use for International Mail  
(See Reverse)

MURJO OIL AND ROYALTY  
BOX 12666  
FORT WORTH, TEXAS 76116

800, June 1991

ANADARKO QUERECHO  
05/17/94

PS Form 3811, December 1991 U.S. POSTAL SERVICE

**SENDER:**  
ANADARKO QUERECHO  
05/17/94

**3. Article Addressed to:**  
MURJO OIL AND ROYALTY  
BOX 12666  
FORT WORTH, TEXAS 76116

**4a. Article Number**  
206 002 257

**4b. Service Type**  
☐ Registered ☐ Insured  
☒ Certified ☐ COD  
☐ Express ☐ Return Receipt for Merchandise

**7. Date of Delivery**  
5-23-94

**8. Addressee's Address (Only if requested and fee is paid)**

**5. Signature (Addressee)**

**6. Signature (Agent)**

**DOMESTIC RETURN RECEIPT**

Thank you for using Return Receipt Service.

Certified Fee	
Special Delivery Fee	
Restricted Delivery Fee	
Return Receipt Showing to Whom & Date Delivered	
Return Receipt Showing to Whom Date and Addressee's Address	
TOTAL Postage & Fees	\$
Postmark or Date	