

**MERIDIAN OIL, INC.**  
**CASE 9592**  
**FEBRUARY 1, 1989**

BEFORE EXAMINER CATANACH  
OIL CONSERVATION DIVISION

\_\_\_\_\_ EXHIBIT NO. \_\_\_\_\_

CASE NO. 9592

**Exhibit 1**



STATE OF NEW MEXICO  
DEPARTMENT OF ENERGY AND MINERALS  
OIL CONSERVATION DIVISION

IN THE MATTER OF THE APPLICATION  
OF MERIDIAN OIL, INC. FOR  
COMPULSORY POOLING, NON-STANDARD  
PRORATION UNIT AND UNORTHODOX  
LOCATION, SAN JUAN COUNTY, NEW MEXICO

CASE:

A P P L I C A T I O N

COMES NOW, MERIDIAN OIL, INC., by and through its attorneys, Kellahin, Kellahin and Aubrey, and in accordance with Section 70-2-17(c) NMSA (1978) applies to the New Mexico Oil Conservation Division for an order pooling all mineral interest in the Basin Fruitland Coal Gas Pool underlying the Lots 3, 4 and E/2 SW/4 Section 7, Lots 1, 2, 3 and 4, and E/2 W/2 Section 18, T30N, R9W, San Juan County, New Mexico. The above described non-standard proration unit is to be dedicated to its Turner Com #250 Well to be drilled to a depth of approximately 2950 feet an unorthodox well location in said Section, and in support thereof would show:

1. Applicant is a working interest owner in the Section 7, T30N R9W.
2. Applicant desires to drill a well at an unorthodox well location in the 1595' FSL and 855' FWL (NW/4NW/4) of Section 7.

NW SW

3. The proposed unit is a non-standard proration and spacing unit consisting of the Lots 3, 4 and E/2SW/4 of Section 7, and Lots 1, 2, 3 and 4 and E/2W/2 of Section 18, T30N, R9W.

4. Applicant, has sought a voluntary agreement with all those parties shown on Exhibit "A" for the formation of appropriate spacing and proration unit as shown on Exhibit B for the drilling of the subject well but has been unable to obtain a voluntary agreement.

5. Pursuant to the Division notice requirements, applicant has notified all those parties shown on Exhibit "A" of this application for compulsory pooling and the applicant's request for a hearing before the Division to be set on February 1, 1988.

6. In order to obtain its just and equitable share of the potential production underlying the above tract, applicant needs an order pooling the mineral interests involved in order to protect applicant's correlative rights and prevent waste.

WHEREFORE, applicant prays that this application be set for hearing before the Division's duly appointed examiner, and that after notice and hearing as required by law, the Division enter its order pooling the mineral interest described herein approving the unorthodox location and the non-standard proration unit. Applicant further prays that it be named operator of the well, and that the order make

provisions for applicant to recover out of production its costs of drilling, completing and equipping the subject well, costs of operation, including costs of supervision, and a risk factor in the amount of 200% for the drilling and completing of the well, for such other and further relief as may be proper.

Respectfully submitted,

By 

W. Thomas Kellahin  
Kellahin, Kellahin & Aburey  
P.O. Box 2265  
Santa Fe, New Mexico 87504

(505) 982-4285

~~Meridian Oil Inc.~~ Operator  
~~c/o Land Department~~  
Meridian Oil Production Inc.  
~~P.O. Box 4289~~  
Farmington, New Mexico 87499-4289

~~El Paso Production Company~~ 66.266960%  
~~c/o Land Department~~  
Meridian Oil Production Inc.  
~~P.O. Box 4289~~  
Farmington, New Mexico 87499-4289

~~Tennessee Oil Company~~ 16.866520%  
~~Post Office Box 3249~~  
~~Englewood, Colorado 80155~~

Conoco Inc. 14.673872%  
Post Office Box 460  
Hobbs, New Mexico 88240

~~FMP Operating Company~~ 2.192648%  
~~Post Office Box 60004~~  
~~New Orleans, Louisiana 70160~~

REVISED: October 3, 1988

S/2-7  
 SECTION All-18 TOWNSHIP 30N RANGE 9W COUNTY San Juan STATE New Mexico

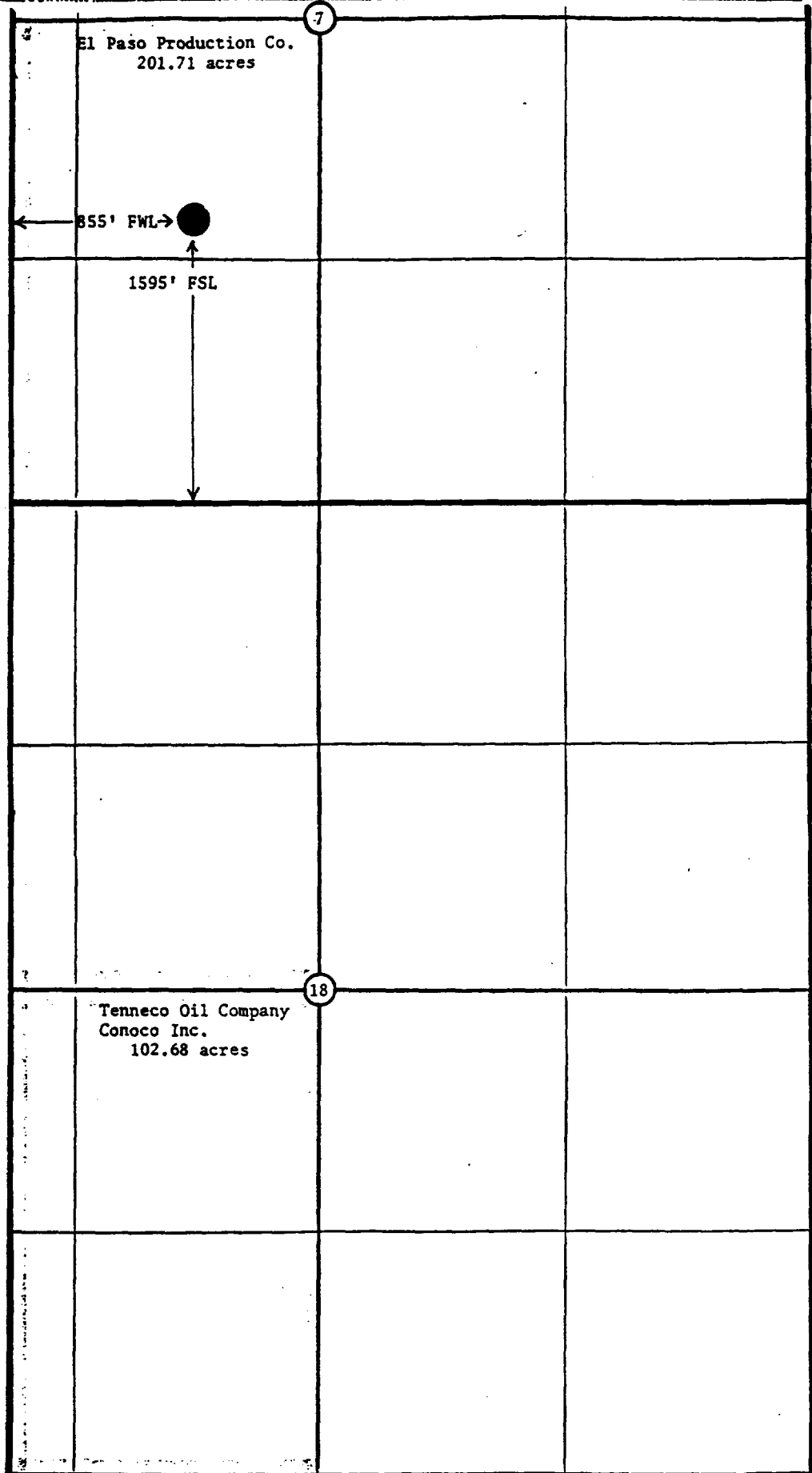

**Exhibit 2**



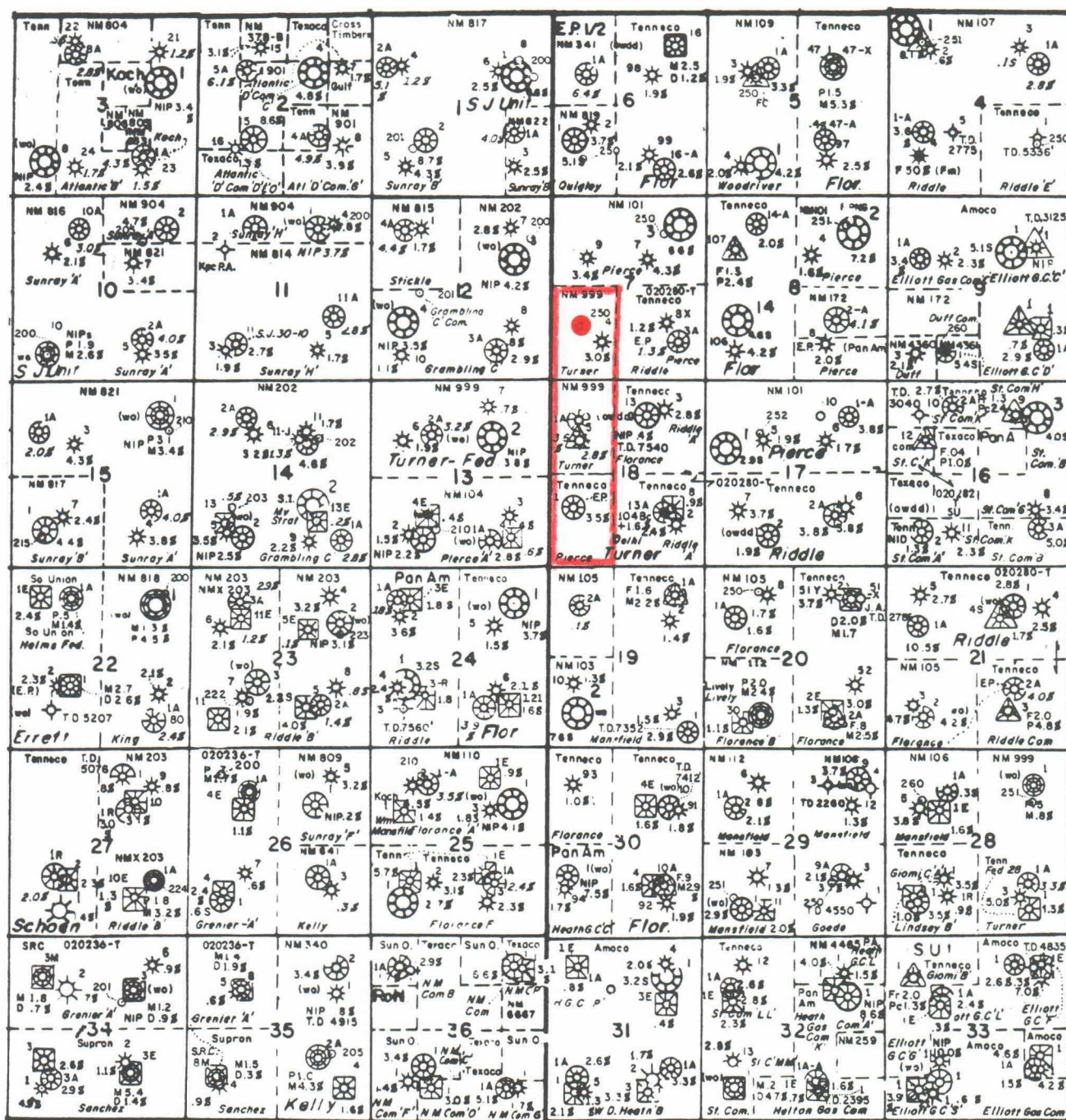

0 1  
MILE

- LEGEND -

PRORATION UNIT

TURNER COM #250

**MERIDIAN OIL**

TURNER COM #250  
W/2 SEC.18, SW/4 SEC.7  
T-30-N, R-9-W  
San Juan County, New Mexico

Landman: John Myrick

r.c.

Jan. 1989

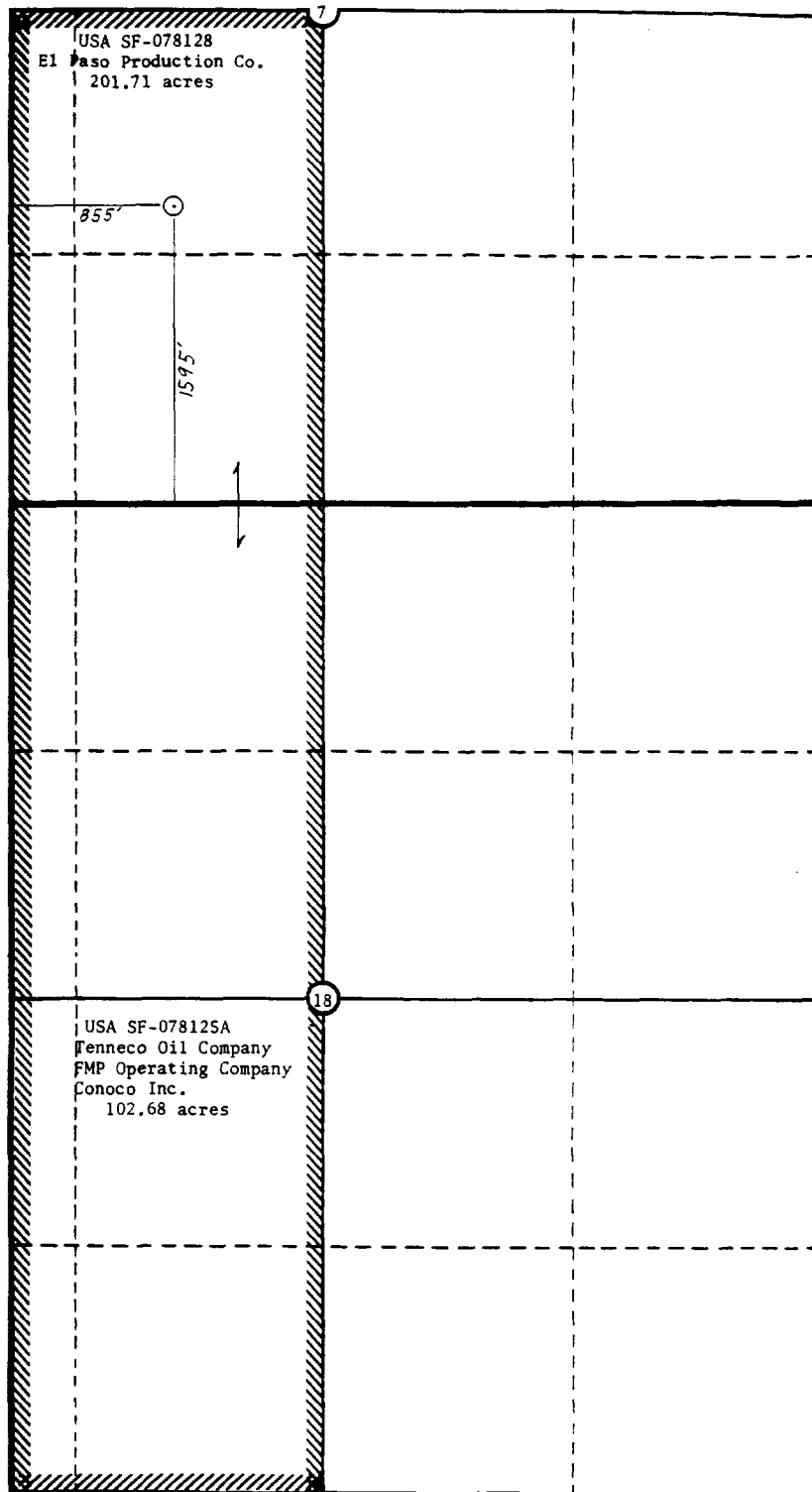

- L E G E N D -



PRORATION UNIT



TURNER COM #250

**MERIDIAN OIL**

TURNER COM #250  
W/2 SEC.18, SW/4 SEC.7  
T-30-N, R-9-W  
San Juan County, New Mexico

Landman: John Myrick

r.c.

Jan. 1989

**Exhibit 3**

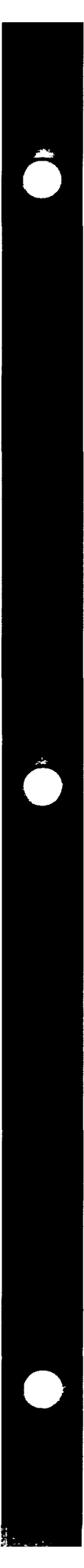

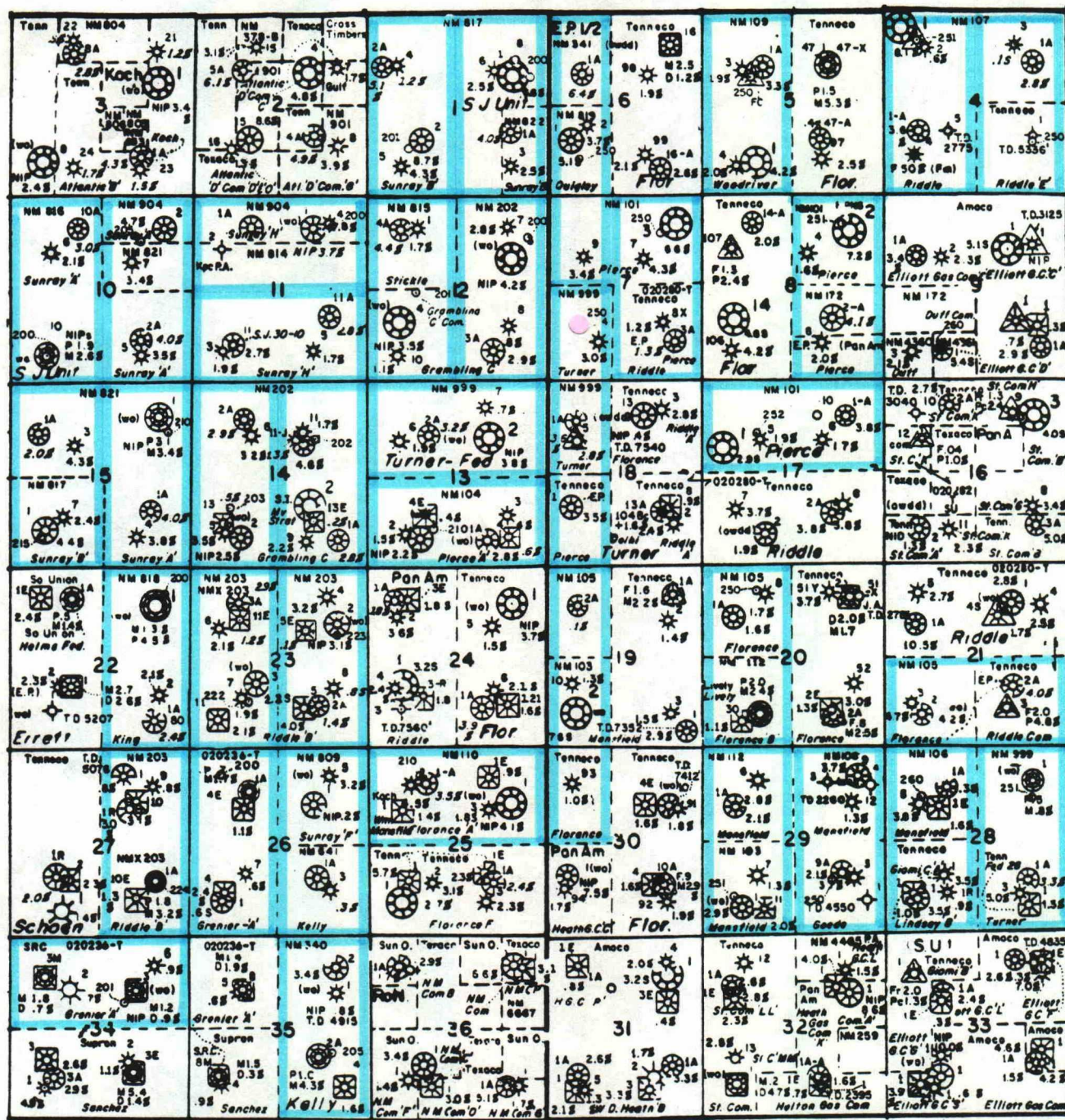

# - L E G E N D -

PROPOSED OR EXISTING  
FRUITLAND PRORATION UNITS

TURNER COM #250

MERIDIAN OIL

TURNER COM #250  
W/2 SEC 18, SW/4 SEC 7  
T-30-N, R-9-W  
San Juan County, New Mexico

Landmark John Myrick

r.c.

Jan. 1989



**Exhibit 4**

R 10 W

R 9 W

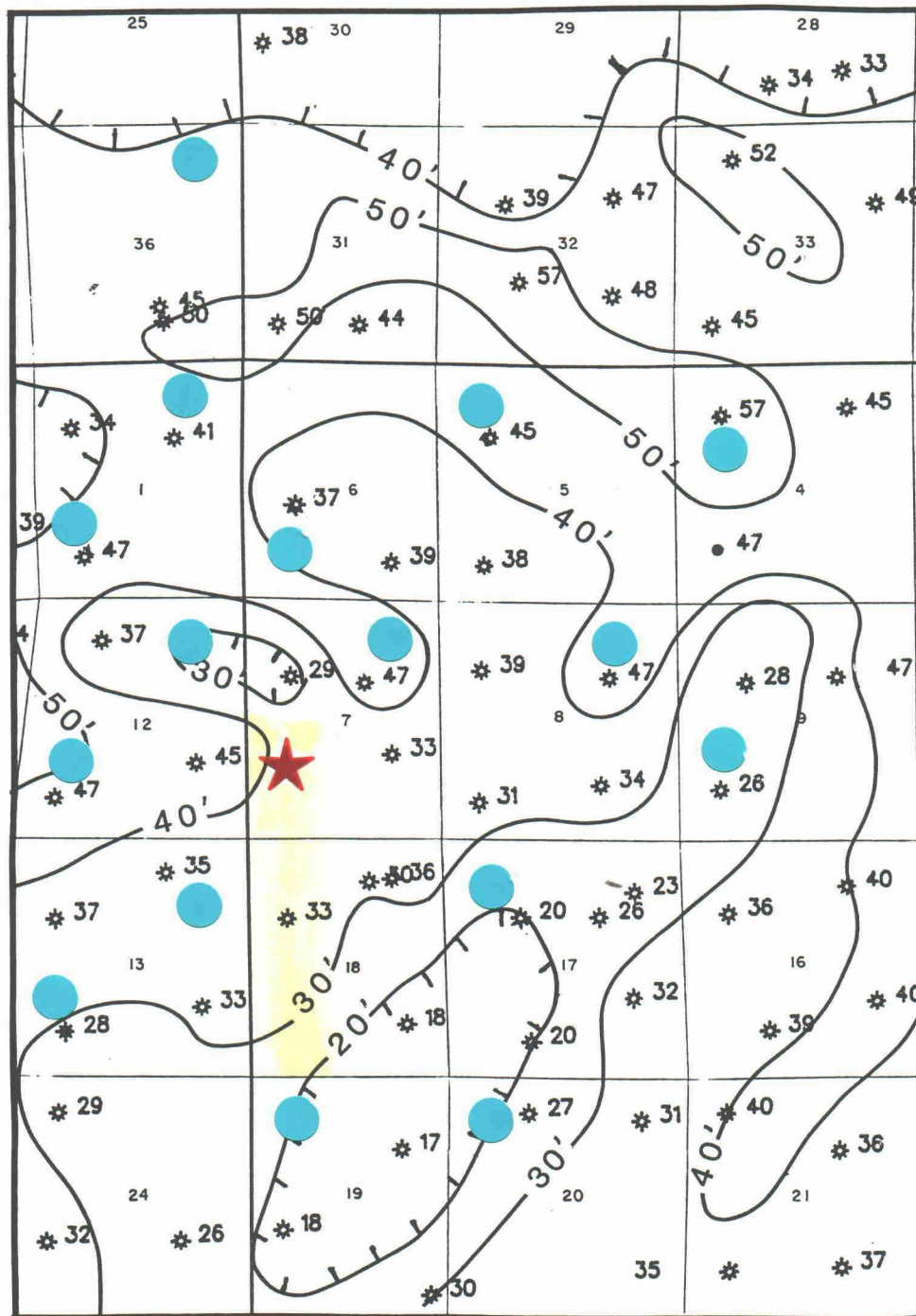
T  
31  
NT  
30  
N

MERIDIAN OIL



FRUITLAND FORMATION NET CLEAN COAL THICKNESS

SAN JUAN CO., NEW MEXICO

CONTOUR INTERVAL= 10 FT.

SCALE: 1" = 4,000'

L. MEIBOS

JAN. 27, 1989

35' NET COAL THICKNESS IN FT.

DRILLED OR PROPOSED  
FRUITLAND COAL WELLSWELL PROPOSED FOR  
NON STANDARD SPACING UNIT

STATE OF NEW MEXICO  
ENERGY AND MINERALS DEPARTMENT

NO. OF COPIES RECEIVED	
DISTRIBUTION	
SANTA FE	
FILE	
U.S.G.S.	
LAND OFFICE	
TRANSPORTER	OIL
OPERATOR	GAS
PRODUCTION OFFICE	

OIL CONSERVATION DIVISION  
P. O. BOX 2088  
SANTA FE, NEW MEXICO 87501

Form C-104  
Revised 10-01-78  
Format 06-01-83  
Page 1

REQUEST FOR ALLOWABLE  
AND  
AUTHORIZATION TO TRANSPORT OIL AND NATURAL GAS

**I. Operator**  
Meridian Oil Inc.

**Address**  
P. O. Box 4289, Farmington, NM 87499

**Reason(s) for filing (Check proper box)**

<input type="checkbox"/> New Well	<input type="checkbox"/> Change in Transporter of:	<input type="checkbox"/> Oil	<input type="checkbox"/> Dry Gas
<input type="checkbox"/> Recompletion	<input type="checkbox"/> Casinghead Gas	<input type="checkbox"/> Condensate	
<input checked="" type="checkbox"/> Change in Ownership/Operatorship			

**Other (Please explain)**  
Meridian Oil Inc. is Operator for El Paso Production Company

If change of ownership give name and address of previous owner: El Paso Natural Gas Company, P. O. Box 4289, Farmington, NM 87499

**II. DESCRIPTION OF WELL AND LEASE**

Lease Name Turner	Well No. 5	Pool Name, including Formation Aztec Fruitland	Kind of Lease State (Federal) or Fee	Lease No. SF 078128
Location Unit Letter <u>F</u> : <u>1840</u> Feet From The <u>North</u> Line and <u>842</u> Feet From The <u>West</u>				
Line of Section <u>18</u> Township <u>30N</u> Range <u>9W</u> , NMPM, San Juan County				

**III. DESIGNATION OF TRANSPORTER OF OIL AND NATURAL GAS**

Name of Authorized Transporter of Oil <input type="checkbox"/> or Condensate <input checked="" type="checkbox"/>	Address (Give address to which approved copy of this form is to be sent)
Meridian Oil Inc.	P. O. Box 4289, Farmington, NM 87499
Name of Authorized Transporter of Casinghead Gas <input type="checkbox"/> or Dry Gas <input checked="" type="checkbox"/>	Address (Give address to which approved copy of this form is to be sent)
El Paso Natural Gas Company	P. O. Box 4289, Farmington, NM 87499
If well produces oil or liquids, give location of tanks.	Is gas actually connected? <input type="checkbox"/> when <input type="checkbox"/>
Unit <u>F</u> Sec. <u>18</u> Twp. <u>30N</u> Rge. <u>9W</u>	

If this production is commingled with that from any other lease or pool, give commingling order number: \_\_\_\_\_

NOTE: Complete Parts IV and V on reverse side if necessary.

**VI. CERTIFICATE OF COMPLIANCE**

I hereby certify that the rules and regulations of the Oil Conservation Division have been complied with and that the information given is true and complete to the best of my knowledge and belief.

(Signature)  
Drilling Clerk

(Title)  
11-1-86

(Date)

OIL CONSERVATION DIVISION

APPROVED \_\_\_\_\_, 19\_\_\_\_  
BY Sam D. Chang  
SUPERVISION DISTRICT # 0  
TITLE \_\_\_\_\_

This form is to be filed in compliance with RULE 1104.

If this is a request for allowable for a newly drilled or deepened well, this form must be accompanied by a tabulation of the deviation tests taken on the well in accordance with RULE 111.

All sections of this form must be filled out completely for allowable on new and recompleted wells.

Fill out only Sections I, II, III, and VI for changes of owner, well name or number, or transporter, or other such change of condition.

Separate Forms C-104 must be filed for each pool in multiply completed wells.

NOV - 1

DISC 3

STATE OF NEW MEXICO  
ENERGY AND MINERALS DEPARTMENT

NO. OF TONS RECEIVED	
DISTRIBUTION	
SANTA FE	
FILE	
U.S.G.S.	
LAND OFFICE	
TRANSPORTER	OIL
OPERATOR	NAT
PERMITS OFFICE	

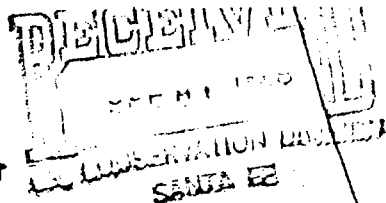

OIL CONSERVATION DIVISION  
P. O. BOX 2088  
SANTA FE, NEW MEXICO 87501

Form C-104  
Revised 10-21-78  
Formal 08-01-83  
Page 1

REQUEST FOR ALLOWABLE  
AND  
AUTHORIZATION TO TRANSPORT OIL AND NATURAL GAS

Operator El Paso Natural Gas Company	
Address P. O. Box 4289, Farmington, NM 87499	
Reason(s) for filing (Check proper box)	Other (Please explain)
<input type="checkbox"/> New Well <input type="checkbox"/> Recompletion <input type="checkbox"/> Change in Ownership	Change in Transporter of: <input type="checkbox"/> Oil <input type="checkbox"/> Condensate Gas <input checked="" type="checkbox"/> Dry Gas <input checked="" type="checkbox"/> Condensate

If change of ownership give name and address of previous owner: \_\_\_\_\_

II. DESCRIPTION OF WELL AND LEASE

Lease Name Turner	Well No. 5	Pool Name, including Formation Aztec Fruitland	Kind of Lease State (Federal) or Fee	Lease No. SF 078128
Location				
Unit Letter F	1840	Feet From The North	Line and 842	Feet From The West
Line of Section 18	Township 30N	Range 9W	San Juan County	

III. DESIGNATION OF TRANSPORTER OF OIL AND NATURAL GAS

Name of Authorized Transporter of Oil <input type="checkbox"/> or Condensate <input checked="" type="checkbox"/>	Address (Give address to which approved copy of this form is to be sent)
Meridian Oil Inc.	P. O. Box 1599, Aztec, New Mexico 87410
Name of Authorized Transporter of Condensate Gas <input type="checkbox"/> or Dry Gas <input checked="" type="checkbox"/>	Address (Give address to which approved copy of this form is to be sent)
El Paso Natural Gas Company	P. O. Box 4289, Farmington, NM 87499
If well produces oil or liquids, give location of tanks.	Unit Sec. Twp. Rng. Is gas actually connected? When
	F 18 30N 9W

If this production is commingled with that from any other lease or pool, give commingling order number: \_\_\_\_\_

NOTE: Complete Parts IV and V on reverse side if necessary.

VI. CERTIFICATE OF COMPLIANCE

I hereby certify that the rules and regulations of the Oil Conservation Division have been complied with and that the information given is true and complete to the best of my knowledge and belief.

Rogger Cook  
(Signature)  
Drilling Clerk  
(Title)  
5-1-  
(Date)



JUN 11 1986

OIL CON. DIV.  
DIST. 3

OIL CONSERVATION DIVISION

APPROVED Frank J. Cook JUN 11 1986  
BY  
SUPERVISOR DISTRICT #  
TITLE

This form is to be filed in compliance with RULE 1104.  
If this is a request for allowable for a newly drilled or deepened well, this form must be accompanied by a tabulation of the deviation tests taken on the well in accordance with RULE 111.  
All sections of this form must be filled out completely for allowable on new and recompleted wells.  
Fill out only Sections I, II, III, and VI for changes of owner, well name or number, or transporter or other such change of condition.  
Separate Forms C-104 must be filed for each pool in multiply completed wells.

#### IV. COMPLETION DATA

Designate Type of Completion - (X)		Oil well	Gas well	New well	Workover	Deepen	Plug Back	Some Other
Date Spudded	Date Compl. Ready to Prod.	Total Depth			P.B.T.D.			
Elevations (DF, RKB, RT, CR, etc.)	Name of Producing Formation	Top Oil/Gas Pay			Tubing Depth			
Perforations						Depth Casing Shoe		
TUBING, CASING, AND CEMENTING RECORD								
HOLE SIZE	CASING & TUBING SIZE		DEPTH SET		SACKS CEMENT			

#### V. TEST DATA AND REQUEST FOR ALLOWABLE (Test must be after recovery of total volume of load oil and must be equal to or exceed allowable for this depth or be for full 24 hours)

Date First New Oil Run To Tanks	Date of Test	Producing Method (Flow, pump, gas lift, etc.)	
Length of Test	Tubing Pressure	Casing Pressure	Choke Size
Actual Prod. During Test	Oil - Bbls.	Water - Bbls.	Gas - MCF

#### GAS WELL

Actual Prod. Test - MCF/D	Length of Test	Bbls. Condensate/MCF	Gravity of Condensate
Testing Method (pilot, back pr.)	Tubing Pressure (Shut-In)	Casing Pressure (Shut-In)	Choke Size

EL PASO NATURAL GAS COMPANY  
POST OFFICE BOX 990  
FARMINGTON, NEW MEXICONOTICE OF DISCONNECTDATE November 2, 1979

THIS IS TO NOTIFY THE OIL CONSERVATION COMMISSION THAT A DISCONNECT ON

<u>El Paso Natural Gas Company</u> Operator	<u>Turner #5</u> Well Name
<u>87-555-01</u> Meter Code	<u>18832-01</u> Site Code
<u>18-30-9</u> S-T-R	<u>E</u> Well Unit
<u>El Paso Natural Gas Company</u> Name of Purchaser	<u>Blanco Pictured Cliff</u> Pool
<u>WAS MADE ON</u>	
<u>December 22, 1978</u> Date	

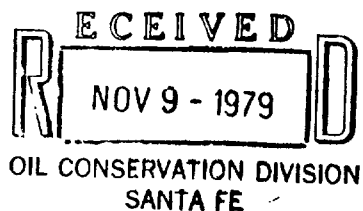
DUE TO Plugged back from Pictured Cliffs to FruitlandEl Paso Natural Gas Company  
PurchaserCharles A. Thomas  
RepresentativeAssistant Chief Dispatcher  
Titlecc: Operator  
Oil Conservation Commission - 2  
Proration - El Paso  
Gas Engineering - Farmington  
Drilling Department - Farmington

File - 2



EL PASO NATURAL GAS COMPANY  
POST OFFICE BOX 990  
FARMINGTON, NEW MEXICO

NOTICE OF GAS CONNECTION

DATE January 3, 1979

THIS IS TO NOTIFY THE OIL CONSERVATION COMMISSION THAT CONNECTION FOR PURCHASE OF

GAS FROM <u>El Paso Natural Gas Company</u>		<u>Turner #5 (FT)</u>	
Operator		Well Name	
<u>90-312-01</u>	<u>26191</u>	<u>E J</u>	<u>18-30-9</u>
Meter Code	Site Code	Well Unit	S-T-R
<u>Aztec Fruitland</u>		<u>El Paso Natural Gas Company</u>	
Pool		Name of Purchaser	

WAS MADE ON December 26, 1978  
DateFIRST DELIVERY December 27, 1978  
DateAOF -

Pictured Cliff plugged back to Fruitland

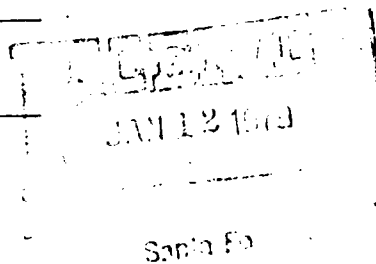
CHOKE -El Paso Natural Gas Company

Purchaser

  
RepresentativeChief Dispatcher

Title

cc: Operator  
Oil Conservation Commission - 2  
Proration - El Paso

File



NO. OF COPIES RECEIVED		5
DISTRIBUTION		
SANTA FE		
FILE		
U.S.G.S.		
LAND OFFICE		
TRANSPORTER	OIL	
	GAS	
OPERATOR		
PRODUCTION OFFICE		

**NEW MEXICO OIL CONSERVATION COMMISSION**  
**REQUEST FOR ALLOWABLE**  
**AND**  
**AUTHORIZATION TO TRANSPORT OIL AND NATURAL GAS**

Form C-104  
 Supersedes Old C-104 and C-110  
 Effective 1-1-65

Operator <b>EL PASO NATURAL GAS COMPANY</b>		
Address <b>BOX 289, FARMINGTON, NEW MEXICO 87401</b>		
Reason(s) for filing (Check proper box)		Other (Please explain)
New Well <input type="checkbox"/>	Change in Transporter of: Oil <input type="checkbox"/> Dry Gas <input type="checkbox"/>	<i>Plugged back from SC</i>
Recompletion <input checked="" type="checkbox"/>	Casinghead Gas <input type="checkbox"/> Condensate <input type="checkbox"/>	
Change in Ownership <input type="checkbox"/>		
If change of ownership give name and address of previous owner		

**II. DESCRIPTION OF WELL AND LEASE**

Lease Name <b>Turner</b>	Well No. Pool Name, Including Formation <b>5(OVWD) Aztec Fruitland</b>	Kind of Lease State, Federal or Fee	Lease No. <b>ST 078128</b>
Location			
Unit Letter <b>F</b>	Feet From The <b>North</b> Line and <b>842</b> Feet From The <b>West</b>		
Line of Section <b>18</b>	Township <b>30-N</b>	Range <b>9-W</b>	San Juan County

**III. DESIGNATION OF TRANSPORTER OF OIL AND NATURAL GAS**

Name of Authorized Transporter of Oil <input type="checkbox"/> or Condensate <input checked="" type="checkbox"/>	Address (Give address to which approved copy of this form is to be sent)
<b>El Paso Natural Gas Company</b>	<b>Box 289, Farmington, New Mexico 87401</b>
Name of Authorized Transporter of Casinghead Gas <input type="checkbox"/> or Dry Gas <input checked="" type="checkbox"/>	Address (Give address to which approved copy of this form is to be sent)
<b>El Paso Natural Gas Company</b>	<b>Box 289, Farmington, New Mexico 87401</b>
If well produces oil or liquids, give location of tanks.	Is gas actually connected? When
Unit <b>F</b> Sec. <b>18</b> Twp. <b>30N</b> Rge. <b>9W</b>	

If this production is commingled with that from any other lease or pool, give commingling order number:

**V. COMPLETION DATA**

Designate Type of Completion - (X)	Oil Well <input type="checkbox"/> Gas Well <input checked="" type="checkbox"/> New Well <input type="checkbox"/> Workover <input checked="" type="checkbox"/> Deepen <input type="checkbox"/> Plug Back <input type="checkbox"/> Same Resv. <input type="checkbox"/> Diff. Resv. <input checked="" type="checkbox"/>
Date Spudded <b>12-1-72</b>	Date Compl. Ready to Prod. <b>10-03-78</b>
Elevations (DF, RKB, RT, GR, etc.) <b>6278' Gr.</b>	Name of Producing Formation <b>Fruitland</b>
Perforations <b>2675, 2678, 2685, 2688, 2779, 2782, 2790, 2794, 2798, 2811, 2815, 2819'</b>	Top XX Gas Pay <b>2675'</b>
TUBING, CASING, AND CEMENTING RECORD	
HOLE SIZE <b>12 1/4"</b>	CASING & TUBING SIZE <b>8 5/8"</b>
<b>6 3/4"</b>	<b>2 7/8"</b>
DEPTH SET <b>140'</b>	
SACKS CEMENT <b>107 cf</b>	
<b>tubingless completion</b>	

**V. TEST DATA AND REQUEST FOR ALLOWABLE OIL WELL**

(Test must be after recovery of total volume of load oil and must be equal to or exceed top allowable for this depth or be for full 24 hours)

Date First New Oil Run To Tanks	Date of Test	Producing Method (Flow, pump, gas lift, etc.)	
Length of Test	Tubing Pressure	Casing Pressure	Choke Size
Actual Prod. During Test	Oil-Bbls.	Water-Bbls.	Gas-MCF

**GAS WELL**

Actual Prod. Test-MCF/D	Length of Test	Bbls. Condensate/MCF	Gravity of Gas
Testing Method (prior, back pr.)	Tubing Pressure (shut-in)	Casing Pressure (shut-in)	Choke Size
		<b>1009</b>	

**I. CERTIFICATE OF COMPLIANCE**

I hereby certify that the rules and regulations of the Oil Conservation Commission have been complied with and that the information given above is true and complete to the best of my knowledge and belief.

*A. G. Guisco*  
 (Signature)

Drilling Clerk

November 22, 1978

(Date)

**OIL CONSERVATION COMMISSION**

APPROVED **DEC 4 1978**

BY *Frank S. Chay*

TITLE **DEPUTY OIL & GAS INSPECTIONER #3**

This form is to be filed in compliance with RULE 1104.

If this is a request for allowable for a newly drilled or deepened well, this form must be accompanied by a tabulation of the deviation tests taken on the well in accordance with RULE 111.

All sections of this form must be filled out completely for allowable on new and recompleted wells.

Fill out only Sections I, II, III, and VI for changes of owner, well name or number, or transporter or other such change of condition.

Separate Forms C-104 must be filed for each pool in multiply completed wells.

WORKOVER - Plug back to Fruitland

9-20-78: Moved on wireline unit and cleaned out to 2998'. Ran tubing stop at 2898' and squeezed Pictured Cliffs perfs with 50 sks cement. Pressure tested to 4000#, O.K. Went in with mill and cleaned out to 2880' and perfed and fraced the Fruitland formation.

UNITED STATES  
DEPARTMENT OF THE INTERIOR  
GEOLOGICAL SURVEY

SUBMIT IN DUPLICATE\*

(See other in-  
structions on  
reverse side)Form approved.  
Budget Bureau No. 42-R355.5.

5. LEASE DESIGNATION AND SERIAL NO.

SF 078128

6. IF INDIAN, ALLOTTEE OR TRIBE NAME

7. UNIT AGREEMENT NAME

8. FARM OR LEASE NAME

Turner

9. WELL NO.

5(OWWO)

10. FIELD AND POOL, OR WILDCAT

Aztec Fruitland

11. SEC., T., R., M., OR BLOCK AND SURVEY  
OR AREA

Sec. 18, T-30-N, R-9-W

NMPM

12. COUNTY OR  
PARISH

San Juan

13. STATE

New Mexico

## WELL COMPLETION OR RECOMPLETION REPORT AND LOG \*

1a. TYPE OF WELL: OIL WELL ☐ GAS WELL ☒ DRY ☐ Other \_\_\_\_\_

b. TYPE OF COMPLETION:

NEW WELL ☐ WORK OVER ☒ DEEP-EN ☐ PLUG BACK ☒ DIFF. RESVR. ☒ Other \_\_\_\_\_

2. NAME OF OPERATOR

El Paso Natural Gas Company

3. ADDRESS OF OPERATOR

Box 289, Farmington, New Mexico 87401

4. LOCATION OF WELL (Report location clearly and in accordance with any State requirements)\*

At surface 1840'N, 842'W

At top prod. interval reported below

At total depth

14. PERMIT NO.

DATE ISSUED

15. DATE SPUDDED

12-1-72

16. DATE T.D. REACHED

12-11-72

17. DATE COMPL. (Ready to prod.)

10-03-78

18. ELEVATIONS (DF, RKB, RT, OR, ETC.)\*

6278'Gr

19. ELEV. CASINGHEAD

20. TOTAL DEPTH, MD &amp; TVD

3063'

21. PLUG, BACK T.D., MD &amp; TVD

2880'

22. IF MULTIPLE COMPL.,  
HOW MANY\*23. INTERVALS  
DRILLED BY

ROTARY TOOLS

CABLE TOOLS

10-3063

24. PRODUCING INTERVAL(S), OF THIS COMPLETION—TOP, BOTTOM, NAME (MD AND TVD)\*

2675-2819'(Ft)

25. WAS DIRECTIONAL  
SURVEY MADE

NO

26. TYPE ELECTRIC AND OTHER LOGS RUN

IEL;CDL/GR; Temp. Survey

27. WAS WELL CORED

NO

28. CASING RECORD (Report all strings set in well)

CASING SIZE	WEIGHT, LB./FT.	DEPTH SET (MD)	HOLE SIZE	CEMENTING RECORD	AMOUNT PULLED
8 5/8"	24#	140'	12 1/4"	107 cf	
2 7/8"	6.4#	3063'	6 3/4"	430 cf	

29. LINER RECORD

SIZE	TOP (MD)	BOTTOM (MD)	SACKS CEMENT*	SCREEN (MD)

30. TUBING RECORD

SIZE	DEPTH SET (MD)	PACKER SET (MD)
tubingless		

31. PERFORATION RECORD (Interval, size and number)

2675,2678,2685,2688,2779,2782,2790,2794,  
2798,2811,2815,2819' w/1 SPZ.

32. ACID, SHOT, FRACTURE, CEMENT SQUEEZE, ETC.

DEPTH INTERVAL (MD)	AMOUNT AND KIND OF MATERIAL USED
2675-2819	55,000# sand, 58,500 gal wtr.

33. PRODUCTION

DATE FIRST PRODUCTION		PRODUCTION METHOD (Flowing, gas lift, pumpjack, etc.) and type of pump				WELL STATUS (Producing or shut-in)	
		After Frac Gauge - 2774 MCF/D				Shut in	
DATE OF TEST	HOURS TESTED	CHOKES SIZE	PROD'N. FOR TEST PERIOD	OIL—BSL.	GAS—MCF.	WATER—BSL.	GAS—OIL RATIO
W/O 10-3-78			→		1000 30 1518		
FLOW. TUBING PRESS.	CASING PRESSURE	CALCULATED 24-HOUR RATE	OIL—BSL.	GAS—MCF.	WATER—BSL.	OIL GRAVITY-API (CORR.)	
	SI 1009	→					

34. DISPOSITION OF GAS (Sold, used for fuel, vented, etc.)

TEST WITNESSED BY  
Ron Headrick COM.

35. LIST OF ATTACHMENTS

36. I hereby certify that the foregoing and attached information is complete and correct as determined from all available records

SIGNED

M. D. Davis

TITLE

Drilling Clerk

DATE

Nov. 22, 1978

\*(See Instructions and Spaces for Additional Data on Reverse Side)

# INSTRUCTIONS

**General:** This form is designed for submitting a complete and correct well completion report and log on all types of lands and leases to either a Federal agency or a State agency, or both, pursuant to applicable Federal and/or State laws and regulations. Any necessary special instructions concerning the use of this form and the number of copies to be submitted, particularly with regard to local, area, or regional procedures and practices, either are shown below or will be issued by, or may be obtained from, the local Federal and/or State office. See instructions on items 22 and 24, and 33, below regarding separate reports for separate completions.

If not filed prior to the time this summary record is submitted, copies of all currently available logs (drillers, geologists, sample and core analysis, all types electric, etc.), formation and pressure tests, and directional surveys, should be attached hereto, to the extent required by applicable Federal and/or State laws and regulations. All attachments should be listed on this form, see item 35.

**Item 4:** If there are no applicable State requirements, locations on Federal or Indian land should be described in accordance with Federal requirements. Consult local State or Federal office for specific instructions.

**Item 18:** Indicate which elevation is used as reference (where not otherwise shown) for depth measurements given in other spaces on this form and in any attachments.

**Items 22 and 24:** If this well is completed for separate production from more than one interval zone (multiple completion), so state in item 22, and in item 24 show the producing interval, or intervals, top(s), bottom(s) and name(s) (if any) for only the interval reported in item 33. Submit a separate report (page) on this form, adequately identified, for each additional interval to be separately produced, showing the additional data pertinent to such interval.

**Item 29: "Sacks Cement":** Attached supplemental records for this well should show the details of any multiple stage cementing and the location of the cementing tool.

**Item 33:** Submit a separate completion report on this form for each interval to be separately produced. (See instruction for items 22 and 24 above.)

37. SUMMARY OF POROUS ZONES: SHOW ALL IMPORTANT ZONES OF POROSITY AND CONTENTS THEREOF; CORED INTERVALS; AND ALL DRILL-STEM TESTS, INCLUDING DEPTH INTERVAL TESTED, CUSHION USED, TIME TOOL OPEN, FLOWING AND SHUT-IN PRESSURES, AND RECOVERIES				38. GEOLOGIC MARKERS		
FORMATION	TOP	BOTTOM	DESCRIPTION, CONTENTS, ETC.	NAME	MEAS. DEPTH	TRUE VERT. DEPTH
				Fruitland	2660	

UNITED STATES  
DEPARTMENT OF THE INTERIOR  
GEOLOGICAL SURVEY

SUNDRY NOTICES AND REPORTS ON WELLS

(Do not use this form for proposals to drill or to deepen or plug back to a different reservoir. Use Form 9-331-C for such proposals.)

1. oil ☐ well gas ☒ well other ☐

2. NAME OF OPERATOR  
EL PASO NATURAL GAS CO.

3. ADDRESS OF OPERATOR  
BOX 289, FARMINGTON, NEW MEXICO

4. LOCATION OF WELL (REPORT LOCATION CLEARLY. See space 17 below.)  
AT SURFACE: 1840'N, 842'W  
AT TOP PROD. INTERVAL:  
AT TOTAL DEPTH:

16. CHECK APPROPRIATE BOX TO INDICATE NATURE OF NOTICE, REPORT, OR OTHER DATA

REQUEST FOR APPROVAL TO:

TEST WATER SHUT-OFF ☐  
FRACTURE TREAT ☐  
SHOOT OR ACIDIZE ☐  
REPAIR WELL ☐  
PULL OR ALTER CASING ☐  
MULTIPLE COMPLETE ☐  
CHANGE ZONES ☐  
ABANDON\* ☐  
(other) ☐

SUBSEQUENT REPORT OF:

☐  
☐  
☐  
☐  
☐  
☐  
☒  
☐

ADV-21513

(NOTE: Report results of multiple completion or zone change on Form 9-330.)

17. DESCRIBE PROPOSED OR COMPLETED OPERATIONS (Clearly state all pertinent details, and give pertinent dates, including estimated date of starting any proposed work. If well is directionally drilled, give subsurface locations and measured and true vertical depths for all markers and zones pertinent to this work.)\*

Plugged the Blanco P.C. Ext. in the following manner:

9/20: Squeezed P.C. perfs down 2 7/8" casing with 50 sks cement. PBTD 2898'. Top PC perf 2970'. Pressure tested 2 7/8" casing to 4000 psi, OK.

9/25: Perfed Uppper and Lower Fruitland 2675,2678,2685,2688,2779,2782,2790, 2794,2798,2811,2815,2819 with 1 SPZ. Fraced w/55,000# 20/40 sand and 58,500 gal. treated water. Flushed w/680 gal. water.

Subsurface Safety Valve: Manu. and Type \_\_\_\_\_ Set @ \_\_\_\_\_ Ft.

18. I hereby certify that the foregoing is true and correct

SIGNED A. D. Buico TITLE Drilling Clerk DATE 10/23/78

(This space for Federal or State office use)

APPROVED BY \_\_\_\_\_ TITLE \_\_\_\_\_ DATE \_\_\_\_\_  
CONDITIONS OF APPROVAL, IF ANY:

\*See Instructions on Reverse Side

NMOCC

5. LEASE SF 078128	
6. IF INDIAN, ALLOTTEE OR TRIBE NAME	
7. UNIT AGREEMENT NAME	
8. FARM OR LEASE NAME Turner	
9. WELL NO. #5 (OWNO)	
10. FIELD OR WILDCAT NAME Aztec Fruitland	
11. SEC., T., R., M., OR BLK. AND SURVEY OR AREA Sec. 18, T-30-N, R-9-W NMPM	
12. COUNTY OR PARISH San Juan	13. STATE New Mexico
14. API NO.	
15. ELEVATIONS (SHOW DF, KDB, AND WD) 6278' GL	

RECEIVED

OCT 25 1978

RECEIVED  
OCT 30 1978  
OIL CON. COM.  
DIST. 3

UNITED STATES  
DEPARTMENT OF THE INTERIOR  
GEOLOGICAL SURVEY

## APPLICATION FOR PERMIT TO DRILL, DEEPEN, OR PLUG BACK

## 1a. TYPE OF WORK

DRILL ☐DEEPEN ☐PLUG BACK ☒

## b. TYPE OF WELL

OIL  
WELL ☐GAS  
WELL ☒

OTHER

SINGLE  
ZONE ☐MULTIPLE  
ZONE ☐

## 2. NAME OF OPERATOR

El Paso Natural Gas Company

## 3. ADDRESS OF OPERATOR

Box 990, Farmington, New Mexico 87401

## 4. LOCATION OF WELL (Report location clearly and in accordance with any State requirements.)\*

At surface

1840'N, 842'W

At proposed prod. zone

## 14. DISTANCE IN MILES AND DIRECTION FROM NEAREST TOWN OR POST OFFICE\*

10 Mi. NE Bloomfield

## 15. DISTANCE FROM PROPOSED\*

LOCATION TO NEAREST

PROPERTY OR LEASE LINE, FT.

(Also to nearest drlg. unit line, if any) 842'

18. DISTANCE FROM PROPOSED LOCATION\*  
TO NEAREST WELL, DRILLING, COMPLETED,  
OR APPLIED FOR, ON THIS LEASE, FT.

700'

## 16. NO. OF ACRES IN LEASE\*

838

## 19. PROPOSED DEPTH

2850'

17. NO. OF ACRES ASSIGNED  
TO THIS WELL

153.45

## 20. ROTARY OR CABLE TOOLS

## 21. ELEVATIONS (Show whether DF, RT, GR, etc.)

6278' GL

## 22. APPROX. DATE WORK WILL START\*

## 23.

## PROPOSED CASING AND CEMENTING PROGRAM

SIZE OF HOLE	SIZE OF CASING	WEIGHT PER FOOT	SETTING DEPTH	QUANTITY OF CEMENT
12 1/4"	8 5/8"	24.0# J-55	140'	90 Sks Circulated to Surface
6 3/4"	2 7/8"	6.4# K-55	3062'	192 Sks. - Top @ 1700'

This well was originally completed in the Pictured Cliffs formation. It is now intended to plug back to the Fruitland in the following manner:

Squeeze Pictured Cliffs perforations down 2 7/8" casing w/75 sacks of cement. (P. C. perforations - 2970-86, 3012-20, 3030-38').

Displace cement to 2850' (Top of P. C. 2960').

W. O. C. 18 hours, pressure test to 4000 psi.

Selectively perforate and sand water fracture the Fruitland formation.

VERBAL APPROVAL RECEIVED FROM P. T. MC GRATH 9-11-78

IN ABOVE SPACE DESCRIBE PROPOSED PROGRAM: If proposal is to deepen or plug back, give data on present productive zone and proposed new productive zone. If proposal is to drill or deepen directionally, give pertinent data on subsurface locations and measured and true vertical depths. Give blowout preventer program, if any.

24.

SIGNED

*D. G. Davis*

TITLE

Drilling Clerk

DATE

9-11-78

(This space for Federal or State office use)

PERMIT NO.

APPROVAL DATE

APPROVED BY

TITLE

DATE

CONDITIONS OF APPROVAL, IF ANY:

\*See Instructions On Reverse Side

NMOCC

5. LEASE DESIGNATION AND SERIAL NO.

SF 078128

6. IF INDIAN, ALLOTTEE OR TRIBE NAME

7. UNIT AGREEMENT NAME

8. FARM OR LEASE NAME

Turner

9. WELL NO.

5 (OWWO)

10. FIELD AND POOL, OR WILDCAT

Aztec Fruitland

11. SEC., T., R., M., OR BLK.  
AND SURVEY OR AREA

Sec. 18, T-36-N, R-9-W

N. MP. M.

12. COUNTY OR PARISH

San Juan

13. STATE  
New Mexico

EL PASO NATURAL GAS COMPANY  
POST OFFICE BOX 990  
FARMINGTON, NEW MEXICO

NOTICE OF GAS CONNECTION

DATE March 16, 1973

THIS IS TO NOTIFY THE OIL CONSERVATION COMMISSION THAT CONNECTION FOR PURCHASE OF

GAS FROM El Paso Natural Gas Company Turner #5  
Operator Well Name

87-555-01 18832-8 F 18-30-9  
Meter Code Site Code Well Unit S-T-R

Blanco Pictured Cliff El Paso Natural Gas Company  
Pool Name of Purchaser

WAS MADE ON March 6, 1973 , FIRST DELIVERY March 14, 1973  
Date Date

AOF 379

CHOKE 376

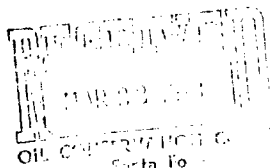

El Paso Natural Gas Company  
Purchaser

A. M. Ferguson  
Representative

Chief Dispatcher  
Title

cc: Operator  
Oil Conservation Commission - 2  
Proration - El Paso  
  
File



3-22-73

NO. COPIES RECEIVED		5
DISTRIBUTION		
SAH TA FE	/	
FILE	/	
U.S.G.S.		
LAND OFFICE		
TRANSPORTER	OIL /	
	GAS /	
OPERATOR	/	
PRODUCTION OFFICE		

**NEW MEXICO OIL CONSERVATION COMMISSION**  
**REQUEST FOR ALLOWABLE**  
**AND**  
**AUTHORIZATION TO TRANSPORT OIL AND NATURAL GAS**

Form C-104  
 Supersedes Old C-104 and C-110  
 Effective 1-1-65

**I. OPERATOR**

Operator El Paso Natural Gas Company

Address PO Box 990, Farmington, NM 87401

Reason(s) for filing (Check proper box)

New Well ☒ Change in Transporter of: Oil ☐ Dry Gas ☐

Recompletion ☐ Casinghead Gas ☐ Condensate ☐

Change in Ownership ☐

Other (Please explain) \_\_\_\_\_

If change of ownership give name and address of previous owner \_\_\_\_\_

**II. DESCRIPTION OF WELL AND LEASE**

Lease Name <u>Turner</u>	Well No. <u>5</u>	Pool Name, including Formation <u>Blanco Pictured Cliffs</u>	Kind of Lease State, (Federal) or Fee <u>SF</u>	Lease No. <u>078128</u>
Location Unit Letter <u>F</u> : <u>1840</u> Feet From The <u>North</u> Line and <u>842</u> Feet From The <u>West</u>				
Line of Section <u>18</u> Township <u>30N</u> Range <u>9W</u> , NMPM, <u>San Juan</u> County				

**III. DESIGNATION OF TRANSPORTER OF OIL AND NATURAL GAS**

Name of Authorized Transporter of Oil <input type="checkbox"/> or Condensate <input checked="" type="checkbox"/> <u>El Paso Natural Gas Company</u>	Address (Give address to which approved copy of this form is to be sent) <u>PO Box 990, Farmington, NM 87401</u>
Name of Authorized Transporter of Casinghead Gas <input type="checkbox"/> or Dry Gas <input checked="" type="checkbox"/> <u>El Paso Natural Gas Company</u>	Address (Give address to which approved copy of this form is to be sent) <u>PO Box 990, Farmington, NM 87401</u>
If well produces oil or liquids, give location of tanks. Unit <u>F</u> Sec. <u>18</u> Twp. <u>30N</u> Rge. <u>9W</u>	Is gas actually connected? When _____

If this production is commingled with that from any other lease or pool, give commingling order number: \_\_\_\_\_

**IV. COMPLETION DATA**

Designate Type of Completion - (X)	Oil Well <input type="checkbox"/>	Gas Well <input checked="" type="checkbox"/>	New Well <input checked="" type="checkbox"/>	Workover <input type="checkbox"/>	Deepen <input type="checkbox"/>	Plug Back <input type="checkbox"/>	Same Res'v. <input type="checkbox"/>	Diff. Res'v. <input type="checkbox"/>
Date Spudded <u>12-1-72</u>	Date Compl. Ready to Prod. <u>1-11-73</u>	Total Depth <u>3063'</u>	P.B.T.D. <u>3052'</u>					
Elevations (DF, RKB, RT, GR, etc.) <u>6278'GL</u>	Name of Producing Formation <u>Pictured Cliffs</u>	Top Oil/Gas Pay <u>2970'</u>	Tubing Depth <u>tubingless</u>					
Perforations <u>2970-86', 3012-20', 3030-38'</u>			Depth Casing Shoe <u>3063'</u>					
<b>TUBING, CASING, AND CEMENTING RECORD</b>								
HOLE SIZE <u>12 1/4"</u> <u>6 3/4"</u>	CASING & TUBING SIZE <u>8 5/8"</u> <u>2 7/8"</u> <u>tubingless</u>	DEPTH SET <u>140'</u> <u>3063'</u>	SACKS CEMENT <u>107 cu. ft.</u> <u>430 cu. ft.</u>					

**V. TEST DATA AND REQUEST FOR ALLOWABLE OIL WELL**

(Test must be after recovery of total volume of load oil and must be equal to or exceed top allowable for this depth or be for full 24 hours)

Date First New Oil Run To Tanks	Date of Test	Producing Method (Flow, pump, gas lift, etc.)	
Length of Test	Tubing Pressure	Casing Pressure	Choke Size
Actual Prod. During Test	Oil - Bbls.	Water - Bbls.	Gas - MCF

**GAS WELL**

Actual Prod. Test-MCF/D <u>379</u>	Length of Test <u>3 hrs.</u>	Bbls. Condensate/MMCF	Gravity of Condensate
Testing Method (prior, back pr.) <u>Calc. AOF</u>	Tubing Pressure (Shut-in) <u>tubingless</u>	Casing Pressure (Shut-in) <u>475</u>	Choke Size <u>3/4"</u>

**VI. CERTIFICATE OF COMPLIANCE**

I hereby certify that the rules and regulations of the Oil Conservation Commission have been complied with and that the information given above is true and complete to the best of my knowledge and belief.

PH Wood  
 (Signature)  
 Petroleum Engineer  
 (Title)

January 19, 1973  
 (Date)

**OIL CONSERVATION COMMISSION**

APPROVED: JAN 21 1973  
 BY: Carroll  
 SUPERVISOR DIST. #3  
 TITLE \_\_\_\_\_

This form is to be filed in compliance with RULE 1104.  
 If this is a request for allowable for a newly drilled or deepened well, this form must be accompanied by a tabulation of the deviation tests taken on the well in accordance with RULE 111.  
 All sections of this form must be filled out completely for allowable on new and recompleted wells.  
 Fill out only Sections I, II, III, and VI for changes of owner, well name or number, or transporter, or other such change of condition.

UNITED STATES  
DEPARTMENT OF THE INTERIOR  
GEOLOGICAL SURVEY

SUBMIT IN DUPLICATE\*

(See other in-  
structions on  
reverse side)Form approved.  
Budget Bureau No. 42-R355.6.

5. LEASE DESIGNATION AND SERIAL NO.

SF 078128

6. IF INDIAN, ALLOTTEE OR TRIBE NAME

7. UNIT AGREEMENT NAME

8. FARM OR LEASE NAME

Turner

9. WELL NO.

5

10. FIELD AND POOL, OR WILDCAT

Blanco Pictured Cliffs Ext.

11. SEC., T., R., M., OR BLOCK AND SURVEY  
OR AREASec. 18, T-30-N, R-9-W  
NMPM12. COUNTY OR  
PARISH

San Juan

13. STATE

New Mexico

## 1a. TYPE OF WELL:

OIL WELL ☐ GAS WELL ☒ DRY ☐ Other

## b. TYPE OF COMPLETION:

NEW WELL ☒ WORK OVER ☐ DEEP-EN ☐ PLUG BACK ☐ DIFF. RESVR. ☐ Other

## 2. NAME OF OPERATOR

El Paso Natural Gas Company

## 3. ADDRESS OF OPERATOR

PO Box 990, Farmington, NM 87401

## 4. LOCATION OF WELL (Report location clearly and in accordance with any State regulations)

At surface 1840'N, 842'W

At top prod. interval reported below

At total depth

14. PERMIT NO.

DATE ISSUED

15. DATE SPUDDED

12-1-72

16. DATE T.D. REACHED

12-11-72

17. DATE COMPL. (Ready to prod.)

1-11-73

18. ELEVATIONS (DF, REE, RT, CR, ETC.)\*

6278'GL

19. ELEV. CASINGHEAD

20. TOTAL DEPTH, MD &amp; TVD

3063'

21. PLUG, BACK T.D., MD &amp; TVD

3052'

22. IF MULTIPLE COMPL.,  
HOW MANY\*23. INTERVALS  
DRILLED BY

ROTARY TOOLS

0-3063'

CABLE TOOLS

24. PRODUCING INTERVAL(S), OF THIS COMPLETION—TOP, BOTTOM, NAME (MD AND TVD)\*

2970-3038'(Pictured Cliffs)

25. WAS DIRECTIONAL  
SURVEY MADE

no

26. TYPE ELECTRIC AND OTHER LOGS RUN

IEL: CDL-GR; Temp. Survey

27. WAS WELL CORED

no

## 28. CASING RECORD (Report all strings set in well)

CASING SIZE	WEIGHT, LB./FT.	DEPTH SET (MD)	HOLE SIZE	CEMENTING RECORD
8 5/8"	24#	140'	12 1/4"	107 cu. ft.
2 7/8"	6.4#	3063'	6 3/4"	430 cu. ft.

## 29. LINER RECORD

SIZE	TOP (MD)	BOTTOM (MD)	SACKS CEMENT*	SCREEN (MD)

## 30. TUBING RECORD

SIZE	DEPTH SET (MD)	PACKER (MD)
tubingless		

## 31. PERFORATION RECORD (Interval, size and number)

2970-86', 3012-20', 3030-38' with 24 shots  
per zone.

## 32. ACID, SHOT, FRACTURE, CEMENT SQUEEZE, ETC.

DEPTH INTERVAL (MD)	AMOUNT AND KIND OF MATERIAL USED
2970-3038'	15,660#sand, 14,410 gal. water

## 33.\* PRODUCTION

DATE FIRST PRODUCTION		PRODUCTION METHOD (Flowing, gas lift, pumping—size and type of pump)				WELL STATUS (Producing or shut-in)	
		flowing				shut in	
DATE OF TEST	HOURS TESTED	CHOKE SIZE	PROD'N. FOR TEST PERIOD	OIL—BBL.	GAS—MCF.	WATER—BBL.	GAS-OIL RATIO
1-11-73	3 hrs.	3/4"	→				
FLOW. TUBING PRESS.	CASING PRESSURE	CALCULATED 24-HOUR RATE	OIL—BBL.	GAS—MCF.	WATER—BBL.	OIL GRAVITY-API (CORR.)	
tubingless	SI 475	→		379 AOF			

## 34. DISPOSITION OF GAS (Sold, used for fuel, vented, etc.)

TEST WITNESSED BY  
W.D. Welch

## 35. LIST OF ATTACHMENTS

36. I hereby certify that the foregoing and attached information is complete and correct as determined from all available records

SIGNED

TITLE Petroleum Engineer

DATE January 19, 1973

\*(See Instructions and Spaces for Additional Data on Reverse Side)

# INSTRUCTIONS

**General:** This form is designed for submitting a complete and correct well completion report and log on all types of lands and leases to either a Federal agency or a State agency, or both, pursuant to applicable Federal and/or State laws and regulations. Any necessary special instructions concerning the use of this form and the number of copies to be submitted, particularly with regard to local, area, or regional procedures and practices, either are shown below or will be issued by, or may be obtained from, the local Federal and/or State office. See instructions on items 22 and 24, and 33, below regarding separate reports for separate completions.

If not filed prior to the time this summary record is submitted, copies of all currently available logs (drillers, geologists, sample and core analysis, all types electric, etc.), formation and pressure tests, and directional surveys, should be attached hereto, to the extent required by applicable Federal and/or State laws and regulations. All attachments should be listed on this form, see item 33.

**Item 4:** If there are no applicable State requirements, locations on Federal or Indian land should be described in accordance with Federal requirements. Consult local State or Federal office for specific instructions.

**Item 18:** Indicate which elevation is used as reference (where not otherwise shown) for depth measurements given in other spaces on this form and in any attachments. **Items 22 and 24:** If this well is completed for separate production from more than one interval zone (multiple completion), so state in item 22, and in item 24 show the producing interval, or intervals, top(s), bottom(s) and name(s) (if any) for only the interval reported in item 33. Submit a separate report (page) on this form, adequately identified, for each additional interval to be separately produced, showing the additional data pertinent to such interval.

**Item 29: "Sacks Cement":** Attached supplemental records for this well should show the details of any multiple stage cementing and the location of the cementing tool. **Item 33:** Submit a separate completion report on this form for each interval to be separately produced. (See instruction for items 22 and 24 above.)

37. SUMMARY OF POROUS ZONES: SHOW ALL IMPORTANT ZONES OF POROSITY AND CONTENTS THEREOF: CORED INTERVALS; AND ALL DRILL-STEM TESTS, INCLUDING DEPTH INTERVAL TESTED, CUSHION USED, TIME TOOL OPEN, FLOWING AND SHUT-IN PRESSURES, AND RECOVERIES			38. GEOLOGIC MARKERS				
FORMATION	TOP	BOTTOM	DESCRIPTION, CONTENTS, ETC.	NAME	MEAS. DEPTH	TOP	TRUE VERT. DEPTH
				Pictured Cliffs	2968'		

UNITED STATES  
DEPARTMENT OF THE INTERIOR  
GEOLOGICAL SURVEYSUBMIT IN TRIPLICATE\*  
(Other instructions on re-  
verse side)Form approved.  
Budget Bureau No. 42-R1424.  
5. LEASE DESIGNATION AND SERIAL NO.

SF 078128

6. IF INDIAN, ALLOTTEE OR TRIBE NAME

7. UNIT AGREEMENT NAME

8. FARM OR LEASE NAME

Turner

9. WELL NO.

5

10. FIELD AND POOL, OR WILDCAT

Blanco Pictured Cliffs ~~Blanco~~11. SEC., T., R., M., OR BLK. AND  
SURVEY OR AREASec. 18, T-30-N, R-9-W  
NMPM

12. COUNTY OR PARISH

San Juan

13. STATE

New Mexico

1. OIL ☐ GAS ☒ OTHER ☐  
WELL WELL

2. NAME OF OPERATOR

El Paso Natural Gas Company

3. ADDRESS OF OPERATOR

PO Box 990, Farmington, NM 87401

4. LOCATION OF WELL (Report location clearly and in accordance with any State requirements.\*  
See also space 17 below.)  
At surface

1840'N, 842'W

14. PERMIT NO.

15. ELEVATIONS (Show whether DF, RT, CR, etc.)

6278'GL

## 16. Check Appropriate Box To Indicate Nature of Notice, Report, or Other Data

## NOTICE OF INTENTION TO:

TEST WATER SHUT-OFF

FRACTURE TREAT

SHOOT OR ACIDIZE

REPAIR WELL

(Other)

PULL OR ALTER CASING

MULTIPLE COMPLETE

ABANDON\*

CHANGE PLANS

## SUBSEQUENT REPORT OF:

WATER SHUT-OFF

FRACTURE TREATMENT

SHOOTING OR ACIDIZING

(Other)

REPAIRING WELL

ALTERING CASING

ABANDONMENT\*

(NOTE: Report results of multiple completion on Well  
Completion or Recompletion Report and Log form.)

17. DESCRIBE PROPOSED OR COMPLETED OPERATIONS (Clearly state all pertinent details, and give pertinent dates, including estimated date of starting any proposed work. If well is directionally drilled, give subsurface locations and measured and true vertical depths for all markers and zones pertinent to this work.)\*

12-11-72

T. D. 3063'. Ran 100 joints 2 7/8", 6.4#, JS production casing, 3052' set at 3063'. Baffle set at 3052'. Cemented with 430 cu. ft. cement. WOC 18 hours. Top of cement at 1700'.

12-18-72

Tested 2 7/8" casing to 4000#-OK.

12-19-72

PBTd 3052'. Perf'd 2970-86', 3012-30', 3030-38' with 24 shots per zone. Frac'd with 15,660# 10/20 sand and 14,410 gallons treated water. Sanded off before 1st ball drop. Would not flow back.

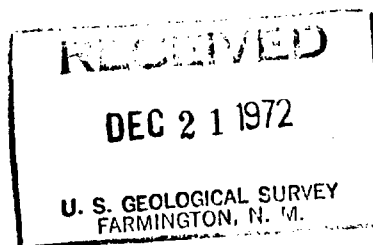
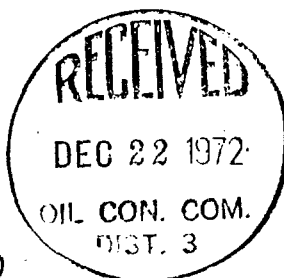
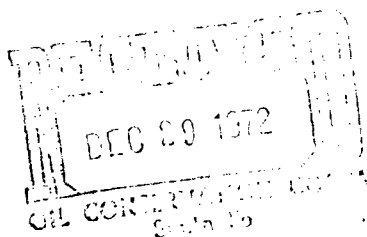

18. I hereby certify that the foregoing is true and correct

SIGNED

TITLE

Petroleum Engineer

DATE December 20, 1972

(This space for Federal or State office use)

APPROVED BY

TITLE

DATE

CONDITIONS OF APPROVAL, IF ANY:

\*See Instructions on Reverse Side

UNITED STATES  
DEPARTMENT OF THE INTERIOR  
GEOLOGICAL SURVEYSUBMIT IN TRIPLICATE\*  
(Other instructions on re-  
verse side)Form approved.  
Budget Bureau No. 42-R1424.

5. LEASE DESIGNATION AND SERIAL NO.

SF 078128

6. IF INDIAN, ALLOTTEE OR TRIBE NAME

7. UNIT AGREEMENT NAME

8. FARM OR LEASE NAME

Turner

9. WELL NO.

5

10. FIELD AND POOL, OR WILDCAT

Blanco Pictured Cliffs ~~Ext.~~11. SEC., T., R., M., OR BLK. AND  
SURVEY OR AREASec 18, T-30-N, R-9-W  
NMPM

12. COUNTY OR PARISH

San Juan

13. STATE

New Mexico

1. OIL WELL ☐ GAS WELL ☒ OTHER2. NAME OF OPERATOR  
El Paso Natural Gas Company3. ADDRESS OF OPERATOR  
PO Box 990, Farmington, NM 874014. LOCATION OF WELL (Report location clearly and in accordance with any State requirements.\*  
See also space 17 below.)  
At surface

1840'N, 842' W

14. PERMIT NO.

15. ELEVATIONS (Show whether DF, RT, CR, etc.)

6278'GL

## 16. Check Appropriate Box To Indicate Nature of Notice, Report, or Other Data

## NOTICE OF INTENTION TO:

TEST WATER SHUT-OFF

FRACTURE TREAT

SHOOT OR ACIDIZE

REPAIR WELL

(Other)

PULL OR ALTER CASING

MULTIPLE COMPLETE

ABANDON\*

CHANGE PLANS

## SUBSEQUENT REPORT OF:

WATER SHUT-OFF

FRACTURE TREATMENT

SHOOTING OR ACIDIZING

(Other)

REPAIRING WELL

ALTERING CASING

ABANDONMENT\*

(NOTE: Report results of multiple completion on Well  
Completion or Recompletion Report and Log form.)

17. DESCRIBE PROPOSED OR COMPLETED OPERATIONS (Clearly state all pertinent details, and give pertinent dates, including estimated date of starting any proposed work. If well is directionally drilled, give subsurface locations and measured and true vertical depths for all markers and zones pertinent to this work.)\*

12-1-72

Spudded well. Drilled surface hole. Ran 4 joints 8 5/8", 24#, KS surface casing, 129' set at 140'. Cemented with 107 cu. ft. cement, circulated to surface. WOC 12 hours, held 600#/30 minutes.

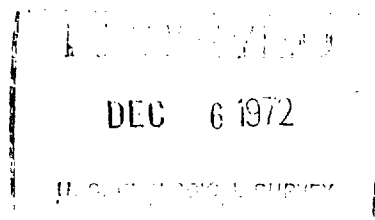

18. I hereby certify that the foregoing is true and correct

SIGNED

TITLE Petroleum Engineer

DATE December 5, 1972

(This space for Federal or State office use)

APPROVED BY

TITLE

DATE

CONDITIONS OF APPROVAL, IF ANY:

\*See Instructions on Reverse Side

UNITED STATES  
DEPARTMENT OF THE INTERIOR  
GEOLOGICAL SURVEY

## APPLICATION FOR PERMIT TO DRILL, DEEPEN, OR PLUG BACK

## 1a. TYPE OF WORK

DRILL ☒DEEPEN ☐PLUG BACK ☐

## b. TYPE OF WELL

OIL  
WELL ☐GAS  
WELL ☒

OTHER

SINGLE  
ZONE ☒MULTIPLE  
ZONE ☐

## 2. NAME OF OPERATOR

El Paso Natural Gas Company

## 3. ADDRESS OF OPERATOR

PO Box 990, Farmington, NM 87401

## 4. LOCATION OF WELL (Report location clearly and in accordance with any State requirements.)\*

At surface

1840'N, 842'W

At proposed prod. zone

## 14. DISTANCE IN MILES AND DIRECTION FROM NEAREST TOWN OR POST OFFICE\*

## 15. DISTANCE FROM PROPOSED\*

LOCATION TO NEAREST  
PROPERTY OR LEASE LINE, FT.  
(Also to nearest drilg. unit line, if any)18. DISTANCE FROM PROPOSED LOCATION\*  
TO NEAREST WELL, DRILLING, COMPLETED,  
OR APPLIED FOR, ON THIS LEASE, FT.

## 21. ELEVATIONS (Show whether DF, RT, GR, etc.)

6278'GR

## 16. NO. OF ACRES IN LEASE

## 19. PROPOSED DEPTH

3080'

17. NO. OF ACRES ASSIGNED  
TO THIS WELL

153.45

## 20. ROTARY OR CABLE TOOLS

Rotary

## 22. APPROX. DATE WORK WILL START\*

## 23.

## PROPOSED CASING AND CEMENTING PROGRAM

SIZE OF HOLE	SIZE OF CASING	WEIGHT PER FOOT	SETTING DEPTH	QUANTITY OF CEMENT
12 1/4"	8 5/8"	24.0#	120'	107 cu. ft. to circulate
6 3/4"	2 7/8"	6.4#	3080'	430 cu. ft. to cover Ojo Alamo

Selectively perforate and sandwater fracture the Pictured Cliffs formation.

The S/2 NW/4, and SW/4 of Section 18 are dedicated to this well.

R-3669

RECEIVED

NOV 13 1972

U. S. GEOLOGICAL SURVEY  
FARMINGTON, N.M.

IN ABOVE SPACE DESCRIBE PROPOSED PROGRAM: If proposal is to deepen or plug back, give data on present productive zone and proposed new productive zone. If proposal is to drill or deepen directionally, give pertinent data on subsurface locations and measured and true vertical depths. Give blowout preventer program, if any.

## 24.

SIGNED

TITLE Petroleum Engineer

DATE November 13, 1972

(This space for Federal or State office use)

PERMIT NO.

APPROVAL DATE

APPROVED BY

TITLE

DATE

CONDITIONS OF APPROVAL, IF ANY:

\*See Instructions On Reverse Side

NEW MEXICO OIL CONSERVATION COMMISSION  
WELL LOCATION AND ACREAGE DEDICATION PLAT

Form G-102  
Supersedes G-128  
Effective 1-1-65

All distances must be from the outer boundaries of the Section.

Operator <b>EL PASO NATURAL GAS COMPANY</b>		Lease <b>TURNER</b>		(SF-078128)		Well No. <b>5</b>
Unit Letter <b>F</b>	Section <b>18</b>	Township <b>30-N</b>	Range <b>9-W</b>	County <b>SAN JUAN</b>		
Actual Footage Location of Well: <b>1840</b> feet from the <b>NORTH</b> line and <b>842</b> feet from the <b>WEST</b> line						
Ground Level Elev. <b>6278</b>	Producing Formation <b>PICTURED CLIFFS</b>		Pool <b>BLANCO PICTURED CLIFFS EXT.</b>		Dedicated Acreage: <b>153.45</b> Acres	

1. Outline the acreage dedicated to the subject well by colored pencil or hachure marks on the plat below.
2. If more than one lease is dedicated to the well, outline each and identify the ownership thereof (both as to working interest and royalty).
3. If more than one lease of different ownership is dedicated to the well, have the interests of all owners been consolidated by communitization, unitization, force-pooling, etc?

☐ Yes ☐ No If answer is "yes," type of consolidation \_\_\_\_\_

If answer is "no," list the owners and tract descriptions which have actually been consolidated. (Use reverse side of this form if necessary.) \_\_\_\_\_

No allowable will be assigned to the well until all interests have been consolidated (by communitization, unitization, forced-pooling, or otherwise) or until a non-standard unit, eliminating such interests, has been approved by the Commission. **NOTE: THIS PLAT REISSUED TO SHOW MOVED LOCATION. 11-7-72**

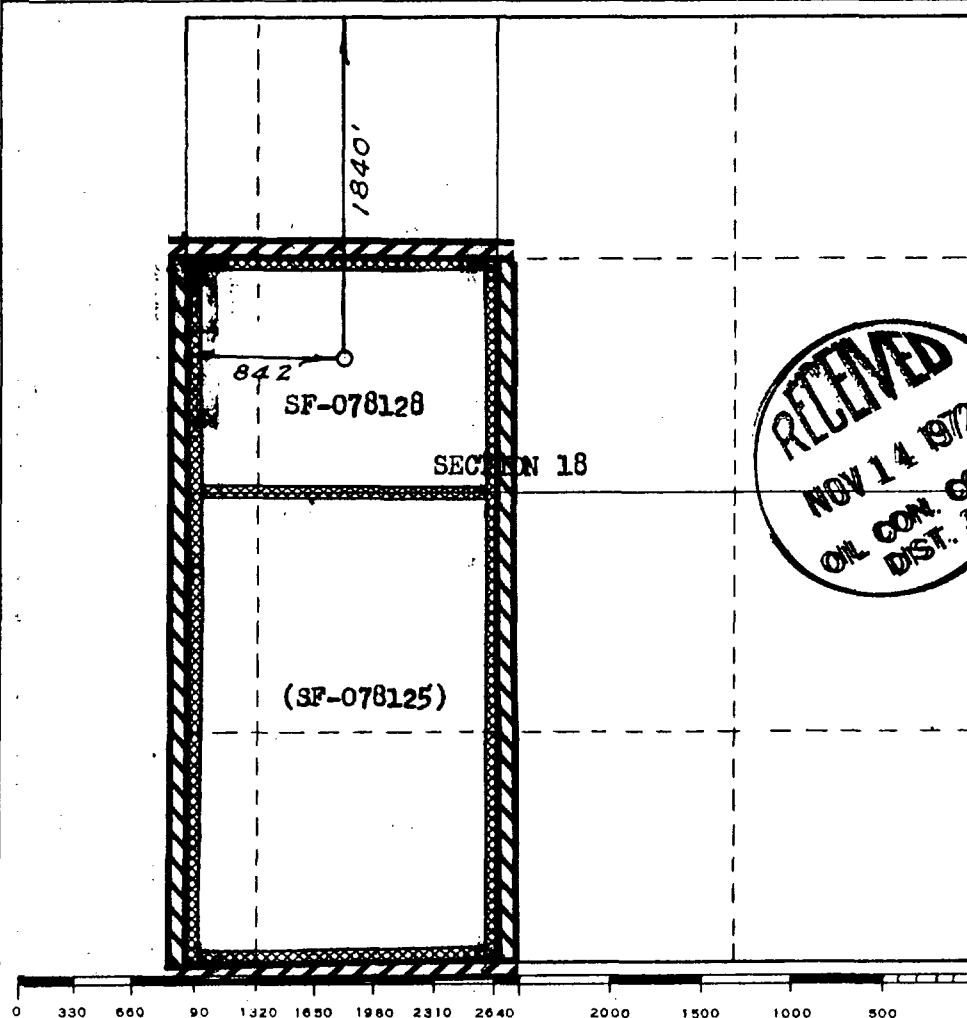

CERTIFICATION

I hereby certify that the information contained herein is true and complete to the best of my knowledge and belief.

Original Signed F. H. WOOD

Name  
**Petroleum Engineer**  
Position  
**El Paso Natural Gas Co.**  
Company  
**November 13, 1972**  
Date

I hereby certify that the well location shown on this plat was plotted from field notes of actual surveys made by me or under my supervision, and that the same is true and correct to the best of my knowledge and belief.

Date Surveyed  
**MARCH 16, 1972**

Registered Professional Engineer  
and/or Land Surveyor

*Paul O. Wilson*  
Certificate No. **1760**

UNITED STATES  
DEPARTMENT OF THE INTERIOR  
BUREAU OF LAND MANAGEMENT

APPLICATION FOR PERMIT TO DRILL, DEEPEN, OR PLUG BACK

1a. TYPE OF WORK

DRILL ☒

DEEPEN ☐

PLUG BACK ☐

b. TYPE OF WELL

OIL  
WELL ☐

WELL ☒

OTHER

SINGLE  
ZONE ☒

MULTIPLE  
ZONE ☐

2. NAME OF OPERATOR

Meridian Oil Inc. 8 1988

3. ADDRESS OF OPERATOR

PO Box 4289, Farmington, NM 87499

4. LOCATION OF WELL (Report location clearly and in accordance with any State requirements.)

At surface

1595'S, 855'W

At proposed prod. zone

14. DISTANCE IN MILES AND DIRECTION FROM NEAREST TOWN OR POST OFFICE\*

17 miles from Aztec, NM

15. DISTANCE FROM PROPOSED\*

LOCATION TO NEAREST  
PROPERTY OR LEASE LINE, FT.  
(Also to nearest drig. unit line, if any)

855'

16. NO. OF ACRES IN LEASE

838.17

17. NO. OF ACRES ASSIGNED  
TO THIS WELL

100.00 / 100.55

18. DISTANCE FROM PROPOSED LOCATION\*  
TO NEAREST WELL, DRILLING, COMPLETED,  
OR APPLIED FOR, ON THIS LEASE, FT.

900'

19. PROPOSED DEPTH

2974'

20. ROTARY OR CABLE TOOLS

Rotary

21. ELEVATIONS (Show whether DF, RT, GR, etc.)

6277' GL DRILLING OPERATIONS AUTHORIZED ARE

23. SUBJECT TO COMPLIANCE WITH ATTACHED

PROPOSED CASING AND CEMENTING PROGRAM

"GENERAL REQUIREMENTS"

This action is subject to technical and  
procedural review pursuant to 43 CFR §100.3  
and appeal pursuant to 43 CFR §100.6  
QUANTITY OF CEMENT.

SIZE OF HOLE	SIZE OF CASING	WEIGHT PER FOOT	SETTING DEPTH	QUANTITY OF CEMENT
12 1/4"	9 5/8"	32.3#	200'	130 cf. circulated
8 3/4"	7"	20.0#	2821'	890 cf circ. surface
6 1/4"	5 1/2" liner	23.0#	2974'	do not cement

The Fruitland coal formation will be completed.

A 3000 psi WP and 6000 psi test double gate preventer equipped with  
blind and pipe rams will be used for blow out prevention on this well.

This gas is dedicated.

The SW/4 of Section 7 is dedicated to this well.

RECEIVED  
AUG 2 5 1988

RECEIVED  
ELM MAIL ROOM  
JUL 22 1988

IN ABOVE SPACE DESCRIBE PROPOSED PROGRAM: If proposal is to deepen or plug back, give data on present productive zone and proposed new productive zone. If proposal is to drill or deepen directionally, give pertinent data on subsurface locations and measured and true vertical depths. Give blowout preventer program, if any.

24. *[Signature]*

SIGNED

TITLE

Regulatory Affairs

DATE

07-22-88

(This space for Federal or State office use)

PERMIT NO.

APPROVAL DATE

"Approval of this action does

not constitute a finding of title

held by the applicant or its  
holders or equitable rights  
or title to the lease."

TITLE

AMDC

\*See Instructions On Reverse Side

APPROVED  
AS AMENDED

AUG 3 1988

AREA MANAGER

All distances must be from the outer boundaries of the Section.

Operator Meridian Oil Inc.			Lease Turner Com (SF-078128)		Well No. 250
Unit Letter K	Section 7	Township 30 North	Range 9 West	County San Juan	
Actual Footage Location of Wells 1595 feet from the South line and 855 feet from the West line					
Ground Level Elev. 6277'	Producing Formation Fruitland Coal		Pool Undesignated	Dedicated Acreage: 160 100.55	

1. Outline the acreage dedicated to the subject well by colored pencil or hatchure marks on the plat below.
2. If more than one lease is dedicated to the well, outline each and identify the ownership thereof (both as to working interest and royalty).
3. If more than one lease of different ownership is dedicated to the well, have the interests of all owners been consolidated by communitization, unitization, force-pooling, etc?

☒ Yes ☐ No If answer is "yes," type of consolidation communitization

If answer is "no," list the owners and tract descriptions which have actually been consolidated. (Use reverse side of this form if necessary.)

No allowable will be assigned to the well until all interests have been consolidated (by communitization, unitization, forced-pooling, or otherwise) or until a non-standard unit, eliminating such interests, has been approved by the Division

\*Note: Standard location-short section

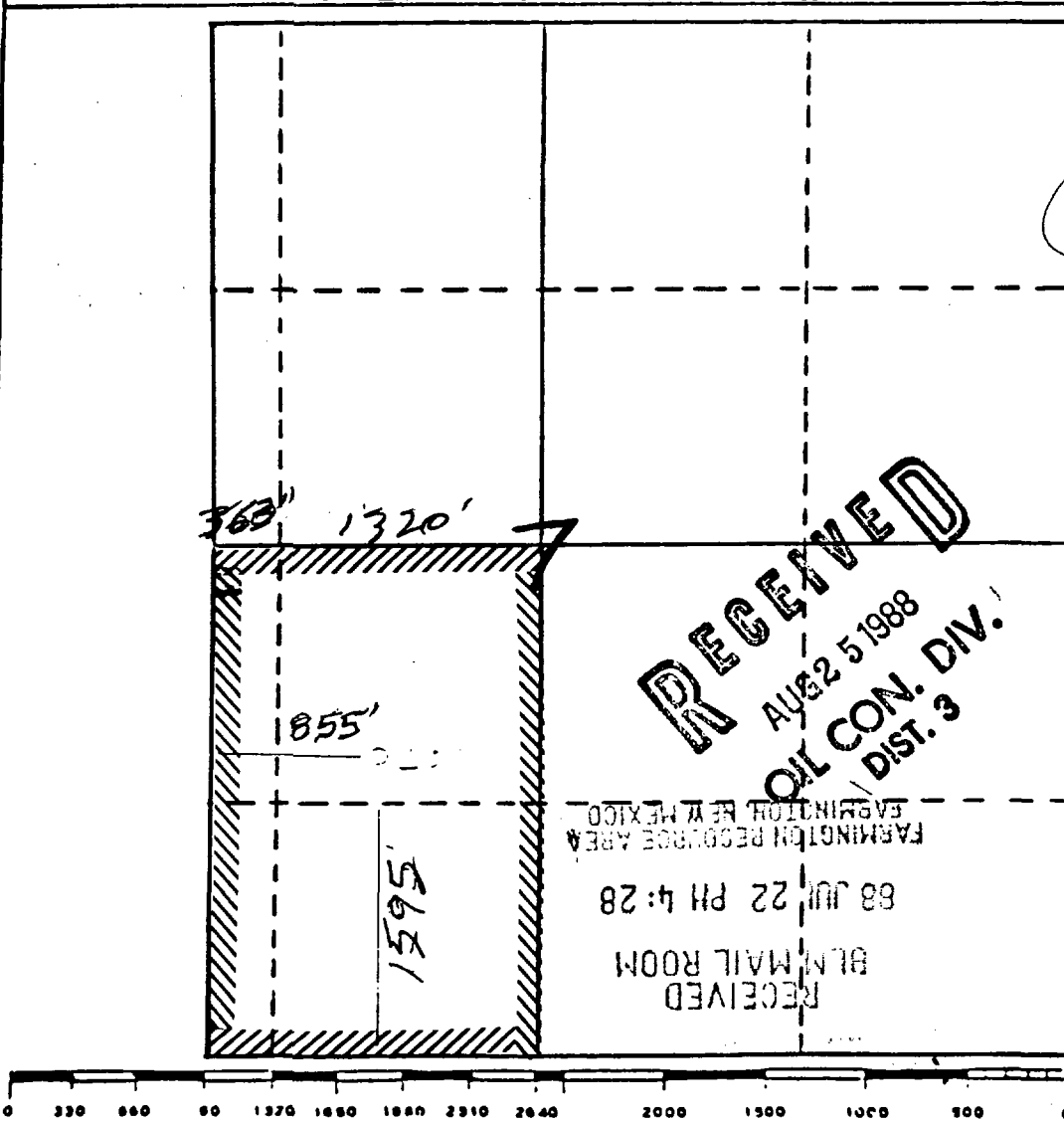

## CERTIFICATION

I hereby certify that the information contained herein is true and complete to the best of my knowledge and belief.

Name  
Drilling Clerk  
Position  
Meridian Oil Inc.

Company  
7-22-88

Date  
88

I hereby certify that the well location shown on this plat is plotted from field notes of actual surveys made by me or under my supervision, and that the same is true and correct to the best of my knowledge and belief.

Date Surveyed  
6-14-88

Registered Professional Engineer  
and/or Land Surveyor

Neale C. Edwards

Certificate No.  
6857



STATE OF NEW MEXICO

ENERGY, MINERALS AND NATURAL RESOURCES DEPARTMENT

OIL CONSERVATION DIVISION

GARREY CARRUTHERS  
GOVERNOR

POST OFFICE BOX 2088  
STATE LAND OFFICE BUILDING  
SANTA FE, NEW MEXICO 87504  
(505) 827-5800

August 29, 1988

Meridian Oil, Inc.  
P.O. Box 4289  
Farmington, NM 87499-4289

Attention: Peggy Doak

ADMINISTRATIVE ORDER NSP-1538

Dear Ms. Doak:

Reference is made to your application of August 3, 1988 for a 100.55-acre, more or less, non-standard gas spacing and proration unit consisting of the following acreage in the Undesignated Blanco Fruitland Pool:

SAN JUAN COUNTY, NEW MEXICO  
TOWNSHIP 30 NORTH, RANGE 9 WEST, NMPM  
Irregular Section 7: Lots 3 and 4 and the E/2 SW/4

It is my understanding that this unit is to be dedicated to your Turner Com Well No. 250 to be drilled at a standard gas well location 1595 feet from the South line and 855 feet from the West line (Unit K) of said Section 7.

By the authority granted me under the provisions of General Rule 104 D.II, the above non-standard gas proration unit is hereby approved.

Sincerely,

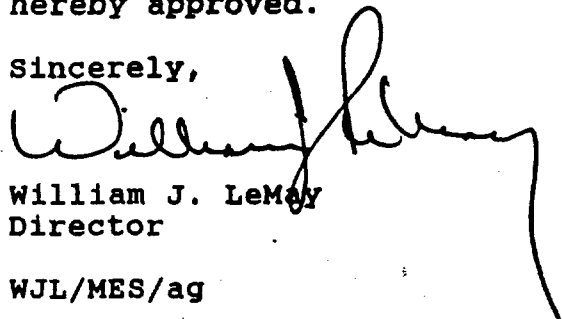
  
William J. LeMay  
Director

WJL/MES/ag

cc: Oil Conservation Division - Aztec  
NM Oil and Gas Engineering Committee - Hobbs  
US Bureau of Land Management - Farmington

COUNTY San JuanPOOL Blanco-Fruitland SANDTOWNSHIP 30 NorthRANGE 9 West

NMFM

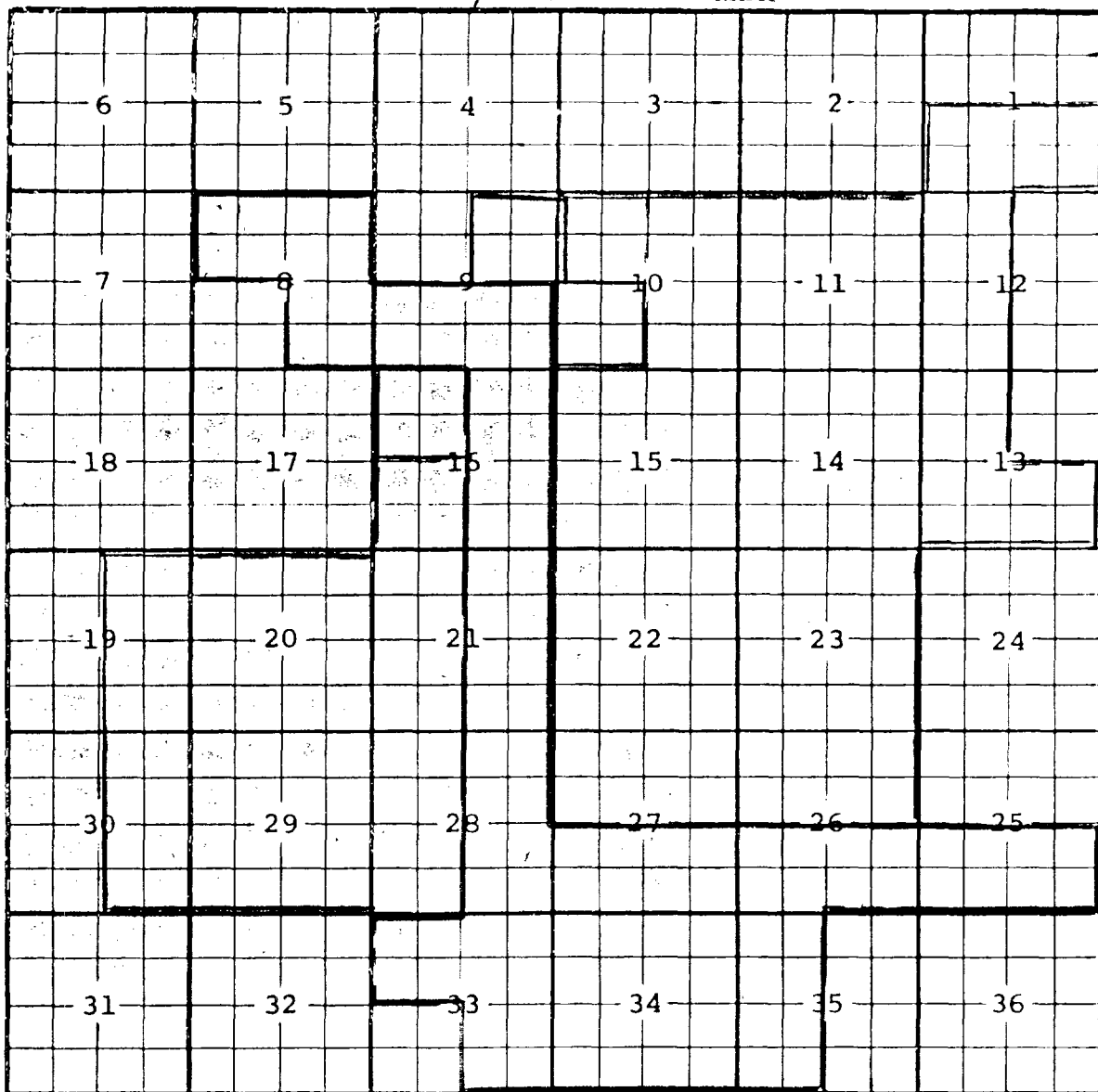

Description:  $\frac{N}{2} \& \frac{SE}{4}$  Sec. 8;  $\frac{S}{2}$  Sec. 9;  $\frac{E}{2}$  Sec. 16;  $\frac{E}{2}$  Sec. 21;  $\frac{S}{2}$  Sec. 25;  $\frac{S}{2}$  Sec. 26;  
 $\frac{S}{2}$  Sec. 27;  $\frac{E}{2}$  Sec. 28;  $\frac{N}{2} \& \frac{SE}{4}$  Sec. 33; All Sec. 34;  $\frac{W}{2}$  Sec. 35 (R-4311, 6-1-72)

Ext:  $\frac{SW}{4}$  Sec. 10,  $\frac{NW}{4}$  Sec. 16 (R-6327, 5-1-80)

Ext:  $\frac{S}{2}$  Sec. 1,  $\frac{N}{2}$  and  $\frac{SE}{4}$  Sec. 10, All Sec. 11,  $\frac{W}{2}$  Sec. 12,  $\frac{S}{2}$  and  $\frac{NW}{4}$   
 Sec. 13, All Secs. 14 and 15,  $\frac{SW}{4}$  Sec. 16,  $\frac{E}{2}$  Sec. 19, All Sec. 20,  
 $\frac{W}{2}$  Sec. 21, All Secs. 22 and 23,  $\frac{N}{2}$  Sec. 26,  $\frac{N}{2}$  Sec. 27,  $\frac{W}{2}$  Sec. 28,  
 All Sec. 29,  $\frac{E}{2}$  Sec. 30 (R-8180, 3-14-86) EXT:  $\frac{NE}{4}$  SEC 9 (R-8713, 8/12/88)  
 REDESIGNATED (R-8769, 10/17/88)

BEFORE THE OIL CONSERVATION COMMISSION  
OF THE STATE OF NEW MEXICO

IN THE MATTER OF THE APPLICATION OF  
DELHI OIL CORPORATION, DALLAS, TEXAS  
FOR AN ORDER PERMITTING THE COMMUNITIZ-  
ING OF SHORT OR NARROW QUARTER-SECTIONS  
ON A NORTH-SOUTH BASIS AS THEY MAY LIE  
ALONG THE WEST SIDE OF TOWNSHIPS 30 AND  
31 NORTH, RANGE 9 WEST, FOR THE PURPOSE OF  
CREATING DRILLING UNITS AND ALLOWABLES  
APPROXIMATELY CORRESPONDING TO THE SPACING  
AND ALLOWABLE REQUIREMENTS OF ORDER NO. 799  
RELATING TO THE BLANCO -MESAVERDE GAS POOL  
IN SAN JUAN COUNTY, NEW MEXICO.

CASE NO. 236  
ORDER NO. R-35

ORDER OF THE COMMISSION

BY THE COMMISSION:

This cause came on for hearing at Santa Fe, New Mexico, at 10:00 o'clock A.M., October 24, 1950, before the Oil Conservation Commission of New Mexico, hereinafter referred to as the "Commission".

NOW, on this 1st day of December, 1950, the Commission having before it for consid-  
eration the testimony adduced at the hearing of said case and being fully advised in the  
premises,

FINDS:

A. The extreme western quarter sections of sections 6, 7, 18, 19, 30 and 31 of Townships 30 and 31 north, Range 8 west, N.M.P.M., San Juan County, New Mexico are "narrow" quarter sections comprising approximately 100 acres each.

B. That the sections in question are within or near the areal limits of the Blanco-Mesaverde Pool.

C. That wells drilled upon "narrow" half sections would be entitled to only approxi-  
mately 200/320 of the allowable assigned to a full 320 acre drilling unit.

D. That waste would result from unnecessary drilling on 200-acre units.

IT IS THEREFORE ORDERED:

1. The following "narrow" quarter sections are hereby unitized as shown below  
by threes, each three unitized quarter sections of approximately 300 acres each to be  
a drilling unit for the Mesaverde formation underlying:

W/2 Sec. 6 and NW/4 Sec. 7  
SW/4 Sec. 7 and W/2 Sec. 18  
W/2 Sec. 19 and NW/4 Sec. 30  
SW/4 Sec. 30 and W/2 Sec. 31  
W/2 Sec. 19 and NW/4 Sec. 30  
SW/4 Sec. 30 and W/2 Sec. 31

for both Townships 30 and 31 north, Range 9 west.

2. (a) Wells which may be located upon these eight unitized drilling units will be located as follows:

All to be not closer than 660 ft. to the outer boundary nor closer to the center than 330 ft. of the quarter section ("narrow") upon which it is located;

SW/4 Sec. 6	for both Townships 30 and 31 north
SW/4 Sec. 18	Range 9 west.
SW/4 Sec. 19	
SW/4 Sec. 30	

(b) All wells upon the east half of the narrow sections to be located in the northeast quarter of the section not closer than 660 ft. to the outer boundary nor closer than 330 ft. to the center of the quarter section upon which they are located.

3. That no well shall be drilled or completed and no Notice of Intention nor drilling permit shall be approved unless one of the above designated 300 acre units is assigned to the well for allowable and proration purposes.

4. That the allowable for any unit shall be in direct proportion of the acreage in the unit to 320, i.e., a 300-acre unit will receive  $300/320$  or  $15/16$  or 93.75% of a normal unit allowable for 320 acres in Mesaverde pools spaced one well to each half section.

DONE at Santa Fe, New Mexico, on this 1st day of December, 1950.

STATE OF NEW MEXICO  
OIL CONSERVATION COMMISSION

THOMAS J. MABRY, CHAIRMAN

GUY SHEPARD, MEMBER

R. R. SPURRIER, SECRETARY

SEAL

STATE OF NEW MEXICO  
ENERGY, MINERALS AND NATURAL RESOURCES DEPARTMENT  
OIL CONSERVATION DIVISION

IN THE MATTER OF THE  
APPLICATION OF MERIDIAN OIL, INC.  
FOR COMPULSORY POOLING,  
SAN JUAN COUNTY, NEW MEXICO

CASE: 9592

CERTIFICATE OF MAILING  
AND  
COMPLIANCE WITH ORDER R-8054

In accordance with Division Rule 1207 (Order R-8054) I hereby certify that on January 9, 1989, I caused to be mailed by certified mail, return receipt, a notice of this hearing and a copy of the application for the above referenced case along with the cover letter, at least twenty days prior to the hearing set for February 1, 1989 to the parties shown in the Application as evidenced by the attached copy of the return receipt cards.

  
W. Thomas Kellahin

SUBSCRIBED AND SWORN to before me this February 1, 1989  
by W. Thomas Kellahin, attorney for applicant.

  
Notary Public

My Commission Expires:

Oct 28, 1989

TM-Merchandise Atlantic B cm 220  
Lunar.com #250

SENDER: Complete items 1 and 2 when additional services are desired, and complete items 3 and 4.  
Put your address in the "RETURN TO" Space on the reverse side. Failure to do this will prevent this card from being returned to you. The return receipt fee will provide you the name of the person delivered to and the date of delivery. For additional fees, the following services are available. Consult postmaster for fees and check boxes for additional services requested.  
1. ☒ Show to whom delivered, date, and addressee's address. (Extra charge)  
2. ☐ Restricted Delivery (Extra charge)

3. Article Addressed to:  Conoco, Inc. Post Office Box 460 Hobbs, NM 88240		4. Article Number  P-484 059 660	
5. Signature - Address  X <i>Post Office</i>		Type of Service: <input type="checkbox"/> Registered <input checked="" type="checkbox"/> Certified <input type="checkbox"/> Insured <input type="checkbox"/> Express Mail <input type="checkbox"/> COD <input type="checkbox"/> Return Receipt for Merchandise	
6. Signature - Agent  X		Always obtain signature of addressee or agent and DATE DELIVERED.	
7. Date of Delivery  X		8. Addressee's Address (ONLY if requested and fee paid)  <i>Post Office</i>	