



STATE OF NEW MEXICO
ENERGY, MINERALS AND NATURAL RESOURCES DEPARTMENT
OIL CONSERVATION DIVISION

GARREY CARRUTHERS
GOVERNOR

POST OFFICE BOX 2088
STATE LAND OFFICE BUILDING
SANTA FE, NEW MEXICO 87504
(505) 827-5800

March 14, 1989

Meridian Oil, Inc.
P.O. Box 4289
Farmington, NM 87499-4289

Case 9649

Attention: Peggy Bradfield

RE: Administrative Application for
an Unorthodox Coal Gas Well
Location; Delhi Com Well No.
300, M-16-30N-8W, Basin
Fruitland Coal (Gas) Pool.

Dear Ms. Bradfield:

Per your letter dated March 6, 1989, the subject administrative application is hereby withdrawn.

Thank you for your cooperation in this matter.

Sincerely,

A handwritten signature in black ink, appearing to read "Michael E. Stogner", written over a horizontal line.

Michael E. Stogner
Chief Hearing Officer

MES/ag

cc: Oil Conservation Division - Aztec
W. Thomas Kellahin

MERIDIAN OIL

March 6. 1989

Mr. William LeMay
New Mexico Oil Conservation Division
Post Office Box 2088
Santa Fe, New Mexico 87504

Dear Mr. LeMay:

Application was made for an unorthodox location for the Meridian Oil Inc. Delhi Com #300 on February 10, 1989. Please cancel this application, as this location has been moved to 1780' South and 1500' West of Section 16, T-30-N, R- 8-W, San Juan County, New Mexico.

Thank you for your consideration.

Sincerely,

Peggy Bradfield

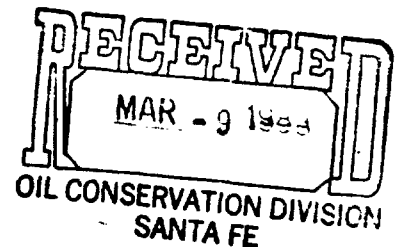



STATE OF NEW MEXICO

ENERGY, MINERALS AND NATURAL RESOURCES DEPARTMENT

OIL CONSERVATION DIVISION

GARREY CARRUTHERS
GOVERNOR

POST OFFICE BOX 2088
STATE LAND OFFICE BUILDING
SANTA FE, NEW MEXICO 87504
(505) 827-5800

March 2, 1989

Meridian Oil, Inc.
P.O. Box 4289
Farmington, NM 87499-4289

Case 9649

Attention: Peggy Bradfield

RE: Administrative Application for
an Unorthodox Coal Gas Well
Location; Delhi Com Well No. 1
300, M-16-30N-8W, Basin
Fruitland Coal (Gas) Pool.

Dear Ms. Bradfield:

The proposed well location seems somewhat extreme considering there is no additional information to support this move. Please explain as to why Meridian cannot locate this well on the existing well pad for the Delhi Com Well No. 1 located 1650 feet from the South and West lines (Unit K) of said Section 16. Also, submit a copy of the U.S.G.S. Topographical Map of this area and copies of any correspondence from other federal and/or state agencies requesting you to move to this particular location.

If this information has not been received by this office within 15 days from the date of this letter, this matter will be set for hearing before an examiner on the next available docket.

Thank you for your cooperation in this matter.

Sincerely,

Michael E. Stogner
Chief Hearing Officer

MES/ag

cc: Oil Conservation Division - Aztec
W. Thomas Kellahin

MERIDIAN OIL

February 10, 1989

Mr. William LeMay
New Mexico Oil Conservation Division
Post Office Box 2088
Santa Fe, New Mexico 87504

*Received
2/13/89*

Dear Mr. LeMay:

This is a request for administrative approval for an unorthodox gas well location in the Basin Fruitland Coal Pool.

It is intended to locate the Meridian Oil Inc. Delhi Com #300 at 570' from the South line and 185' from the West line of Section 16, T-30-N, R-8-W, San Juan County, New Mexico.

The flood plain terrain, San Juan River, and existing or proposed campsites makes this location necessary.

A copy of this application is being submitted to all offset operators by certified mail with a request that they furnish your Santa Fe office with a Waiver of Objection, and return one copy to this office.

Plats showing the proposed well location and the terrain in Section 16, along with an ownership plat, are attached.

Sincerely yours,

Peggy Bradford

Peggy Bradford

encl.

WAIVER

_____ hereby waives objection to Meridian Oil Inc.'s application for an unorthodox location for their Delhi Com #300 as proposed above.

By: _____ Date: _____

xc: Tenneco Oil
BHP Petroleum
Union Texas Petroleum

Copy Sent to E. Busch 2/27/89

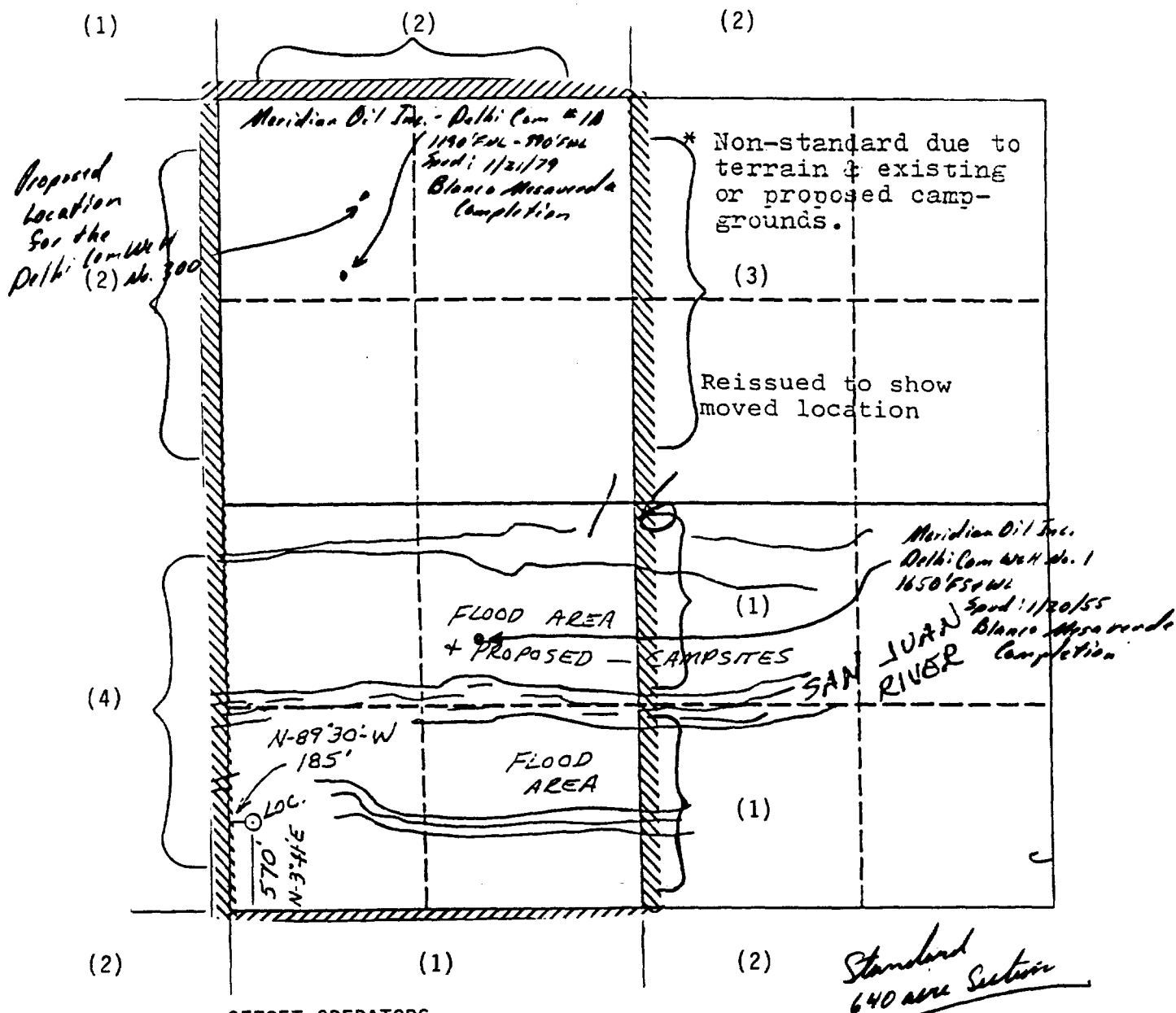
Well Name Delhi Com #300, Fruitland CoalFootage-- 570' FSL; 185' FWLAPPLICATION FOR NON-STANDARD LOCATIONCounty San Juan State New Mexico Section 16 Township 30N Range 8W

REMARKS:

OFFSET OPERATORS:

(1) Meridian Oil Inc.

(2) Tenneco Oil Company

(3) BHP Petroleum

(4) Union Texas Petroleum Corporation

Submit to Appropriate
District Office
State Lease - 4 copies
Fee Lease - 3 copies

State of New Mexico
Energy, Minerals and Natural Resources Department

OIL CONSERVATION DIVISION

P.O. Box 2088
Santa Fe, New Mexico 87504-2088

DISTRICT I
P.O. Box 1980, Hobbs, NM 88240

DISTRICT II
P.O. Drawer DD, Artesia, NM 88210

DISTRICT III
1000 Rio Brazos Rd., Aztec, NM 87410

WELL LOCATION AND ACREAGE DEDICATION PLAT

All Distances must be from the outer boundaries of the section

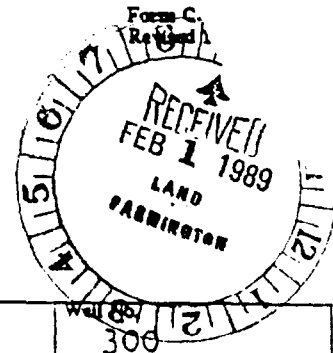

Operator Meridian Oil Inc.		Lease Delhi Com (B-10938-34)		Well No. 300
Unit Letter M	Section 16	Township 30 North	Range 8 West	County San Juan

Actual Footage Location of Well:

570 feet from the South line and 185 feet from the West line

Ground level Elev. 5750'	Producing Formation Fruitland Coal	Pool Basin	Dedicated Acreage: 320 Acres
-----------------------------	---------------------------------------	---------------	---------------------------------

- Outline the acreage dedicated to the subject well by colored pencil or hatchure marks on the plat below.
- If more than one lease is dedicated to the well, outline each and identify the ownership thereof (both as to working interest and royalty).
- If more than one lease of different ownership is dedicated to the well, have the interest of all owners been consolidated by communitization, unitization, force-pooling, etc?
☐ Yes ☐ No If answer is "yes" type of consolidation _____
If answer is "no" list the owners and tract descriptions which have actually been consolidated. (Use reverse side of this form if necessary).
No allowable will be assigned to the well until all interests have been consolidated (by communitization, unitization, forced-pooling, or otherwise) or until a non-standard unit, eliminating such interest, has been approved by the Division.

* Non-standard due to
terrain & existing
or proposed camp-
grounds.

Reissued to show
moved location

FLOOD AREA
+ PROPOSED - CAMPSITES

SAN JUAN RIVER

N-89°30'-W
185'

FLOOD
AREA

LOC.

570'
N-34°E

0 330 660 990 1320 1650 1980 2310 2640 2000 1500 1000 500 0

N-89°30'-W 2641.98

OPERATOR CERTIFICATION

I hereby certify that the information
contained herein is true and complete to the
best of my knowledge and belief.

Signature
Peggy Bradfield
Printed Name
Regulatory Affairs
Position
Meridian Oil Inc.
Company

Date

SURVEYOR CERTIFICATION

I hereby certify that the well location shown
on this plat was plotted from field notes of
actual surveys made by me or under my
supervision, and that the same is true and
correct to the best of my knowledge and
belief.

Date Surveyed 1-30-89
Neal A. Hawkins

Signature & Seal of
Professional Surveyor

Certificate No. 6857



STATE OF NEW MEXICO

ENERGY, MINERALS AND NATURAL RESOURCES DEPARTMENT

OIL CONSERVATION DIVISION

GARREY CARRUTHERS
GOVERNOR

POST OFFICE BOX 2088
STATE LAND OFFICE BUILDING
SANTA FE, NEW MEXICO 87504
(505) 827-5800

March 14, 1989

Meridian Oil, Inc.
P.O. Box 4289
Farmington, NM 87499-4289

Attention: Peggy Bradfield

RE: Administrative Application for
an Unorthodox Coal Gas Well
Location; Delhi Com Well No.
300, M-16-30N-8W, Basin
Fruitland Coal (Gas) Pool.

Dear Ms. Bradfield:

Per your letter dated March 6, 1989, the subject administrative application is hereby withdrawn.

Thank you for your cooperation in this matter.

Sincerely,

A handwritten signature in dark ink, appearing to read "Michael E. Stogner", with a long horizontal line extending to the right.

Michael E. Stogner
Chief Hearing Officer

MES/ag

cc: Oil Conservation Division - Aztec
W. Thomas Kellahin

MERIDIAN OIL

March 6. 1989

Mr. William LeMay
New Mexico Oil Conservation Division
Post Office Box 2088
Santa Fe, New Mexico 87504

Dear Mr. LeMay:

Application was made for an unorthodox location for the Meridian Oil Inc. Delhi Com #300 on February 10, 1989. Please cancel this application, as this location has been moved to 1780' South and 1500' West of Section 16, T-30-N, R- 8-W, San Juan County, New Mexico.

Thank you for your consideration.

Sincerely,

Peggy Bradford

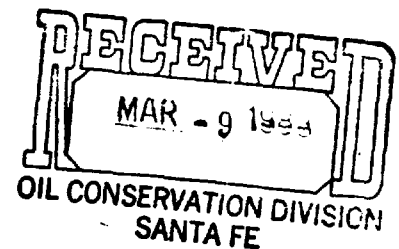



STATE OF NEW MEXICO

ENERGY, MINERALS AND NATURAL RESOURCES DEPARTMENT

OIL CONSERVATION DIVISION

GARREY CARRUTHERS
GOVERNOR

POST OFFICE BOX 2088
STATE LAND OFFICE BUILDING
SANTA FE, NEW MEXICO 87504
(505) 827-5800

March 2, 1989

Meridian Oil, Inc.
P.O. Box 4289
Farmington, NM 87499-4289

Attention: Peggy Bradfield

RE: Administrative Application for
an Unorthodox Coal Gas Well
Location; Delhi Com Well No.
300, M-16-30N-8W, Basin
Fruitland Coal (Gas) Pool.

Dear Ms. Bradfield:

The proposed well location seems somewhat extreme considering there is no additional information to support this move. Please explain as to why Meridian cannot locate this well on the existing well pad for the Delhi Com Well No. 1 located 1650 feet from the South and West lines (Unit K) of said Section 16. Also, submit a copy of the U.S.G.S. Topographical Map of this area and copies of any correspondence from other federal and/or state agencies requesting you to move to this particular location.

If this information has not been received by this office within 15 days from the date of this letter, this matter will be set for hearing before an examiner on the next available docket.

Thank you for your cooperation in this matter.

Sincerely,

A handwritten signature in black ink, appearing to read "Michael E. Stogner".

Michael E. Stogner
Chief Hearing Officer

MES/ag

cc: Oil Conservation Division - Aztec
W. Thomas Kellahin

MERIDIAN OIL

February 10, 1989

Mr. William LeMay
New Mexico Oil Conservation Division
Post Office Box 2088
Santa Fe, New Mexico 87504

*Received
2/13/89*

Dear Mr. LeMay:

This is a request for administrative approval for an unorthodox gas well location in the Basin Fruitland Coal Pool.

It is intended to locate the Meridian Oil Inc. Delhi Com #300 at 570' from the South line and 185' from the West line of Section 16, T-30-N, R-8-W, San Juan County, New Mexico.

The flood plain terrain, San Juan River, and existing or proposed campsites makes this location necessary.

A copy of this application is being submitted to all offset operators by certified mail with a request that they furnish your Santa Fe office with a Waiver of Objection, and return one copy to this office.

Plats showing the proposed well location and the terrain in Section 16, along with an ownership plat, are attached.

Sincerely yours,

Peggy Bradford

Peggy Bradford

encl.

WAIVER

_____ hereby waives objection to Meridian Oil Inc.'s application for an unorthodox location for their Delhi Com #300 as proposed above.

By: _____ Date: _____

xc: Tenneco Oil
BHP Petroleum
Union Texas Petroleum

Copy Sent to E. Busch 2/27/89

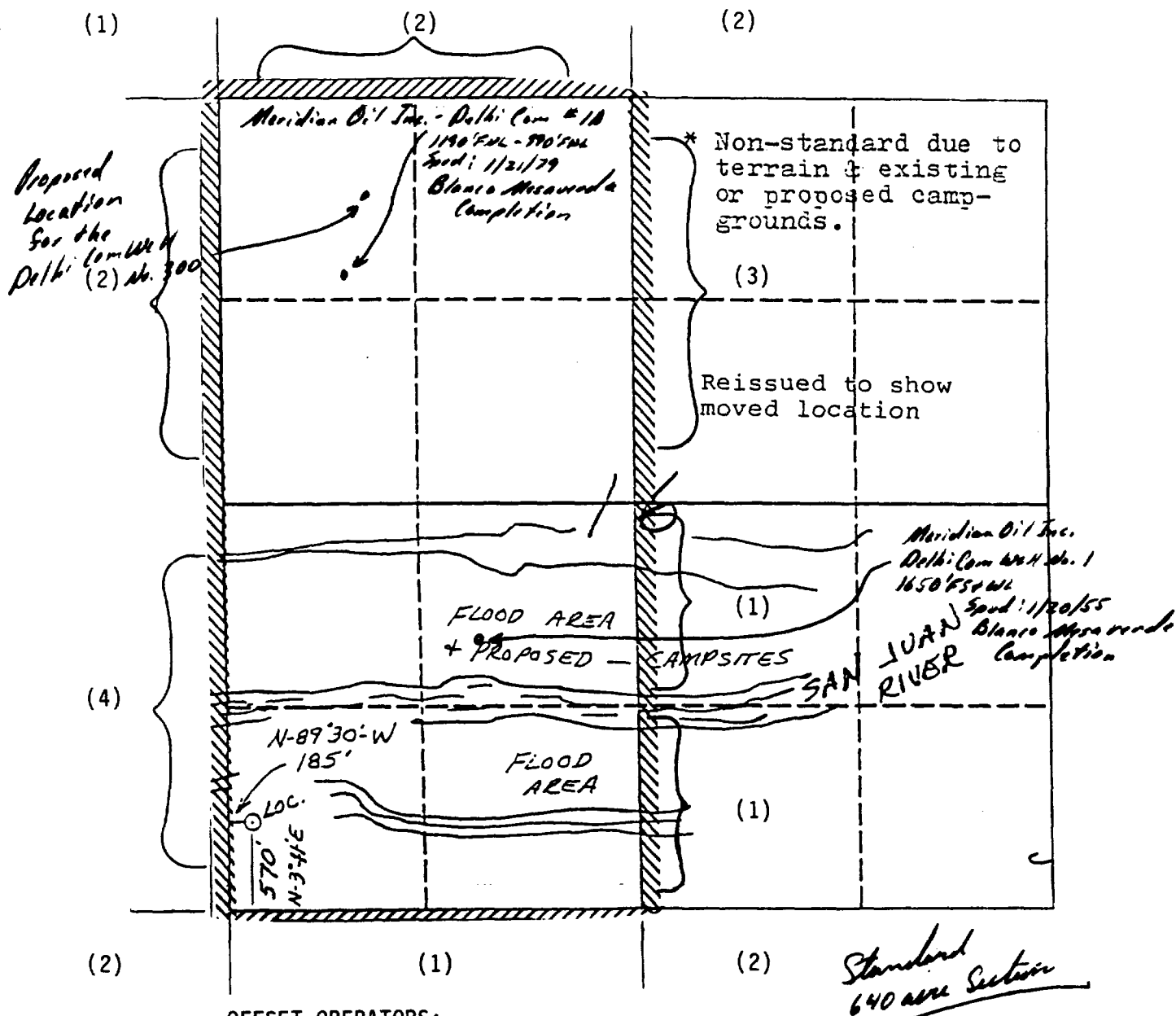
Well Name Delhi Com #300, Fruitland CoalFootage-- 570' FSL; 185' FWLAPPLICATION FOR NON-STANDARD LOCATIONCounty San Juan State New Mexico Section 16 Township 30N Range 8W

REMARKS:

OFFSET OPERATORS:

(1) Meridian Oil Inc.

(2) Tenneco Oil Company

(3) BHP Petroleum

(4) Union Texas Petroleum Corporation

Submit to Appropriate
District Office
State Lease - 4 copies
Fee Lease - 3 copies

STATE OF NEW MEXICO
Energy, Minerals and Natural Resources Department

OIL CONSERVATION DIVISION

P.O. Box 2088
Santa Fe, New Mexico 87504-2088

DISTRICT I
P.O. Box 1980, Hobbs, NM 88240

DISTRICT II
P.O. Drawer DD, Artesia, NM 88210

DISTRICT III
1000 Rio Brazos Rd., Aztec, NM 87410

WELL LOCATION AND ACREAGE DEDICATION PLAT

All Distances must be from the outer boundaries of the section

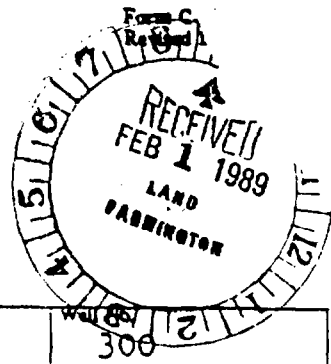

Operator Meridian Oil Inc.		Lease Delhi Com (B-10938-34)		Well No. 300
Unit Letter M	Section 16	Township 30 North	Range 8 West	County San Juan

Actual Footage Location of Well: 570 feet from the South line and 185 feet from the West line				
Ground level Elev. 5750'	Producing Formation Fruitland Coal	Pool Basin	Dedicated Acreage: 320 Acres	

- Outline the acreage dedicated to the subject well by colored pencil or hatchure marks on the plat below.
- If more than one lease is dedicated to the well, outline each and identify the ownership thereof (both as to working interest and royalty).
- If more than one lease of different ownership is dedicated to the well, have the interest of all owners been consolidated by communitization, unitization, force-pooling, etc.?
☐ Yes ☐ No If answer is "yes" type of consolidation _____
If answer is "no" list the owners and tract descriptions which have actually been consolidated. (Use reverse side of this form if necessary).
No allowable will be assigned to the well until all interests have been consolidated (by communitization, unitization, forced-pooling, or otherwise) or until a non-standard unit, eliminating such interest, has been approved by the Division.

* Non-standard due to terrain & existing or proposed camp-grounds.

Reissued to show moved location

FLOOD AREA
+ PROPOSED - CAMPSITES

SAN JUAN RIVER

N-89°30'-W
185'

FLOOD AREA

570'
N-34°E

OPERATOR CERTIFICATION

I hereby certify that the information contained herein is true and complete to the best of my knowledge and belief.

Signature
Peggy Bradfield
Printed Name
Regulatory Affairs
Position
Meridian Oil Inc.
Company

Date

SURVEYOR CERTIFICATION

I hereby certify that the well location shown on this plat was plotted from field notes of actual surveys made by me or under my supervision, and that the same is true and correct to the best of my knowledge and belief.

1-30-89

Date Surveyed
Nesley C. Edwards

Signature & Seal of
Professional Surveyor

Certificate No. 6857

MERIDIAN OIL

March 6. 1989

Mr. William LeMay
New Mexico Oil Conservation Division
Post Office Box 2088
Santa Fe, New Mexico 87504

Dear Mr. LeMay:

Application was made for an unorthodox location for the Meridian Oil Inc. Delhi Com #300 on February 10, 1989. Please cancel this application, as this location has been moved to 1780' South and 1500' West of Section 16, T-30-N, R- 8-W, San Juan County, New Mexico.

Thank you for your consideration.

Sincerely,

Peggy Bradfield

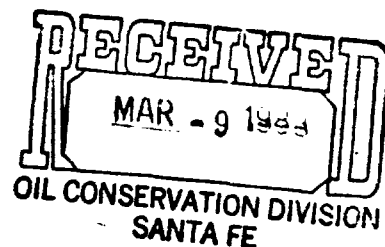



STATE OF NEW MEXICO

ENERGY, MINERALS AND NATURAL RESOURCES DEPARTMENT

OIL CONSERVATION DIVISION

GARREY CARRUTHERS
GOVERNOR

POST OFFICE BOX 2088
STATE LAND OFFICE BUILDING
SANTA FE, NEW MEXICO 87504
(505) 827-5800

March 2, 1989

Meridian Oil, Inc.
P.O. Box 4289
Farmington, NM 87499-4289

Attention: Peggy Bradfield

RE: Administrative Application for
an Unorthodox Coal Gas Well
Location; Delhi Com Well No.
300, M-16-30N-8W, Basin
Fruitland Coal (Gas) Pool.

Dear Ms. Bradfield:

The proposed well location seems somewhat extreme considering there is no additional information to support this move. Please explain as to why Meridian cannot locate this well on the existing well pad for the Delhi Com Well No. 1 located 1650 feet from the South and West lines (Unit K) of said Section 16. Also, submit a copy of the U.S.G.S. Topographical Map of this area and copies of any correspondence from other federal and/or state agencies requesting you to move to this particular location.

If this information has not been received by this office within 15 days from the date of this letter, this matter will be set for hearing before an examiner on the next available docket.

Thank you for your cooperation in this matter.

Sincerely,

A handwritten signature in black ink, appearing to read "Michael E. Stogner".

Michael E. Stogner
Chief Hearing Officer

MES/ag

cc: Oil Conservation Division - Aztec
W. Thomas Kellahin

February 10, 1989

vision

Received
2/13/89

angle 8W

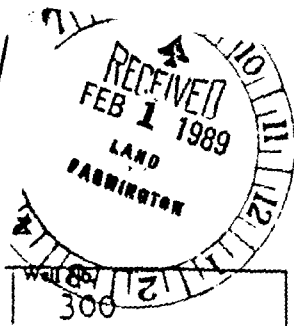

Juan

st line

Dedicated Acreage:

320 Acres

rest and royalty).

d by communitization.

forced-pooling, or otherwise)

OPERATOR CERTIFICATION

I hereby certify that the information contained herein is true and complete to the best of my knowledge and belief.

Signature

Peggy Bradfield

Printed Name

Regulatory Affairs

Position

Meridian Oil Inc.

Company

Date

SURVEYOR CERTIFICATION

I hereby certify that the well location shown on this plat was plotted from field notes of actual surveys made by me or under my supervision, and that the same is true and correct to the best of my knowledge and belief.

1-30-89

Date Surveyed

Neal C. Kowalski

Signature or Seal of Professional Surveyor

Certificate No.

6857

000 500 0

ative approval for an unorthodox
ruitland Coal Pool.
idian Oil Inc. Delhi Com #300 at
' from the West line of Section
y, New Mexico.
River, and existing or proposed
essary.

g submitted to all offset
request that they furnish your
jection, and return one copy to
ation and the terrain in
plat, are attached.

on to Meridian Oil Inc.'s
r their Delhi Com #300 as

Telephone 505-327-0251