



Production Department
Hobbs Division
North American Production

Conoco Inc.
726 East Michigan
P.O. Box 460
Hobbs, NM 88241
(505) 397-5800

July 24, 1989

RECEIVED

JUL 28 1989

OIL CONSERVATION DIV.
SANTA FE

Mr. Michael Stogner
New Mexico Oil Conservation Division
P.O. Box 2088
Santa Fe, New Mexico 87504

Dear Mr. Stogner:

Request For Unorthodox Location,
West Knowles Well No. 11, Shipp
Stawn Pool, Lea County, New Mexico

Case 9728

Attached are three copies of Conoco Inc's. Application for Hearing for the subject well. We respectfully request that this case be placed on the Examiner docket for August 23, 1989.

Copies of this Application are being sent to all known offset operators notifying them of this request.

Yours very truly,

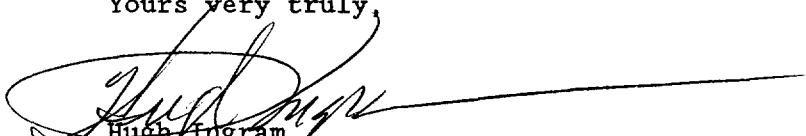
Hugh Ingram
Conservation Coordinator

tm

cc: Amerind Oil Company
500 Wilco Building
Midland, TX 79701

Chevron USA, Inc.
P.O. Box 670
Hobbs, NM 88240

Union Texas Petroleum Co.
1330 Post Oak Blvd.
P.O. Box 2120
Houston, TX 77252

BP Exploration Inc.
5151 San Felipe
Houston, TX 77056

Pennzoil Expl. & Prod. Co.
P.O. Box 2967
Houston, TX 77252

BEFORE THE OIL CONSERVATION DIVISION
OF THE
ENERGY, MINERALS, AND NATURAL RESOURCES DEPARTMENT

IN THE MATTER OF THE APPLICATION OF
CONOCO INC. FOR APPROVAL TO DRILL AND
COMPLETE AS A STRAWN OIL WELL ITS WEST
KNOWLES WELL NO. 11 AT AN UNORTHODOX
LOCATION 660' FSL AND 330' FEL OF SECTION
34, T-16-S, R-37-E, LEA COUNTY, NEW MEXICO
AND TO DEDICATE THE S/2 SE/4 OF SAID SECTION
TO THIS WELL

Case 9728

A P P L I C A T I O N

Applicant, Conoco Inc., respectfully requests authority to drill and equip for production its West Knowles Well No. 11 at an unorthodox location for a well in the Shipp Strawn Pool, being 660' FSL and 330' FEL of Section 34, T-16-S, R-37-E, Lea County, New Mexico and dedicate the S/2 SE/4 consisting of 80 acres to said well, and in support thereof will show:

1. Conoco Inc. is operator and co-owner of the West Knowles Lease consisting of, among other lands, the E/2 of Section 34, T-16-S, R-37E, Lea County, New Mexico.

2. Applicant intends to drill and complete as a Strawn oil well its West Knowles Well No. 11 at an unorthodox location 660' FSL and 330' FEL of said Section 34.

3. That special pool rules for the Shipp Strawn Pool call for 80-acre proration units and wells to be drilled within 150' of center of the quarter/quarter section.

4. That for geologic reasons, said well should be drilled at an unorthodox location in order to optimize the chances for a successful completion.

5. That granting this Application will prevent waste and will not impair the correlative rights of any party.

WHEREFORE, Applicant respectfully requests that this application be set for hearing before the Division's duly appointed Examiner on August 9, 1989, and upon that hearing, an order be entered authorizing the operator to drill and produce said well at the requested unorthodox location.

Respectfully submitted,

Conoco Inc.

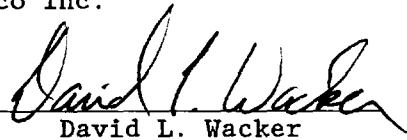
By 
David L. Wacker

Division Manager, Exploration
and Production
Hobbs Division

HAI/tm

Submit to Appropriate
District Office
State Lease - 4 copies
Fee Lease - 3 copies

State of New Mexico
Energy, Minerals and Natural Resources Department

Form C-102
Revised 1-1-89

OIL CONSERVATION DIVISION

DISTRICT I
P.O. Box 1980, Hobbs, NM 88240

P.O. Box 2088
Santa Fe, New Mexico 87504-2088

DISTRICT II
P.O. Drawer DD, Artesia, NM 88210

DISTRICT III
1000 Rio Brazos Rd., Aztec, NM 87410

WELL LOCATION AND ACREAGE DEDICATION PLAT

All Distances must be from the outer boundaries of the section

Operator Conoco, Inc.			Lease West Knowles		Well No. 11
Unit Letter P	Section 34	Township 16 South	Range 27 East	County NMPM	Lea
Actual Footage Location of Well: 660 feet from the South line and 330 feet from the East line					
Ground level Elev. 3765.5	Producing Formation		Pool	Dedicated Acreage: Acres	

- Outline the acreage dedicated to the subject well by colored pencil or hatchure marks on the plat below.
- If more than one lease is dedicated to the well, outline each and identify the ownership thereof (both as to working interest and royalty).
- If more than one lease of different ownership is dedicated to the well, have the interest of all owners been consolidated by communitization, unitization, force-pooling, etc.?
☐ Yes ☐ No If answer is "yes" type of consolidation _____
If answer is "no" list the owners and tract descriptions which have actually been consolidated. (Use reverse side of this form if necessary). _____
No allowable will be assigned to the well until all interests have been consolidated (by communitization, unitization, forced-pooling, or otherwise) or until a non-standard unit, eliminating such interest, has been approved by the Division.

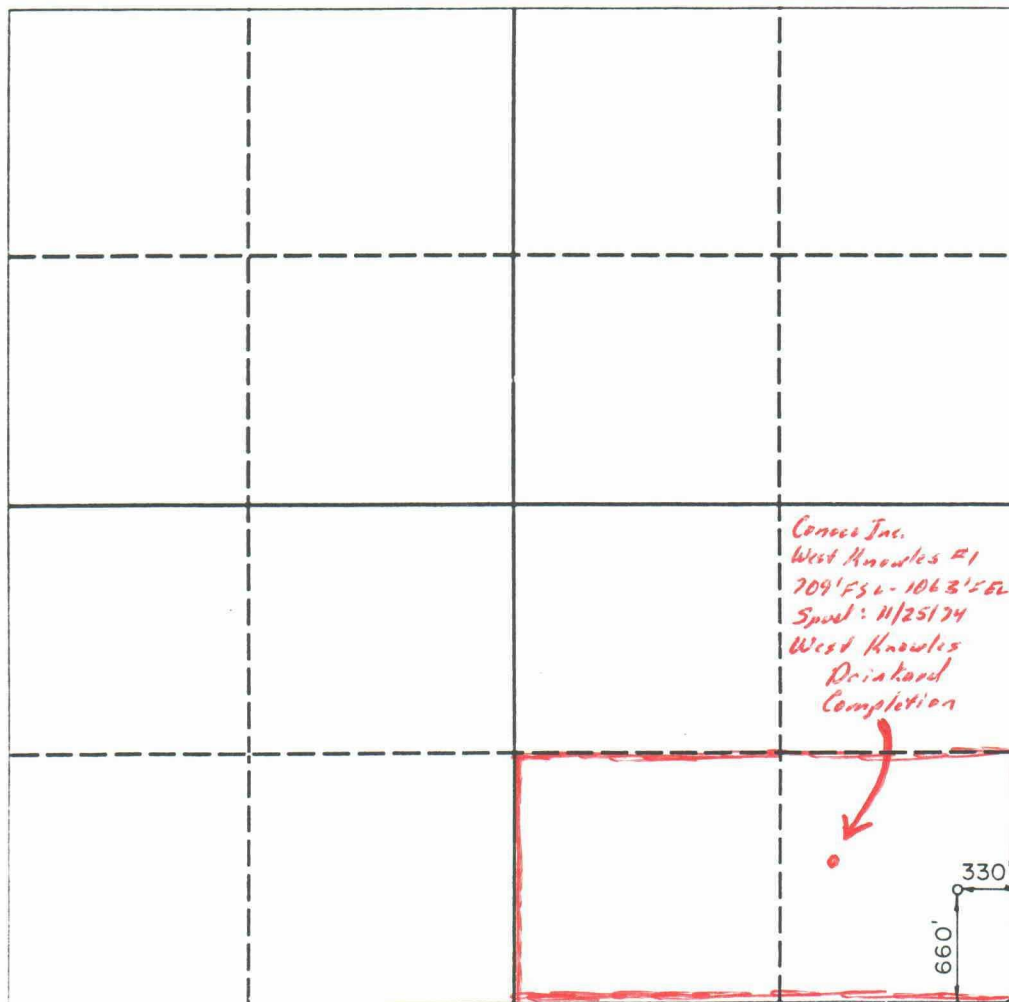

OPERATOR CERTIFICATION

I hereby certify that the information contained herein is true and complete to the best of my knowledge and belief.

Signature

Printed Name

Position

Company

Date

SURVEYOR CERTIFICATION

I hereby certify that the well location shown on this plat was plotted from field notes of actual surveys made by me or under my supervision, and that the same is true and correct to the best of my knowledge and belief.

Date Surveyed

June 22, 1983

Signature & Seal of
Professional Surveyor

Certificate No. 676
RONALD J. ETISON 3239

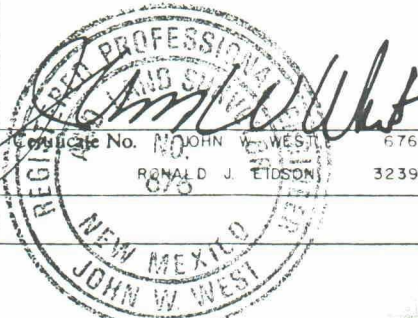

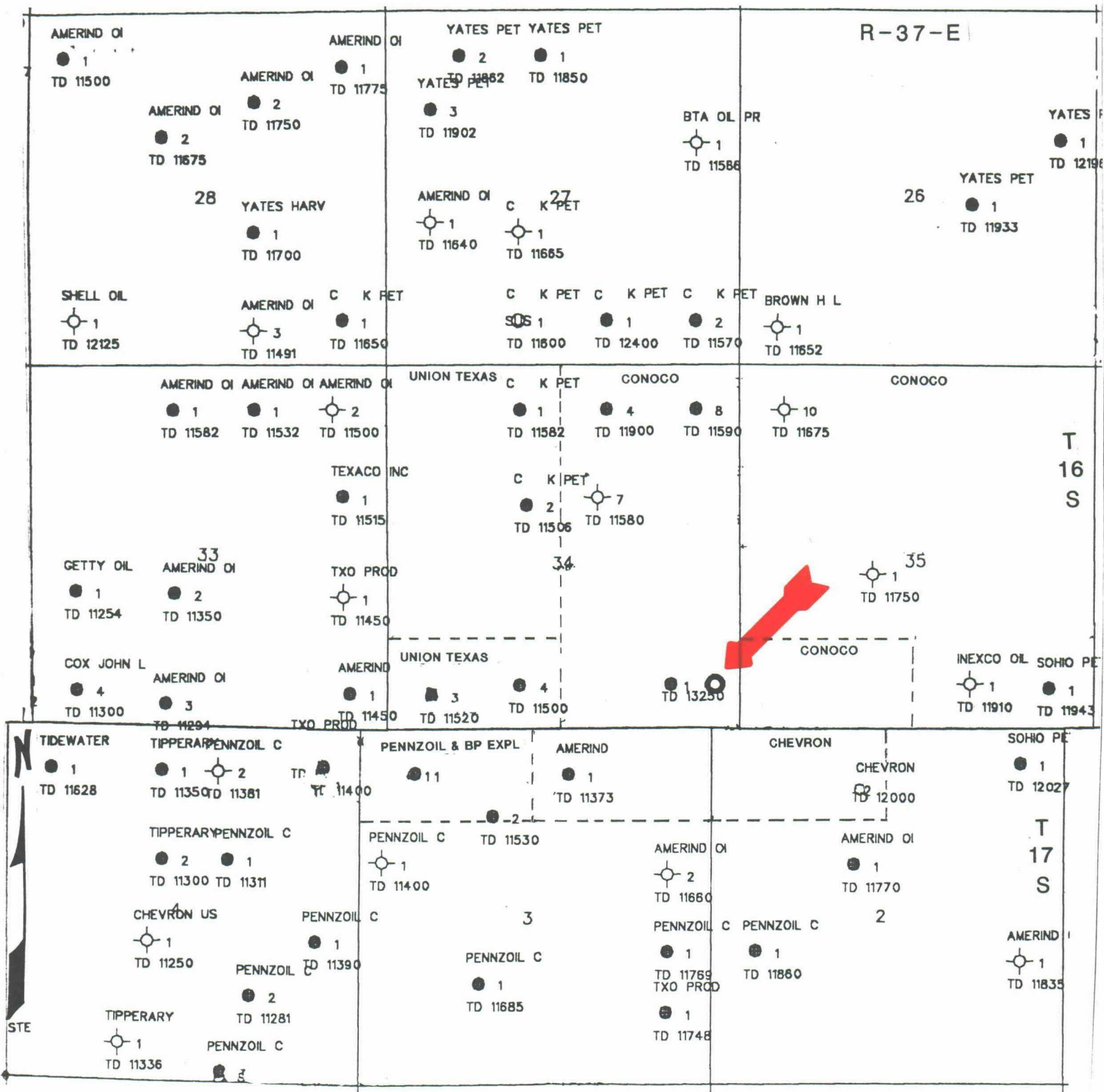

E&P NA



HOBBS
DIVISION

LEA COUNTY, NEW MEXICO

conoco

Production Department
Hobbs Division
North American Production

Conoco Inc.
726 East Michigan
P.O. Box 460
Hobbs, NM 88241
(505) 397-5800

July 24, 1989

Mr. Michael Stogner
New Mexico Oil Conservation Division
P.O. Box 2088
Santa Fe, New Mexico 87504

Dear Mr. Stogner:

Request For Unorthodox Location,
West Knowles Well No. 11, Shipp
Stawn Pool, Lea County, New Mexico

Case 9728

Attached are three copies of Conoco Inc's. Application for Hearing for the subject well. We respectfully request that this case be placed on the Examiner docket for August 23, 1989.

Copies of this Application are being sent to all known offset operators notifying them of this request.

Yours very truly,

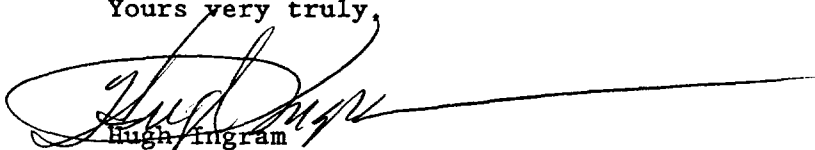

Hugh Ingram

Conservation Coordinator

tm

cc: Amerind Oil Company
500 Wilco Building
Midland, TX 79701

Chevron USA, Inc.
P.O. Box 670
Hobbs, NM 88240

Union Texas Petroleum Co.
1330 Post Oak Blvd.
P.O. Box 2120
Houston, TX 77252

BP Exploration Inc.
5151 San Felipe
Houston, TX 77056

Pennzoil Expl. & Prod. Co.
P.O. Box 2967
Houston, TX 77252

BEFORE THE OIL CONSERVATION DIVISION
OF THE
ENERGY, MINERALS, AND NATURAL RESOURCES DEPARTMENT

IN THE MATTER OF THE APPLICATION OF
CONOCO INC. FOR APPROVAL TO DRILL AND
COMPLETE AS A STRAWN OIL WELL ITS WEST
KNOWLES WELL NO. 11 AT AN UNORTHODOX
LOCATION 660' FSL AND 330' FEL OF SECTION
34, T-16-S, R-37-E, LEA COUNTY, NEW MEXICO
AND TO DEDICATE THE S/2 SE/4 OF SAID SECTION
TO THIS WELL

Case 9728

A P P L I C A T I O N

Applicant, Conoco Inc., respectfully requests authority to drill and equip for production its West Knowles Well No. 11 at an unorthodox location for a well in the Shipp Strawn Pool, being 660' FSL and 330' FEL of Section 34, T-16-S, R-37-E, Lea County, New Mexico and dedicate the S/2 SE/4 consisting of 80 acres to said well, and in support thereof will show:

1. Conoco Inc. is operator and co-owner of the West Knowles Lease consisting of, among other lands, the E/2 of Section 34, T-16-S, R-37E, Lea County, New Mexico.

2. Applicant intends to drill and complete as a Strawn oil well its West Knowles Well No. 11 at an unorthodox location 660' FSL and 330' FEL of said Section 34.

3. That special pool rules for the Shipp Strawn Pool call for 80-acre proration units and wells to be drilled within 150' of center of the quarter/quarter section.

4. That for geologic reasons, said well should be drilled at an unorthodox location in order to optimize the chances for a successful completion.

5. That granting this Application will prevent waste and will not impair the correlative rights of any party.

WHEREFORE, Applicant respectfully requests that this application be set for hearing before the Division's duly appointed Examiner on August 9, 1989, and upon that hearing, an order be entered authorizing the operator to drill and produce said well at the requested unorthodox location.

Respectfully submitted,

Conoco Inc.

By

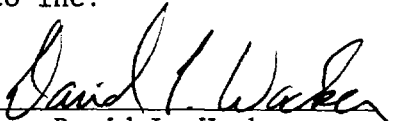
David L. Wacker

Division Manager, Exploration
and Production
Hobbs Division

HAI/tm

Submit to Appropriate
District Office
State Lease - 4 copies
Fee Lease - 3 copies

State of New Mexico
Energy, Minerals and Natural Resources Department

Form C-102
Revised 1-1-89

OIL CONSERVATION DIVISION

DISTRICT I
P.O. Box 1980, Hobbs, NM 88240

P.O. Box 2088

Santa Fe, New Mexico 87504-2088

DISTRICT II
P.O. Drawer DD, Artesia, NM 88210

DISTRICT III
1000 Rio Brazos Rd., Aztec, NM 87410

WELL LOCATION AND ACREAGE DEDICATION PLAT

All Distances must be from the outer boundaries of the section

Operator Conoco, Inc.		Lease West Knowles		Well No. 11
Unit Letter P	Section 24	Township 10 South	Range 27 East	County NMPM
Actual Footage Location of Well: 560 feet from the South line and 330 feet from the East line				
Ground level Elev. 3765.5	Producing Formation		Pool	Dedicated Acreage: Acres

1. Outline the acreage dedicated to the subject well by colored pencil or hatchure marks on the plat below.
2. If more than one lease is dedicated to the well, outline each and identify the ownership thereof (both as to working interest and royalty).
3. If more than one lease of different ownership is dedicated to the well, have the interest of all owners been consolidated by communitization, unitization, force-pooling, etc.?
☐ Yes ☐ No If answer is "yes" type of consolidation _____
If answer is "no" list the owners and tract descriptions which have actually been consolidated. (Use reverse side of this form if necessary.) _____
No allowable will be assigned to the well until all interests have been consolidated (by communitization, unitization, forced-pooling, or otherwise) or until a non-standard unit, eliminating such interest, has been approved by the Division.

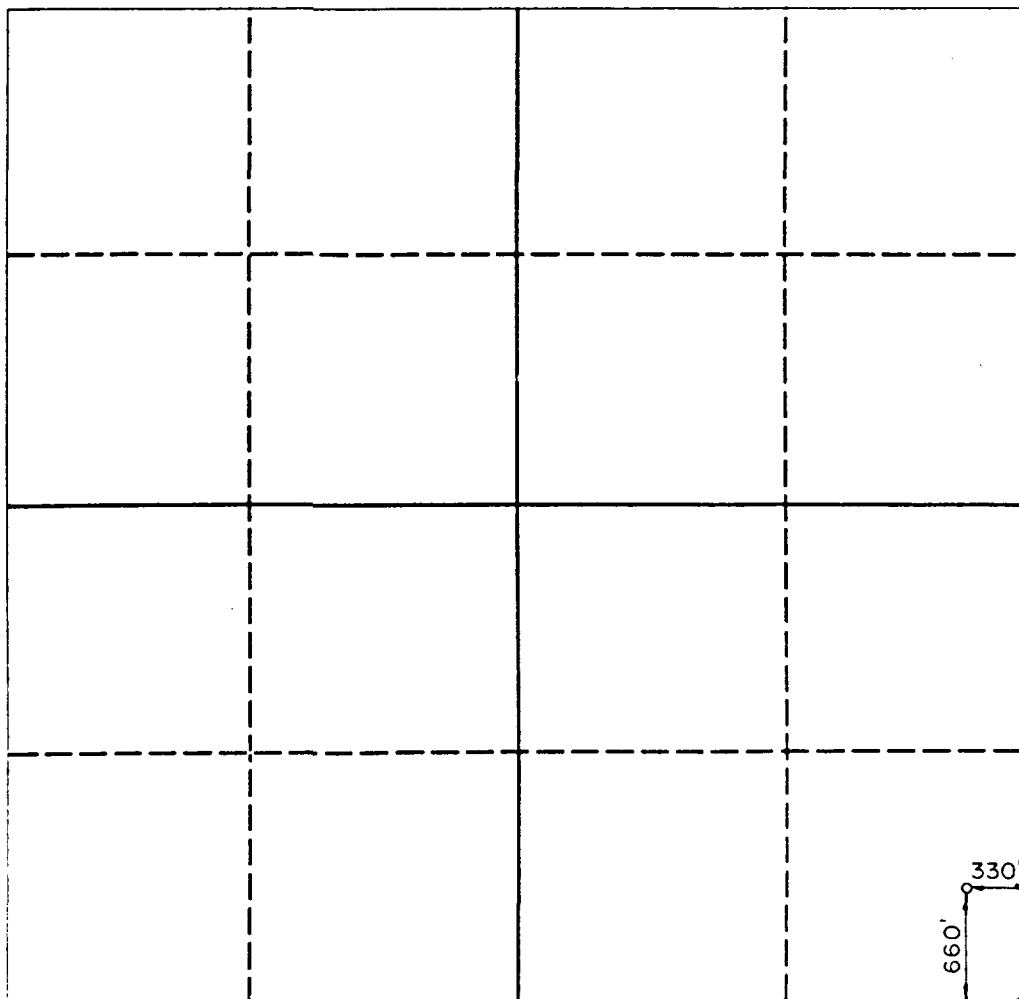

OPERATOR CERTIFICATION

I hereby certify that the information contained herein is true and complete to the best of my knowledge and belief.

Signature

Printed Name

Position

Company

Date

SURVEYOR CERTIFICATION

I hereby certify that the well location shown on this plat was plotted from field notes of actual surveys made by me or under my supervision, and that the same is true and correct to the best of my knowledge and belief.

Date Surveyed

June 22, 1989

Signature & Seal of
Professional Surveyor

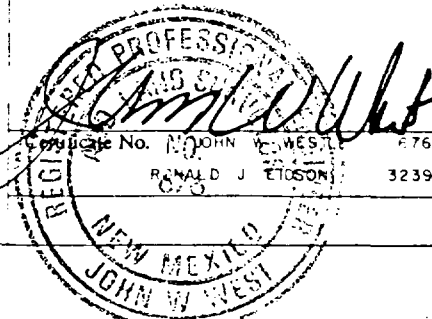

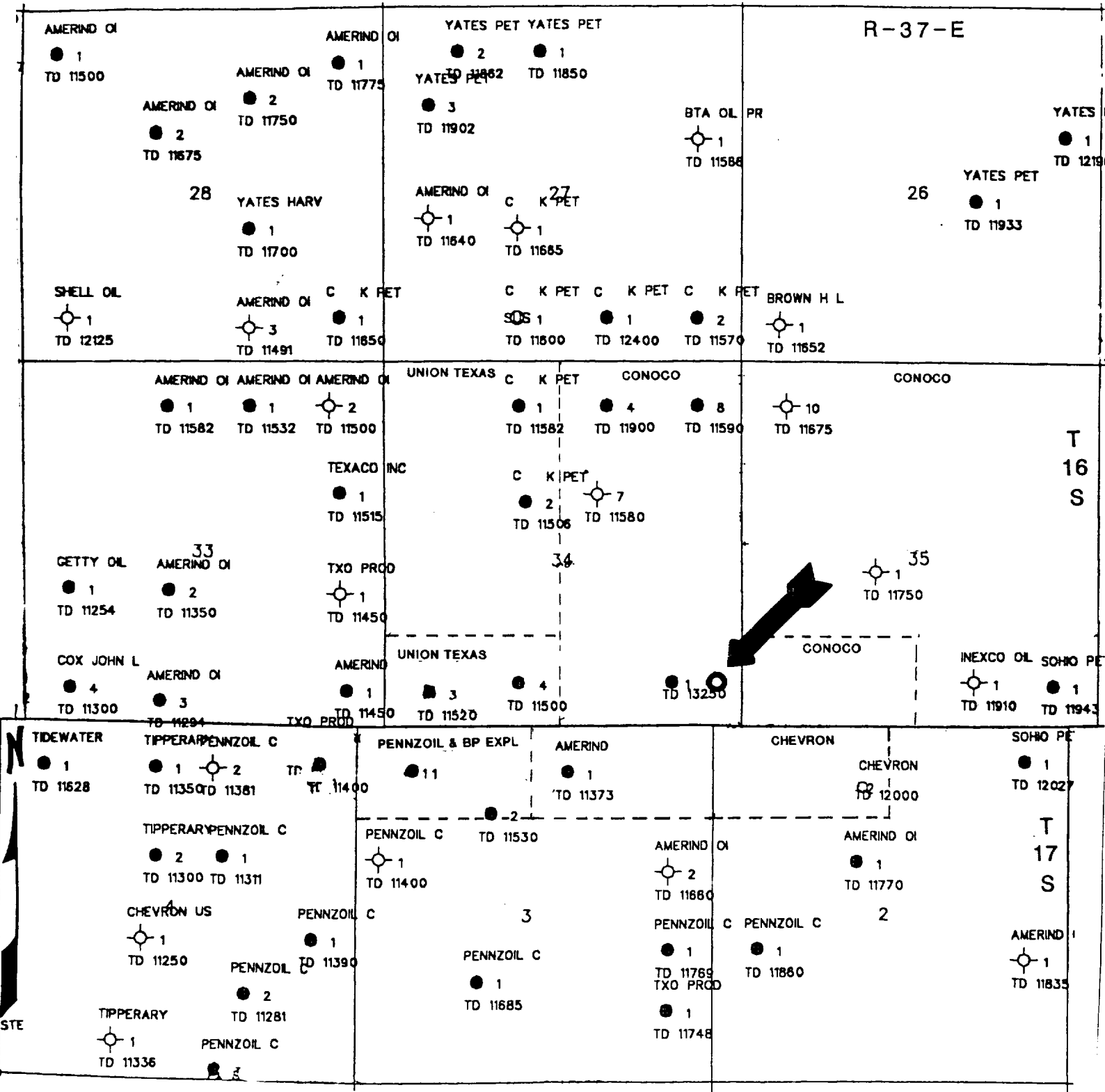

E&P NA



HOBBS
DIVISION

LEA COUNTY, NEW MEXICO



Production Department
Hobbs Division
North American Production

Conoco Inc.
726 East Michigan
P.O. Box 460
Hobbs, NM 88241
(505) 397-5800

July 24, 1989

Mr. Michael Stogner
New Mexico Oil Conservation Division
P.O. Box 2088
Santa Fe, New Mexico 87504

Case 9728

Dear Mr. Stogner:

Request For Unorthodox Location,
West Knowles Well No. 11, Shipp
Stawn Pool, Lea County, New Mexico

Attached are three copies of Conoco Inc's. Application for Hearing for the subject well. We respectfully request that this case be placed on the Examiner docket for August 23, 1989.

Copies of this Application are being sent to all known offset operators notifying them of this request.

Yours very truly,

Hugh Ingram
Conservation Coordinator

tm

cc: Amerind Oil Company
500 Wilco Building
Midland, TX 79701

BP Exploration Inc.
5151 San Felipe
Houston, TX 77056

Chevron USA, Inc.
P.O. Box 670
Hobbs, NM 88240

Pennzoil Expl. & Prod. Co.
P.O. Box 2967
Houston, TX 77252

Union Texas Petroleum Co.
1330 Post Oak Blvd.
P.O. Box 2120
Houston, TX 77252

BEFORE THE OIL CONSERVATION DIVISION
OF THE
ENERGY, MINERALS, AND NATURAL RESOURCES DEPARTMENT

IN THE MATTER OF THE APPLICATION OF
CONOCO INC. FOR APPROVAL TO DRILL AND
COMPLETE AS A STRAWN OIL WELL ITS WEST
KNOWLES WELL NO. 11 AT AN UNORTHODOX
LOCATION 660' FSL AND 330' FEL OF SECTION
34, T-16-S, R-37-E, LEA COUNTY, NEW MEXICO
AND TO DEDICATE THE S/2 SE/4 OF SAID SECTION
TO THIS WELL

Case 9728

A P P L I C A T I O N

Applicant, Conoco Inc., respectfully requests authority to drill and equip for production its West Knowles Well No. 11 at an unorthodox location for a well in the Shipp Strawn Pool, being 660' FSL and 330' FEL of Section 34, T-16-S, R-37-E, Lea County, New Mexico and dedicate the S/2 SE/4 consisting of 80 acres to said well, and in support thereof will show:

1. Conoco Inc. is operator and co-owner of the West Knowles Lease consisting of, among other lands, the E/2 of Section 34, T-16-S, R-37E, Lea County, New Mexico.

2. Applicant intends to drill and complete as a Strawn oil well its West Knowles Well No. 11 at an unorthodox location 660' FSL and 330' FEL of said Section 34.

3. That special pool rules for the Shipp Strawn Pool call for 80-acre proration units and wells to be drilled within 150' of center of the quarter/quarter section.

4. That for geologic reasons, said well should be drilled at an unorthodox location in order to optimize the chances for a successful completion.

5. That granting this Application will prevent waste and will not impair the correlative rights of any party.

WHEREFORE, Applicant respectfully requests that this application be set for hearing before the Division's duly appointed Examiner on August 9, 1989, and upon that hearing, an order be entered authorizing the operator to drill and produce said well at the requested unorthodox location.

Respectfully submitted,

Conoco Inc.

By

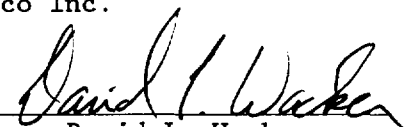
David L. Wacker

Division Manager, Exploration
and Production
Hobbs Division

HAI/tm

Submit to Appropriate
District Office
State Lease - 4 copies
Fee Lease - 3 copies

State of New Mexico
Energy, Minerals and Natural Resources Department

Form C-102
Revised 1-1-89

OIL CONSERVATION DIVISION

DISTRICT I
P.O. Box 1980, Hobbs, NM 88240

P.O. Box 2088

Santa Fe, New Mexico 87504-2088

DISTRICT II
P.O. Drawer DD, Artesia, NM 88210

DISTRICT III
1000 Rio Brazos Rd., Aztec, NM 87410

WELL LOCATION AND ACREAGE DEDICATION PLAT

All Distances must be from the outer boundaries of the section

Operator Conoco, Inc.			Lease West Knowles		Well No. 11
Unit Letter P	Section 24	Township 16 South	Range 27 East	County NMPM	Lea
Actual Footage Location of Well: 550 feet from the South line and 330 feet from the East line					
Ground level Elev. 3755.5	Producing Formation		Pool	Dedicated Acreage: Acres	

1. Outline the acreage dedicated to the subject well by colored pencil or hatchure marks on the plat below.
2. If more than one lease is dedicated to the well, outline each and identify the ownership thereof (both as to working interest and royalty).
3. If more than one lease of different ownership is dedicated to the well, have the interest of all owners been consolidated by communitization, unitization, force-pooling, etc.?
☐ Yes ☐ No If answer is "yes" type of consolidation _____
If answer is "no" list the owners and tract descriptions which have actually been consolidated. (Use reverse side of this form if necessary.) _____
No allowable will be assigned to the well until all interests have been consolidated (by communitization, unitization, forced-pooling, or otherwise) or until a non-standard unit, eliminating such interest, has been approved by the Division.

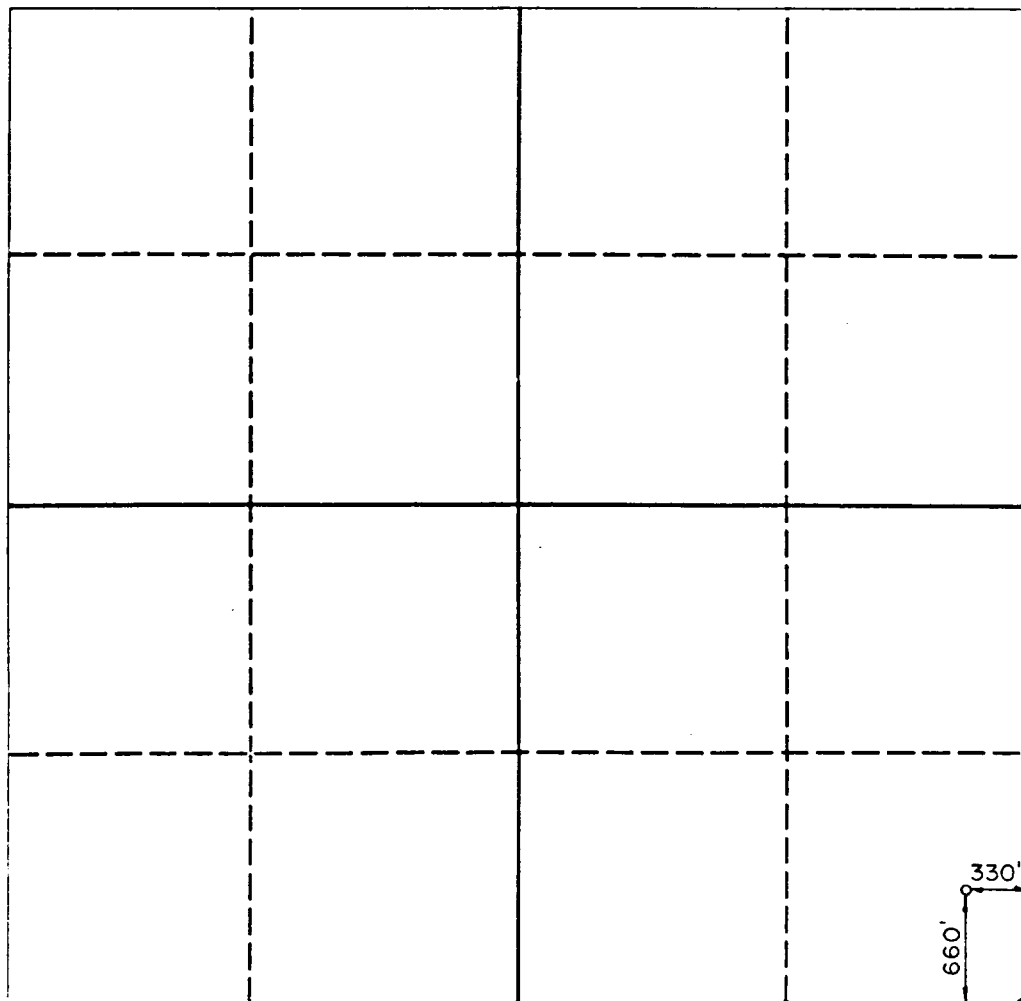

OPERATOR CERTIFICATION

I hereby certify that the information contained herein is true and complete to the best of my knowledge and belief.

Signature

Printed Name

Position

Company

Date

SURVEYOR CERTIFICATION

I hereby certify that the well location shown on this plat was plotted from field notes of actual surveys made by me or under my supervision, and that the same is true and correct to the best of my knowledge and belief.

Date Surveyed

June 22, 1989

Signature & Seal of
Professional Surveyor

Professional Surveyor
Certificate No. JOHN W. WEST 676
RONALD J. EDSON 3239
NEW MEXICO
JOHN W. WEST

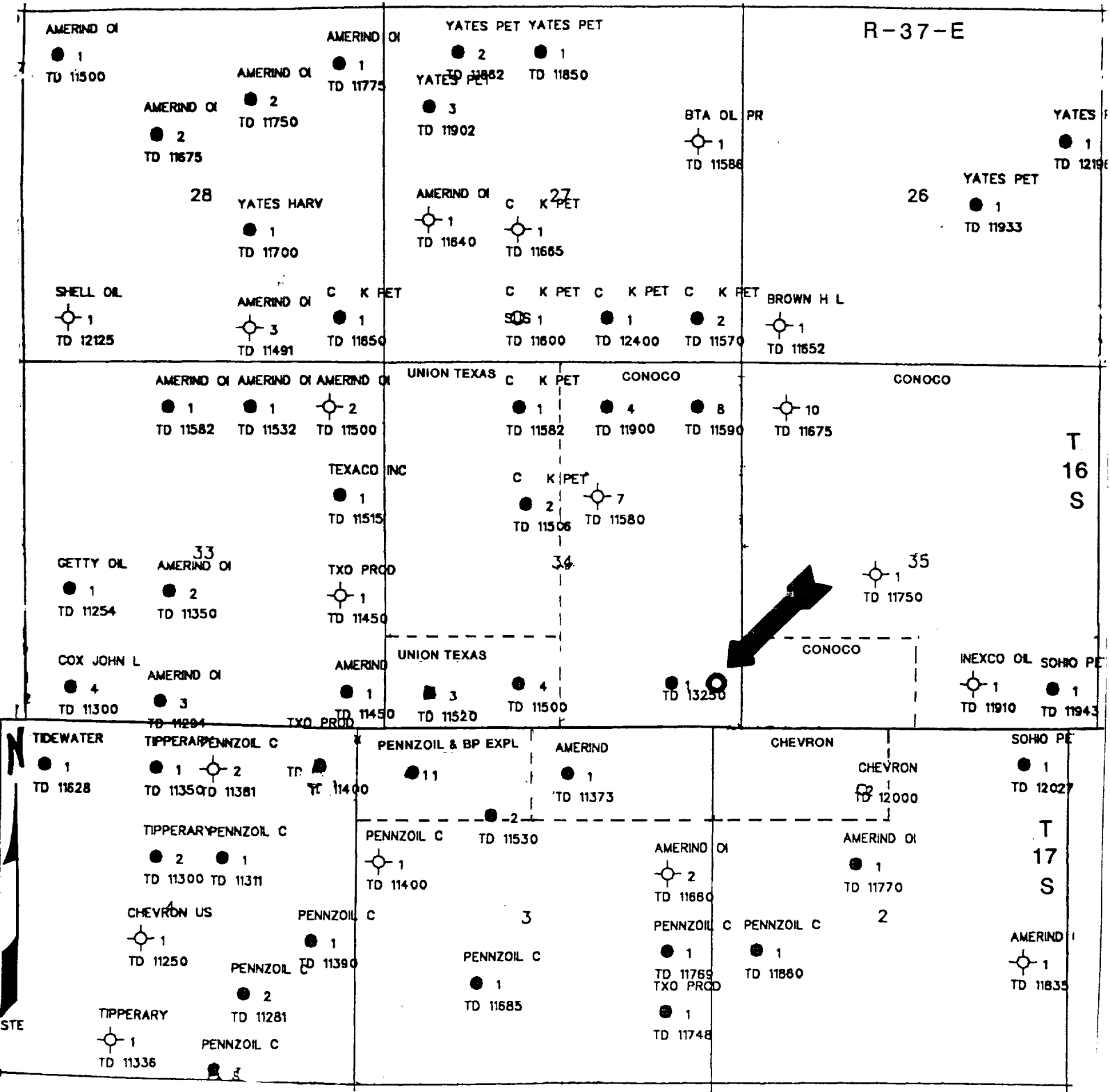

COUNTY Lea

POOL

Casey - StrawnTOWNSHIP 16 SouthRANGE 37 East

NMPM

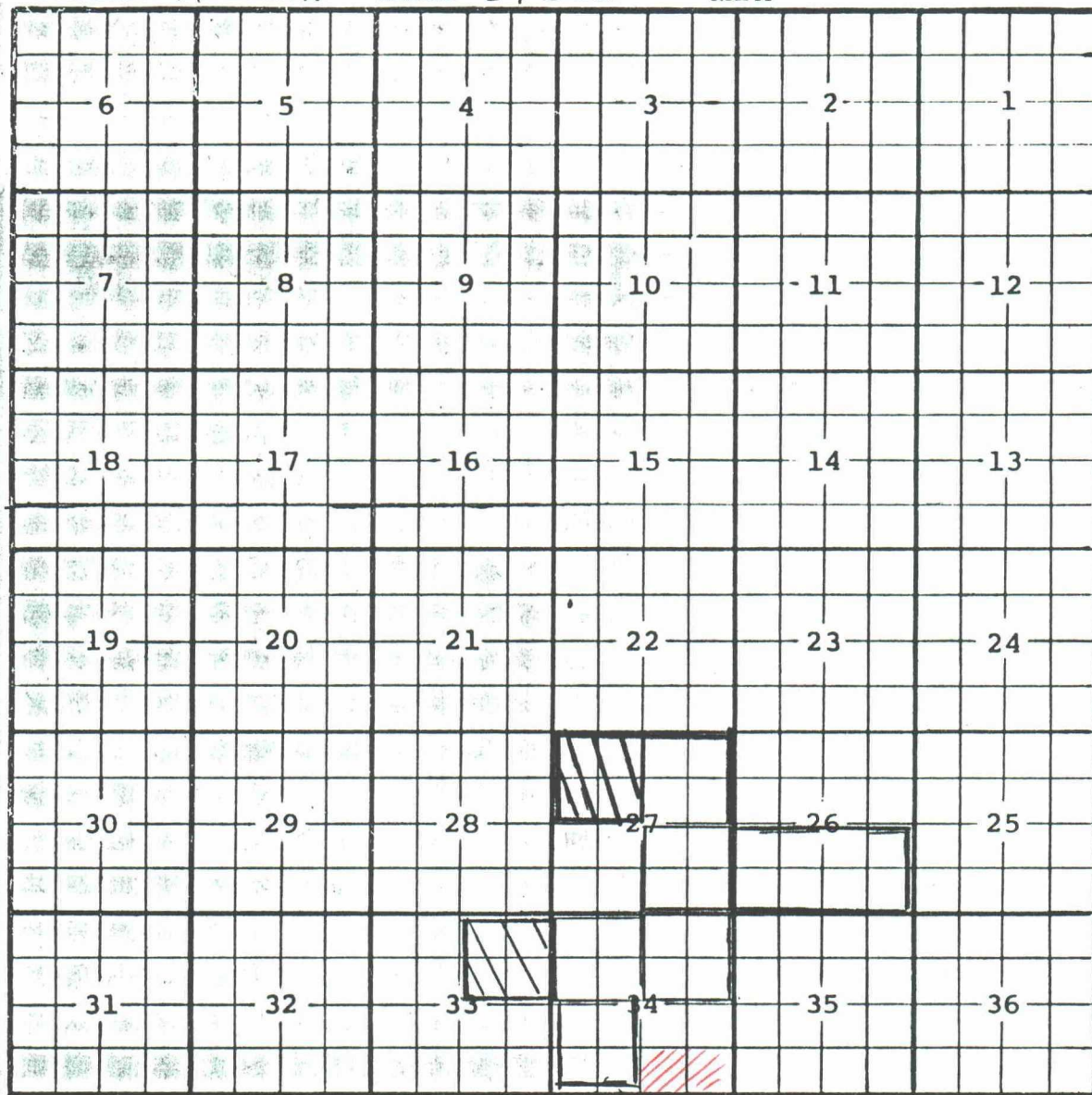
Description: $\frac{SE}{4}$ Sec 27 (R-4992, 4-1-75)Ext: $\frac{NE}{4}$ Sec 34 (R-5081, 9-1-75) Ext: $\frac{NW}{4}$ Sec 34 (R-5124, 12-1-75)Ext: $\frac{NE}{4}$ Sec. 33 (R-7279, 5-17-83) Ext: $\frac{N}{2}$ Sec. 27 (R-7667, 9-21-84)Delete $\frac{NW}{4}$ sec. 27 (R-7996, 8-6-85)Delete $\frac{NE}{4}$ Sec. 33 (R-8182, 3-11-86) Ext: $\frac{SW}{4}$ Sec. 34 (R-8451, 6-3-87)EXT: $\frac{S}{2}$ SEC 26 (R-8603, 7/19/88)

80 acres

County Lea Pool Ship-Strawn

TOWNSHIP 16 South Range 32 East NMPM

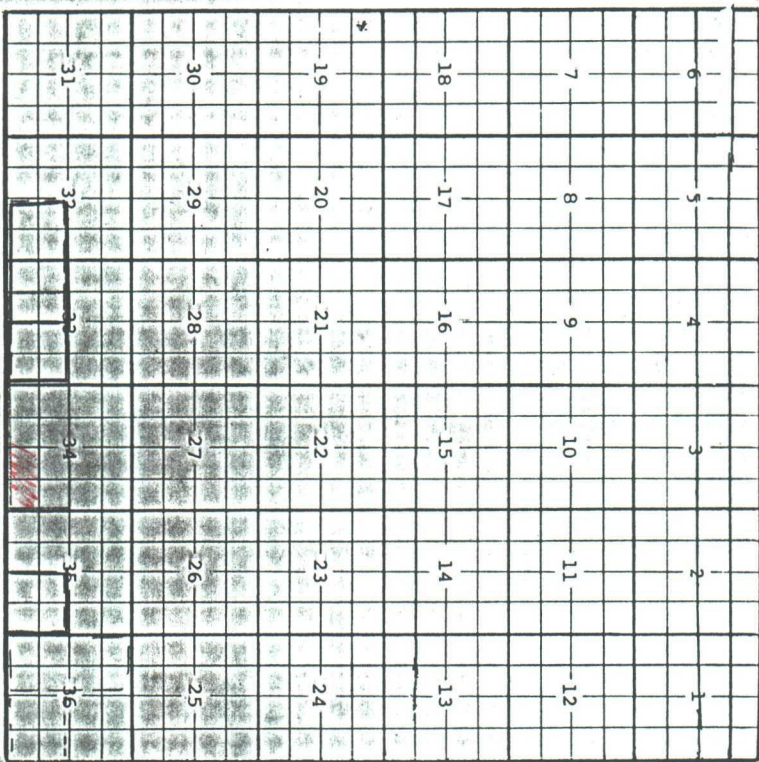
Description: $\frac{1}{4}$ and $\frac{1}{2}$ sec. 33, $\frac{1}{2}$ sec. 34 (R-8062, 10-3-85)Amend horizontal limits to include $\frac{1}{2}$ and $\frac{1}{4}$ sec. 4 and 7, 125,R-87E (R-8062-A, 1-21-86) EXT: $\frac{1}{4}$ sec. 33 (R-8513, 9-18-85)EXT: $\frac{1}{4}$ sec. 32, $\frac{1}{4}$ sec. 33 (R-8403, 7-19-88) EXT: $\frac{1}{4}$ sec. 35 (R-8402, 7-10-88)

80 acres

County Lea Pool Ship-Strawn

TOWNSHIP 17 South Range 32 East NMPM

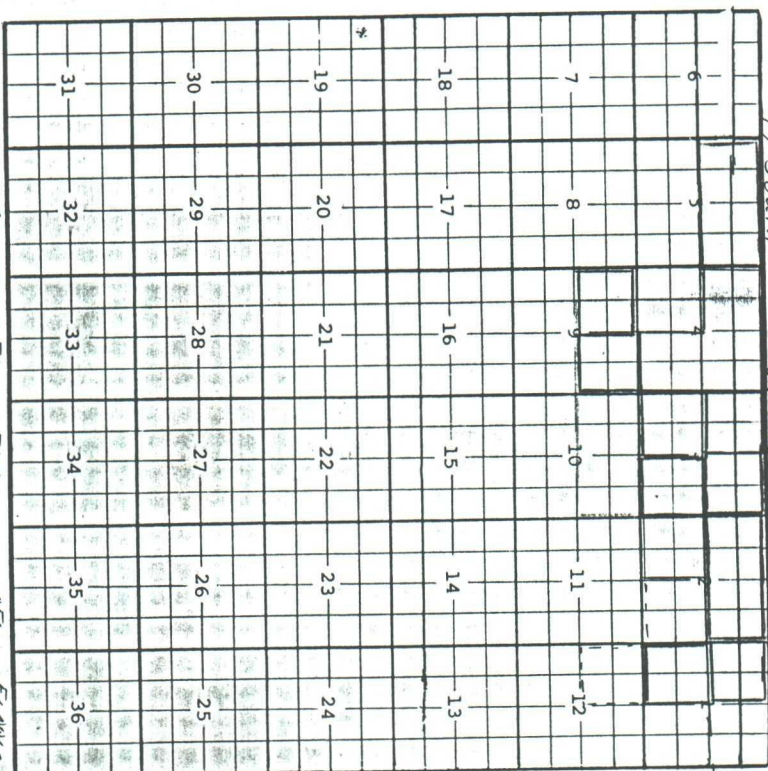
Description: All sec. 3, $\frac{1}{2}$ and $\frac{1}{4}$ sec. 4, $\frac{1}{4}$ and $\frac{1}{2}$ sec. 5, $\frac{1}{2}$ sec. 10 (R-8062, 10-3-85)Amend horizontal limits to be $\frac{1}{2}$ and $\frac{1}{4}$ sec. 4 (R-8062-A, 1-21-86)EXT: $\frac{1}{4}$ sec. 9 (R-8214, 5-1-86) EXT: $\frac{1}{4}$ sec. 9 (R-8340, 11-3-86)EXT: $\frac{1}{4}$ sec. 3 (R-8409, 3-7-87) EXT: $\frac{1}{4}$ sec. 3 (R-8451, 6-3-87)EXT: $\frac{1}{4}$ sec. 3 (R-8533, 10-28-87) EXT: $\frac{1}{2}$ sec. 5 (R-8403, 7-19-88)EXT: $\frac{1}{2}$ sec. 2, $\frac{1}{4}$ sec. 3 (R-8626, 4-1-88) EXT: $\frac{1}{4}$ sec. 2 (R-8556, 1-25-88)EXT: $\frac{1}{4}$ sec. 1 (R-8701, 4-1-89)

County Lea Pool Shipp-Strawn

80 acres

TOWNSHIP 16 South Range 32 East NMPM

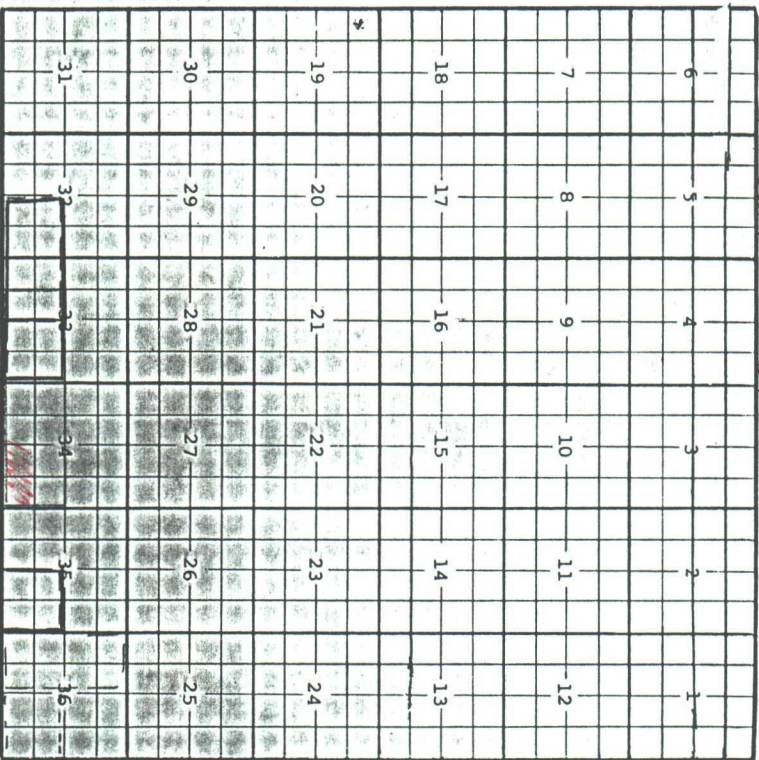

Description: $\frac{1}{4}$ Sec 34 and $\frac{1}{4}$ Sec 35 (R-8062, 10-31-85)

Amend horizontal limits to include $\frac{1}{4}$ Sec 34 and $\frac{1}{4}$ Sec 35 (R-8062, 10-31-85)

R-8062-1-A, 1-21-86) EXT: $\frac{1}{4}$ Sec 33 (R-8513, 9-18-85)

EXT: $\frac{1}{4}$ Sec 32, $\frac{1}{4}$ Sec 33 (R-8403, 7-19-88) EXT: $\frac{1}{4}$ Sec 35 (R-8403, 7-19-88)

ILLEGIBLE

County Lea Pool Shipp-Strawn

80 acres

TOWNSHIP 17 South Range 32 East NMPM

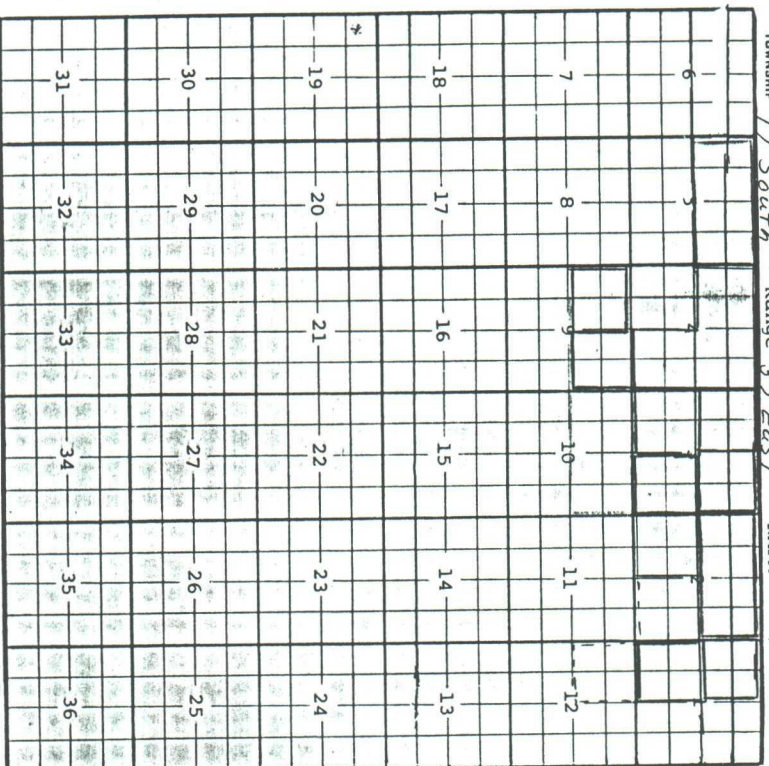

Description: $\frac{1}{4}$ Sec 3, $\frac{1}{4}$ Sec 4 and $\frac{1}{4}$ Sec 5, $\frac{1}{4}$ Sec 6 and $\frac{1}{4}$ Sec 7

$\frac{1}{4}$ Sec 10 (R-8062, 10-31-85)

Amend horizontal limits to be $\frac{1}{4}$ Sec 3 and $\frac{1}{4}$ Sec 4 (R-8062-1, 1-21-86)

EXT: $\frac{1}{4}$ Sec 9 (R-8214, 5-1-86) EXT: $\frac{1}{4}$ Sec 9 (R-8310, 11-3-86)

EXT: $\frac{1}{4}$ Sec 3 (R-8409, 3-7-87) EXT: $\frac{1}{4}$ Sec 3 (R-8451, 6-3-87)

EXT: $\frac{1}{4}$ Sec 3 (R-8533, 10-28-87) EXT: $\frac{1}{4}$ Sec 3 (R-8603, 7-19-88)

EXT: $\frac{1}{4}$ Sec 2, $\frac{1}{4}$ Sec 3 (R-8626, 4-1-88) EXT: $\frac{1}{4}$ Sec 2 (R-8856, 1-25-89)

EXT: $\frac{1}{4}$ Sec 1 (R-8901, 4-1-89)

1	2	3	4	5	6	7	8	9	10	11	12	13	14	15	16	17	18	19	20	21	22	23	24	25	26	27	28	29	30	31	32	33	34	35	36	37	38	39	40	41	42	43	44	45	46	47	48	49	50	51	52	53	54	55	56	57	58	59	60	61	62	63	64	65	66	67	68	69	70	71	72	73	74	75	76	77	78	79	80	81	82	83	84	85	86	87	88	89	90	91	92	93	94	95	96	97	98	99	100
---	---	---	---	---	---	---	---	---	----	----	----	----	----	----	----	----	----	----	----	----	----	----	----	----	----	----	----	----	----	----	----	----	----	----	----	----	----	----	----	----	----	----	----	----	----	----	----	----	----	----	----	----	----	----	----	----	----	----	----	----	----	----	----	----	----	----	----	----	----	----	----	----	----	----	----	----	----	----	----	----	----	----	----	----	----	----	----	----	----	----	----	----	----	----	----	----	----	----	-----