

CAMPBELL & BLACK, P.A.
LAWYERS

JACK M. CAMPBELL
BRUCE D. BLACK
MICHAEL B. CAMPBELL
WILLIAM F. CARR
BRADFORD C. BERGE
MARK F. SHERIDAN
WILLIAM P. SLATTERY
PATRICIA A. MATTHEWS

*Original
File*

JEFFERSON PLACE
SUITE 1 - 110 NORTH GUADALUPE
POST OFFICE BOX 2208
SANTA FE, NEW MEXICO 87504-2208
TELEPHONE: (505) 988-4421
TELECOPIER: (505) 983-6043

March 12, 1990

HAND-DELIVERED

William J. LeMay, Director
Oil Conservation Division
New Mexico Department of Energy,
Minerals and Natural Resources
State Land Office Building
Santa Fe, New Mexico 87503

RECEIVED

MAR 8 1990

OIL CONSERVATION DIV.
SANTA FE

9903

Re: In the Matter of the Application of Yates Petroleum Corporation, for
Directional Drilling, and an Unorthodox Location, Eddy County, New Mexico

Dear Mr. LeMay:

Enclosed in triplicate is the above-referenced application of Yates Petroleum Corporation. Yates Petroleum Corporation respectfully requests that this matter be placed on the docket for the Examiner hearings scheduled on April 4, 1990.

Very truly yours,

William F. Carr

WILLIAM F. CARR

WFC:mlh

Enclosures

cc w/enclosures: Ms Janet Richardson, Landman
Yates Petroleum Corporation
105 South Fourth Street
Artesia, New Mexico 88210

RECEIVED

MAR 12 8 1998

OIL CONSERVATION DIV.
SANTA FE

BEFORE THE
OIL CONSERVATION DIVISION
DEPARTMENT OF ENERGY, MINERALS AND NATURAL RESOURCES

IN THE MATTER OF THE APPLICATION OF
YATES PETROLEUM CORPORATION,
FOR DIRECTIONAL DRILLING, AND
AN UNORTHODOX LOCATION,
EDDY COUNTY, NEW MEXICO.

CASE NO. 9903

APPLICATION

YATES PETROLEUM COMPANY, by its undersigned attorneys, hereby makes application pursuant to Oil Conservation Division Rule 111 to directionally drill its Gazelle AHG Federal Com Well No. 1, and in support thereof states:

1. Applicant is the operator of the Strawn and Morrow formations underlying the S/2 of Section 15, Township 20 South, Range 29 East, N.M.P.M., Eddy County, New Mexico, and proposes to directionally drill its Gazelle AHG Federal Com Well No. 1 to test the Morrow and intermediate formations.

2. Applicant proposes to directionally drill its Gazelle AHG Federal Com Well No. 1 from a surface location of 1312 feet from the North line and 1844 feet from the West line to a bottom hole location in the Strawn formation, Burton Flat East Strawn Pool, 1980 feet from the South and East lines and a non-standard bottom hole location in the Morrow formation 1472 feet from the South line and 1540 feet from the East line of Section 15, Township 20 South, Range 29 East, N.M.P.M., Eddy County.

3. Applicant proposes to dedicate to the Gazelle AHG Federal Com Well No. 1 a standard proration unit comprised of the S/2 of said Section 15.

4. The directional drilling of this well will enable the Applicant to produce the reserves which underlie the above-referenced proration unit in the most economical and efficient manner.

5. Approval of this application will enable the Applicant to produce hydrocarbons that otherwise would not be produced and will otherwise be in the best interest of conservation, the prevention of waste and the protection of correlative rights.

WHEREFORE, Applicant requests that this application be set for hearing before a duly appointed Examiner of the Oil Conservation Division on April 4, 1990, that notice be given as required by law and the rules of the Rules of the Division, and that the Division enter its Order granting the applicant permission to directionally drill its Gazelle AHG Federal Com Well No. 1 and granting such other relief as is appropriate.

Respectfully submitted,

CAMPBELL & BLACK, P.A.

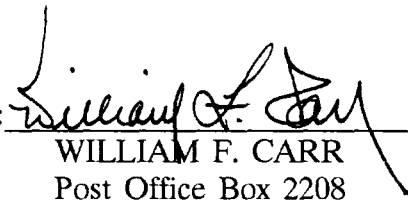
By: 
WILLIAM F. CARR
Post Office Box 2208
Santa Fe, New Mexico 87504
Telephone: (505) 988-4421

ATTORNEYS FOR YATES
PETROLEUM CORPORATION

BEFORE THE
OIL CONSERVATION DIVISION
DEPARTMENT OF ENERGY, MINERALS AND NATURAL RESOURCES

RECEIVED

12 X
MAR 8 1969

for filing
MAR 11 1969

IN THE MATTER OF THE APPLICATION OF
YATES PETROLEUM CORPORATION,
FOR DIRECTIONAL DRILLING, AND
AN UNORTHODOX LOCATION,
EDDY COUNTY, NEW MEXICO.

CASE NO. 9903

APPLICATION

YATES PETROLEUM COMPANY, by its undersigned attorneys, hereby makes application pursuant to Oil Conservation Division Rule 111 to directionally drill its Gazelle AHG Federal Com Well No. 1, and in support thereof states:

1. Applicant is the operator of the Strawn and Morrow formations underlying the S/2 of Section 15, Township 20 South, Range 29 East, N.M.P.M., Eddy County, New Mexico, and proposes to directionally drill its Gazelle AHG Federal Com Well No. 1 to test the Morrow and intermediate formations.

2. Applicant proposes to directionally drill its Gazelle AHG Federal Com Well No. 1 from a surface location of 1312 feet from the North line and 1844 feet from the West line to a bottom hole location in the Strawn formation, Burton Flat East Strawn Pool, 1980 feet from the South and East lines and a non-standard bottom hole location in the Morrow formation 1472 feet from the South line and 1540 feet from the East line of Section 15, Township 20 South, Range 29 East, N.M.P.M., Eddy County.

3. Applicant proposes to dedicate to the Gazelle AHG Federal Com Well No. 1 a standard proration unit comprised of the S/2 of said Section 15.

4. The directional drilling of this well will enable the Applicant to produce the reserves which underlie the above-referenced proration unit in the most economical and efficient manner.

5. Approval of this application will enable the Applicant to produce hydrocarbons that otherwise would not be produced and will otherwise be in the best interest of conservation, the prevention of waste and the protection of correlative rights.

WHEREFORE, Applicant requests that this application be set for hearing before a duly appointed Examiner of the Oil Conservation Division on April 4, 1990, that notice be given as required by law and the rules of the Rules of the Division, and that the Division enter its Order granting the applicant permission to directionally drill its Gazelle AHG Federal Com Well No. 1 and granting such other relief as is appropriate.

Respectfully submitted,

CAMPBELL & BLACK, P.A.

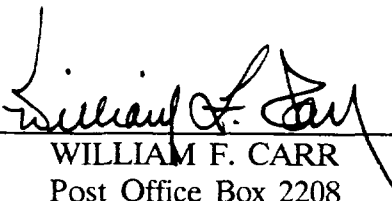
By: 
WILLIAM F. CARR
Post Office Box 2208
Santa Fe, New Mexico 87504
Telephone: (505) 988-4421

ATTORNEYS FOR YATES
PETROLEUM CORPORATION

BEFORE THE
OIL CONSERVATION DIVISION
DEPARTMENT OF ENERGY, MINERALS AND NATURAL RESOURCES

RECEIVED

MAR 6 1988

OIL CONSERVATION DIV.
SANTA FE

IN THE MATTER OF THE APPLICATION OF
YATES PETROLEUM CORPORATION,
FOR DIRECTIONAL DRILLING, AND
AN UNORTHODOX LOCATION,
EDDY COUNTY, NEW MEXICO.

CASE NO. 9903

APPLICATION

YATES PETROLEUM COMPANY, by its undersigned attorneys, hereby makes application pursuant to Oil Conservation Division Rule 111 to directionally drill its Gazelle AHG Federal Com Well No. 1, and in support thereof states:

1. Applicant is the operator of the Strawn and Morrow formations underlying the S/2 of Section 15, Township 20 South, Range 29 East, N.M.P.M., Eddy County, New Mexico, and proposes to directionally drill its Gazelle AHG Federal Com Well No. 1 to test the Morrow and intermediate formations.

2. Applicant proposes to directionally drill its Gazelle AHG Federal Com Well No. 1 from a surface location of 1312 feet from the North line and 1844 feet from the West line to a bottom hole location in the Strawn formation, Burton Flat East Strawn Pool, 1980 feet from the South and East lines and a non-standard bottom hole location in the Morrow formation 1472 feet from the South line and 1540 feet from the East line of Section 15, Township 20 South, Range 29 East, N.M.P.M., Eddy County.

3. Applicant proposes to dedicate to the Gazelle AHG Federal Com Well No. 1 a standard proration unit comprised of the S/2 of said Section 15.

4. The directional drilling of this well will enable the Applicant to produce the reserves which underlie the above-referenced proration unit in the most economical and efficient manner.

5. Approval of this application will enable the Applicant to produce hydrocarbons that otherwise would not be produced and will otherwise be in the best interest of conservation, the prevention of waste and the protection of correlative rights.

WHEREFORE, Applicant requests that this application be set for hearing before a duly appointed Examiner of the Oil Conservation Division on April 4, 1990, that notice be given as required by law and the rules of the Rules of the Division, and that the Division enter its Order granting the applicant permission to directionally drill its Gazelle AHG Federal Com Well No. 1 and granting such other relief as is appropriate.

Respectfully submitted,

CAMPBELL & BLACK, P.A.

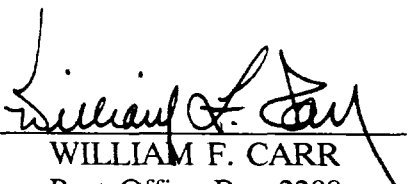
By: 
WILLIAM F. CARR
Post Office Box 2208
Santa Fe, New Mexico 87504
Telephone: (505) 988-4421

ATTORNEYS FOR YATES
PETROLEUM CORPORATION

R-1111-P
Area

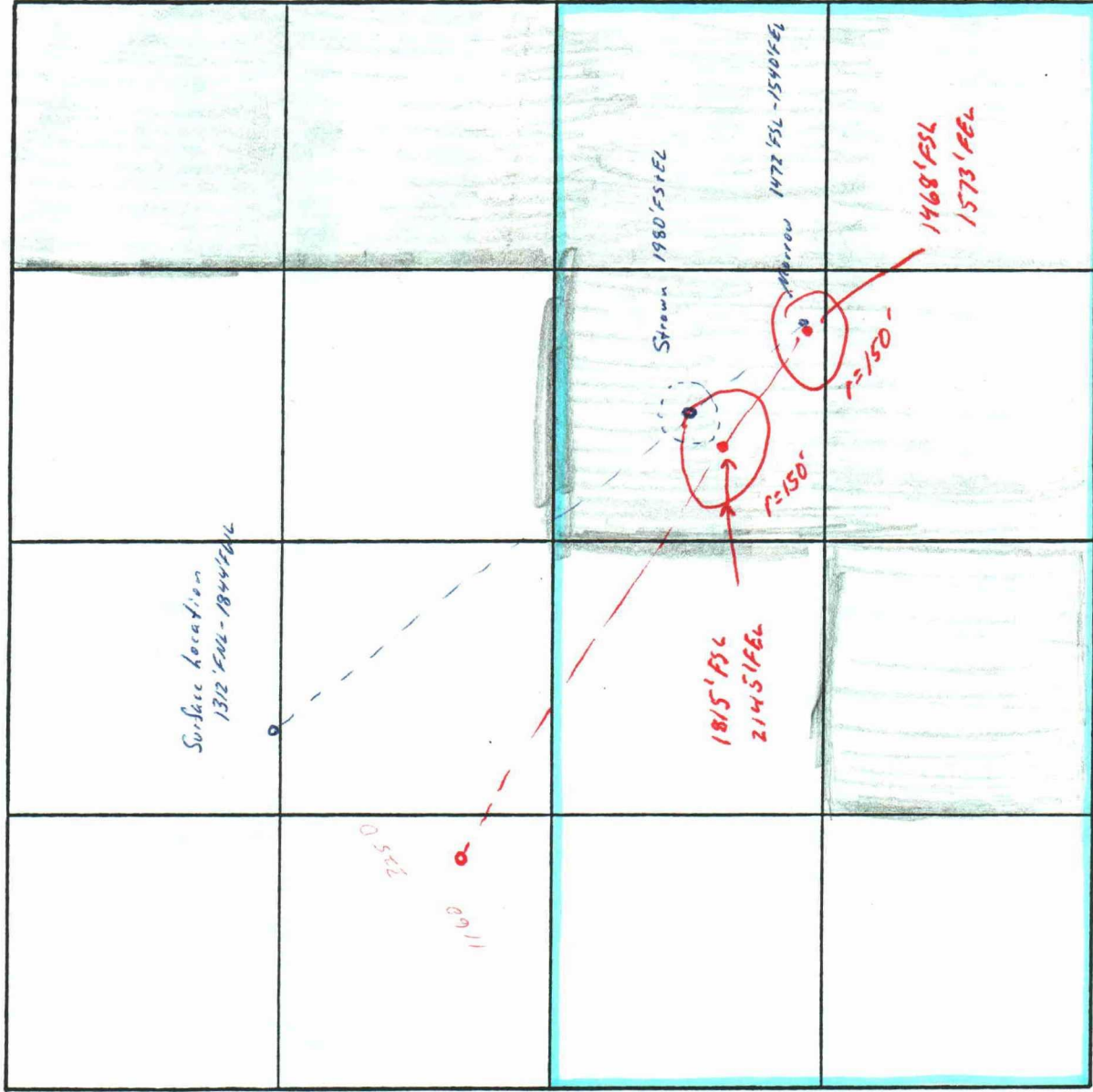

SECTION 15 TOWNSHIP 20 SOUTH RANGE 29 EAST

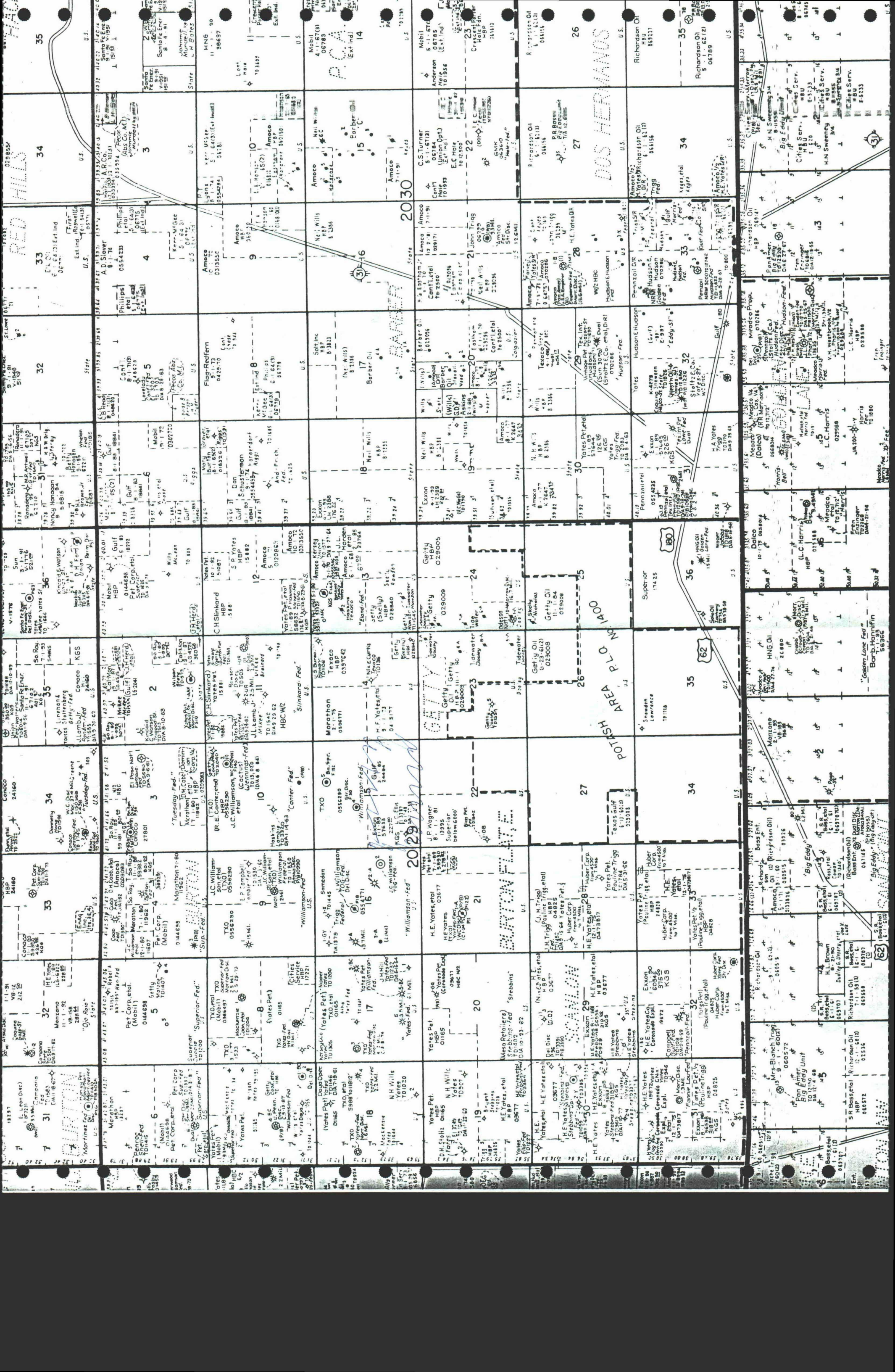

county Eddy Pool South Parkway-Strawn

TOWNSHIP 20 South Range 29 East NMPM

6	5	4	3	2	1
7	8	9	10	11	12
18	17	16	15	14	13
19	20	21	22	23	24
30	29	28	27	26	25
31	32	33	34	35	36

A red rectangle is drawn around section 15, and a smaller black square is drawn within it, covering the center of section 15.

Description: Sec: 15, NW/4 (R-7222, 2-25-83)

COUNTY Eddy

POOL East Burton Flat-Strawn Gas

TOWNSHIP 20 South

RANGE 29 East

NMPM

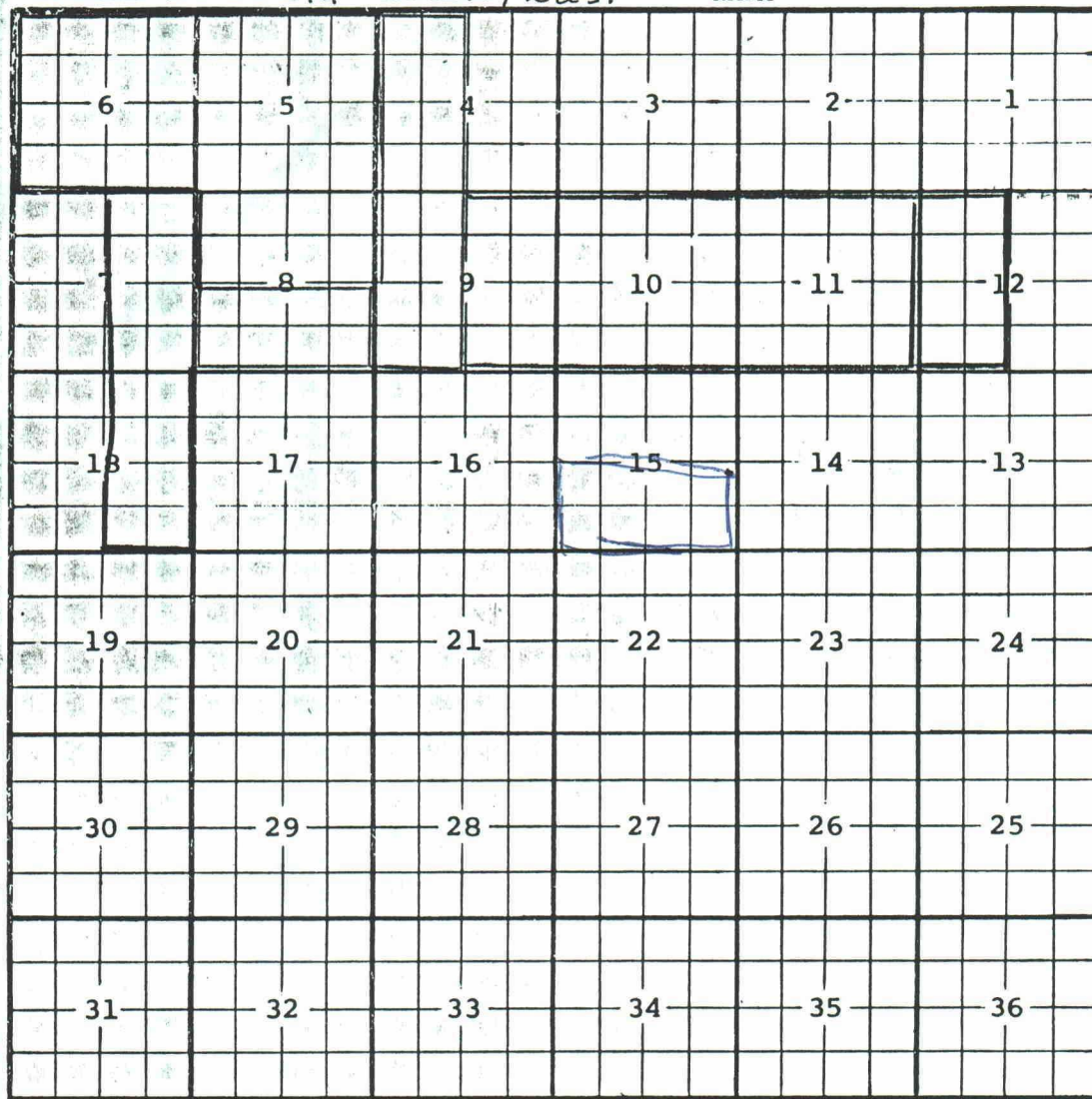

Description: $\frac{5}{2}$ Sec 8 (R-5252, 9-1-76)

Ext: $\frac{W}{2}$ Sec 4, $\frac{W}{2}$ Sec 9 (R-5511, 9-1-77)

Ext: $\frac{E}{2}$ Sec 9, All Sec. 10, All Sec. 11 (R-7158, 12-8-82)

Ext: All Sec. 5, All Sec. 6, $\frac{N}{2}$ Sec. 8 (A-7307, 6-14-83) EXT: $\frac{W}{2}$ sec 12 (R-8945, 5-31-89) EXT: $\frac{E}{2}$ SEC 7, $\frac{E}{2}$ SEC 18 (R-9017, 11-1-89)

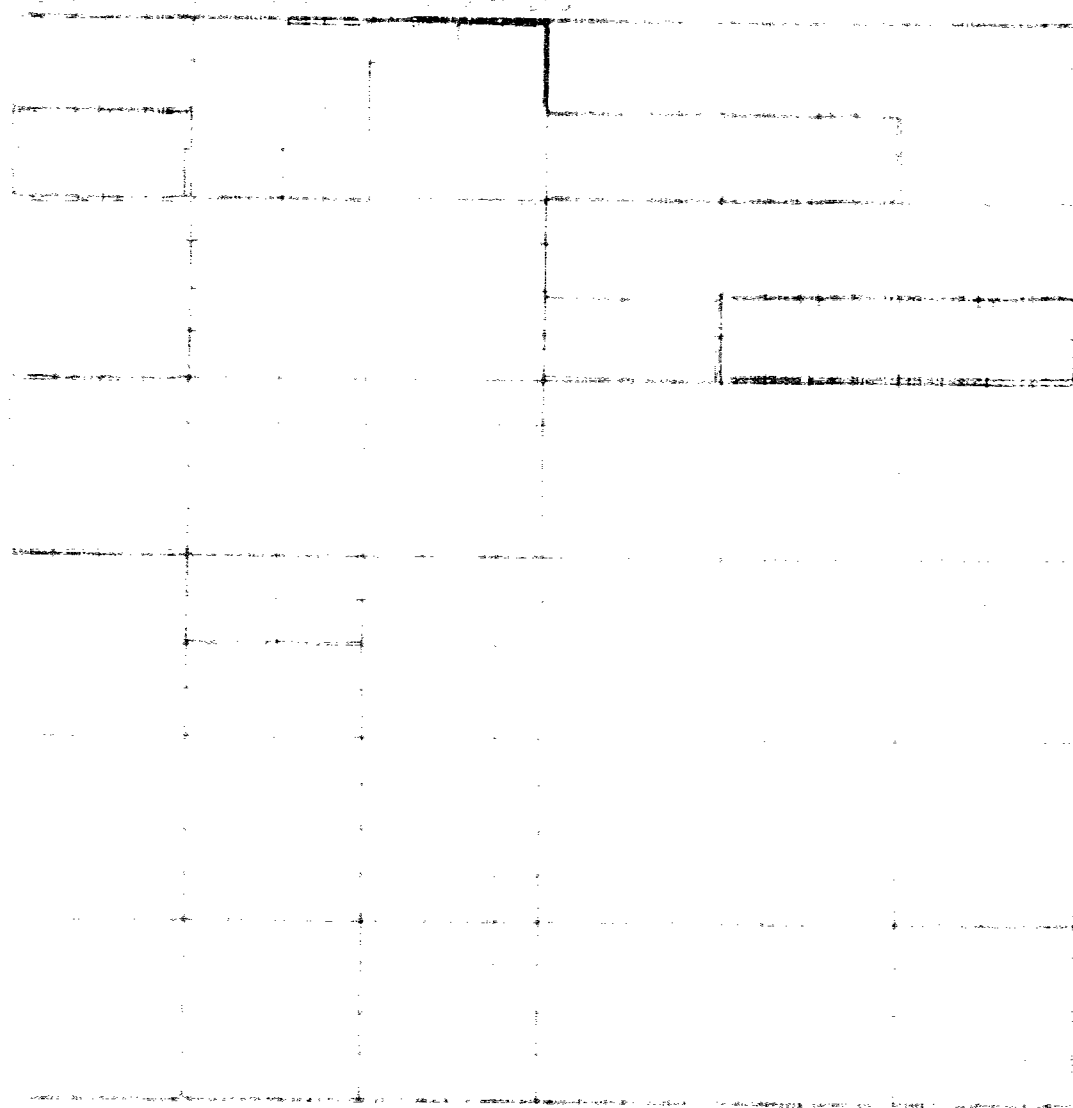

COUNTY EddyPOOL East Burton Flat - Morrow GasTOWNSHIP 20 SouthRANGE 29 East

NMPM

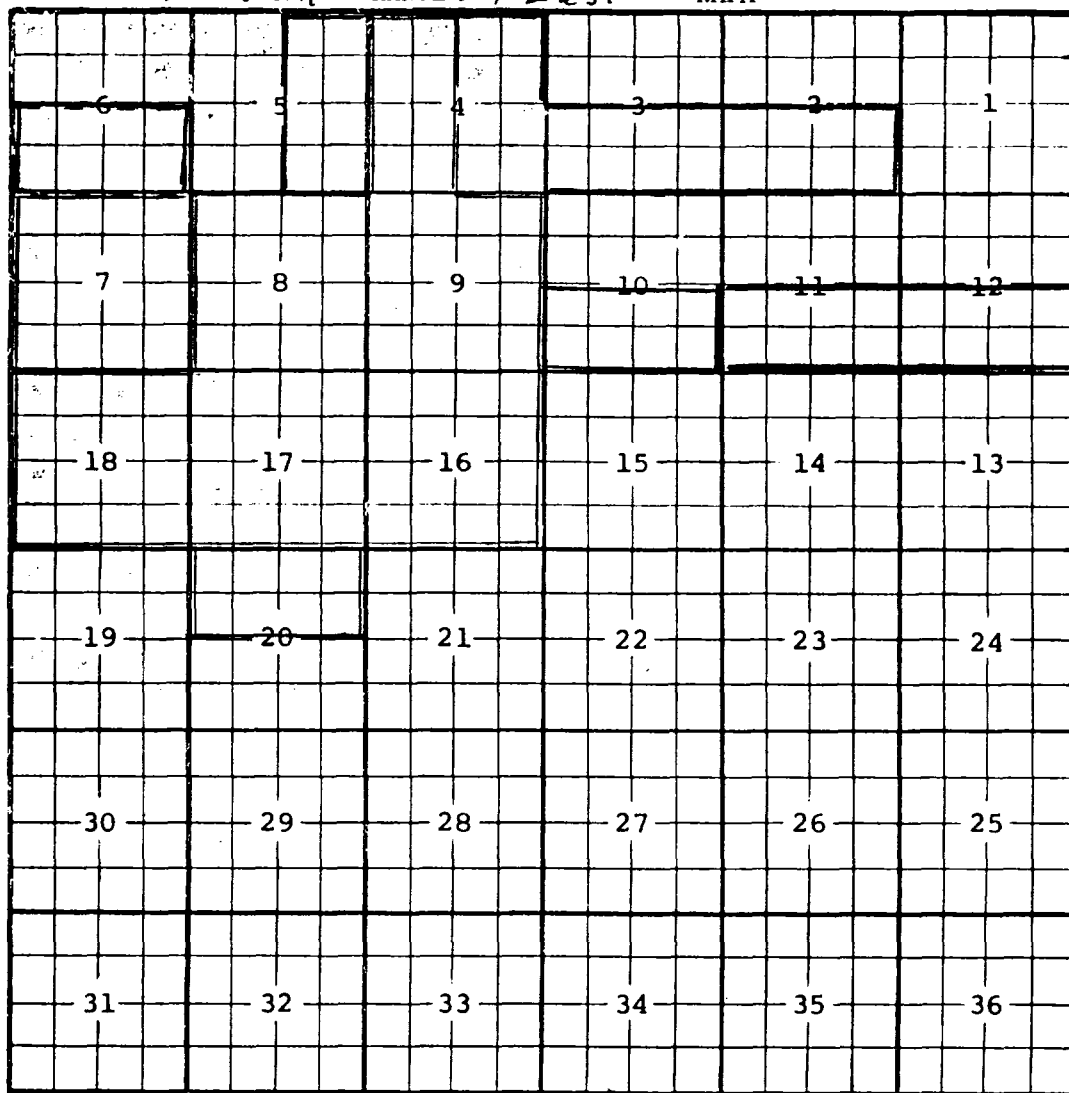

Description: $\frac{W}{2}$ Sec 4, All sec 8, 9, 16, 17 & 18 (R-5252, 9-1-76)

Ext: $\frac{N}{2}$ Sec 20 (R-5456, 7-1-77) Ext: All Sec 7 (R-5667, 4-1-78)

Ext: $\frac{E}{2}$ Sec 5 (R-5838, 11-1-78) EXT: $\frac{S}{2}$ sec 6 (R-7009, 6-19-82)

Ext: $\frac{S}{2}$ Sec. 2, $\frac{S}{2}$ Sec. 3, $\frac{E}{2}$ Sec. 4 (R-7875, 4-16-85)

Ext: $\frac{S}{2}$ Sec. 10 (R-8065, 10-31-85) EXT: $\frac{S}{2}$ sec 11, $\frac{S}{2}$ sec 12 (R-8969, 8-1-89)

CAMPBELL & BLACK, P.A.
LAWYERS

JACK M. CAMPBELL
BRUCE D. BLACK
MICHAEL B. CAMPBELL
WILLIAM F. CARR
BRADFORD C. BERGE
MARK F. SHERIDAN
WILLIAM P. SLATTERY
PATRICIA A. MATTHEWS

Amended Petition

JEFFERSON PLACE
SUITE 1 - 110 NORTH GUADALUPE
POST OFFICE BOX 2208
SANTA FE, NEW MEXICO 87504-2208
TELEPHONE: (505) 988-4421
TELECOPIER: (505) 983-6043

March 27, 1990

HAND-DELIVERED

William J. LeMay, Director
Oil Conservation Division
New Mexico Department of Energy,
Minerals and Natural Resources
State Land Office Building
Santa Fe, New Mexico 87503

RECEIVED
MAR 27 1990
OIL CONSERVATION DIVISION
9903

Re: In the Matter of the Application of Yates Petroleum Corporation, for
Directional Drilling, and an Unorthodox Location, Eddy County, New Mexico

Dear Mr. LeMay:

Enclosed in triplicate is an amended application of Yates Petroleum Corporation in the
above-referenced case. Yates Petroleum Corporation respectfully requests that this matter
be placed on the docket for the Examiner hearings scheduled on April 18, 1990.

Very truly yours,

William F. Carr
WILLIAM F. CARR

WFC:mlh

Enclosures

cc w/enclosures: Ms Janet Richardson, Landman
Yates Petroleum Corporation
105 South Fourth Street
Artesia, New Mexico 88210

BEFORE THE
OIL CONSERVATION DIVISION
DEPARTMENT OF ENERGY, MINERALS AND NATURAL RESOURCES

IN THE MATTER OF THE APPLICATION OF
YATES PETROLEUM CORPORATION,
FOR DIRECTIONAL DRILLING, AND
AN UNORTHODOX LOCATION,
EDDY COUNTY, NEW MEXICO.

RECEIVED

MAR 27 1990

CASE NO. 7703

OIL CONSERVATION DIVISION
AMENDED APPLICATION

YATES PETROLEUM COMPANY, by its undersigned attorneys, hereby makes application pursuant to Oil Conservation Division Rule 111 to directionally drill its Gazelle AHG Federal Com Well No. 1, and in support thereof states:

1. Applicant is the operator of the Strawn and Morrow formations underlying the S/2 of Section 15, Township 20 South, Range 29 East, N.M.P.M., Eddy County, New Mexico, and proposes to directionally drill its Gazelle AHG Federal Com Well No. 1 to test the Morrow and intermediate formations.

2. Applicant proposes to directionally drill its Gazelle AHG Federal Com Well No. 1 from a surface location of 2280 feet from the North line and 1180 feet from the West line to a bottom hole location within 150 feet of a point 1468 feet from the South line and 1573 feet from the East line of said Section 15. Said well will be at a bottom hole location in the Strawn formation, Burton Flat East Strawn Pool, within 150 feet of a point 1815 feet from the South line and 2145 feet from the East line and at a non-standard bottom hole location in the Morrow formation within 150 feet of a point 1566 feet from the South line and 1734 feet from the East line of Section 15, Township 20

South, Range 29 East, N.M.P.M., Eddy County.

3. Applicant proposes to dedicate to the Gazelle AHG Federal Com Well No. 1 a standard proration unit comprised of the S/2 of said Section 15.

4. The directional drilling of this well will enable the Applicant to produce the reserves which underlie the above-referenced proration unit in the most economical and efficient manner.

5. Approval of this application will enable the Applicant to produce hydrocarbons that otherwise would not be produced and will otherwise be in the best interest of conservation, the prevention of waste and the protection of correlative rights.

WHEREFORE, Applicant requests that this application be set for hearing before a duly appointed Examiner of the Oil Conservation Division on April 18, 1990, that notice be given as required by law and the rules of the Rules of the Division, and that the Division enter its Order granting the applicant permission to directionally drill its Gazelle AHG Federal Com Well No. 1 and granting such other relief as is appropriate.

Respectfully submitted,

CAMPBELL & BLACK, P.A.

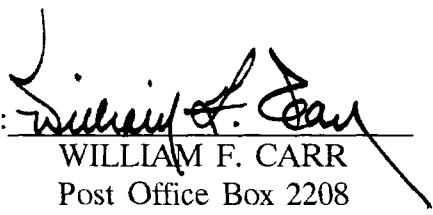
By: 
WILLIAM F. CARR
Post Office Box 2208
Santa Fe, New Mexico 87504
Telephone: (505) 988-4421

ATTORNEYS FOR YATES
PETROLEUM CORPORATION

BEFORE THE
OIL CONSERVATION DIVISION
DEPARTMENT OF ENERGY, MINERALS AND NATURAL RESOURCES

IN THE MATTER OF THE APPLICATION OF
YATES PETROLEUM CORPORATION,
FOR DIRECTIONAL DRILLING, AND
AN UNORTHODOX LOCATION,
EDDY COUNTY, NEW MEXICO.

RECEIVED

MAR 27 1990

CASE NO. 9903

OIL CONSERVATION DIVISION

AMENDED APPLICATION

YATES PETROLEUM COMPANY, by its undersigned attorneys, hereby makes application pursuant to Oil Conservation Division Rule 111 to directionally drill its Gazelle AHG Federal Com Well No. 1, and in support thereof states:

1. Applicant is the operator of the Strawn and Morrow formations underlying the S/2 of Section 15, Township 20 South, Range 29 East, N.M.P.M., Eddy County, New Mexico, and proposes to directionally drill its Gazelle AHG Federal Com Well No. 1 to test the Morrow and intermediate formations.

2. Applicant proposes to directionally drill its Gazelle AHG Federal Com Well No. 1 from a surface location of 2280 feet from the North line and 1180 feet from the West line to a bottom hole location within 150 feet of a point 1468 feet from the South line and 1573 feet from the East line of said Section 15. Said well will be at a bottom hole location in the Strawn formation, Burton Flat East Strawn Pool, within 150 feet of a point 1815 feet from the South line and 2145 feet from the East line and at a non-standard bottom hole location in the Morrow formation within 150 feet of a point 1566 feet from the South line and 1734 feet from the East line of Section 15, Township 20

South, Range 29 East, N.M.P.M., Eddy County.

3. Applicant proposes to dedicate to the Gazelle AHG Federal Com Well No. 1 a standard proration unit comprised of the S/2 of said Section 15.

4. The directional drilling of this well will enable the Applicant to produce the reserves which underlie the above-referenced proration unit in the most economical and efficient manner.

5. Approval of this application will enable the Applicant to produce hydrocarbons that otherwise would not be produced and will otherwise be in the best interest of conservation, the prevention of waste and the protection of correlative rights.

WHEREFORE, Applicant requests that this application be set for hearing before a duly appointed Examiner of the Oil Conservation Division on April 18, 1990, that notice be given as required by law and the rules of the Rules of the Division, and that the Division enter its Order granting the applicant permission to directionally drill its Gazelle AHG Federal Com Well No. 1 and granting such other relief as is appropriate.

Respectfully submitted,

CAMPBELL & BLACK, P.A.

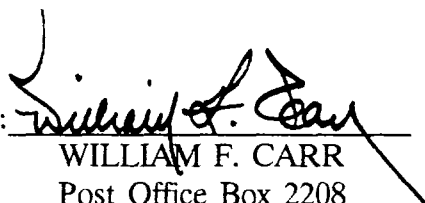
By: 
WILLIAM F. CARR
Post Office Box 2208
Santa Fe, New Mexico 87504
Telephone: (505) 988-4421

ATTORNEYS FOR YATES
PETROLEUM CORPORATION

BEFORE THE
OIL CONSERVATION DIVISION
DEPARTMENT OF ENERGY, MINERALS AND NATURAL RESOURCES

IN THE MATTER OF THE APPLICATION OF
YATES PETROLEUM CORPORATION,
FOR DIRECTIONAL DRILLING, AND
AN UNORTHODOX LOCATION,
EDDY COUNTY, NEW MEXICO.

RECEIVED
MAR 27 1990 CASE NO. 9903
OIL CONSERVATION DIVISION

AMENDED APPLICATION

YATES PETROLEUM COMPANY, by its undersigned attorneys, hereby makes application pursuant to Oil Conservation Division Rule 111 to directionally drill its Gazelle AHG Federal Com Well No. 1, and in support thereof states:

1. Applicant is the operator of the Strawn and Morrow formations underlying the S/2 of Section 15, Township 20 South, Range 29 East, N.M.P.M., Eddy County, New Mexico, and proposes to directionally drill its Gazelle AHG Federal Com Well No. 1 to test the Morrow and intermediate formations.

2. Applicant proposes to directionally drill its Gazelle AHG Federal Com Well No. 1 from a surface location of 2280 feet from the North line and 1180 feet from the West line to a bottom hole location within 150 feet of a point 1468 feet from the South line and 1573 feet from the East line of said Section 15. Said well will be at a bottom hole location in the Strawn formation, Burton Flat East Strawn Pool, within 150 feet of a point 1815 feet from the South line and 2145 feet from the East line and at a non-standard bottom hole location in the Morrow formation within 150 feet of a point 1566 feet from the South line and 1734 feet from the East line of Section 15, Township 20

South, Range 29 East, N.M.P.M., Eddy County.

3. Applicant proposes to dedicate to the Gazelle AHG Federal Com Well No. 1 a standard proration unit comprised of the S/2 of said Section 15.

4. The directional drilling of this well will enable the Applicant to produce the reserves which underlie the above-referenced proration unit in the most economical and efficient manner.

5. Approval of this application will enable the Applicant to produce hydrocarbons that otherwise would not be produced and will otherwise be in the best interest of conservation, the prevention of waste and the protection of correlative rights.

WHEREFORE, Applicant requests that this application be set for hearing before a duly appointed Examiner of the Oil Conservation Division on April 18, 1990, that notice be given as required by law and the rules of the Rules of the Division, and that the Division enter its Order granting the applicant permission to directionally drill its Gazelle AHG Federal Com Well No. 1 and granting such other relief as is appropriate.

Respectfully submitted,

CAMPBELL & BLACK, P.A.

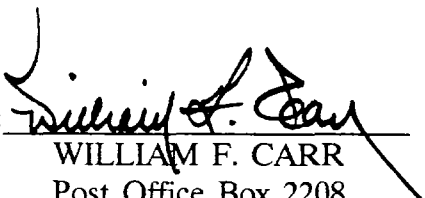
By: 
WILLIAM F. CARR
Post Office Box 2208
Santa Fe, New Mexico 87504
Telephone: (505) 988-4421

ATTORNEYS FOR YATES
PETROLEUM CORPORATION