

# MERIDIAN OIL

June 5, 1990

Certified Mail

Mr. William LeMay  
New Mexico Oil Conservation Division  
Post Office Box 2088  
Santa Fe, New Mexico 87503

*Case 10018*

RE: Hargrave #3  
990'FSL, 1150'FEL  
Section 16, T-27-N, R-10-W  
San Juan County, New Mexico

Dear Mr. LeMay:

This is a request for administrative approval for a non-standard gas well location in the Basin Fruitland Pool.

Meridian Oil intends to plugback and recomplete the Hargrave #3 well from the Pictured Cliffs pool to the Basin Fruitland Coal Pool. The current location of this well is 990'FSL, 1150'FEL, Section 16, T-27-N, R-10-W, San Juan County, New Mexico. The well is considered non-standard due to the NE-SW dedicated pattern established for the Basin Fruitland Coal Pool. To comply with the New Mexico Oil Conservation Division rules, Meridian is submitting the following for your approval of this non-standard location:

1. C-102 plat showing location of the well;
2. Plat showing offset owners/operators;
3. Affidavit of notification of offset owners/operators;
4. Copy of Well Completion Log for original completion.

A copy of this application is being submitted to all offset owners/operators by certified mail with a request that they furnish your Santa Fe office with a Waiver of Objection, and return one copy to this office.

Sincerely yours,



Peggy Bradfield  
encl.

## WAIVER

\_\_\_\_\_ hereby waives objection to Meridian Oil Inc.'s application for a non-standard location for their Hargrave #3 as proposed above.

By: \_\_\_\_\_ Date: \_\_\_\_\_

xc: Amoco Production Company  
Mobil Producing Texas & New Mexico

Hargrave #3  
990'FSL, 1150'FEL  
Section 16, T-27-N, R-10-W  
San Juan County, New Mexico

I hereby certify that the following offset owners/operators have been mailed notification of our application for administrative approval for non-standard gas well location for the plugback and recompletion of the above well.

Amoco Production Company  
P.O. Box 800  
Denver, CO 80201

Mobil Producing Texas & New Mexico  
P.O. Box 5444  
Denver, CO 80217  
Attn: Mr. Jeff Maisch

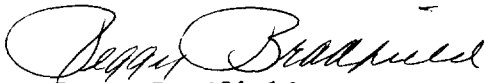

Peggy Bradfield  
June 5, 1990

San Juan County  
State of New Mexico

My commission expires August 17, 1992

Submit to Appropriate  
District Office  
State Lease - 4 copies  
Fee Lease - 3 copies

State of New Mexico  
Energy, Minerals and Natural Resources Department

Form C-102  
Revised 1-1-89

OIL CONSERVATION DIVISION

P.O. Box 2088  
Santa Fe, New Mexico 87504-2088

DISTRICT I

P.O. Box 1980, Hobbs, NM 88240

DISTRICT II

P.O. Drawer DD, Artesia, NM 88210

DISTRICT III

1000 Rio Brazos Rd., Aztec, NM 87410

WELL LOCATION AND ACREAGE DEDICATION PLAT

All Distances must be from the outer boundaries of the section

Operator Meridian Oil Inc.			Lease Hargrave (SF-077382)		Well No. 3
Unit Letter P	Section 16	Township 27 North	Range 10 West	County NMNM San Juan	
Actual Footage Location of Well: 990 feet from the South line and 1150 feet from the East line					
Ground level Elev. 6153'		Producing Formation Fruitland Coal		Pool Basin	Dedicated Acreage: 320 Acres

1. Outline the acreage dedicated to the subject well by colored pencil or hectare marks on the plat below.
2. If more than one lease is dedicated to the well, outline each and identify the ownership thereof (both as to working interest and royalty).
3. If more than one lease of different ownership is dedicated to the well, have the interest of all owners been consolidated by communitization, unitization, force-pooling, etc.?  
☐ Yes ☐ No If answer is "yes" type of consolidation communitization agreement will be  
If answer is "no" list the owners and tract descriptions which have actually been consolidated. (Use reverse side of this form if necessary.) obtained  
No allowable will be assigned to the well until all interests have been consolidated (by communitization, unitization, forced-pooling, or otherwise) or until a non-standard unit, eliminating such interest, has been approved by the Division.

Prepared from a plat  
dated 08-21-51 by  
C. O. Walker

OPERATOR CERTIFICATION

I hereby certify that the information  
contained herein is true and complete to the  
best of my knowledge and belief.

Signature  
Peggy Bradfield  
Printed Name  
Regulatory Affairs  
Position  
Meridian Oil Inc.  
Company  
Date

SURVEYOR CERTIFICATION

I hereby certify that the well location shown  
on this plat was plotted from field notes of  
actual surveys made by me or under my  
supervision, and that the same is true and  
correct to the best of my knowledge and  
belief. 5-23-90

Date Surveyed  
Signature of Surveyor  
Professional Surveyor  
NEW MEXICO  
6857  
6857  
REGISTERED LAND SURVEYOR  
Certificate No.  
Neale C. Edwards

0 330 660 990 1320 1650 1980 2310 2640 2000 1500 1000 500 0

MERIDIAN OIL INC.

Well Name Hargrave #3

Footage---- 990 FSL; 1150' FEL

APPLICATION FOR NON-STANDARD PRORATION UNIT

County San Juan State New Mexico Section 16 Township 27N Range 10W

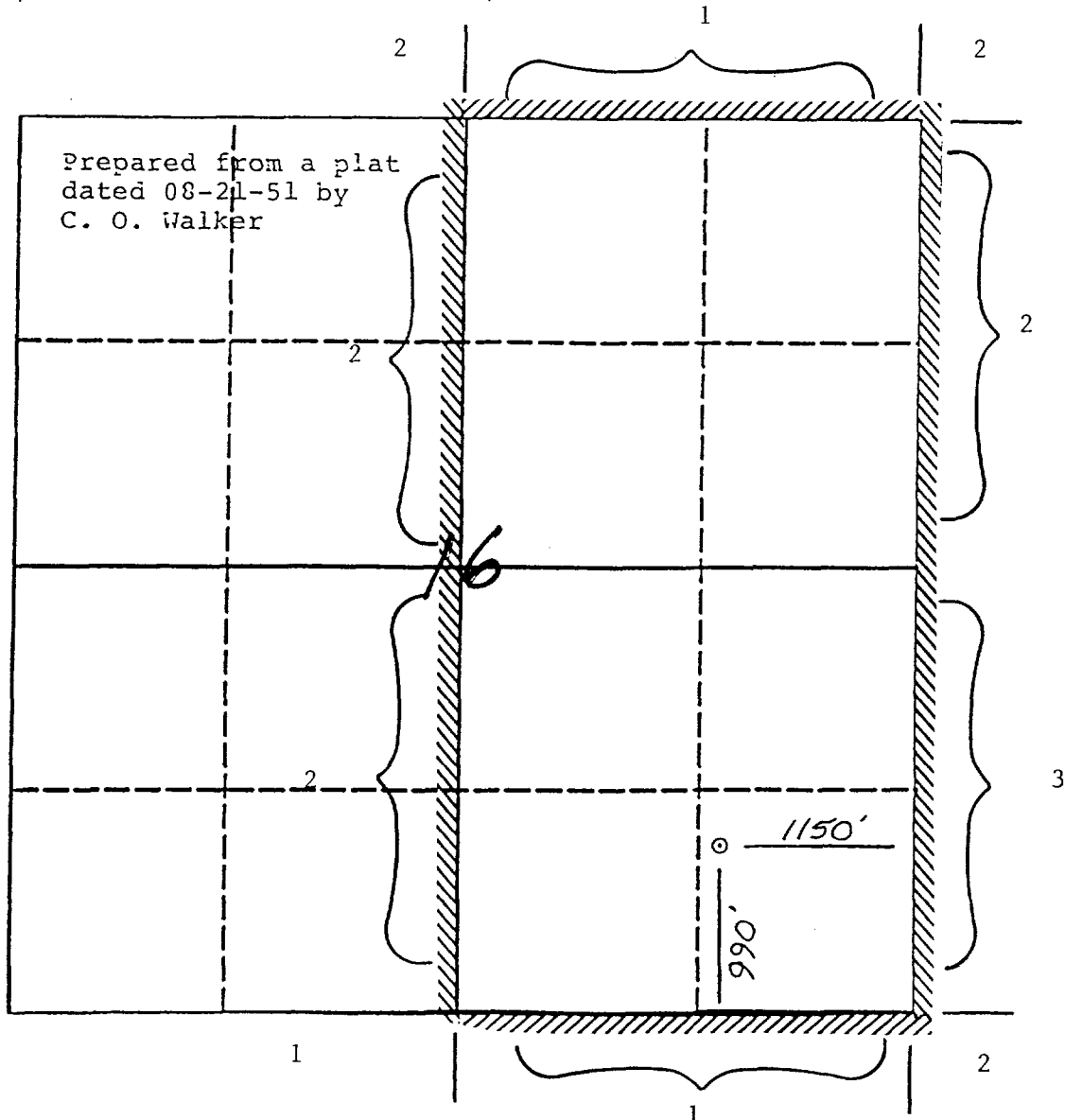

REMARKS: 1) Meridian Oil Inc.  
2) Amoco Production Inc.  
1670 Broadway  
Denver, CO 80202  
3) Mobil Producing Texas & New Mexico  
ATTN: Mr. Jeff Maisch  
PO Box 5444  
Denver, CO 80217

UNITED STATES  
DEPARTMENT OF THE INTERIOR  
GEOLOGICAL SURVEY

SUBMIT IN DUPLICATE\*

(See other in-  
structions on  
reverse side)Form approved.  
Budget Bureau No. 42-R355.5.

## WELL COMPLETION OR RECOMPLETION REPORT AND LOG \*

1a. TYPE OF WELL: OIL WELL <input type="checkbox"/> GAS WELL <input checked="" type="checkbox"/> DRY <input type="checkbox"/> Other _____		5. LEASE DESIGNATION AND SERIAL NO. <b>SF 077382</b>	
b. TYPE OF COMPLETION: NEW WELL <input type="checkbox"/> WORK OVER <input checked="" type="checkbox"/> DEEP-EN <input type="checkbox"/> PLUG BACK <input type="checkbox"/> DIFF. RESVR. <input type="checkbox"/> Other _____		6. IF INDIAN, ALLOTTEE OR TRIBE NAME	
2. NAME OF OPERATOR <b>El Paso Natural Gas Company</b>		7. UNIT AGREEMENT NAME	
3. ADDRESS OF OPERATOR <b>Box 990, Farmington, New Mexico - 87401</b>		8. FARM OR LEASE NAME <b>Hargrave</b>	
4. LOCATION OF WELL (Report location clearly and in accordance with any State requirements)* At surface <b>990'S, 1150'E</b> At top prod. interval reported below At total depth		9. WELL NO. <b>3 (OWWO)</b>	
14. PERMIT NO.		DATE ISSUED	
15. DATE SPUDDED <b>W/O 6-29-68</b>		16. DATE T.D. REACHED <b>W/O 6-30-68</b>	
17. DATE COMPL. (Ready to prod.) <b>8-16-68</b>		18. ELEVATIONS (DF, RKB, RT, GR, ETC.)* <b>6052' GL</b>	
19. ELEV. CASINGHEAD		20. TOTAL DEPTH, MD & TVD <b>1980'</b>	
21. PLUG, BACK T.D., MD & TVD <b>1974'</b>		22. IF MULTIPLE COMPL., HOW MANY*	
23. INTERVALS DRILLED BY →		24. PRODUCING INTERVAL(S), OF THIS COMPLETION—TOP, BOTTOM, NAME (MD AND TVD)* <b>1870 - 82' (Pictured Cliffs)</b>	
25. WAS DIRECTIONAL SURVEY MADE <b>No</b>		26. TYPE ELECTRIC AND OTHER LOGS RUN <b>ES, Temp. Survey</b>	
27. WAS WELL CORED <b>No</b>		28. CASING RECORD (Report all strings set in well)	
29. LINER RECORD		30. TUBING RECORD	
31. PERFORATION RECORD (Interval, size and number) <b>1870 - 82' w/48 Shots</b>		32. ACID, SHOT, FRACTURE, CEMENT SQUEEZE, ETC.	
33.* PRODUCTION		34. DISPOSITION OF GAS (Sold, used for fuel, vented, etc.)	
35. LIST OF ATTACHMENTS		36. I hereby certify that the foregoing and attached information is complete and correct as determined from all available records	

Original signed by  
SIGNED Carl E. Matthews TITLE Petroleum Engineer DATE 8-21-68

\*(See Instructions and Spaces for Additional Data on Reverse Side)

# MERIDIAN OIL

June 5, 1990

Certified Mail

Mr. William LeMay  
New Mexico Oil Conservation Division  
Post Office Box 2088  
Santa Fe, New Mexico 87503

*Case 10018*

RE: Hargrave #3  
990'FSL, 1150'FEL  
Section 16, T-27-N, R-10-W  
San Juan County, New Mexico

Dear Mr. LeMay:

This is a request for administrative approval for a non-standard gas well location in the Basin Fruitland Pool.

Meridian Oil intends to plugback and recomplete the Hargrave #3 well from the Pictured Cliffs pool to the Basin Fruitland Coal Pool. The current location of this well is 990'FSL, 1150'FEL, Section 16, T-27-N, R-10-W, San Juan County, New Mexico. The well is considered non-standard due to the NE-SW dedicated pattern established for the Basin Fruitland Coal Pool. To comply with the New Mexico Oil Conservation Division rules, Meridian is submitting the following for your approval of this non-standard location:

1. C-102 plat showing location of the well;
2. Plat showing offset owners/operators;
3. Affidavit of notification of offset owners/operators;
4. Copy of Well Completion Log for original completion.

A copy of this application is being submitted to all offset owners/operators by certified mail with a request that they furnish your Santa Fe office with a Waiver of Objection, and return one copy to this office.

Sincerely yours,



Peggy Bradfield  
encl.

## WAIVER

\_\_\_\_\_ hereby waives objection to Meridian Oil Inc.'s application for a non-standard location for their Hargrave #3 as proposed above.

By: \_\_\_\_\_ Date: \_\_\_\_\_

xc: Amoco Production Company  
Mobil Producing Texas & New Mexico

Hargrave #3  
990'FSL, 1150'FEL  
Section 16, T-27-N, R-10-W  
San Juan County, New Mexico

I hereby certify that the following offset owners/operators have been mailed notification of our application for administrative approval for non-standard gas well location for the plugback and recompletion of the above well.

Amoco Production Company  
P.O. Box 800  
Denver, CO 80201

Mobil Producing Texas & New Mexico  
P.O. Box 5444  
Denver, CO 80217  
Attn: Mr. Jeff Maisch

  
Peggy Bradfield  
June 5, 1990

San Juan County  
State of New Mexico

My commission expires August 17, 1992



Submit to Appropriate  
District Office  
State Lease - 4 copies  
Fee Lease - 3 copies

State of New Mexico  
Energy, Minerals and Natural Resources Department

Form C-102  
Revised 1-1-89

OIL CONSERVATION DIVISION

DISTRICT I  
P.O. Box 1980, Hobbs, NM 88240

P.O. Box 2088  
Santa Fe, New Mexico 87504-2088

DISTRICT II  
P.O. Denver OD, Artesia, NM 88210

DISTRICT III  
1000 Rio Brazos Rd., Aztec, NM 87410

WELL LOCATION AND ACREAGE DEDICATION PLAT

All Distances must be from the outer boundaries of the section

Operator Meridian Oil Inc.			Lease Hargrave (SF-077382)		Well No. 3
Unit Letter F	Section 16	Township 27 North	Range 10 West	County San Juan	
Actual Footage Location of Well: 990 feet from the South line and 1150 feet from the East line					
Ground level Elev. 6153'	Producing Formation Fruitland Coal		Pool Basin	Dedicated Acreage: 320 Acres	

- Outline the acreage dedicated to the subject well by colored pencil or ink lines marks on the plat below.
- If more than one lease is dedicated to the well, outline each and identify the ownership thereof (both as to working interest and royalty).
- If more than one lease of different ownership is dedicated to the well, have the interest of all owners been consolidated by communitization, unitization, force-pooling, etc.?  
☐ Yes ☐ No If answer is "yes" type of consolidation communitization agreement will be obtained  
If answer is "no" list the owners and trust descriptions which have actually been consolidated. (Use reverse side of this form if necessary.)  
No allowable will be assigned to the well until all interests have been consolidated (by communitization, unitization, force-pooling, or otherwise) or until a non-standard unit, eliminating such interest, has been approved by the Division.

Prepared from a plat  
dated 08-21-51 by  
C. O. Walker

OPERATOR CERTIFICATION

I hereby certify that the information contained herein is true and complete to best of my knowledge and belief.

Signature  
Peggy Bradfield  
Printed Name  
Regulatory Affairs  
Position  
Meridian Oil Inc.  
Company  
Date

SURVEYOR CERTIFICATION

I hereby certify that the well location shown on this plat was plotted from field notes, actual surveys made by me or under my supervision, and that the same is true and correct to the best of my knowledge and belief. 5-23-90

Date Surveyed  
Signature of Surveyor  
Professional Seal  
NEALE C. EDWARDS  
6857  
6857  
Certified Land Surveyor  
Neale C. Edwards

0 330 660 990 1320 1650 1980 2310 2640 2000 1500 1000 500 0



MERIDIAN OIL INC.

Well Name Hargrave #3

Footage---- 990 FSL; 1150' FEL

APPLICATION FOR NON-STANDARD PRORATION UNIT

County San Juan State New Mexico Section 16 Township 27N Range 10W

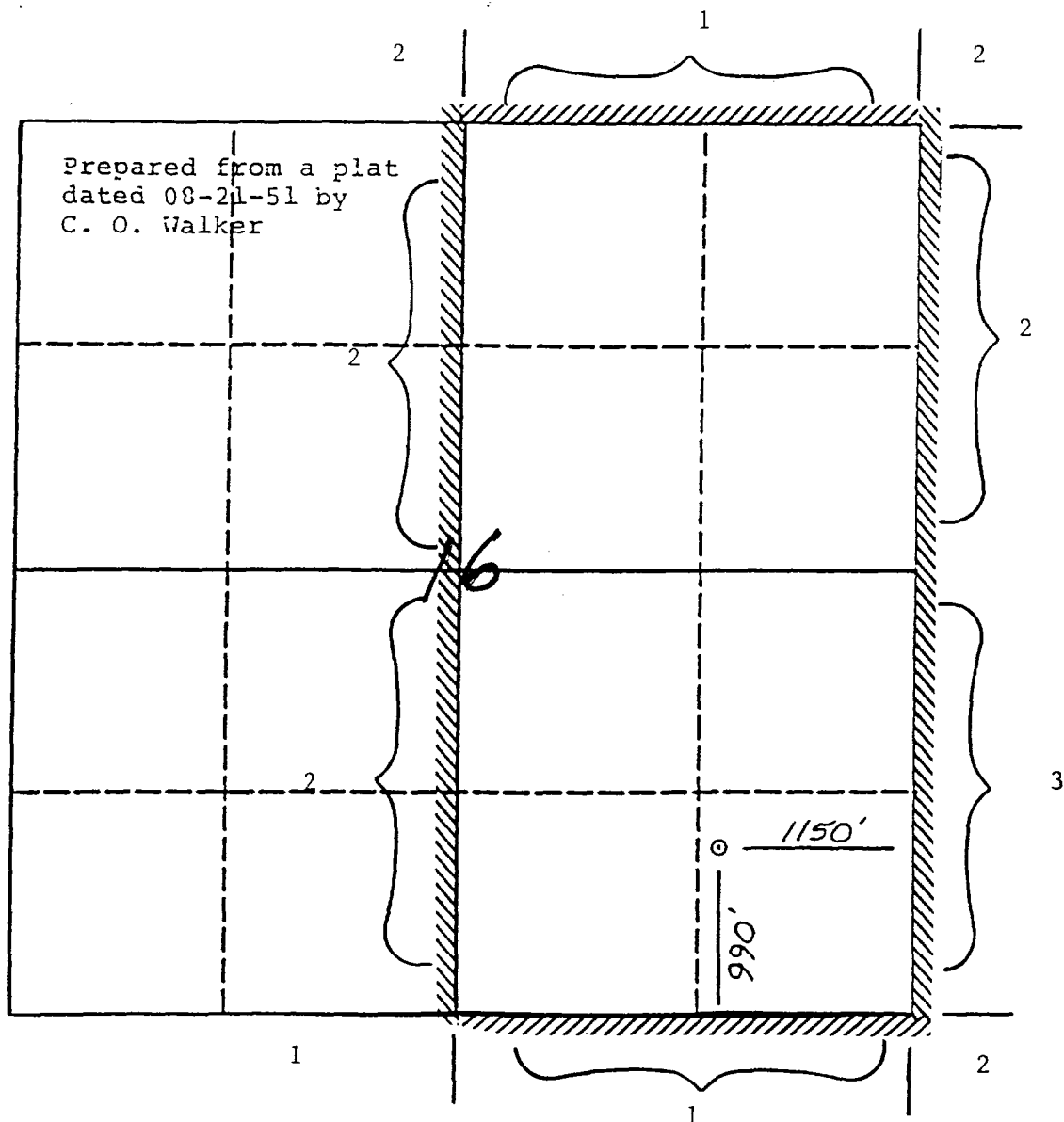

REMARKS: 1) Meridian Oil Inc.

2) Amoco Production Inc.  
1670 Broadway

Denver, CO 80202

3) Mobil Producing Texas & New Mexico  
ATTN: Mr. Jeff Maisch

PO Box 5444

Denver, CO 80217

UNITED STATES  
DEPARTMENT OF THE INTERIOR  
GEOLOGICAL SURVEY

SUBMIT IN DUPLICATE\*

(See other in-  
structions on  
reverse side)Form approved.  
Budget Bureau No. 42-R355.5.

## WELL COMPLETION OR RECOMPLETION REPORT AND LOG \*

1a. TYPE OF WELL:		OIL WELL <input type="checkbox"/>	GAS WELL <input checked="" type="checkbox"/>	DRY <input type="checkbox"/>	Other _____		
b. TYPE OF COMPLETION:		NEW WELL <input type="checkbox"/>	WORK OVER <input checked="" type="checkbox"/>	DEEP-EN <input type="checkbox"/>	PLUG BACK <input type="checkbox"/>	DIFF. RESVR. <input type="checkbox"/>	Other _____
2. NAME OF OPERATOR <b>El Paso Natural Gas Company</b>						5. LEASE DESIGNATION AND SERIAL NO. <b>SF 077382</b>	
3. ADDRESS OF OPERATOR <b>Box 990, Farmington, New Mexico - 87401</b>						6. IF INDIAN, ALLOTTEE OR TRIBE NAME	
4. LOCATION OF WELL (Report location clearly and in accordance with any State requirements)* At surface <b>990'S, 1150'E</b> At top prod. interval reported below At total depth						7. UNIT AGREEMENT NAME	
14. PERMIT NO.						DATE ISSUED	
15. DATE SPUDDED <b>W/O 6-29-68</b>						16. DATE T.D. REACHED <b>W/O 6-30-68</b>	
17. DATE COMPL. (Ready to prod.) <b>8-16-68</b>						18. ELEVATIONS (DF, REB, RT, GR, ETC.)* <b>6052' GL</b>	
19. ELEV. CASINGHEAD						20. TOTAL DEPTH, MD & TVD <b>1980'</b>	
21. PLUG, BACK T.D., MD & TVD <b>1974'</b>						22. IF MULTIPLE COMPL., HOW MANY*	
23. INTERVALS DRILLED BY						24. PRODUCING INTERVAL(S), OF THIS COMPLETION—TOP, BOTTOM, NAME (MD AND TVD)* <b>1870 - 82' (Pictured Cliffs)</b>	
25. WAS DIRECTIONAL SURVEY MADE						26. TYPE ELECTRIC AND OTHER LOGS RUN <b>ES, Temp. Survey</b>	
27. WAS WELL CORED						28. WAS WELL CORED	
29. CASING RECORD (Report all strings set in well)							
CASING SIZE		WEIGHT, LB./FT.		DEPTH SET (MD)		HOLE SIZE	
8 5/8"		28#		114'		12 1/4"	
5 9/16"		14.65#		1871'		7 7/8"	
2 7/8"		6.4#		1980'		4 3/4"	
CEMENTING RECORD		AMOUNT PULLED					
60 Sks.							
100 Sks.							
100 Sks.							
30. LINER RECORD							
SIZE		TOP (MD)		BOTTOM (MD)		SACKS CEMENT*	
31. TUBING RECORD							
SIZE		DEPTH SET (MD)		PACKER SET (MD)			
Tubingless Completion							
32. PERFORATION RECORD (Interval, size and number)							
1870 - 82' w/48 Shots							
33. ACID, SHOT, FRACTURE, CEMENT SQUEEZE, ETC.							
DEPTH INTERVAL (MD)				AMOUNT AND KIND OF MATERIAL USED			
1870 - 1882				20,580 gal. water, 20,000# sand			
34. PRODUCTION							
DATE FIRST PRODUCTION		PRODUCTION METHOD (Flowing, gas lift, pumping—size and type of pump)				WELL STATUS (Producing or shut-in)	
		Flowing				Shut In	
DATE OF TEST		HOURS TESTED		CHOKE SIZE		PROD'N. FOR TEST PERIOD	
8-16-68		3		3/4"			
FLOW. TUBING PRESS.		CASING PRESSURE		CALCULATED 24-HOUR RATE		OIL—BBL.	
		SI 449				GAS—MCF.	
						WATER—BBL.	
						OIL GRAVITY-API (CORR.)	
						SI 495 MCF/D	
35. DISPOSITION OF GAS (Sold, used for fuel, vented, etc.)						TEST WITNESSED BY	
						D. R. Roberts	
36. LIST OF ATTACHMENTS							
37. I hereby certify that the foregoing and attached information is complete and correct as determined from all available records							
Original signed by							
SIGNED		Carl E. Matthews		TITLE		Petroleum Engineer	
						DATE 8-21-68	

\*(See Instructions and Spaces for Additional Data on Reverse Side)