



NEW MEXICO ENERGY, MINERALS and NATURAL RESOURCES DEPARTMENT

GARY E. JOHNSON

Governor

Jennifer A. Salisbury

Cabinet Secretary

July 18, 2001

Lori Wrotenberg

Director

Oil Conservation Division

Sage Energy Company
P.O. Drawer 3068
Midland, Texas 79702-3068

Attn: Mr. George M. Harris, Jr.

**RE: *Injection Pressure Increase
North Vacuum (Abo) North Unit Waterflood Project
Lea County, New Mexico***

Dear Mr. Harris:

Reference is made to your request dated June 5, 2001 to increase the surface injection pressure on three wells within the North Vacuum (Abo) North Unit Waterflood Project. This request is based on step rate tests conducted on these wells on June 6, 2001. The results of the tests have been reviewed by my staff and we feel an increase in injection pressure for these wells is justified at this time.

You are therefore authorized to increase the surface injection pressure on the following wells:

| <i>Well and Location</i> | <i>Maximum Surface Injection Pressure</i> |
|---|--|
| North Vacuum (Abo) North Unit "5B" Well No. 1 API No. 30-025-24341 Unit Letter P, Section 1, Township 17 South, Range 34 East | 4115 PSIG |
| North Vacuum (Abo) North Unit "10" Well No. 1 API No. 30-025-25059 Unit Letter D, Section 1, Township 17 South, Range 34 East | 4410 PSIG |
| North Vacuum (Abo) North Unit "13" Well No. 1 API No. 30-025-25066 Unit Letter B, Section 2, Township 17 South, Range 34 East | 4270 PSIG |

Injection Pressure Increase
Sage Energy Company
June 18, 2001
Page 2

The Division Director may rescind this injection pressure increase if it becomes apparent that the injected water is not being confined to the injection zone or is endangering any fresh water aquifers.

Sincerely,

A handwritten signature in black ink, appearing to read "Lori Wrotenbery", followed by a small, stylized mark that looks like a checkmark or the letter "D".

Lori Wrotenbery
Director

LW/DRC

cc: Oil Conservation Division - Hobbs
Files: 4th Qtr 2001 IPI; Case File No.10103 /



NEW MEXICO ENERGY, MINERALS
& NATURAL RESOURCES DEPARTMENT

OIL CONSERVATION DIVISION
2040 South Pacheco Street
Santa Fe, New Mexico 87505
(505) 827-7131

June 25, 1997

Sage Energy Company
P.O. Drawer 3068
Midland, Texas 79702-3068

Attn: Mr. Jay H. Hardy

**RE: Injection Pressure Increase,
 North Vacuum (Abo) North Unit Waterflood Project,
 Lea County, New Mexico**

Dear Mr. Hardy:

Reference is made to your request dated April 24, 1997 to increase the surface injection pressure on 16 wells in the above referenced project. This request is based on step rate tests conducted on these wells between April 3 and 16, 1997. The results of the tests have been reviewed by my staff and we feel an increase in injection pressure all of the wells is justified at this time.

You are therefore authorized to increase the surface injection pressure on the following wells:

| <i>Well and Location</i> | <i>Maximum Surface Injection Pressure</i> |
|---|---|
| North Vacuum (Abo) North Unit Well No.2A-1 Unit Letter N, Section 1, Township 17 South, Range 34 East | 4170 PSIG |
| North Vacuum (Abo) North Unit Well No.5B-1 Unit Letter P, Section 1, Township 17 South, Range 34 East | 3945 PSIG |
| North Vacuum (Abo) North Unit Well No.14-1 Unit Letter D, Section 12, Township 17 South, Range 34 East | 4420 PSIG |
| North Vacuum (Abo) North Unit Well No.14-2 Unit Letter F, Section 12, Township 17 South, Range 34 East | 4180 PSIG |
| North Vacuum (Abo) North Unit Well No.3-1 Unit Letter J, Section 1, Township 17 South, Range 34 East | 4520 PSIG |
| North Vacuum (Abo) North Unit Well No.4A-1 Unit Letter L, Section 1, Township 17 South, Range 34 East | 4680 PSIG |

| <i>Well and Location</i> | <i>Maximum Surface Injection Pressure</i> |
|---|---|
| North Vacuum (Abo) North Unit Well No.1B-1 Unit Letter F, Section 1, Township 17 South, Range 34 East | 3985 PSIG |
| North Vacuum (Abo) North Unit Well No.19-1 Unit Letter H, Section 2, Township 17 South, Range 34 East | 4110 PSIG |
| North Vacuum (Abo) North Unit Well No.19-2 Unit Letter J, Section 2, Township 17 South, Range 34 East | 3865 PSIG |
| North Vacuum (Abo) North Unit Well No.6C-1 Unit Letter B, Section 1, Township 17 South, Range 34 East | 4145 PSIG |
| North Vacuum (Abo) North Unit Well No.7C-2 Unit Letter H, Section 1, Township 17 South, Range 34 East | 3800 PSIG |
| North Vacuum (Abo) North Unit Well No.21A-1 Unit Letter F, Section 2, Township 17 South, Range 34 East | 4130 PSIG |
| North Vacuum (Abo) North Unit Well No.15-1 Unit Letter N, Section 36, Township 16 South, Range 34 East | 4255 PSIG |
| North Vacuum (Abo) North Unit Well No.10-1 Unit Letter D, Section 1, Township 17 South, Range 34 East | 3670 PSIG |
| North Vacuum (Abo) North Unit Well No.13-1 Unit Letter B, Section 2, Township 17 South, Range 34 East | 4100 PSIG |
| North Vacuum (Abo) North Unit Well No.17-1 Unit Letter P, Section 35, Township 16 South, Range 34 East | 3480 PSIG |

The Division Director may rescind this injection pressure increase if it becomes apparent that the injected water is not being confined to the injection zone or is endangering any fresh water aquifers.

Sincerely,

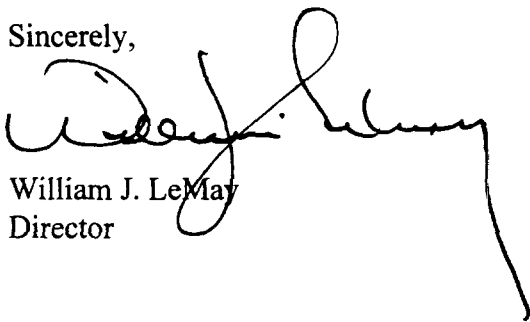

William J. LeMay
Director

WJL/BES

cc: Oil Conservation Division - Hobbs
Files: 3rd Q97 PSI-X; Case File No.10103

SAGE ENERGY COMPANY

P. O. DRAWER 3068
MIDLAND, TEXAS 79702

915/683-5271

OIL CONSERVATION DIVISION
RECEIVED

'90 OCT 11 AM 8 50

JHM

October 8, 1990

New Mexico Oil & Gas Conservation Commission
Oil Conservation Division
P. O. Box 2088
Santa Fe, New Mexico 87504

ATTN: Mr. Jim Morrow
Examiner

RE: North Vacuum (Abo)
North Unit
Case No. 10103
Lea County, New Mexico

Dear Mr. Morrow:

Sage Energy Company respectfully requests that it be allowed to use unlined injection tubing in the nineteen injection wells of the subject unit. The tubing will be run on Baker Lokset packers and monitored in accordance with Rule 704-A and B. Fresh water from the Ogallala formation will be used and since the system will be closed, there will be very little corrosion.

The estimated cost to internally plastic coat the injection tubing is \$325,000.00. This is an addition to the 6 plus million dollars to install the waterflood. The initial investment is excessive because we are flooding a deep tight pay at 8400'. Consequently, the economics are marginal; a 25% ROR BFIT and a 4.8 year payout. Thus, Sage and it's working interest owners are seeking relief

from the additional investment of \$325,000.00. Your granting of this request would be greatly appreciated.

Very truly yours,

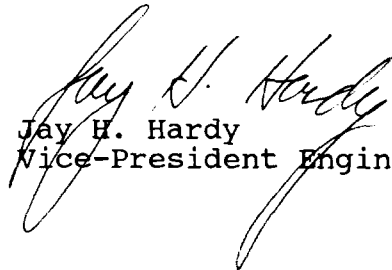

Jay H. Hardy
Vice-President Engineering

CC: Lee Patrick
San Antonio

Jim Bruce
Hinkle, Cox, Eaton Coffield and Hensley

SAGE ENERGY COMPANY

P. O. DRAWER 3068

MIDLAND, TEXAS 79702

915/683-5271

OIL CONSERVATION DIVISION
RECEIVED

'90 OCT 15 AM 9 01

JHM

October 12, 1990

State of New Mexico Energy, Minerals and Natural Resources
Oil Conservation Division
P. O. Box 2088
Santa Fe, New Mexico 87504

Attn: Mr. Jim Morrow

RE: North Vacuum (Abo) Unit
Lea County, New Mexico
Case No. 10103

Dear Mr. Morrow:

As you requested at the hearing on October 3, 1990, for Case No. 10103, enclosed is the water analysis of two fresh water wells. These wells are located northwest of the commercial fresh water well which is located in section 36. The water analysis for the commercial well is attached to Sage Energy's C-108 application dated August 10, 1990.

If further information is needed please contact Jay Hardy at the Midland office or Lee Patrick at the San Antonio office.

Sincerely,

Jay Hardy
Jay Hardy

Vice President Engineering

CC: James Bruce
Hinkle, Cox, Eaton, Coffield & Hensley

Lee Patrick
Sage Energy San Antonio

File

Enclosures

JH/bb

LABORATORY WATER ANALYSIS

No. 227

To Sage Energy

Date 10-11-90

Drawer 3068

Midland Texas

Att: Jay Hardy

This report is the property of Halliburton Company and neither it nor any part thereof nor a copy thereof is to be published or disclosed without first securing the express written approval of laboratory management. It may however, be used in the course of regular business operations by any person or concern and employees thereof receiving such report from Halliburton Company.

Submitted by _____ Date Rec. 10-11-90

Well No. _____ Depth _____ Formation _____

County _____ Field _____ Source _____

Windmill well south of Penzoil 35A^{*}, *Windmill* well north of Penzoil 35^{#1}

SE1/4, SW1/4 Sec 35, T-16-S

SE1/4 NE1/4 Sec. 35 T-16-S

R-34-E

R-34-E

Resistivity _____

Specific Gravity 1.000 .095

pH 6.4 6.5

Calcium (Ca) 75 70 *MPL

Magnesium (Mg) 9 9

Chlorides (Cl) 100 100

Sulfates (SO₄) NJI. NILBicarbonates (HCO₃) 61 152.5

Soluble Iron (Fe) NIL NIL

Remarks: _____ *Milligrams per liter

Respectfully submitted,

Analyst *John Eubank*

HALLIBURTON COMPANY

cc:

By _____ CHEMIST

NOTICE

THIS REPORT IS LIMITED TO THE DESCRIBED SAMPLE TESTED. ANY USER OF THIS REPORT AGREES THAT HALLIBURTON SHALL NOT BE LIABLE FOR ANY LOSS OR DAMAGE, WHETHER IT BE TO ACT OR OMISSION, RESULTING FROM SUCH REPORT OR ITS USE.

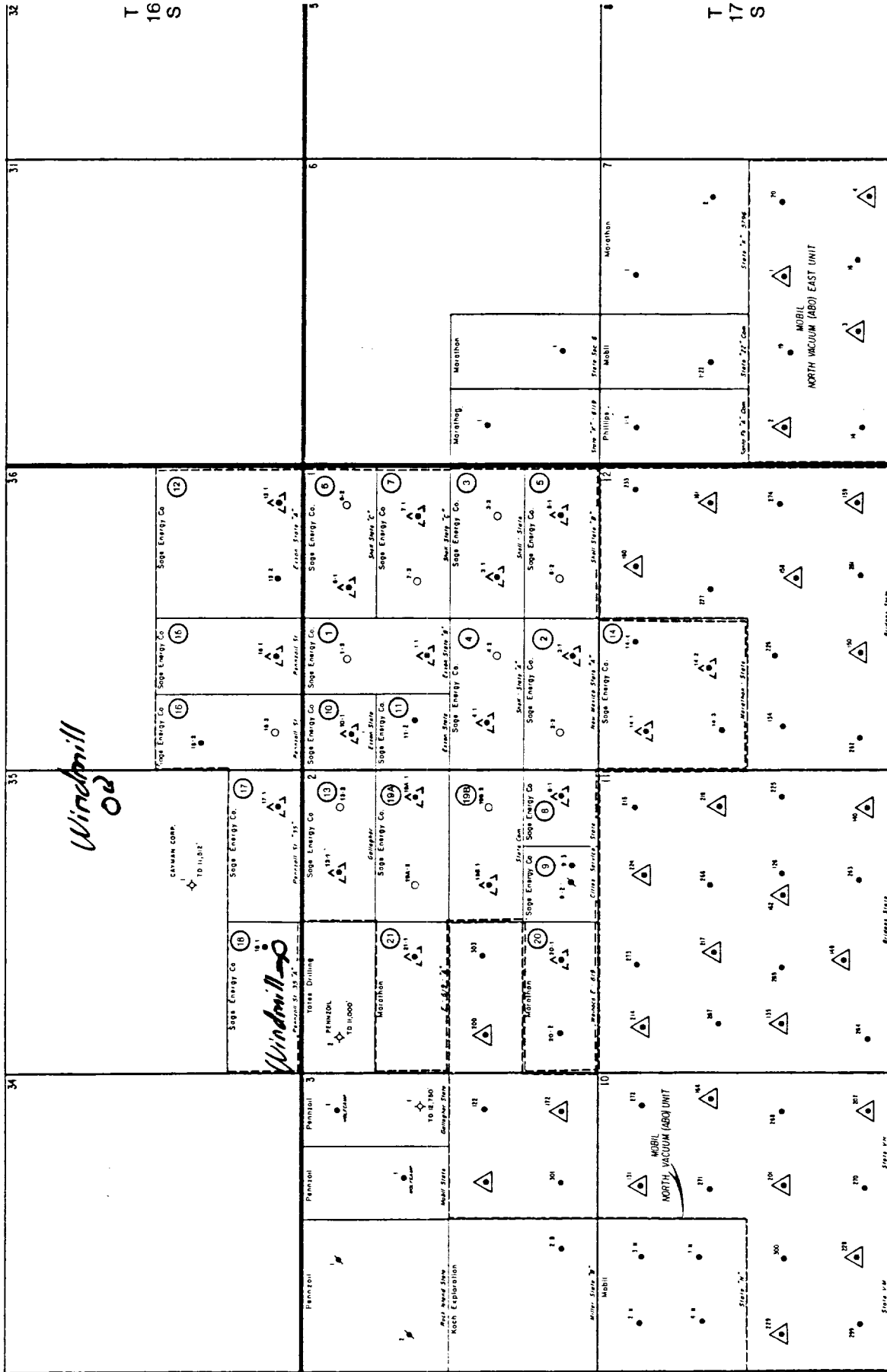

R 34 E

R 35 E

Sage Energy Company
Midland, Texas

PROPOSED NORTH VACUUM (ABO) NORTH UNIT
LEA COUNTY, NEW MEXICO

T 16 S, R 34 E
T 17 S, R 34 E

Scale: 1" = 1000' 1988

INJECTION WELL

UNIT BOUNDARY

PROPOSED INJECTION WELL

PROPOSED PRODUCING WELL

Injection Pressure Increase
Sage Energy Company
August 21, 1995
Page 2

WJL/BES

cc: Oil Conservation Division - Hobbs
File: Case File No.10103; PSI-X 3rd QTR 95



**NEW MEXICO ENERGY, MINERALS
& NATURAL RESOURCES DEPARTMENT**

OIL CONSERVATION DIVISION
2040 South Pacheco Street
Santa Fe, New Mexico 87505
(505) 827-7131

February 23, 2000

Sage Energy Company
P.O. Drawer 3068
Midland, Texas 79702-3068

Attn: Mr. George M. Harris, Jr.

***RE: Injection Pressure Increase,
North Vacuum (Abo) North Unit Waterflood Project,
Lea County, New Mexico***

Dear Mr. Harris:

Reference is made to your request dated February 22, 2000 to increase the surface injection pressure on seven wells in the above referenced project. This request is based on step rate tests conducted on these wells on February 3rd and 4th, 2000. The results of the tests have been reviewed by my staff and we feel an increase in injection pressure all of the wells is justified at this time.

You are therefore authorized to increase the surface injection pressure on the following wells:

| <i>Well and Location</i> | <i>Maximum Surface Injection Pressure</i> |
|---|--|
| North Vacuum (Abo) North Unit Well No.1B-1 Unit Letter F, Section 1, Township 17 South, Range 34 East | 4680 PSIG |
| North Vacuum (Abo) North Unit Well No.2A-1 Unit Letter N, Section 1, Township 17 South, Range 34 East | 4605 PSIG |
| North Vacuum (Abo) North Unit Well No.6C-1 Unit Letter B, Section 1, Township 17 South, Range 34 East | 4185 PSIG |
| North Vacuum (Abo) North Unit Well No.17-1 Unit Letter P, Section 35, Township 16 South, Range 34 East | 4280 PSIG |
| North Vacuum (Abo) North Unit Well No.19-1 Unit Letter H, Section 2, Township 17 South, Range 34 East | 4850 PSIG |
| North Vacuum (Abo) North Unit Well No.19-2 Unit Letter J, Section 2, Township 17 South, Range 34 East | 4050 PSIG |

August 21, 1995

Sage Energy Company
P.O. Drawer 3068
Midland, Texas 79702-3068

Attn: Mr. Jay H. Hardy

**RE: Injection Pressure Increase North Vacuum (Abo) North
Unit Waterflood Project Lea County, New Mexico**

Dear Mr. Hardy:

Reference is made to your request dated August 11, 1995 to increase the surface injection pressure on four wells in the above referenced waterflood project. This request is based on a step rate tests conducted between August 1 and 4, 1994. The results of the test have been reviewed by my staff and we feel an increase in injection pressure on these wells is justified at this time.

You are therefore authorized to increase the surface injection pressure on the following wells:

| Well and Location | Maximum Injection Surface Pressure |
|---|--|
| NVANU 6C Well No.1, Unit B, Section 1 of Township 17 South | 2740 PSIG |
| NVANU 7C Well No.2, Unit H, Section 1 of Township 17 South | 2610 PSIG |
| NVANU 21A Well No.1, Unit F, Section 2 of Township 17 South | 3480 PSIG |
| NVANU 15 Well No.1, Unit N, Section 36 of Township 16 South | 3120 PSIG |
| All located in Range 34 East, Lea County, New Mexico. | |

The Division Director may rescind this injection pressure increase if it becomes apparent that the injected water is not being confined to the injection zone or is endangering any fresh water aquifers.

Sincerely,

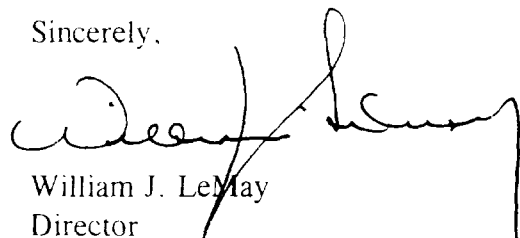

William J. LeMay
Director

Injection Pressure Increase
Sage Energy Company
February 23, 2000
Page 2

| <i>Well and Location</i> | <i>Maximum Surface Injection Pressure</i> |
|---|--|
| North Vacuum (Abo) North Unit Well No.21A-1 Unit Letter F, Section 2, Township 17 South, Range 34 East | 4500 PSIG |

The Division Director may rescind this injection pressure increase if it becomes apparent that the injected water is not being confined to the injection zone or is endangering any fresh water aquifers.

Sincerely,

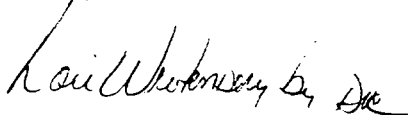

Lori Wrotenbery
Director

LW/MWA/kv

cc: Oil Conservation Division - Hobbs
Files: 1st Qtr 2000 IPI; Case File No.10103 (Division Order No. R-9359)



STATE OF NEW MEXICO
ENERGY, MINERALS AND NATURAL RESOURCES DEPARTMENT
OIL CONSERVATION DIVISION



BRUCE KING
GOVERNOR

ANITA LOCKWOOD
CABINET SECRETARY

April 14, 1992

POST OFFICE BOX 2088
STATE LAND OFFICE BUILDING
SANTA FE, NEW MEXICO 87504
(505) 827-5800

Sage Energy Company
P.O. Drawer 3068
Midland, Texas 79702

Case 10103

Attention: Jay H. Hardy

RE: *Injection Pressure Increase
North Vacuum (Abo) North Unit
6 Wells
Lea County, New Mexico*

Dear Mr. Hardy:

Reference is made to your request dated May 5, 1992, to increase the surface injection pressure on six (6) wells in the North Vacuum (Abo) North Unit. This request is based on step rate tests conducted on these wells between April 29 & May 1, 1992. The results of the tests have been reviewed by my staff and we feel an increase in injection pressure on these wells is justified at this time.

You are therefore authorized to increase the surface injection pressure on the following wells:

WELL AND LOCATION

MAXIMUM INJECTION
SURFACE PRESSURE

NVANU 3 No. 1
1780' FSL & 1980' FEL
Unit J, 1-17S-34E

3000 PSIG

NVANU 4A No. 1
1980' FSL & 860' FWL
Unit L, 1-17S-34E

3200 PSIG

WELL AND LOCATION

MAXIMUM INJECTION
SURFACE PRESSURE

NVANU 5B No. 1
660' FSL & 860' FEL
Unit P, 1-17S-34E

3100 PSIG

NVANU 2A No. 1
460' FSL & 1980' FWL
Unit N, 1-17S-34E

3200 PSIG

NVANU 14 No. 1
860' FNL & 660' FWL
Unit D, 12-17S-34E

3000 PSIG

NVANU 14 No. 2
1980' FNL & 1780' FWL
Unit F, 12-17S-34E

2700 PSIG

The Division Director may rescind this injection pressure increase if it becomes apparent that the injected water is not being confined to the injection zone or is endangering any fresh water aquifers.

Sincerely,

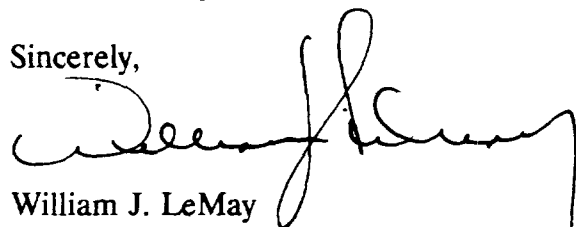

William J. LeMay
Director

WJL/DC/jc

cc: Oil Conservation Division - Hobbs
File: R-9359 ✓
D. Catanach
R. Brown

HINKLE, COX, EATON, COFFIELD & HENSLEY

ATTORNEYS AT LAW

500 MARQUETTE N.W., SUITE 800
ALBUQUERQUE, NEW MEXICO 87102-2121

(505) 768-1500

FAX (505) 768-1529

OF COUNSEL
D. M. CALHOUN*
MACK EASLEY
JOE W. WOOD
RICHARD S. MORRIS

CLARENCE E. HINKLE (190-1985)
W. E. BONDURANT, JR. (1913-1973)
ROY C. SNODGRASS, JR. (1914-1987)

November 14, 1990

LEWIS C. COX
PAUL W. EATON
CONRAD E. COFFIELD
HAROLD L. HENSLEY, JR.
STUART D. SHANOR
ERIC D. LANFHERE
C. D. MARTIN
PAUL J. KELLY, JR.
MARSHALL G. MARTIN
OWEN M. LOPEZ
DOUGLAS L. LUNSFORD
JOHN J. KELLY
T. CALDER EZZELL, JR.
WILLIAM B. BURFORD*
RICHARD E. OLSON
RICHARD R. WILFONG*
THOMAS J. MCBRIDE
STEVEN D. ARNOLD
JAMES J. WECHSLER
NANCY S. CUSACK
JEFFREY L. FORNACIARI
JEFFREY D. HEWETT
JAMES BRUCE
JERRY F. SHACKELFORD*
JEFFREY W. HELLBERG*
ALBERT L. PITTS
THOMAS M. HNASKO
JOHN C. CHAMBERS*
MICHAEL A. GROSS
THOMAS D. HAINES, JR.

FRANKLIN H. MCALLUM*
GREGORY J. NIBERT
DAVID T. MARKETTE*
MARK C. DOW
KAREN M. RICHARDSON*
FRED W. SCHWENDIMANN
JAMES M. HUDSON

STANLEY K. KOTOVSKY, JR.
BETTY H. LITTLE*
JEFFREY S. BARO*
RUTH S. MCGRAVE
HOWARD P. THOMAS
PATRICIA A. WATTS
VACCONNEL GORDON
REBECCA N. CHOLS. JOHNSON
WILLIAM P. JOHNSON
ELLEN S. CASEY
S. BARRY PASNER
MARGARET CARTER LUDEWIG
MARTIN MEYERS
GREGORY S. WHEELER
ANDREW J. CLOUTIER
JAMES A. GILLESPIE
GARY W. JARSON
STEPHANE LANDRY
JOHN R. KULSETH, JR.
LISA K. SMITH*

*NOT LICENSED IN NEW MEXICO

DIVISION
ALBUQUERQUE

NOV 15 1990

700 UNITED BANK PLAZA
POST OFFICE BOX 10
ROSWEEL, NEW MEXICO 88202
(505) 622-6510
FAX (505) 623-9332

280C CLAYDESTA NATIONAL BANK BUILDING

POST OFFICE BOX 3580
MIDLAND, TEXAS 79702
(915) 683-4691
FAX (915) 683-6518

700 TEAM BANK BUILDING

POST OFFICE BOX 9238
AMARILLO, TEXAS 79105
(806) 372-5569
FAX (806) 372-9761

218 MONTEZUMA
POST OFFICE BOX 2068
SANTA FE, NEW MEXICO 87504
(505) 982-4554
FAX (505) 982-8623

Handwritten notes: "11-15-90" and "File" with a checkmark.

Mr. Jim Morrow
New Mexico Oil Conservation
Division
P. O. Box 2088
Santa Fe, New Mexico 87504

Re: Sage Energy Company (Case No. 10,102 and 10,103)

Dear Mr. Morrow:

Regarding the COPAS attached to the Operating Agreement, I have notified my client of the juxtaposition of figures regarding overhead rates, and they will be sending you a corrected page. Also enclosed is a list of fresh water wells within the area of review.

Very truly yours,

HINKLE, COX, EATON, COFFIELD &
HENSLEY

Signature of James Bruce
By: James Bruce

JB:le

SAGE ENERGY COMPANY

P. O. DRAWER 8068

MIDLAND, TEXAS 79702

915/683-5271

FILE COPY
OCT 15 '90

October 12, 1990

FILE

State of New Mexico Energy, Minerals and Natural Resources
Oil Conservation Division
P. O. Box 2088
Santa Fe, New Mexico 87504

Attn: Mr. Jim Morrow

RE: North Vacuum (Abo) Unit
Lea County, New Mexico
Case No. 10103

Dear Mr. Morrow:

As you requested at the hearing on October 3, 1990, for Case No. 10103, enclosed is the water analysis of two fresh water wells. These wells are located northwest of the commercial fresh water well which is located in section 36. The water analysis for the commercial well is attached to Sage Energy's C-108 application dated August 10, 1990.

If further information is needed please contact Jay Hardy at the Midland office or Lee Patrick at the San Antonio office.

Sincerely,

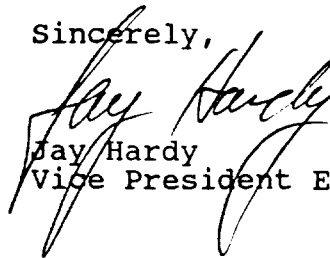

Jay Hardy
Vice President Engineering

CC: James Bruce
Hinkle, Cox, Eaton, Coffield & Hensley

Lee Patrick
Sage Energy San Antonio

File

Enclosures

JH/bb

LABORATORY WATER ANALYSIS

No. 227

To: Sage Energy

Date: 10-11-90

Drawer 3068

Midland Texas

Att: Jay Hardy

This report is the property of Halliburton Company and neither it nor any part thereof nor a copy thereof is to be published or disclosed without first securing the express written approval of laboratory management; it may however, be used in the course of regular business operations by any person or concern and employees thereof receiving such report from Halliburton Company.

Submitted by: Date Rec: 10-11-90

Well No. Depth Formation

County Field Source

Windmill well south of Penzoil 35A^{*}, Windmill well north of Penzoil 35^{#1}

SE1/4, SW1/4 Sec 35, T-16-S

SE1/4 NE1/4 Sec. 35 T-16-S

R-34-E

R-34-E

Resistivity

Specific Gravity 1.000 .095

pH 6.4 6.5

Calcium (Ca) 75 70 *MPL

Magnesium (Mg) 9 9

Chlorides (Cl) 100 100

Sulfates (SO₄) NIL NILBicarbonates (HCO₃) 61 152.5

Soluble Iron (Fe) NIL NIL

Remarks: *Milligrams per liter

Respectfully submitted,

Analyst

cc:

HALLIBURTON COMPANY

By

CHEMIST

NOTICE

THIS REPORT IS LIMITED TO THE DESCRIBED SAMPLE TESTED. ANY USER OF THIS REPORT AGREES THAT HALLIBURTON SHALL NOT BE LIABLE FOR ANY LOSS OR DAMAGE, WHETHER IT BE TO ACT OR OMISSION, RESULTING FROM SUCH REPORT OR ITS USE.

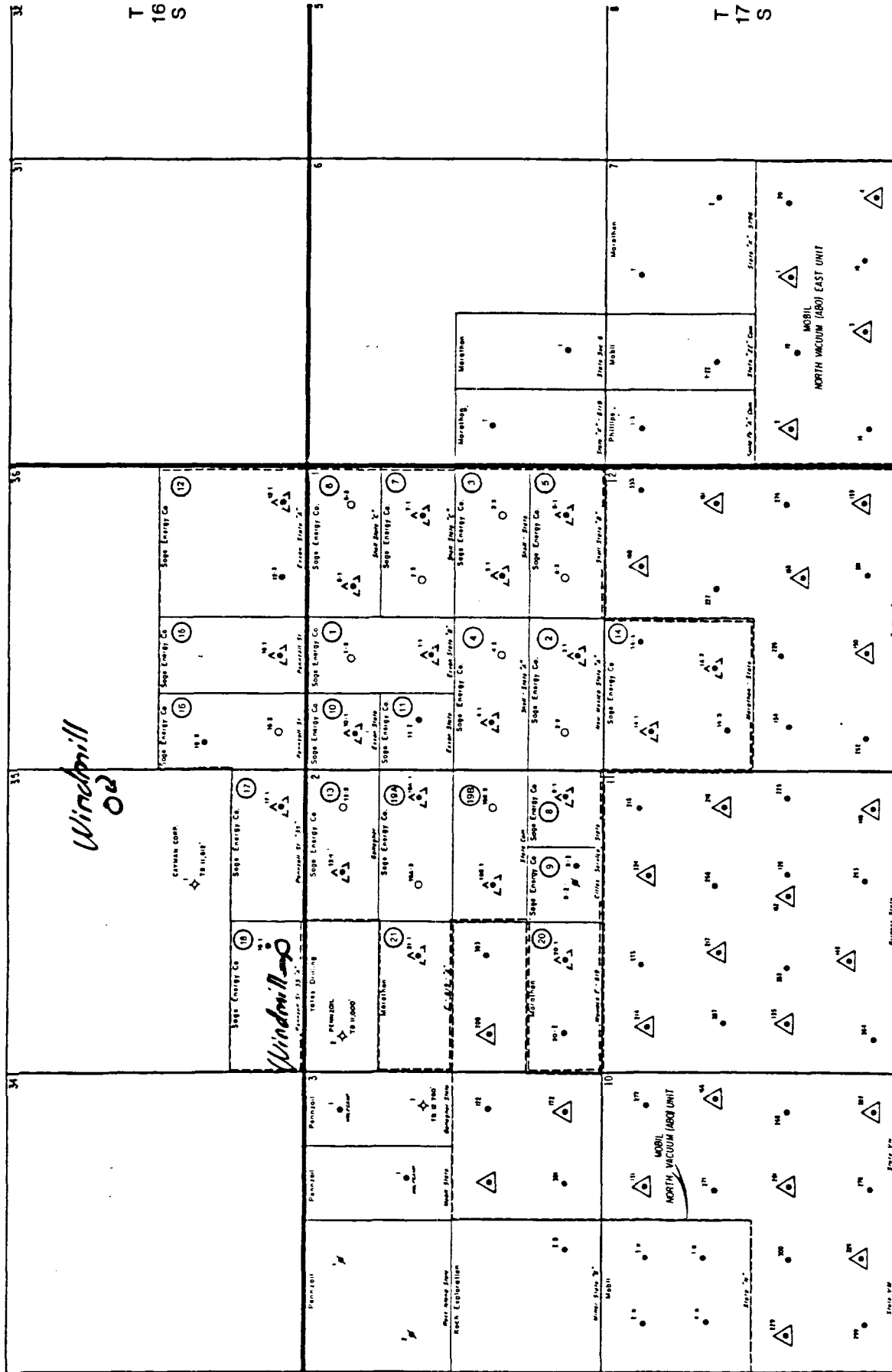

R 34 E

R 35 E

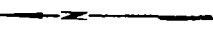

Sage Energy Company
Midland, Texas

- INJECTION WELL
- △ UNIT BOUNDARY
- △ PROPOSED INJECTION WELL
- PROPOSED PRODUCING WELL

PROPOSED NORTH VACUUM (ABO) NORTH UNIT
LEA COUNTY, NEW MEXICO

T 16 S, R 34 E
T 17 S, R 34 E

Scale: 1 inch = 1 mile 1988

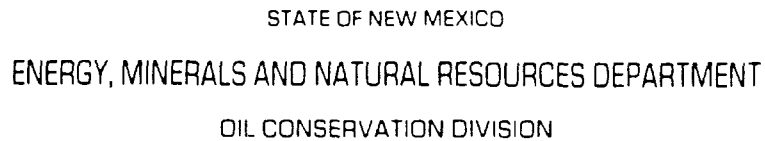

POST OFFICE BOX 2089
STATE LAND OFFICE BUILDING
SANTA FE, NEW MEXICO 87504
(505) 827-5800

Mr. James Bruce
Hinkle, Cox, Eaton,
Coffield & Hensley
Attorneys at Law
500 Marquette, N.W., Suite 800
Albuquerque, New Mexico 87102-2121

Re: CASE NO. 10103
ORDER NO. R-9359

Applicant:
Sage Energy Company

Dear Sir:

Enclosed herewith are two copies of the above-referenced Division order recently entered in the subject case.

Sincerely,

Florene Davidson

FLORENE DAVIDSON
OC Staff Specialist

Copy of order also sent to:

| | |
|-------------|----------|
| Hobbs OCD | <u>x</u> |
| Artesia OCD | <u>x</u> |
| Aztec OCD | |

Other _____