

MERIDIAN OIL

October 31, 1990

Federal Express

Mr. William LeMay
New Mexico Oil Conservation Division
310 Old Santa Fe Trail
Santa Fe, New Mexico 87503

Case 10132

RE: Angel Peak B #44
485'FNL, 2310'FWL
Section 24, T-28-N, R-11-W
San Juan County, New Mexico

Dear Mr. LeMay:

This is a request for administrative approval for a non-standard gas well location in the Basin Fruitland Pool.

Meridian Oil intends to plugback and recomplete the Angel Peak B #44 well from the Gallup pool to the Basin Fruitland Coal Pool. The current location of this well is 485'FNL, 2310'FWL, Section 24, T-28-N, R-11-W, San Juan County, New Mexico. The well is considered non-standard due to the NE-SW dedicated pattern established for the Basin Fruitland Coal Pool. To comply with the New Mexico Oil Conservation Division rules, Meridian is submitting the following for your approval of this non-standard location:

1. C-102 plat showing location of the well;
2. Plat showing offset owners/operators;
3. Affidavit of notification of offset owners/operators;
4. Copy of Well Completion Log for original completion.

A copy of this application is being submitted to all offset owners/operators by certified mail with a request that they furnish your Santa Fe office with a Waiver of Objection, and return one copy to this office.

Sincerely yours,

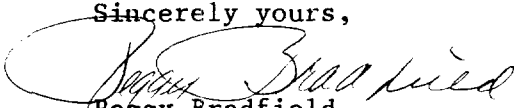

Peggy Bradfield
encl.

WAIVER

_____ hereby waives objection to Meridian Oil Inc.'s application for a non-standard location for their Angel Peak B #44 as proposed above.

By: _____ Date: _____

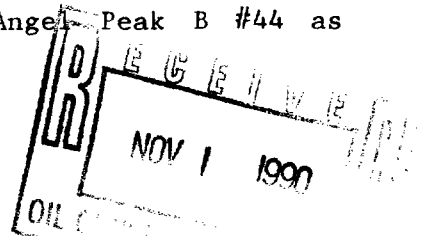
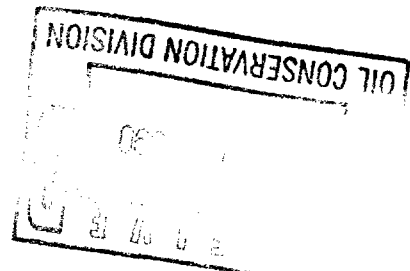
xc: Chapparral Oil & Gas Co.
General Minerals Corp.



Angel Peak B #44
485'FNL, 2310'FWL
Section 24, T-28-N, R-11-W
San Juan County, New Mexico

I hereby certify that the following offset owners/operators have been notified by certified mail of our application for administrative approval for non-standard gas well location for the plugback and recompletion of the above well.

Chapparal Oil & Gas Co.
P.O. Box 1289
Noble, OK 73068-1289

General Minerals Corp.
621 17th Street, Suite 1301
Denver, CO 80293

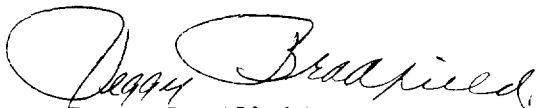

Peggy Bradfield
October 31, 1990

San Juan County
State of New Mexico

My commission expires August 17, 1992

MERIDIAN OIL INC

Well Name Angel Peak B #44

Footage 485' FNL; 2310' FWL

APPLICATION FOR NON-STANDARD LOCATION

County San Juan State New Mexico Section 24 Township 28N Range 11 W

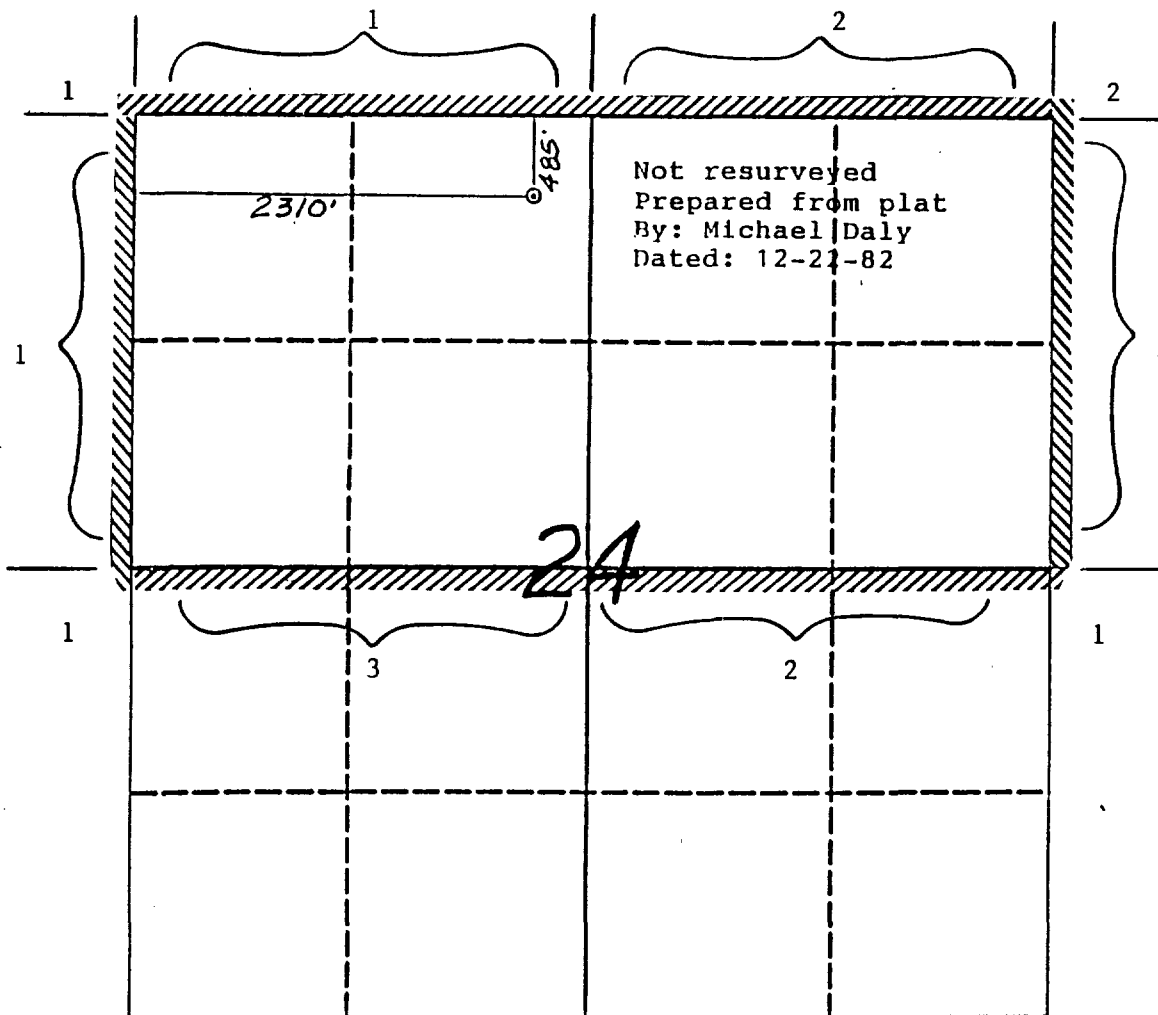

Remarks (1) Meridian Oil Inc

(2) Chapparal Oil & Gas Co.

P.O. Box 1289, Noble, OK 73068

(3) General Minerals Corp.

621 17th Street, Suite 1301, Denver, CO 80293

Submit to Appropriate
District Office
State Lease - 4 copies
Fee Lease - 3 copies

State of New Mexico
Energy, Minerals and Natural Resources Department

Form C-102
Revised 1-1-89

OIL CONSERVATION DIVISION

P.O. Box 2088

Santa Fe, New Mexico 87504-2088

DISTRICT I

P.O. Box 1980, Hobbs, NM 88240

DISTRICT II

P.O. Drawer 00, Aramis, NM 88210

DISTRICT III

1000 Rio Benson Rd., Aztec, NM 87410

WELL LOCATION AND ACREAGE DEDICATION PLAT

All Distances must be from the outer boundaries of the section

Operator Meridian Oil Inc.			Lease Angel Peak B (SF-047017B)			Well No. 44		
Unit Letter C	Section 24	Township 28 North	Range 11 West	County San Juan				
Actual Footage Location of Well: 485 feet from the North line and 2310 feet from the West line								
Ground level Elev. 5809'		Producing Formation Fruitland Coal			Pool Basin		Dedicated Acreage: 320 Acres	

1. Outline the acreage dedicated to the subject well by colored pencil or ink on the plat below.

2. If more than one lease is dedicated to the well, outline each and identify the ownership thereof (both as to working interest and royalty).

3. If more than one lease of different ownership is dedicated to the well, have the interests of all owners been consolidated by communitization, unitization, force-pooling, etc.?

☐ Yes

☐ No

If answer is "yes" type of consolidation communitization agreement will be

If answer is "no" list the owners and tract descriptions which have actually been consolidated. (Use reverse side of this form if necessary.) obtained

No allowable will be assigned to the well until all interests have been consolidated (by communitization, unitization, force-pooling, or otherwise) or until a non-standard unit, eliminating such interest, has been approved by the Division.

2310'		485'	Not resurveyed Prepared from plat By: Michael Daly Dated: 12-22-82
24			

OPERATOR CERTIFICATION

I hereby certify that the information contained herein is true and complete to the best of my knowledge and belief.

Signature

Peggy Bradfield

Printed Name

Regulatory Affairs

Position

Meridian Oil Inc.

Company

Date

SURVEYOR CERTIFICATION

I hereby certify that the well location shown on this plat was plotted from field notes of actual surveys made by me or under my supervision, and that the same is true and correct to the best of my knowledge and belief. 10-26-90

Date Surveyed

Signature of Surveyor
Professional Surveyor



Certified by
Neale Edwards

UNITED STATES
DEPARTMENT OF THE INTERIOR
GEOLOGICAL SURVEY

SUBMIT IN DUPLICATE*

(See other instructions on reverse side)

Form approved.
Budget Bureau No. 42-R355.5.

WELL COMPLETION OR RECOMPLETION REPORT AND LOG *

1a. TYPE OF WELL: OIL WELL <input checked="" type="checkbox"/> GAS WELL <input type="checkbox"/> DRY <input type="checkbox"/> Other _____		5. LEASE DESIGNATION AND SERIAL NO. SF 047017 B																															
b. TYPE OF COMPLETION: NEW WELL <input checked="" type="checkbox"/> WORK OVER <input type="checkbox"/> DEEP-EN <input type="checkbox"/> PLUG BACK <input type="checkbox"/> DIFF. RESVR. <input type="checkbox"/> Other _____		6. IF INDIAN, ALLOTTEE OR TRIBE NAME																															
2. NAME OF OPERATOR Union Texas Petroleum Corporation		7. UNIT AGREEMENT NAME																															
3. ADDRESS OF OPERATOR P.O. Box 1290, Farmington, New Mexico 87499		8. FARM OR LEASE NAME Angel Peak B																															
4. LOCATION OF WELL (Report location clearly and in accordance with any State requirements)* At surface 485 ft/North; 2310 ft/West At top prod. interval reported below Same as above At total depth Same as above		9. WELL NO. 44																															
10. FIELD AND POOL, OR WILDCAT Undesignated Gallup		11. SEC., T., R., M., OR BLOCK AND SURVEY OR AREA Section 24, T28N-R11W NMPN																															
12. PERMIT NO. BUREAU OF LAND MANAGEMENT FARMINGTON RESOURCE AREA		13. COUNTY OR PARISH San Juan																															
14. DATE ISSUED OCT 14 1983		15. STATE New Mexico																															
15. DATE SPUDDED 7-27-83	16. DATE T.D. REACHED 8-5-83	17. DATE COMPL. (Ready to prod.) 8-15-83	18. ELEVATIONS (DF, RKB, RT, GR, ETC.)* 5821' RKB																														
19. ELEV. CASINGHEAD 5809' GR	20. TOTAL DEPTH, MD & TVD 6263'																																
21. PLUG BACK T.D., MD & TVD 6213'	22. IF MULTIPLE COMPL., HOW MANY*	23. INTERVALS DRILLED BY 0-6263'	24. PRODUCING INTERVAL(S), OF THIS COMPLETION—TOP, BOTTOM, NAME (MD AND TVD)* 6142' - 6192' Greenhorn 5393' - 5914' Gallup																														
25. WAS DIRECTIONAL SURVEY MADE No			26. TYPE ELECTRIC AND OTHER LOGS RUN DIL-GR, CDL-CNL-GR																														
27. WAS WELL CORED No			28. CASING RECORD (Report all strings set in well)																														
<table border="1"><thead><tr><th>CASING SIZE</th><th>WEIGHT, LB./FT.</th><th>DEPTH SET (MD)</th><th>HOLE SIZE</th><th>CEMENTING RECORD</th><th>AMOUNT PULLED</th></tr></thead><tbody><tr><td>9-5/8"</td><td>36</td><td>321'</td><td>12-1/2"</td><td>325 cu.ft.</td><td></td></tr><tr><td>7"</td><td>23</td><td>5260'</td><td>8-3/4"</td><td>2656 cu.ft. (2stage)</td><td></td></tr><tr><td>4-1/2"</td><td>11.6</td><td>5045'-6263'</td><td>6-1/4"</td><td>192 cu.ft.</td><td></td></tr><tr><td colspan="5">(See Attachment)</td><td></td></tr></tbody></table>				CASING SIZE	WEIGHT, LB./FT.	DEPTH SET (MD)	HOLE SIZE	CEMENTING RECORD	AMOUNT PULLED	9-5/8"	36	321'	12-1/2"	325 cu.ft.		7"	23	5260'	8-3/4"	2656 cu.ft. (2stage)		4-1/2"	11.6	5045'-6263'	6-1/4"	192 cu.ft.		(See Attachment)					
CASING SIZE	WEIGHT, LB./FT.	DEPTH SET (MD)	HOLE SIZE	CEMENTING RECORD	AMOUNT PULLED																												
9-5/8"	36	321'	12-1/2"	325 cu.ft.																													
7"	23	5260'	8-3/4"	2656 cu.ft. (2stage)																													
4-1/2"	11.6	5045'-6263'	6-1/4"	192 cu.ft.																													
(See Attachment)																																	
29. LINER RECORD																																	
<table border="1"><thead><tr><th>SIZE</th><th>TOP (MD)</th><th>BOTTOM (MD)</th><th>SACKS CEMENT*</th><th>SCREEN (MD)</th></tr></thead><tbody><tr><td>4-1/2"</td><td>5045'</td><td>6263'</td><td>192cu.ft.</td><td></td></tr></tbody></table>				SIZE	TOP (MD)	BOTTOM (MD)	SACKS CEMENT*	SCREEN (MD)	4-1/2"	5045'	6263'	192cu.ft.																					
SIZE	TOP (MD)	BOTTOM (MD)	SACKS CEMENT*	SCREEN (MD)																													
4-1/2"	5045'	6263'	192cu.ft.																														
30. TUBING RECORD																																	
<table border="1"><thead><tr><th>SIZE</th><th>DEPTH SET (MD)</th><th>PACKER SET (MD)</th></tr></thead><tbody><tr><td>2-3/8"</td><td>6097'</td><td></td></tr></tbody></table>				SIZE	DEPTH SET (MD)	PACKER SET (MD)	2-3/8"	6097'																									
SIZE	DEPTH SET (MD)	PACKER SET (MD)																															
2-3/8"	6097'																																
31. PERFORATION RECORD (Interval, size and number)																																	
6142' - 6192' 26 holes 5393' - 5914' 42 holes																																	
32. ACID, SHOT, FRACTURE, CEMENT SQUEEZE, ETC.																																	
<table border="1"><thead><tr><th>DEPTH INTERVAL (MD)</th><th>AMOUNT AND KIND OF MATERIAL USED</th></tr></thead><tbody><tr><td>6142'-6192'</td><td>See Attachment</td></tr><tr><td>5393'-5914'</td><td>See Attachment</td></tr></tbody></table>				DEPTH INTERVAL (MD)	AMOUNT AND KIND OF MATERIAL USED	6142'-6192'	See Attachment	5393'-5914'	See Attachment																								
DEPTH INTERVAL (MD)	AMOUNT AND KIND OF MATERIAL USED																																
6142'-6192'	See Attachment																																
5393'-5914'	See Attachment																																
33. PRODUCTION																																	
<table border="1"><thead><tr><th>DATE FIRST PRODUCTION</th><th>PRODUCTION METHOD (Flowing, gas lift, pumping—size and type of pump)</th><th>WELL STATUS (Producing or shut-in)</th></tr></thead><tbody><tr><td>9-8-83</td><td>Flowing</td><td>Producing</td></tr></tbody></table>				DATE FIRST PRODUCTION	PRODUCTION METHOD (Flowing, gas lift, pumping—size and type of pump)	WELL STATUS (Producing or shut-in)	9-8-83	Flowing	Producing																								
DATE FIRST PRODUCTION	PRODUCTION METHOD (Flowing, gas lift, pumping—size and type of pump)	WELL STATUS (Producing or shut-in)																															
9-8-83	Flowing	Producing																															
<table border="1"><thead><tr><th>DATE OF TEST</th><th>HOURS TESTED</th><th>CHOKE SIZE</th><th>PROD'N. FOR TEST PERIOD</th><th>OIL—BBL.</th><th>GAS—MCF.</th><th>WATER—BBL.</th><th>GAS-OIL RATIO</th></tr></thead><tbody><tr><td>9-20-83</td><td>10</td><td>1"</td><td>→</td><td>33</td><td>30</td><td>20</td><td>909</td></tr></tbody></table>				DATE OF TEST	HOURS TESTED	CHOKE SIZE	PROD'N. FOR TEST PERIOD	OIL—BBL.	GAS—MCF.	WATER—BBL.	GAS-OIL RATIO	9-20-83	10	1"	→	33	30	20	909														
DATE OF TEST	HOURS TESTED	CHOKE SIZE	PROD'N. FOR TEST PERIOD	OIL—BBL.	GAS—MCF.	WATER—BBL.	GAS-OIL RATIO																										
9-20-83	10	1"	→	33	30	20	909																										
<table border="1"><thead><tr><th>FLOW. TUBING PRESS.</th><th>CASING PRESSURE</th><th>CALCULATED 24-HOUR RATE</th><th>OIL—BBL.</th><th>GAS—MCF.</th><th>WATER—BBL.</th><th>OIL GRAVITY-API (CORR.)</th></tr></thead><tbody><tr><td>125</td><td>780</td><td>→</td><td>79</td><td>72</td><td>48</td><td>40°</td></tr></tbody></table>				FLOW. TUBING PRESS.	CASING PRESSURE	CALCULATED 24-HOUR RATE	OIL—BBL.	GAS—MCF.	WATER—BBL.	OIL GRAVITY-API (CORR.)	125	780	→	79	72	48	40°																
FLOW. TUBING PRESS.	CASING PRESSURE	CALCULATED 24-HOUR RATE	OIL—BBL.	GAS—MCF.	WATER—BBL.	OIL GRAVITY-API (CORR.)																											
125	780	→	79	72	48	40°																											
34. DISPOSITION OF GAS (Sold, used for fuel, vented, etc.)																																	
Sold																																	
35. LIST OF ATTACHMENTS Cementing and Stimulation Records																																	
36. I hereby certify that the foregoing and attached information is complete and correct as determined from all available records																																	
SIGNED J.A. Edmister		TITLE Engineering Analyst																															
DATE OCT 30 1983		DATE OCT 30 1983																															

* (See Instructions and Spaces for Additional Data on Reverse Side) FARMINGTON RESOURCE AREA

OPERATOR
Smm