

RECEIVED

BEFORE THE

DEC 18 1990

OIL CONSERVATION DIVISION

OIL CONSERVATION DIV.
SANTA FE

DEPARTMENT OF ENERGY, MINERALS AND NATURAL RESOURCES

IN THE MATTER OF THE APPLICATION OF
BLACKWOOD & NICHOLS CO. A LIMITED
PARTNERSHIP FOR DIRECTIONAL DRILLING,
AND AN UNORTHODOX WELL LOCATION,
RIO ARriba COUNTY, NEW MEXICO.

CASE NO. 10201

APPLICATION

COMES NOW BLACKWOOD & NICHOLS CO. A LIMITED PARTNERSHIP,
through its undersigned attorneys, and hereby makes application pursuant to Oil
Conservation Division Rule 111 to directionally drill its Northeast Blanco Unit Well No.
475, Basin Fruitland Coal Gas Pool, and for an unorthodox gas well location, and in
support of this application states:

1. Applicant is the operator of the Basin-Fruitland Coal Gas Pool, underlying
the following described lands:

TOWNSHIP 30 NORTH, RANGE 7 WEST, N.M.P.M.

Section 19: E/2

containing 320-acres, more or less.

2. Applicant proposes to directionally drill its Northeast Blanco Unit Well No.
475 from a surface location of 2560 feet from the South line and 1695 feet from the West
line of Section 20, Township 30 North, Range 7 West, N.M.P.M., to a bottomhole location
within 50 feet of a point 1750 feet from the North line and 54 feet from the East line of

Section 19, Township 30 North, Range 7 West, N.M.P.M., Rio Arriba County, New Mexico, with the intent of testing the Fruitland formation, Basin-Fruitland Coal Gas Pool.

3. The E/2 of Section 19 will be dedicated to this well.

4. The subject well is located in close proximity to Navajo Lake and must be directionally drilled to the above-referenced unorthodox location to enable the applicant to produce the reserves which underlie the above-described proration unit and, at the same time, keep the well a safe distance away from Navajo Dam.

5. Attached hereto and incorporated herein is a copy of OCD Form C-102 showing the proposed surface and bottomhole location for the subject well and a plat showing the general topography of the proposed proration unit.

6. Approval of this Application will enable the Applicant to produce hydrocarbons that otherwise would not be produced and will otherwise be in the best interest of conservation, the prevention of waste and the protection of correlative rights.

WHEREFORE, Applicant requests that this matter be set for hearing before a duly appointed Examiner of the Oil Conservation Division on January 10, 1991, that notice be given as required by law and the rules of the Division, and that the Division enter its Order granting the Applicant permission to directionally drill its Northeast Blanco Unit Well No. 475 and approving the unorthodox location for this well.

Respectfully submitted,

CAMPBELL & BLACK, P.A.

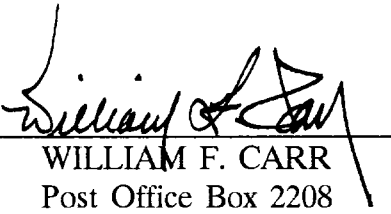
By: 
WILLIAM F. CARR
Post Office Box 2208
Santa Fe, New Mexico 87504
Telephone: (505) 988-4421

ATTORNEYS FOR BLACKWOOD
& NICHOLS CO. A LIMITED
PARTNERSHIP

Submit to Appropriate
District Office
State Lease - 4 copies
Fee Lease - 3 copies

State of New Mexico
Energy, Minerals and Natural Resources Department

Form C-102
Revised 1-1-89

OIL CONSERVATION DIVISION

P.O. Box 2088
Santa Fe, New Mexico 87504-2088

DISTRICT I
P.O. Box 1980, Hobbs, NM 88240

DISTRICT II
P.O. Drawer DD, Artesia, NM 88210

DISTRICT III
1000 Rio Brazos Rd., Aztec, NM 87410

WELL LOCATION AND ACREAGE DEDICATION PLAT

All Distances must be from the outer boundaries of the section

Operator Blackwood & Nichols Co, A Limited Partnership			Lease Northeast Blanco Unit		Well No. 475
Unit Letter K	Section 30N	Township 7W	Range NMPM	County Rio Arriba	
Actual Footage Location of Well: Bottom Hole: 1750' FNL - 54' FEL, Section 19					
face: 2560 feet from the South line and 1695 feet from the West line Section 20					
Ground level Elev. 6405'	Producing Formation Fruitland Coal	Pool Basin Fruitland Coal	Dedicated Acreage: 320 Acres		

1. Outline the acreage dedicated to the subject well by colored pencil or hatchure marks on the plat below.
2. If more than one lease is dedicated to the well, outline each and identify the ownership thereof (both as to working interest and royalty).
3. If more than one lease of different ownership is dedicated to the well, have the interest of all owners been consolidated by communitization, unitization, force-pooling, etc.?
☒ Yes ☐ No If answer is "yes" type of consolidation Unitization
 If answer is "no" list the owners and tract descriptions which have actually been consolidated. (Use reverse side of this form if necessary).
 No allowable will be assigned to the well until all interests have been consolidated (by communitization, unitization, force-pooling, or otherwise) or until a non-standard unit, eliminating such interest, has been approved by the Division.

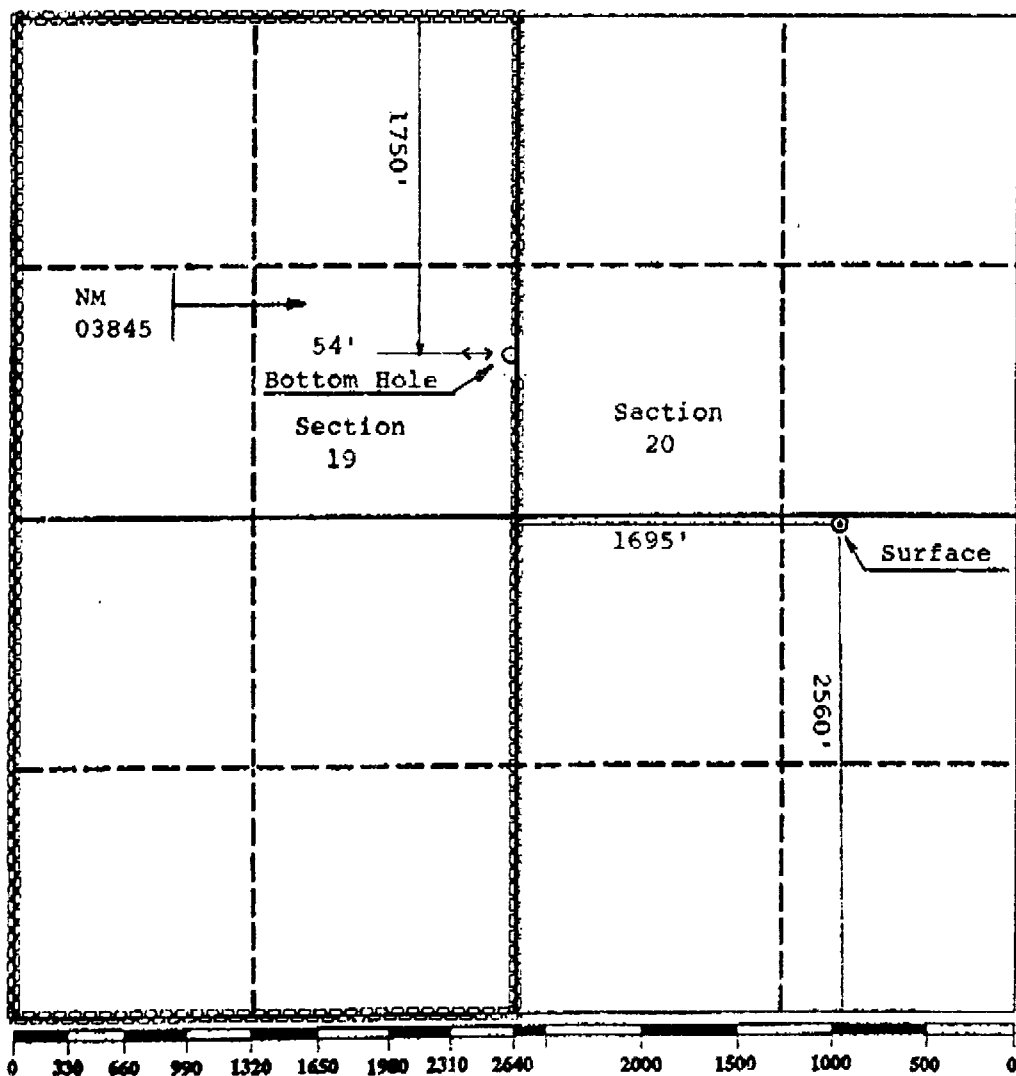

OPERATOR CERTIFICATION

I hereby certify that the information contained herein is true and complete to the best of my knowledge and belief.

Signature R.W. Williams
 Printed Name Roy W. Williams
 Position Administrative Manager
 Company Blackwood & Nichols Co., A Limited Partnership
 Date 12/17/90

SURVEYOR CERTIFICATION

I hereby certify that the well location shown on this plat was plotted from field notes of actual surveys made by me or under my supervision, and that the same is true and correct to the best of my knowledge and belief. 12/10/90

Date Surveyed 12/10/90
 Signature [Signature]
 Professional Seal: **NEW MEXICO**
REGISTERED LAND SURVEYOR
6857
Neale Edwards

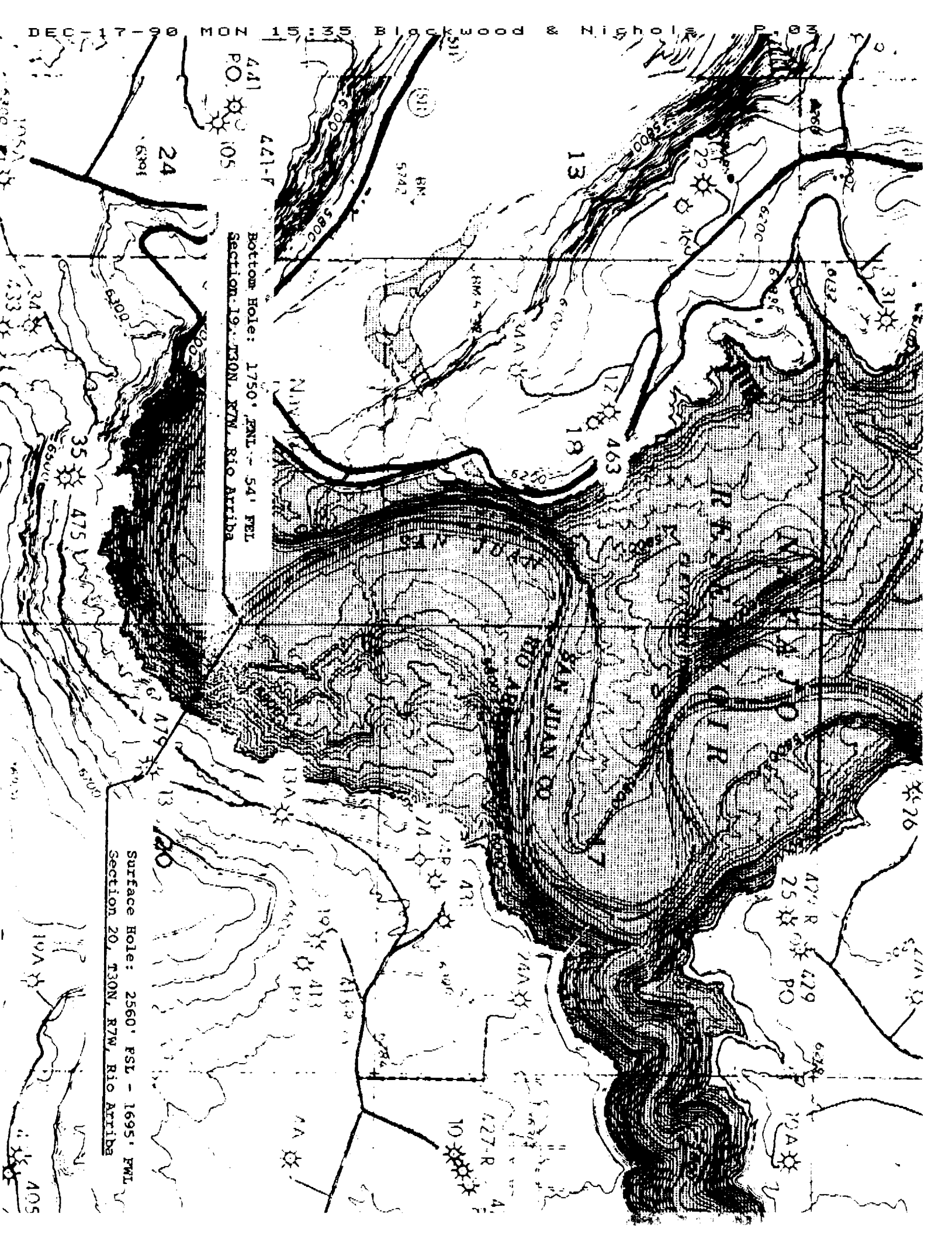

Bottom Hole: 1750' FNL - 54' FFL
Section 19, T30N, R7W, Rio Arriba

Surface Hole: 2560' FSL - 1695' FFL
Section 20, T30N, R7W, Rio Arriba