



Case 8592
**natural
resources
engineering inc.**

April 17, 1985

Oil Conservation Division
P. O. Box 2088
Santa Fe, New Mexico 87501

Attention: Dick Staments

RE: Form C-108
Caudill SWD #G-32
FM01-001-032

Dear Mr. Staments:

Please find attached copies of letters sent to the offset operators within the area of review for the above referenced well. This letter with a revised C-108 was sent to each of the offset operators via certified, return receipt requested, mail. When we receive the return receipts we will forward copies to the OCD.

Our letter of April 12 had some minor errors in it. The current injection zone was incorrect. It should have been 14172' to 14480' with the proposed injection zone to be 4950' - 14480'. Additionally the map showing the area of review was mismatched. I have attached a revised map. These corrections have been made on all copies sent to the offset operators. We are sorry for any inconvenience this may have caused.

Sincerely yours,

J. T. Janica
NRE, Agents for
Fannie Lee Mitchell, Inc.

Enclosures

cc: chrono
file
F. L. Mitchell, Inc.
J. Sexton - OCD, Hobbs

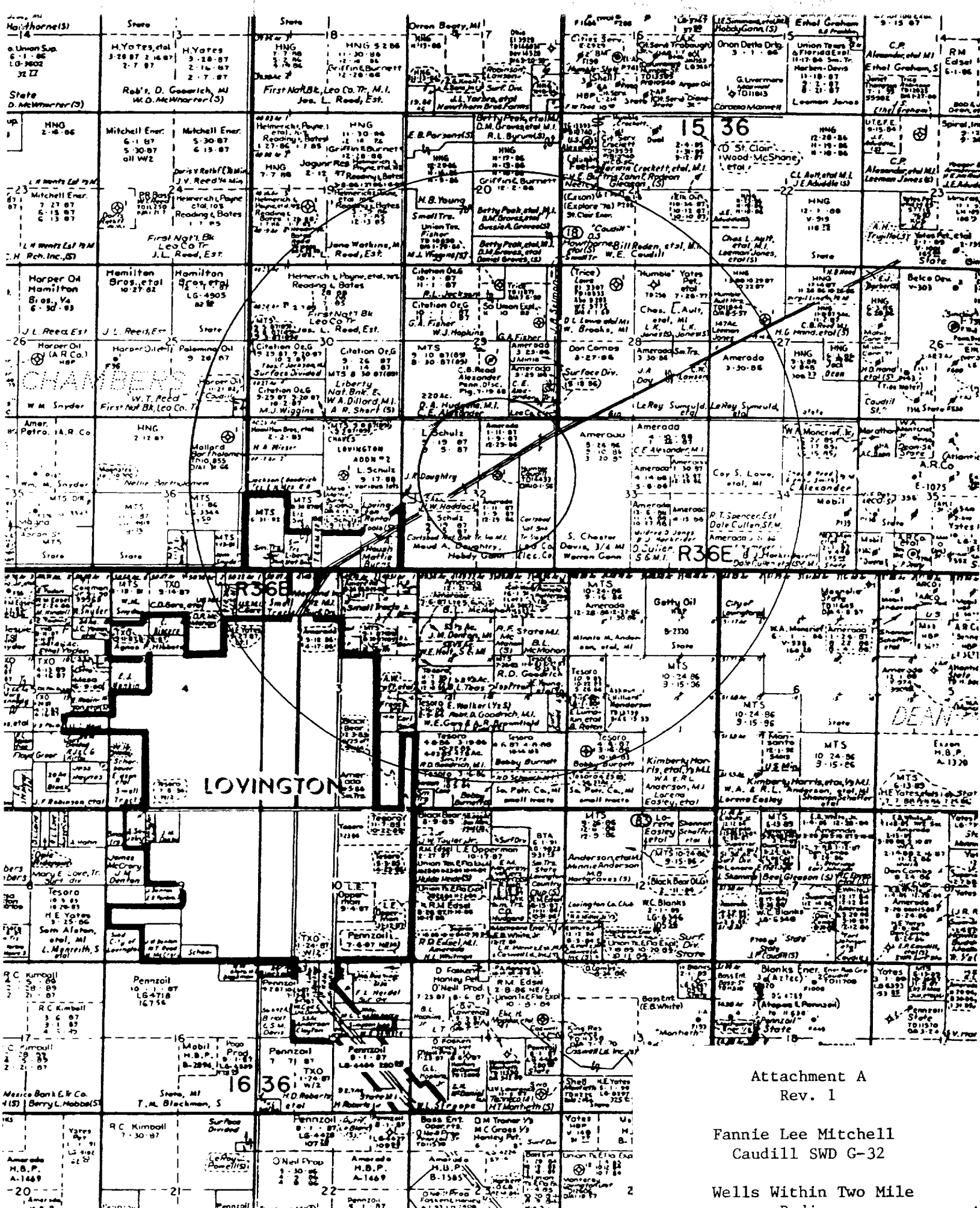



April 15, 1985

Mountain States Petroleum
P. O. Box 1936
Roswell, New Mexico 88201

Attention: K. C. Havenor

RE: Caudill SWD #6-32
1980' FNL, 1830' FEL
Sec. 32, T-15-S, R-36-E
Lea County, New Mexico

Dear Mr. Havenor:

Fannie Lee Mitchell is currently operating a disposal well located in Sec. 32, T-15-S, R-36-E, Lea County, New Mexico.

Attached for your review is a copy of the C-108 filed with the Oil Conservation Division requesting to increase the injection interval from 14172 - 14480' to 4950 - 14480'.

You are being furnished a copy of this C-108 as this well adjoins some non-producing property which you are the lessee of.

If you have any questions concerning this application, please feel free to contact our office.

Sincerely yours,

J. T. Janica
NRE, Agents for
Fannie Lee Mitchell

Enclosures

cc: chrono
file
F L Mitchell



April 15, 1985

L. Schulz
P. O. Box 3753
Midland, Texas 79702

RE: Caudill SWD #G-32
1980' FNL, 1830' FEL
Sec. 32, T-15-S, R-36-E
Lea County, New Mexico

Dear Mr. Schulz:

Fannie Lee Mitchell is currently operating a disposal well located in Sec. 32, T-15-S, R-36-E, Lea County, New Mexico.

Attached for your review is a copy of the C-108 filed with the Oil Conservation Division requesting to increase the injection interval from 14172 - 14480' to 4950 - 14480'.

You are being furnished a copy of this C-108 as this well adjoins some non-producing property which you are the lessee of.

If you have any questions concerning this application, please feel free to contact our office.

Sincerely yours,

J. T. Janica
NRE, Agents for
Fannie Lee Mitchell

Enclosures

cc: chrono
file
F L Mitchell



April 15, 1985

Hobdy Gann
P. O. Box 1505
Lovington, New Mexico 88260

RE: Caudill SWD #G-32
1980' FNL, 1830' FEL
Sec. 32, T-15-S, R-36-E
Lea County, New Mexico

Dear Mr. Gann:

Fannie Lee Mitchell is currently operating a disposal well located in Sec. 32, T-15-S, R-36-E, Lea County, New Mexico.

Attached for your review is a copy of the C-108 filed with the Oil Conservation Division requesting to increase the injection interval from 14172 - 14480' to 4950 - 14480'.

You are being furnished a copy of this C-108 as this well adjoins some non-producing property which you are the surface owner of.

If you have any questions concerning this application, please feel free to contact our office.

Sincerely yours,

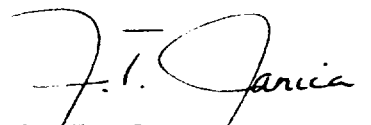
J. T. Janica
NRE, Agents for
Fannie Lee Mitchell

Enclosures

cc: chrono
file
F L Mitchell



April 15, 1985

Amerada Hess
P. O. Box 840
Seminole, Texas 79360

Attention: J. I. Johnson

RE: Caudill SWD #G-32
1980' FNL, 1830' FEL
Sec. 32, T-15-S, R-36-E
Lea County, New Mexico

Dear Mr. Johnson:

Fannie Lee Mitchell is currently operating a disposal well located in Sec. 32, T-15-S, R-36-E, Lea County, New Mexico.

Attached for your review is a copy of the C-108 filed with the Oil Conservation Division requesting to increase the injection interval from 14172 - 14480' to 4950 - 14480'.

You are being furnished a copy of this C-108 as this well adjoins some non-producing property which you are the lessee of.

If you have any questions concerning this application, please feel free to contact our office.

Sincerely yours,

J. T. Janica
NRE, Agents for
Fannie Lee Mitchell

Enclosures

cc: chrono
file
F L Mitchell



April 23, 1985

Oil Conservation Division
P. O. Box 2088
Santa Fe, New Mexico 87501

Attention: Dick Staments

RE: Caudill SWD #G-32
FM01-001-001

Dear Mr. Staments:

Attached please find a copies of the certified mail receipts that we have received from the offset operators of the Caudill SWD #G-32. These mail receipts are our proof of notification of offset operators.

If you have any questions or if further information is needed, please contact our office.

Yours truly,

Jan E. Clark
NRE, Agents for
Fannie Lee Mitchell, Inc.

Enclosures

cc: chrono
file
F. L. Mitchell, Inc.
J. Sexton - OCD, Hobbs

SENDER: Complete items 1, 2, 3 and 4.

Put your address in the "RETURN TO" space on the reverse side. Failure to do this will prevent this card from being returned to you. The return receipt fee will provide you the name of the person delivered to and the date of delivery. For additional fees the following services are available. Consult postmaster for fees and check box(es) for service(s) requested.

1. ☒ Show to whom, date and address of delivery.
 2. ☐ Restricted Delivery.

3. Article Addressed to:
 Mountain States Petroleum
 P. O. Box 1936
 Roswell, NM 88201

Attention: K. C. Havenor

| | |
|---|----------------|
| 4. Type of Service: | Article Number |
| <input type="checkbox"/> Registered <input type="checkbox"/> Insured <input checked="" type="checkbox"/> Certified <input type="checkbox"/> COD <input type="checkbox"/> Express Mail | P 497 960 844 |

Always obtain signature of addressee or agent and
DATE DELIVERED.

5. Signature - Addressee
K. C. Havenor

6. Signature - Agent

X

7. Date of Delivery

8. Addressee's Address (ONLY if requested and fee paid)

SENDER: Complete items 1, 2, 3 and 4.

Put your address in the "RETURN TO" space on the reverse side. Failure to do this will prevent this card from being returned to you. The return receipt fee will provide you the name of the person delivered to and the date of delivery. For additional fees the following services are available. Consult postmaster for fees and check box(es) for service(s) requested.

1. ☒ Show to whom, date and address of delivery.
 2. ☐ Restricted Delivery.

3. Article Addressed to:
 Amerada Hess
 P. O. Box 840
 Seminole, TX 79360

Attention: J. I. Johnson

| | |
|---|----------------|
| 4. Type of Service: | Article Number |
| <input type="checkbox"/> Registered <input type="checkbox"/> Insured <input checked="" type="checkbox"/> Certified <input type="checkbox"/> COD <input type="checkbox"/> Express Mail | P 497 960 845 |

Always obtain signature of addressee or agent and
DATE DELIVERED.

5. Signature - Addressee
J. I. Johnson

6. Signature - Agent

X

7. Date of Delivery

8. Addressee's Address (ONLY if requested and fee paid)

SENDER: Complete items 1, 2, 3 and 4.

Put your address in the "RETURN TO" space on the reverse side. Failure to do this will prevent this card from being returned to you. The return receipt fee will provide you the name of the person delivered to and the date of delivery. For additional fees the following services are available. Consult postmaster for fees and check box(es) for service(s) requested.

1. ☒ Show to whom, date and address of delivery.
 2. ☐ Restricted Delivery.

3. Article Addressed to:
 Hobdy Gann
 P. O. Box 1505
 Lovington, NM 88260

| | |
|---|----------------|
| 4. Type of Service: | Article Number |
| <input type="checkbox"/> Registered <input type="checkbox"/> Insured <input checked="" type="checkbox"/> Certified <input type="checkbox"/> COD <input type="checkbox"/> Express Mail | P 497 960 846 |

Always obtain signature of addressee or agent and
DATE DELIVERED.

5. Signature - Addressee
Hobdy Gann

6. Signature - Agent

X

7. Date of Delivery

8. Addressee's Address (ONLY if requested and fee paid)

SENDER: Complete items 1, 2, 3 and 4.

Put your address in the "RETURN TO" space on the reverse side. Failure to do this will prevent this card from being returned to you. The return receipt fee will provide you the name of the person delivered to and the date of delivery. For additional fees the following services are available. Consult postmaster for fees and check box(es) for service(s) requested.

1. ☒ Show to whom, date and address of delivery.
 2. ☐ Restricted Delivery.

3. Article Addressed to:
 L. Schulz
 P. O. Box 3753
 Midland, TX 79702

| | |
|---|----------------|
| 4. Type of Service: | Article Number |
| <input type="checkbox"/> Registered <input type="checkbox"/> Insured <input checked="" type="checkbox"/> Certified <input type="checkbox"/> COD <input type="checkbox"/> Express Mail | P 497 960 843 |

Always obtain signature of addressee or agent and
DATE DELIVERED.

5. Signature - Addressee
L. Schulz

6. Signature - Agent

X

7. Date of Delivery

8. Addressee's Address (ONLY if requested and fee paid)

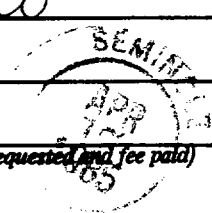

PS Form 3811, July 1983 447-845

SENDER: Complete items 1, 2, 3 and 4.

Put your address in the "RETURN TO" space on the reverse side. Failure to do this will prevent this card from being returned to you. The return receipt fee will provide you the name of the person delivered to and the date of delivery. For additional fees the following services are available. Consult postmaster for fees and check box(es) for service(s) requested.

1. ☒ Show to whom, date and address of delivery.

2. ☐ Restricted Delivery.

3. Article Addressed to:
Mountain States Petroleum
P. O. Box 1936
Roswell, NM 88201

Attention: K. C. Havenor

| 4. Type of Service: | Article Number |
|---|----------------|
| <input type="checkbox"/> Registered <input type="checkbox"/> Insured <input checked="" type="checkbox"/> Certified <input type="checkbox"/> COD <input type="checkbox"/> Express Mail | P 497 960 844 |

Always obtain signature of addressee or agent and **DATE DELIVERED.**

5. Signature - Addressee
K. C. Havenor

6. Signature - Agent
X

7. Date of Delivery

8. Addressee's Address (ONLY if requested and fee paid)

DOMESTIC RETURN RECEIPT

PS Form 3811, July 1983 447-845

SENDER: Complete items 1, 2, 3 and 4.

Put your address in the "RETURN TO" space on the reverse side. Failure to do this will prevent this card from being returned to you. The return receipt fee will provide you the name of the person delivered to and the date of delivery. For additional fees the following services are available. Consult postmaster for fees and check box(es) for service(s) requested.

1. ☒ Show to whom, date and address of delivery.

2. ☐ Restricted Delivery.

3. Article Addressed to:

Hobdy Gann
P. O. Box 1505
Lovington, NM 88260

| 4. Type of Service: | Article Number |
|---|----------------|
| <input type="checkbox"/> Registered <input type="checkbox"/> Insured <input checked="" type="checkbox"/> Certified <input type="checkbox"/> COD <input type="checkbox"/> Express Mail | P 497 960 846 |

Always obtain signature of addressee or agent and **DATE DELIVERED.**

5. Signature - Addressee
X *Hobdy Gann*

6. Signature - Agent
X

7. Date of Delivery
4-17-85

8. Addressee's Address (ONLY if requested and fee paid)

DOMESTIC RETURN RECEIPT

PS Form 3811, July 1983 447-845

SENDER: Complete items 1, 2, 3 and 4.

Put your address in the "RETURN TO" space on the reverse side. Failure to do this will prevent this card from being returned to you. The return receipt fee will provide you the name of the person delivered to and the date of delivery. For additional fees the following services are available. Consult postmaster for fees and check box(es) for service(s) requested.

1. ☒ Show to whom, date and address of delivery.

2. ☐ Restricted Delivery.

3. Article Addressed to:
Amerada Hess
P. O. Box 840
Seminole, TX 79360

Attention: J. I. Johnson

| 4. Type of Service: | Article Number |
|---|----------------|
| <input type="checkbox"/> Registered <input type="checkbox"/> Insured <input checked="" type="checkbox"/> Certified <input type="checkbox"/> COD <input type="checkbox"/> Express Mail | P 497 960 845 |

Always obtain signature of addressee or agent and **DATE DELIVERED.**

5. Signature - Addressee
J. I. Johnson

6. Signature - Agent
X

7. Date of Delivery
APR 18 1985

8. Addressee's Address (ONLY if requested and fee paid)

DOMESTIC RETURN RECEIPT

PS Form 3811, July 1983 447-845

SENDER: Complete items 1, 2, 3 and 4.

Put your address in the "RETURN TO" space on the reverse side. Failure to do this will prevent this card from being returned to you. The return receipt fee will provide you the name of the person delivered to and the date of delivery. For additional fees the following services are available. Consult postmaster for fees and check box(es) for service(s) requested.

1. ☒ Show to whom, date and address of delivery.

2. ☐ Restricted Delivery.

3. Article Addressed to:

L. Schulz
P. O. Box 3753
Midland, TX 79702

| 4. Type of Service: | Article Number |
|---|----------------|
| <input type="checkbox"/> Registered <input type="checkbox"/> Insured <input checked="" type="checkbox"/> Certified <input type="checkbox"/> COD <input type="checkbox"/> Express Mail | P 497 960 843 |

Always obtain signature of addressee or agent and **DATE DELIVERED.**

5. Signature - Addressee
X *L. Schulz*

6. Signature - Agent
X

7. Date of Delivery
APR 18 1985

8. Addressee's Address (ONLY if requested and fee paid)

DOMESTIC RETURN RECEIPT



STATE OF NEW MEXICO
ENERGY AND MINERALS DEPARTMENT
OIL CONSERVATION DIVISION

TONEY ANAYA
GOVERNOR

June 17, 1985

POST OFFICE BOX 2088
STATE LAND OFFICE BUILDING
SANTA FE, NEW MEXICO 87501
(505) 827-5800

Mr. William F. Carr
Campbell & Black
Attorneys at Law
Post Office Box 2208
Santa Fe, New Mexico

Re: CASE NO. 3592
ORDER NO. R-7954

Applicant:

Fannie Lee Mitchell, Inc.

Dear Sir:

Enclosed herewith are two copies of the above-referenced Division order recently entered in the subject case.

Sincerely,

B. L. Hunt

R. L. STAMETS
Director

RLS / fd

Copy of order also sent to:

| | |
|-------------|------------------------------|
| Hobbs OCD | <u> x </u> |
| Artesia OCD | <u> x </u> |
| Aztec OCD | |

Other _____



TONEY ANAYA
GOVERNOR

STATE OF NEW MEXICO
ENERGY AND MINERALS DEPARTMENT
OIL CONSERVATION DIVISION

50 YEARS



1935 - 1985

POST OFFICE BOX 2088
STATE LAND OFFICE BUILDING
SANTA FE, NEW MEXICO 87501
(505) 827-5800

October 9, 1985

William F. Carr
Campbell & Black
Attorneys at Law
Post Office Box 2208
Santa Fe, New Mexico 87501

Re: Case No. 8592
Order No. R-7954

Dear Mr. Carr:

Fannie Lee Mitchell, Inc. is hereby granted an extension of time until January 17, 1986, in which to install the seven-inch casing or plug and abandon its Caudill SWD Well 32 as described in the above referenced order.

This extension is granted based upon the request contained in your letter of October 8, 1985.

Sincerely,

R. L. STAMETS
Director

RLS/fd

CAMPBELL & BLACK, P.A.

LAWYERS

JACK M. CAMPBELL
BRUCE D. BLACK
MICHAEL B. CAMPBELL
WILLIAM F. CARR
BRADFORD C. BERGE
J. SCOTT HALL
PETER N. IVES
LOURDES A. MARTINEZ

JEFFERSON PLACE
SUITE 1 - 110 NORTH GUADALUPE
POST OFFICE BOX 2208
SANTA FE, NEW MEXICO 87501
TELEPHONE: (505) 988-4421
TELECOPIER: (505) 983-6043

October 8, 1985

HAND DELIVERED

Mr. R. L. Stamets, Director
Oil Conservation Division
New Mexico Department of
Energy and Minerals
State Land Office Building
Santa Fe, New Mexico 87501

Re: Oil Conservation Division Case 8592: Application of
Fannie Lee Mitchell, Inc. for Salt Water Disposal,
Lea County, New Mexico.

Dear Mr. Stamets:

On June 17, 1985, the Division entered Order No. R-7954 granting the application of Fannie Lee Mitchell, Inc. for the disposal of produced salt water into certain formations in its Caudill SWD Well No. 32, located 1980 feet from the North line and 1830 feet from the East line of Section 32, Township 15 South, Range 36 East, N.M.P.M., Lea County, New Mexico. This order granted the applicant 120 days from the date of the Order to complete the installation of new 7-inch casing or plug or abandon the well in accordance with Division standards. This 120-day time limitation can be extended, pursuant to the Order, upon a proper showing to the Division Director.

The purpose of this letter is to request a 90-day extension of Order R-7954. The reason for this request is that title to the physical property in the well is presently held by FDIC. The FDIC in Midland has in writing approved an arrangement whereby the title to the property will be released. This arrangement must, however, be approved by the FDIC in Houston and Washington, D.C. Such approval is expected within 50 days. Although Fannie Lee Mitchell, Inc. is prepared to proceed immediately with the installation of new casing in the well, the First Interstate Bank

R. L. Stamets
October 8, 1985
Page Two

of Lovington that will finance this work on the well is delaying final approval prior to the FDIC action. It is therefore necessary for us to request a 90-day extension of this Order.

If any further information concerning this matter is needed, please advise.

Very truly yours,

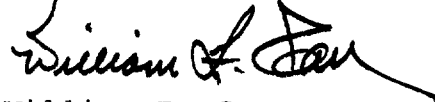
A handwritten signature in black ink, appearing to read "William F. Carr", with a long, sweeping horizontal stroke extending to the right.

William F. Carr

WFC/cv

cc: Mr. Robert Caudle
Fannie Lee Mitchell, Inc.
Post Office Box 1327
Lovington, NM 88206



TONEY ANAYA
GOVERNOR

STATE OF NEW MEXICO
ENERGY AND MINERALS DEPARTMENT
OIL CONSERVATION DIVISION

50 YEARS



1935 - 1985

POST OFFICE BOX 2088
STATE LAND OFFICE BUILDING
SANTA FE, NEW MEXICO 87501
(505) 827-5800

January 10, 1986

Mr. William F. Carr
Campbell & Black
Attorneys at Law
Post Office Box 2208
Santa Fe, New Mexico 87501

Re: Case No. 8592
Order No. R-7954

Dear Mr. Carr:

Fannie Lee Mitchell, Inc. is hereby granted an additional extension of time until February 7, 1986, in which to install the seven-inch casing or plug and abandon its Caudill SWD Well No. 32 as described in the above-referenced order.

This extension is based upon the request contained in your letter of January 9, 1986.

Sincerely,

R. L. STAMETS
Director

RLS/fd

cc: Jerry Sexton
Case file

ILLEGIBLE

CAMPBELL & BLACK, P.A.

LAWYERS

JACK M. CAMPBELL
BRUCE D. BLACK
MICHAEL B. CAMPBELL
WILLIAM F. CARR
BRADFORD C. BERGE
J. SCOTT HALL
PETER N. IVES
JOHN H. BEMIS

GUADALUPE PLACE
SUITE 1 - 110 NORTH GUADALUPE
POST OFFICE BOX 2208
SANTA FE, NEW MEXICO 87501
TELEPHONE: (505) 988-4421
TELECOPIER: (505) 983-6043

January 9, 1986

RECEIVED

JAN 9 1986

OIL CONSERVATION DIVISION

R. L. Stamets, Director
Oil Conservation Division
State Land Office Building
Santa Fe, New Mexico 87501

Re: Oil Conservation Division Case 8592: Application of
Fannie Lee Mitchell for Salt Water Disposal, Lea
County, New Mexico.

Dear Mr. Stamets:

By letter dated October 8, 1985, Fannie Lee Mitchell, Inc. requested a 90-day extension of Order R-7954 which was entered by the Division on June 17, 1985. The extension was granted on October 9, 1985, allowing Fannie Lee Mitchell, Inc. an additional 90 days, until January 17, 1986, within which to complete the installation of new 7-inch casing or plug and abandon its Caudill SWD Well No. 32.

This letter is to inform the Division that title to the physical property in the well has not yet been released by the FDIC in Midland, as the required approval from the FDIC in Washington has not been obtained. A hearing on the matter is scheduled on January 15, 1986 in Washington and, Fannie Lee Mitchell, Inc. expects to receive FDIC approval on that date.

Due to the period of time involved in getting the title to the property released by the FDIC in Midland, and then proceeding to the First Interstate Bank in Lovington, who will be financing the work on the well, the January 17, 1986 deadline may not be met. An additional 20-day extension from January 17th is hereby requested, at which time all approvals will have been obtained, and work on the well commenced.

If you foresee any problems with this request, or if you require additional information, please let me know.

Thank you for your prompt attention to this matter.

Very truly yours,

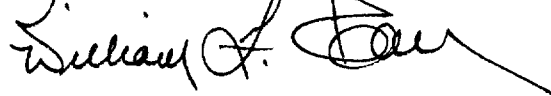

William F. Carr

WFC/cv

Memo

1-17-86

From

EVELYN DOWNS
District I - UIC Coordinator

Case 8592

Order 7954

To David Catanach,

If Fanne Lee Mitchell
asks for another extension
please call us before it
is approved as we are
opposed to any more extensions

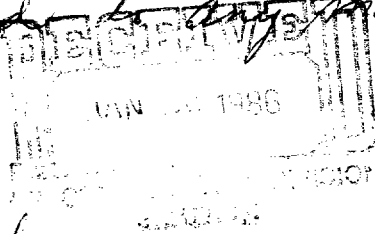

Thanks,

Evelyn

Oil Conservation Division
PO Box 1980, Hobbs, New Mexico 88240

CAMPBELL & BLACK, P.A.

LAWYERS

JACK M. CAMPBELL
BRUCE D. BLACK
MICHAEL B. CAMPBELL
WILLIAM F. CARR
BRADFORD C. BERGE
J. SCOTT HALL
PETER N. IVES
JOHN H. BEMIS

GUADALUPE PLACE
SUITE 1 - 110 NORTH GUADALUPE
POST OFFICE BOX 2208
SANTA FE, NEW MEXICO 87501
TELEPHONE: (505) 988-4421
TELECOPIER: (505) 983-6043

January 31, 1986

RECEIVED

JAN 31 1986

OIL CONSERVATION DIVISION

R. L. Stamets, Director
Oil Conservation Division
New Mexico Department of
Energy and Minerals
Post Office Box 2088
Santa Fe, New Mexico 87504-2088

Re: Case 8592: Application of Fannie Lee Mitchell, Inc. for
Salt Water Disposal, Lea County, New Mexico.

Dear Mr. Stamets:

Pursuant to our conversation of January 30, 1986, we hereby request an extension of Oil Conservation Division Order No. R-7954. As you will recall, this order was originally entered on June 17, 1985, and has been extended on several occasions to permit Fannie Lee Mitchell, Inc. to conclude negotiations with the Federal Deposit Insurance Corporation concerning the ownership of the property upon which the well is located. The most recent of these extensions was granted by you on January 10, 1986, at which time you gave Fannie Lee Mitchell until February 7, 1986 to install 7-inch casing in the subject well or plug and abandon it in accordance with a Commission-approved plugging program.

As I advised you at our meeting with Mr. Sexton, Mr. Caudle has reached an agreement with FDIC which will close in the offices of the FDIC in Midland on February 26, 1986. Fannie Lee Mitchell, Inc. therefore is requesting that Order No. R-7954 be extended to provide thirty days following February 26, 1986 in which to commence operations on the Caudell Salt Water Disposal Well No. 32. We would request that the Order be extended for so long as Fannie Lee Mitchell, Inc. diligently proceeds with work on the well, but in no event shall authority to work on the well extend for a period in excess of ninety days from the date on which the work is commenced.

R. L. Stamets
January 31, 1986
Page Two

Your consideration of this request is appreciated.

Very truly yours,

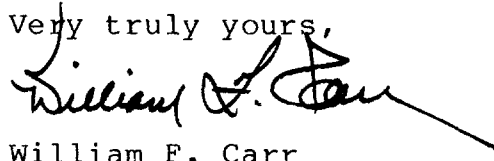
A handwritten signature in black ink, appearing to read "William F. Carr". The signature is fluid and cursive, with a long horizontal stroke extending to the right.

William F. Carr

WFC/cv

cc: Mr. Robert Caudle



TONEY ANAYA
GOVERNOR

STATE OF NEW MEXICO
ENERGY AND MINERALS DEPARTMENT
OIL CONSERVATION DIVISION

50 YEARS



1935 - 1985

POST OFFICE BOX 314
STATE LAND OFFICE BUILDING
SANTA FE, NEW MEXICO 87501
(505) 827-5800

February 3, 1986

Mr. William F. Carr
Campbell & Black
Attorneys at Law
Post Office Box 2208
Santa Fe, New Mexico 87501

Re: Case No. 8592
Order No. R-7954

Dear Mr. Carr:

Fannie Lee Mitchell, Inc. is hereby granted an additional extension of time until May 26, 1986, in which to install the seven-inch casing or plug and abandon its Caudill SWD Well No. 32 as described in the above-referenced order.

This extension is based upon the request contained in your letter of January 31, 1986. No additional extensions will be granted unless work has begun on the well within 30 days after the agreement with FDIC is completed.

Sincerely,

R. L. STAMETS
Director

RLS/fd

cc: Jerry Sexton
✓Case file