

DICKERSON, FISK & VANDIVER  
ATTORNEYS AT LAW  
SEVENTH & MAHONE / SUITE E  
ARTESIA, NEW MEXICO 88210  
(505) 746-9841

CHAD DICKERSON  
JOHN FISK  
DAVID R. VANDIVER  
REBECCA REESE DICKERSON

February 17, 1988

*M.S.*

Energy and Minerals Department  
Oil Conservation Division  
P. O. Box 2088  
Santa Fe, New Mexico 87501

*Case 9330*

Re: Eland "AFC" Federal Com. No. 1 Well  
Township 20 South, Range 29 East, NMPM  
Section 13: W/2  
Eddy County, New Mexico

Gentlemen:

Enclosed for filing, please find three copies of the Application of Yates Petroleum Corporation for an Unorthodox Well Location, Eddy County, New Mexico.

We ask that this matter be set for hearing before an Examiner on March 16, 1988.

Thank you.

Sincerely yours,

DICKERSON, FISK & VANDIVER

*Chad Dickerson*  
Chad Dickerson

CD:pvw  
Enclosures

cc w/enclosure: Mr. Ray Beck  
Ms. Janet Richardson

BEFORE THE OIL CONSERVATION DIVISION  
OF THE STATE OF NEW MEXICO

IN THE MATTER OF THE APPLICATION :  
OF YATES PETROLEUM CORPORATION :  
FOR AN UNORTHODOX WELL LOCATION, :  
EDDY COUNTY, NEW MEXICO :  
\_\_\_\_\_ :

CASE NO. 9330

APPLICATION

COMES NOW Yates Petroleum Corporation, by its attorneys, and in support hereof, respectfully states:

1. Applicant is the operator of the following lands in Eddy County, New Mexico:

Township 20 South, Range 29 East, N.M.P.M.

Section 13: W/2

containing 320 acres, more or less,

and proposes to drill its Eland "AFC" Federal Com. No. 1 Well, at a point located 660 feet from the north line and 660 feet from the west line of said Section 13.

2. The Applicant seeks an exception to the well location requirements of Rule 104 of the Oil Conservation Division to permit the drilling of the well at the above mentioned unorthodox location for all formations from the base of the Wolfcamp through the base of the Morrow formation, which may be developed on 320-acre spacing.

3. A standard 320-acre proration unit comprising the W/2 of said Section 13 should be dedicated to such well or to such lesser portion thereof as is reasonably shown to be productive of oil and gas from the base of the Wolfcamp formation through the base of the Morrow formation.

4. The approval of this Application will afford Applicant the opportunity to produce its just and equitable share of oil and gas, will prevent economic loss caused by the drilling of unnecessary wells, avoid the augmentation of risk arising from the drilling of an excessive number of wells, and will otherwise prevent waste and protect correlative rights.

WHEREFORE, Applicant prays:

A. That this Application be set for hearing before an examiner and that notice of said hearing be given as required by law.

B. That upon hearing the Division enter its order granting Applicant permission to drill its Eland "AFC" Federal Com. No. 1 Well at a point 660 feet from the north line and 660 feet from the west line of said Section 13, and to dedicate the W/2 of Section 13 to said well for production from all formations which may be developed on 320-acre spacing.

C. And for such other and further relief as may be just in the premises.

YATES PETROLEUM CORPORATION

By:   
Chad Dickerson

DICKERSON, FISK & VANDIVER  
Seventh and Mahone, Suite E  
Artesia, New Mexico 88210  
(505) 746-9841

Attorneys for Applicant

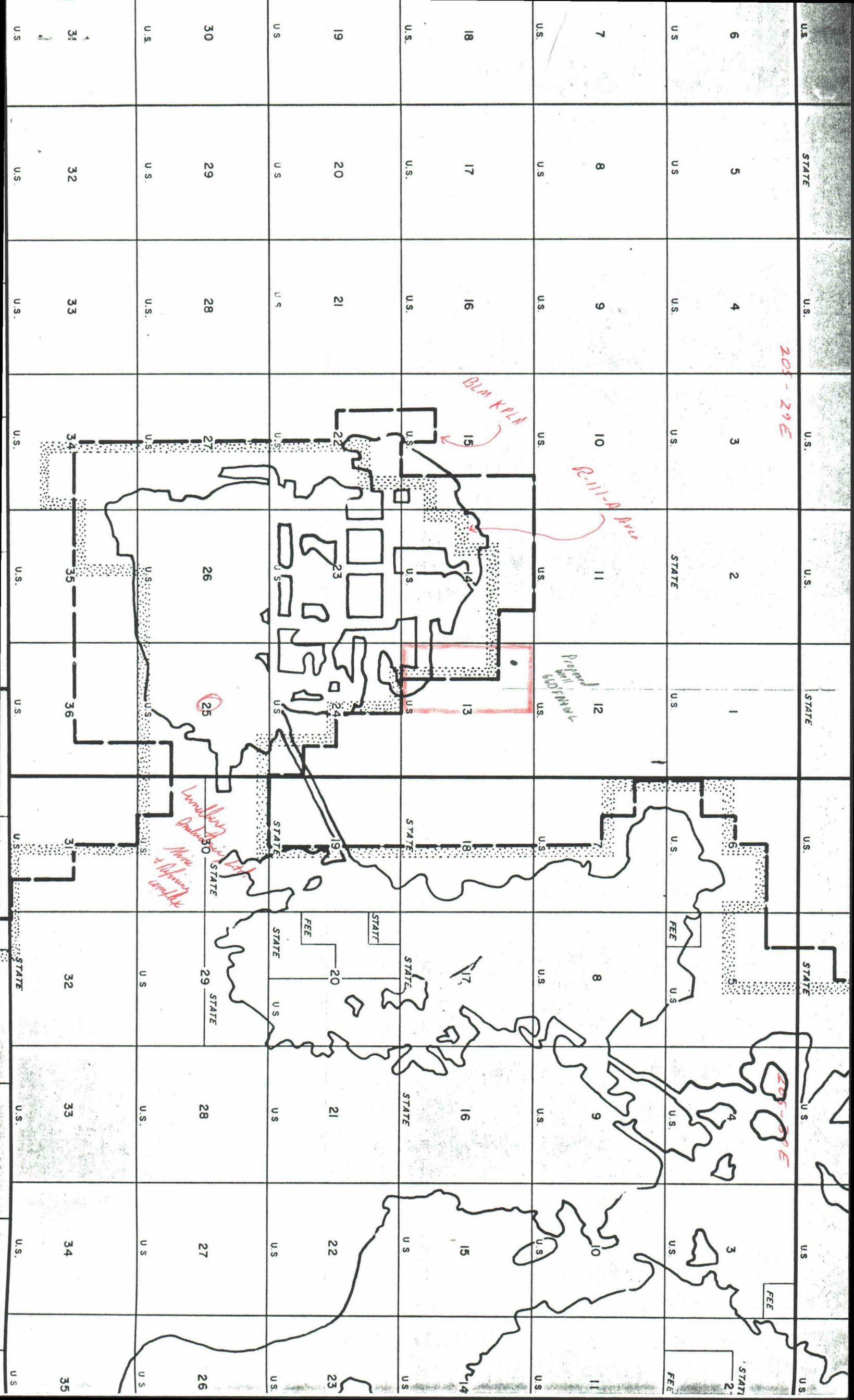

County *Eddy*

Pool *Getty - Morrow Gas*

Township *20 South*

Range *29 East*

NMPM

6	5	4	3	2	1
7	8	9	10	11	12
18	17	16	15	14	13
19	20	21	22	23	24
30	29	28	27	26	25
31	32	33	34	35	36

*Note: Section 24 is shaded with red diagonal lines. A red dot is located in the upper right quadrant of the grid, between sections 13 and 14.*

*Description: All Sec. 24 (R-2651, 3-1-64)*

*Ext:  $\frac{E, SE}{4}$  Sec. 23;  $\frac{N, NW}{4}$  Sec. 25;  $\frac{NE, NE}{4}$  Sec. 26 (R-2985, 11-1-65)*

*No Special Pool Rules*

COUNTY Eddy

POOL East Burton Flat - Strawn Gas

TOWNSHIP 20 South

RANGE 29 East

NMPM

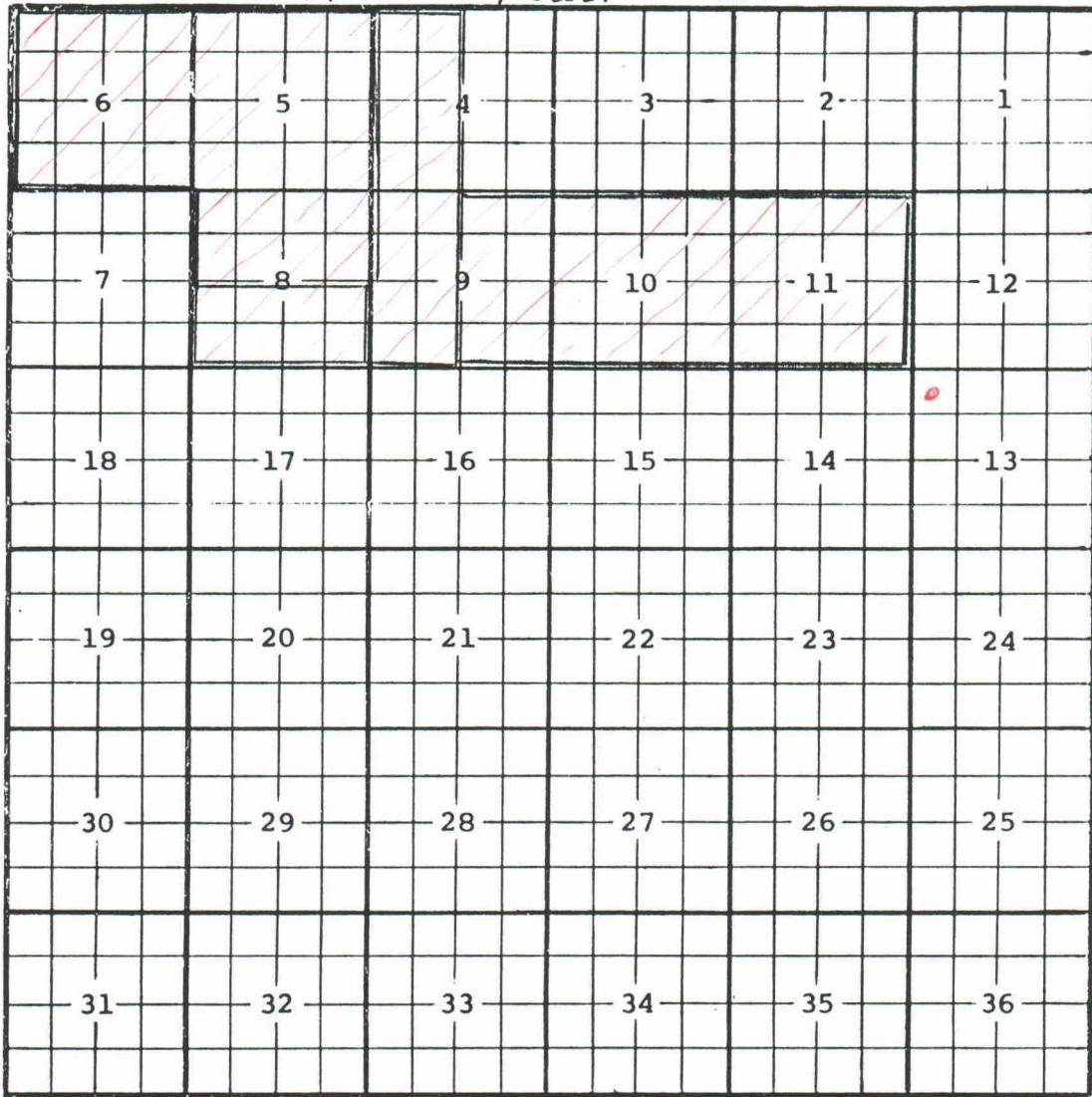

Description:  $\frac{S}{2}$  Sec 8 (R-5252, 9-1-76)

Ext:  $\frac{W}{2}$  Sec 4,  $\frac{W}{2}$  Sec 9 (R-5511, 9-1-77)

Ext:  $\frac{E}{2}$  Sec 9, All Sec. 10, All Sec. 11 (R-7158, 12-8-82)

Ext: All Sec. 5, All Sec. 6,  $\frac{N}{2}$  Sec. 8 (A-7307, 6-14-83)

No. Shaded  
Pool Probe

20-29

~~Burton-Delaware~~  
~~East Burton-Delaware~~  
~~Burton-Yates~~  
~~East Burton Flat-Atoka Gas~~  
~~East Burton Flat-Morrow Gas~~  
~~East Burton Flat-Strawn Gas~~  
~~East Burton Flat-Wolfcamp Gas~~  
~~Getty-Morrow Gas~~  
~~Getty-Yates~~  
~~Golden Lane-Atoka Gas~~  
~~South Parkway-Strawn~~  
~~Scanlon-Delaware~~  
~~Scanlon-Morrow Gas~~  
~~Scanlon-Strawn Gas~~  
~~Scanlon-Tansill Gas~~  
~~Burton Flat-Upper Strawn~~  
~~Gatuna Canyon-Wolfeamp~~  
~~Getty-Bone Spring~~  
~~South Parkway-Wolfeamp~~

20-30

~~Barber-Yates~~  
~~Dos Hermanos-Morrow Gas~~  
~~Dos Hermanos Yates-Seven Rivers~~  
~~Golden Lane-Atoka Gas~~  
~~Golden Lane-Morrow Gas~~  
~~Golden Lane-Strawn Gas~~  
~~Hale-Tansill Gas~~  
~~P.C.A.-Yates~~