

COUNTY *Lea*POOL: *Monument-Tubb*

TOWNSHIP

20-South

RANGE

37-East

NMPM

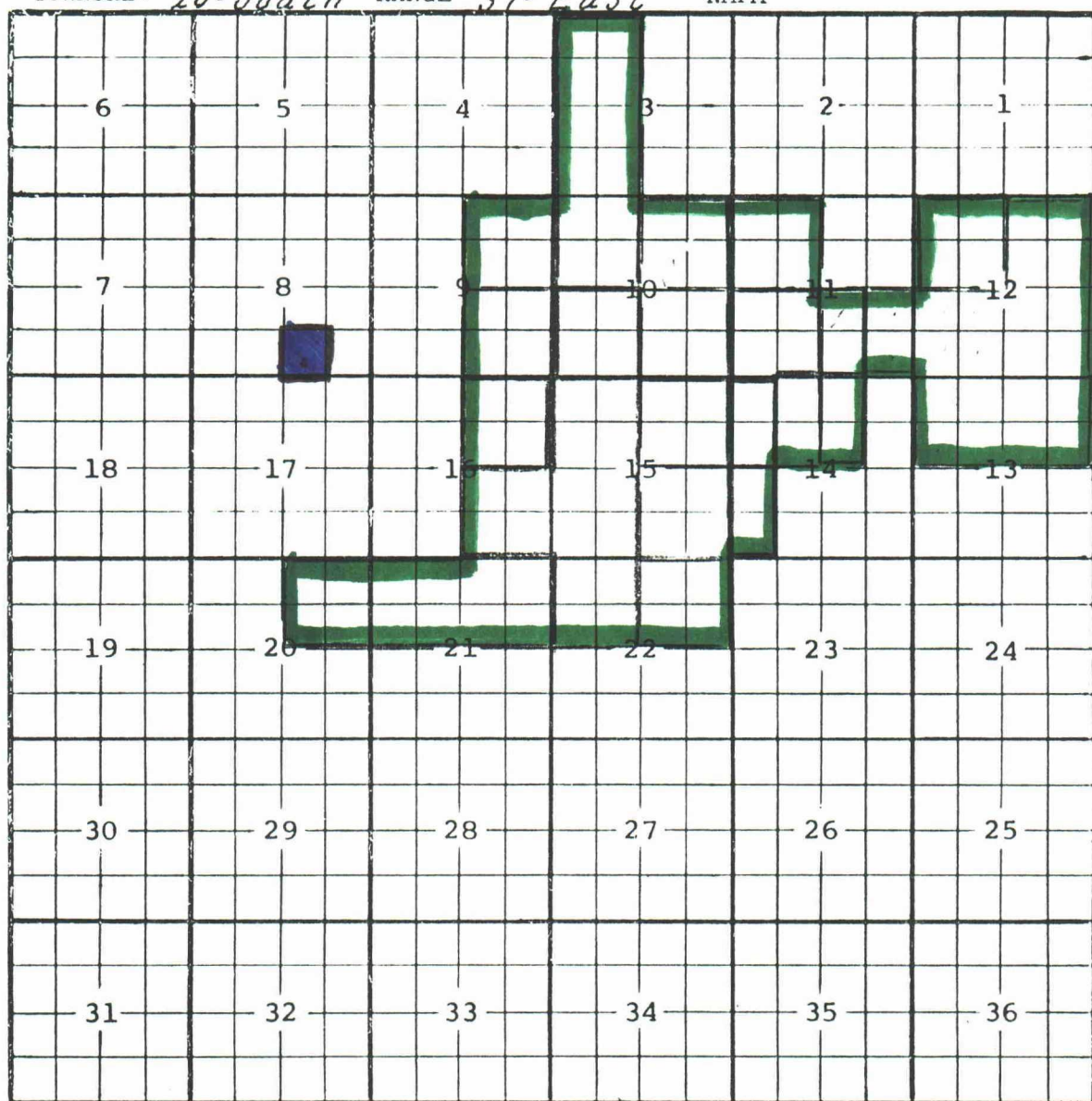

Description: $\frac{SE}{4}$ Sec. 16, (R-1532, 12-1-59).

Ext: $\frac{W}{2}$ Sec. 15, (R-1720, 8-1-60) - $\frac{NW}{4}$ Sec. 22, (R-2393, 1-1-63).

- $\frac{NE}{4}$ Sec. 16, (R-2427, 3-1-63) - $\frac{SW}{4}$ Sec. 10 (R-2527, 8-1-63)

- $\frac{NE}{4}$ Sec. 15; $\frac{NE}{4}$ Sec. 20; $\frac{N}{2}$ Sec. 21 (R-2602, 12-1-63) - $\frac{W}{2}$ Sec. 3; $\frac{SE}{4}$ Sec. 9.

$\frac{NW}{4}$ & $\frac{SE}{4}$ Sec. 10; $\frac{NE}{4}$ Sec. 22 (R-2692, 5-1-64) - $\frac{NE}{4}$ Sec. 10; $\frac{SE}{4}$ Sec. 15 (R-2781, 11-1-64)

- $\frac{W}{2}$ $\frac{NW}{4}$ Sec. 14 (R-2879, 4-1-65) - $\frac{SW}{4}$ Sec. 11; $\frac{W}{2}$ $\frac{SW}{4}$ Sec. 14 (R-2923, 7-1-65)

- $\frac{NW}{4}$ & $\frac{W}{2}$ $\frac{SE}{4}$ Sec. 11 (R-2983, 11-1-65) - $\frac{NE}{4}$ Sec. 9 (R-3051, 4-1-66) - $\frac{E}{2}$ $\frac{NW}{4}$ Sec. 14 (R-3182, 2-1-67)

Ext: $\frac{E}{2}$ $\frac{SE}{4}$ Sec. 11, $\frac{E}{2}$ & $\frac{SW}{4}$ Sec. 12, $\frac{N}{2}$ Sec. 13 (R-4734, 3-1-74)

Ext: $\frac{NW}{4}$ Sec. 12 (R-6211, 12-31-79) Ext: $\frac{W}{2}$ $\frac{NE}{4}$ Sec. 14 (R-7248, 3-30-83)

COUNTY *Lea*POOL *Monument - Paddock*TOWNSHIP *20 South*RANGE *37 East*

NMFM

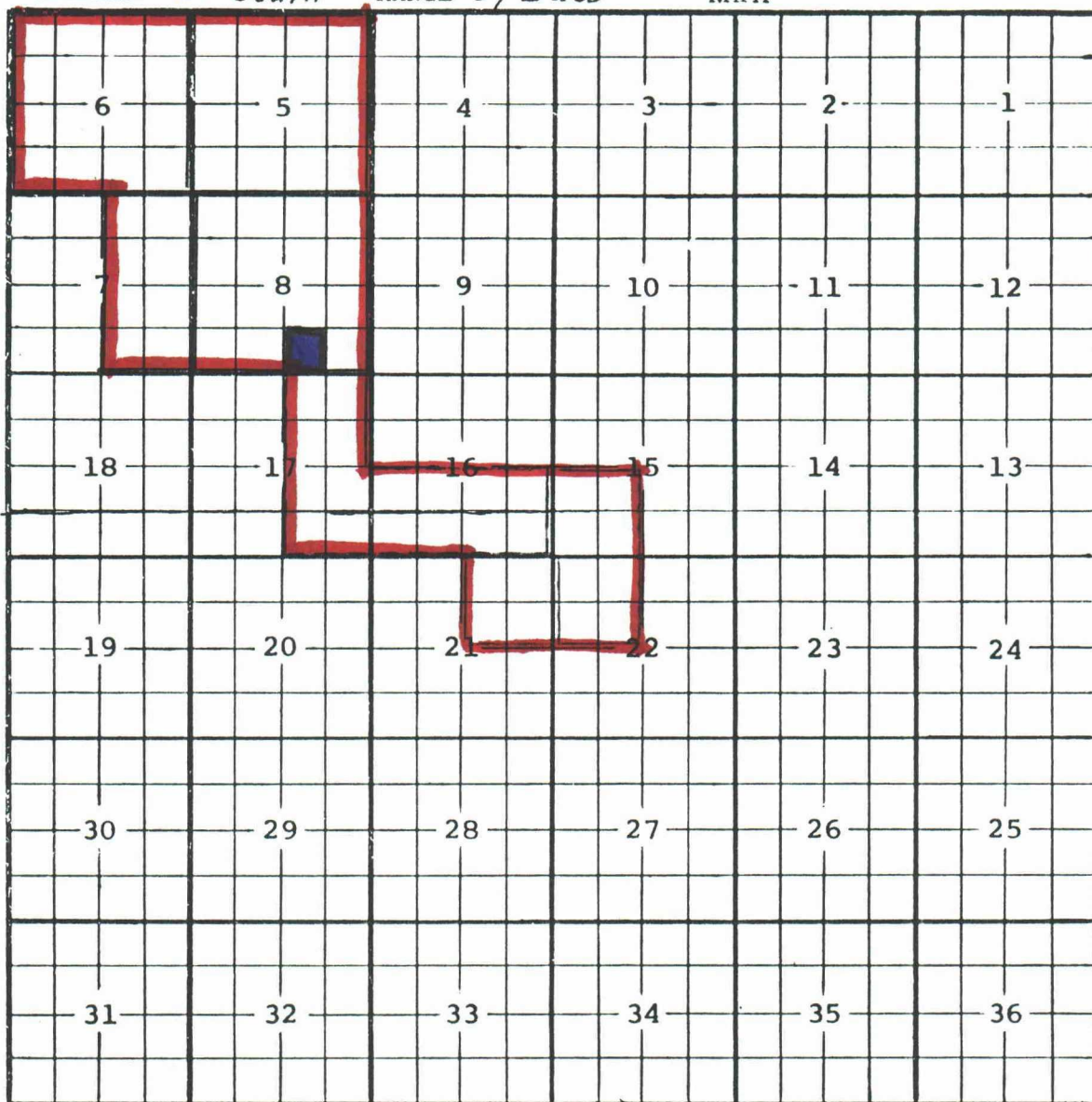
Description: All Sec. 6Ext: All Sec. 5 (R-393, 11-74-53) - All Sec. 8 (R-407, 1-20-54)- $\frac{E}{2}$ Sec. 7 (R-419, 5-6-54), Ext: $\frac{S}{2}$ Sec 16, $\frac{E}{2}$ Sec 17 (R-4646, 11-1-73)Ext: $\frac{SW}{4}$ Sec 15, $\frac{NW}{4}$ Sec 22 (R-4861, 11-1-74)Ext: $\frac{NE}{4}$ Sec. 21 (R-5232, 11-1-78)

COUNTY LeaPOOL Monument - Blinbry

TOWNSHIP

20-South

RANGE

37-East

NMFM

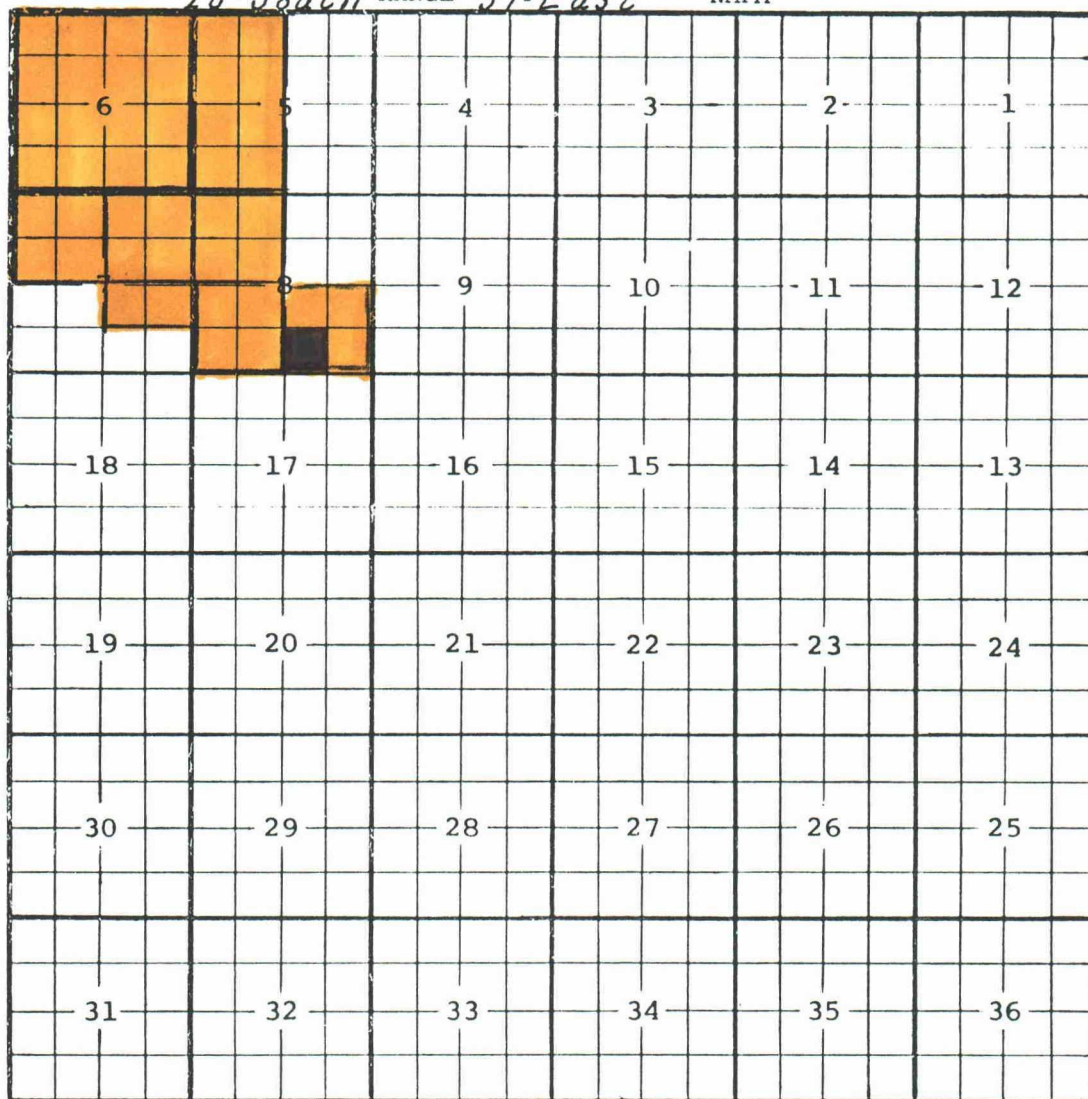
Description: All Sec. 6.

Ext: $\frac{1}{2}$ Sec. 5 (R-184, 8-28-52) - $\frac{1}{4}$ Sec. 7, $\frac{1}{4}$ Sec. 8,
 (R-348, 7-27-53) - $\frac{1}{4}$ Sec. 8, (R-407, 1-20-54) - $\frac{1}{4}$ Sec. 7,
 (R-561, 12-16-54) - $\frac{1}{2}$ $\frac{1}{4}$ Sec. 7, (R-713, 11-10-55).

EXT: $\frac{1}{4}$ SEC. 8 (R-8603, 2/19/88)

MONUMENT-TUBB POOL
Lea County, New Mexico

Order No. R-2800, Adopting Operating Rules for the Monument-Tubb Pool, Lea County, New Mexico, December 1, 1964.

Application of Continental Oil Company for
Special Pool Rules, Lea County, New Mexico.

CASE NO. 3123
Order No. R-2800

ORDER OF THE COMMISSION

BY THE COMMISSION: This cause came on for hearing at 9 o'clock a.m. on October 13, 1964, at Santa Fe, New Mexico, before Examiner Elvis A. Utz.

NOW, on this 10th day of November, 1964, the Commission, a quorum being present, having considered the testimony, the record, and the recommendations of the Examiner, and being fully advised in the premises,

FINDS:

(1) That due public notice having been given as required by law, the Commission has jurisdiction of this cause and the subject matter thereof.

(2) That the applicant, Continental Oil Company, seeks the promulgation of special rules and regulations for the Monument-Tubb Pool in Township 20 South, Range 37 East, NMPM, Lea County, New Mexico, including a provision for 80-acre spacing units and a gas-oil ratio of 6000 to 1.

(3) That one well in the Monument-Tubb Pool can efficiently and economically drain and develop 80 acres.

(4) That in order to prevent the economic loss caused by the drilling of unnecessary wells, to avoid the augmentation of risk arising from the drilling of an excessive number of wells to prevent reduced recovery which might result from the drilling of too few wells, and to otherwise prevent waste and protect correlative rights, special rules and regulations providing for 80-acre spacing units should be promulgated for the Monument-Tubb Pool.

(5) That a limiting gas-oil ratio of 6000 to 1 would be excessive for this pool and might result in waste.

(6) That the special rules and regulations should provide for a limiting gas-oil ratio of 4000 to 1 in order to allow each operator in the pool the opportunity to use his just and equitable share of the reservoir energy.

IT IS THEREFORE ORDERED:

That Special Rules and Regulations for the Monument-Tubb Pool are hereby promulgated as follows, effective December 1, 1964:

SPECIAL RULES AND REGULATIONS
FOR THE
MONUMENT-TUBB POOL

RULE 1. Each well completed or recompleted in the Monument-Tubb Pool or in the Tubb formation within one mile thereof, and not nearer to or within the limits of another designated Tubb oil pool, shall be spaced, drilled, operated, and

produced in accordance with the Special Rules and Regulations hereinafter set forth.

RULE 2. Each well shall be located on a standard unit containing 80 acres, more or less, consisting of the N/2, S/2, E/2, or W/2 of a governmental quarter section; provided, however, that nothing contained herein shall be construed as prohibiting the drilling of a well on each of the quarter-quarter sections in the unit.

RULE 3. The Secretary-Director of the Commission may grant an exception to the requirements of Rule 2 without notice and hearing when an application has been filed for a non-standard unit comprising a governmental quarter-quarter section or lot. All operators offsetting the proposed non-standard unit shall be notified of the application by registered or certified mail, and the application shall state that such notice has been furnished. The Secretary-Director may approve the application upon receipt of written waivers from all offset operators or if no offset operator has entered an objection to the formation of the non-standard unit within 30 days after the Secretary-Director has received the application.

RULE 4. Each well shall be located no nearer than 330 feet to any governmental quarter-quarter section or lot line.

RULE 5. The Secretary-Director may grant an exception to the requirements of Rule 4 without notice and hearing when an application has been filed for an unorthodox location necessitated by topographical conditions. All operators offsetting the proposed unorthodox location shall be notified of the application by registered or certified mail, and the application shall state that such notice has been furnished. The Secretary-Director may approve the application upon receipt of written waivers from all offset operators or if no offset operator has entered an objection to the unorthodox location within 20 days after the Secretary-Director has received the application.

RULE 6. A standard proration unit (79 through 81 acres) shall be assigned an 80-acre proportional factor of 2.77 for allowable purposes, and in the event there is more than one well on an 80-acre proration unit, the operator may produce the allowable assigned to the unit from the wells on the unit in any proportion.

The allowable assigned to a non-standard proration unit shall bear the same ratio to a standard allowable as the acreage in such non-standard unit bears to 80-acres.

RULE 7. The limiting gas-oil ratio shall be 4000 cubic feet of gas for each barrel of oil produced.

IT IS FURTHER ORDERED:

(1) That any well presently drilling to or completed in the Monument-Tubb Pool or in the Tubb formation within one mile thereof that will not comply with the well location requirements of Rule 4 is hereby granted an exception to the requirements of said rule. The operator shall notify the Hobbs District Office of the Commission in writing of the name and location of the well on or before December 1, 1964.

(2) That each well presently drilling to or completed in the Monument-Tubb Pool or in the Tubb formation within one mile thereof shall receive a 40-acre allowable until a Form C-128 dedicating 80 acres to the well has been filed with the Commission.

(3) That jurisdiction of this cause is retained for the entry of such further orders as the Commission may deem necessary.

DONE at Santa Fe, New Mexico, on the day and year hereinabove designated.

STATE OF NEW MEXICO
ENERGY AND MINERALS DEPARTMENT

NO. OF COPIES RECEIVED	
DISTRIBUTION	
SANTA FE	
FILE	
U.S.O.S.	
LAND OFFICE	
OPERATOR	

OIL CONSERVATION DIVISION

P. O. BOX 2088

SANTA FE, NEW MEXICO 87501

MAY 13 1988

Form C-103
Revised 10-1-78

SUNDRY NOTICES AND REPORTS ON WELLS

(DO NOT USE THIS FORM FOR PROPOSALS TO DRILL OR TO DEEPEN OR PLUG BACK TO A DIFFERENT RESERVOIR.
USE "APPLICATION FOR PERMIT --" (FORM C-101) FOR SUCH PROPOSALS.)

1. OIL WELL <input checked="" type="checkbox"/> GAS WELL <input type="checkbox"/> OTHER <input type="checkbox"/>	5a. Indicate Type of Lease State <input type="checkbox"/> Fee <input checked="" type="checkbox"/>
2. Name of Operator Horizon Oil & Gas Co.	5. State Oil & Gas Lease No.
3. Address of Operator P.O. Box 7, Spearman, Texas 79081	7. Unit Agreement Name
4. Location of Well UNIT LETTER <u>o</u> <u>330</u> FEET FROM THE <u>South</u> LINE AND <u>1980</u> FEET FROM THE <u>East</u> LINE, SECTION <u>8</u> TOWNSHIP <u>20S</u> RANGE <u>37E</u> NMPM.	8. Farm or Lease Name Anderson
	9. Well No. 1
	10. Field and Pool, or Wildcat Monument Tubbs
15. Elevation (Show whether DF, RT, GR, etc.) 3550 RKB	12. County Lea

Check Appropriate Box To Indicate Nature of Notice, Report or Other Data

NOTICE OF INTENTION TO:		SUBSEQUENT REPORT OF:	
PERFORM REMEDIAL WORK <input type="checkbox"/>	PLUG AND ABANDON <input type="checkbox"/>	REMEDIAL WORK <input checked="" type="checkbox"/>	ALTERING CASING <input type="checkbox"/>
TEMPORARILY ABANDON <input type="checkbox"/>	CHANGE PLANS <input type="checkbox"/>	COMMENCE DRILLING OPNS. <input type="checkbox"/>	PLUG AND ABANDONMENT <input type="checkbox"/>
PULL OR ALTER CASING <input type="checkbox"/>	OTHER <input type="checkbox"/>	CASING TEST AND CEMENT JOB <input type="checkbox"/>	OTHER <input type="checkbox"/>

17. Describe Proposed or Completed Operations (Clearly state all pertinent details, and give pertinent dates, including estimated date of starting any proposed work) SEE RULE 1103.

Tested Tubb Formation as follows:

Perforated 6452' - 6466' (14') with 29 Holes. Acidize with 3,000 gals. 15% NE FE Acid.
Frac with 9,000 gals. 20% NE Acid + 15,500 gals. 2% Gelled KCL Water.

Perforated 6362' to 6374' (12') with 25 Holes. Acidize with 3,000 gals. 15% NE FE Acid.
Frac with 9,000 gals. 20% NE Acid + 15,400 gals. 2% KCL Water.

Producing 6 barrels oil + 11 barrels water. (October 6, 1987)

Set Retrievable Bridge Plug @ 6,097', to test Blinbry.

8. I hereby certify that the information above is true and complete to the best of my knowledge and belief.

SIGNED Ante L. C. F. TITLE Engineer DATE May 2, 1988

APPROVED BY [Signature] TITLE _____ DATE _____

CONDITIONS OF APPROVAL, IF ANY:

STATE OF NEW MEXICO
ENERGY AND MINERALS DEPARTMENT

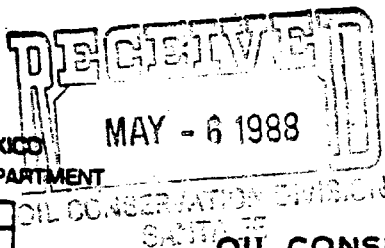

Form C-104
Revised 10-01-78
Format 08-01-83
Page 1

NO. OF COPIES RETURNED		
DISTRIBUTION		
SANTA FE		
FILE		
U.S.S.		
LAND OFFICE		
TRANSPORTER	OIL	
	NAT	
OPERATOR		
REGISTRATION OFFICE		

OIL CONSERVATION DIVISION

P. O. BOX 2088
SANTA FE, NEW MEXICO 87501

REQUEST FOR ALLOWABLE
AND
AUTHORIZATION TO TRANSPORT OIL AND NATURAL GAS

I. Operator
Horizon Oil & Gas Co.

Address
P.O. Box 7, Spearman, Texas 79081

Reason(s) for filing (Check proper box)

<input type="checkbox"/> New Well	Change in Transporter of:	Other (Please explain)
<input checked="" type="checkbox"/> Recompletion	<input type="checkbox"/> Oil	
<input type="checkbox"/> Change in Ownership	<input type="checkbox"/> Casinghead Gas	

☐ Dry Gas
☐ Condensate

If change of ownership give name and address of previous owner

II. DESCRIPTION OF WELL AND LEASE

Lease Name Anderson	Well No. 1	Pool Name, including Formation Monument Paddock	Kind of Lease State, Federal or Fee	Lease No. Fee
Location				
Unit Letter <u>0</u> : <u>330</u> Feet From The <u>South</u> Line and <u>1980</u> Feet From The <u>East</u>				
Line of Section <u>8</u> Township <u>20S</u> Range <u>37E</u> NMPM, Lea County				

III. DESIGNATION OF TRANSPORTER OF OIL AND NATURAL GAS

Name of Authorized Transporter of Oil <input checked="" type="checkbox"/> or Condensate <input type="checkbox"/> Tesoro Crude Oil	Address (Give address to which approved copy of this form is to be sent) 8700 Tesoro Dr., San Antonio, TX 78286
Name of Authorized Transporter of Casinghead Gas <input checked="" type="checkbox"/> or Dry Gas <input type="checkbox"/> Warren Petroleum	Address (Give address to which approved copy of this form is to be sent) P.O. Box 1589, Tulsa, Oklahoma 74102
If well produces oil or liquids, give location of tanks.	Unit Sec. Twp. Rge. is gas actually connected? When
	0 8 20S 37E Yes Jan. 19, 1988

If this production is commingled with that from any other lease or pool, give commingling order number: NA

NOTE: Complete Parts IV and V on reverse side if necessary.

VI. CERTIFICATE OF COMPLIANCE

I hereby certify that the rules and regulations of the Oil Conservation Division have been complied with and that the information given is true and complete to the best of my knowledge and belief.

Curtis F. Covington (Signature)
Engineer
(Title)
April 30, 1988
(Date)

OIL CONSERVATION DIVISION

APPROVED W. B. [Signature], 19 1988
BY [Signature]
TITLE Director

This form is to be filed in compliance with RULE 1104.

If this is a request for allowable for a newly drilled or deepened well, this form must be accompanied by a tabulation of the deviation tests taken on the well in accordance with RULE 111.

All sections of this form must be filled out completely for allowable on new and recompleted wells.

Fill out only Sections I, II, III, and VI for changes of owner, well name or number, or transporter or other such change of condition.

Separate Forms C-104 must be filed for each pool in multiply completed wells.

IV. COMPLETION DATA

Designate Type of Completion - (X)		Oil Well	Gas Well	New Well	Workover	Deepen	Plug Back	Same Res'v.	Dif. Res'v.
		XX					XX		
Date Spudded	Date Compl. Ready to Prod.		Total Depth		P.B.T.D.				
6-30-87	4-21-88		6800'		5400'				
Elevations (DF, RKB, RT, GR, etc.)	Name of Producing Formation		Top Oil/Gas Pay		Tubing Depth				
3550 RKB	Paddock		5110		5353				
Perforations						Depth Casing Shoe			
5118 - 5178 OA 36 Holes						6539			
TUBING, CASING, AND CEMENTING RECORD									
HOLE SIZE	CASING & TUBING SIZE		DEPTH SET		SACKS CEMENT				
17	13 3/8		250		260				
12 1/4	8 5/8		1,215		470				
7 7/8	5 1/2		6,539		820				

V. TEST DATA AND REQUEST FOR ALLOWABLE (Test must be after recovery of total volume of load oil and must be equal to or exceed top allowable for this depth or be for full 24 hours)

Date First New Oil Run To Tanks	Date of Test	Producing Method (Flow, pump, gas lift, etc.)	
4-21-88	4-29-88	Pumping	
Length of Test	Tubing Pressure	Casing Pressure	Choke Size
24 Hours	NA	40#	NA
Actual Prod. During Test	Oil - Bbls.	Water - Bbls.	Gas - MCF
206	31	175	26

GAS WELL

Actual Prod. Test - MCF/D	Length of Test	Bbls. Condensate/MCF	Gravity of Condensate
Testing Method (pilot, back pr.)	Tubing Pressure (Shut-in)	Casing Pressure (Shut-in)	Choke Size

STATE OF NEW MEXICO
ENERGY AND MINERALS DEPARTMENT

Form C-105
Revised 10-1-78

OIL CONSERVATION DIVISION

P.O. BOX 2088
SANTA FE, NEW MEXICO 87501

WELL COMPLETION OR RECOMPLETION REPORT AND LOG

NO. OF COPIES RECEIVED	
DISTRIBUTION	
SANTA FE	
FILE	
U.S.O.S.	
LAND OFFICE	
OPERATOR	

5a. Indicate Type of Lease	
State <input type="checkbox"/>	Fee <input checked="" type="checkbox"/>
5. State Oil & Gas Lease No.	

1a. TYPE OF WELL

OIL WELL ☒ GAS WELL ☐ DRY ☐ OTHER ☐

2. TYPE OF COMPLETION

NEW WELL ☐ WORK OVER ☐ DEEPEN ☐ PLUG BACK ☒ DIFF. REGR. ☐ OTHER ☐

3. Name of Operator
Horizon Oil & Gas Co.

4. Address of Operator
P.O. Box 7, Spearman, Texas 79081

5. Location of Well

7. Unit Agreement Name

8. Farm or Lease Name
Anderson

9. Well No.
1

10. Field and Pool, or Wildcat
Monument Paddock

UNIT LETTER O LOCATED 330 FEET FROM THE South LINE AND 1980 FEET FROM THE East LINE OF SEC. 8 TWP. 20S RGE. 37E

12. County
Lea

15. Date Spudded 6-30-87	16. Date T.D. Reached 7-30-87	17. Date Compl. (Ready to Prod.) 4-21-88	18. Elevations (DF, RKB, RT, GR, etc.) 3550 RKB	19. Elev. Casinghead 3539
20. Total Depth 6800	21. Plug Back T.D. 5400	22. If Multiple Compl., How Many NA	23. Intervals Drilled By Rotary Tools XX	24. Cable Tools

24. Producing Interval(s), at this completion - Top, Bottom, Name
Paddock 5118 - 5178

25. Type Electric and Other Logs Run
DLL & CNL/CDT

27. Was Well Cored
No

28. CASING RECORD (Report all strings set in well)					
CASING SIZE	WEIGHT LB./FT.	DEPTH SET	HOLE SIZE	CEMENTING RECORD	AMOUNT PULLED
13 3/8	48	250		20 sx. Class "C"	0
8 5/8	24	1,215	12 1/4	470 sx. Lite & Class "C"	0
5 1/2	15.5	6,539	7 7/8	820 sx. Lite & Class "H"	0

29. LINER RECORD				30. TUBING RECORD			
SIZE	TOP	BOTTOM	SACKS CEMENT	SCREEN	SIZE	DEPTH SET	PACKER SET
NA					2 3/8	5,353	NA

31. Perforation Record (Interval, size and number)			32. ACID, SHOT, FRACTURE, CEMENT SQUEEZE, ETC.	
5168 - 78	4" Csg. Guns	11 Holes	DEPTH INTERVAL	AMOUNT AND KIND MATERIAL USED
5148 - 54	4" Csg. Guns	7 Holes	5118 - 5178	5,000 gal. 15% NE FE Acid
5138 - 42	4" Csg. Guns	5 Holes		
5118 - 30	4" Csg. Guns	13 Holes		

33. PRODUCTION

Date First Production
4-21-88

Production Method (Flowing, gas lift, pumping - Size and type pump)
Pumping

Well Status (Prod. or Shut-in)
Producing

Date of Test 4-29-88	Hours Tested 24	Choke Size NA	Prod'n. For Test Period →	Oil - Bbl. 31	Gas - MCF 26	Water - Bbl. 175	Gas - Oil Ratio 839
Flow Tubing Press. NA	Casing Pressure 40	Calculated 24-Hour Rate →	Oil - Bbl. 31	Gas - MCF 26	Water - Bbl. 175	Oil Gravity - API (Corr.) 38.3	

34. Disposition of Gas (Sold, used for fuel, vented, etc.)
Sold

Test Witnessed By
Reliable Pumping Service

35. List of Attachments

36. I hereby certify that the information shown on both sides of this form is true and complete to the best of my knowledge and belief.

SIGNED Curtis F. Covington TITLE Engineer DATE April 30, 1988

INSTRUCTIONS

This form is to be filed with the appropriate District Office of the Division not later than 30 days after the completion of any newly-drilled or deepened well. It shall be accompanied by one copy of all electrical and radio-activity logs run on the well and a summary of all special tests conducted, including drill stem tests. All depths reported shall be measured depths. In the case of directionally drilled wells, true vertical depths shall also be reported. For multiple completions, items 30 through 34 shall be reported for each zone. The form is to be filed in quadruplicate except on same land, where six copies are required. See Rule 1105.

INDICATE FORMATION TOPS IN CONFORMANCE WITH GEOGRAPHICAL SECTION OF STATE

Southeastern New Mexico

Northwestern New Mexico

T. Anhy _____ 1060	T. Canyon _____	T. Ojo Alamo _____	T. Penn. "B" _____
T. Salt _____ 1220	T. Strawn _____	T. Kirtland-Fruitland _____	T. Penn. "C" _____
D. Salt _____ 2295	T. Atoka _____	T. Pictured Cliffs _____	T. Penn. "D" _____
T. Yates _____ 2432	T. Miss _____	T. Cliff House _____	T. Leadville _____
T. 7 Rivers _____ 2742	T. Devonian _____	T. Menefee _____	T. Madison _____
T. Queen _____ 3171	T. Silurian _____	T. Point Lookout _____	T. Elbert _____
T. Grayburg _____ 3470	T. Montoya _____	T. Mancos _____	T. McCracken _____
T. San Andres _____ 3838	T. Simpson _____	T. Gallup _____	T. Ignacio Qtzite _____
T. Glorieta _____ 5105	T. McKee _____	Base Greenhorn _____	T. Granite _____
T. Paddock _____ 5170	T. Ellenburger _____	T. Dakota _____	T. _____
T. Hilinebry _____ 5590	T. Gr. Wash _____	T. Morrison _____	T. _____
T. Tubb _____ 6305	T. Granite _____	T. Todilto _____	T. _____
T. Drinkard _____	T. Delaware Sand _____	T. Entrada _____	T. _____
T. Abo _____	T. Bone Springs _____	T. Wingate _____	T. _____
T. Wolfcamp _____	T. _____	T. Chinle _____	T. _____
T. Penn _____	T. _____	T. Permian _____	T. _____
T. Cisco (Bough C) _____	T. _____	T. Penn. "A" _____	T. _____

OIL OR GAS SANDS OR ZONES

No. 1, from _____ 5110	to _____ 5240	No. 4, from _____	to _____
No. 2, from _____ 5590	to _____ 5700	No. 5, from _____	to _____
No. 3, from _____ 6350	to _____ 6470	No. 6, from _____	to _____

IMPORTANT WATER SANDS

Include data on rate of water inflow and elevation to which water rose in hole.

No. 1, from _____ Unknown	to _____	feet _____
No. 2, from _____	to _____	feet _____
No. 3, from _____	to _____	feet _____
No. 4, from _____	to _____	feet _____

FORMATION RECORD (Attach additional sheets if necessary)

From	To	Thickness in Feet	Formation	From	To	Thickness in Feet	Formation
			NOTE: Our rights did not start until Paddock Zone. Geologist on location at 5100'.				
5100	5230	130	Limestone and Shale				
5230	5600	470	Limestone				
5600	5680	80	Limestone and Shale				
5680	5780	100	Limestone, Shale & Sandstone				
5780	6330	550	Limestone and Shale				
6330	6800	470	Limestone, Shale & Sandstone				

STATE OF NEW MEXICO
ENERGY AND MINERALS DEPARTMENT

RECEIVED
MAR 11 1988
OIL CONSERVATION DIVISION

OIL CONSERVATION DIVISION
P. O. BOX 2088
SANTA FE, NEW MEXICO 87501

Form C-104
Revised 10-01-78
Format 08-01-83
Page 1

NO. OF COPIES ORDERED	
DISTRIBUTION	
SANTA FE	
FILE	
U.S.G.S.	
LAND OFFICE	
TRANSPORTER	OIL <input checked="" type="checkbox"/> GAS <input checked="" type="checkbox"/>
OPERATOR	
OPERATION OFFICE	

REQUEST FOR ALLOWABLE
AND
AUTHORIZATION TO TRANSPORT OIL AND NATURAL GAS

I. Operator
Horizon Oil & Gas Co.

Address
P.O. Box 7, Spearman, Texas 79081

Reason(s) for filing (Check proper box)

<input checked="" type="checkbox"/> New Well	Change in Transporter of:	Other (Please explain)
<input type="checkbox"/> Recompletion	<input type="checkbox"/> Oil	To show transporter of Casinghead Gas.
<input type="checkbox"/> Change in Ownership	<input checked="" type="checkbox"/> Casinghead Gas	Pumping oil well.
	<input type="checkbox"/> Dry Gas	
	<input type="checkbox"/> Condensate	

If change of ownership give name
and address of previous owner _____

II. DESCRIPTION OF WELL AND LEASE

Lease Name Anderson	Well No. 1	Pool Name, including Formation Monument Blinbry	Kind of Lease State, Federal or Fee	Fee	Lease No.
Location					
Unit Letter 0 : 330' Feet From The South Line and 1980' Feet From The East					
Line of Section 8 Township 20S Range 37E, NMPM, Lea County					

III. DESIGNATION OF TRANSPORTER OF OIL AND NATURAL GAS

Name of Authorized Transporter of Oil <input checked="" type="checkbox"/> or Condensate <input type="checkbox"/>	Address (Give address to which approved copy of this form is to be sent)
Tesoro Crude Oil Co.	8700 Tesoro Dr., San Antonio 78286
Name of Authorized Transporter of Casinghead Gas <input checked="" type="checkbox"/> or Dry Gas <input type="checkbox"/>	Address (Give address to which approved copy of this form is to be sent)
Warren Petroleum	P.O. Box 15189, Tulsa, Oklahoma 74102
If well produces oil or liquids, give location of tanks.	Is gas actually connected? When
Unit 0, Sec. 8, Twp. 20S, Rge. 37E	Yes January 19, 1988

If this production is commingled with that from any other lease or pool, give commingling order number: _____

NOTE: Complete Parts IV and V on reverse side if necessary.

VI. CERTIFICATE OF COMPLIANCE

I hereby certify that the rules and regulations of the Oil Conservation Division have been complied with and that the information given is true and complete to the best of my knowledge and belief.

Gloria D. Knox
Office Manager
March 4, 1988

(Signature)
(Title)
(Date)

OIL CONSERVATION DIVISION

APPROVED _____, 19____
BY _____
TITLE _____

This form is to be filed in compliance with RULE 1104.

If this is a request for allowable for a newly drilled or deepened well, this form must be accompanied by a tabulation of the deviation tests taken on the well in accordance with RULE 111.

All sections of this form must be filled out completely for allowable on new and recompleted wells.

Fill out only Sections I, II, III, and VI for changes of owner, well name or number, or transporter, or other such change of condition.

Separate Forms C-104 must be filed for each pool in multiply completed wells.

IV. COMPLETION DATA

Designate Type of Completion - (X)		Oil Well X	Gas Well	New Well X	Workover	Deepen	Plug Back	Same Res'v.	Diff. Res.
Date Spudded 6-30-87	Date Compl. Ready to Prod. 12-1-87	Total Depth 6800'			P.B.T.D. 6097'				
Elevations (DF, RKB, RT, CR, etc.) 3550 RKB	Name of Producing Formation Blinebry	Top Oil/Gas Pay 5590'			Tubing Depth 6026'				
Perforations 5593' - 5700'						Depth Casing Shoe 6539'			
TUBING, CASING, AND CEMENTING RECORD									
HOLE SIZE	CASING & TUBING SIZE		DEPTH SET		SACKS CEMENT				
17	13 3/8"		250		260 SX.				
11	8 5/8"		1215		470 SX.				
7 7/8"	5 1/2"		6539		820 SX.				

V. TEST DATA AND REQUEST FOR ALLOWABLE (Test must be after recovery of total volume of load oil and must be equal to or exceed top allowable for this depth or be for full 24 hours)

Date First New Oil Run To Tanks 10-16-87 Swabbed	Date of Test 12-2-87	Producing Method (Flow, pump, gas lift, etc.) Pumping	
Length of Test 24 hours	Tubing Pressure -	Casing Pressure 25#	Choke Size -
Actual Prod. During Test	Oil - Bbls. 17	Water - Bbls. 47	Gas - MCF (Casinghead) 47

GAS WELL

Actual Prod. Test - MCF/D NA	Length of Test NA	Bbls. Condensate/MMCF NA	Gravity of Condensate NA
Testing Method (prior, back pr.) NA	Tubing Pressure (Shut-in) NA	Casing Pressure (Shut-in) NA	Choke Size NA

1002-2-1001
 1002-2-1001
 1002-2-1001

STATE OF NEW MEXICO
ENERGY AND MINERALS DEPARTMENT

NO. OF COPIES RECEIVED	
DISTRIBUTION	
SANTA FE	
FILE	
U.S.G.S.	
LAND OFFICE	
TRANSPORTER	OIL
	GAS
OPERATOR	
PROMOTION OFFICE	

OIL CONSERVATION DIVISION

P.O. BOX 2088

SANTA FE, NEW MEXICO 87501

RECEIVED

DEC 17 '87

Form C-104
Revised 10-01-78
Format 06-01-83
Page 1

REQUEST FOR ALLOWABLE
AND
AUTHORIZATION TO TRANSPORT OIL AND NATURAL GAS

O. C. D.
ARTESIA, OFFICE

I.

Operator Horizon Oil & Gas Co.	
Address P.O. Box 7 Spearman, Texas 79081	
Reason(s) for filing (Check proper box)	Other (Please explain)
<input checked="" type="checkbox"/> New Well <input type="checkbox"/> Recompletion <input type="checkbox"/> Change in Ownership	Change in Transporter of: <input type="checkbox"/> Oil <input type="checkbox"/> Dry Gas <input type="checkbox"/> Casinghead Gas <input type="checkbox"/> Condensate
CASINGHEAD GAS MUST NOT BE FLARED AFTER 2-1-33 UNLESS AN EXCEPTION TO RULE 1104 IS OBTAINED.	

If change of ownership give name and address of previous owner

THIS WELL HAS BEEN PLACED IN THE POOL DESIGNATED BELOW. IF YOU DO NOT CONCUR NOTIFY THIS OFFICE.

II. DESCRIPTION OF WELL AND LEASE

Lease Name Anderson	Well No. 1	Pool Name, including Formation Monument Blinebry	Kind of Lease State, Federal or Fee Fee	Lease No.
Location				
Unit Letter 0 : 330' Feet From The South Line and 1980' Feet From The East				
Line of Section 8 Township 20 S Range 37E, NMPM, Eddy Lea County				

III. DESIGNATION OF TRANSPORTER OF OIL AND NATURAL GAS

Name of Authorized Transporter of Oil <input checked="" type="checkbox"/> or Condensate <input type="checkbox"/> Tesoro Crude oil Co.	Address (Give address to which approved copy of this form is to be sent) Midland, Texas
Name of Authorized Transporter of Casinghead Gas <input type="checkbox"/> or Dry Gas <input type="checkbox"/>	Address (Give address to which approved copy of this form is to be sent)
If well produces oil or liquids, give location of tanks.	Unit Sec. Twp. Rge. Is gas actually connected? When
	0 8 20 S 37E No

If this production is commingled with that from any other lease or pool, give commingling order number:

NOTE: Complete Parts IV and V on reverse side if necessary.

VI. CERTIFICATE OF COMPLIANCE

I hereby certify that the rules and regulations of the Oil Conservation Division have been complied with and that the information given is true and complete to the best of my knowledge and belief.

Curtis F. Covington (Signature)
Engineer

(Title)

12-3-87

(Date)

OIL CONSERVATION DIVISION

APPROVED _____, 19____
BY *[Signature]*
TITLE _____

This form is to be filed in compliance with RULE 1104.

If this is a request for allowable for a newly drilled or deepened well, this form must be accompanied by a tabulation of the deviation tests taken on the well in accordance with RULE 111.

All sections of this form must be filled out completely for allowable on new and recompleted wells.

Fill out only Sections I, II, III, and VI for changes of owner, well name or number, or transporter, or other such change of condition.

Separate Forms C-104 must be filed for each pool in multiply completed wells.

IV. COMPLETION DATA

IV. COMPLETION DATA									
Designate Type of Completion - (X)		Oil Well	Gas Well	New Well	Workover	Deepen	Plug Back	Same Res'v.	Diff. Res'v.
		X		X					
Date Spudded 6-30-87	Date Compl. Ready to Prod. 12-1-87			Total Depth 6800'			P.B.T.D. 6097'		
Elevations (DF, RKB, RT, GR, etc.) 3550 RKB	Name of Producing Formation Blinebry			Top Oil/Gas Pay 5590			Tubing Depth 6026'		
Perforations 5593' - 5700'							Depth Casing Shoe 6539'		

TUBING, CASING, AND CEMENTING RECORD

HOLE SIZE	CASING & TUBING SIZE	DEPTH SET	SACKS CEMENT
13 3/8"	13 3/8"	250	260 SX.
11	8 5/8"	1215	470 SX.
7 7/8"	5 1/2"	6539	820 SX.

V. TEST DATA AND REQUEST FOR ALLOWABLE (Test must be after recovery of total volume of load oil and must be equal to or exceed top allowable for this depth or be for full 24 hours)

Date First New Oil Run To Tanks 10-16-87 Swabbed	Date of Test 12-2-87		Producing Method (Flow, pump, gas lift, etc.) Pumping	
Length of Test 24 hours	Tubing Pressure -		Casing Pressure 25#	Choke Size -
Actual Prod. During Test	Oil - Bbls. 17	Water - Bbls. 47	Gas - MCF 47	

GAS WELL

Actual Prod. Test - MCF/D	Length of Test	Bbls. Condensate/MMCF	Gravity of Condensate
Sealing Method (pilot, back pr.)	Tubing Pressure (Shut-in)	Casing Pressure (Shut-in)	Choke Size

Deviation surveys taken on Horizon Oil & Gas's Anderson 1-8 well
in Lea County, New Mexico:

<u>Depth</u>	<u>Degree</u>
250	.25
798	.75
1220	.50
1674	.50
2218	.75
2718	1.00
2772	1.00
3240	.75
3721	.50
4706	1.50
5700	3.25
5750	3.75
5812	3.50
5906	2.50
6070	2.25
6126	2.25
6283	1.75
6451	1.75
6657	2.50
6800	1.75

RECEIVED

DEC 17 '87

O. C. D.
ARTESIA, OFFICE

I hereby certify that I have personal knowledge of the facts placed
on this sheet and that such information given above is true and complete.

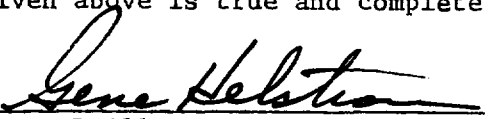
Norton Drilling Company

Before me, the undersigned authority, on this day personally appeared
Gene Helstrom, known to me to be the person whose name is subscribed
hereto, who, after being duly sworn, on oath states that he is the
drilling contractor of the well identified in this instrument and that
such well was not intentionally deviated from the vertical whatsoever.

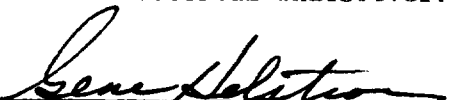
Gene Helstrom

SWORN AND SUBSCRIBED TO before me this 3rd day of December 1987.

Notary Public in and for
Lubbock County, Texas.

My Commission expires 4-9-88.

OIL CONSERVATION DIVISION

P. O. BOX 2088

SANTA FE, NEW MEXICO 87501

NO. OF COPIES RECEIVED	
DISTRIBUTION	
SANTA FE	
FILE	
U.S.G.S.	
LAND OFFICE	
OPERATOR	

WELL COMPLETION OR RECOMPLETION REPORT AND LOG
RECEIVED

5a. Indicate Type of Lease	
State <input type="checkbox"/>	Fee <input checked="" type="checkbox"/>
5. State Oil & Gas Lease No.	

1a. TYPE OF WELL OIL WELL <input checked="" type="checkbox"/> GAS WELL <input type="checkbox"/> DRY <input type="checkbox"/> OTHER <input type="checkbox"/>		DEC 17 '87	
b. TYPE OF COMPLETION NEW WELL <input checked="" type="checkbox"/> WORK OVER <input type="checkbox"/> DEEPEN <input type="checkbox"/> PLUG BACK <input type="checkbox"/> DIFF. RESVR. <input type="checkbox"/> OTHER <input type="checkbox"/>		O.C.D.	
2. Name of Operator Horizon Oil & Gas Co.		ARTESIA, OFFICE	
3. Address of Operator P.O. Box 7 Spearman, Texas 79081		9. Well No. 1	
4. Location of Well UNIT LETTER 0 LOCATED 330' FEET FROM THE south LINE AND 1980' FEET FROM THE east LINE OF SEC. 8 TWP. 20S REC. 37E NMPM		10. Field and Pool, or Wildcat Monument Blinebry	
15. Date Spudded 6-30-87		16. Date T.D. Reached 7-30-87	
17. Date Compl. (Ready to Prod.) 12-1-87		18. Elevations (DF, RKB, RT, GR, etc.) 3550 RKB	
19. Elev. Casinghead 5339		12. County Eddy Lea	
20. Total Depth 6800		21. Plug Back T.D. 6097	
22. If Multiple Compl., How Many NA		23. Intervals Drilled By Rotary Tools X Cable Tools	
24. Producing Interval(s), of this completion - Top, Bottom, Name Blinebry 5593-5700		25. Was Directional Survey Made No	
26. Type Electric and Other Logs Run Dual Laterlog and Comp. Neutron/ Comp. Density		27. Was Well Cored No	

28. CASING RECORD (Report all strings set in well)					
CASING SIZE	WEIGHT LB./FT.	DEPTH SET	HOLE SIZE	CEMENTING RECORD	AMOUNT PULLED
13 3/8"	48	250		260 sx. Class "C"	0
8 5/8"	24	1215	12 1/4	470 sx. lite & Class "C"	0
5 1/2"	15.5	6539	7 7/8	820 sx. lite & Class "H"	0

29. LINER RECORD				30. TUBING RECORD			
SIZE	TOP	BOTTOM	SACKS CEMENT	SCREEN	SIZE	DEPTH SET	PACKER SET
NA					2 3/8"	6026	NA

31. Perforation Record (Interval, size and number) 5593' - 5700' overall using 4" Casing Gun - Total 65 holes.		32. ACID, SHOT, FRACTURE, CEMENT SQUEEZE, ETC. DEPTH INTERVAL 5593' - 5700' AMOUNT AND KIND MATERIAL USED 40,000 gal. jelled 2% KCL & 41,000# 20/40 sand.	
---	--	---	--

33. PRODUCTION							
Date First Production 10-16-87 Swabbed		Production Method (Flowing, gas lift, pumping - Size and type pump) Pumping				Well Status (Prod. or Shut-in) Producing	
Date of Test 12-2-87	Hours Tested 24	Choke Size -	Prod'n. For Test Period 17	Oil - Bbl. 47	Gas - MCF 47	Water - Bbl. 47	Gas - Oil Ratio 2765
Flow Tubing Press.	Casing Pressure 25	Calculated 24-Hour Rate 17	Oil - Bbl. 47	Gas - MCF 47	Water - Bbl. 47	Oil Gravity - API (Corr.) 39.7	

34. Disposition of Gas (Sold, used for fuel, vented, etc.) Vented	Test Witnessed By Reliable Pumping Service
--	---

35. List of Attachments

36. I hereby certify that the information shown on both sides of this form is true and complete to the best of my knowledge and belief.

SIGNED

Curtis F. Covington

TITLE

Engineer

DATE

12-3-87

INSTRUCTIONS

This form is to be filled with the appropriate District Office of the Division not later than 20 days after the completion of any newly-drilled or deepened well. It shall be accompanied by one copy of all electrical and radio-activity logs run on the well and a summary of all special tests conducted, including drill stem tests. All depths reported shall be measured depths. In the case of directionally drilled wells, true vertical depths shall also be reported. For multiple completions, Items 30 through 34 shall be reported for each zone. The form is to be filed in quadruplicate except on state land, where six copies are required. See Rule 1105.

INDICATE FORMATION TOPS IN CONFORMANCE WITH GEOGRAPHICAL SECTION OF STATE

Southeastern New Mexico

Northwestern New Mexico

T. Anhy	1060	T. Canyon		T. Ojo Alamo		T. Penn. "B"	
T. Salt	1220	T. Strawn		T. Kirtland-Fruitland		T. Penn. "C"	
B. Salt	2295	T. Atoka		T. Pictured Cliffs		T. Penn. "D"	
T. Yates	2432	T. Miss		T. Cliff House		T. Leadville	
T. 7 Rivers	2742	T. Devonian		T. Menefee		T. Madison	
T. Queen	3171	T. Silurian		T. Point Lookout		T. Elbert	
T. Grayburg	3470	T. Montoya		T. Mancos		T. McCracken	
T. San Andres	3838	T. Simpson		T. Gallup		T. Ignacio Qtzite	
T. Glorieta	5105	T. McKee		Base Greenhorn		T. Granite	
T. Paddock	5170	T. Ellenburger		T. Dakota		T.	
T. Blinbry	5590	T. Gr. Wash		T. Morrison		T.	
T. Tubb	6305	T. Granite		T. Todilto		T.	
T. Drinkard		T. Delaware Sand		T. Entrada		T.	
T. Abo		T. Bone Springs		T. Wingate		T.	
T. Wolfcamp		T.		T. Chinle		T.	
T. Penn.		T.		T. Permian		T.	
T. Cisco (Bough C)		T.		T. Penn. "A"		T.	

OIL OR GAS SANDS OR ZONES

No. 1, from	5110	to	5240	No. 4, from		to	
No. 2, from	5590	to	5700	No. 5, from		to	
No. 3, from	6350	to	6470	No. 6, from		to	

IMPORTANT WATER SANDS

Include data on rate of water inflow and elevation to which water rose in hole.

No. 1, from	Unknown	to		feet	
No. 2, from		to		feet	
No. 3, from		to		feet	
No. 4, from		to		feet	

FORMATION RECORD (Attach additional sheets if necessary)

From	To	Thickness in Feet	Formation	From	To	Thickness in Feet	Formation
			NOTE: Our rights did not start until Paddock Zone. Geologist on location at 5100'.				
5100	5230	130	Limestone and Shale				
5230	5600	470	Limestone				
5600	5680	80	Limestone and Shale				
5680	5780	100	Limestone, Shale & Sandstone				
5780	6330	550	Limestone and Shale				
6330	6800	470	Limestone, Shale & Sandstone				

STATE OF NEW MEXICO
ENERGY AND MINERALS DEPARTMENT

NO. OF COPIES RECEIVED	
DISTRIBUTION	
SANTA FE	
FILE	
U.S.G.S.	
LAND OFFICE	
TRANSPORTER	OIL
	GAS
OPERATOR	
PRODUCTION OFFICE	

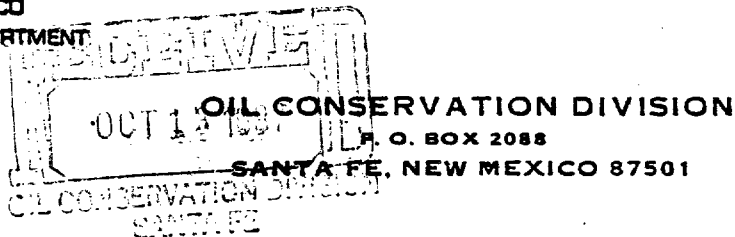

Form C-104
Revised 10-01-78
Format 08-01-83
Page 1

REQUEST FOR ALLOWABLE
AND
AUTHORIZATION TO TRANSPORT OIL AND NATURAL GAS

I. Operator Horizon Oil & Gas Co.

Address P.O. Box 7 Spearman, Texas 79081

Reason(s) for filing (Check proper box)

<input checked="" type="checkbox"/> New Well	Change in Transporter of:	Other (Please explain) <u>500 Bbl Test Allowable for Tulsa</u>
<input type="checkbox"/> Recompletion	<input type="checkbox"/> Oil	
<input type="checkbox"/> Change in Ownership	<input type="checkbox"/> Casinghead Gas	
	<input type="checkbox"/> Dry Gas	
	<input type="checkbox"/> Condensate	

If change of ownership give name and address of previous owner _____

II. DESCRIPTION OF WELL AND LEASE

Lease Name <u>Anderson</u>	Well No. <u>1</u>	Pool Name, including Formation <u>Monument (Tabb)</u>	Kind of Lease State, Federal or Fee <u>Fee</u>	Lease No.
Location				
Unit Letter <u>O</u> : <u>330</u> Feet From The <u>South</u> Line and <u>1980</u> Feet From The <u>East</u>				
Line of Section <u>8</u> Township <u>20S</u> Range <u>37E</u> , NMPM, <u>LEH</u> County				

III. DESIGNATION OF TRANSPORTER OF OIL AND NATURAL GAS

Name of Authorized Transporter of Oil <input checked="" type="checkbox"/> or Condensate <input type="checkbox"/> <u>TESORO</u>	Address (Give address to which approved copy of this form is to be sent) <u>Midland, Texas</u>	
Name of Authorized Transporter of Casinghead Gas <input type="checkbox"/> or Dry Gas <input type="checkbox"/>	Address (Give address to which approved copy of this form is to be sent)	
If well produces oil or liquids, give location of tanks.	Unit <u>O</u>	Sec. <u>8</u>
	Twp. <u>20S</u>	Rge. <u>37E</u>
Is gas actually connected?		When

If this production is commingled with that from any other lease or pool, give commingling order number: _____

NOTE: Complete Parts IV and V on reverse side if necessary.

VI. CERTIFICATE OF COMPLIANCE

I hereby certify that the rules and regulations of the Oil Conservation Division have been complied with and that the information given is true and complete to the best of my knowledge and belief.

Curtis A. Galt
(Signature)

(Title)

(Date)

OIL CONSERVATION DIVISION

APPROVED _____, 19____
BY Jerry L. [Signature]
TITLE _____

This form is to be filed in compliance with RULE 1104.

If this is a request for allowable for a newly drilled or deepened well, this form must be accompanied by a tabulation of the deviation tests taken on the well in accordance with RULE 111.

All sections of this form must be filled out completely for allowable on new and recompleted wells.

Fill out only Sections I, II, III, and VI for changes of owner, well name or number, or transporter or other such change of condition.

Separate Forms C-104 must be filed for each pool in multiply completed wells.

IV. COMPLETION DATA

Designate Type of Completion - (X)		Oil Well	Gas Well	New Well	Workover	Deepen	Plug Back	Same Res'v.	Diff. Res'v.
Date Spudded	Date Compl. Ready to Prod.		Total Depth			P.B.T.D.			
Elevations (DF, RKB, RT, GR, etc.)	Name of Producing Formation		Top Oil/Gas Pay			Tubing Depth			
Perforations						Depth Casing Shoe			
TUBING, CASING, AND CEMENTING RECORD									
HOLE SIZE	CASING & TUBING SIZE		DEPTH SET			SACKS CEMENT			

V. TEST DATA AND REQUEST FOR ALLOWABLE (Test must be after recovery of total volume of load oil and must be equal to or exceed top allowable for this depth or be for full 24 hours)

Date First New Oil Run To Tanks	Date of Test	Producing Method (Flow, pump, gas lift, etc.)	
Length of Test	Tubing Pressure	Casing Pressure	Choke Size
Actual Prod. During Test	Oil-Bbls.	Water-Bbls.	Gas-MCF

GAS WELL

Actual Prod. Test-MCF/D	Length of Test	Bbls. Condensate/MMCF	Gravity of Condensate
Testing Method (pilot, back pr.)	Tubing Pressure (Shut-in)	Casing Pressure (Shut-in)	Choke Size

STATE OF NEW MEXICO
ENERGY AND MINERALS DEPARTMENT

NO. OF COPIES RECEIVED	
DISTRIBUTION	
SANTA FE	
FILE	
U.S.G.S.	
LAND OFFICE	
OPERATOR	

OIL CONSERVATION DIVISION

P.O. BOX 2088
SANTA FE, NEW MEXICO 87501

Form C-103
Revised 10-1-78

AUG 17 1987

5a. Indicate Type of Lease	
State <input type="checkbox"/>	Fee <input checked="" type="checkbox"/>
5. State Oil & Gas Lease No.	
7. Unit Agreement Name	
8. Farm or Lease Name Anderson	
9. Well No. #1	
10. Field and Pool, or Wildcat Monument	
12. County Lea	

SUNDRY NOTICES AND REPORTS ON WELLS

(DO NOT USE THIS FORM FOR PROPOSALS TO DRILL ON TO DEEPEN OR PLUG BACK TO A DIFFERENT RESERVOIR.
USE "APPLICATION FOR PERMIT -" (FORM C-101) FOR SUCH PROPOSALS.)

1. OIL WELL <input checked="" type="checkbox"/> GAS WELL <input type="checkbox"/> OTHER <input type="checkbox"/>
2. Name of Operator Horizon Oil & Gas Co.
3. Address of Operator P.O. Box 7 Spearman, Texas 79081
4. Location of Well UNIT LETTER 0 1980 FEET FROM THE East LINE AND 330 FEET FROM THE South LINE, SECTION 8 TOWNSHIP 20S RANGE 37E NMPM.

15. Elevation (Show whether DF, RT, GR, etc.)
GR 3538

16. Check Appropriate Box To Indicate Nature of Notice, Report or Other Data	
NOTICE OF INTENTION TO:	SUBSEQUENT REPORT OF:
PERFORM REMEDIAL WORK <input type="checkbox"/>	REMEDIAL WORK <input type="checkbox"/>
TEMPORARILY ABANDON <input type="checkbox"/>	COMMENCE DRILLING OPS. <input type="checkbox"/>
PULL OR ALTER CASING <input type="checkbox"/>	CASING TEST AND CEMENT JOB <input checked="" type="checkbox"/>
OTHER <input type="checkbox"/>	OTHER <input type="checkbox"/>
PLUG AND ABANDON <input type="checkbox"/>	ALTERING CASING <input type="checkbox"/>
CHANGE PLANS <input type="checkbox"/>	PLUG AND ABANDONMENT <input type="checkbox"/>

17. Describe Proposed or Completed Operations (Clearly state all pertinent details, and give pertinent dates, including estimated date of starting any proposed work) SEE RULE 1103.

A. Ran 5 1/2" - 15.5# casing. Set at 6539'. Cemented with 420 sx. Halliburton Lite cement containing 5#/sk. Gilsonite and 1/4#/sk Flocele, followed by 400 sx class "H" containing 5#/sk Gilsonite and 5#/sk KCL and 6/10 of 1% Halled Nine. Plug down at 3:50 P.M., 7-31-87. Pressured casing to 1800#. Held okay.

3. I hereby certify that the information above is true and complete to the best of my knowledge and belief.

CHD <u>Curtis F. Covington</u>	TITLE <u>Engineer</u>	DATE <u>8-6-87</u>
PROVED BY <u>[Signature]</u>	TITLE <u>DISTRICT SUPERVISOR</u>	DATE <u>8-10-87</u>
CONDITIONS OF APPROVAL, IF ANY:		

STATE OF NEW MEXICO
ENERGY AND MINERALS DEPARTMENT

NO. OF COPIES RECEIVED	
DISTRIBUTION	
SANTA FE	
FILE	
U.S.G.S.	
LAND OFFICE	
OPERATOR	

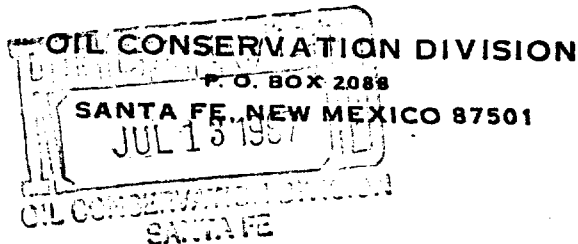

Form C-103
Revised 10-1-78

5a. Indicate Type of Lease State <input type="checkbox"/> Fee <input checked="" type="checkbox"/>
5. State Oil & Gas Lease No.
7. Unit Agreement Name
8. Farm or Lease Name Anderson
9. Well No. # 1
10. Field and Pool, or Wildcat Monument
12. County Lea

SUNDRY NOTICES AND REPORTS ON WELLS

(DO NOT USE THIS FORM FOR PROPOSALS TO DRILL OR TO DEEPEN OR PLUG BACK TO A DIFFERENT RESERVOIR. USE "APPLICATION FOR PERMIT -" (FORM C-101) FOR SUCH PROPOSALS.)

1. OIL WELL <input checked="" type="checkbox"/> GAS WELL <input type="checkbox"/> OTHER <input type="checkbox"/>
2. Name of Operator Horizon Oil & Gas Co.
3. Address of Operator P.O. Box 7 Spearman, Texas 79081
4. Location of Well UNIT LETTER <u>0</u> , <u>1980</u> FEET FROM THE <u>East</u> LINE AND <u>330</u> FEET FROM THE <u>South</u> LINE, SECTION <u>8</u> TOWNSHIP <u>20S</u> RANGE <u>37E</u> NMPM.
15. Elevation (Show whether DF, RT, GR, etc.) GR 3538'

Check Appropriate Box To Indicate Nature of Notice, Report or Other Data

NOTICE OF INTENTION TO:

PERFORM REMEDIAL WORK <input type="checkbox"/>	PLUG AND ABANDON <input type="checkbox"/>
TEMPORARILY ABANDON <input type="checkbox"/>	CHANGE PLANS <input type="checkbox"/>
PULL OR ALTER CASING <input type="checkbox"/>	OTHER <input type="checkbox"/>

SUBSEQUENT REPORT OF:

REMEDIAL WORK <input type="checkbox"/>	ALTERING CASING <input type="checkbox"/>
COMMENCE DRILLING OPS. <input checked="" type="checkbox"/>	PLUG AND ABANDONMENT <input type="checkbox"/>
CASING TEST AND CEMENT JOBS <input checked="" type="checkbox"/>	OTHER <input type="checkbox"/>

17. Describe Proposed or Completed Operations (Clearly state all pertinent details, and give pertinent dates, including estimated date of starting any proposed work) SEE RULE 1703.

- A. Spudded well at 9:30 P.M., 6-30-87.
- B. Ran 13 3/8", 48# Surface Casing, set at 250'. Cemented with 260 sx. of class "C" containing 2% CaCl. Cement circulated to surface. Plug down at 9 A.M., 7-1-87. Waited on cement 20 hours. Tested Casing on 7-2-87, to 600#. Held okay.
- C. Ran 8 5/8", 24# Protection Casing. Set at 1215'. Cemented with 270 sx. Halliburton Lite cement and 200 sx. class "C" containing 2% CaCl. Cement circulated to surface. Plug down at 2:15 P.M., 7-3-87. Waited on cement 20 hours. Tested Casing on 7-4-87 to 1,000#. Held okay.

8. I hereby certify that the information above is true and complete to the best of my knowledge and belief.

SIGNED <u>Curtis F. Covington</u>	TITLE <u>Engineer</u>	DATE <u>7-6-87</u>
PROVED BY <u>[Signature]</u>	TITLE <u>DISTRICT SUPERVISOR</u>	DATE <u></u>

CONDITIONS OF APPROVAL, IF ANY:

NO. OF COPIES RECEIVED	
DISTRIBUTION	
SANTA FE	
FILE	
U.S.G.S.	
LAND OFFICE	
OPERATOR	

P. O. BOX 2088
SANTA FE, NEW MEXICO 87501

JUN 29 1987

5A. Indicate Type of Lease

STATE ☐ FEE ☒

5. State Oil & Gas Lease No.

APPLICATION FOR PERMIT TO DRILL, DEEPEN, OR PLUG BACK

1a. Type of Work

b. Type of Well
OIL WELL ☒ GAS WELL ☐ OTHER ☐
DRILL ☒ DEEPEN ☐ PLUG BACK ☐
SINGLE ZONE ☐ MULTIPLE ZONE ☐

2. Name of Operator

3. Address of Operator

4. Location of Well

UNIT LETTER O LOCATED 1980 FEET FROM THE EAST LINEAND 330 FEET FROM THE South LINE OF SEC. 8 TWP. 20S RGE. 37E NMPM

7. Unit Agreement Name

8. Farm or Lease Name

9. Well No.

10. Field and Pool, or Wildcat

12. County

1. Elevations (Show whether DF, RT, etc.)

21A. Kind & Status Plug. Bond

19. Proposed Depth

19A. Formation

20. Rotary or C.T.

23.

PROPOSED CASING AND CEMENT PROGRAM

SIZE OF HOLE	SIZE OF CASING	WEIGHT PER FOOT	SETTING DEPTH	SACKS OF CEMENT	EST. TOP
17"	13 3/8"	54	250'	300	Surface
11"	8 7/8"	24#	1500'	500	Surface
7 7/8"	4 1/2" or 5 1/2"	11.6# or 15#	6800'	as needed	approx 2500'

Blow-out-preventor - Shaffer E11", 3000 psi double hydraulic
with 2 3" openings below rams,

Other well in this 40 Acres - Chevron Theodore Anderson #1 (August 1987)

I ABOVE SPACE DESCRIBE PROPOSED PROGRAM; IF PROPOSAL IS TO DEEPEN OR PLUG BACK, GIVE DATA ON PRESENT PRODUCTIVE ZONE AND PROPOSED NEW PRODUCTIVE ZONE. GIVE BLOWOUT PREVENTER PROGRAM, IF ANY.

I hereby certify that the information above is true and complete to the best of my knowledge and belief.

Signed Carly J. Egan Title Engineer Date 6-22-87

(This space for State Use)

APPROVED BY Larry Lupton TITLE DISTRICT 1 SUPERVISOR DATE JUN 25 1987

CONDITIONS OF APPROVAL, IF ANY:

Permit Expires 6 Months From Approval
Date Unless Drilling Underway.

**NEW MEXICO OIL CONSERVATION COMMISSION
WELL LOCATION AND ACREAGE DEDICATION PLAT**

Form C-102
Supersedes C-128
Effective 1-1-65

All distances must be from the outer boundaries of the Section.

Operator HORIZON OIL & GAS CO.			Lease Anderson		Well No. 1
Unit Letter 0	Section 8	Township 20-S	Range 37-E	County Lea	
Actual Footage Location of Well: <div style="display: flex; justify-content: space-between;"> 330 feet from the South line and 1980 feet from the East line </div>					
Ground Level Elev. 3538	Producing Formation Paddock	Pool Monument	Dedicated Acreage: 40 Acres		

1. Outline the acreage dedicated to the subject well by colored pencil or hatchure marks on the plat below.
2. If more than one lease is dedicated to the well, outline each and identify the ownership thereof (both as to working interest and royalty).

Only one lease involved
3. If more than one lease of different ownership is dedicated to the well, have the interests of all owners been consolidated by communitization, unitization, force-pooling, etc?

Not applicable

☐ Yes ☐ No If answer is "yes," type of consolidation _____

If answer is "no," list the owners and tract descriptions which have actually been consolidated. (Use reverse side of this form if necessary.) _____

No allowable will be assigned to the well until all interests have been consolidated (by communitization, unitization, forced-pooling, or otherwise) or until a non-standard unit, eliminating such interests, has been approved by the Commission.

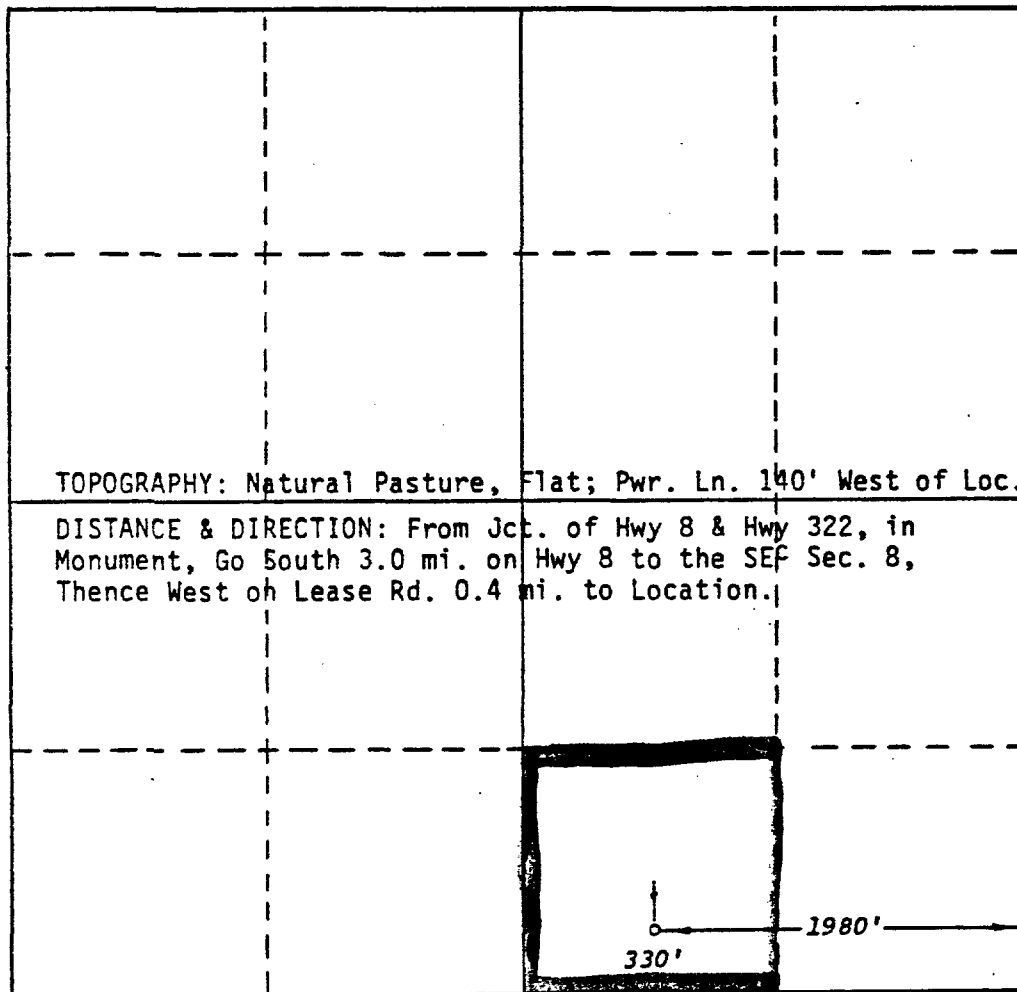

CERTIFICATION

I hereby certify that the information contained herein is true and complete to the best of my knowledge and belief.

Curtis F. Covington

Name
Curtis F. Covington

Position
Engineer

Company
Horizon Oil & Gas Co.

Date
6-23-87

I hereby certify that the well location shown on this plat was obtained from field notes of actual surveys made by me or under my supervision, and that the same is true and correct to the best of my knowledge and belief.

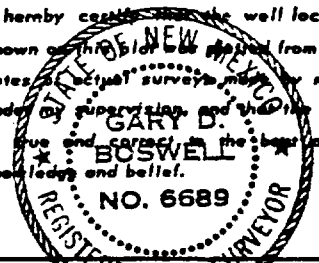

Date Surveyed
JUNE 22, 1987

Registered Professional Engineer and/or Land Surveyor

Gary D. Boswell

Certificate No. **6689**

**NEW MEXICO OIL CONSERVATION COMMISSION
WELL LOCATION AND ACREAGE DEDICATION PLAT**

Form C-102
Supersedes C-128
Effective 1-1-65

All distances must be from the outer boundaries of the Section.

Operator HORIZON OIL & GAS CO.			Lessee Anderson		Well No. 1
Unit Letter 0	Section 8	Township 20-S	Range 37-E	County Lea	
Actual Footings Location of Well: <div style="display: flex; justify-content: space-between;"> 330 feet from the South line and 1980 feet from the East line </div>					
Ground Level Elev. 3538	Producing Formation Blindery	Pool Monument	Dedicated Acreage: 40 Acres		

1. Outline the acreage dedicated to the subject well by colored pencil or hatchure marks on the plat below.
2. If more than one lease is dedicated to the well, outline each and identify the ownership thereof (both as to working interest and royalty).

Only one lease involved
3. If more than one lease of different ownership is dedicated to the well, have the interests of all owners been consolidated by communitization, unitization, force-pooling, etc?

Not applicable

☐ Yes ☐ No If answer is "yes," type of consolidation _____

If answer is "no," list the owners and tract descriptions which have actually been consolidated. (Use reverse side of this form if necessary.) _____

No allowable will be assigned to the well until all interests have been consolidated (by communitization, unitization, forced-pooling, or otherwise) or until a non-standard unit, eliminating such interests, has been approved by the Commission.

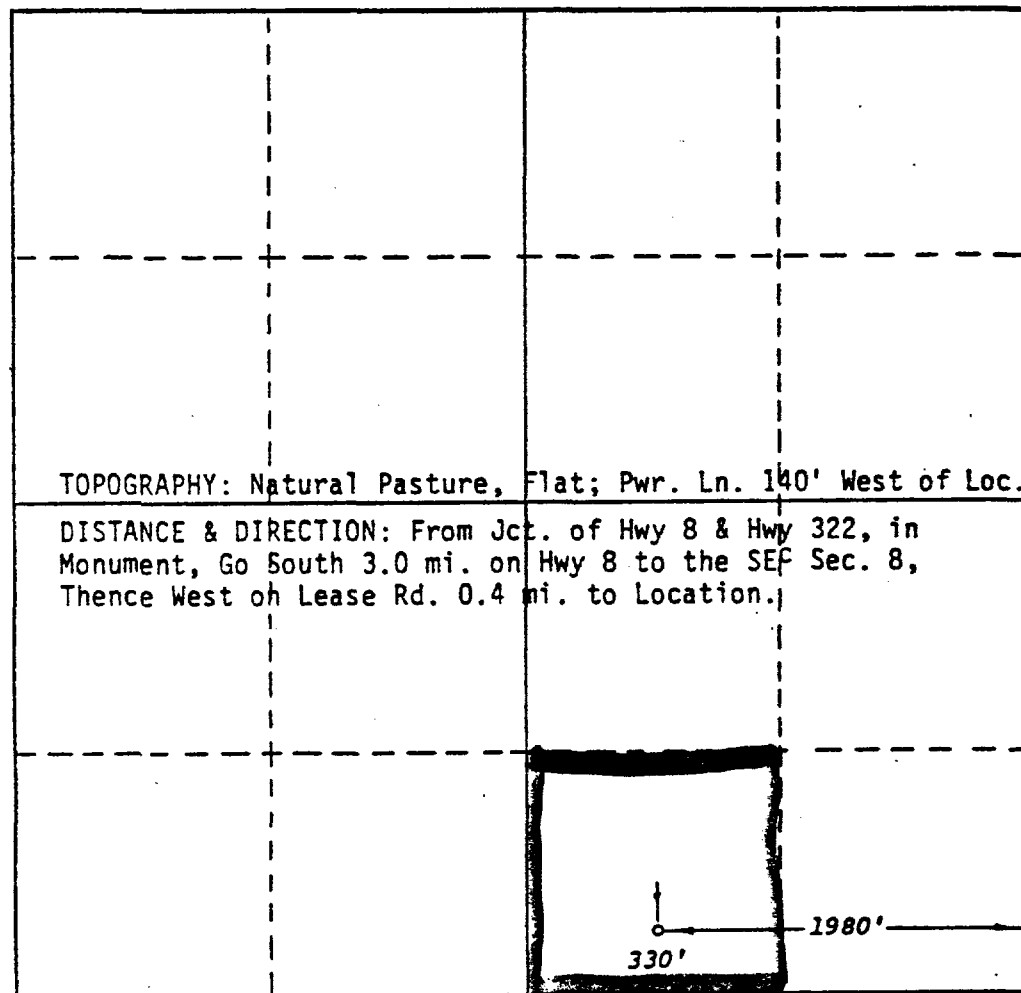

CERTIFICATION

I hereby certify that the information contained herein is true and complete to the best of my knowledge and belief.

Curtis F. Covington

Name
Curtis F. Covington

Position
Engineer

Company
Horizon Oil & Gas Co.

Date
6-23-87

I hereby certify that the well location shown on this plat was obtained from field notes of actual surveys made by me or under my supervision, and that the same is true and correct to the best of my knowledge and belief.

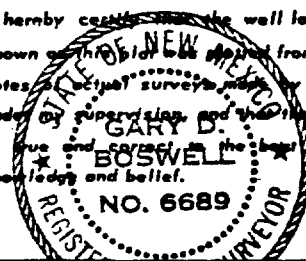

Date Surveyed
June 12, 1987

Registered Professional Engineer and/or Land Surveyor

Gary D. Boswell

Certificate No.
6689