

Submit to Appropriate
District Office
State Leases - 4 copies
Fee Leases - 3 copies

State of New Mexico
Energy, Minerals and Natural Resources Department

Form C-102
Revised 1-1-89

OIL CONSERVATION DIVISION

P.O. Box 2088

Santa Fe, New Mexico 87504-2088

DISTRICT I
P.O. Box 1980, Hobbs, NM 88240

DISTRICT II
P.O. Drawer DD, Artesia, NM 88210

DISTRICT III
1000 Rio Brazos Rd., Aztec, NM 87410

WELL LOCATION AND ACREAGE DEDICATION PLAT

All Distances must be from the outer boundaries of the section

| | | | | |
|--|---|------------------------------|--|----------------------------------|
| Operator UNOCAL | | Lease RINCON | | Well No. E 192 |
| Unit Letter D | Section 1 | Township 26N | Range 7W | County NMFM Rio Arriba |
| Actual Footage Location of Well: 1020 feet from the North line and 970 feet from the West line | | | | |
| Ground level Elev. 6536 | Producing Formation Dakota - Gallup | Pool Basin - Largo | Dedicated Acreage: 320.60/160.60 Acres | |
| <p>1. Outline the acreage dedicated to the subject well by colored pencil or hatchure marks on the plat below.</p> <p>2. If more than one lease is dedicated to the well, outline each and identify the ownership thereof (both as to working interest and royalty).</p> <p>3. If more than one lease of different ownership is dedicated to the well, have the interest of all owners been consolidated by communitization, unitization, force-pooling, etc.? <input type="checkbox"/> Yes <input type="checkbox"/> No If answer is "yes" type of consolidation N/A</p> <p>If answer is "no" list the owners and tract descriptions which have actually been consolidated. (Use reverse side of this form if necessary.)</p> <p>No allowable will be assigned to the well until all interests have been consolidated (by communitization, unitization, forced-pooling, or otherwise) or until a non-standard unit, eliminating such interest, has been approved by the Division.</p> | | | | |

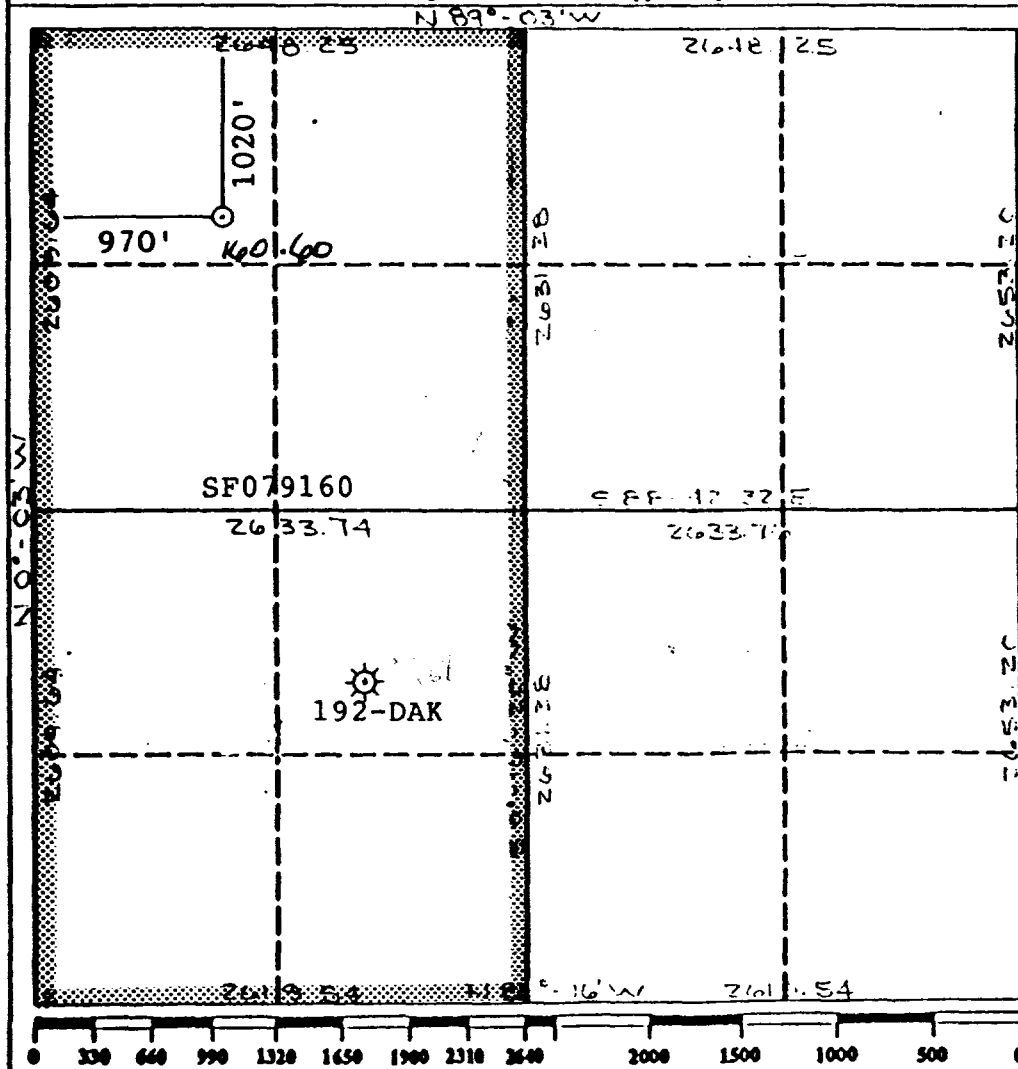

| | |
|---|---------------------------------|
| OPERATOR CERTIFICATION | |
| I hereby certify that the information contained herein is true and complete to the best of my knowledge and belief. | |
| Signature | <i>Bill Hering</i> |
| Printed Name | Mr. Bill Hering |
| Position | District Petroleum Engr. |
| Company | UNOCAL |
| Date | 03/18/91 |
| SURVEYOR CERTIFICATION | |
| I hereby certify that the well location shown on this plat was plotted from field notes of actual surveys made by me or under my supervision, and that the same is true and correct to the best of my knowledge and belief. | |
| Date Surveyed | March 8, 1991 |
| Signature of Surveyor | <i>B. Tullis</i> |
| Printed Name of Surveyor | B. Tullis |
| Certificate No. | 9672 |