

## APPLICATION FOR AUTHORIZATION TOJECT

- I. Purpose: ☐ Secondary Recovery ☐ Pressure Maintenance ☒ Disposal ☐ Storage  
Application qualifies for administrative approval? ☐ yes ☐ no

II. Operator: Jubilee Energy Corporation  
Address: 4000 N. Big Spring, Suite 109, Midland, Texas 79705  
Contact party: T. B. Garber Phone: 915-686-0431

III. Well data: Complete the data required on the reverse side of this form for each well proposed for injection. Additional sheets may be attached if necessary.

IV. Is this an expansion of an existing project? ☐ yes ☒ no  
If yes, give the Division order number authorizing the project \_\_\_\_\_

V. Attach a map that identifies all wells and leases within two miles of any proposed injection well with a one-half mile radius circle drawn around each proposed injection well. This circle identifies the well's area of review.

\* VI. Attach a tabulation of data on all wells of public record within the area of review which penetrate the proposed injection zone. Such data shall include a description of each well's type, construction, date drilled, location, depth, record of completion, and a schematic of any plugged well illustrating all plugging detail.

VII. Attach data on the proposed operation, including:

1. Proposed average and maximum daily rate and volume of fluids to be injected;
2. Whether the system is open or closed;
3. Proposed average and maximum injection pressure;
4. Sources and an appropriate analysis of injection fluid and compatibility with the receiving formation if other than reinjected produced water; and
5. If injection is for disposal purposes into a zone not productive of oil or gas at or within one mile of the proposed well, attach a chemical analysis of the disposal zone formation water (may be measured or inferred from existing literature, studies, nearby wells, etc.).

\*VIII. Attach appropriate geological data on the injection zone including appropriate lithologic detail, geological name, thickness, and depth. Give the geologic name, and depth to bottom of all underground sources of drinking water (aquifers containing waters with total dissolved solids concentrations of 10,000 mg/l or less) overlying the proposed injection zone as well as any such source known to be immediately underlying the injection interval.

IX. Describe the proposed stimulation program, if any.

\* X. Attach appropriate logging and test data on the well. (If well logs have been filed with the Division they need not be resubmitted.)

\* XI. Attach a chemical analysis of fresh water from two or more fresh water wells (if available and producing) within one mile of any injection or disposal well showing location of wells and dates samples were taken.

XII. Applicants for disposal wells must make an affirmative statement that they have examined available geologic and engineering data and find no evidence of open faults or any other hydrologic connection between the disposal zone and any underground source of drinking water.

XIII. Applicants must complete the "Proof of Notice" section on the reverse side of this form.

XIV. Certification

I hereby certify that the information submitted with this application is true and correct to the best of my knowledge and belief.

Name: T. B. Garber Title: President  
Signature: [Signature] Date: 11-6-84

\* If the information required under Sections VI, VIII, X, and XI above has been previously submitted, it need not be duplicated and resubmitted. Please show the date and circumstance of the earlier submittal.

DISTRIBUTION: Original and one copy to Santa Fe with one copy to district office.

EXHIBIT

#1  
Case 8428

DEPT. OF JUSTICE	
FEDERAL BUREAU OF INVESTIGATION	
WASHINGTON, D. C. 20535	
DATE: 10/1/84	
TIME: 10:00 AM	
CASE NO. 8428	

III. Well Data

- A. (1) Exxon "A" Federal No. 2, Section 27, T-24-S, R-32-E, 1980' fWL & 1980' FSL, Lea County, New Mexico.
- (2) Casing: 8 5/8" 24# @ 943' and cemented with 450 sx. Cement circulated. Set in 12 1/2" hole.  
5 1/2" 15.5# @ 4977' and cemented with 200 sx. Cement top @ 3800'. Set in 7 7/8" hole.
- (3) Tubing will be 2 7/8" 6.5# J-55 set @ 4800'.
- (4) Packer will be Baker Model "R" Production Packer.
- B. (1) Injection zone: Delaware sand (Ramsey zone)  
Double X Delaware Field
- (2) Injection interval: 4854' to 4872'. Preforated 1 shot/ft.
- (3) Well drilled for production and was a dry hole.
- (4) No other zones perforated.
- (5) None.

- VII. (1) 200 barrels daily (average).
- (2) Open system.
- (3) Gravity to 50#.
- (4) Produced Delaware formation water.
- (5) Re-injection of formation water into productive zone.

- VIII. (1) Lithologic detail: Fine grain silt sandstone with 20% porosity and low permeability.
- (2) Name: Delaware sand
- (3) Thickness: 60
- (4) Depth: 4850' to 4910'.
- (5) No known fresh water in the area.

- IV. (1) No stimulation required.

- X. (1) Well logs attached. Production test recovered salt water with show of oil and gas.

- XI. (1) No producing water wells in area.

- XII. (1) We find no evidence of open faults or any other hydrologic connection between the disposal zone and any uderground source of drinking water.

- XIII. (1) Proof of Notice completed.

Exxon "A" Federal No. 1

1. Type: Oil-pumping
2. Construction: Typical oil
3. Date Drilled: 12-15-82
4. Location: Unit F, 1980' FNL & 1980' FWL in Section 27, T-24-S, R-32-E,  
Lea County, New Mexico
5. Depth: 4905'
6. Completion Record: 5 1/2" casing set @ 4905' w/150 sx. of 50-50 poz.  
Perforated from 4845' to 4847' Delaware; Acidize  
with 2000 gallons; Fraced with 32,000 gallons  
+ 34,500# sand.
7. Plug Detail: None

Exxon "A" Federal No. 3

1. Type: Oil-pumping
2. Construction: Typical oil
3. Date Drilled: 11-20-83
4. Location: Unit C, 660' FNL & 1980' FWL in Section 27, T-24-S, R-32-E,  
Lea County, New Mexico
5. Depth: 4883'
6. Completion Record: 5 1/2" casing set @ 4883' with 150 sx. 50-50 poz.  
Perforated from 4862' to 4874' Delaware; Acidize  
with 1000 gallons; Fraced with 20,000 gallons +  
20,000# sand.
7. Plug Detail: None

Exxon "A" Federal No. 4

1. Type: Oil-pumping
2. Construction: Typical oil
3. Date Drilled: 5-2-84
4. Location: Unit N, 990' FSL & 1980' FWL of Section 27, T-24-S, R-32-E,  
Lea County, New Mexico
5. Depth: 4862'
6. Completion Record: 5 1/2" casing set @ 4862' w/200 sx. of 50-50 poz.  
Perforated from 4835' to 4855'; Acidized w/2000  
gallons. Fraced w/20,000 gallons + 20,000# sand.
7. Plug Detail: None

R. E. Williamson Wright Federal No. 2

1. Type: Oil-pumping
2. Construction: Typical oil
3. Date Drilled: 7-17-79
4. Location: Unit G, 1980' FNL and 1980' FEL of Section 27, T-24-S, R-32-E  
Lea County, New Mexico
5. Depth: 4885'
6. Completion Record: 4½" casing set @ 4885' w/200 sx. Class "C".  
Perforated from 4866' to 4871'; Fraced w/20,000  
Gallons + 30,000# sand.
7. Plug Detail: None

# EXXON "A" No. 2 u. 11

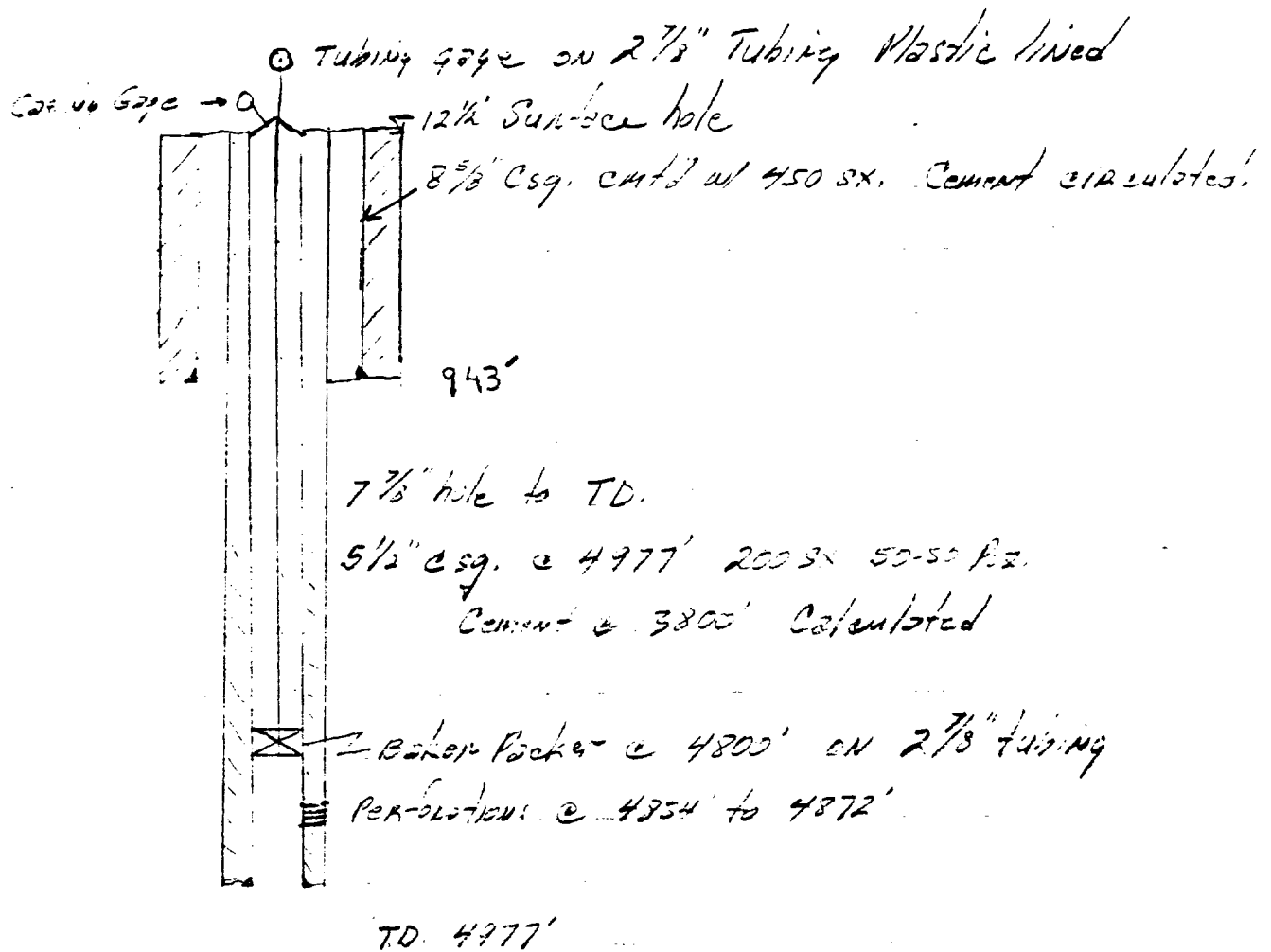

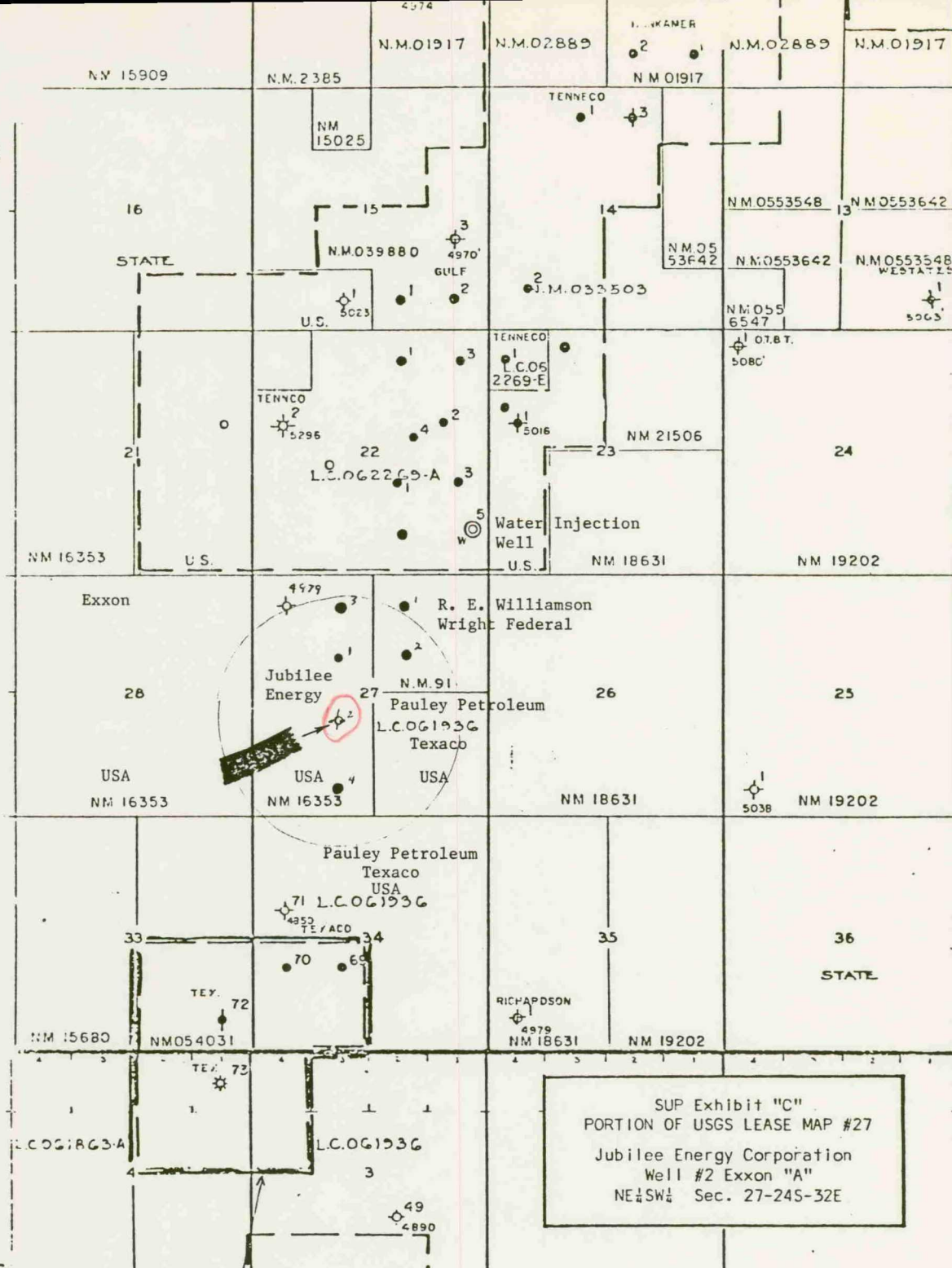

**AFFIDAVIT OF PUBLICATION**

State of New Mexico,

County of Lea.

1. \_\_\_\_\_

Robert L. Summers

of the Hobbs Daily News-Sun, a daily newspaper published at Hobbs, New Mexico, do solemnly swear that the clipping attached hereto was published once a week in the regular and entire issue of said paper, and not in a supplement thereof for a period

of \_\_\_\_\_

One weeks.

Beginning with the issue dated

November 9, 19 84

and ending with the issue dated

November 9, 19 84

Robert L. Summers  
Publisher.

Sworn and subscribed to before

me this 12 day of

November, 1984  
Jane Paulowsky  
Notary Public.

My Commission expires \_\_\_\_\_

3-24, 1987

(Seal)

This newspaper is duly qualified to publish legal notices or advertisements within the meaning of Section 3, Chapter 167, Laws of 1937, and payment of fees for said publication has been made.

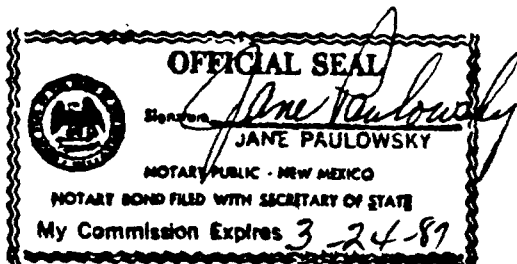

**LEGAL NOTICE**  
November 9, 1984  
Publication of Application  
For Water Disposal Well.  
T.B. Garber c/o Jubilee  
Energy Corporation Applicant,  
4000 N. Big Spring, Suite 109,  
Midland, Texas 79705.  
Water Disposal Well - Ex-  
posed "A" No. 2, 1980' FWL and  
1980' FSL, Sec. 27, T-24-S,  
R-32-E, Lea County, New Mex-  
ico.  
Formation: Delaware Sand at  
4854' to 4872'. Inject approxi-  
mately 200 bbls. water per day  
at 50 PSI.  
A notation that interested  
parties must file objections or  
requests for hearing with the  
Oil Conservation Division P.O.  
Box 2088, Santa Fe, New Mex-  
ico 87501, within 15 days.  
T.B. GARBER,  
President