

P. O. BOX 4289
FARMINGTON, NEW MEXICO 87499-4289
PHONE: 505-325-2841

December 13, 1984

Mr. Richard Stamets
New Mexico Oil Conservation Division
Post Office Box 2088
Santa Fe, New Mexico 87501

Case 8466

Dear Mr. Stamets:

This is a request for administrative approval for an unorthodox gas well location in the Blanco Mesa Verde Pool.

It is intended to locate the El Paso Natural Gas Company's Allison Unit #26A at 1180' from the North line and 2440' from the East line of Section 9, T-32-N, R-7-W, San Juan County, New Mexico.

Extremely rough terrain in the form of steep cliffs in the Northeast corner of this section makes it impossible to build an orthodox gas well location.

A copy of this application is being submitted to all offset operators by certified mail with a request that they furnish your Santa Fe office with a Waiver of Objection, and return one copy to this office.

Plats showing the proposed well location and the lake in Section 9, along with an ownership plat, are attached.

Sincerely yours,

G. W. Brink
Project Drilling Engineer

encl.

WAIVER

Northwest Pipeline Company hereby waives objection to El Paso Exploration Company's application for an unorthodox location for their Allison Unit #26A as proposed above.

By: _____

Date: _____

WELL LOCATION AND ACREAGE DEDICATION PLAT

Case 84-120
Effective 1-1-85

All distances must be from the outer boundaries of the Section.

Operator EL PASO NATURAL GAS COMPANY		Lease ALLISON UNIT (SF 081155)		Well No. 26A
Unit Letter J	Section 9	Township 32N	Range 7W	County San Juan
Actual Footage Location of Wells: 1180 feet from the North line and 2440 feet from the East line				
Ground Level Elev: 6698	Producing Formation Mesa Verde	Pool Blanco	Dedicated Acreage: 411.44 Acres	

1. Outline the acreage dedicated to the subject well by colored pencil or hachure marks on the plat below.
2. If more than one lease is dedicated to the well, outline each and identify the ownership thereof (both as to working interest and royalty).
3. If more than one lease of different ownership is dedicated to the well, have the interests of all owners been consolidated by communitization, unitization, force-pooling, etc?

☒ Yes ☐ No If answer is "yes," type of consolidation Unitization

If answer is "no," list the owners and tract descriptions which have actually been consolidated. (Use reverse side of this form if necessary.)

No allowable will be assigned to the well until all interests have been consolidated (by communitization, unitization, forced-pooling, or otherwise) or until a non-standard unit, eliminating such interests, has been approved by the Commission.

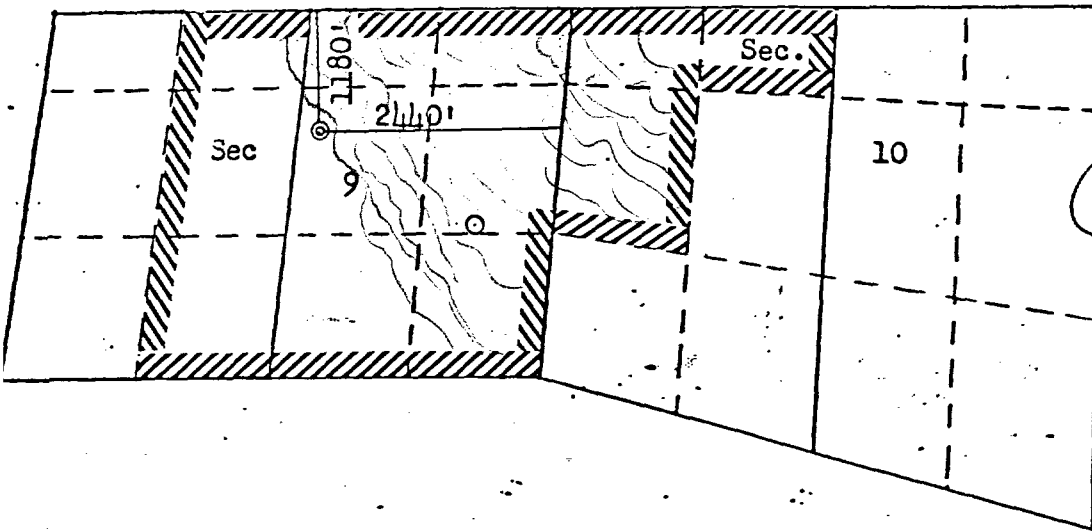

CERTIFICATION

I hereby certify that the information contained herein is true and complete to the best of my knowledge and belief.

Name

Drilling Clerk

Position

El Paso Natural Gas

Company

November 29, 1984

Date

I hereby certify that the well location shown on this plat was plotted from field notes of actual surveys made by me or under my supervision; and that the same is true and correct to the best of my knowledge and belief.

Date Surveyed

November 5, 1984

Registered Professional Engineer and Land Surveyor

Fred B. Kerr Jr.

Certificate No.

Scale: 1"=2000'

WELL LOCATION AND ACREAGE DEDICATION PLAT

Supersede 1-1-60
Effective 1-1-65

All distances must be from the outer boundaries of the Section.

Operator EL PASO NATURAL GAS COMPANY			Lease ALLISON UNIT (SF 081155)		Well No. 26A
Unit Letter J	Section 9	Township 32N	Range 7W	County San Juan	

Actual Footage Location of Wells:
1180 feet from the **North** line and **2440** feet from the **East** line
 Ground Level Elev: **6698** Producing Formation **Mesa Verde** Pool **Blanco** Dedicated Acreage: **411.44** Acres

1. Outline the acreage dedicated to the subject well by colored pencil or hachure marks on the plat below.
2. If more than one lease is dedicated to the well, outline each and identify the ownership thereof (both as to working interest and royalty).
3. If more than one lease of different ownership is dedicated to the well, have the interests of all owners been consolidated by communitization, unitization, force-pooling, etc?

☒ Yes ☐ No If answer is "yes," type of consolidation Unitization

If answer is "no," list the owners and tract descriptions which have actually been consolidated. (Use reverse side of this form if necessary.)

No allowable will be assigned to the well until all interests have been consolidated (by communitization, unitization, forced-pooling, or otherwise) or until a non-standard unit, eliminating such interests, has been approved by the Commission.

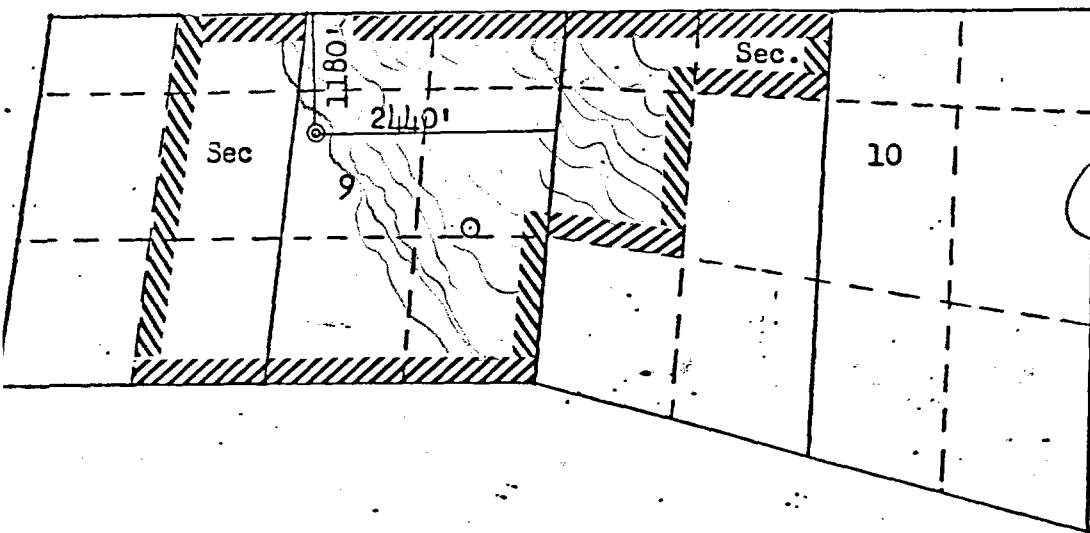

CERTIFICATION

I hereby certify that the information contained herein is true and complete to the best of my knowledge and belief.

Regan Bradford
Name

Drilling Clerk

Position

El Paso Natural Gas

Company

November 29, 1984

Date

I hereby certify that the well location shown on this plat was plotted from field notes of actual surveys made by me or under my supervision; and that the same is true and correct to the best of my knowledge and belief.

Date Surveyed

November 5, 1984

Registered Professional Engineer
and Land Surveyor

Fred B. Kerr Jr.
Fred B. Kerr Jr.

Certificate No.

Scale: 1"=2000'

EL PASO NATURAL GAS COMPANY

Well Name Allison Unit #26 A, Blanco Mesaverde

Footage----- 1180' FNL, 2440' FEL

APPLICATION FOR NON-STANDARD LOCATION

County San Juan State New Mexico Section 9 Township 32N Range 7W

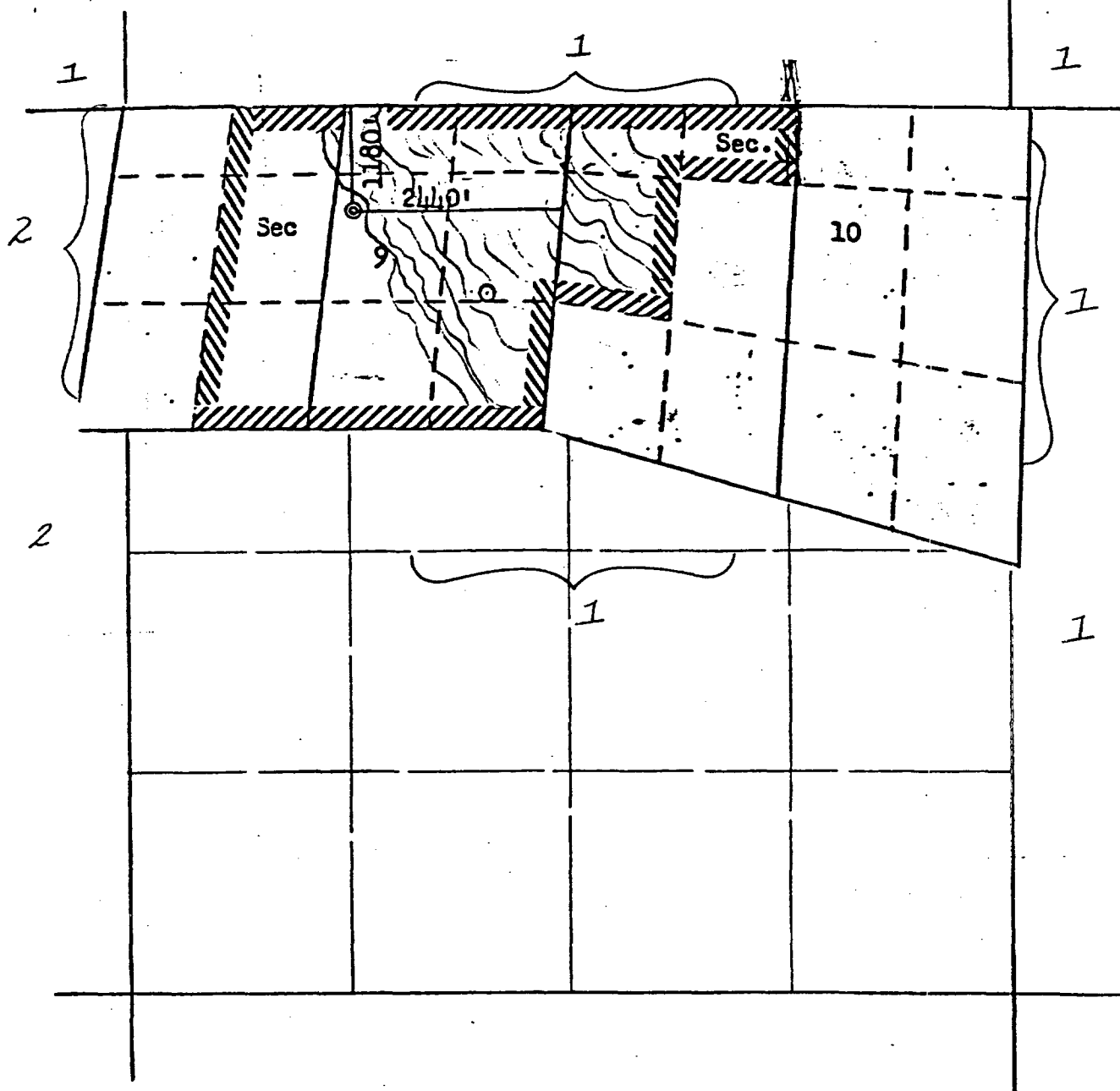

REMARKS:

- (1) El Paso Natural Gas Company-Operator
- (2) Northwest Pipeline Corporation-Operator

EL PASO NATURAL GAS COMPANY

Well Name Allison Unit #26 A, Blanco Mesaverde

Footage---- 1180' FNL, 2440' FEL

APPLICATION FOR NON-STANDARD LOCATION

County San Juan State New Mexico Section 9 Township 32N Range 7W

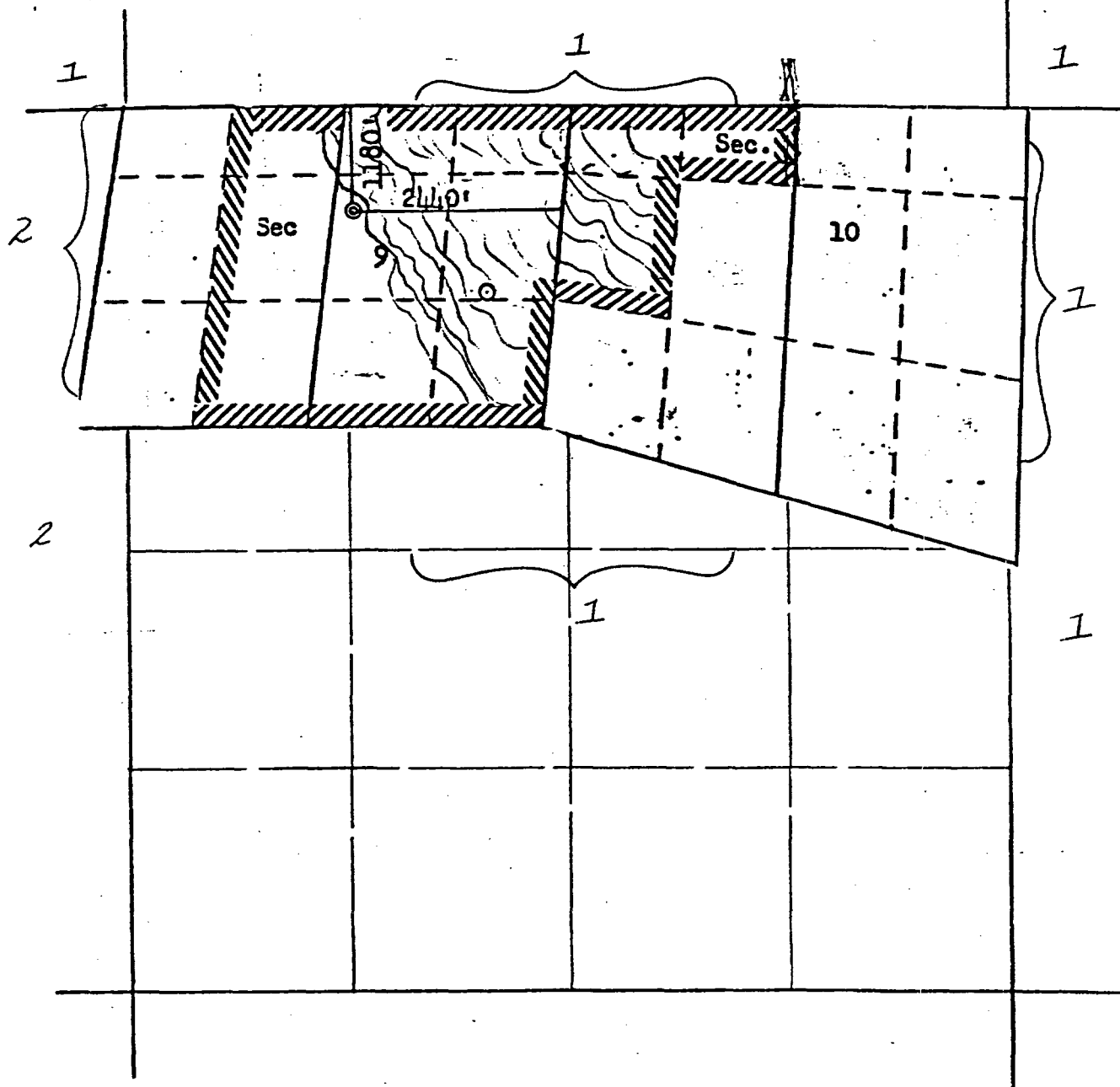

REMARKS:

- (1) El Paso Natural Gas Company-Operator
- (2) Northwest Pipeline Corporation-Operator