

Jason Kellahin
W. Thomas Kellahin
Karen Aubrey

KELLAHIN and KELLAHIN
Attorneys at Law
El Patio - 117 North Guadalupe
Post Office Box 2265
Santa Fe, New Mexico 87504-2265

Telephone 982-4285
Area Code 505

May 27, 1986

RECEIVED

MAY 28 1986

OIL CONSERVATION DIVISION

Mr. Michael E. Stogner
Oil Conservation Division
P. O. Box 2088
Santa Fe, New Mexico 87501

"Hand Delivered"

Re: Lewis Burleson, Inc.
Case 8924

Case 8924

Dear Mr. Stogner:

In accordance with our telephone conversation today, please consider this letter our application on behalf of Mr. Burleson and Lewis B. Burleson, Inc. for an unorthodox well location and a non-standard proration and spacing unit for the Mobil #1 well to be located 1980' FNL and 2180' FWL on Section 22, T25S, R37E, NMPM, Jalmat Gas Pool, Lea County, New Mexico.

The non-standard proration and spacing unit consists of 150 acres and is described as follows:

- (b) T25S, R37E, (150 acres)
 - Section 22: E/2NW/4 (80 acres)
 - NW/4NE/4 (40 acres)
 - W/2NE/4NE/4 (20 acres)
 - W/2E/2NE/4NE/4 (10 acres)

This matter is being set for the New Mexico Oil Conservation Commission hearing scheduled for June 19, 1986. By copy of this letter, we are sending notice by certified mail, return receipt, to all offsetting operators. Any such operator has the right to appear and present evidence at this hearing, if they desire. You may contact the Commission, consult the Division rules and regulations or contact the undersigned for more information.

Very truly yours,

W. Thomas Kellahin

WTK:ca

KELLAHIN and KELLAHIN

Mr. Michael E. Stogner
May 27, 1986
Page 2

cc: Lewis Burleson
P. O. Box 2479
Midland, Texas 79702

William F. Carr, Esq.
P. O. Box 2208
Santa Fe, New Mexico 87504

(Certified Return-Receipt Requested)
All addresses below:

Doyle Hartman
P. O. Box 10426
Midland, Texas 79702

Mobile Producing Texas & New Mexico, Inc.
Attn: G. E. Tate
P. O. Box 633
Midland, Texas 79702

El Paso Natural Gas
Attn: Babe Kendrick
P. O. Box 1492
El Paso, Texas 79999

Chevron, U.S.A.
Attn: Mark Costello
P. O. Box 1660
Midland, Texas 79702

Cities Service Oil & Gas Corp.
Attn: E. F. Motter
P. O. Box 1919
Midland, Texas 79702

Stamets

KELLAHIN and KELLAHIN
Attorneys at Law

Jason Kellahin
W. Thomas Kellahin
Karen Aubrey

El Patio - 117 North Guadalupe
Post Office Box 2265
Santa Fe, New Mexico 87504-2265

Telephone 982-4235
Area Code 505

*Flonene
Commission hearing
May*

March 24, 1986

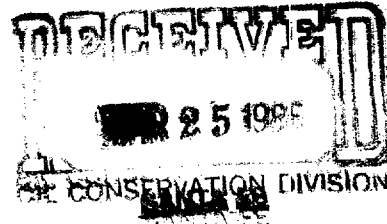

Mr. Richard L. Stamets
Oil Conservation Division
P. O. Box 2088
Santa Fe, New Mexico 87504

Re: Lewis B. Burleson, Inc.
Administrative Application
Non-Standard Proration Unit
Unorthodox Well Location
Mobil No. 1
1980 ' FNL and 2180' FWL
Section 22, T25S, R37E
Lea County, New Mexico

Case 8924

Dear Mr. Stamets:

Our firm represents Mr. Burleson who filed the referenced administrative application with the Division by letter dated February 28, 1986. By letter dated March 10, 1986, Doyle Hartman filed his objection and requested that Mr. Burleson's case be set on the Commission docket of April 9, 1986.

Mr. Burleson requests that his case be set for hearing on the May, 1986, Commission docket and not on the April docket. In addition, I already have pending on that docket numerous cases and I am unable to prepare Mr. Burleson's case in time for that docket.

Very truly yours,

W. Thomas Kellahin
W. Thomas Kellahin

WTK:ca

cc: Lewis B. Burleson
P. O. Box 2479
Midland, Texas 79702

Mr. William F. Carr
Campbell & Black, P. A.
P. O. Box 2208
Santa Fe, New Mexico

DOYLE HARTMAN

Oil Operator

500 N. MAIN

P.O. BOX 10426

MIDLAND, TEXAS 79702

(915) 684-4011

March 10, 1986

Lewis B. Burleson, Inc.
Post Office Box 2479
Midland, Texas 79702

Case 8924

Attention: Mr. Steven L. Burleson

Re: Mobil No. 1
E/2 NW/4 and N/2 NE/4
Less East 10 acres
NE/4 NE/4
Section 22, T-25-S, R-37-E
Lea County, New Mexico

Gentlemen:

Reference is made to your administrative application dated February 28, 1986 requesting approval for the above described non-standard proration to be dedicated to your proposed Mobil No. 1 to be located at a non-standard location consisting of 1980' FNL and 2180' FWL Section 22.

We are in opposition to your application as it is currently filed and by copy of this letter are requesting the Commission to schedule a hearing to review your request on the same docket as the de novo hearing for our Carlson-Harrison Federal Com. Lease.

Very truly yours,

DOYLE HARTMAN

Michelle Hembree
Michelle Hembree
Administrative Assistant

MH/lr

cc Mr. R. L. Stamets
New Mexico Oil Conservation Division
Post Office Box 2088
Santa Fe, New Mexico 87501

Mr. William F. Carr
Campbell & Black, P. A.
Post Office Box 2208
Santa Fe, New Mexico 87501

Lewis B. Burleson, Inc.

March 10, 1986

Page 2

Mr. Daniel S. Nutter
105 E. Alicante
Santa Fe, New Mexico 87501

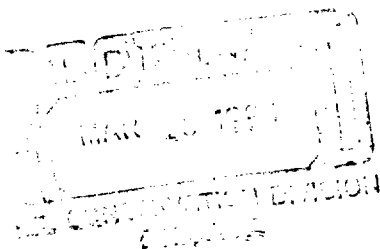

DOYLE HARTMAN

Oil Operator

500 N. MAIN

P.O. BOX 10426

MIDLAND, TEXAS 79702

(915) 684-4011

March 10, 1986

Lewis B. Burleson, Inc.
Post Office Box 2479
Midland, Texas 79702

Attention: Mr. Steven L. Burleson

Re: Mobil No. 1
E/2 NW/4 and N/2 NE/4
Less East 10 acres
NE/4 NE/4
Section 22, T-25-S, R-37-E
Lea County, New Mexico

Gentlemen:

Reference is made to your administrative application dated February 28, 1986 requesting approval for the above described non-standard proration to be dedicated to your proposed Mobil No. 1 to be located at a non-standard location consisting of 1980' FNL and 2180' FWL Section 22.

We are in opposition to your application as it is currently filed and by copy of this letter are requesting the Commission to schedule a hearing to review your request on the same docket as the de novo hearing for our Carlson-Harrison Federal Com. Lease.

Very truly yours,

DOYLE HARTMAN

Michelle Hembree
Michelle Hembree
Administrative Assistant

MH/lr

cc Mr. R. L. Stamets
New Mexico Oil Conservation Division
Post Office Box 2088
Santa Fe, New Mexico 87501

Mr. William F. Carr
Campbell & Black, P. A.
Post Office Box 2208
Santa Fe, New Mexico 87501

Lewis B. Burleson, Inc.
March 10, 1986
Page 2

Mr. Daniel S. Nutter
105 E. Alicante
Santa Fe, New Mexico 87501

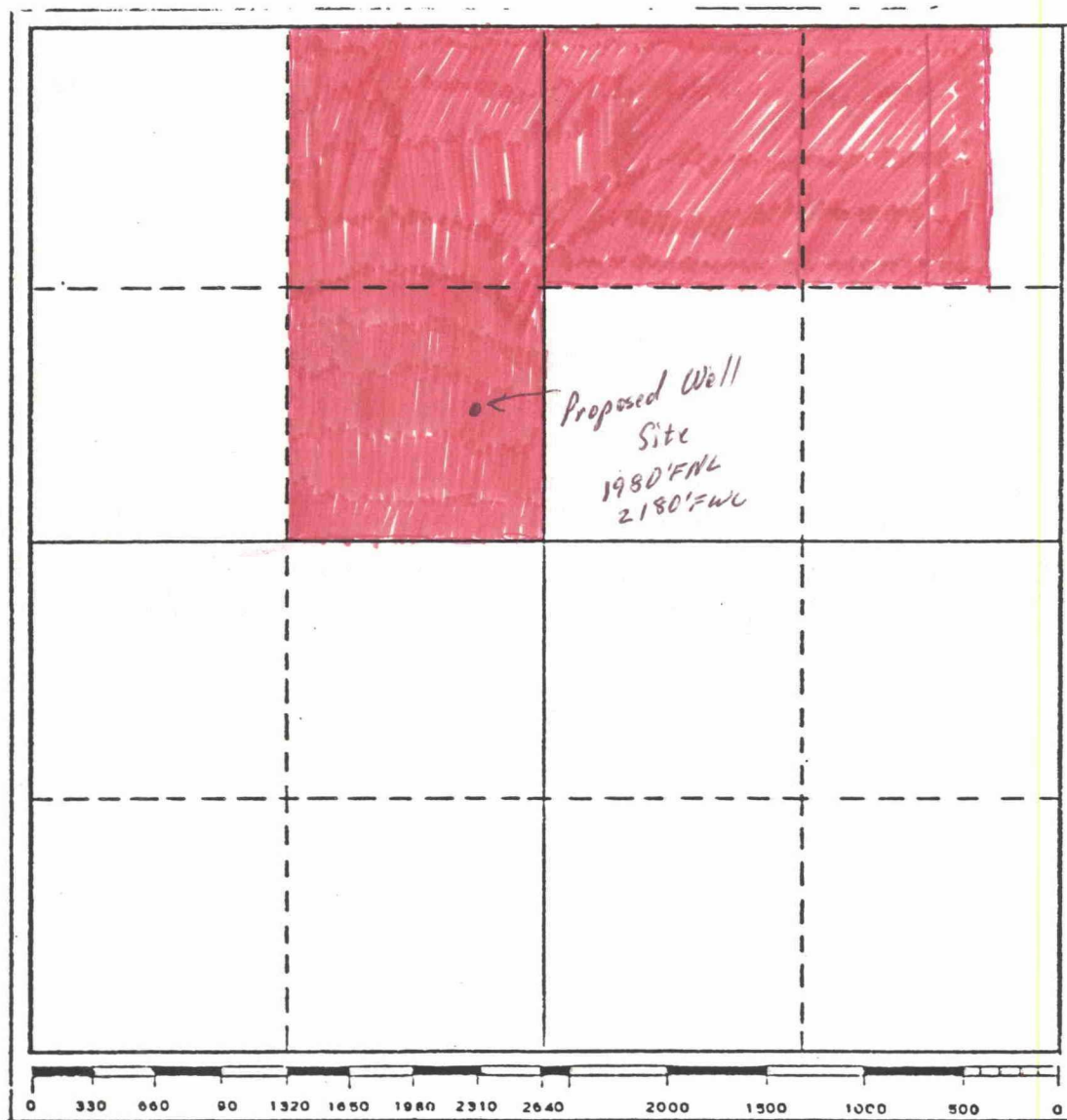

Section 22, Township 25 South, Range 37 East, NM PM,
Lea County, New Mexico, Galmat Pool