

State 1-2 Well No. 1
1980' FNL & 660' FWL of Section 2, T-19-S, R-32-E
Lea County, New Mexico

Detailed History of Bone Springs Recompletion

- 11/13/86 - Phillips files Notice of Intention to plug back from Wolfcamp to Bone Springs.
- 11/17/86 - N.M.O.C.D. informs Phillips that subject well will be placed in East Lusk Bone Springs Pool which has 160 acre spacing; Phillips is requested to file for 160 acre proration unit.
- 11/26/86 - Phillips files for nonstandard 120 acre proration unit, requesting administrative approval if no objections are raised.
- 12/23/86 - On behalf of offset lease holder Sol West III, Los Siete Exploration and Murphy Operating Corporation file an objection to the proposed 120 acre nonstandard proration unit. In their objection, 40 acre spacing is suggested as an alternative.
- 1/5/87 - Phillips withdraws request for nonstandard 120 acre proration unit and refiles application to plug back for Undesignated Bone Springs, 40 acre spacing.
- 1/13/87 - Undesignated Bone Springs plug back application is approved by N.M.O.C.D. Hearing on nonstandard proration unit is dismissed.
- 4/7/87 - Phillips recompletes well in the Bone Springs. Initial potential (pumping) is 3 BOPD, 34 BWPD, GOR 2666.
- 4/16/87 - Notice of Recompletion and Request for Allowable are filed for Undesignated Bone Springs, 40 acre spacing.
- 4/27/87 - N.M.O.C.D. rejects 40 acre spacing request because nearest 40 acre Bone Springs pool (Upper Querecho Plains Bone Springs) has depth limitations which do not include entire perforated interval in the State 1-2 No. 1. Phillips is requested to re-file application to be placed in East Lusk Bone Springs Pool, 160 acre spacing.
- 5/11/87 - Phillips files for nonstandard 120 acre proration unit in East Lusk Bone Springs pool. Application is protested and set for Examiner Hearing on 6/3/87. Case is continued to hearing on 6/17/87, then to hearing on 7/15/87 at Phillips' request.
- 7/1/87 - Hole in tubing in State 1-2 No. 1 is repaired. Average well production for week of 7/5 - 7/10 is 11 BOPD, 150 BWPD, GOR 1727.

NEW MEXICO
STATE LAND OFFICE

LEASE LG 888

LEASE VB0032

SECTION 2

TOWNSHIP 19 NORTH
RANGE 32 EAST
LEA COUNTY, N.M.

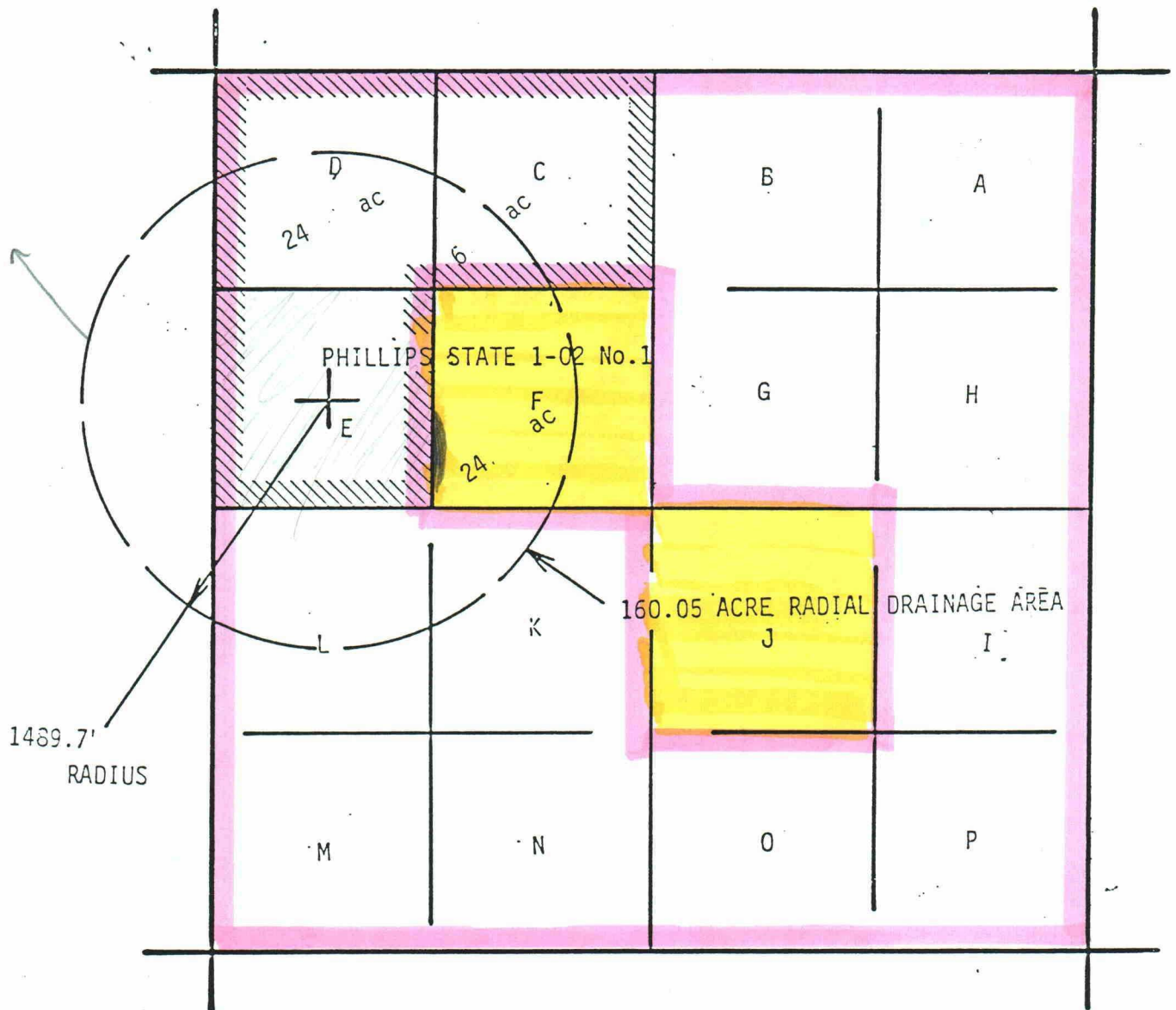

LEASE LG 888

10 yr x 1/8 PHILLIPS

LEASE VB 32

5 yr x 3/16 SOL WEST III



REQUESTED PRORATION UNIT (120 ACRES)

OIL CONSERVATION DIVISION

CASE 9147

EXHIBIT

SLO
1