

W.R. HUMPHRIES
COMMISSIONER

Commissioner of Public Lands

September 26, 1988

P.O. BOX 1148
SANTA FE, NEW MEXICO 87504-1148

Oil Reports and Gas Services, Inc.
Attn: Ms. Donna Holler
P. O. Box 755
Hobbs, New Mexico 88241

Re: Change in Unit Operator
West Cap Queen Sand Unit
Chaves County, New Mexico

Gentlemen:

This office is in receipt of your letter of September 20, 1988, together with a revised Exhibit "B" and a Change in Unit Operator by Assignment, wherein General Operating Co., Inc. has designated Circle Ridge Production, Inc. as unit operator of the West Cap Queen Sand Unit Area.

The Commissioner of Public Lands has this date approved Circle Ridge Production, Inc. as the new unit operator of the West Cap Queen Sand Unit Area.

If we may be of further help please do not hesitate to call on us.

Very truly yours,

W. R. HUMPHRIES
COMMISSIONER OF PUBLIC LANDS

BY: *Floyd O. Prado*
FLOYD O. PRANDO, Director
Oil and Gas Division
(505) 827-5744

WRH/FOP/pm
encls.
cc: OCD
BLM

State of New Mexico

#2719

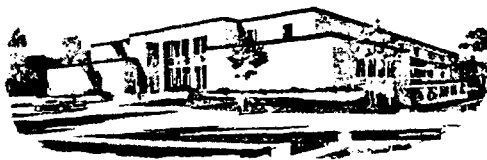

W.R. HUMPHRIES
COMMISSIONER

Commissioner of Public Lands

SLO REF NO OG-813
P.O. BOX 1148
SANTA FE, NEW MEXICO 87504-1148

June 6, 1988

Citation Oil and Gas Corp.
Attn: Mr. Tommy Deiss
16800 Greenspoint Pk. Dr
Houston, Tx. 77060-2304

Re: 1988 Plan of Development
Antelope Ridge Unit
Lea County, New Mexico

Gentlemen:

The Commissioner of Public Lands has this date approved your 1988 Plan of Development for the above captioned unit area.

Our approval is subject to like approval by all other appropriate agencies.

Enclosed is an approved copy for your files.

If we may be of further help please do not hesitate to call on us.

Very truly yours,

W. R. HUMPHRIES
COMMISSIONER OF PUBLIC LANDS

BY:

Floyd O. Prando
FLOYD O. PRANDO, Director
Oil and Gas Division
(505) 827-5744

WRH/FOP/pm
encls.
cc: OCD
BLM



United States Department of the Interior

GEOLOGICAL SURVEY
Conservation Division
P. O. Box 26124
Albuquerque, New Mexico 87125

APR 28 1977

General Operating Company
Attention: Mr. C. W. Stumhoffer
Suite 1007, Ridglen Bank Building
Fort Worth, Texas 76116

Gentlemen:

Seven copies of an instrument dated December 1, 1976, by which Chaves Oil Ltd. resigns as unit operator and General Operating Company is designated as successor unit operator for the West Cap Queen Sand unit agreement, Chaves County, New Mexico, No. 14-08-0001-8486, were filed with this office on April 20, 1977. The instrument is executed by Chaves Oil Ltd. as the present unit operator and working interest owner and by General Operating Company as successor unit operator.

The selection of General Operating Company as successor unit operator has been approved on this date, effective as of April 1, 1977, subject to like approval by the appropriate officials of the State of New Mexico. Copies of the approved instrument have been distributed to the Federal agencies concerned and three copies are returned herewith.

Sincerely yours,

(ORIGINAL OF INSTRUMENT)

Area Oil and Gas Supervisor

cc: BLM, Santa Fe (w/cy instr.)
Comm. Pub. Lands, Santa Fe (ltr. only)
NMOCC, Santa Fe (ltr. only) Copy for

MAIN OFFICE 900

1963 FEB 6 PM 1:37 Drawer 1857
Roswell, New Mexico

February 4, 1963

Phillips Petroleum Company
Bartlesville, Oklahoma

Attention: Mr. Shofner Smith

Gentlemen:

Your initial plan of operation and development, dated December 18, 1962, for the West Cap Queen Sand unit area, Chaves County, New Mexico, proposing the conversion of 16 wells to water injection status and the drilling of one injection well has been approved on this date subject to like approval by the appropriate State officials.

One approved copy of the plan is enclosed.

Very truly yours,

JOHN A. ANDERSON
Regional Oil and Gas Supervisor

Copy to: Washington (ltr. only)
Artesia (w/cy of plan)
NMOCC - Santa Fe (ltr. only)
Comm. of Pub. Lands - Santa Fe (ltr. only)

NOTEGRAM - TELEGRAM

IF TELEGRAM

FR	DL	NL	CHARGE
----	----	----	--------

Date 12-13-62

To Mr. A. L. Porter, Jr. Dept. _____ Address OCC, Santa Fe, New Mexico

From Phillips Petr. Co. Dept. _____ Address 3rd Floor Permian Bldg., Midland, Texas

In re: West Cap Queen Sant Unit Captrock Queen Pool, Chaves County, New Mexico

This is the attachment that should have been attached to our letter to you
under the above subject, dated December 12, 1962.



FIGURE _ _ _ _ _ 1



PHILLIPS PETROLEUM COMPANY
BARTLESVILLE, OKLAHOMA
EXPLORATION AND PRODUCTION DEPARTMENT

MAIN OFFICE OCC
1963 FEB 11 AM 8:37

February 7, 1963

Oil Conservation Commission
of the State of New Mexico
Santa Fe, New Mexico

West Cap Queen Sand Unit
Case No. 2642
Order No. R-2332

Gentlemen:

In accordance with the subject order, Phillips Petroleum Company herewith files the following enclosed material:

One copy of the West Cap Queen Sand Unit Agreement and Operating Agreement with signature pages, ratifications, revised Exhibits A and B for the Unit Agreement and revised Exhibit F for the Unit Operating Agreement.

One copy of U.S. Department of the Interior Geological Survey approval.

One copy of New Mexico Commissioner of Public Lands approval.

One copy of the Recording Data for the Agreements.

Very truly yours,

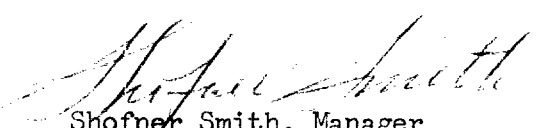
Shofner Smith, Manager
Reservoir Engineering
and Unitization

RMA:LMW
Enclosures

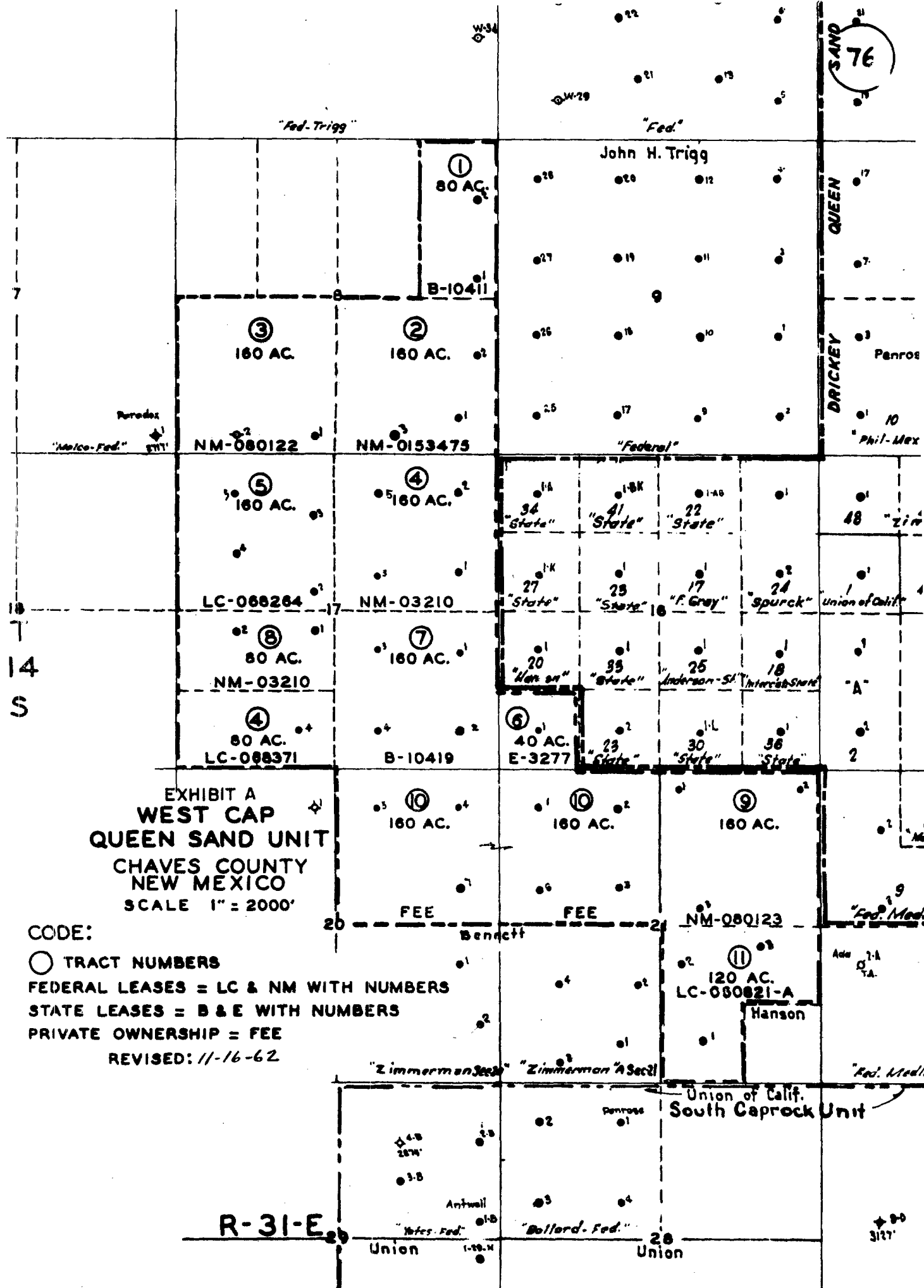

EXHIBIT "F"
Summary of Working Interest Ownership
By Individuals and Companies

	Tract No.	Per Cent Working Interest	Tract Per Cent Participation		Owners Per Cent Participation in Unit	
			Primary	Secondary	Primary	Secondary
Premier Title & Mortgage Co., Trustee	5	4.340	4.80094	7.48082	0.20836	0.32467
John B. Rich	11	1.458	18.01177	10.17646	0.26261	0.14837
R. S. Rogers	8	5.000	4.75124	3.92120	0.23757	0.19607
Wm. G. Ross	8	12.500	4.75124	3.92120	0.59391	0.49015
Sinclair Oil & Gas Company	2	100.000	8.84308	10.13479	8.84308	10.13479
Schlo Petroleum Company	11	58.334	18.01177	10.17646	10.50699	5.93634
Tidewater Oil Company	7	100.000	7.49948	11.52992	7.49948	11.52992
L. C. White	8	5.000	4.75124	3.92120	0.23757	0.19607
Chas. H. Wood	8	12.500	4.75124	3.92120	0.59391	0.49015
TOTAL					100.00000	100.00000

EXHIBIT "F"

Revised 11-20-62

TO UNIT OPERATING AGREEMENT WEST CAP QUEEN SAND UNIT SUMMARY OF WORKING INTEREST OWNERSHIP BY INDIVIDUALS AND COMPANIES

	Tract No.	Per Cent Working Interest	Tract Per Cent Participation		Owners Per Cent Participation in Unit	
			Primary	Secondary	Primary	Secondary
K. S. Adams, Jr.	9	100.000	13.73974	10.81548	13.73974	10.81548
Richard S. Anderson, Inc.	11	12.500	18.01177	10.17646	2.25147	1.27206
Brosco Corporation	1	100.000	2.70741	3.87720	2.70741	3.87720
Brosco Corporation	11	27.708	18.01177	10.17646	4.99070	2.81969
Brosco Corporation Total					7.69811	6.69689
A. D. Frese	5	10.532	4.80094	7.48082	0.50564	0.78788
Gulf Oil Corporation	3	100.000	1.08712	1.95364	1.08712	1.95364
Gulf Oil Corporation	10	100.000	17.49573	16.11007	17.49573	16.11007
Gulf Oil Corporation Total					18.58285	18.06371
Gordon E. Herkenhoff	8	10.000	4.75124	3.92120	0.47512	0.39212
T. F. Hodge	5	35.185	4.80094	7.48082	1.68921	2.63213
A. C. Holder	8	12.500	4.75124	3.92120	0.59391	0.49015
O. J. Holder	8	5.000	4.75124	3.92120	0.23757	0.19607
Tom H. Hood	8	10.000	4.75124	3.92120	0.47512	0.39213
Paul N. Layman, Sr.	5	3.472	4.80094	7.48082	0.16669	0.25973
R. Lounsbery	5	17.361	4.80094	7.48082	0.83349	1.29875
J. R. & R. L. McLaughlin	8	7.500	4.75124	3.92120	0.35634	0.29410
W. L. Maguire	5	4.340	4.80094	7.48082	0.20836	0.32467
W. N. Maguire	5	8.681	4.80094	7.48082	0.41677	0.64941
H. D. Mercer	5	8.681	4.80094	7.48082	0.41677	0.64941
John D. Meschuk, M.D.	8	10.000	4.75124	3.92120	0.47512	0.39212
D. D. Patteson	8	5.000	4.75124	3.92120	0.23757	0.19607
E. D. Pearce	8	5.000	4.75124	3.92120	0.23757	0.19607
Pecos Land & Development Co., Inc.	5	7.407	4.80094	7.48082	0.35561	0.55410
Phillips Petroleum Company	4	100.000	17.10224	19.18434	17.10224	19.18434
Phillips Petroleum Company	4	100.000	3.96125	4.81608	3.96125	4.81608
Phillips Petroleum Company Total	6	100.000	3.96125	4.81608	21.06349	24.00042

Tract No.	Description of Land	No. of Acres	No. of Wells	Lease and/or Assignment Number	Basic Royalty	Lessee of Record	Overriding Royalty Owners and Amount	Working Interest Owners and Amount	Percent of Participation		Remaining Primary as of 12-1-60, Barrels
									Primary	Secondary	
7	FEDERAL TRACTS	1,080	21								
1	E/2 NE/4 Sec. 8-T.14S, R.31E, Chaves County, New Mexico	80	2	B-10411 Assigned #20 7-2-43	12 1/2% State of New Mexico	W. E. Lee, et ux	First National Bank, Reno, Nev., & Clarence E. Hinkle Co-Trustees U/M of Allie M. Lee, Dec'd, Richard S. Anderson, Inc. Broseco Corporation John B. Rich Soho Petroleum Co.	100.000%	2.70741	3.87720	3,813
6	SW/4 SW/4 Sec. 16-T.14S-R.31E, Chaves County, New Mexico	40	1	E-3277 2-10-50	12 1/2% State of New Mexico	Phillips Petroleum Co.	None	100.000%	3.96125	4.81608	6,132
7	SE/4 Sec. 17-T.14S-R.31E, Chaves County, New Mexico	160	4	B-10419 7-6-43	12 1/2% State of New Mexico	Tidewater Oil Company	Thorolf-Silvertsen	100.000%	7.43948	11.52992	18,428
3	STATE TRACTS	280	7								
10	NE/4 Sec. 20 & NW/4 Sec. 21-T.14S-R.31E, Chaves County, New Mexico	320	7	Fee Lease 3-6-46	12 1/2% Private Owners*	Gulf Oil Corporation	None	100.000%	17.43973	16.11007	42,710
				*Mabel Alston Ruth Zimmerman Wm. P. Zimmerman Hazel Z. Hart Total	2.500% 5.000 2.500 2.500 12.500%						
1	FEES LEASE	320	7								
	UNIT TOTAL	1,680	35						100.00000%	100.00000%	223,582

Leasehold Information and Working Interest Participations

Tract No.	Description of Land	No. of Acres	No. of Wells	Lease and/or Assignment Number	Basic Royalty	Lessee of Record	Overriding Royalty Owners and Amount	Working Interest Owners and Amount	Percent of Participation in Unit	Remaining Primary as of 12-1-60, Barrels		
2	SE 1/4 Sec. 8-T.14S-R.31E, Chaves County, New Mexico	160	3	NM-0153475 1-1-50 HBP	12 1/2% USA	Sinclair Oil & Gas Company	None	Sinclair Oil & Gas Company	100%	23,102		
3	SW 1/4 Sec. 8-T.14S-R.31E, Chaves County, New Mexico	160	1	NM-080122 7-1-48 HBP	12 1/2% USA	Gulf Oil Corp.	Vergil O. Hopp Olen F. Featherstone Rudie C. Bell Eliz. W. Crosby 1.66667 0.8333 0.8333 5.0000	Gulf Oil Corporation	100%	1,380		
4	NE 1/4 and S/2 SW 1/4 Sec. 17-T.14S-R.31E, Chaves, New Mexico	240	5	NM-03210 8-1-49 HBP	12 1/2% USA	Lips Petroleum Co.	Ade M. Mills J. R. Miller E. H. Peterson 0.9000 1.7500 1.0000 3.2500	Phillips Petroleum Company	100%	42,002		
5	NW 1/4 Sec. 17-T.14S-R.31E, Chaves County, New Mexico	160	4	LC-068264 6-1-49 5-31-59 Extended	12 1/2% USA	Hondo Oil & Gas Co.	T. F. Hodge Hondo Oil & Gas Co. J. R. & G. A. Miller 11.06671 14.66667 2.00000 27.73438	T. F. Hodge A. D. Freese Paul N. Layman, Sr. R. Lounsbury W. L. Maguire Walter N. Maguire Henry D. Mercer Premier Title & Mortgage Co., Trustee Pecos Land & Dev. Co., Inc. 4.3403047 7.4074025 100.0000000	35.1851783 10.532432 3.4722304 17.3611852 4.3400705 8.6805926 8.6805926	4,80094	7,48082	6,754
8	N/2 SW 1/4 Sec. 17-T.14S-R.31E, Chaves Co., New Mexico	80	2	NM-03210 8-1-49 HBP	12 1/2% USA	Phillips Petroleum Co.	J. R. Miller Ada M. Mills E. H. Peterson Phillips Petroleum Co. 1.75000 0.50000 1.00000 5.46875 8.71875	A. C. Holder G. E. Harkenhoff O. J. Holder Tom H. Hood J. R. & R. L. McLaughlin Dr. John D. Meschuk D. D. Patterson E. D. Pearce R. S. Rogers Wm. G. Ross L. C. White Chas. H. Wood 12.500 10.000 5.000 5.000 5.000 12.500 5.000 12.500 100.000	4,75124	3,92120	8,218	
9	NE 1/4 Sec. 21-T.14S-R.31E, Chaves County, New Mexico	160	3	NM-080123 5-1-47 HBP	12 1/2% USA	Ed Shockley	Ed & Ruth Shockley Olen F. Featherstone Ada M. Mills E. H. Peterson Eliz. W. Crosby Rudie C. Bell 0.300 1.350 0.500 1.000 0.675 0.675 4.500	K. S. Adams, Jr.	100%	29,273		
11	W/2 SE 1/4 and NE 1/4 SE 1/4 of Sec. 21-T.14S-R.31E, Chaves County, New Mexico	120	3	LC-060821A 11-1-47 HBP	12 1/2% USA	Brosseau Corporation John B. Rich Neyville G. Petrrose, Inc.	Olen F. Featherstone Rudie C. Bell Eliz. W. Chaney Frank A. Sauer 1.350 0.675 0.675 0.300 3.000	Richard S. Anderson, In Brosseau Corporation John B. Rich Sohio Petroleum Company 12.500 27.708 1.458 58.334 100.000	18.01177	10.17646	42,770	

WEST GAP QUEEN SAND UNIT
Chaves County, New Mexico

Approved by State Land Commission of N.M.;
Order #R-2336 - Dated: October 18, 1962

RECORDING DATA FOR WORKING INTEREST AND ROYALTY
AS TO UNIT AND UNIT OPERATING AGREEMENT

Type of Agreement Executed
1 - Original Unit and
Operating Agreement
2 - Ratification Instrument

Working Interest or Royalty Owner	Type of Interest	Date Executed	Type of Agreement	Officer of Company and Title or Individual Owner	Recorded in Chaves Co., N. M.	Page	Date
Phillips Petroleum Company	W.I.	6-18-62	1	L. E. Fitzjarrald, Vice President	83	324-331	10-25-62
K. S. Adams, Jr.	W.I.	7-9-62	1	Self	83	324-333	10-25-62
Gulf Oil Corporation	W.I.	7-19-62	1	W. A. Shellhearer, Attorney in Fact	83	325-332	10-25-62
T. F. Hodge	W.I.	7-16-62	1	Self	83	325-333	10-25-62
Sinclair Oil & Gas Company	W.I.	7-17-62	1	R. L. Elston, Vice President	83	329-331	10-25-62
Brosco Corporation	W.I.	6-21-62	2	John B. Rich, Exec. Vice President	83	253-254	10-25-62
A. D. Freese	W.I.	7-18-62	2	Self	83	259-260	10-25-62
Tom H. Hood, et ux	W.I.	6-25-62	2	Self	83	267-268	10-25-62
O. J. Holder, et ux	W.I.	6-18-62	2	Self	83	269-270	10-25-62
A. C. Holder, et ux	W.I.	6-18-62	2	Self	83	271-272	10-25-62
Gordon E. Herkenhoff, et ux	W.I.	6-18-62	2	Self	83	273-274	10-25-62
R. Lounsbury, et ux	W.I.	6-20-62	2	Self	83	275-283	10-25-62
Paul N. Layman, Sr.	W.I.	6-26-62	2	Self	83	284-286	10-25-62
Walter N. Maguire, et ux	W.I.	6-29-62	2	Self	83	294-295	10-25-62
W. L. Maguire, et ux	W.I.	6-26-62	2	Self	83	296-297	10-25-62
Henry D. Mercer, et ux	W.I.	6-26-62	2	Self	83	298-299	10-25-62
Dr. John D. Meschuk, et ux	W.I.	7-13-62	2	Self	83	300-301	10-25-62
R. L. McLaughlin, et ux	W.I.	7-18-62	2	Self	83	302-303	10-25-62
J. R. McLaughlin, et ux	W.I.	7-28-62	2	Self	83	302-303	10-25-62
D. D. Patteson, et ux	W.I.	6-22-62	2	Self	83	378-379	10-25-62
Pecos Land & Development Co., Inc.	W.I.	7-25-62	2	Alva A. Simpson, Jr.	83	380-381	10-25-62
E. D. Pearce, et ux	W.I.	7-11-62	2	Self	83	382-383	10-25-62
Premier Title & Mortgage Co., Trustee	W.I.	6-29-62	2	W. N. Maguire, President	83	384-385	10-25-62
John B. Rich, et ux	W.I.	6-21-62	2	Self	83	386-387	10-25-62
R. S. Rogers, et ux	W.I.	6-18-62	2	Self	83	388-389	10-25-62
Wm. G. Ross, et ux	W.I.	6-17-62	2	Self	83	390-391	10-25-62
Schio Petroleum Company	W.I.	8-7-62	2	F. H. Willibrand, Vice President	83	398-399	10-25-62
Tidewater Oil Company	W.I.	8-8-62	2	E. B. Miller, Jr., Vice President	83	400-401	10-25-62
L. C. White, et ux	W.I.	6-18-62	2	Self	83	402-403	10-25-62
Chas. H. Wood, et ux	W.I.	6-25-62	2	Self	83	404-405	10-25-62
Mabel Alston, et vir	R.I.	7-19-62	2	Self	83	247-248	10-25-62
Richard S. Anderson, Inc.	R.I.	7-3-62	2	Richard S. Anderson, President	83	249-250	10-25-62
Rubie C. Bell, et vir	R.I.	7-12-62	2	Self	83	251-252	10-25-62
Elizabeth W. Chaney	R.I.	7-18-62	2	Self	83	255-256	10-25-62
Olen F. Featherstone, et ux	R.I.	7-6-62	2	Self	83	257-258	10-25-62
FNB of Nevada & Clarence E. Hinkle	R.I.	6-28-62	2	R. O. Kwapi, Vice President and Trust Officer FNB.	83	288-289	10-25-62
Trustees u/w Allie M. Lee, Dec'd.	R.I.	7-19-62	2	Self as Trustee of Estate.	83	265-266	10-25-62
Hazel Z. Hart	R.I.	6-30-62	2	Donald B. Anderson, Vice President	83	261-262	10-25-62
Hondo Oil & Gas Company	R.I.	7-21-62	2	Self	83	263-264	10-25-62
Vergil O. Hopp, et ux	R.I.	6-28-62	2	Self	83	290-291	10-25-62
Ada M. Mills, Feme Sole	R.I.	6-29-62	2	Self	83	292-293	10-25-62
J. R. Miller, et ux	R.I.	8-22-62	2	Self	83	376-377	10-25-62
E. H. Peterson	R.I.	6-28-62	2	Self	83	396-397	10-25-62
Frank A. Saner, et ux	R.I.	7-6-62	2	Self	83	394-395	10-25-62
Ed. Shockley, et ux	R.I.	7-11-62	2	Self	83	392-393	10-25-62
Thoralf Sivertsen, et ux	R.I.	7-19-62	2	Self	83	406-407	10-25-62
Ruth Zimmerman	R.I.	7-19-62	2	Self	83	408-409	10-25-62
William P. Zimmerman	R.I.	10-24-62	1	E. S. Wacker, Commissioner - Public Lands State of N.M.	83	338	10-25-62
Certificate of Approval by New Mexico State Land Office	R.I.						

U.S. Department of Interior - U.S.G.S. Approval 12-27-62 - Unit Designation No. 14-08-0001-8486 Effective January 1, 1963.

CERTIFICATE OF EFFECTIVENESSWEST CAP QUEEN SAND UNIT
CHAVES COUNTY, NEW MEXICO

WHEREAS, Article 23 of the agreement entitled "Unit Agreement - West Cap Queen Sand Unit, Chaves County, New Mexico", covering the following described land in Chaves County, New Mexico, to wit:

Township 14 South, Range 31 East
 Section 8: E/2 NE/4, SE/4, SW/4
 16: SW/4 SW/4
 17: NW/4, NE/4, SE/4, SW/4
 20: NE/4
 21: NW/4, NE/4, N/2 SE/4, SW/4 SE/4,

a counterpart copy of which agreement is recorded in the office of the County Clerk of said County in Book 83 at Page 304, provides for the filing of a certificate by the unit operator named in the agreement certifying to the information set out below; and

WHEREAS, PHILLIPS PETROLEUM COMPANY, a corporation, having its principal office in Bartlesville, Oklahoma, is the Unit Operator named pursuant to said agreement;

NOW, THEREFORE, PHILLIPS PETROLEUM COMPANY, as Unit Operator, hereby certifies as follows:

1. A counterpart of said unit agreement is filed for record in the office of the County Clerk of Chaves County, New Mexico, as shown above.
 2. Tracts comprising 100 per cent of the unit area shown on Exhibit "A" to the unit agreement have qualified for inclusion in the unit under Article 12 of said agreement.
 3. New Mexico Commission Order No. R-2332, Case No. 2642, dated October 18, 1962, approved the subject unit as to New Mexico state lands included therein.
- U. S. Department of Interior letter dated December 27, 1962, approved creation of the West Cap Queen Sand Unit and designated No. 14-08-0001-8486 to the unit project, with its effective date being January 1, 1963.
4. Pursuant to determination by the working interest owners in the qualified tracts, the effective time and date of said unit agreement is January 1, 1963, at 7:00 o'clock a.m.

ATTEST:

PHILLIPS PETROLEUM COMPANY

 Assistant Secretary

By 
 Vice President

STATE OF Oklahoma)
COUNTY OF Washington) ss

CORPORATION ACKNOWLEDGMENT

On this 17th day of January, 1963, before me appeared B. F. STRADLEY, to me personally known, who being by me duly sworn, did say that he is the VICE PRESIDENT of Phillips Petroleum Company, a corporation, and that the seal affixed to said instrument is the corporate seal of said corporation, and that said instrument was signed and sealed in behalf of said corporation by authority of its Board of Directors, and said VICE PRESIDENT acknowledged said instrument to be the free act and deed of said corporation.

Given under my hand and seal of office this 17th day of January, 1963.

Russell J. McLellan
Notary Public in and for said
County and State

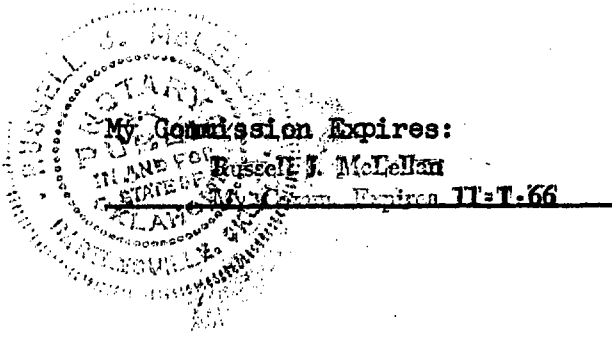

State of New Mexico, }
County of Chaves } ss.

FILED FOR RECORD

JAN 24 1963

at 9:40 o'clock A. M. and recorded in
Book 14 page 265
Dorothy Herring County Clerk
Joyce Walker Deputy

Rec #1123 C Fee \$2.75

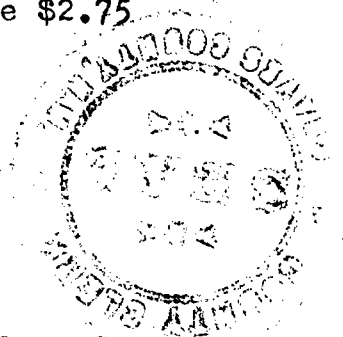

Phillips Petroleum Co.
Phillips Building Room 123
Bartlesville, Oklahoma

CERTIFICATE OF APPROVAL

BY COMMISSIONER OF PUBLIC LANDS, STATE OF NEW MEXICO

WEST CAP QUEEN SAND UNIT

There having been presented to the undersigned Commissioner of Public Lands of the State of New Mexico for examination, the attached Agreement for the development and operation of acreage which is described within the attached Agreement, dated April 1, 1962, which has been executed or is to be executed by parties owning and holding oil and gas leases and royalty interests in and under the property described, and upon examination of said Agreement, the Commissioner finds:

- (a) That such agreement will tend to promote the conservation of oil and gas and the better utilization of reservoir energy in said area.
- (b) That under the proposed agreement the State of New Mexico will receive its fair share of the recoverable oil or gas in place under its lands in the area.
- (c) That each beneficiary Institution of the State of New Mexico will receive its fair and equitable share of the recoverable oil and gas under its lands within the area.
- (d) That such agreement is in other respects for the best interests of the state, with respect to state lands.

NOW, THEREFORE, by virtue of the authority conferred upon me under Sections 7-11-39, 7-11-40, 7-11-41, 7-11-47, 7-11-48, New Mexico Statutes Annotated 1953 Compilation, I, the undersigned, Commissioner of Public Lands of the State of New Mexico, for the purpose of more properly conserving the oil and gas resources of the State, do hereby consent to and approve the said Agreement, and any leases embracing lands of the State of New Mexico within the area shall be and the same are hereby amended to conform with the terms thereof, and shall remain in full force and effect according to the terms and conditions of said Agreement. This approval is subject to all of the provisions of the aforesaid statutes.

IN WITNESS WHEREOF, this Certificate of Approval is executed, with seal affixed, this 24th day of October 19 62.

Commissioner of Public Lands
of the State of New Mexico



UNITED STATES
DEPARTMENT OF THE INTERIOR
GEOLOGICAL SURVEY
WASHINGTON 25, D. C.

DEC 27 1962

Phillips Petroleum Company

Bartlesville, Oklahoma

Gentlemen:

On December 20, 1962, Arthur A. Baker, Acting Director of the Geological Survey, approved the West Cap Queen Sand unit agreement, Chaves County, New Mexico, filed by your company as unit operator. This agreement has been designated No. 14-08-0001-8486, and is effective as of January 1, 1963.

Enclosed are three copies of the approved unit agreement for your records. It is requested that you furnish the State of New Mexico and any other interested principal with whatever evidence of this approval is deemed appropriate.

Sincerely yours,

For the Director

Enclosures 3

RECEIVED

JAN 4 1963

U. S. GEOLOGICAL SURVEY
ROSWELL, NEW MEXICO

APPROVAL - CERTIFICATION - DETERMINATION

Pursuant to the authority vested in the Secretary of the Interior under the Act approved February 25, 1920, 41 Stat. 437, 30 U.S.C. Secs. 181 et seq., as amended by the Act of August 8, 1946, 60 Stat. 950, and delegated to the Director of the Geological Survey, pursuant to Departmental Order No. 2365 of October 8, 1947, 43 CFR Sec. 4.618, 12 FR 6784, I do hereby:

- A. Approve the attached secondary recovery Unit Agreement for the development and operation of the West Cap Queen Sand Unit Area, State of New Mexico.
- B. Certify and determine that the unit plan for secondary recovery contemplated in the attached Agreement is necessary and advisable in the public interest and is for the purpose of more properly conserving the natural resources.
- C. Certify and determine that the drilling, producing, rental, minimum royalty and royalty requirements of the Federal lease or leases committed to said agreement are hereby established, altered, changed or revoked to conform with the terms and conditions of the Agreement.

Dated DEC 20 1962.

Contract No. 14-08-0001 8486

William H. Baker

Acting Director
United States Geological Survey

CLASS OF SERVICE

This is a fast message unless its deferred character is indicated by the proper symbol.

WESTERN UNION

TELEGRAM

W. P. MARSHALL, PRESIDENT

1201 (4-60)

SYMBOLS

DL=Day Letter

NL=Night Letter

LT=International Letter Telegram

The filing time shown in the date line on domestic telegrams is LOCAL TIME at point of origin. Time of receipt is LOCAL TIME at point of destination

LA061 SSG122

1962 SEP 26 PM 12 47

L HBA025 PD=HOBBS NMEX 26 1022A MST=

NEW MEXICO OTL CONSERVATION COMMISSION, ATTN A L
PORTER JR= BOX 871 SANTA FE NMEX=

CITIES SERVICE PETROLEUM CO OPERATOR OF THE DRICKEY
QUEEN SAND UNIT WHICH OFF SETS THE PROPOSED WEST CAP
QUEEN SAND UNIT OPERATED BY PHILLIPS PETROLEUM CO
RECOMMENDS APPROVAL OF CASES 2642 AND 2643=

: E F MOTTER DIVN ENGINEER CITIES SERVICE
PETROLEUM CO=

=2642 2643

WE APPRECIATE SUGGESTIONS FROM ITS PATRONS CONCERNING ITS SERVICE

CLASS OF SERVICE

This is a fast message unless its deferred character is indicated by the proper symbol.

WESTERN UNION TELEGRAM

W. P. MARSHALL, PRESIDENT

1201 (4-60)

SYMBOLS

DL=Day Letter

NL=Night Letter

LT=International
Letter Telegram

The filing time shown in the date line on domestic telegrams is LOCAL TIME at point of origin. Time of receipt is LOCAL TIME at point of destination.

LA183 SSD309

1962 SEP 24 PM 5 26

CASH OFFICE USE

L RWA113 PD=ROSWELL NMEX 24 437P MST=

OIL CONSERVATION COMMISSION=

STATE OF NEW MEXICO SANTA FE NMEX=

ATTENTION: MR A. L. PORTER, JR. RE: CASES NO. 2642 AND
2643 SCHEDULED FOR EXAMINER HEARING SEPTEMBER 27, 1962.

9 GULF OIL CORPORATION, BEING A WORKING INTEREST
OWNER IN THE PROPOSED WEST CAP QUEEN UNIT, CONCURS WITH
PHILLIPS PETROLEUM COMPANY IN THEIR APPLICATIONS IN
THESE CASES=

W B HOPKINS.

THE COMPANY WILL APPRECIATE SUGGESTIONS FROM ITS PATRONS CONCERNING ITS SERVICE

GOVERNOR
EDWIN L. MECHEM
CHAIRMAN

State of New Mexico
Oil Conservation Commission

LAND COMMISSIONER
E. S. JOHNNY WALKER
MEMBER

STATE GEOLOGIST
A. L. PORTER, JR.
SECRETARY - DIRECTOR

P. O. BOX 871
SANTA FE

October 19, 1962

2642

Mr. Jason Kellahin
Kellahin & Fox
Post Office Box 1713
Santa Fe, New Mexico

Re: Case No. R-2332
Order No. _____
~~Applicant~~ Phillips Petroleum Company

Dear Sir:

Enclosed herewith are two copies of the above-referenced Commission order recently entered in the subject case.

Very truly yours,

A. L. Porter, Jr.

A. L. PORTER, Jr.
Secretary-Director

ir/

Carbon copy of order also sent to:

Hobbs OCC x

Artesia OCC _____

Aztec OCC _____

OTHER _____
