

#4791

PATRICK H. LYONS
COMMISSIONER

State of New Mexico
Commissioner of Public Lands

310 OLD SANTA FE TRAIL
P.O. BOX 1148
SANTA FE, NEW MEXICO 87504-1148

COMMISSIONER'S OFFICE

Phone (505) 827-5760
Fax (505) 827-5766
www.nmstatelands.org

March 6, 2003

Ocean Energy, Inc.
1001 Fannin, Suite 1600
Houston, Texas 77002

Attn: Mr. Derold Maney

Re: Burton Flat Deep Unit
Commerciality Determinations
BFDU Well No. 14 (Lot 13) Sec. 2-21S-27E (Strawn Formation)
BFDU Well No. 27 (Lot 15) Sec. 2-21S-27E (Delaware Formation)
BFDU Well No. 41 (K) Sec. 27-20S-28E (Strawn Formation)
BFDU Well No. 2 (Lot 14) Sec. 2-21S-27E (Atoka Formation)
Eddy County, New Mexico

Dear Mr. Maney:

We are in receipt of your letter of July 23, 2002 together with the commerciality determination data for the above captioned wells.

The Bureau of Land Management, by their letter of September 18, 2002, has concurred with your determination that the above captioned wells are non-commercial wells and should be produced on a lease basis.

Please be advised that the Commissioner of Public Lands concurs with the Bureau of Land Management's determination that the Burton Flat Deep Unit Well Nos. 14, 27, 41 and 2 are non-commercial wells as submitted in your application. These non-commercial wells should be produced on a lease basis.

If you have any questions or if we may be of further help, please contact Pete Martinez at (505) 827-5791.

Very truly yours,

PATRICK H. LYONS
COMMISSIONER OF PUBLIC LANDS

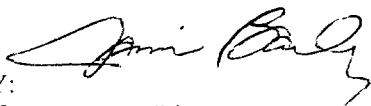

BY:
JAMI BAILEY, Director
Oil, Gas and Minerals Division
(505) 827-5744

PL/JB/pm

cc: Reader File
OCD-Santa Fe Attention: Mr. Roy Johnson
BLM-Roswell, Attn: Mr. Armando Lopez
RMN-Attn: Ms. Linda Vieira

#4791

COMMISSIONER'S OFFICE

Phone (505) 827-5760

Fax (505) 827-5766

ADMINISTRATION

Phone (505) 827-5700

Fax (505) 827-5853

GENERAL COUNSEL

Phone (505) 827-5713

Fax (505) 827-4262

PUBLIC AFFAIRS

Phone (505) 827-1245

Fax (505) 827-5766

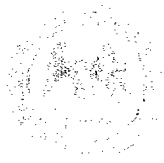

**New Mexico State Land Office
Commissioner of Public Lands
Ray Powell, M.S., D.V.M.**

COMMERCIAL RESOURCES

Phone (505) 827-5724

Fax (505) 827-6157

MINERAL RESOURCES

Phone (505) 827-5744

Fax (505) 827-4739

ROYALTY MANAGEMENT

Phone (505) 827-5772

Fax (505) 827-4739

SURFACE RESOURCES

Phone (505) 827-5793

Fax (505) 827-5711

June 6, 2002

Ocean Energy, Inc.
1001 Fannin
Suite 1600
Houston, Texas 77002-6794

Attn: Mr. Derold Maney

Re: 2002 Plan of Development
Burton Flats Deep Unit
Eddy County, New Mexico

Dear Mr. Maney:

The Commissioner of Public Lands has, of this date, approved the above-captioned Plan of Development. Our approval is subject to like approval by all other appropriate agencies.

The possibility of drainage by wells outside of the unit area and the need for further development of the unit may exist. You may be contacted at a later date regarding these possibilities.

If you have any questions or if we may be of further help, please contact Pete Martinez at (505) 827-5791.

Very truly yours,

RAY POWELL, M.S., D.V.M.
COMMISSIONER OF PUBLIC LANDS

BY: *Anthony H. Neal*
JAMI BAILEY, Director
Oil, Gas and Minerals Division
(505) 827-5744

For

RP/JB/cpm
xc: Reader File

OCD

BLM

COMMISSIONER'S OFFICE

Phone (505) 827-5760
Fax (505) 827-5766

ADMINISTRATION

Phone (505) 827-5700
Fax (505) 827-5853

GENERAL COUNSEL

Phone (505) 827-5713
Fax (505) 827-4262

PUBLIC AFFAIRS

Phone (505) 827-1245
Fax (505) 827-5766



4791

COMMERCIAL RESOURCES

Phone (505) 827-5724
Fax (505) 827-6157

MINERAL RESOURCES

Phone (505) 827-5744
Fax (505) 827-4739

ROYALTY MANAGEMENT

Phone (505) 827-5772
Fax (505) 827-4739

SURFACE RESOURCES

Phone (505) 827-5793
Fax (505) 827-5711

**New Mexico State Land Office
Commissioner of Public Lands
Ray Powell, M.S., D.V.M.**

January 3, 2002

Ocean Energy, Inc.
1001 Fannin
Suite 1600
Houston, Texas 77002-6794

Attn: Mr. Derold Maney

Re: 2002 Plan of Development
Burton Flat Deep Unit
Eddy County, New Mexico

Dear Mr. Maney:

The Commissioner of Public Lands has, of this date, approved the above-captioned Plan of Development. Our approval is subject to like approval by all other appropriate agencies.

The possibility of drainage by wells outside of the unit area and the need for further development of the unit may exist. You may be contacted at a later date regarding these possibilities.

If you have any questions or if we may be of further help, please contact Pete Martinez at (505) 827-5791.

Very truly yours,

RAY POWELL, M.S., D.V.M.
COMMISSIONER OF PUBLIC LANDS

A handwritten signature in cursive script, appearing to read "Jami Bailey", is written over a horizontal line.

BY:
JAMI BAILEY, Director
Oil, Gas and Minerals Division
(505) 827-5744

RP/JB/cpm
xc: Reader File

OCD

BLM



United States Department of the Interior

BUREAU OF LAND MANAGEMENT

Box 1397, Roswell, New Mexico - 86201

14-08-0001-12391

September 11, 1984

Monsanto Oil Company
ATTN: Mr. Kevin Pfister
1300 One First City Center
500 West Texas
Midland, TX 79701

CASE # 4791

RE: Second Revised Ninth Plan of
Development and Operation for
the Burton Flat Deep Unit,
Eddy County, New Mexico

Gentlemen:

Enclosed is an approved copy of your Second Revised Ninth Plan of Development for the period January 1, 1984 to January 1, 1985 for the Burton Flat Deep Unit, Eddy County, New Mexico. This revision proposes to add Bone Spring Wells No. 34 through 44 to the Burton Flat Deep Unit.

Approval of this revision is subject to like approval by the New Mexico Commissioner of Public Lands and the New Mexico Oil Conservation Division.

Sincerely,

S/ Richard Bastin

District Manager

cc: Commissioner of Public Lands, Santa Fe
✓NMOCD, Santa Fe

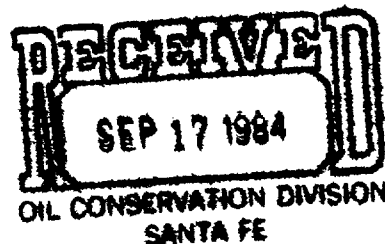



United States Department of the Interior

BUREAU OF LAND MANAGEMENT

Box 1397, Roswell, New Mexico - 88201

IN REPLY REFER TO

#4791

Burton Flat
Deep Unit

April 3, 1984

RECEIVED
APR 6 9 07 AM '84
STATE LAND OFFICE
SANTA FE, N.M.

Monsanto Oil Company
Attention: Mrs. Marianne Giles
1300 One First City Center
500 West Texas
Midland, TX 79701

Gentlemen:

Enclosed is an approved copy of your Revised Ninth Plan of Development and Operation for the Burton Flat Deep Unit Area, Eddy County, New Mexico, covering the period January 1, 1984 to January 1, 1985. This plan, proposing an orderly development of the Delaware Mountain Group and Bone Springs reservoirs through additional wells (Unit Wells No. 17 through 22 and 24 through 33) and workovers (Unit Well Nos. 2, 3, 9, 11 and 14) which may be completed during 1984, was approved this date, subject to like approval by the New Mexico Commissioner of Public Lands and the New Mexico Oil Conservation Division.

In subsequent plans of development please continue to provide statistical data on production and/or decline curves on producing wells.

Sincerely yours,

Orig. Sgd. Earl R. Cunningham

District Manager

Enclosure (1)

cc: Commissioner of Public Lands, Santa Fe
NMOCD, Santa Fe

#4791

State of New Mexico



JIM BACA
COMMISSIONER

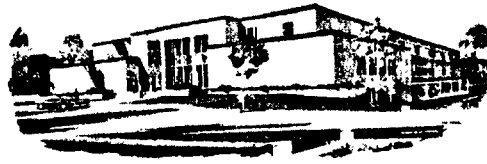

Commissioner of Public Lands

January 18, 1984

P.O. BOX 1148
SANTA FE, NEW MEXICO 87504-1148

Monsanto Oil Company
1300 One First City Center
500 West Texas
Midland, Texas 79701

Re: Ninth Plan of Development
and Operation for the
Burton Flat Deep Unit
Eddy County, New Mexico

ATTENTION: Mr. Kevin Pfister

Gentlemen:

The Commissioner of Public Lands has this date approved your Ninth Plan of Development and Operation for the Burton Flat Deep Unit, Area, Eddy County, New Mexico, covering the period of January 1, 1984 to January 1, 1985. Such plan proposes to evaluate the Delaware Mountain Group Reservoir and select additional locations based on such evaluation data, determine and submit participating areas for approval as each well is completed and conduct work-over operations on several unit wells.

Our approval is subject to like approval by the Bureau of Land Management.

Enclosed is an approved copy for your files.

Very truly yours,

JIM BACA
COMMISSIONER OF PUBLIC LANDS

BY:
RAY D. GRAHAM, Director
Oil and Gas Division
AC 505/827-5744

JB/RDG/pm
encls.

cc: OCD-Santa Fe, New Mexico
BLM-Albuquerque, New Mexico
BLM-Roswell, New Mexico

State of New Mexico



JIM BACA
COMMISSIONER



Commissioner of Public Lands

November 9, 1983

P.O. BOX 1148
SANTA FE, NEW MEXICO 87504-1148

#4791

Monsanto Oil Company
1300 One First City Center
500 West Texas
Midland, Texas 79701

Re: Revised 1983 Plan of Development
Burton Flat Deep Unit
Eddy County, New Mexico

ATTENTION: Mr. Kevin Pfister

Gentlemen:

The Commissioner of Public Lands has this date approved your Revised Eighth Plan of Development and Operation for the Burton Flat Deep Unit, Eddy County, New Mexico. Such plan proposes to drill the Unit Well Nos. 15 and 16 to test the Delaware Mountain Group. Our approval is subject to like approval by the Bureau of Land Management.

Enclosed is an approved copy for your files.

Very truly yours,

JIM BACA
COMMISSIONER OF PUBLIC LANDS

BY:
RAY D. GRAHAM, Director
Oil and Gas Division
AC 505/827-5744

JB/RDG/pm
encls.

cc: OCD-Santa Fe, New Mexico
BLM-Albuquerque, New Mexico
BLM-Roswell, New Mexico



IN REPLY
REFER TO:

4791

United States Department of the Interior

BUREAU OF LAND MANAGEMENT
505 MARQUETTE AVENUE, N.W., SUITE 815
ALBUQUERQUE, NEW MEXICO 87102

RECEIVED
FEB 21 9 37 AM '83
STATE LAND OFFICE
SANTA FE, N. M.

Monsanto Company
Attention: Kevin Pfister
1300 One Midland National Center
500 West Texas
Midland, Texas 79701

Gentlemen:

Six approved copies of your 1983 plan of development for the Burton Flat Deep unit area, Eddy County, New Mexico, are enclosed. Such plan, proposing no further drilling during 1983, was approved on this date subject to like approval by the appropriate officials of the State of New Mexico.

Sincerely yours,

Gene F. Daniel
Deputy Minerals Manager
Oil and Gas

Enclosures

cc:
Comm. of Public Lands
NMOCD



JIM BACA
COMMISSIONER

Angel

State of New Mexico

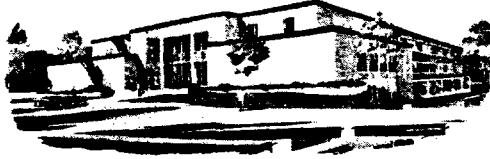

Commissioner of Public Lands

March 4, 1983

P.O. BOX 1148
SANTA FE, NEW MEXICO 87504-1148

Monsanto Oil Company
1300 One First City Center
500 West Texas
Midland, Texas 79701

Re: 1983 Plan of Development
Burton Flat Deep Unit
Eddy County, New Mexico

ATTENTION: Mr. Kevin Pfister

Gentlemen:

The Commissioner of Public Lands has this date approved your Eighth Plan of Development and Operation for the Burton Flat Deep Unit Area, Eddy County, New Mexico, covering the period of January 1, 1983, to January 1, 1984. Such plan proposes no further drilling to be anticipated during 1983. Our approval is subject to like approval by the Bureau of Land Management.

Enclosed are three approved copies of your plan for your files.

Your filing fee in the amount of Three (\$3.00) Dollars has been received.

Very truly yours,

JIM BACA
COMMISSIONER OF PUBLIC LANDS

BY:
FLOYD O. PRANDO, Assistant Director
Oil and Gas Division
AC 505/827-5744

JB/FOP/pm
encls.

cc: OCD-Santa Fe, New Mexico
USMMS-Albuquerque, New Mexico
Administration

State of New Mexico

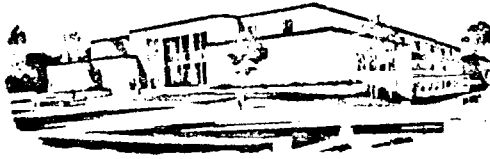

Commissioner of Public Lands

ALEX J. ARMIJO
COMMISSIONER

April 22, 1982

P. O. BOX 1149
SANTA FE, NEW MEXICO 87504
87504-1148

Monsanto Company
1330 Midland National Bank Tower
500 West Texas
Midland, Texas 79701

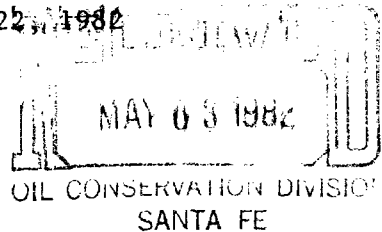

Re: Burton Flat Deep Unit
Eddy County, New Mexico
1982 Plan of Development

4-7-11

ATTENTION: Mr. Kevin Pfister

Gentlemen:

The Commissioner of Public Lands has this date approved your 1982 Plan of Development for the Burton Flat Deep Unit, Eddy County, New Mexico. Such plan proposes no further drilling during 1982, however, workover operations on several Unit wells will begin in the third and fourth quarter of 1982. Our approval is subject to like approval by the New Mexico Oil Conservation Division and the United States Minerals Service.

Enclosed are two approved copies for your files.

Your filing fee in the amount of Three (\$3.00) Dollars has been received.

Very truly yours,

ALEX J. ARMIJO
COMMISSIONER OF PUBLIC LANDS

BY:
RAY D. GRAHAM, Director
Oil and Gas Division
AC 505/827-2748

AJA/RDG/pm
encls.
cc:

OCD-Santa Fe, New Mexico
USMMS-Albuquerque, New Mexico



United States Department of the Interior

OFFICE OF THE SECRETARY

Minerals Management Service
South Central Region
P. O. Box 26124
Albuquerque, New Mexico 87125

APR 08 1982

OIL CONSERVATION
SANTA FE

APR 7 1982

4791

Monsanto Company
Attention: Kevin Pfister
1330 Midland National Bank Tower
500 West Texas
Midland, Texas 79701

Gentlemen:

Four approved copies of your 1982 plan of development for the Burton Flat Deep unit area, Eddy County, New Mexico, are enclosed. Such plan, proposing no further drilling during 1982, was approved on this date subject to like approval by the appropriate officials of the State of New Mexico.

Sincerely yours,

(ORIG. SIGNED) JAMES W. SHEPHERD
FOR Gene F. Daniel
Deputy Minerals Manager
Oil and Gas

Enclosures

cc:
Comm. of Public Lands, Santa Fe
NMOCD, Santa Fe

State of New Mexico



ALEX J. ARMIJO
COMMISSIONER

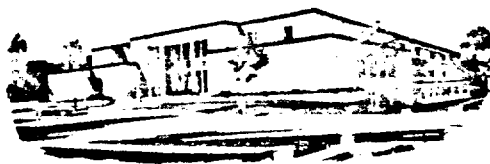

Commissioner of Public Lands

January 8, 1982

P. O. BOX 1148
SANTA FE, NEW MEXICO 87501

Monsanto Company
1330 Midland National Bank Tower
500 West Texas
Midland, Texas 79701

Re: Plan of Development
Burton Flat Deep Unit
Eddy County, New Mexico

ATTENTION: Mr. Kevin Pfister

Gentlemen:

The Commissioner of Public lands has this date approved your 1981 Plan of Development For the Burton Flat Deep Unit, Eddy County, New Mexico. Such plan is for the period of January 1, 1981 thru January 1, 1982 and calls for workover operations on several Unit wells beginning in the fourth quarter and also to study and evaluate the unit area and immediate area surrounding the unit boundries to determine what additional operations appear to be warranted as to the unit area.

When submitting your Plan of Development for 1982 please evaluate the W/2 of Section 3, Township 21 South, Range 27 East for Morrow drainage by the Mobil Producing Texas and New Mexico Inc. Federal 4 Com Well No. 1 Located in Lot 9 of Section 4, Township 21 South, Range 27 East.

Enclosed is one approved copy for your files.

Please remit a Three (\$3.00) Dollar filing fee.

Very truly yours,

ALEX J. ARMIJO
COMMISSIONER OF PUBLIC LANDS

BY:
RAY D. GRAHAM, Director
Oil and Gas Division
AC 505/827-2748

AJA/RDG/pm

encls.

cc:

OCD-Santa Fe, New Mexico
USGS-Albuquerque, New Mexico

South Central Region
P. O. Box 26124
Albuquerque, New Mexico 87125

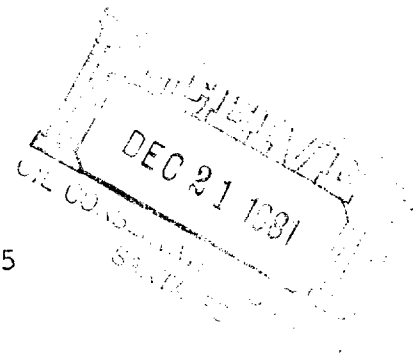

DEC 16 1981

470

Monsanto Company
Attention: Kevin Pfister
1330 Midland National Bank Tower
500 West Texas
Midland, Texas 79701

Gentlemen:

Your sixth Plan of Development and Operation for the Burton Flat Deep Unit, Eddy County, New Mexico, has been received by this office.

The sixth plan as submitted proposes evaluation of the unit and surrounding area to determine what, if any, additional operations might be needed. Workover operations on several unit wells will begin in the last quarter of 1981. This plan is approved, however, you are requested to re-examine the W $\frac{1}{2}$ section 3, T. 21 S., R. 27 E., N.M.P.M., for drainage of unitized substances from the Morrow formation by the well located in Lot 9 Section 4, T. 21 S., R. 27 E., N.M.P.M.

Sincerely yours,

(ORIG. SGD.) JAMES W. SHELTON

FOR Gene F. Daniel
Deputy Conservation Manager
Oil and Gas

cc:
Comm. of Public Lands, Santa Fe
NMOCD, Santa Fe
DS, Roswell (w/cy)
Development Unit

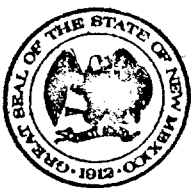

State of New Mexico

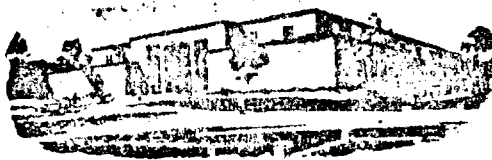

Commissioner of Public Lands

March 3, 1978

PHIL R. LUCERO
COMMISSIONER

P. O. BOX 1148
SANTA FE, NEW MEXICO 87501

Monsanto Company
1330 Midland National Bank Tower
500 West Texas
Midland, Texas 79701

Handwritten signature/initials

Re: Schedule of Lands and Leases
Burton Flat Deep Unit Agreement
Eddy County, New Mexico

ATTENTION: Mr. John B. Huckabay

Gentlemen:

Your letter of February 23, 1978, transmit three copies of revised Exhibits "A" and "B" for the Burton Flat Deep Unit. Such Exhibits describe lands remaining in the Burton Flat Deep Unit after elimination.

On Exhibit "B", Tract 24, the description should read the NE/4SW/4 instead of NW/4SW/4. We have corrected our copy, please correct your copies accordingly.

These Exhibits have been approved as of this date effective as of November 3, 1977. Enclosed is a copy of Exhibit "A" and "B" surplus to our need. Exhibit "B" enclosed reflects the correction on Tract 24.

Very truly yours,

PHIL R. LUCERO
COMMISSIONER OF PUBLIC LANDS

BY:
RAY D. GRAHAM, Director
Oil and Gas Division

PRL/RDG/s
encls.
cc:

OCC-Santa Fe, New Mexico
USGS-Roswell, New Mexico
USGS-Albuquerque, New Mexico

State of New Mexico



JIM BACA
COMMISSIONER

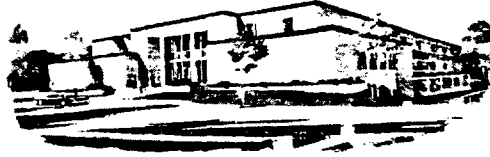

Commissioner of Public Lands

September 20, 1984

P.O. BOX 1148
SANTA FE, NEW MEXICO 87504-1148
Express Mail Delivery Use:
310 Old Santa Fe Trail
Santa Fe, New Mexico 87501

Monsanto Oil Company
1300 One First City Center
500 West Texas
Midland, Texas 79701

Re: Second Revised Ninth Plan of
Development and Operation for
the Burton Flat Deep Unit
Eddy County, New Mexico

ATTENTION: Mr. Kevin Pfister

Gentlemen:

The Commissioner of Public Lands has this date approved your Second Revised Ninth Plan of Development and Operation for the period January 1, 1984 to January 1, 1985 for the Burton Flat Deep Unit, Eddy County, New Mexico. This revision proposes to drill the unit well nos. 34 through 44.

Our approval is subject to like approval by the New Mexico Oil Conservation Division and the Bureau of Land Management.

Enclosed is an approved copy for your files.

Very truly yours,

JIM BACA
COMMISSIONER OF PUBLIC LANDS

BY:
RAY D. GRAHAM, Director
Oil and Gas Division
AC 505/827-5744

JB/RDG/pm
encls.

cc: OCD-Santa Fe, New Mexico
BLM-Albuquerque, New Mexico
BLM-Roswell, New Mexico Attn: Mr. Armando Lopez

ALL INFORMATION CONTAINED
HEREIN IS UNCLASSIFIED

ALD-03

#479/

Dear Mr. Johnson:

Reference is made to our telephone conversation of September 6, 1984. Enclosed please find correction pages for the above described document.

I have switched the locations for wells 35 and 43 around. I have also corrected the township and range designation for wells 37 through 42 to read T-21-S, R-27-E, instead of T-20-S, R-28-E.

If I can be of any further assistance in this regard, please apprise.

Very truly yours,

Kevin Pfister
Senior Landman

KP/lab

Enclosures

<u>UNIT WELL</u>	<u>LOCATION</u>	<u>COMPLETION DATE</u>	<u>TOTAL DEPTH</u>	<u>ZONE</u>
Unit Well No. 37	NE/4 SE/4 Section 2 T-21-S, R-27-E	Projected, 1984	5,700' (Est.)	Bone Spring
Unit Well No. 38	SE/4 SE/4 Section 2 T-21-S, R-27-E	Projected, 1984	5,700' (Est.)	Bone Spring
Unit Well No. 39	SW/4 SE/4 Section 2 T-21-S, R-27-E	Projected, 1984	5,700' (Est.)	Bone Spring
Unit Well No. 40	NW/4 SE/4 Section 2 T-21-S, R-27-E	Projected, 1984	5,700' (Est.)	Bone Spring
Unit Well No. 41	Lot 15 Section 2 T-21-S, R-27-E	Projected, 1984	5,700' (Est.)	Bone Spring
Unit Well No. 42	Lot 11 Section 2 T-21-S, R-27-E	Projected, 1984	5,700' (Est.)	Bone Spring
Unit Well No. 43	NE/4 SW/4 Section 2 T-21-S, R-27-E	Projected, 1984	5,700' (Est.)	Bone Spring
Unit Well No. 44	NE/4 SE/4 Section 34 T-20-S, R-28-E	Projected, 1984	5,700' (Est.)	Bone Spring

Current gas market conditions affect the producing status of some of the Unit Wells, and some wells reflected above as producing may be intermittently shut-in.

During the period covered by this Second Revised Ninth Plan of Development and Operation for the Burton Flat Deep Unit Area, an orderly development and evaluation of the Delaware Mountain Group and Bone Spring reservoirs is planned, subject to approval, during 1984 or until the reservoirs limits have been established. Geological and production data from each well drilled within the unit boundaries or the immediate surrounding area, will be evaluated upon completion and additional locations selected on the basis of evaluation of such data.

During the period covered by this Second Revised Ninth Plan of Development and Operation participating areas will be determined and submitted for approval.

Workover operations on several unit wells will begin in the last quarter of 1984 to improve production. Wells slated for possible workovers include Unit Wells Nos. 2, 3, 9, 11, and 14. Presently the Working Interest Owners are studying and evaluating the geology and production data applicable to the Unit Area and immediate area surrounding the unit boundaries to determine what, if any, additional operations appear to be warranted as to the Unit Area.

The Second Revised Ninth Plan of Development and Operation shall constitute the further obligations of the Operator under the Burton Flat Deep Unit Agreement for the period ending January 1, 1985, and may be modified or supplemented from time to time with the approval of the District Manager, Bureau of Land Management, Commissioner of Public Lands, and New Mexico Oil Conservation Commission when necessary to meet changed conditions or to protect the interest of all parties to the Unit Agreement.

Approval of this Second Revised Ninth Plan of Development and Operation for the Burton Flat Deep Unit Area is respectfully requested.

Submitted this _____ day of August, 1984.

MONSANTO OIL COMPANY

BY: _____
J. D. COBB, JR.
Regional Exploration Manager

<u>UNIT WELL</u>	<u>LOCATION</u>	<u>COMPLETION DATE</u>	<u>TOTAL DEPTH</u>	<u>ZONE</u>
Unit Well No. 9	SW/4 NW/4 Section 35, T-20-S, R-28-E	March 5, 1974	11,540'	Strawn (S-I) Morrow (S-I)
Unit Well No. 11	NW/4 NE/4 Section 27, T-20-S, R-28-E	May 28, 1974	11,500'	Morrow (Prod)
Unit Well No. 12	NE/4 NW/4 Section 26, T-20-S, R-28-E	May 1, 1975	11,475'	Wolfcamp (S-I)
Unit Well No. 13	SW/4 SE/4 Section 28, T-20-S, R-28-E	December 26, 1974	11,560'	Morrow (S-I)
Unit Well No. 14	Lot 13 Section 2, T-21-S, R-27-E	June 26, 1975	11,610'	Morrow (Prod)
Unit Well No. 15	SE/4 NW/4 Section 27, T-20-S, R-28-E	February 6, 1984	5,600'	Bone Spring
Unit Well No. 16	NE/4 SW/4 Section 3, T-21-S, R-27-E	Reached Total Depth January 9, 1984	5,500'	Bone Spring
Unit Well No. 17	SW/4 NW/4 Section 27, T-20-S, R-28-E	Projected, 1984	5,300' (Est.)	Delaware
Unit Well No. 18	SW/4 NE/4 Section 27, T-20-S, R-28-E	Projected, 1984	5,200' (Est.)	Delaware
Unit Well No. 19	NE/4 SW/4 Section 27, T-20-S, R-28-E	Projected, 1984	5,300' (Est.)	Delaware
Unit Well No. 20	NW/4 SW/4 Section 3, T-21-S, R-27-E	Projected, 1984	5,200' (Est.)	Delaware
Unit Well No. 21	Lot 14 Section 3, T-21-S, R-27-E	Projected, 1984	5,200' (Est.)	Delaware
Unit Well No. 22	NW/4 SE/4 Section 3, T-21-S, R-27-E	Projected, 1984	5,200' (Est.)	Delaware
Unit Well No. 23	Lot 8 Section 2, T-21-S, R-27-E	March 1, 1984	5,700'	Bone Spring
Unit Well No. 24	Lot 1 Section 2, T-21-S, R-27-E	May 20, 1984	6,000'	Bone Spring
Unit Well No. 25	Lot 9 Section 2, T-21-S, R-27-E	Reached Total Depth on August 11, 1984	5,700'	Bone Spring
Unit Well No. 26	Lot 2 Section 2, T-21-S, R-27-E	Projected, 1984	5,700' (Est.)	Bone Spring
Unit Well No. 27	Lot 7 Section 2, T-21-S, R-27-E	May 25, 1984	6,250'	Bone Spring
Unit Well No. 28	Lot 10 Section 2, T-21-S, R-27-E	Projected, 1984	5,700' (Est.)	Bone Spring
Unit Well No. 29	Lot 3 Section 2, T-21-S, R-27-E	Projected, 1984	5,700' (Est.)	Bone Spring
Unit Well No. 30	SW/4 SE/4 Section 34, T-20-S, R-28-E	Projected, 1984	5,700' (Est.)	Bone Spring
Unit Well No. 31	SE/4 SE/4 Section 34, T-20-S, R-28-E	Projected, 1984	5,700' (Est.)	Bone Spring
Unit Well No. 32	SW/4 SW/4 Section 35, T-20-S, R-28-E	August 7, 1984	5,700'	Bone Spring
Unit Well No. 33	SE/4 SW/4 Section 35, T-20-S, R-28-E	Projected, 1984	5,700' (Est.)	Bone Spring
Unit Well No. 34	SW/4 NW/4 Section 26 T-20-S, R-28-E	Projected, 1984	5,700' (Est.)	Bone Spring
Unit Well No. 35	NE/4 SW/4 Section 35 T-20-S, R-28-E	Projected, 1984	5,700' (Est.)	Bone Spring
Unit Well No. 36	Lot 16 Section 2 T-21-S, R-27-E	Projected, 1984	5,700' (Est.)	Bone Spring

<u>UNIT WELL</u>	<u>LOCATION</u>	<u>COMPLETION DATE</u>	<u>TOTAL DEPTH</u>	<u>ZONE</u>
Unit Well No. 37	NE/4 SE/4 Section 2 T-21-S, R-27-E	Projected, 1984	5,700' (Est.)	Bone Spring
Unit Well No. 38	SE/4 SE/4 Section 2 T-21-S, R-27-E	Projected, 1984	5,700' (Est.)	Bone Spring
Unit Well No. 39	SW/4 SE/4 Section 2 T-21-S, R-27-E	Projected, 1984	5,700' (Est.)	Bone Spring
Unit Well No. 40	NW/4 SE/4 Section 2 T-21-S, R-27-E	Projected, 1984	5,700' (Est.)	Bone Spring
Unit Well No. 41	Lot 15 Section 2 T-21-S, R-27-E	Projected, 1984	5,700' (Est.)	Bone Spring
Unit Well No. 42	Lot 11 Section 2 T-21-S, R-27-E	Projected, 1984	5,700' (Est.)	Bone Spring
Unit Well No. 43	NE/4 SW/4 Section 2 T-21-S, R-27-E	Projected, 1984	5,700' (Est.)	Bone Spring
Unit Well No. 44	NE/4 SE/4 Section 34 T-20-S, R-28-E	Projected, 1984	5,700' (Est.)	Bone Spring

Current gas market conditions affect the producing status of some of the Unit Wells, and some wells reflected above as producing may be intermittently shut-in.

During the period covered by this Second Revised Ninth Plan of Development and Operation for the Burton Flat Deep Unit Area, an orderly development and evaluation of the Delaware Mountain Group and Bone Spring reservoirs is planned, subject to approval, during 1984 or until the reservoirs limits have been established. Geological and production data from each well drilled within the unit boundaries or the immediate surrounding area, will be evaluated upon completion, and additional locations selected on the basis of evaluation of such data.

During the period covered by this Second Revised Ninth Plan of Development and Operation, participating areas will be determined and submitted for approval.

Workover operations on several unit wells will begin in the last quarter of 1984 to improve production. Wells slated for possible workovers include Unit Wells Nos. 2, 3, 9, 11, and 14. Presently the Working Interest Owners are studying and evaluating the geology and production data applicable to the Unit Area and immediate area surrounding the unit boundaries to determine what, if any, additional operations appear to be warranted as to the Unit Area.

The Second Revised Ninth Plan of Development and Operation shall constitute the further obligations of the Operator under the Burton Flat Deep Unit Agreement for the period ending January 1, 1985, and may be modified or supplemented from time to time with the approval of the District Manager, Bureau of Land Management, Commissioner of Public Lands, and New Mexico Oil Conservation Commission when necessary to meet changed conditions or to protect the interest of all parties to the Unit Agreement.

Approval of this Second Revised Ninth Plan of Development and Operation for the Burton Flat Deep Unit Area is respectfully requested.

Submitted this 16th day of August, 1984.

MONSANTO OIL COMPANY

BY:

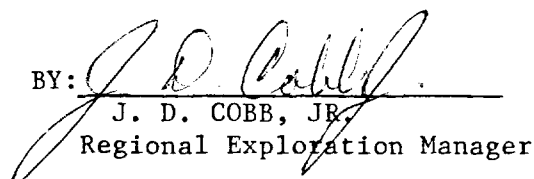
J. D. COBB, JR.
Regional Exploration Manager



STATE OF NEW MEXICO
ENERGY AND MINERALS DEPARTMENT
OIL CONSERVATION DIVISION

TONEY ANAYA
GOVERNOR

POST OFFICE BOX 2088
STATE LAND OFFICE BUILDING
SANTA FE, NEW MEXICO 87501
(505) 827-5800

August 30, 1984

Monsanto Oil Company
1300 One First City Center
500 West Texas
Midland, Texas 79701

Attention: Kevin Pfister

Re: Second Revised Ninth
Plan of Development
and Operation for the
Burton Flat Deep Unit,
Eddy County, NM

Dear Mr. Pfister:

Enclosed please find an approved copy of the material referenced above. Such approval is contingent upon like approval by the Commissioner of Public Lands and the Bureau of Land Management.

Sincerely,

A handwritten signature in cursive script, reading "Roy E. Johnson".

ROY E. JOHNSON
Petroleum Geologist

REJ/dp

cc: Commissioner of Public Lands - Santa Fe
Bureau of Land Management - Albuquerque
OCD District Office - Artesia

Monsanto Oil Company

Monsanto Oil Company
1300 One First City Center
500 West Texas
Midland, Texas 79701
Phone: (915) 683-3306

August 16, 1984

District Manager
Bureau of Land Management
Post Office Box 1397
Roswell, New Mexico 88201

The Commissioner of Public Lands
State of New Mexico
P. O. Drawer 1148
Santa Fe, New Mexico 87501

New Mexico Oil Conservation Commission
Post Office Box 2088
Santa Fe, New Mexico 87504

ATTN: Mr. Roy Johnson

Gentlemen:

RE: Second Revised Ninth Plan of
Development and Operation for
the Burton Flat Deep Unit,
Eddy County, New Mexico

Enclosed please find original documents entitled "Second Revised Ninth Plan of Development and Operation" for the Burton Flat Unit.

This document was prepared primarily (1): to indicate an additional ten (10) proposed unit wells (Nos. 34 - 44); (2): update our drilling activity and completion attempts, and (3): indicate acceptance by all governmental agencies of our Bone Springs Participating Area "A" Application.

If in order, please execute all the documents enclosed and return one executed original to me for our files. I ask that this Plan be approved as quickly as possible in order that we may proceed to drill one of our new locations which offsets production.

If I can be of any further assistance, please apprise.

Very truly yours,

Kevin Pfister
Senior Landman

KP/lab

Enclosures

SECOND REVISED NINTH PLAN OF DEVELOPMENT AND OPERATION

BURTON FLAT DEEP UNIT AREA
EDDY COUNTY, NEW MEXICO

To: District Manager
Bureau of Land Management
Post Office Box 1397
Roswell, New Mexico 88201

The Commissioner of Public Lands
State of New Mexico
P. O. Drawer 1148
Santa Fe, New Mexico 87501

New Mexico Oil Conservation Commissioner
Post Office Box 2088
Santa Fe, New Mexico 87504

ATTN: Mr. Roy Johnson

MONSANTO OIL COMPANY, as Unit Operator for the Burton Flat Deep Unit Area, pursuant to the provisions of Section 10, of the Unit Agreement for Development and Operation of the Burton Flat Deep Unit Area dated July 1, 1972 (No. 14-08-0001-12391), respectfully submits for the approval of the District Manager, Bureau of Land Management, or his duly authorized representative, the Commissioner of Public Lands, and the New Mexico Oil Conservation Commission, this Second Revised Ninth Plan of Development and Operation for the Burton Flat Deep Unit Area. This plan is for the period January 1, 1984, to January 1, 1985.

During the period covered by our First Revised Ninth Plan of Development, the Unit Operator proposed to drill Unit Wells 23, 24, 25, 27, and 32. These wells have now been drilled and the initial potentials for all wells have or will be filed with the appropriate agencies.

Monsanto has established the Bone Springs Participating Area "A" surrounding production from Wells 23, 24, 25, 27, and 32. This participating area has now been approved by the Bureau of Land Management (verbal), the Commissioner of Public Lands (written), and the New Mexico Oil Conservation Commission (written).

The following wells have been drilled and completed within the Burton Flat Deep Unit Area since August 29, 1972, which was the effective date of the Unit Agreement; additional wells (Unit Well Nos. (17-22, 26, 28-31, and 33) have been permitted which may be drilled during the period covered by this Second Revised Ninth Plan of Development and Operation. In addition, the Unit Operator is now permitting additional wells which are listed below (Wells 34 - 44).

<u>UNIT WELL</u>	<u>LOCATION</u>	<u>COMPLETION DATE</u>	<u>TOTAL</u> <u>DEPTH</u>	<u>ZONE</u>
Unit Well No. 1	Lot 15 Section 3, T-21-S, R-27-E	November 3, 1972	11,700'	Morrow (S-I)
Unit Well No. 2	Lot 6 Section 2, T-21-S, R-27-E	January 24, 1973	11,600'	Morrow (S-I)
Unit Well No. 3	SE/4 SW/4 Section 3, T-21-S, R-27-E	April 16, 1973	11,546'	Strawn (Prod) Morrow (Prod)
Unit Well No. 4	SE/4 SW/4 Section 34, T-20-S, R-28-E	July 23, 1973	11,500'	Strawn (S-I) Morrow (Prod)
Unit Well No. 5	SE/4 SW/4 Section 2, T-21-S, R-27-E	October 10, 1973	11,725'	Strawn (S-I)
Unit Well No. 6	SW/4 NE/4 Section 34, T-20-S, R-28-E	November 5, 1973	11,450'	Morrow (Prod)
Unit Well No. 7	NE/4 SE/4 Section 33, T-20-S, R-28-E	November 19, 1973 (Recompleted to Wolfcamp 6/16/78)	11,540'	Wolfcamp (S-I)
Unit Well No. 8	SW/4 SE/4 Section 27, T-20-S, R-28-E	January 3, 1974	11,460'	Morrow (Prod)

<u>UNIT WELL</u>	<u>LOCATION</u>	<u>COMPLETION DATE</u>	<u>TOTAL DEPTH</u>	<u>ZONE</u>
Unit Well No. 9	SW/4 NW/4 Section 35, T-20-S, R-28-E	March 5, 1974	11,540'	Strawn (S-I) Morrow (S-I)
Unit Well No. 11	NW/4 NE/4 Section 27, T-20-S, R-28-E	May 28, 1974	11,500'	Morrow (Prod)
Unit Well No. 12	NE/4 NW/4 Section 26, T-20-S, R-28-E	May 1, 1975	11,475'	Wolfcamp (S-I)
Unit Well No. 13	SW/4 SE/4 Section 28, T-20-S, R-28-E	December 26, 1974	11,560'	Morrow (S-I)
Unit Well No. 14	Lot 13 Section 2, T-21-S, R-27-E	June 26, 1975	11,610'	Morrow (Prod)
Unit Well No. 15	SE/4 NW/4 Section 27, T-20-S, R-28-E	February 6, 1984	5,600'	Bone Spring
Unit Well No. 16	NE/4 SW/4 Section 3, T-21-S, R-27-E	Reached Total Depth January 9, 1984	5,500'	Bone Spring
Unit Well No. 17	SW/4 NW/4 Section 27, T-20-S, R-28-E	Projected, 1984	5,300' (Est.)	Delaware
Unit Well No. 18	SW/4 NE/4 Section 27, T-20-S, R-28-E	Projected, 1984	5,200' (Est.)	Delaware
Unit Well No. 19	NE/4 SW/4 Section 27, T-20-S, R-28-E	Projected, 1984	5,300' (Est.)	Delaware
Unit Well No. 20	NW/4 SW/4 Section 3, T-21-S, R-27-E	Projected, 1984	5,200' (Est.)	Delaware
Unit Well No. 21	Lot 14 Section 3, T-21-S, R-27-E	Projected, 1984	5,200' (Est.)	Delaware
Unit Well No. 22	NW/4 SE/4 Section 3, T-21-S, R-27-E	Projected, 1984	5,200' (Est.)	Delaware
Unit Well No. 23	Lot 8 Section 2, T-21-S, R-27-E	March 1, 1984	5,700'	Bone Spring
Unit Well No. 24	Lot 1 Section 2, T-21-S, R-27-E	May 20, 1984	6,000'	Bone Spring
Unit Well No. 25	Lot 9 Section 2, T-21-S, R-27-E	Reached Total Depth on August 11, 1984	5,700'	Bone Spring
Unit Well No. 26	Lot 2 Section 2, T-21-S, R-27-E	Projected, 1984	5,700' (Est.)	Bone Spring
Unit Well No. 27	Lot 7 Section 2, T-21-S, R-27-E	May 25, 1984	6,250'	Bone Spring
Unit Well No. 28	Lot 10 Section 2, T-21-S, R-27-E	Projected, 1984	5,700' (Est.)	Bone Spring
Unit Well No. 29	Lot 3 Section 2, T-21-S, R-27-E	Projected, 1984	5,700' (Est.)	Bone Spring
Unit Well No. 30	SW/4 SE/4 Section 34, T-20-S, R-28-E	Projected, 1984	5,700' (Est.)	Bone Spring
Unit Well No. 31	SE/4 SE/4 Section 34, T-20-S, R-28-E	Projected, 1984	5,700' (Est.)	Bone Spring
Unit Well No. 32	SW/4 SW/4 Section 35, T-20-S, R-28-E	August 7, 1984	5,700'	Bone Spring
Unit Well No. 33	SE/4 SW/4 Section 35, T-20-S, R-28-E	Projected, 1984	5,700' (Est.)	Bone Spring
Unit Well No. 34	SW/4 NW/4 Section 26 T-20-S, R-28-E	Projected, 1984	5,700' (Est.)	Bone Spring
Unit Well No. 35	NE/4 SW/4 Section 2 T-21-S, R-27-E	Projected, 1984	5,700' (Est.)	Bone Spring
Unit Well No. 36	Lot 16 Section 2 T-20-S, R-28-E	Projected, 1984	5,700' (Est.)	Bone Spring

<u>UNIT WELL</u>	<u>LOCATION</u>	<u>COMPLETION DATE</u>	<u>TOTAL DEPTH</u>	<u>ZONE</u>
Unit Well No. 37	NE/4 SE/4 Section 2 T-20-S, R-28-E	Projected, 1984	5,700' (Est.)	Bone Spring
Unit Well No. 38	SE/4 SE/4 Section 2 T-20-S, R-28-E	Projected, 1984	5,700' (Est.)	Bone Spring
Unit Well No. 39	SW/4 SE/4 Section 2 T-20-S, R-28-E	Projected, 1984	5,700' (Est.)	Bone Spring
Unit Well No. 40	NW/4 SE/4 Section 2 T-20-S, R-28-E	Projected, 1984	5,700' (Est.)	Bone Spring
Unit Well No. 41	Lot 15 Section 2 T-20-S, R-28-E	Projected, 1984	5,700' (Est.)	Bone Spring
Unit Well No. 42	Lot 11 Section 2 T-20-S, R-28-E	Projected, 1984	5,700' (Est.)	Bone Spring
Unit Well No. 43	NE/4 SW/4 Section 35 T-20-S, R-28-E	Projected, 1984	5,700' (Est.)	Bone Spring
Unit Well No. 44	NE/4 SE/4 Section 34 T-20-S, R-28-E	Projected, 1984	5,700' (Est.)	Bone Spring

Current gas market conditions affect the producing status of some of the Unit Wells, and some wells reflected above as producing may be intermittently shut-in.

During the period covered by this Second Revised Ninth Plan of Development and Operation for the Burton Flat Deep Unit Area, an orderly development and evaluation of the Delaware Mountain Group and Bone Spring reservoirs is planned, subject to approval, during 1984 or until the reservoirs limits have been established. Geological and production data from each well drilled within the unit boundaries or the immediate surrounding area, will be evaluated upon completion, and additional locations selected on the basis of evaluation of such data.

During the period covered by this Second Revised Ninth Plan of Development and Operation participating areas will be determined and submitted for approval.

Workover operations on several unit wells will begin in the last quarter of 1984 to improve production. Wells slated for possible workovers include Unit Wells Nos. 2, 3, 9, 11, and 14. Presently the Working Interest Owners are studying and evaluating the geology and production data applicable to the Unit Area and immediate area surrounding the unit boundaries to determine what, if any, additional operations appear to be warranted as to the Unit Area.

The Second Revised Ninth Plan of Development and Operation shall constitute the further obligations of the Operator under the Burton Flat Deep Unit Agreement for the period ending January 1, 1985, and may be modified or supplemented from time to time with the approval of the District Manager, Bureau of Land Management, Commissioner of Public Lands, and New Mexico Oil Conservation Commission when necessary to meet changed conditions or to protect the interest of all parties to the Unit Agreement.

Approval of this Second Revised Ninth Plan of Development and Operation for the Burton Flat Deep Unit Area is respectfully requested.

Submitted this 16th day of August, 1984.

MONSANTO OIL COMPANY

BY:

J. D. COBB, JR.

Regional Exploration Manager

APPROVED this _____ day of _____, 1984,
subject to approval by the Commissioner of Public
Lands, State of New Mexico, and New Mexico Oil
Conservation Commission.

BUREAU OF LAND MANAGEMENT
District Manager

APPROVED this _____ day of _____, 1984,
subject to approval by the District Manager,
Bureau of Land Management and New Mexico Oil
Conservation Commission.

THE COMMISSIONER OF PUBLIC LANDS
State of New Mexico

APPROVED this 28 day of August, 1984,
subject to like approval by the District Manager,
Bureau of Land Management, and the Commissioner
of Public Lands, State of New Mexico.

NEW MEXICO OIL CONSERVATION COMMISSION

BY: _____

TITLE: _____

Senior Petroleum Geologist

State of New Mexico



JIM BACA
COMMISSIONER

Commissioner of Public Lands

July 26, 1984

P.O. BOX 1148
SANTA FE, NEW MEXICO 87504-1148
Express Mail Delivery Uses
310 Old Santa Fe Trail
Santa Fe, New Mexico 87501

Monsanto Oil Company
1300 One First City Center
500 West Texas
Midland, Texas 79701

Re: Application for Initial Participating
Area "A" for Bone Springs Formation
Burton Flat Deep Unit Agreement
Eddy County, New Mexico

ATTENTION: Mr. Kevin Pfister

Gentlemen:

This office is in receipt of your Geologic and Engineering Report in conjunction with your commercial determination of the Burton Flat Deep Unit Well Nos. 23, 24, 27 and your application for approval of the Initial Participating Area "A" for the Bone Springs Formation. This office concurs with your determination that the Unit Well Nos. 23, 24 and 27 are capable of producing unitized substances in paying quantities from the Bone Springs formation.

This office has also approved your application for approval of the Initial Participating Area "A", Bone Springs Formation for the Burton Flat Deep Unit Agreement. The Initial Participating Area "A" includes 754.62 acres described as the SE/4 Sec. 34, SW/4 Sec. 35, T-20S, R-28E, Lots 1 thru 12, Sec. 2, T-20S, R-27E. Our approval is subject to like approval by the New Mexico Oil Conservation Division and the Bureau of Land Management.

Enclosed is an approved copy for your files.

Very truly yours,

JIM BACA
COMMISSIONER OF PUBLIC LANDS

BY:
RAY D. GRAHAM, Director
Oil and Gas Division
AC 505/827-5744

JLB:RPG/pm
encls.
cc:

OCD-Santa Fe, New Mexico
BLM-Albuquerque, New Mexico
BLM-Roswell, New Mexico

Monsanto Oil Company

1300 One First City Center
500 West Texas
Midland, Texas 79701
Phone: (915) 683-3306
August 1, 1984

New Mexico Oil Conservation Commission
Post Office Box 2088
Santa Fe, New Mexico 87504

ATTN: Mr. Roy Johnson

Gentlemen:

RE: Application for Initial
Participating Area "A"
Bone Springs Formation
Burton Flat Deep Unit
Eddy County, New Mexico

Through oversight, Monsanto failed to provide you with the above referenced document for your approval. If acceptable, please execute both documents and return one copy to me for further handling. (Both the Commissioner of Public Lands and the Bureau of Land Management have approved the Initial Participating Area "A".)

Also enclosed for your information are the Ninth and Revised Ninth Plans of Development and Operation for the Burton Flat Unit.

If I may be of any further assistance in this regard, please apprise.

Very truly yours,

Kevin Pfister
Kevin Pfister
Senior Landman

KP/1

Enc1

Dot -
Enclosed please
find unit letter -

Thy
R



JIM BACA
COMMISSIONER

State of New Mexico



Commissioner of Public Lands

April 2, 1984

RECEIVED
LAND DEPT.

APR 05 1984

P.O. BOX 1148
SANTA FE, NEW MEXICO 87504-1148
Express Mail Delivery Used
310 Old Santa Fe Trail
Santa Fe, New Mexico 87501

Monsanto Oil Company
1300 One First City Center
500 West Texas
Midland, Texas 79701

Re: Revised Ninth Plan of
Development and Operation,
Burton Flat Deep Unit Area,
Eddy County, New Mexico

ATTENTION: Ms. Marianne Giles

Gentlemen:

The Commissioner of Public Lands has this date approved your Revised Ninth Plan of Development and Operation for the Burton Flat Deep Unit Area, Eddy County, New Mexico, covering the period of January 1, 1984 to January 1, 1985. Such plan proposes to possibly drill the Unit Well Nos. 17 through 22 and 24 through 33. Also planned is the evaluation of the Delaware Mountain Group and Bone Spring reservoirs.

Our approval is subject to like approval by the Bureau of Land Management.

Enclosed is an approved copy for your files.

Very truly yours,

JIM BACA
COMMISSIONER OF PUBLIC LANDS

BY: *Ray D. Graham*
RAY D. GRAHAM, Director
Oil and Gas Division
AC 505/827-5744

JB/RDG/pm
encls.
cc:

CCD-Santa Fe, New Mexico
BLM-Albuquerque, New Mexico
BLM-Roswell, New Mexico Attn: Mr. Armando Lopez



United States Department of the Interior

BUREAU OF LAND MANAGEMENT

Roswell District Office

P. O. Box 1397

Roswell, New Mexico 88201

RECEIVED
LAND DEPT.

APR 05 1984

IN REPLY
REFER TO:

Burton Flat
Deep Unit

April 3, 1984

Monsanto Oil Company
Attention: Mrs. Marianne Giles
1300 One First City Center
500 West Texas
Midland, TX 79701

Gentlemen:

Enclosed is an approved copy of your Revised Ninth Plan of Development and Operation for the Burton Flat Deep Unit Area, Eddy County, New Mexico, covering the period January 1, 1984 to January 1, 1985. This plan, proposing an orderly development of the Delaware Mountain Group and Bone Springs reservoirs through additional wells (Unit Wells No. 17 through 22 and 24 through 33) and workovers (Unit Well Nos. 2, 3, 9, 11 and 14) which may be completed during 1984, was approved this date, subject to like approval by the New Mexico Commissioner of Public Lands and the New Mexico Oil Conservation Division.

In subsequent plans of development please continue to provide statistical data on production and/or decline curves on producing wells.

Sincerely yours

Earl R. Cunningham
District Manager

Enclosure (1)

REVISED NINTH PLAN OF DEVELOPMENT AND OPERATION

BURTON FLAT DEEP UNIT AREA
EDDY COUNTY, NEW MEXICO

To: District Manager
Bureau of Land Management
Post Office Box 1397
Roswell, New Mexico 88201

The Commissioner of Public Lands
State of New Mexico
P. O. Drawer 1148
Santa Fe, New Mexico 87501

MONSANTO OIL COMPANY, as Unit Operator for the Burton Flat Deep Unit Area, pursuant to the provisions of Section 10, of the Unit Agreement for Development and Operation of the Burton Flat Deep Unit Area dated July 1, 1972 (No. 14-08-0001-12391), respectfully submits for the approval of the District Manager, Bureau of Land Management, or his duly authorized representative and of the Commissioner of Public Lands, this Revised Ninth Plan of Development and Operation for the Burton Flat Deep Unit Area. This plan is for the period January 1, 1984, to January 1, 1985.

During the period covered by the Eighth Plan of Development (Revised), the Unit Operator proposed to drill Unit Well No. 15 located in Section 27, T-20-S, R-28-E, and Unit Well No. 1 located in Section 3, T-21-S, R-27-E. These wells, along with Unit Well No. 23, have now been drilled and the initial potentials for said wells will be filed with the appropriate agencies. The following wells have been drilled and completed within the Burton Flat Deep Unit Area since August 29, 1972, which was the effective date of the Unit Agreement; additional wells (Unit Well No. 17 through 22 and 24 through 33) have been permitted which may be drilled during the period covered by this Revised Ninth Plan of Development and Operation as reflected below:

	<u>LOCATION</u>	<u>COMPLETION DATE</u>	<u>TOTAL DEPTH</u>	<u>ZONE</u>
Unit Well No. 1	Lot 15, Section 3, T-21-S, R-27-E	November 3, 1972	11,700'	Morrow (S-I)
Unit Well No. 2	Lot 6, Section 2, T-21-S, R-27-E	January 24, 1973	11,600'	Morrow (S-I)
Unit Well No. 3	SE/4 SW/4 Section 3, T-21-S, R-27-E	April 16, 1973	11,546'	Strawn (Prod) Morrow (Prod)
Unit Well No. 4	SE/4 SW/4 Section 34, T-20-S, R-28-E	July 23, 1973	11,500'	Strawn (S-I) Morrow (Prod)
Unit Well No. 5	SE/4 SW/4 Section 2, T-21-S, R-27-E	October 10, 1973	11,725'	Strawn (S-I)
Unit Well No. 6	SW/4 NE/4 Section 34, T-20-S, R-28-E	November 5, 1973	11,450'	Morrow (Prod)
Unit Well No. 7	NE/4 SE/4 Section 33, T-20-S, R-28-E	November 19, 1973 (Recompleted to Wolfcamp 6/16/78)	11,540'	Wolfcamp (S-I)
Unit Well No. 8	SW/4 SE/4 Section 27, T-20-S, R-28-E	January 3, 1974	11,460'	Morrow (Prod)
Unit Well No. 9	SW/4 NW/4 Section 35, T-20-S, R-28-E	March 5, 1974	11,540'	Strawn (S-I) Morrow (S-I)
Unit Well No. 11	NW/4 NE/4 Section 27, T-20-S, R-28-E	May 28, 1974	11,500'	Morrow (Prod)
Unit Well No. 12	NE/4 NW/4 Section 26, T-20-S, R-28-E	May 1, 1975	11,475'	Wolfcamp (S-I)
Unit Well No. 13	SW/4 SE/4 Section 28, T-20-S, R-28-E	December 26, 1974	11,560'	Morrow (S-I)
Unit Well No. 14	Lot 13 Section 2, T-21-S, R-27-E	June 26, 1975	11,610'	Morrow (Prod)

	<u>LOCATION</u>	<u>COMPLETION DATE</u>	<u>TOTAL DEPTH</u>	<u>ZONE</u>
Unit Well No. 15	SW/4 NE/4 Section 27, T-20-S, R-28-E	February 6, 1984	5,600'	Bone Spring
Unit Well No. 16	NE/4 SW/4 Section 3, T-21-S, R-27-E	Reached Total Depth January 9, 1984	5,500'	Bone Spring
Unit Well No. 17	SW/4 NW/4 Section 27, T-20-S, R-28-E	Projected, 1984	5,300' (Est.)	Delaware
Unit Well No. 18	SW/4 NE/4 Section 27, T-20-S, R-28-E	Projected, 1984	5,200' (Est.)	Delaware
Unit Well No. 19	NE/4 SW/4 Section 27, T-20-S, R-28-E	Projected, 1984	5,300' (Est.)	Delaware
Unit Well No. 20	NW/4 SW/4 Section 3, T-21-S, R-27-E	Projected, 1984	5,200' (Est.)	Delaware
Unit Well No. 21	NE/4 NW/4 Section 3, T-21-S, R-27-E	Projected, 1984	5,200' (Est.)	Delaware
Unit Well No. 22	NW/4 SE/4 Section 3, T-21-S, R-27-E	Projected, 1984	5,200' (Est.)	Delaware
Unit Well No. 23	SE/4 NE/4 Section 2, T-21-S, R-27-E	Reached Total Depth February 13, 1984	5,700'	Bone Spring
Unit Well No. 24	NE/4 NE/4 Section 2, T-21-S, R-27-E	Projected, 1984	5,700' (Est.)	Bone Spring
Unit Well No. 25	NE/4 SE/4 Section 2, T-21-S, R-27-E	Projected, 1984	5,700' (Est.)	Bone Spring
Unit Well No. 26	NW/4 NE/4 Section 2, T-21-S, R-27-E	Projected, 1984	5,700' (Est.)	Bone Spring
Unit Well No. 27	SW/4 NE/4 Section 2, T-21-S, R-27-E	Projected, 1984	5,700' (Est.)	Bone Spring
Unit Well No. 28	NW/4 SE/4 Section 2, T-21-S, R-27-E	Projected, 1984	5,700' (Est.)	Bone Spring
Unit Well No. 29	NE/4 NW/4 Section 2, T-21-S, R-27-E	Projected, 1984	5,700' (Est.)	Bone Spring
Unit Well No. 30	SW/4 SE/4 Section 2, T-20-S, R-28-E	Projected, 1984	5,700' (Est.)	Bone Spring
Unit Well No. 31	SE/4 SE/4 Section 34, T-20-S, R-28-E	Projected, 1984	5,700' (Est.)	Bone Spring
Unit Well No. 32	SW/4 SW/4 Section 35, T-20-S, R-28-E	Projected, 1984	5,700' (Est.)	Bone Spring
Unit Well No. 33	SE/4 SW/4 Section 35, T-20-S, R-28-E	Projected, 1984	5,700' (Est.)	Bone Spring

Current gas market conditions affect the producing status of the Unit Wells, and well reflected above as producing may be intermittently shut-in.

During the period covered by this Revised Ninth Plan of Development and Operation for the Burton Flat Deep Unit Area, an orderly development and evaluation of the Delaware Mountain Group and Bone Spring reservoirs is planned, subject to approval, during 1984 or until the reservoir limits have been established. Geological and production data from each well drilled within the unit boundaries or the immediate surrounding area, will be evaluated upon completion, and additional locations selected on the basis of evaluation of such data.

During the period covered by this Revised Ninth Plan of Development and Operation, participating areas will be determined and submitted for approval as each well is completed.

REVISED NINTH PLAN OF DEVELOPMENT AND OPERATION

BURTON FLAT DEEP UNIT AREA
EDDY COUNTY, NEW MEXICO

To: District Manager
Bureau of Land Management
Post Office Box 1397
Roswell, New Mexico 88201

The Commissioner of Public Lands
State of New Mexico
P. O. Drawer 1148
Santa Fe, New Mexico 87501

MONSANTO OIL COMPANY, as Unit Operator for the Burton Flat Deep Unit Area, pursuant to the provisions of Section 10, of the Unit Agreement for Development and Operation of the Burton Flat Deep Unit Area dated July 1, 1972 (No. 14-08-0001-12391), respectfully submits for the approval of the District Manager, Bureau of Land Management, or his duly authorized representative and of the Commissioner of Public Lands, this Revised Ninth Plan of Development and Operation for the Burton Flat Deep Unit Area. This plan is for the period January 1, 1984, to January 1, 1985.

During the period covered by the Eighth Plan of Development (Revised), the Unit Operator proposed to drill Unit Well No. 15 located in Section 27, T-20-S, R-28-E, and Unit Well No. 1 located in Section 3, T-21-S, R-27-E. These wells, along with Unit Well No. 23, have now been drilled and the initial potentials for said wells will be filed with the appropriate agencies. The following wells have been drilled and completed within the Burton Flat Deep Unit Area since August 29, 1972, which was the effective date of the Unit Agreement; additional wells (Unit Well No. 17 through 22 and 24 through 33) have been permitted which may be drilled during the period covered by this Revised Ninth Plan of Development and Operation as reflected below:

	<u>LOCATION</u>	<u>COMPLETION DATE</u>	<u>TOTAL DEPTH</u>	<u>ZONE</u>
Unit Well No. 1	Lot 15, Section 3, T-21-S, R-27-E	November 3, 1972	11,700'	Morrow (S-I)
Unit Well No. 2	Lot 6, Section 2, T-21-S, R-27-E	January 24, 1973	11,600'	Morrow (S-I)
Unit Well No. 3	SE/4 SW/4 Section 3, T-21-S, R-27-E	April 16, 1973	11,546'	Strawn (Prod) Morrow (Prod)
Unit Well No. 4	SE/4 SW/4 Section 34, T-20-S, R-28-E	July 23, 1973	11,500'	Strawn (S-I) Morrow (Prod)
Unit Well No. 5	SE/4 SW/4 Section 2, T-21-S, R-27-E	October 10, 1973	11,725'	Strawn (S-I)
Unit Well No. 6	SW/4 NE/4 Section 34, T-20-S, R-28-E	November 5, 1973	11,450'	Morrow (Prod)
Unit Well No. 7	NE/4 SE/4 Section 33, T-20-S, R-28-E	November 19, 1973 (Recompleted to Wolfcamp 6/16/78)	11,540'	Wolfcamp (S-I)
Unit Well No. 8	SW/4 SE/4 Section 27, T-20-S, R-28-E	January 3, 1974	11,460'	Morrow (Prod)
Unit Well No. 9	SW/4 NW/4 Section 35, T-20-S, R-28-E	March 5, 1974	11,540'	Strawn (S-I) Morrow (S-I)
Unit Well No. 11	NW/4 NE/4 Section 27, T-20-S, R-28-E	May 28, 1974	11,500'	Morrow (Prod)
Unit Well No. 12	NE/4 NW/4 Section 26, T-20-S, R-28-E	May 1, 1975	11,475'	Wolfcamp (S-I)
Unit Well No. 13	SW/4 SE/4 Section 28, T-20-S, R-28-E	December 26, 1974	11,560'	Morrow (S-I)
Unit Well No. 14	Lot 13 Section 2, T-21-S, R-27-E	June 26, 1975	11,610'	Morrow (Prod)

		<u>LOCATION</u>	<u>COMPLETION DATE</u>	<u>TOTAL DEPTH</u>	<u>ZONE</u>
Unit Well No. 15	SE/4 NW/4 ^{RAM} SW/4 NE/4 Section 27, 4-3-84	T-20-S, R-28-E	February 6, 1984	5,600'	Bone Spring
Unit Well No. 16	NE/4 SW/4 Section 3,	T-21-S, R-27-E	Reached Total Depth January 9, 1984	5,500'	Bone Spring
Unit Well No. 17	SW/4 NW/4 Section 27,	T-20-S, R-28-E	Projected, 1984	5,300' (Est.)	Delaware
Unit Well No. 18	SW/4 NE/4 Section 27,	T-20-S, R-28-E	Projected, 1984	5,200' (Est.)	Delaware
Unit Well No. 19	NE/4 SW/4 Section 27,	T-20-S, R-28-E	Projected, 1984	5,300' (Est.)	Delaware
Unit Well No. 20	NW/4 SW/4 Section 3,	T-21-S, R-27-E	Projected, 1984	5,200' (Est.)	Delaware
Unit Well No. 21	^{RAM} NE/4 NW/4 Section 3, 4-3-84	T-21-S, R-27-E	Projected, 1984	5,200' (Est.)	Delaware
Unit Well No. 22	NW/4 SE/4 Section 3,	T-21-S, R-27-E	Projected, 1984	5,200' (Est.)	Delaware
Unit Well No. 23	^{RAM} SE/4 NE/4 Section 2, 4-3-84	T-21-S, R-27-E	Reached Total Depth February 13, 1984	5,700'	Bone Spring
Unit Well No. 24	^{RAM} NE/4 NE/4 Section 2, 4-3-84	T-21-S, R-27-E	Projected, 1984	5,700' (Est.)	Bone Spring
Unit Well No. 25	^{RAM} NE/4 SE/4 Section 2, 4-3-84	T-21-S, R-27-E	Projected, 1984	5,700' (Est.)	Bone Spring
Unit Well No. 26	^{RAM} NW/4 NE/4 Section 2, 4-3-84	T-21-S, R-27-E	Projected, 1984	5,700' (Est.)	Bone Spring
Unit Well No. 27	^{RAM} SW/4 NE/4 Section 2, 4-3-84	T-21-S, R-27-E	Projected, 1984	5,700' (Est.)	Bone Spring
Unit Well No. 28	^{RAM} NW/4 SE/4 Section 2, 4-3-84	T-21-S, R-27-E	Projected, 1984	5,700' (Est.)	Bone Spring
Unit Well No. 29	^{RAM} NE/4 NW/4 Section 2, 4-3-84	T-21-S, R-27-E	Projected, 1984	5,700' (Est.)	Bone Spring
Unit Well No. 30	^{34 RAM} SW/4 SE/4 Section 2, 4-3-84	T-20-S, R-28-E	Projected, 1984	5,700' (Est.)	Bone Spring
Unit Well No. 31	SE/4 SE/4 Section 34,	T-20-S, R-28-E	Projected, 1984	5,700' (Est.)	Bone Spring
Unit Well No. 32	SW/4 SW/4 Section 35,	T-20-S, R-28-E	Projected, 1984	5,700' (Est.)	Bone Spring
Unit Well No. 33	SE/4 SW/4 Section 35,	T-20-S, R-28-E	Projected, 1984	5,700' (Est.)	Bone Spring

Current gas market conditions affect the producing status of the Unit Wells, and well reflected above as producing may be intermittently shut-in.

During the period covered by this Revised Ninth Plan of Development and Operation for the Burton Flat Deep Unit Area, an orderly development and evaluation of the Delaware Mountain Gro and Bone Spring reservoirs is planned, subject to approval, during 1984 or until the reservoir limits have been established. Geological and production data from each well drilled within the unit boundaries or the immediate surrounding area, will be evaluated upon completion, and additional locations selected on the basis of evaluation of such data.

During the period covered by this Revised Ninth Plan of Development and Operation participating areas will be determined and submitted for approval as each well is completed.

Workover operations on several unit wells will begin in the second quarter of 1984 to improve production. Wells slated for possible workovers include Unit Wells Nos. 2, 3, 9, 11, and 14. Presently the Working Interest Owners are studying and evaluating the geology and production data applicable to the Unit Area and immediate area surrounding the unit boundaries to determine what, if any, additional operations appear to be warranted as to the Unit Area.

The Revised Ninth Plan of Development and Operation shall constitute the further obligation of the Operator under the Burton Flat Deep Unit Agreement for the period ending January 1, 1985 and may be modified or supplemented from time to time with the approval of the Associate District Manager, Bureau of Land Management and the Commissioner of Public Lands when necessary to meet changed conditions or to protect the interest of all parties to the Unit Agreement.

Approval of this Revised Ninth Plan of Development and Operation for the Burton Flat Deep Unit Area is respectfully requested.

Submitted this _____ day of April, 1984.

MONSANTO OIL COMPANY

BY:

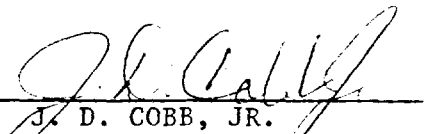
J. D. COBB, JR.
Regional Exploration Manager

APPROVED this _____ day of _____, 1984,
subject to approval by the Commissioner of Public
Lands, State of New Mexico.

BUREAU OF LAND MANAGEMENT
~~Associate~~ District Manager

APPROVED this _____ day of _____, 1984,
subject to approval by the ~~Associate~~ District Manager,
Bureau of Land Management.

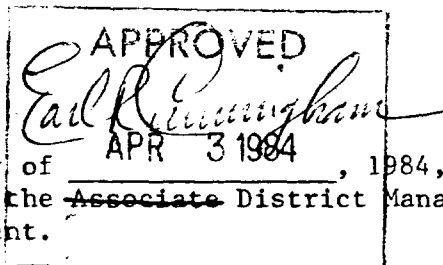

THE COMMISSIONER OF PUBLIC LANDS
State of New Mexico

Workover operations on several unit wells will begin in the second quarter of 1984 to improve production. Wells slated for possible workovers include Unit Wells Nos. 2, 3, 9, 11, and 14. Presently the Working Interest Owners are studying and evaluating the geology and production data applicable to the Unit Area and immediate area surrounding the unit boundaries to determine what, if any, additional operations appear to be warranted as to the Unit Area.

The Revised Ninth Plan of Development and Operation shall constitute the further obligation of the Operator under the Burton Flat Deep Unit Agreement for the period ending January 1, 1985 and may be modified or supplemented from time to time with the approval of the Associate District Manager, Bureau of Land Management and the Commissioner of Public Lands when necessary to meet changed conditions or to protect the interest of all parties to the Unit Agreement.

Approval of this Revised Ninth Plan of Development and Operation for the Burton Flat Deep Unit Area is respectfully requested.

Submitted this _____ day of April, 1984.

MONSANTO OIL COMPANY

BY: 

J. D. COBB, JR.

Regional Exploration Manager

APPROVED this _____ day of _____, 1984,
subject to approval by the Commissioner of Public
Lands, State of New Mexico.

BUREAU OF LAND MANAGEMENT
Associate District Manager

APPROVED this 3rd day of April, 1984,
subject to approval by the Associate District Manager,
Bureau of Land Management.



THE COMMISSIONER OF PUBLIC LANDS
State of New Mexico



United States Department of the Interior

BUREAU OF LAND MANAGEMENT

Roswell District Office

P. O. Box 1397

Roswell, New Mexico 88201

RECEIVED
LAND DEPT.

JAN 27 1984

IN REPLY
REFER TO:
No. 14-08-
0001-12391

January 26, 1984

Monsanto Oil Company
Attn: Kevin Pfister
1300 One First City Center
500 West Texas
Midland, Texas 79701

Gentlemen:

Three approved copies of your Ninth Plan of Development for the Burton Flat Deep Unit, Eddy County, New Mexico, covering the period January 1, 1984 through December 31, 1984, are enclosed. Such plan, proposing the evaluation and development of the Delaware Mountain Group reservoir and possible workover operations for well numbers 2, 3, 9, 11, and 14, is approved on this date subject to like approval by the State of New Mexico.

In subsequent plans of development please continue to provide statistical data on production and/or decline curves of producing wells.

Sincerely Yours,

~~Associate~~ District Manager

State of New Mexico



JIM BACA
COMMISSIONER



Commissioner of Public Lands

January 18, 1984

P.O. BOX 1148
SANTA FE, NEW MEXICO 87504-1148

Monsanto Oil Company
1300 One First City Center
500 West Texas
Midland, Texas 79701

Re: Ninth Plan of Development
and Operation for the
Burton Flat Deep Unit
Eddy County, New Mexico

ATTENTION: Mr. Kevin Pfister

Gentlemen:

The Commissioner of Public Lands has this date approved your Ninth Plan of Development and Operation for the Burton Flat Deep Unit, Area, Eddy County, New Mexico, covering the period of January 1, 1984 to January 1, 1985. Such plan proposes to evaluate the Delaware Mountain Group Reservoir and select additional locations based on such evaluation data, determine and submit participating areas for approval as each well is completed and conduct work-over operations on several unit wells.

Our approval is subject to like approval by the Bureau of Land Management.

Enclosed is an approved copy for your files.

Very truly yours,

JIM BACA
COMMISSIONER OF PUBLIC LANDS

BY: *Ray D. Graham*
RAY D. GRAHAM, Director
Oil and Gas Division
AC 505/827-5744

JB/RDG/pm
encls.

cc: OCD-Santa Fe, New Mexico
BLM-Albuquerque, New Mexico
BLM-Roswell, New Mexico

RECEIVED
LAND DEPT.

RECEIVED
LAND DEPT.

JAN 20 1984

JAN 20 1984

NINTH PLAN OF DEVELOPMENT AND OPERATION

BURTON FLAT DEEP UNIT AREA
EDDY COUNTY, NEW MEXICO

To: District Manager
Bureau of Land Management
Post Office Box 1397
Roswell, New Mexico 88201

The Commissioner of Public Lands
State of New Mexico
P. O. Drawer 1148
Santa Fe, New Mexico 87501

MONSANTO OIL COMPANY, as Unit Operator for the Burton Flat Deep Unit Area, pursuant to the provisions of Section 10, of the Unit Agreement for Development and Operation of the Burton Flat Deep Unit Area dated July 1, 1972 (No. 14-08-0001-12391), respectfully submits for the approval of the District Manager, Bureau of Land Management, or his duly authorized representative, and of the Commissioner of Public Lands, this Ninth Plan of Development and Operation for the Burton Flat Deep Unit Area. This plan is for the period January 1, 1984, to January 1, 1985.

During the period covered by the Eighth Plan of Development (Revised), the Unit Operator proposed to drill Unit Well No. 15 located in Section 27, T-20-S, R-28-E, and Unit Well No. 16 located in Section 3, T-21-S, R-27-E. These wells were proposed to be completed prior to January 1, 1984, and the initial potentials for said wells will be filed with the appropriate agencies. The following wells have been drilled and completed within the Burton Flat Deep Unit Area since August 29, 1972, which was the effective date of the Unit Agreement:

	<u>LOCATION</u>	<u>COMPLETION DATE</u>	<u>TOTAL DEPTH</u>	<u>ZONE</u>
Unit Well No. 1	Lot 15, Section 3, T-21-S, R-27-E	November 3, 1972	11,700'	Morrow (S-I)
Unit Well No. 2	Lot 6, Section 2, T-21-S, R-27-E	January 24, 1973	11,600'	Morrow (S-I)
Unit Well No. 3	SE/4 SW/4 Section 3, T-21-S, R-27-E	April 16, 1973	11,546'	Strawn (S-I) Morrow (Prod)
Unit Well No. 4	SE/4 SW/4 Section 34, T-20-S, R-28-E	July 23, 1973	11,500'	Strawn (S-I) Morrow (Prod)
Unit Well No. 5	SE/4 SW/4 Section 2, T-21-S, R-27-E	October 10, 1973	11,725'	Strawn (S-I)
Unit Well No. 6	SW/4 NE/4 Section 34, T-20-S, R-28-E	November 5, 1973	11,450'	Morrow (S-I)
Unit Well No. 7	NE/4 SE/4 Section 33, T-20-S, R-28-E	November 19, 1973 (Recompleted to Wolfcamp 6/16/78)	11,540'	Wolfcamp (S-I)
Unit Well No. 8	SW/4 SE/4 Section 27, T-20-S, R-28-E	January 3, 1974	11,460'	Morrow (S-I)
Unit Well No. 9	SW/4 NW/4 Section 35, T-20-S, R-28-E	March 5, 1974	11,540'	Strawn (S-I) Morrow (S-I)
Unit Well No. 11	NW/4 NE/4 Section 27, T-20-S, R-28-E	May 28, 1974	11,500'	Morrow (Prod)
Unit Well No. 12	NE/4 NW/4 Section 26, T-20-S, R-28-E	May 1, 1975	11,475'	Wolfcamp (S-I)
Unit Well No. 13	SW/4 SE/4 Section 28, T-20-S, R-28-E	December 26, 1974	11,560'	Morrow (S-I)
Unit Well No. 14	Lot 13 Section 2, T-21-S, R-27-E	June 26, 1975	11,610'	Morrow (S-I)
Unit Well No. 15	SW/4 NE/4 Section 27, T-20-S, R-28-E	December 1983 (Projected)	5,600' (Est.)	Delaware Mt.
Unit Well No. 16	NE/4 SW/4 Section 3, T-21-S, R-27-E	December 1983 (Projected)	5,600' (Est.)	Delaware Mt.

During the period covered by this Ninth Plan of Development and Operation for the Burton Flat Deep Unit Area, an orderly development and evaluation of the Delaware Mountain Group reservoir is planned, subject to approval, during 1984 or until the reservoir limits have been established. Geological and production data from each well drilled within the unit boundaries or the immediate surrounding area, will be evaluated upon completion, and additional locations selected on the basis of evaluation of such data.

During the period covered by this Ninth Plan of Development and Operation, participating areas will be determined and submitted for approval as each well is completed.

Workover operations on several unit wells will begin in the second quarter of 1984 to improve production. Wells slated for possible workovers include Unit Wells Nos. 2, 3, 9, 11, and 14. Presently the Working Interest Owners are studying and evaluating the geology and production data applicable to the Unit Area and immediate area surrounding the unit boundaries to determine what, if any, additional operations appear to be warranted as to the Unit Area.

The Ninth Plan of Development and Operation shall constitute the further obligations of the Operator under the Burton Flat Deep Unit Agreement for the period ending January 1, 1985, and may be modified or supplemented from time to time with the approval of the District Manager, Bureau of Land Management and the Commissioner of Public Lands when necessary to meet changed conditions or to protect the interest of all parties to the Unit Agreement.

Approval of this Ninth Plan of Development and Operation for the Burton Flat Deep Unit Area is respectfully requested.

Submitted this _____ day of _____, 198__.

MONSANTO OIL COMPANY

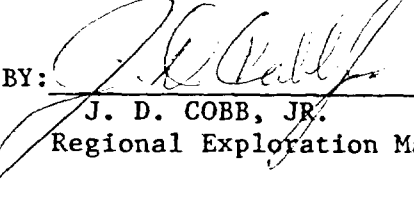
BY: 
J. D. COBB, JR.
Regional Exploration Manager

APPROVED this _____ day of _____, 198__,
subject to approval by the Commissioner of Public
Lands, State of New Mexico.

BUREAU OF LAND MANAGEMENT
District Manager

APPROVED this 18th day of January, 1984,
subject to approval by the District Manager, Bureau of
Land Management.

THE COMMISSIONER OF PUBLIC LANDS
State of New Mexico

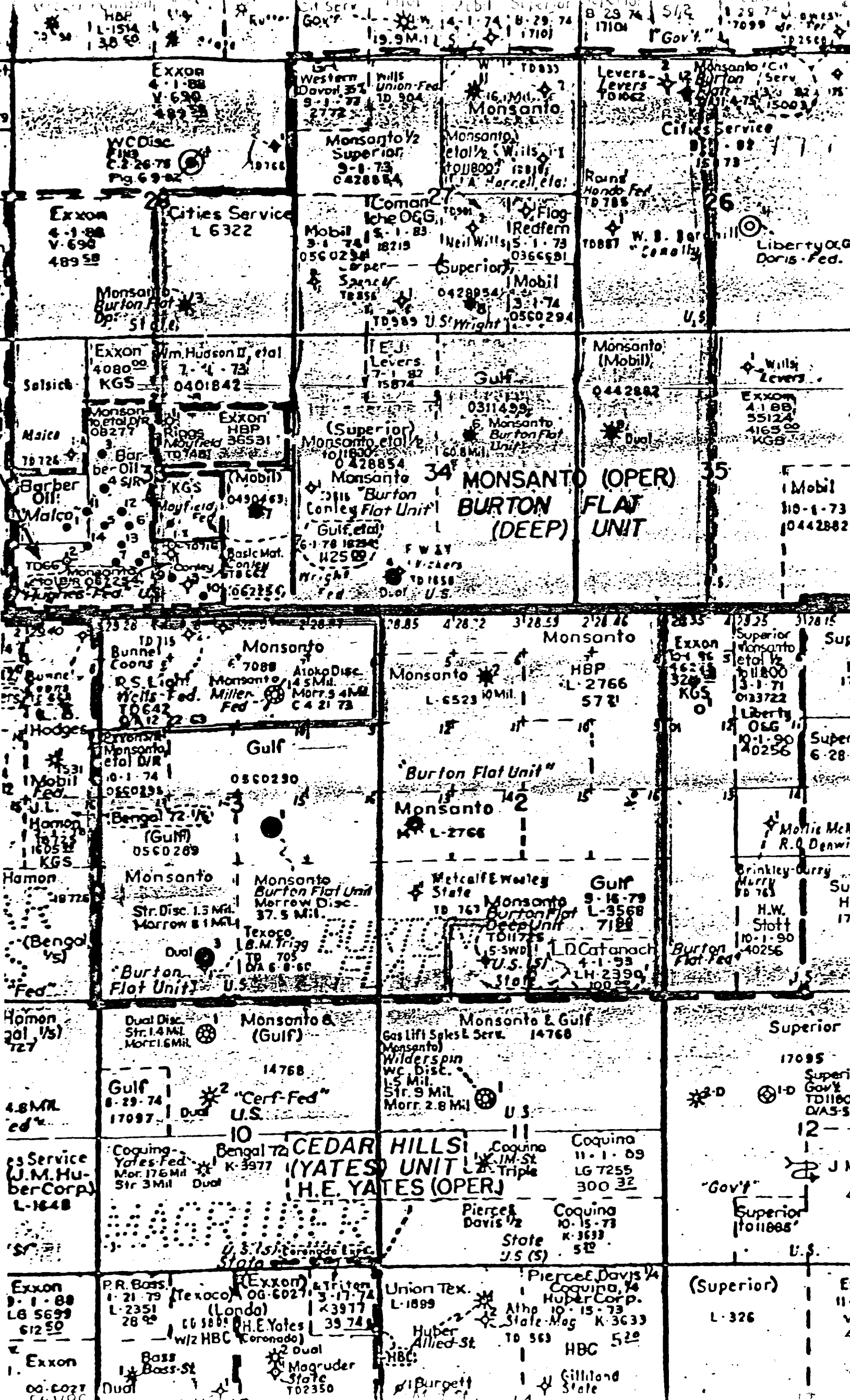

1982	CUM BBLs.	MCF GAS SALES			TOTAL	CUM. MCF		
	OIL				MONTHLY	GAS		
	PROD.	GNM	TW	Llano	GAS SALES	SALES		
1 Jan.	0 5331	0	0	0	0	4527376		
2 Feb.	100 5431	0	0	0	0	4527376		
3 Mar.	0	0	0	0	0			
4 April	0	0	0	0	0			
5 May	0	0	0	0	0			
6 June	0	0	0	0	0			
7 July	0	0	0	0	0			
8 Aug.	0	0	0	0	0			
9 Sept.	0	0	0	0	0			
10 Oct.	0	0	0	0	0			
11 Nov.	0	103	0	0	103	4527479		
12 Dec.	0 5431	1503	0	0	1503	4528782		
13 1983								
14 Jan.	0	1888	0	0	1888	4530870		
15 Feb.	0	4243	0	0	4243	4535113		
16 March	0	0	0	0	0			
17 April	0	0	0	0	0			
18 May	0	0	0	0	0			
19 June	0	0	0	0	0			
20 July	0	0	0	0	0			
21 Aug.	0	0	0	0	0			
22 Sept.	0	0	0	0	0			
23 Oct.	0	0	0	0	0			
24 Nov.								
25 Dec.								
26								
27								
28								
29								
30								
31								
32								
33								
34								
35								
36								
37								
38								
39								
40								

	1979	BBLs.	CUM. BBLs.	MCF GAS SALES			TOTAL		CUM. M
		OIL PROD.	OIL PROD.	GUM	TW	Llano	MONTHLY GAS SALES	GAS SALES	
1	Jan.	0	5271	0	572	349	941	41324	
2	Feb.	0		5121	4172	72	9375	41328	
3	March	0		17251	0	0	17351	42456	
4	April	0		14168	0	0	14168	42598	
5	May	0		15184	0	0	15184	42750	
6	June	0		15941	0	0	15941	42709	
7	July	0		16369	0	0	16369	43072	
8	August	0		17039	0	0	17039	43212	
9	Sept.	0		18185	0	0	18185	43450	
10	Oct.	0		15003	0	0	15003	43100	
11	Nov.	0		6923	0	2917	13840	42739	
12	Dec.	0		20097	0	0	20097	43940	
13	1980								
14	Jan.	0		19688	0	0	19688	42132	
15	Feb.	0		19703	6	0	19723	44315	
16	March	0		15941	0	0	15941	41195	
17	April	41	5322	7238	0	0	7288	41156	
18	May	0		7519	0	0	7519	411613	
19	June	9	5331	8625	0	0	8625	411337	
20	July	0	5331	8369	0	0	8369	42813	
21	Aug.	0		7488	0	0	7488	411898	
22	Sept.	0		7075	0	0	7075	411959	
23	Oct.	0		6651	0	0	6651	45025	
24	Nov.	0		6804	0	0	6804	45093	
25	Dec.	0		6486	0	0	6486	451585	
26	1981								
27	Jan.	0		6704	0	0	6704	451255	
28	Feb.	0		4138	0	0	4138	451619	
29	March	0		0	0	0	0	45266	
30	April	0		0	0	0	0	45316	
31	May	0		17	0	0	17	45328	
32	June	0		0	0	0	0	45328	
33	July	0		354	0	0	354	45328	
34	Aug.	0		0	0	0	0	45328	
35	Sept.	0		91	0	0	91	45328	
36	Oct.	0		0	0	0	0	45328	
37	Nov.	0		0	0	0	0	45328	
38	Dec.	0		0	0	0	0	45328	
39									
40									

Eddy County, New Mexico

	1		2		3		4		5		6	
	BBLS. CUM BBLS.						TOTAL				CUM MCF	
	OIL	OIL					MTHLY				GAS	
	PROD.	PROD.	GCNM	TW	Llano		GAS SALES				SALES	
1 1982												
2 Jan.	0	9954	278	0	0	0	278				5062674	
3 Feb.	0		305	0	0	0	305				5062979	
4 March	0		97	0	0	0	97				5063076	
5 April	0		98	0	0	0	98				5063174	
6 May	0		26	0	0	0	26				5063200	
7 June	0		0	0	0	0	0				5063200	
8 July	0		36	0	0	0	36				5063236	
9 August	0		0	0	0	0	0					
10 Sept.	0		0	0	0	0	0					
11 Oct.	0		0	0	0	0	0					
12 Nov.	0		0	0	0	0	0					
13 Dec.	0	9954	0	0	0	0	0				5063240	
14 1983												
15 Jan.	0		0	0	0	0	0					
16 Feb.	0		0	0	0	0	0					
17 March	0		0	0	0	0	0					
18 April	0		0	0	0	0	0					
19 May	0		0	0	0	0	0					
20 June	0		0	0	0	0	0					
21 July	0		0	0	0	0	0					
22 Aug.	0		0	0	0	0	0					
23 Sept.	0		0	0	0	0	0					
24 Oct.	0		0	0	0	0	0					
25 Nov.												
26 Dec.												
27												
28												
29												
30												
31												
32												
33												
34												
35												
36												
37												
38												
39												
40												

	BBLS.	CUM BBLS.	MCF GAS SALES			TOTAL		CUM. MC
	OIL	BL				MONTHLY		GAS
1979	PROD.	PROD.	GCNM	TH	11mo	GAS SALES		SALES
1 Jan.	0	9932	0	0	0	0		501770
2 Feb.	0		0	0	0	0		501770
3 March	0		0	0	39	39		501781
4 April	0		0	0	14	14		501783
5 May	0		0	0	5	5		501783
6 June	0		0	0	12	12		501785
7 July	0		0	0	137	137		501798
8 August	0		0	0	157	157		501814
9 Sept.	0		0	0	181	181		501832
10 Oct.	0		0	0	348	348		501867
11 Nov.	0		0	0	25	25		501869
12 Dec.	0		Disconnected	0	0	0		
13 1980								
14 Jan.	0			0	0	0		
15 Feb.	0			0	0	0		501869
16 March	0			0	0	0		
17 April	0		612	0	0	612		501731
18 May	0		825	0	0	825		502013
19 June	0		818	0	0	818		502095
20 July	0		1154	0	0	1154		502210
21 Aug.	0		1171	0	0	1171		502327
22 Sept.	0		1109	0	0	1109		502438
23 Oct.	0		382	0	0	382		502476
24 Nov.	0		622	0	0	622		502539
25 Dec.	0		471	0	0	471		502608
26 1981								
27 Jan.	0		738	0	0	738		502682
28 Feb.	0		4293	0	0	4293		503311
29 March	0		1091	0	0	1091		503980
30 April	0		3153	0	0	3153		504296
31 May	0		1149	0	0	1149		504410
32 June	0		3500	0	0	3500		504760
33 July	8	9040	4431	0	0	4431		505204
34 Aug.	14	9954	453	0	0	453		505654
35 Sept.	0	9954	4052	0	0	4052		506059
36 Oct.	0	9954	1304	0	0	1304		506189
7 Nov.	0	9954	230	0	0	230		506216
38 Dec.	0	9954	139	0	0	139		506230
39								
40								

	1		2		3		4		5		6	
	RBLS. CUM BBLs.		MCF GAS SALES		TOTAL		MONTHLY		CUM. MCF		GAS	
	OIL	OIL										
1982	PROD.	PROD.	GCNM	TW	Llano	GAS SALES					SALES	
1 Jan.	0	3197	2708	2424	0	29752					6708887	
2 Feb.	0		20099	1946	0	23355					6732242	
3 Mar.	0		8716	5286	0	14002					6746244	
4 April	0		16393	3023	0	19416					6765660	
5 May	0		25209	2784	0	27993					6793653	
6 June	0		9924	2301	0	12225					6805878	
7 July	0		12563	1899	0	14462					6820340	
8 Aug.	0		11941	4835	0	16776					6837116	
9 Sept.	0		28215	603	0	34228					6871344	
10 Oct.	20		17813	8159	0	25973					6897316	
11 Nov.	0		14300	6348	Temp Disconn't	16648	Llano disconnected 11/1/82					
12 Dec.	0	3197	17758	3655		21415					6939612	
13 1983												
14 Jan.	0		8707	4491		12198					6965223	
15 Feb.	0		12523	8469		20992					6986215	
16 March	0		23356	4491		27847					7014062	
17 April	0		26472	5814		32286					7046348	
18 May	0		7020	10986		18006					7064354	
19 June	0		0	7158		7158					7071512	
20 July	0		3629	5272		8909					7080421	
21 Aug.	0		0	5878		5878					7086299	
22 Sept.	0		6691	5259		11950					7098249	
23 Oct.	0		24	8928		8932					7107181	
24 Nov.												
25 Dec.												
26												
27												
28												
29												
30												
31												
32												
33												
34												
35												
36												
37												
38												
39												
40												

	BBLs	CUM BBLs	MCF GAS SALES			TOTAL	CUM
	OIL	OIL				MONTHLY	GAS
1979	PROD.	PROD.	GCNM	TW	Llano	GAS SALES	SALES
1 Jan.	0	3114	14757	3802	3271	445165	59824
2 Feb.	14	3128	15522	0	0	38466	60208
3 March	18	3146	15709	4142	0	43376	60635
4 April	0		15130	2593	0	38275	61013
5 May	10	3156	21619	4613	0	40848	61421
6 June	13	3169	11545	5918	3309	32013	61842
7 July	0		14757	3802	3271	21830	62025
8 August	0		15522	0	0	15522	62180
9 Sept.	0		15709	4142	0	22902	62409
10 Oct.	0		15130	2593	0	17523	62584
11 Nov.	0		21619	4613	0	24282	62826
12 Dec.	0		11545	5918	3309	20772	63034
13 1980							
14 Jan.	0		4695	3566	16183	24444	63278
15 Feb.	0		3304	2619	18063	24926	63528
16 March	0		1279	2945	12216	16440	63693
17 April	0		22712	4093	0	26805	63961
18 May	0		24942	0	0	34972	64310
19 June	0		1004	5504	0	6508	64375
20 July	0		29605	0	0	29605	64671
21 Aug.	0		15152	7510	0	22662	64897
22 Sept.	0		0	2936	0	2936	64926
23 Oct.	0		0	4717	0	4717	64973
24 Nov.	0		7304	5019	0	12323	65196
25 Dec.	0		13021	970	0	13991	65336
26 1981							
27 Jan.	5	3174	16504	6433	0	22927	65565
28 Feb.	0		12537	5019	0	17556	65741
29 March	0		12552	7284	0	19836	65939
30 April	0		15121	3953	0	19074	66130
31 May	0		1435	5327	0	3932	66169
32 June	0		5287	3557	0	4616	66215
33 July	0		2040	4052	0	7456	66290
34 Aug.	13	3187	12537	4615	0	7916	66369
35 Sept.	0	3187	12537	3716	0	17764	66547
36 Oct.	0	3187	2254	4354	0	7358	66621
37 Nov.	0	3187	11521	4725	0	15926	66780
38 Dec.	0	3187	5881	5653	0	13180	66911
39							
40							

		1		2		3		4		5		6	
		BBLs COND		CUM BBLs		MCF		GAS SALES		TOTAL			
1982		PROD.	COND PROD	GCNM	TW	Llano				MONTHLY	CUM MCF	GAS SALES	GAS SALES
1	Jan.	0	25704	599	0	0				399	880669		
2	Feb.	22	25726	4398	0	0				4398	885067		
3	Mar.	53	25779	1537	0	0				1537	886604		
4	April	0		2026	0	0				2026	888630		
5	May	110	25889	3192	0	0				2192	890822		
6	June	0		1418	0	0				1418	892240		
7	July	55	25944	668	0	0				668	892908		
8	Aug.	6	25950	1014	0	0				1014	893922		
9	Sept.	96	26046	543	0	0				543	894465		
10	Oct.	11	26057	10422	0	0				10422	904887		
11	Nov.	22	26079	4173	0	Disconnect 11/11/82				4173	909060		
12	Dec.	96	26175	5275	0					5275	914335		
13	1983												
14	Jan.	24	26199	8805	0					8805	923143		
15	Feb.	64	26263	9012	0					9012	932155		
16	March	11	26274	10100	0					10100	942255		
17	April	137	26411	2863	0					2863	945118		
18	May	81	26492	2914	0					2914	948032		
19	June	27	26519	0	0					0			
20	July	15	26534	1916	0					1916	949948		
21	Aug.	65	26599	5903	0					5903	955851		
22	Sept.	131	26730	329	0					317	956180		
23	Oct.	25	26755	9234	0					9234	965414		
24	Nov.												
25	Dec.												
26													
27													
28													
29													
30													
31													
32													
33													
34													
35													
36													
37													
38													
39													
40													

		BBLS COND		CUM BBLS.	MCF GAS SALES			TOTAL	
		PROD.	COND	PROD.	GCNM	FW	Llano	MTHLY	CUM MCF
								GAS SALES	GAS SALES
1979									
Jan.	72			24159		2517	279	3100	7753
Feb.	137			24086		2570	62	2932	7768
March	105			24191		2741	1033	3774	7803
April	39			24230		298	1568	1866	7824
May	196			24426		2115	445	2560	7853
June	88			24504		1860	0	1860	7863
July	98			24612		1790	1793	3573	7909
August	0					0	3407	3407	7953
Sept.	11			24623		0	3143	3143	7970
Oct.	22			24645		0	3579	3579	8001
Nov.	0			24645		0	3223	3223	8033
Dec.	0					0	3295	3295	8071
1980									
Jan.	0					0	3300	3304	8101
Feb.	0					0	2723	2723	8131
March	0					0	3156	3156	8163
April	0					0	2534	2534	8188
May	45			24690		0	2793	2793	8216
June	31			24721		0	2573	2573	8242
July	119			24840		0	2458	2458	8266
Aug.	81			24921		0	1540	1540	8282
Sept.	61			24982	3962	0	0	3962	8321
Oct.	93			25075	1815	0	0	1815	8339
Nov.	64			25139	1897	0	0	1897	8358
Dec.	0			25139	5432	0	0	5432	8413
1981									
Jan.	0			25139	2565	0	0	2565	8447
Feb.	0				2281	0	0	2281	8469
March	0				3637	0	0	3637	8506
April	0				2655	0	0	2655	8532
May	355			25494	4119	0	0	4119	8573
June	23			25507	2219	0	0	2219	8595
July	0			25507	4119	0	0	4119	8636
Aug.	40			25547	1612	0	0	1612	8652
Sept.	22			25569	2825	0	0	2825	8680
Oct.	0				186	0	0	186	8699
Nov.	67			25636	1025	0	0	1025	8705
Dec.	0			25636	20	0	0	20	8725

Edgy County, New Mexico

	1		2		3		4		5		6	
	BBLS.		MCF GAS SALES		TOTAL		CUM. MCF					
	OIL	CUM BBLS OIL			MONTHLY		GAS					
1982	PROD.	PROD.	GCNM	TW	Llano	GAS SALES	SALES					
1 Jan.	0	2034	2224	0	0	2224	2274674					
2 Feb.	0	2039	2092	0	0	2092	2276766					
3 Mar.	0		2072	0	0	2072	2278838					
4 April	0		2025	0	0	2025	2280863					
5 May	0		1773	0	0	1773	2282636					
6 June	0		1960	0	0	1960	2284596					
7 July	0		3122	0	0	3122	2287718					
8 Aug.	0		2021	0	0	2021	2289739					
9 Sept.	0		1218	0	0	1218	2290957					
10 Oct.	0		1411	0	0	1411	2292368					
11 Nov.	0		1511	0	0	1511	2293879					
12 Dec.	0	2034	1741	0	0	1741	2295620					
13 1983												
14 Jan.	0		1750	0	0	1750	2297370					
15 Feb.	0		1846	0	0	1846	2299216					
16 March	0		1463	0	0	1463	2300679					
17 April	0		1262	0	0	1262	2301941					
18 May	0		521	0	0	521	2302462					
19 June	0		3419	0	0	3419	2305881					
20 July	0		2686	0	0	2686	2308567					
21 Aug.	0		2388	0	0	2388	2310955					
22 Sept.	0		1609	0	0	1609	2312564					
23 Oct.	0		468	0	0	468	2313032					
24 Nov.												
25 Dec.												
26												
27												
28												
29												
30												
31												
32												
33												
34												
35												
36												
37												
38												
39												
40												

	BBLs.	CUM BBLs	MCF GAS SALES		TOTAL MONTHLY		CUM. MCF
	OIL	OIL					GAS
	PROD.	PROD.	GCNM	TH	Llano	GAS SALES	SALES
1979							
Jan.	0	1925	0	1977.1	217	17277	20377
Feb.	0		0	16756	5	16741	21014
March	53	1978	0	18327	1175	19502	21239
April	19	1997	0	16593	683	17266	21413
May	0		0	13820	786	17606	21528
June	0		0	2177	6845	9022	21618
July	0		3523	0	1637	5200	21670
August	0		5756	0	0	5756	21728
Sept.	0		5472	0	0	5472	21782
Oct.	0		5148	0	0	5148	21854
Nov.	0		4082	0	0	4082	21875
Dec.	0		7131	0	0	7131	21946
1980							
Jan.	0		5176	0	0	5176	21998
Feb.	0		4631	0	0	4631	22044
March	0		3893	0	0	3893	22083
April	0		5207	0	0	5207	22135
May	14	2011	3392	0	0	3392	22169
June	0		3107	0	0	3107	22200
July	0		3369	0	0	3369	22234
Aug.	0		3166	0	0	3166	22265
Sept.	0		2893	0	0	2893	22294
Oct.	0		3390	0	0	3390	22328
Nov.	0		3325	0	0	3325	22361
Dec.	0		2840	0	0	2840	22390
1981							
Jan.	9	2020	3381	0	0	3381	22423
Feb.	0		3544	0	0	3544	22458
March	0		2550	0	0	2550	22483
April	0		3832	0	0	3832	22521
May	0		2620	0	0	2620	22547
June	0		2622	0	0	2622	22573
July	14	2034	2735	0	0	2735	22600
Aug.	0		2602	0	0	2602	22626
Sept.	0		2910	0	0	2910	22655
Oct.	0	2034	2235	0	0	2235	22677
Nov.	0	2034	2572	0	0	2572	22702
Dec.	0	2034	2216	0	0	2216	22724
1982							
Jan.							
Feb.							
March							
April							
May							
June							
July							
Aug.							
Sept.							
Oct.							
Nov.							
Dec.							

		1		2		3		4		5		6	
		BBLS. COND CUM BBLS.		MCF GAS SALES		TOTAL		MONTHLY		CUM MCF			
		PROD.	COND. PROD.	TW	Llano	GAS SALES	GAS SALES						
1982													
1	Jan.	0	49,546	0	2160	2160	3,157,732						
2	Feb.	0		0	1922	1922	3,159,654						
3	Mar.	0		0	1306	1306	3,160,960						
4	April	0		0	2148	2148	3,163,108						
5	May	0		0	2029	2029	3,165,137						
6	June	0		0	2205	2205	3,167,342						
7	July	0		0	2117	2117	3,169,459						
8	Aug.	0		0	1389	1389	3,170,848						
9	Sept.	0		0	2056	2056	3,172,904						
10	Oct.	0		0	2076	2076	3,174,980						
11	Nov.	0		0	63	63	3,175,043						
12	Dec.	0	49,546	0	0	0	3,175,043						
13	1983												
14	Jan.	0		0	0	0	3,175,043						
15	Feb.	0		0	0	0							
16	March	0		0	0	0							
17	April	0		0	0	0							
18	May	0		0	0	0							
19	June	0		0	0	0							
20	July	0		0	0	0							
21	Aug.	0		0	0	0							
22	Sept.	0		0	0	0							
23	Oct.	0		0	0	0							
24	Nov.												
25	Dec.												
26													
27													
28													
29													
30													
31													
32													
33													
34													
35													
36													
37													
38													
39													
40													

		BBLS. COND. CUM BBLS.		MCF GAS SALES		TOTAL	CUM MCF
		PROD.	COND PROD	IN	Llano	MTHLY GAS SALES	GAS SAL
1	1979						
2	Jan.	0	42292	152	152	7164	27191
3	Feb.	417	49221	15250	11438	24035	30131
4	March	226	49440	15257	15536	28793	30419
5	April	81	49521	10341	12050	22396	30645
6	May	25	49546	4177	7342	12011	30764
7	June	0		0	3295	3295	30797
8	July	0		0	3436	3436	30831
9	August	0		0	3235	3235	30863
10	Sept.	0		0	2898	2898	30892
11	Oct.	0		0	2995	2995	30922
12	Nov.	0		0	2686	2686	30949
13	Dec.	0		0	2548	2548	30975
14	1980						
15	Jan.	0		0	2685	2685	31002
16	Feb.	0		0	2301	2301	31025
17	March	0		0	2739	2739	31053
18	April	0		0	2741	2741	31080
19	May	0		0	2747	2747	31108
20	June	0		0	2663	2663	31134
21	July	0		0	2713	2713	31161
22	Aug.	0		0	2639	2639	31188
23	Sept.	0		0	2496	2496	31213
24	Oct.	0		0	2556	2556	31239
25	Nov.	0		0	2360	2360	31262
26	Dec.	0	49546	0	2529	2529	31287
27	1981						
28	Jan.	0		0	2576	2576	31313
29	Feb.	0		0	2278	2278	31336
30	March	0		0	2531	2531	31361
31	April	0		0	2214	2214	31383
32	May	0		0	2088	2088	31404
33	June	0		0	2247	2247	31426
34	July	0		0	2231	2231	31448
35	Aug.	0		0	2214	2214	31470
36	Sept.	0		0	2129	2129	31491
37	Oct.	0		0	2224	2224	31513
38	Nov.	0		0	2126	2126	31534
39	Dec.	0	49546	0	2088	2088	31555
40							

1982	BBLs.	CUM BBLs.	MCF GAS SALES			TOTAL	CUM. MCF
	OIL	OIL				MONTHLY	GAS
	PROD.	PROD.	GCNM	TW	Llano	GAS SALES	SALES
1 Jan.	0	12,770	35,226	0	0	35,226	9,609,335
2 Feb.	16	12,786	24,996	0	0	24,996	9,625,581
3 Mar.	0	12,786	52,600	0	0	52,600	9,630,591
4 April	0		17,356	0	0	17,356	9,647,947
5 May	0		18,855	0	0	18,855	9,666,802
6 June	0		741	0	0	741	9,667,543
7 July	0		2843	0	0	2843	9,670,386
8 Aug.	0		4770	0	0	4770	9,675,156
9 Sept.	0		5369	0	0	5369	9,680,525
10 Oct.	0		10,576	0	0	10,576	9,691,101
11 Nov.	0		3562	0	0	3562	9,694,663
12 Dec.	0	12,786	52,444	0	0	52,444	9,699,907
13 1983							
14 Jan.	0		2472	0		2472	9,702,379
15 Feb.	0		1153	0		1153	9,703,532
16 March	0		12,588	0		12,588	9,716,120
17 April	0		18,613	0		18,613	9,734,733
18 May	0		9115	0		9115	9,743,848
19 June	0		0	0		0	
20 July	0		0	0		0	
21 Aug.	0		0	0		0	
22 Sept.	0		0	0		0	
23 Oct.	0		0	0		0	
24 Nov.							
25 Dec.							
26							
27							
28							
29							
30							
31							
32							
33							
34							
35							
36							
37							
38							
39							
40							

Burton E. Unit Well #6 (Harrow)
Eddy County, New Mexico

	BBLs.	CUM BBLs.	MCF GAS SALES			TOTAL		CUM MCF
	OIL	OIL				MONTHLY		GAS 8.52
1979	PROD.	PROD.	GCNM	TH	Land	GAS SALES		SALES
1 Jan.	68	12,105	7228	7112	5228	12577		85574
2 Feb.	62	12,167	3724	23077	24120	51271		86406
3 March	13	12,180	0	16152	1014	17258		86579
4 April	0		0	11205	822	12700		86706
5 May	32	12,212	0	22222	22250	52042		87222
6 June	38	12,250	0	20948	34219	57157		87797
7 July	27	12,277	940	3243	21015	26135		88049
8 August	8	12,285	5473	0	21236	31809		88367
9 Sept.	21	12,306	0	0	38446	38446		88752
10 Oct.	27	12,333	0	0	45536	45536		89207
11 Nov.	23	12,356	0	0	47527	47527		89683
12 Dec.	52	12,408	943	0	47191	48134		90164
13 1980								
14 Jan.	81	12,489	24	0	45252	45276		90612
15 Feb.	0	12,489	164	0	51578	51742		90874
16 March	0		3555	0	29258	35213		91126
17 April	37	12526	30094	0	0	30094		91427
18 May	45	12571	62428	0	0	62428		92091
19 June	31	12602	56051	0	1230	57281		92667
20 July	22	12624	54301	4145	0	38446		93049
21 Aug.	28	12652	40222	0	0	40222		93451
22 Sept.	0	12652	29725	0	0	29725		93748
23 Oct.	16	12668	14095	0	0	14095		93889
24 Nov.	35	12703	24936	0	0	24936		94139
25 Dec.	6	12709	15591	0	0	15591		94294
26 1981								
27 Jan.	11	12720	21238	0	0	21238		94502
28 Feb.	0		10588	0	0	10588		94611
29 March	0		11608	0	0	11608		94727
30 April	0		2558	0	0	2558		94772
31 May	0		15158	0	0	2158		94854
32 June	19	12739	1522	0	0	15346		94957
33 July	6	12745	5537	0	0	2517		95092
34 Aug.	25	12770	1222	0	0	18102		95180
35 Sept.	0		12221	0	0	18681		95367
36 Oct.	0		648	0	0	1818		95455
37 Nov.	0		12352	0	0	12722		95580
38 Dec.	0	12770	9055	0	0	19055		95751
39								
40								

Oil Purchaser: Permian Cor
Gas Purchaser: Llano, Inc.

BURTON FLAT WELLS #7 (Wolfcamp)

Sec. 33-20S-28E, Eddy Co., N.M.

NORTH BURTON FLAT WOLF CAMP FIELD

	Llano	Llano CUM			
	MCF Gas	MCF GAS	BBLS COND	CUM BBLS	
1978	Sales	SALES	PROD	COND PROD.	
1 August	1216	1216	28	28	Well was producing from M
2 Sept.	2783	4003	165	296	Now producing from Wolfca
3 Oct.	1477	5486	216	1092	
4 Nov.	950	6436	130	1222	
5 Dec.	1139	7635	95	1317	
6 1979					
7 Jan.	1238	8873	139	1456	
8 Feb.	928	9771	78	1534	
9 March	561	10332	110	1644	
10 April	158	10490	20	1664	
11 May	679	11169	80	1744	
12 June	129	11298	7	1751	
13 July	12	11310	0	1751	
14 August	0		0		
15 Sept.	0		0		
16 Oct.	0		0		
17 Nov.	0		0		
18 Dec.	7	11317	0		Well shut in
19					
20					
21 1981					
22 Jan.	0		0		
23	0		0		
24					
25					
26					
27					
28					
29					
30					
31					
32					
33					
34					
35					
36					
37					
38					
39					
40					

EDDY COUNTY, NEW MEXICO

	1		2		3		4		5		6	
	BBLs. OIL		CUM BBLs.		MCF GAS SALES				TOTAL			
	PROD.	OIL PROD.	GCNM	TW	MONTHLY		SALES		CUM MCF		GAS SALES	
1983												
1 Jan.	0	4155	3275	0				3248			1,712,532	
2 Feb.	36	4191	3052	0				3052			1,713,584	
3 March	0		719	0				719			1,714,303	
4 April	0		3047	0				3047			1,717,350	
5 May	0		1217	0				1217			1,718,567	
6 June	0		0	0				0				
7 July	0		110	0				110			1,718,677	
8 Aug.	0		826	0				826			1,719,503	
9 Sept.	0		311	0				311			1,719,814	
10 Oct.	0		386	6				386			1,720,200	
11 Nov.												
12 Dec.												
13												
14												
15												
16												
17												
18												
19												
20												
21												
22												
23												
24												
25												
26												
27												
28												
29												
30												
31												
32												
33												
34												
35												
36												
37												
38												
39												
40												

CONDENSATE PURCHASER: Perin Corp.

GAS PURCHASER: GCNM & TW

BURTON FLAT MORROW FIELD

Burton Flat Unit Well #8 (Morrow)

Sec. 27-20S-28E, Eddy Co., N.M.

	BBLS. OIL PROD.	CUM BBLS. OIL PROD.	GCNM	MCF GAS SALES TW	Llano	TOTAL MONTHLY SALES	CUM MCF GAS SALES
1980							
1 Jan.	26	367	2559	0	0	9.39	15112.39
2 Feb.	0	367	2587	0	0	10.53	15217.92
3 March	0		269	0	0	10.27	15328.19
4 April	0		7060	0	0	7060	15329.19
5 May	181	3859	2554	0	0	2554	15585.19
6 June	6	3865	15134	0	0	15134	15636.53
7 July	10	3875	1507	0	0	1807	15717.60
8 Aug.	9	3884	4506	0	0	4506	15802.66
9 Sept.	0	3884	431	0	0	3881	15841.47
10 Oct.	0	3967	3965	0	0	3965	15881.12
11 Nov.	83	3967	008	0	0	1008	15891.20
12 Dec.	0		1793	0	0	4793	15939.13
13 1981							
14 Jan.	0	3967	1598	0	0	1598	15955.11
15 Feb.	0		700	0	0	700	15962.11
16 March	0		758	0	0	3798	16000.09
17 April	0		4045	0	0	4045	16040.54
18 May	0		3045	0	0	3045	16071.00
19 June	43	4010	5590	0	0	5590	16126.90
20 July	12	4022	7711	0	0	7711	16204.01
21 Aug.	48	4070	1357	0	0	4357	16247.58
22 Sept.	0		634	0	0	634	16254.92
23 Oct.	0		1371	0	0	1371	16268.63
24 Nov.	0	4070	1619	0	0	1619	16284.82
25 Dec.	0	4070	1019	0	0	1019	16346.01
26 1982							
27 Jan.	0	4070	3755	0	0	3755	16383.56
28 Feb.	24	4094	1140	0	0	8140	16464.96
29 Mar.	0		2094	0	0	2094	16485.90
30 April	13	4107	4913	0	0	4913	16535.03
31 May	24	4131	9908	0	0	9908	16634.11
32 June	0		1860	0	0	1860	16652.71
33 July	11	4142	2396	0	0	2996	16682.67
34 Aug.	0	4142	10355	0	0	10355	16786.22
35 Sept.	0		209	0	0	9709	16883.31
Oct.	13	4155	8401	0	0	8401	16967.32
Nov.	0		4739	0	0	4739	17014.71
Dec.	0	4155	4234	0	0	4234	17057.05

		1		2		3		4		5		6	
		BBLs. OIL		CUM BBLs.		MCF GAS SALES		TOTAL					
		PROD.		OIL PROD.		Lalno		GCNM		MONTHLY		CUM MCF	
1983										SALES		GAS SALES	
1	Jan.		0	597		0					0	186,625	
2	Feb.		0			0					0		
3	March		0			0					0		
4	April		0			0					0		
5	May		0			0					0		
6	June		0			0					0		
7	July		0			0					0		
8	Aug.		0			0					0		
9	Sept.		0			0					0		
10	Oct.		0			0					0		
11	Nov.												
12	Dec.												
13													
14													
15													
16													
17													
18													
19													
20													
21													
22													
23													
24													
25													
26													
27													
28													
29													
30													
31													
32													
33													
34													
35													
36													
37													
38													
39													
40													

BURTON FLAT UNIT MORROW
 Burton Flat Unit Well #9 (Morrow)
 Sec. 35-20S-28E, Eddy Co., N.M.

		BBLs. OIL PROD.	CUM BBLs. OIL PROD	MCF GAS SALES LTano	GCNM	TOTAL MONTHLY SALES	CUM MCF GAS SALES
1980							
1	Jan.	0	520	1102		1102	15517
2	Feb.	0	530	1102		1102	15627
3	March	0		1682		1682	15795
4	April	0		572		572	15836
5	May	0		715		715	15908
6	June	0		677		677	15976
7	July	0		735		735	16049
8	Aug.	0		535		535	16098
9	Sept.	0		1567		1567	16235
10	Oct.	0		1206		1206	16406
11	Nov.	0		842		842	16490
12	Dec.	0		910		910	16581
13	1981						
14	Jan.	2	522	579		579	16659
15	Feb.	0		591		591	16698
16	March	0		1806		1806	16878
17	April	0		1141		1141	16992
18	May	0		1145		1145	17106
19	June	10	532	1014		1014	17207
20	July	12	544	989		989	17306
21	Aug.	0		830		830	17390
22	Sept.	0		797		797	17469
23	Oct.	0		1581		1581	17628
24	Nov.	0		1056		1056	17734
25	Dec.	0	544	793		793	17813
26	1982						
27	Jan.	0	554	650		650	17878
28	Feb.	16	570	605		605	17939
29	Mar.	0		502		502	17989
30	April	0	570	703		703	18059
31	May	0		574		574	18117
32	June	22	592	1197		1197	18237
33	July	0		1385		1385	18375
34	Aug.	0		966		966	18471
35	Sept.	0		961		961	18567
36	Oct.	0		858		858	18653
37	Nov.	0		137		137	18690
38	Dec.	0	597	0		0	18690
39							
40							

YEAR	BELS.	CUM BELS.	MCF GAS SALES		MONTHLY	CUM GAS	CUM GAS
	COND.	COND.	(Strawn)		GAS SALES	SALES	SALES
	PROD.	PROD.	S.U.	T.W.	(SU & TW)	(SU)	(TW)
1974							
March	0	0	0	0	0	0	0
April	0	0	0	2900	2900	0	2900
May	0	0	0	3976	3976	0	913
June	0	0	0	2542	2542	0	1167
July	0	0	0	1928	1928	0	1360
August	50	50	38	530	568	38	1398
Sept.	0	50	0	0	0	38	1360
Oct.	0	50	138	0	138	138	1500
Nov.	0	50	120	0	120	258	1560
Dec.	0	50	354	0	354	1250	1525
1975							
Jan.	0	50	352	0	352	1407	1513
Feb.	0	50	17	0	17	1454	1313
March	0	50	22	0	22	1476	1345
April	0	50	0	0	0	1476	1345
May	0	50	0	0	0	1476	1345
June	0	50	269	0	269	1945	1345
July	0	50	0	0	0	1945	1345
August	0	50	0	0	0	1945	1345
Sept.	0	50	0	0	0	1945	1345
Oct.	0	50	0	0	0	1945	1345
Nov.	0	50	0	0	0	1945	1345
Dec.	0	50	0	0	0	1945	1345
1976							
Jan.	0	50	0	0	0	1945	1345
Feb.	0	50	0	0	0	1945	1345
March	0	50	0	0	0	1945	1345
April	0	50	0	0	0	1945	1345
May	0		0	0	0		
June	0		0	0	0		
July	0		0	0	0		
August	0		0	0	0		
Sept.	0		0	0	0		
Oct.	0		0	0	0		
Nov.	0		0	0	0		
Dec.	0		0	0	0		

Well shut-in

EDDY COUNTY, N.M.

		1		2		3		4		5		6	
		BBLs. OIL		CUM BBLs.		MCF GAS SALES				TOTAL			
1983		PROD.		OIL PROD.		GCNM		TW		MONTHLY		CUM MCF	
										SALES		GAS SALES	
1	Jan.	0		10,500		2224		0		2224		3758365	
2	Feb.	0				2356		0		2356		3760721	
3	March	0				2307		0		2307		3763028	
4	April	0				2023		0		2023		3765051	
5	May	0				1635		0		1635		3766686	
6	June	0				1726		0		1726		3768412	
7	July	0				1541		0		1541		3769953	
8	Aug.	0				1326		0		1326		3771279	
9	Sept.	0				870		0		870		3772149	
10	Oct.	0				905		0		905		3773054	
11	Nov.												
12	Dec.												
13													
14													
15													
16													
17													
18													
19													
20													
21													
22													
23													
24													
25													
26													
27													
28													
29													
30													
31													
32													
33													
34													
35													
36													
37													
38													
39													
40													

OIL PURCHASER: Permian Co

GAS PURCHASER: GCNM & TW

BURTON FLAT MORROW

Burton Flat Unit Well #11 (Morrow)

Sec. 27-20S-28E, Eddy Co., N.M.

		BBLS OIL PROD.	CUM BBLS OIL PROD.	MCF GAS SALES			TOTAL MONTHLY SALES	CUM MCF GAS SALES
				GCNM	TW	Llano		
1	1980							
2	Jan.	0	10305	0	0	325	325	3664926
3	Feb.	0	10309	0	0	321	321	3668173
4	March	0		19	793	254	805	3671123
5	April	0		336	0	0	336	3674489
6	May	33	10362	2612	0	0	2612	3677101
7	June	0		2596	0	0	2596	3679697
8	July	0		2454	0	0	2454	3682151
9	Aug.	0		2651	0	0	2651	3684802
10	Sept.	0		2499	0	0	2499	3687301
11	Oct.	0		1977	0	0	1977	3689278
12	Nov.	17		2715	0	0	2715	3691993
13	Dec.	0		2660	0	0	2660	3694653
14	1981							
15	Jan.	11	10375	2957	0	0	2957	3697610
16	Feb.	0		2631	0	0	2631	3700241
17	March	0		265	0	0	265	3702896
18	April	0		2044	0	0	2044	3704940
19	May	0		2725	0	0	2725	3707665
20	June	10	10383	2755	0	0	2755	3710420
21	July	0	10383	2599	0	0	2599	3713019
22	Aug.	3	10386	2515	0	0	2515	3715534
23	Sept.	12	10398	2397	0	0	2397	3717931
24	Oct.	0		1305	0	0	1305	3719236
25	Nov.	0		2066	0	0	2066	3721302
26	Dec.	18	10416	2530	0	0	2530	3723832
27	1982							
28	Jan.	0	10416	2853	0	0	2853	3726685
29	Feb.	14	10430	2029	0	0	2029	3728714
30	Mar.	5	10435	2604	0	0	2604	3731318
31	April	0		2801	0	0	2801	3734119
32	May	0		2636	0	0	2636	3736755
33	June	0		2620	0	0	2620	3739375
34	July	11	10446	1538	0	0	1538	3740913
35	Aug.	0		2956	0	0	2956	3743869
36	Sept.	40	10486	2660	0	0	2660	3746529
37	Oct.	14	10500	2602	0	0	2602	3749131
38	Nov.	0		1996	0	11/9/82	1996	3751127
39	Dec.	0	10500	2262	0		2262	3753389
40								

		1		2		3		4		5	
YEAR		BBLS. COND.	CUM BBLS COND.	MCF GAS SALES (Morrow)							
1975		PROD.	PRODUCED	TW							
1	Sept.	0	0	777		Well Shut-in					
2											
3											
4	1976					Well Shut-in					
5	1977										
6	1978										
7	1979										
8	1980										
9	1981										
10	1982										
11	1983										
12											
13											
14											
15											
16											
17											
18											
19											
20											
21											
22											
23											
24											
25											
26											
27											
28											
29											
30											
31											
32											
33											
34											
35											
36											
37											
38											
39											
40											

EDDY COUNTY, NEW MEXICO

		1		2		3		4		5		6	
		BELS. OIL		CUM BELS.		MCF GAS SALES				TOTAL MONTHLY		CUM MCF GAS	
		PROD.	OIL PROD.	GCNM	Llano	EPG				SALES		SALES	
1981													
1	Jan.	0	326	380	0	0				380		1075523	
2	Feb.	0		285	0	0				285		1075808	
3	March	0		101	0	0				101		1075909	
4	April	0		238	0	0				238		1076147	
5	May	0		33	0	0				33		1076180	
6	June	0		159	0	0				159		1076339	
7	July	8	334	106	0	0				106		1076445	
8	Aug.	7	341	68	0	0				68		1076513	
9	Sept.	0		321	0	0				321		1076834	
10	Oct.	0		1240	0	0				1240		1078074	
11	Nov.	0	341	934	0	0				934		1079008	
12	Dec.	0	341	470	0	0				470		1079478	
13	1982												
14	Jan.	0	341	829	0	0				829		1080307	
15	Feb.	0		508	0	0				508		1080815	
16	Mar.	0		110	0	0				110		1080925	
17	April	0		130	0	0				130		1081055	
18	May	0		143	0	0				143		1081198	
19	June	0		27	0	0				27		1081225	
20	July	0		106	0	0				106		1081331	
21	Aug.	0		200	0	0				200		1081531	
22	Sept.	0		162	0	0				162		1081693	
23	Oct.	0		163	0	0				163		1081856	
24	Nov.	0		152	LL discon- nected 11/1/82				0	152		1082008	
25	Dec.	0	341	246		0				246		1082254	
26	1983												
27	Jan.	0		121		Temporary 1-16-83 0				121		1082375	
28	Feb.	0		88						88		1082463	
29	March	0		188						188		1082651	
30	April	0		139						139		1082790	
31	May	0		79						79		1082869	
32	June	0		0						0			
33	July	0		0						0			
34	Aug.	0		0						0			
35	Sept.	0		0						0			
36	Oct.	0		5						5		1082874	
37	Nov.												
38	Dec.												
39													
40													

Gas:

GCHM, Llang - 4 LPG

Eddy County, New Mexico

		CUM	MCF GAS SALES			TOTAL	CUM GAS	CUM GAS	CUM G
BBLs		BBLs				MONTHLY	SALES	SALES	SALES
1978	COND	COND	GCNM	Llano	EPG	SALES	(GCNM)	(Llano)	(EPG)
1	Jan.	12	297	25209	5255	2140	38164	563862	144119
2	Feb.	8	305	25520	5295	3132	33953	589382	129058
3	March	10	315	6186	11252	3714	21752	595598	161210
4	April	10	325	13335	12431	55	2551	608913	173141
5	May	1	326	6412	11539	0	17951	615325	185180
6	June	0	326	0	1525	4335	5820	615325	186705
7	July	0	326	0	844	951	1072	615325	187549
8	August	0	326	0	0	788	788	615325	187549
9	Sept.	0	326	0	2548	616	12158	615325	194057
10	Oct.	0	326	0	7146	3807	10953	615325	201043
11	Nov.	0	326	852	0	5300	6152	616177	201243
12	Dec.	0	326	7224	0	4070	11394	623001	201243
13									CUM MO
14	1979								715176
15	Jan.	0	326	0	1785	2525	4310		105
16	Feb.	0		0	3021	1083	4704		105
17	March	0		0	2832	2429	5261		106
18	April	0		0	2849	0	2849		106
19	May	0		0	1432	0	1432		106
20	June	0		0	855	0	855		106
21	July	0		0	667	0	667		106
22	August	0		0	305	0	305		106
23	Sept.	0		0	11	0	11		106
24	Oct.	0		0	0	0	0		106
25	Nov.	0		0	0	0	0		106
26	Dec.	0		0	0	0	0		106
27	1980								
28	Jan.	0		0	0	0	0		
29	Feb.	0		0	6	0	0		106
30	March	0		0	0	0	0		
31	April	0		1877	0	0	1877		106
32	May	0		1163	0	0	1163		106
33	June	0		748	0	8	757		107
34	July	0		381	0	0	381		107
35	Aug.	0		258	0	0	258		107
36	Sept.	0		117	0	0	117		107
37	Oct.	0		16	0	0	16		107
38	Nov.	0		59	0	0	59		107
39	Dec.	0		27	0	0	27		107

APPLICATION FOR INITIAL PARTICIPATING AREA "A"

BONE SPRINGS FORMATION
BURTON FLAT DEEP UNIT AGREEMENT
EDDY COUNTY, NEW MEXICO

TO: District Manager
Bureau of Land Management
P. O. Drawer 1397
Roswell, New Mexico 88201

The Commissioner of Public Lands
State of New Mexico
P. O. Drawer 1148
Santa Fe, New Mexico 87501

MONSANTO OIL COMPANY, as Unit Operator for the Burton Flat Deep Unit Agreement, respectfully requests your approval, pursuant to Section 11 of the Unit Agreement, of the selection of the lands indicated on the land ownership map, attached hereto as Exhibit "A", to constitute the initial participating area "A" for the Bone Springs Formation.

As defined, the initial Bone Springs participating area "A" embraces 754.62 acres.

The schedule of lands attached hereto as Exhibit "B" described the lands within the initial participating area "A" for the Bone Springs Formation and indicates the percentage of participation of each lease and tract within said area.

A geologic and engineering report to which is attached pertinent test data, is being submitted separately as justification for the proposed definition of the Bone Springs participating area "A".

The initial Bone Springs participating area "A" is predicated upon the formation obtained by the completion on March 2, 1984, of the Burton Flat Unit No. 23, in Lot 8 of Section 2, T-21-S, R-27-E, N.M.P.M., Eddy County, New Mexico. Initial oil production from the Burton Flat No. 23 was 11.7 barrels of oil (flowing) and 350 MCF of gas in seven hours from the Bone Springs Formation at a depth of 5,413 to 5,440 feet. The initial Bone Springs Participating Area "A" is also predicated upon information obtained by the completion on May 20, 1984, of the Burton Flat Unit Well No. 24, in Lot 1 of Section 2, T-21-S, R-27-E, N.M.P.M., Eddy County, New Mexico. Initial oil production from the Burton Flat No. 24 was 105

BOPD (flowing) and 290 MCFGPD from the Bone Springs Formation at a depth of 5,454 to 5,482 feet. The initial Bone Springs participating area is also predicated upon information obtained by the completion on May 25, 1984 of the Burton Flat Unit Well No. 27, in Lot 7 of Section 2, T-21-S, R-27-E, N.M.P.M., Eddy County, New Mexico. Initial oil production from the Burton Flat No. 27 was 120 BOPD (flowing) and 200 MCFGPD from the Bone Springs formation at a depth of 5,395 to 5,420 feet.

Pursuant to Section 11 of the Unit Agreement, the effective date of the initial participating area "A" should be March 2, 1984.

Your approval is, therefore, requested for the selection of the lands indicated on attached Exhibit "A" as the initial Bone Springs participating area "A" effective March 2, 1984.

DATED this 8th day of June, 1984.

MONSANTO OIL COMPANY

BY

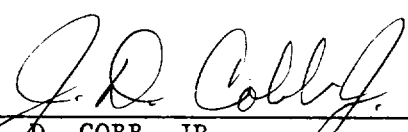
J. D. COBB, JR.
REGIONAL EXPLORATION MANAGER

APPROVED this _____ day of _____, 1984, subject to approval by the Commissioner of Public Lands of the State of New Mexico.

DISTRICT MANAGER
BUREAU OF LAND MANAGEMENT

APPROVED this _____ day of _____, 1984, subject to approval by the Commissioner of Public Lands of the State of New Mexico and the District Manager, Bureau of Land Management.

NEW MEXICO OIL CONSERVATION COMMISSION

BY:

TITLE:

APPROVED this 26th day of July, 1984, subject to the approval of the District Manager, Bureau of Land Management.

COMMISSIONER OF PUBLIC LANDS of
the STATE OF NEW MEXICO

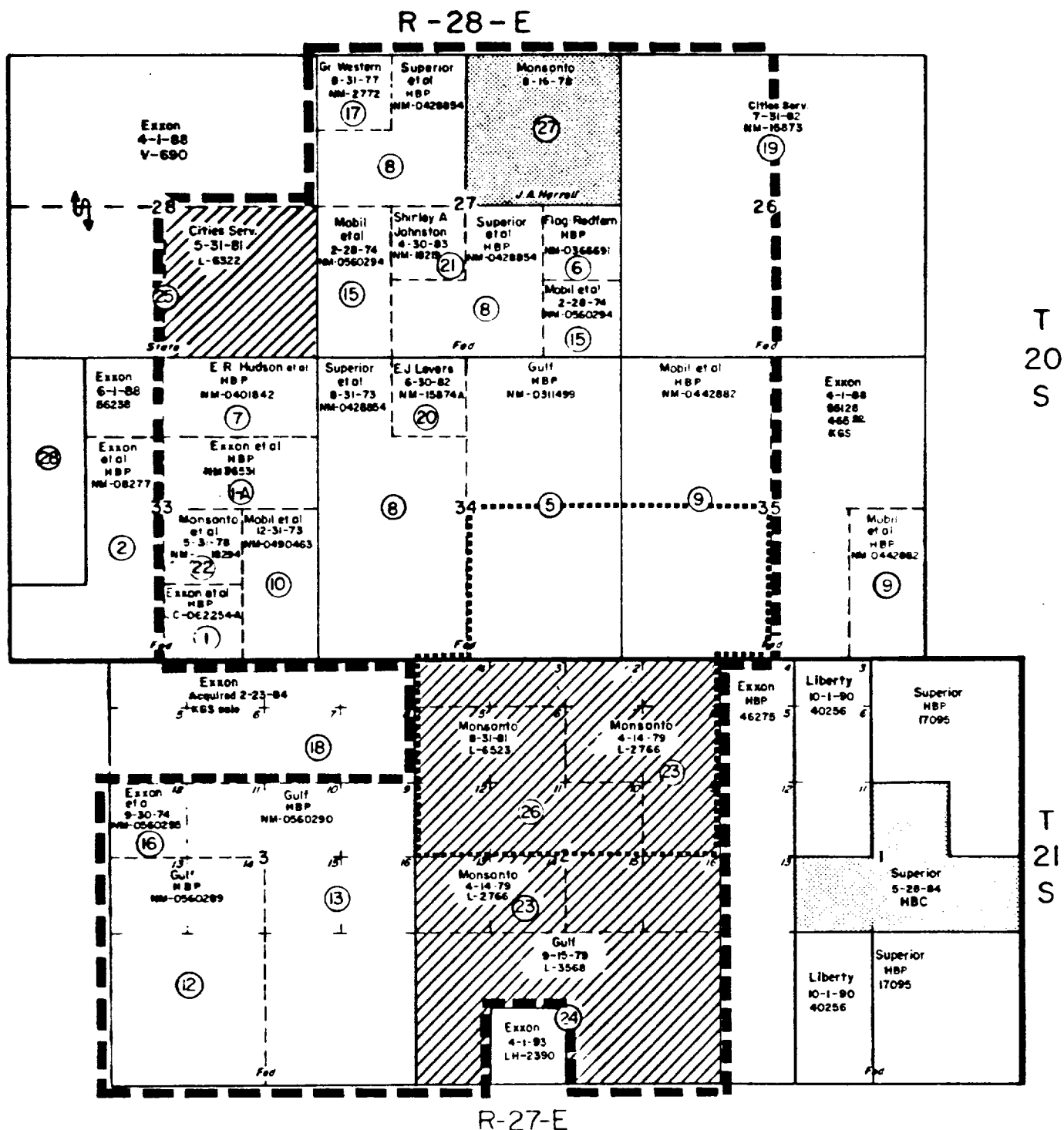

② — Tract Number

Federal Lands

State Of New Mexico Lands

Potented (Fee) Lands

----- Unit Outline

..... Initial Participating Area

BURTON FLAT DEEP UNIT

Eddy Co. New Mexico

EXHIBIT "A"

Application for Initial Participating Area 'A'
Bone Springs Formation
Effective 3/2/84

E X H I B I T "B"

INITIAL BONE SPRINGS FORMATION PARTICIPATING AREA "A"

BURTON FLAT DEEP UNIT AGREEMENT

EDDY COUNTY, NEW MEXICO

TRACT NO.	LEASE NO. OR TYPE OF LAND	DESCRIPTION	PARTICIPATION		PERCENTAGE OF PARTICIPATION	WORKING INTEREST OWNER
			AREA			
5	NM-0311499	T-20-S, R-28-E Section 34: SE/4	160.00		21.202725	Gulf Oil Corporation
9	NM-0442882	T-20-S, R-28-E Section 35: SW/4	160.00		21.202725	Mobil Oil Corporation, et al
23	L-2766 (State of New Mexico)	T-21-S, R-27-E Section 2: Lots 1, 2, 3, 4, 7, 8, 9	234.62		31.091145	Monsanto Company
26	L-6523 (State of New Mexico)	T-21-S, R-27-E Section 2: Lots, 5, 6, 10, 11, 12	200.00		26.503405	Monsanto Company
R E C A P I T U L A T I O N						
			PARTICIPATING ACRES	COMMITTED	PERCENTAGE OF PARTICIPATION	

R E C A P I T U L A T I O N

	PARTICIPATING		COMMITTED		PERCENTAGE OF PARTICIPATION
	ACRES				
Total Federal Lands	320.00		320.00		42.405450
Total State Lands	434.62		434.62		57.594550
Total Patented Lands	0.00		0.00		0.000000
TOTAL	754.62		754.62		100.000000

GEOLOGIC AND ENGINEERING REPORT

BURTON FLAT DEEP UNIT

EDDY COUNTY, NEW MEXICO

RE: Application for Initial Participating Area "A"
Bone Springs Formation-Effective March 2, 1984

1. Burton Flat Unit Well No. 23

A. GENERAL

Burton Flat Well No. 23 is completed in the Bone Springs Formation. This is the second Bone Springs producer within the Burton Flat Unit and necessitates the establishment of a second Bone Springs participating area.

The Bone springs was encountered at 5,294' (-2,105' Subsea) and is a marine sandstone. Attached is a structure map on the top of the Bone Springs sandstone. Superimposed on this map is the Isopach of that sandstone. Following is a summary of location and tops encountered in Burton Flat No. 23:

	<u>Burton Flat No. 23</u>
Location	1,527' FNL & 744' FEL Sec. 2, T-21-S, R-27-E
Total Depth	5,700'
Elevation (KB)	3,189'
<u>Tops:</u>	
Capitan Reef	1,200' (+1,989')
Delaware	2,650' (+ 539')
Bone Springs	5,293' (-2,104')

B. BONE SPRINGS COMPLETION

Burton Flat No. 23 is completed in the Bone Springs. Casing and perforations are:

Burton Flat No. 23

Surface

Depth	634'
Size	13-3/78"
Weight	48# and 68#/Ft.
Cement	600 Sacks

Intermediate

Depth	2,604'
Size	8-5/8"
Weight	24# and 32#/Ft.
Cement	850 Sacks

Production

Depth	5,700'
Size	5-1/2"
Weight	15-1/2# and 17#/Ft.
Cement	900 Sacks

Bone Springs Perforations

5,413' = 5,440' (27')

Potential Test

Flowed 40 BOPD, Trace
Water, 1,200 MCFGPD

C. PRESENT STATUS

The well was completed on March 2, 1984. The well had been shut-in awaiting the completion of Phillips Company's low pressure casinghead gas line. The line was completed at the end of April 1984, and sales begun at that time. Oil sales are to Permian Corporation and casinghead gas is being sold to Phillips Petroleum Company.

D. COMMERCIAL PRODUCTION ESTABLISHED

Commercial production rates are indicated by the potential test.

Good reservoir size is expected due to the 27' pay section, which is correlative to the subsequently drilled Burton Flat Unit Wells #24 and #27.

2. Burton Flat Unit Well No. 24

A. GENERAL

Burton Flat Well No. 24 is completed in the Bone Springs Formation. This is the third Bone Springs producer within the Burton Flat Unit.

The Bone Springs was encountered at 5,378' (-2,183' Subsea) and is a marine sandstone. Following is a summary of location and tops encountered in Burton Flat No. 24:

	<u>Burton Flat No. 24</u>
Location	426' FNL & 660' FEL Sec. 2, T-21-S, R-27-E
Total Depth	6,000'
Elevation (KB)	3,195'
<u>Tops:</u>	
Capitan Reef	1,430' (+1,765')
Delaware	2,660' (+ 545')
Bone Springs	5,378' (-2,183')

B. BONE SPRINGS COMPLETION

Burton Flat No. 24 is completed in the Bone Springs. Casing and perforations are:

Burton Flat No. 24

Surface

Depth	609'
Size	13-3/8"
Weight	48#/Ft.
Cement	600 Sacks

Intermediate

Depth	2,560'
Size	8-5/8"
Weight	24#/Ft.
Cement	2,600 Sacks

Production

Depth	6,600'
Size	5-1/2"
Weight	17#/Ft.
Cement	900 Sacks

Bone Springs Perforations

5,454' - 5,482' (28')

Potential Test

Flowed 105 BOPD, 0
BWPD, 290 MCFGPD

C. PRESENT STATUS

The well was completed on May 20, 1984. Oil sales are to Permian Corporation and casinghead gas is being sold to Phillips Petroleum Company.

D. COMMERCIAL PRODUCTION ESTABLISHED

Commercial production rates are indicated by the potential test. Good reservoir size is expected due to the 28' pay section, which is correlative in the Burton Flat Unit #23 and #27, both of which are producing.

3. Burton Flat Unit Well No. 27

A. GENERAL

Burton Flat Well No. 27 is completed in the Bone Springs Formation. This is the fourth Bone Springs producer within the Burton Flat Unit.

The Bone Springs was encountered at 5,278' (-2,068' Subsea) and is a marine sandstone. Following is a summary of location and tops encountered in Burton Flat No. 27:

	<u>Burton Flat No. 27</u>
Location	1612' FNL & 1980' FEL Sec. 2, T-21-S, R-27-E
Total Depth	6,250'
Elevation (KB)	3,205'
<u>Tops:</u>	
Capitan Reef	1,030' (+2,175')
Delaware	2,644' (+ 561')
Bone Springs	5,278' (-2,068')

B. BONE SPRINGS COMPLETION

Burton Flat No. 27 is completed in the Bone Springs. Casing and perforations are:

	<u>Burton Flat No. 27</u>
<u>Surface</u>	
Depth	600'
Size	13-3/8"
Weight	48#/Ft.
Cement	500 Sacks

Intermediate

Depth	2,573'
Size	8-5/8"
Weight	24#/Ft.
Cement	1400 Sacks

Production

Depth	6,250'
Size	5-1/2"
Weight	15.5#/Ft.
Cement	975 Sacks

Bone Springs Perforations

5,395' - 5,420' (25')

Potential Test

Flowed 120 BOPD, 20
BWPD, 200 MCFGPD

C. PRESENT STATUS

The well was completed on May 25, 1984. Oil sales are to Permian Corporation and casinghead gas is being sold to Phillips Petroleum Company.

D. COMMERCIAL PRODUCTION ESTABLISHED

Commercial production rates are indicated by the potential test. Good reservoir size is expected due to the 25' pay section, which is correlative in the Burton Flat Unit #23 and #24, both of which are producing.

INITIAL PARTICIPATING AREA

In our opinion, the Burton Flat Unit Wells #23, 24, and 27 have established commercial Bone Springs production and the initial participating area should include and be limited to the 754.62 Acre area outlined by the plat attached as Exhibit "A" to the Application for Initial Participating Area "A".

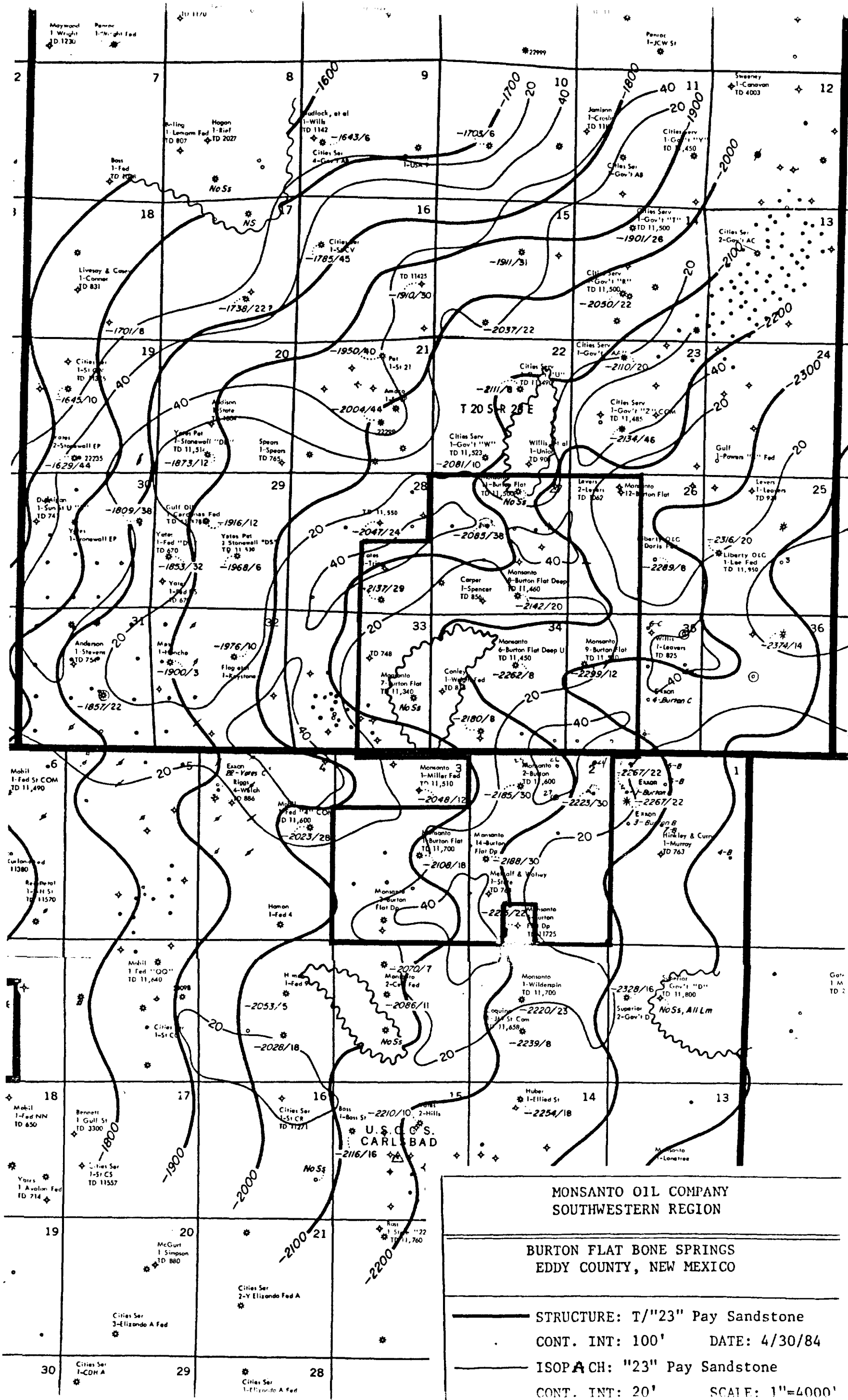

#4791

Monsanto Oil Company

Monsanto Oil Company
1300 One First City Center
500 West Texas
Midland, Texas 79701
Phone: (915) 683-3306

November 26, 1984

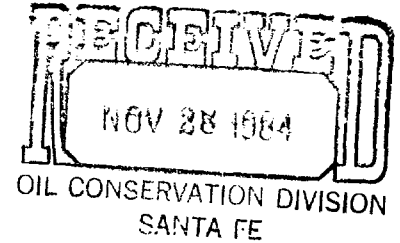

District Manager
Bureau of Land Management
Roswell District Office
P. O. Drawer 1397
Roswell, New Mexico 88201

The Commissioner of Public Lands
State of New Mexico
P. O. Drawer 1148
Santa Fe, New Mexico 87501

New Mexico Oil Conservation Commission
P. O. Box 2088
Santa Fe, New Mexico 87504

ATTN: Mr. Roy Johnson

Gentlemen:

RE: Application for First
Revision of the Participating
Area "A" for the Bone Spring
Formation, Burton Flat Deep
Unit, Eddy County, New Mexico
D-SW-50

Enclosed for each of you are five (5) partially executed documents entitled "Application for First Revision of Participating Area 'A' for the Bone Spring Formation, Burton Flat Deep Unit Agreement".

Expansion of the Bone Spring Participating Area "A" is predicated upon the successful completion on October 26, 1984, of the Burton Flat Unit Well No. 36.

Monsanto requests your immediate approval to the expansion of the Bone Spring Participating Area "A" based upon the completion results of the Burton Flat Unit Well No. 36 in order that accounting problems can be held to an absolute minimum.

If I can be of any further assistance, please apprise.

Very truly yours,

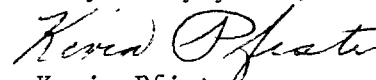

Kevin Pfister
Senior Landman

KP/lab

Enclosures

APPLICATION FOR FIRST REVISION OF THE
PARTICIPATING AREA "A" FOR THE BONE SPRING FORMATION

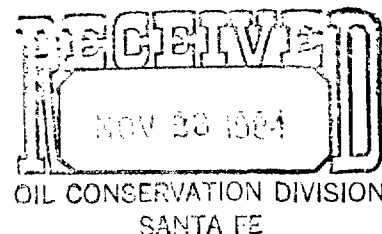
BURTON FLAT DEEP UNIT AGREEMENT
EDDY COUNTY, NEW MEXICO



TO: District Manager
Bureau of Land Management
Roswell District Office
P. O. Drawer 1397
Roswell, New Mexico 88201

The Commissioner of Public Lands
State of New Mexico
P. O. Drawer 1148
Santa Fe, New Mexico 87501

New Mexico Oil Conservation Commission
P. O. Box 2088
Santa Fe, New Mexico 87504
ATTN: Mr. Roy Johnson

MONSANTO OIL COMPANY, as Unit Operator for the Burton Flat Deep Unit Agreement, respectfully requests your approval, pursuant to Section 11 of the Unit Agreement, of the selection of the lands indicated on the land ownership map, attached hereto as Exhibit "A", to constitute the first revision of the Participating Area "A" for the Bone Spring Formation.

As defined, the first revision of the Bone Spring Participating Area "A" embraces 834.62 acres.

The schedule of lands attached hereto as Exhibit "B" described the lands within the Participating Area "A" for the Bone Spring Formation following the first revision thereof and indicates the percentage of participation of each lease and tract within said area.

The first revision of the Bone Spring Participating Area "A" is predicated upon the information obtained by the completion, on October 26, 1984, of Burton Flat Unit No. 36 in Lot 16, Section 2, Township 21 South, Range 27 East, N.M.P.M., Eddy County, New Mexico. Initial oil production from the Burton Flat No. 36 was 96 barrels of oil (flowing) and 316 MCF of gas per day from the Bone Spring Formation at a depth of 5,456 to 5,478 feet.

A Geologic and Engineering Report attached as Exhibit "C" to this Application denotes pertinent test data which justifies the proposed redefinition of the Bone Spring Participating Area "A".

Pursuant to Section 11 of the Unit Agreement, the first revision should be effective October 26, 1984.

Your approval is therefore requested for the selection of lands indicated on attached Exhibit "A" as the First Revision of the Bone Spring Participating Area "A" effective as of October 26, 1984.

DATED this _____ day of November, 1984.

MONSANTO OIL COMPANY

BY: 

J. D. COBB, JR.

REGIONAL EXPLORATION MANAGER

APPROVED this _____ day of _____, 1984, subject to approval by the Commissioner of Public Lands of the State of New Mexico and the New Mexico Oil Conversation Commission.

DISTRICT MANAGER
BUREAU OF LAND MANAGEMENT

APPROVED this _____ day of _____, 1984, subject to the approval of the District Manager, Bureau of Land Management and the New Mexico Oil Conservation Commission.

COMMISSIONER OF PUBLIC LANDS of
the STATE OF NEW MEXICO

APPROVED this 28 day of November, 1984, subject to the approval of the District Manager, Bureau of Land Management and the Commissioner of Public Lands of the State of New Mexico.

NEW MEXICO OIL CONSERVATION COMMISSION

BY: 

TITLE: Senior Petroleum Geologist

R-28-E

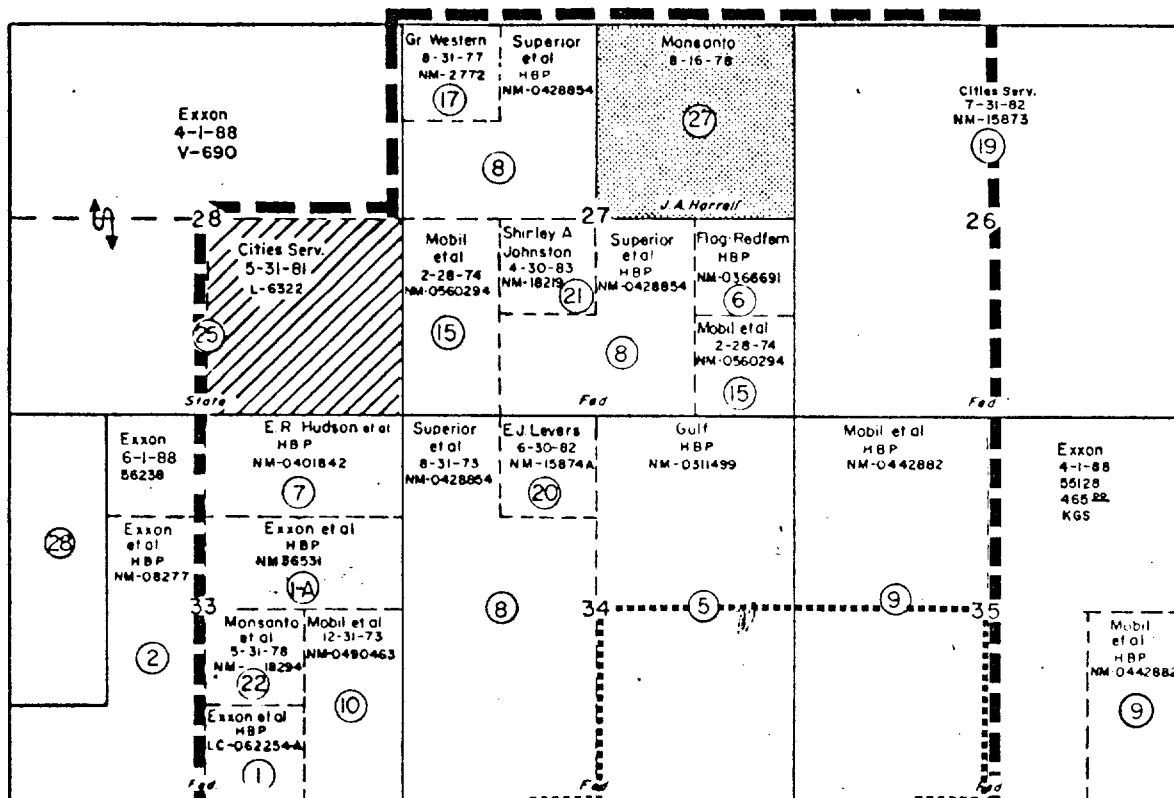

T
20
S

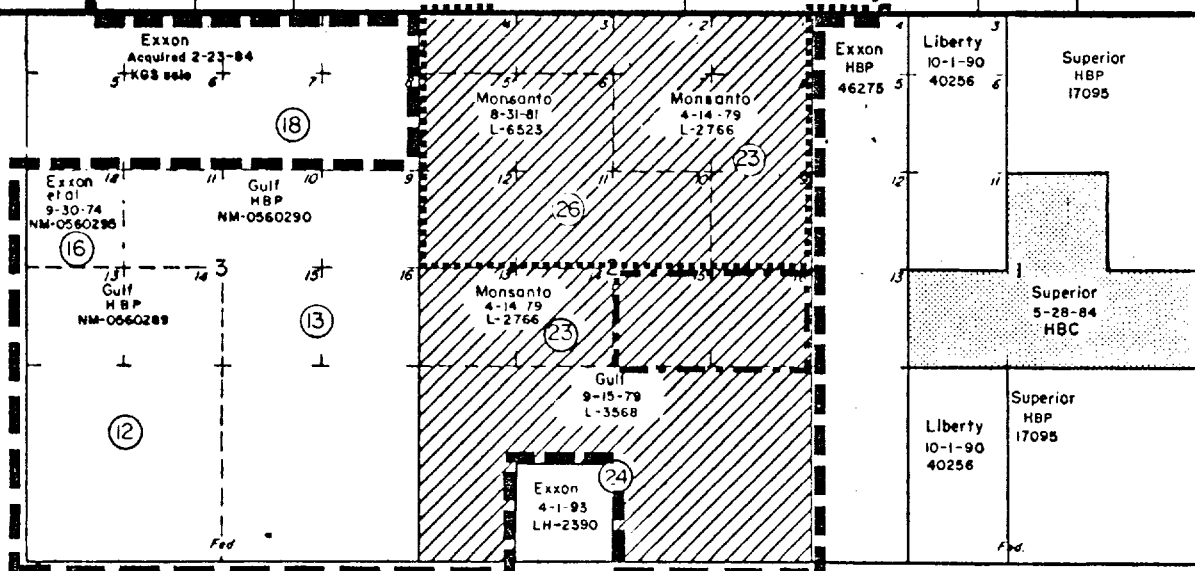

T
21
S

R-27-E

② — Tract Number

 Federal Lands In Participating Area
320 Acres

 State Of New Mexico Lands
In Participating Area
514.62 Acres

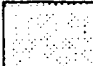
 Patented (Fee) Lands In Participating Area
0 Acres

BURTON FLAT DEEP UNIT
Eddy Co. New Mexico

EXHIBIT "A"

Application for First Revision of Participating
Area "A" Bone Spring Formation
Effective 10/26/84

----- Unit Outline

..... Initial Participating Area "A"

----- First Revised Participating Area "A"

E X H I B I T "B"

FIRST REVISION BONE SPRING FORMATION PARTICIPATING AREA "A"

BURTON FLAT DEEP UNIT AGREEMENT
EDDY COUNTY, NEW MEXICO

TRACT NO.	LEASE NO. OR TYPE OF LAND	DESCRIPTION	PARTICIPATION AREA	PERCENTAGE OF PARTICIPATION	WORKING INTEREST OWNER
5	NM-0311499	T-20-S, R-28-E Section 34: SE/4	160.00	19.170401	Gulf Oil Corporation
9	NM-0442882	T-20-S, R-28-E Section 35: SW/4	160.00	19.170401	Mobil Oil Corporation, et al
23	L-2766 (State of New Mexico)	T-21-S, R-27-E Section 2: Lots 1, 2, 3, 4, 7, 8, and 9	234.62	28.110997	Monsanto Oil Company
26	L-6523 (State of New Mexico)	T-21-S, R-27-E Section 2: Lots 5, 6, 10, 11, 12, 15, and 16	280.00	33.548201	Monsanto Oil Company
RECAPITULATION					
			PARTICIPATING ACRES	COMMITTED	PERCENTAGE OF PARTICIPATION
Total Federal Lands			320.00	320.00	38.340802
Total State Lands			514.62	514.62	61.659198
Total Patented Lands			0.00	0.00	0.000000
TOTALS			834.62	834.62	100.000000

EXHIBIT "C"

GEOLOGIC AND ENGINEERING REPORT

BURTON FLAT DEEP UNIT
EDDY COUNTY, NEW MEXICO

RE: Application for First Revision of Participating Area "A"
Bone Spring Formation - Effective October 26, 1984

1. Burton Flat Unit Well No. 36

A. GENERAL

Burton Flat Well No. 36 is completed in the Bone Spring Formation. This is the sixth Bone Spring producer within the Burton Flat Unit and necessitates the establishment of a First Revision of the Bone Spring Participating Area "A".

The Bone Spring was encountered at 5,457' (-2,244' Subsea) and is a marine sandstone. Attached is a structure map on the top of the Bone Spring sandstone pay. Superimposed on this map is the Isopach of that sandstone. Following is a summary of location and tops encountered in Burton Flat No. 36:

	<u>Burton Flat No. 36</u>
Location	3,300' FSL & 660' FEL Sec. 2, T-21-S, R-27-E
Total Depth	5,600'
Elevation (KB)	3,214'
<u>Tops:</u>	
Capitan Reef	1,230'
Delaware	2,620'
Bone Spring	5,311'

B. BONE SPRING COMPLETION

Burton Flat No. 36 is completed in the Bone Spring Formation.
Casing and perforations are:

	<u>Burton Flat No. 36</u>
<u>Surface</u>	
Depth	600'
Size	13-3/8"
Weight	54.5#/Ft.
Cement	600 Sacks
<u>Intermediate</u>	
Depth	2,639'
Size	8-5/8"
Weight	32# and 24#/Ft.
Cement	1,400 Sacks
<u>Production</u>	
Depth	5,604'
Size	5-1/2"
Weight	17#/Ft.
Cement	850 Sacks
<u>Bone Spring Perforations</u>	
	5,456' - 5,478' (22')
<u>Potential Test</u>	
	Flowed 96 BOPD, 1 BWPD, 316 MCFGPD

C. PRESENT STATUS

The well was completed on October 26, 1984. Oil sales are to Permian Corporation and casinghead gas is being sold to Phillips Petroleum Company.

D. COMMERCIAL PRODUCTION ESTABLISHED

Commercial determination is proven by 1) volumetric reserves calculation and 2) decline curve analysis based on well test data. (See calculations on next page.)

Burton Flat Unit Well No. 36

VOLUMETRIC RESERVES

	<u>INTERVAL</u>	<u>NET PAY</u>	<u>Ø</u>	<u>S_w</u>
A)	5,457' - 5,462'	5'	14.0	26
B)	5,462' - 5,470'	8'	20.5	16
C)	5,470' - 5,480'	10'	17.0	19

$$A = \frac{15 (7758) (40) (5) (.14) (1-.26)}{1.4}$$

A = 17,223 BO

B = 45,803 BO

C = 45,783 BO

108,809 BO.....Total Volumetric Reserve Estimate

WELL TESTS

11-11-84 -- 96 BO, 1/2 BW, 316 MCFGPD

DECLINE CURVE RESERVES

EUR based on IP and 30% Decline Rate - 98,509 BO.

Total Casinghead Gas production is estimated at 400 MCF (0.4 BCF).

Decline curve rate of 30% is based on field history to date and agrees within 10% of volumetric estimate.

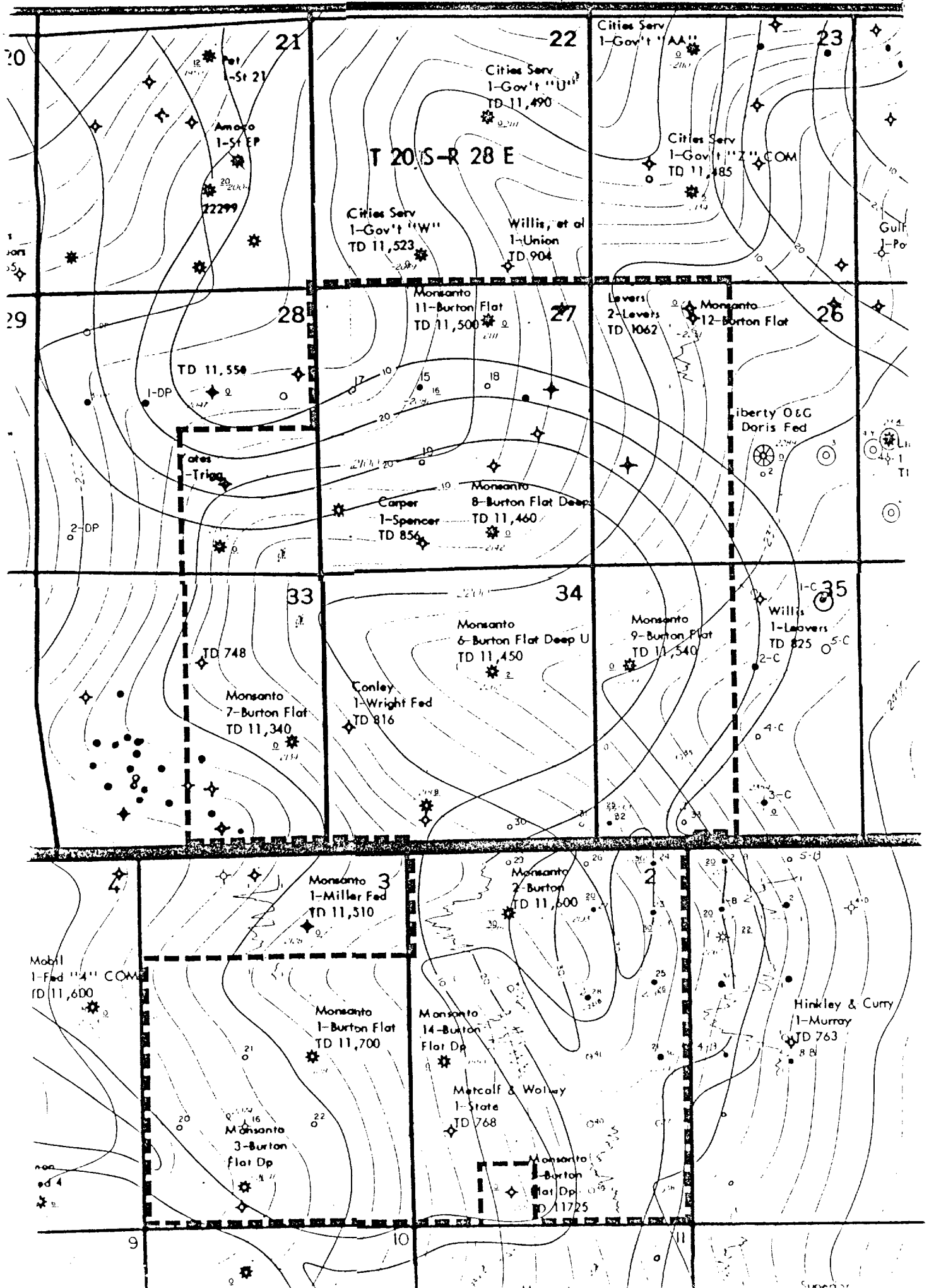

Monsanto Oil Company

1300 One First City Center
500 West Texas
Midland, Texas 79701
Phone: (915) 683-3306

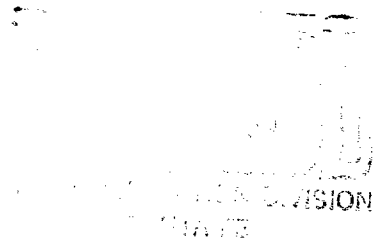

November 12, 1984

The Commissioner of Public Lands
State of New Mexico
Post Office Drawer 1148
Santa Fe, New Mexico 87501

New Mexico Oil Conservation Commission
Post Office Box 2088
Santa Fe, New Mexico 87504
Attn: Mr. Roy Johnson

Re: Application for Initial Participating Area "A", Bone Springs Formation, consisting of 754.62 acres described as T-20-S, R-28-E, Sec. 34: SE/4; Sec. 35: SW/4; T-21-S, R-27-E, Sec. 2: Lots 1-12, Eddy County, New Mexico

Gentlemen:

Enclosed please find a copy of the captioned document for your files. Please note that the effective date of the initial participating area has been changed from March 2, 1984, to May 25, 1984, per request of the BLM.

Monsanto is now drilling additional wells outside the established participating area. If successful, a second revision of the Bone Spring Participating Area will be sent to all parties for their approval.

If I may be of any further assistance, please apprise.

Very truly yours,

Kevin Pfister

KP/pwh
Encl.



United States Department of the Interior

BUREAU OF LAND MANAGEMENT

Roswell District Office

P. O. Box 1397

Roswell, New Mexico 88201

IN REPLY
REFER TO:

14-08-0001-12391

November 8, 1984

Monsanto Oil Company
1300 One First City Center
500 West Texas
Midland, TX 79701

Gentlemen:

Your letter of June 8, 1984, indicates that as unit operator of the Burton Flat Deep Unit, Eddy County, New Mexico, you have determined that unit wells No. 23, 24, and 27, located in section 2, T. 21 S., R. 27 E., N.M.P.M., are capable of producing unitized substances in paying quantities.

This office concurs with your determination that such wells are capable of producing unitized substances in paying quantities from the Bone Springs Formation pursuant to section 9 of the unit agreement. Your application for the Bone Springs "A" Participating Area is being reviewed at this time.

Sincerely yours,

District Manager

Acting

RECEIVED
LAND DEPT.

NOV 12 1984



United States Department of the Interior

BUREAU OF LAND MANAGEMENT

Roswell District Office

P. O. Box 1397

Roswell, New Mexico 88201

IN REPLY
REFER TO:

14-08-001-12391

November 8, 1984

Monsanto Oil Company
1300 One First City Center
500 West Texas
Midland, TX 79701

Gentlemen:

Your application of June 8, 1984, requesting approval of the Initial Bone Springs "A" Participating Area for the Burton Flat Deep Unit, Eddy County, New Mexico, is approved on November 8, 1984 and effective as of May 25, 1984. Section 11 of the unit agreement requires the effective date to be the date of completion of the well initiating the request. Since unit well No. 27 is included and the data obtained from the drilling of that well is used in establishing the participating area, the completion date of unit well No. 27 will be the effective date of the participating area.

The Initial Bone Springs "A" Participating Area embraces 754.62 acres described as the following:

T. 20 S., R. 28 E., N.M.P.M., Eddy County, New Mexico
sec. 34, SE $\frac{1}{4}$;
sec. 35, SW $\frac{1}{4}$.

T. 21 S., R. 27 E., N.M.P.M.
sec. 2, lots 1 through 12.

Such participating area is based on completion of unit wells 23, 24, and 27, located in section 2, T. 21 S., R. 27 E., N.M.P.M. Unit well No. 23 was completed on March 2, 1984. Unit well No. 24 was completed on May 20, 1984. Unit well No. 27 was completed on May 25, 1984. The wells were determined to be paying wells pursuant to section 9 of the unit agreement by letter dated November 7, 1984.

Copies of the approved application are being distributed to the appropriate Federal office and one copy is returned herewith. You are requested to

RECEIVED
LAND DEPT.

NOV 12 1984

furnish the State of New Mexico and all interested parties with evidence of this approval.

Sincerely yours,

T. R. Kuehn

District Manager

Acting

Enclosure

APPLICATION FOR INITIAL PARTICIPATING AREA "A"

BONE SPRINGS FORMATION
BURTON FLAT DEEP UNIT AGREEMENT
EDDY COUNTY, NEW MEXICO

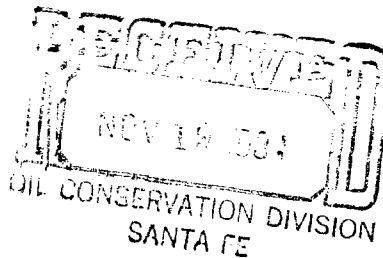

TO: District Manager
Bureau of Land Management
P. O. Drawer 1397
Roswell, New Mexico 88201

The Commissioner of Public Lands
State of New Mexico
P. O. Drawer 1148
Santa Fe, New Mexico 87501

MONSANTO OIL COMPANY, as Unit Operator for the Burton Flat Deep Unit Agreement, respectfully requests your approval, pursuant to Section 11 of the Unit Agreement, of the selection of the lands indicated on the land ownership map, attached hereto as Exhibit "A", to constitute the initial participating area "A" for the Bone Springs Formation.

As defined, the initial Bone Springs participating area "A" embraces 754.62 acres.

The schedule of lands attached hereto as Exhibit "B" described the lands within the initial participating area "A" for the Bone Springs Formation and indicates the percentage of participation of each lease and tract within said area.

A geologic and engineering report to which is attached pertinent test data, is being submitted separately as justification for the proposed definition of the Bone Springs participating area "A".

The initial Bone Springs participating area "A" is predicated upon the formation obtained by the completion on March 2, 1984, of the Burton Flat Unit No. 23, in Lot 8 of Section 2, T-21-S, R-27-E, N.M.P.M., Eddy County, New Mexico. Initial oil production from the Burton Flat No. 23 was 11.7 barrels of oil (flowing) and 350 MCF of gas in seven hours from the Bone Springs Formation at a depth of 5,413 to 5,440 feet. The initial Bone Springs Participating Area "A" is also predicated upon information obtained by the completion on May 20, 1984, of the Burton Flat Unit Well No. 24, in Lot 1 of Section 2, T-21-S, R-27-E, N.M.P.M., Eddy County, New Mexico. Initial oil production from the Burton Flat No. 24 was 105

BOPD (flowing) and 290 MCFGPD from the Bone Springs Formation at a depth of 5,454 to 5,482 feet. The initial Bone Springs participating area is also predicated upon information obtained by the completion on May 25, 1984 of the Burton Flat Unit Well No. 27, in Lot 7 of Section 2, T-21-S, R-27-E, N.M.P.M., Eddy County, New Mexico. Initial oil production from the Burton Flat No. 27 was 120 BOPD (flowing) and 200 MCFGPD from the Bone Springs formation at a depth of 5,395 to 5,420 feet.

Pursuant to Section 11 of the Unit Agreement, the effective date of the initial participating area "A" should be ~~March 2, 1984~~ *MAY 25 A.B. CHANGED PER DISCUSSION WITH KEVIN PFISTER 11/7/84*

Your approval is, therefore, requested for the selection of the lands indicated on attached Exhibit "A" as the initial Bone Springs participating area "A" effective ~~March 2, 1984~~ *MAY 25 CHANGED PER DISCUSSION WITH KEVIN PFISTER 11/7/84 L. Babayak*

DATED this 8th day of June, 1984.

MONSANTO OIL COMPANY

BY

J. D. Cobb, Jr.
J. D. COBB, JR.
REGIONAL EXPLORATION MANAGER

APPROVED this 8th day of ~~November~~, 1984, subject to approval by the Commissioner of Public Lands of the State of New Mexico.

Acting

T. R. Keegan
DISTRICT MANAGER
BUREAU OF LAND MANAGEMENT

APPROVED this _____ day of _____, 1984, subject to the approval of the District Manager, Bureau of Land Management.

COMMISSIONER OF PUBLIC LANDS of
the STATE OF NEW MEXICO

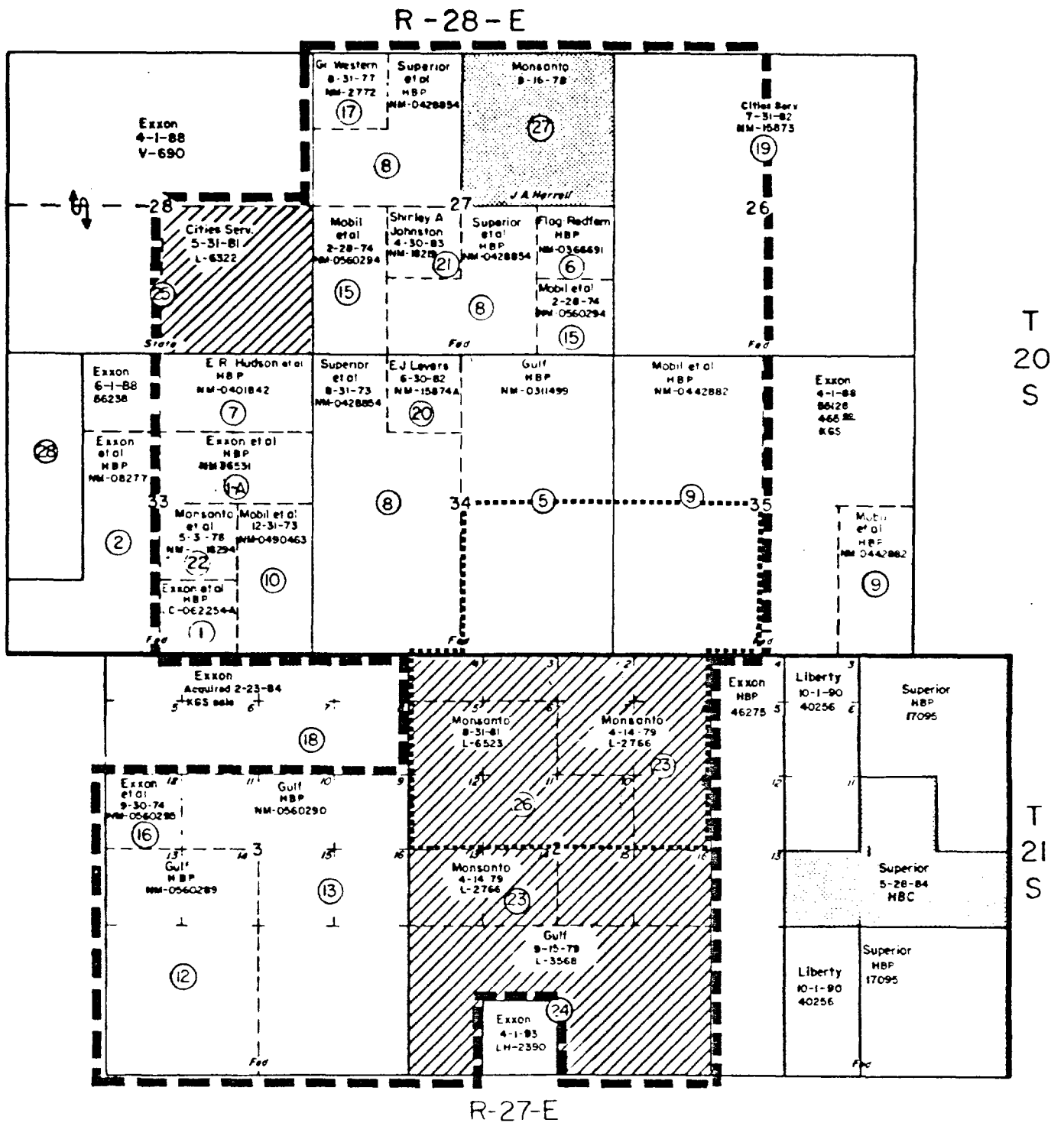

② — Tract Number

Federal Lands

State Of New Mexico Lands

Patented (Fee) Lands

Unit Outline

Initial Participating Area

BURTON FLAT DEEP UNIT

Eddy Co. New Mexico

EXHIBIT "A"

Application for Initial Participating Area 'A'
Bone Springs Formation
Effective 3/2/84

E X H I B I T "B"

INITIAL BONE SPRINGS FORMATION PARTICIPATING AREA "A"

BURTON FLAT DEEP UNIT AGREEMENT

EDDY COUNTY, NEW MEXICO

TRACT NO.	LEASE NO. OR TYPE OF LAND	DESCRIPTION	<u>PARTICIPATION</u>		WORKING INTEREST OWNER
			AREA	PERCENTAGE OF PARTICIPATION	
5	NM-0311499	T-20-S, R-28-E Section 34: SE/4	160.00	21.202725	Gulf Oil Corporation
9	NM-0442882	T-20-S, R-28-E Section 35: SW/4	160.00	21.202725	Mobil Oil Corporation, et al
23	L-2766 (State of New Mexico)	T-21-S, R-27-E Section 2: Lots 1, 2, 3, 4, 7, 8, 9	234.62	31.091145	Monsanto Company
26	L-6523 (State of New Mexico)	T-21-S, R-27-E Section 2: Lots, 5, 6, 10, 11, 12	200.00	26.503405	Monsanto Company

R E C A P I T U L A T I O N

	<u>PARTICIPATING</u>		<u>COMMITTED</u>		<u>PERCENTAGE OF PARTICIPATION</u>
	ACRES				
Total Federal Lands	320.00		320.00		42.405450
Total State Lands	434.62		434.62		57.594550
Total Patented Lands	<u>0.00</u>		<u>0.00</u>		<u>0.000000</u>
TOTAL	754.62		754.62		100.000000

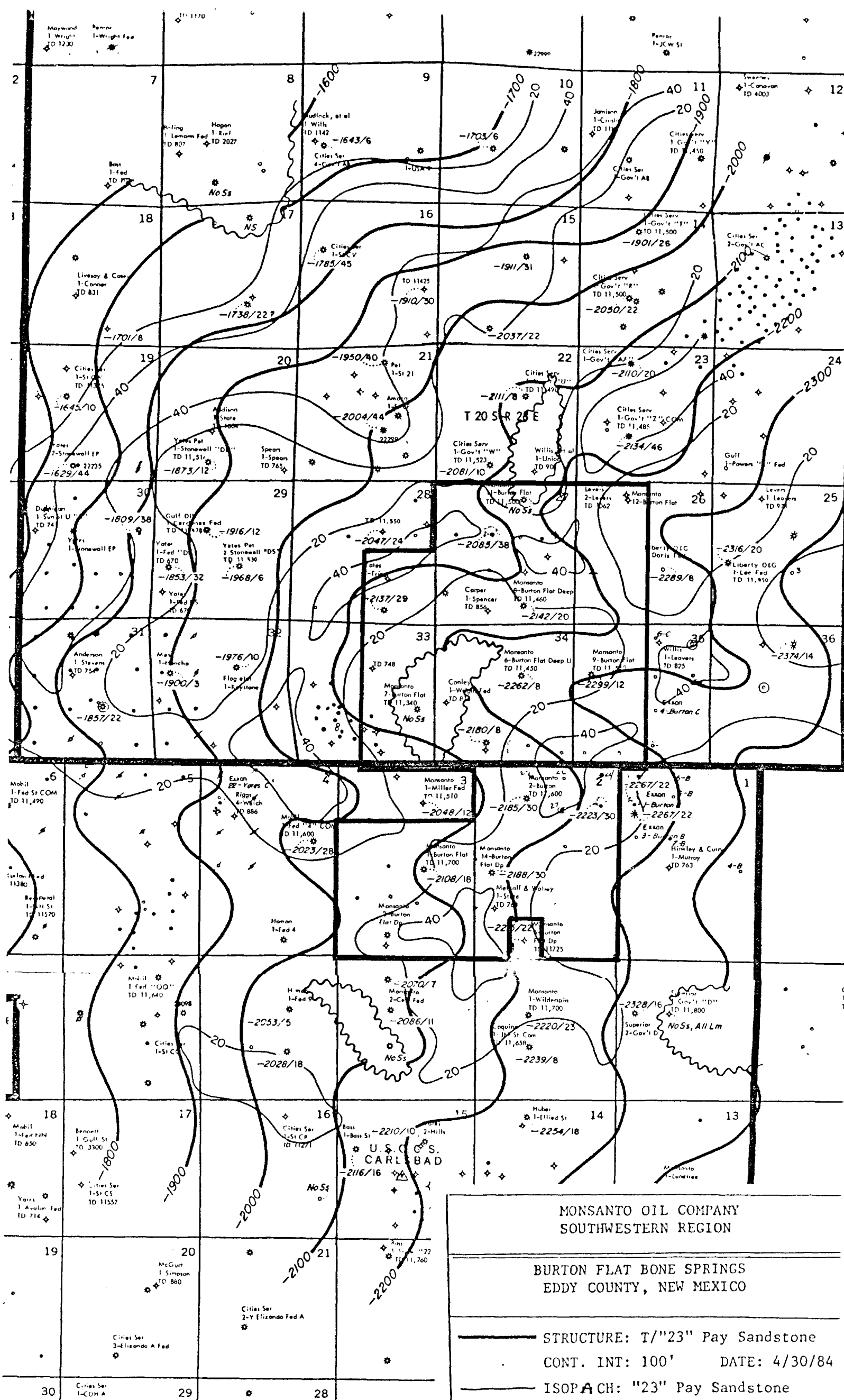

MONSANTO OIL COMPANY
SOUTHWESTERN REGION

BURTON FLAT BONE SPRINGS
EDDY COUNTY, NEW MEXICO

STRUCTURE: T/'23" Pay Sandstone
CONT. INT: 100' DATE: 4/30/84
ISOPACH: "23" Pay Sandstone
CONT. INT: 20' SCALE: 1"=400'

GEOLOGIC AND ENGINEERING REPORT

BURTON FLAT DEEP UNIT

EDDY COUNTY, NEW MEXICO

RE: Application for Initial Participating Area "A"
Bone Springs Formation-Effective March 2, 1984

1. Burton Flat Unit Well No. 23

A. GENERAL

Burton Flat Well No. 23 is completed in the Bone Springs Formation. This is the second Bone Springs producer within the Burton Flat Unit and necessitates the establishment of a second Bone Springs participating area.

The Bone springs was encountered at 5,294' (-2,105' Subsea) and is a marine sandstone. Attached is a structure map on the top of the Bone Springs sandstone. Superimposed on this map is the Isopach of that sandstone. Following is a summary of location and tops encountered in Burton Flat No. 23:

	<u>Burton Flat No. 23</u>
Location	1,527' FNL & 744' FEL Sec. 2, T-21-S, R-27-E
Total Depth	5,700'
Elevation (KB)	3,189'
<u>Tops:</u>	
Capitan Reef	1,200' (+1,989')
Delaware	2,650' (+ 539')
Bone Springs	5,293' (-2,104')

B. BONE SPRINGS COMPLETION

Burton Flat No. 23 is completed in the Bone Springs. Casing and perforations are:

Burton Flat No. 23

Surface

Depth	634'
Size	13-3/78"
Weight	48# and 68#/Ft.
Cement	600 Sacks

Intermediate

Depth	2,604'
Size	8-5/8"
Weight	24# and 32#/Ft.
Cement	850 Sacks

Production

Depth	5,700'
Size	5-1/2"
Weight	15-1/2# and 17#/Ft.
Cement	900 Sacks

Bone Springs Perforations

5,413' = 5,440' (27')

Potential Test

Flowed 40 BOPD, Trace
Water, 1,200 MCFGPD

C. PRESENT STATUS

The well was completed on March 2, 1984. The well had been shut-in awaiting the completion of Phillips Company's low pressure casinghead gas line. The line was completed at the end of April 1984, and sales begun at that time. Oil sales are to Permian Corporation and casinghead gas is being sold to Phillips Petroleum Company.

D. COMMERCIAL PRODUCTION ESTABLISHED

Commercial production rates are indicated by the potential test.

Good reservoir size is expected due to the 27' pay section, which is correlative to the subsequently drilled Burton Flat Unit Wells #24 and #27.

2. Burton Flat Unit Well No. 24

A. GENERAL

Burton Flat Well No. 24 is completed in the Bone Springs Formation. This is the third Bone Springs producer within the Burton Flat Unit.

The Bone Springs was encountered at 5,378' (-2,183' Subsea) and is a marine sandstone. Following is a summary of location and tops encountered in Burton Flat No. 24:

	<u>Burton Flat No. 24</u>
Location	426' FNL & 660' FEL Sec. 2, T-21-S, R-27-E
Total Depth	6,000'
Elevation (KB)	3,195'
<u>Tops:</u>	
Capitan Reef	1,430' (+1,765')
Delaware	2,660' (+ 545')
Bone Springs	5,378' (-2,183')

B. BONE SPRINGS COMPLETION

Burton Flat No. 24 is completed in the Bone Springs. Casing and perforations are:

Burton Flat No. 24

Surface

Depth	609'
Size	13-3/8"
Weight	48#/Ft.
Cement	600 Sacks

Intermediate

Depth	2,560'
Size	8-5/8"
Weight	24#/Ft.
Cement	2,600 Sacks

Production

Depth	6,600'
Size	5-1/2"
Weight	17#/Ft.
Cement	900 Sacks

Bone Springs Perforations

5,454' - 5,482' (28')

Potential Test

Flowed 105 BOPD, 0
BWPD, 290 MCFGPD

C. PRESENT STATUS

The well was completed on May 20, 1984. Oil sales are to Permian Corporation and casinghead gas is being sold to Phillips Petroleum Company.

D. COMMERCIAL PRODUCTION ESTABLISHED

Commercial production rates are indicated by the potential test. Good reservoir size is expected due to the 28' pay section, which is correlative in the Burton Flat Unit #23 and #27, both of which are producing.

3. Burton Flat Unit Well No. 27

A. GENERAL

Burton Flat Well No. 27 is completed in the Bone Springs Formation. This is the fourth Bone Springs producer within the Burton Flat Unit.

The Bone Springs was encountered at 5,278' (-2,068' Subsea) and is a marine sandstone. Following is a summary of location and tops encountered in Burton Flat No. 27:

	<u>Burton Flat No. 27</u>
Location	1612' FNL & 1980' FEL Sec. 2, T-21-S, R-27-E
Total Depth	6,250'
Elevation (KB)	3,205'
<u>Tops:</u>	
Capitan Reef	1,030' (+2,175')
Delaware	2,644' (+ 561')
Bone Springs	5,278' (-2,068')

B. BONE SPRINGS COMPLETION

Burton Flat No. 27 is completed in the Bone Springs. Casing and perforations are:

	<u>Burton Flat No. 27</u>
<u>Surface</u>	
Depth	600'
Size	13-3/8"
Weight	48#/Ft.
Cement	500 Sacks

Intermediate

Depth	2,573'
Size	8-5/8"
Weight	24#/Ft.
Cement	1400 Sacks

Production

Depth	6,250'
Size	5-1/2"
Weight	15.5#/Ft.
Cement	975 Sacks

Bone Springs Perforations

5,395' - 5,420' (25')

Potential Test

Flowed 120 BOPD, 20
BWPD, 200 MCFGPD

C. PRESENT STATUS

The well was completed on May 25, 1984. Oil sales are to Permian Corporation and casinghead gas is being sold to Phillips Petroleum Company.

D. COMMERCIAL PRODUCTION ESTABLISHED

Commercial production rates are indicated by the potential test. Good reservoir size is expected due to the 25' pay section, which is correlative in the Burton Flat Unit #23 and #24, both of which are producing.

INITIAL PARTICIPATING AREA

In our opinion, the Burton Flat Unit Wells #23, 24, and 27 have established commercial Bone Springs production and the initial participating area should include and be limited to the 754.62 Acre area outlined by the plat attached as Exhibit "A" to the Application for Initial Participating Area "A".

State of New Mexico

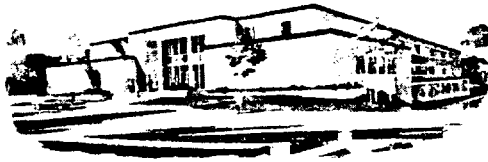

JIM BACA
COMMISSIONER

Commissioner of Public Lands

October 25, 1984

P.O. BOX 1148
SANTA FE, NEW MEXICO 87504-1148
Express Mail Delivery Used
310 Old Santa Fe Trail
Santa Fe, New Mexico 87501

Union Oil Company of California
500 North Marienfeld
Midland, Texas 79701

Re: Laguna Deep Unit
Automatic Contraction
Morrow Participating Area
Effective February 9, 1984
Lea County, New Mexico

ATTENTION: Mr. Robert V. Lockhart

Gentlemen:

This office is in receipt of your letter of May 31, 1984, accompanied by revised Exhibits "A" and "B" which correctly describes the lands remaining in the Laguna Deep Unit, Lea County, New Mexico following the automatic elimination pursuant to Section 2 (e) of the unit agreement. The lands eliminated contain 638.04 acres covering the E/2 of Section 34, Township 19 South, Range 33 East, 320.00 acres and Lots 1,2,3,4,S/2N/2 of Section 2, Township 20 South, Range 33 East, 318.04 acres of which no part was included in the Morrow Participating Area. The revised unit area includes only those lands within the Morrow Participating Area which contains 1,920.00 acres.

This office concurs with your description of the lands remaining in the Laguna Deep Unit following the automatic elimination, effective February 9, 1984 and has this date accepted your revised Exhibits "A" and "B" which reflect this contraction. This action is subject to like concurrence by the Bureau of Land Management.

Very truly yours,

JIM BACA
COMMISSIONER OF PUBLIC LANDS

BY: *Ray D. Graham*
RAY D. GRAHAM, Director
Oil and Gas Division
AC 505/827-5744

JB/RDG/pm
encls.

cc: OCD-Santa Fe, New Mexico
BLM-Albuquerque, New Mexico
BLM-Roswell, New Mexico



United States Department of the Interior

BUREAU OF LAND MANAGEMENT
Box 139Z, Roswell, New Mexico - 88201

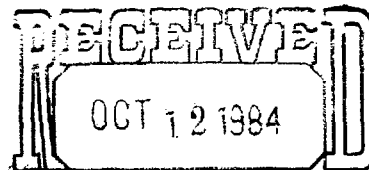

14-08-0001-12391

October 9, 1984

OIL CONSERVATION DIVISION
SANTA FE

Monsanto Oil Company
Attention: Kevin Pfister
1300 One First City Center
500 West Texas
Midland, TX 79701

RE: Application for Initial
Participating Area for Bone Springs
Formation, Burton Flat Deep Unit,
Eddy County, New Mexico

Gentlemen:

Your letter of June 8, 1984 indicates that as unit operator of the Burton Flat Deep Unit, Eddy County, New Mexico, you have determined that Unit well No. 15 in the SE $\frac{1}{4}$ NW $\frac{1}{4}$ of Section 27, T. 20 S., R. 28 E., N.M.P.M., Eddy County, New Mexico is capable of producing unitized substances in paying quantities from the Bone Springs formation and have also applied for the establishment of the initial Bone Springs Participating Area which you have determined to be the NW $\frac{1}{4}$, Section 27, T. 20 S., R. 28 E., N.M.P.M., Eddy County, New Mexico, a total of 160.00 acres.

We have analyzed your data from Mr. D.E. Brown, Regional Production Manager, dated September 13, 1984, and do not feel that Unit well No. 15 is capable of producing unitized substances from the Bone Springs formation pursuant to Section 9 of the Unit Agreement, and therefore that establishment of the initial Bone Springs Participating Area is not justified.

Should you have any additional information to support this application, we would be more than happy to review it.

Sincerely yours,

~~John Sgd. Earl R. [unclear]~~

District Manager

cc: Commissioner of Public Lands, Santa Fe
NMOCD

TENTH PLAN OF DEVELOPMENT AND OPERATIONBURTON FLAT DEEP UNIT AREA
EDDY COUNTY, NEW MEXICO

#4791

To: District Manager
Bureau of Land Management
Post Office Box 1397
Roswell, New Mexico 88201

The Commissioner of Public Lands
State of New Mexico
P. O. Drawer 1148
Santa Fe, New Mexico 87501

New Mexico Oil Conservation Commissioner
Post Office Box 2088
Santa Fe, New Mexico 87504

ATTN: Mr. Roy Johnson

MONSANTO OIL COMPANY, as Unit Operator for the Burton Flat Deep Unit Area, pursuant to the provisions of Section 10, of the Unit Agreement for Development and Operation of the Burton Flat Deep Unit Area dated July 1, 1972 (No. 14-08-0001-12391), respectfully submits for the approval of the District Manager, Bureau of Land Management, or his duly authorized representative, the Commissioner of Public Lands, and the New Mexico Oil Conservation Commission, this Tenth Plan of Development and Operation for the Burton Flat Deep Unit Area. This plan is for the period January 1, 1985, to January 1, 1986.

The following wells have been drilled and completed within the Burton Flat Deep Unit Area since August 29, 1972, which was the effective date of the Unit Agreement, to-wit:

<u>UNIT WELL</u>	<u>LOCATION</u>	<u>COMPLETION DATE</u>	<u>TOTAL DEPTH</u>	<u>ZONE</u>
Unit Well No. 1	Lot 15 Section 3, T-21-S, R-27-E	November 3, 1972	11,700'	Morrow (S-I)
Unit Well No. 2	Lot 6 Section 2, T-21-S, R-27-E	January 24, 1973	11,600'	Bone Spring (S-I)
Unit Well No. 3	SE/4 SW/4 Section 3, T-21-S, R-27-E	April 16, 1973	11,546'	Strawn (Prod) Morrow (Prod)
Unit Well No. 4	SE/4 SW/4 Section 34, T-20-S, R-28-E	July 23, 1973	11,500'	Strawn (S-I) Morrow (Prod)
Unit Well No. 5	SE/4 SW/4 Section 2, T-21-S, R-27-E	October 10, 1973	11,725'	Strawn (P&A)
Unit Well No. 6	SW/4 NE/4 Section 34, T-20-S, R-28-E	November 5, 1973	11,450'	Morrow (Prod)
Unit Well No. 7	NE/4 SE/4 Section 33, T-20-S, R-28-E	November 19, 1973 (Recompleted to Wolfcamp 6/16/78)	11,540'	Wolfcamp (S-I)
Unit Well No. 8	SW/4 SE/4 Section 27, T-20-S, R-28-E	January 3, 1974	11,460'	Morrow (Prod)
Unit Well No. 9	SW/4 NW/4 Section 35, T-20-S, R-28-E	March 5, 1974	11,540'	Strawn (S-I) Morrow (S-I)
Unit Well No. 11	NW/4 NE/4 Section 27, T-20-S, R-28-E	May 28, 1974	11,500'	Morrow (Prod)
Unit Well No. 12	NE/4 NW/4 Section 26, T-20-S, R-28-E	May 1, 1975	11,475'	Wolfcamp (S-I)
Unit Well No. 13	SW/4 SE/4 Section 28, T-20-S, R-28-E	December 26, 1974	11,560'	Morrow (S-I)

<u>UNIT WELL</u>	<u>LOCATION</u>	<u>COMPLETION DATE</u>	<u>TOTAL DEPTH</u>	<u>ZONE</u>
Unit Well No. 14	Lot 13 Section 2, T-21-S, R-27-E	June 26, 1975	11,610'	Morrow (Prod)
Unit Well No. 15	SE/4 NW/4 Section 27, T-20-S, R-28-E	February 6, 1984	5,600'	Bone Spring (Prod)
Unit Well No. 16	NE/4 SW/4 Section 3, T-21-S, R-27-E	Reached Total Depth January 9, 1984	5,500'	Bone Spring (S-I)
Unit Well No. 23	Lot 8 Section 2, T-21-S, R-27-E	March 1, 1984	5,700'	Bone Spring (Prod)
Unit Well No. 24	Lot 1 Section 2, T-21-S, R-27-E	May 20, 1984	6,000'	Bone Spring (Prod)
Unit Well No. 25	Lot 9 Section 2, T-21-S, R-27-E	August 23, 1984	5,702'	Bone Spring (Prod)
Unit Well No. 27	Lot 7 Section 2, T-21-S, R-27-E	May 25, 1984	6,250'	Bone Spring (Prod)
Unit Well No. 28	Lot 10 Section 2, T-21-S, R-27-E	December 1984	5,602'	Bone Spring (Prod)
Unit Well No. 32	SW/4 SW/4 Section 35, T-20-S, R-28-E	August 7, 1984	5,700'	Bone Spring (Prod)
Unit Well No. 33	SE/4 SW/4 Section 35, T-20-S, R-28-E	Total Depth Reached September 1984	5,638'	Bone Spring (S-I)
Unit Well No. 36	Lot 16 Section 2 T-21-S, R-27-E	October 1984	5,606'	Bone Spring (Prod)
Unit Well No. 37	NE/4 SE/4 Section 2 T-21-S, R-27-E	January 17, 1985	5,650'	Delaware (S-I)

Additional unit wells have been permitted which may be drilled during the period covered by this Tenth Plan of Development and Operation, to-wit:

<u>UNIT WELL</u>	<u>LOCATION</u>	<u>COMPLETION DATE</u>	<u>TOTAL DEPTH</u>	<u>ZONE</u>
Unit Well No. 26	Lot 2, Section 2, T-21-S, R-28-E	May Spud 2nd or 3rd Quarter 1985	5,700'	Bone Spring
Unit Well No. 31	SE/4 SE/4 Section 34, T-20-S, R-28-E	May Spud 3rd Quarter 1985	5,700' (Est.)	Bone Spring
Unit Well No. 41	Lot 15, Section 2, T-21-S, R-28-E	May Spud 3rd Quarter 1985	5,700' (Est.)	Bone Spring

In addition, two wells may be drilled in the S/2 SE/4 of Section 2, T-21-S, R-28-E, to the Bone Springs, approximate total depth 5,700 feet, and one well may be drilled in W/2 of Section 2 T-20-S, R-28-E. These wells have not been staked or applied for.

Current gas market conditions affect the producing status of some of the Unit Wells, and some wells reflected above as producing may be intermittently shut-in.

During the period covered by this Tenth Plan of Development and Operation for the Burton Fls Deep Unit Area, an orderly development and evaluation of the Delaware Mountain Group and Bone Spring reservoirs is planned, subject to approval, during 1985 or until the reservoir limits have been established. Geological and production data from each well drilled within the unit boundaries or the immediate surrounding area, will be evaluated upon completion, and additional locations selected on the basis of evaluation of such data.

During the period covered by this Tenth Plan of Development and Operation, participating areas will be determined and submitted for approval.

Workover operations on several unit wells may begin in 1985 to improve production. Wells slated for possible workovers include Unit Wells Nos. 3, 9, 11, and 14. Presently the Working Interest Owners are studying and evaluating the geology and production data applicable to the Unit Area and immediate area surrounding the unit boundaries to determine what, if any, additional operations appear to be warranted as to the Unit Area.

This Tenth Plan of Development and Operation shall constitute the further obligations of the Operator under the Burton Flat Deep Unit Agreement for the period ending January 1, 1986, and may be modified or supplemented from time to time with the approval of the District Manager, Bureau of Land Management, Commissioner of Public Lands, and New Mexico Oil Conservation Commission when necessary to meet changed conditions or to protect the interest of all parties to the Unit Agreement.

Approval of this Tenth Plan of Development and Operation for the Burton Flat Deep Unit Area is respectfully requested.

Submitted this _____ day of January, 1985.

MONSANTO OIL COMPANY

BY: 

J. D. COBB, JR.
Regional Exploration Manager

APPROVED this _____ day of _____, 1985,
subject to approval by the Commissioner of Public
Lands, State of New Mexico, and New Mexico Oil
Conservation Commission.

BUREAU OF LAND MANAGEMENT
District Manager

APPROVED this _____ day of _____, 1985,
subject to approval by the District Manager,
Bureau of Land Management and New Mexico Oil
Conservation Commission.

THE COMMISSIONER OF PUBLIC LANDS
State of New Mexico

APPROVED this 19th day of Feb., 1985,
subject to like approval by the District Manager,
Bureau of Land Management, and the Commissioner
of Public Lands, State of New Mexico.

NEW MEXICO OIL CONSERVATION COMMISSION

BY: 

TITLE: Senior Petroleum Geologist