

Case 4972

Griffin, Ross & Burnett, Inc.

Oil Properties

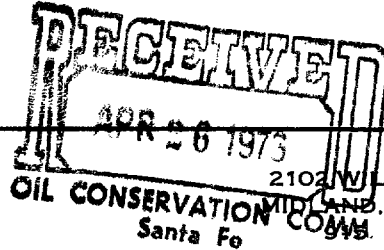

KENNETH H. GRIFFIN
ROBERT B. ROSS
GARY G. BURNETT

April 25, 1973

Re: File No. 2197
Proposed Forty-Niner Ridge Unit
Eddy County, New Mexico

OIL CONSERVATION COMMISSION
State Land Office Building
Santa Fe, New Mexico

Attention: Mrs. Ida Rodriguez

Gentlemen:

In behalf of Skelly Oil Company it is requested that a hearing be set at your scheduled meeting of May 23, 1973, to consider the approval of the proposed Forty-Niner Ridge Unit in Eddy County, New Mexico, as outlined on the attached plat and lease schedule.

This unit will be for exploratory purposes and covers 7,678.8 acres, being owned as follows:

<u>Owner</u>	<u>Acres</u>	<u>Percentage</u>
<u>U.S.A.</u>	6,238.80	81.247
<u>State</u> of New Mexico	1,400.00	18.232
<u>Fee</u>	40.00	.521
	<u>7,678.80</u>	100.000%

Please advise if any additional information is needed. It will also be appreciated if you will confirm that we are on the agenda for the May 23, 1973, meeting as we must be drilling on our well by May 31, 1973.

Yours very truly,

GRIFFIN, ROSS & BURNETT, INC.

Kenneth H. Griffin

KHG:mw

DOCKET MAILED

Date 5-11-73

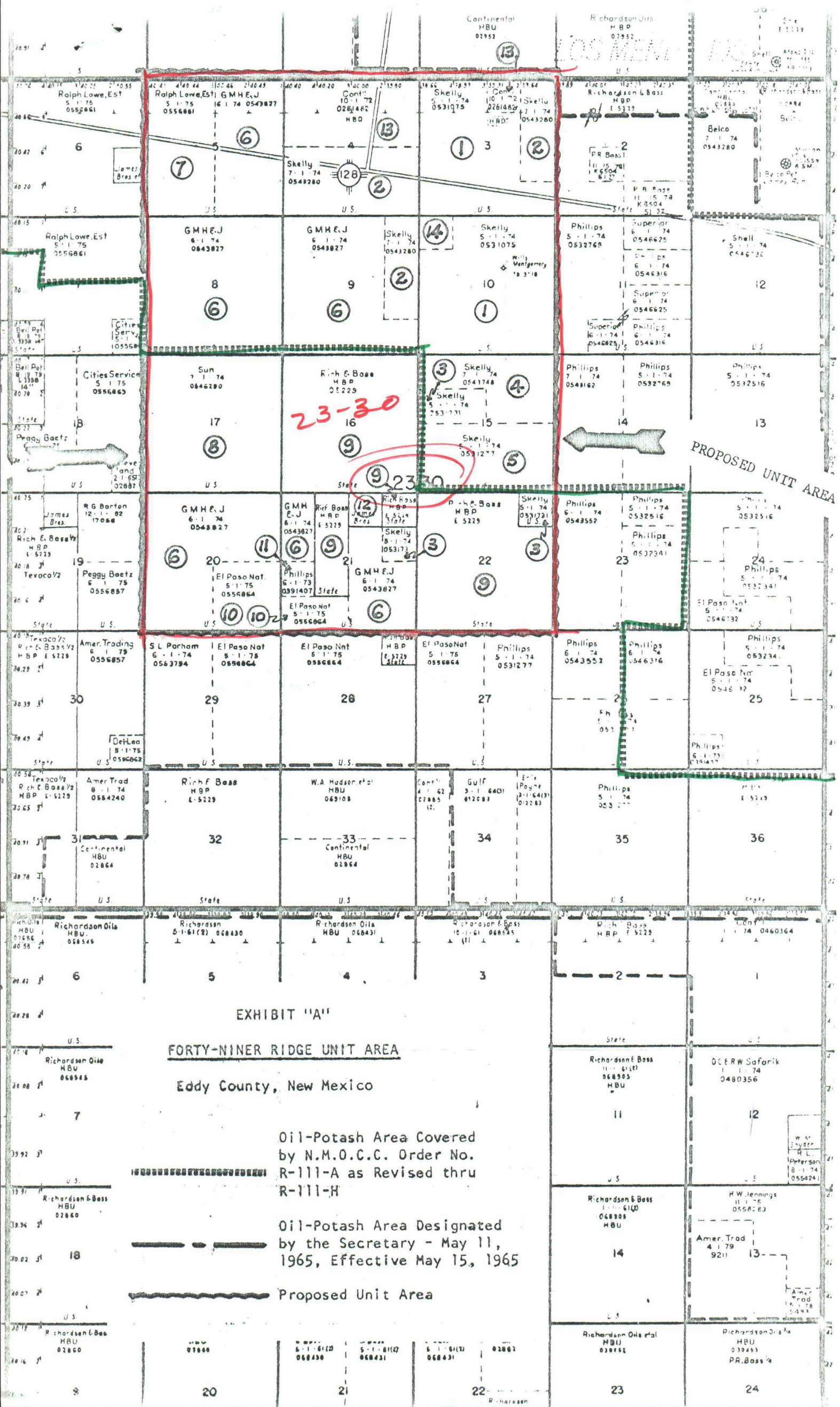

EXHIBIT "A"
FORTY-NINER RIDGE UNIT AREA

Eddy County, New Mexico

Oil-Potash Area Covered
by N.M.O.C.C. Order No.
R-111-A as Revised thru
R-111-H

Oil-Potash Area Designated
by the Secretary - May 11,
1965, Effective May 15, 1965

Proposed Unit Area

LESSEE	TRACT NO.	DESCRIPTION	OWNER	ACRES	PERCENTAGE	EXP. DATE
Skelly	1	Lots 3, 4, S/2 NW/4, SW/4, SW/4 NE/4, W/2 SE/4 and SE/4 SE/4 Sec. 3; All Sec. 10, except NW/4 NW/4 (0531075)	USA	1,077.65		5-1-74
	2	Lot 1, SE/4 NE/4 and NE/4 SE/4 Sec. 3; S/2 Sec. 4; E/2 NE/4 and NE/4 SE/4 Sec. 9 (0543280)	USA	559.64		7-1-74
	3	SE/4 NE/4 Sec. 21; NE/4 NE/4 Sec. 22; S/2 NW/4 Sec. 15 (0531731)	USA	160.00		5-1-74
	4	N/2 N/2, S/2 NE/4 Sec. 15 (0543748)	USA	240.00		7-1-74
	5	S/2 Sec. 15 (0531277)	USA	320.00		5-1-74
	6	Lots 1, 2, S/2 NE/4, SE/4 Sec. 5; All Sec. 8; W/2, W/2 E/2 and SE/4 SE/4 Sec. 9; N/2, SW/4 Sec. 20; W/2 NW/4, SW/4 NE/4, SE/4 Sec. 21 (0543827)	USA	2,240.95 (4,598.24)	59.883	6-1-74
Ralph Lowe Estate	7	Lots 3, 4, S/2 NW/4 and SW/4 Sec. 5 (0556861)	USA	320.85	4.178	5-1-75
Sun	8	All Sec. 17 (0546280)	USA	640.00	8.335	7-1-74
Bass	9	All Sec. 16; E/2 NW/4, NE/4 SW/4; NE/4 NE/4 Sec. 21; all Sec. 22, Except NE/4 NE/4 (E-5229)	State	1,400.00	18.232	HBP
El Paso Natural Gas	10	SE/4 Sec. 20; and S/2 SW/4 Sec. 21 (0556864)	USA	240.00	3.125	5-1-75
Phillips	11	NW/4 SW/4 Sec. 21 (0391407)	USA	40.00	0.521	6-1-73
Open	12	NW/4 NE/4 Sec. 21	James Bros.	40.00	0.521	OPEN
Open	13	Lot 2 Sec. 3; Lots 1, 2, 3, 4 and S/2 N/2 Sec. 4	USA	359.71	4.684	OPEN
Open	14	NW/4 NW/4 Sec. 10	USA	<u>40.00</u>	<u>0.521</u>	OPEN (Withdrawn AEC)
TOTALS:				7,678.80	100.000%	