

OIL CONSERVATION DIVISION

P.O. Box 2088
Santa Fe, New Mexico 87504-2088

DISTRICT I
P.O. Box 1980, Hobbs, NM 88240
DISTRICT II
P.O. Drawer DD, Artesia, NM 88210
DISTRICT III
1000 Rio Brazos Rd., Aztec, NM 87410

WELL LOCATION AND ACREAGE DEDICATION PLAT

All distances must be from the outer boundaries of the Section.

Operator Hanagan Petroleum Corporation		Lease Leapin Lizard		Well No. 1
Unit Letter C	Section 4	Township 14S	Range 29E NMPM	County Chaves
Actual Footage Location of Well: 421 feet from the North line and 2381 feet from the West line.				
Ground level Elev. 3684	Producing Formation Devonian	Pool Lone Wolf Devonian	Dedicated Acreage: 40 Acres	

- Outline the acreage dedicated to the subject well by colored pencil or hatchure marks on the plat below.
- If more than one lease is dedicated to the well, outline each and identify the ownership thereof (both as to working interest and royalty).
- If more than one lease of different ownership is dedicated to the well, have the interest of all owners been consolidated by communitization, unitization, force-pooling, etc.?

☐ Yes ☐ No If answer is "yes", type of consolidation _____

If answer is "no", list the owners and tract descriptions which have actually been consolidated. (Use reverse side of this form if necessary.) _____

No allowable will be assigned to the well until all interests have been consolidated (by communitization, unitization, forced-pooling, or otherwise) or until a non-standard unit, eliminating such interest, has been approved by the Division.

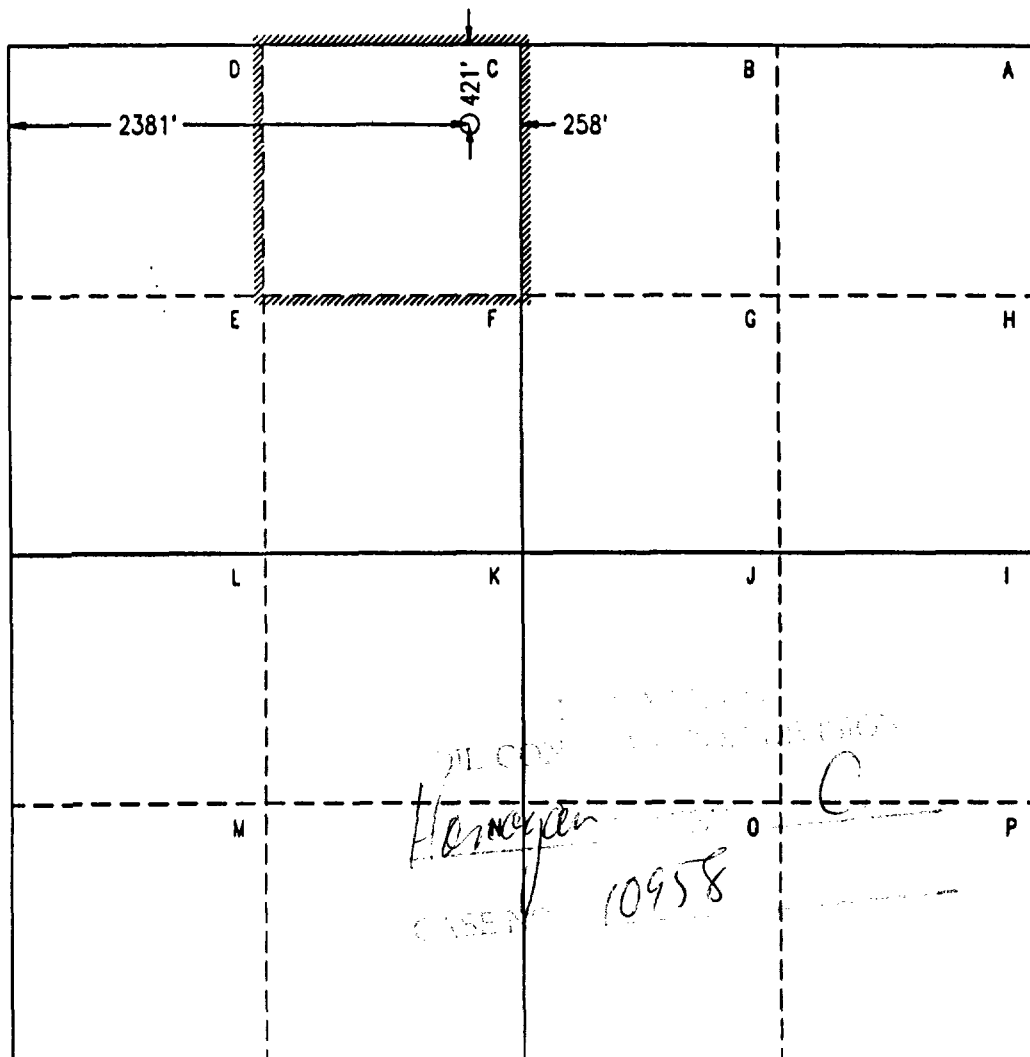

OPERATOR CERTIFICATION

I hereby certify that the information contained herein is true and complete to the best of my knowledge and belief.

Signature

Printed Name

Michael G. Hanagan

Position

Vice President

Company

Hanagan Petroleum Corporation

Date

March 11, 1994

SURVEYOR CERTIFICATION

I hereby certify that the well location shown on this plat was plotted from field notes of actual surveys made by me or under my supervision, and that the same is true and correct to the best of my knowledge and belief.

Date Surveyed

March 7, 1994

Signature
Professional

10324

Certified to

10324

15 Miles East of Hagerman, New Mexico.

File No. A-0347

UNITED STATES
DEPARTMENT OF THE INTERIOR
BUREAU OF LAND MANAGEMENT

APPLICATION FOR PERMIT TO DRILL, DEEPEN, OR PLUG BACK

1a. TYPE OF WORK

DRILL ☒

DEEPEN ☐

PLUG BACK ☐

b. TYPE OF WELL

OIL
WELL ☒

GAS
WELL ☐

OTHER

SINGLE
ZONE ☐

MULTIPLE
ZONE ☐

2. NAME OF OPERATOR

Hanagan Petroleum Corporation

3. ADDRESS OF OPERATOR

P.O. Box 1737 - Roswell, NM 88202

4. LOCATION OF WELL (Report location clearly and in accordance with any State requirements.)*

At surface 421' FNL & 2381' FWL

At proposed prod. zone
same

14. DISTANCE IN MILES AND DIRECTION FROM NEAREST TOWN OR POST OFFICE*

15 miles East of Hagerman, NM

16. DISTANCE FROM PROPOSED*
LOCATION TO NEAREST
PROPERTY OR LEASE LINE, FT.
(Also to nearest drig. unit line, if any)

258'

16. NO. OF ACRES IN LEASE

478.24

17. NO. OF ACRES ASSIGNED
TO THIS WELL

40 acres

18. DISTANCE FROM PROPOSED LOCATION*
TO NEAREST WELL, DRILLING, COMPLETED,
OR APPLIED FOR, ON THIS LEASE, FT.

None

19. PROPOSED DEPTH

9750

20. ROTARY OR CABLE TOOLS

Rotary

21. ELEVATIONS (Show whether DF, RT, GR, etc.)

3689 GR

22. APPROX. DATE WORK WILL START*

23.

PROPOSED CASING AND CEMENTING PROGRAM

SIZE OF HOLE	SIZE OF CASING	WEIGHT PER FOOT	SETTING DEPTH	QUANTITY OF CEMENT
17 1/2"	13 3/8"	48#/ft.	300'	325 sx - circ.
12 1/4"	8 5/8"	24#/ft.	2200'	1250 sx - circ.
7 7/8"	5 1/2"	15.50 & 17.0	9750	as required to isolate productive zone

For Additional Information Refer To These Attached Items:

1. Survey Plat (C 102)
2. Pertinent Information
3. Multi-point surface use plan.
4. Supplemental drilling data.

IN ABOVE SPACE DESCRIBE PROPOSED PROGRAM: If proposal is to deepen or plug back, give data on present productive zone and proposed new productive zone. If proposal is to drill or deepen directionally, give pertinent data on subsurface locations and measured and true vertical depths. Give blowout preventer program, if any.

24.

SIGNED

TITLE

VICE PRESIDENT

DATE 3/15/94

(This space for Federal or State office use)

PERMIT NO.

APPROVAL DATE

APPROVED BY

TITLE

DATE

CONDITIONS OF APPROVAL, IF ANY:

*See Instructions On Reverse Side

Title 18 U.S.C. Section 1001, makes it a crime for any person knowingly and willfully to make to any department or agency of the United States any false, fictitious or fraudulent statements or representations as to any matter within its jurisdiction.

PERTINENT INFORMATION
for
HANAGAN PETROLEUM CORPORATION
#1 Leapin Lizard Federal

421' FNL & 2381' FWL
Section 4 - T14S - R29E
Chaves County, New Mexico

LOCATED: Approximately 15 miles east
of Hagerman, New Mexico.

FEDERAL LEASE
NUMBER: NM-62196

LEASE ISSUED: September 1, 1985 (effective date)

ACRES IN LEASE: 478.24 acres
Township 14 South, Range 29 East,
Sec. 4: Lots 1-4, S/2N/2
Sec. 5: Lots 1-2, S/2NE/4

RECORD LESSEE: Marathon Oil Company (100.00%)

OPERATING RIGHTS: Hanagan Petroleum Corporation (66.67%)
Marathon Oil Company (33.33%)

BOND COVERAGE: Statewide Bond of Hanagan Petroleum
Corporation from Planet Indemnity
Company: Surety Bond #B03222

BLM BOND FILE #: Statewide Bond 3104 (943-3ssp)

SURFACE OWNERSHIP: Federal Surface (BLM-Roswell)

GRAZING PERMITTEE: Allotment #5075
Bogle Farms
P.O. Box 460
Dexter, NM 88230
734-5442

POOL RULES: Statewide Rules - 40 Acre oil spacing

EXHIBITS: A. USGS Topographic map showing roads
and wells.
B. County Road Map
C. Rig/pad Diagram
E. BOPE Diagram
D. Statement of Responsibility