

COMPANY RPM Energy Inc.		PROPERTY NAME State	WELL NO. 3
DATE	LOCATION (ULSTR) Unit D 16-16-26	FOOTAGE 330 EN+WL	
API NO.		POOL Und. SA	

① Fill 4 1/2 csg to surface with cement from 1353'

② Set P&A marker

③ Clean & level location

CASING RECORD:

7" c 1080' cmt 1605x<
4 1/2" c 1368' c
Perts c 1181-1353

After

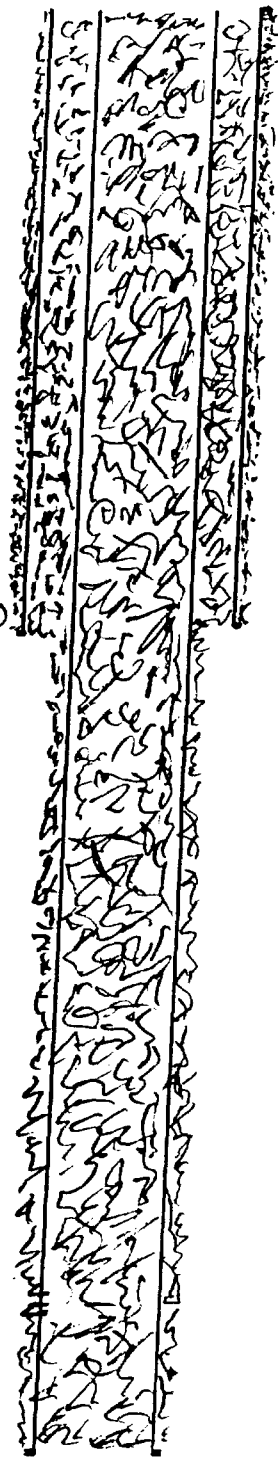

7" 1080'

Perts 1181

4 1/2 1368

BEFORE EXAMINER CATANACH	
OIL CONSERVATION DIVISION	
<u>OOD</u>	EXHIBIT NO. <u>1F</u>
CASE NO. <u>11944</u>	

COMPANY RPM Energy Inc.		PROPERTY NAME State		WELL NO. 3
DATE	LOCATION (ULSTR)	FOOTAGE		
	Unit D 16-16-26	330 EN+WL		
API NO.		POOL Und. SA		

① Fill 4 1/2 csg to surface with cement from 1353'

② Set P&A marker

③ Clean + level location

Before

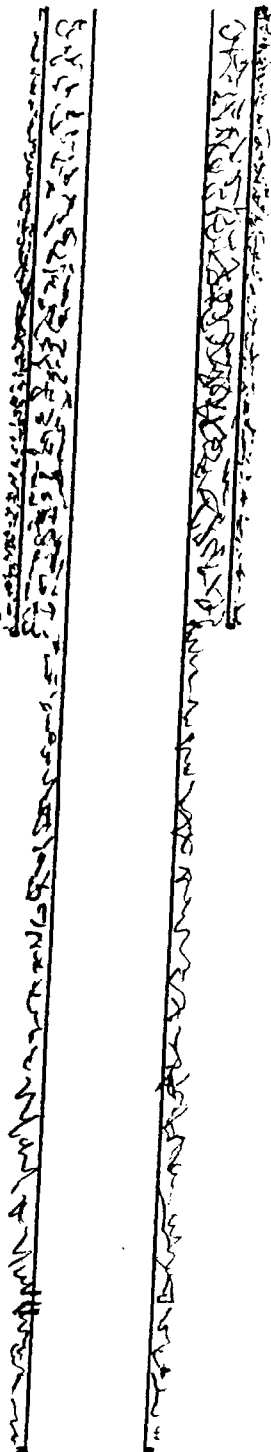

7" 1080'

CASING RECORD:

7" c 1080' cmt 1605x^c

4 1/2" c 1368' c

Perts c 1181-1353

Perts 1181

4 1/2 1368

STATE OF NEW MEXICO
ENERGY, MINERALS AND NATURAL RESOURCES DEPARTMENT

OIL CONSERVATION DIVISION
ARTESIA DISTRICT OFFICE

GARY E. JOHNSON
GOVERNOR

JENNIFER SALISBURY
CABINET SECRETARY

May 13, 1997

Rand Carroll, Legal Bureau
Oil Conservation Division
2040 S. Pacheco Street
Santa Fe NM 87505

Re: Well Plugging, RPM Energy, State #1, 2 & 3, Exxon #1, Exxon A #1
and #2

Dear Rand;

We recommend the above captioned well's be plugged to protect
fresh waters of the state of New Mexico, the environment and
correlative rights in the area.

Our records show Bond #610 0802 478 for \$50,000.00 to be in effect.
Certified mail was signed for on March 4, 1997.

Yours Truly,

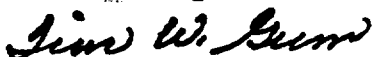

Tim W. Gum
District II Supervisor

New Mexico
ENERGY, MINERALS AND NATURAL RESOURCES DEPARTMENT

OIL CONSERVATION DIVISION
ARTESIA DISTRICT OFFICE

GARY E. JOHNSON
Governor

JENNIFER SALISBURY
Cabinet Secretary

1-9-98

RPM Energy Inc.
613 Commerical Bank Bldg.
Midland, Texas 79701- 6398

Re; Properly Abandoned Wells;

Dear Sir,

The state of New Mexico is in the process at this time of reviewing leases to determin the number of abandoned and shut in wells.

Rule 201 A. states " The operator of any well drilled for oil, gas or injection, for seismic, core or other exploration, or for a service well, whether cased or uncased, shall be responsible for the plugging thereof."

Rule 201 B. A well shall be either properly plugged and abandoned or temporarily abandoned in accordance with these rules within (90) days after {1} a 60 day period following suspension of drilling.{2} A determination that the well is no longer beneficial purposes.{3} A period of 1 year in which a well has been continuously inactive.

House Bill 65 has been passed by the legislature and provides some tax incentives for wells put back in production. However, if there are no plans to put a well or wells back in service then plugging or proper temporary abandonment will be required.

Please forward to the Oil Conservation Division office in Artesia by March 9,1998 a plan to bring the following list of wells into compliance with rule 201.

Yours truly,

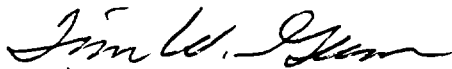
Tim Gum

RPM Energy Inc.

State	# 1	Sec. 16-16-26	Ut. I
State	# 2	Sec. 16-16-26	Ut. J
State	# 3	Sec. 16-16-26	Ut. D
Exxon A	# 1	Sec. 21-16-26	Ut. F
Exxon A	# 2	Sec. 21-16-26	Ut. J
Exxon	# 1	Sec. 21-16-26	Ut. L

**STATE OF NEW MEXICO
ENERGY, MINERALS AND NATURAL RESOURCES DEPARTMENT**

**OIL CONSERVATION DIVISION
ARTESIA DISTRICT OFFICE**

GARY E. JOHNSON
GOVERNOR

JENNIFER SALISBURY
CABINET SECRETARY

February 26, 1997

RPM Energy Inc.
P.O. Box 1207
Big Spring TX 79721

Re: Properly Abandoned Wells, State #1, 2 & 3, Exxon #1, Exxon A #1
and #2, Eddy County New Mexico.

The state of New Mexico is in the process at this time of reviewing
leases and determining the number of abandoned wells.

Rule 201 A. states the operator of any well drilled for oil, gas or
injection, for seismic, core or other exploration, or for a service
well, whether cased or uncased, shall be responsible for the plugging
thereof.

Rule 201 B. states a well shall be either properly plugged and
abandoned or temporarily abandoned in accordance with these rules
within 90 days after (1) a 60 day period following suspension of
drilling. (2) a determination that the well is no longer usable
for beneficial purposes. (3) a period of 1 year in which a well
has been continuously inactive.

House Bill 65 has been passed by the legislature and provides some
tax incentives for wells put back in production. However, if there
are no plans to put these wells back into service then they need to be
either plugged or properly temporarily abandoned.

The last reported production on the above captioned wells was 1982
to 1985. Please forward to the NMOCDD Artesia office by April 15, 1997
a plan to bring these wells into compliance with Rule 201.

Failure to respond will result in us asking our legal department in
Santa Fe to schedule a hearing so you may appear and show cause why
these wells should not be plugged.

Yours Truly

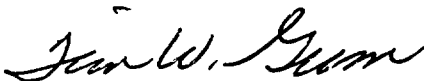

Tim W. Gum
District II Supervisor

RPM Energy, Inc.
613 Commercial Bank Tower
Midland, TX 79701

\$50,000 BLANKET PLUGGING

United States Fire Ins. Co.,
Surety

Bond No. 610 0802 478

App. 12-22-80

Cancelled: July 20, 1984

As to any property or wells acquired,
started, or drilled after that date.
However, the subject bond will remain
in effect as to any property or wells
acquired, started, or drilled prior to
July 20, 1984.



Is your **RETURN ADDRESS** completed on the reverse side?

SENDER:

- Complete items 1 and/or 2 for additional services.
- Complete items 3, 4a, and 4b.
- Print your name and address on the reverse of this form so that we can return the card to you.
- Attach this form to the front of the mailpiece, or on the back if space does not permit.
- Write "Return Receipt Requested" on the mailpiece below the article number.
- The Return Receipt will show to whom the article was delivered and the date delivered.

I also wish to receive the following services (for an extra fee):

- 1. ☐ Addressee's Address
 - 2. ☐ Restricted Delivery
- Consult postmaster for fee.

3. Article Addressed to:

RPM Energy Inc.
P.O. Box 1207
Big Spring, TX 79721

4a. Article Number

P 194 615 077

4b. Service Type

☐ Registered
☐ Express Mail

☒ Certified
☐ Insured

☒ Return Receipt for Merchandise

☐ COD

7. Date of Delivery

DEC 24 1994

5. Received By: (Print Name)

6. Signature: (Addressee or Agent)

X

PS Form 3811, December 1994

Domestic Return Receipt

Thank you for using Return Receipt Service.

RPM Energy, Inc./

Address

613 Commercial Bank Tower, Midland, TX 79701

Reason(s) for filing (Check proper box)

Other (Please explain)

New Well ☒

Recompletion ☐

Change In Ownership ☐

Change In Transporter of: Oil ☐ Dry Gas ☐ Casinghead Gas ☐ Condensate ☐

CASINGHEAD GAS IS NOT BE
PRODUCED FROM THIS WELL
THESE ARE PRODUCTION TO RULE 306
IS OBTAINED
EX # 2-398

If change of ownership give name and address of previous owner

N/A

1. DESCRIPTION OF WELL AND LEASE

Lease Name	Well No.	Pool Name, Including Formation	Kind of Lease	Lease No.
State	3	Undesignated San Andres	State, Federal or Fee State	L-4853
Location				
Unit Letter	D	330 Feet From The North Line and 330 Feet From The West		
Line of Section	16	Township 16S	Range 26E	NMPM, Eddy County

2. DESIGNATION OF TRANSPORTER OF OIL AND NATURAL GAS

Name of Authorized Transporter of Oil <input checked="" type="checkbox"/> or Condensate <input type="checkbox"/>	Address (Give address to which approved copy of this form is to be sent)					
Cities Service Trucks Attn: B. Shelton	P.O. Box 1919, Midland, Texas 79702					
Name of Authorized Transporter of Casinghead Gas <input type="checkbox"/> or Dry Gas <input type="checkbox"/>	Address (Give address to which approved copy of this form is to be sent)					
If well produces oil or liquids, give location of tanks.	Unit	Sec.	Twp.	Rge.	Is gas actually connected?	When
	D	16	16S	26E		

If this production is commingled with that from any other lease or pool, give commingling order number:

COMPLETION DATA

Designate Type of Completion - (X)	Oil Well	Gas Well	New Well	Workover	Deepen	Plug Back	Same Res'v.	Diff. Res'v.
	X		X					
Date Spudded	Date Compl. Ready to Prod.	Total Depth	P.B.T.D.					
9-17-81	11-4-81	1370	1366					
Elevations (DF, RAB, RT, GR, etc.)	Name of Producing Formation	Top Oil/Gas Pay	Tubing Depth					
3353 GR	San Andres	1181	1209'					
Perforations			Depth Casing Shoe					
1181-1353	W/38 shots		1368'					

TUBING, CASING, AND CEMENTING RECORD

HOLE SIZE	CASING & TUBING SIZE	DEPTH SET	SACKS CEMENT
9-7/8"	7"	1080	200 SXS
6-1/8"	4 1/2"	1368	160 SXS
		1269	

TEST DATA AND REQUEST FOR ALLOWABLE OIL WELL (Test must be after recovery of total volume of load oil and must be equal to or exceed top allowable for this depth or be for full 24 hours)

Date First New Oil Run To Tanks	Date of Test	Producing Method (Flow, pump, gas lift, etc.)		
11-4-81	1-28-82	Pump		
Length of Test	Tubing Pressure	Casing Pressure	Choke Size	
24 hours	8.0		1/4"	
Actual Prod. During Test	Oil-Bbls.	Water-Bbls.	Gas-MCF	
13.6 bbls	10.2	3.4	18.49	

Posted ID-2
Comp. Book
L-CIT
2-26-82

GAS WELL

Actual Prod. Test-MCF/D	Length of Test	Bbls. Condensate/MMCF	Gravity of Condensate
Testing Method (piston, back pr.)	Tubing Pressure (shut-in)	Casing Pressure (shut-in)	Choke Size

CERTIFICATE OF COMPLIANCE

I hereby certify that the rules and regulations of the Oil Conservation Division have been complied with and that the information given above is true and complete to the best of my knowledge and belief.

Ray Z Jones

(Signature)

Vice President

(Title)

February 1, 1982

(Date)

OIL CONSERVATION DIVISION

APPROVED FEB 22 1982

BY W. A. Gressett

TITLE SUPERVISOR, DISTRICT II

This form is to be filed in compliance with RULE 1104.

If this is a request for allowable for a newly drilled or deepened well, this form must be accompanied by a tabulation of the deviation tests taken on the well in accordance with RULE 111.

All sections of this form must be filled out completely for allowable on new and recompleted wells.

Fill out only Sections I, II, III, and VI for changes of owner, well name or number, or transporter, or other such change of condition.

Separate Form C-104 must be filed.

STATE OF NEW MEXICO
ENERGY AND MINERALS DEPARTMENT

OIL CONSERVATION DIVISION

P. O. BOX 2088
SANTA FE, NEW MEXICO 87501

WELL COMPLETION OR RECOMPLETION REPORT AND LOG

NO. OF COPIES RECEIVED	
DISTRIBUTION	
SANTA FE	
FILE	
U.S.O.S.	
LAND OFFICE	
OPERATOR	

5a. Indicate Type of Lease
State ☒ Fee ☐

5. State Oil & Gas Lease No.
L-4853

7. Unit Agreement Name

8. Form or Lease Number

9. Well No.
3

10. TYPE OF WELL

FEB 3 1982

b. TYPE OF COMPLETION

OIL WELL ☒ GAS WELL ☐ DRY ☐ OTHER ☐
NEW WELL ☒ WORK OVER ☐ DEEPEN ☐ PLUG BACK ☐ DIFF. RESVR. ☐ OTHER ☐
O. C. D.
ARTESIA, OFFICE

2. Name of Operator

RPM Energy, Inc.

3. Address of Operator

613 Commercial Bank Tower, Midland, TX 79701

4. Location of Well

UNIT LETTER D LOCATED 330 FEET FROM THE North LINE AND 330 FEET FROMTHE West LINE OF SEC. 16 TWP. 16S RGE. 26E N.M.P.M.

15. Date Spudded 9-17-81 16. Date T.D. Reached 9-24-81 17. Date Compl. (Ready to Prod.) 11-4-81 18. Elevations (DF, RKB, RT, GR, etc.) 3353 GR 19. Elev. Casinghead 3353

20. Total Depth 1370' 21. Plug Back T.D. 22. If Multiple Compl., How Many 23. Intervals Drilled By Rotary Tools Cable Tools X

24. Producing Interval(s), of this completion - Top, Bottom, Name

Top (1181) Bottom 1216 San Andres Top 1270, Bottom 1278
Top (1340) Bottom 1353 San Andres Top 1302, Bottom 130625. Was Directional Survey Made
yes

26. Type Electric and Other Logs Run

Dual Induction Guard, Sidewall Neutron, Neutron Correlation

27. Was Well Cased
No

28. CASING RECORD (Report all strings set in well)

CASING SIZE	WEIGHT LB./FT.	DEPTH SET	HOLE SIZE	CEMENTING RECORD	AMOUNT PULLED
7"	17#	1080	9-7/8"	200 sxs Class C	Circ. 5 sxs
4-1/2"	9.5#	1368	6-1/8"	160 sxs	

29. LINER RECORD

SIZE	TOP	BOTTOM	SACKS CEMENT	SCREEN
4-1/2"	Surface	1368	160	N/A

30. TUBING RECORD

SIZE	DEPTH SET	PACKER SET
2-3/8"	1209'	N/A

31. Perforation Record (Interval, size and number)

1181, 1184, 1186, 1200, 1204, 1206, 1212, 1214, 1270, 1272, 1276, 1278, 1302, 1304, 1341, 1343, 1345, 1347, 1353

2 SPF w/HSC (38 holes)

32. ACID, SHOT, FRACTURE, CEMENT SQUEEZE, ETC.

DEPTH INTERVAL	AMOUNT AND KIND MATERIAL USED
1181 1353	4000 gal 15% HCl Acid Frac w/
	45560 gal Aqua gel 10,000#
	100 mesh sand, 38,000# 20/40 s

3. PRODUCTION

Date First Production 11-4-81 Production Method (Flowing, gas lift, pumping - Size and type pump) Pumping Well Status (Prod. or Shut-in) producing

Date of Test	Hours Tested	Choke Size	Prod'n. For Test Period	Oil - Bbl.	Gas - MCF	Water - Bbl.	Gas - Oil Ratio
1-28-82	24	3/4"		10.2	18.49	3.4	1812.75
Flow Tubing Press.	Casing Pressure	Calculated 24-Hour Rate	Oil - Bbl.	Gas - MCF	Water - Bbl.	Oil Gravity - API (Corr.)	
8#			10.2	18.49	3.4	33.4	

4. Disposition of Gas (Sold, used for fuel, vented, etc.)

Used to run pump jack motor

Test Witnessed By
Dwight Adamson

5. List of Attachments

Dual Induction Guard Log, Sidewall Neutron Log

I hereby certify that the information shown on both sides of this form is true and complete to the best of my knowledge and belief.



TITLE

DATE

This form is to be filed with the appropriate District Office of the Division not later than 20 days after the completion of any newly-drilled or deepened well. It shall be accompanied by one copy of all electrical and radio-activity logs run on the well and a summary of all special tests conducted, including drill stem tests. All depths reported shall be measured depths. In the case of directionally drilled wells, true vertical depth shall also be reported. For multiple completions, Items 30 through 34 shall be reported for each zone. The form is to be filed in quintuplicate except on state land, where six copies are required. See Rule 1105.

INDICATE FORMATION TOPS IN CONFORMANCE WITH GEOGRAPHICAL SECTION OF STATE

Southeastern New Mexico

Northwestern New Mexico

T. Anhy	T. Canyon	T. Ojo Alamo	T. Penn. "B"
T. Salt	T. Strawn	T. Kirtland-Fruitland	T. Penn. "C"
B. Salt	T. Atoka	T. Pictured Cliffs	T. Penn. "D"
T. Yates	T. Miss	T. Cliff House	T. Leadville
T. 7 Rivers	T. Devonian	T. Menefee	T. Madison
T. Queen	T. Silurian	T. Point Lookout	T. Elbert
T. Grayburg	T. Montoya	T. Mancos	T. McCracken
T. San Andres 850	T. Simpson	T. Gallup	T. Ignacio Qtzite
T. Glorieta	T. McKee	Base Greenhorn	T. Granite
T. Paddock	T. Ellenburger	T. Dakota	T.
T. Elinebry	T. Gr. Wash	T. Morrison	T.
T. Tubb	T. Granite	T. Todillo	T.
T. Drinkard	T. Delaware Sand	T. Entrada	T.
T. Abo	T. Bone Springs	T. Wingate	T.
T. Wolfcamp	T.	T. Chinle	T.
T. Penn.	T.	T. Permian	T.
T. Cisco (Bough C)	T.	T. Penn. "A"	T.

OIL OR GAS SANDS OR ZONES

No. 1, from 1180 to 1355	No. 4, from to
No. 2, from to	No. 5, from to
No. 3, from to	No. 6, from to

IMPORTANT WATER SANDS

Include data on rate of water inflow and elevation to which water rose in hole.

No. 1, from to feet
No. 2, from to feet
No. 3, from to feet
No. 4, from to feet

FORMATION RECORD (Attach additional sheets if necessary)

From	To	Thickness in Feet	Formation	From	To	Thickness in Feet	Formation
0	800		Drilled pea size gravel sand fine-grain, medium				
800	1100		Limestone				
1100	1370		Dolomite				

S & B DRILLING COMPANY

4500 W. Illinois, Suite 104
Midland, Texas 79703
(915) 699-4944

February 5, 1982

RPM ENERGY, Inc. - ~~Citee~~ - State # 3 ✓
330' FNL & 330' FWL
Sec. 16, T-16-S, R-26-E
Eddy County, New Mexico

DEVIATION SURVEY

<u>Depth</u> <u>ft</u>	<u>Deviation</u> <u>Degree</u>	<u>Sine of</u> <u>Angle x 10³</u>	<u>Vertical</u> <u>Displacement, ft</u>	<u>Horizontal</u> <u>Displacement, ft.</u>	<u>Cumul. Horizontal</u> <u>Displacement, ft</u>
627	3/4	13.0895	627	8.21	8.21
1081	1	17.4524	454	7.92	16.13
1372	1	17.4524	291	5.08	21.21

I hereby certify that the data submitted in this report is true and accurate to the best of my knowledge.

RECEIVED

FEB 19 1982

O. C. D.
ARTESIAN OFFICE

Les Skinner, P.E.

Les Skinner, P. E.



GAS-OIL RATIO TESTS

Revised 10-1-78

RPM Energy, Inc.		Pool		County	
Undesignated San Andres		Eddy			
613 Commercial Bank Tower, Midland, TX - 79701		TYPE OF TEST - (X)		SCHEDULED	
LEASE NAME		LOCATION		DATE OF TEST	
WELL NO.		U		T	
3		D		16	
State		16S		26E	
		P		1-28-82	
		8 psi			
		24			
		3.4		33.4	
		10.2		18.49	
		1812.75			
		WATER BBL'S		OIL BBL'S	
		GAS - OIL RATIO		CU.FT/GBL	
		PACD. DURING TEST		Special	
		WATER BBL'S		OIL BBL'S	
		GAS - OIL RATIO		CU.FT/GBL	

RECEIVED
FEB 3 1982
O. C. D.
ARTESIA, OFFICE

No well will be assigned an allowable greater than the amount of oil produced on the offset test.
During gas-oil ratio test, each well shall be produced at a rate not exceeding the top unit allowable for the pool in which well is located by more than 25 percent. Operator is encouraged to take advantage of this 25 percent tolerance in order that well can be assigned increased allowables when authorized by the Division.
Gas volumes must be reported in MCF measured at a pressure base of 15.025 psia and a temperature of 60° F. Specific gravity base will be 0.60.
Report casing pressure in lieu of tubing pressure for any well producing through casing.
Mail original and one copy of this report to the district office of the New Mexico Oil Conservation Division in accordance with Rule 301 and appropriate pool rules.

I hereby certify that the above information is true and complete to the best of my knowledge and belief.

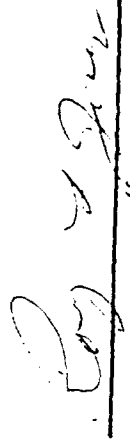
Vice President
(Signature)
(Title)



BRUCE KING
GOVERNOR
LARRY KEHOE
SECRETARY

STATE OF NEW MEXICO
ENERGY AND MINERALS DEPARTMENT
OIL CONSERVATION DIVISION
ARTESIA DISTRICT OFFICE

February 10, 1982

P.O. DRAWER DD
ARTESIA, NEW MEXICO 88210
(505) 748-1283

RPM Energy Inc.
613 Commercial Bank Tower
Midland, Texas 79701

Re: State
#3-D-16-16-26
Eddy County, New Mexico

Gentlemen:

We hereby acknowledge receipt of the completion reports
on the subject well.

However, to date we have not received the Deviation Tests
sworn to and notarized in accordance with Division Rule III.

Upon receipt of said Deviation Tests, an allowable will be
assigned.

If you have any questions concerning this matter, please
feel free to call upon me.

Sincerely,

W.A. Gressett
Supervisor, District II

WAG:mm

OIL CONSERVATION DIVISION

P. O. BOX 2088
SANTA FE, NEW MEXICO 87501

JAN 27 1982

O. C. D.
ARTESIA, OFFICE

Form C-103
Revised 10-1-

NO. OF COPIES RECEIVED	5
DISTRIBUTION	
SANTA FE	/
FILE	/
U.S.G.S.	
LAND OFFICE	
OPERATOR	/

SUNDRY NOTICES AND REPORTS ON WELLS

(DO NOT USE THIS FORM FOR PROPOSALS TO DRILL OR TO DEEPEN OR PLUG BACK TO A DIFFERENT RESERVOIR. USE "APPLICATION FOR PERMIT -" (FORM C-101) FOR SUCH PROPOSALS.)

OIL WELL ☒ GAS WELL ☐ OTHER ☐

5a. Indicate Type of Lease
State ☒ Fee ☐
5. State Oil & Gas Lease No.
L-4853

7. Unit Agreement Name

8. Farm or Lease Name

STATE

9. Well No.

3

10. Field and Pool, or Wildcat
Undesignated San Andres

UNIT LETTER D 330 FEET FROM THE North LINE AND 330 FEET FROM
West LINE, SECTION 16 TOWNSHIP 16S RANGE 26E NMPM.

15. Elevation (Show whether DF, RT, CR, etc.)

3353 GL

12. County
Eddy

Check Appropriate Box To Indicate Nature of Notice, Report or Other Data
NOTICE OF INTENTION TO: SUBSEQUENT REPORT OF:

PERFORM REMEDIAL WORK <input type="checkbox"/>	PLUG AND ABANDON <input type="checkbox"/>	REMEDIAL WORK <input type="checkbox"/>	ALTERING CASING <input type="checkbox"/>
TEMPORARILY ABANDON <input type="checkbox"/>	CHANGE PLANS <input type="checkbox"/>	COMMENCE DRILLING OPNS. <input type="checkbox"/>	PLUG AND ABANDONMENT <input type="checkbox"/>
PULL OR ALTER CASING <input type="checkbox"/>	OTHER <input type="checkbox"/>	CASING TEST AND CEMENT JOB <input type="checkbox"/>	
		OTHER Well Report <input type="checkbox"/>	

Describe Proposed or Completed Operations (Clearly state all pertinent details, and give pertinent dates, including estimated date of starting any proposed work) SEE RULE 1103.

1/19/82	5 BO	5.5 bbls wtr
1/20/82	3.7 BO	4.5 bbls wtr
1/21/82	4.5 BO	5 bbls wtr
1/22/82	3.7 BO	4.5 bbls wtr
1/23/82	4 BO	5 bbls wtr
1/24/82	3 BO	4.7 bbls wtr
1/25/82	5 BO	5.8 bbls wtr

I hereby certify that the information above is true and complete to the best of my knowledge and belief.

By Becki Dean TITLE Production Secretary DATE 1/25/82

Mike Williams TITLE OIL AND GAS INSPECTOR DATE FEB 2 1982

NO. OF COPIES RECEIVED	3
DISTRIBUTION	
SANTA FE	2
FILE	1
U.S.G.S.	
LAND OFFICE	
OPERATOR	1

OIL CONSERVATION DIVISION

P. O. BOX 2088
SANTA FE, NEW MEXICO 87501

JAN 27 1982

O. C. D.
ARTESIA, OFFICE

Form C-103
Revised 10-1-

5a. Indicate Type of Lease
State <input checked="" type="checkbox"/> For <input type="checkbox"/>
5. State Oil & Gas Lease No.
L-4853

SUNDRY NOTICES AND REPORTS ON WELLS

(DO NOT USE THIS FORM FOR PROPOSALS TO DRILL OR TO DEEPEN OR PLUG BACK TO A DIFFERENT RESERVOIR.
USE "APPLICATION FOR PERMIT -" (FORM C-101) FOR SUCH PROPOSALS.)

OIL WELL ☒ GAS WELL ☐ OTHER ☐

7. Unit Agreement Name

8. Farm or Lease Name

STATE

9. Well No.

3

10. Field and Pool, or Wildcat
Undesignated San Andres

UNIT LETTER D 330 FEET FROM THE North LINE AND 330 FEET FROM
THE West LINE, SECTION 16 TOWNSHIP 16S RANGE 26E NMPM.

15. Elevation (Show whether DF, RT, CR, etc.)

3353 GL

12. County
Eddy

Check Appropriate Box To Indicate Nature of Notice, Report or Other Data

NOTICE OF INTENTION TO:

SUBSEQUENT REPORT OF:

PERFORM REMEDIAL WORK <input type="checkbox"/>	PLUG AND ABANDON <input type="checkbox"/>	REMEDIAL WORK <input type="checkbox"/>	ALTERING CASING <input type="checkbox"/>
TEMPORARILY ABANDON <input type="checkbox"/>	CHANGE PLANS <input type="checkbox"/>	COMMENCE DRILLING OPS. <input type="checkbox"/>	PLUG AND ABANDONMENT <input type="checkbox"/>
NULL OR ALTER CASING <input type="checkbox"/>	OTHER <input type="checkbox"/>	CASING TEST AND CEMENT JOB <input type="checkbox"/>	OTHER Well Report <input type="checkbox"/>

Describe Proposed or Completed Operations (Clearly state all pertinent details, and give pertinent dates, including estimated date of starting any proposed work) SEE RULE 1103.

12/12/81	0 BO	2.3 bbls wtr	12/31/81	4.16 BO	5 bbls wtr
12/13/81	2.16 BO	3 bbls wtr	1/1/82	4.5 BO	4.7 bbls wtr
12/14/81	2 BO	2.14 bbls wtr	1/2/82	4 BO	5 bbls wtr
12/15/81	3.2 BO	3.19 bbls wtr	1/3/82	4.7 BO	5.19 bbls wtr
12/16/81	5 BO	10 bbls wtr	1/4/82	5 BO	5.7 bbls wtr
12/17/81	1.5 BO	3 bbls wtr	1/5/82	5 BO	6 bbls wtr
12/18/81	4.5 BO	5 bbls wtr	1/6/82	4.5 BO	5 bbls wtr
12/19/81	3.8 BO	4.15 bbls wtr	1/7/82	4.7 BO	4.5 bbls wtr
12/20/81	2.5 BO	4.3 bbls wtr	1/8/82	5 BO	5.5 bbls wtr
12/21/81	4 BO	5 bbls wtr	1/9/82	6 BO	8.5 bbls wtr
12/22/81	4.5 BO	5 bbls wtr	1/10/82	5.5 BO	7 bbls wtr
12/23/81	5 BO	5 bbls wtr	1/11/82	4 BO	5 bbls wtr
12/24/81	4.16 BO	5.5 bbls wtr	1/12/82	4.7 BO	5.5 bbls wtr
12/25/81	4.5 BO	5.16 bbls wtr	1/13/82	5 BO	6 bbls wtr
12/26/81	5.5 BO	8.3 bbls wtr	1/14/82	5.3 BO	5 bbls wtr
12/27/81	4.3 BO	5.5 bbls wtr	1/15/82	4.5 BO	5.3 bbls wtr
12/28/81	4.5 BO	5 bbls wtr	1/16/82	5 BO	6.5 bbls wtr
12/29/81	5 BO	6.5 bbls wtr	1/17/82	4.5 BO	5 bbls wtr
12/30/81	5 BO	4.7 bbls wtr	1/18/82	4 BO	4.7 bbls wtr

I hereby certify that the information above is true and complete to the best of my knowledge and belief.

Becki Dean TITLE Production Secretary DATE 1/25/82

Mike Williams TITLE OIL AND GAS INSPECTOR DATE FEB 2 1982

STATE OF NEW MEXICO
ENERGY AND MINERALS DEPARTMENT

OIL CONSERVATION DIVISION

P. O. BOX 2088
SANTA FE, NEW MEXICO 87501

Form C-103
Revised 10-1-

NO. OF COPIES RECEIVED	3
DISTRIBUTION	
SANTA FE	/
FILE	/
U.S.G.S.	
LAND OFFICE	
OPERATOR	/

5a. Indicate Type of Lease
State ☒ Fee ☐
5. State Oil & Gas Lease No.
L-4853

SUNDRY NOTICES AND REPORTS ON WELLS
(DO NOT USE THIS FORM FOR PROPOSALS TO DRILL OR TO DEEPEN OR PLUG BACK TO A DIFFERENT RESERVOIR.
USE "APPLICATION FOR PERMIT -" (FORM C-101) FOR SUCH PROPOSALS.)

OIL WELL ☒ GAS WELL ☐ OTHER-

7. Unit Agreement Name

Name of Operator
RPM Energy, Inc. / DEC 14 1981

8. Farm or Lease Name
STATE

Address of Operator
613 Commercial Bank Tower, Midland, TX 79701-6398 O. C. D.

9. Well No.
3

Location of Well
UNIT LETTER D 330 FEET FROM THE North LINE AND 330 FEET FROM
THE West LINE, SECTION 16 TOWNSHIP 16S RANGE 26E NMPM.

10. Field and Pool, or Wildcat
Undesignated San Andres

15. Elevation (Show whether DF, RT, GR, etc.)
3353 GL

12. County
Eddy

Check Appropriate Box To Indicate Nature of Notice, Report or Other Data
NOTICE OF INTENTION TO: SUBSEQUENT REPORT OF:

PERFORM REMEDIAL WORK <input type="checkbox"/>	PLUG AND ABANDON <input type="checkbox"/>	REMEDIAL WORK <input type="checkbox"/>	ALTERING CASING <input type="checkbox"/>
TEMPORARILY ABANDON <input type="checkbox"/>	CHANGE PLANS <input type="checkbox"/>	COMMENCE DRILLING OPNS. <input type="checkbox"/>	PLUG AND ABANDONMENT <input type="checkbox"/>
PULL OR ALTER CASING <input type="checkbox"/>	OTHER <input type="checkbox"/>	CASING TEST AND CEMENT JOB <input type="checkbox"/>	
		OTHER Well Report <input type="checkbox"/>	

Describe Proposed or Completed Operations (Clearly state all pertinent details, and give pertinent dates, including estimated date of starting any proposed work) SEE RULE 1103.

12/3/81	2 bbls wtr	5 BO
12/4/81	5.2 bbls wtr	2 BO
12/5/81	5.23 bbls wtr	2 BO
12/6/81	4.03 bbls wtr	1 BO
12/7/81	5.07 bbls wtr	2 BO
12/8/81	2 bbls wtr	3 BO
12/9/81	2.5 bbls wtr	2.5 BO
12/10/81	3 bbls wtr	2.13 BO
12/11/81	3 bbls wtr	2.13 BO

I hereby certify that the information above is true and complete to the best of my knowledge and belief.

Prepared by Buckie C. Dean TITLE Production Secretary DATE 12/11/81

Approved by Mike Williams TITLE OIL AND GAS INSPECTOR DATE DEC 15 1981

STATE OF NEW MEXICO
ENERGY AND MINERALS DEPARTMENT

NO. OF COPIES RECEIVED	3
DISTRIBUTION	
SANTA FE	/
FILE	/
U.S.G.S.	
LAND OFFICE	
OPERATOR	/

OIL CONSERVATION DIVISION

P. O. BOX 2088

SANTA FE, NEW MEXICO 87501

Form C-103
Revised 10

5a. Indicate Type of Lease
State <input checked="" type="checkbox"/> For <input type="checkbox"/>
5. State Oil & Gas Lease No.
L-4853

SUNDRY NOTICES AND REPORTS ON WELLS
(DO NOT USE THIS FORM FOR PROPOSALS TO DRILL OR TO DEEPEN OR PLUG BACK TO A DIFFERENT RESERVOIR.
USE "APPLICATION FOR PERMIT -" (FORM C-101) FOR SUCH PROPOSALS.)

OIL WELL ☒ GAS WELL ☐ OTHER ☐

RECEIVED

DEC 4 1981

C. C. D.
ARTESIA, OFFICE

1. Name of Operator
RPM Energy, Inc.

2. Address of Operator

613 Commercial Bank Tower, Midland, Texas 79701-6398

3. Location of Well

UNIT LETTER D 330 FEET FROM THE North LINE AND 330 FEET FROM
THE West LINE, SECTION 16 TOWNSHIP 16S RANGE 26E NMPM.

7. Unit Agreement Name

8. Farm or Lease Name

STATE

9. Well No.

3

10. Field and Pool, or WHDCat
Undesignated San Andr

15. Elevation (Show whether DF, RT, GR, etc.)

3353 GL

12. County

Eddy

16. Check Appropriate Box To Indicate Nature of Notice, Report or Other Data
NOTICE OF INTENTION TO: SUBSEQUENT REPORT OF:

PERFORM REMEDIAL WORK ☐
TEMPORARILY ABANDON ☐
PULL OR ALTER CASING ☐

PLUG AND ABANDON ☐
CHANGE PLANS ☐

REMEDIAL WORK ☒
COMMENCE DRILLING OPNS. ☐
CASING TEST AND CEMENT JOB ☐

ALTERING CASING
PLUG AND ABANDONMENT

OTHER

17. Describe Proposed or Completed Operations (Clearly state all pertinent details, and give pertinent dates, including estimated date of starting any proposed work) SEE RULE 1103.

10/1/81 Flowing back. 400 bbls frac fl--no oil shows.
10/2/81 Flowing back
10/3/81 thru 10/8/81 No Report-No production
10/9/81 thru 10/14/81 WOW
10/15/81 thru 11/2/81 WOPU
11/3/81 MIRU Plg Un. Run in hole w/tbg opn ended. Hit sd fill @ 728'. Wash sd to 1375'. Start out of hole w/tbg. SDON.
11/4/81 SI. Fin plg out of hole w/tbg; ran in hole w/PP string as follows: 1 jt 2-3/8" tbg; BP; 4' perf nip; SN; 37 jts 2-3/8" tbg. End of tbg @ 1209'. SN @ 1177'. Ran in hole w/pipe and rods as follows: 2"x1 1/2"x8' w/4' gas anchor; 2"x5/8" sub; 46 each 5/8" rods; 4 each 2'x5/8" subs; 1 each 6'x5/8" sub; PR w/lin; Set pmp; clamp well off. RDM
11/5/81 thru 11/20/81 Since well has started pumping it has produced 337 bbls wtr and 143 bbls o
11/20/81 thru 11/24/81 Engine has been broken down.
11/26/81 thru 12/1/81 Well has produced daily, 29 bbls fluid--60-80% oil
12/2/81 20 bbls wtr; 15 bbls oil

18. I hereby certify that the information above is true and complete to the best of my knowledge and belief.

SIGNED Becki C. Dean

TITLE Production Secretary

DATE 12/3/81

M. H. Williams

TITLE OIL AND GAS INSPECTOR

DATE DEC 9 1981

OIL CONSERVATION DIVISION

P. O. BOX 2088

SANTA FE, NEW MEXICO 87501

Form C-103
Revised 10-1

NO. OF COPIES RECEIVED	
DISTRIBUTION	
SANTA FE	1
FILE	1
U.S.G.S.	
LAND OFFICE	
OPERATOR	

5a. Indicate Type of Lease
State <input checked="" type="checkbox"/> For <input type="checkbox"/>
5. State Oil & Gas Lease No.
L-4853

SUNDRY NOTICES AND REPORTS ON WELLS
(DO NOT USE THIS FORM FOR PROPOSALS TO DRILL OR TO DEEPEN OR PLUG BACK TO A DIFFERENT RESERVOIR. USE "APPLICATION FOR PERMIT -" (FORM C-101) FOR SUCH PROPOSALS.)

1. OIL WELL <input checked="" type="checkbox"/> GAS WELL <input type="checkbox"/> OTHER- 2. Name of Operator RPM Energy, Inc. / 3. Address of Operator 613 Commercial Bank Tower, Midland, TX 79701-6398 4. Location of Well UNIT LETTER D 330 FEET FROM THE North LINE AND 330 FEET FROM THE West LINE, SECTION 16 TOWNSHIP 16S RANGE 26E NMPM. 15. Elevation (Show whether DF, RT, GR, etc.) 3353 GR	7. Unit Agreement Name OCT 18 1981 8. Farm or Lease Name C. C. D. STATE 9. Well No. ARTESIA, OFFICE 3 10. Field and Pool, or Wildcat Undesig. San Andres 12. County Eddy
---	---

Check Appropriate Box To Indicate Nature of Notice, Report or Other Data

NOTICE OF INTENTION TO:

PERFORM REMEDIAL WORK ☐
TEMPORARILY ABANDON ☐
PULL OR ALTER CASING ☐
OTHER ☐

PLUG AND ABANDON ☐
CHANGE PLANS ☐
OTHER ☐

SUBSEQUENT REPORT OF:

REMEDIAL WORK ☐
COMMENCE DRILLING OPNS. ☐
CASING TEST AND CEMENT JOBS ☐
OTHER ☐ Drilling Report

17. Describe Proposed or Completed Operations (Clearly state all pertinent details, and give pertinent dates, including estimated date of starting any proposed work) SEE RULE 1103.

9/17/81 MIRU & Spudded @ 10:00 a.m. LC @ 187' mixed mud & LCM to bring mud to 38 vis & keep circ. Circ returned. Drlg @ 270', gvl, clay, boulders. Mud wt 9.05, Vis 40' 180 sx Gel, 10 sx Soda Ash, 5 sx Quik Seal, 1 sk paper, 1 sk hulls. Bit #1 9-7/8" 11JC Serial #934207. Gardner-Denver #1 7 1/2" Liner 10 stroke.

9/18/81 Drlg @ 930' in li. Mud wt 9.6 Vis 41.

9/19/81 Drld to 1091' in dolo. Circ & cond hole. Mud wt 9.7 Vis 41.

9/20/81 Set 25 jts 7" 17# csg to 1080'. Cmt w/160 sx Class "C" cmt. Did not circ. Ran 1" tubing down 500'. Cmt w/160 sx Class "C" cmt through 1". Circ to sfc. WOC 19 hrs.

9/21/81 Drld cmt plug. Cond mud w/4 sx C/S 2 sx Soda Ash. Bit #2 in @ 1082'. 6-1/8" Smith F3 Serial # B53793.

9/22/81 Drld to 1210' dolo. Mud wt 9.3 Vis 34. 2 sx Gel.

9/23/81 Drld to 1370' dolo. Circ. mud wt 9.4 Vis 43. Added 17 sx Gel.

9/24/81 TD 1370'. Logged w/CDL-N/DIGL. Ran 34 jts 4 1/2" 9.5# csg to 1368'. Cmt w/160 sx 50/50 poz A, 6 lbs salt, 2% Gel, 0.3% CFR-2. Circ to sfc. WOC. Rig released at 4:30 p.m.

9/28/81 Perf w/HSC from 1181' to 1353' w/38 shots. Acidize w/4000 gal 15% HCL. Frac w/45560 gal A Aqua gel, 10,000 lbs 100 mesh, and 38000 lbs 20/40 sd. 21 BPM @ 2558 PSI AVG. ISDP 710. 650 @ 5 min.

18. I hereby certify that the information above is true and complete to the best of my knowledge and belief.

SIGNED Bucki Dean TITLE Production Secretary DATE 10/12/81

APPROVED BY M. L. Williams TITLE OIL AND GAS INSPECTOR DATE OCT 20 1981

CONDITIONS OF APPROVAL, IF ANY:

NEW MEXICO OIL CONSERVATION COMMISSION
DRAWER 10
ARTESIA, NEW MEXICO

FIELD REPORT FOR CEMENTING OF WELLS

Operator RPM Energy Inc		Lease State		Well # 3	
Location of Well	Unit 330N 330W D	Section 16	Township 16	Range 26	County Eddy
Drilling Contractor	St B Drlg		Type of Equipment Rotary 9/16/81		
* Witness					
<u>APPROVED CASING PROGRAM</u>					
Size of Hole	Size of Casing	Weight Per Foot	New or Used	Depth	Sacks Cement
* 9 1/2	7"	17#		1100	360 Sx Circ
6 1/4	4 1/2	9.5#		1600	200 Sx Circ
Casing Data:					
Surface _____ joints of _____ inch _____ # Grade _____					
(Approved) (Rejected) _____					
Inspected by _____ date _____					
Cementing Program					
Size of hole 9 7/8" Size of Casing 7" Sacks cement required 240					
Type of Shoe used guide Float collar used inst Btm 3 jts welded yes					
TD of hole 1092 Set 1100 Feet of 7 Inch 17 # Grade _____					
New-used csg. @ 1092 with 160 sacks neat cement around shoe w/2% CaCl. + _____ sax _____ additives _____					
Plug down @ 8:30 (AM) (PM) Date 9/21/81					
Cement circulated NO No. of Sacks _____					
Cemented by HALLIBURTON Witnessed by LARRY BROOKS					
Temp. Survey ran @ 2:30 (AM) (PM) Date 9/21/81 top cement @ 500'					
Casing test @ _____ (AM) (PM) Date _____					
Method Used _____ Witnessed by _____					
Checked for shut off @ _____ (AM) (PM) Date _____					
Method used _____ Witnessed by _____					
Remarks: TAGGED w/1" @ 496'. Pumped 130 sxs. Cl. C neat.					
& circulated 30 sxs. to the pit.					

STATE OF NEW MEXICO
ENERGY AND MINERALS DEPARTMENT

CONSERVATION DIVISION

P. O. BOX 2088

SANTA FE, NEW MEXICO 87501

30-065-2272
Form C-101
Revised 10-1-78

NO. OF COPIES RECEIVED	
DISTRIBUTION	
SANTA FE	
FILE	
U.S.G.S.	
LAND OFFICE	
OPERATOR	

SEP 16 1981

5A. Indicate Type of Lease	
STATE <input checked="" type="checkbox"/>	FEED <input type="checkbox"/>
5. State Oil & Gas Lease No.	
L-4853	

APPLICATION FOR PERMIT TO DRILL, DEEPEN, OR PLUG BACK

1a. Type of Work		ARTESIA OFFICE	
b. Type of Well		PLUG BACK <input type="checkbox"/>	
DRILL <input checked="" type="checkbox"/>		DEEPEN <input type="checkbox"/>	
OIL WELL <input checked="" type="checkbox"/>		SINGLE ZONE <input type="checkbox"/>	
GAS WELL <input type="checkbox"/>		MULTIPLE ZONE <input type="checkbox"/>	
OTHER			
2. Name of Operator			
RPM ENERGY, INC.			
3. Address of Operator			
613 Commercial Bank Tower, Midland TX, 79701			
4. Location of Well			
UNIT LETTER <u>ID</u> LOCATED <u>330</u> FEET FROM THE <u>North</u> LINE			
<u>West.</u>			
AND <u>330</u> FEET FROM THE <u>East</u> LINE OF SEC. <u>16</u> TWP. <u>16S</u> RCE. <u>26E</u> N.M.P.M.			
12. County			
EDDY			
19. Proposed Depth		19A. Formation	
1600'		San Andres	
20. Rotary or C.T.		Rotary	
21. Elevations (Show whether DF, RT, etc.)		21B. Drilling Contractor	
3353 GL		S&B Drilling	
21A. Kind & Status Plug. Bond		22. Approx. Date Work will start	
Blanket Bond		Sept. 17, 1981	

23. PROPOSED CASING AND CEMENT PROGRAM					
SIZE OF HOLE	SIZE OF CASING	WEIGHT PER FOOT	SETTING DEPTH	SACKS OF CEMENT	EST. TOP
9 1/2"	7"	17#	1030' / 1100'	360	
6 1/4"	4 1/2"	9.5#	1600	200	

Field Development (San Andres)

APPROVAL VALID FOR 180 DAYS
PERMIT EXPIRES 3-16-82
UNLESS DRILLING UNDERWAY

ABOVE SPACE DESCRIBE PROPOSED PROGRAM; IF PROPOSAL IS TO DEEPEN OR PLUG BACK, GIVE DATA ON PRESENT PRODUCTIVE ZONE AND PROPOSED NEW PRODU-
VE ZONE. GIVE BLOW-OUT / REVENTER PROGRAM, IF ANY.

I hereby certify that the information above is true and complete to the best of my knowledge and belief.

Signed Roy L. Jones Title Roy L. Jones, Vice President Date 09/15/81

(This space for State Use)

APPROVED BY W.A. Arnesen TITLE SUPERVISOR, DISTRICT II DATE 9-16-81

CONDITIONS OF APPROVAL, IF ANY:

Notify N.M.D.C. in sufficient
time to

Cement must be circulated to

7"

All distances must be from the outer boundaries of the Section.

RPM Energy <i>Inc</i>			Lease		State		Well No. #3	
Letter D	Section 16	Township 16 South	Range 26 East	County Eddy County				
Actual Postage Location of Well:								
330		feet from the North line and		330		feet from the West line		
Ground Level Elev. 3353		Producing Formation San Andres		Pool Undesignated - SA		Dedicated Acreage: 40		Acreage

1. Outline the acreage dedicated to the subject well by colored pencil or hatchure marks on the plat below.
2. If more than one lease is dedicated to the well, outline each and identify the ownership thereof (both as to working interest and royalty).
3. If more than one lease of different ownership is dedicated to the well, have the interests of all owners been consolidated by communitization, unitization, force-pooling, etc?

☐ Yes ☐ No If answer is "yes," type of consolidation _____

If answer is "no," list the owners and tract descriptions which have actually been consolidated. (Use reverse side of this form if necessary.) _____

No allowable will be assigned to the well until all interests have been consolidated (by communitization, unitization, forced-pooling, or otherwise) or until a non-standard unit, eliminating such interests, has been approved by the Division.

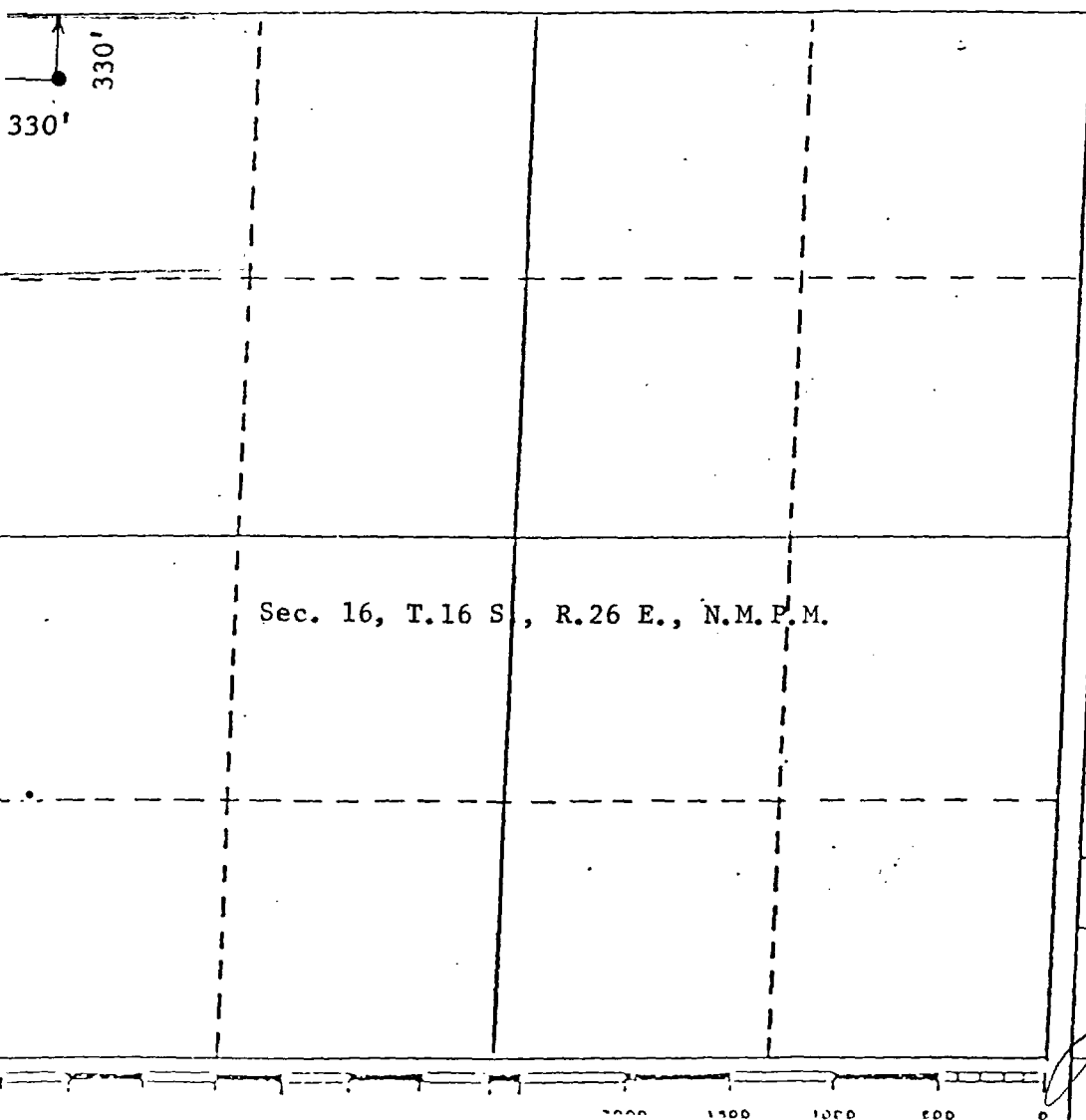

CERTIFICATION

I hereby certify that the information contained herein is true and complete to the best of my knowledge and belief.

Name

Position

Vice Pres,

Company

RPM ENERGY INC.

Date

September 16, 1981

I hereby certify that the well location shown on this plat was plotted from field notes of actual surveys made by me or under my supervision, and that the same is true and correct to the best of my knowledge and belief.

Date Surveyed

September 15, 1981

Registered Professional Engineer
and/or Licensed Surveyor

John D. Jaquess, P.E. & L.S.

Certificate No.

6290

