



United States Department of the Interior

BUREAU OF LAND MANAGEMENT
Wyoming State Office Reservoir Management Group
2987 Prospector Drive
Casper, Wyoming 82604-2968



In Reply Refer To:
3186
(3186.1)
Big Eddy Unit
NMNM068294X

MAY 08 2019

XTO Energy Inc.
Attn: Greg Davis
EMHC.W4.4A.541
22777 Springwoods Village Pkwy
Spring, Texas 77389-1425

Re: First Revision to the Delaware Formation Participating Area "A"
Big Eddy Unit
Eddy County, New Mexico

Gentlemen:

The first revision to the Delaware Formation Participating Area "A", NMNM068294N (formerly known as Cherry Canyon Formation PA "A") is hereby approved effective as of August 1, 2014, pursuant to Section 11 of the Big Eddy Unit Agreement, Eddy County, New Mexico.

This revision enlarges the Delaware Formation Participating Area "A" from 40.00 acres to 400.00 acres and is based upon the completion of unit well No. DI 5 4H, located in the SW $\frac{1}{4}$ NE $\frac{1}{4}$ (SHL) of Section 27, unit tract No. 78, Lease No. NMLC065431, and in the SE $\frac{1}{4}$ NE $\frac{1}{4}$ (BHL) of Section 25, T.20S., R.31E., unit tract No. 88A, Lease No. NMLC065914, with an initial potential of 368 BOPD and 0 MCFPD, from the Delaware Formation.

Copies of the approved request are being distributed to the appropriate agencies and one copy of Exhibits "A" and "B" are returned herewith. Please advise all interested parties of the approval of the first revision to the Delaware Formation Participating Area "A" effective as of August 1, 2014.

Any production royalties that are due must be reported and paid within 30 days of the Bureau of Land Management's approval date or the payors will be assessed interest for late payment under the Federal Oil and Gas Royalty Management Act of 1982 (30 CFR 218.54). If you need assistance or clarification, please contact the Office of Natural Resources Revenue (ONRR) at 1-800-525-9167 or 303-231-3856.

If you have any questions, please call Lewis Tromp, Petroleum Engineer, at (307) 261-7628.

Sincerely,

/s/ J. David Chase

J. David Chase
Chief, Reservoir Management Group

2 Enclosures

Encl. 1 - Exhibits "A" and "B"

cc: NMSO, James Glover w/Encl. 1
CFO, Chris Walls w/Encl. 1
ONRR, Glen Reese w/Encl. 1
New Mexico State Land Office, Randy Bayliss w/Encl. 1
—New Mexico Oil Conservation Division, William Jones w/Encl. 1

RECEIVED 05/02/19 08:08 AM BLM LHPPD/CASPER FIELD OFFICE



EXHIBIT "A"
FIRST REVISED DELAWARE PARTICIPATING AREA "A"
BIG EDDY UNIT 4H
EDDY COUNTY, NEW MEXICO
EFFECTIVE AUGUST 1, 2014



Date: 5/1/2019

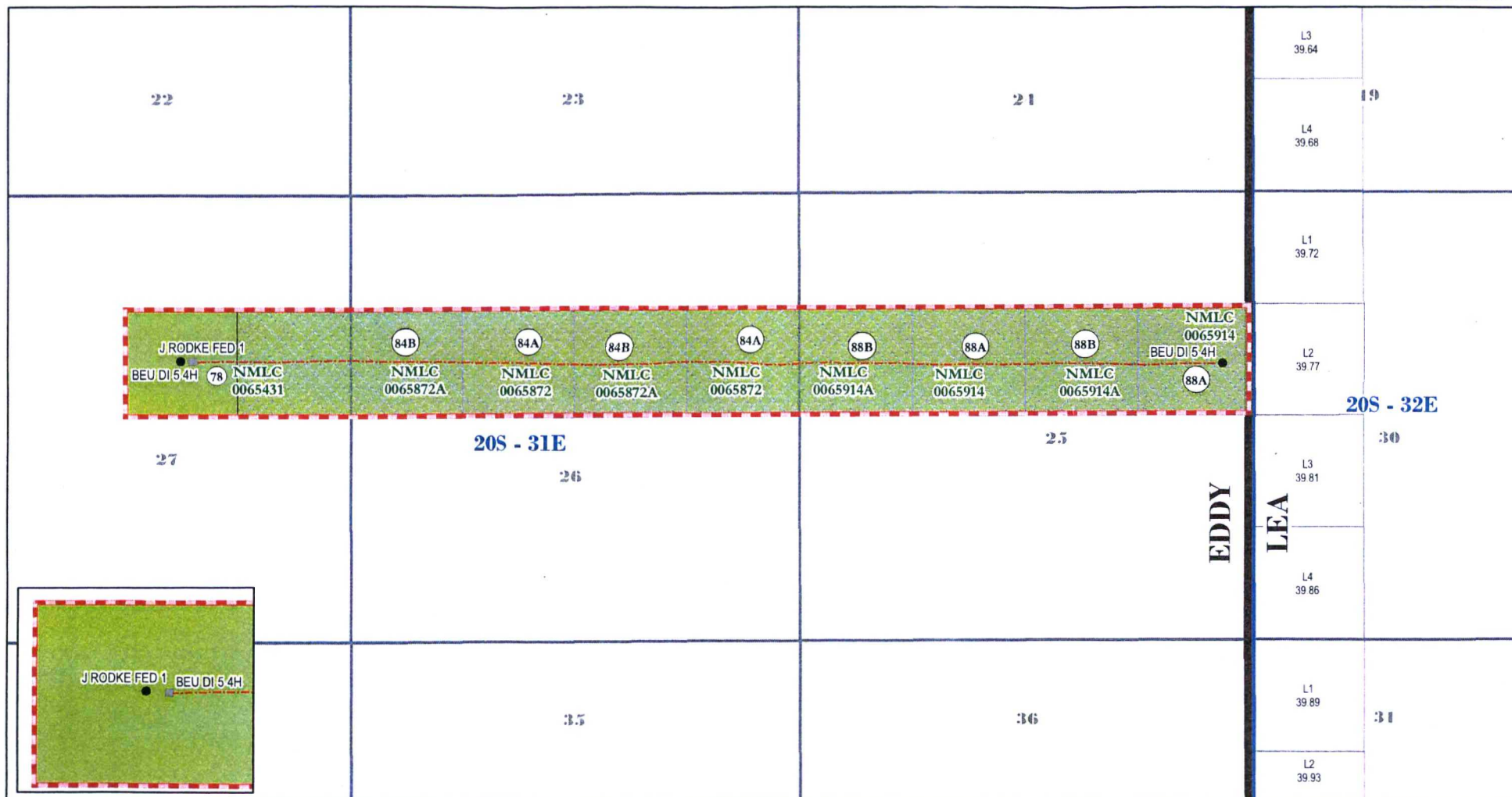

Land GIS Dept: D:\Arcview\Projects\K&B\ Project: MKD\PD Greg Davis: BEU DI WR Cherry Canyon A: 1st Revised: PA.mxd

- BIG EDDY UNIT OUTLINE
- CAPABLE WELL (BHL/ VERTICAL)
- CAPABLE WELL (SHL)
- CAPABLE WELLBORE
- BEU DLWR "A"
- PERMIAN_PA_REVISED_AC
- FEDERAL ACREAGE WITHIN PA

0 2,500 5,000 10,000 Feet

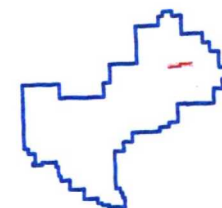

BIG EDDY UNIT

RECEIVED 05/02/19 08:08 AM BLM WHPD/CASPER FIELD OFFICE

EXHIBIT "B"
 SCHEDULE OF LANDS AND TRACT PARTICIPATION
 FIRST REVISED DELAWARE FORMATION PARTICIPATING AREA "A"
 BIG EDDY UNIT DI 5 4H
 EDDY CO, NM
 EFFECTIVE AUGUST 1, 2014

Unit Tract No.	Lease No.	Description	Acres	Participation
78	Federal	T20S-R31E,NMPM Section 27: S/2 NE/4	80	20.00000000%
84B	NMLC 065872-A Federal	T20S-R31E,NMPM Section 26: SW4/NW/4, SW/4NE/4	80	20.00000000%
84A	NMLC 065872 Federal	T20S-R31E,NMPM Section 26: SE/4NW/4, SE/4NE/4	80	20.00000000%
88B	NMLC 065914-A Federal	T20S-R31E,NMPM Section 25: SW/4NW/4, SW/4NE/4	80	20.00000000%
88A	NMLC 065914 Federal	T20S-R31E,NMPM Section 25: SE/4NW/4, SE/4NE/4	80	20.00000000%
Totals			400	100.00000000%

TYPE OF LAND	COMMITTED ACRES	NON-COMMITTED ACRES	PERCENT
FEDERAL	400.00	0	100.00000000%
STATE	0.00	0	0.00000000%
PATENTED	0.00	0	0.00000000%
TOTAL	400.00	0	100.00000000%