



United States Department of the Interior

BUREAU OF LAND MANAGEMENT
Wyoming State Office Reservoir Management Group
2987 Prospector Drive
Casper, Wyoming 82604-2968



AUG 07 2018 14:03:31

In Reply Refer To:
3186
(3186.1)
James Ranch Unit
NMNM70965X

JUL 26 2018

BOPCO, L.P.
Attn: Ken Hilger
Land Dept. Loc. 115
22777 Springwoods Village Pkwy
Spring, TX 77389-1425

Re: First Revision to the Bone Spring Formation Participating Area "B"
James Ranch Unit
Eddy County, New Mexico

Gentlemen:

The first revision to the Bone Spring Formation Participating Area "B" is hereby approved effective as of October 1, 2013, pursuant to Section 11 of the James Ranch Unit Agreement, Eddy County, New Mexico.

The application enlarges the Bone Spring Formation Participating Area "B" from 280.00 acres to 720.23 acres and is based upon the completion of unit well 126H, located in the SW $\frac{1}{4}$ NE $\frac{1}{4}$ (SHL) of Section 21, T.22S., R.30E., unit tract No. 11, Lease No. NMNM06808, and in the NW $\frac{1}{4}$ NW $\frac{1}{4}$ (BHL) of Section 19, T.22S., R.30E., unit tract No. 9, Lease No. NMNM06806, with an initial potential of 876 BOPD and 1,902 MCFPD on October 26, 2013, from the Bone Spring Formation.

Copies of the approved request are being distributed to the appropriate agencies and one copy of Exhibits "A" and "B" are returned herewith. Please advise all interested parties of the approval of the first revision to the Bone Spring Formation Participating Area "B" effective as of October 1, 2013.

Any production royalties that are due must be reported and paid within 30 days of the Bureau of Land Management's approval date or the payors will be assessed interest for late payment under the Federal Oil and Gas Royalty Management Act of 1982 (30 CFR 218.54). If you need assistance or clarification, please contact the Office of Natural Resources Revenue (ONRR) at 1-800-525-9167 or 303-231-3856.

If you have any questions, please call the undersigned at (307) 261-7685.

Sincerely,

J. David Chase

J. David Chase
Chief, Reservoir Management Group

1 Enclosure

Encl. 1 - Exhibits "A" and "B"

cc: NMSO, James Glover
CFO, Chris Walls
ONRR, Glen Reese
New Mexico State Land Office, Marilyn Gruebel
New Mexico Oil Conservation Division, William Jones



EXHIBIT "A"
FIRST REVISED BONE SPRING PARTICIPATING AREA "B"
126H, JAMES RANCH UNIT
EDDY COUNTY, NM
EFFECTIVE OCTOBER 1, 2013

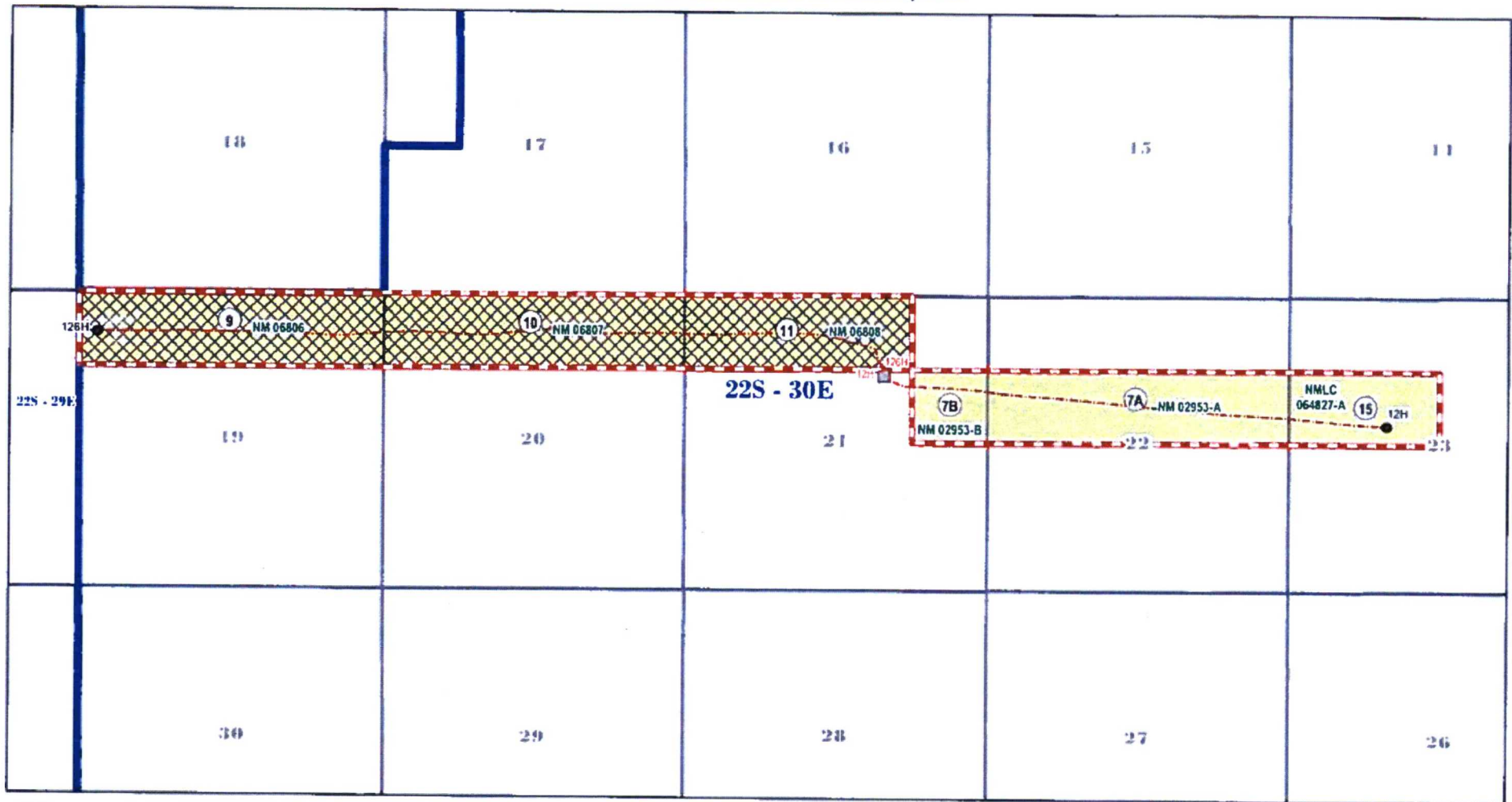

- JAMES RANCH UNIT OUTLINE
- CAPABLE WELL (SHL)
- CAPABLE WELL (BHL)
- CAPABLE WELLBORE
- PROPOSED BONE SPRING PA "B"
- FEDERAL ACREAGE WITHIN PA "B"
- REVISED ACREAGE

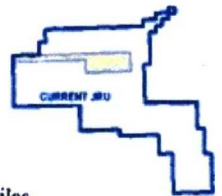

Land GIS Dept. C:\Arcview\Projects\JAMES\Projects\MEDIS\JBL\BSPG_Pkg_01202013.mxd

RECEIVED 07/26/16 10:17 AM DLT WHPD/CROPER FIELD OFFICE

EXHIBIT "B"
 SCHEDULE OF LANDS AND TRACT PARTICIPATION
 FIRST REVISION BONE SPRING FORMATION PARTICIPATING AREA "B"
 JAMES RANCH UNIT
 EDDY COUNTY, NEW MEXICO
 EFFECTIVE DATE OCTOBER 1, 2013

Tract No.	Lease No.	Description	Acres	Participation
7A	NMNM02953A Federal	T22S-R30E, 23rd P.M. Section 22: S/2 N/2	160.00	22.2151%
7B	NMNM02953B Federal	T22S-R30E, 23rd P.M. Section 21: SE/4NE/4	40.00	5.5538%
9	NMNM06806 Federal	T22S-R30E, 23rd P.M. Section 19: N/2NE/4; NE/4NW/4, Lot 1 (40.23)	160.23	22.2471%
10	NMNM06807 Federal	T22S-R30E, 23rd P.M. Section 20: N/2N/2	160.00	22.2151%
11	NMNM06808 Federal	T22S-R30E, 23rd P.M. Section 21: N/2NW/4; NW/4NE/4	120.00	16.6613%
15	NMLC064827A Federal	T22S-R30E, 23rd P.M. Section 23: S/2NW/4	80.00	11.1076%
Totals			720.23	100.0000%

TYPE OF LAND	COMMITTED ACRES	NON-COMMITTED ACRES	PERCENT
FEDERAL	720.23	0.00	100.0000%
STATE	0.00	0.00	0.0000%
PATENTED	0.00	0.00	0.0000%
TOTAL	720.23	0.00	100.0000%



United States Department of the Interior

BUREAU OF LAND MANAGEMENT
Wyoming State Office Reservoir Management Group
2987 Prospector Drive
Casper, Wyoming 82604-2968



In Reply Refer To:
3186
(3186.1)
James Ranch Unit
NMNM70965X

AUG 07 2018 PM 03:31

JUL 27 2018

BOPCO, L.P.
Attn: Ken Hilger
Land Dept. Loc. 115
22777 Springwoods Village Pkwy
Spring, TX 77389-1425

Re: Second Revision to the Bone Spring Formation Participating Area "B"
James Ranch Unit
Eddy County, New Mexico

Gentlemen:

The second revision to the Bone Spring Formation Participating Area "B" is hereby approved effective as of January 1, 2014, pursuant to Section 11 of the James Ranch Unit Agreement, Eddy County, New Mexico.

The application enlarges the Bone Spring Formation Participating Area "B" from 720.23 acres to 1,000.23 acres and is based upon the completion of unit well 163H, located in the SW $\frac{1}{4}$ NE $\frac{1}{4}$ (SHL) of Section 21, T.22S., R.30E., unit tract No. 11, Lease No. NMNM06808, and in the NE $\frac{1}{4}$ SW $\frac{1}{4}$ (BHL) of Section 23, T.22S., R.30E., unit tract No. 15, Lease No. NMLC064827A, with an initial potential of 1,196 BOPD and 1,000 MCFPD on January 24, 2014, from the Bone Spring Formation.

Copies of the approved request are being distributed to the appropriate agencies and one copy of Exhibits "A" and "B" are returned herewith. Please advise all interested parties of the approval of the second revision to the Bone Spring Formation Participating Area "B" effective as of January 1, 2014.

Any production royalties that are due must be reported and paid within 30 days of the Bureau of Land Management's approval date or the payors will be assessed interest for late payment under the Federal Oil and Gas Royalty Management Act of 1982 (30 CFR 218.54). If you need assistance or clarification, please contact the Office of Natural Resources Revenue (ONRR) at 1-800-525-9167 or 303-231-3856.

If you have any questions, please call the undersigned at (307) 261-7685.

Sincerely,

/s/ J. David Chase





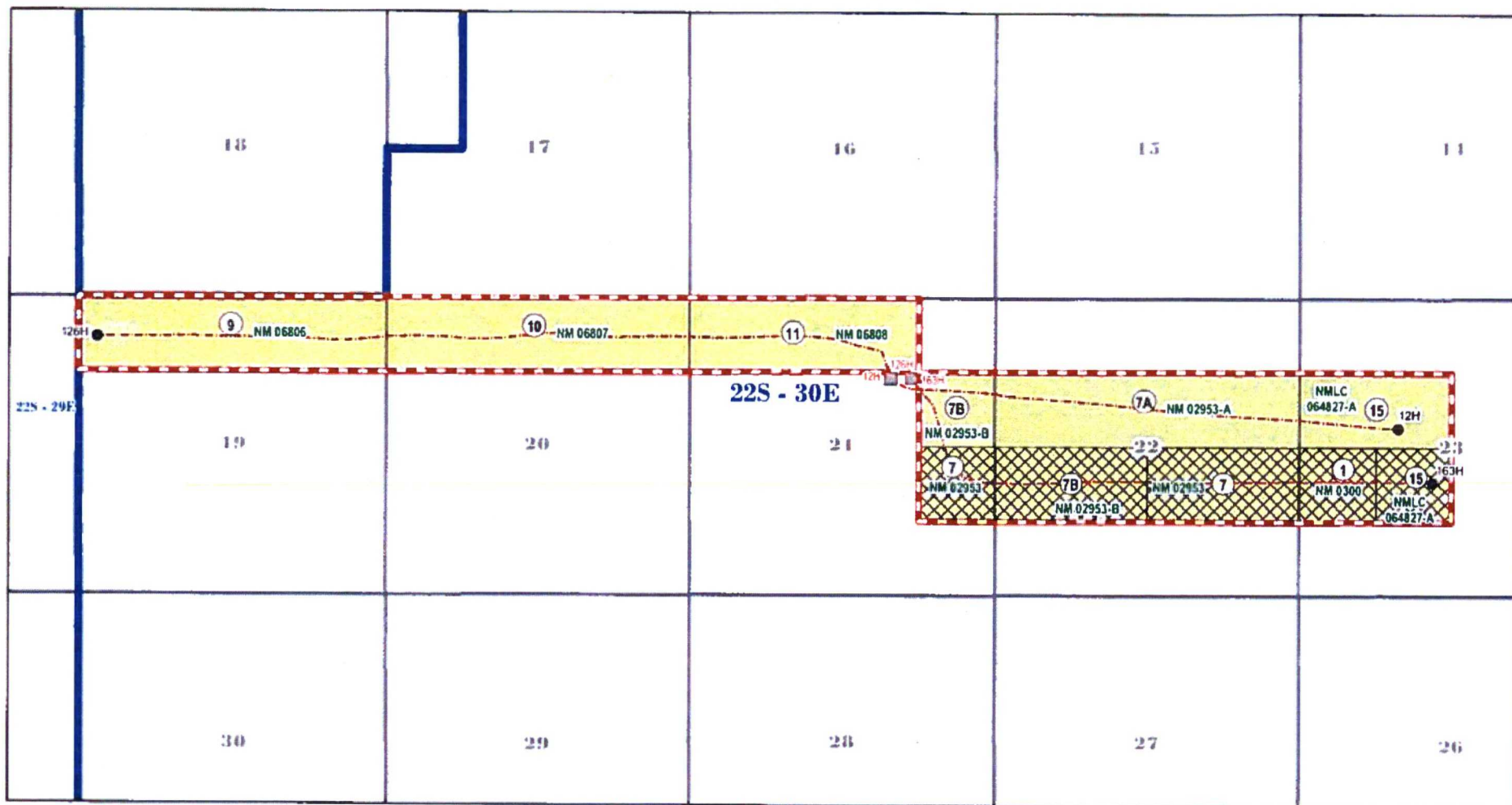
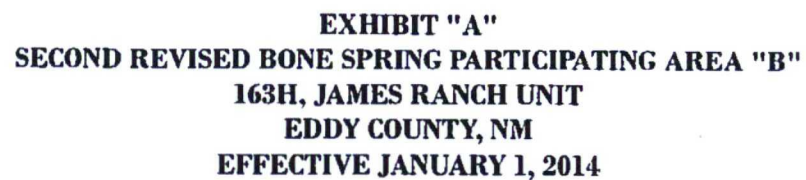

J. David Chase
Chief, Reservoir Management Group

1 Enclosure

Encl. 1 - Exhibits "A" and "B"

cc: NMSO, James Glover
CFO, Chris Walls
ONRR, Glen Reese
New Mexico State Land Office, Marilyn Gruebel
New Mexico Oil Conservation Division, William Jones



-  JAMES RANCH UNIT OUTLINE
-  CAPABLE WELL (SHL)
-  CAPABLE WELL (BHL)
-  CAPABLE WELLBORE
-  PROPOSED BONE SPRING PA "B"
-  FEDERAL ACREAGE WITHIN PA "B"
-  REVISED ACREAGE



Land Cts Dept. U \ Arc view \ Projects \ 4547N \ Projects - MEETS \ RE' BSG PA. 01282010.mxd

[illegible]

EXHIBIT "B"
 SCHEDULE OF LANDS AND TRACT PARTICIPATION
 SECOND REVISION BONE SPRING PARTICIPATING AREA "B"
 JAMES RANCH UNIT
 EDDY COUNTY, NEW MEXICO
 EFFECTIVE APRIL 1, 2014

Tract No.	Lease No.	Description	Acres	Participation
1	NMNM0300 Federal	T22S-R30E, 23rd P.M. Section 23: NW/4SW/4	40.00	3.9993%
7	NMNM02953 Federal	T22S-R30E, 23rd P.M. Section 21: NE/4SE/4 Section 22: N/2SE/4	120.00	11.9972%
7A	NMNM02953A Federal	T22S-R30E, 23rd P.M. Section 22: S/2N/2	160.00	15.9963%
7B	NMNM02953B Federal	T22S-R30E, 23rd P.M. Section 21: SE/4NE/4 Section 22: N/2SW/4	120.00	11.9972%
9	NMNM06806 Federal	T22S-R30E, 23rd P.M. Section 19: N/2NE/4; NE/4NW/4; Lot 1 (40.23)	160.23	16.0193%
10	NMNM06807 Federal	T22S-R30E, 23rd P.M. Section 20: N/2N/2	160.00	15.9963%
11	NMNM06808 Federal	T22S-R30E, 23rd P.M. Section 21: N/2NW/4; NW/4NE/4	120.00	11.9972%
15	NMLC064827A Federal	T22S-R30E, 23rd P.M. Section 23: S/2NW/4; NE/4SW/4	120.00	11.9972%
Totals			1000.23	100.0000%

TYPE OF LAND	COMMITTED ACRES	NON-COMMITTED ACRES	PERCENT
FEDERAL	1000.23	0.00	100.0000%
STATE	0.00	0.00	0.0000%
PATENTED	0.00	0.00	0.0000%
TOTAL	1000.23	0.00	100.0000%

RECEIVED 07/26/16 09:06 PM BLM WIPAC/CHAPER FIELD OFFICE



United States Department of the Interior

BUREAU OF LAND MANAGEMENT
Wyoming State Office Reservoir Management Group
2987 Prospector Drive
Casper, Wyoming 82604-2968



In Reply Refer To:
3186
(3186.1)
James Ranch Unit
NMNM70965X

AUG 07 2018 P-03:31

JUL 25 2018

BOPCO, L.P.
Attn: Ken Hilger
Land Dept. Loc. 115
22777 Springwoods Village Pkwy
Spring, TX 77389-1425

Re: Initial Bone Spring Formation Participating Area "B"
James Ranch Unit
Eddy County, New Mexico

Gentlemen:

The initial Bone Spring Formation Participating Area "B" is hereby approved effective as of October 27, 2011, pursuant to Section 11 of the James Ranch Unit Agreement, Eddy County, New Mexico. This participating area has been designated NMNM70965H.

The application establishes an initial Bone Spring Formation Participating Area "B" of 280.00 acres and is based upon the completion of unit well 12H, located in the SW $\frac{1}{4}$ NE $\frac{1}{4}$ (SHL) of Section 21, T.22S, R.30E, unit tract No. 11, Lease No. NMNM06808, and in the SE $\frac{1}{4}$ NW $\frac{1}{4}$ (BHL) of Section 23, T.22S, R.30E, unit tract No. 15, Lease No. NMLC064827A, with an initial potential of 1,057 BOPD and 1,232 MCFPD on October 27, 2011, from the Bone Spring Formation.

Copies of the approved request are being distributed to the appropriate agencies and one copy of Exhibits "A" and "B" are returned herewith. Please advise all interested parties of the approval of the initial Bone Spring Formation Participating Area "B" effective as of October 27, 2011.

Any production royalties that are due must be reported and paid within 30 days of the Bureau of Land Management's approval date or the payors will be assessed interest for late payment under the Federal Oil and Gas Royalty Management Act of 1982 (30 CFR 218.54). If you need assistance or clarification, please contact the Office of Natural Resources Revenue (ONRR) at 1-800-525-9167 or 303-231-3856.

If you have any questions, please call the undersigned at (307) 261-7685.

Sincerely,

/s/ J. David Chase

J. David Chase
Chief, Reservoir Management Group

1 Enclosure

Encl. 1 - Exhibits "A" and "B"

cc: NMSO, James Glover
CFO, Chris Walls
ONRR, Glen Reese
New Mexico State Land Office, Marilyn Gruebel
New Mexico Oil Conservation Division, William Jones



EXHIBIT "A"
INITIAL BONE SPRING PARTICIPATING AREA "B"
12H, JAMES RANCH UNIT
EDDY COUNTY, NM
EFFECTIVE OCTOBER 27, 2011

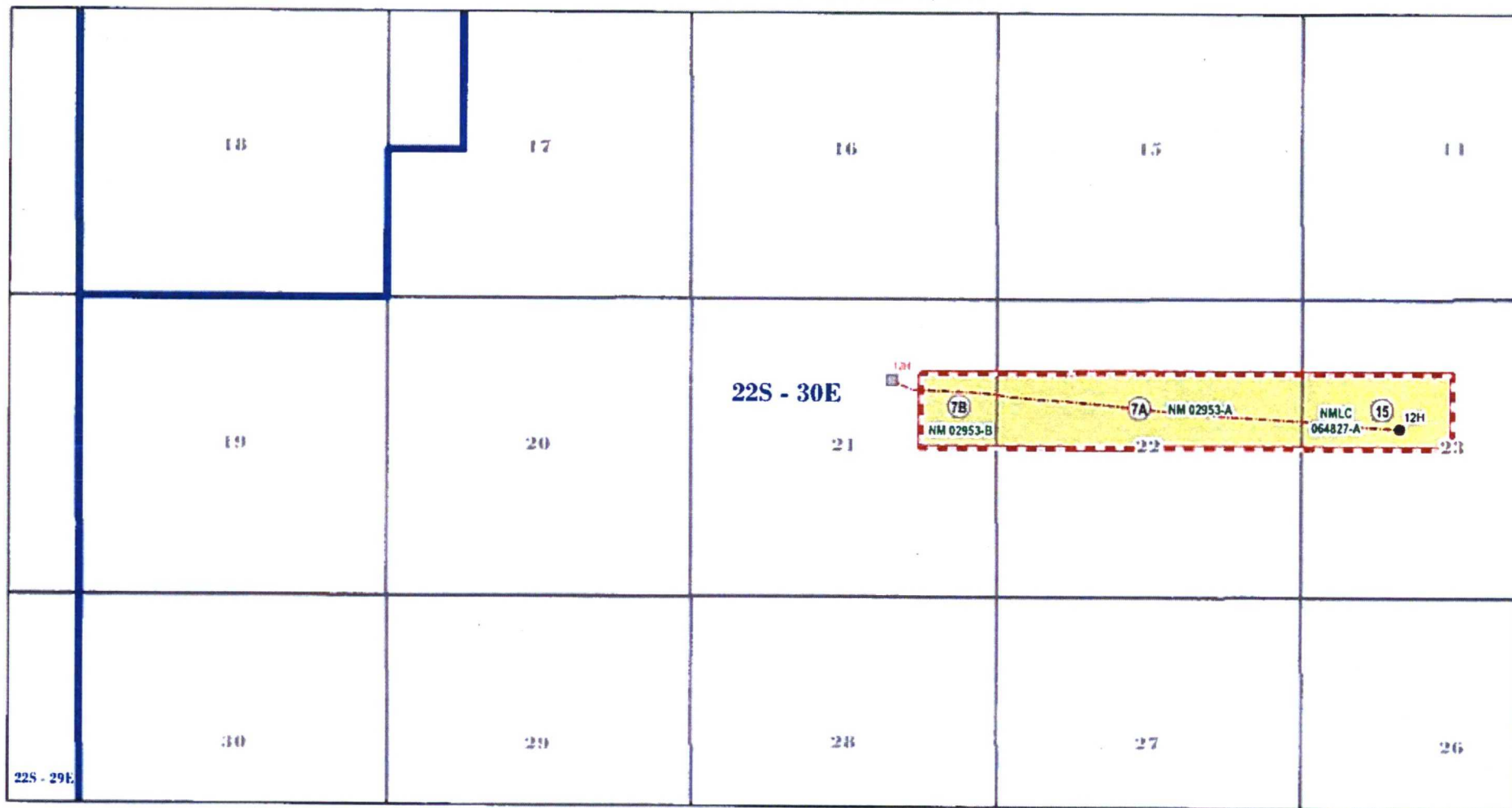

- JAMES RANCH UNIT OUTLINE
- CAPABLE WELL (SHL)
- CAPABLE WELL (BHL)
- CAPABLE WELL BORE
- PROPOSED BONE SPRING PA "B"
- FEDERAL ACREAGE WITHIN PA "B"



EXHIBIT "B"
 SCHEDULE OF LANDS AND TRACT PARTICIPATION
 INITIAL BONE SPRING FORMATION PARTICIPATING AREA "B"
 JAMES RANCH UNIT
 EDDY COUNTY, NEW MEXICO
 EFFECTIVE OCTOBER 27, 2011

Tract No.	Lease No.	Description	Acres	Participation
7A	NMNM02953A Federal	T22S-R30E, 23rd P.M. Section 22: S/2N/2	160.00	57.1429%
7B	NMNM02953B Federal	T22S-R30E, 23rd P.M. Section 21: SE/4NE/4	40.00	14.2857%
15	NMLC064827A Federal	T22S-R30E, 23rd P.M. Section 23: S/2NW/4	80.00	28.5714%
Totals			280.00	100.0000%

TYPE OF LAND	COMMITTED ACRES	NON-COMMITTED ACRES	PERCENT
FEDERAL	280.00	0.00	100.0000%
STATE	0.00	0.00	0.0000%
PATENTED	0.00	0.00	0.0000%
TOTAL	280.00	0.00	100.0000%

