

District I
1625 N. French Dr., Hobbs, NM 88240
District II
811 South First, Artesia, NM 88210
District III
1000 Rio Brazos Road, Aztec, NM 87410
District IV
2040 South Pacheco, Santa Fe, NM 87505

State of New Mexico
Energy Minerals and Natural Resources

Form C-101
Revised March 17, 1999

Oil Conservation Division
2040 South Pacheco
Santa Fe, NM 87505

Submit to appropriate District Office
State Lease - 6 Copies
Fee Lease - 5 Copies

AMENDED REPORT

APPLICATION FOR PERMIT TO DRILL, RE-ENTER, DEEPEN, PLUGBACK, OR ADD A ZONE

¹ Operator Name and Address Sonat Raton, L.L.C. P.O.Box 190 Raton, New Mexico 87740		² OGRID Number 180514
		³ API Number 30 - 007- 20102
³ Property Code 24648	⁵ Property Name Vermejo Park Ranch	⁶ Well No. VPR A-24 (formerly Can.River "X")

⁷ Surface Location

UL or lot no.	Section	Township	Range	Lot Idn	Feet from the	North/South line	Feet from the	East/West line	County
I	29	32N	20E		1920'	FSL	330'	FEL	Colfax

⁸ Proposed Bottom Hole Location If Different From Surface

UL or lot no.	Section	Township	Range	Lot Idn	Feet from the	North/South line	Feet from the	East/West line	County
⁹ Proposed Pool 1 Vermejo					¹⁰ Proposed Pool 2 Raton				

¹¹ Work Type Code E	¹² Well Type Code M	¹³ Cable/Rotary completion rig	¹⁴ Lease Type Code P	¹⁵ Ground Level Elevation 8058' (GL)
¹⁶ Multiple yes	¹⁷ Proposed Depth 2380'	¹⁸ Formation Vermejo	¹⁹ Contractor Leeds Energy	²⁰ Spud Date July 1, 1999

²¹ Proposed Casing and Cement Program

Hole Size	Casing Size	Casing weight/foot	Setting Depth	Sacks of Cement	Estimated TOC
12 1/2"	8 5/8"	24#	330.5'	192 sx.	
7 7/8"	5 1/2"	17#	2380'	400 sx.	

²² Describe the proposed program. If this application is to DEEPEN or PLUG BACK, give the data on the present productive zone and proposed new productive zone. Describe the blowout prevention program, if any. Use additional sheets if necessary.

1. RU completion rig. Install BOP. PU and RIH with 4 3/4" bit on 2 7/8" tubing.
2. Drill out surface plug 0' to 50'. Reverse circulate clean with fresh or clean produced water to PBSD at 2340'.
3. Perforate and frac according to HLS CBL of 9/19/89 and HLS Density log of 9/10/89.
4. Clean out to bottom and reverse circulate clean.
5. RIH with pumping equipment and place on test.

²³ I hereby certify that the information given above is true and complete to the best of my knowledge and belief.

Signature: *DR Lankford*

Printed name: Donald R Lankford

Title: Senior Petroleum Engineer

Date: 6/11/99

Phone: (505)445-4620

OIL CONSERVATION DIVISION

Approved by: *Ry E Johnson*

Title: **DISTRICT SUPERVISOR**

Approval Date: **6/14/99**

Expiration Date: **6/14/00**

Conditions of Approval:

Attached

Submit 3 Copies
to Appropriate
District Office

State of New Mexico
Energy, Minerals and Natural Resources Department

Form C-103
Revised 1-1-89

OIL CONSERVATION DIVISION
P.O. Box 2088
Santa Fe, New Mexico 87504-2088

DISTRICT I
P.O. Box 1980, Hobbs, NM 88240

DISTRICT II
P.O. Drawer DD, Artesia, NM 88210

DISTRICT III
1000 Rio Brazos Rd., Aztec, NM 87410

WELL API NO. 20102
30-007-20100

5. Indicate Type of Lease
STATE FEE

6. State Oil & Gas Lease No.

SUNDRY NOTICES AND REPORTS ON WELLS
(DO NOT USE THIS FORM FOR PROPOSALS TO DRILL OR TO DEEPEN OR PLUG BACK TO A
DIFFERENT RESERVOIR. USE "APPLICATION FOR PERMIT"
(FORM C-101) FOR SUCH PROPOSALS.)

7. Lease Name or Unit Agreement Name
Canadian River
3220

1. Type of Well:
OIL WELL GAS WELL OTHER Coal methane

8. Well No.
291-I

2. Name of Operator
Pennzoil Exploration and Production Company

9. Pool name or Wildcat
Wildcat

3. Address of Operator
P.O. Box 2967, Houston, TX 77252

4. Well Location
Unit Letter I : 330 Feet From The East Line and 1920 Feet From The South Line

Section 29 Township 32N Range 20E NMPM Colfax County

10. Elevation (Show whether DF, RKB, RT, GR, etc.)
8058 GR

11. Check Appropriate Box to Indicate Nature of Notice, Report, or Other Data

NOTICE OF INTENTION TO:

SUBSEQUENT REPORT OF:

PERFORM REMEDIAL WORK PLUG AND ABANDON
TEMPORARILY ABANDON CHANGE PLANS
PULL OR ALTER CASING
OTHER: _____

REMEDIAL WORK ALTERING CASING
COMMENCE DRILLING OPNS. PLUG AND ABANDONMENT
CASING TEST AND CEMENT JOB
OTHER: Drilling completed

12. Describe Proposed or Completed Operations (Clearly state all pertinent details, and give pertinent dates, including estimated date of starting any proposed work) SEE RULE 1103.

- 9-06-89 Spud.
- 9-08-89 Drill 12 1/2" hole to 340'. Set and cement 12 jts (330.51') 8 5/8", 24 lb. J-55, ST&C casing w/292 sks class G w/2% CaCl @ 15.8 ppg. Plug down w/500 psi cement to surface.
- 9-09-89 Test casing and BOP w/600 psi for 30 minutes. No pressure drop.
- 9-10-89 Drill 7 7/8" hole to 2414'.
- 9-11-89 Set and cement 61 jts (2379.84') 5 1/2" 17 lb. J-55, LTC casing w/400 sks silicalite @ 11.0 ppg. Plug down with 1000 psi. No cement to surface. Waiting on completion equipment.

I hereby certify that the information above is true and complete to the best of my knowledge and belief.

SIGNATURE L. D. Williamson TITLE Operations Superintendent DATE 9/14/89

TYPE OR PRINT NAME L. D. Williamson TELEPHONE NO. 505-376-2817

(This space for State Use)

APPROVED BY [Signature] TITLE DISTRICT SUPERINTENDENT DATE 9-18-89

CONDITIONS OF APPROVAL, IF ANY:

X
Submit 3 Copies
to Appropriate
District Office

State of New Mexico
Energy, Minerals and Natural Resources Department

Form C-103
Revised 1-1-89

DISTRICT I
P.O. Box 1980, Hobbs, NM 88240

OIL CONSERVATION DIVISION
P.O. Box 2088
Santa Fe, New Mexico 87504-2088

DISTRICT II
P.O. Drawer DD, Artesia, NM 88210

DISTRICT III
1000 Rio Brazos Rd., Aztec, NM 87410

WELL API NO. 30-007-20102
5. Indicate Type of Lease STATE <input type="checkbox"/> FEE <input checked="" type="checkbox"/>
6. State Oil & Gas Lease No.

SUNDRY NOTICES AND REPORTS ON WELLS (DO NOT USE THIS FORM FOR PROPOSALS TO DRILL OR TO DEEPEN OR PLUG BACK TO A DIFFERENT RESERVOIR. USE "APPLICATION FOR PERMIT" (FORM C-101) FOR SUCH PROPOSALS.)	
1. Type of Well: OIL WELL <input type="checkbox"/> GAS WELL <input type="checkbox"/> OTHER Coal Methane	7. Lease Name or Unit Agreement Name Canadian River 3220
2. Name of Operator Pennzoil Exploration & Production Company	8. Well No. 291-I
3. Address of Operator P.O. Box 2967, Houston, TX 77252	9. Pool name or Wildcat Wildcat
4. Well Location Unit Letter <u>I</u> : <u>330</u> Feet From The <u>East</u> Line and <u>1920</u> Feet From The <u>South</u> Line Section <u>29</u> Township <u>32N</u> Range <u>20E</u> NMPM Colfax County	
10. Elevation (Show whether DF, RKB, RT, GR, etc.) 8058 GR	

11. Check Appropriate Box to Indicate Nature of Notice, Report, or Other Data

NOTICE OF INTENTION TO:		SUBSEQUENT REPORT OF:	
PERFORM REMEDIAL WORK <input type="checkbox"/>	PLUG AND ABANDON <input type="checkbox"/>	REMEDIAL WORK <input type="checkbox"/>	ALTERING CASING <input type="checkbox"/>
TEMPORARILY ABANDON <input type="checkbox"/>	CHANGE PLANS <input type="checkbox"/>	COMMENCE DRILLING OPNS. <input type="checkbox"/>	PLUG AND ABANDONMENT <input checked="" type="checkbox"/>
PULL OR ALTER CASING <input type="checkbox"/>		CASING TEST AND CEMENT JOB <input type="checkbox"/>	
OTHER: <input type="checkbox"/>		OTHER: <input type="checkbox"/>	

12. Describe Proposed or Completed Operations (Clearly state all pertinent details, and give pertinent dates, including estimated date of starting any proposed work) SEE RULE 1103.

- 9/10/91. Start of work.
1. No perforations. Fill well bore with 9.0 ppg gel mud.
 2. Place 6 sks (50') surface plug w/class A @ 15.6 ppg.
 3. Place well marker. Pits previously filled and location reclaimed.
 4. Pipe left in well: 330.5' of 8 5/8", 24 lb/ft set @ 330.5'
2380' of 5 1/2", 17 lb/ft set @ 2380'
 5. All work completed 9/11/91

I hereby certify that the information above is true and complete to the best of my knowledge and belief.

SIGNATURE L. D. Williamson TITLE Operations Superintendent DATE 9/12/91
 TYPE OR PRINT NAME L. D. Williamson TELEPHONE NO. 376-2817

(This space for State Use)
 APPROVED BY [Signature] TITLE DISTRICT SUPERVISOR DATE 9-20-91
 CONDITIONS OF APPROVAL, IF ANY:

X
 Submit to Appropriate District Office
 State Lease - 6 copies
 Fee Lease - 5 copies
 DISTRICT I
 P.O. Box 1980, Hobbs, NM 88240

State of New Mexico
 Energy, Minerals and Natural Resources Department

Form C-105
 Revised 1-1-89

OIL CONSERVATION DIVISION
 P.O. Box 2088
 Santa Fe, New Mexico 87504-2088

DISTRICT II
 P.O. Drawer DD, Artesia, NM 88210

DISTRICT III
 1000 Rio Brazos Rd., Aztec, NM 87410

WELL API NO.
 30-007-20102

5. Indicate Type of Lease
 STATE FEE

6. State Oil & Gas Lease No.

WELL COMPLETION OR RECOMPLETION REPORT AND LOG

1a. Type of Well:
 OIL WELL GAS WELL DRY OTHER Coal Methane

b. Type of Completion:
 NEW WELL WORK OVER DEEPEN PLUG BACK DIFF RESVR OTHER P&G

7. Lease Name or Unit Agreement Name
 Canadian River 3220

8. Well No.
 291-I

9. Pool name or Wildcat
 Wildcat

2. Name of Operator
 Pennzoil Exploration & Production Company

3. Address of Operator
 P.O. Box 2967, Houston, Tx 77252

4. Well Location
 Unit Letter I: 330 Feet From The East Line and 1920 Feet From The South Line
 Section 29 Township 32N Range 20E NMPM Colfax County

10. Date Spudded 9/06/89
 11. Date T.D. Reached 9/10/89
 12. Date Compl. (Ready to Prod.) NA
 13. Elevations (DF& RKB, RT, GR, etc.) 8058 GR
 14. Elev. Casinghead 8060 GR

15. Total Depth 2414
 16. Plug Back T.D. 2340
 17. If Multiple Compl. How Many Zones?
 18. Intervals Drilled By Rotary Tools 0-2414 Cable Tools

19. Producing Interval(s), of this completion - Top, Bottom, Name
 NA

20. Was Directional Survey Made
 Yes

21. Type Electric and Other Logs Run
 Dil, Neutron, Gamma, Density, Directional, Temperature

22. Was Well Cored
 No

CASING RECORD (Report all strings set in well)

CASING SIZE	WEIGHT LB./FT.	DEPTH SET	HOLE SIZE	CEMENTING RECORD	AMOUNT PULLED
8 5/8	24	330.5	12 1/2	192 sks class G	0
5 1/2	17	2380	7 7/8	400 sks silicalite	0

24. LINER RECORD

SIZE	TOP	BOTTOM	SACKS CEMENT	SCREEN

25. TUBING RECORD

SIZE	DEPTH SET	PACKER SET

26. Perforation record (interval, size, and number)
 None

27. ACID, SHOT, FRACTURE, CEMENT, SQUEEZE, ETC.
 DEPTH INTERVAL AMOUNT AND KIND MATERIAL USED

28. PRODUCTION

Date First Production NA
 Production Method (Flowing, gas lift, pumping - Size and type pump)
 Well Status (Prod. or Shut-in)

Date of Test NA
 Hours Tested
 Choke Size
 Prod'n For Test Period
 Oil - Bbl.
 Gas - MCF
 Water - Bbl.
 Gas - Oil Ratio

Flow Tubing Press.
 Casing Pressure
 Calculated 24-Hour Rate
 Oil - Bbl.
 Gas - MCF
 Water - Bbl.
 Oil Gravity - API - (Corr.)

29. Disposition of Gas (Sold, used for fuel, vented, etc.)
 NA

Test Witnessed By

30. List Attachments
 Plugging report--all logs previously submitted.

31. I hereby certify that the information shown on both sides of this form is true and complete to the best of my knowledge and belief

Signature L. D. Williamson Printed Name L. D. Williamson Title Operations Supt. Date 9/12/91

X

Submit 3 Copies to Appropriate District Office

State of New Mexico Energy, Minerals and Natural Resources Department

Form C-103 Revised 1-1-89

DISTRICT I P.O. Box 1980, Hobbs, NM 88240

OIL CONSERVATION DIVISION P.O. Box 2088 Santa Fe, New Mexico 87504-2088

DISTRICT II P.O. Drawer DD, Artesia, NM 88210

DISTRICT III 1000 Rio Brazos Rd., Aztec, NM 87410

WELL API NO. 30-007-20102

5. Indicate Type of Lease STATE [] FEE [X]

6. State Oil & Gas Lease No.

SUNDRY NOTICES AND REPORTS ON WELLS (DO NOT USE THIS FORM FOR PROPOSALS TO DRILL OR TO DEEPEN OR PLUG BACK TO A DIFFERENT RESERVOIR. USE 'APPLICATION FOR PERMIT' (FORM C-101) FOR SUCH PROPOSALS.)



7. Lease Name or Unit Agreement Name Canadian River 3220

1. Type of Well: OIL WELL [] GAS WELL [] OTHER Coal Methane

2. Name of Operator Pennzoil Exploration & production Company

8. Well No. 291-I

3. Address of Operator P.O. Box 2967, Houston, TX 77252

9. Pool name or Wildcat Wildcat

4. Well Location Unit Letter I : 330 Feet From The East Line and 1920 Feet From The South Line Section 29 Township 32N Range 20E NMPM Colfax County

10. Elevation (Show whether DF, RKB, RT, GR, etc.) 8058 Gr

11. Check Appropriate Box to Indicate Nature of Notice, Report, or Other Data NOTICE OF INTENTION TO: PERFORM REMEDIAL WORK [] PLUG AND ABANDON [X] TEMPORARILY ABANDON [] CHANGE PLANS [] PULL OR ALTER CASING [] OTHER: [] SUBSEQUENT REPORT OF: REMEDIAL WORK [] ALTERING CASING [] COMMENCE DRILLING OPNS. [] PLUG AND ABANDONMENT [] CASING TEST AND CEMENT JOB [] OTHER: []

12. Describe Proposed or Completed Operations (Clearly state all pertinent details, and give pertinent dates, including estimated date of starting any proposed work) SEE RULE 1103.

- 9/15/91 Estimated start of work. 1. No perforations. Fill well bore with gel mud. 2. Place 64 sks (50') surface plug w/class A @ 15.6 ppg. 3. Place well marker. Pits previously filled and location reclaimed.

I hereby certify that the information above is true and complete to the best of my knowledge and belief. SIGNATURE [Signature] TITLE Operations Superintendent DATE 8/12,91 TYPE OR PRINT NAME L. D. Williamson TELEPHONE NO. 376-2817

(This space for State Use) APPROVED BY [Signature] TITLE DISTRICT SUPERVISOR DATE 8-29-91 CONDITIONS OF APPROVAL, IF ANY:

Submit to Appropriate District Office
 State Lease - 6 copies
 Fee Lease - 5 copies

State of New Mexico
 Energy, Minerals and Natural Resources Department

RECEIVED

Form C-101
 Revised 1-1-89

OIL CONSERVATION DIVISION

P.O. Box 2088
 Santa Fe, New Mexico 87504-2088

DISTRICT I
 P.O. Box 1980, Hobbs, NM 88240

DISTRICT II
 P.O. Drawer DD, Artesia, NM 88210

DISTRICT III
 1000 Rio Brazos Rd., Aztec, NM 87410

API NO. assigned by OCD on New Wells)
 AUG 30-007-201002
 OIL CONSERVATION DIV.
 State of Lease
 SANTA FE STATE FEE
 6. State Oil & Gas Lease No.

APPLICATION FOR PERMIT TO DRILL, DEEPEN, OR PLUG BACK

1a. Type of Work: DRILL RE-ENTER DEEPEN PLUG BACK
 b. Type of Well: OIL WELL GAS WELL OTHER Coal Methane SINGLE ZONE MULTIPLE ZONE
 2. Name of Operator: Pennzoil Exploration and Production Company
 3. Address of Operator: P.O. Box 2967, Houston, TX 77252
 7. Lease Name or Unit Agreement Name: Canadian River
 8. Well No.: 291 I
 9. Pool name or Wildcat: Wildcat

4. Well Location Unit Letter I : 330 Feet From The east Line and 1920 Feet From The south Line
 Section 29 Township 32N Range 20E NMPM Colfax County

10. Proposed Depth: 2600'
 11. Formation: Vermejo
 12. Rotary or C.T.: rotary
 13. Elevations (Show whether DF, RT, GR, etc.): 8058 GR
 14. Kind & Status Plug. Bond: blanket
 15. Drilling Contractor: V&H
 16. Approx. Date Work will start: August 28, 1989

17. PROPOSED CASING AND CEMENT PROGRAM

SIZE OF HOLE	SIZE OF CASING	WEIGHT PER FOOT	SETTING DEPTH	SACKS OF CEMENT	EST. TOP
12-1/4"	8-5/8"	24	350	175	surface
7-7/8"	5-1/2"	17	2600	500	surface

1. Drill 12-1/4" hole to 350' with mud.
2. Set 8-5/8" casing and cement to surface.
3. Drill 7-7/8" hole to TD.
4. Set 5-1/2" casing to 2600' and cement to surface.

APPROVAL VALID FOR 90 DAYS
 PERMIT EXPIRES 11-5-89
 UNLESS DRILLING UNDERWAY

IN ABOVE SPACE DESCRIBE PROPOSED PROGRAM: IF PROPOSAL IS TO DEEPEN OR PLUG BACK, GIVE DATA ON PRESENT PRODUCTIVE ZONE AND PROPOSED NEW PRODUCTIVE ZONE. GIVE BLOWOUT PREVENTER PROGRAM, IF ANY.

I hereby certify that the information above is true and complete to the best of my knowledge and belief.
 SIGNATURE [Signature] TITLE Project Manager DATE 8/14/89
 TYPE OR PRINT NAME R.D. Osterhout TELEPHONE NO 546-4774

(This space for State Use)
 APPROVED BY [Signature] TITLE DISTRICT SUPERVISOR DATE 8-17-89
 CONDITIONS OF APPROVAL, IF ANY:
NSL MUST BE APPROVED PRIOR TO PRODUCTION
 AT AT LEAST 100 FOOT INTERVALS

WELL
X

NEW MEXICO OIL CONSERVATION COMMISSION WELL LOCATION AND ACREAGE DEDICATION PLAT

Form C-102
Supersedes C-128
Effective 1-4-85

All distances must be from the outer boundaries of the Section.

Pennzoil Exploration and Production Co.		Lease Canadian River		Well No. 291 I
Unit Letter I	Section 29	Township T32N	Range R20E	County COLFAX
Actual Footage Location of Well 330 feet from the EAST line and 1920 feet from the SOUTH line				
Ground Level Elev. 8058	Producing Formation Vermejo/Raton		Pool	Dedicated Acreage: Wildcat Acres

1. Outline the acreage dedicated to the subject well by colored pencil or hachure marks on the plat below.
2. If more than one lease is dedicated to the well, outline each and identify the ownership thereof (both as to working interest and royalty).
3. If more than one lease of different ownership is dedicated to the well, have the interests of all owners been consolidated by communitization, unitization, force-pooling, etc?

Yes No If answer is "yes;" type of consolidation _____

If answer is "no;" list the owners and tract descriptions which have actually been consolidated. (Use reverse side of this form if necessary.) _____

No allowable will be assigned to the well until all interests have been consolidated (by communitization, unitization, forced-pooling, or otherwise) or until a non-standard unit, eliminating such interests, has been approved by the Commission.

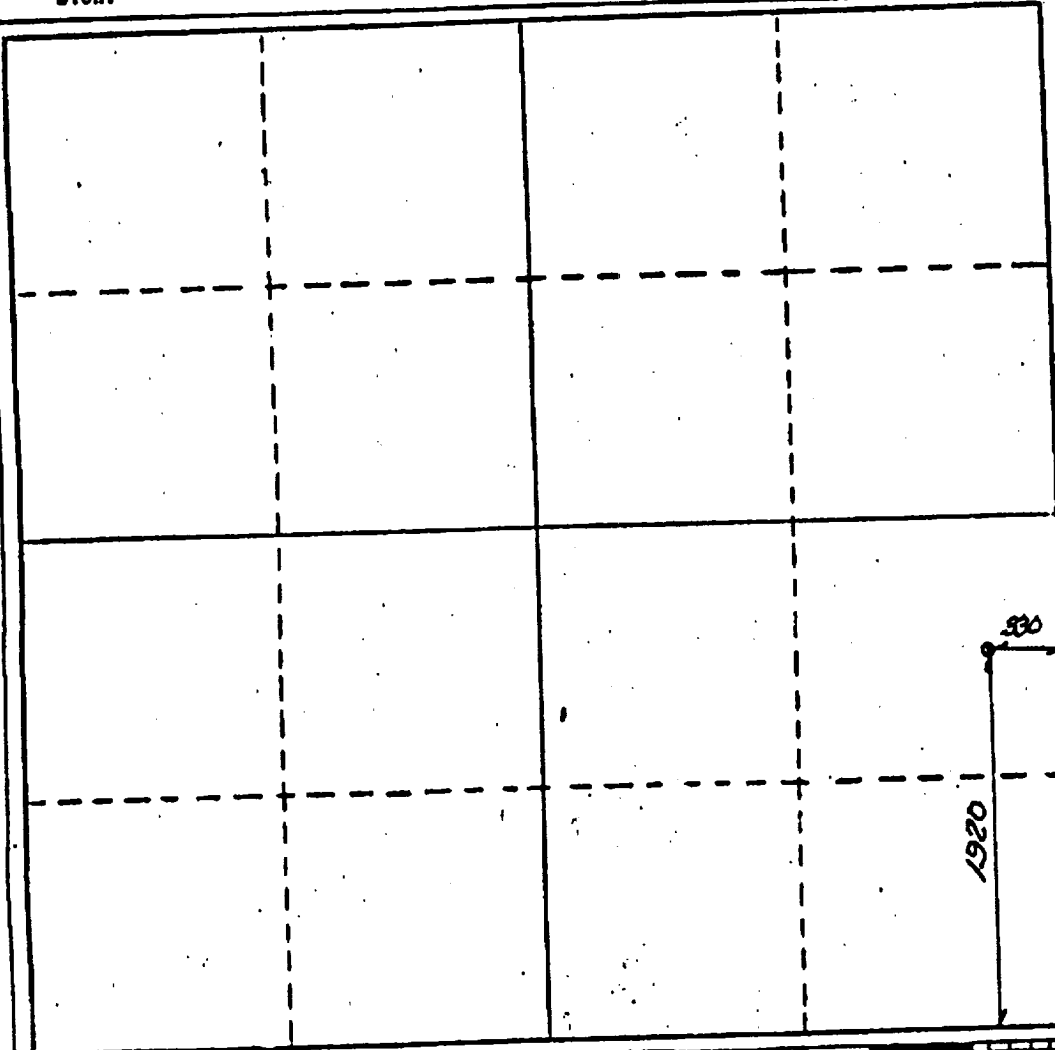

CERTIFICATION

I hereby certify that the information contained herein is true and complete to the best of my knowledge and belief.

Name
R.D. Osterhout

Position
Project Manager

Company
PEPCO

Date
August 14, 1989

I hereby certify that the well location shown on this plat was plotted from field notes of actual surveys made by me or under my supervision, and that the same is true and correct to the best of my knowledge and belief.

AUGUST 10, 1989

Date Surveyed

Registered Professional Engineer
and/or Land Surveyor

N.M.L.S. NO. 5103
Certificate No.



WELL

RECEIVED

N. MEXICO OIL CONSERVATION COMMISSION
WELL LOCATION AND ACREAGE DEDICATION PLAT

Effective 1-1-83

AUG 28 1989

All distances must be from the outer boundaries of the Section.

Pennzoil Exploration And Production Co.		Lease		Canadian River		Well No.	
Unit Letter I		Township T32N		Range R20E		County COLFAX	
Actual Footage Location of Well:		330 feet from the EAST line and		1920 feet from the SOUTH line		Dedicated Acreage:	
Ground Level Elev. 8058		Producing Formation Vermejo/Raton		Pool		Wildcat	

1. Outline the acreage dedicated to the subject well by colored pencil or hachure marks on the plat below.
2. If more than one lease is dedicated to the well, outline each and identify the ownership thereof (both as to working interest and royalty).
3. If more than one lease of different ownership is dedicated to the well, have the interests of all owners been consolidated by communitization, unitization, force-pooling, etc?

Yes No If answer is "yes," type of consolidation _____

If answer is "no," list the owners and tract descriptions which have actually been consolidated. (Use reverse side of this form if necessary.) _____

No allowable will be assigned to the well until all interests have been consolidated (by communitization, unitization, forced-pooling, or otherwise) or until a non-standard unit, eliminating such interests, has been approved by the Commission.

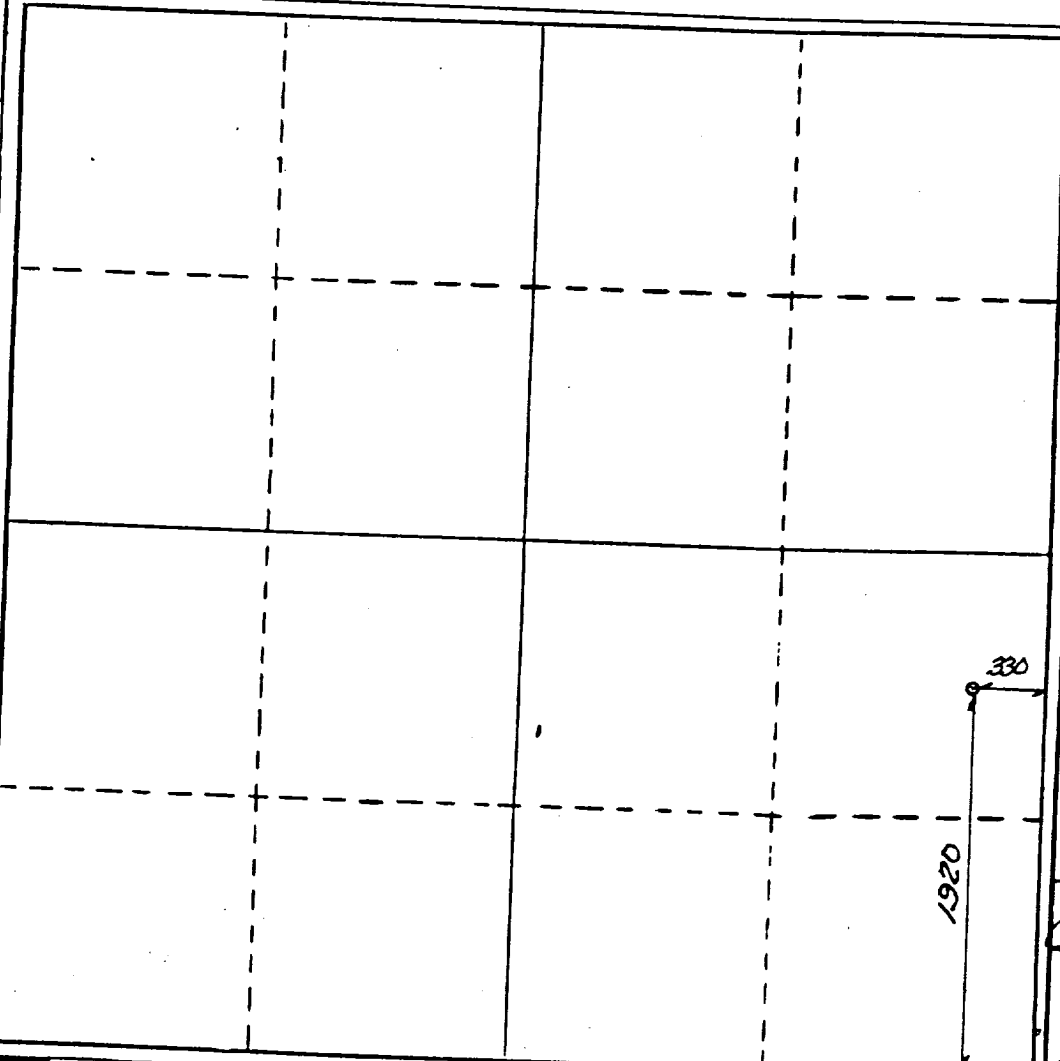

CERTIFICATION

I hereby certify that the information contained herein is true and complete to the best of my knowledge and belief.

Name: R. D. Osterhout
 Position: Project Manager
 Company: Pepco
 Date: August 14, 1989

I hereby certify that the well location shown on this plat was plotted from field notes of actual surveys made by me or under my supervision, and that the same is true and correct to the best of my knowledge and belief.

AUGUST 14 1989

Date Filed: _____

Registered Professional Engineer and/or Land Surveyor

5103

N. MEXICO

Certification No. _____

E. SHIELD

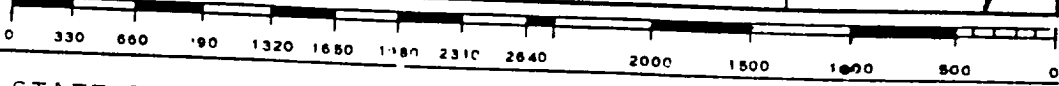

"X"

Submit 3 Copies to Appropriate District Office

State of New Mexico Energy, Minerals and Natural Resources Department

Form C-103 Revised 1-1-89

DISTRICT I P.O. Box 1980, Hobbs, NM 88240

OIL CONSERVATION DIVISION P.O. Box 2088 Santa Fe, New Mexico 87504-2088

DISTRICT II P.O. Drawer DD, Artesia, NM 88210

DISTRICT III 1000 Rio Brazos Rd., Artec, NM 87410

WELL API NO. 30-007-20102

5. Indicate Type of Lease STATE [] FEE [X]

6. State Oil & Gas Lease No.

SUNDRY NOTICES AND REPORTS ON WELLS (DO NOT USE THIS FORM FOR PROPOSALS TO DRILL OR TO DEEPEN OR PLUG BACK TO A DIFFERENT RESERVOIR. USE "APPLICATION FOR PERMIT" (FORM C-101) FOR SUCH PROPOSALS.)

7. Lease Name or Unit Agreement Name Canadian River 3220

1. Type of Well: OIL WELL [] GAS WELL [] OTHER Coal Methane

8. Well No. 291 I

2. Name of Operator Pennzoil Exploration & Production Company

9. Pool name or Wildcat Wildcat

3. Address of Operator P.O. Box 2967, Houston, TX 77252

4. Well Location Unit Letter I : 330 Feet From The East Line and 1920 Feet From The South Line Section 29 Township 32 N Range 20 E NMPM Colfax County

10. Elevation (Show whether DF, RKB, RT, GR, etc.) 8058 GR

11. Check Appropriate Box to Indicate Nature of Notice, Report, or Other Data NOTICE OF INTENTION TO: PERFORM REMEDIAL WORK [] PLUG AND ABANDON [] TEMPORARILY ABANDON [] CHANGE PLANS [] PULL OR ALTER CASING [] OTHER: [] SUBSEQUENT REPORT OF: REMEDIAL WORK [] ALTERING CASING [] COMMENCE DRILLING OPNS. [] PLUG AND ABANDONMENT [] CASING TEST AND CEMENT JOB [] OTHER: Temporary Abandonment [X]

12. Describe Proposed or Completed Operations (Clearly state all pertinent details, and give pertinent dates, including estimated date of starting any proposed work) SEE RULE 1103.

Temporary abandonment status is requested for this well. The well was drilled, logged and cased on 9/11/89, but not perforated or completed. The well will be used for coal methane production if testing proves the area to be economically viable for this process.

Casing integrity test conducted 8/9/90 11:00 am - 529 psia 11:30 am - 529 psia 30 minute pressure drop - 0 psi

I hereby certify that the information above is true and complete to the best of my knowledge and belief. SIGNATURE [Signature] TITLE Operations Superintendent DATE 9/5/90 TYPE OR PRINT NAME L. D. Williamson TELEPHONE NO. 505-376-2817

(This space for State Use) APPROVED BY [Signature] TITLE DISTRICT SUPERVISOR DATE 9-6-90

R-9210

AUTHORIZATION FOR MAINTENANCE IN SITU IN OR TEMPORARY ABANDONMENT STATUS EXPIRES 9-6-905